

# United States Patent [19]

Kato et al.

[11] Patent Number: **Des. 281,434**

[45] Date of Patent: **\*\* Nov. 19, 1985**

[54] **TYPEWRITER**

[75] Inventors: **Shigemasa Kato**, Kanagawa; **Sanae Takada**, Tokyo, both of Japan

[73] Assignee: **Tokyo Juki Industrial Co., Ltd.**, Tokyo, Japan

[\*\*] Term: **14 Years**

[21] Appl. No.: **552,285**

[22] Filed: **Nov. 16, 1983**

[30] **Foreign Application Priority Data**

Jul. 29, 1983 [JP] Japan ..... 58-033407

[52] U.S. Cl. .... **D18/1**

[58] Field of Search ..... D18/1, 2, 11, 13; D14/100, 107, 111, 115; 400/689-695

[56] **References Cited**

**U.S. PATENT DOCUMENTS**

D. 155,781 11/1949 Clement ..... D18/1  
D. 257,771 1/1981 Dargatz ..... D14/111

D. 278,340 4/1985 Enomoto ..... D14/100  
4,013,342 3/1977 Narodny ..... D18/1 X

**OTHER PUBLICATIONS**

Smith Corona Flyer #CPE 0787 printed 4/82-Type-tronk II.

*Primary Examiner*—Louis S. Zarfes

*Attorney, Agent, or Firm*—Abelman, Frayne, Rezac & Schwab

[57] **CLAIM**

The ornamental design for a typewriter, as shown.

**DESCRIPTION**

FIG. 1 is a perspective view of a typewriter showing our new design;

FIG. 2 is a bottom plan view thereof;

FIG. 3 is a front elevational view thereof;

FIG. 4 is a top plan view thereof;

FIG. 5 is a rear elevational view thereof;

FIG. 6 is a right side elevational view thereof; and

FIG. 7 is a left side elevational view thereof.

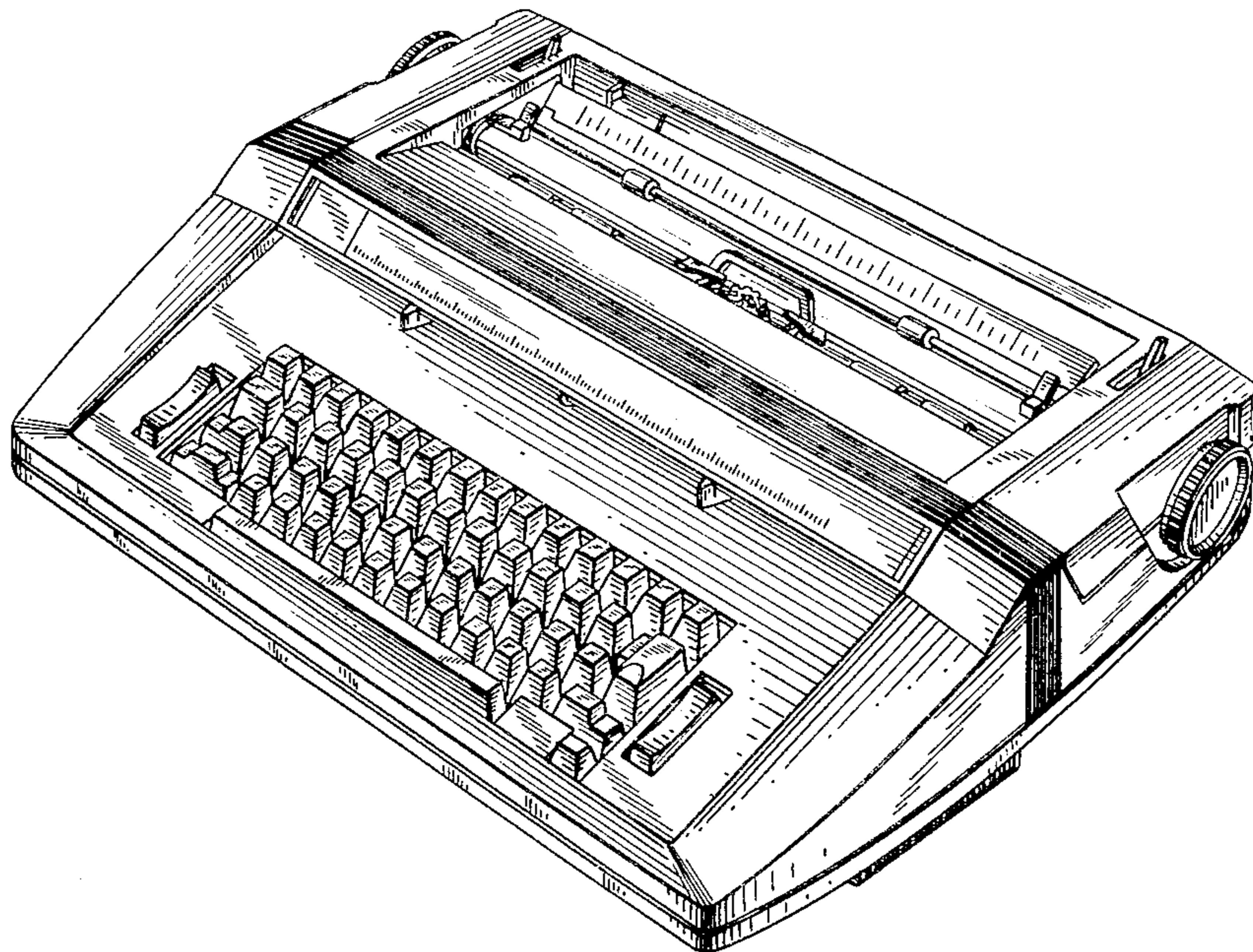

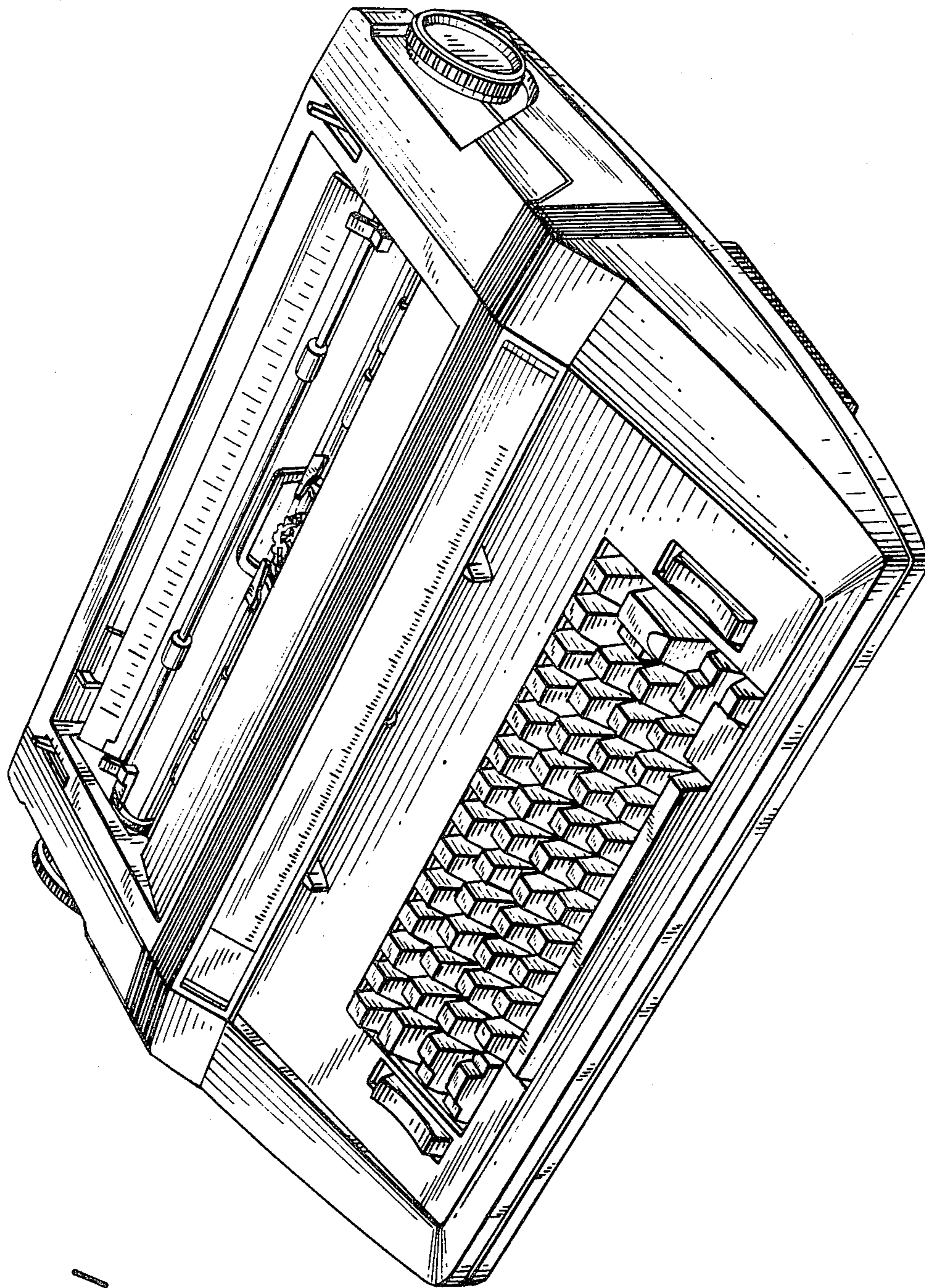

FIG. 1

FIG. 2

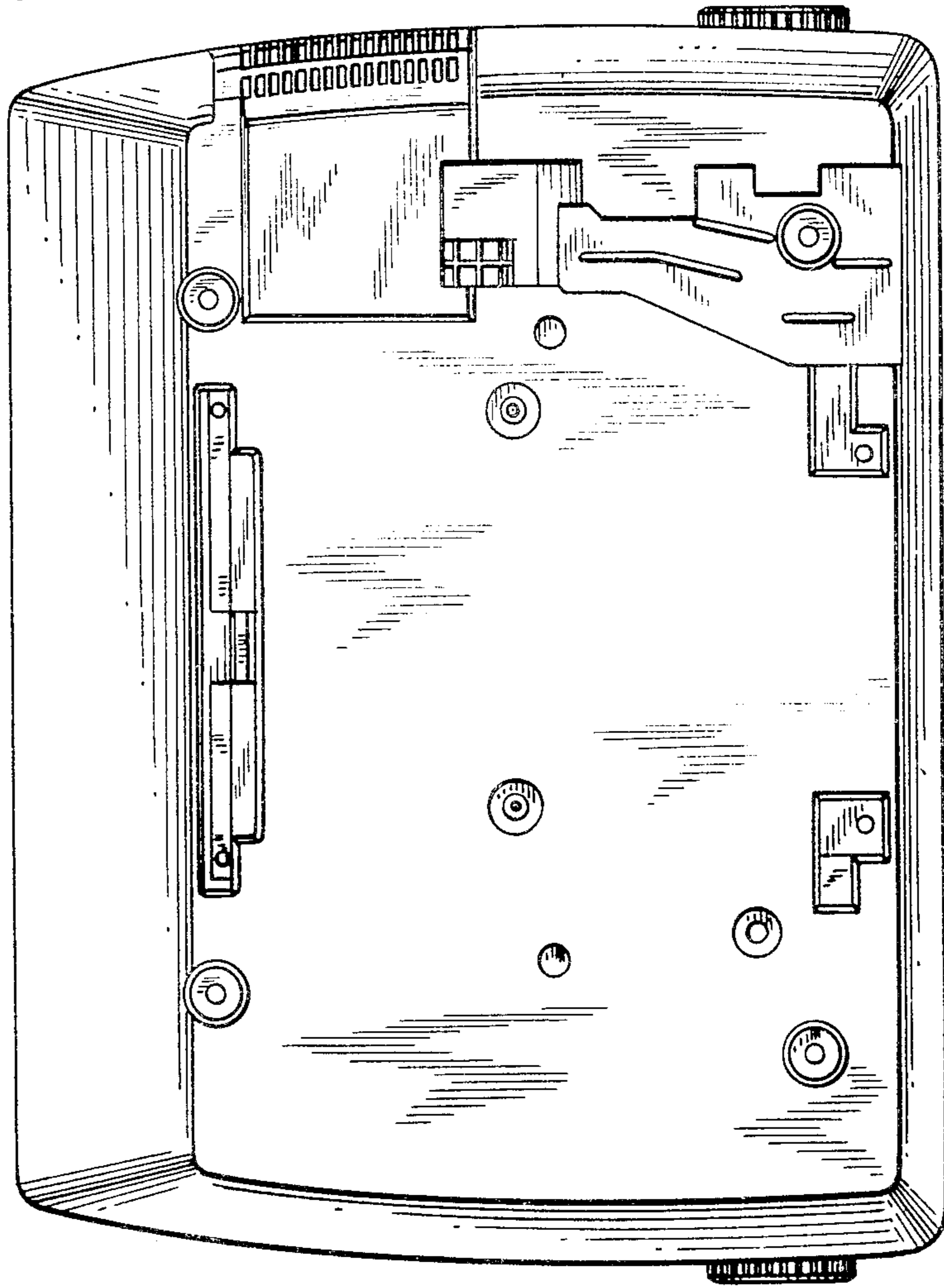

FIG. 6

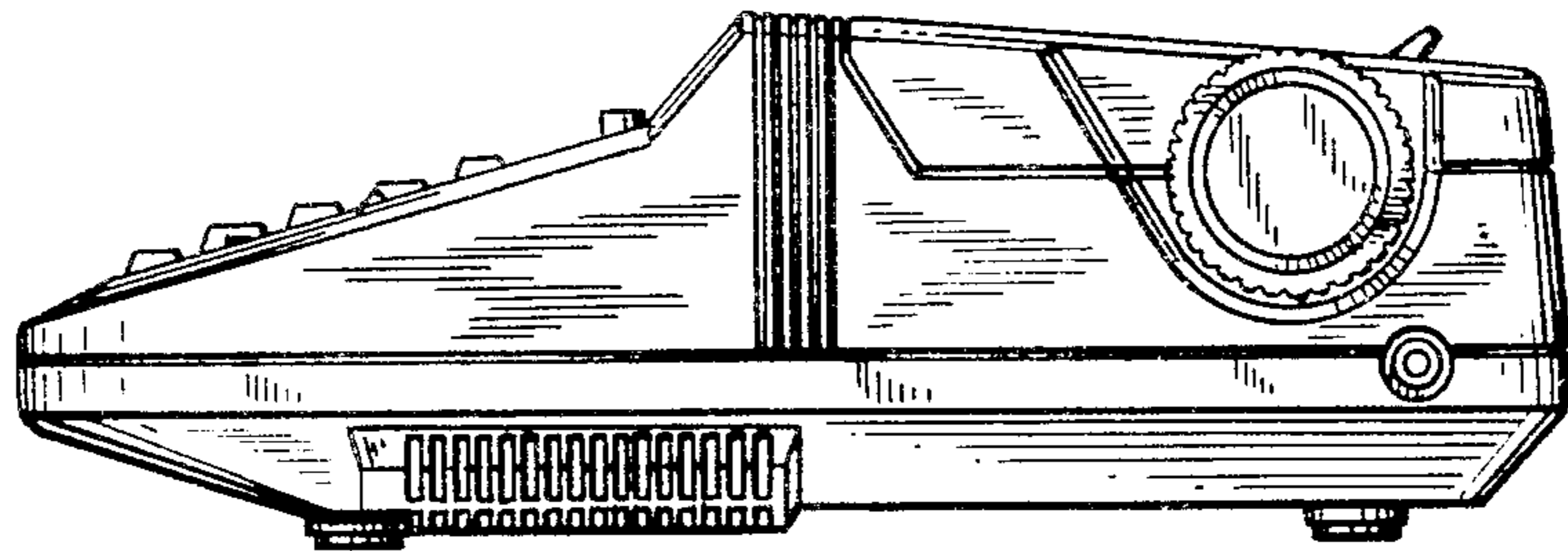

FIG. 3

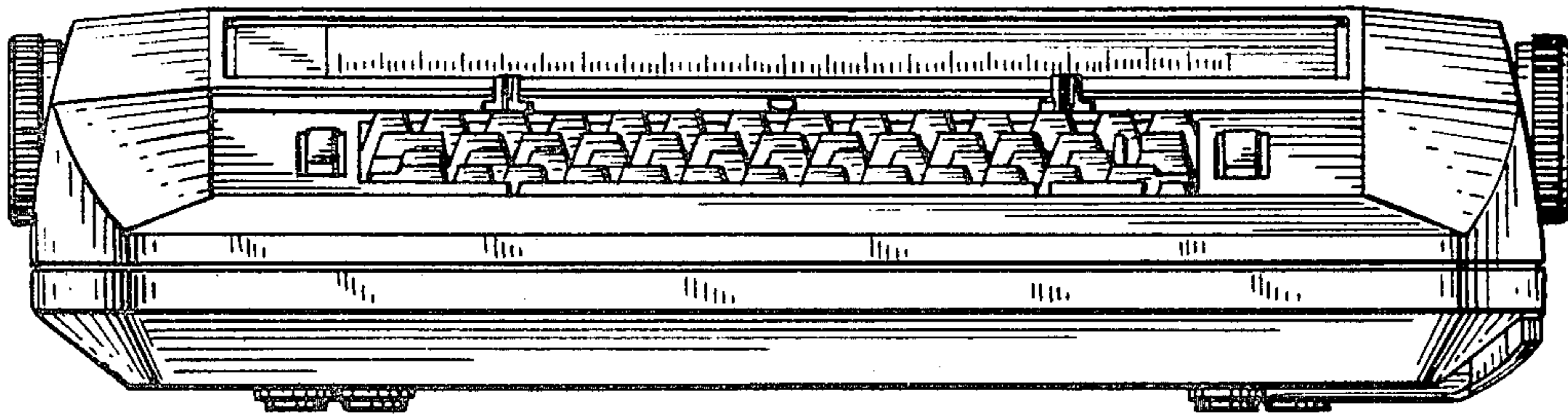
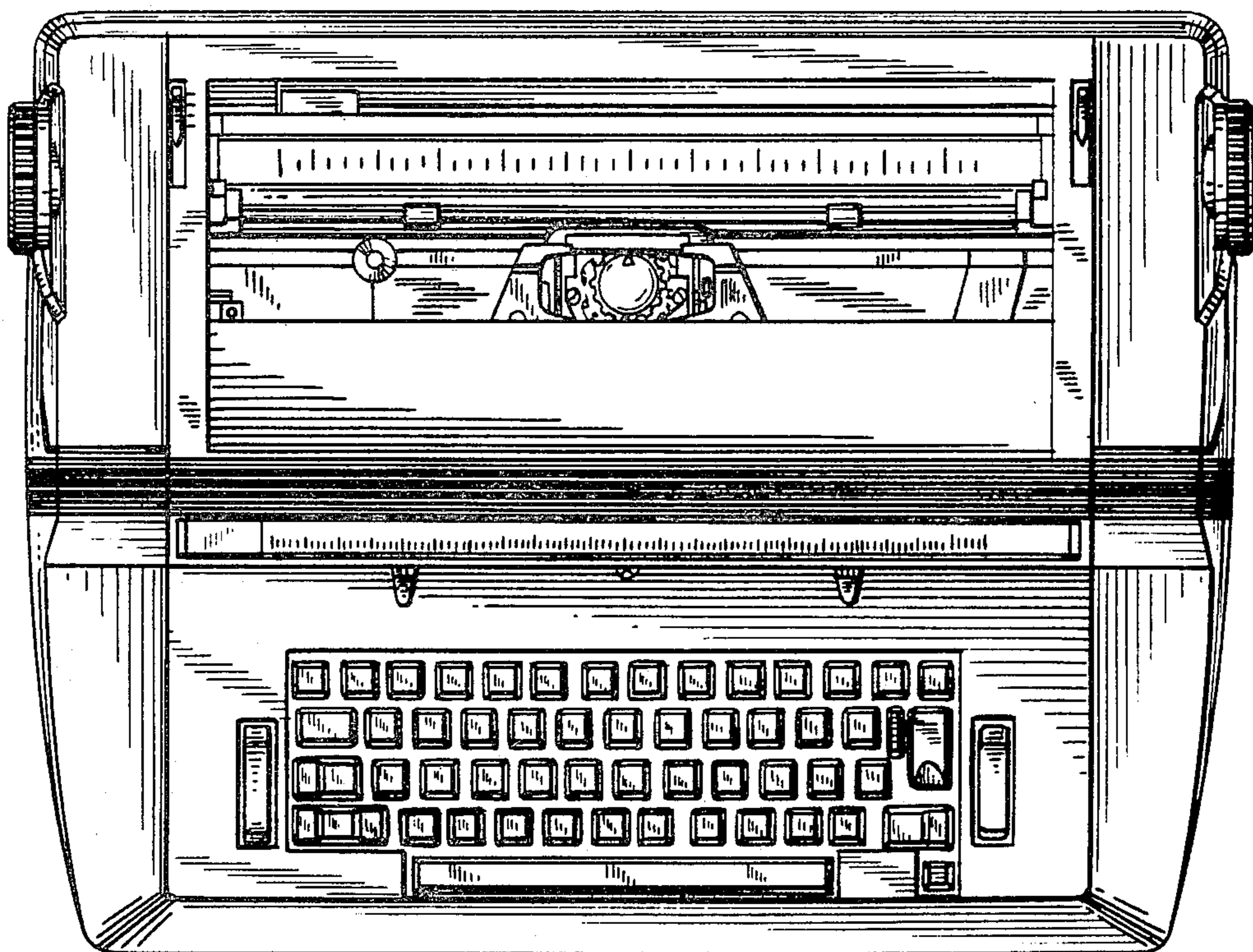
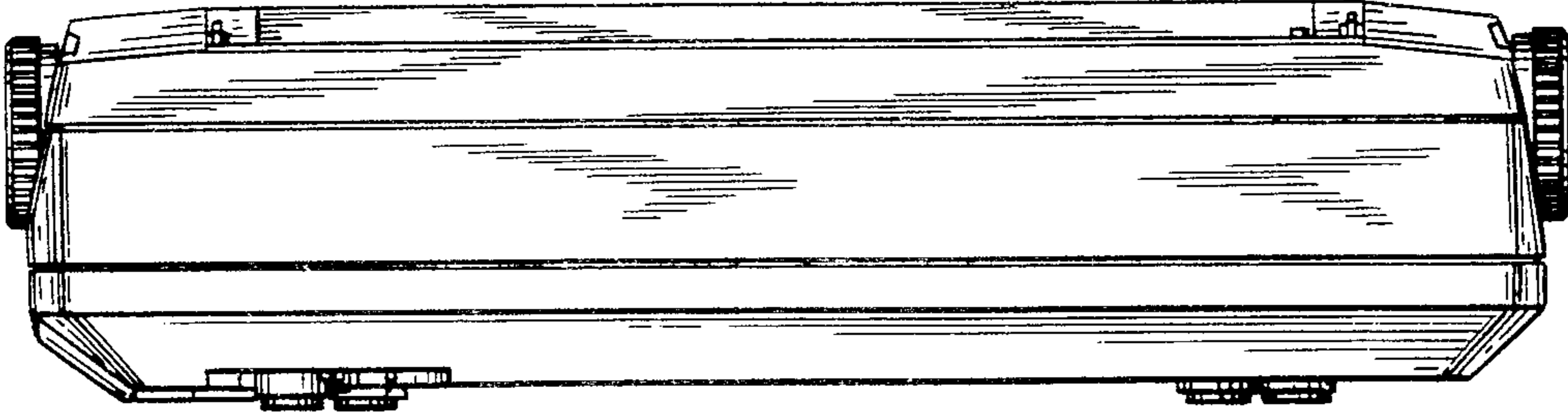

FIG. 4



*FIG. 5*



*FIG. 7*

