

[54] **TURNING MACHINE**

[75] **Inventors:** Carl J. Myers, Mentor; Rainer B. Teufel, Columbus, both of Ohio

[73] **Assignee:** The Warner & Swasey Company, Cleveland, Ohio

[**] **Term:** 14 Years

[21] **Appl. No.:** 457,333

[22] **Filed:** Jan. 12, 1983

[52] **U.S. Cl. D15/130**

[58] **Field of Search D15/130, 122, 199; 82/2 R, 2 B**

[56] **References Cited**

U.S. PATENT DOCUMENTS

D. 220,721	5/1971	Stevens	D15/130
D. 252,575	8/1979	Simmons	D15/130
D. 265,204	6/1982	Turchan et al.	D15/130
D. 265,319	7/1982	Watanabe et al.	D15/130
D. 270,449	9/1983	Myers et al.	D15/130
3,844,186	10/1974	Youden et al.	82/2 R

OTHER PUBLICATIONS

American Machinist; 3/1981; p. 168, Wickman Taiyo CNC Bar Chucker.

American Machinist; 7/1980; p. 104; MMTS Inc Okuma CNC Chucker.

Primary Examiner—B. J. Bullock

Attorney, Agent, or Firm—Howard G. Massung

[57] **CLAIM**

The ornamental design for a turning machine, substantially as shown and described.

DESCRIPTION

FIG. 1 is a perspective view of a turning machine embodying our new design;

FIG. 2 is a front view thereof;

FIG. 3 is a right side view thereof;

FIG. 4 is a left side view thereof;

FIG. 5 is a rear view thereof;

FIG. 6 is a top view thereof.

The bottom view, which is not shown, is unornamented and not visible in normal use.

The vents which are partially shown in FIGS. 4 and 6 are understood to repeat uniformly throughout the circumscribed area.

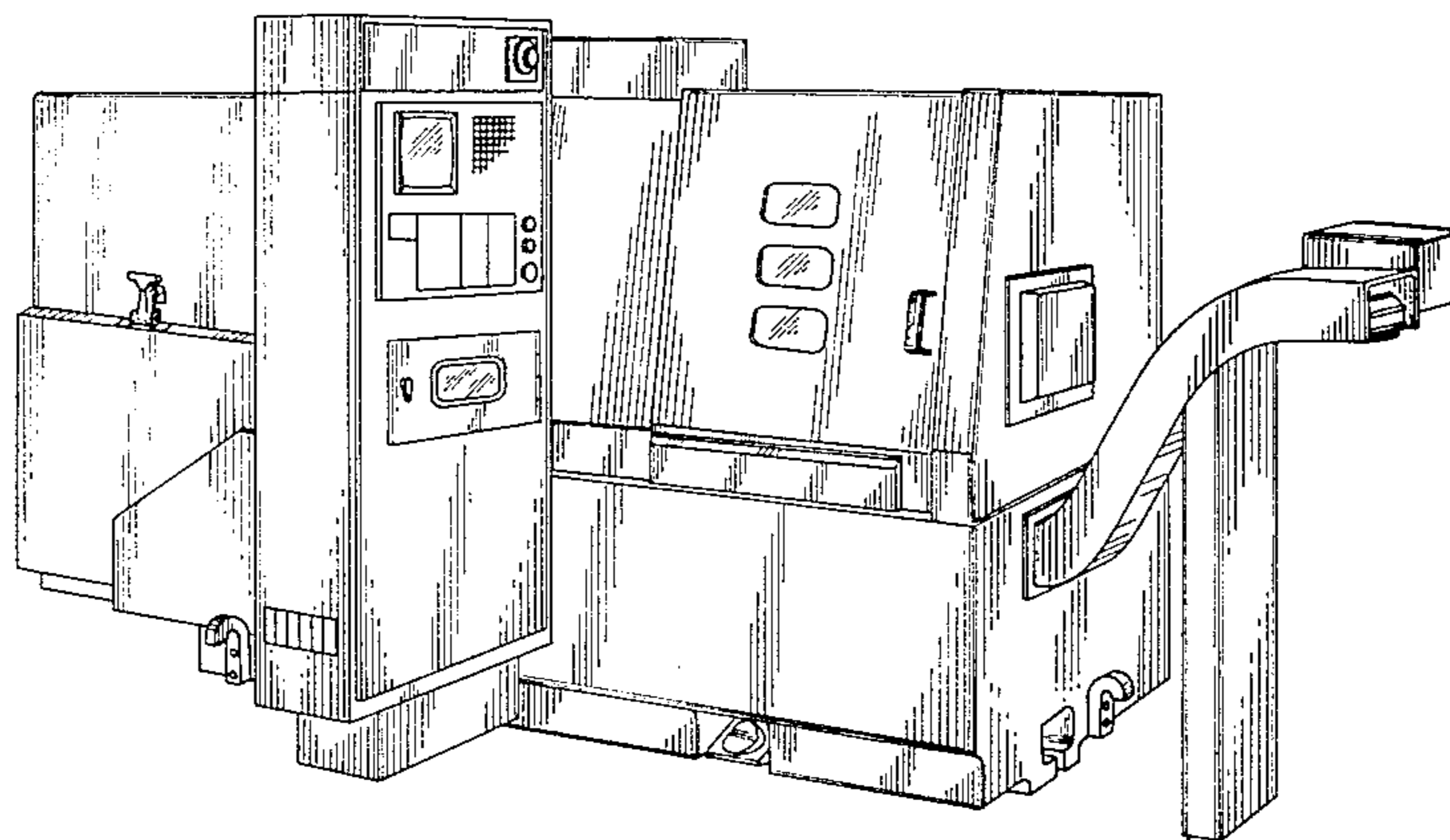

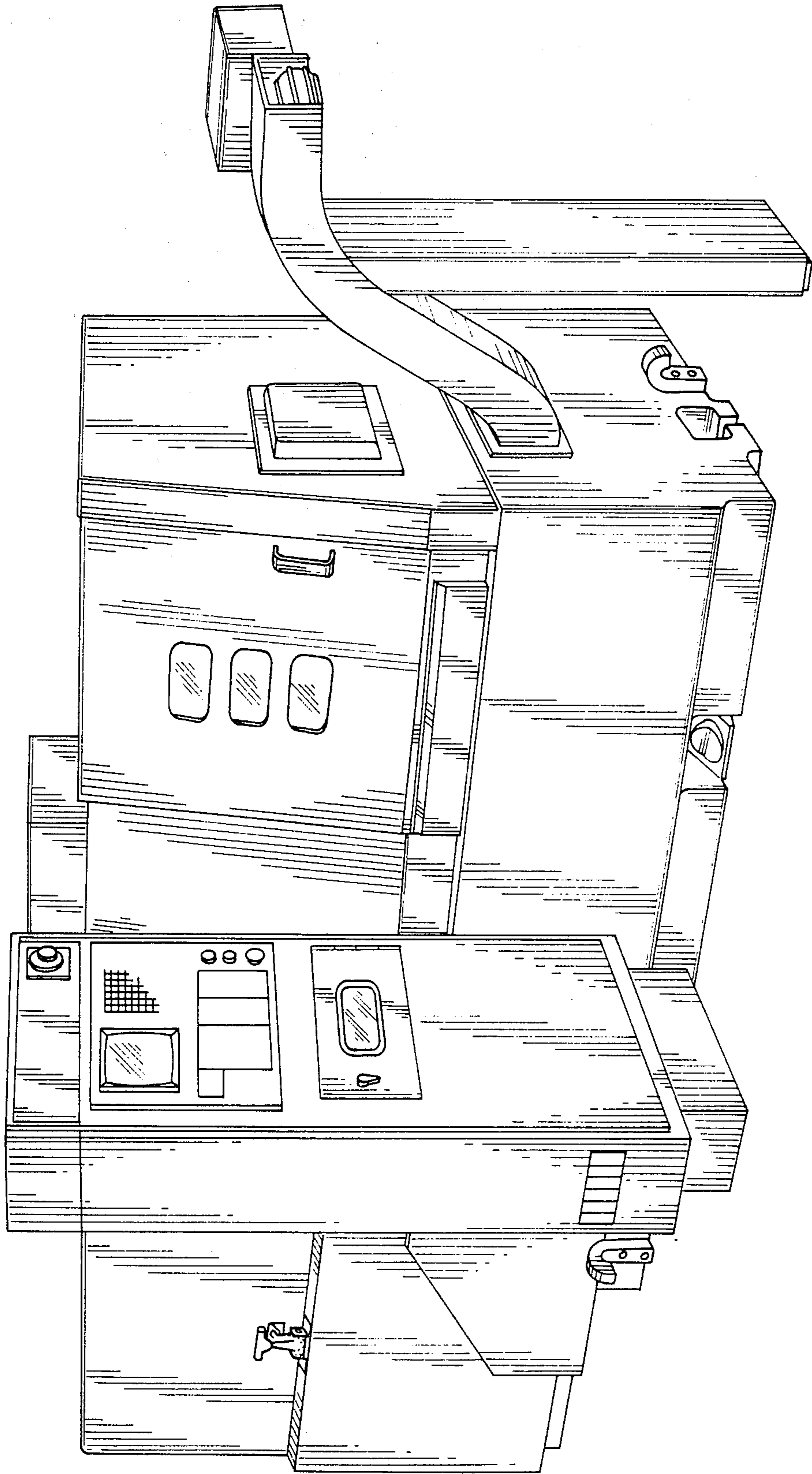

FIG. 1

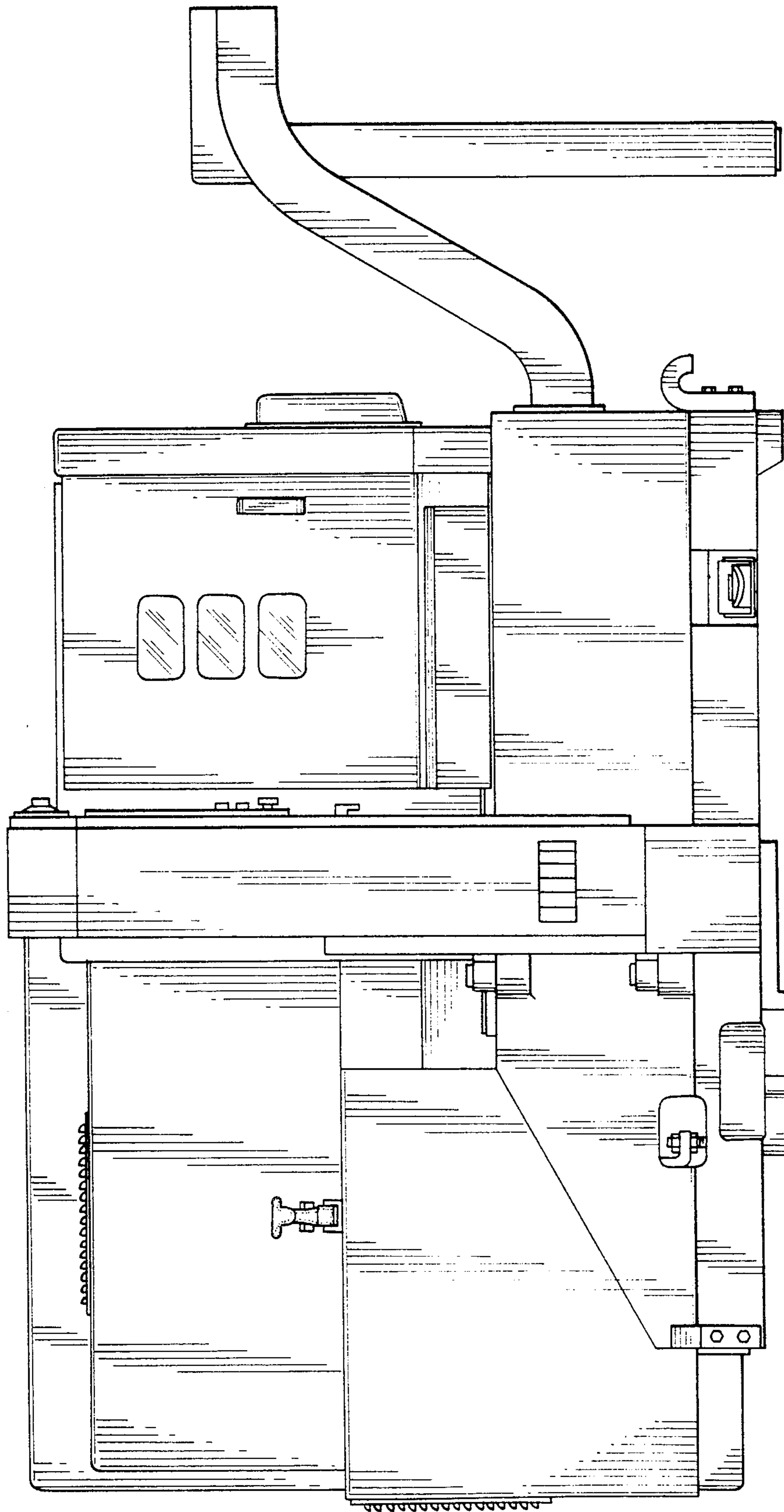

FIG. 2

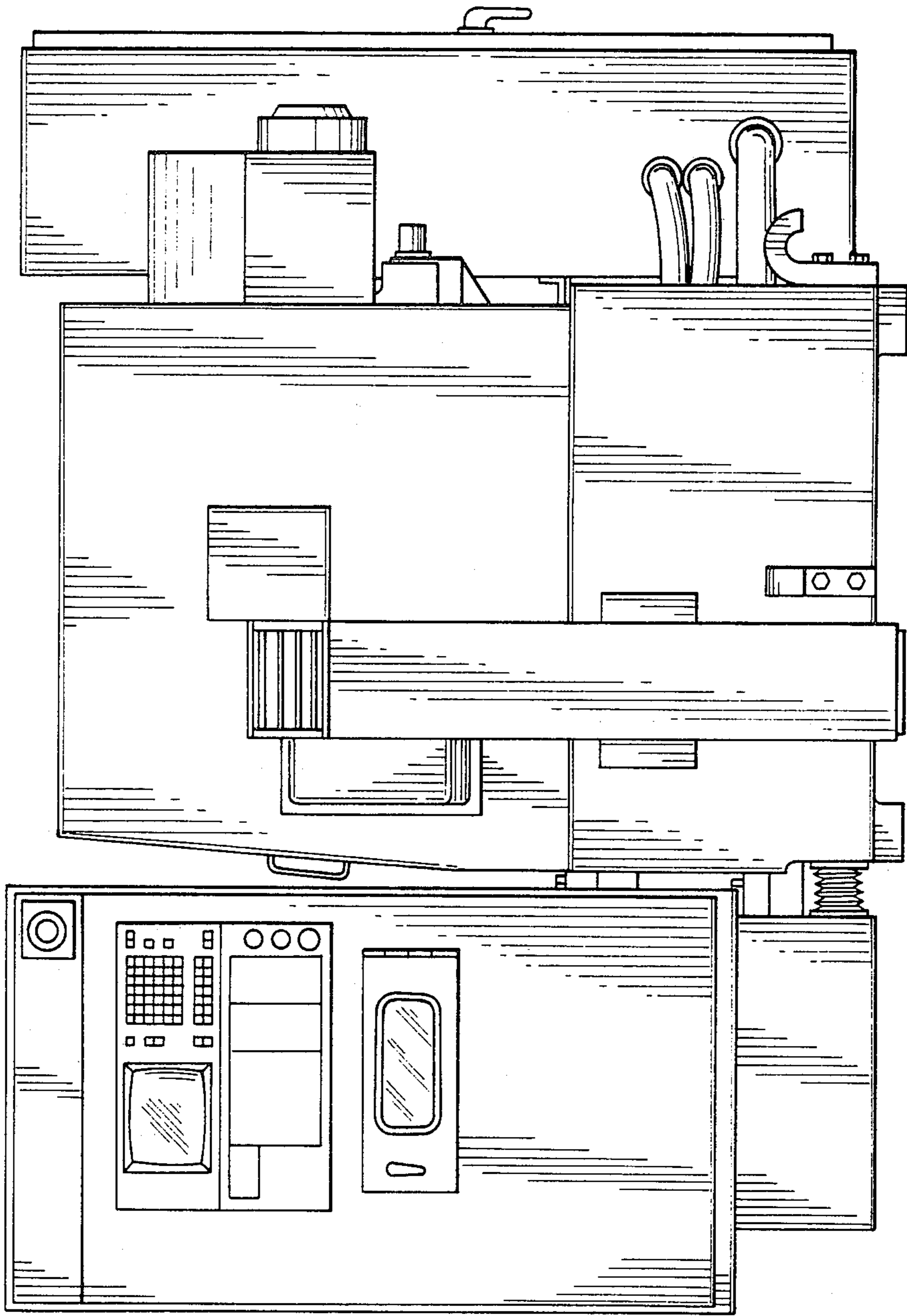

FIG. 3

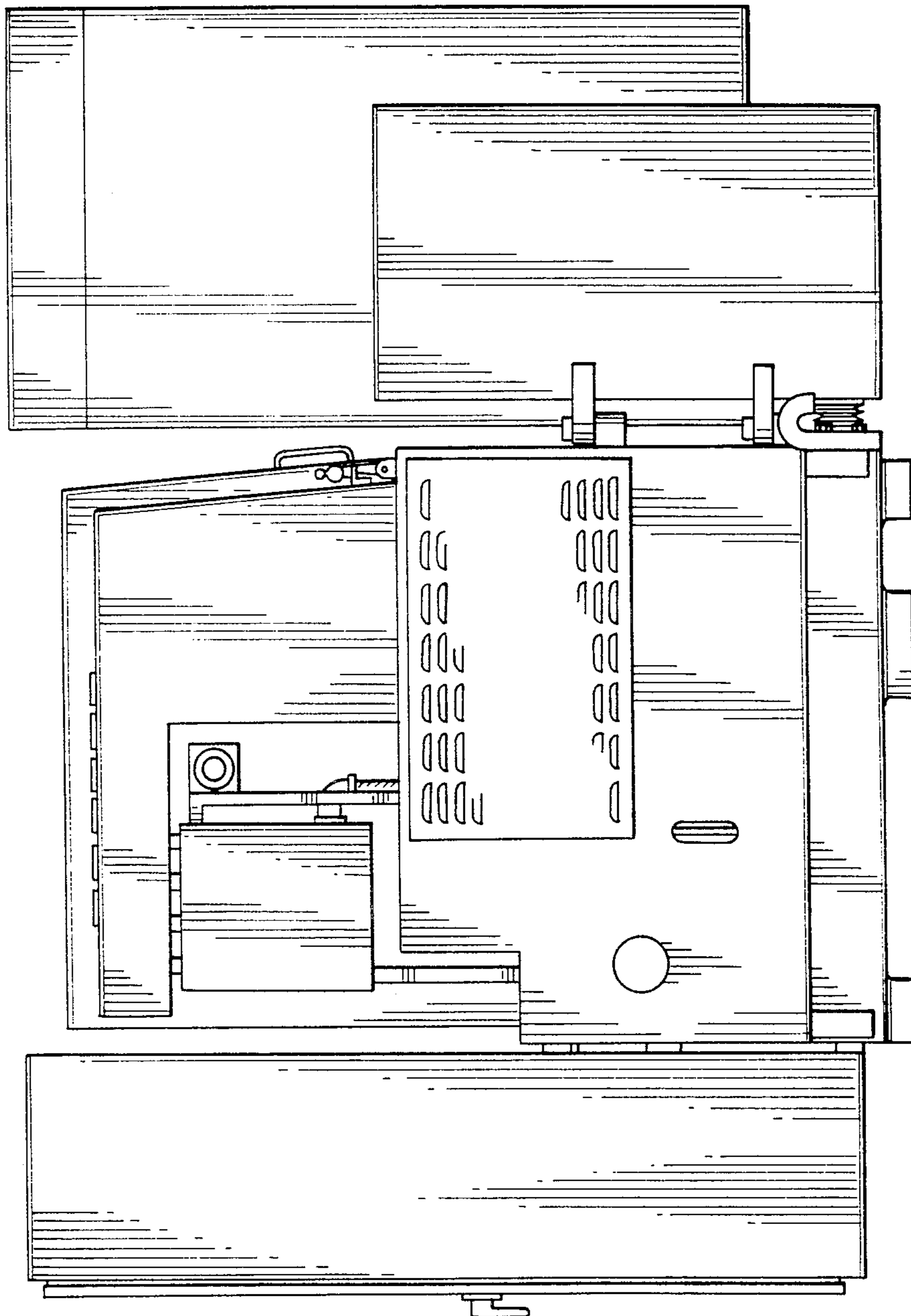

FIG. 4

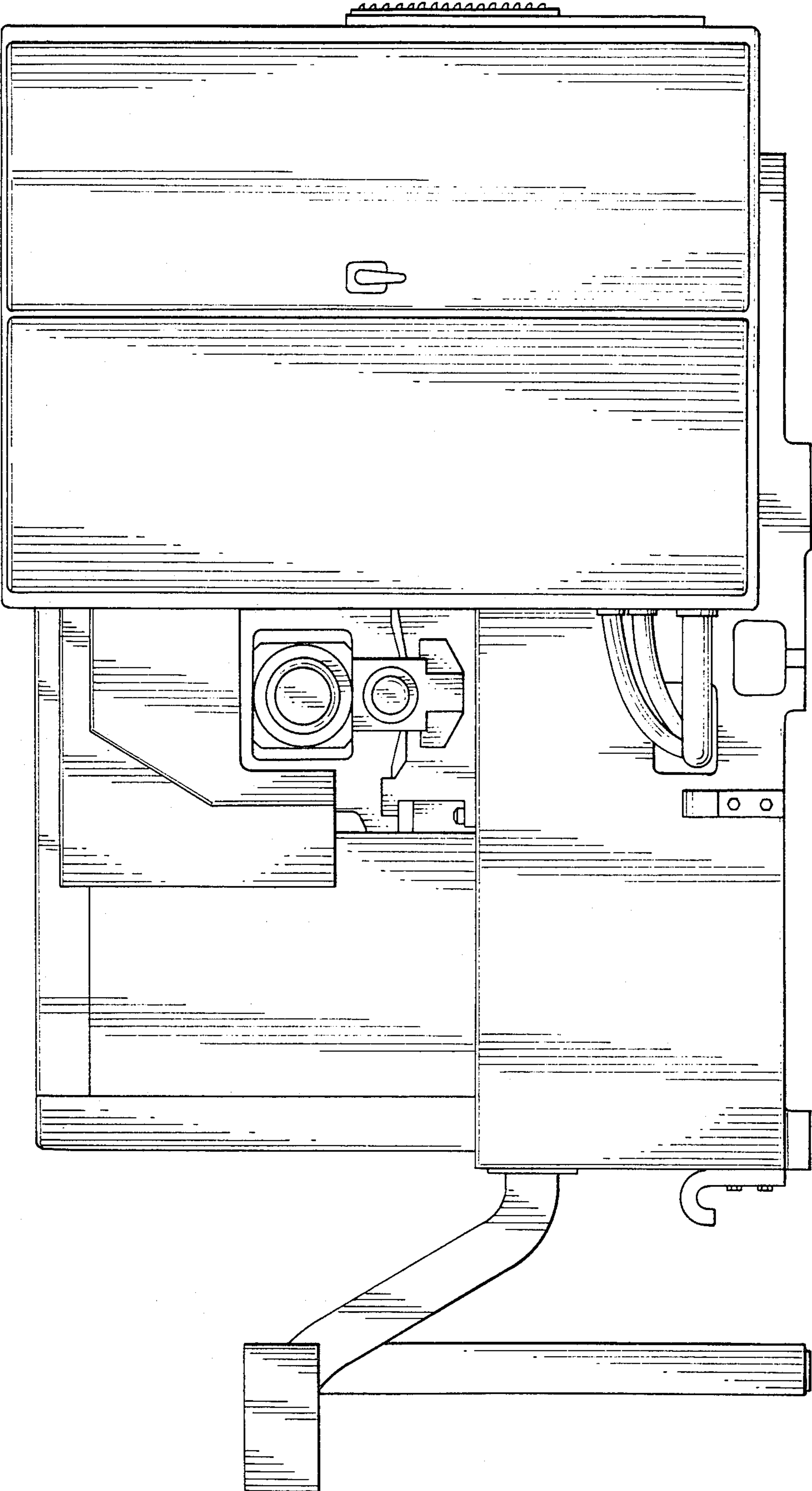

FIG. 5

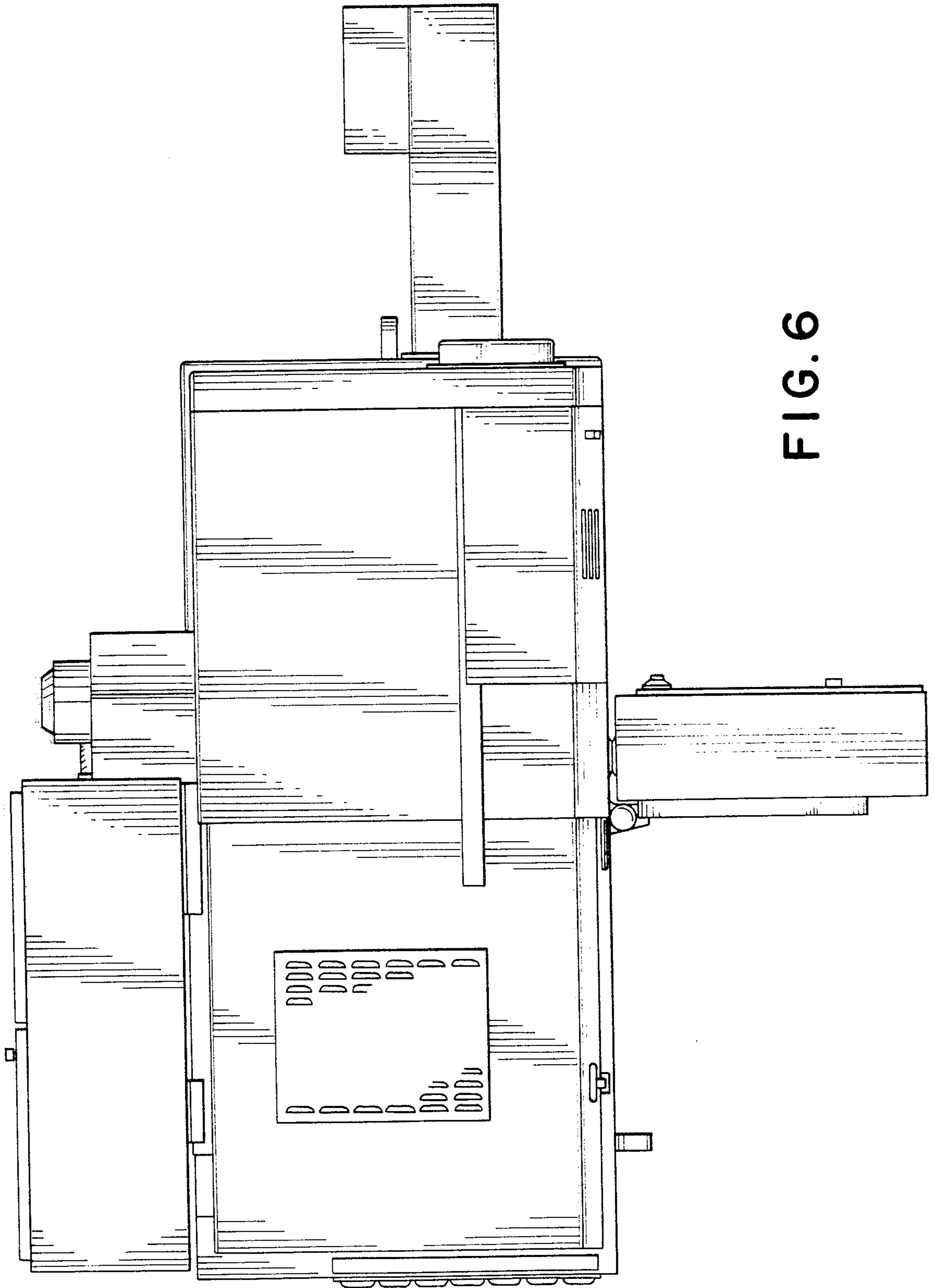

FIG. 6