

[54] TOY CASTLE

[76] Inventor: Benjamin D. Pope, 831 Jewell, Ferndale, Mich. 48220

[**] Term: 14 Years

[21] Appl. No.: 294,518

[22] Filed: Aug. 20, 1981

[52] U.S. Cl. D21/114

[58] Field of Search D21/114, 118, 115, 119; 46/12, 13; D25/7

[56] References Cited

U.S. PATENT DOCUMENTS

- D. 169,888 6/1953 Beyer 46/12
- D. 241,871 10/1976 Reiling D21/114
- D. 262,902 2/1982 Duarte D21/114

Primary Examiner—Charles A. Rademaker
Attorney, Agent, or Firm—Hauke & Patalidis

[57] CLAIM

The ornamental design for a toy castle, as shown and described.

DESCRIPTION

FIG. 1 is a front perspective view of a toy castle showing my new design;
 FIG. 2 is a rear perspective view thereof;
 FIG. 3 is a top plan view thereof;
 FIG. 4 is a rear elevational view thereof;
 FIG. 5 is a right side elevational view thereof;
 FIG. 6 is a left side elevational view thereof;
 FIG. 7 is a front elevational view thereof; and
 FIG. 8 is a bottom plan view thereof.
 The partially indicated texture is an overall pattern within the areas indicated.

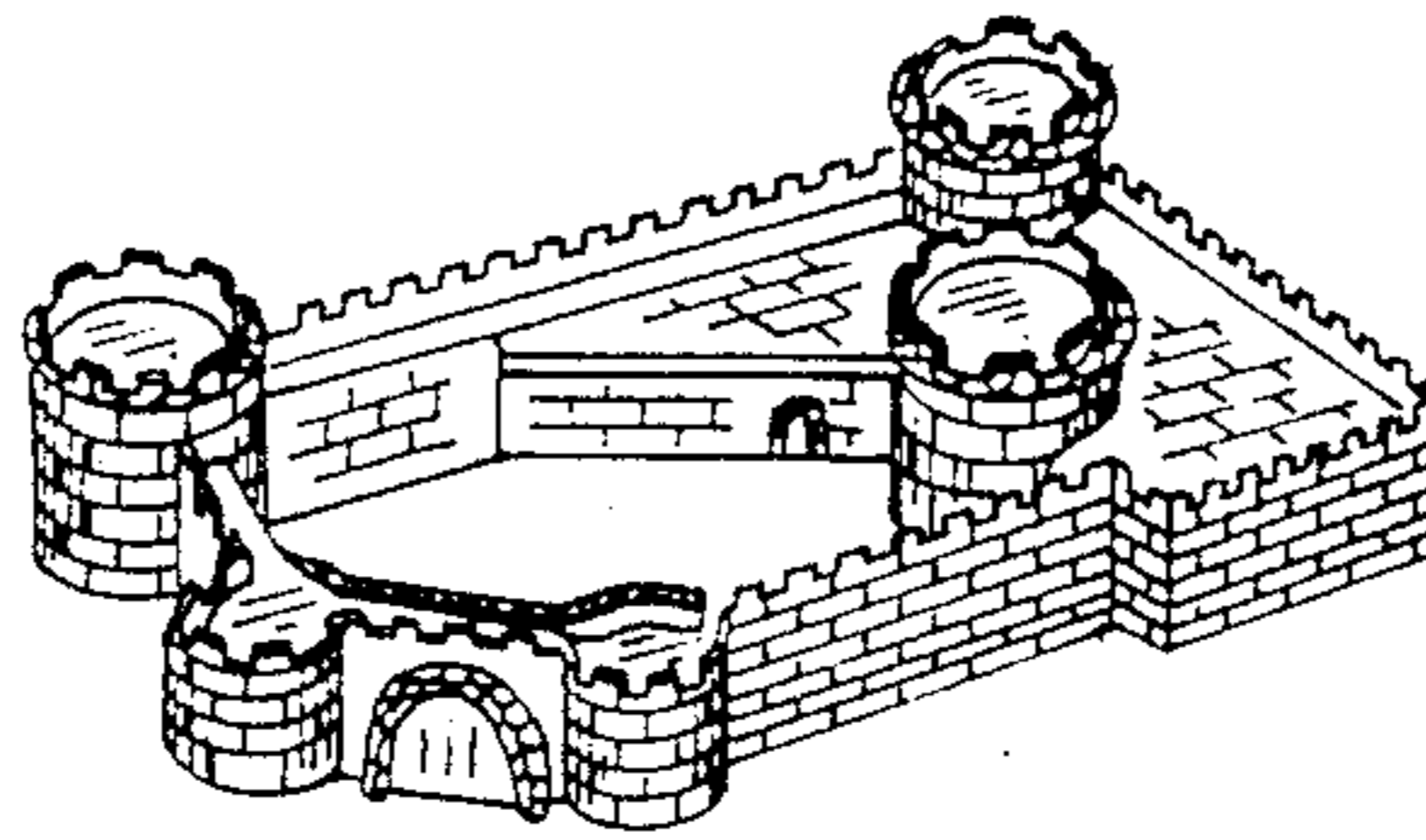

FIG. 1

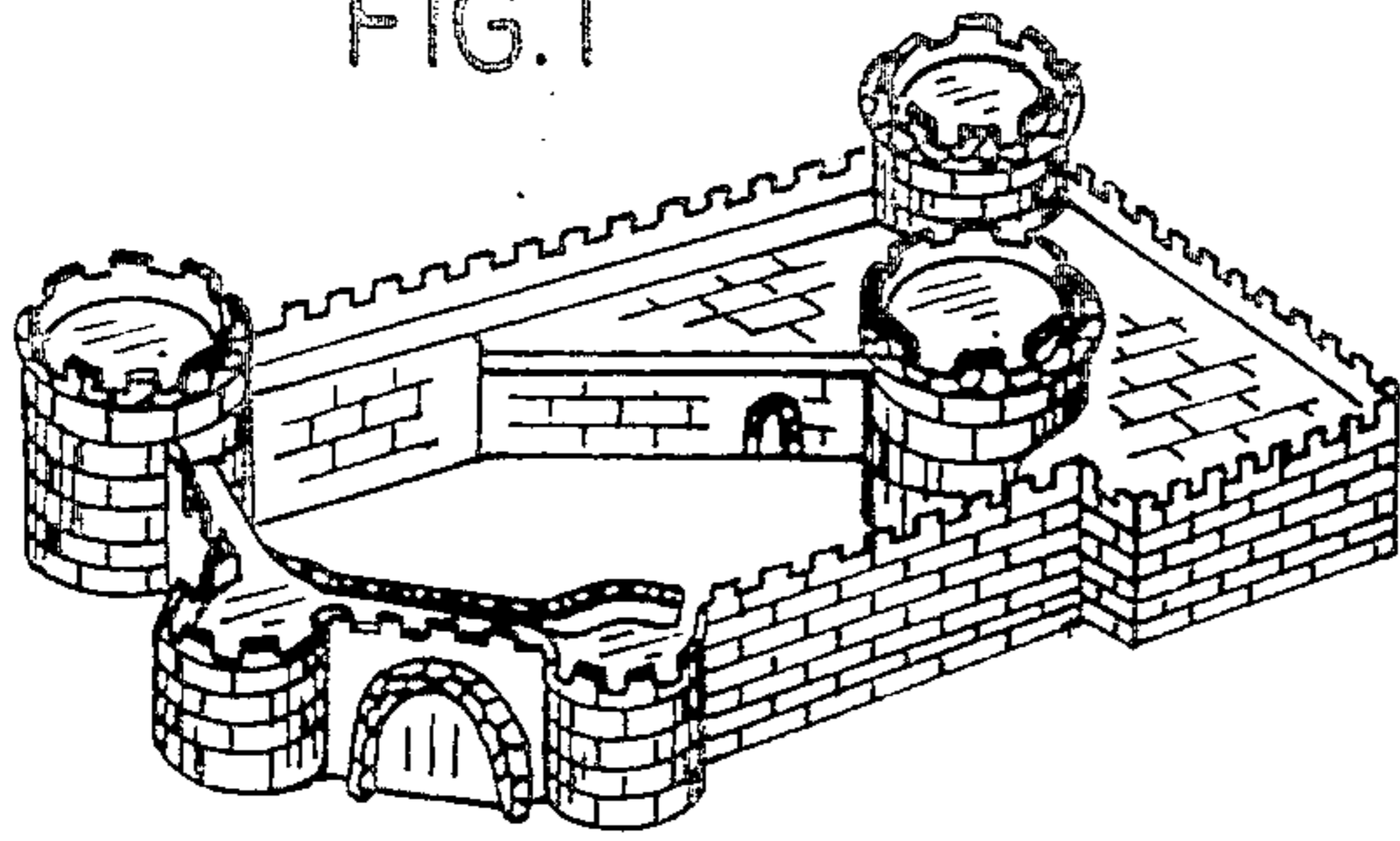

FIG. 2

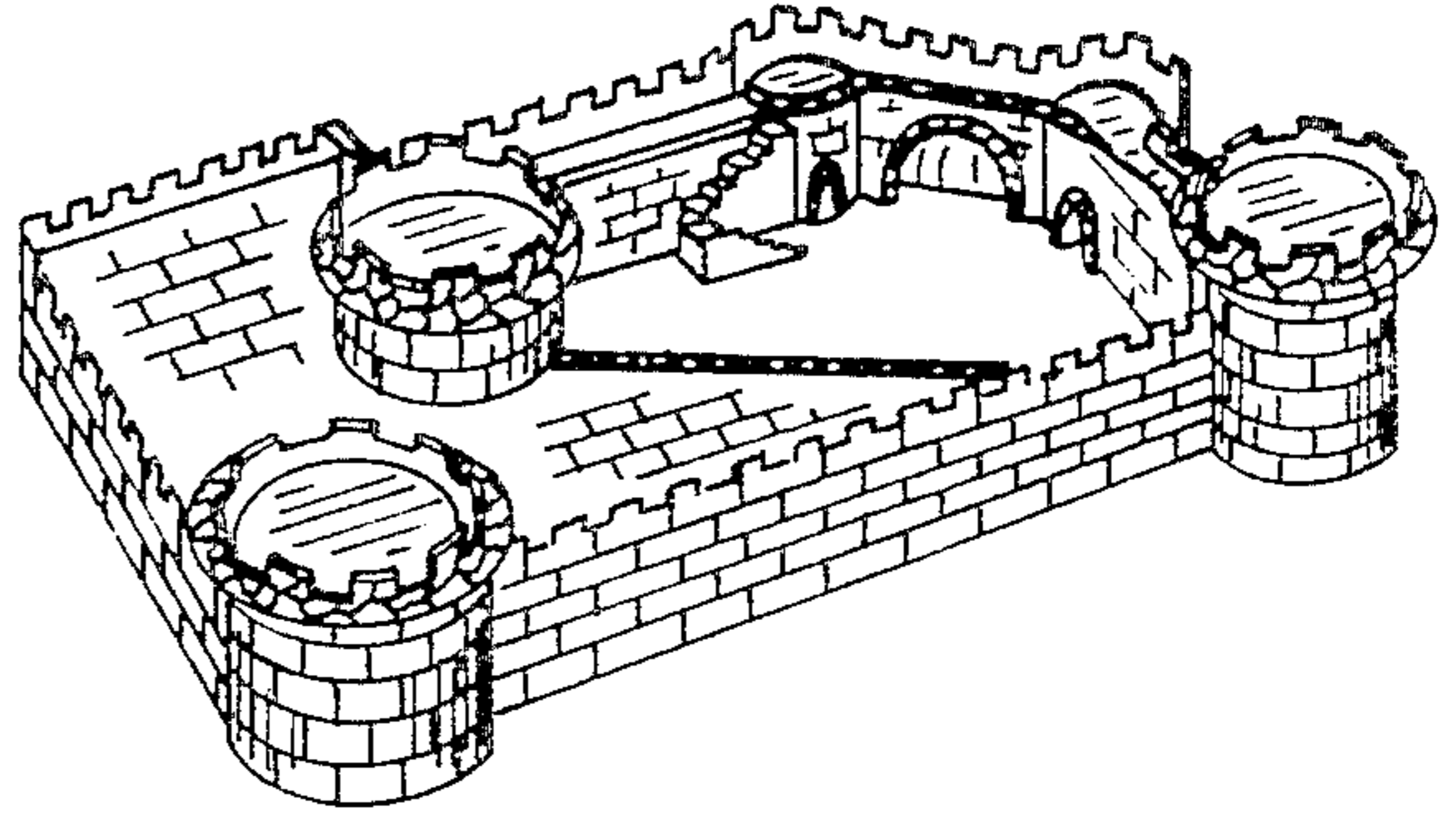

FIG. 3

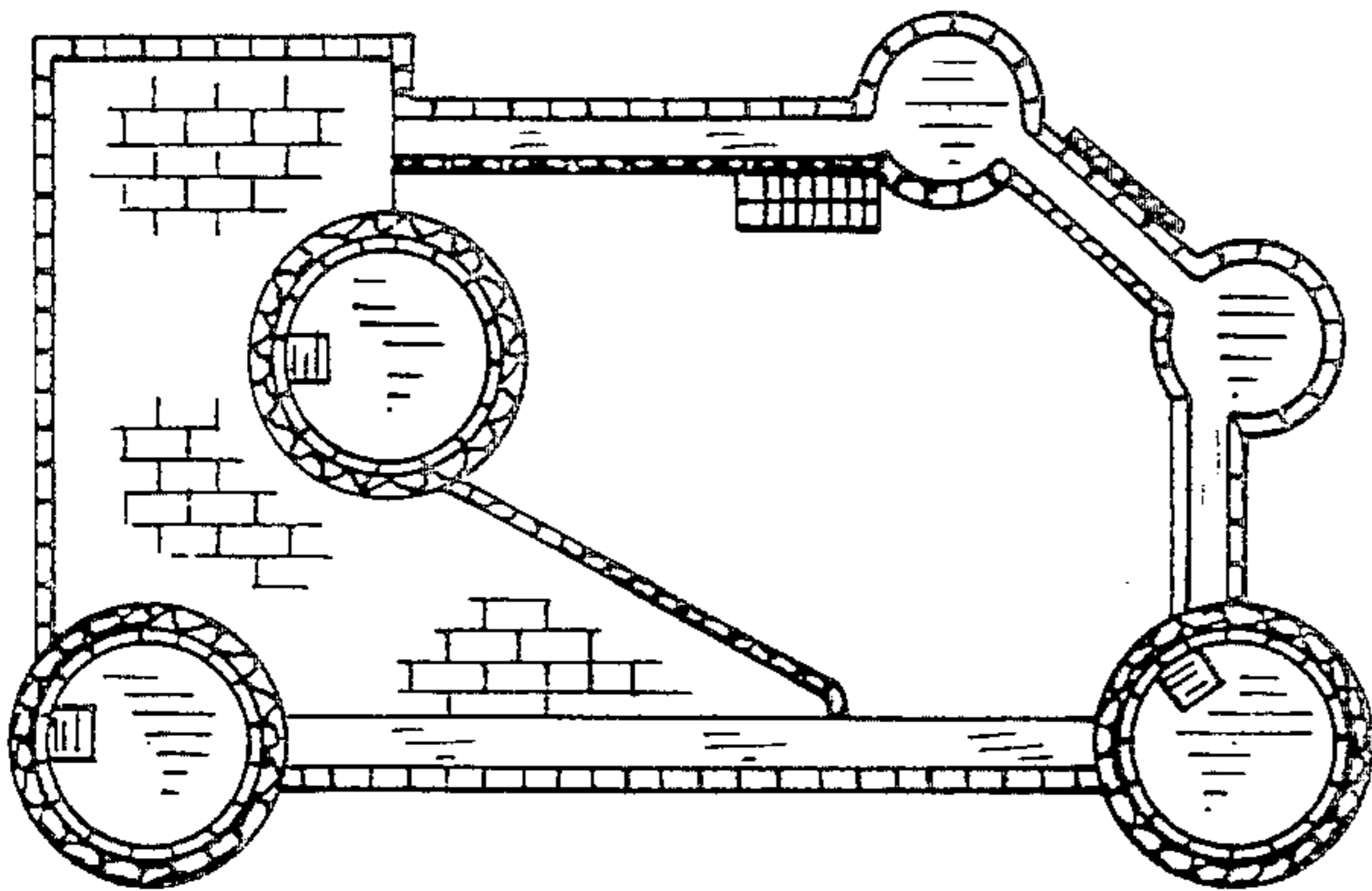

FIG. 5

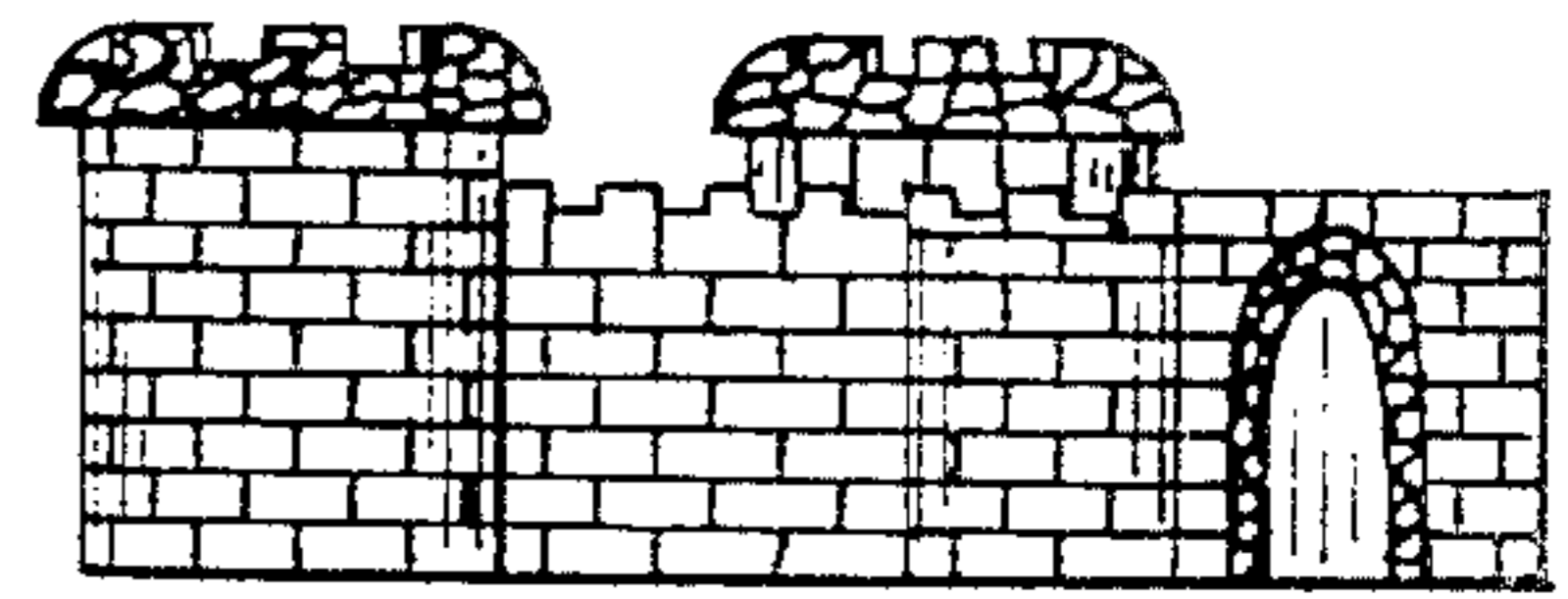

FIG. 4

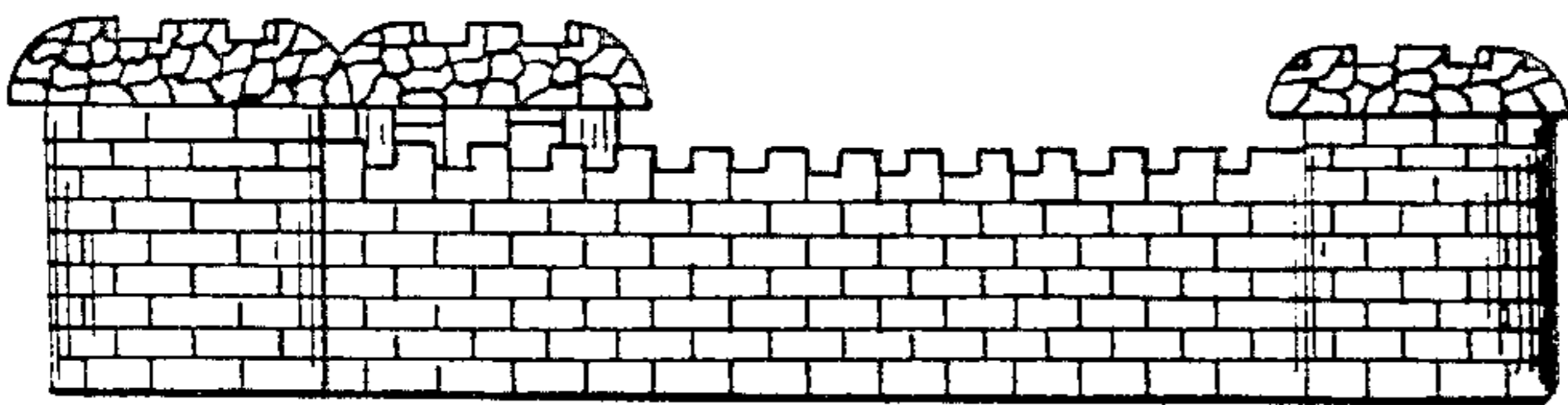

FIG. 6

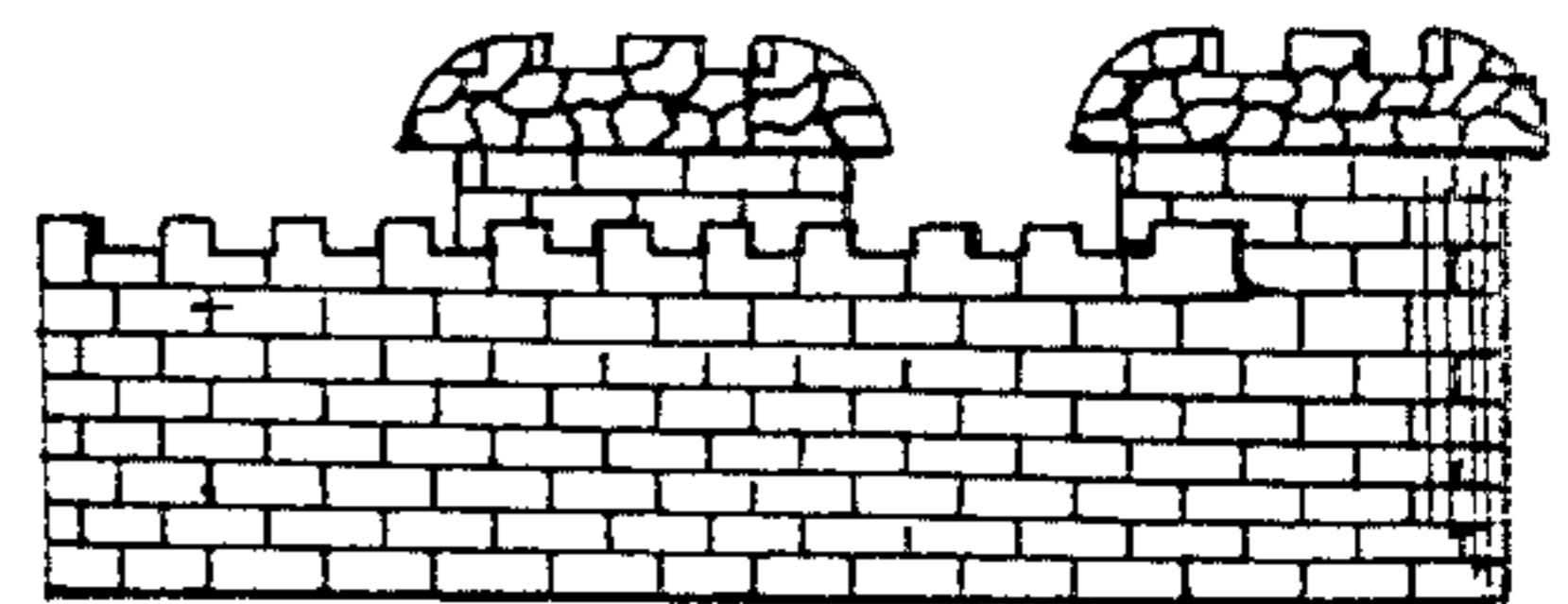

FIG. 8

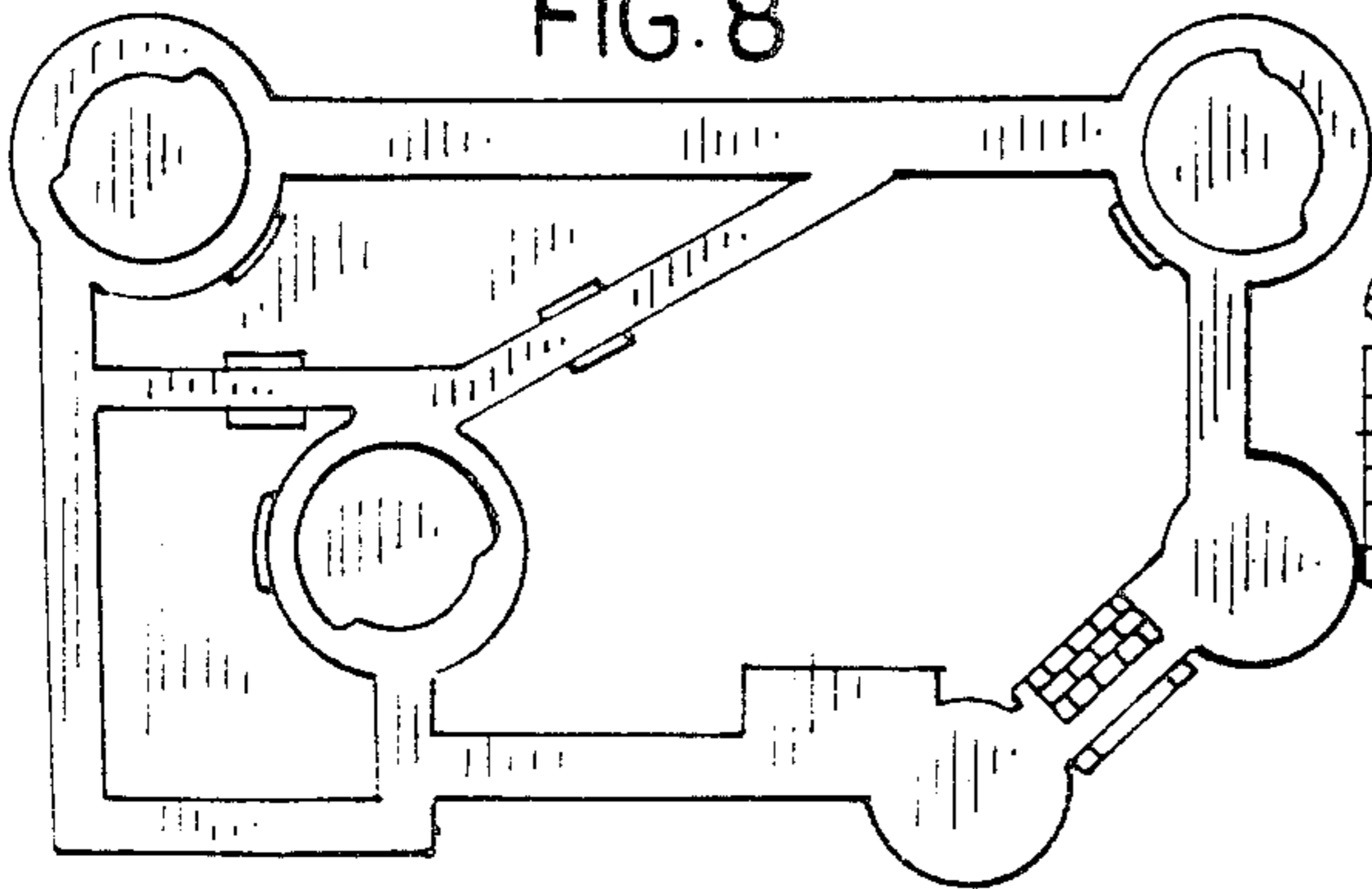

FIG. 7

