

[54] **CORNER BRACKET FOR PICTURE FRAME OR THE LIKE**

- [75] Inventor: Charles W. Buchanan, Scottsdale, Ariz.
 [73] Assignee: William E. Sornborger, Los Angeles, Calif.
 [**] Term: 14 Years
 [21] Appl. No.: 363,020
 [22] Filed: Mar. 29, 1982
 [52] U.S. Cl. D6/300; D8/403
 [58] Field of Search D6/246; 40/152, 152.1

[56] **References Cited**

U.S. PATENT DOCUMENTS

D. 35,089	9/1901	Child	D6/246
696,935	4/1902	Buechner	40/152
1,064,450	6/1913	Davison	40/152

Primary Examiner—Melvin B. Feifer

Attorney, Agent, or Firm—Don J. Flickinger

[57] **CLAIM**

The ornamental design for a corner bracket for picture frame or the like, as shown and described.

DESCRIPTION

FIG. 1 is a perspective view of a corner bracket for picture frame or the like showing my new design;
 FIG. 2 is a front elevation view of the corner bracket of FIG. 1;
 FIG. 3 is an end elevation view taken from the right-hand end of FIG. 1;
 FIG. 4 is a rear elevation view of the corner bracket of FIG. 1;
 FIG. 5 is a top plan view of the corner bracket of FIG.

1, it being understood that an end elevation view taken from the right-hand end of FIG. 1 would have a similar appearance;

FIG. 6 is a bottom plan view of the corner bracket of FIG. 1;

FIG. 7 is a perspective view of an alternate embodiment of a corner bracket in accordance with my new design therefor;

FIG. 8 is a front elevation view of the corner bracket of FIG. 7;

FIG. 9 is an end elevation view taken from the right-hand end of FIG. 7;

FIG. 10 is a rear elevation view of the corner bracket of FIG. 7;

FIG. 11 is a top plan view of the corner bracket of FIG. 7, it being understood that an end elevation view taken from the right-hand end of FIG. 7 would have a similar appearance;

FIG. 12 is a bottom plan view of the corner bracket of FIG. 7;

FIG. 13 is a perspective view of yet another embodiment of a corner bracket in accordance with my design therefor;

FIG. 14 is a front elevation view of the corner bracket of FIG. 13;

FIG. 15 is an end elevation view taken from the right-hand end of FIG. 13;

FIG. 16 is a rear elevation view of the corner bracket of FIG. 13;

FIG. 17 is a top plan view of the corner bracket of FIG. 13, it being understood that an end elevation view taken from the right-hand end of FIG. 13 would have a similar appearance; and

FIG. 18 is a bottom plan view of the corner bracket of FIG. 13.

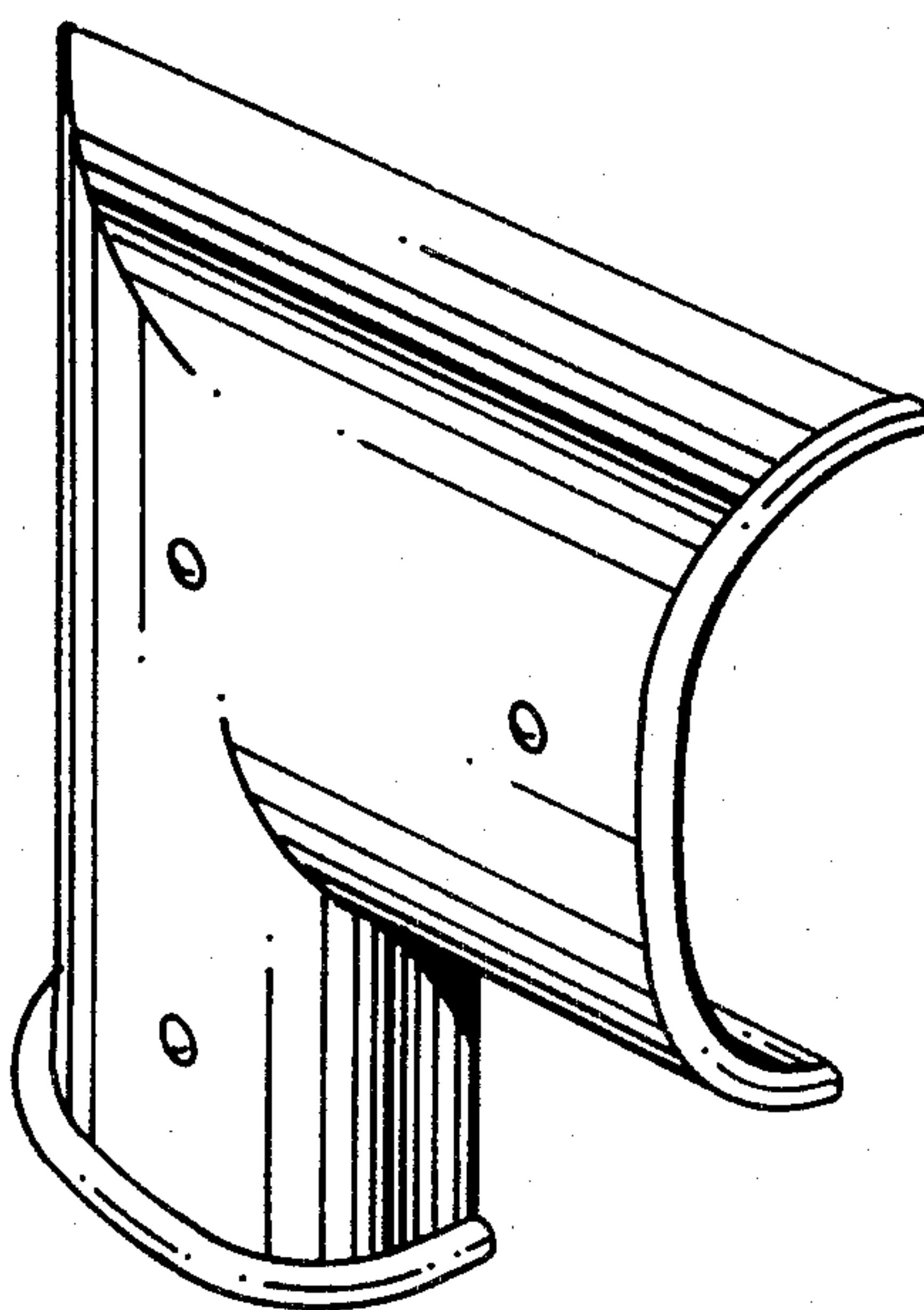

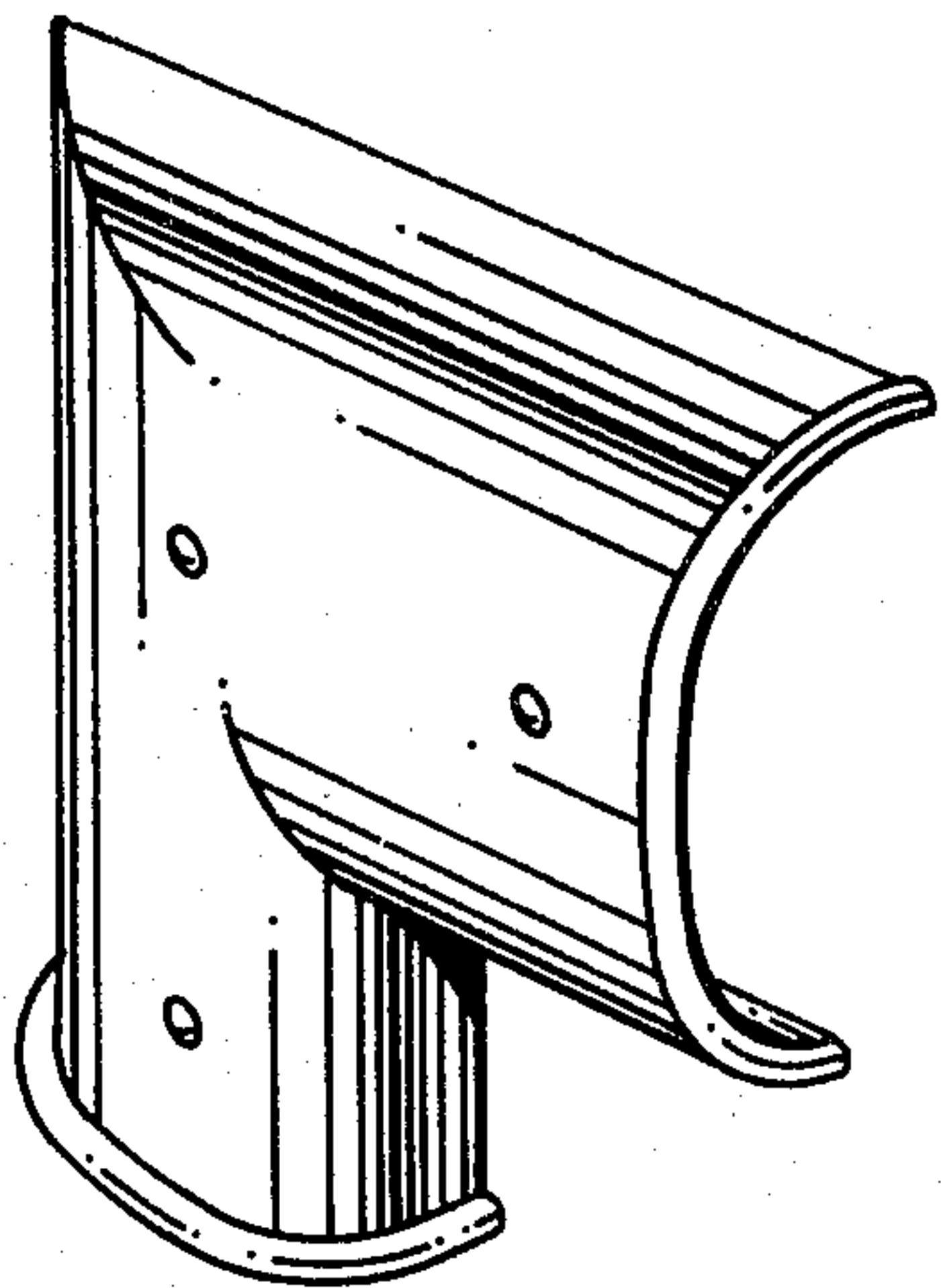

FIG. 1

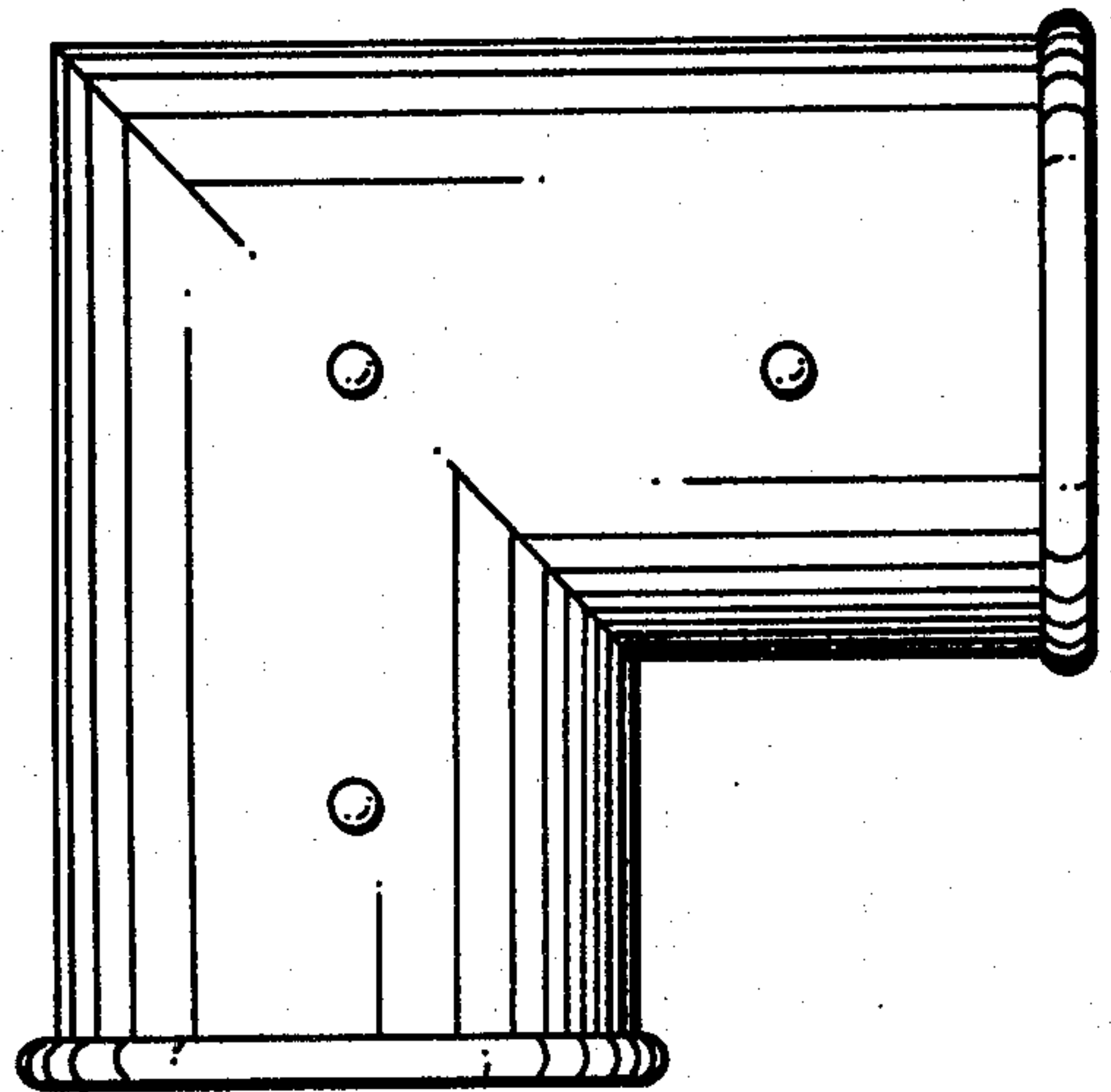

FIG. 2

FIG. 3

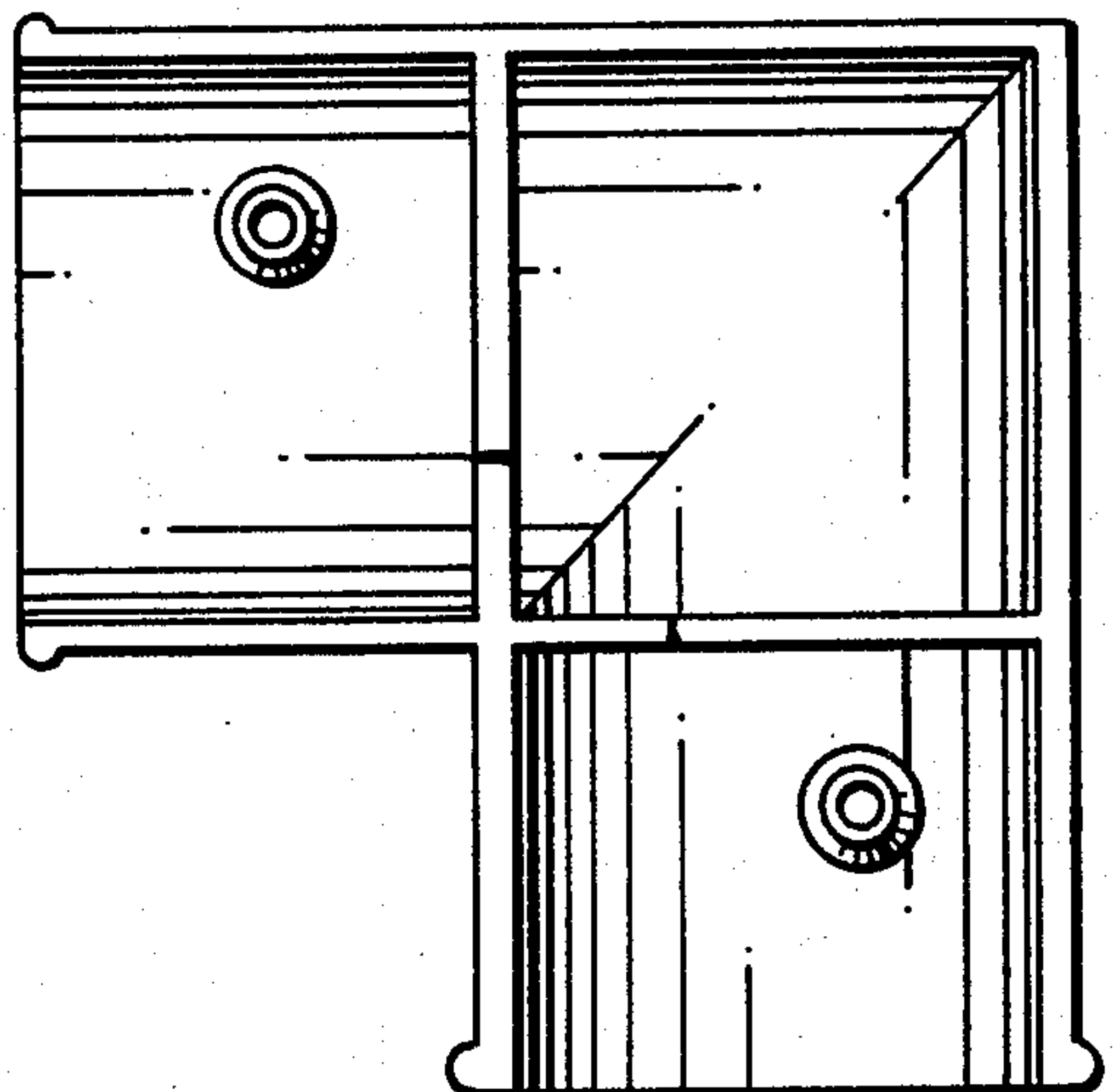
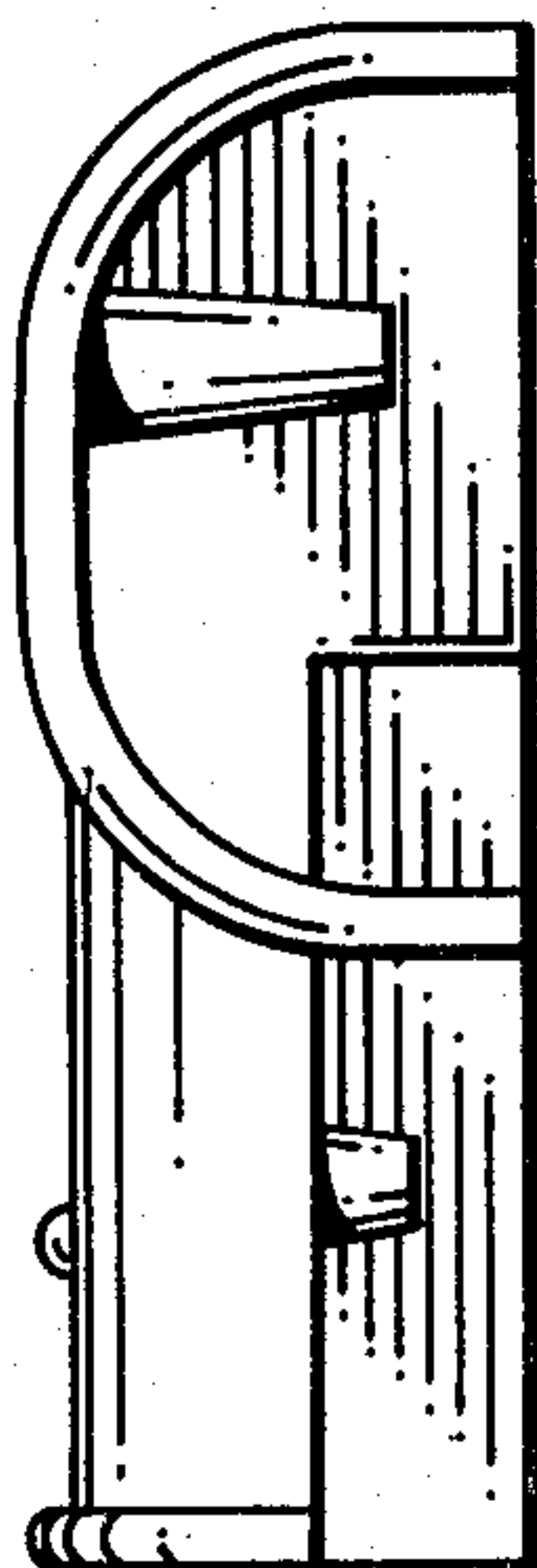

FIG. 4

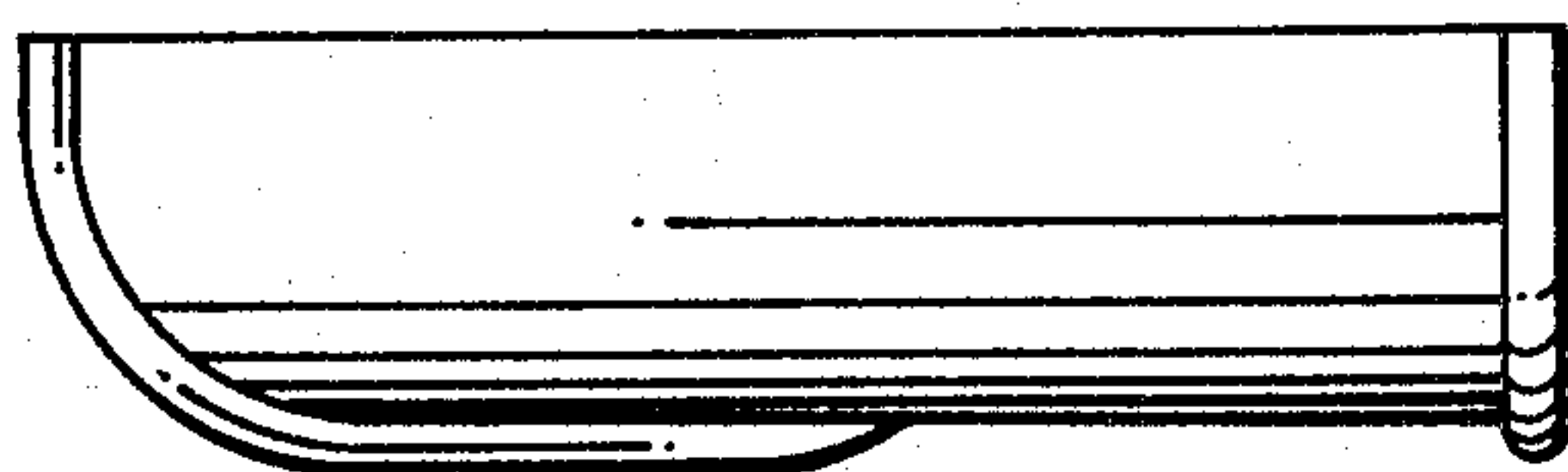

FIG. 5

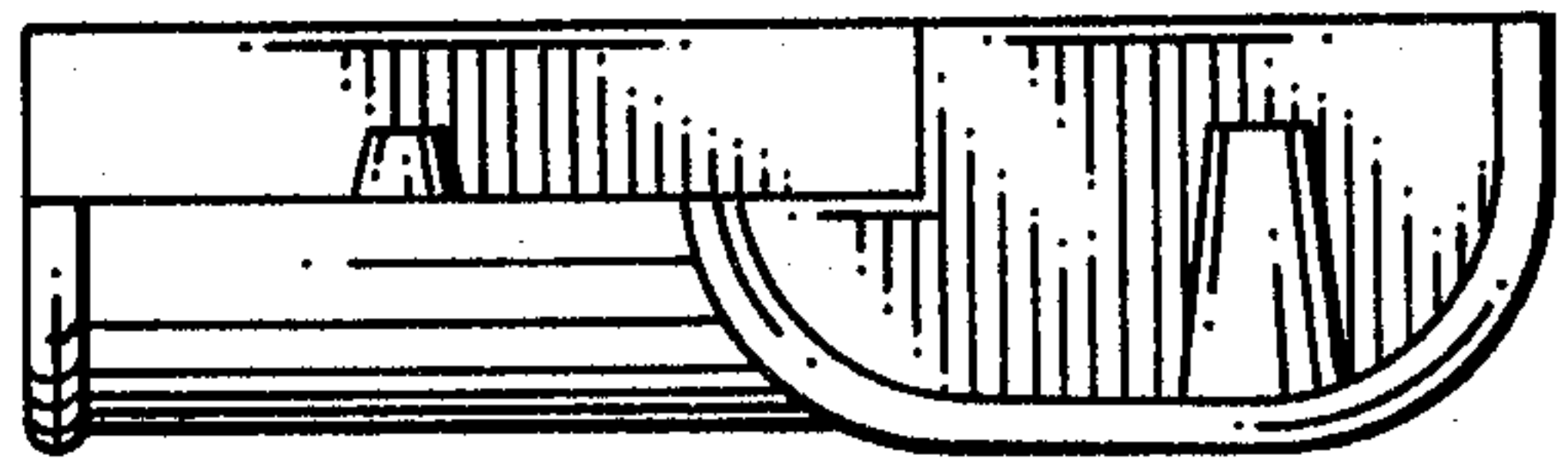

FIG. 6

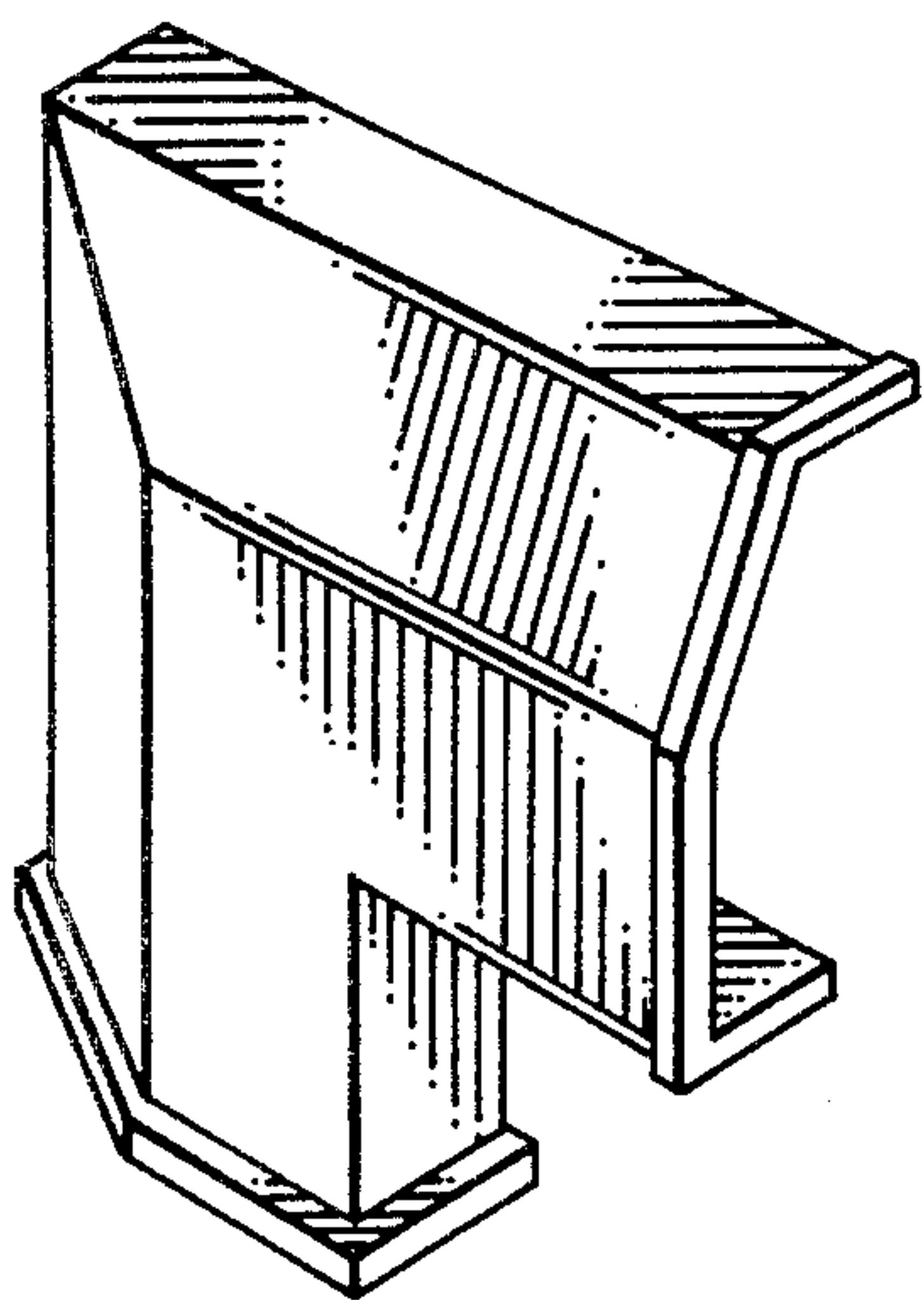

FIG. 7

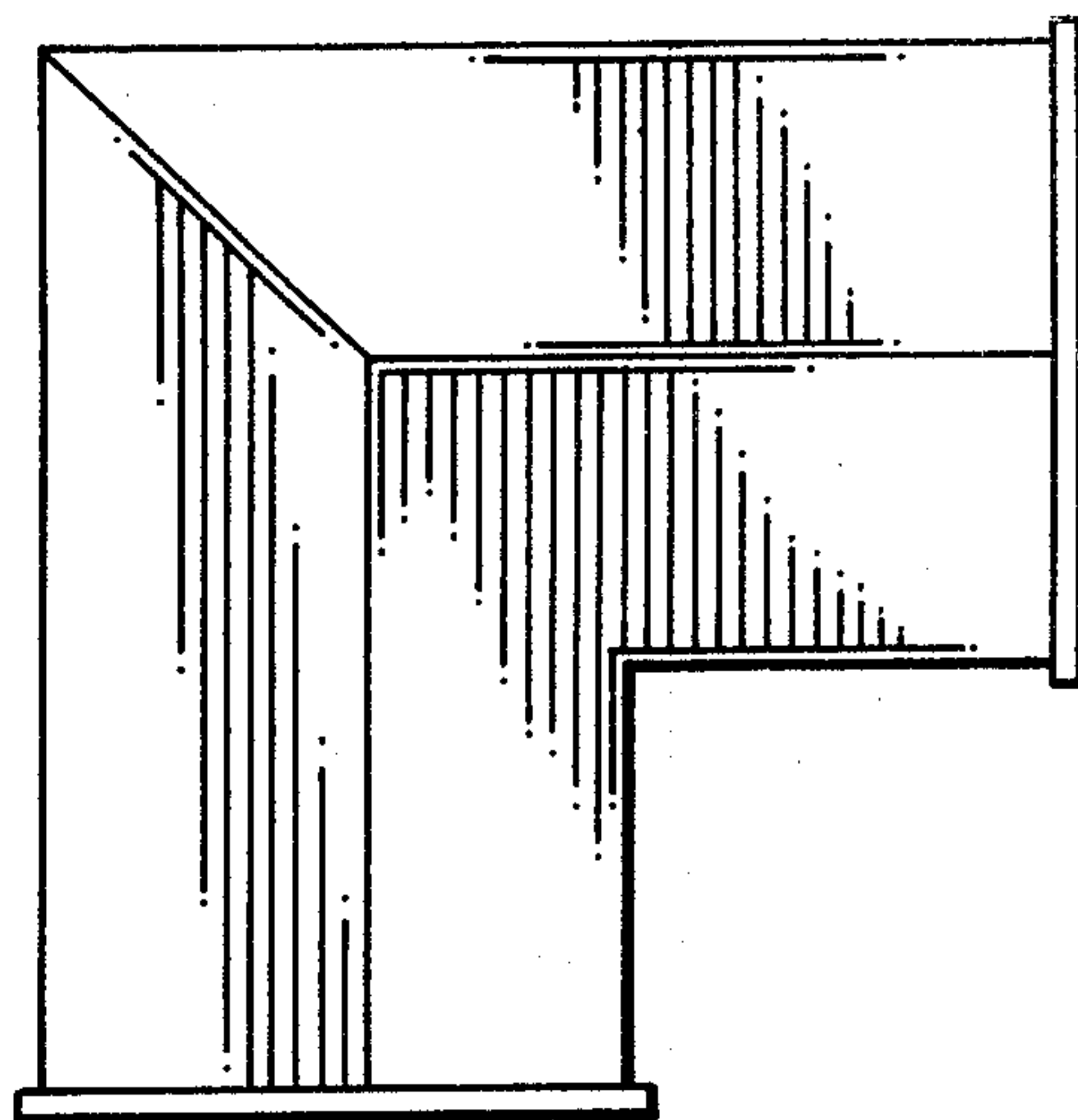

FIG. 8

FIG. 9

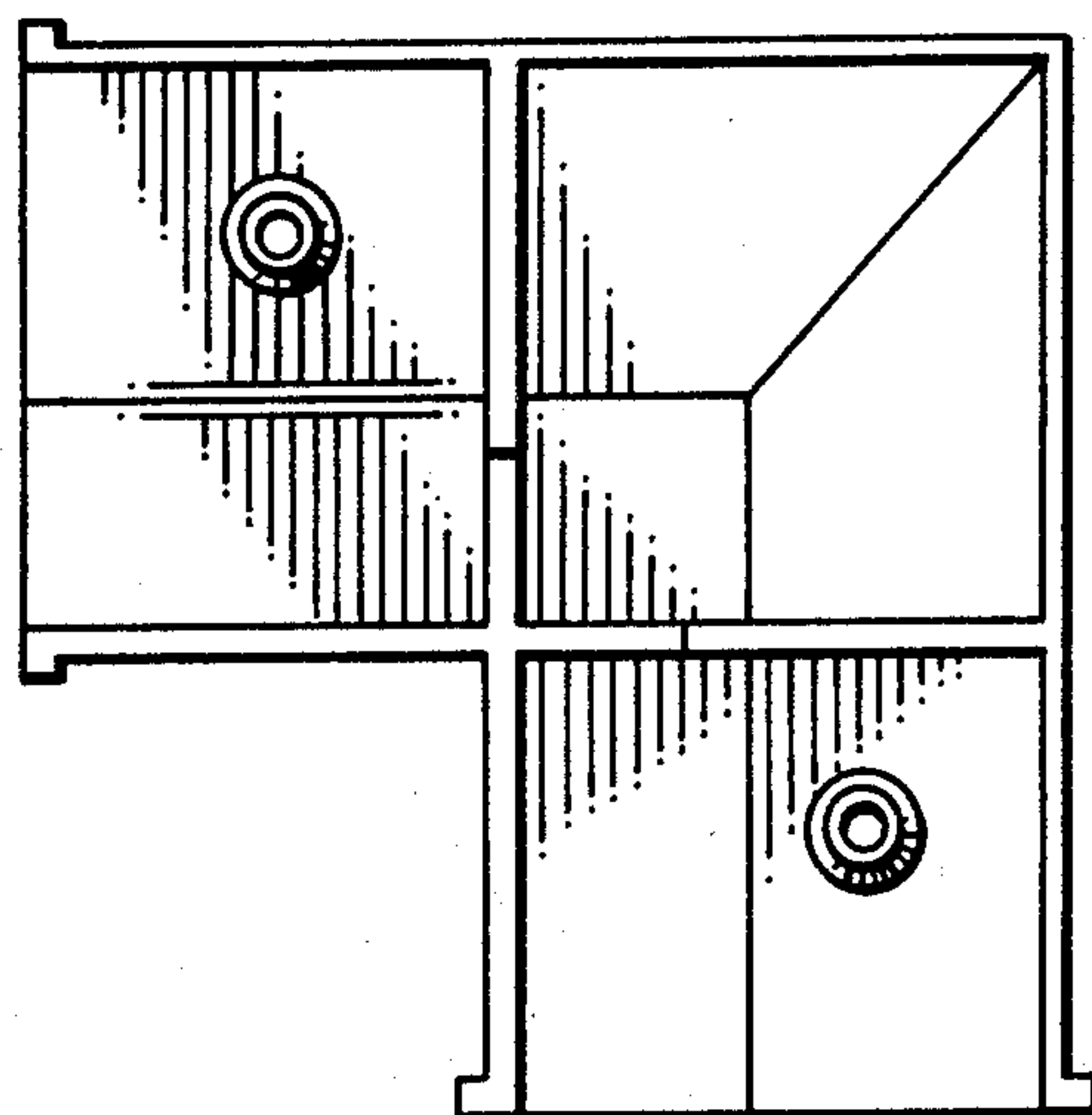
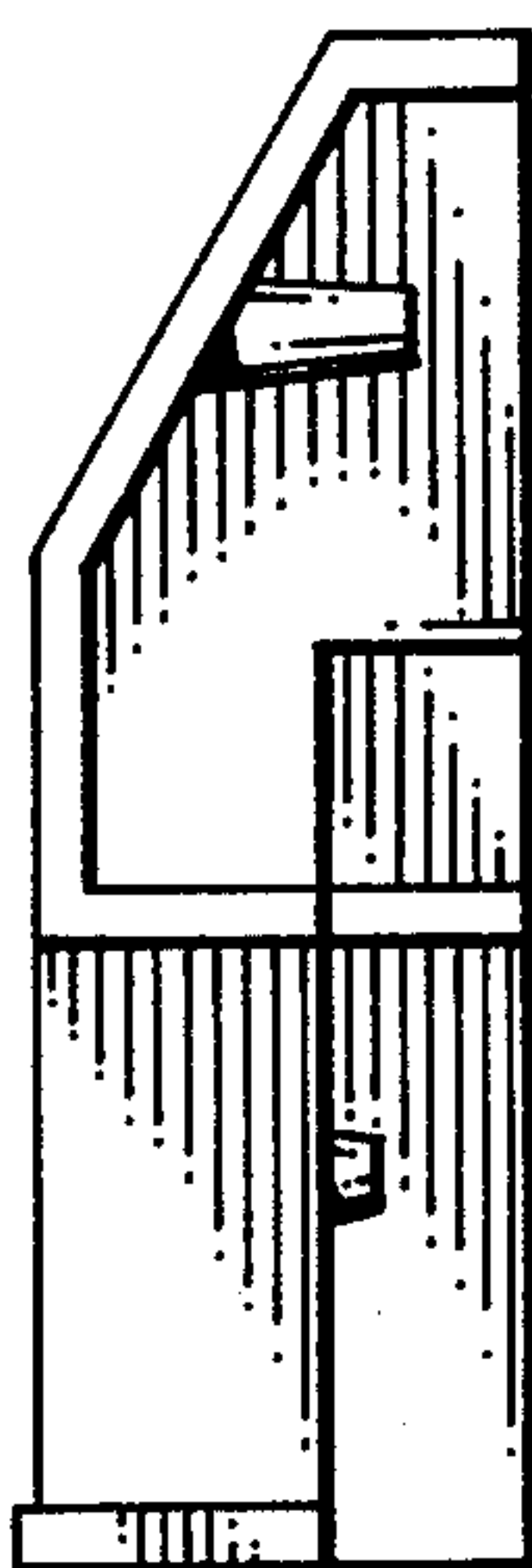

FIG. 10

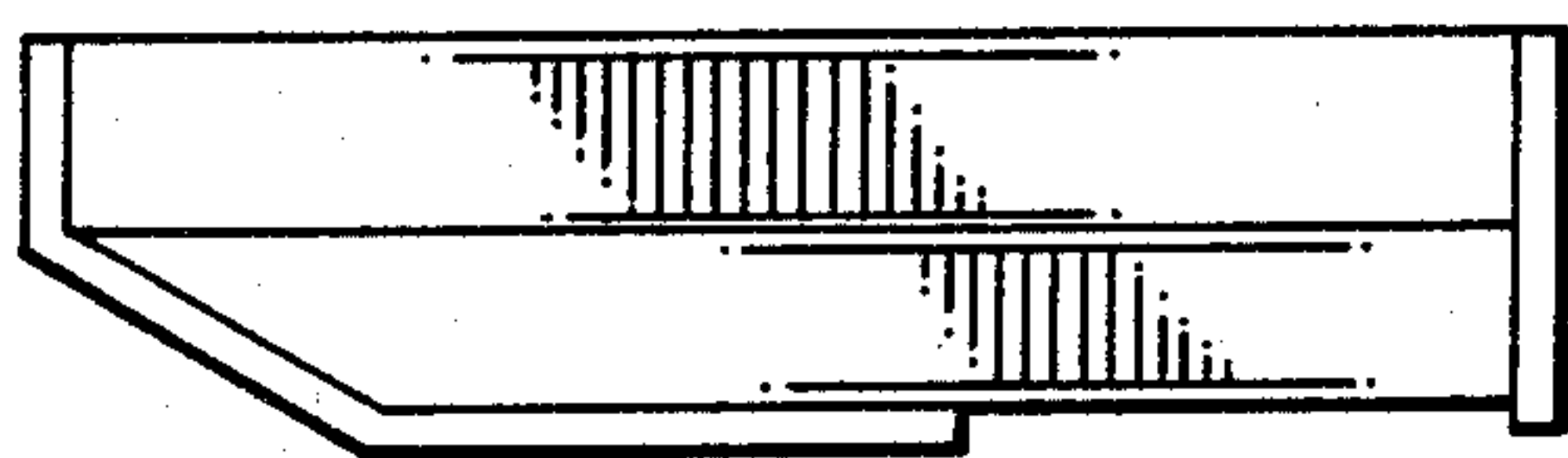

FIG. 11

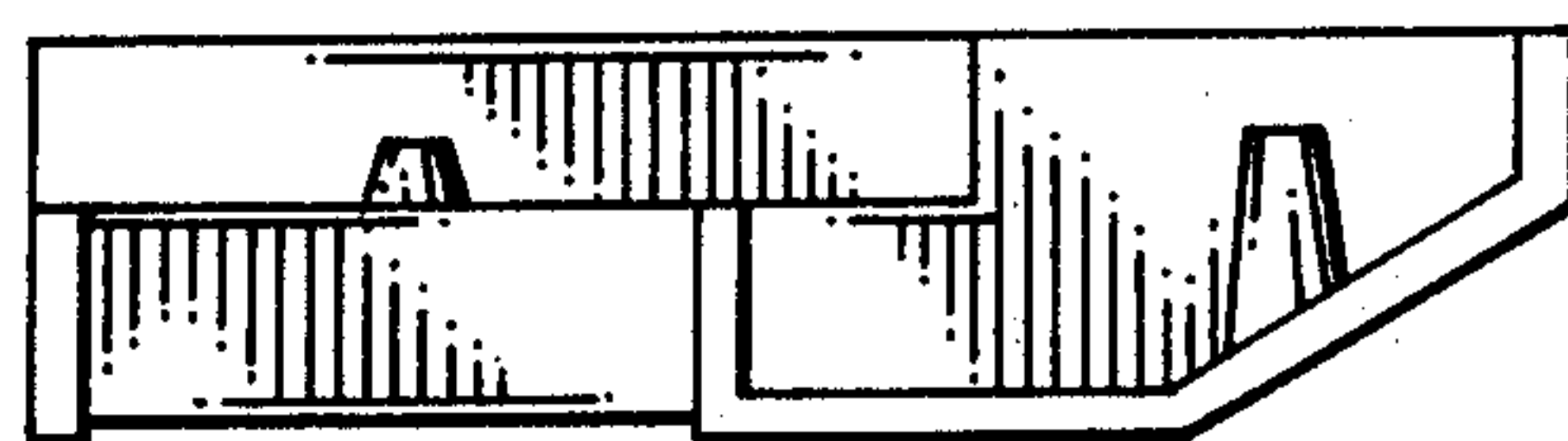

FIG. 12

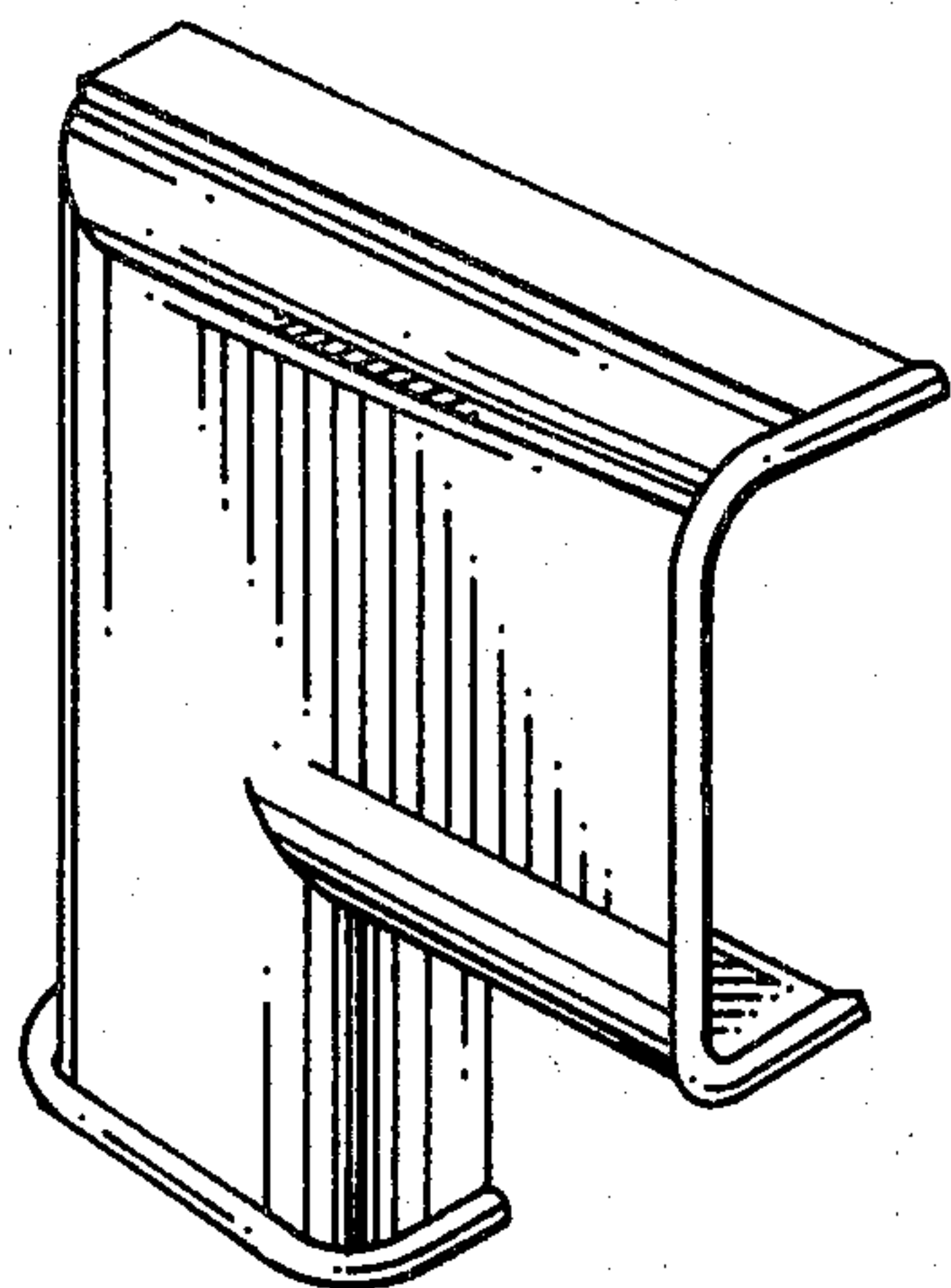

FIG. 13

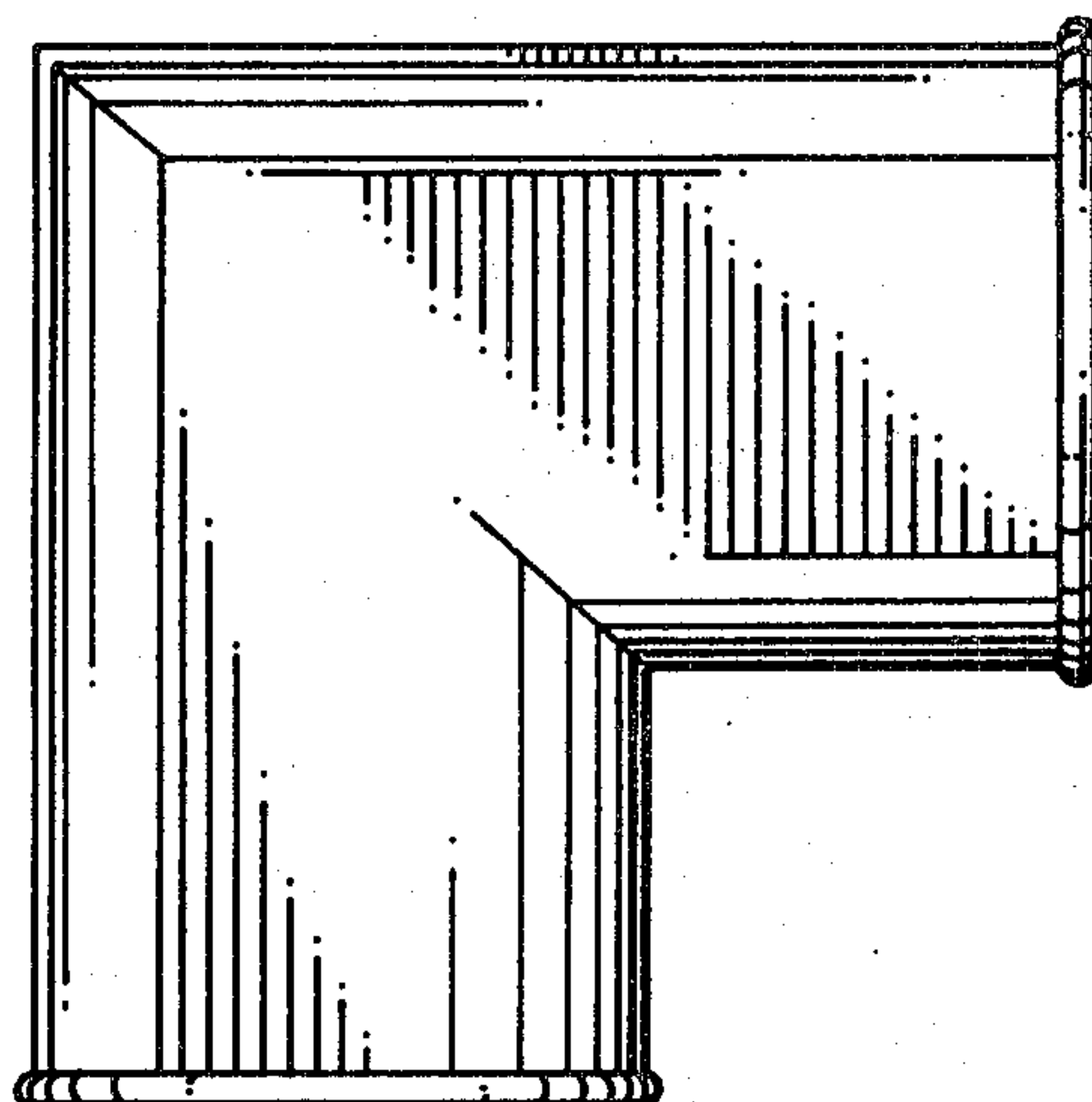

FIG. 14

FIG. 15

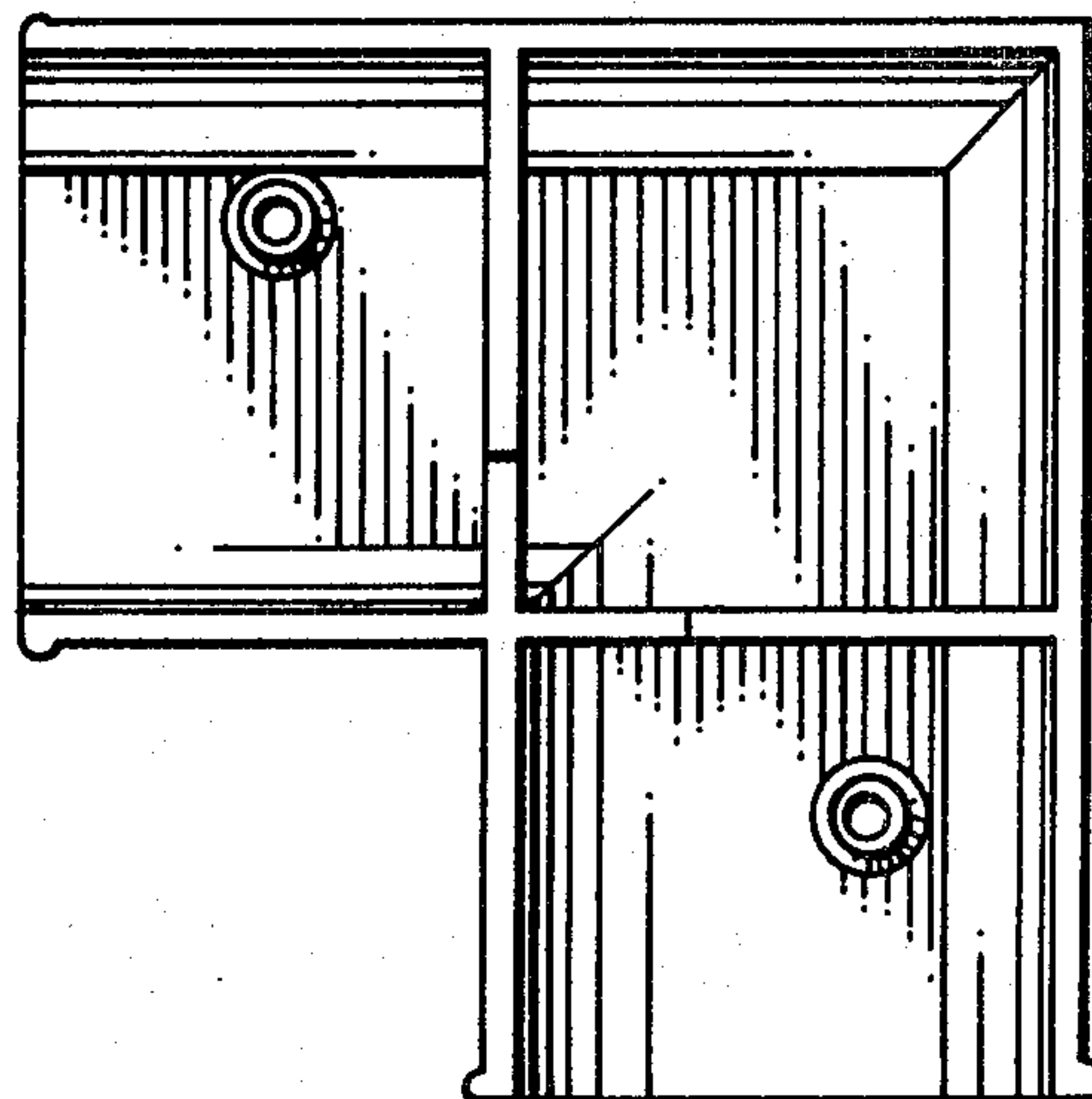
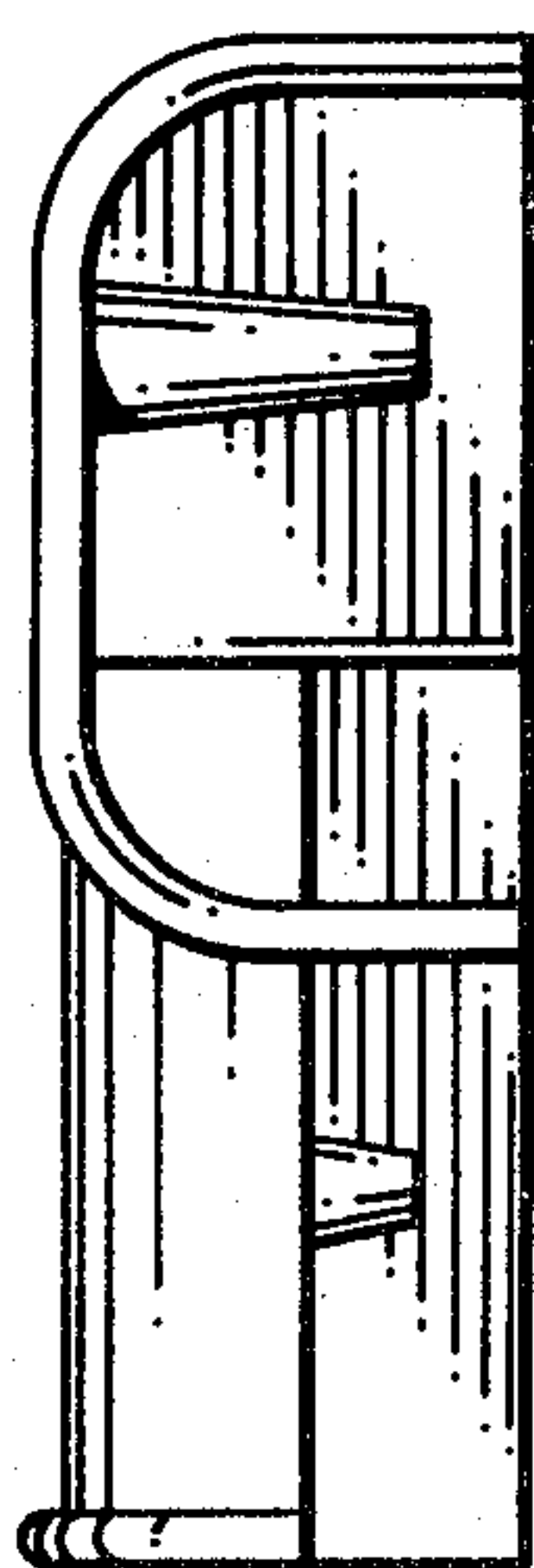

FIG. 16

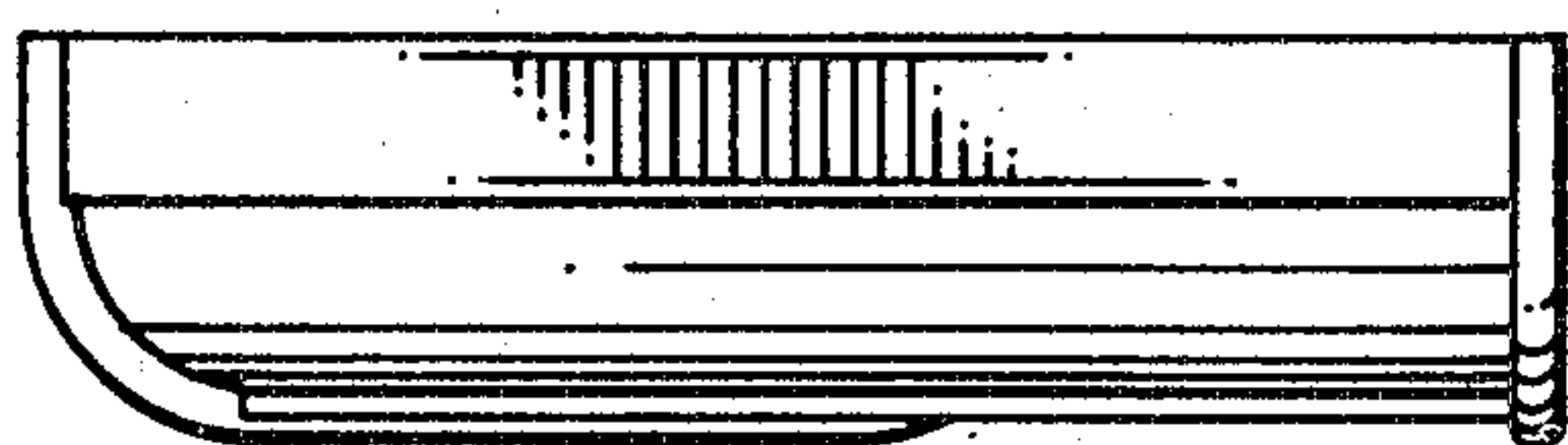

FIG. 17

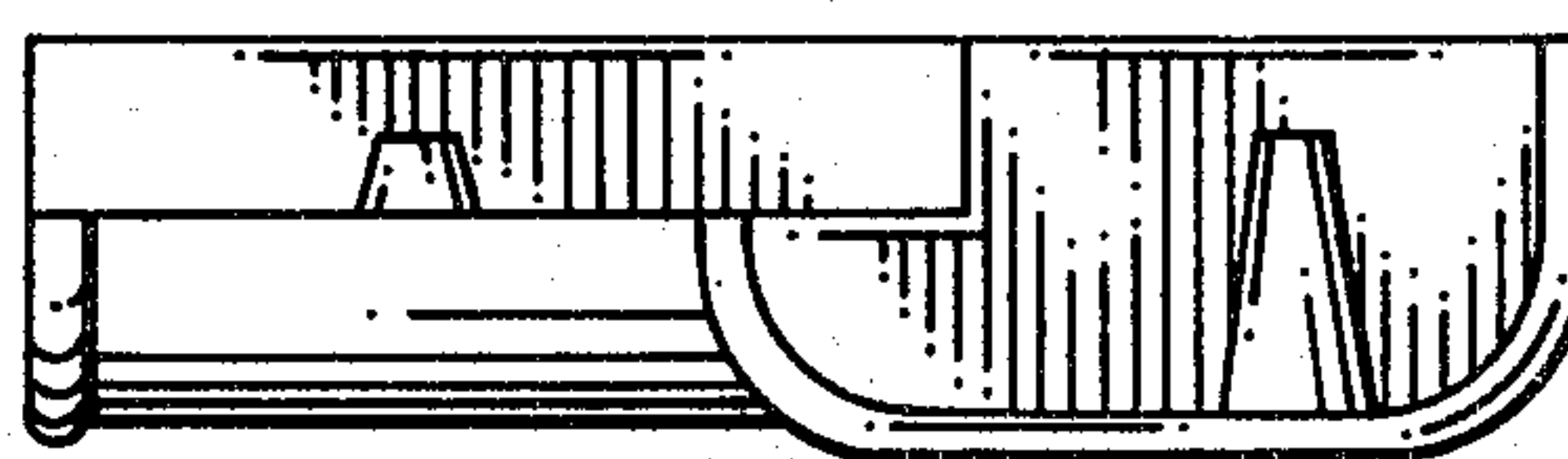

FIG. 18