

[54] **FURNITURE BASE OR SIMILAR ARTICLE**

[76] Inventor: **George Hollander**, 320 W. 22nd St.,
New York, N.Y. 10011

[**] Term: **14 Years**

[21] Appl. No.: **317,759**

[22] Filed: **Nov. 2, 1981**

[52] U.S. Cl. **D6/194; D25/74**

[58] Field of Search **D6/20-29,**
D6/175, 177, 194; D25/74

[56] **References Cited**

U.S. PATENT DOCUMENTS

- D. 91,692 3/1934 Stuart D6/194
D. 203,582 2/1966 Hinrichs et al. D6/194 X

- D. 237,126 10/1975 McDonald D6/175
D. 240,880 8/1976 Phillips D6/194
D. 260,215 8/1981 O'Neill D6/194
D. 261,310 10/1981 Schmidt D25/74

Primary Examiner—Bruce W. Dunkins
Attorney, Agent, or Firm—Steinberg & Raskin

[57] **CLAIM**

The ornamental design for a furniture base or similar article, as shown and described.

DESCRIPTION

FIG. 1 is a top plan view of a furniture base or similar article showing my new design, the bottom plan view being identical thereto;
FIG. 2 is a front elevational view thereof, the rear and side elevational views being identical thereto; and
FIG. 3 is a perspective view thereof.

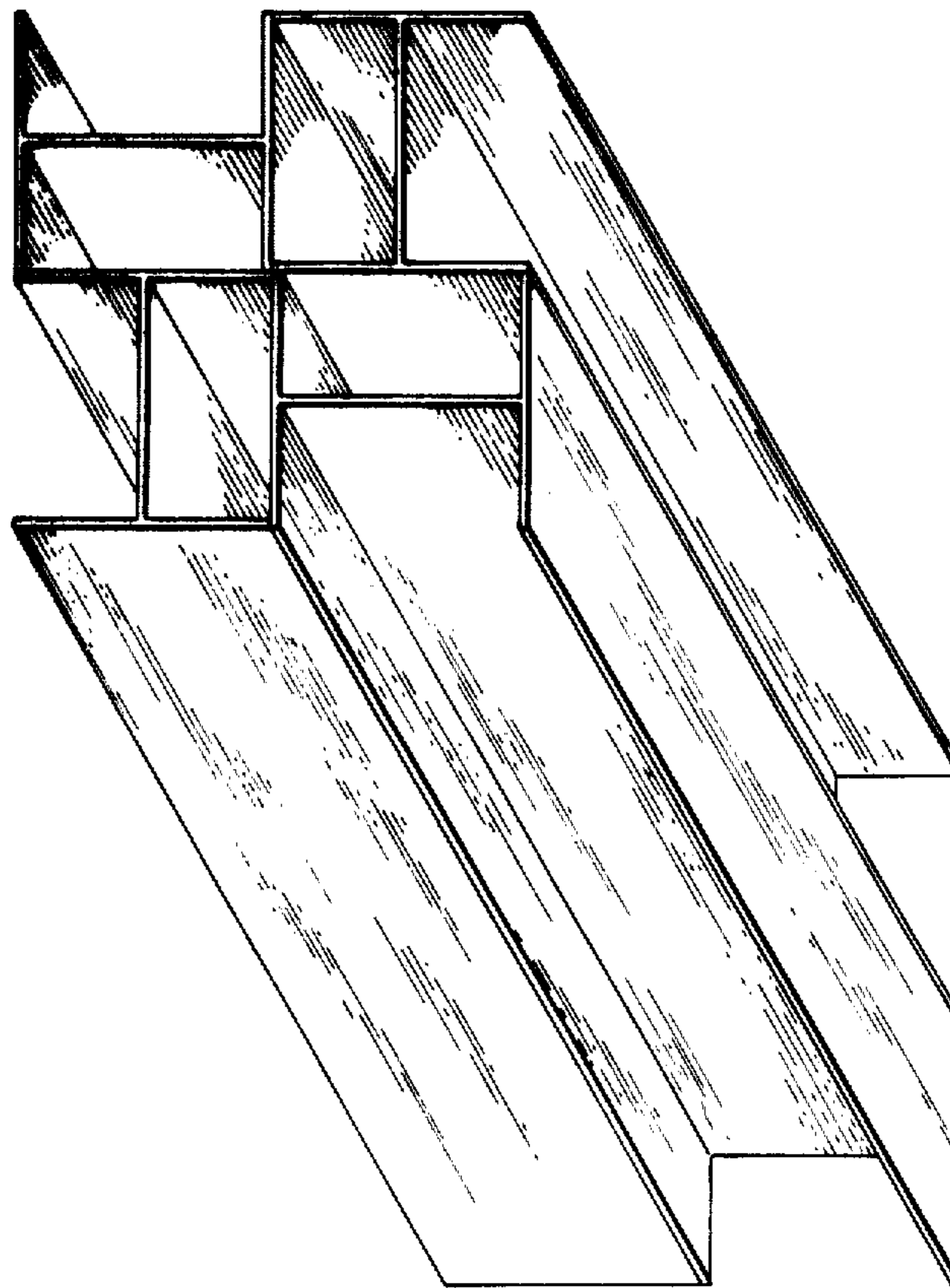

FIG. 1

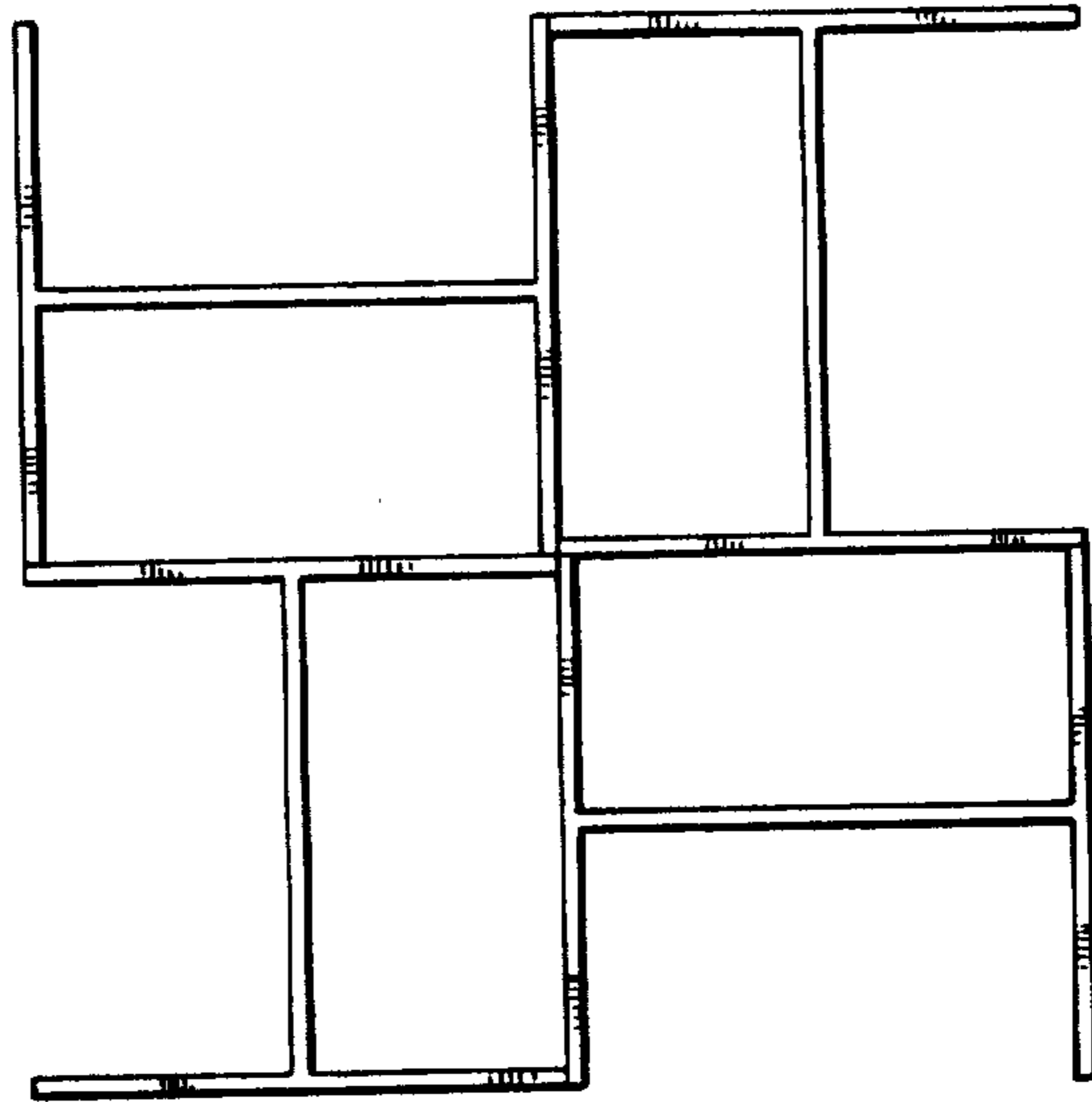

FIG. 2

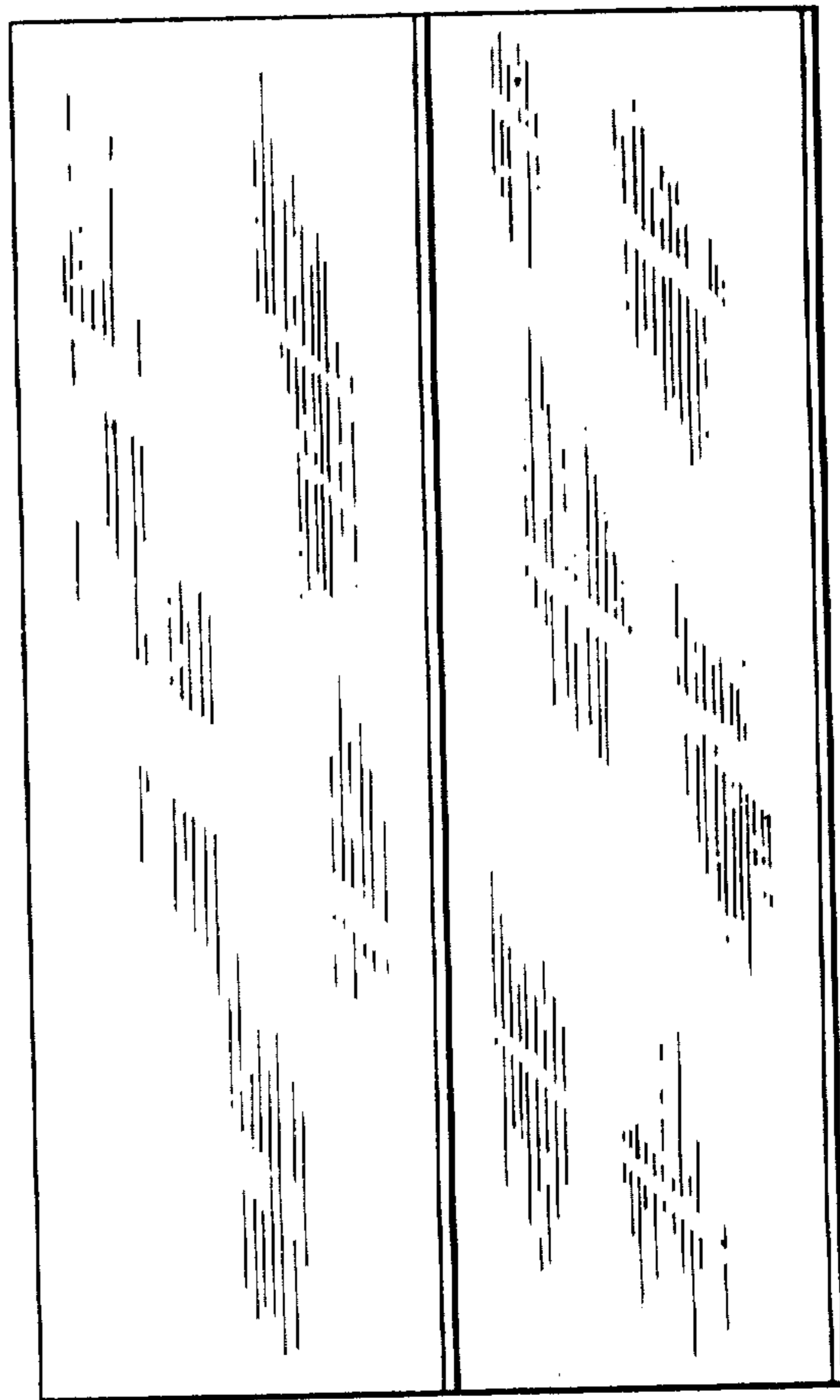

FIG 3

