

[54] WALK-IN AUTOMATIC TELLER BUILDING

[75] Inventor: **Randall L. Elliott**, Oklahoma City, Okla.

[73] Assignee: **Vector Specialized Construction, Inc.**, Oklahoma City, Okla.

[\*\*] Term: **14 Years**

[21] Appl. No.: **354,221**

[22] Filed: **Mar. 3, 1982**

[52] U.S. Cl. .... **D25/33**

[58] Field of Search ..... **D25/1, 16, 32, 33, 22, D25/56**

[56] **References Cited**

**U.S. PATENT DOCUMENTS**

D. 197,766 3/1964 Roxburgh ..... D25/33

D. 204,056 3/1966 Bartley et al. .... D25/33  
D. 257,539 11/1980 Berman ..... D25/33  
3,078,917 2/1963 Recchione ..... D25/16

*Primary Examiner*—A. Hugo Word  
*Attorney, Agent, or Firm*—Robert M. Hessin

[57] **CLAIM**

The ornamental design for an walk-in automatic teller, substantially as shown and described.

**DESCRIPTION**

FIG. 1 is a perspective view of the walk-in automatic teller building;  
FIG. 2 is a front view of the design;  
FIG. 3 is a rear view of the design;  
FIG. 4 is a side view of the design;  
FIG. 5 is an opposite side view of the design; and  
FIG. 6 is a top view of the design of the present invention.

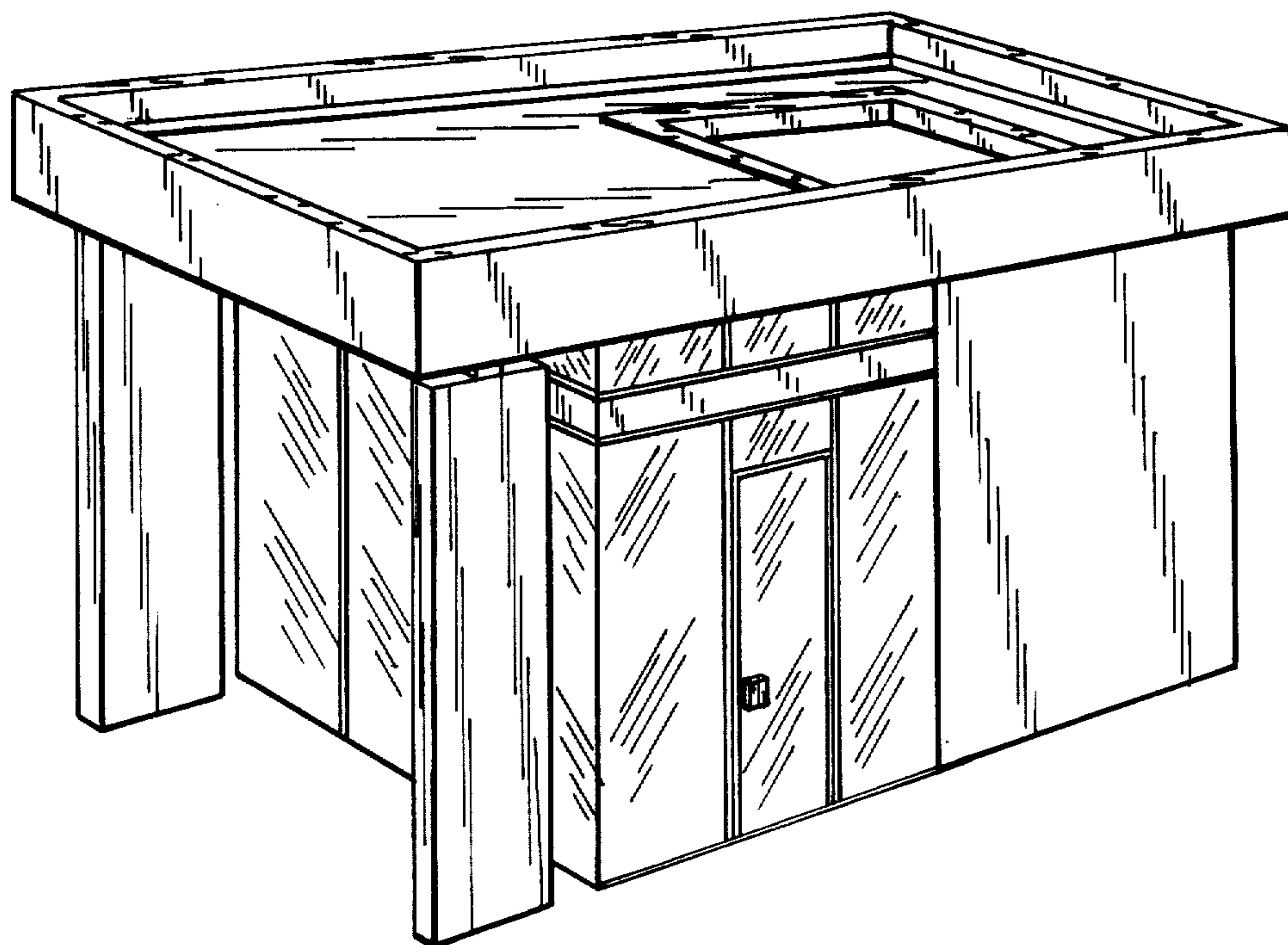

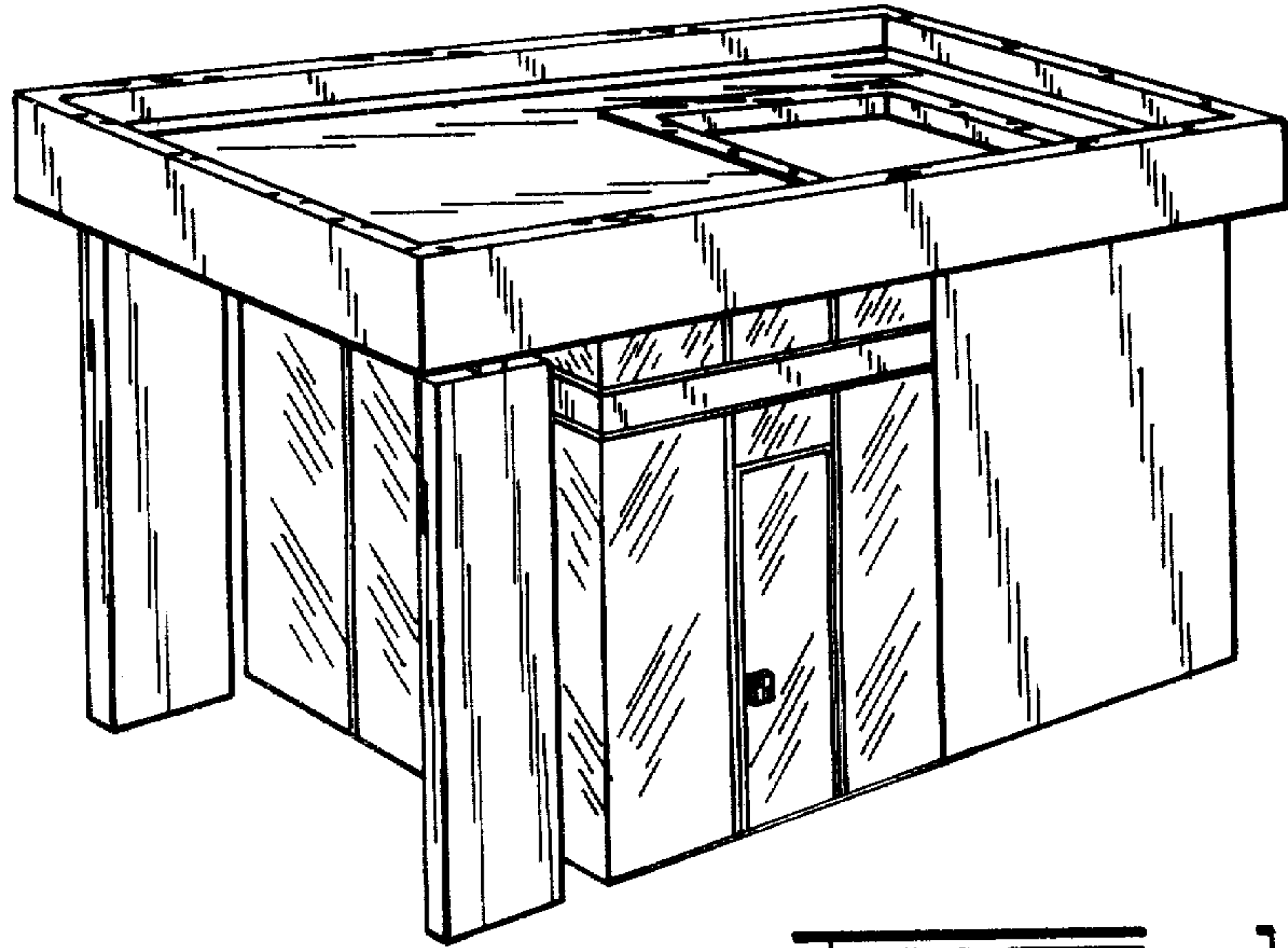

FIG. 1

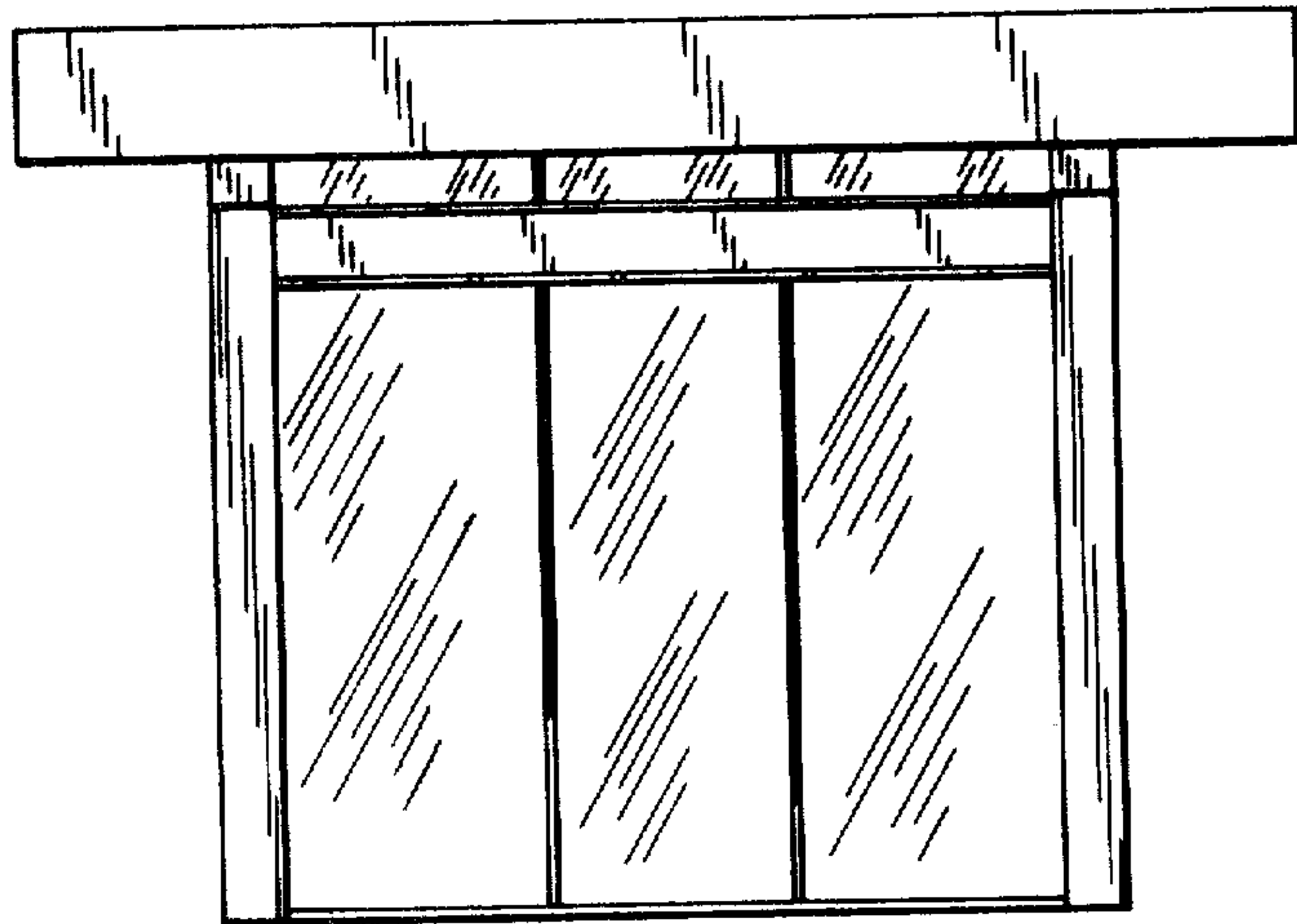

FIG. 2

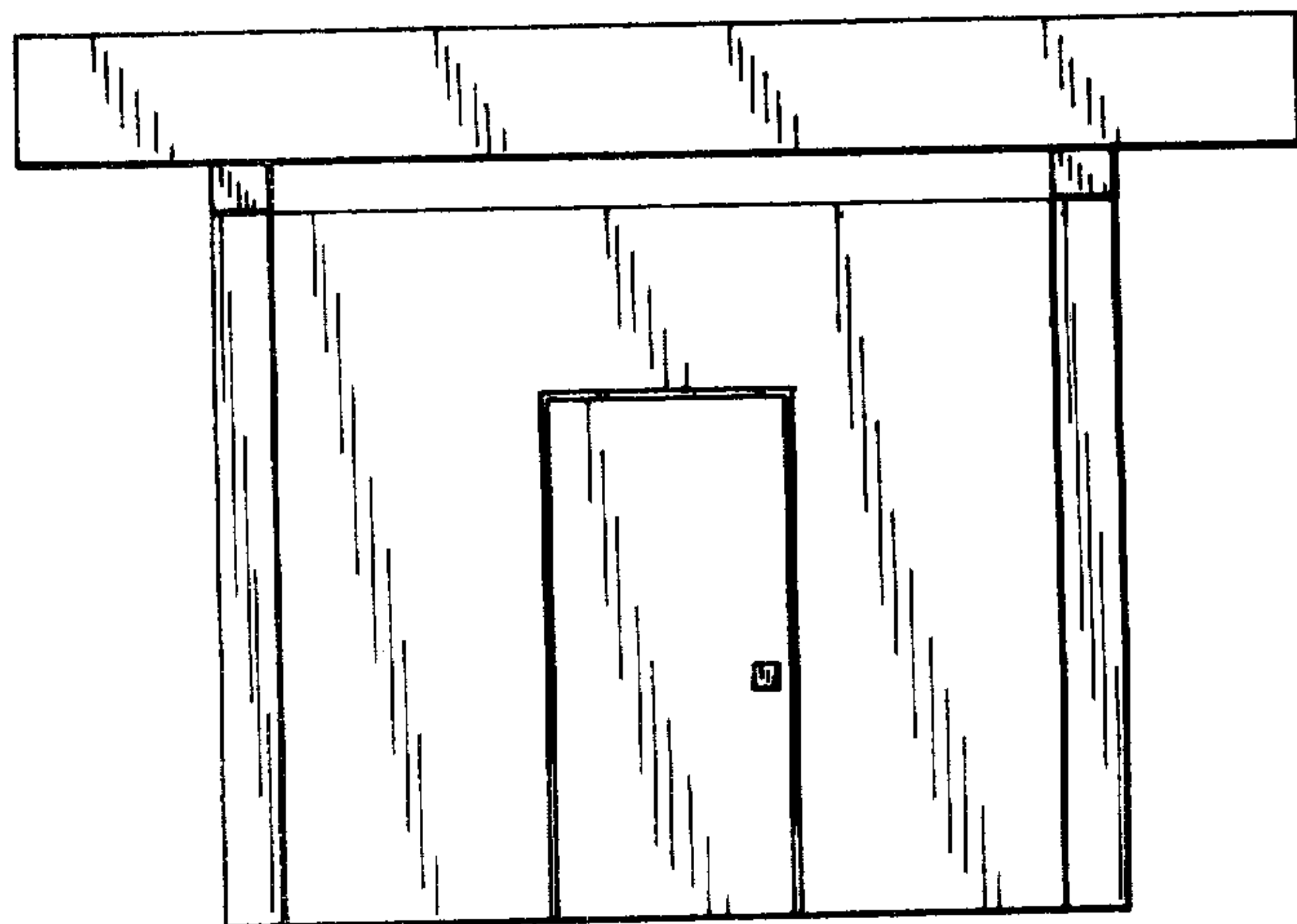

FIG. 3

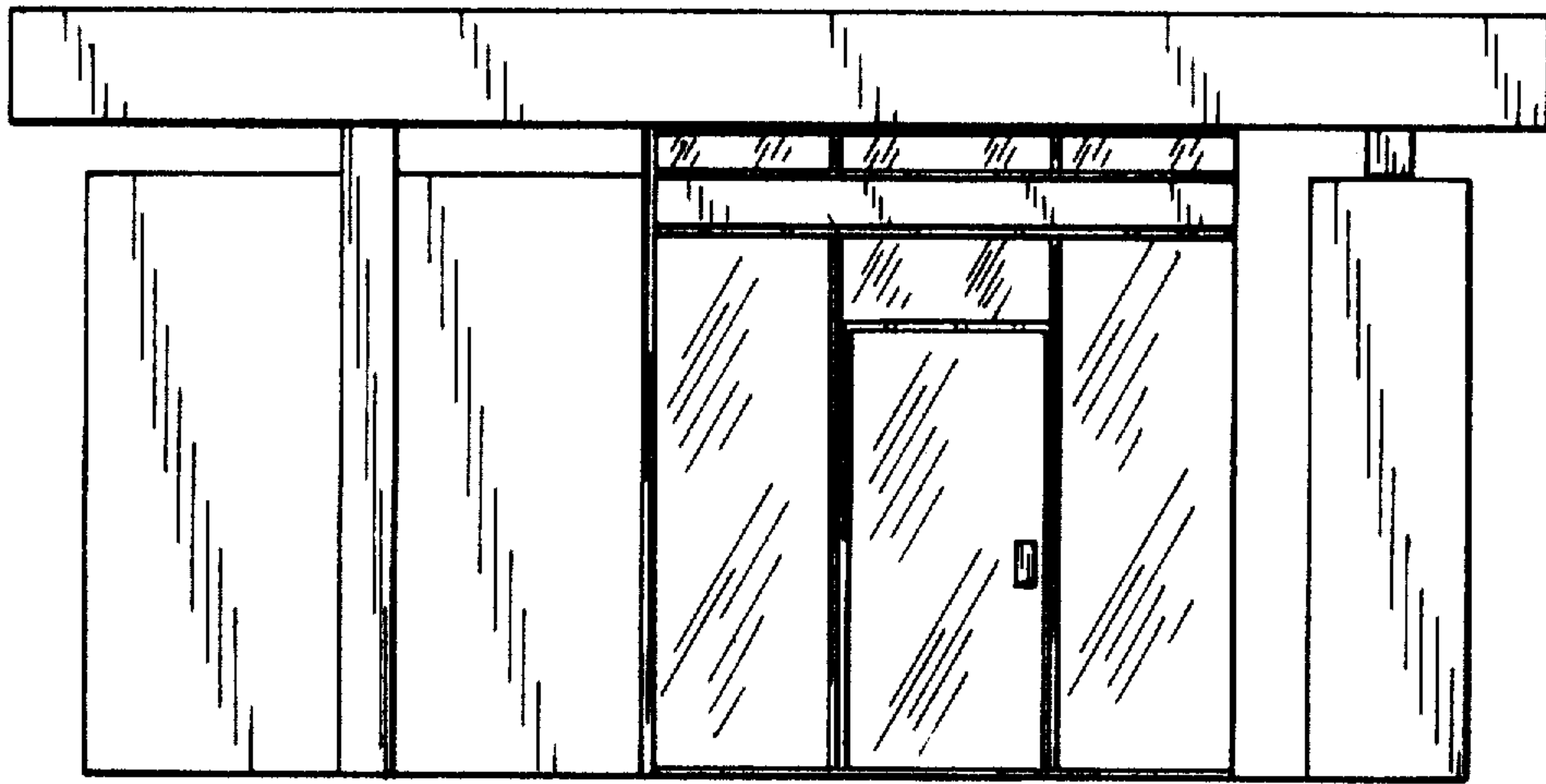

FIG. 4

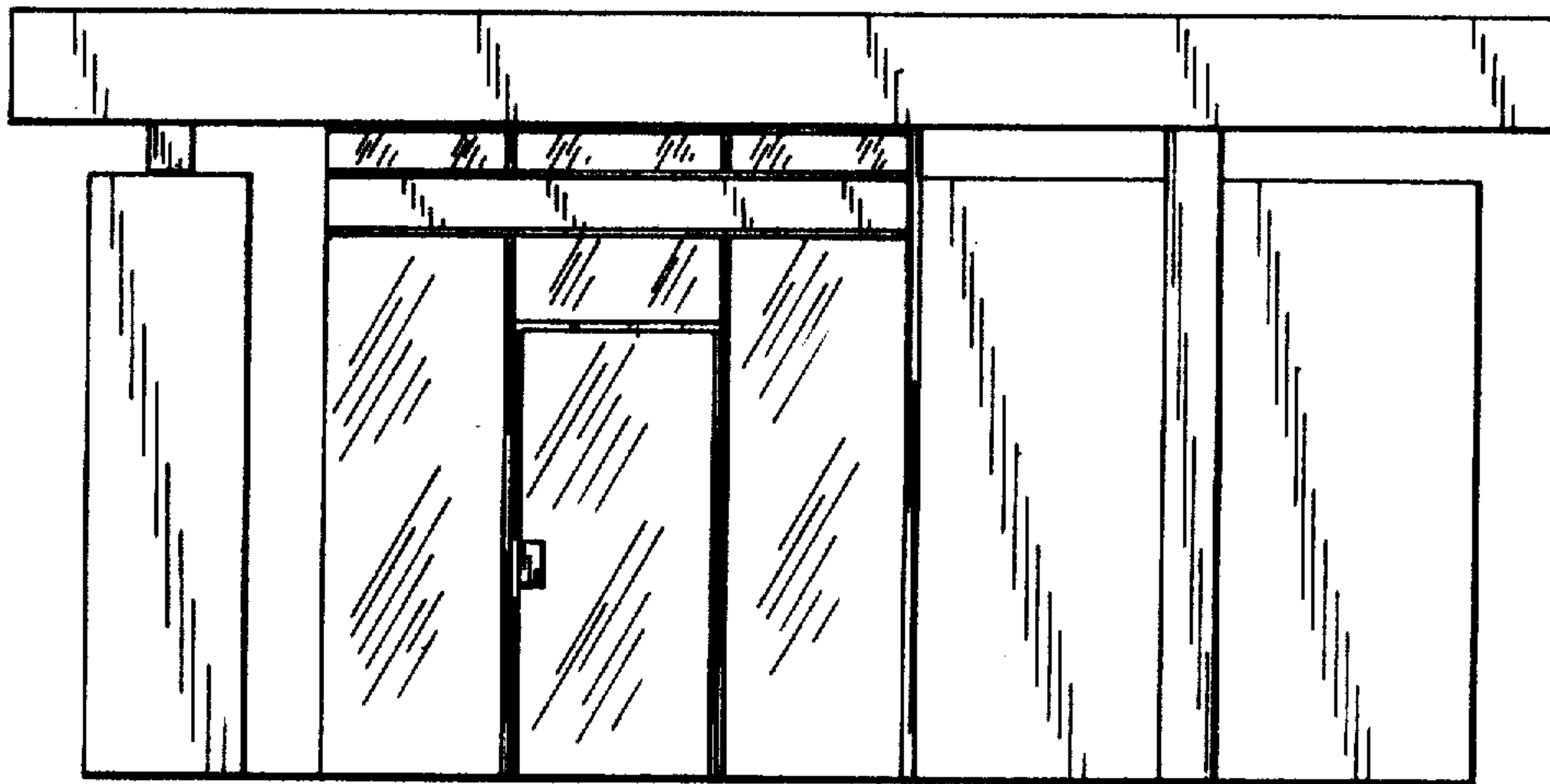

FIG. 5

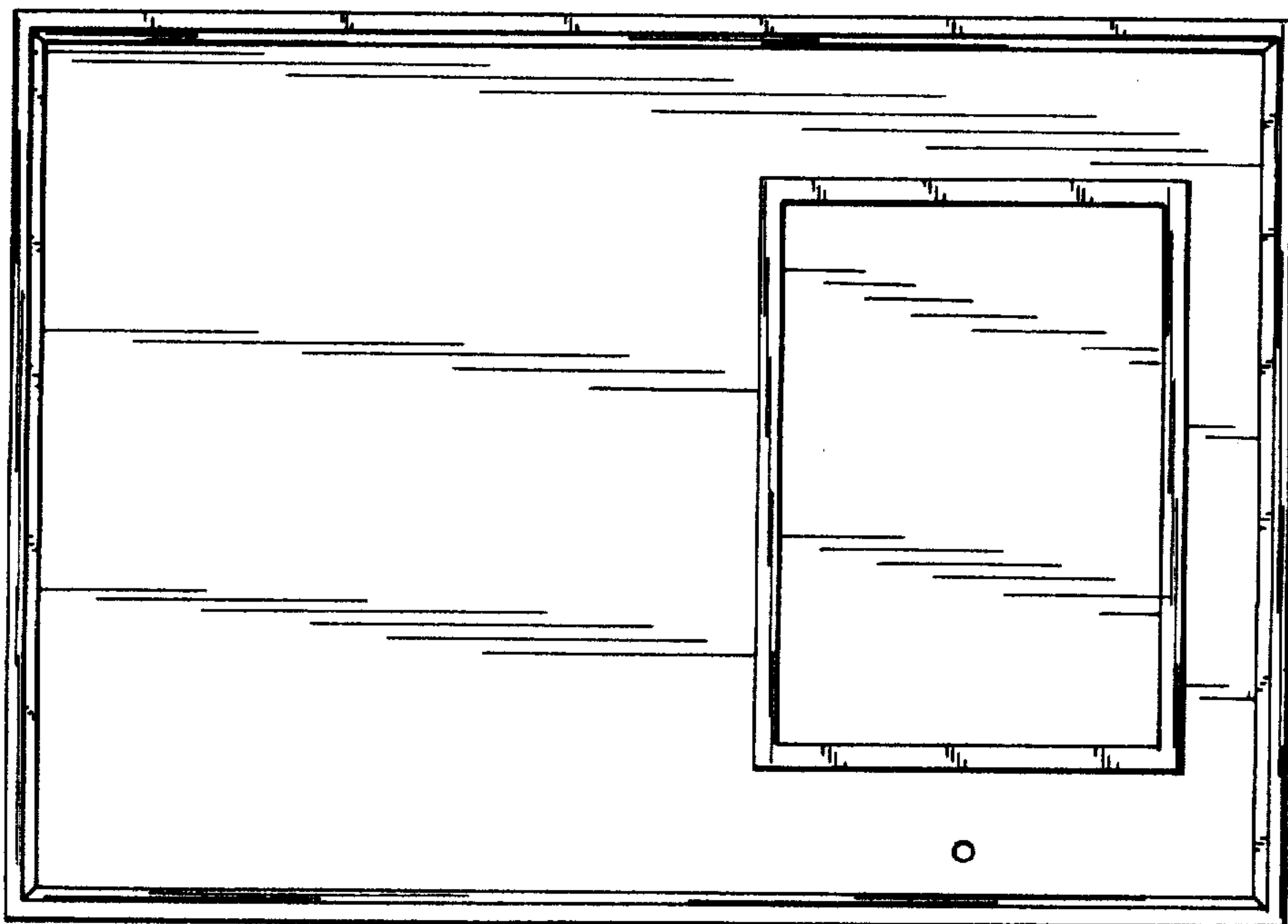

FIG. 6