

[54] PICTURE IMAGE MEMORY-SEARCH APPARATUS WITH COPYING FUNCTION

[75] Inventor: Kunio Hara, Chiba, Japan

[73] Assignee: Tokyo Shibaura Denki Kabushiki Kaisha, Kawasaki, Japan

[**] Term: 14 Years

[21] Appl. No.: 243,606

[22] Filed: Mar. 13, 1981

[30] Foreign Application Priority Data

Sep. 17, 1980 [JP] Japan 55-38065

[51] Int. Cl. D16-03

[52] U.S. Cl. D16/28

[58] Field of Search D16/27-32, D16/28; D14/100, 102, 103 X, 106; 355/3, 5, 8-9, 11, 14 R, 14 C

[56] References Cited

U.S. PATENT DOCUMENTS

- D. 176,927 2/1956 Perzentka D16/28
- D. 209,110 10/1967 Bennett D16/28 X
- D. 238,497 1/1976 Fossella D14/106
- D. 238,514 1/1976 Artaud D16/27 X
- D. 248,648 7/1978 Clayton et al. .
- D. 249,686 9/1978 Clayton et al. .
- D. 256,796 9/1980 Plaza D14/106 X
- D. 258,432 3/1981 Aderman D14/102

- D. 263,719 4/1982 McConnell D16/28
- 3,759,611 9/1973 O'Connell D16/28 X
- 4,213,696 7/1980 Wise 355/5 X
- 4,298,269 11/1981 Yoshimaru 355/3 R

FOREIGN PATENT DOCUMENTS

- 54-526752 12/1979 Japan .
- 55-536817 5/1980 Japan .
- 55-536830 5/1980 Japan .
- 55-537158 5/1980 Japan .
- 55-548638 11/1980 Japan D16/28

Primary Examiner—Nelson C. Holtje
Attorney, Agent, or Firm—Finnegan, Henderson, Farabow, Garrett & Dunner

[57] CLAIM

The ornamental design for a picture image memory-search apparatus with copying function, substantially as shown and described.

DESCRIPTION

FIG. 1 is a perspective view of a picture image memory-search apparatus with copying function showing my new design;
FIG. 2 is a front elevational view thereof;
FIG. 3 is a top plan view thereof;
FIG. 4 is a left side elevational view thereof;
FIG. 5 is a right side elevational view thereof;
FIG. 6 is a rear elevational view thereof; and
FIG. 7 is a bottom plan view thereof.

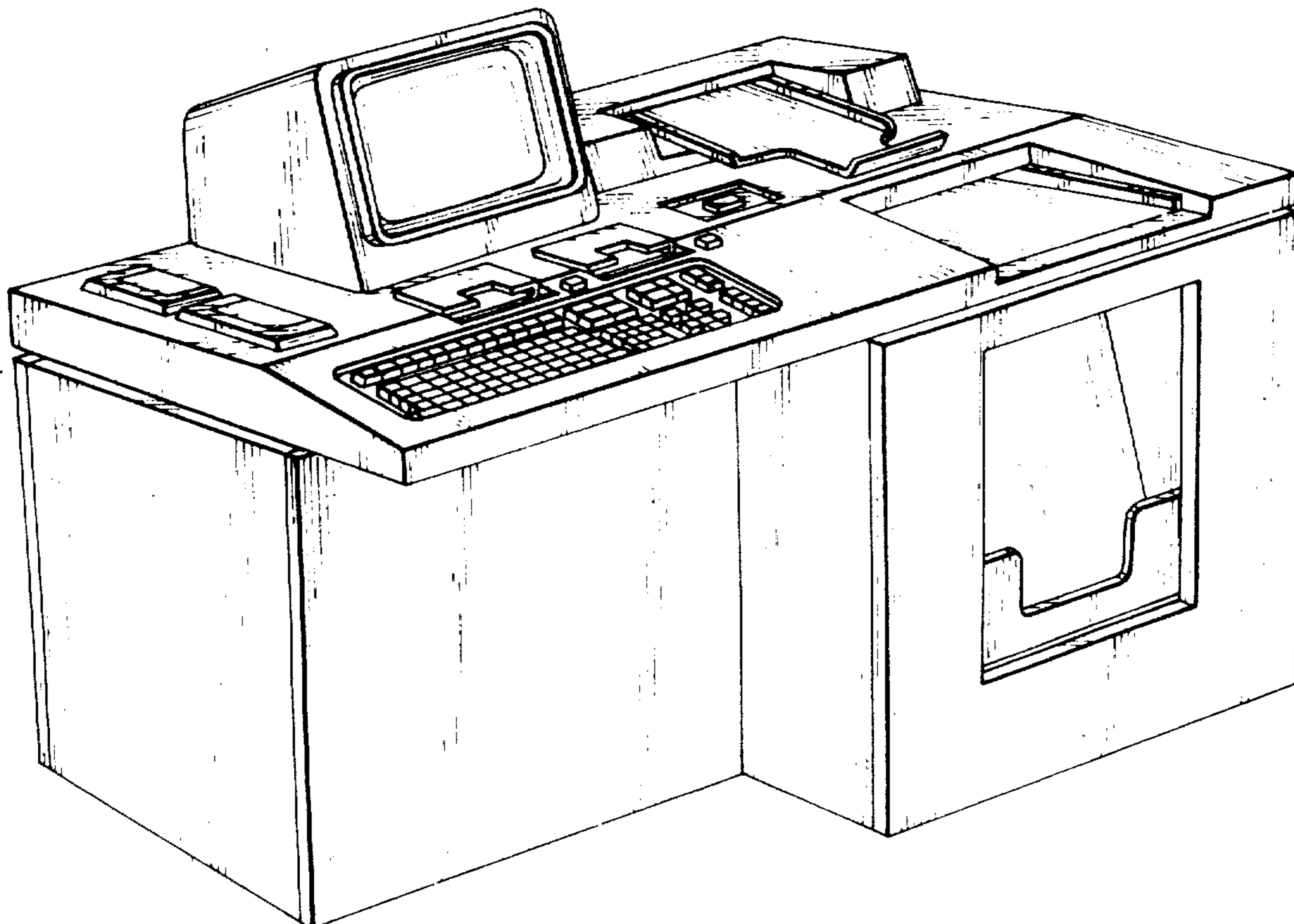

FIG. 1

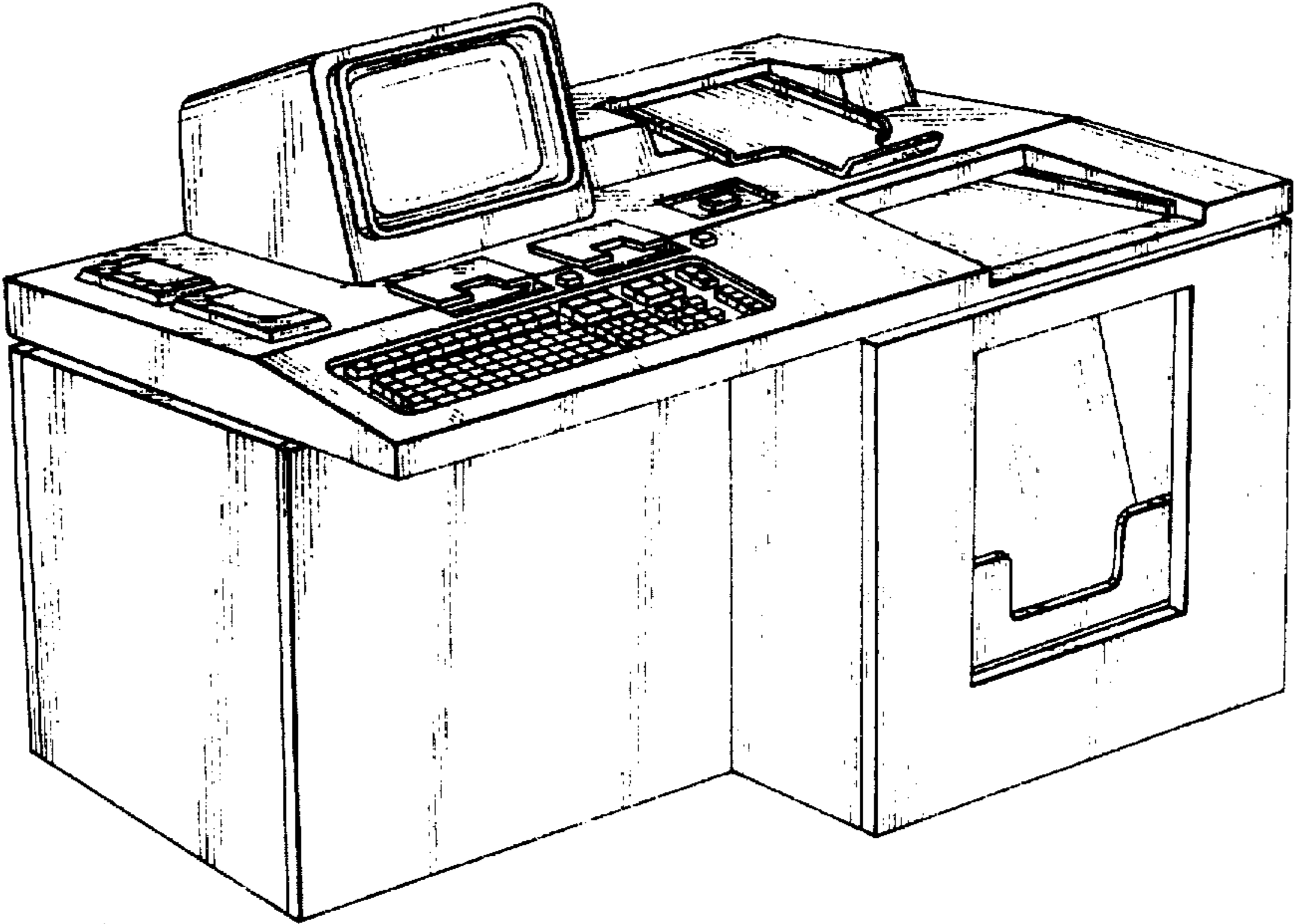

FIG. 2

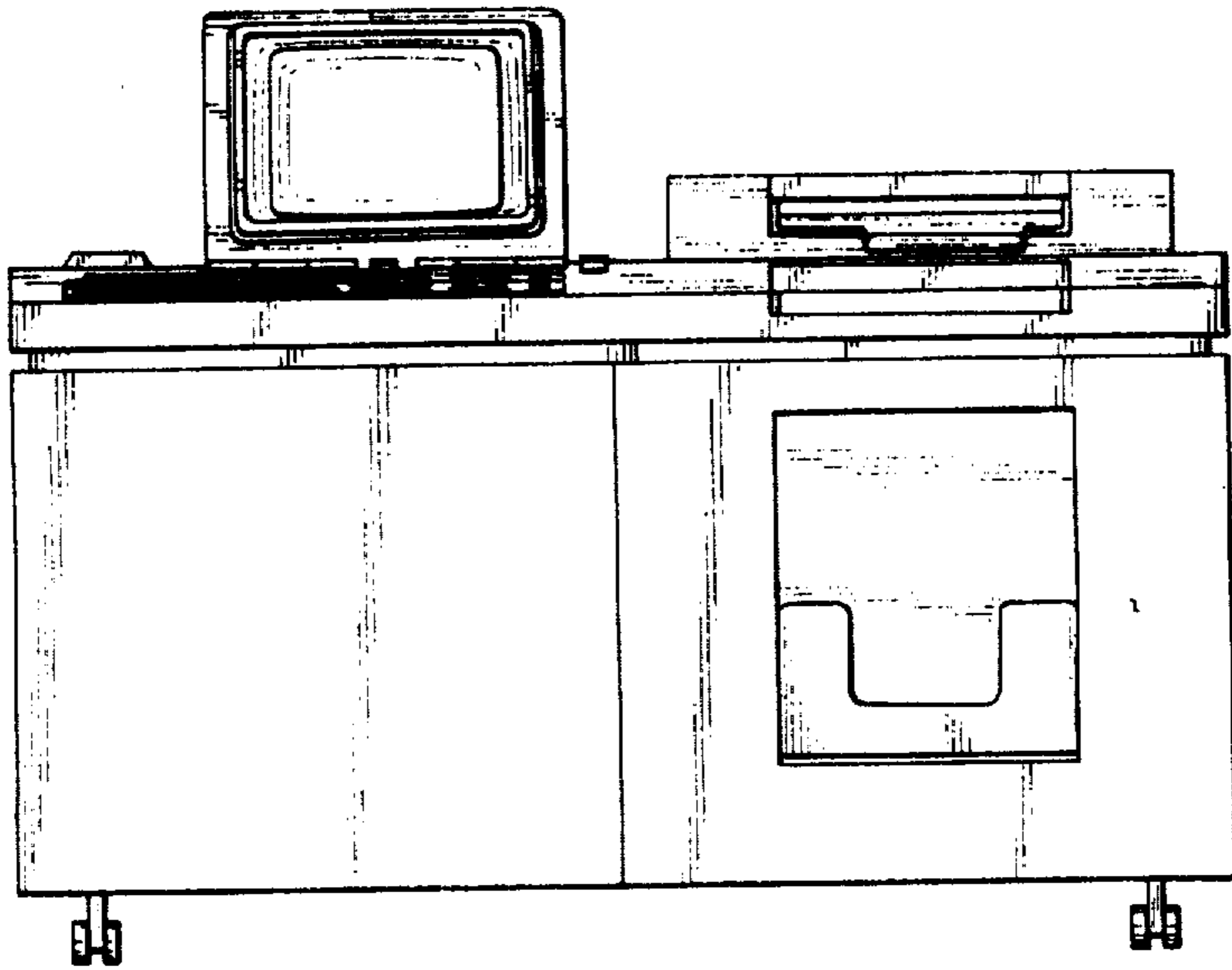

FIG. 3

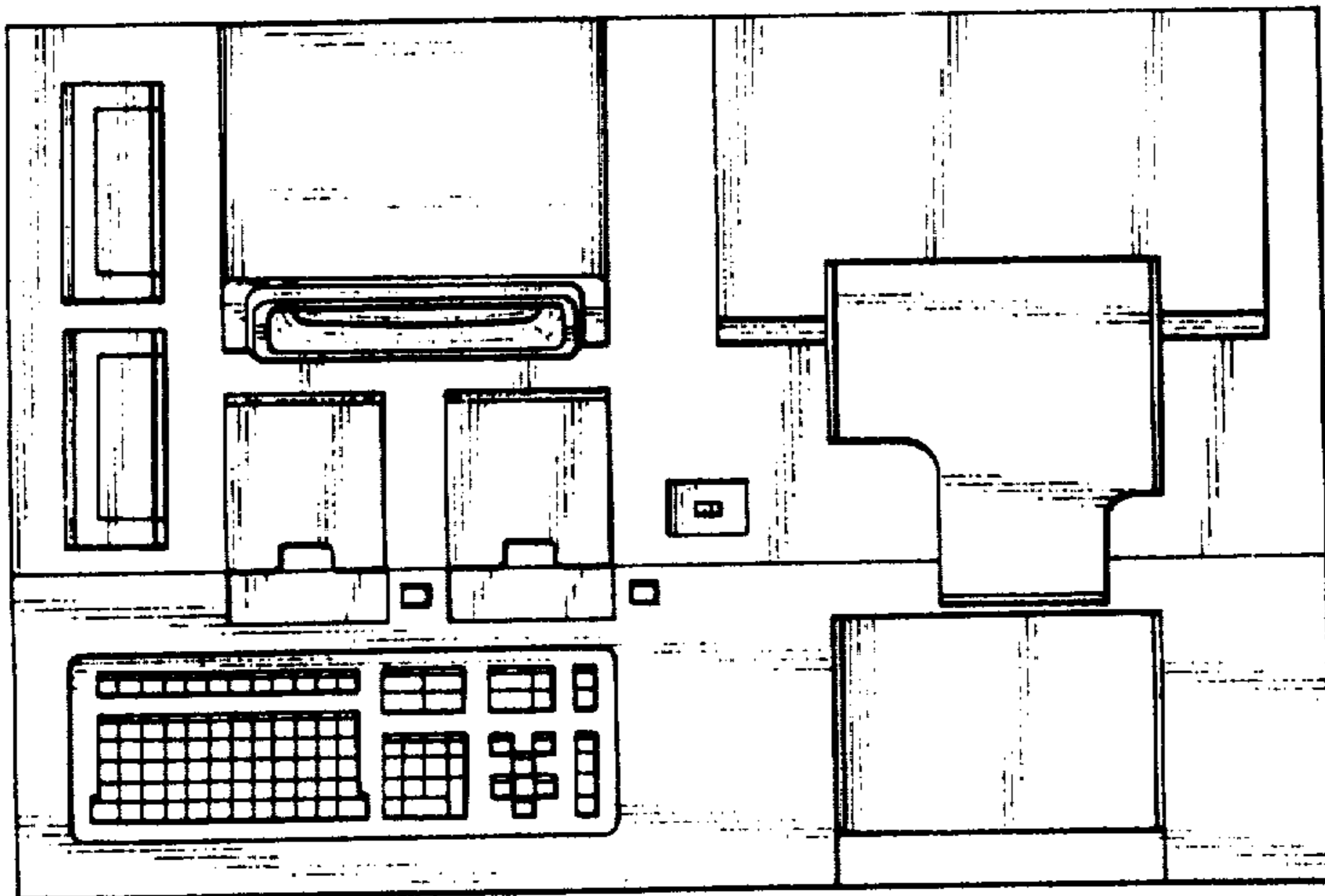

FIG. 4

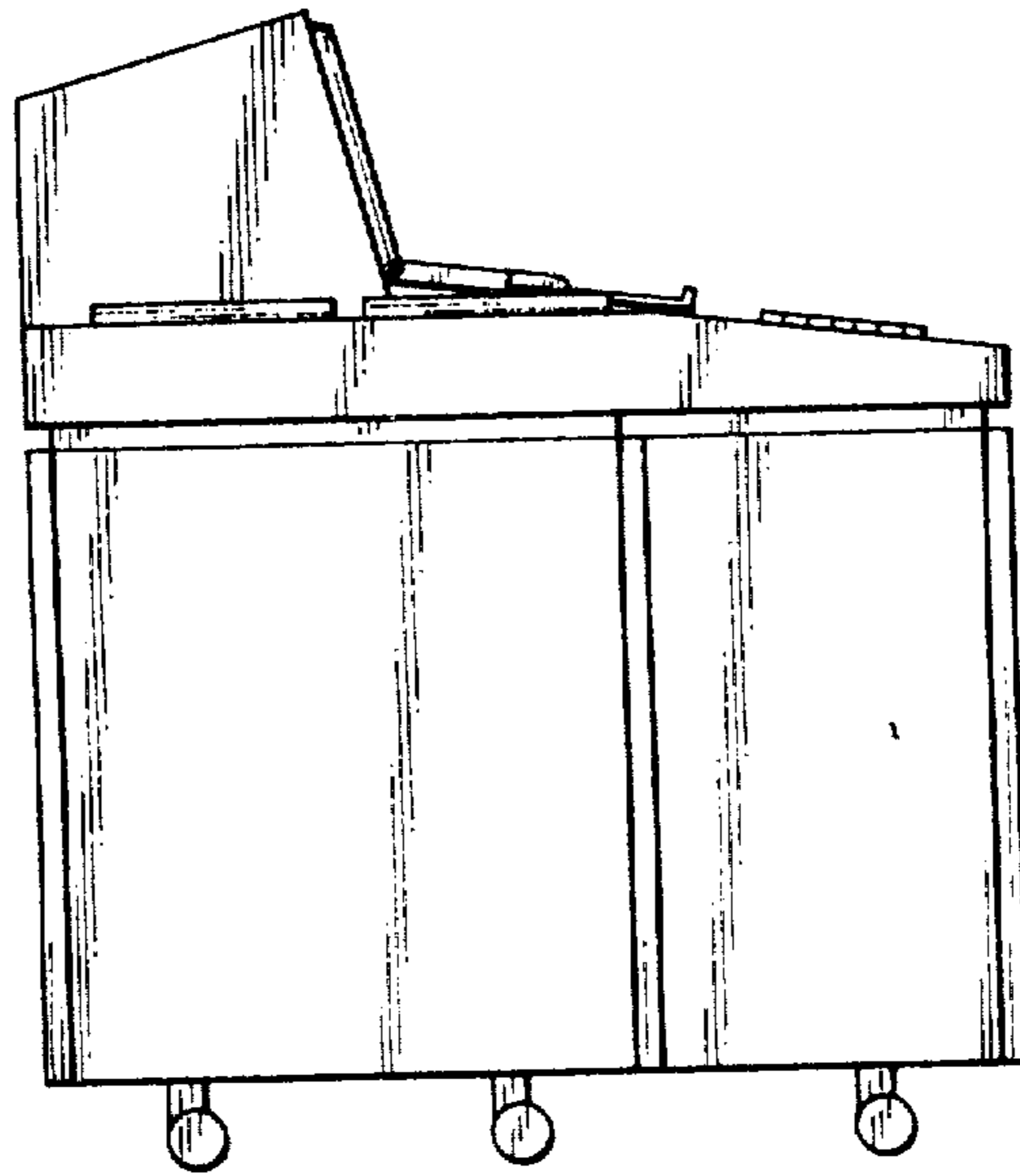

FIG. 5

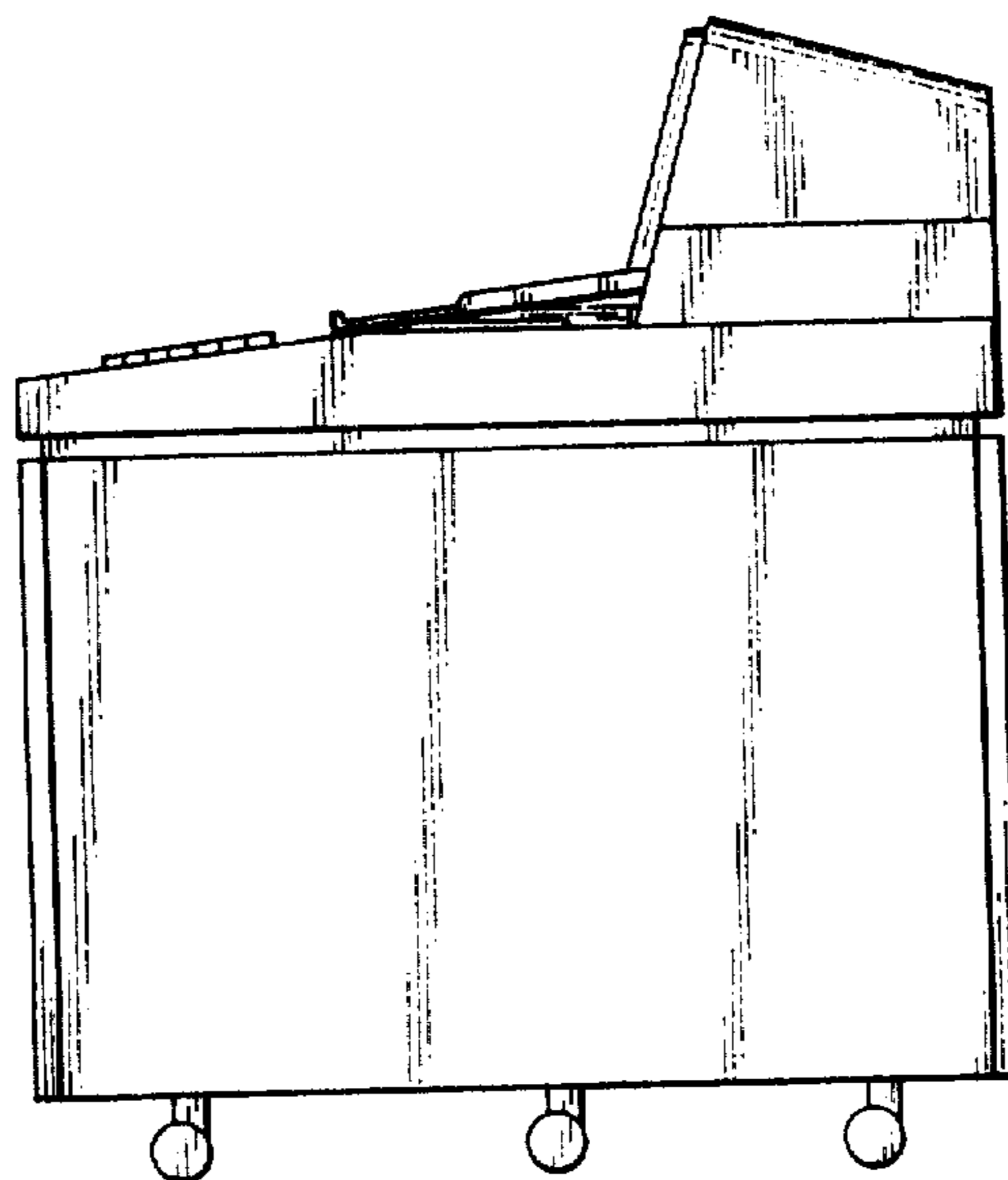

FIG. 6

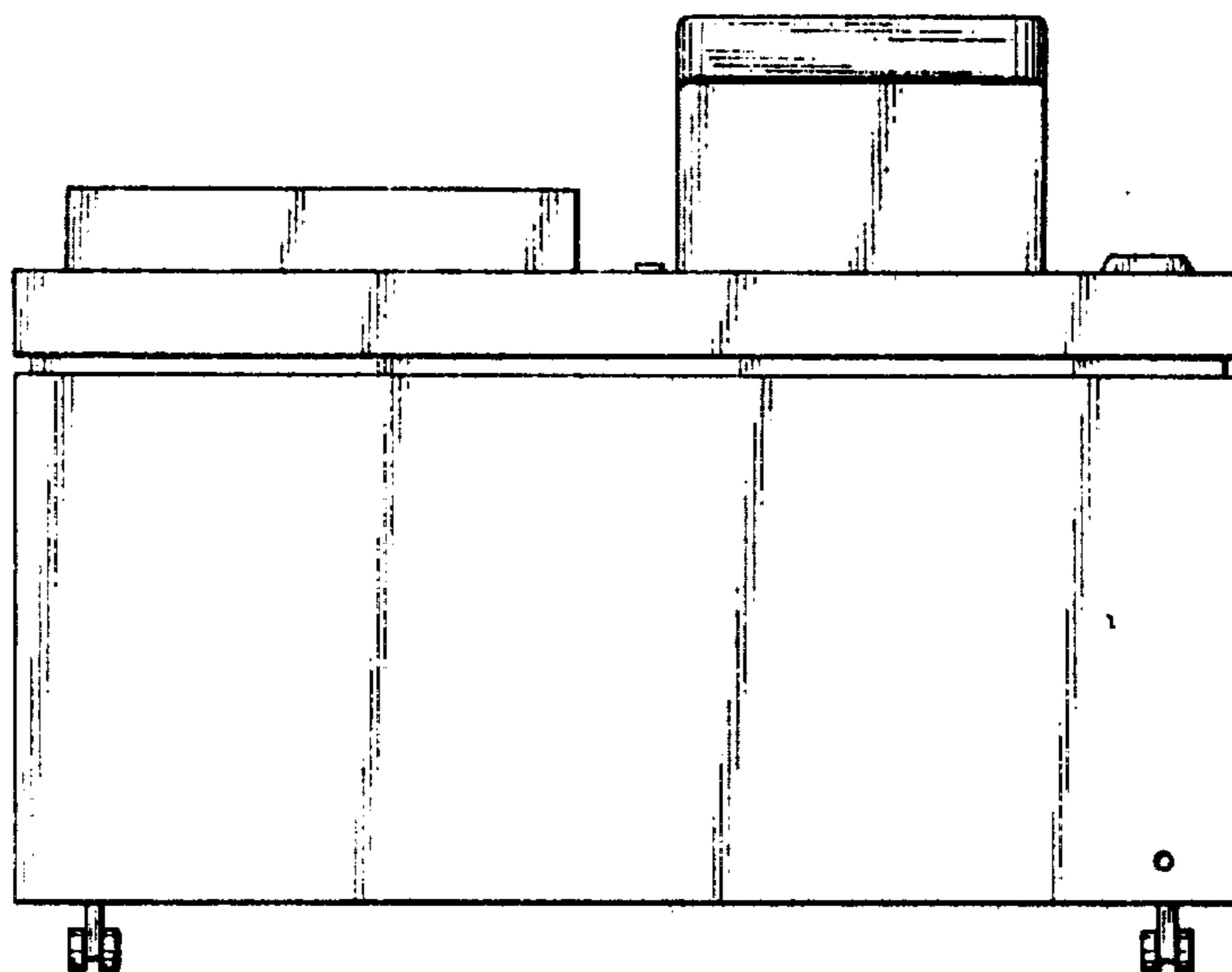
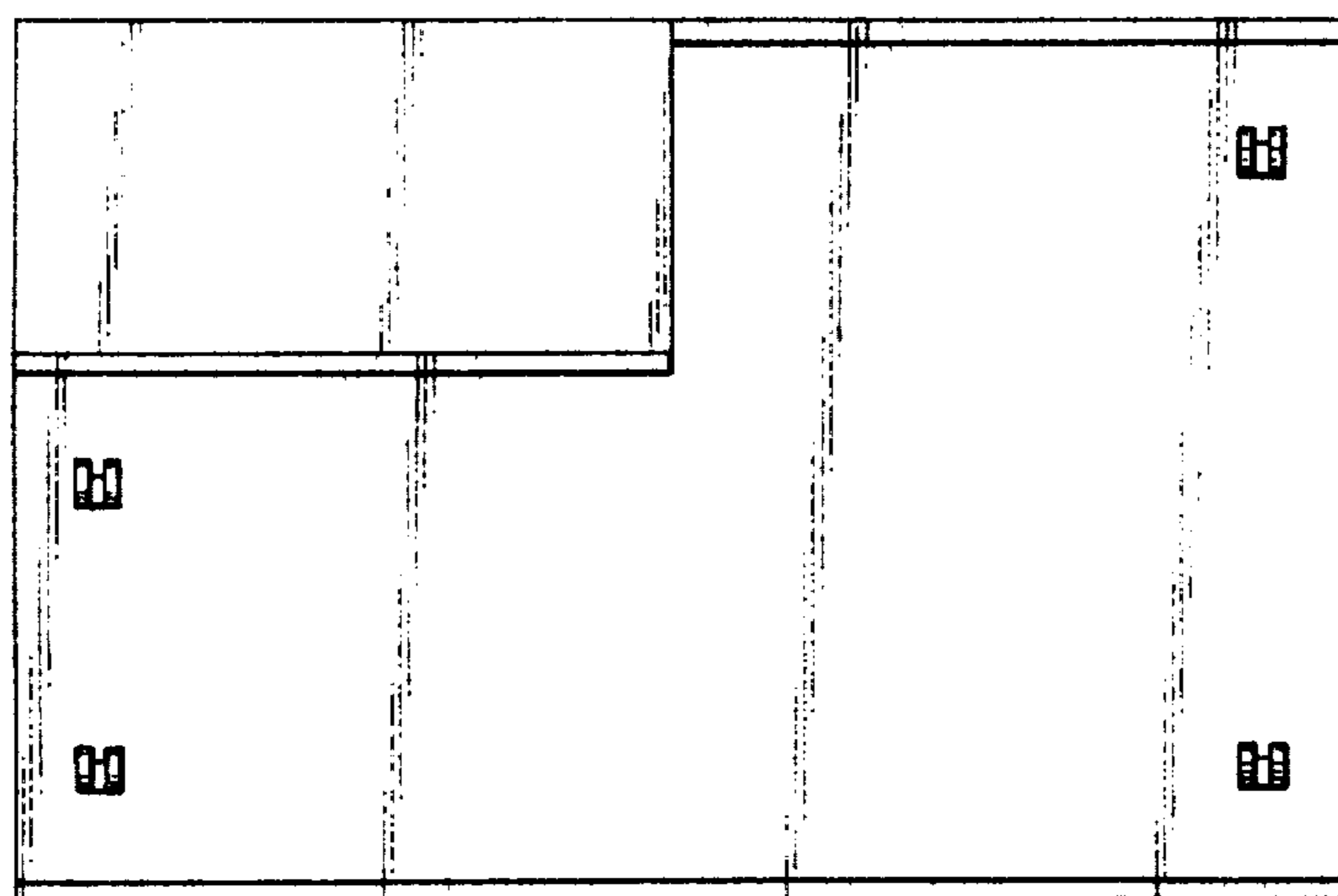

FIG. 7



UNITED STATES PATENT AND TRADEMARK OFFICE
CERTIFICATE OF CORRECTION

PATENT NO. : DES. 270,536
DATED : September 13, 1983
INVENTOR(S) : KUNIO HARA

It is certified that error appears in the above—identified patent and that said Letters Patent is hereby corrected as shown below:

IN THE CLAIM:

After "function," insert --or the like,--

Signed and Sealed this

Twentieth Day of December 1983

[SEAL]

Attest:

Attesting Officer

GERALD J. MOSSINGHOFF

Commissioner of Patents and Trademarks