

[54] HUTCH OR SIMILAR ARTICLE

[75] Inventor: Sidney A. Lenger, Jr., Jamestown, N.C.

[73] Assignee: The Singer Company, Stamford, Conn.

[\*\*] Term: 14 Years

[21] Appl. No.: 186,814

[22] Filed: Sep. 12, 1980

[51] Int. Cl. .... D06-04

[52] U.S. Cl. .... D6/53

[58] Field of Search ..... D6/1, 5, 151, 153, 154, D6/181, 186, 167, 168, 169, 170; D21/114, 115, 118; 46/12, 13, 19, 21; 312/204, 224, 237

[56] **References Cited**

U.S. PATENT DOCUMENTS

D. 196,470 10/1963 Hendley ..... D6/153

1,889,468 11/1932 Flannery ..... 46/12

2,114,886 4/1938 Merriman ..... 46/12

3,174,814 3/1965 Kershaw ..... 312/204

4,233,778 11/1980 Lemelson ..... 46/19 X

*Primary Examiner*—Joel Stearman  
*Assistant Examiner*—Carmen H. Vales  
*Attorney, Agent, or Firm*—Robert E. Smith; Edward L. Bell

[57] CLAIM

The ornamental design for a hutch or similar article, substantially as shown.

DESCRIPTION

FIG. 1 is an enlarged front perspective view of a hutch or similar article showing my new design, FIG. 2 is a front elevational view, FIG. 3 is a rear elevational view, FIG. 4 is a top plan view, FIG. 5 is a rear side elevational view, and FIG. 6 is a left side elevational view.

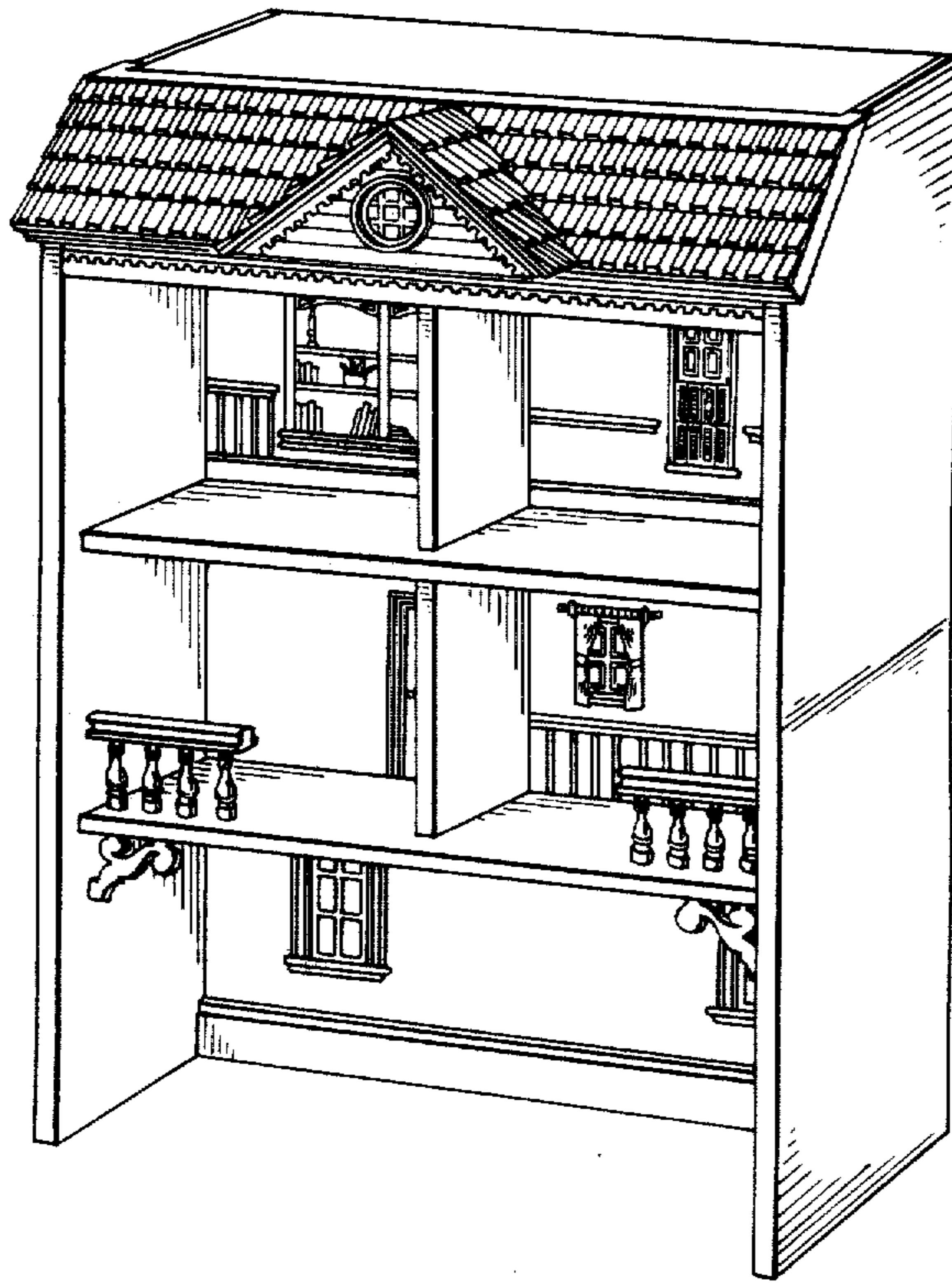

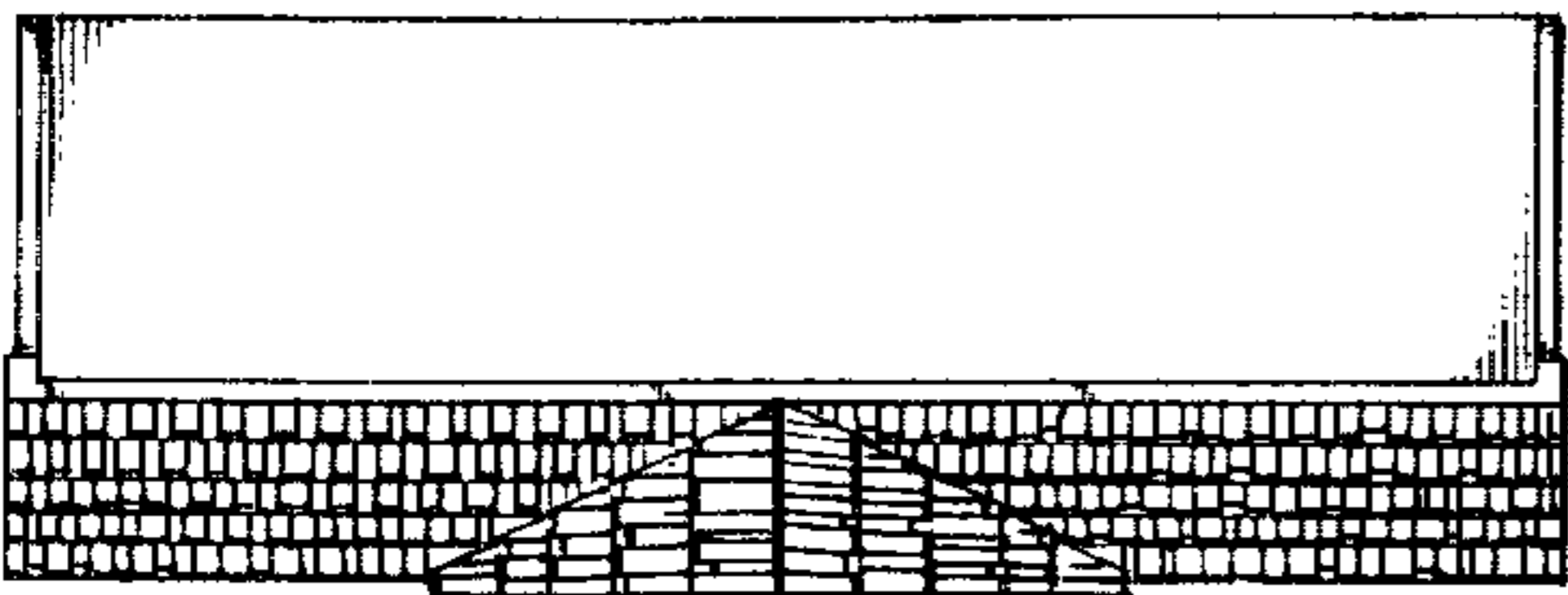

Fig. 4

Fig. 2

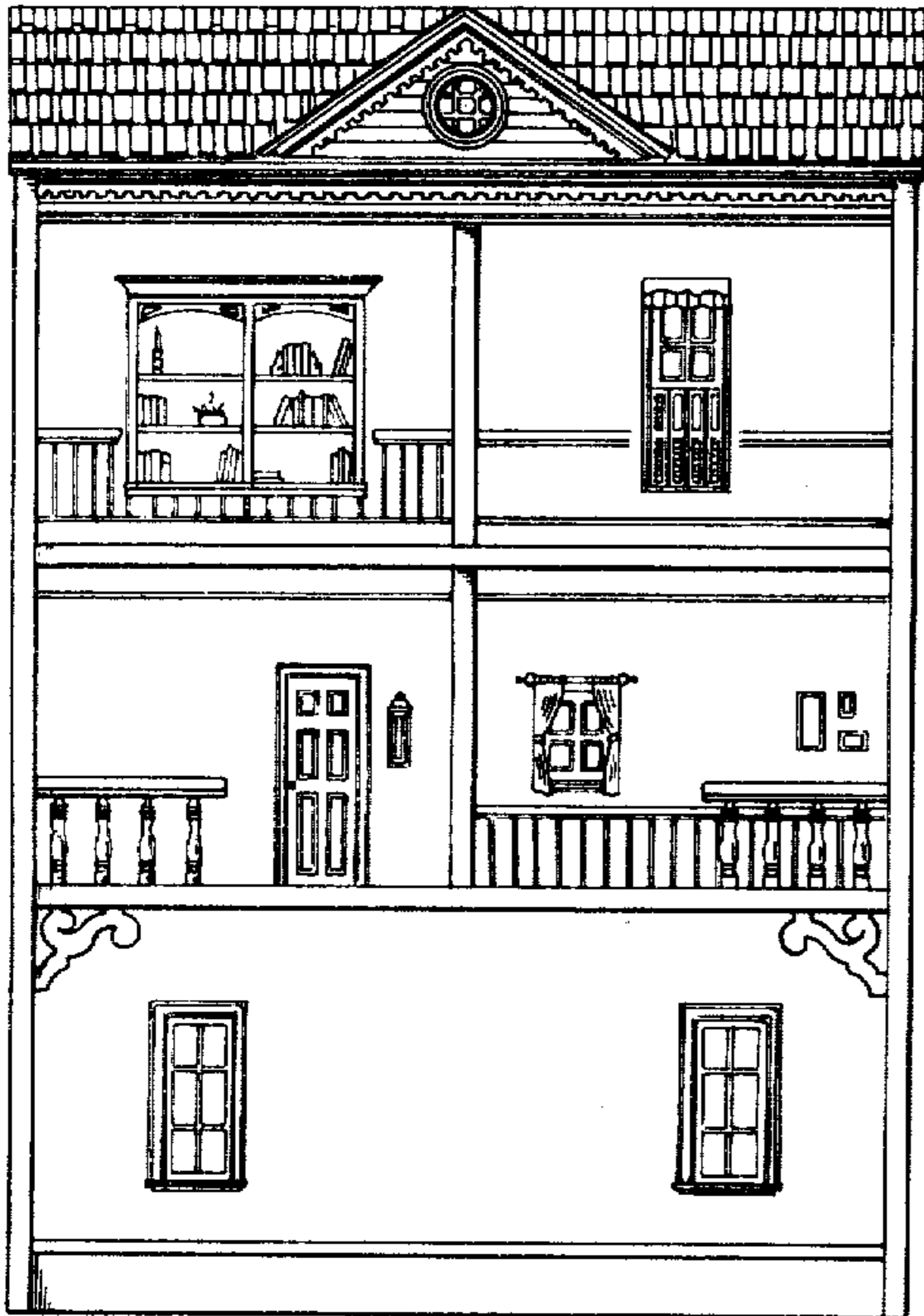

Fig. 1

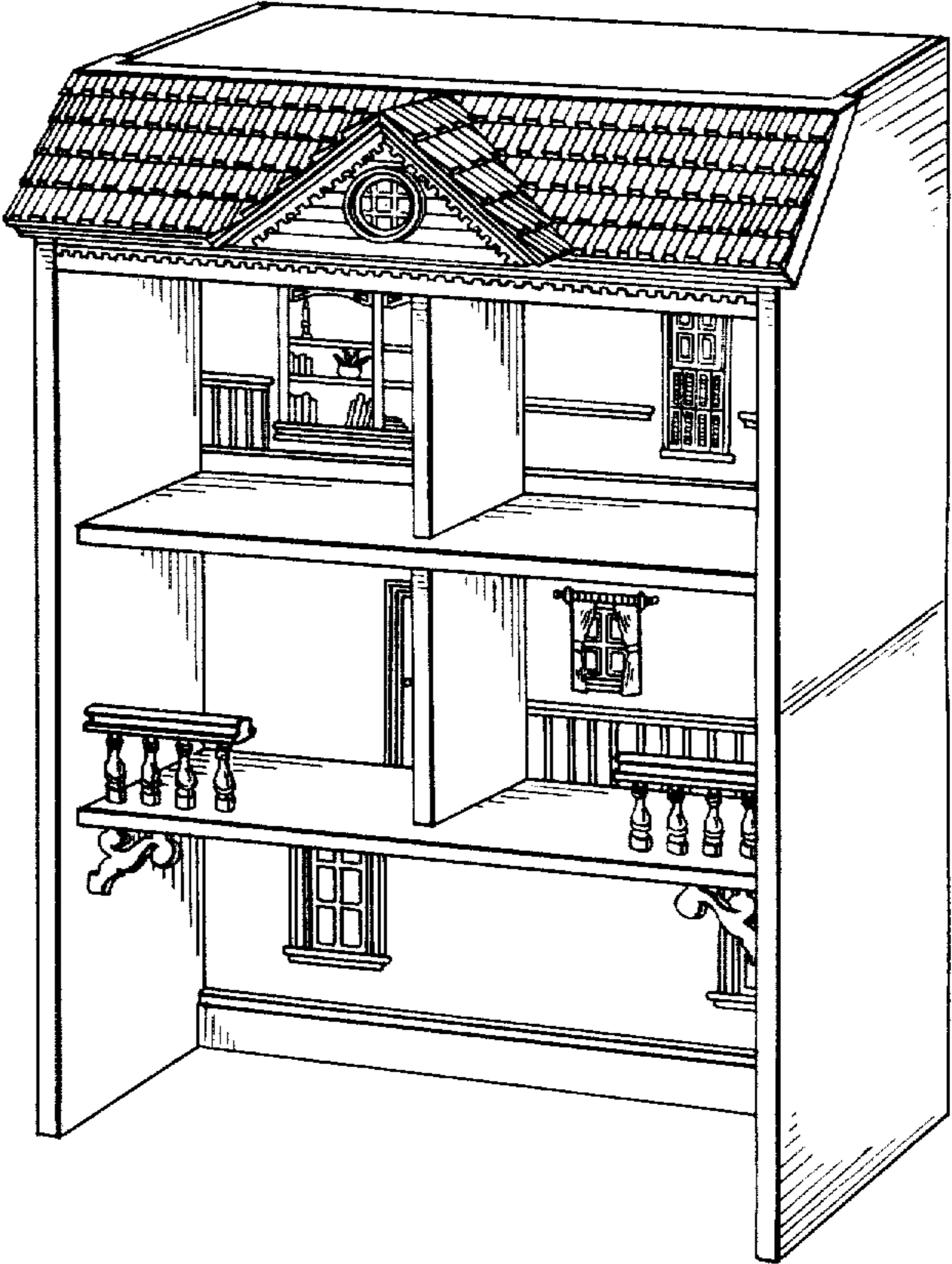

Fig. 3

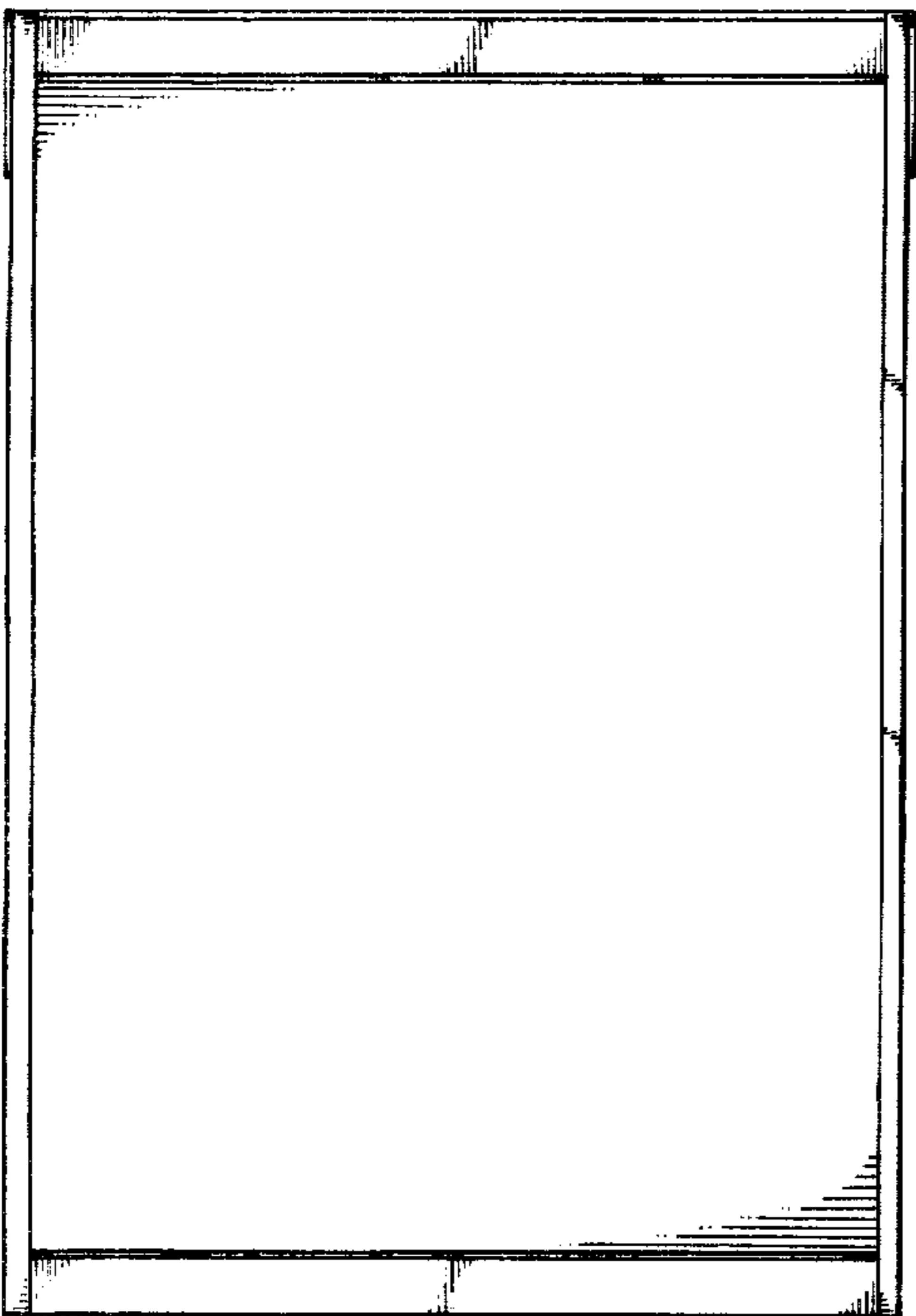

Fig. 6

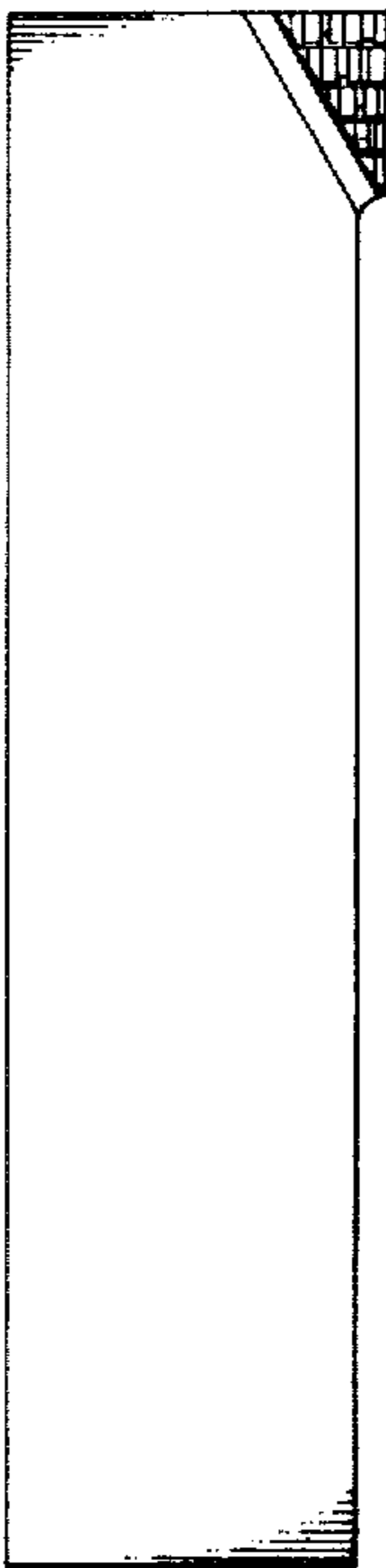

Fig. 5

