

[54] BUILDING

[75] Inventor: Glenn W. Monigle, Golden, Colo.

[73] Assignee: The National Bank of Georgia, Atlanta, Ga.

[**] Term: 14 Years

[21] Appl. No.: 189,263

[22] Filed: Sep. 22, 1980

[51] Int. Cl. D25-03

[52] U.S. Cl. D25/33; D25/22

[58] Field of Search D25/1, 16, 22, 32, 33; 52/79.1

[56] References Cited

U.S. PATENT DOCUMENTS

D. 123,640 11/1940 Thomason D25/33

D. 147,738 10/1947 Wakefield D25/33 X

D. 192,026 1/1962 McGee D25/33

D. 250,839 1/1979 Chambers D25/33 X

Primary Examiner—A. Hugo Word
Attorney, Agent, or Firm—Beveridge, DeGrandi & Kline

[57] CLAIM

The ornamental design for a building, substantially as shown and described.

DESCRIPTION

FIG. 1 is a front perspective view of a building showing the new design;

FIG. 2 is an elevational view of the right side thereof;

FIG. 3 is a rear view thereof; and,

FIG. 4 is a top view thereof.

The left side of the building is substantially a mirror image of FIG. 2, and the bottom of the building is plain and unornamental.

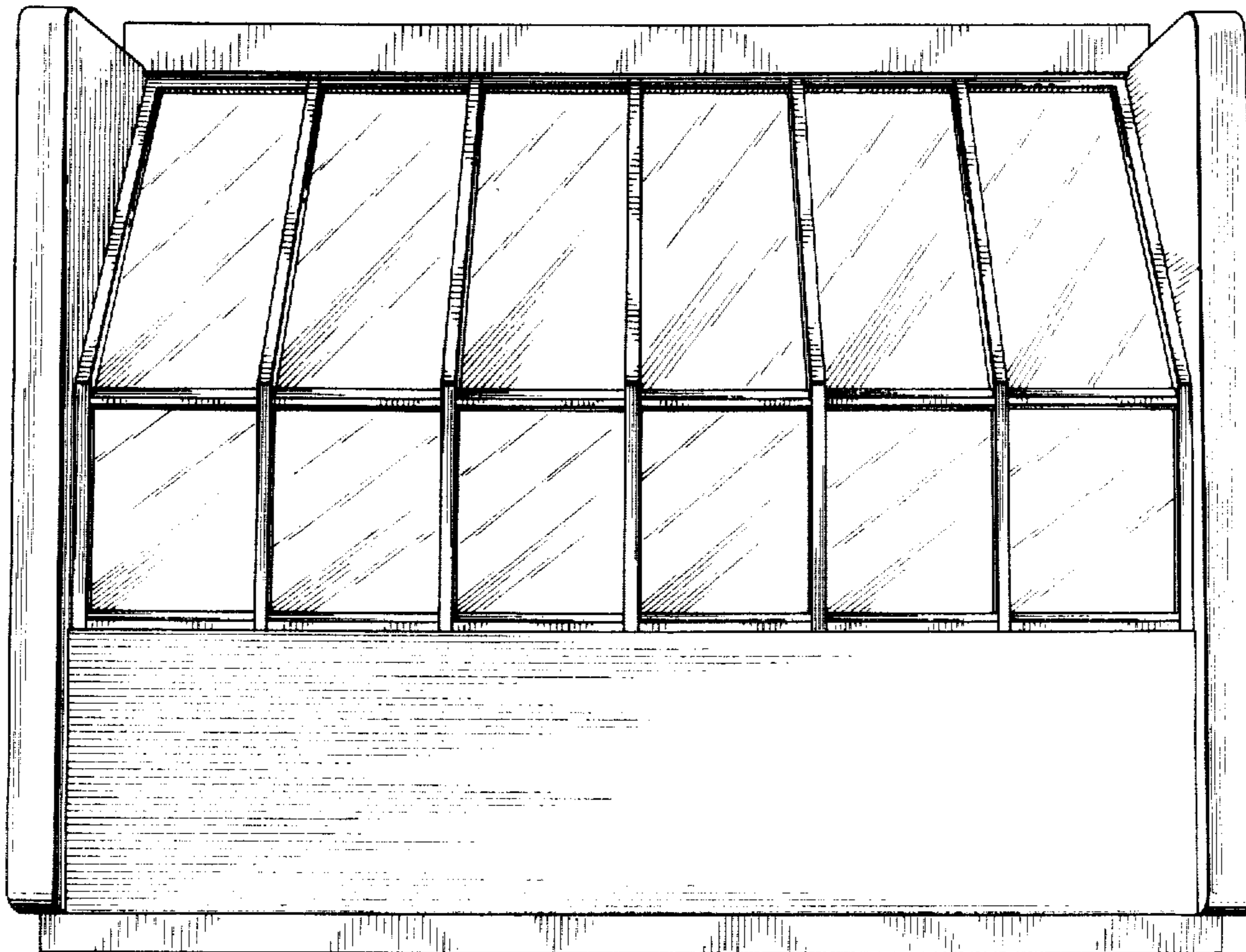

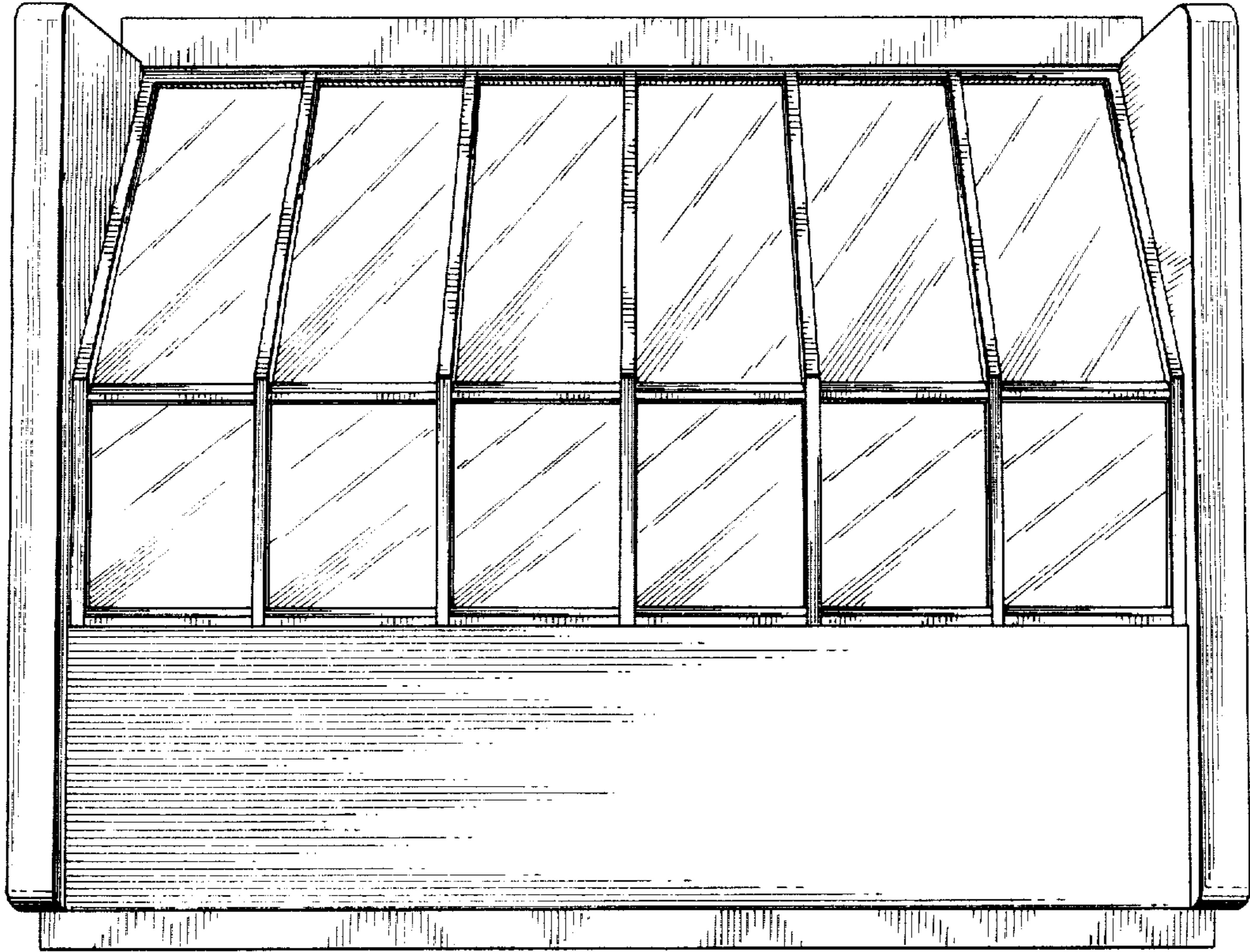
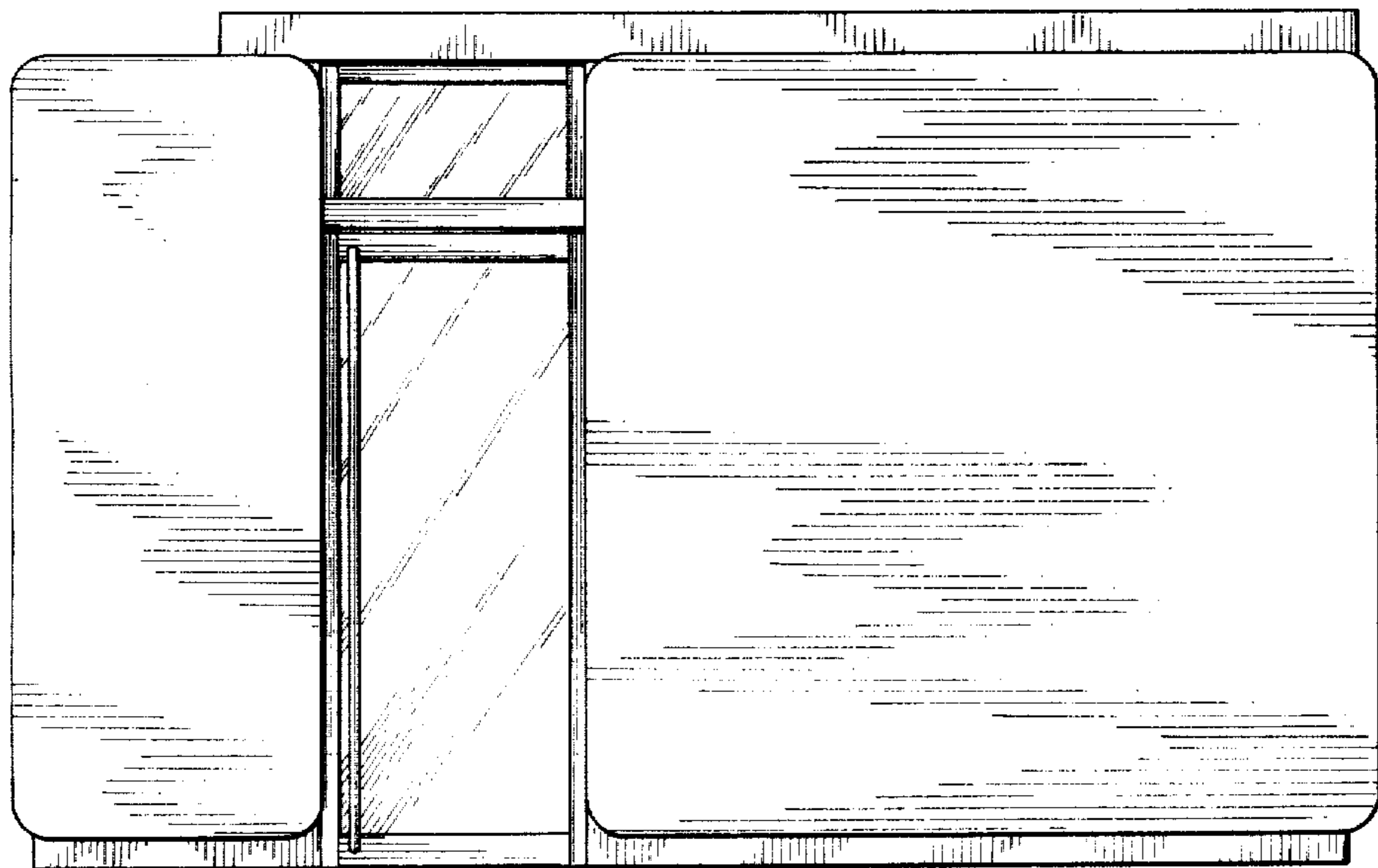

FIG. 1

FIG. 2



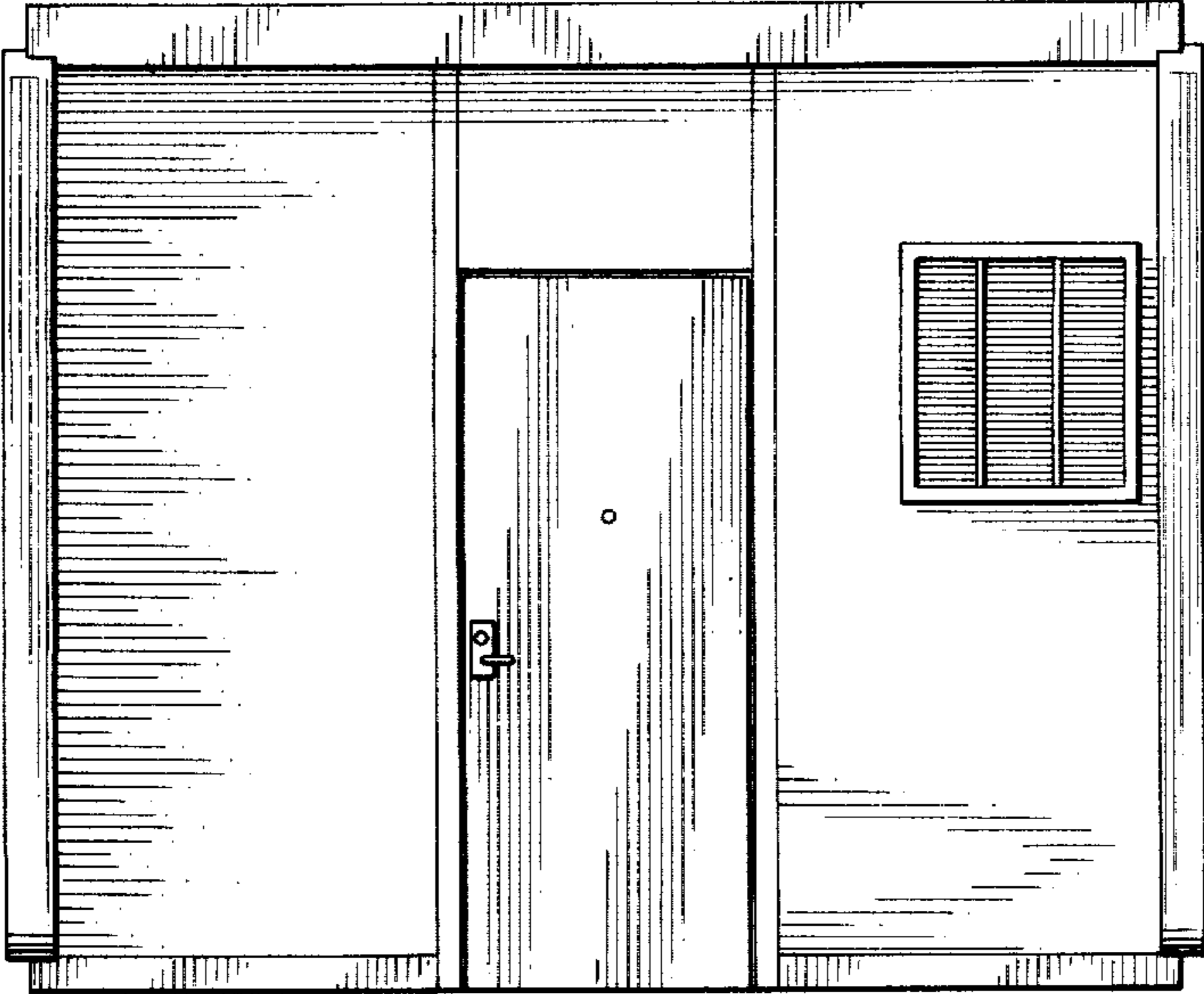

FIG. 3

FIG. 4

