

[54] WALL MOUNTED COMMUNICATIONS MODULE FOR AN AUTOMATED TELLER

[75] Inventor: Ernest F. J. Prinzhorn, Pasadena, Calif.

[73] Assignee: QRS Corporation, Los Angeles, Calif.

[\*\*] Term: 14 Years

[21] Appl. No.: 205,018

[22] Filed: Nov. 7, 1980

[51] Int. Cl. .... D14-03; D14-02

[52] U.S. Cl. .... D14/61; D99/28

[58] Field of Search ..... 235/419, 379; 179/6.3 R, 2 DP; D14/61; D99/28, 99; D6/132

[56] References Cited

U.S. PATENT DOCUMENTS

D. 209,793	1/1968	Hinohara	.....	D99/28
D. 238,429	1/1976	Hermann	.....	D99/28
D. 251,465	4/1979	Margeson	.....	D6/132
D. 253,701	12/1979	Woods	.....	D99/28
D. 256,692	9/1980	Genaro et al.	.....	D14/61
3,932,709	1/1976	Hoff et al.	.....	179/2 DP
3,937,925	2/1976	Boothroyd	.....	235/379
3,943,335	3/1976	Kinker et al.	.....	235/379

4,134,537 1/1979 Glasser et al. .... 235/379

Primary Examiner—Bernard Ansher  
Attorney, Agent, or Firm—Saul Epstein

[57] CLAIM

The ornamental design for a wall mounted communications module for an automated teller, substantially as shown and described.

DESCRIPTION

FIG. 1 is a front perspective view of a wall mounted communications module for an automated teller, showing my new design;

FIG. 2 is a front elevation thereof;

FIG. 3 is a side elevation thereof;

FIG. 4 is a top plan view thereof;

FIG. 5 is a bottom plan view thereof;

FIG. 6 is a rear elevation thereof;

FIG. 7 is a cross-section taken on line 7-7 of FIG. 2;

FIG. 8 is a front perspective view of a modified embodiment of the communications module illustrated in FIG. 1;

FIG. 9 is a front elevation thereof;

FIG. 10 is a side elevation thereof;

FIG. 11 is a top plan view thereof;

FIG. 12 is a bottom plan view thereof;

FIG. 13 is a rear elevation thereof; and

FIG. 14 is a cross-section taken on line 4-4 of FIG. 9.

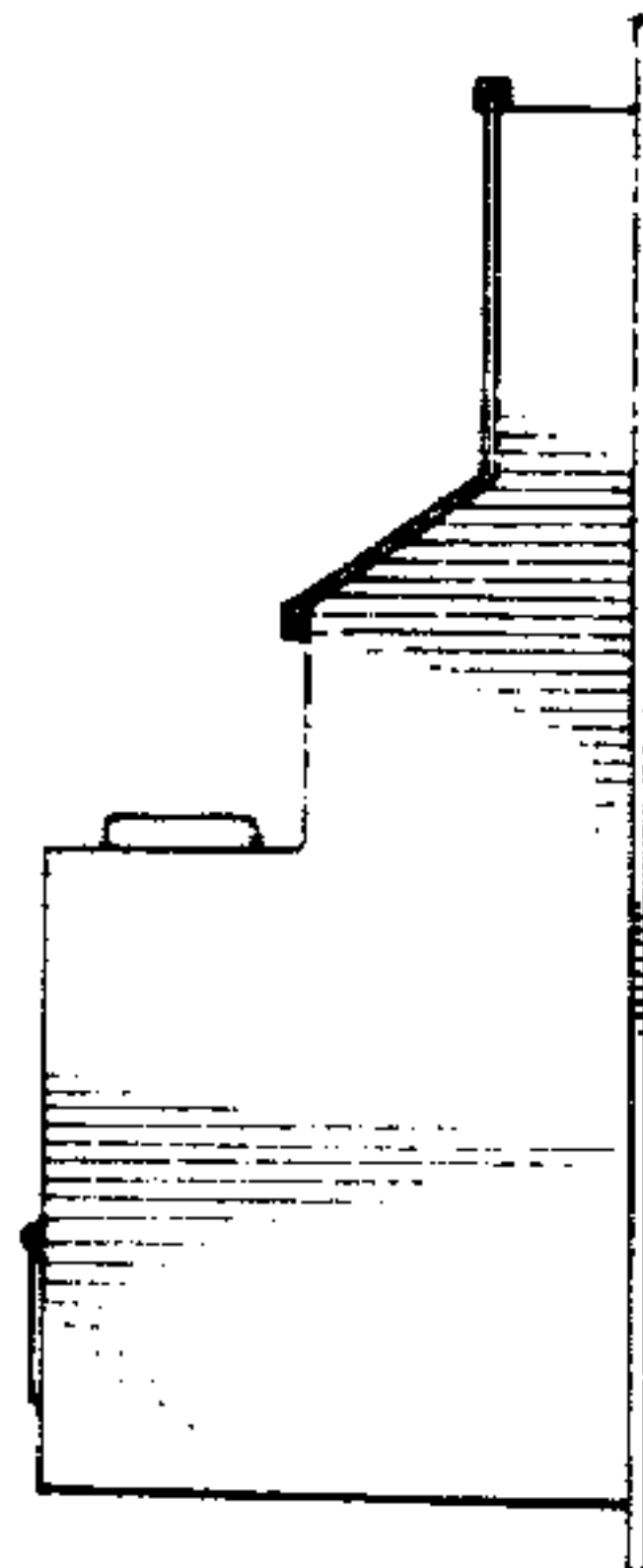
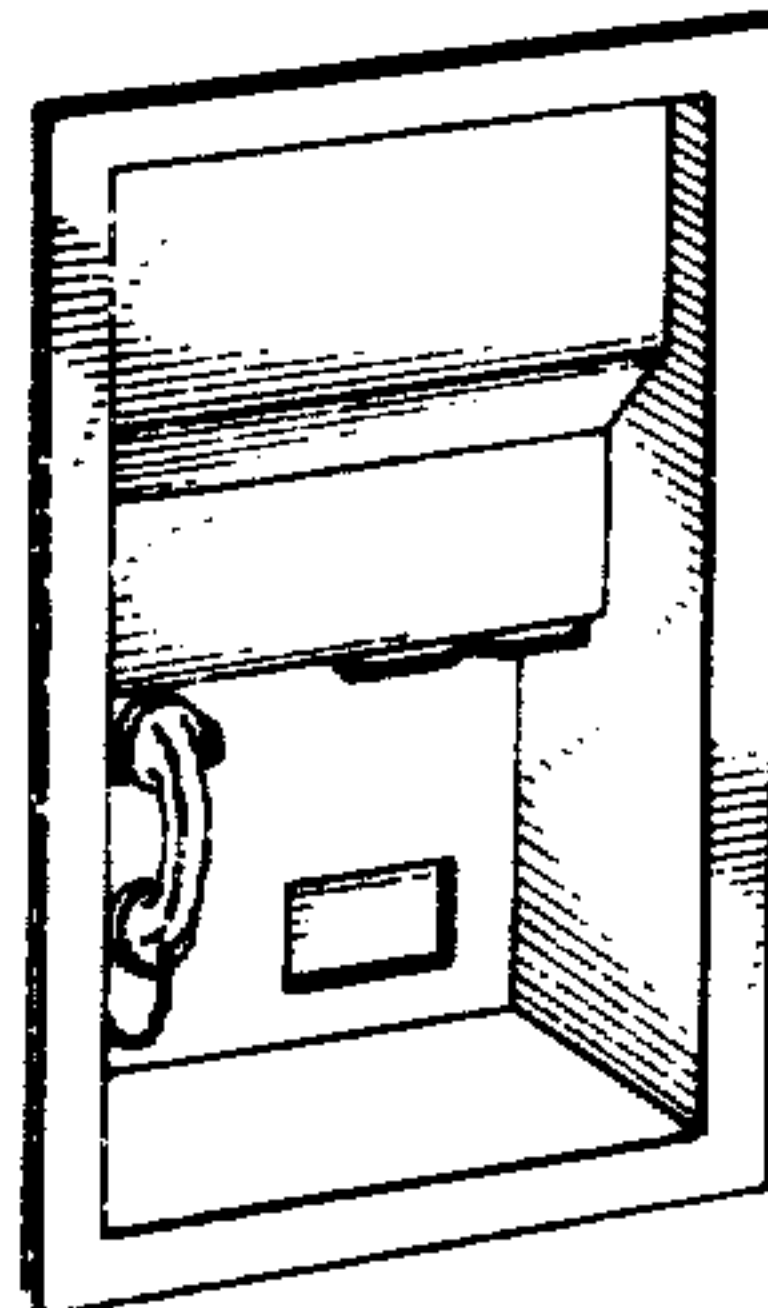

FIG. 1.

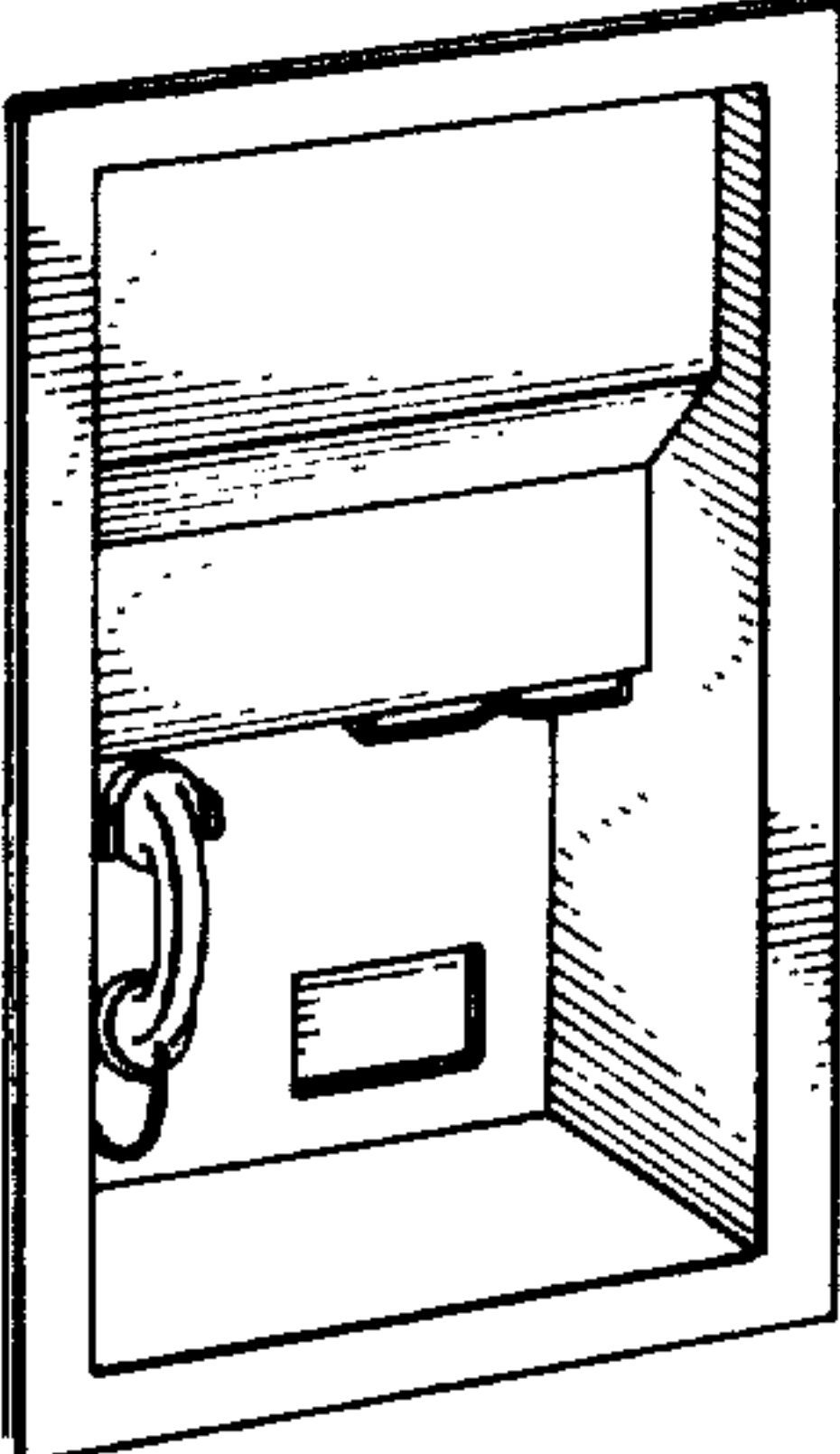

FIG. 2.

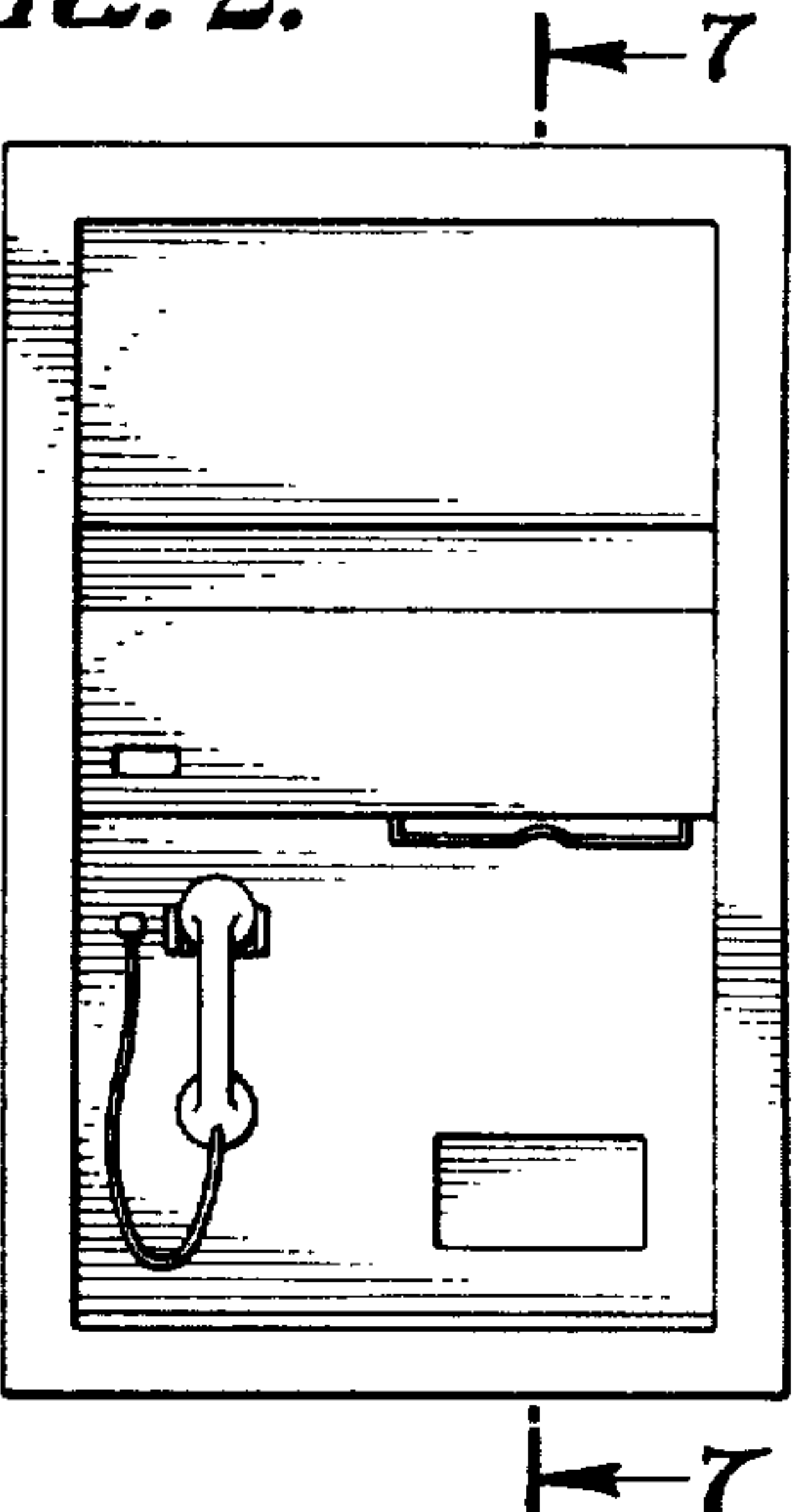

FIG. 4

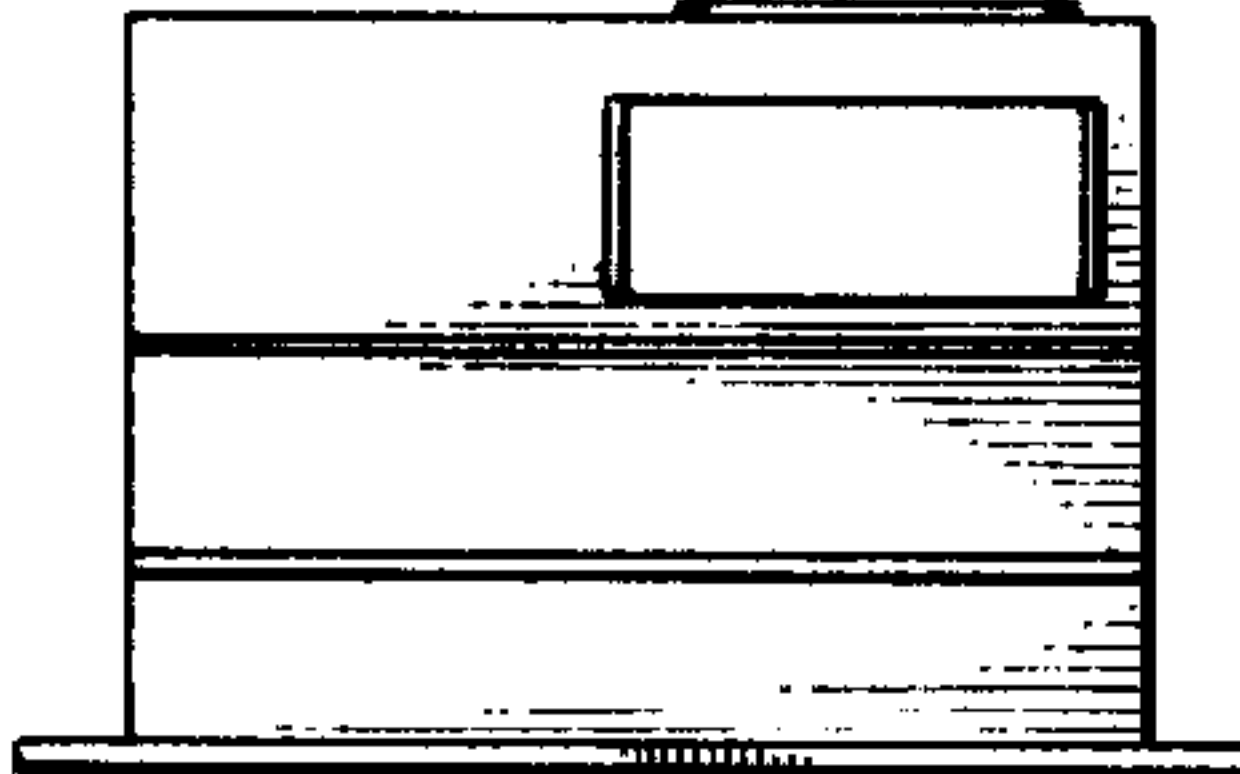

FIG. 3.

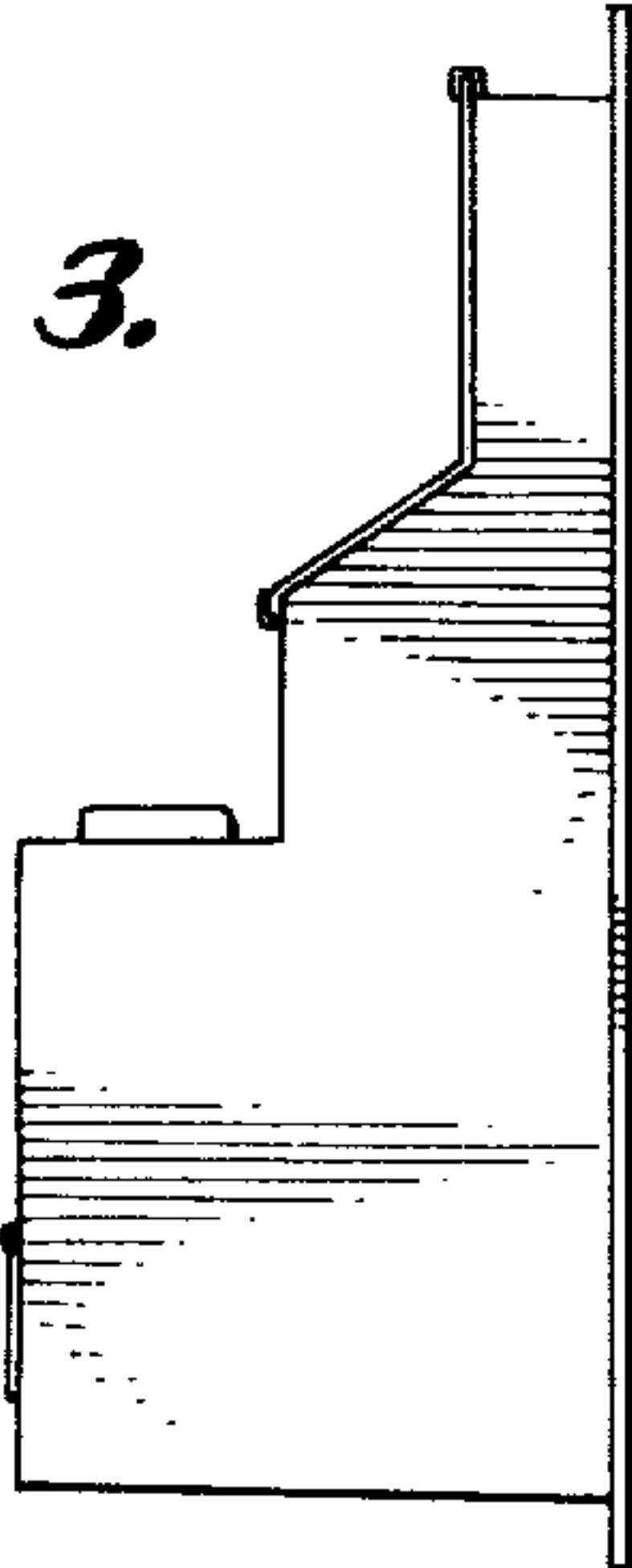

FIG. 5.

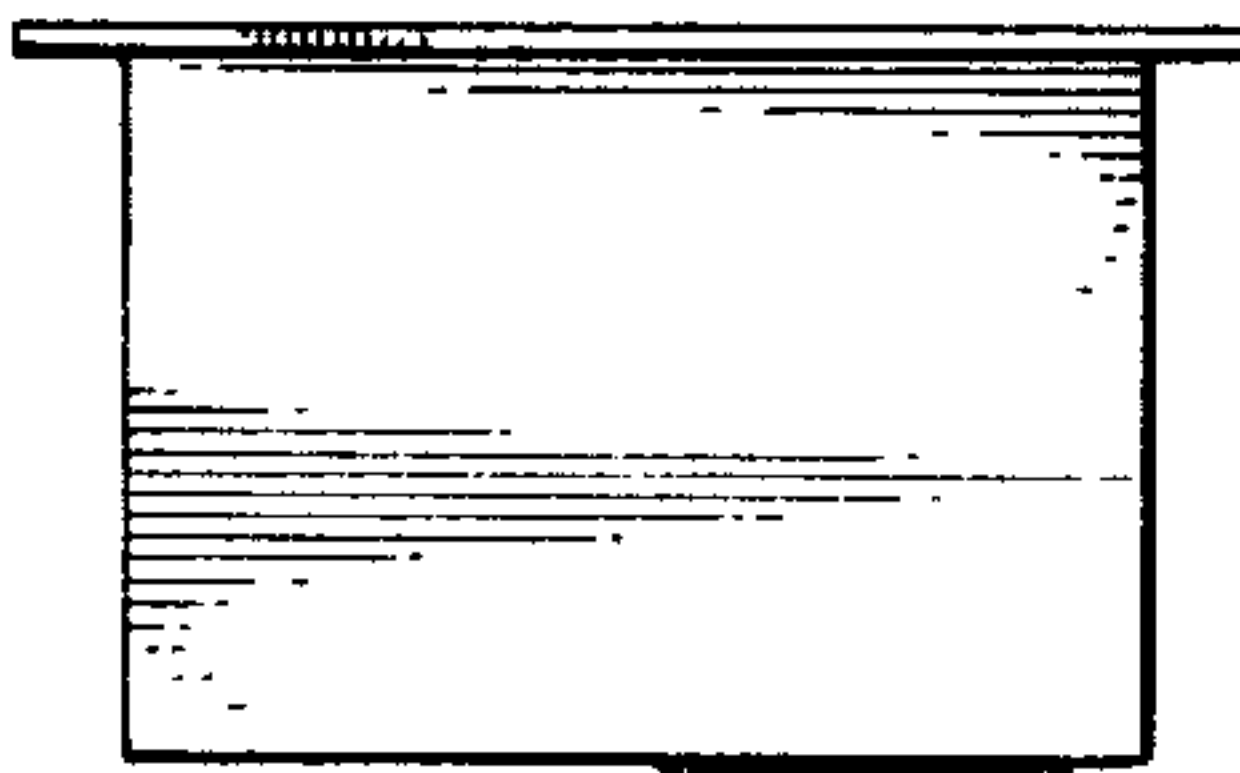

FIG. 6.

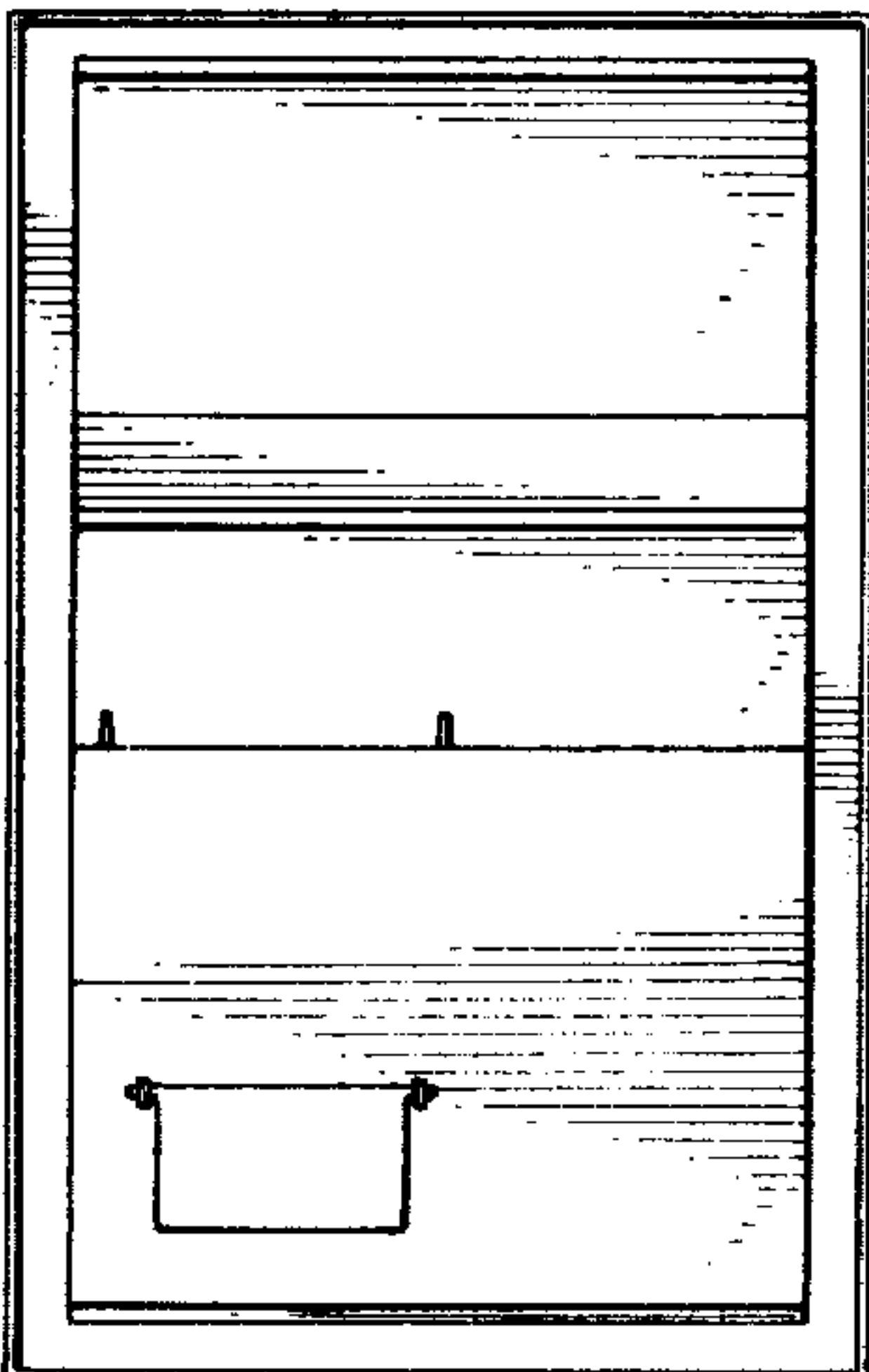
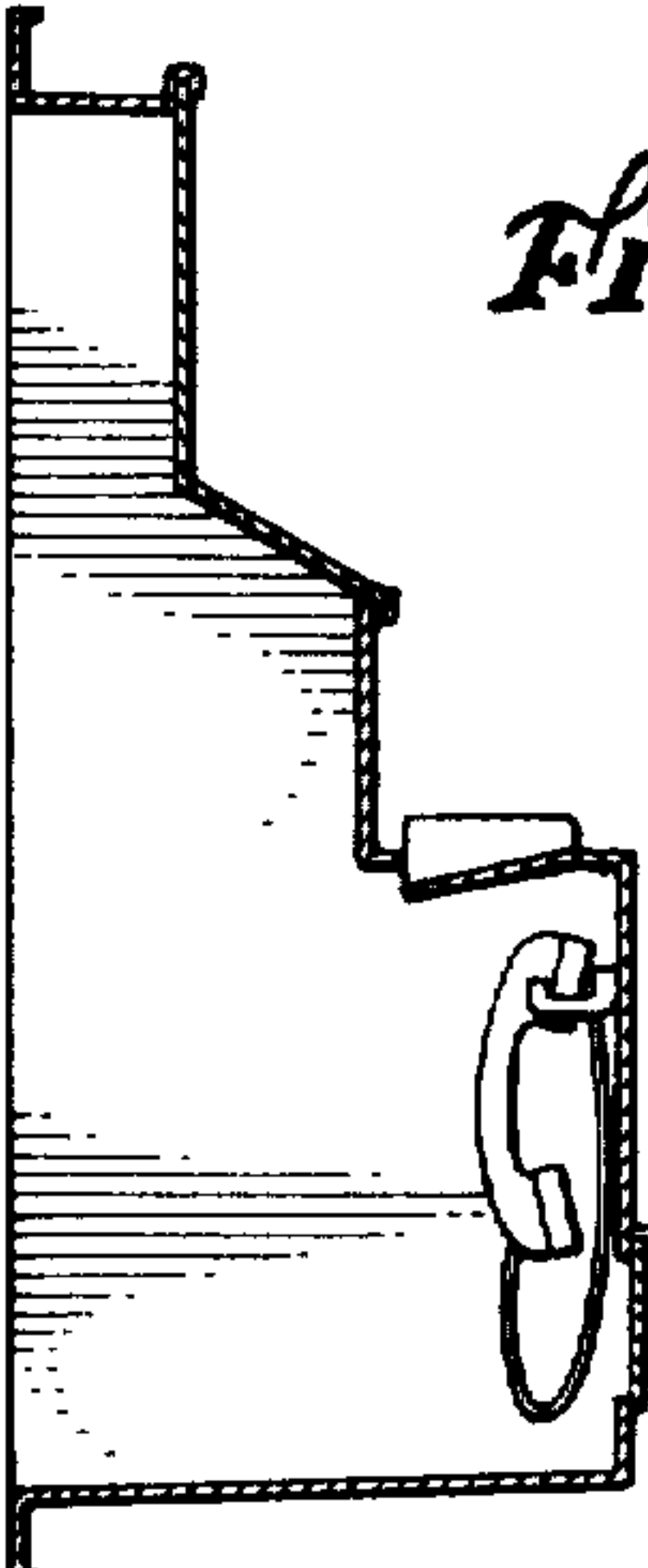
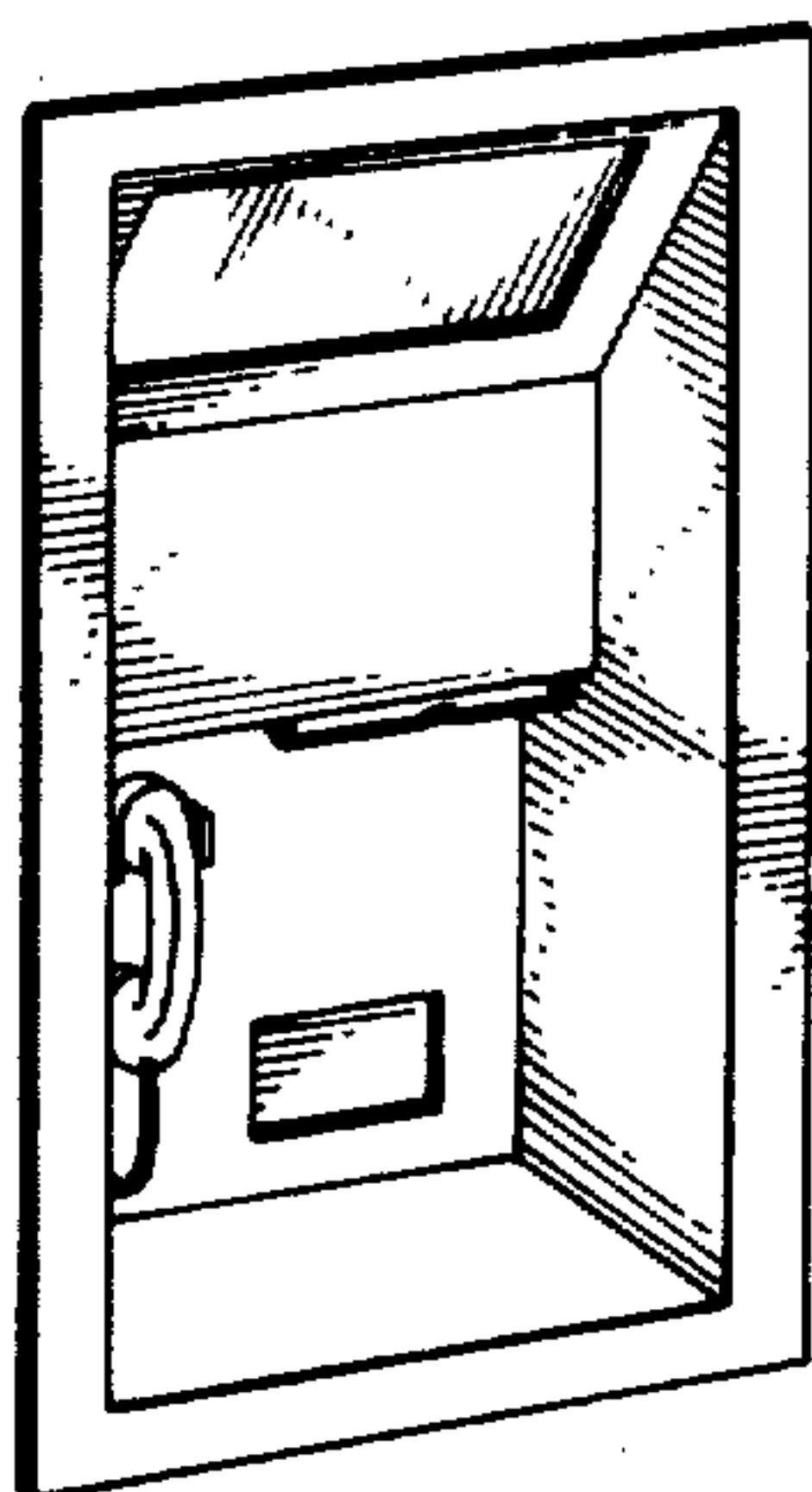

FIG. 7.



*FIG. 8.*



*FIG. 9.* ← 14

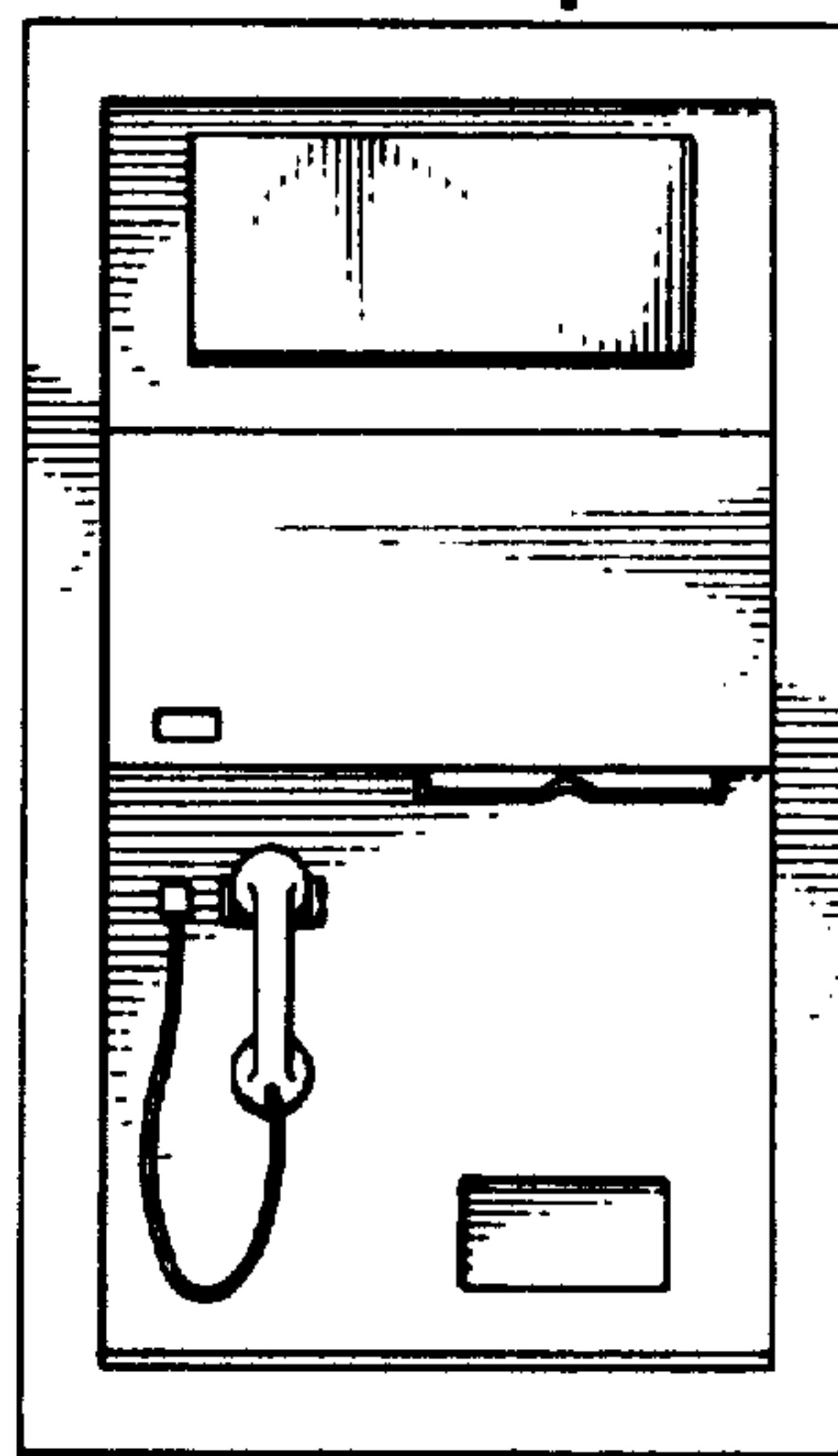

*FIG. 11.*

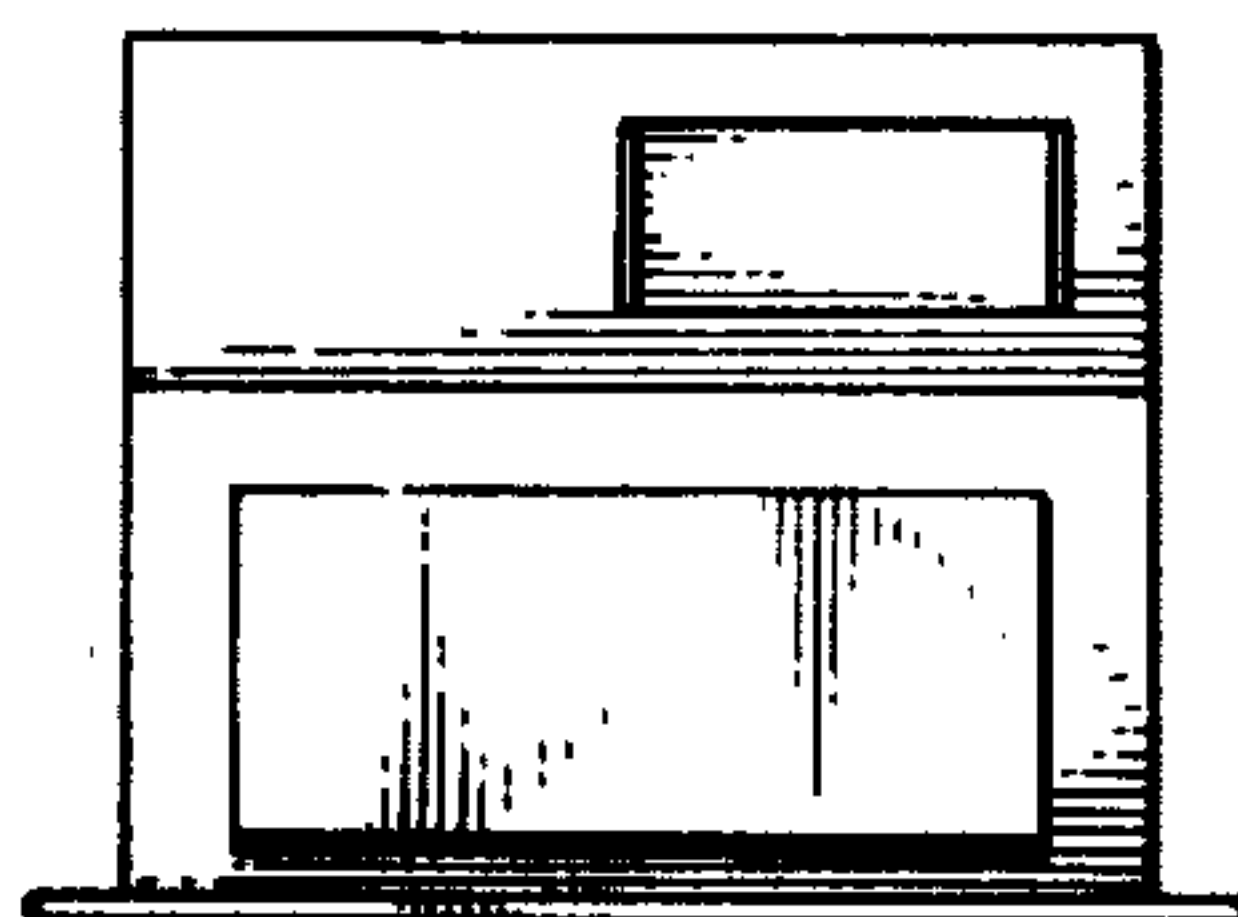

*FIG. 10.*

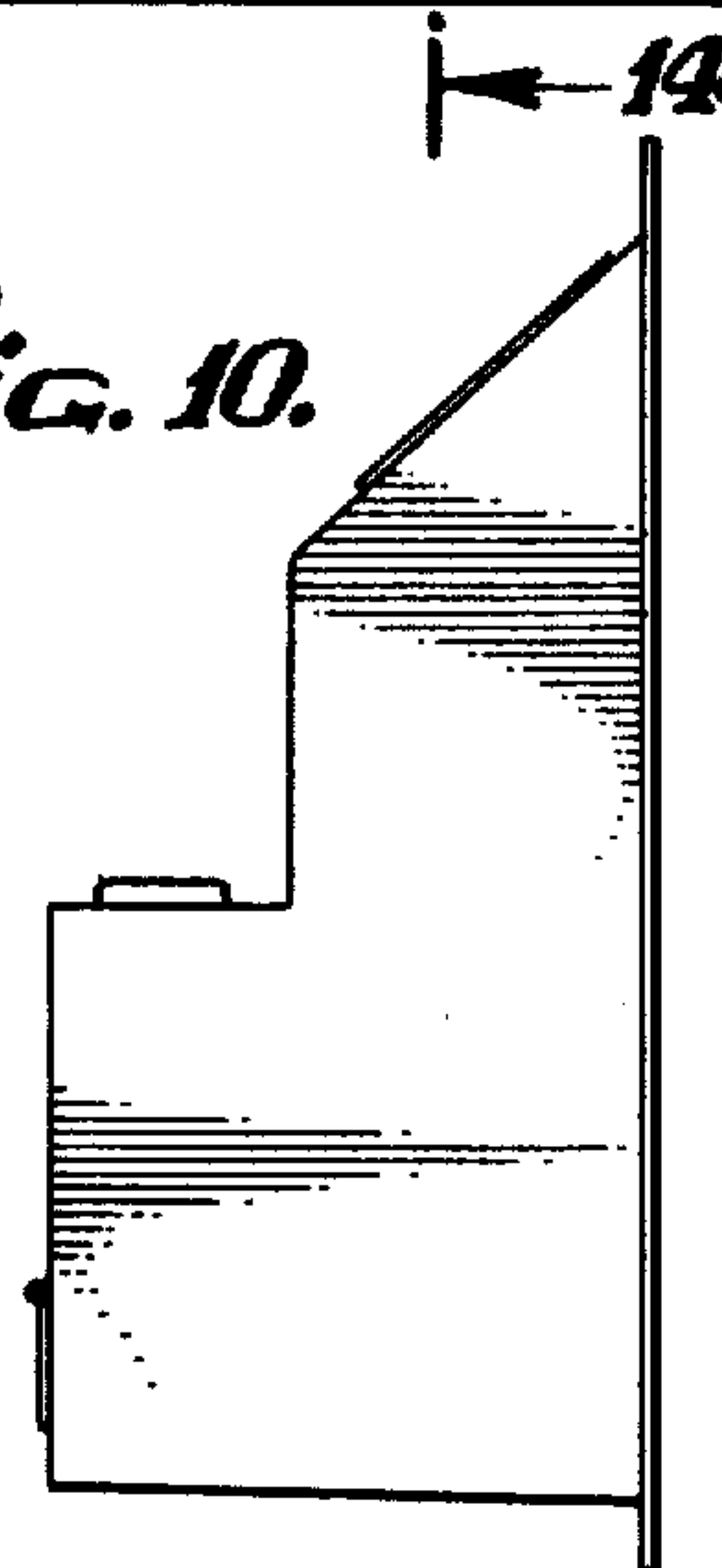

*FIG. 12.*



*FIG. 14.*

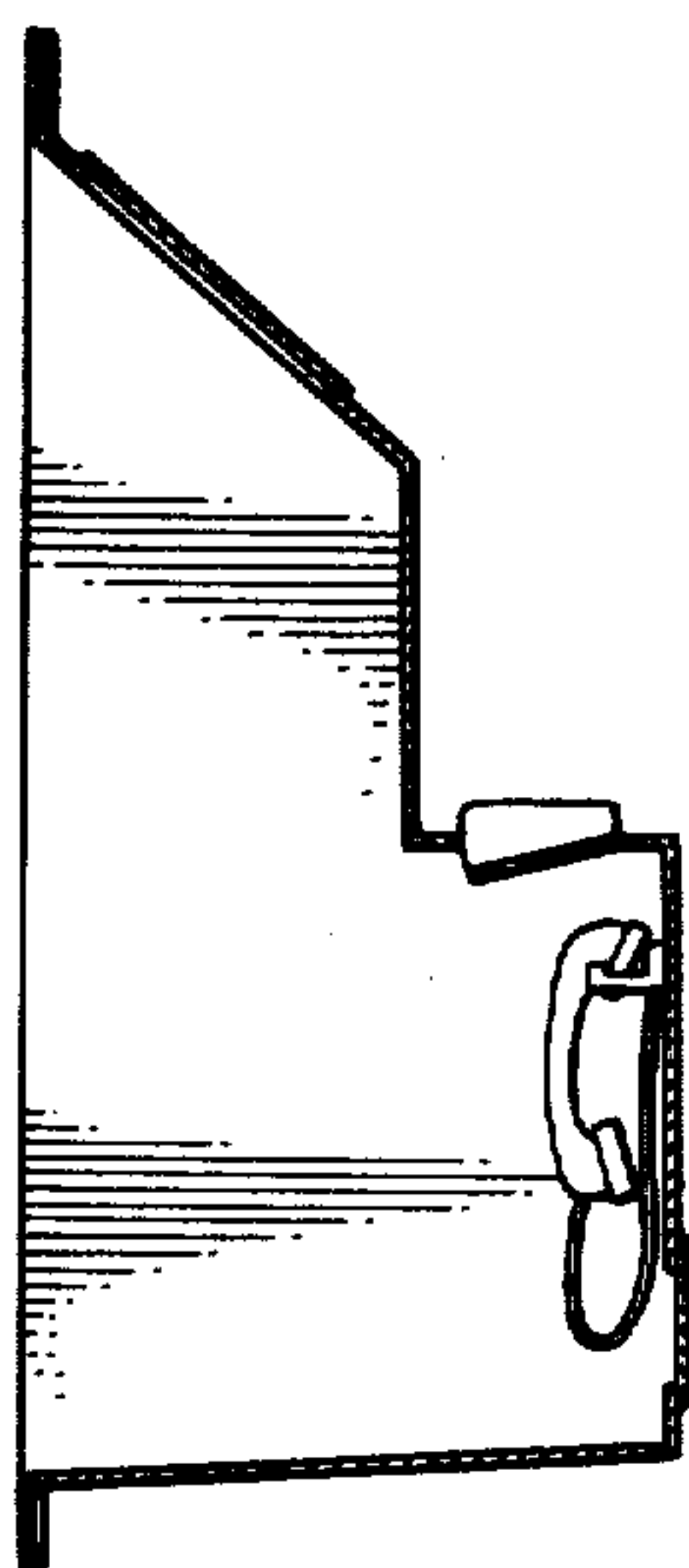

*FIG. 13.*

