

[54] CONTROL CONSOLE

[75] Inventor: Constantine Vintzel, Brighton, Mich.

[73] Assignee: The Bendix Corporation, Southfield, Mich.

[\*\*] Term: 14 Years

[21] Appl. No.: 252,639

[22] Filed: Apr. 9, 1981

[51] Int. Cl. .... D13-03

[52] U.S. Cl. .... D13/40

[58] Field of Search ..... D13/12, 32, 40, 41; D14/100, 102, 103, 106, 107, 114, 115; 361/331, 332, 334, 346, 380, 381, 384, 390-395, 399; 174/50, 52

[56] References Cited

U.S. PATENT DOCUMENTS

- D. 197,229 12/1963 Michael ..... D13/12
- D. 254,613 4/1980 Ault ..... D13/12
- 3,137,212 6/1964 Rose ..... 361/392 X

Primary Examiner—Susan J. Lucas  
Attorney, Agent, or Firm—Markell Seitzman; Russel C. Wells

[57] CLAIM

The ornamental design for a control console, substantially shown and described.

DESCRIPTION

FIG. 1 is a front perspective view of a control console embodying my design.

FIG. 2 is a rear perspective view of the control console.

FIG. 3 is a top view of the control console.

FIG. 4 is a front view of the control console.

FIG. 5 is a bottom view of the control console.

FIG. 6 is a right side view of the control console.

FIG. 7 is a left side view of the control console.

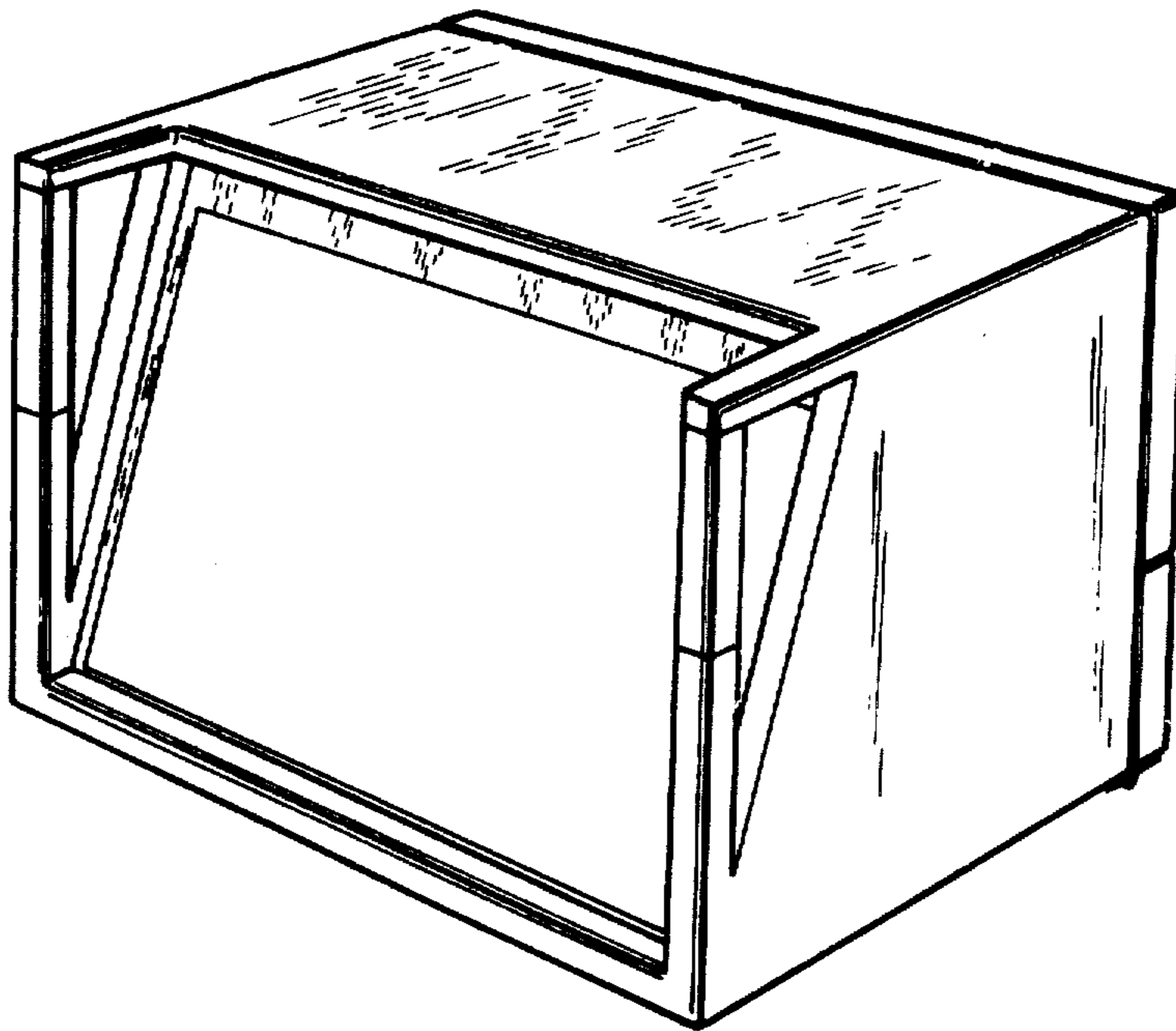

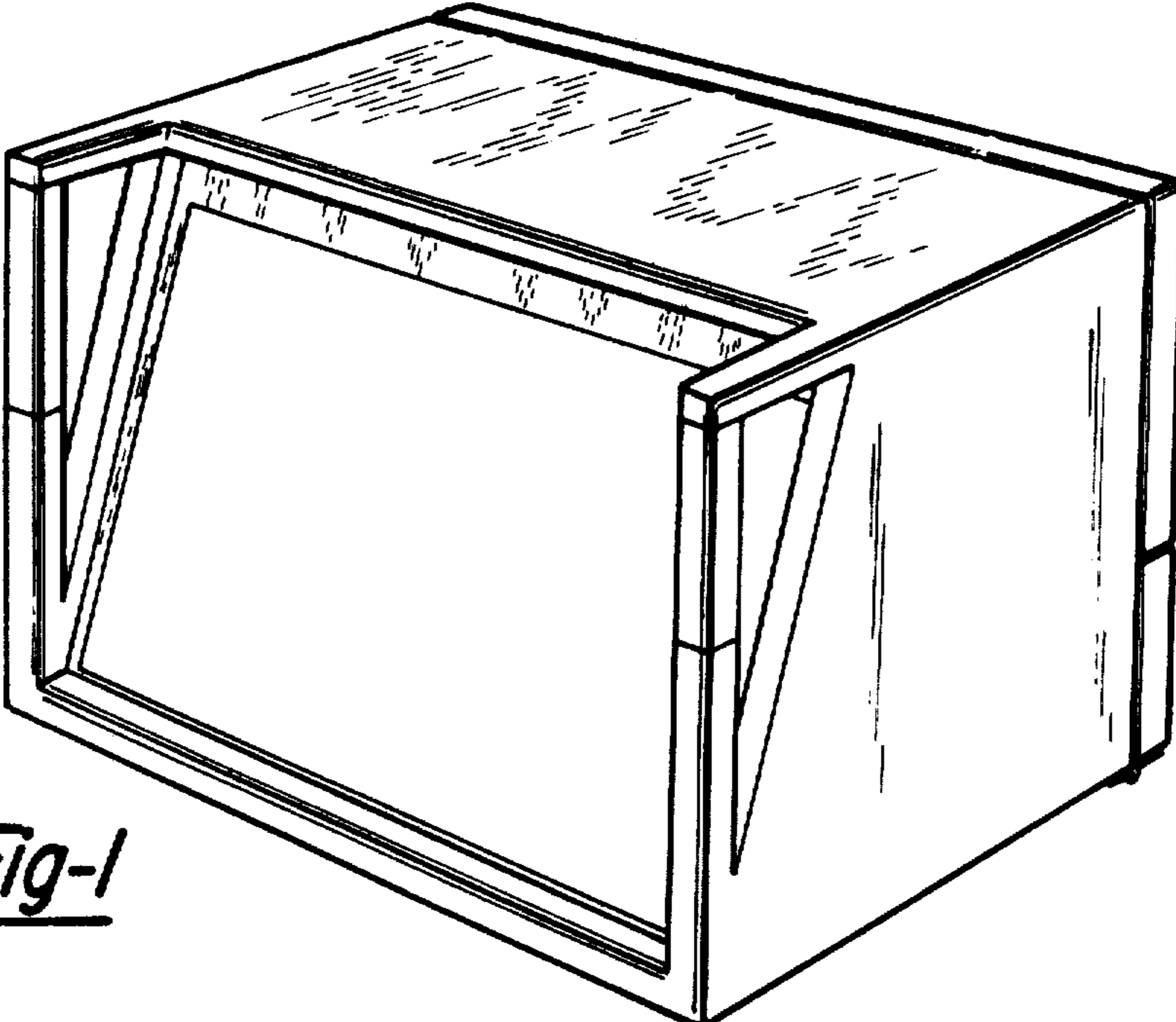

Fig-1

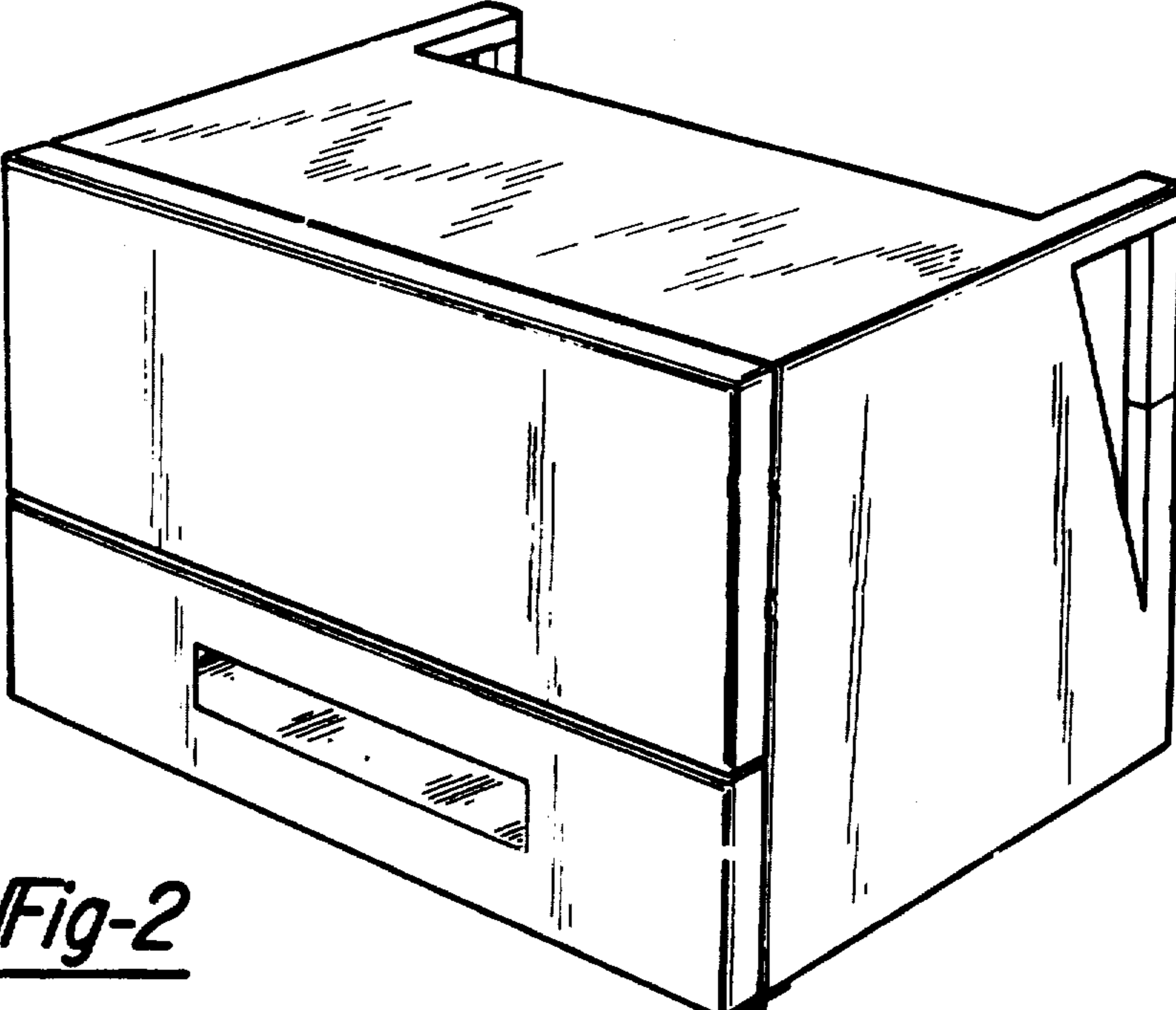

Fig-2

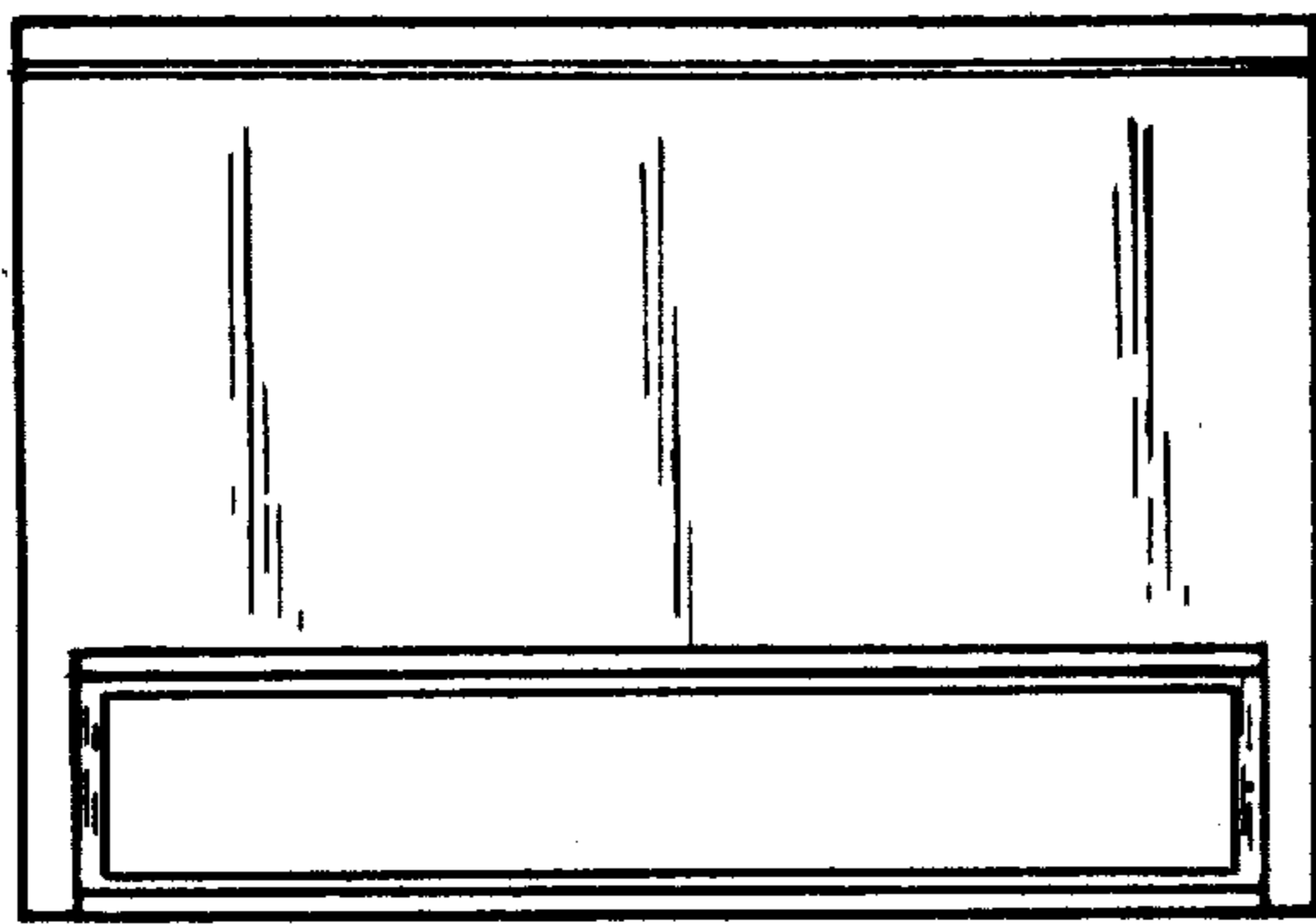

Fig-3

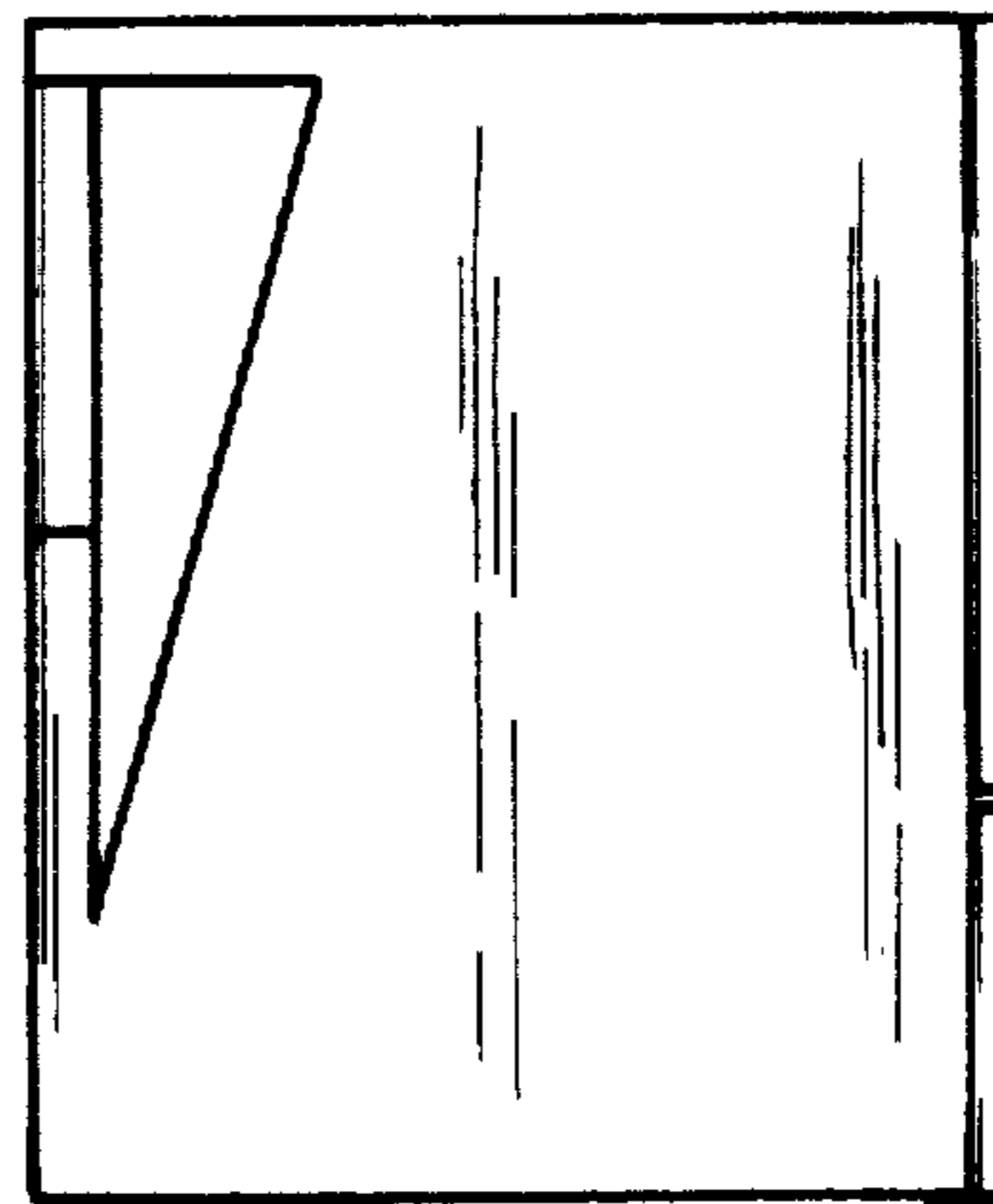

Fig-6

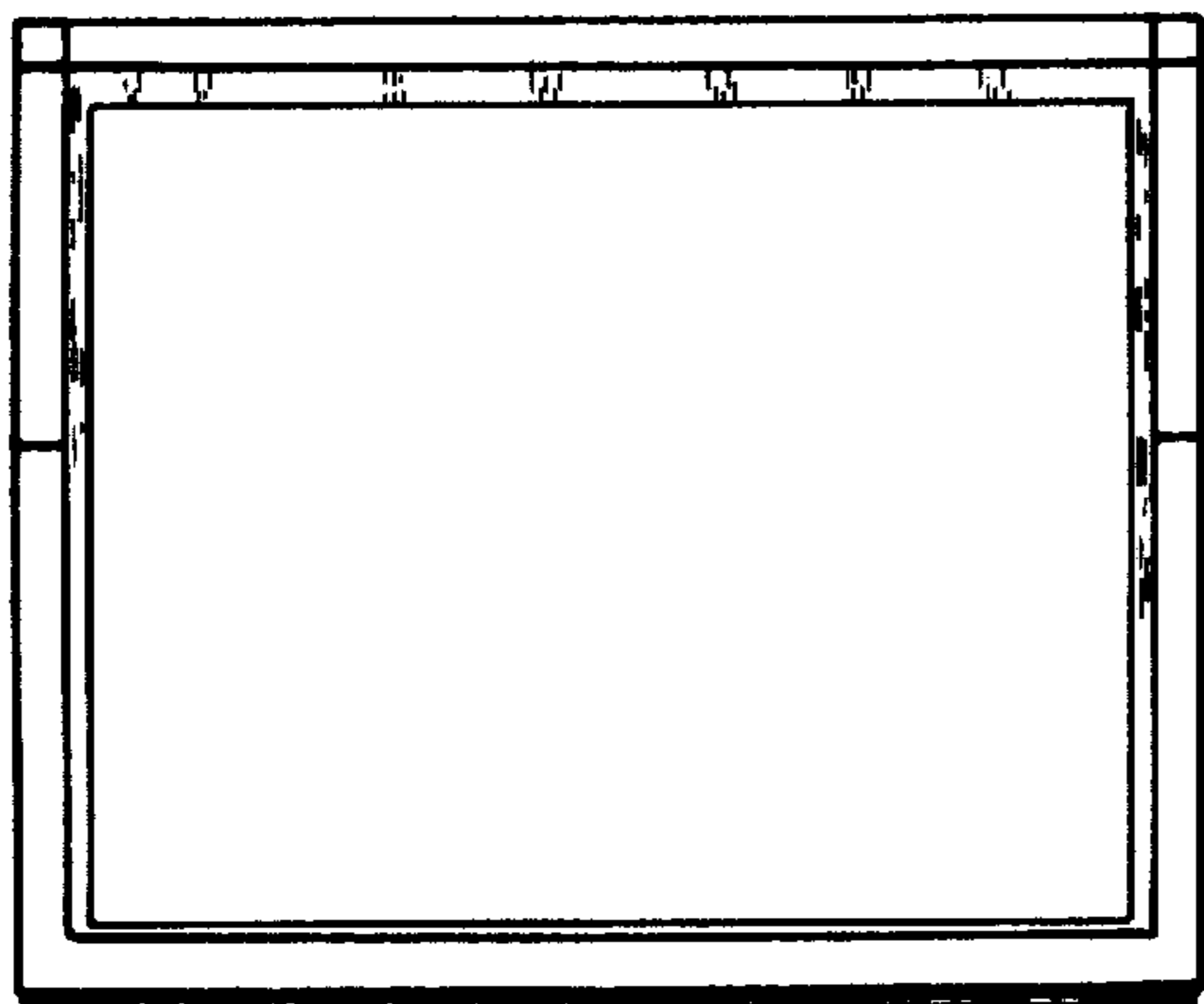

Fig-4

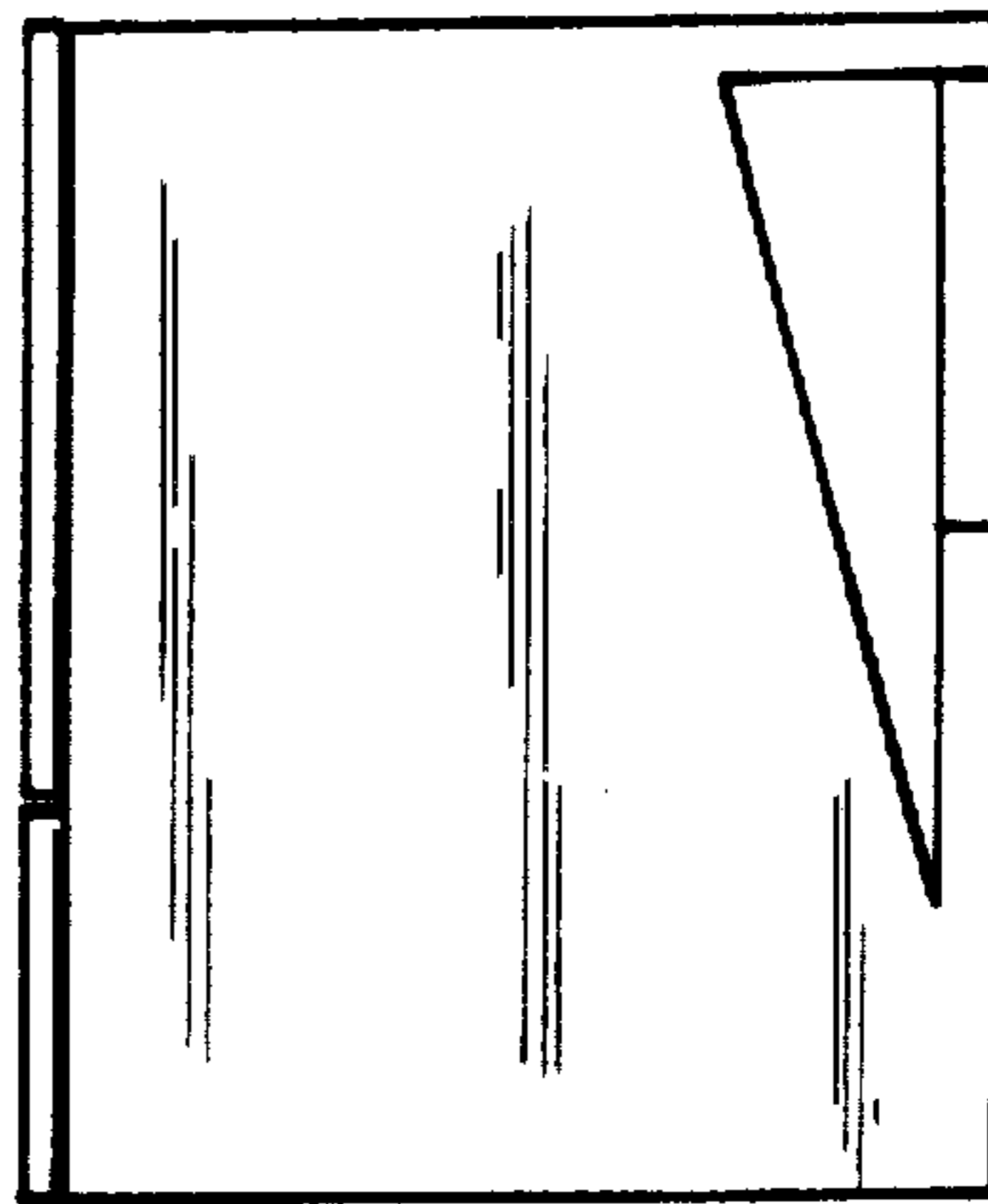

Fig-7

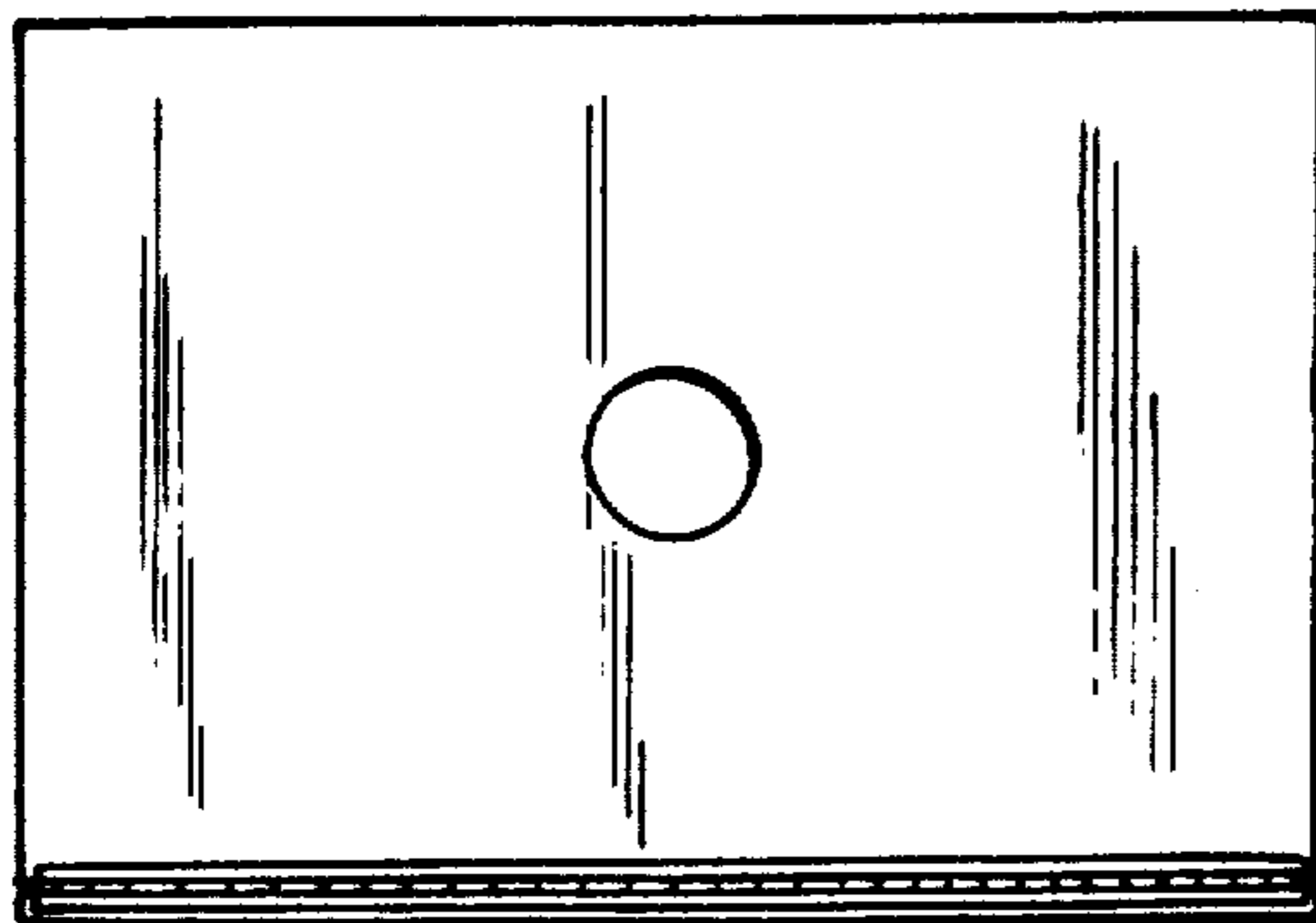

Fig-5