

[54] **DRILLING ALIGNMENT TOOL**

[76] Inventor: **Herbert C. Schulze**, P.O. Box 6070,
Incline Village, Nev. 89450

[**] Term: **14 Years**

[21] Appl. No.: **922,152**

[22] Filed: **Jul. 5, 1978**

[51] Int. Cl. **D8—01**

[52] U.S. Cl. **D8/70**

[58] Field of Search **D8/70; 408/56, 76, 84,**
408/111

3,336,611 8/1967 Schepp D8/70

3,827,822 8/1974 Converse D8/70

3,907,452 9/1975 Tripp 408/56

Primary Examiner—Sam Rosen

[57] **CLAIM**

The ornamental design for a drilling alignment tool, as shown and described.

DESCRIPTION

FIG. 1 is a perspective view from the left upper side of the drilling alignment tool;

FIG. 2 is a perspective view from the right lower side thereof; and

FIG. 3 is an exploded view of the elements thereof.

The drill is partially shown in the views in broken lines for illustrative purposes only and does not form a part of the claimed design.

[56] **References Cited**

U.S. PATENT DOCUMENTS

1,994,516 3/1935 Hawn 408/56

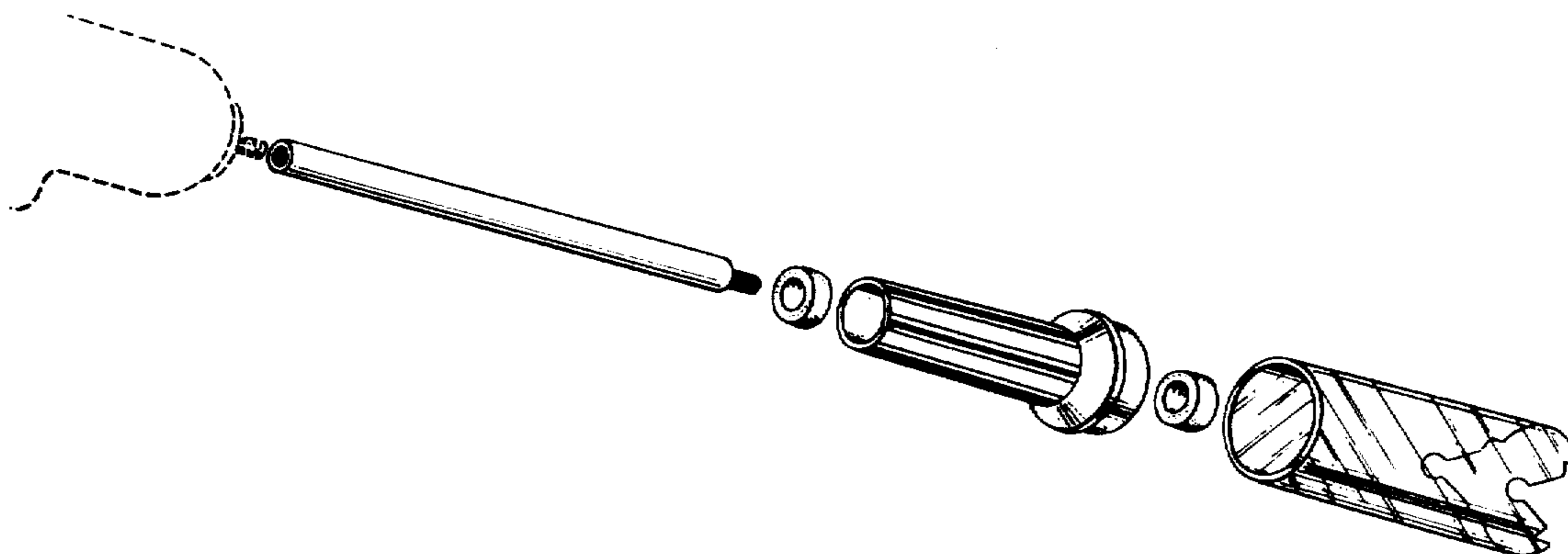

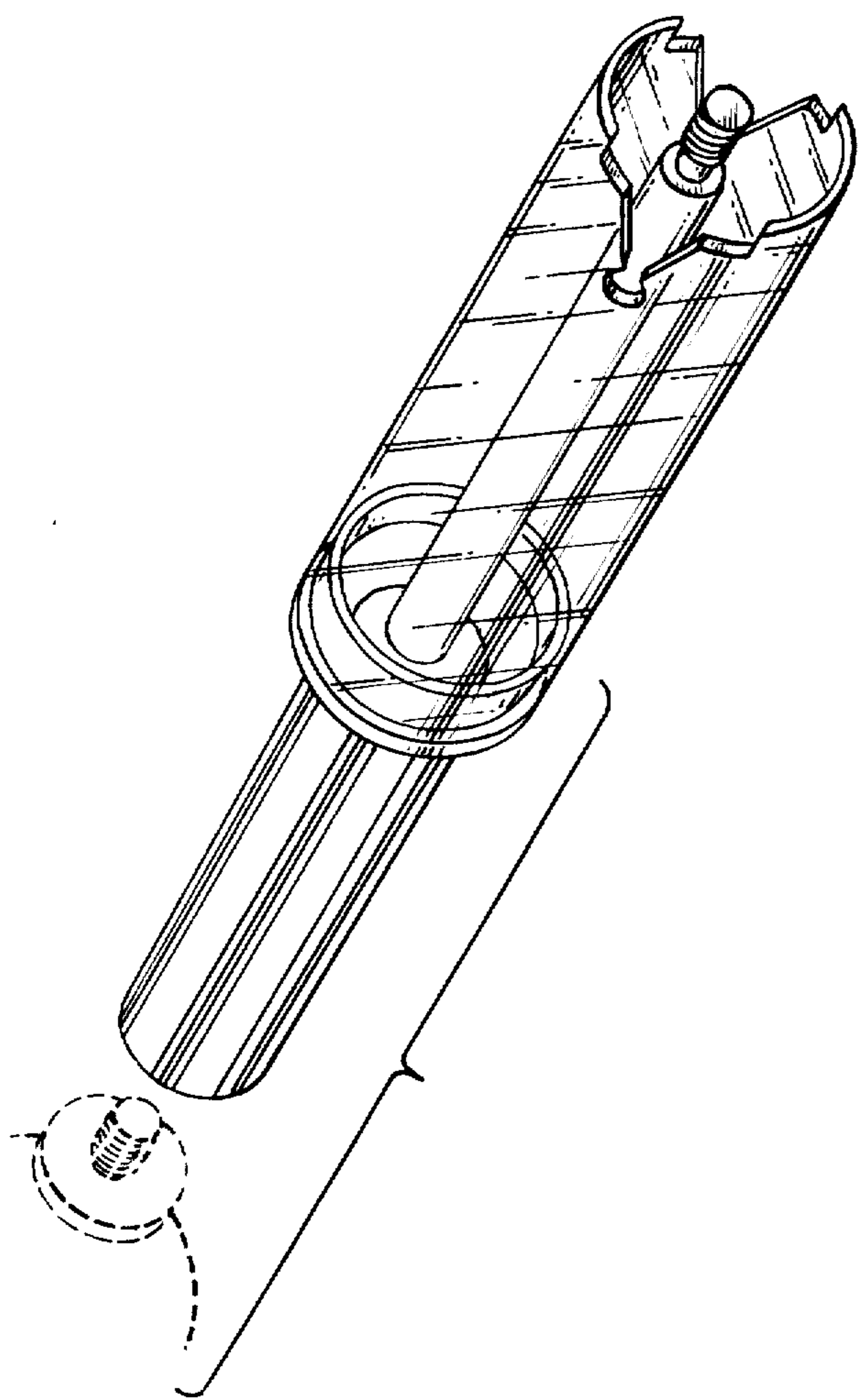

FIG. 1.

FIG. 2.

