

[54] **COMBINED CAT PLAYGROUND AND EXERCISER**

[75] Inventor: **Robert J. Michalski, Paramus, N.J.**
[73] Assignee: **Abeta Pet Supply, Inc., Dumont, N.J.**
[**] Term: **14 Years**
[21] Appl. No.: **168,161**
[22] Filed: **Jul. 14, 1980**

Related U.S. Application Data

[62] Division of Ser. No. 5,695, Jan. 23, 1979.

[51] Int. Cl. **D30—99**
[52] U.S. Cl. **D30/42**
[58] Field of Search **D30/1-3,**
D30/41, 42, 99; 119/1, 29

[56] **References Cited**

U.S. PATENT DOCUMENTS

D. 77,297 12/1928 Cuff D21/119
D. 209,042 10/1967 Harum D30/1
D. 220,843 6/1971 Cook D30/1
D. 224,685 8/1972 Michlap D30/1
D. 224,686 8/1972 Michlap D30/1
D. 233,844 12/1974 Tucker D30/42
D. 236,140 7/1975 Whitlock D30/42
2,096,078 10/1937 Windson 119/29
3,581,707 6/1971 Cook 119/1
4,112,873 9/1978 Van Zandt 119/29

Primary Examiner—James R. Largen
Attorney, Agent, or Firm—Samuelson & Jacob

[57] **CLAIM**

The ornamental design for a combined cat playground and exerciser, substantially as shown.

DESCRIPTION

FIG. 1 is a front perspective view of a combined cat playground and exerciser showing my new design; FIG. 2 is a rear perspective view thereof; and FIG. 3 is a top plan view thereof.

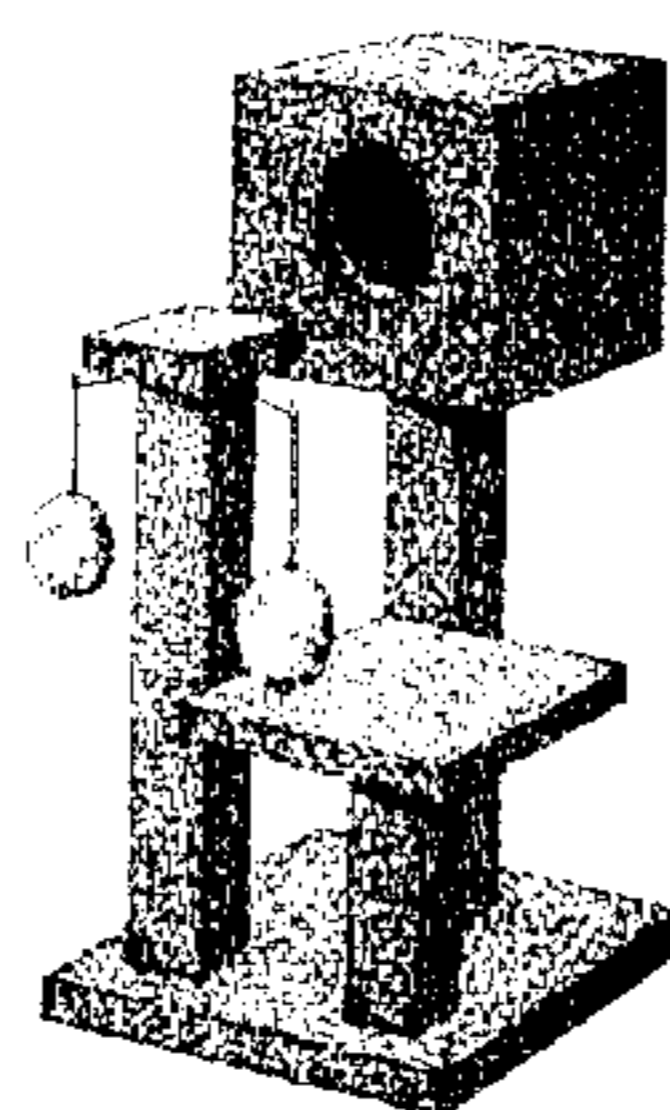

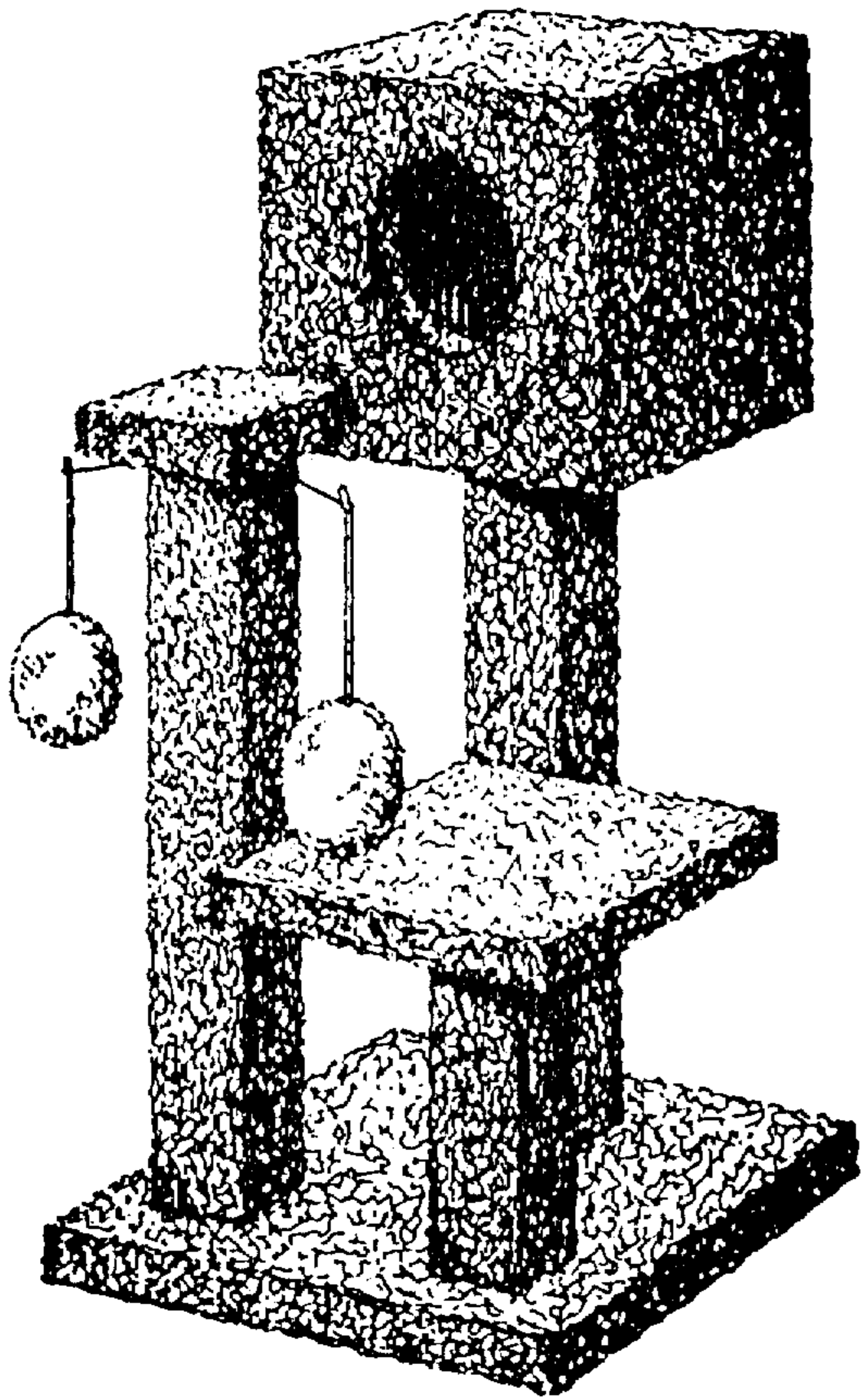

FIG. 1

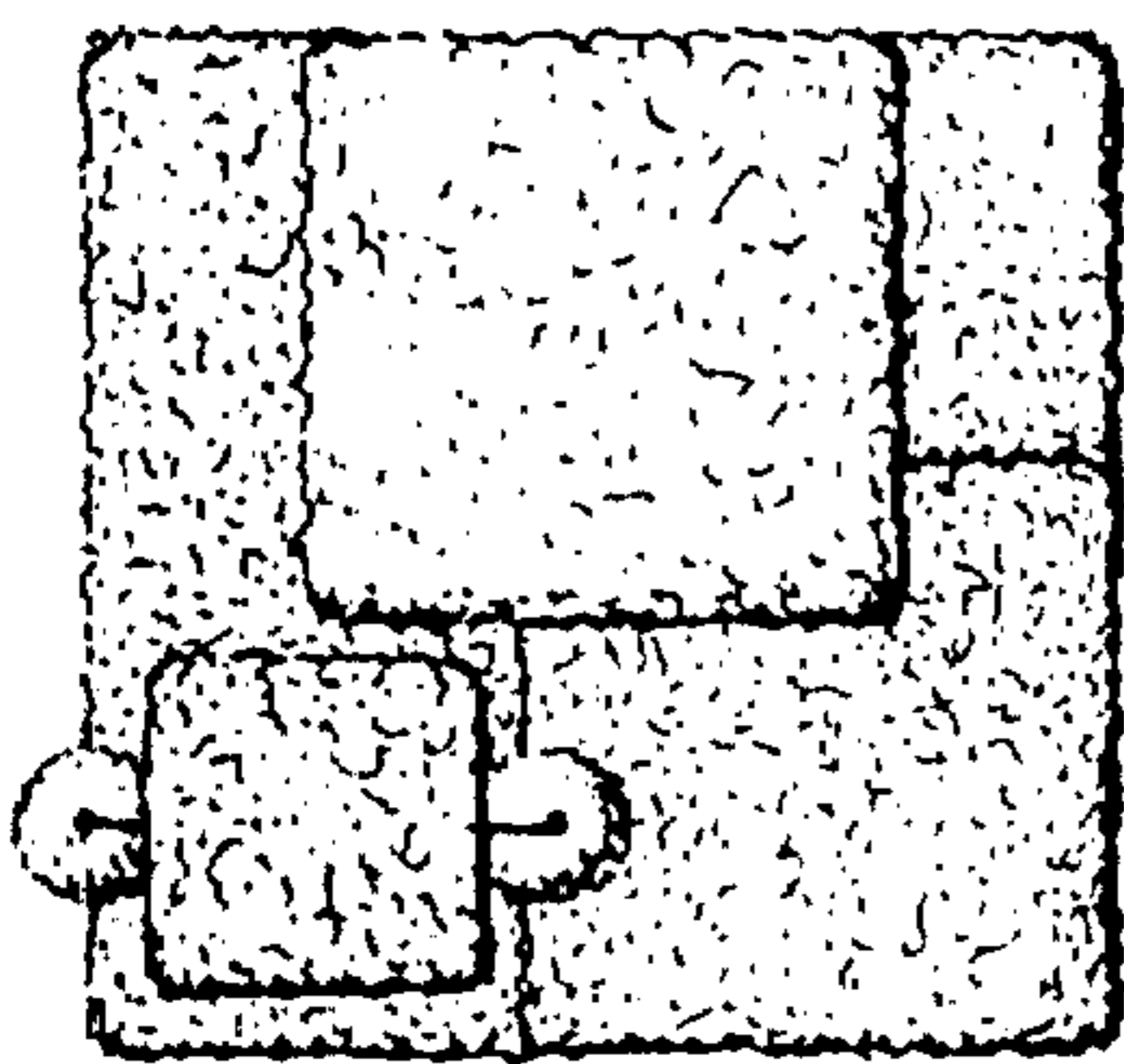

FIG. 3

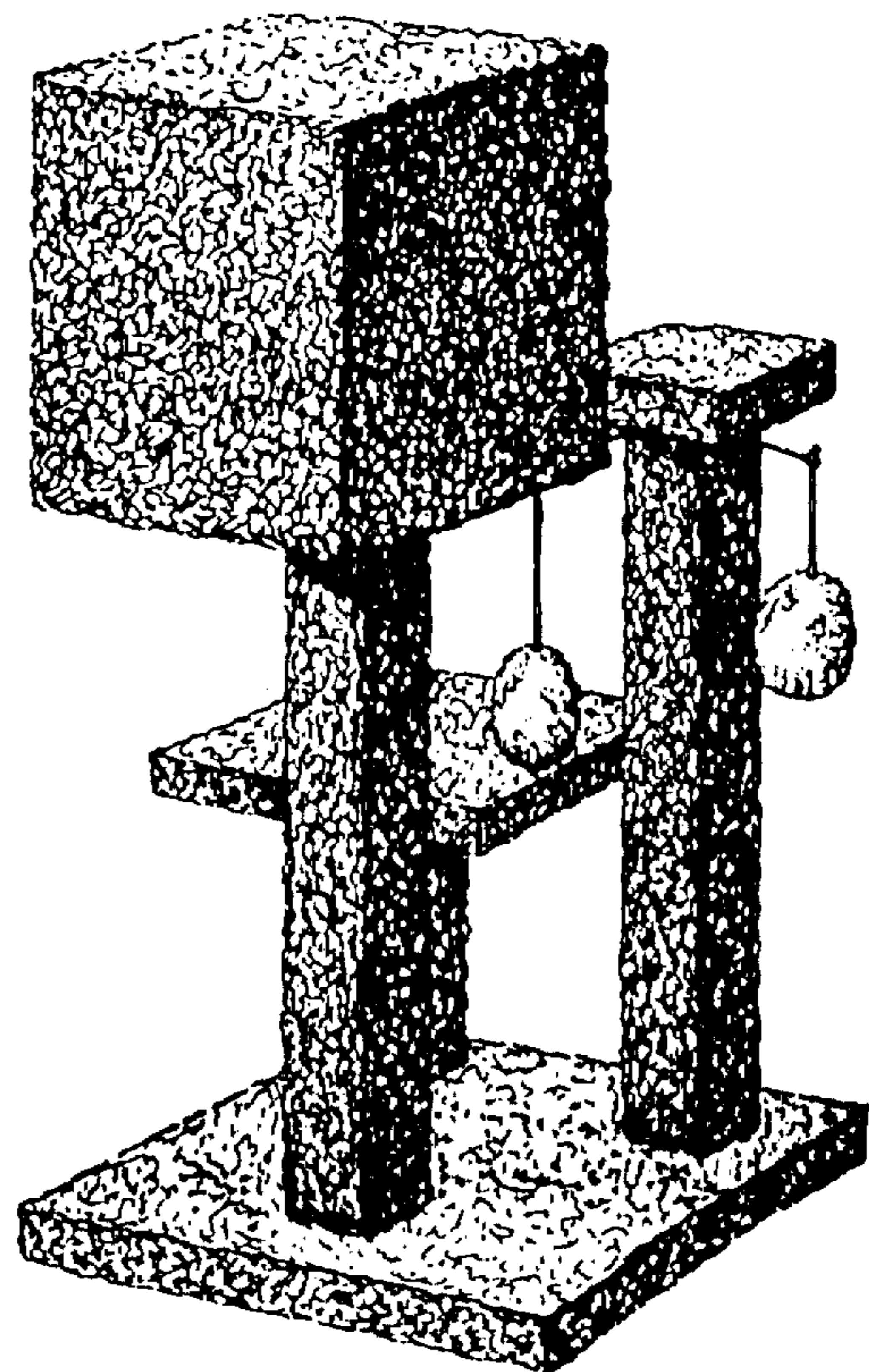

FIG. 2