

[54] LAVATORY FIXTURE UNIT

[75] Inventor: Gilles Thévenot, Baden-Baden, Fed. Rep. of Germany

[73] Assignee: Friedrich Grohe Armaturenfabrik GmbH & Co., Fed. Rep. of Germany

[**] Term: 14 Years

[21] Appl. No.: 59,506

[22] Filed: Jul. 23, 1979

[51] Int. Cl. D23—01

[52] U.S. Cl. D23/25

[58] Field of Search D23/23-33

[56] References Cited

U.S. PATENT DOCUMENTS

D. 190,711	6/1961	Kohler	D23/26
D. 237,613	11/1975	Saporito	D23/25
D. 237,614	11/1975	Saporito	D23/25

OTHER PUBLICATIONS

Domestic Engineering, May 1962, p. 57.
Kohler Co. Catalog K56, ©1958, inside front cover, lower right item.

Primary Examiner—James R. Largent
Attorney, Agent, or Firm—James B. Raden

[57] CLAIM

The ornamental design for a lavatory fixture unit, substantially as shown and described.

DESCRIPTION

FIG. 1 is a front perspective view of a lavatory fixture unit showing my new design;
FIG. 2 is a side view thereof;
FIG. 3 is a rear view thereof; and
FIG. 4 is a bottom plan view thereof.

The broken line representation of a portion of counter top in FIGS. 1 through 4 is for purposes of illustration only.

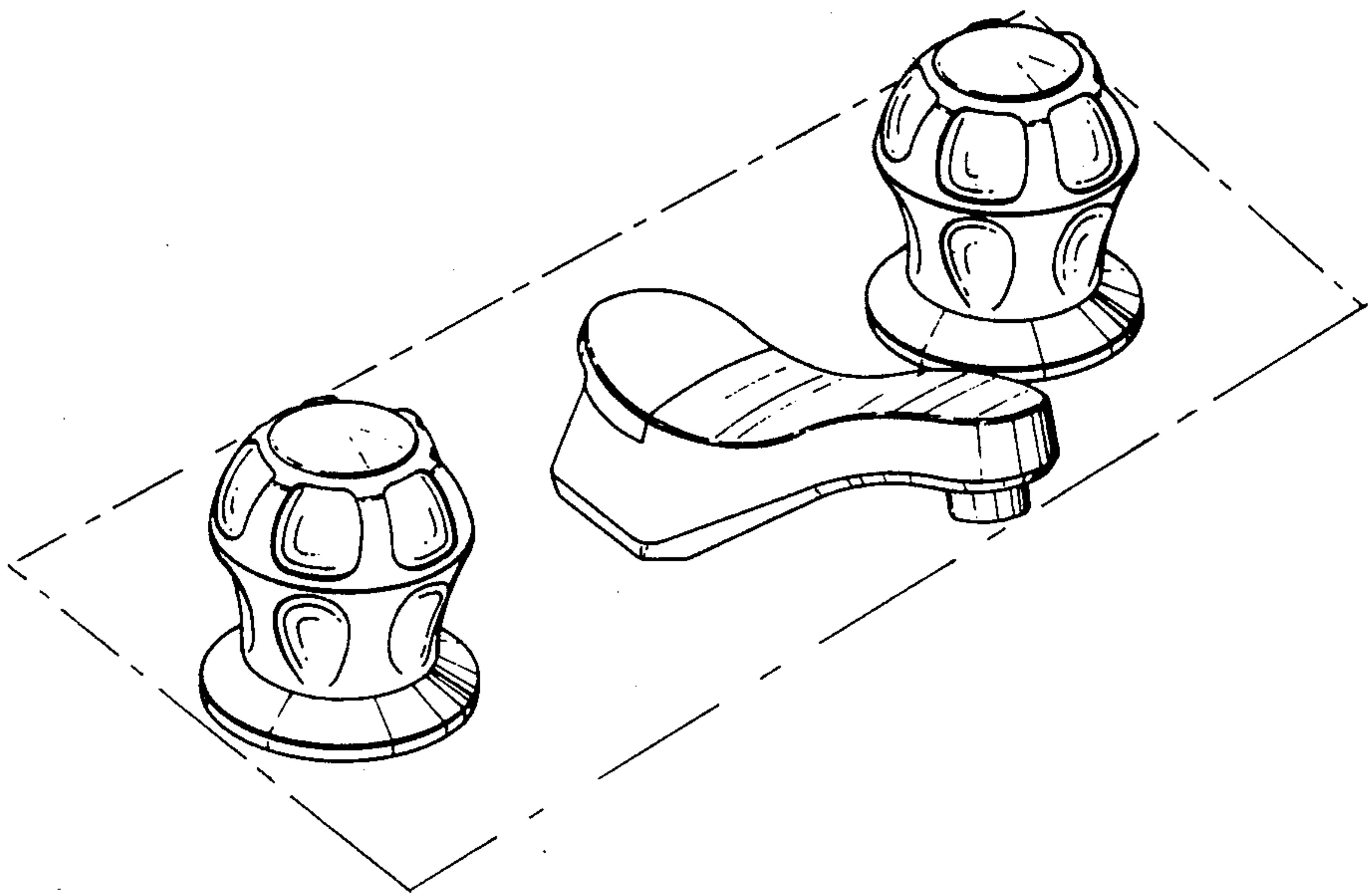

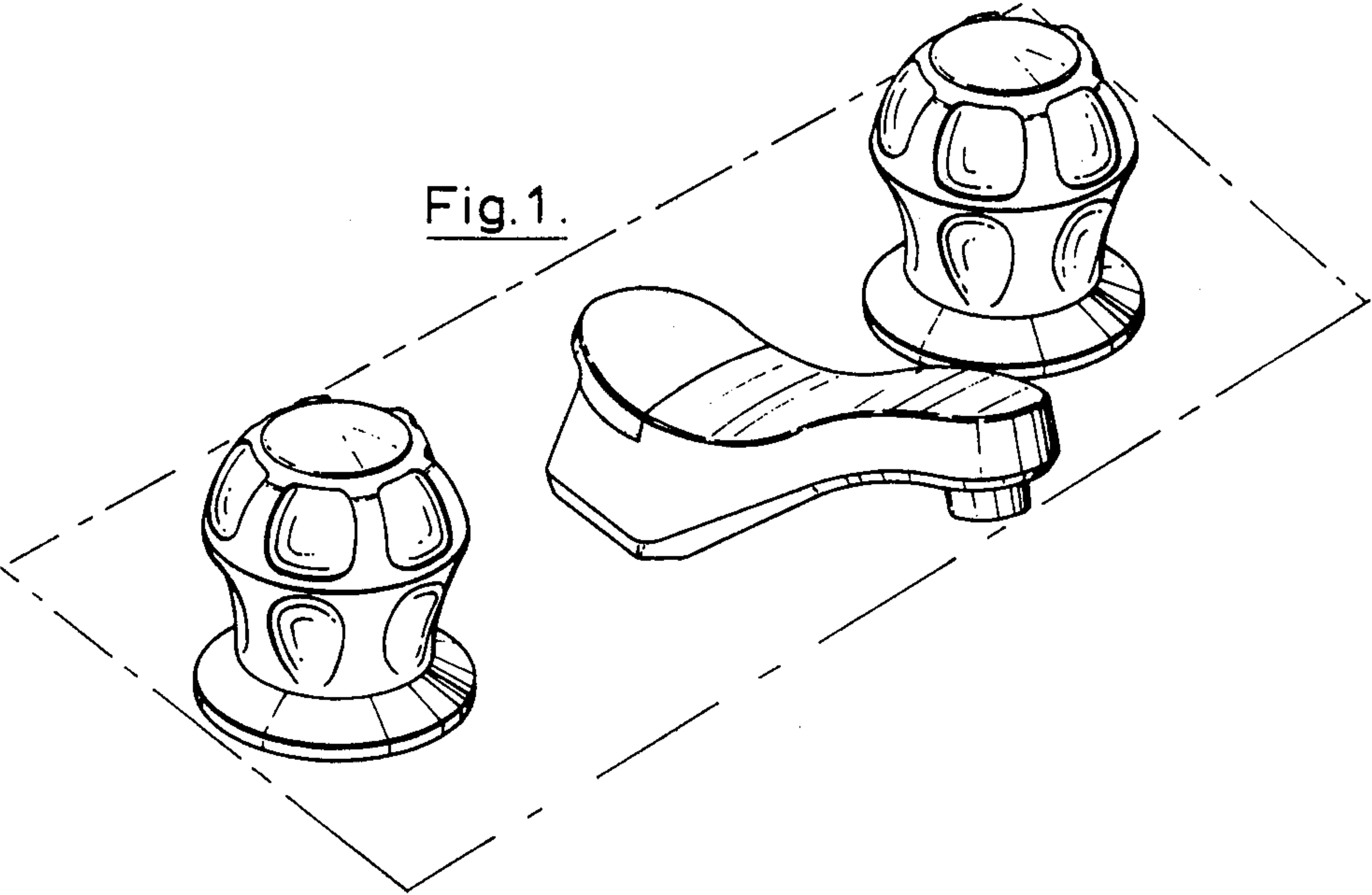

Fig.2.

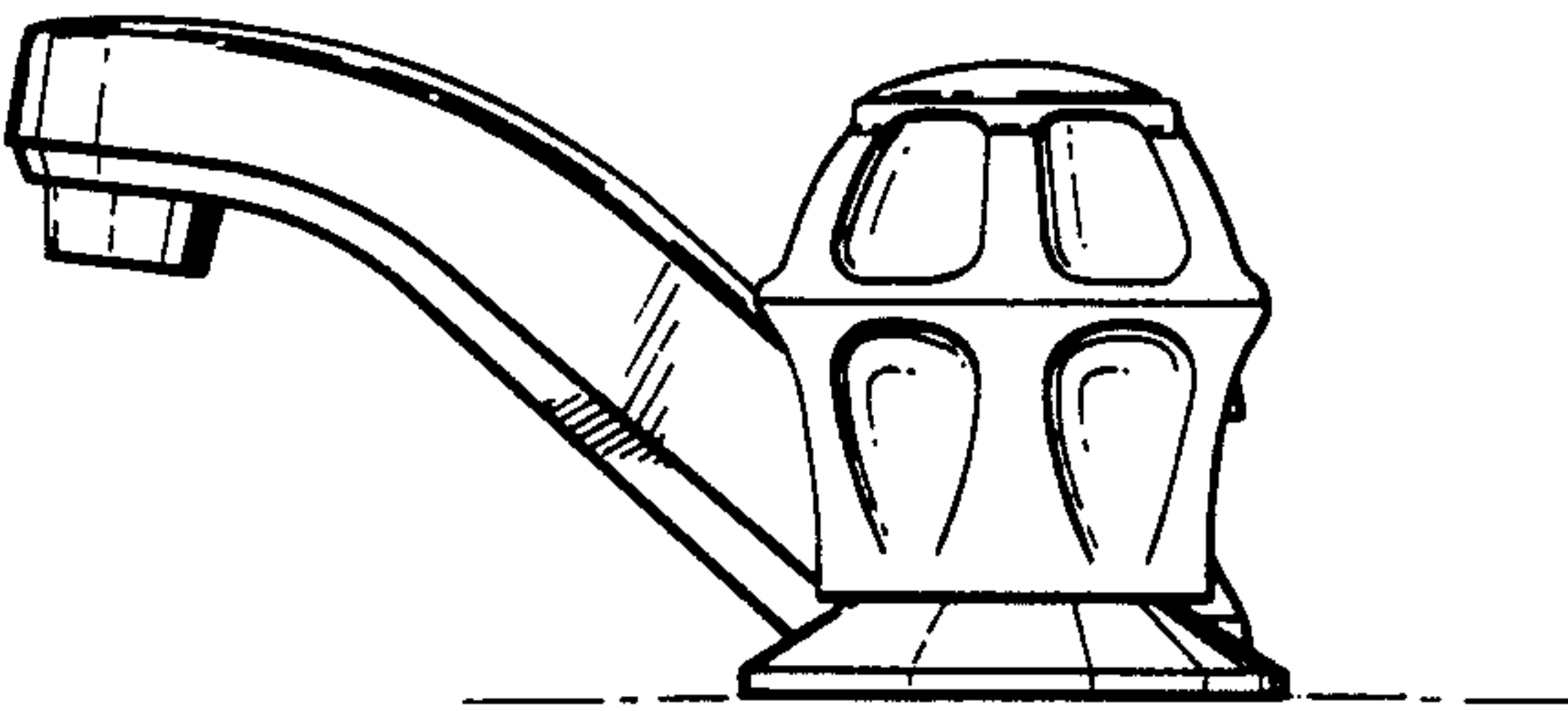

Fig. 3.

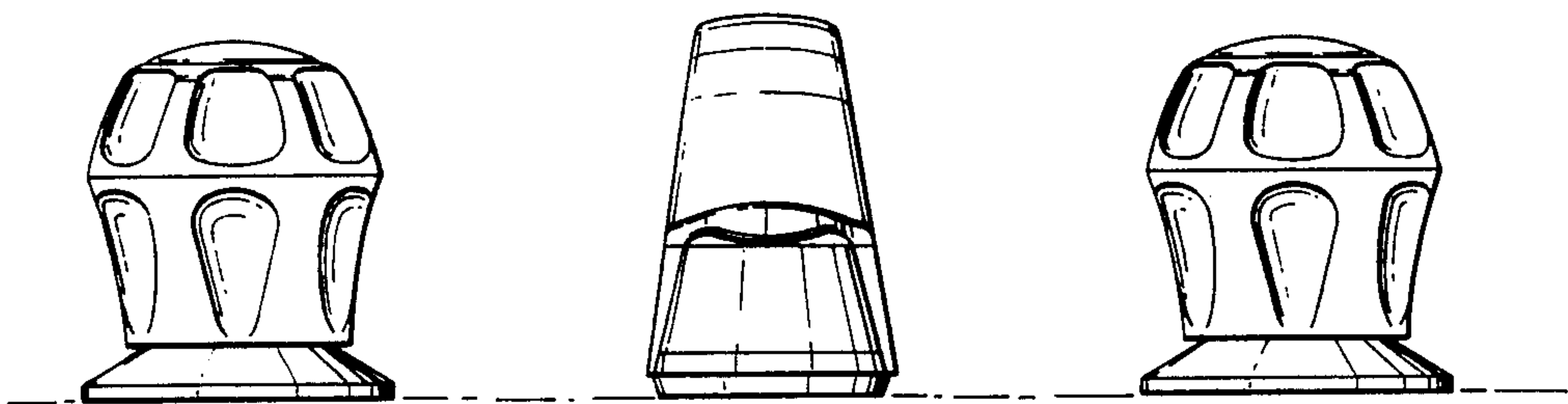
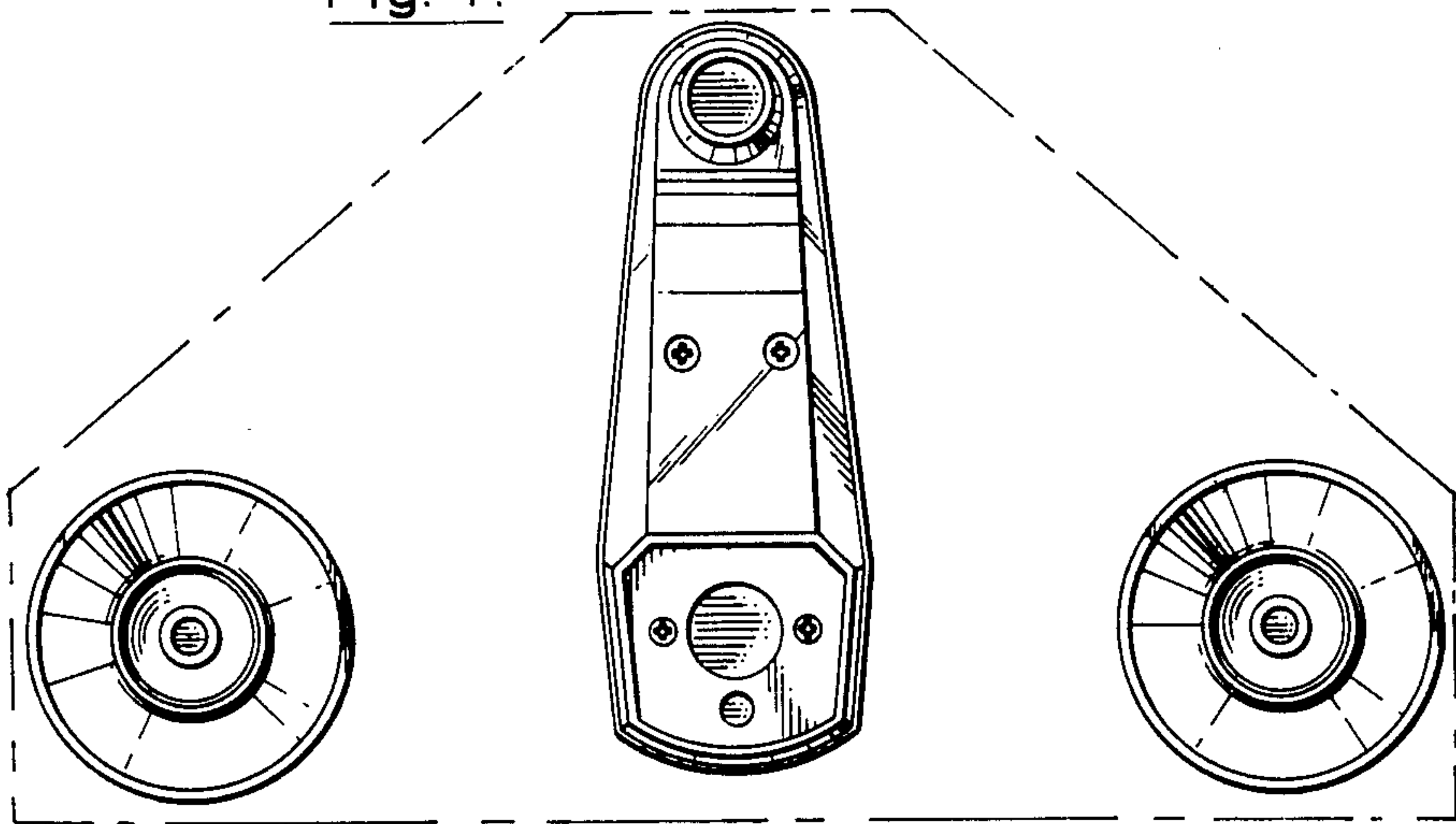

Fig. 4.



UNITED STATES PATENT AND TRADEMARK OFFICE
CERTIFICATE OF CORRECTION

PATENT NO. : Des 258,522

DATED : March 10, 1981

INVENTOR(S) : Gilles Thevenot

It is certified that error appears in the above-identified patent and that said Letters Patent is hereby corrected as shown below:

On the Title page Insert:

--**[30]** Foreign Application Priority Data

January 24, 1979 Fed. Rep. of Germany.....MR 6903--.

Signed and Sealed this

Third Day of August 1982

[SEAL]

Attest:

GERALD J. MOSSINGHOFF

Attesting Officer

Commissioner of Patents and Trademarks