

[54] TOY STORE

[76] Inventor: Wilma I. Johnson, 692 Palisade St., Pasadena, Calif. 91103

[**] Term: 14 Years

[21] Appl. No.: 742,861

[22] Filed: Nov. 18, 1976

[51] Int. Cl. D21-01

[52] U.S. Cl. D21/114

[58] Field of Search D34/15 LL, 11 A; 46/11, 46/12; D25/1, 16, 17, 22

[56] References Cited

U.S. PATENT DOCUMENTS

D. 80,409 1/1930 Dillinger D34/15 LL

D. 175,390 8/1955 Buechner D34/15 LL
1,016,208 1/1912 Cass D34/15 LL

Primary Examiner—Bruce W. Dunkins
Assistant Examiner—C. A. Rademaker
Attorney, Agent, or Firm—Robert L. Parker

[57] CLAIM

The ornamental design for a toy store, substantially as shown and described.

DESCRIPTION

FIG. 1 is a perspective view of a toy store showing my new design;
FIG. 2 is a top plan view thereof;
FIG. 3 is a front elevational view thereof;
FIG. 4 is a rear elevational view thereof; and,
FIG. 5 is a side elevational view thereof.

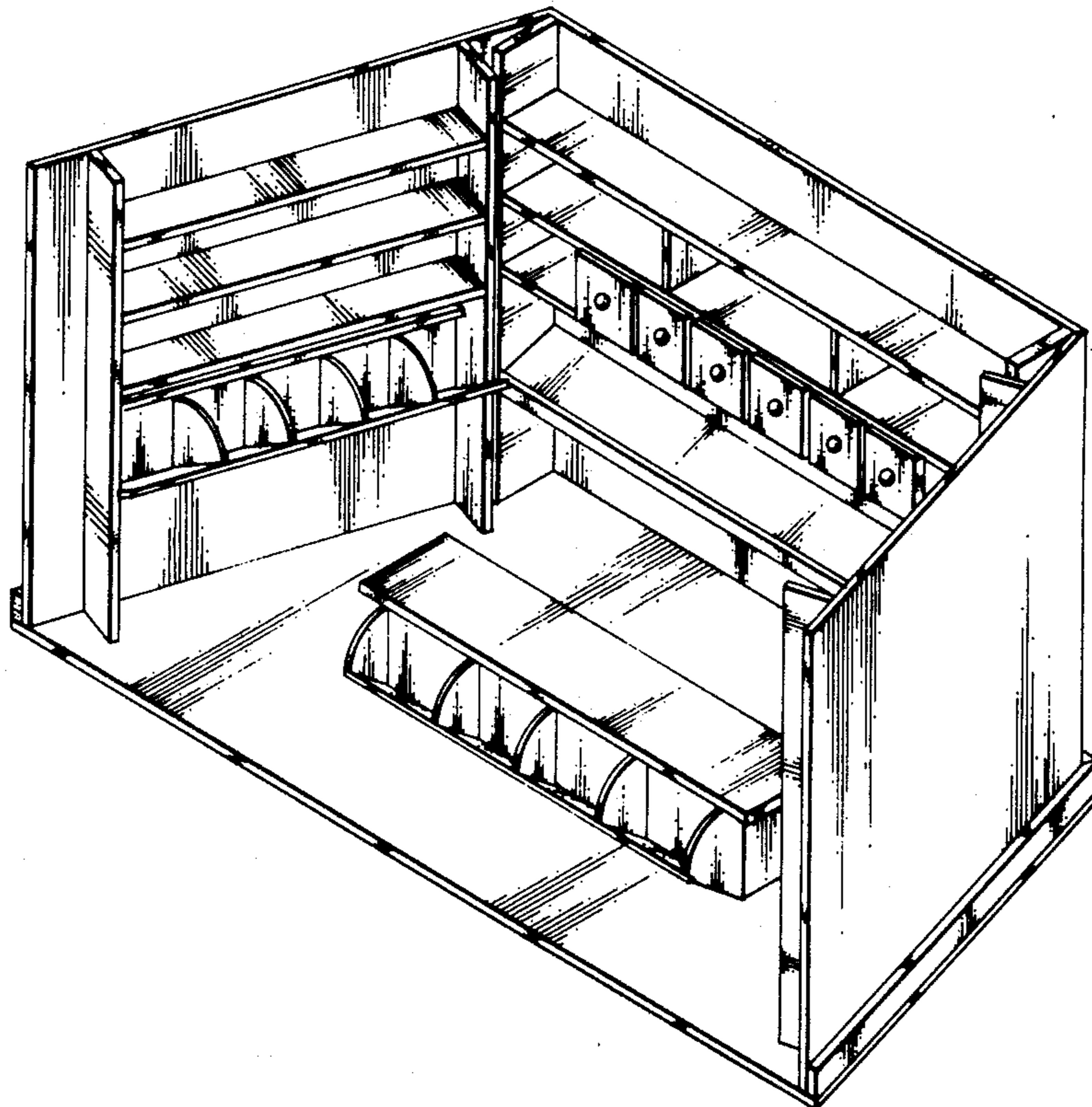
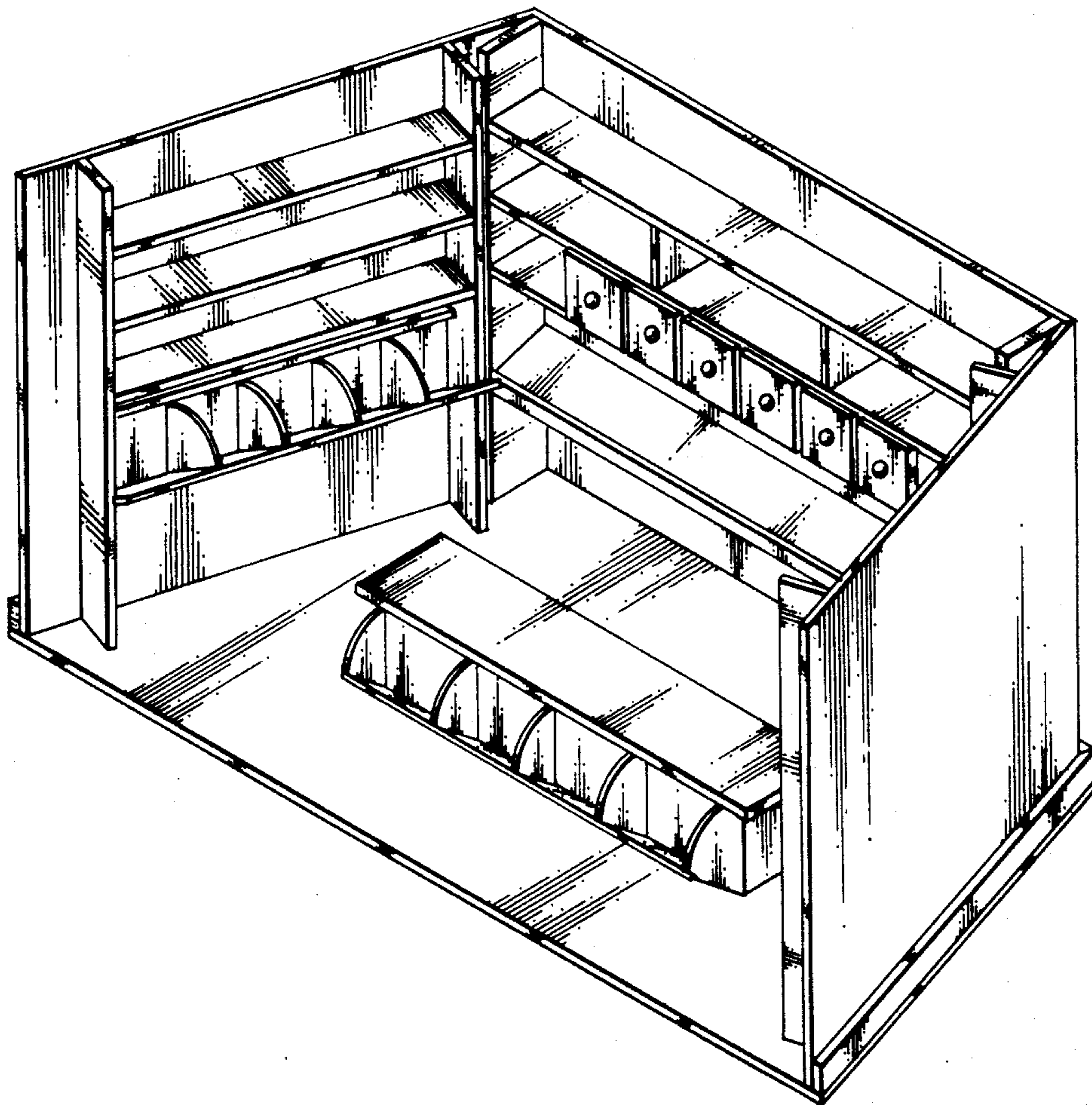

Fig. 1



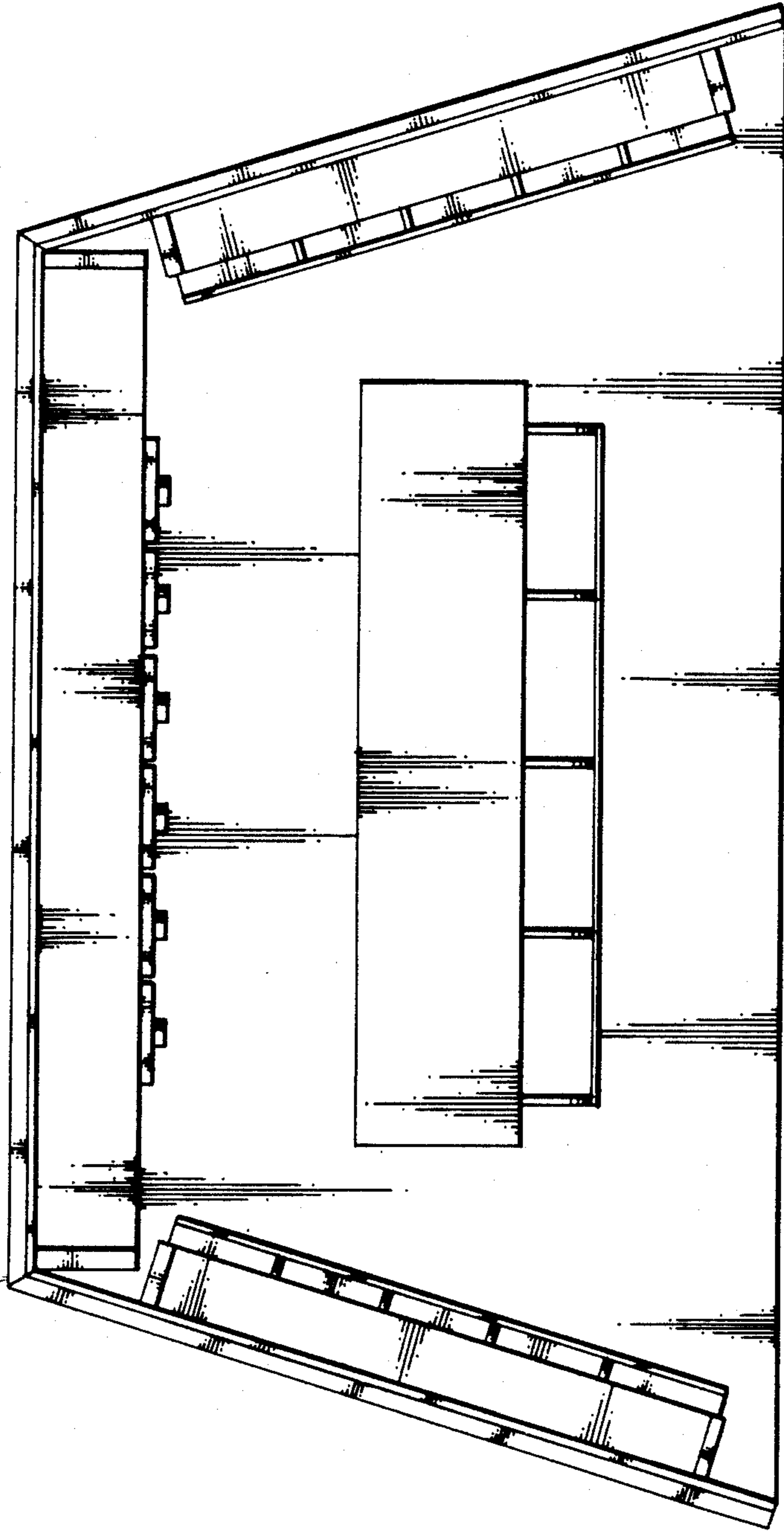

Fig. 2

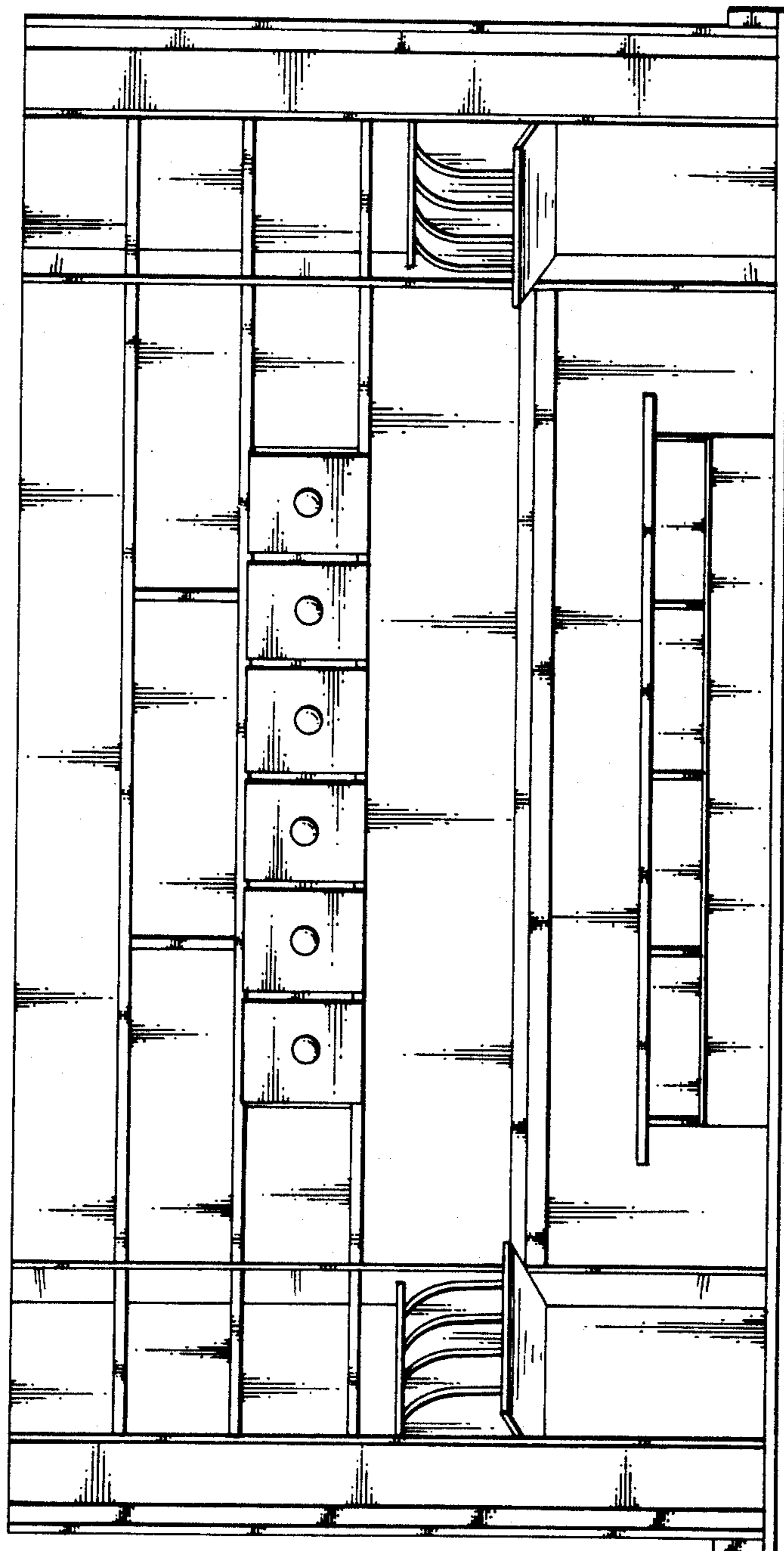

Fig. 3

Fig. 4

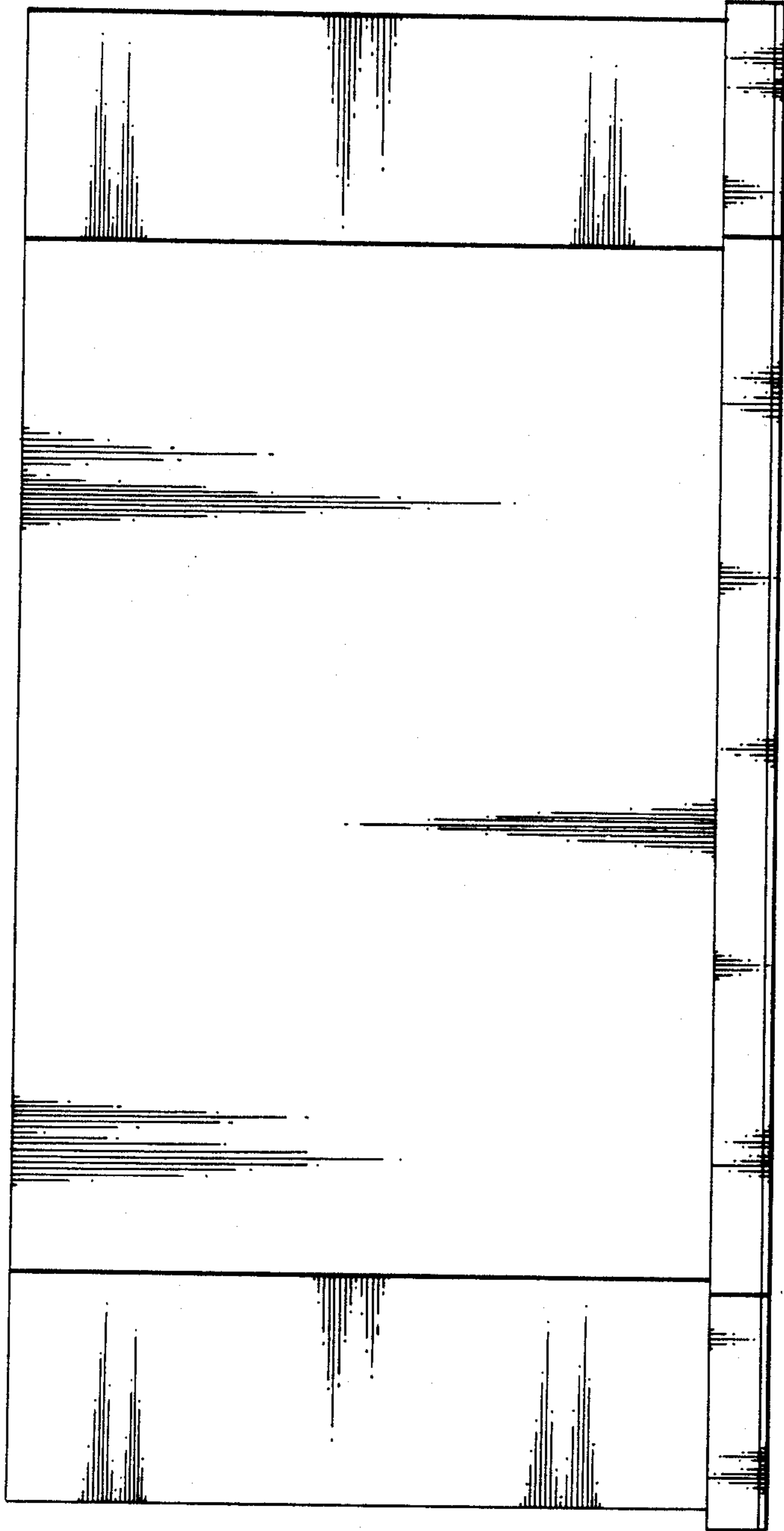

Fig. 5

