

[54] DOLL HOUSE

[76] Inventor: Anthony J. Christ, 3144 Broadmoor Blvd., San Bernadino, Calif. 92404

[\*\*] Term: 14 Years

[21] Appl. No.: 821,428

[22] Filed: Aug. 3, 1977

[51] Int. Cl. .... D21-01

[52] U.S. Cl. .... D21/114

[58] Field of Search ..... D34/15 LL, 11 A; D25/1, D25/17, 22; 46/11, 12, 18, 19

[56] References Cited

U.S. PATENT DOCUMENTS

D. 139,527	11/1944	Olson	.....	D34/15 LL
1,639,934	8/1927	Ferring	.....	D34/15 LL

OTHER PUBLICATIONS

Cherilea Toy Catalog, 1976, p. 18, item 2402, General Store.

Primary Examiner—Bruce W. Dunkins

Assistant Examiner—C. A. Rademaker

Attorney, Agent, or Firm—B. G. Nilsson

[57] CLAIM

The ornamental design for a doll house, substantially as shown and described.

DESCRIPTION

FIG. 1 is a front elevational view of a doll house showing my new design;

FIG. 2 is a side elevational view thereof;

FIG. 3 is a top plan view thereof; and,

FIG. 4 is a rear elevational view thereof.

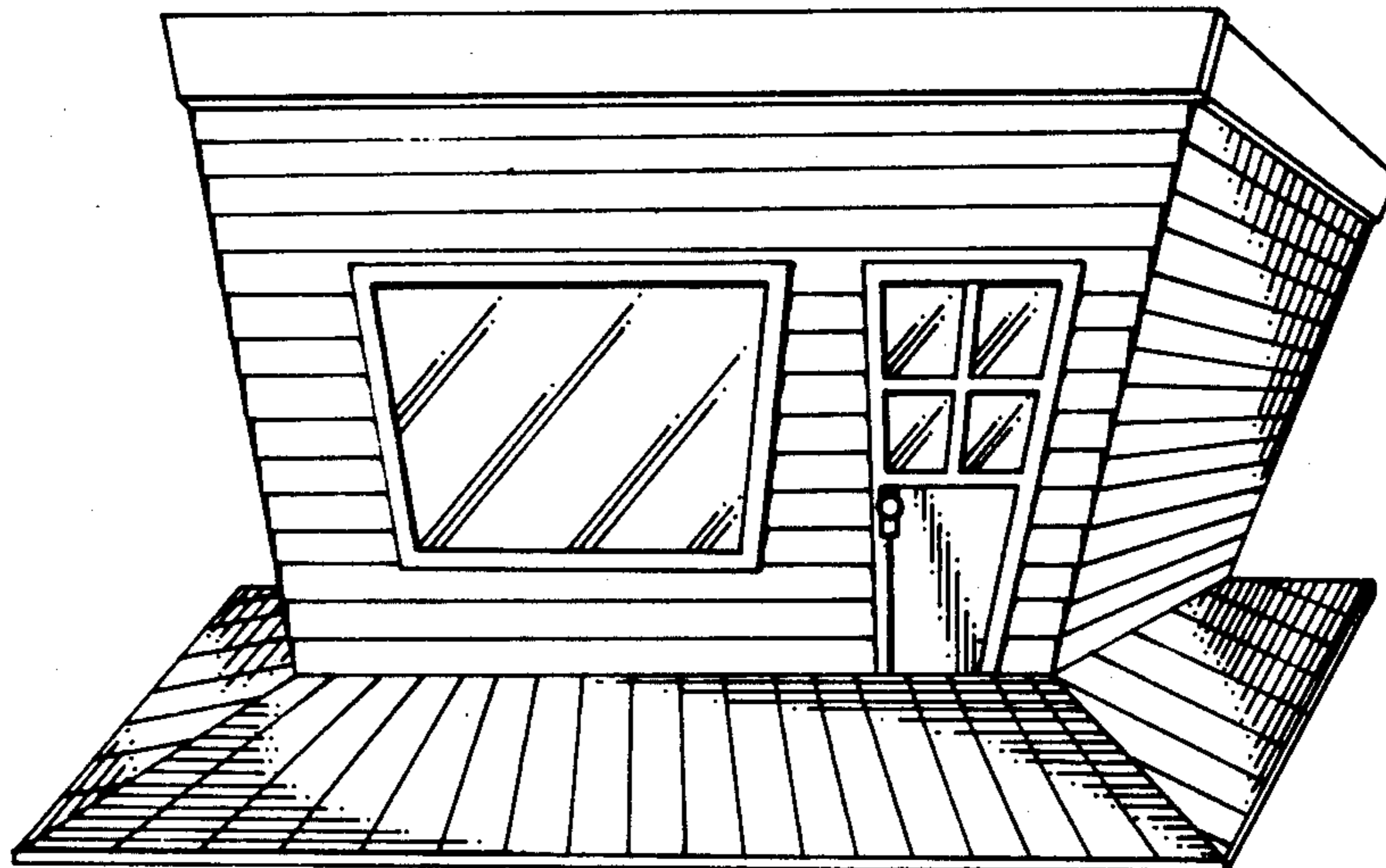

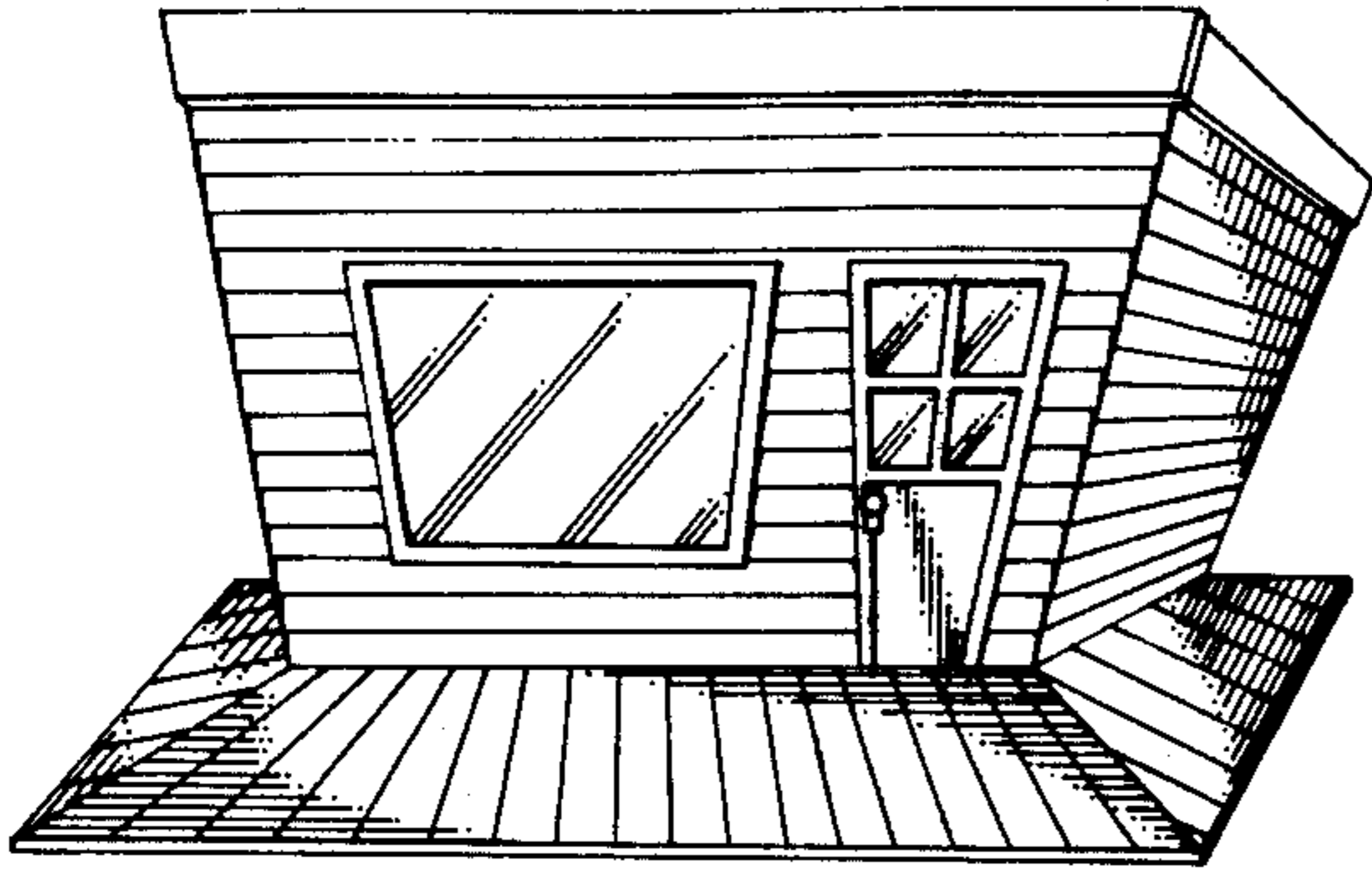

FIG. 1

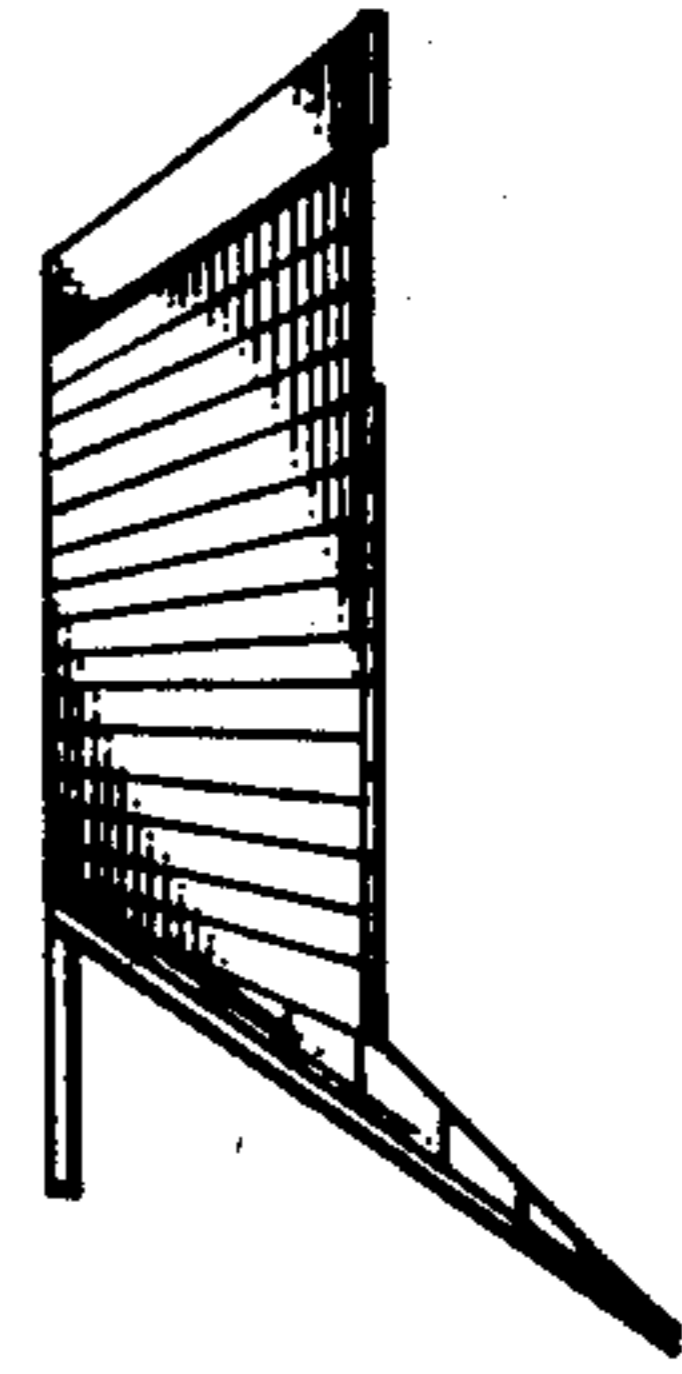

FIG. 2

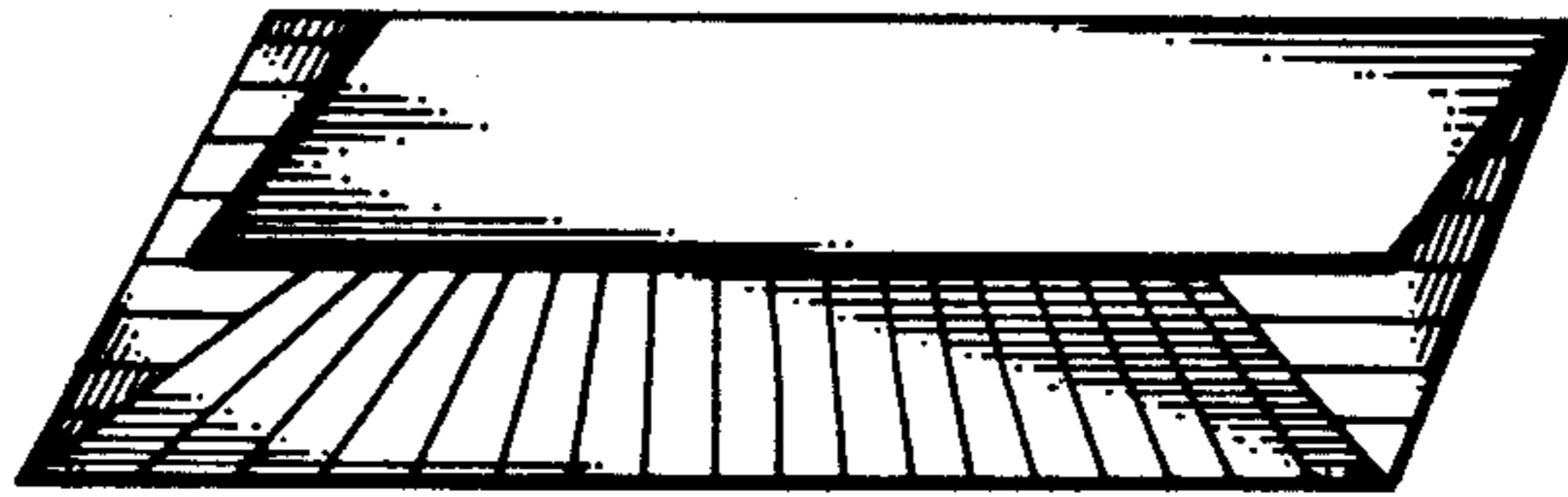

FIG. 3

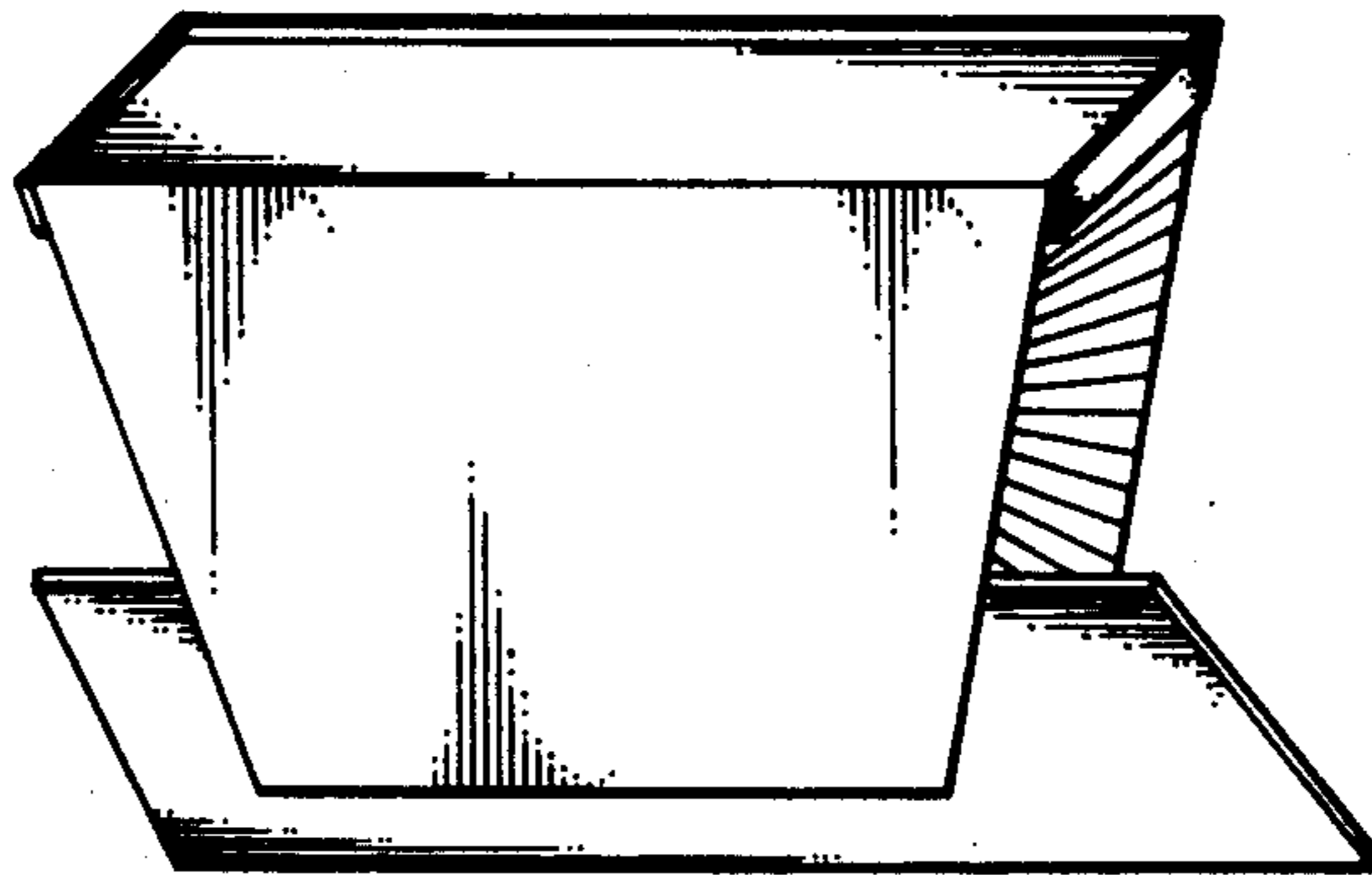

FIG. 4