

[54] PULL

[75] Inventor: LaVerne E. Clayton, Rockford, Ill.

[73] Assignee: Amerock Corporation, Rockford, Ill.

[**] Term: 14 Years

[21] Appl. No.: 890,713

[22] Filed: Mar. 27, 1978

[51] Int. Cl. D8-06

[52] U.S. Cl. D8/319; D8/306

[58] Field of Search D8/300-302, D8/305-307, 310-322, 350-353, 367; D7/137, 150; 16/110 R, 121, 124-127; 292/347, 357

[56] References Cited

U.S. PATENT DOCUMENTS

- D. 193,176 7/1962 Aleks D8/319
- D. 211,935 8/1968 Algoren D8/310

Primary Examiner—Wallace R. Burke
Assistant Examiner—B. J. Bullock
Attorney, Agent, or Firm—C. Frederick Leydig

[57] CLAIM

The ornamental design for a pull, as shown.

DESCRIPTION

FIG. 1 is a front elevational view of a pull incorporating my new design.

FIG. 2 is a top plan view thereof.

FIG. 3 is a side elevational view as seen from the left in FIG. 1.

FIG. 4 is an enlarged sectional view taken along the line 4-4 in FIG. 1.

FIG. 5 is an enlarged sectional view taken along the line 5-5 in FIG. 1.

FIG. 6 is an enlarged sectional view taken along the line 6-6 in FIG. 1.

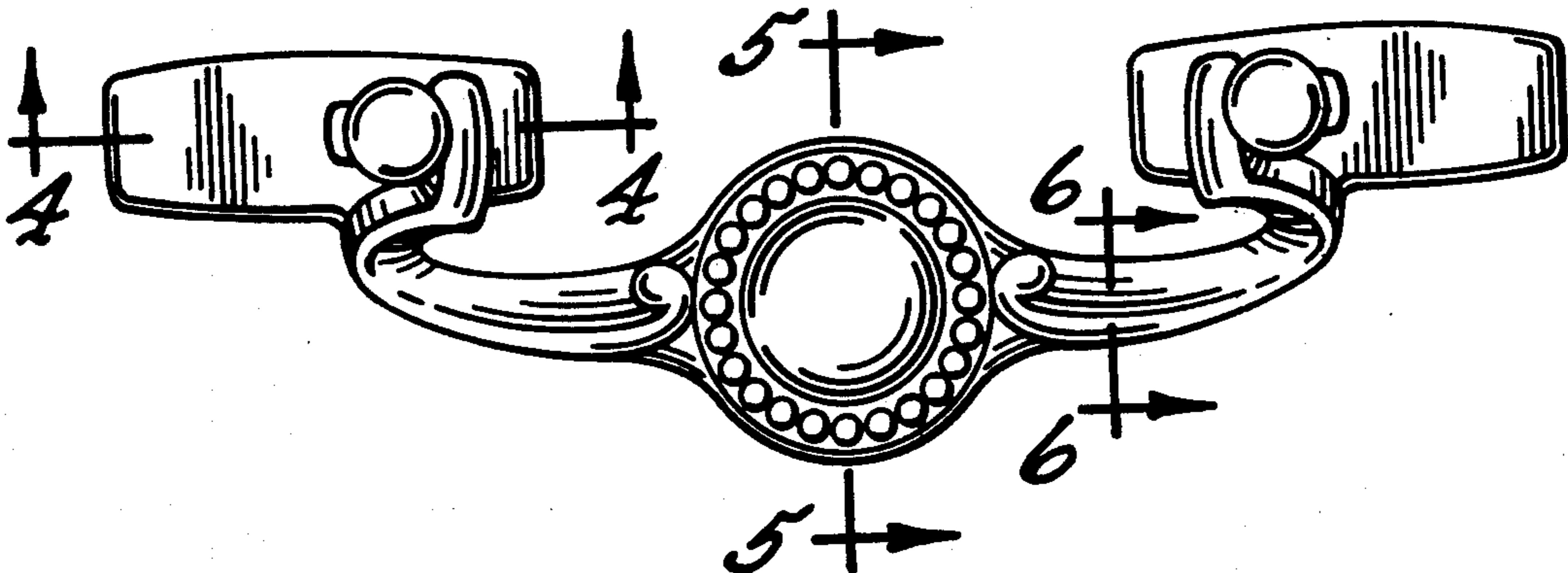

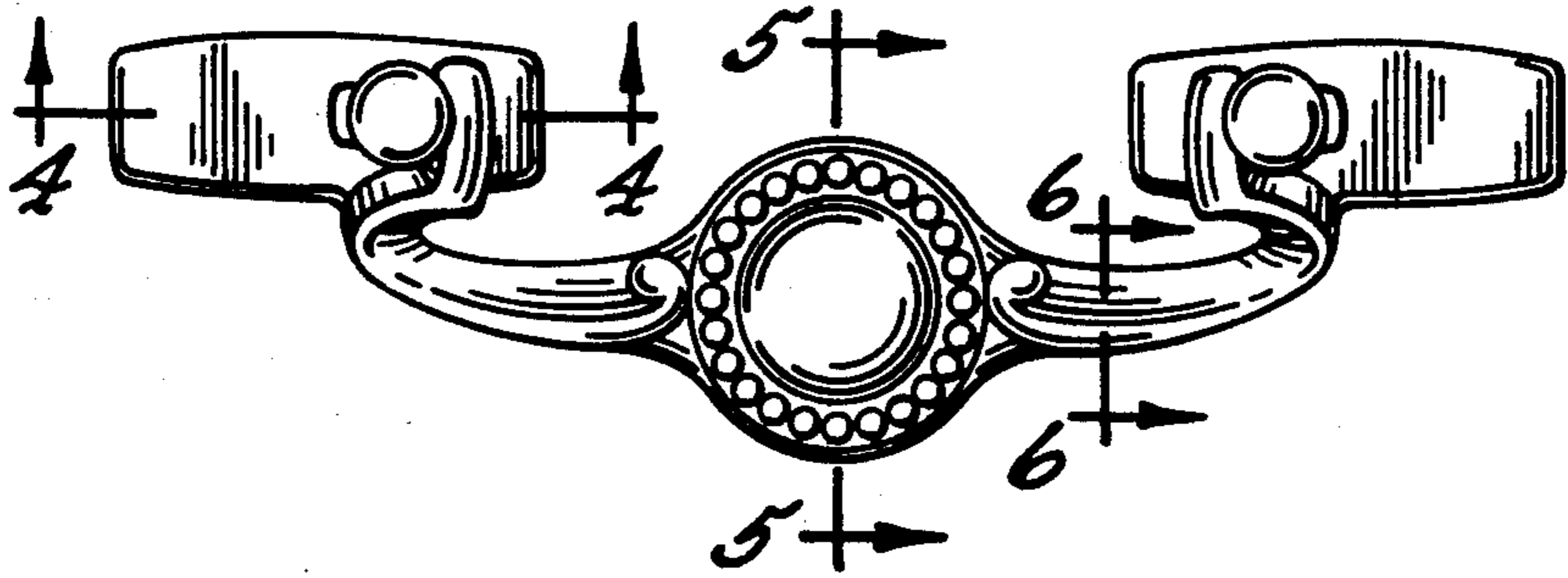

FIG. 1.

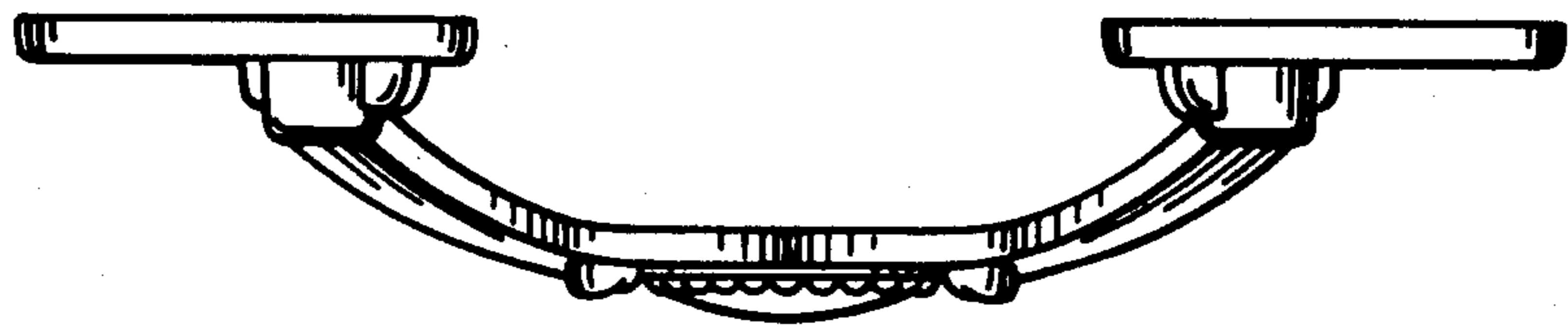

FIG. 2.

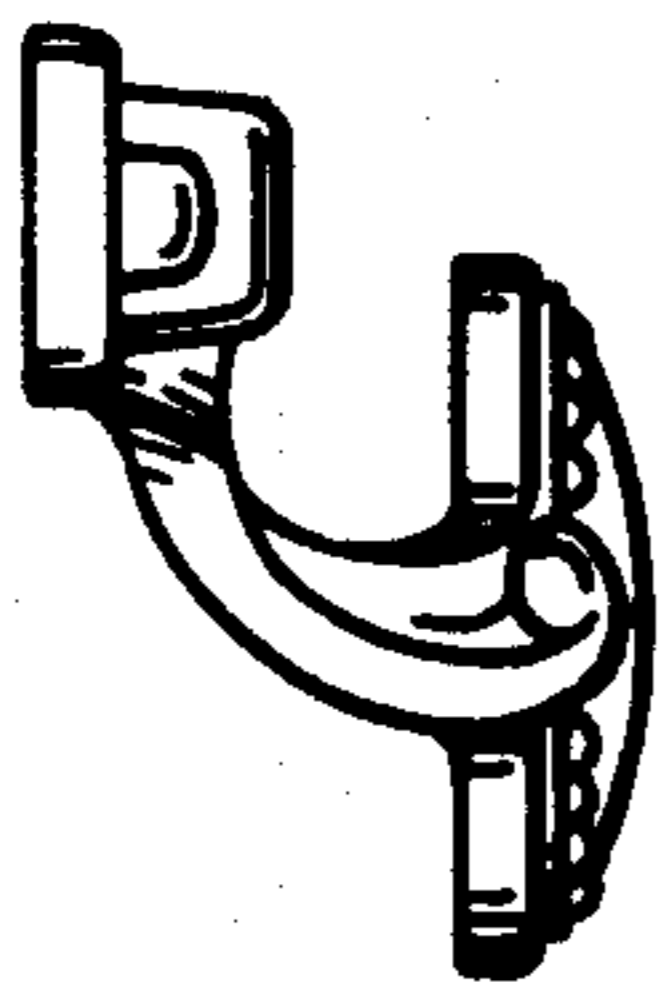

FIG. 3.

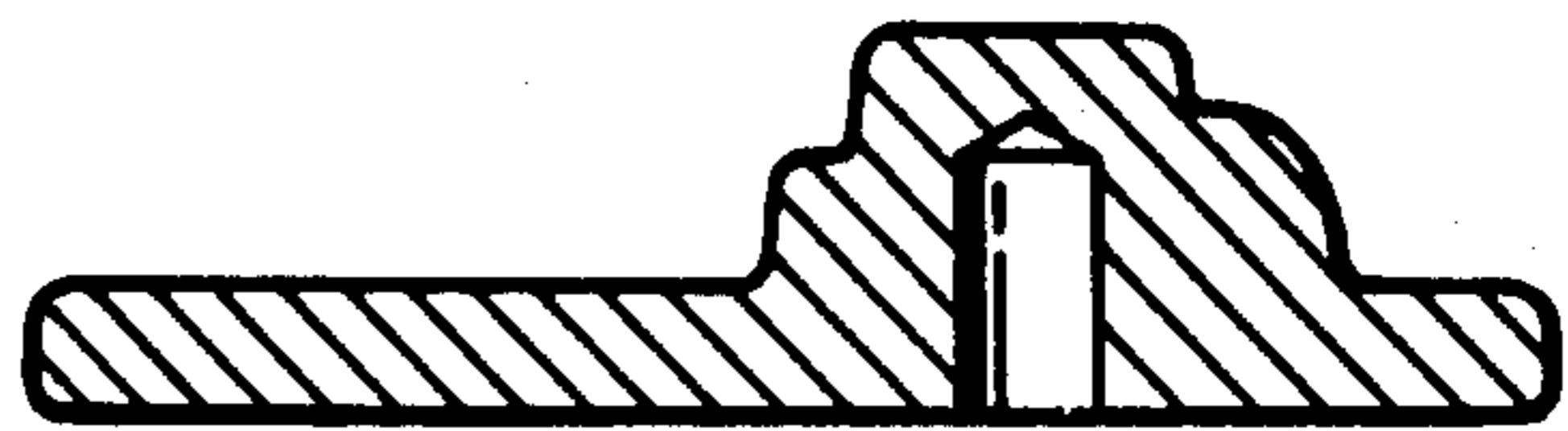

FIG. 4.



FIG. 5.



FIG. 6.