

[54] PENDANT PULL

[75] Inventor: LaVerne E. Clayton, Rockford, Ill.

[73] Assignee: Amerock Corporation, Rockford, Ill.

[\*\*] Term: 14 Years

[21] Appl. No.: 746,610

[22] Filed: Dec. 1, 1976

[51] Int. Cl. .... D8-06

[52] U.S. Cl. .... D8/307

[58] Field of Search ..... D8/300, 301, 305-307, D8/310, 313-323, 349-353, 400, 401; 16/110 R

[56] References Cited

U.S. PATENT DOCUMENTS

D. 231,319 4/1974 James ..... D8/307

OTHER PUBLICATIONS

Jaybee Builders' and Cabinet Hardware Cat. 133, 2/1974, p. 49, pendant No. 477.

Artistic Brass Cat. H-69, 11/1969, p. 7, escutcheon H43-142.

Sear's Cat. - Philadelphia Ed., Fall/Winter 1968, p. 1030, pull No. 4.

Primary Examiner—Wallace R. Burke

Assistant Examiner—B. J. Bullock

Attorney, Agent, or Firm—C. Frederick Leydig

[57] CLAIM

The ornamental design for a pendant pull, as shown.

DESCRIPTION

FIG. 1 is a front elevational view of a pendant pull incorporating my new design;

FIG. 2 is a side elevational view, taken from the right of FIG. 1;

FIG. 3 is a top plan view;

FIG. 4 is a sectional view taken along the line 4-4 in FIG. 1.

FIG. 5 is an enlarged sectional view taken along the line 5-5 in FIG. 1.

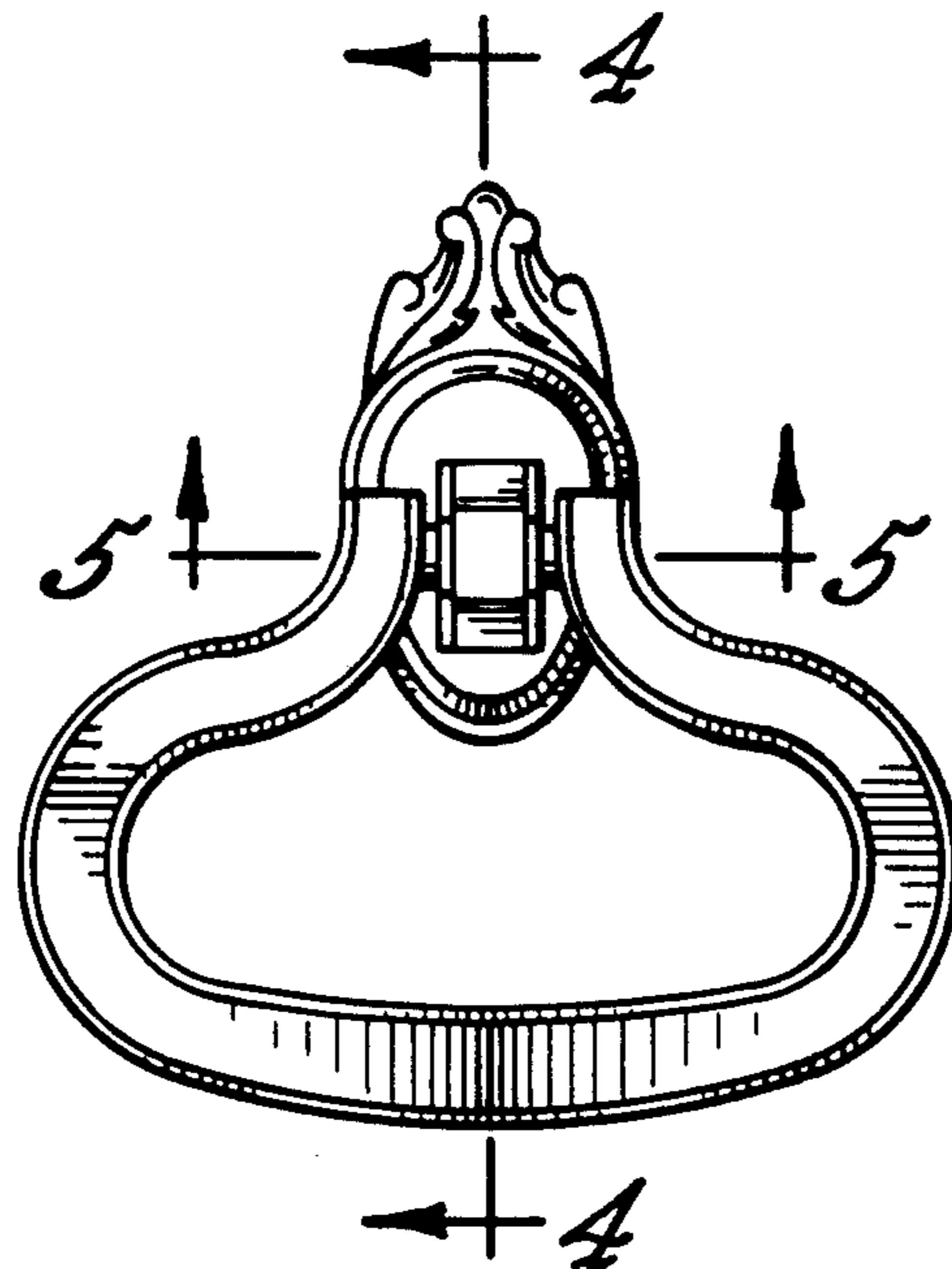

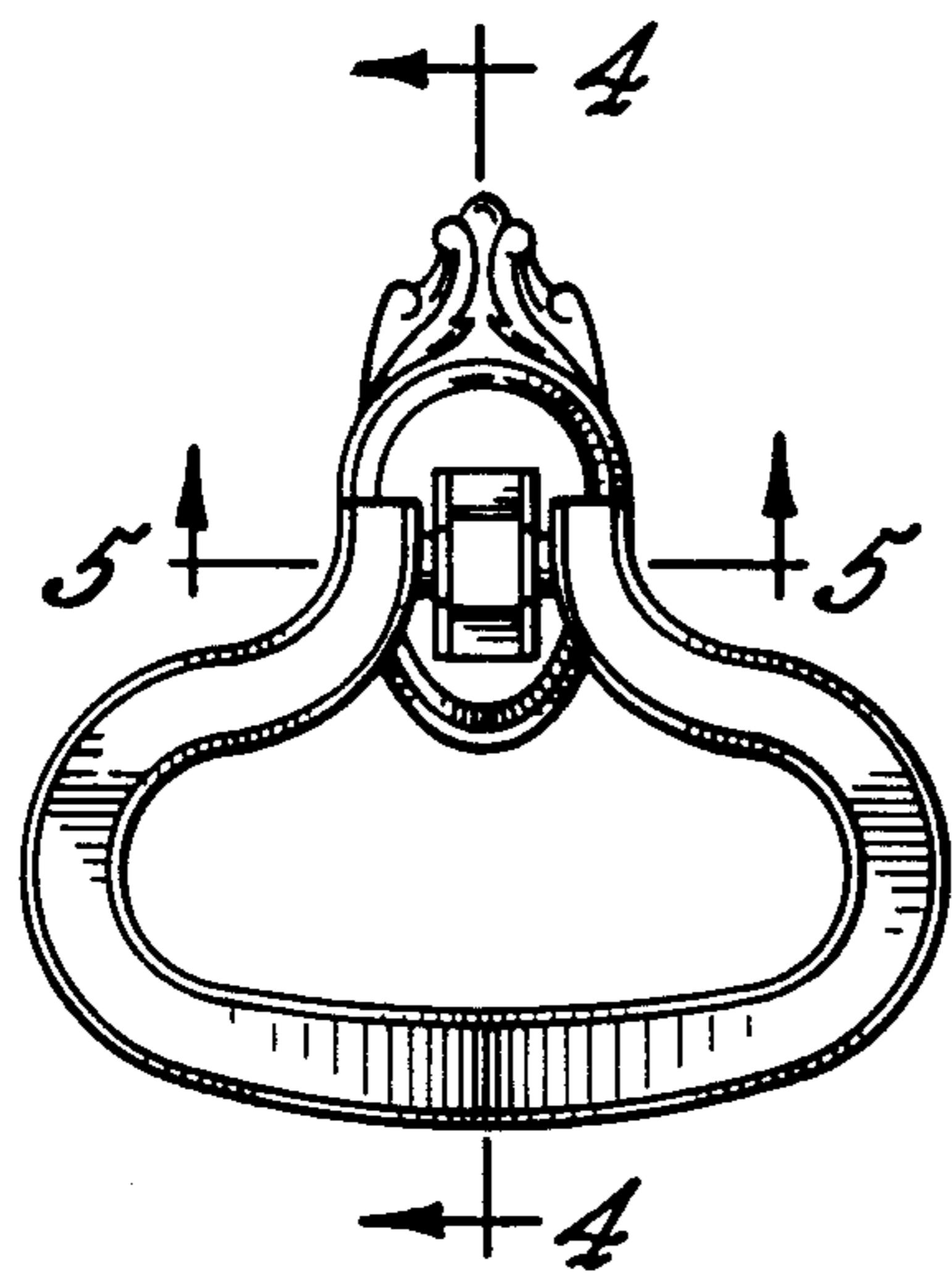

FIG. 1.



FIG. 2.

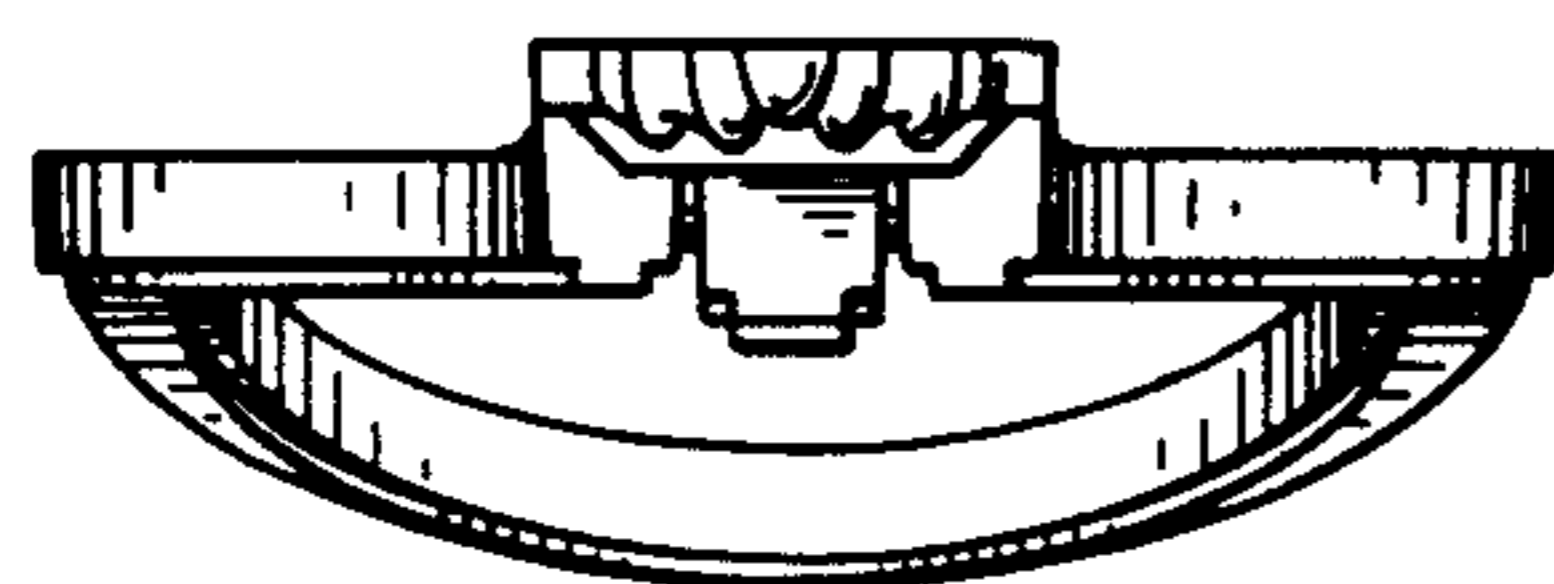

FIG. 3.

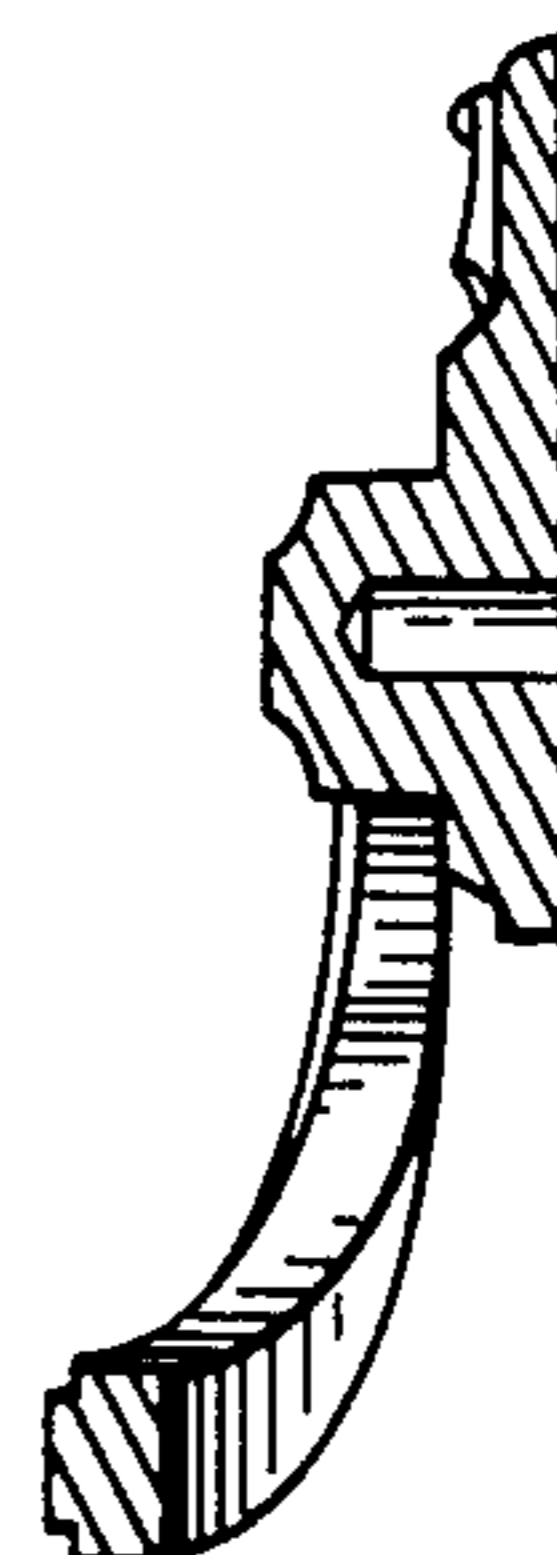

FIG. 4.

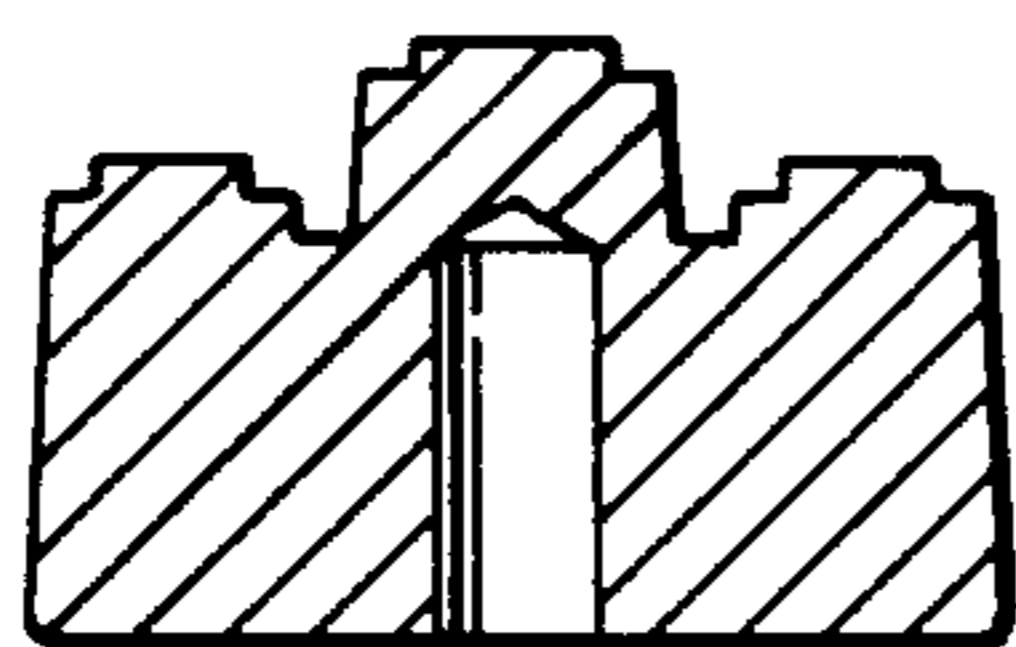

FIG. 5.