

[54] JEWELRY RING BOX

[76] Inventor: Jerome Shiffman, 128 Carthage Road, Scarsdale, N.Y. 10583

[**] Term: 7 Years

[21] Appl. No.: 393,441

[22] Filed: Aug. 31, 1973

[51] Int. Cl. D9-03

[52] U.S. Cl. D9/235

[58] Field of Search D87/1 B; D9/222-241

[56] References Cited

U.S. PATENT DOCUMENTS

- D. 56,211 8/1920 Vivaudou D9/235
- D. 180,423 6/1957 Rutledge D87/1 B
- D. 194,333 1/1963 Chapman D9/193

Primary Examiner—Robert C. Spangler
Attorney, Agent, or Firm—W. Lee Helms

[57] CLAIM

The ornamental design for a jewelry ring box, as shown and described.

DESCRIPTION

FIG. 1 is a top plan view of a jewelry ring box showing my new design, the ornamentation shown, being embossed on the under surface of the cover;
 FIG. 2 is a front elevational view thereof;
 FIG. 3 is a side elevational view thereof;
 FIG. 4 is a rear elevational view thereof;
 FIG. 5 is a bottom plan view thereof;
 FIG. 6 is a top plan view thereof with the cover removed.
 FIG. 7 is a side elevational view thereof with the cover raised.

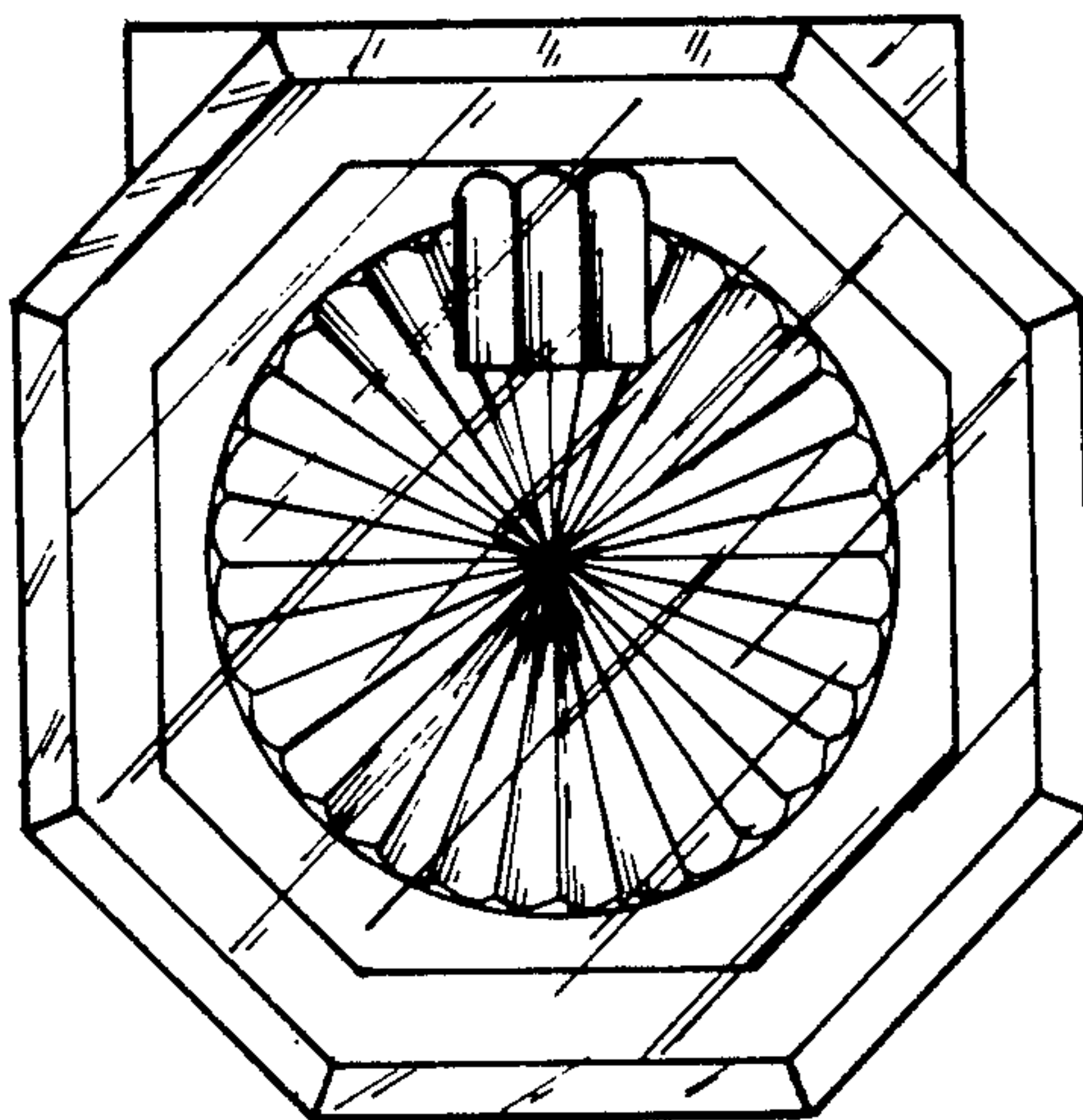

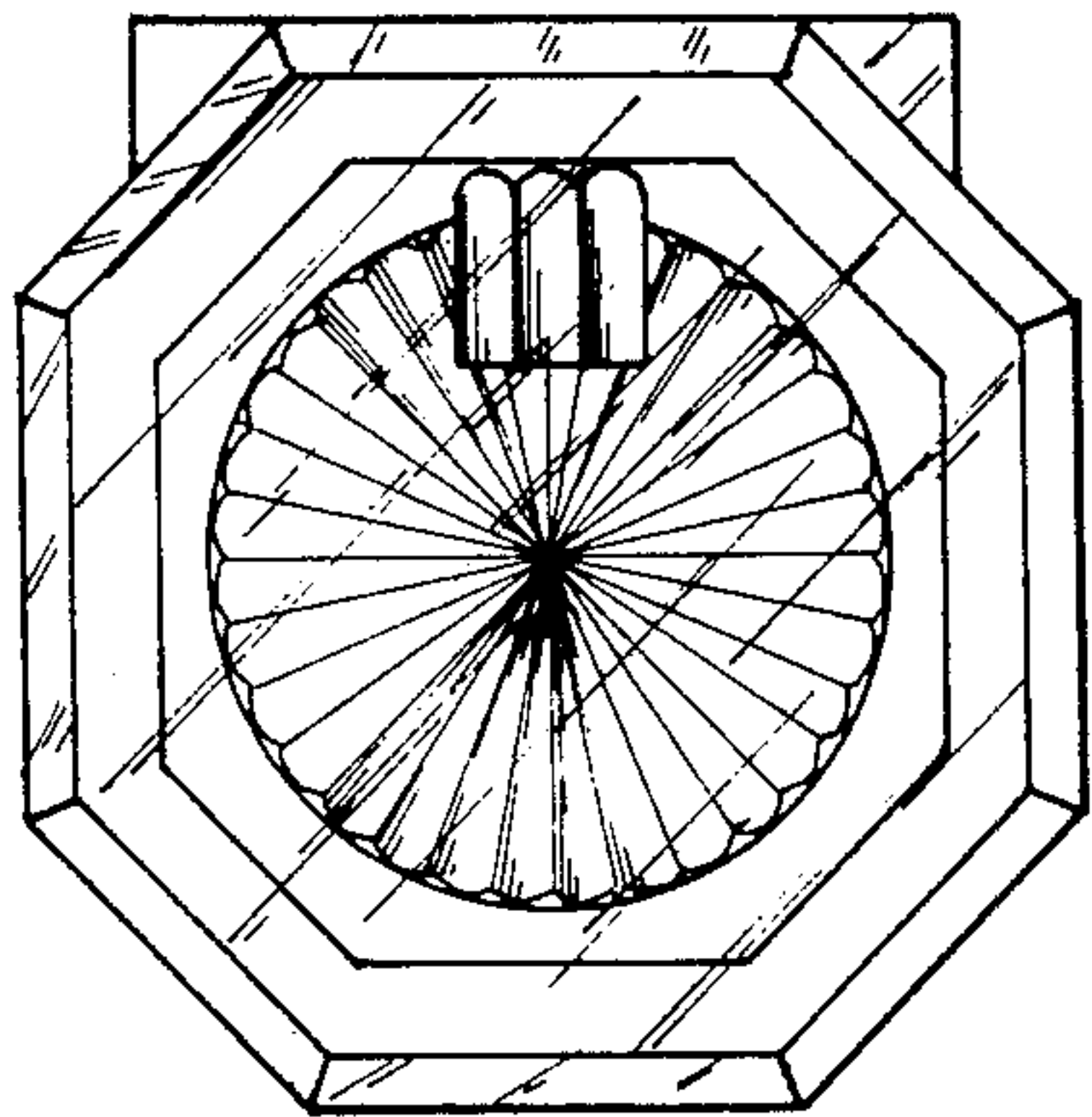

FIG. 1

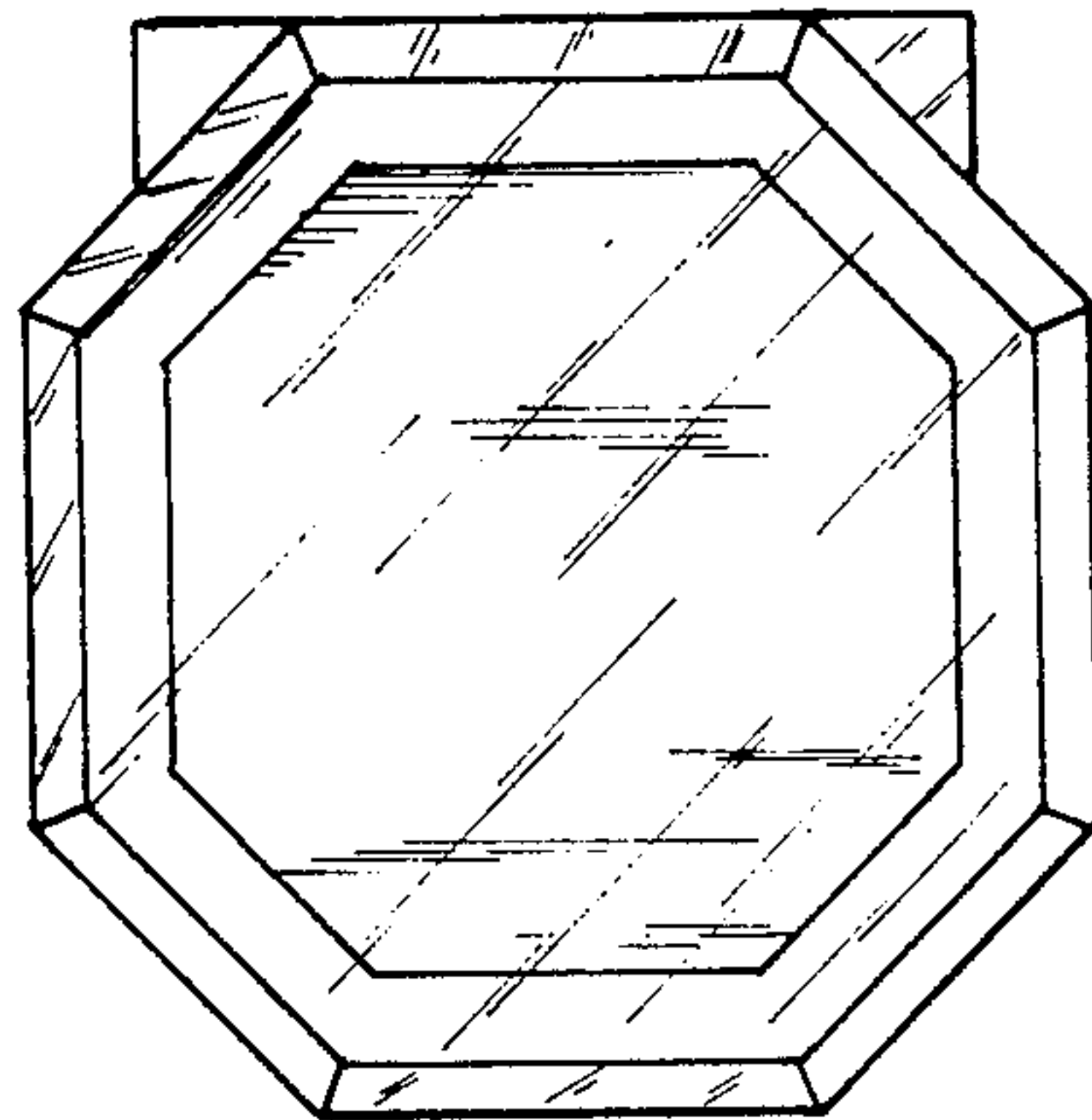

FIG. 5

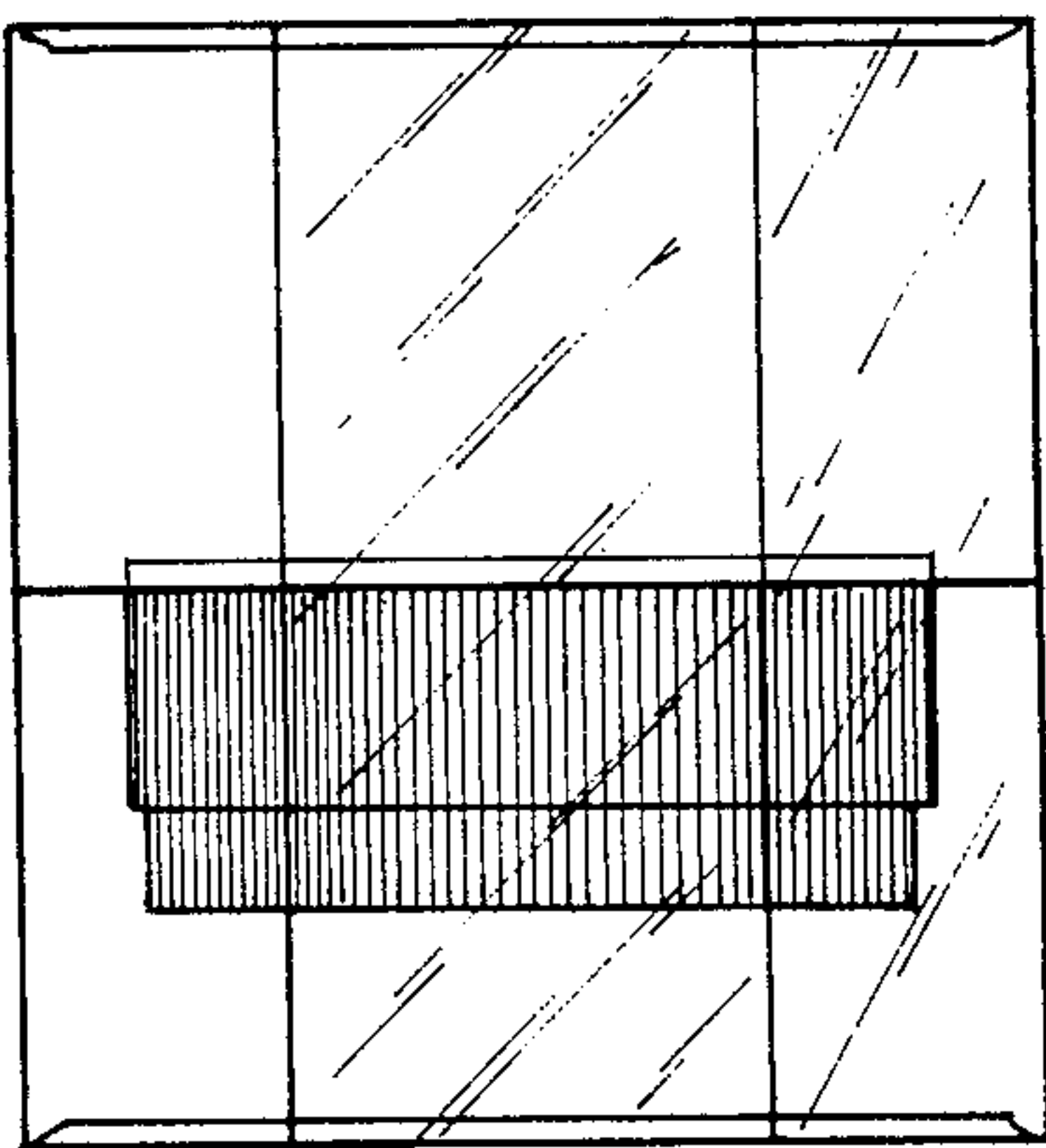

FIG. 2

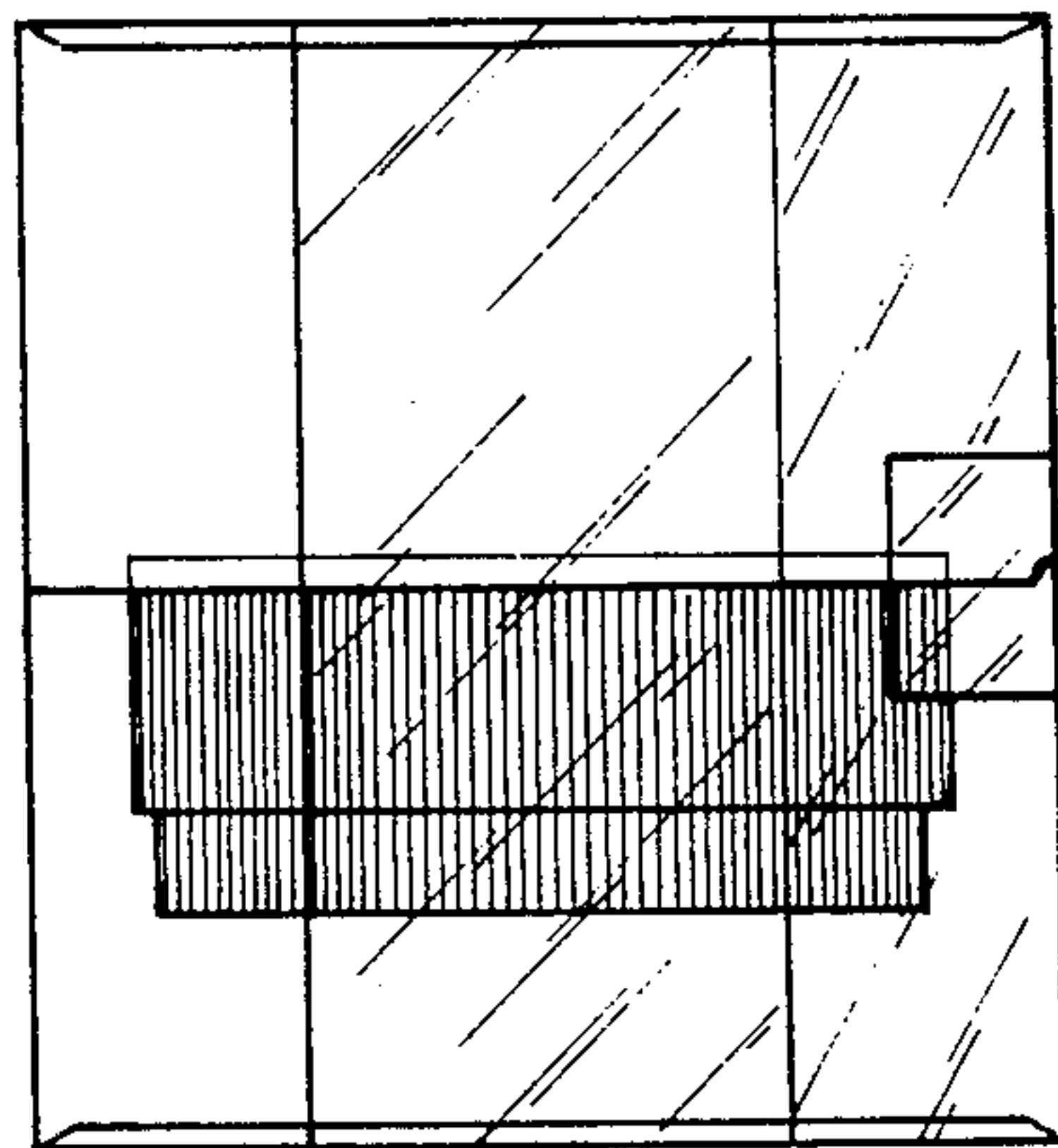

FIG. 3

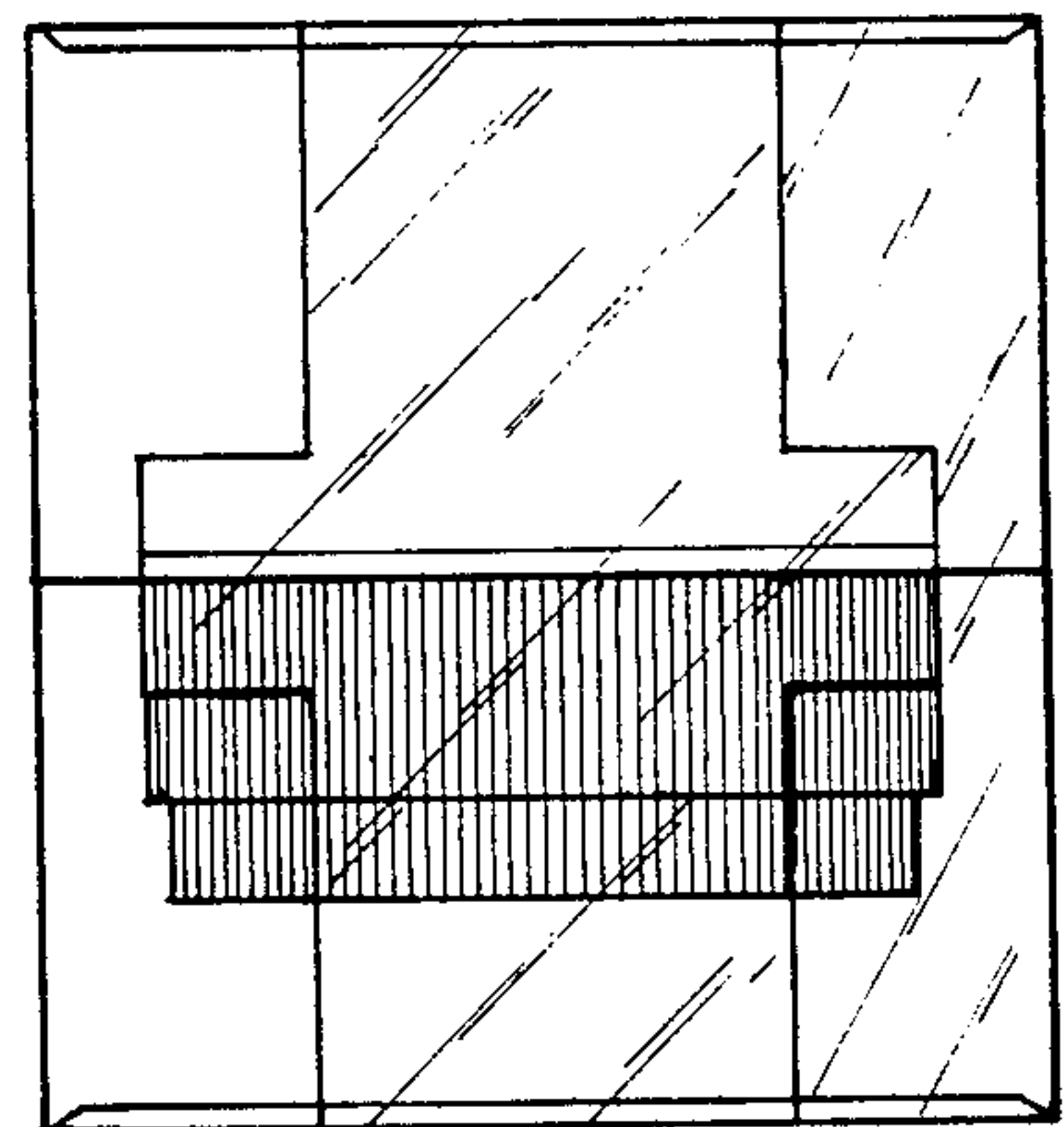

FIG. 4

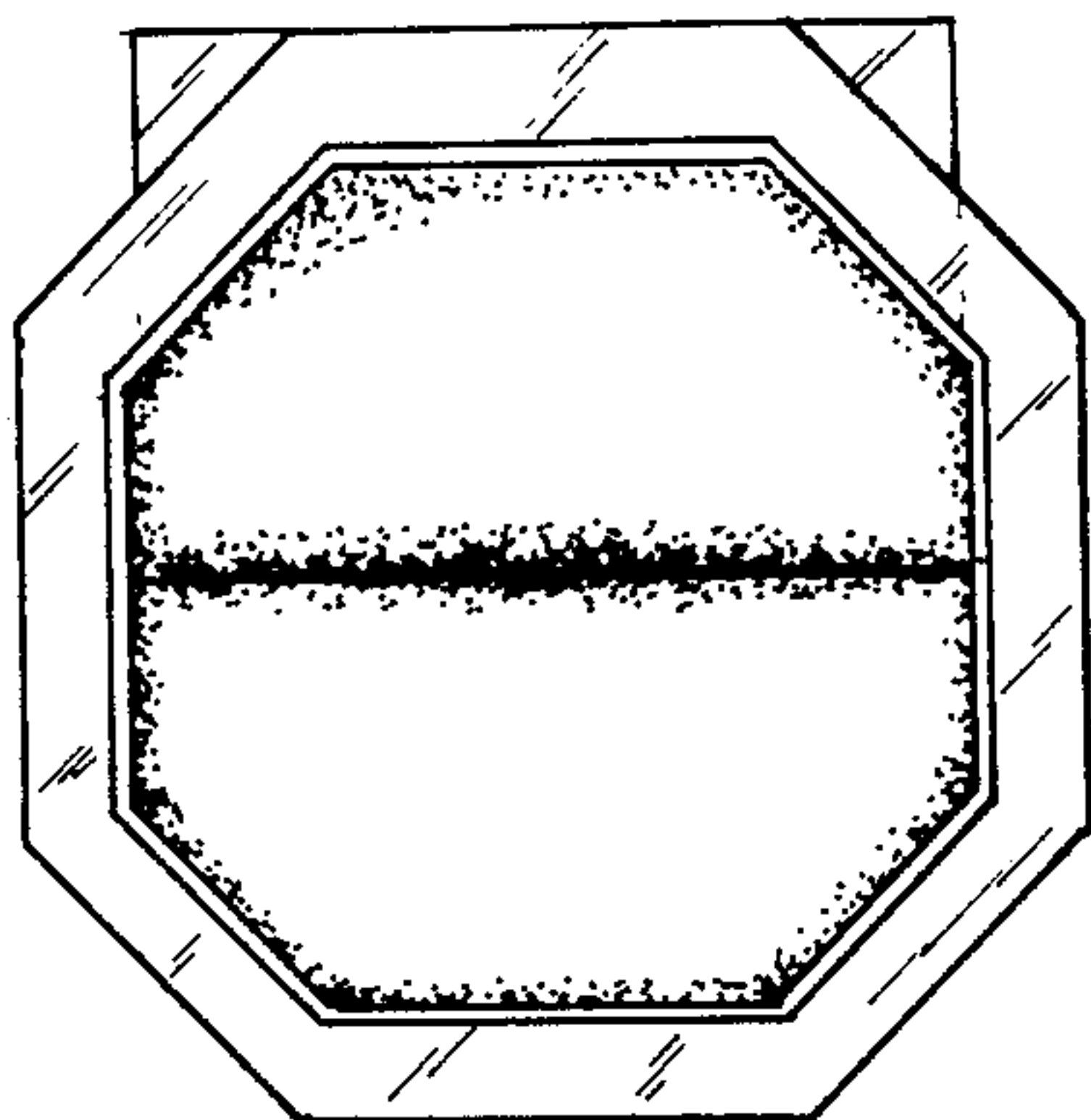

FIG. 6

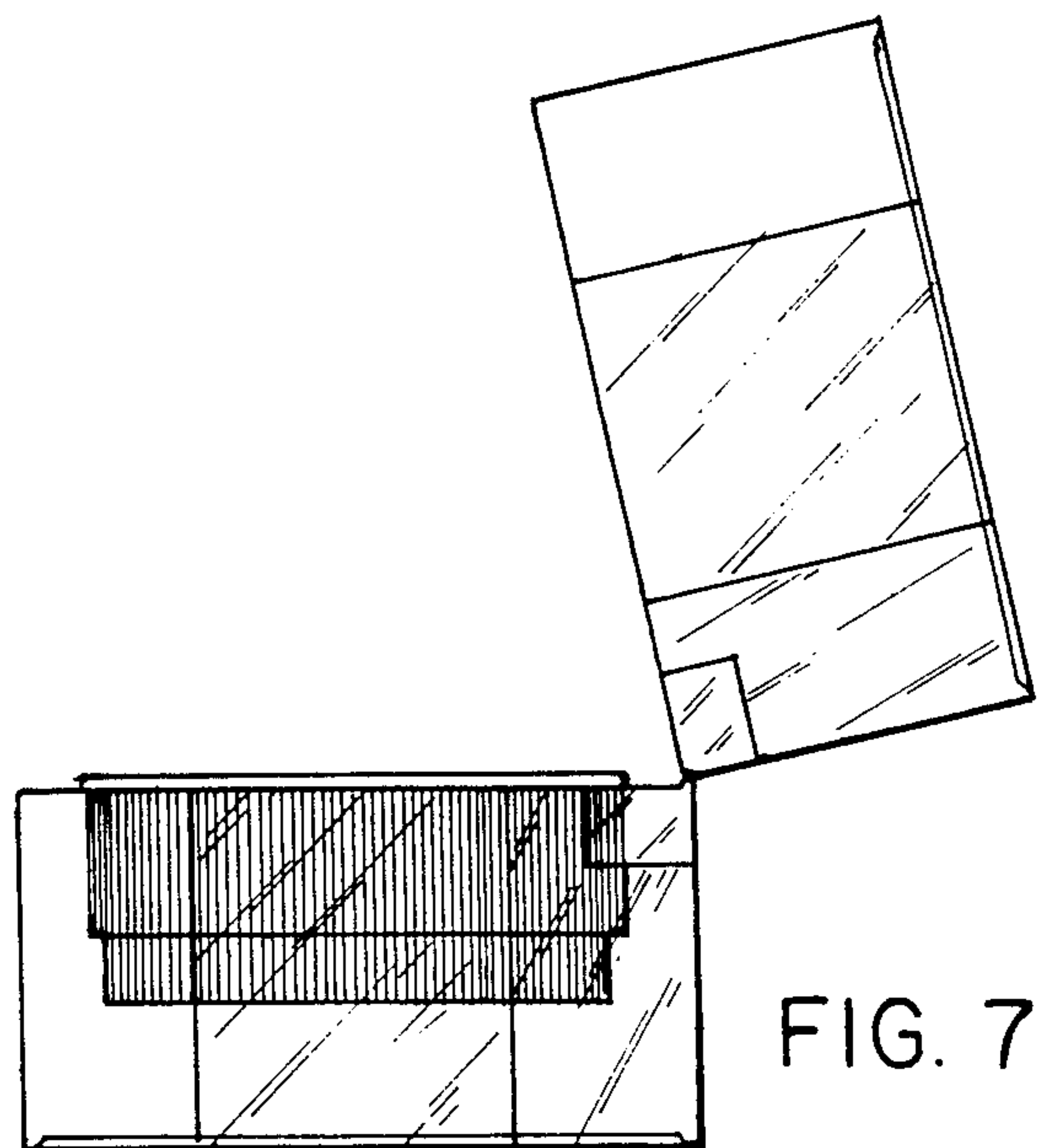

FIG. 7