



(12) **United States Patent**  
**Herzog et al.**

(10) **Patent No.:** **US 9,774,541 B1**  
(45) **Date of Patent:** **Sep. 26, 2017**

(54) **SYSTEM, METHOD, AND COMPUTER PROGRAM FOR GENERATING AN ORCHESTRATION DATA TREE UTILIZING A NETWORK FUNCTION VIRTUALIZATION ORCHESTRATOR (NFV-O) DATA MODEL**

(71) Applicant: **Amdocs Software Systems Limited**, Raanana (IL)

(72) Inventors: **Shai Herzog**, Ganei Tikva (IL); **Shiri Amichai**, Tel-Mond (IL); **Shimon Seretensky**, Alpey Menashe (IL)

(73) Assignees: **Amdocs Software Systems Limited**, Dublin (IE); **Amdocs Development Limited**, Limassol (CY)

(\*) Notice: Subject to any disclaimer, the term of this patent is extended or adjusted under 35 U.S.C. 154(b) by 211 days.

(21) Appl. No.: **14/628,145**

(22) Filed: **Feb. 20, 2015**

(51) **Int. Cl.**  
**G06F 15/173** (2006.01)  
**H04L 12/911** (2013.01)

(52) **U.S. Cl.**  
CPC ..... **H04L 47/78** (2013.01)

(58) **Field of Classification Search**  
CPC ..... H04L 47/78  
USPC ..... 709/223, 226  
See application file for complete search history.

(56) **References Cited**

U.S. PATENT DOCUMENTS

2013/0246996	A1	9/2013	Duggal et al.	
2015/0156059	A1*	6/2015	Shew .....	H04L 41/145 709/223
2015/0264117	A1*	9/2015	Kasturi .....	H04L 41/5019 709/217
2016/0149771	A1*	5/2016	Prasad .....	H04L 41/5054 709/226
2016/0212017	A1*	7/2016	Li .....	H04L 41/20

\* cited by examiner

*Primary Examiner* — Joseph E Avellino

*Assistant Examiner* — Marshall McLeod

(74) *Attorney, Agent, or Firm* — Zilka-Kotab, PC

(57) **ABSTRACT**

A system, method, and computer program product are provided for generating an orchestration data tree utilizing a Network Function Virtualization Orchestrator (NFV-O) data model. In use, an NFV-O data model is identified, the NFV-O data model being associated with an NFV-O module corresponding to a communication network. Additionally, an orchestration data tree template is generated utilizing the NFV-O data model, the orchestration data tree being utilized to support orchestration of a plurality of services associated with the communication network, and the orchestration data tree template capable of including: a plurality of nodes, each of the nodes representing one of the plurality of services associated with the communication network; a plurality of node relations, each of the plurality of node relations representing a relation of a parent node and a sub-node; a plurality of links, each of the plurality of links defining a relationship between two of the plurality of nodes; and a plurality of connectors, each of the plurality of connectors being associated with one of the plurality of nodes and functioning to connect to one of the plurality of links.

**21 Claims, 9 Drawing Sheets**

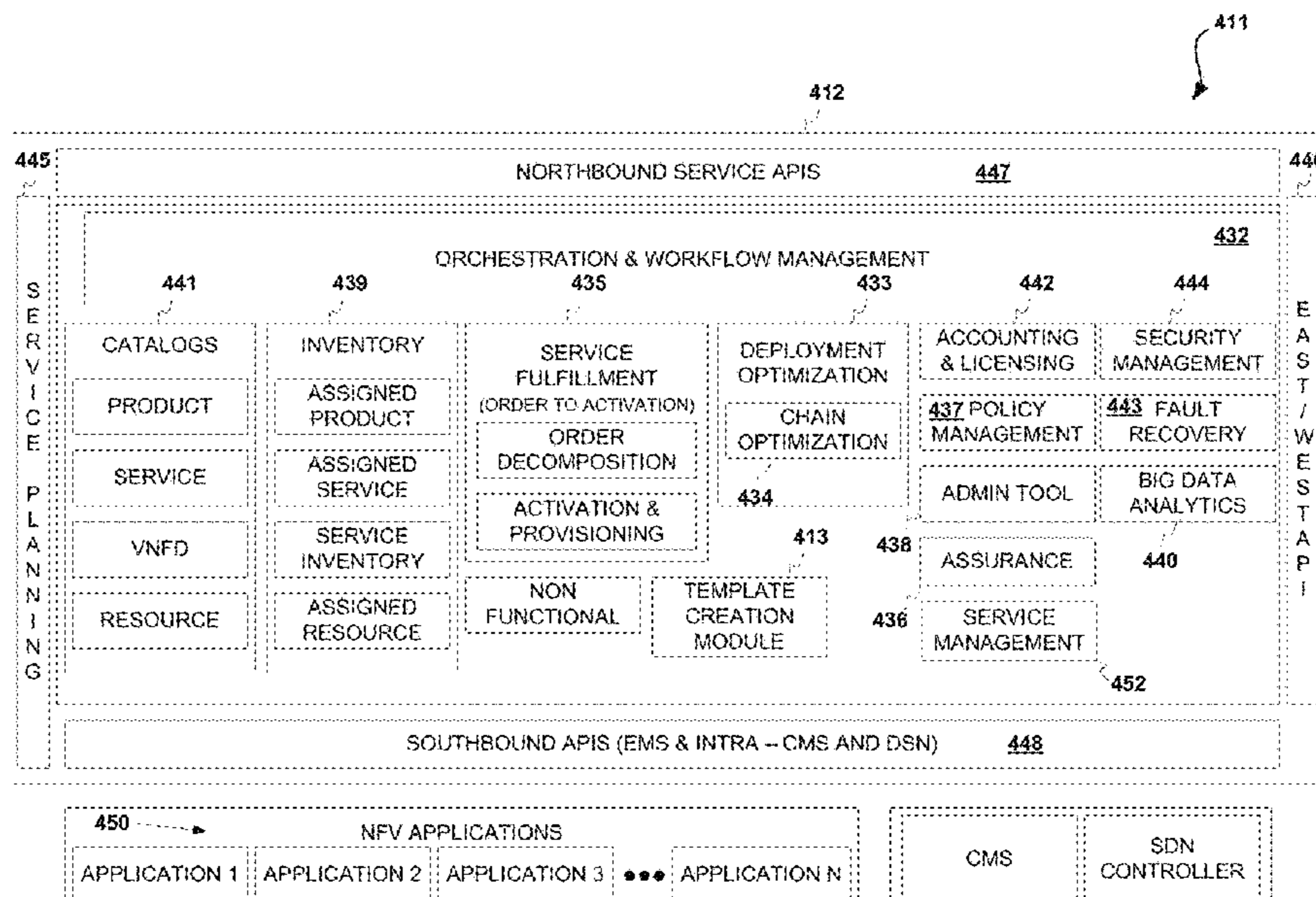

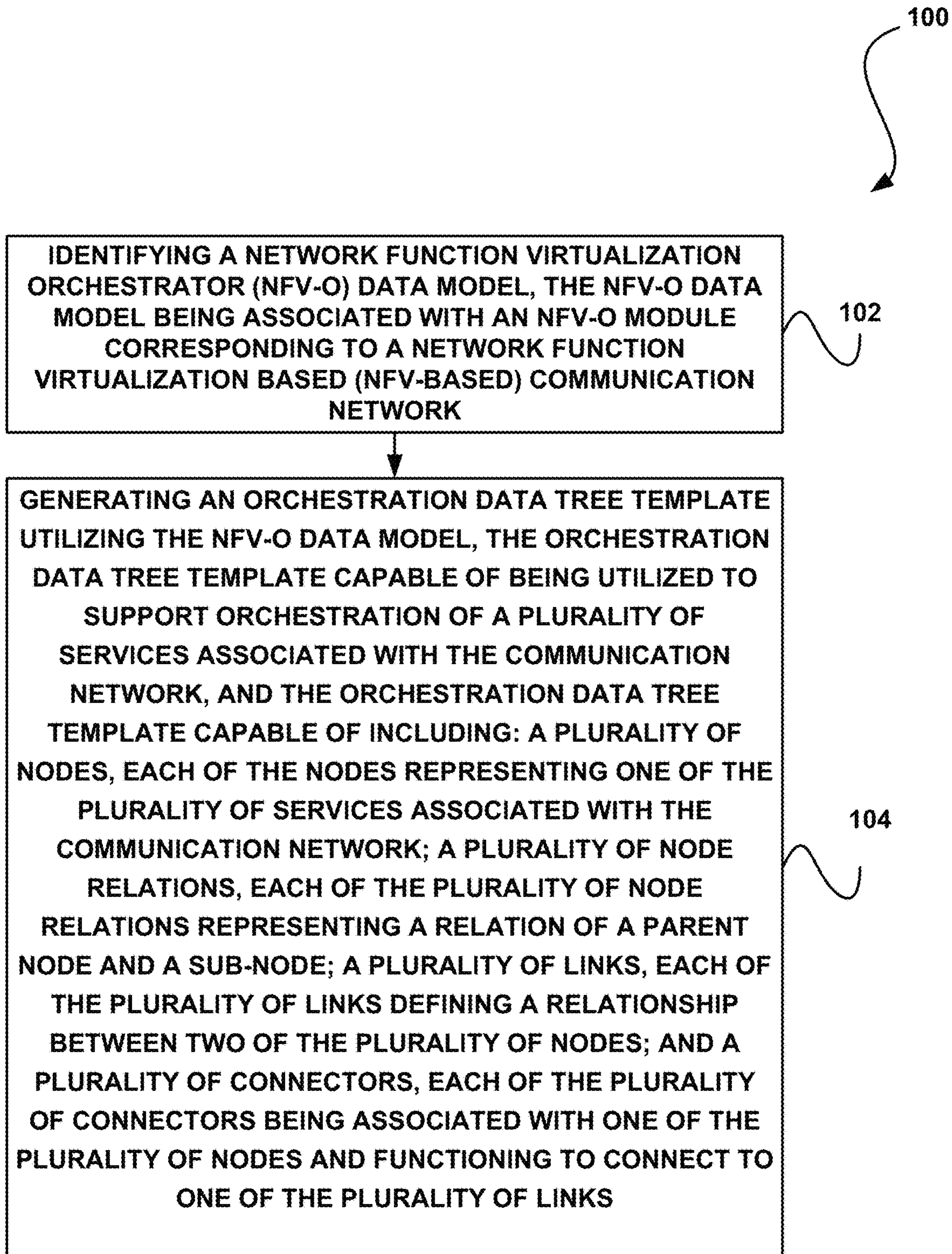

FIGURE 1



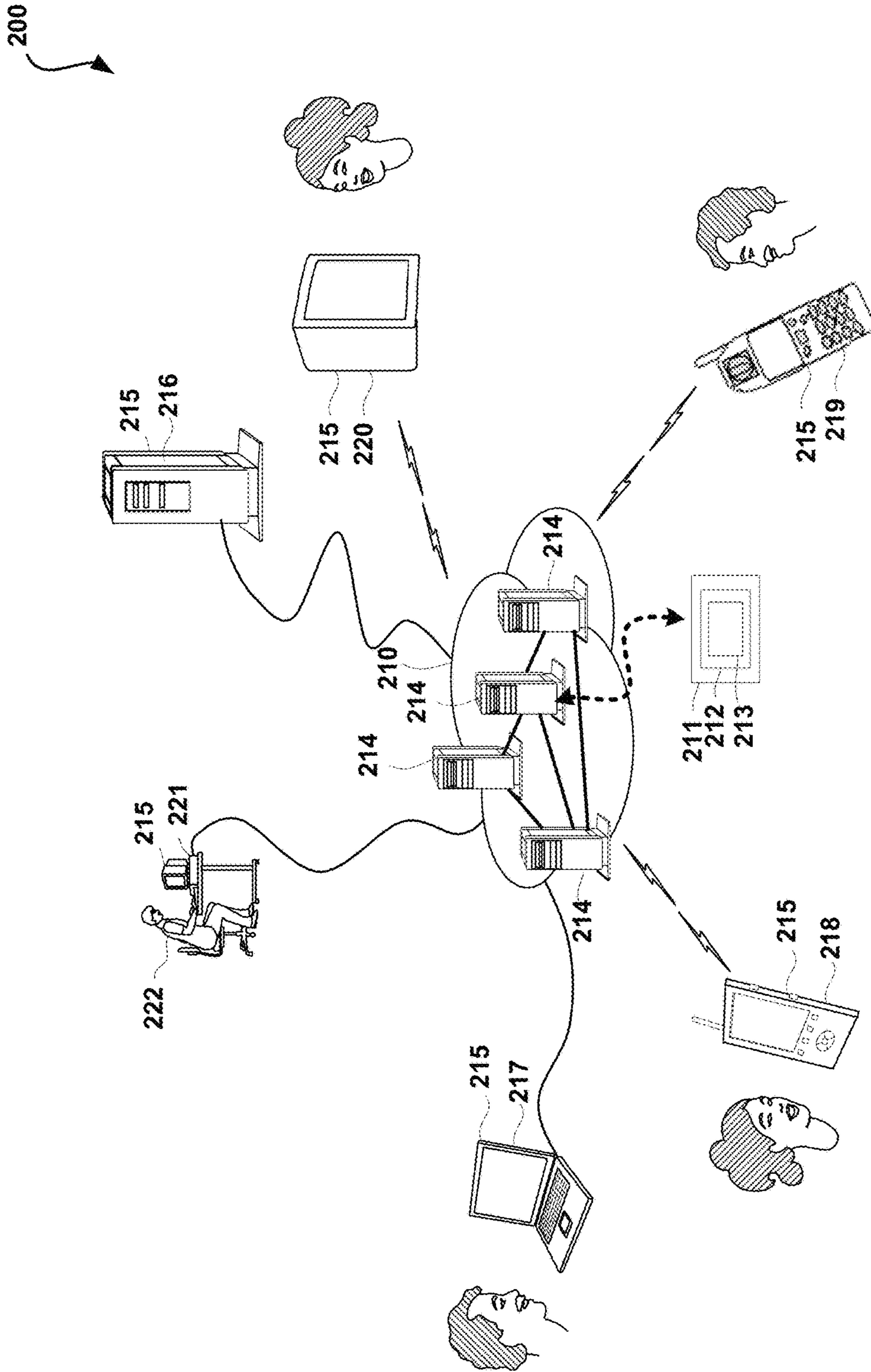

FIGURE 2

300

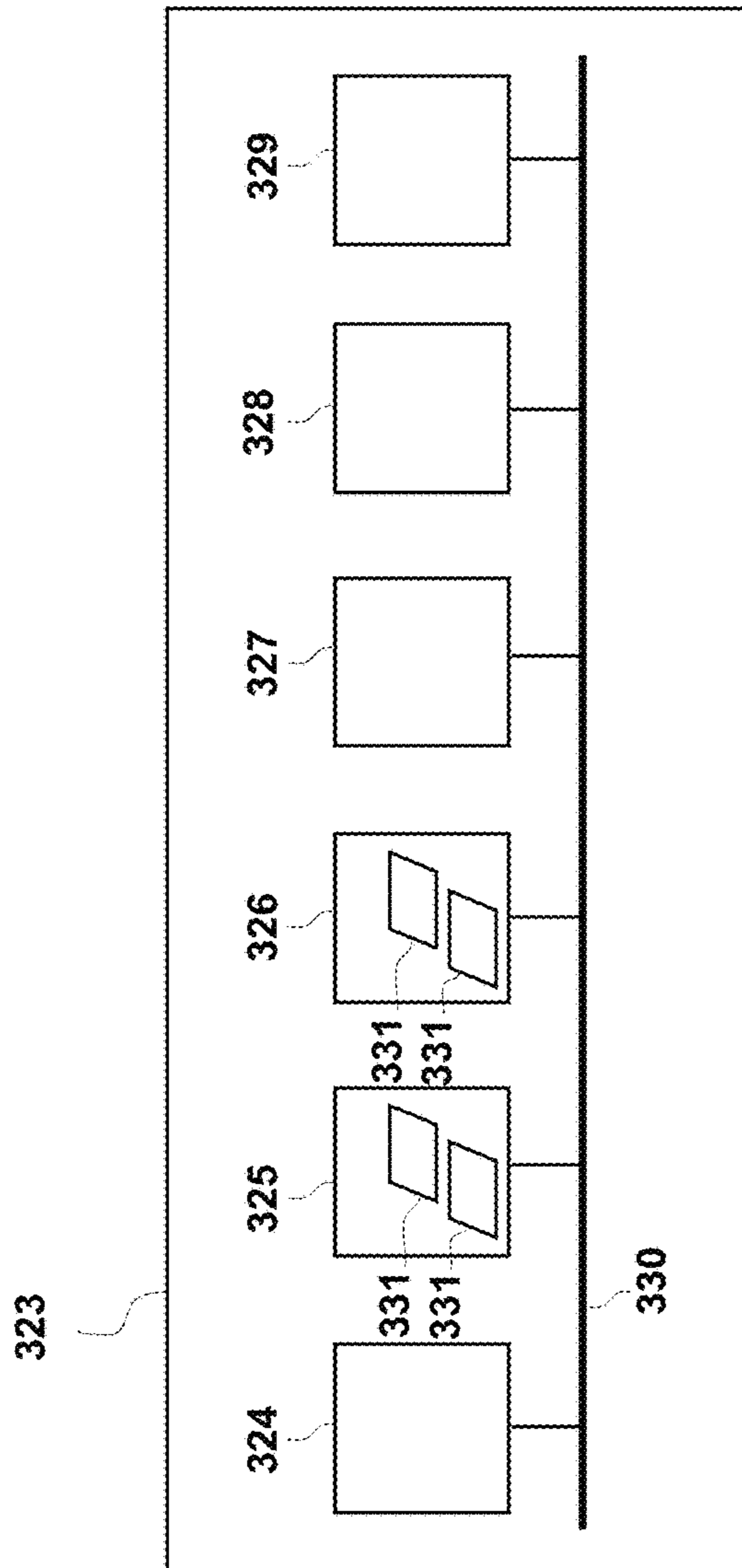

FIGURE 3

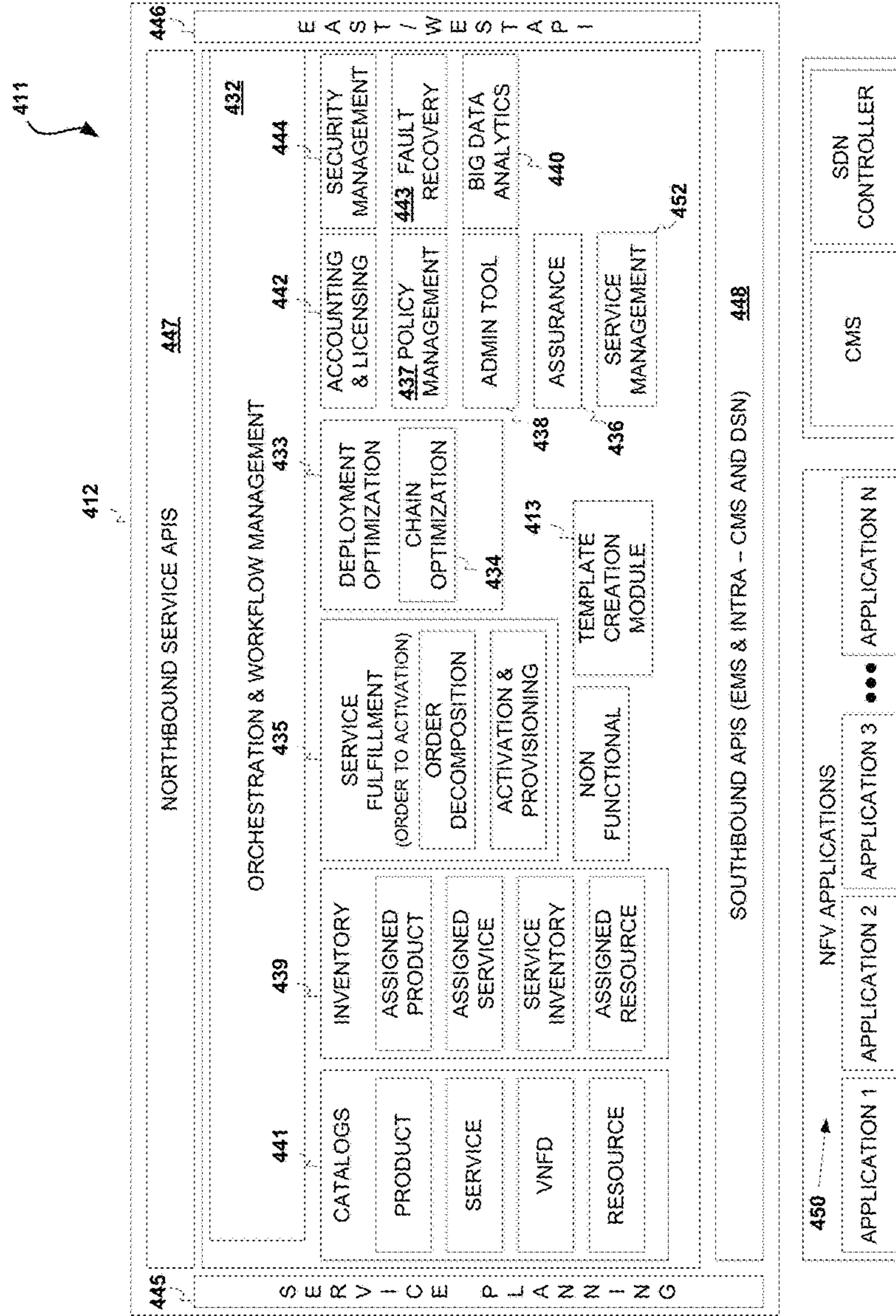
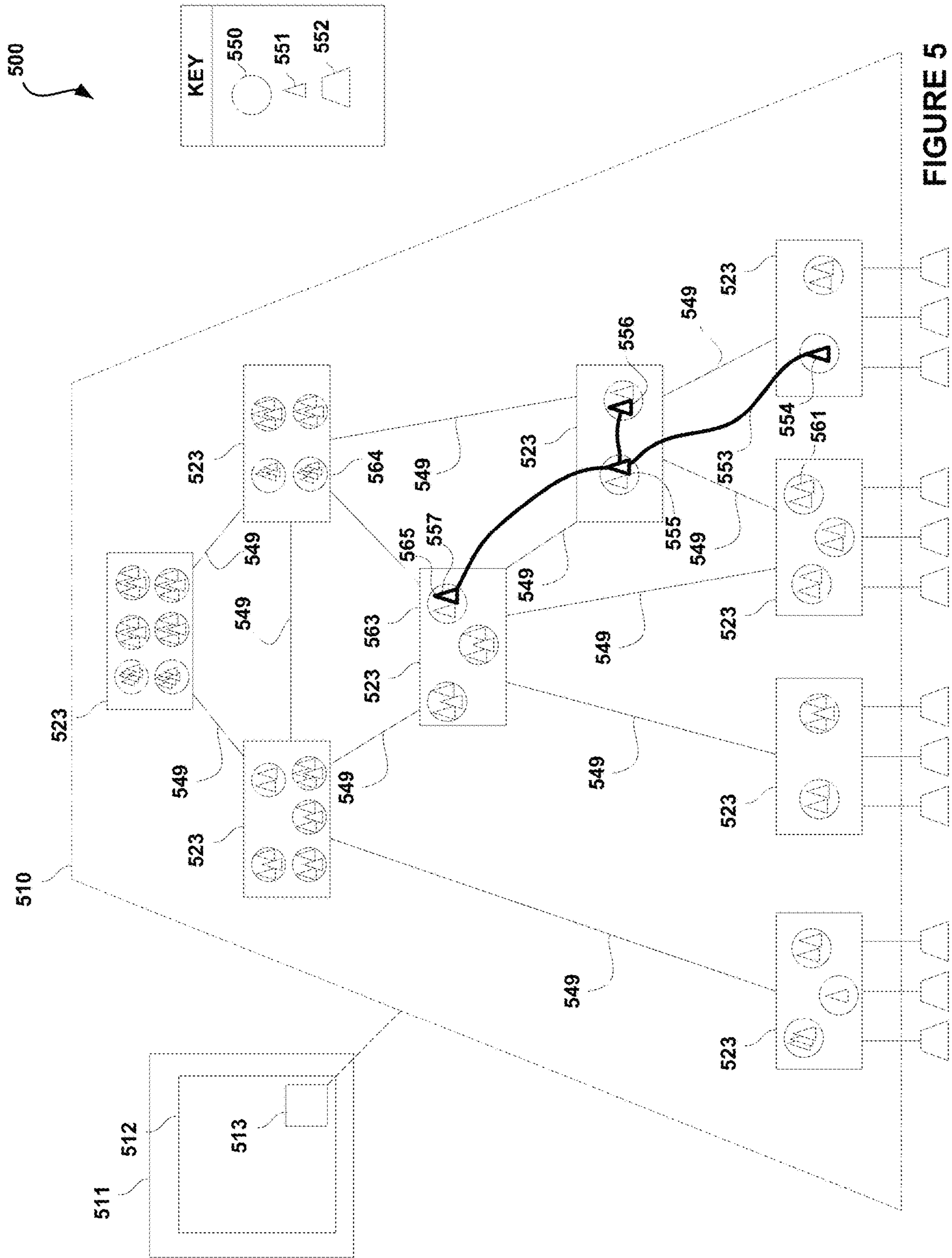

FIGURE 4



600

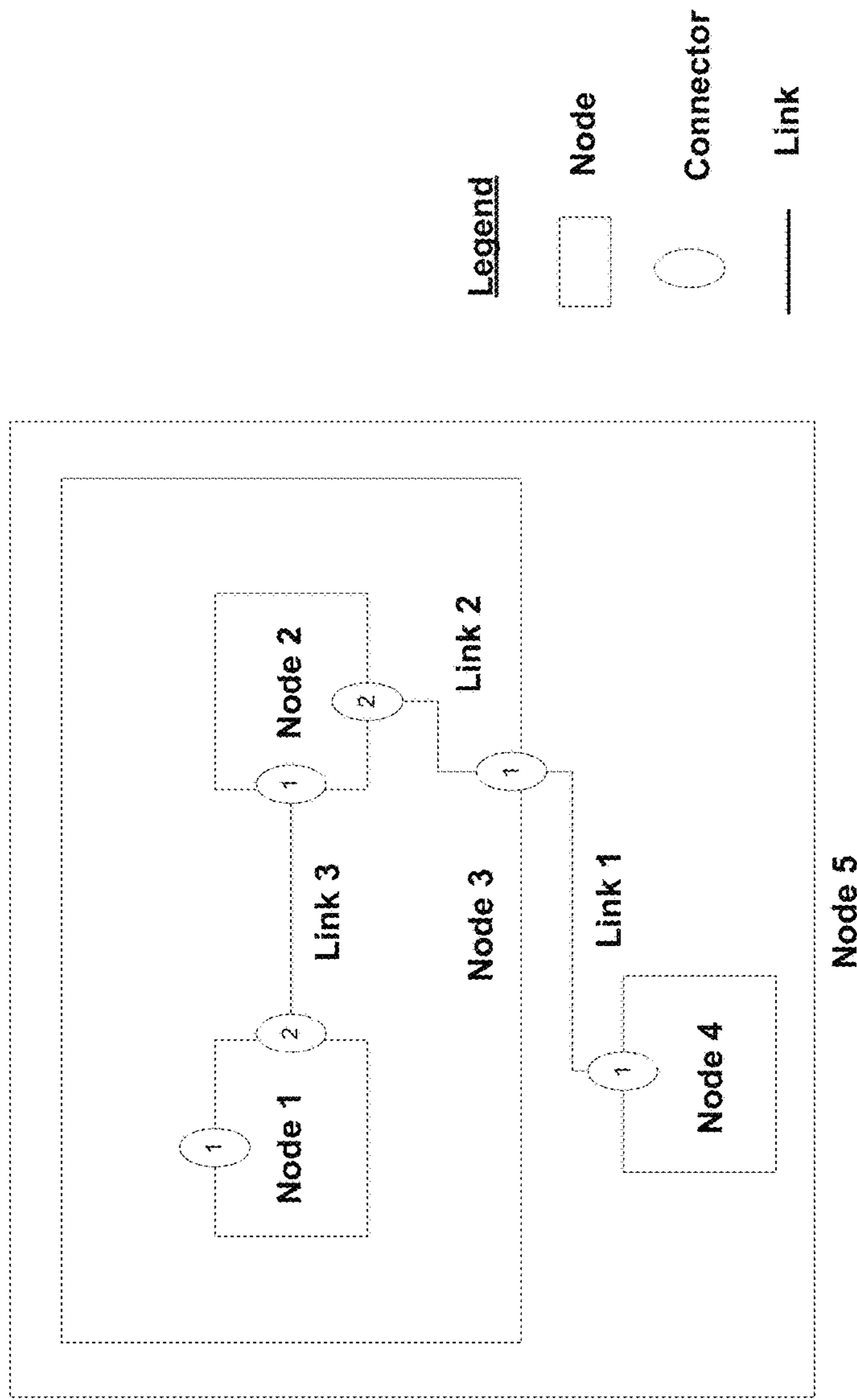

FIGURE 6



700

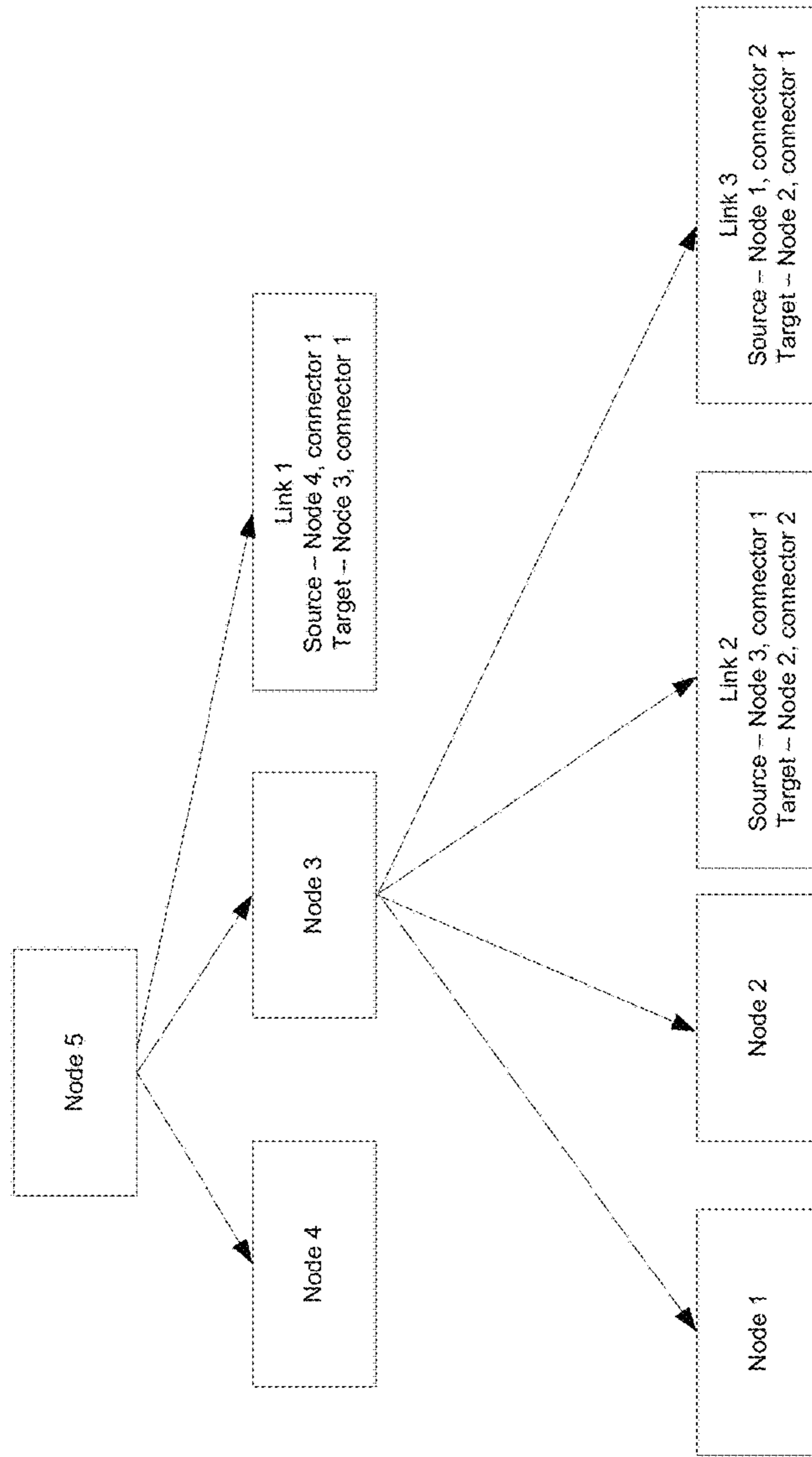

FIGURE 7



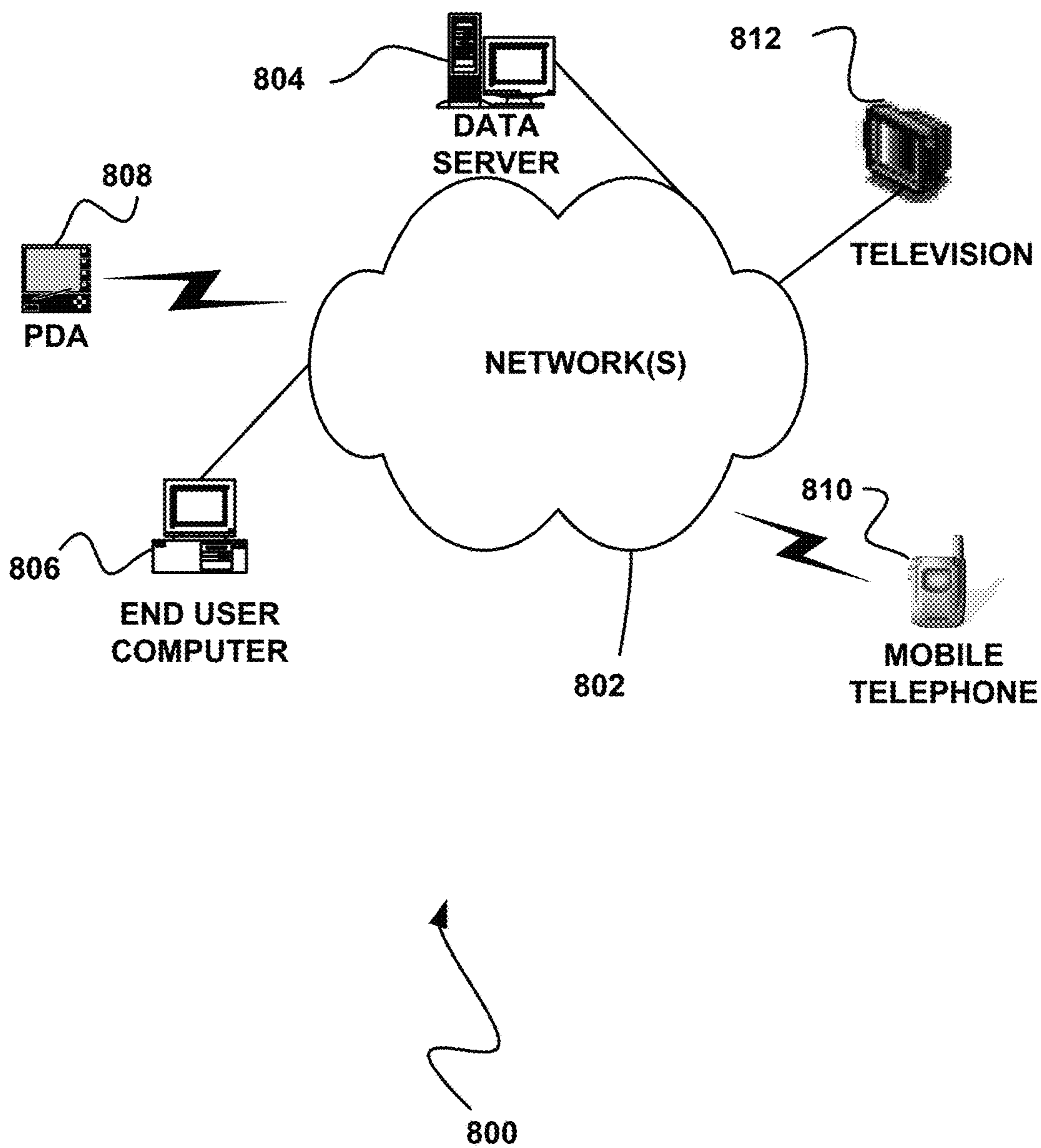

FIGURE 8

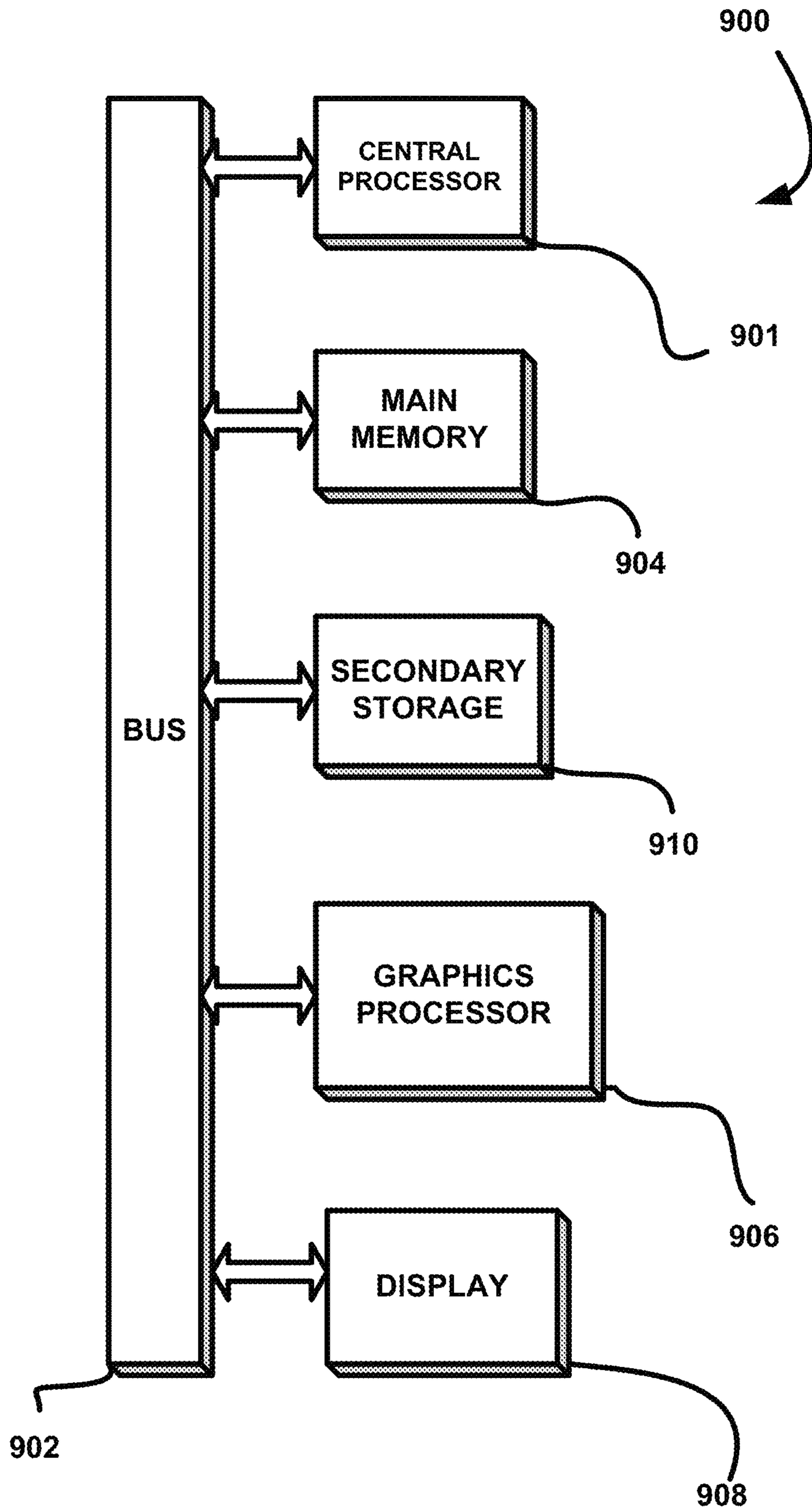

FIGURE 9



1

**SYSTEM, METHOD, AND COMPUTER  
PROGRAM FOR GENERATING AN  
ORCHESTRATION DATA TREE UTILIZING  
A NETWORK FUNCTION VIRTUALIZATION  
ORCHESTRATOR (NFV-O) DATA MODEL**

FIELD OF THE INVENTION

The present invention relates to telecommunications and/or data communications and, more particularly to network function virtualization (NFV) of telecommunications networks.

BACKGROUND

Network Function Virtualization is a term or a name of a proposed architecture of telecom services as published by the European Telecommunications Standards Institute (ETSI) in a series of documents available from the ETSI website. NFV uses generic hardware platform and software adapted for the generic hardware platform. Thus, NFV creates a network much more flexible and dynamic than a legacy communication network. In NFV-based networks, a Virtual Network Function (VNF) decouples the software implementation of the network function from the infrastructure resources it runs on by virtualization. A network service is based on one or VNFs and/or Physical Network Functions (PNFs), their interconnections, and chaining definitions. The VNFs can be executed on almost any generic hardware processing facility. Therefore, VNFs may be installed, removed, and moved between hardware facilities, much more easily, less costly and thus, more frequently.

The flexibility of the NFV-based network enhances the means available for optimizing the network's capacity and performance. However, current techniques for orchestration of such network resources are limited.

There is thus a need for addressing these and/or other issues associated with the prior art.

SUMMARY

A system, method, and computer program product are provided for generating an orchestration data tree utilizing a Network Function Virtualization Orchestrator (NFV-O) data model. In use, an NFV-O data model is identified, the NFV-O data model being associated with an NFV-O module corresponding to a communication network. Additionally, an orchestration data tree template is generated utilizing the NFV-O data model, the orchestration data tree being utilized to support orchestration of a plurality of services associated with the communication network, and the orchestration data tree template capable of including: a plurality of nodes, each of the nodes representing one of the plurality of services associated with the communication network; a plurality of node relations, each of the plurality of node relations representing a relation of a parent node and a sub-node; a plurality of links, each of the plurality of links defining a relationship between two of the plurality of nodes; and a plurality of connectors, each of the plurality of connectors being associated with one of the plurality of nodes and functioning to connect to one of the plurality of links.

BRIEF DESCRIPTION OF THE DRAWINGS

FIG. 1 illustrates a method for generating an orchestration data tree utilizing a Network Function Virtualization Orchestrator (NFV-O) data model, in accordance with one embodiment.

2

FIG. 2 illustrates a simplified diagram of a system associated with an NFV-based communication network, in accordance with one embodiment.

FIG. 3 illustrates a simplified block diagram of a hardware unit of an NFV-based network, in accordance with one embodiment.

FIG. 4 illustrates a simplified diagram of an NFV management system, in accordance with one embodiment.

FIG. 5 illustrates a simplified diagram of a deployed NFV-based network, in accordance with one embodiment.

FIG. 6 illustrates an example of an orchestration service graph, in accordance with one embodiment.

FIG. 7 illustrates an example of an orchestration data tree generated utilizing a NFV-O data model, in accordance with one embodiment.

FIG. 8 illustrates a network architecture, in accordance with one possible embodiment.

FIG. 9 illustrates an exemplary system, in accordance with one embodiment.

DETAILED DESCRIPTION

FIG. 1 illustrates a method **100** for generating an orchestration data tree utilizing a Network Function Virtualization Orchestrator (NFV-O) data model, in accordance with one embodiment.

As shown, an NFV-O data model is identified. See operation **102**. The NFV-O data model is associated with an NFV-O module corresponding to a communication network. The communication network may include a Network Function Virtualization based (NFV-based) network, a hybrid NFV-based/physical network, and a physical network.

Additionally, an orchestration data tree template is generated utilizing the NFV-O data model. See operation **104**. The orchestration data tree template is capable of being utilized to support orchestration of a plurality of services associated with the communication network.

Further, the orchestration data tree template capable of including: a plurality of nodes, each of the nodes representing one of the plurality of services associated with the NFV-based communication network; a plurality of node relations, each of the plurality of node relations representing a relation of a parent node and a sub-node; a plurality of links, each of the plurality of links defining a relationship between two of the plurality of nodes; and a plurality of connectors, each of the plurality of connectors being associated with one of the plurality of nodes and functioning to connect to one of the plurality of links.

The orchestration data tree template may include any template capable of being used to generate an orchestration data tree for use by an NFV-O to support orchestration of a plurality of services associated with the communication network.

With further reference to FIG. 1, the plurality of nodes may represent any number of services or portions of services. For example, in one embodiment, at least one of the plurality of nodes may represent at least a portion of one or more a virtual network services associated with the communication network. Additionally, in one embodiment, at least one of the plurality of nodes may represent at least a portion of one or more virtual network functions (VNFs) associated with the communication network. In another embodiment, at least one of the plurality of nodes may represent an auxiliary service associated with the communication network. Still yet, the plurality of nodes may describe one or more key performance indicators (KPIs) associated with Big Data Analytics.



The orchestration data tree template may be further utilized to support a plurality of life cycle events associated with the communication network. In this case, each node (or a portion of nodes) may be associated with one or more of the plurality of life cycle events. In this case, the lifecycle events may be associated with a variety of criteria.

For example, each of the plurality of life cycle events may be associated with an eligibility condition. In this case, the eligibility condition may include lifecycle state of a corresponding node. As another example, the eligibility condition may include a lifecycle state of a parent node. As another example, the eligibility condition may include a lifecycle state of a child node. As another example, the eligibility condition may include a lifecycle state of a linked node. An adjacent node may include itself, a parent node, a child node, and a linked node. As another example, the eligibility condition may include a lifecycle state of at a portion of a plurality of children nodes. Of course, the lifecycle condition may include any combinations of these conditions. Additionally, the life cycle events may perform orchestration tasks, reading or writing data from nodes, or include data that can be state, inventory, and input or output parameters.

In another embodiment, one or more of the plurality of nodes may include contextual information capable of being utilized for making policy decisions. The contextual information may include any information associated with a node and/or associated service. Additionally, the contextual information may be a portion of contextual information that is associated with another node. In one embodiment, the contextual information for at least one child node may be derived or obtained from a parent node.

Additionally, in one embodiment, each of the plurality of nodes may include a list of attributes that need to be determined based on a policy decision. The list of attributes may include any attributes that are determined by various policies. Such attributes may be associated with node and/or service characteristics.

Further, in one embodiment, the method **100** may include determining a number of instances to include in a fully instantiated orchestration data tree associated with the orchestration data tree template. This determination may be made based on various policy decisions, service level agreements, and/or various other information.

The data model used to generate the orchestration data tree template may include various information capable of being used to generate the template. For example, the data model may include a plurality of policy decision rules that are associated with one or more nodes or attributes corresponding to the one or more nodes. The policy decision rules may include any number of applicability conditions. The applicability conditions may be utilized to indicate relevance of a particular rule associated a node or attribute, etc.

Additionally, the policy decision rules may be associated with one or more actions or computation decisions. For example, a decision associated with policy may be made based on current contextual information, etc.

With further reference to FIG. 1, in one embodiment, the method **100** may include generating a fully instantiated orchestration data tree utilizing the orchestration data tree template. In this case, the fully instantiated orchestration data tree may be used by the NFV-O to provide run-time orchestration for a plurality of services associated with the communication network.

In the context of the present description, the terms “network” and “communication network” refer to the hardware

and software connecting one or more communication elements including wireline networks, wireless networks, and/or combinations thereof.

The terms “network function virtualization” (NFV) and virtual network function (VNF) are described in a series of documents published by the European Telecommunications Standards Institute (ETSI) and available from the ETSI website. The term “virtual network function or feature” (VNF) refers to a particular implementation of a function, a feature, or a service provided by the network, internally within the network, or externally to a customer, subscriber, end-user, a terminal or a server. A VNF may include the software program implementation of the function or feature or service. The term VNF instance (VNF-I) refers to a particular process or task executing the VNF program by a particular virtual machine or processor or computing facility and/or used by a particular customer (or subscriber, end-user, terminal or server, etc.).

The term “service” refers to any type of use (such as a use case) that a NFV-based communication network may offer or provide to one or more communication elements. A service may include switching data or content between any number of elements, providing content from a server to a communication element or between servers, securing and protecting communication and content, processing content provided by the customer or by a third party, providing backup and redundancy, etc. A service may be using partial functionality of a VNF or may include one or more VNFs and/or one or more VNF instances forming a service sub-network (or interconnection model). In the context of the present description, the term “chain” may refer to such service sub-network, such as a particular plurality of VNFs and/or VNF instances associated with a particular service type or a service instance.

The term “deployment”, when referring to hardware elements, including processing elements, memory elements, storage elements, connectivity (communication) elements, etc., refer to the configuration or topology of these hardware elements creating the NFV-based network. The term “deployment”, when referring to software elements, such a VNFs and VNF instances, refers to the association between such software elements and hardware elements.

The term “deployment optimizations” refers to association of software and hardware elements in a manner that satisfies a particular set of requirements and/or rules, such as load-related and performance-related requirements, or a manner that makes a better use of a particular hardware deployment, such as by reducing operational cost.

The terms “service deployment optimization”, or “service optimization” or “chain optimization” refer to optimizing the deployment of a service chain, i.e., optimizing the deployment of one or more VNF instances making a particular service. The terms chain optimization and service optimization may thus be used interchangeably.

The term “session” refers to a communication connection between two or more entities that persists for a period of time during which data may be exchanged there between. A session may be implemented and managed by a session layer in the corresponding network protocol. The term session may include a network session and a logical session. The network session may be associated with the devices used to communicate, while the logical session may be associated with the communicating parties (users) and may persist regardless of the communication means that the parties are using.

The term “service continuity” includes and applies to the terms “session continuity” and “streaming continuity”.



Streaming refers to streaming media, session or service, such as sound (including voice), video, multimedia, animation, etc. The term service usually applies to a group of VNFs (or the functionality provided by the group of VNFs) but may also apply to a single VNF (or the functionality provided by the VNF). The term “continuity” indicates that the session or the service is not interrupted, or that an interruption is short enough that a user is not aware of such interruption, or that the interruption does not cause any loss of data, or that the loss is handled in acceptable manner (e.g. a few packets of speech lost, but the conversation can continue, etc.).

The term “availability” or “service availability” refers to a level of the service, or a characteristic of the service, in which the service provider should provide the service, albeit possible hardware or software faults. For example, the service provider may obligate to the customer to provide a particular level of processing power, communication features such as bandwidth, latency, and jitter, database consistency, etc. Such level or characteristic of the service should be available to the customer even when a hardware component or a software component providing the service do not function properly. Providing availability may therefore require additional resources such as backup resources and/or mirroring. Hence “availability” may also refer to the terms “fault recovery” and “redundancy”.

The term “fault recovery” refers to the process of recovering one or more of the network’s services, functions, and features after a fault, whether caused by a hardware malfunction, a system crash, a software bug or a security breach or fault. A hardware malfunction includes, but is not limited to, any type of inadequate performance associated with, for example, power supply, processing units, memory, storage, transmission line, etc. The term “fault recovery” also applies to recovering the functionality of one or more VNFs or VNF instances with respect to any of the above. The terms security breach or security fault may be used interchangeably.

The term “redundancy” refers to any type of component of the network that is fully or partly duplicated, provided in standby mode, or otherwise available, to replace another component of the network when that other component stops functioning properly or otherwise indicates some kind of fault. Redundancy may apply, but is not limited to, hardware, software, data and/or content.

More illustrative information will now be set forth regarding various optional architectures and uses in which the foregoing method may or may not be implemented, per the desires of the user. It should be strongly noted that the following information is set forth for illustrative purposes and should not be construed as limiting in any manner. Any of the following features may be optionally incorporated with or without the exclusion of other features described.

The principles and operation of a system, method, and computer program product for generating an orchestration data tree according to various embodiments may be further understood with reference to the following drawings and accompanying description.

FIG. 2 illustrates a simplified diagram of a system 200 associated with an NFV-based communication network 210, in accordance with one embodiment. As an option, the system 200 may be implemented in the context of the details of FIG. 1. Of course, however, system 200 may be implemented in the context of any desired environment. Further, the aforementioned definitions may equally apply to the description below.

As shown in FIG. 2, at least one NFV-based network 210 is provided. The NFV-based communication network 210 includes an NFV management system 2111, an NFV-orchestration (NFV-O) module 212, and a template creation module 213, according to one embodiment.

In the context of the present network architecture, the NFV-based network 210 may take any form including, but not limited to a telecommunications network, a local area network (LAN), a wireless network, a wide area network (WAN) such as the Internet, peer-to-peer network, cable network, etc. While only one network is shown, it should be understood that two or more similar or different NFV-based networks 210 may be provided.

The NFV-based network 210 may include one or more computation facilities 214, each including one or more hardware units and being interconnected by communication links to form the NFV-based network 210. At least one of the computation facilities 214 may include the NFV management system 211. The NFV management system 211 may include the NFV-O module 212 and the template creation module 213.

The NFV-O module 212 may be executed by one or more processors, or servers, such as computation facilities 214, of the NFV-based network 210. The NFV-O module 212 may be executed as an NFV-O instance or component. The NFV-O module 212 may therefore include a plurality of NFV-O instances or components as will be further explained below.

The template creation module 213 may be a part or a component of the NFV-O module 212. However, the template creation module 213, the NFV-O module 212 and the NFV management system 211 may be separate software programs provided by different vendors. In one embodiment, the NFV-based network 210 may even have a plurality of any of the NFV management systems 211, the NFV-O modules 212, and/or the template creation module 213.

A plurality of devices 215 are communicatively coupled to the NFV-based network 210. For example, a server computer 216 and a computer or terminal 217 may be coupled to the NFV-based network 210 for communication purposes. Such end-user computer or terminal 217 may include a desktop computer, a lap-top computer, a tablet computer, and/or any other type of logic or data processing device. Still yet, various other devices may be coupled to the NFV-based network 210 including a personal digital assistant (PDA) device 218, a mobile phone device 219, a television 220 (e.g. cable, aerial, mobile, or satellite television, etc.), etc. These devices 215 may be owned and/or operated by end-users, subscribers and/or customers of the NFV-based network 210. Others of the devices 215, such as administration station 221, may be owned and/or operated by the operator of the NFV-based network 210.

A network administrator 222 may supervise at least some aspects of the operation of the NFV-based network 210 by controlling an NFV infrastructure including the NFV management system 211, the NFV-O 212, and the template creation module 213.

FIG. 3 illustrates a simplified block diagram 300 of a hardware unit 323 of an NFV-based network, in accordance with one embodiment. As an option, the block diagram 300 may be viewed in the context of the details of the previous Figures. Of course, however, block diagram 300 may be viewed in the context of any desired environment. Further, the aforementioned definitions may equally apply to the description below.

In one embodiment, the hardware unit 323 may represent a computing facility 214 of FIG. 2, or a part of a computing



facility **214**. The hardware unit **323** may include a computing machine. The term computing machine relates to any type or combination of computing devices, or computing-related units, including, but not limited to, a processing device, a memory device, a storage device, and/or a communication device.

The hardware unit **323** may therefore be a network server, and the computing facility **214** may be a plurality of network servers, or a data-center, including cloud-based infrastructure. As an option, the hardware unit **323** may be implemented in the context of any of the devices of the NFV-based network **210** of FIG. 2 and/or FIG. 5 and in any desired communication environment.

Each hardware unit **323** (or computing machine, computing device, computing-related unit, and/or hardware component, etc.), including each communication link between such hardware units, may be associated with one or more performance type and a respective performance rating or value, where the hardware unit and/or communication link is operative to provide the performance value. Performance types are, for example, processing power, cash memory capacity, regular memory capacity (e.g. RAM, dynamic, or volatile memory, etc.), non-volatile memory (e.g. such as flash memory, etc.) capacity, storage capacity, power, cooling, bandwidth, bitrate, latency, jitter, bit error rate, and packet loss, etc. Virtual machines may run on top of the hardware unit **323** and a VNF may be run on one or more of such virtual machines.

The hardware unit **323** may be operative to provide computing infrastructure and resources for any type and/or instance of software component executed within the NFV-based network **210** of FIG. 2. In this regard, the hardware unit **323** may be operative to process any of the processes described herein, including but not limited to, any NFV-related software component and/or process. The hardware unit **323** is operative to process virtual network functions (VNFs), VNF instances, network function virtualization orchestration (NFV-O) software, modules and functions, data center management software, and/or cloud management systems (CMS), etc.

In various embodiments, the hardware unit **323** may include at least one processor unit **324**, one or more memory units **325** (e.g. random access memory (RAM), a non-volatile memory such as a Flash memory, etc.), one or more storage units **326** (e.g. including a hard disk drive and/or a removable storage drive, representing a floppy disk drive, a magnetic tape drive, a compact disk drive, etc.), one or more communication units **327**, one or more graphic processors **328** and displays **329**, and one or more communication buses **330** connecting the various units/devices.

The hardware unit **323** may also include one or more computer programs **331**, or computer control logic algorithms, which may be stored in any of the memory units **325** and/or storage units **326**. Such computer programs, when executed, enable the hardware unit **323** to perform various functions (e.g. as set forth in the context of FIG. 1, etc.). The memory units **325** and/or the storage units **326** and/or any other storage are possible examples of tangible computer-readable media.

It is appreciated that computer program **331** may include any of the NFV management system **211**, the NFV-O **212**, and/or the template creation module **213** of FIG. 2.

FIG. 4 illustrates a simplified diagram of an NFV management system **411**, in accordance with one embodiment. As an option, the NFV management system **411** may be implemented in the context of the details of the previous Figures. For example, in one embodiment, the NFV man-

agement system **411** may represent the NFV management system **211** of FIG. 2. Of course, however, the NFV management system **411** may be implemented in the context of any desired environment. Further, the aforementioned definitions may equally apply to the description below.

In one embodiment, the NFV management system **411** may include an NFV-O module **412**, and a template creation module **413**. The NFV management system **411** may include one or more NFV-O modules **412**. In various embodiments, each of the NFV-O modules **412** may include orchestration and workflow management **432** that is responsible for managing (i.e. orchestrating) and executing all NFV-O processes, including inbound and/or outbound communication and interfaces.

The NFV management system **411** may include a deployment optimization module **433** that enables a user to devise automatic mechanisms for network optimizations. The deployment optimization module **433** may operate these mechanisms automatically and continuously to optimize the distribution of VNFs **450** and their VNF instances in real-time (or near-real-time) by migrating VNFs **450** and VNF instances (e.g. VNF instances **551** of FIG. 5, etc.) between hardware units (e.g. hardware units **551** of FIG. 5, etc.).

The NFV management system **411** may also include a chain optimization module **434**. The chain optimization module **434** may be a part of deployment optimization module **433** and may enable a user to devise automatic mechanisms for optimizing the deployment of chains or groups of VNFs **450** and VNF instances. A service provided by an NFV-based network is typically made of a particular chain or group of particular VNFs **450** and their respective VNF instances. The chain optimization module **434** optimizes the deployment of chains or groups of services between hardware units according to the requirements and specifications associated with and/or adapted to the particular service, or chain, or a group.

The chain optimization module **434** may operate these mechanisms automatically and continuously to optimize in real-time the operation of chains or groups of the VNFs **450** and their VNF instances by re-planning their distribution among hardware units and optionally also by migrating the VNFs **450** and associated VNF instances between hardware units.

The NFV management system **411** may also include a service fulfillment module **435** that manages service and resource (e.g. VNF) instance lifecycle activities as part of the process and orchestration activities. This may include onboarding, initiation (e.g. instantiation), installation and configuration, scaling, termination, software update (e.g. of a running VNF, etc.), test environment, and/or rollback procedure. Additionally, the service fulfillment module **435** may also provide decomposition of an order to multiple network services, and the activation of such network service as a single VNF instance, or as a chain of VNF instances.

Order decomposition includes translating business orders into a network oriented service implementation plan. For example, a business order may be decomposed into a plurality of functions, some of which may be provided by different software programs or modules (e.g. such as various VNFs) instantiated as a plurality of VNF instances across one or more data centers. Performing order decomposition, the service fulfillment module **435** may consult the deployment optimization module **433** for the best deployment option to customer order in a given network and resource condition. Performing order decomposition, the service fulfillment module **435** may then initiate the service including all its components. Order decomposition may be performed



in several locations across an NFV-O hierarchy. For example, initial decomposition may be performed in the root of the NFV-O, and then further decomposition may be performed in the relevant data centers.

In one embodiment, an activation and provisioning module may provide the plan for activation and provisioning of the service to the orchestration and workflow management **432**. The activation and provisioning module may also provide feedback on fulfillment status to an upper layer. This upper layer may include the business support services (BSS).

The NFV management system **411** may also include an assurance module **436** and a service management module **452** capable of gathering real time data on network elements' status and creating a consolidated view of services and network health. The assurance module **436** includes assurance functionality and may interact with the service management module **452** to perform assurance related lifecycle management procedures. Lifecycle management can be also triggered by other modules, policies, manual intervention, or from the VNFs themselves, etc. The assurance module **436** and the service management module **452** may also trigger events associated with lifecycle management and faults. The assurance module **436** and the service management module **452** may monitor the health of the network and may execute fault recovery activities.

The assurance module **436** and the service management module **452** provide the ability to monitor services' status and performance according to the required criteria. The assurance module **436** and the service management module **452** may also interact with the network infrastructure (e.g. including computing, storage, and networking, etc.) to receive the required information, analyze the information, and act upon each incident according to the defined policy. The assurance module **436** and the service management module **452** are able to interact with analytics to enrich a policy assurance module. Interfaces may also be provided for implementation by an external system.

The NFV management system **411** may also include a policy management module **437** that enables a user to define and configure offline and/or real-time policy for controlling VNF and service related rules. The policy management module **437** may contain the preconfigured policies and activities as well as selection rules for the NFV-O process to determine the preferred policy or activity to be performed for a particular process event. The policy management may be multi-layered, including vendor policy, service policy, and operator policy, etc. The policy mechanism may trigger the suitable policy layer (vendor/service/operator).

The NFV management system **411** may also include an administration module **438** that provides an overall view of the network, manual lifecycle management and intervention, and manual system administration and configuration. The administration module **438** may be operable to enable a user such as an administrator (e.g. administrator **222** of FIG. 2, etc.) to manage, view, and operate the NFV-O system. The administration module **438** may also provide a view of the network topology and services, the ability to perform specific activities such as manual lifecycle management, and changing service and connectivity configuration.

The NFV management system **411** may also include an inventory management module **439** that maintains a distributed view of deployed services and hardware resources. Inventory catalogues may reflect the current instantiation and allocation of the resources and services within the network mapped into products and/or customer entities.

The NFV management system **411** may also include a big data analytics module **440** that analyzes network and service data to support network decisions involving services and subscribers to improve network performance based on actual usage patterns. The big data analytics module **440** may also generate what-if scenarios to support business-oriented planning processes. Additionally, the big data analytics module **440** may function to analyze and evaluate the information for various planning aspects (e.g. Virtual Network Capacity Planning, Data Center Capacity Planning, Value based planning, Cost analysis for network deployment alternatives, etc.), deployment and management (e.g. Guided Operator Recommendations, What-if scenario analysis and simulation, application rapid elasticity and resource usage optimization, etc.), and may support business-oriented planning processes.

The NFV management system **411** may also include a catalog module **441** may include records defining various aspects of the network, such as products, services, and resources such as hardware units and VNFs (e.g. a VNF directory, etc.). The catalog module **441** may include a collection of centralized, hierarchical information repositories containing resource, service and product definitions with their relationship, versioning, and/or descriptors, etc. Such records may include templates enabling a user, such as an administrator, to define particular network components such as resources, products, services, etc. A resource template may define resources descriptors, attributes, activities, procedures, and/or connectivity, etc. A service template may define a service variation from resource building blocks. A product template may define parameters of a sellable product (e.g. prices, rating, etc.) based on service composition (e.g. in one embodiment, this may be part of a BSS catalogue).

The inventory management module **439**, the big data analytics module **440**, and/or the catalog module **441** may support multiple data centers, multiple CMSs and provide a centralized view across the infrastructure. The inventory management module **439**, the big data analytics module **440**, and/or the catalog module **441** may also support hybrid networks and services maintaining both physical and virtual resources.

The NFV management system **411** may also include an accounting and licensing module **442** that may be operable to record and manage network software usage data for commercial purposes including licensing, accounting, billing, and reconciliation of services with subscribers and providers. The accounting and licensing module **442** may manage licensing and usage of virtual network applications, including the ability to support complex rating schemes, based on various parameters such as CPU, memory, data, etc. The accounting and licensing module **442** may enable users to define the pricing of particular VNF modules and provide settlement with vendors. The accounting and licensing module **442** may also enable the evaluation of internal costs of services provided within the network for calculating return on investment (ROI).

The NFV management system **411** may also include a fault recovery module **443** (otherwise named disaster recovery planning module or DRP, etc.) that enables a user to plan and manage disaster recovery procedures for the NFV-O and/or the entire network.

The NFV management system **411** may also include a security management module **444** that provides the authentication authorization and accounting services of application security across the network. The security management module **444** may include, for example, an authentication module



and function. In one embodiment, the authentication module and function (e.g. including identity management, etc.) may authenticate the identity of each user defined in the system. Each user may have a unique user identity and password. The system may support password based authentication with flexible password policy. Integration with external authentication providers may be done via additional system enhancements. The authorization module and function may support a role-based access control (RBAC) mechanism, where each user is assigned with one or more roles according to the business needs based on the least privileges concept (e.g. standard or administrator roles). In one embodiment, the accounting and licensing module **442** may provide an audit of security events such as authentication or login events.

As an option, the security management module **444** may use rules to protect sensitive information. For example, such rules may be used to ensure the data accessed is used for the specific purposes for which it was collected, sensitive information is encrypted when in storage/transit and masked/truncated on display and logs, and that the entire security system is deployed in the customer's intranet network (i.e. behind network/infrastructure measures), in an independent domain, etc.

In one embodiment, the NFV management system **411** may further include a Secure Development Life Cycle (SDLC) module that ensures that security aspects are handled during a project's life cycle, such as security design, security testing, etc.

As shown further in FIG. 4, the NFV management system **411** may include a service planning module **445**. The service planning module **445** may be used by a communication service provider (CSP) sales representative, enterprise, and/or technician, as part of selling engagement process with enterprise/SMB customers.

The service planning module **445** may also provide the ability to interact with catalogues, customer data, network and ordering systems to provide online network service proposals for the enterprise customers with ability to quote update the proposal, validate the serviceability and network inventory, and once done, provide the service order for activation using the northbound interface.

The template creation module **413** may also be part of the NFV-O module **412**. The template creation module **413** is operable to: identify a NFV-O data model; and generate an orchestration data tree template utilizing the NFV-O data model, where the orchestration data tree template is capable of being utilized to support orchestration of a plurality of services associated with the communication network, and the orchestration data tree template is capable of including: a plurality of nodes, each of the nodes representing one of the plurality of services associated with the communication network; a plurality of node relations, each of the plurality of node relations representing a relation of a parent node and a sub-node; a plurality of links, each of the plurality of links defining a relationship between two of the plurality of nodes; and a plurality of connectors, each of the plurality of connectors being associated with one of the plurality of nodes and functioning to connect to one of the plurality of links.

The NFV management system **411** may also include east/west APIs **446** that include various domains/activities interfaces, including an information source to a big data repository, and interaction capability with a physical network system (OSS).

Northbound APIs **447** provides application programming interfaces (APIs) to various external software packages,

such as business support system (BSS) for service order fulfillment, cancel and update activities, status notification, resource inventory view, monitoring system, assurance system, service planning tool, administration tool for system view and configuration, and big data repository, etc.

Further, the southbound APIs **448** may provide APIs for external software packages, such as CMS (including service and VNFs lifecycle activities—receiving from the infrastructure status and monitoring information for upstream system and activities [e.g. assurance]), an SDN Controller (or other connectivity system) to configure inter and intra data center connectivity, an EMS to configure the VNF, and a VNF for a direct configuration.

FIG. 5 illustrates a simplified diagram **500** of a deployed NFV-based network **510**, in accordance with one embodiment. As an option, the diagram **500** may be viewed in the context of the details of the previous Figures. For example, in one embodiment, the deployed NFV-based network **510** and associated elements may represent the NFV-based networks and associated elements described in the context of the previous Figures. Of course, however, the diagram **500** may be viewed in the context of any desired environment. Further, the aforementioned definitions may equally apply to the description below.

As shown in FIG. 5, the NFV-based network **510** may include hardware units **523** connected via transmission lines **549**, and VNFs implemented as software programs **550** installed in hardware units **523**. Some of the hardware units **523** may be directly connected to a customer. The customer may be a subscriber, an end-user, or an organization, represented herein as a terminal or a server **552**, or a plurality of terminals and/or servers **552**. The NFV-based network **510** may also include a NFV management system **511**, an NFV-orchestration (NFV-O) **512**, and a template creation module **513** (which may all represent elements described in the context of the previous figures, etc.).

As shown further in FIG. 5, several, typically different, VNFs **550** may be installed in the same hardware unit **523**. Additionally, the same VNF **550** may be installed in different hardware units **523**.

A VNF **550** may be executed by a processor of the hardware unit **523** in the form of a VNF instance **551**. Therefore, a particular VNF **550** installed in a particular hardware unit **523** may be “incarnated” in (e.g. initiated, executed as, etc.) any number of VNF instances **551**. The VNF instances **551** may be independent of each other. Additionally, each VNF instance **551** may serve different terminals and/or servers **552**. The NFV-based network **510** connects to and between communication terminal devices **552** that may be operated by one or more customers, subscribers, and/or end-users.

It is appreciated that a network operator may manage one or more services deployed in the customer's premises. Therefore, some of the hardware units **523** may reside within the premises of the network operator, while other hardware units **523** may reside in the customer's premises. Similarly, a server, such as server computer **216** of FIG. 2, may reside in the premises of the network operator or in the customer's premises. Consequently, when the network operator provides and/or manages one or more services for a customer's terminal devices **552** such as a server computer, the NFV-based network **510** of the network operator may directly manage the VNFs **550**, providing the services and their VNF instances **551**.

In such situation, the NFV-based network **510** may manage the services irrespectively of the location of the terminal devices **552** (e.g. the server computer **216**, etc.), whether in



the premises of the network operator or in the customer's premises. In other words, the NFV-based network **510** may be managing the VNFs **550** and the VNF instances **551** providing the services, as well as the terminal devices **552** (e.g. the server computer **216**, etc.) being co-located within the same computing device (e.g. the hardware unit **523**, etc.), whether in the premises of the network operator or in the customer's premises or in a commercial cloud or any other place.

A service provided by the communication network may be implemented using one or more VNFs. For example, the service may be a group, or a chain of interconnected VNFs. The VNFs making the group, or the service, may be installed and executed by a single processor, by several processors on the same rack, within several racks in the same data-center, or by processors distributed within two or more data-centers. In some cases, chain optimization may be employed by optimizing the deployment of a service in a communication network using network function virtualization, and to optimizing the deployment of a group, or a chain, of virtual network functions in the NFV-based network **510**. Therefore, the term "chain optimization" refers to the planning and/or managing of the deployment of VNFs making a chain, or a group, of VNFs providing a particular service.

For example, FIG. **5** shows a first service **553**, including the VNFs **550** and their respective VNF instances **554**, **555**, **556**, and **557**, and a thick line. In this example, the group or chain of the VNFs **550** making first service **553** are connected as a chain of VNFs **550**. However, the VNFs **550** making a service may be connected in any conceivable form such as a star, tree-root, tree-branch, mesh, etc., including combinations thereof. It is noted that the VNFs **550** may be executed by two or more VNF instances **551**, such as VNF **554**.

The deployment of the group or chain of the VNFs **550** making the first service **553** is therefore limited by constraints such as the capacity of the communication link **549** bandwidth and/or latency (delay).

A VNF may have a list of requirements, or specifications, such as processing power, cash memory capacity, regular memory capacity (e.g. RAM, dynamic, or volatile memory, etc.), non-volatile memory (e.g. such as flash memory, etc.) capacity, storage capacity, power requirements, cooling requirements, etc. A particular VNF instance **551** providing a particular function (e.g. to a particular customer, entity, etc.) may have further requirements, or modified requirements, for example, associated with a particular quality of service (QoS) or service level agreement (SLA). Such requirements may include maximum latency or delay, average latency and maximum variance (latency jitter), maximal allowed packet loss, etc. Other requirements may include service availability, redundancy, backup, provisions for roll-back and/or recovery, fault-tolerance, and/or fail-safe operation, etc.

A service made of a chain or a group of VNFs **550** and their VNF instances **551** may have a similar list of requirements, or specifications, covering the service as a whole. Therefore, such requirements, or specifications, may imply, affect, or include, requirements, or specifications, regarding communication links between the VNFs **550** and/or the VNF instances **551**. Such requirements, or specifications, may include bandwidth, latency, bit-error rate, and/or packet loss, etc. Such communication requirements or specifications may further impose deployment limitations, or constraints, requiring particular VNFs **550** and/or VNF instances **551** to reside in the same data-center, or within the same rack, or even in the same computing device, for example, sharing

memory or being executed by the same processor. Security measures may add further requirements, or specifications, such as co-location of some of the VNFs **550** and/or the VNF instances **551**.

In the context of FIG. **5**, the NFV-based network **510** has a hierarchical structure. There may be at least four aspects of the hierarchical structure of the NFV-based network **510**. The networking or traffic aspect refers to the arrangement of the transmission lines between the hardware units **523**. The processing aspect refers to the arrangement of the hardware units **523**. The software aspect refers to the arrangement of the VNFs **550**. The operational aspect refers to the arrangement of the VNF instances **551**.

One aspect of the optimization process in an NFV-based network is that it may be based on real-time needs, rather than long-term, statistically anticipated, needs. One potential limitation on network reconfiguration in NFV-based networks is that network configuration does not result in a deterioration beyond acceptable level of any of the current services. The NFV deployment module (e.g. module **433** of FIG. **4**, etc.) may function to enable and manage migration of services between the hardware units **523**, the VNFs **550**, and the VNF instances **551** in real-time, without affecting or with a minimal effect on the availability of a service, and while securing service and session continuity.

In the context of the current description, the term "continuous" means that the deployment optimization module and/or a chain optimization module (e.g. the chain optimization module **434** of FIG. **4**, etc.) performs the relevant optimization task or process in run-time, or real-time, or online, or on-the-fly, or repetitively and without adversely affecting the network's functionality and its services.

Unlike a legacy network, the NFV-based network may have two topologies: the topology of the hardware devices, and the topology of the VNFs (the distribution of VNFs among the hardware devices). The topology of the hardware network is relatively stable, while the VNF topology can be optimized in real-time. Another benefit of the NFV-based network is that modifying the software topology (e.g. the distribution of VNFs among the hardware devices) is much less costly than any modification of the hardware topology. However, any modification of the network has its cost, including the cost of making such modification possible. Added cost may result from the need to process the modification of the topology and the re-distribution of VNF instances and to maintain excess resources for such purpose.

Thus, in some cases, it may be desired to localize the NFV-O **512**, and particularly the deployment optimization processes associated with the deployment optimization module and the chain optimization module to reduce the cost, and simultaneously to secure the possibility to expand the scope of the network managed by these processes, if needed.

FIG. **6** illustrates an example **600** of an orchestration service graph, in accordance with one embodiment. As an option, the example **600** may be implemented in the context of the details of the previous Figures. Of course, however, the example **600** may be implemented in the context of any desired environment. Further, the aforementioned definitions may equally apply to the description below.

The example **600** shows an orchestration service graph, in accordance with one embodiment. As shown, the orchestration service graph includes a plurality of nodes with connectors, and links between the nodes. Moreover, the orchestration service graph illustrates that nodes may include a plurality of other nodes, including connectors and links.



FIG. 7 illustrates an example 700 of an orchestration data tree generated utilizing a NFV-O data model, in accordance with one embodiment. As an option, the example 700 may be implemented in the context of the details of the previous figures. Of course, however, the example 700 may be implemented in the context of any desired environment. Further, the aforementioned definitions may equally apply to the description below.

Using an NFV-O data model, an orchestration tree may be defined, which supports the orchestration of any network service, life cycle events such as instantiation, scaling, and shutdown, etc.

The main elements in the data model orchestration tree include nodes, node relations, connectors, links, policies, work flows, and dynamic profiles.

The orchestration tree contains a plurality of nodes. The nodes may represent any type of service in the tree. The services may be a network service, VNF, VNFC, client services, and/or server services, etc. The nodes may have relations to other nodes that represent a service that is composed of sub services.

Any number of service hierarchies may be supported. The low level in the tree will be a node without sub nodes. The data on the node may be static, driven from the parent node or from a policy engine.

Node Relations represent the relation between a node and a sub node. This element includes mapping functionally between the parent node to a child node, which may be simple, such as a copy, or complicated, such as an 'on the fly' expression. A node attribute may be a function of a node and its attributes (e.g. node attribute=f(Node B, attribute 1, attribute 2, . . .)).

The connectors represent the node "leg". Each node has connectors. The upper node that is composed of these nodes is responsible for making the link between the composed nodes using these connectors. In various embodiments, the connector may be a network (vNIC) or a logical connector.

The links represent the relationships between nodes in the tree. The links may be a network link or a logical link, such as a chain link. The links may be defined between a source node and connector and a target node and connector. The links may include mapping functionally between the link source and target. The links may be defined between parent and child nodes, or between "brother" nodes.

Each node may also include policies for different behaviors. For example, the nodes may include policy rules for scale in/out of the node, policy rules for data setting, such as selecting data center based on different parameters, etc.

Each node may also include states (e.g. init and config states, etc.), work flows that includes activities that need to be run for that node state, and definitions of what will be the next state. There may also be dependencies between different work flows from different nodes. The work flow activities may include activities that will create and maintain the service in run-time.

The orchestration tree may also include all optional nodes. For example, while building the run-time tree, each node may have a quantity between 0 to N (where N is a positive integer). The service needs to have connectivity if a node is added or removed during run-time due to different events.

The service may also be elastic. For example, the quantity of a node B may be defined on the relation between node A to node B, as part of the node A definition. The quantity may have static values due to the network service graph limitation, or policy driven. In other words, the quantity may be changed in run-time due to scaling events and any other

events. Each time the value of the quantity may come from the policy engine based on the system state.

The core data model used in the NFV-O is very small and powerful yet it incorporates all the necessary information and functionality for supporting the separation of roles and isolation of policy to a single question at a time (where the policy server has all the relevant knowledge needed to make service wide decisions without having any specific understanding of the service design/orchestration tree, nor any domain expertise in specific networking area).

FIG. 8 illustrates a network architecture 800, in accordance with one possible embodiment. As shown, at least one network 802 is provided. In the context of the present network architecture 800, the network 802 may take any form including, but not limited to a telecommunications network, a local area network (LAN), a wireless network, a wide area network (WAN) such as the Internet, peer-to-peer network, cable network, etc. While only one network is shown, it should be understood that two or more similar or different networks 802 may be provided.

Coupled to the network 802 is a plurality of devices. For example, a server computer 804 and an end user computer 806 may be coupled to the network 802 for communication purposes. Such end user computer 806 may include a desktop computer, lap-top computer, and/or any other type of logic. Still yet, various other devices may be coupled to the network 802 including a personal digital assistant (PDA) device 808, a mobile phone device 810, a television 812, etc.

FIG. 9 illustrates an exemplary system 900, in accordance with one embodiment. As an option, the system 900 may be implemented in the context of any of the devices of the network architecture 800 of FIG. 8. Of course, the system 900 may be implemented in any desired environment.

As shown, a system 900 is provided including at least one central processor 901 which is connected to a communication bus 902. The system 900 also includes main memory 904 [e.g. random access memory (RAM), etc.]. The system 900 also includes a graphics processor 906 and a display 908.

The system 900 may also include a secondary storage 910. The secondary storage 910 includes, for example, a hard disk drive and/or a removable storage drive, representing a floppy disk drive, a magnetic tape drive, a compact disk drive, etc. The removable storage drive reads from and/or writes to a removable storage unit in a well-known manner.

Computer programs, or computer control logic algorithms, may be stored in the main memory 904, the secondary storage 910, and/or any other memory, for that matter. Such computer programs, when executed, enable the system 900 to perform various functions (as set forth above, for example). Memory 904, storage 910 and/or any other storage are possible examples of tangible computer-readable media.

While various embodiments have been described above, it should be understood that they have been presented by way of example only, and not limitation. Thus, the breadth and scope of a preferred embodiment should not be limited by any of the above-described exemplary embodiments, but should be defined only in accordance with the following claims and their equivalents.

What is claimed is:

1. A method, comprising: identifying a Network Function Virtualization Orchestrator (NFV-O) data model, the NFV-O data model being associated with an NFV-O corresponding to a communication network; and generating an orchestration data tree template utilizing the NFV-O data model, the



orchestration data tree template being utilized to support orchestration of a plurality of services associated with the communication network, and the orchestration data tree template including: a plurality of nodes, each of the nodes representing one of the plurality of services associated with the communication network; a plurality of node relations, each of the plurality of node relations representing a relation of a parent node and a child sub-node, wherein the plurality of node relations are a function of a node attribute representing a relation of the parent node and the child sub-node; a plurality of links, each of the plurality of links defining a relationship between two of the plurality of nodes; and a plurality of connectors, each of the plurality of connectors being associated with one of the plurality of nodes and functioning to connect one of the plurality of links to the one of the plurality of nodes.

2. The method of claim 1, wherein at least one of the plurality of nodes represents at least a portion of one or more a virtual network services associated with the communication network.

3. The method of claim 1, wherein at least one of the plurality of nodes represents at least a portion of one or more virtual network functions (VNFs) associated with the communication network.

4. The method of claim 1, wherein at least one of the plurality of nodes represents an auxiliary service associated with the communication network.

5. The method of claim 1, wherein the orchestration data tree template is further utilized to support a plurality of life cycle events associated with the communication network, each node being associated with one or more of the plurality of life cycle events, the life cycle events being associated with performing one or more of orchestration tasks, reading or writing data from nodes, data that can be state, inventory, and input or output parameters.

6. The method of claim 5, wherein each of the plurality of life cycle events is associated with an eligibility condition.

7. The method of claim 6, wherein the eligibility condition includes a lifecycle state of a corresponding node.

8. The method of claim 6, wherein the eligibility condition includes a lifecycle state of a parent node.

9. The method of claim 6, wherein the eligibility condition includes a lifecycle state of a child node.

10. The method of claim 6, wherein the eligibility condition includes a lifecycle state of a linked node.

11. The method of claim 6, wherein the eligibility condition includes a lifecycle state of at least a portion of a plurality of children nodes.

12. The method of claim 1, wherein each of the plurality of nodes includes contextual information capable of being utilized for making policy decisions.

13. The method of claim 12, wherein the contextual information for at least one child node is derived or obtained from a parent node.

14. The method of claim 1, wherein each of the plurality of nodes includes a list of attributes that need to be determined based on a policy decision.

15. The method of claim 1, further comprising determining a number of instances of a node to include in a fully instantiated orchestration data tree associated with the orchestration data tree template.

16. The method of claim 1, wherein the data model includes a plurality of policy decision rules that are associated with one or more nodes or attributes corresponding to the one or more nodes.

17. The method of claim 16, wherein the plurality of policy decision rules include applicability conditions, the applicability conditions being utilized to indicate relevance of a particular rule associated a node or attribute.

18. The method of claim 16, wherein the plurality of policy decision rules are associated with one or more actions or computation decisions.

19. The method of claim 1, further comprising generating a fully instantiated orchestration data tree utilizing the orchestration data tree template.

20. A computer program product embodied on a non-transitory computer readable medium, comprising: computer code for identifying a Network Function Virtualization Orchestrator (NFV-O) data model, the NFV-O data model being associated with an NFV-O corresponding to a communication network; and computer code for generating an orchestration data tree template utilizing the NFV-O data model, the orchestration data tree template being utilized to support orchestration of a plurality of services associated with the communication network, and the orchestration data tree template including: a plurality of nodes, each of the nodes representing one of the plurality of services associated with the communication network; a plurality of node relations, each of the plurality of node relations representing a relation of a parent node and a child sub-node, wherein the plurality of node relations are a function of a node attribute representing a relation of the parent node and the child sub-node; a plurality of links, each of the plurality of links defining a relationship between two of the plurality of nodes; and a plurality of connectors, each of the plurality of connectors being associated with one of the plurality of nodes and functioning to connect one of the plurality of links to the one of the plurality of nodes.

21. A system comprising: a memory system; and one or more processing cores coupled to the memory system and that are each configured to: identify a Network Function Virtualization Orchestrator (NFV-O) data model, the NFV-O data model being associated with an NFV-O corresponding to a communication network; and generate an orchestration data tree template utilizing the NFV-O data model, the orchestration data tree template being utilized to support orchestration of a plurality of services associated with the communication network, and the orchestration data tree template including: a plurality of nodes, each of the nodes representing one of the plurality of services associated with the communication network; a plurality of node relations, each of the plurality of node relations representing a relation of a parent node and a child sub-node, wherein the plurality of node relations are a function of a node attribute representing a relation of the parent node and the child sub-node; a plurality of links, each of the plurality of links defining a relationship between two of the plurality of nodes; and a plurality of connectors, each of the plurality of connectors being associated with one of the plurality of nodes and functioning to connect one of the plurality of links to the one of the plurality of nodes.