



US009405088B2

(12) **United States Patent**
Hayashi et al.

(10) **Patent No.:** **US 9,405,088 B2**
(45) **Date of Patent:** **Aug. 2, 2016**

(54) **LENS DRIVING APPARATUS, CAMERA MODULE, AND CAMERA-EQUIPPED MOBILE TERMINAL**

USPC 359/577; 348/208.7, 208.11
See application file for complete search history.

(71) Applicants: **Ichiro Hayashi**, Tokyo (JP); **Yohei Enta**, Tokyo (JP)

(56) **References Cited**

(72) Inventors: **Ichiro Hayashi**, Tokyo (JP); **Yohei Enta**, Tokyo (JP)

U.S. PATENT DOCUMENTS

(73) Assignee: **MITSUMI ELECTRIC CO., LTD.**, Tokyo (JP)

2009/0232483 A1* 9/2009 Anshita 396/55
2012/0099201 A1 4/2012 Chan et al.
2012/0154614 A1* 6/2012 Moriya et al. 348/208.5
2012/0300088 A1* 11/2012 Terajima 348/208.7

(*) Notice: Subject to any disclaimer, the term of this patent is extended or adjusted under 35 U.S.C. 154(b) by 32 days.

FOREIGN PATENT DOCUMENTS
JP 2010-197519 A 9/2010
JP 2011-65140 A 3/2011

(Continued)

(21) Appl. No.: **14/138,321**

OTHER PUBLICATIONS

(22) Filed: **Dec. 23, 2013**

JP 2013-190654 corresponds to JP 5007373.

(65) **Prior Publication Data**

US 2014/0177056 A1 Jun. 26, 2014

Primary Examiner — Bumsuk Won
Assistant Examiner — William R Alexander

(30) **Foreign Application Priority Data**

Dec. 26, 2012 (JP) 2012-282762

(74) *Attorney, Agent, or Firm* — Brundidge & Stanger, P.C.

(51) **Int. Cl.**

G02B 7/02 (2006.01)
G02B 7/08 (2006.01)
G02B 27/64 (2006.01)
H04N 5/225 (2006.01)
H04N 5/228 (2006.01)
G03B 17/02 (2006.01)
G02B 7/09 (2006.01)

(57) **ABSTRACT**

A lens driving apparatus includes: a lens holder having an auto-focusing first coil; a lens holder moving section that supports the lens holder in such a manner that the lens holder is movable in a first direction; a driving magnet disposed at four corners of the lens holder moving section and moves the lens holder in the first direction in cooperation with the first coil; a camera-shake correction second coil that moves the lens holder in a second direction and a third direction in cooperation with the driving magnet, the second direction and the third direction corresponding to diagonal directions of the lens holder moving section; and a supporting section that supports the lens holder moving section in such a manner that the lens holder moving section is movable in the second direction and the third direction.

(52) **U.S. Cl.**

CPC .. **G02B 7/08** (2013.01); **G02B 7/09** (2013.01);
G02B 27/64 (2013.01); **G02B 27/646**
(2013.01); **G03B 17/02** (2013.01); **H04N 5/225**
(2013.01); **H04N 5/228** (2013.01)

(58) **Field of Classification Search**

CPC G02B 7/09; G02B 27/64; G02B 7/08;
H04N 5/228

6 Claims, 8 Drawing Sheets

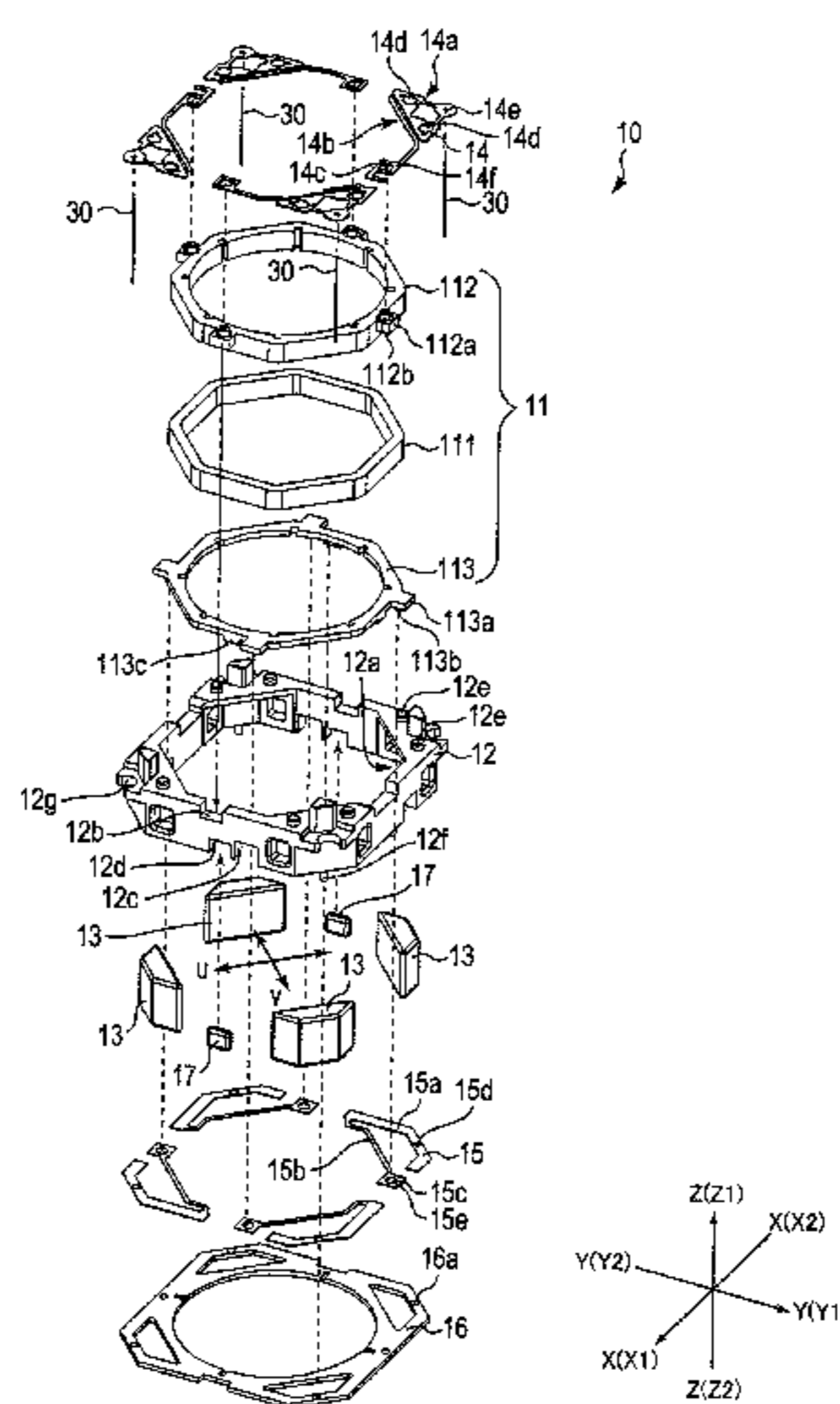

(56)

References Cited

FOREIGN PATENT DOCUMENTS

JP 2011-085666 A 4/2011
JP 2012-8379 A 1/2012

JP 5007373 B 6/2012
JP 2012-252120 A 12/2012
JP 2013-190654 A 9/2013
WO 2011/021559 A1 2/2011
WO 2011/142153 A1 11/2011

* cited by examiner

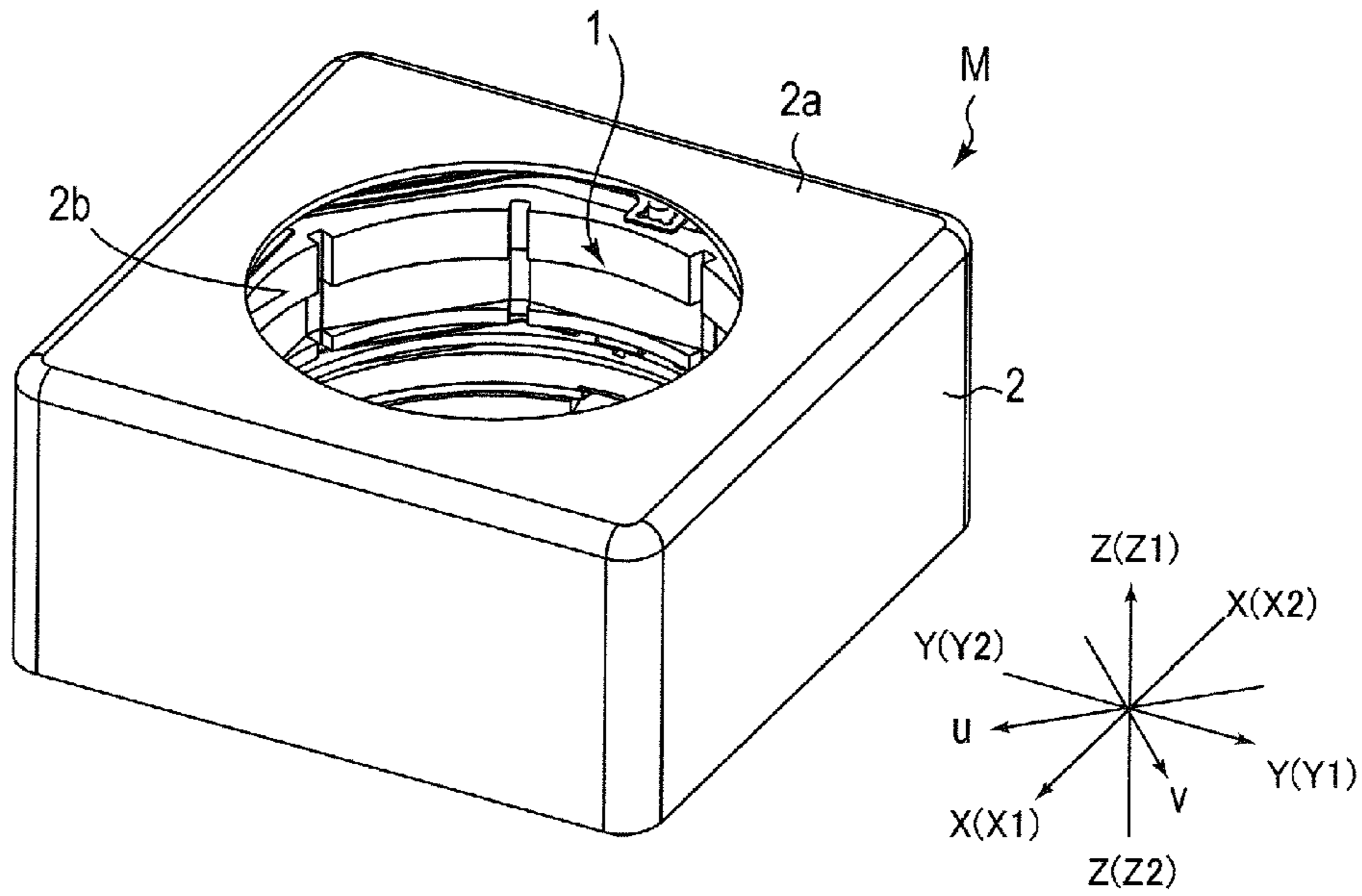

FIG. 1

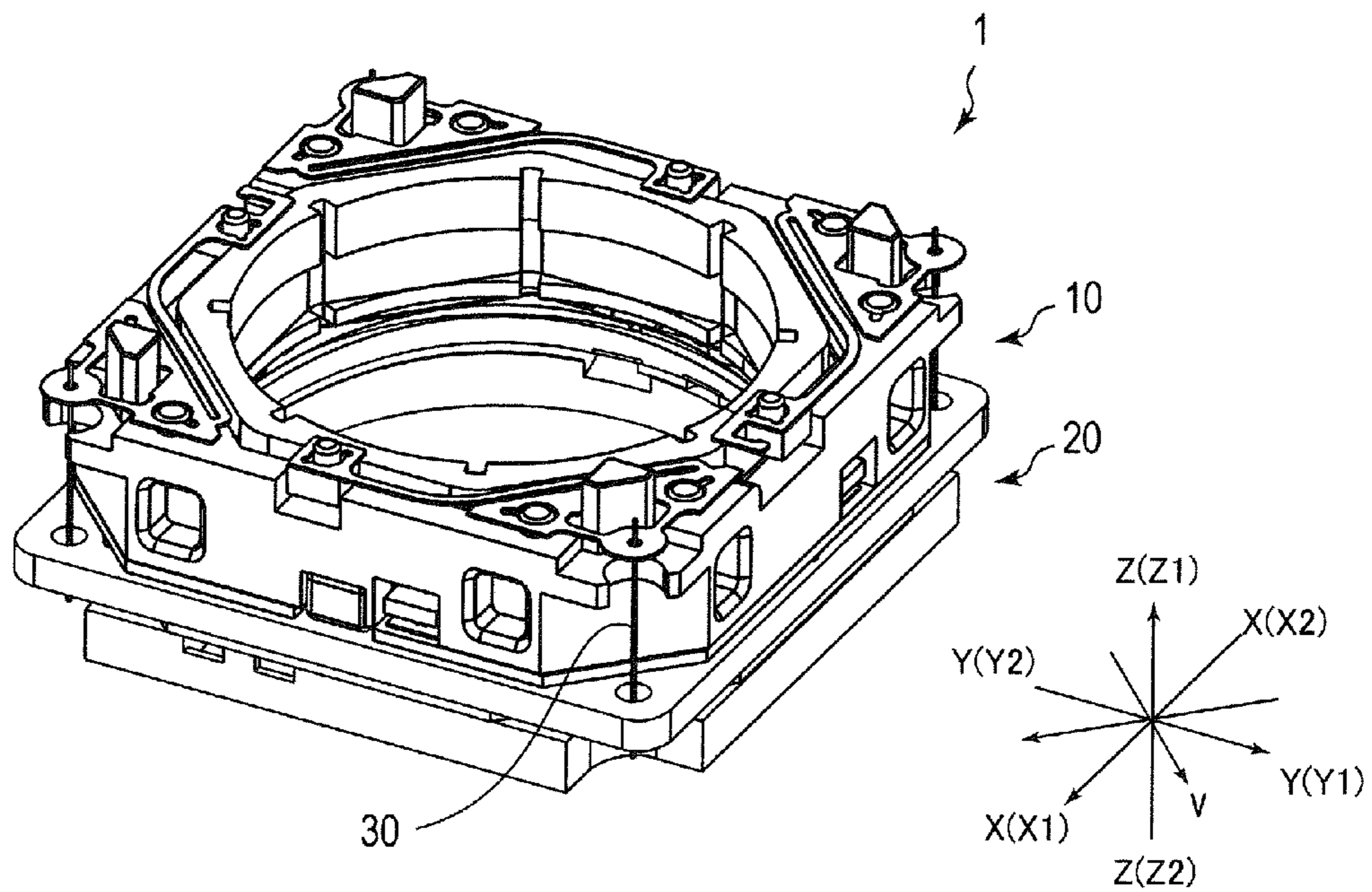

FIG. 2

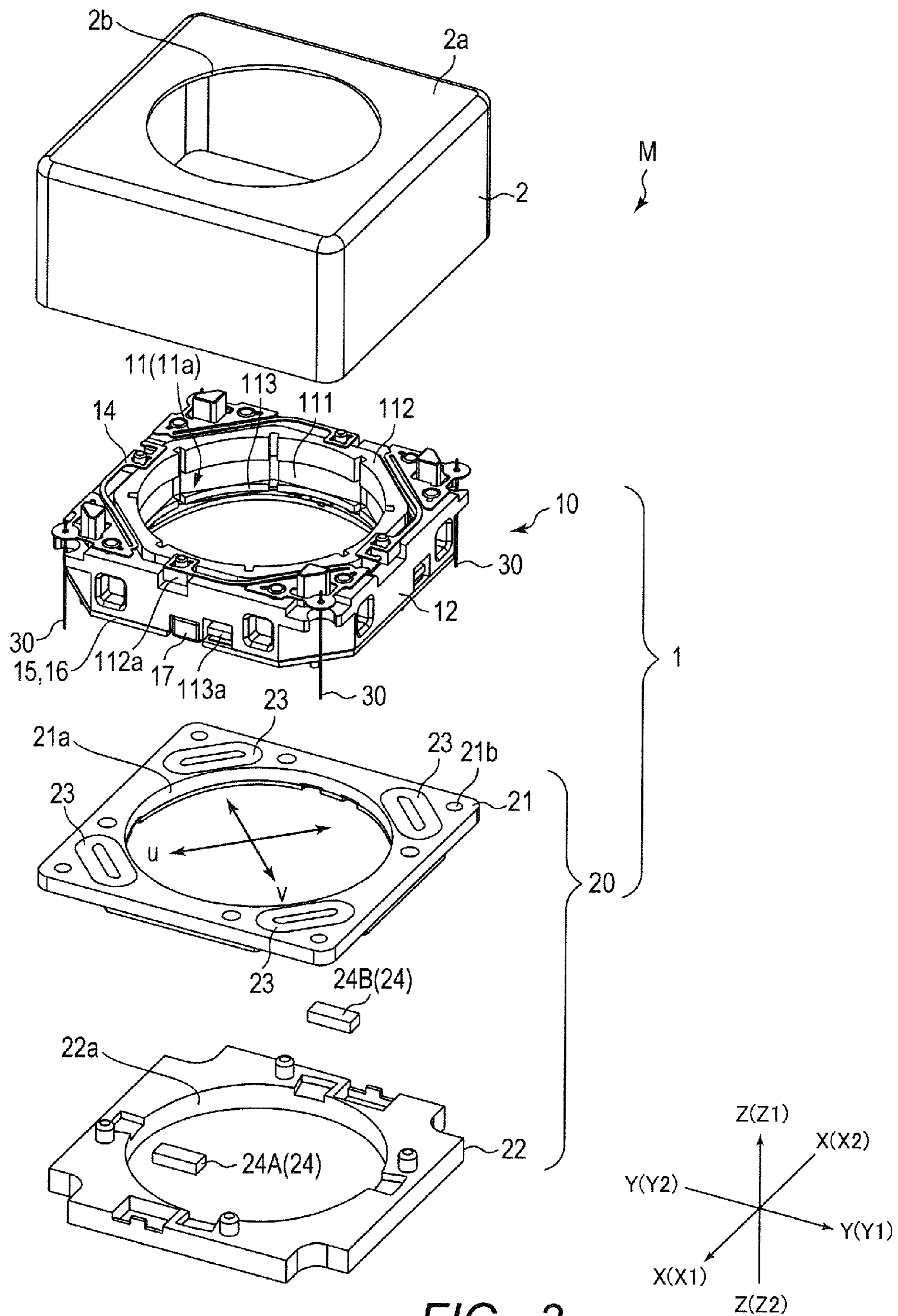

FIG. 3

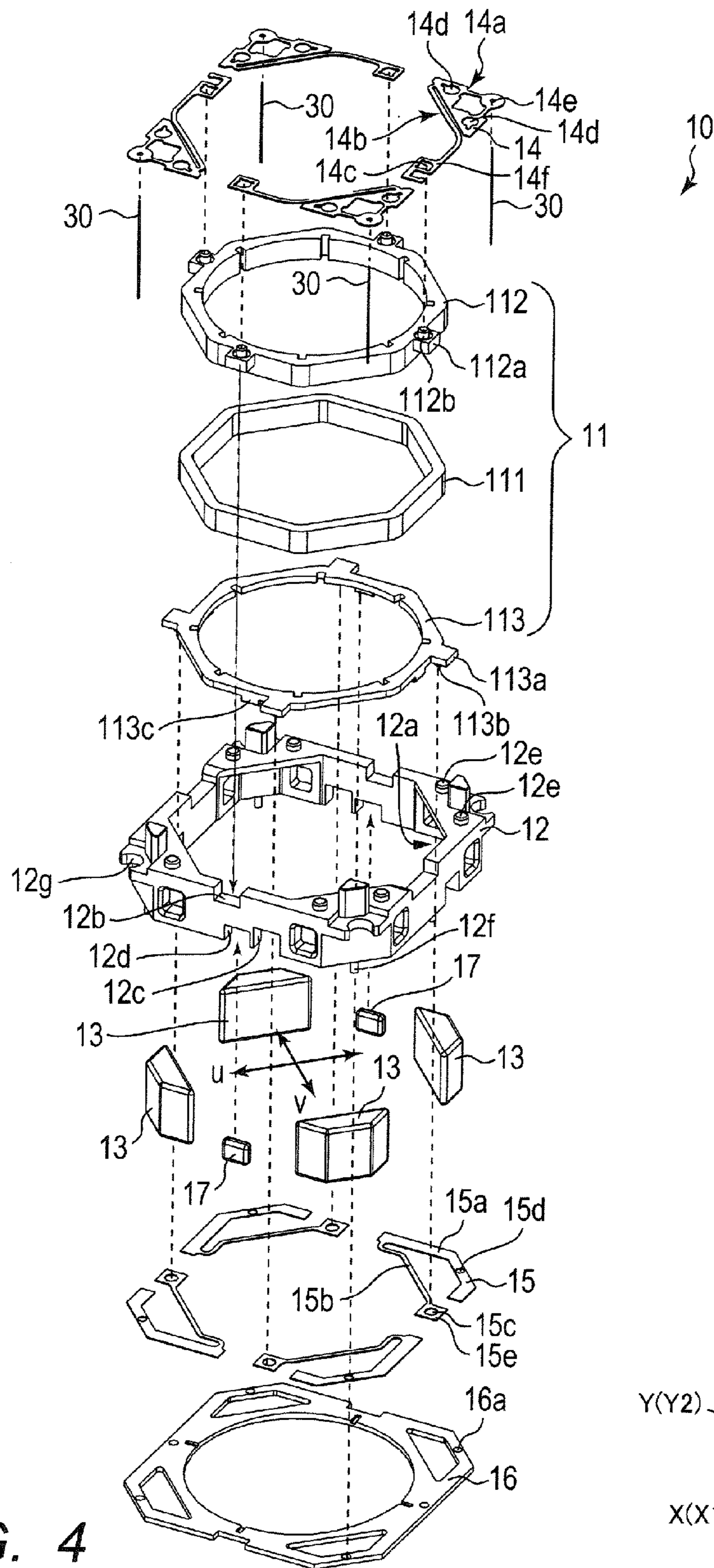

FIG. 4

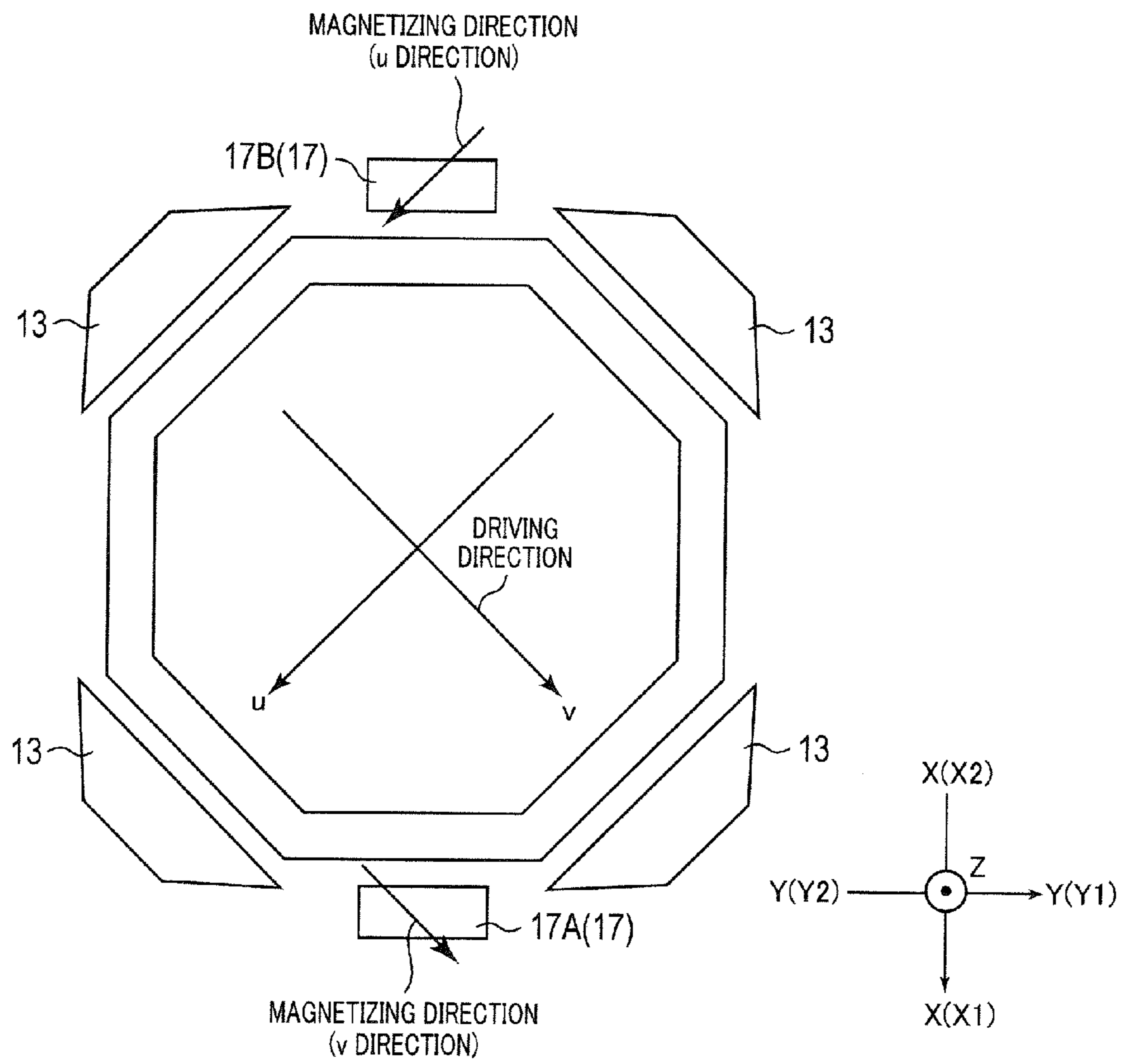

FIG. 5

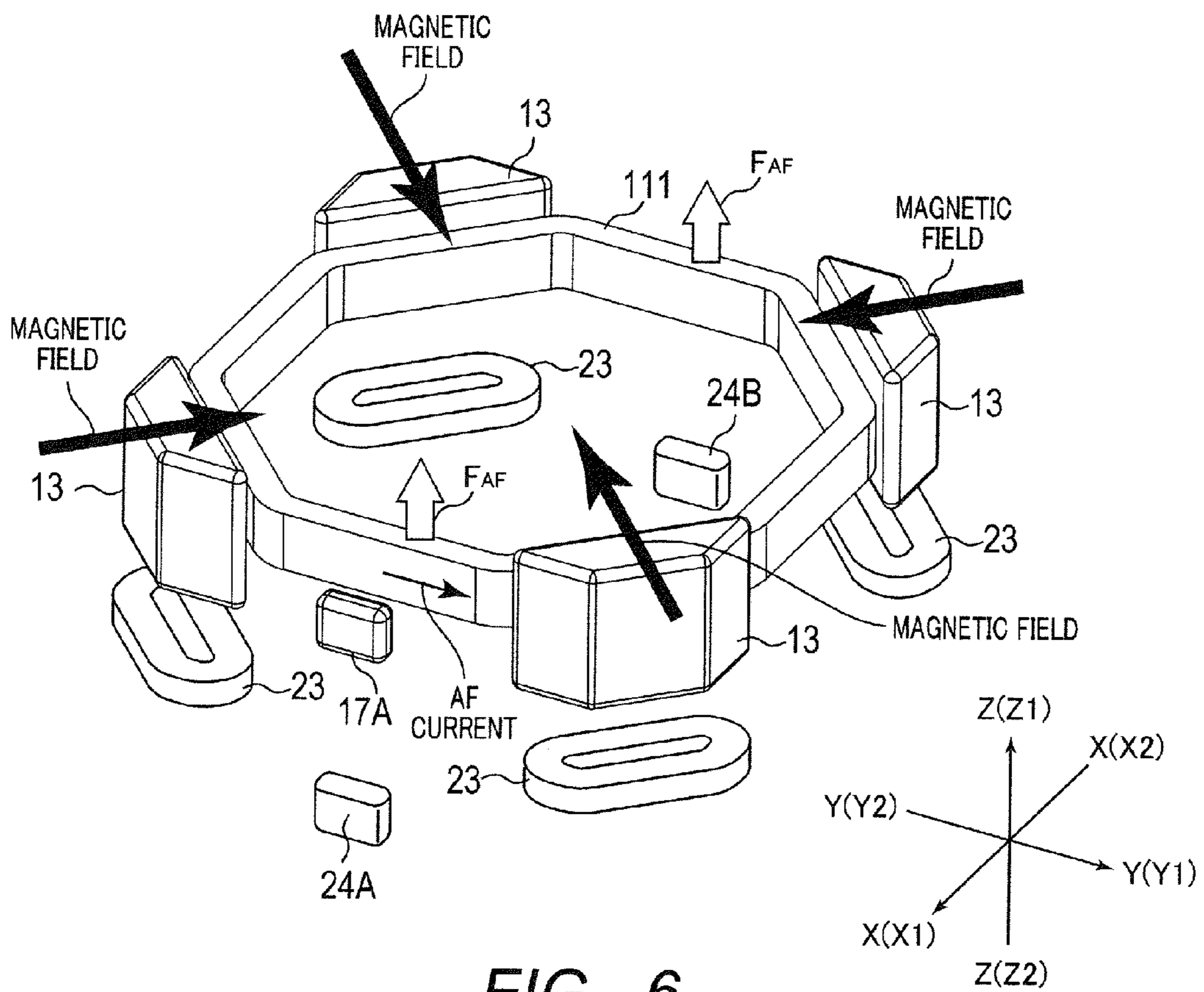

FIG. 6

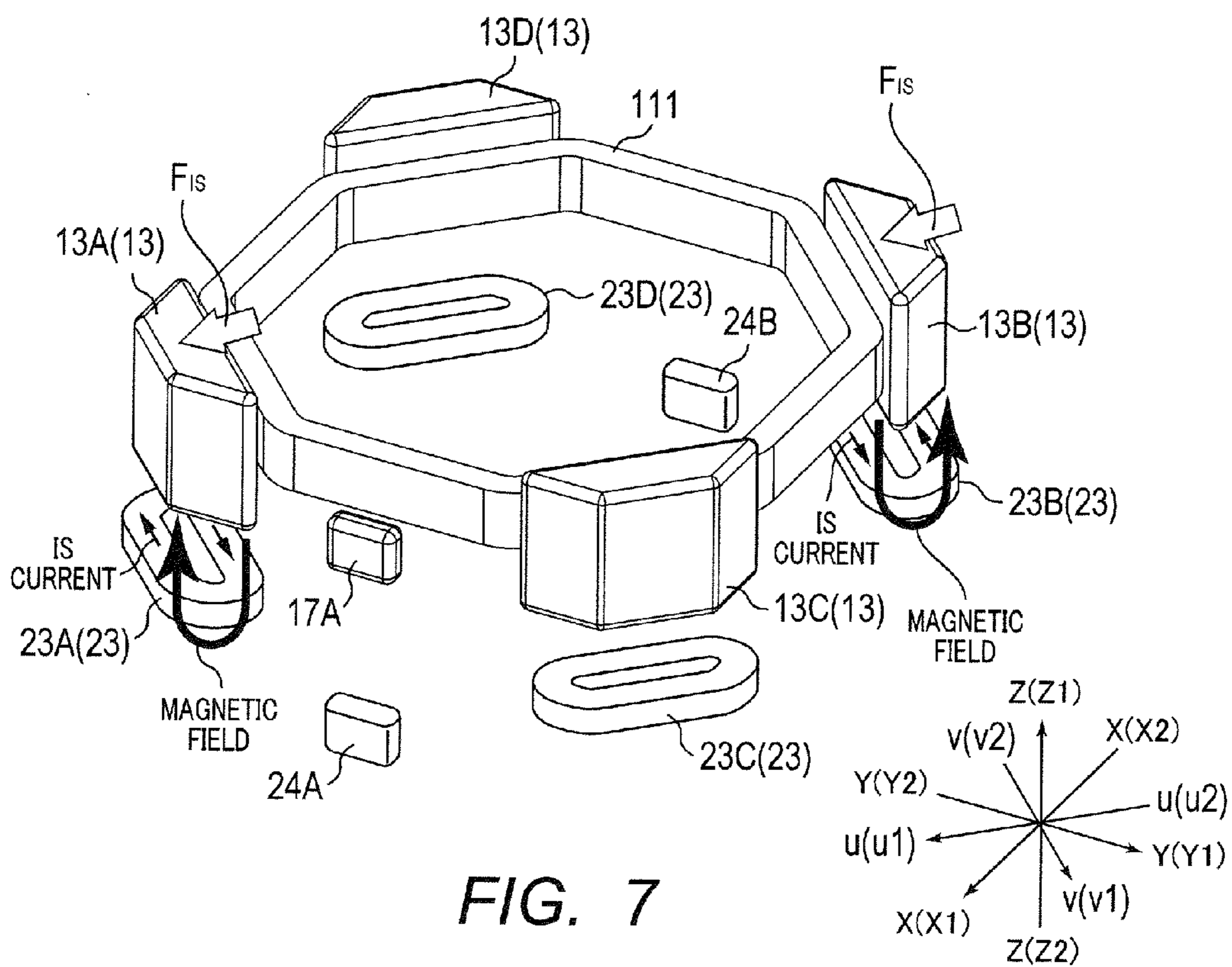
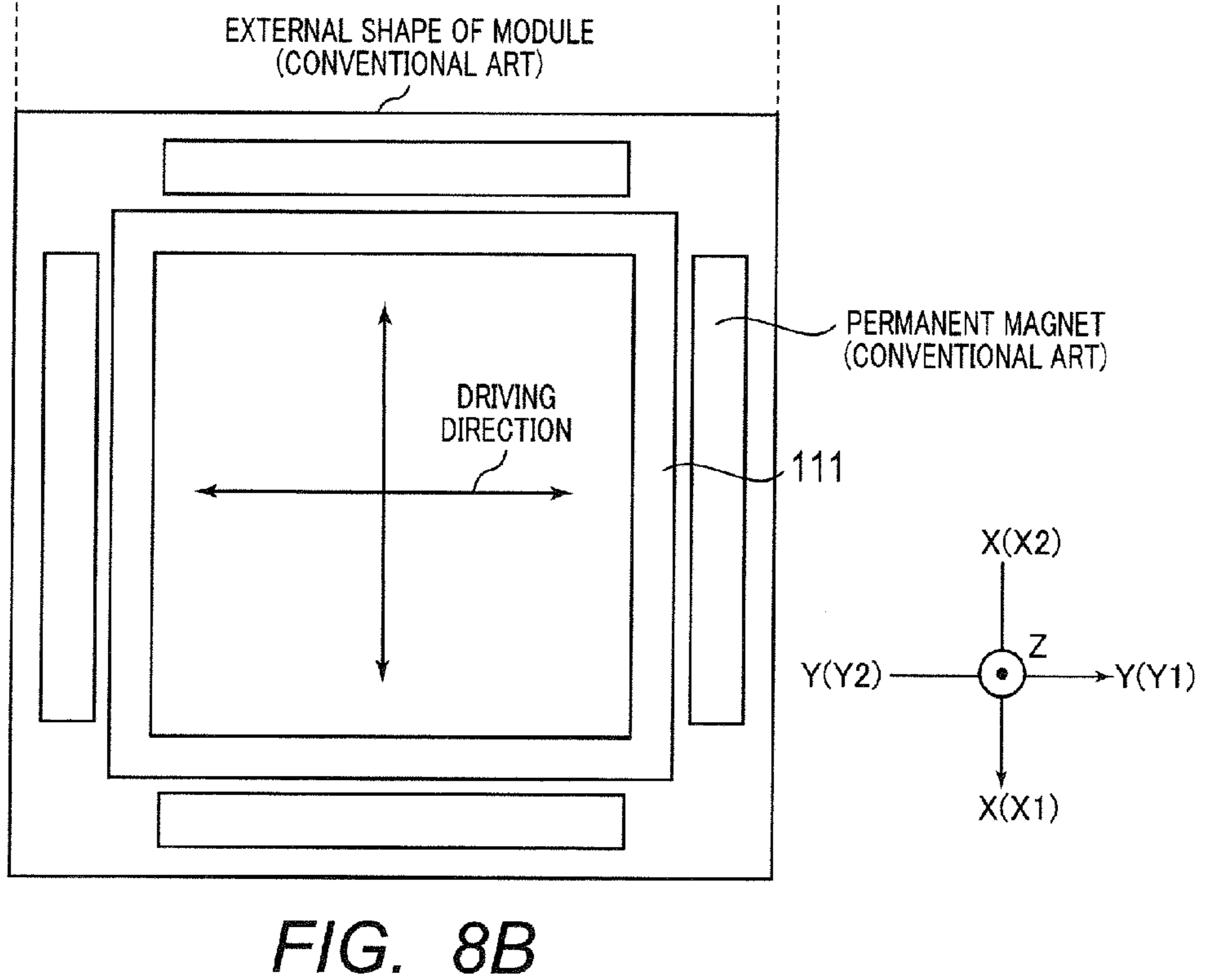
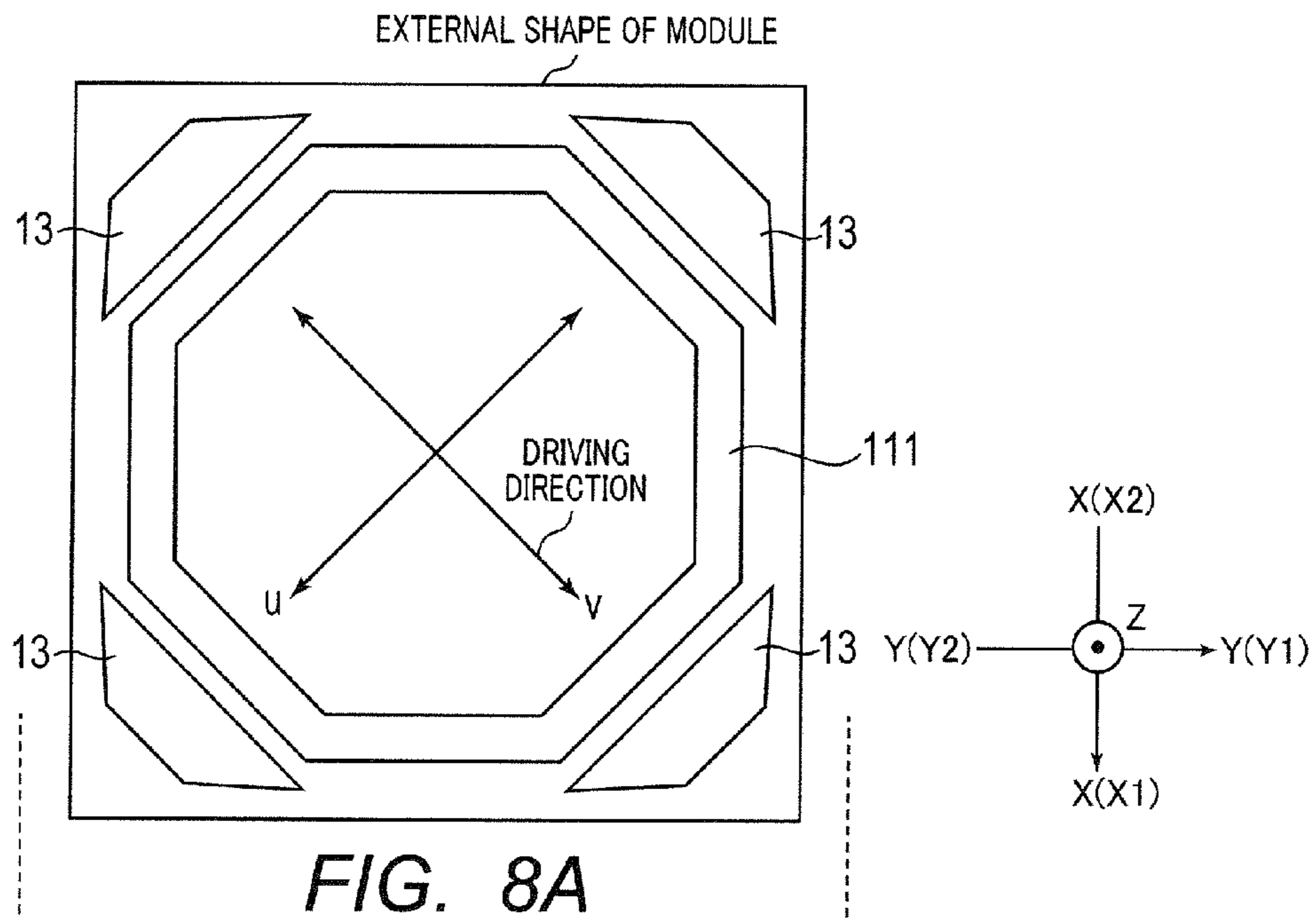

FIG. 7



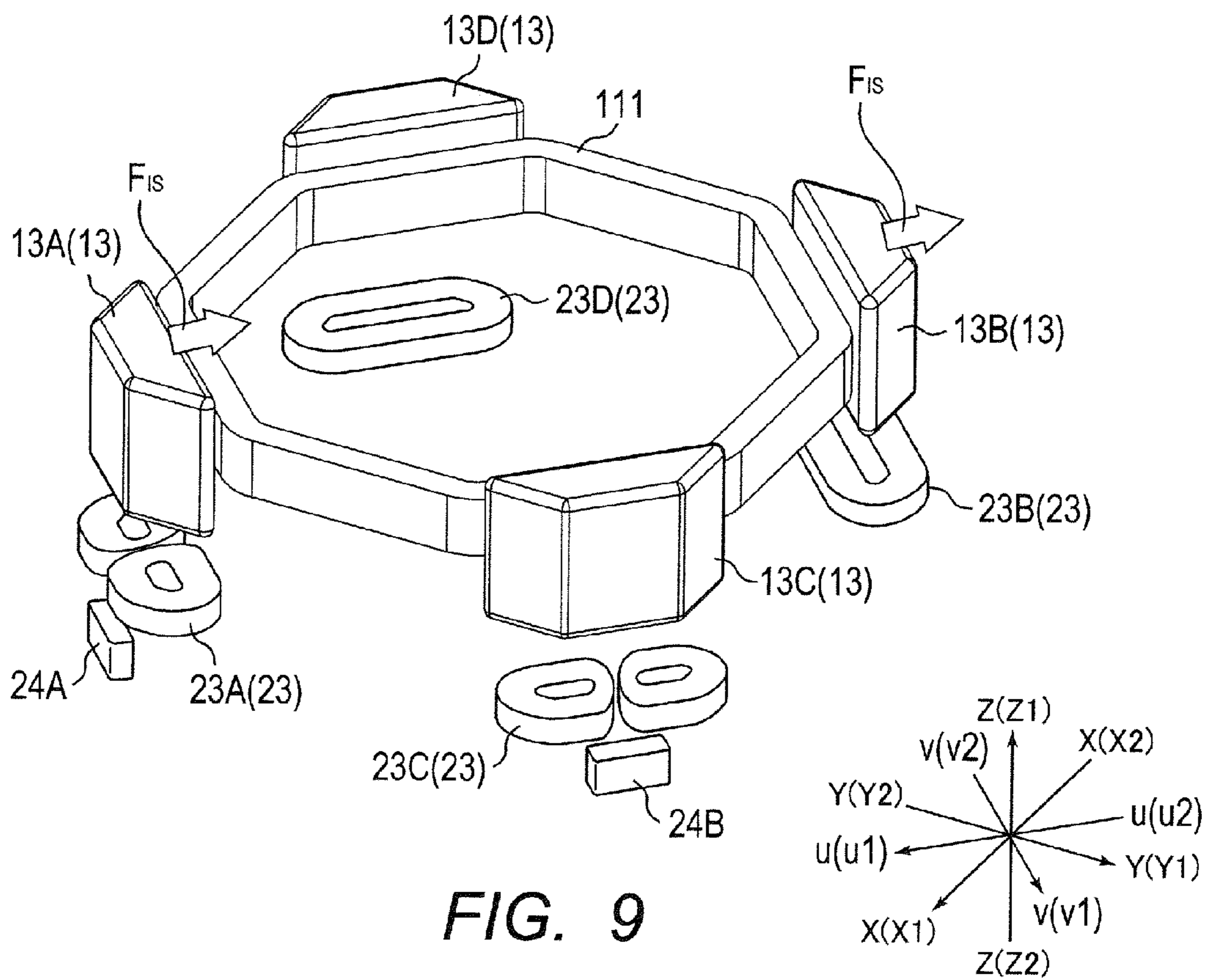

FIG. 9

1

**LENS DRIVING APPARATUS, CAMERA
MODULE, AND CAMERA-EQUIPPED
MOBILE TERMINAL**

CROSS REFERENCE TO RELATED
APPLICATIONS

This application is entitled to and claims the benefit of Japanese Patent Application No.2012-282762, filed on Dec. 26, 2012, the disclosure of which including the specification, drawings and abstract is incorporated herein by reference in its entirety.

BACKGROUND OF THE INVENTION

1. Field of the Invention

The present invention relates to a lens driving apparatus for use in a camera equipped with an auto-focusing function and a camera-shake correction function, a camera module, and a camera-equipped mobile terminal.

2. Description of Related Art

Conventionally, as a camera installed in a mobile terminal such as a smartphone, a camera equipped with an auto-focusing function and a camera-shake correction function is known. Such a camera adopts a lens driving apparatus that automatically focuses on a subject to be captured by moving a lens barrel and can reduce an image defect by correcting a camera-shake (vibration) when capturing an image (for example, WO2011/021559).

A lens driving apparatus disclosed in WO2011/021559 includes a lens holder moving section that supports a lens holder in which a lens barrel is fixed, wherein the lens holder is supported in such a manner as to be movable in the optical axis direction. In this lens driving apparatus, an auto-focusing first coil is disposed around the lens barrel (lens holder), and a permanent magnet is disposed to the lens holder moving section, whereby an auto-focusing lens driving section (hereinafter referred to as AF lens driving section) is configured. The AF lens driving section moves the lens holder in the optical axis direction by utilizing an electromagnetic force (Lorentz force) which acts on a first coil when a current is passed through the first coil, to thereby perform auto-focusing.

In addition, in the lens driving apparatus disclosed in WO2011/021559, a second coil is disposed in a spaced relationship with an auto-focusing permanent magnet in the optical axis direction, whereby a camera-shake correction lens driving section is configured. The camera-shake correction lens driving section moves the lens holder moving section and the lens holder along a plane orthogonal to the optical axis direction by utilizing an electromagnetic force which is generated when a current is passed through the second coil, to thereby perform camera-shake correction.

The portion at which the second coil is disposed is referred to as a fixed section since the portion does not move at the time of the camera-shake correction, whereas the lens holder and the lens holder moving section are referred to as a movable section since they rock at the time of the camera-shake correction. The movable section is supported to the fixed section by a supporting member such as a suspension wire for example so as to be able to rock.

In the above-mentioned manner, the AF lens driving section and the camera-shake correction lens driving section share the permanent magnet, whereby the size and thickness of the lens driving apparatus can be reduced.

Generally, a lens holder moving section has an external form which is square in plan view as viewed in the optical axis

2

direction, and includes a substantially circular (which encompasses regular polygons) holder housing section which is formed at a center portion and configured to house a lens holder. A permanent magnet for auto-focusing and camera-shake correction is composed of a cuboid bar magnet, and disposed along the four sides defining the external shape of the lens holder moving section. That is, the permanent magnet is disposed in parallel with the outer periphery of the product. In addition, the second coil making up the camera-shake correction lens driving section has an ellipsoidal form with rounded corners matching the form of the permanent magnet. The second coil is also disposed in parallel with the outer periphery of the product.

As used herein, the term "plan view" means a plan view in the optical axis direction.

In recent years, because of a trend toward multi-functionality of mobile terminals and the advent of thin devices such as smartphones, there has been a growing demand for further reduction in size and thickness. However, it is difficult to achieve further size reduction with the configuration of the conventional lens driving apparatuses.

More specifically, the conventional lens driving apparatus requires a sufficient space for disposing the permanent magnet in parallel with the outer periphery of the product around the holder housing section of the lens holder moving section. In addition, the external size of the fixed section at which the second coil is disposed is substantially the same as the lens holder moving section, which also hinders miniaturization.

SUMMARY OF THE INVENTION

An object of the present invention is to provide a lens driving apparatus, a camera module, and a camera-equipped mobile terminal which can achieve miniaturization in comparison with conventional technology.

A lens driving apparatus according to an embodiment of the present invention includes: a lens holder to which a lens barrel can be attached, the lens holder including an auto-focusing first coil; a lens holder moving section that is square as viewed in a plane orthogonal to a first direction along an optical axis, the lens holder moving section being configured to support the lens holder in such a manner that the lens holder is movable in the first direction; a driving magnet disposed at four corners of the lens holder moving section, the driving magnet being configured to move the lens holder in the first direction in cooperation with the first coil; a camera-shake correction second coil configured to move the lens holder in a second direction and a third direction in cooperation with the driving magnet, the second direction and the third direction corresponding to diagonal directions of the lens holder moving section; and a supporting section configured to support the lens holder moving section in such a manner that the lens holder moving section is movable in the second direction and the third direction.

A camera module according to an embodiment of the present invention includes: the above-mentioned lens driving apparatus; a lens barrel held by the lens holder; and an imaging section configured to capture a subject image formed by the lens barrel.

A camera-equipped mobile terminal according to an embodiment of the present invention includes the above-mentioned camera module.

BRIEF DESCRIPTION OF DRAWINGS

The present invention will become more fully understood from the detailed description given hereinbelow and the

3

appended drawings which are given by way of illustration only, and thus are not intended as a definition of the limits of the present invention, and wherein:

FIG. 1 is a perspective view illustrating an external appearance of a camera module according to an embodiment of the present invention;

FIG. 2 is a perspective view illustrating an external appearance of a lens driving apparatus to be covered by a shield cover;

FIG. 3 is an exploded perspective view illustrating a camera module;

FIG. 4 is an exploded perspective view illustrating a movable section of the lens driving apparatus;

FIG. 5 illustrates magnetizing directions of position detecting magnets;

FIG. 6 illustrates the operating principle of auto-focusing in the lens driving apparatus;

FIG. 7 illustrates the operating principle of camera-shake correction in the lens driving apparatus;

FIGS. 8A and 8B illustrate external shapes of the lens driving apparatus of the embodiment and a conventional lens driving apparatus, for comparison; and

FIG. 9 illustrates a modification of a position detecting section.

DESCRIPTION OF THE PREFERRED EMBODIMENTS

Now, an embodiment of the present invention will be described with reference to the accompanying drawings.

FIG. 1 is a perspective view illustrating an external appearance of camera module M according to an embodiment of the present invention. FIG. 2 is a perspective view illustrating an external appearance of lens driving apparatus 1 to be covered by shield cover 2. FIG. 3 is an exploded perspective view illustrating camera module M. FIG. 4 is an exploded perspective view illustrating movable section 10 of lens driving apparatus 1.

For the description, orthogonal coordinate system (X, Y, and Z) is used, as illustrated in FIG. 1 to FIG. 3. In FIG. 1 to FIG. 3, the X direction is the front-rear direction (depth direction), the Y direction is the horizontal direction (width direction), and the Z direction is the vertical direction (height direction).

In FIG. 1 to FIG. 3, the Z direction is the optical axis direction of a lens. In addition, the intermediate directions between the X and Y directions, or in other words, the diagonal directions in plan view in the Z direction of camera module M are u direction and v direction. The Z direction, u direction, and v direction correspond to a first direction, second direction, and third direction in the present invention, respectively.

Camera module M illustrated in FIG. 1 to FIG. 3 is a camera module to be mounted to a smartphone, for example. Camera module M is equipped with auto-focusing function and camera-shake correction function, and is capable of automatically focusing on a subject to be captured and of capturing images without image blurring by correcting camera-shake (vibration) when capturing images.

Camera module M includes a cylindrical lens barrel (not illustrated) that houses a lens, lens driving apparatus 1 that moves the lens barrel to perform auto-focusing and camera-shake correction, an imaging section (not illustrated) that captures an image of a subject, shield cover 2 that covers the entire camera module M, and the like.

Shield cover 2 is a box that covers the outer peripheral surface of lens driving apparatus 1. The upper surface 2a of

4

shield cover 2 is square, and the lens barrel (not illustrated) faces the outside through circular opening 2b formed on upper surface 2a. That is, camera module M is square in plan view, and lens driving apparatus 1 covered by shield cover 2 also is square in plan view.

As illustrated in FIG. 2 and FIG. 3, lens driving apparatus 1 includes fixed section 20 which is fixed so as to be unmovable when camera module M is mounted to a mobile terminal or the like, and movable section 10 that rocks in the X-Y plane with respect to fixed section 20. Movable section 10 is disposed upwardly of fixed section 20 (in the Z1 direction) with a gap therebetween, and supported by a supporting member such as suspension wire 30 so as to be able to rock.

As illustrated in FIG. 3 and FIG. 4, movable section 10 includes lens holder 11, magnet holder 12, permanent magnet 13, upper spring 14, lower spring 15, spacer 16, position detecting magnet 17, and the like. Magnet holder 12, upper spring 14, lower spring 15, and spacer 16 make up a lens holder moving section that supports lens holder 11 so as to be movable in the Z direction.

Lens holder 11 includes first coil 111, upper coil holder 112, and lower coil holder 113.

First coil 111 is an air-core coil through which a current flows at the time of auto-focusing, in which a wire is wound in a substantially octagonal cylindrical form.

Upper coil holder 112 is an annular frame formed in an octagonal shape in plan view matching the external shape of first coil 111. Upper coil holder 112 includes protrusions 112a protruding radially outwardly. On the upper surface of protrusion 112a, boss 112b on which to attach upper spring 14 is formed.

Lower coil holder 113 is an annular frame formed in an octagonal shape in plan view matching the external shape of first coil 111. Lower coil holder 113 includes protrusions 113a protruding radially outwardly. On the bottom surface of protrusions 113a, boss 113b on which to attach lower spring 15 is formed.

Upper coil holder 112 and lower coil holder 113 tightly sandwich first coil 111. In other words, lens holder 11 is a vertically-separable lens holder, and cylindrical barrel housing section 11a is formed by the inner peripheral surfaces of first coil 111, upper coil holder 112, and lower coil holder 113. In lens holder 11, the inner peripheral surface of first coil 111 is exposed. The lens barrel (not illustrated) is fixed to barrel housing section 11a.

In the above-mentioned manner, in lens driving apparatus 1, lens holder 11 is made up of first coil (111) composed of an air-core coil, and a coil holding member (upper coil holder 112 and lower coil holder 113) that tightly sandwich first coil (111), and the inner peripheral surface of first coil (111) is exposed.

In comparison with a coil in which a wire is wound around the outer peripheral surface of a coil holder, the coil internal diameter is reduced by the thickness of the coil holder, which is effective in miniaturizing lens driving apparatus 1.

The lens barrel (not illustrated) is fixed to barrel housing section 11a of lens holder 11 by bonding. Although there is a possibility that a foreign matter such as dust enters lens driving apparatus 1 in the case where the lens barrel (not illustrated) is threadedly engaged with lens holder 11, such a defect can be prevented by the above-described fixing method.

Magnet holder 12 has a square cylindrical form which is square in plan view. Magnet holder 12 is provided, at its four corners, with magnet housing sections 12a at which permanent magnets 13 are disposed. Magnet housing sections 12a

5

are each formed in an isosceles trapezoidal form in plan view matching the external shape of permanent magnet 13.

Recesses 12b are formed at substantially the center of the four sides on the upper surface of magnet holder 12. Protrusions 112a of upper coil holder 112 are disposed at respective recesses 12b.

In addition, two bosses 12e, on which to attach upper spring 14, are formed at each of the four corners on the upper surface of magnet holder 12. In addition, protruding portions 12g are formed at the four corners on the upper surface of magnet holder 12 so as to surround suspension wires 30.

Recesses 12c are formed at substantially the center of the four sides on the bottom surface of magnet holder 12. Protrusions 113a of lower coil holder 113 are disposed at respective recesses 12c. The depth of recess 12c is so set that it is sufficiently greater than the height of protrusion 113a of lower coil holder 113. The depth of recess 12c limits the migration length of lens holder 11 at the time of auto-focusing.

In addition, on the bottom surface of magnet holder 12, recess 12d adjacent to recess 12c is formed at the two sides facing each other in the X direction. Position detecting magnet 17 is disposed at recess 12d. In addition, one boss 12f on which to attach lower spring 15 and spacer 16 is formed at each of the four corners on the bottom surface of magnet holder 12.

Permanent magnet 13 is a magnet having an isosceles trapezoidal columnar form. Permanent magnet 13 is disposed at magnet housing section 12a located at the four corners of magnet holder 12 with the long side of the isosceles trapezoid being positioned on the radially inner side. Specifically, four permanent magnets 13 are disposed to face first coil 111 in the u direction and the v direction. Magnet holder 12 and permanent magnet 13 define a space having an octagonal shape in plan view, in which lens holder 11 can move in the Z direction.

Permanent magnet 13 is magnetized in such a manner that a magnetic field orthogonal to the radial direction is formed at first coil 111. Here, permanent magnet 13 is magnetized in such a manner that the inner periphery side thereof is N pole, and the outer periphery side thereof is S pole.

Upper spring 14 is a leaf spring made of beryllium copper, nickel copper, stainless-steel, or the like, for example and is composed of equally-shaped four members. Upper spring 14 includes magnet holder attaching section 14a to be fixed to the upper surface of magnet holder 12, and lens holder attaching section 14f to be fixed to the upper surface of lens holder 11 (upper coil holder 112). Upper spring 14 elastically supports lens holder 11 with respect to magnet holder 12.

Magnet holder attaching section 14a has a form corresponding to a corner on the upper surface of magnet holder 12. In magnet holder attaching section 14a, engagement hole 14d which engages with boss 12e formed on the upper surface of magnet holder 12 is formed. In addition, in magnet holder attaching section 14a, wire fixation hole 14e into which an end of suspension wire 30 is inserted is formed.

Between lens holder attaching section 14f and magnet holder attaching section 14a, arm section 14b extending along the external shape of lens holder 11 is formed. Engagement hole 14c which engages with boss 112b of upper coil holder 112 is formed in lens holder attaching section 14f.

Similarly to upper spring 14, lower spring 15 is a leaf spring made of beryllium copper, nickel copper, stainless-steel, or the like, for example, and is composed of equally-shaped four members. Lower spring 15 includes magnet holder attaching section 15a to be fixed to the bottom surface of magnet holder 12, and lens holder attaching section 15e to

6

be fixed to the bottom surface of lens holder 11 (lower coil holder 113). Lower spring 15 elastically supports lens holder 11 with respect to magnet holder 12.

Magnet holder attaching section 15a has a form corresponding to a corner on the bottom surface of magnet holder 12. In magnet holder attaching section 15a, engagement hole 15d which engages with boss 12f formed on the bottom surface of magnet holder 12 is formed.

Between lens holder attaching section 15e and magnet holder attaching section 15a, arm section 15b extending along the external shape of lens holder 11 is formed. Engagement hole 15c which engages with boss 113b of lower coil holder 113 is formed in lens holder attaching section 15e.

At the time of fitting lens holder 11 to magnet holder 12, boss 12e of magnet holder 12 is inserted into engagement hole 14d of magnet holder attaching section 14a of upper spring 14, and fixed by thermal welding, for example. In addition, boss 112b of upper coil holder 112 is inserted into engagement hole 14c of lens holder attaching section 14f, and fixed by thermal welding or bonding.

Further, boss 12f of magnet holder 12 is inserted into engagement hole 15d of magnet holder attaching section 15a of lower spring 15, and engagement hole 16a of spacer 16 disposed below lower spring 15, and fixed by thermal welding, for example.

In addition, boss 113b of lower coil holder 113 is inserted into engagement hole 15c of lens holder attaching section 15e, and fixed by thermal welding or bonding.

Thus, lens holder 11 is elastically supported by upper spring 14 and lower spring 15 in such a manner that lens holder 11 can be displaced in the Z direction in the state where lens holder 11 is positioned with respect to magnet holder 12.

In addition, when four protrusions 113c formed on the bottom surface of lower coil holder 113 contact the upper surface of spacer 16, the entirety of lens holder 11 is lifted in the optical axis direction by the height of protrusion 113c, whereby upper spring 14 and lower spring 15 are caused to generate a back tension.

At this time, protrusions 112a of upper coil holder 112 are loosely fixed to recesses 12b formed on the upper surface of magnet holder 12, and protrusions 113a of lower coil holder 113 are loosely fixed to recesses 12c formed on the bottom surface of magnet holder 12. Further, lens holder attaching section 14f of upper spring 14 is distanced from the upper surface of magnet holder 12 by the height of protrusions 113c formed on the bottom surface of lower coil holder 113.

Specifically, by the distance between lens holder attaching section 14f of upper spring 14 and the upper surface of magnet holder 12, a back tension is generated at upper spring 14, and lens holder 11 (protrusions 112a) is pressed toward magnet holder 12. In addition, lens holder attaching section 15e of lower spring 15 is distanced by the same amount as upper spring 14, and accordingly a back tension is generated. With this configuration, in a non-energizing state, lens holder 11 does not move even when the posture of lens driving apparatus 1 is turned upside down. From this standard state, lens holder 11 moves upward (Z1 direction) at the time of auto-focusing (at the time of energization).

Position detecting magnets 17A and 17B are disposed in recesses 12d formed on the bottom surface of magnet holder 12 (see FIG. 5). Position detecting magnets 17A and 17B are cuboid bar magnets. Position detecting magnet 17A is obliquely magnetized in the v direction, and position detecting magnet 17B is obliquely magnetized in the v direction orthogonal to the u direction. The position of movable section 10 in the v direction can be detected by detecting the magnetic field formed by position detecting magnet 17A, and the posi-

tion of movable section **10** in the *u* direction can be detected by detecting the magnetic field formed by position detecting magnet **17B**. The magnetic fields formed by position detecting magnets **17A** and **17B** are detected by Hall devices **24A** and **24B** disposed to face position detecting magnets **17A** and **17B** in the *Z* direction.

In addition, also in the case where position detecting magnet **17A** is obliquely magnetized in the *u* direction and position detecting magnet **17B** is obliquely magnetized in the *v* direction, Hall devices **24A** and **24B** can detect the position of movable section **10** in the *u* direction and the *v* direction.

It is to be noted that, as position detecting magnets **17A** and **17B**, commonly used bar magnets magnetized in the longitudinal direction or the short direction may also be used. In this case, position detecting magnets **17A** and **17B** are obliquely disposed so that the magnetizing direction corresponds to the *u* direction or the *v* direction.

Fixed section **20** includes coil board **21**, base member **22**, and the like.

Similarly to magnet holder **12**, coil board **21** is square in plan view, and circular opening **21a** is formed at the center of coil board **21**. In addition, at the four corners of coil board **21**, wire fixation hole **21b** into which the other end (lower end) of suspension wire **30** is inserted is formed.

At the four corners of coil board **21**, camera-shake correction second coil **23** is disposed to face permanent magnet **13**. Second coil **23** has a form of an isosceles trapezoid with rounded corners in plan view so as to correspond to the form of permanent magnet **13**. The form, arrangement, and the like of permanent magnet **13** and second coil **23** are so set that the radial edges of permanent magnet section **13** fall within the cross-sectional width of the coil, or more specifically, are so set that the magnetic field radiated from permanent magnet **13** in the *Z* direction traverses the opposing two sides of second coil **23** and returns to permanent magnet **13**. With this configuration, the driving force (electromagnetic force) for moving movable section **10** in the *XY* plane can be efficiently generated.

Similarly to coil board **21**, base member **22** is square in plan view, and circular opening **22a** is formed at the center of base member **22**.

In addition, fixed section **20** includes a position detecting section that detects the position of movable section **10** in the *XY* plane, or more concretely, the position in the *u* direction and the *v* direction. In this example, as the position detecting section, Hall devices **24A** and **24B** are attached to base member **22**. Hall devices **24A** and **24B** are disposed at respective positions facing detecting magnets **17A** and **17B**. Hall devices **24A** and **24B** are magnetic sensors that detect a magnetic field by utilizing Hall effect. When the magnetic field formed by position detecting magnets **17A** and **17B** is detected by Hall devices **24A** and **24B**, the position of movable section **10** in the *XY* plane can be detected.

In the above-mentioned manner, lens driving apparatus **1** includes the position detecting section that detects the position of the lens holder moving section (magnet holder **12**, upper spring **14**, lower spring **15**, and spacer **16**) in the second direction (the *u* direction) and third direction (the *v* direction).

To be more specific, lens driving apparatus **1** includes: a first position detecting magnet (position detecting magnet **17B**) disposed along a side of the lens holder moving section (**12**, **14**, **15**, **16**) and magnetized in the second direction (the *u* direction); and a second position detecting magnet (position detecting magnet **17A**) disposed along a side of lens holder moving section (**12**, **14**, **15**, **16**) different from the side along which first position detecting magnet is disposed and magnetized in the third direction (the *v* direction). The position

detecting section is made up of first Hall device (**24B**) disposed to face first position detecting magnet (**17B**) in the first direction (the *Z* direction), and second Hall device (**24A**) disposed to face second position detecting magnet (**17A**) in the first direction (the *Z* direction).

Since components (such as coil, for example) having an influence on the magnetic field formed by position detecting magnets **17A** and **17B** are not disposed between position detecting magnets **17A** and **17B** and Hall devices **24A** and **24B**, the accuracy in the detection of magnetic field by Hall devices **24A** and **24B** is improved.

Movable section **10** and fixed section **20** are coupled by a supporting member such as suspension wire **30**. To be more specific, four suspension wires **30** extend along the *Z* direction, and support the entirety of movable section **10** in such a manner that movable section **10** can rock in the *XY* plane. An end (upper end) of each of four suspension wires **30** is inserted into protruding portion **12g** of magnet holder **12**, and fixed to wire fixation hole **14e** of upper spring **14** by soldering. The other end (lower end) of each of four suspension wires **30** is inserted into wire fixation hole **21b** of coil board **21**, and fixed by soldering.

It is to be noted that two of four suspension wires **30** are used also for supplying electricity to first coil **111**. In addition, the number of suspension wires **30** is not limited to four, and it suffices that a plurality of suspension wires **30** are provided.

A damper (not illustrated) is disposed between magnet holder **12** and upper spring **14** so as to surround suspension wire **30**. Specifically, magnet holder **12** includes protruding portions **12g** protruding radially outwardly at the four corners of magnet holder **12**. Protruding portions **12g** are each provided at a position near wire fixation hole **14e** in such a manner as to surround suspension wire **30** with a gap therebetween. The damper (not illustrated) is disposed between protruding portion **12g** and upper spring **14** in such a manner as to surround suspension wire **30**. The damper (not illustrated) can be readily applied by using a dispenser for example. For example, ultraviolet curable silicone gel (trade name: TB3168E, viscosity: 90 Pa·s) available from ThreeBond Co., Ltd. may be employed as the damper (not illustrated). It is to be noted that the damper (not illustrated) is not limited to the ultraviolet curable resin, and any materials may be used as long as a damper effect is obtained.

Since unnecessary resonance is suppressed by disposing the damper (not illustrated) between magnet holder **12** and upper spring **14** in such a manner as to surround suspension wire **30**, the operation of lens driving apparatus **1** is remarkably stabilized. In addition, since the damper (not illustrated) reduces the impact which is caused when the apparatus is dropped, the impact resistance of lens driving apparatus **1** is improved.

In addition, Hall devices **24A** and **24B** and a sensor board (not illustrated, FPC: Flexible printed circuits) on which a control section is mounted are disposed between coil board **21** and base member **22**, as the imaging section. Further, an imaging device (not illustrated) is disposed below base member **22**. The imaging device (not illustrated) is composed of a charge-coupled device (CCD) image sensor, a complementary metal oxide semiconductor (CMOS) image sensor, or the like, for example. The imaging device (not illustrated) captures a subject image formed by means of the lens barrel (not illustrated), converts this image into an electrical signal, and outputs this signal to the control section (not illustrated).

The control section (not illustrated) performs auto-focusing by controlling the current to be passed through first coil **111**. In addition, the control section (not illustrated) performs camera-shake correction by controlling the current to be

passed through second coil **24** on the basis of the position detection signal detected by two Hall devices **24A** and **24B** so as to offset the rock detected by two direction gyros (not illustrated).

FIG. 6 illustrates the operating principle of auto-focusing in lens driving apparatus **1**.

When auto-focusing is performed in lens driving apparatus **1**, permanent magnet **13** and first coil **111** cooperate with each other to move lens holder **11** in the Z direction. That is, the AF lens driving section includes permanent magnet **13** and first coil **111**. To be more specific, in order to perform auto-focusing, the AF lens driving section moves lens holder **11** in the Z direction by utilizing an electromagnetic force (Lorentz force) which acts on first coil **111** when a current is passed through first coil **111**.

As illustrated in FIG. 6, at first coil **111**, a radially inward magnetic field is formed by permanent magnets **13**. Accordingly, when a counterclockwise AF current is passed through first coil **111**, upward electromagnetic force F_{AF} (Lorentz force) is generated in first coil **111** according to Fleming's left hand rule. As a result, lens holder **11** (lens barrel) moves in the Z1 direction.

Since the magnitude of an electromagnetic force generated in first coil **111** changes when the value of the AF current changes, automatic focusing is achieved by controlling the value of AF current to adjust the migration amount of lens holder **11** (lens barrel).

It is to be noted that when lens holder **11** keeps on moving in the Z1 direction at the time of auto-focusing, protrusions **113a** finally come into contact with recesses **12c** of magnet holder **12**, and thus further movement thereof is limited.

In other words, in lens driving apparatus **1**, lens holder (**11**) includes a protrusion (protrusions **113a** of lower coil holder **113**) protruding radially outwardly, and the lens holder moving section (magnet holder **12**) includes an engaging section (recesses **12c**) which is to be engaged with the protrusion (**113a**) and restricts the movement of lens holder (**11**).

With this configuration, recesses **12c** of magnet holder **12** function as a physical stopper at the time of auto-focusing, whereby damage and the like can be prevented when movable section **10** excessively moves due to malfunction.

FIG. 7 illustrates the operating principle of camera-shake correction in lens driving apparatus **1**.

When camera-shake correction is performed in lens driving apparatus **1**, permanent magnet **13** and second coil **23** cooperate with each other to move lens holder **11** in the XY plane. That is, the camera-shake correction lens driving section includes permanent magnet **13** and second coil **23**. To be more specific, in order to perform auto-focusing, the camera-shake correction lens driving section moves lens holder **11** in the XY plane by utilizing an electromagnetic force (Lorentz force) which acts on second coil **23** when a current is passed through second coil **23**.

As illustrated in FIG. 7, at second coil **23A** disposed in the u1 direction, a magnetic field that traverses second coil **23A** in the Z direction is formed by permanent magnet **13A**. Accordingly, when a clockwise IS current is passed through second coil **23A**, a u2-directional electromagnetic force is generated in second coil **23A** according to Fleming's left hand rule. Since second coil **23A** is fixed, as a reaction thereto, u1-directional Force F_{IS} acts on permanent magnet **13A**.

In addition, at second coil **23B** disposed in the u2 direction, a magnetic field that traverses second coil **23B** in the Z direction is formed by permanent magnet **13B**. Accordingly, when a counterclockwise IS current is passed through second coil **23B**, a u2-directional electromagnetic force is generated in second coil **23B** according to Fleming's left hand rule. Since

second coil **23B** is fixed, as a reaction thereto, u1-directional Force F_{IS} acts on permanent magnet **13B**.

As a result, lens holder **11** (lens barrel) moves in the u1 direction as movable section **10**.

Conversely, when a counterclockwise IS current is passed through second coil **23A**, and at the same time a clockwise IS current is passed through second coil **23B**, lens holder **11** (lens barrel) moves in the u2 direction as movable section **10**.

Likewise, when an IS current is passed through second coils **23C** and **23D** disposed in the v1 direction and v2 direction, lens holder **11** can be moved in the v1 direction or v2 direction.

In the above-mentioned manner, lens driving apparatus **1** includes: lens holder (**11**) that has auto-focusing first coil (**111**) disposed around the lens barrel (not illustrated) and holds the lens barrel; the lens holder moving section (magnet holder **12**, upper spring **14**, lower spring **15**, and spacer **16**) that is square as viewed in a plane orthogonal to the first direction (the Z direction) along the optical axis and supports lens holder (**11**) in such a manner that lens holder (**11**) is movable in the first direction (the Z direction); a driving magnet (permanent magnet **13**) that is disposed at the four corners of lens holder moving section (**12**, **14**, **15**, **16**) and moves lens holder (**11**) in the first direction (the Z direction) in cooperation with first coil (**111**); camera-shake correction second coil (**23**) that moves lens holder (**11**) in the diagonal direction of lens holder moving section (**12**, **14**, **15**, **16**), that is, in the second direction (the u direction) and third direction (the v direction), in cooperation with driving magnet (**13**); and the supporting section (fixed section **20**, suspension wire **30**) that supports the lens holder moving section (**12**, **14**, **15**, **16**) in such a manner that the lens holder moving section is movable in the second direction (the u direction) and third direction (the v direction).

According to lens driving apparatus **1**, since the driving magnet (permanent magnet **13**) and second coil (**23**) are disposed at the four corners of the apparatus which is square in plan view to effectively utilize the dead space in the conventional lens driving apparatuses, the space for disposing driving magnet (**13**) and second coil (**23**) can be reduced, and miniaturization can be achieved in comparison with conventional apparatuses.

It is obvious that the external shape of camera module M according to the embodiment (see FIG. **8A**) is smaller than that of the conventional camera module (see FIG. **8B**) when substantially the same external shape of first coil **111** and substantially the same thickness of the permanent magnet are employed as illustrated in FIG. **8**.

The present inventor estimates that the conventional lens driving apparatus having a size of 11.5 mm×11.5 mm can be miniaturized to the size of 8.5 mm×8.5 mm, by more than 45% in planar dimension.

While the invention made by the present inventor has been specifically described based on the preferred embodiments, it is not intended to limit the present invention to the above-mentioned preferred embodiments but the present invention may be further modified within the scope and spirit of the invention defined by the appended claims.

For example, as position detecting magnets **17A** and **17B**, commonly used bar magnets which are magnetized in the longitudinal direction or the short direction may also be used. In this case, position detecting magnets **17A** and **17B** are obliquely disposed so that the magnetizing direction corresponds to the u direction or the v direction.

In addition, while position detecting magnets **17A** and **17B** are disposed at two sides of magnet holder **12** facing each other in the embodiment, position detecting magnets **17A** and

11

17B may also be disposed at adjacent two sides. Also in this case, it suffices that one of position detecting magnets 17 is magnetized in the u direction and the other of position detecting magnets 17 is magnetized in the v direction.

In addition, it is also possible to dispose position detecting magnets 17A and 17B on fixed section 20 side, and Hall devices 24A and 24B on the movable section 10 side.

In addition, it is also possible that, as illustrated in FIG. 9, Hall device 24A, which detects the position of movable section 10 in the u direction, is disposed to face one of permanent magnets 13A and 13B (in FIG. 9, permanent magnet 13A) in the Z direction with a gap therebetween, and Hall device 24B, which detects the position of movable section 10 in the v direction, is disposed to face one of permanent magnets 13C and 13D (in FIG. 9, permanent magnet 13C) in the Z direction with a gap therebetween. Here, permanent magnets 13A and 13B are disposed to face each other in the u direction, and permanent magnets 13C and 13D are disposed to face each other in the v direction.

In this case, since permanent magnets 13A and 13C are used for the position detection, it is not necessary to dispose position detecting magnets 17A and 17B unlike the embodiment. However, since second coils 23A and 23C are disposed between permanent magnets 13A and 13C and Hall devices 24A and 24B, a magnetic field which is generated when a current is passed through second coils 23A and 23C is undesirably detected by Hall devices 24A and 24B. In other words, under the influence of a magnetic field which is generated when a current is passed through second coils 23A and 23C, the detection accuracy of Hall devices 24A and 24B may be decreased.

In view of the above, when permanent magnets 13A and 13C are used for the position detection, it is preferable to employ separation-type coils, as second coils 23A and 23C, which are each separated at the center thereof in the longitudinal direction, as illustrated in FIG. 9. By disposing Hall devices 24A and 24B just below the portions where second coils 23A and 23C are separated, it is possible to prevent the problem that the detection accuracy of Hall devices 24A and 24B is decreased by a magnetic field which is generated when a current is passed through second coils 23A and 23C.

Further, as the position detecting section that detects the position of movable section 10 in the XY plane, an optical sensor composed of a combination of a photointerrupter and a reflection plate may be employed.

While camera module M and lens driving apparatus 1 to be mounted in a smartphone are described in the embodiment, the camera module and the lens driving apparatus according to the embodiment of the present invention are applicable to laptop computers, tablet personal computers, mobile terminals such as mobile game machines, Web cameras, and camera apparatuses such as in-vehicle cameras.

The embodiment disclosed herein is merely an exemplification and should not be considered as limitative. The scope of the present invention is specified by the following claims, not by the above-mentioned description. It should be understood that various modifications, combinations, sub-combinations and alterations may occur depending on design requirements and other factors in so far as they are within the scope of the appended claims or the equivalents thereof.

What is claimed is:

1. A lens driving apparatus comprising:

- a lens holder to which a lens barrel can be attached, the lens holder including an auto-focusing first coil;
- a lens holder moving section that is square as viewed in a plane orthogonal to a first direction along an optical axis, the lens holder moving section being configured to sup-

12

port the lens holder in such a manner that the lens holder is movable in the first direction;

driving magnets disposed at four corners of the lens holder moving section, the driving magnet being configured to move the lens holder in the first direction in cooperation with the first coil;

a camera-shake correction second coil configured to move a movable section in a second direction and a third direction in cooperation with the driving magnet, the movable section including the lens holder, the lens holder moving section, and the driving magnet, the second direction and the third direction corresponding to diagonal directions of the lens holder moving section;

a position detecting section configured to detect a position of the movable section in the second direction and the third direction;

a fixed section disposed apart from the movable section in the first direction, the fixed section including the second coil and the position detecting section; and

a first supporting section configured to support the movable section with respect to the fixed section in such a manner that the movable section is movable in the second direction and the third direction, wherein:

the driving magnets include a pair of first driving magnets disposed to face each other in the second direction and a pair of second driving magnets disposed to face each other in the third direction,

the position detecting section includes a first Hall device disposed to face one of the first driving magnets in the first direction with a gap therebetween, and a second Hall device disposed to face one of the second driving magnets in the first direction with a gap therebetween, the second coil is disposed between the first Hall device and one of the first driving magnets provided with the first Hall device and between the second Hall device and one of the second driving magnets provided with the second Hall device,

wherein the lens holder moving section includes:

- a magnet holder configured to hold the driving magnets,
- a second supporting section configured to support the lens holder with respect to the magnet holder on a bottom side where the position detecting section is disposed, and

- a third supporting section configured to support the lens holder with respect to the magnet holder on a top side opposite to the bottom side, and

wherein the second supporting section includes:

- a magnet holder attaching section to be fixed to the magnet holder,

- a lens holder attaching section to be fixed to the lens holder; and

- an arm section configured to link the magnet holder attaching section and the lens holder attaching section, the arm section having a form extending along an external shape of the lens holder,

- wherein the second supporting section is disposed without overlapping with the driving magnets in the first direction.

2. The lens driving apparatus according to claim 1, wherein the lens barrel is fixed to the lens holder by bonding.

3. The lens driving apparatus according to claim 1, wherein the lens holder includes:

- the first coil composed of an air-core coil, wherein an inner peripheral surface of the first coil is exposed; and
- a coil holding member configured to tightly sandwich the first coil.

4. The lens driving apparatus according to claim 1, wherein the lens holder includes a protrusion protruding radially outwardly, and

the lens holder moving section includes an engaging section at which the protrusion is engaged, the engaging section being configured to restrict the movement of the lens holder. 5

5. A camera module comprising:

the lens driving apparatus according to claim 1;

a lens barrel held by the lens holder; and 10

an imaging section configured to capture a subject image formed by the lens barrel.

6. A camera-equipped mobile terminal comprising the camera module according to claim 5.

* * * * *