

US008695834B2

(12) **United States Patent**
Panek, Jr.

(10) **Patent No.:** **US 8,695,834 B2**
(45) **Date of Patent:** ***Apr. 15, 2014**

(54) **MEDICAL WASTE DISPOSAL CONTAINER SYSTEM**

(56) **References Cited**

U.S. PATENT DOCUMENTS

(75) Inventor: **Robert Joseph Panek, Jr.**, Huntley, IL (US)
(73) Assignee: **Covidien LP**, Mansfield, MA (US)
(*) Notice: Subject to any disclaimer, the term of this patent is extended or adjusted under 35 U.S.C. 154(b) by 913 days.
This patent is subject to a terminal disclaimer.

1,315,143	A *	9/1919	Masters	217/57
2,351,597	A	6/1944	Burlin	
2,634,933	A	4/1953	Grimsley	
2,667,320	A	1/1954	Whitley	
3,008,604	A	11/1961	Garner	
3,041,030	A	6/1962	Heimrich	
3,064,931	A	11/1962	Rowe	
3,208,706	A	9/1965	Clark	
3,333,721	A	8/1967	Marek	
3,347,507	A	10/1967	Dyer	
3,514,007	A *	5/1970	Woods, Sr.	220/23.88
3,869,979	A	3/1975	Sulcek	
4,280,640	A	7/1981	Daloisio	
4,338,987	A	7/1982	Miles	
4,420,168	A	12/1983	Dewing	

(Continued)

(21) Appl. No.: **12/047,784**

(22) Filed: **Mar. 13, 2008**

(65) **Prior Publication Data**

US 2008/0156818 A1 Jul. 3, 2008

FOREIGN PATENT DOCUMENTS

DE 890623 9/1953
OTHER PUBLICATIONS

General translation of Office Action of Mexican Patent Office.
SharpSafety Brochure of Tyco Healthcare, dated Dec. 2000.

(Continued)

Primary Examiner — Stephen Castellano
(74) *Attorney, Agent, or Firm* — Lisa E. Winsor, Esq.

(57) **ABSTRACT**

A carrier is configured to hold a container having a door mounted for reciprocation between opened and closed positions. The carrier includes a body adapted to receive the container as well as an extension coupled for reciprocal movement with respect to the body. The extension is adapted for engagement with the door of the container, and the reciprocal movement of the extension is adapted to reciprocate the door of the container between the opened and closed position. A container system including a container and the carrier is also provided.

Related U.S. Application Data

(63) Continuation of application No. 10/792,361, filed on Mar. 3, 2004, now Pat. No. 7,364,049, and a continuation of application No. 09/845,976, filed on Apr. 30, 2001, now Pat. No. 7,114,629.

(51) **Int. Cl.**
B65F 1/04 (2006.01)

(52) **U.S. Cl.**
USPC **220/345.1**; 220/254.1; 220/254.9;
220/345.4; 220/908

(58) **Field of Classification Search**
USPC 220/254.1, 254.9, 345.1, 348, 345.4,
220/908, 260, 262, 23.87, 23.91, 23.86,
220/23.83; 232/43.2

See application file for complete search history.

18 Claims, 13 Drawing Sheets

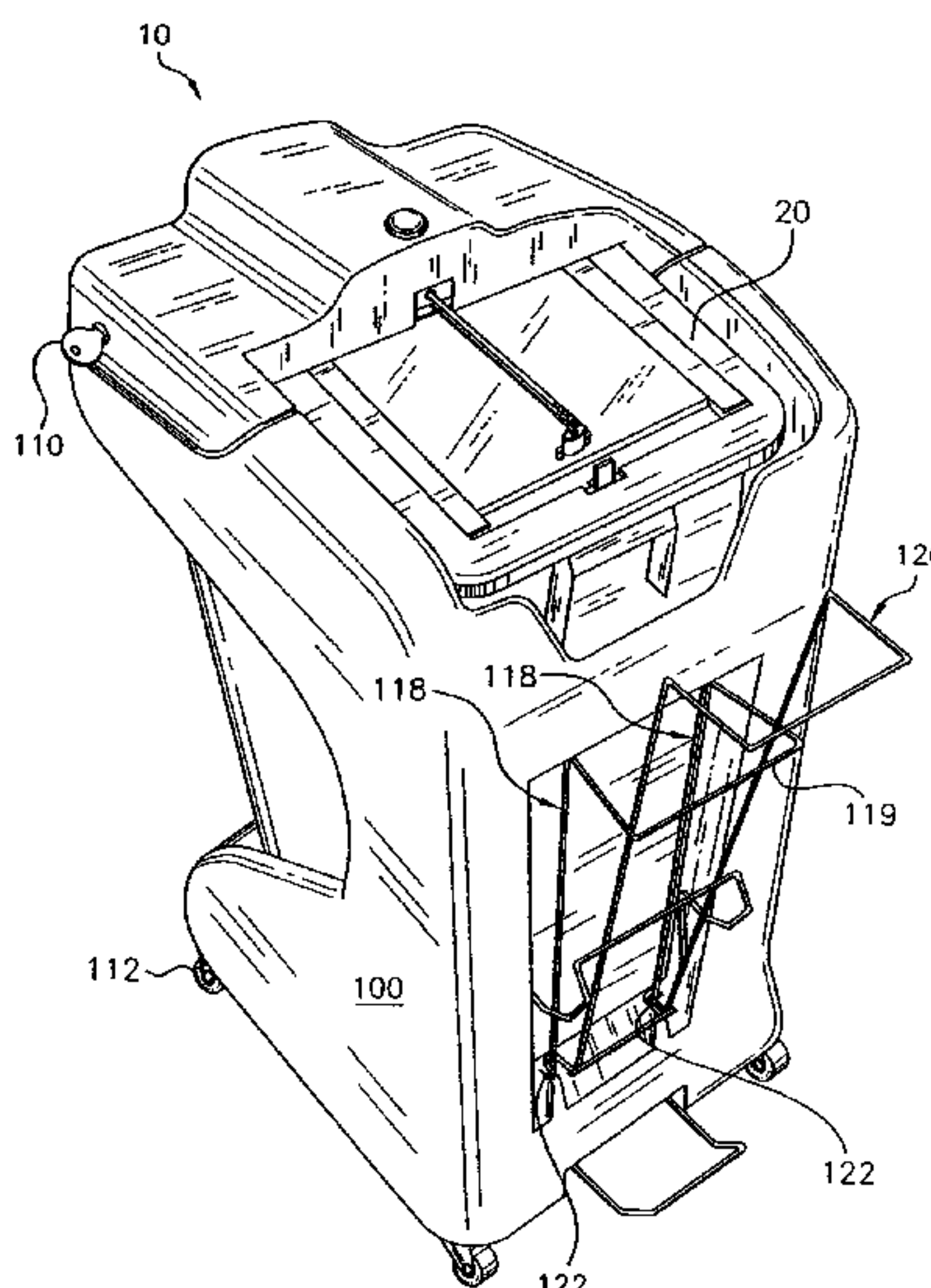

(56)

References Cited

U.S. PATENT DOCUMENTS

4,637,545	A	1/1987	Stewart	
4,765,548	A	8/1988	Sing	
4,768,742	A	9/1988	Kaaloa	
4,883,189	A	11/1989	Lobbert	
4,911,294	A	3/1990	Russo et al.	
4,913,309	A	4/1990	Fink	
4,949,866	A	8/1990	Sanders	
5,048,712	A	9/1991	Wolters	
5,082,132	A	1/1992	Tsai	
5,107,990	A	4/1992	Wicherski et al.	
D326,753	S	6/1992	DeBusk	
5,143,389	A	9/1992	Jonkers	
5,163,574	A	11/1992	Sosan	
D332,852	S	1/1993	Delmerico	
5,195,649	A	3/1993	Wolters	
5,230,525	A	7/1993	Delmerico et al.	
5,235,795	A	8/1993	DeBusk	
D341,237	S	11/1993	DeBusk	
5,348,222	A	9/1994	Patey	
5,354,023	A	10/1994	Meeks	
D352,350	S	11/1994	Rambo et al.	
5,372,271	A	12/1994	Miller et al.	
D358,240	S	5/1995	Mosior	
5,415,315	A	5/1995	Ramirez	
5,419,435	A	5/1995	Perzan et al.	
5,474,201	A	12/1995	Liu	
5,531,346	A	7/1996	Mosior	
5,531,348	A	7/1996	Baker et al.	
5,538,158	A	7/1996	Prout et al.	
5,570,547	A	11/1996	Webb et al.	
5,582,322	A	12/1996	Prout et al.	
5,590,840	A	1/1997	Adams et al.	
5,641,171	A	6/1997	Posey et al.	
5,659,247	A	8/1997	Clements	
5,671,859	A	9/1997	Sheu et al.	
5,673,811	A	10/1997	Dickinson et al.	
D388,577	S	12/1997	Rehrig et al.	
5,730,451	A	3/1998	Walker	
D393,334	S	4/1998	Presnell et al.	
5,779,047	A	7/1998	Darrah	
5,881,896	A	3/1999	Presnell et al.	
5,899,468	A	5/1999	Apps et al.	
5,947,285	A	9/1999	Gaba et al.	
6,010,024	A	1/2000	Wang	
6,053,354	A	4/2000	Niemeyer	
6,138,558	A	10/2000	Harrington	
6,202,922	B1	3/2001	Phillips et al.	
D445,228	S	7/2001	Apps et al.	
D478,701	S	8/2003	Panek, Jr.	
6,623,316	B1	9/2003	Wu	
6,626,316	B2	9/2003	Yang	
6,626,321	B2	9/2003	Jaeger	
6,651,992	B1	11/2003	Smith, Sr.	
6,722,672	B2	4/2004	Cates et al.	
7,114,629	B2 *	10/2006	Panek, Jr.	220/345.1
7,364,049	B2 *	4/2008	Panek, Jr.	220/345.1
2002/0158068	A1	10/2002	Panek, Jr.	
2004/0020927	A1	2/2004	Yang et al.	

OTHER PUBLICATIONS

Office action issued Dec. 2, 2008 in related U.S. Appl. No. 11/085,488. 8 pgs.
 Response filed Dec. 31, 2008 to Office Action dated Dec. 2, 2008 from related U.S. Appl. No. 11/085,488. 6 pgs.
 Office action issued Feb. 10, 2009 in related U.S. Appl. No. 11/085,488. 4 pgs.
 Response filed Apr. 24, 2009 to Office Action dated Feb. 10, 2009 from related U.S. Appl. No. 11/085,488. 19 pgs.
 Office action issued Jul. 17, 2009 in related U.S. Appl. No. 11/085,488. 10 pgs.

Response filed Jan. 19, 2010 to Office Action dated Jul. 17, 2009 from related U.S. Appl. No. 11/085,488. 14 pgs.
 Office action issued Apr. 16, 2010 in related U.S. Appl. No. 11/085,488. 9 pgs.
 Response filed Oct. 12, 2010 to Office Action dated Apr. 16, 2010 from related U.S. Appl. No. 11/085,488. 20 pgs.
 Office action issued Jun. 15, 2011 in related U.S. Appl. No. 11/085,488. 6 pgs.
 Office action issued Jul. 21, 2010 in related U.S. Appl. No. 12/388,085. 12 pgs.
 Response filed Nov. 22, 2010 to Office Action dated Jul. 21, 2010 from related U.S. Appl. No. 12/388,085. 26 pgs.
 Office action issued Feb. 25, 2011 in related U.S. Appl. No. 12/388,085. 9 pgs.
 Response filed Mar. 24, 2011 to Office Action dated Feb. 25, 2011 from related U.S. Appl. No. 12/388,085. 11 pgs.
 Office action issued Sep. 13, 2001 in related U.S. Appl. No. 09/845,976. 8 pgs.
 Response filed Jan. 14, 2002 to Office Action dated Sep. 13, 2001 from related U.S. Appl. No. 09/845,976. 11 pgs.
 Office action issued Apr. 17, 2002 in related U.S. Appl. No. 09/845,976. 8 pgs.
 Response filed Aug. 19, 2002 to Office Action dated Apr. 17, 2002 from related U.S. Appl. No. 09/845,976. 8 pgs.
 Office action issued Nov. 18, 2002 in related U.S. Appl. No. 09/845,976. 7 pgs.
 Response filed May 14, 2003 to Office Action dated Nov. 18, 2002 from related U.S. Appl. No. 09/845,976. 22 pgs.
 Office action issued Jul. 17, 2003 in related U.S. Appl. No. 09/845,976. 10 pgs.
 Response filed Jan. 16, 2004 to Office Action dated Jul. 17, 2003 from related U.S. Appl. No. 09/845,976. 31 pgs.
 Office action issued Apr. 7, 2004 in related U.S. Appl. No. 09/845,976. 6 pgs.
 Response filed Oct. 6, 2004 to Office Action dated Apr. 7, 2004 from related U.S. Appl. No. 09/845,976. 28 pgs.
 Office action issued Aug. 4, 2005 in related U.S. Appl. No. 09/845,976. 5 pgs.
 Response filed Feb. 3, 2006 to Office Action dated Aug. 4, 2005 from related U.S. Appl. No. 09/845,976. 8 pgs.
 Office action issued Jul. 5, 2006 in related U.S. Appl. No. 10/792,361. 8 pgs.
 Response filed Jan. 3, 2007 to Office Action dated Jul. 5, 2006 from related U.S. Appl. No. 10/792,361. 16 pgs.
 Office action issued Feb. 20, 2007 in related U.S. Appl. No. 10/792,361. 6 pgs.
 Response filed May 17, 2007 to Office Action dated Feb. 20, 2007 from related U.S. Appl. No. 10/792,361. 6 pgs.
 Office action issued Jun. 8, 2009 in related U.S. Appl. No. 12/047,766. 11 pgs.
 Response filed Sep. 8, 2009 to Office Action dated Jun. 8, 2009 from related U.S. Appl. No. 12/047,766. 25 pgs.
 Office action issued Jan. 5, 2010 in related U.S. Appl. No. 12/047,766. 13 pgs.
 Office action issued Aug. 6, 2009 in related U.S. Appl. No. 12/047,828. 9 pgs.
 Response filed Nov. 6, 2009 to Office Action dated Aug. 6, 2009 from related U.S. Appl. No. 12/047,828. 12 pgs.
 Response filed Oct. 12, 2011 to Office Action dated Jun. 15, 2011 regarding related U.S. Appl. No. 11/085,488 now issued as Patent No. 8,201,704—2 pgs.
 Office action issued Nov. 15, 2011 in related U.S. Appl. No. 11/085,488 now issued as Patent No. 8,201,704—5 pgs.
 Response filed Jan. 12, 2012 to Office Action dated Nov. 15, 2011 regarding related U.S. Appl. No. 11/085,488 now issued as Patent No. 8,201,704—1 pg.

* cited by examiner

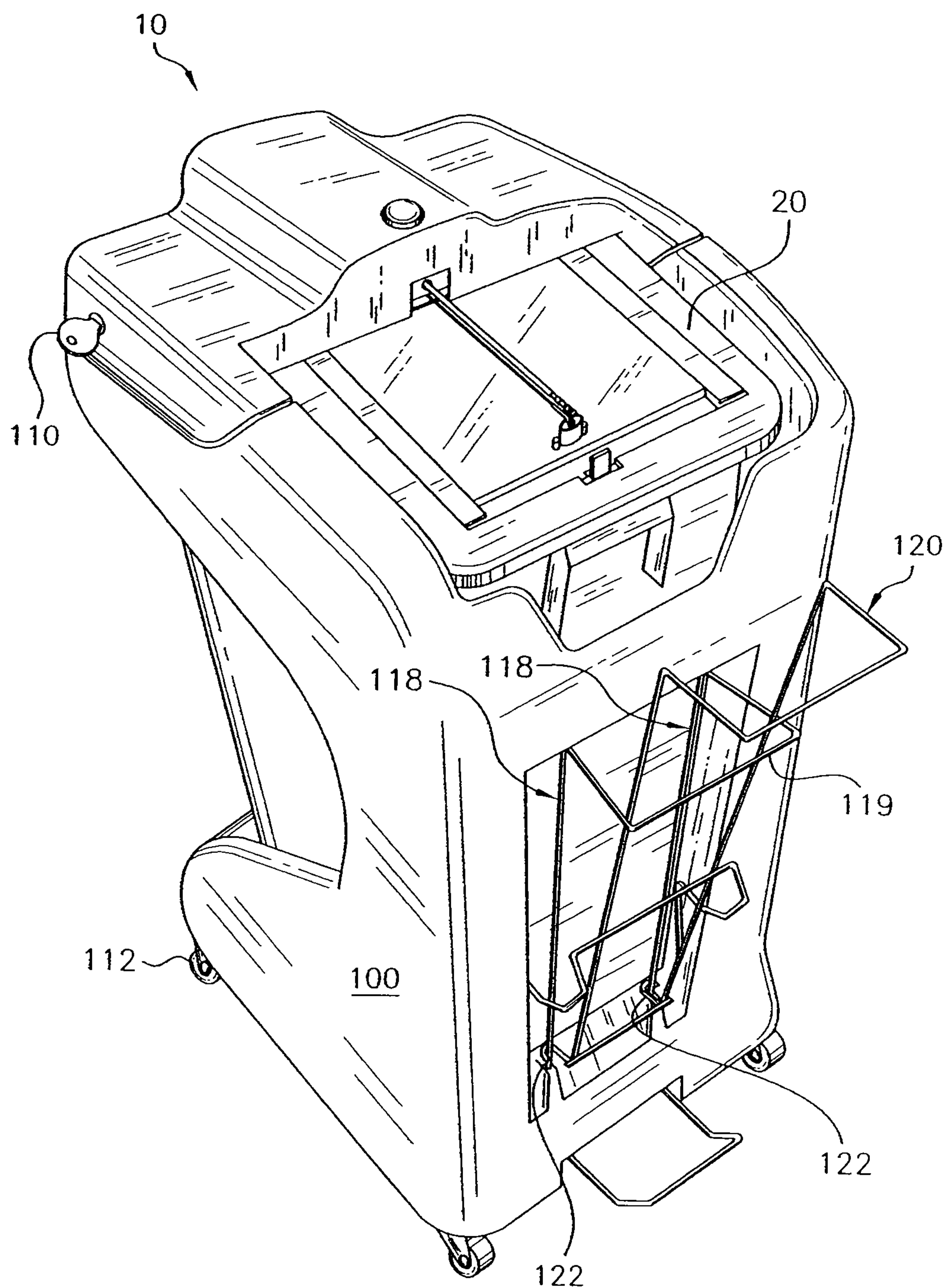

FIG. 1

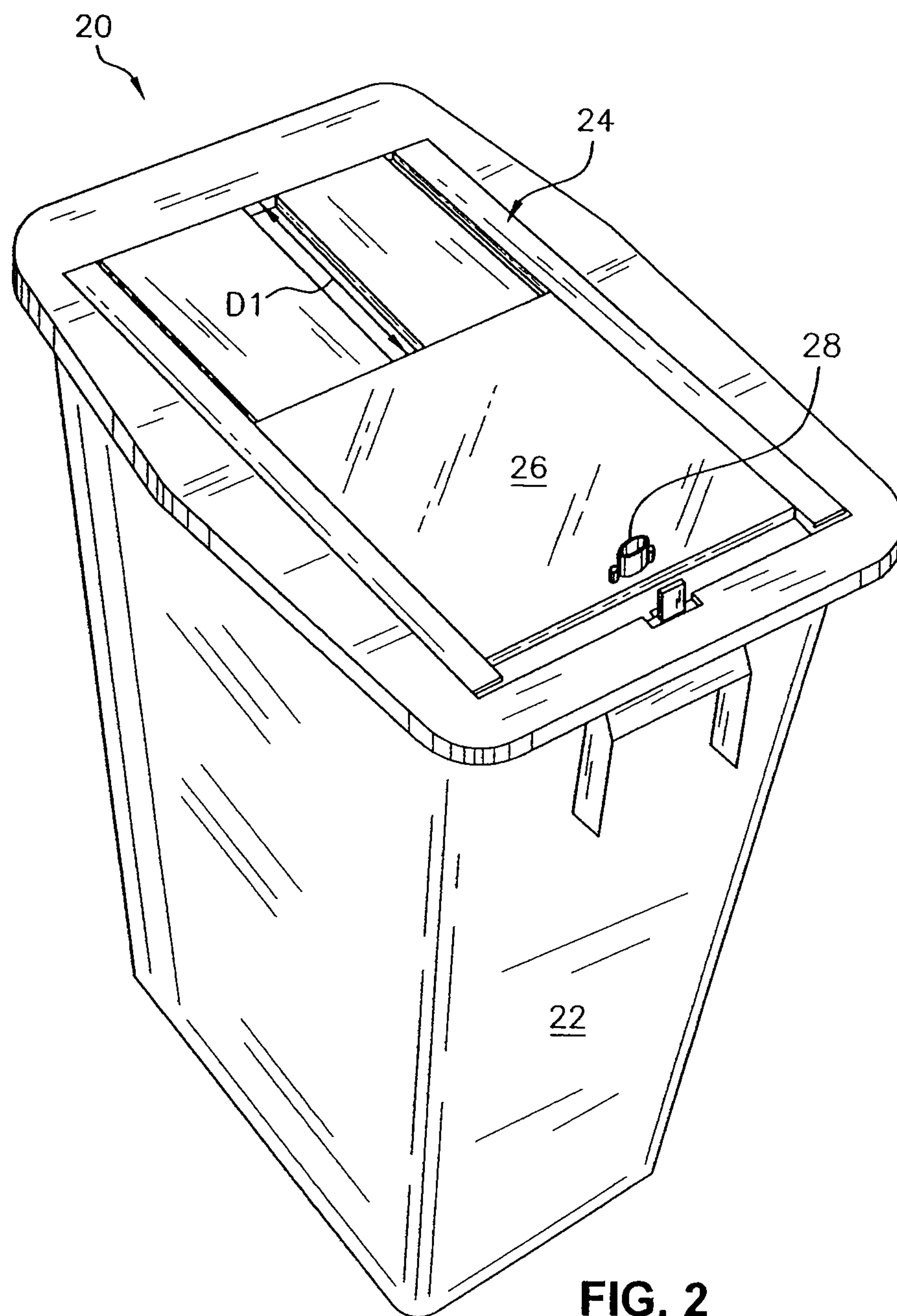

FIG. 2

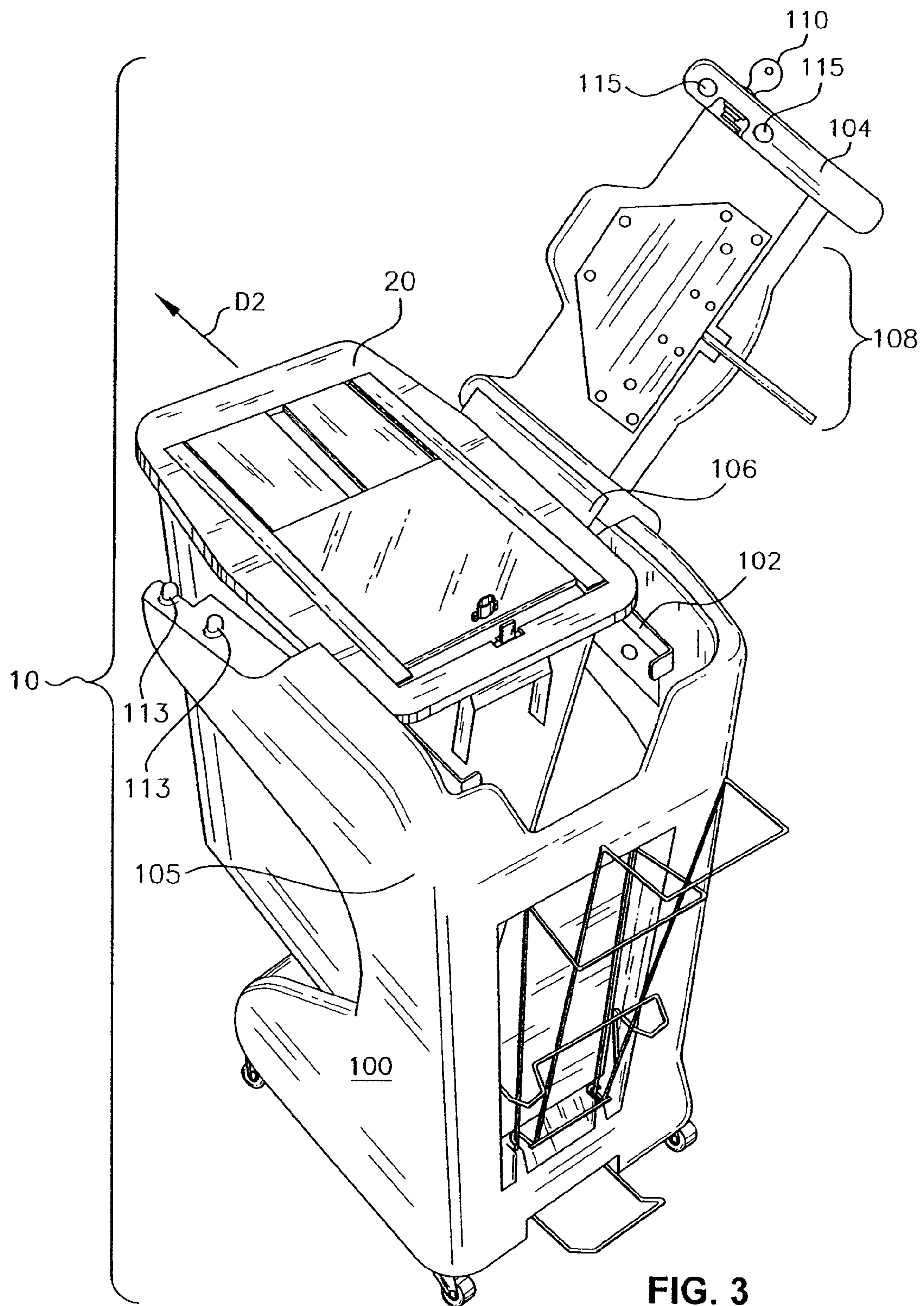

FIG. 3

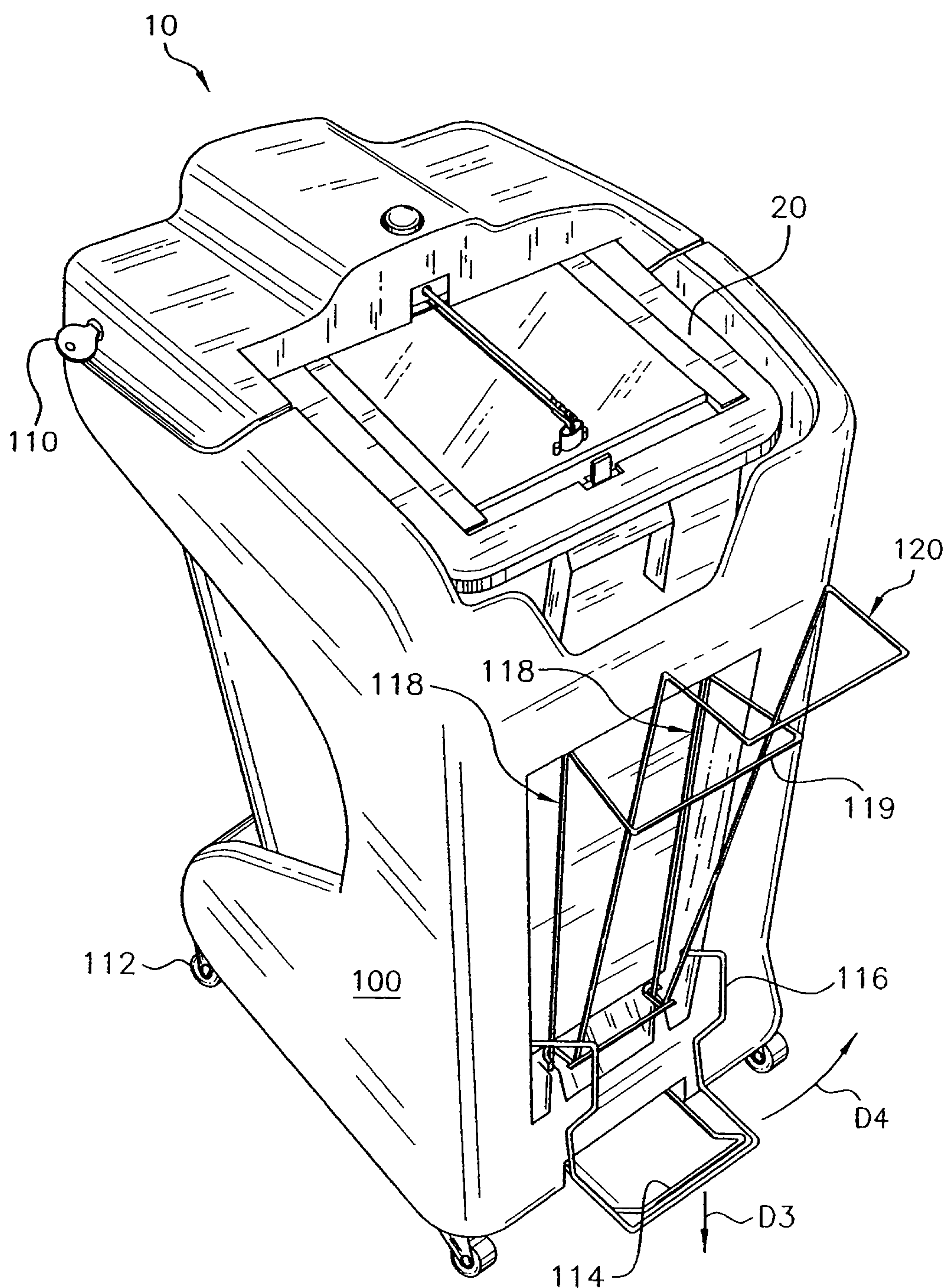

FIG. 4

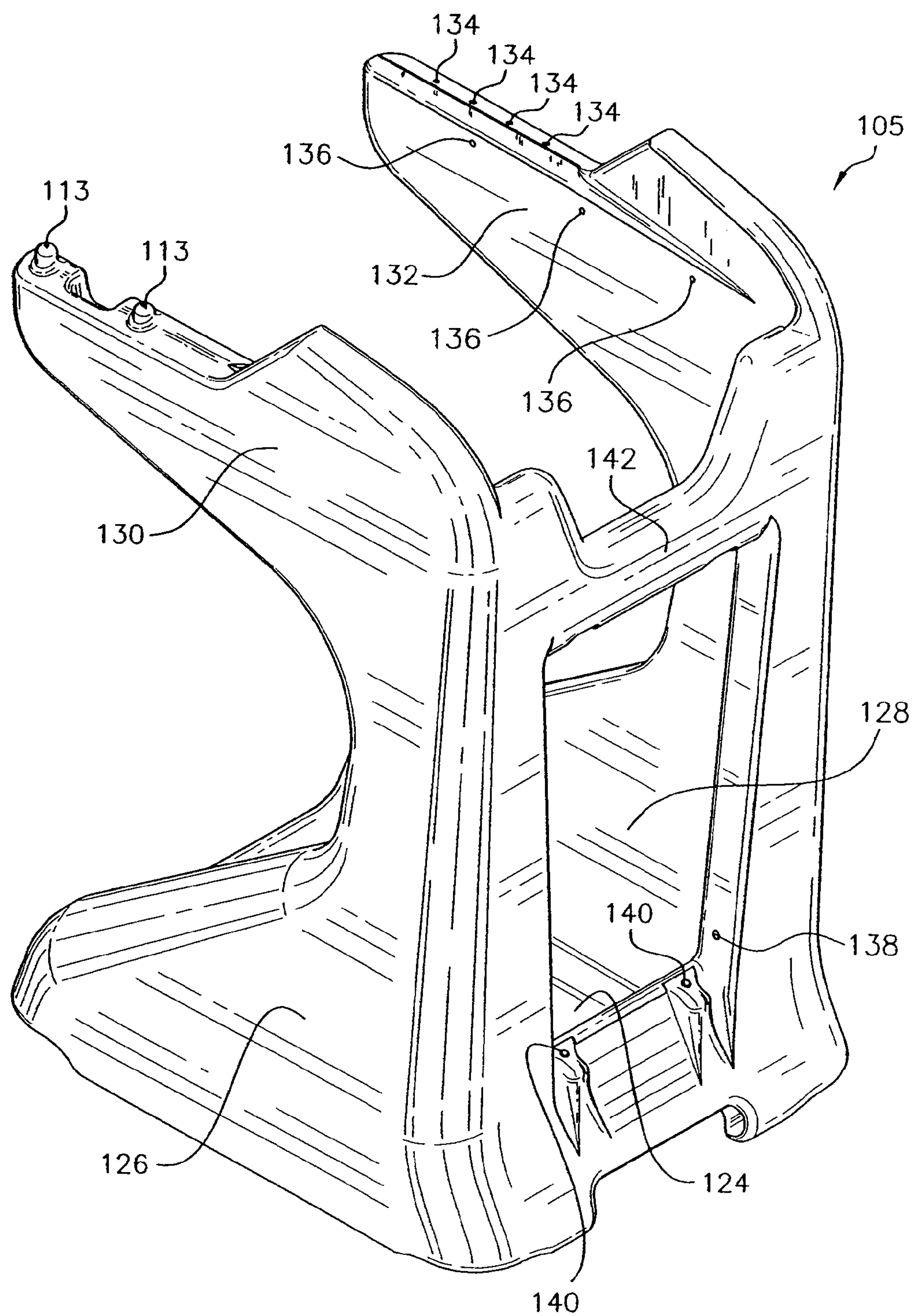

FIG. 5A

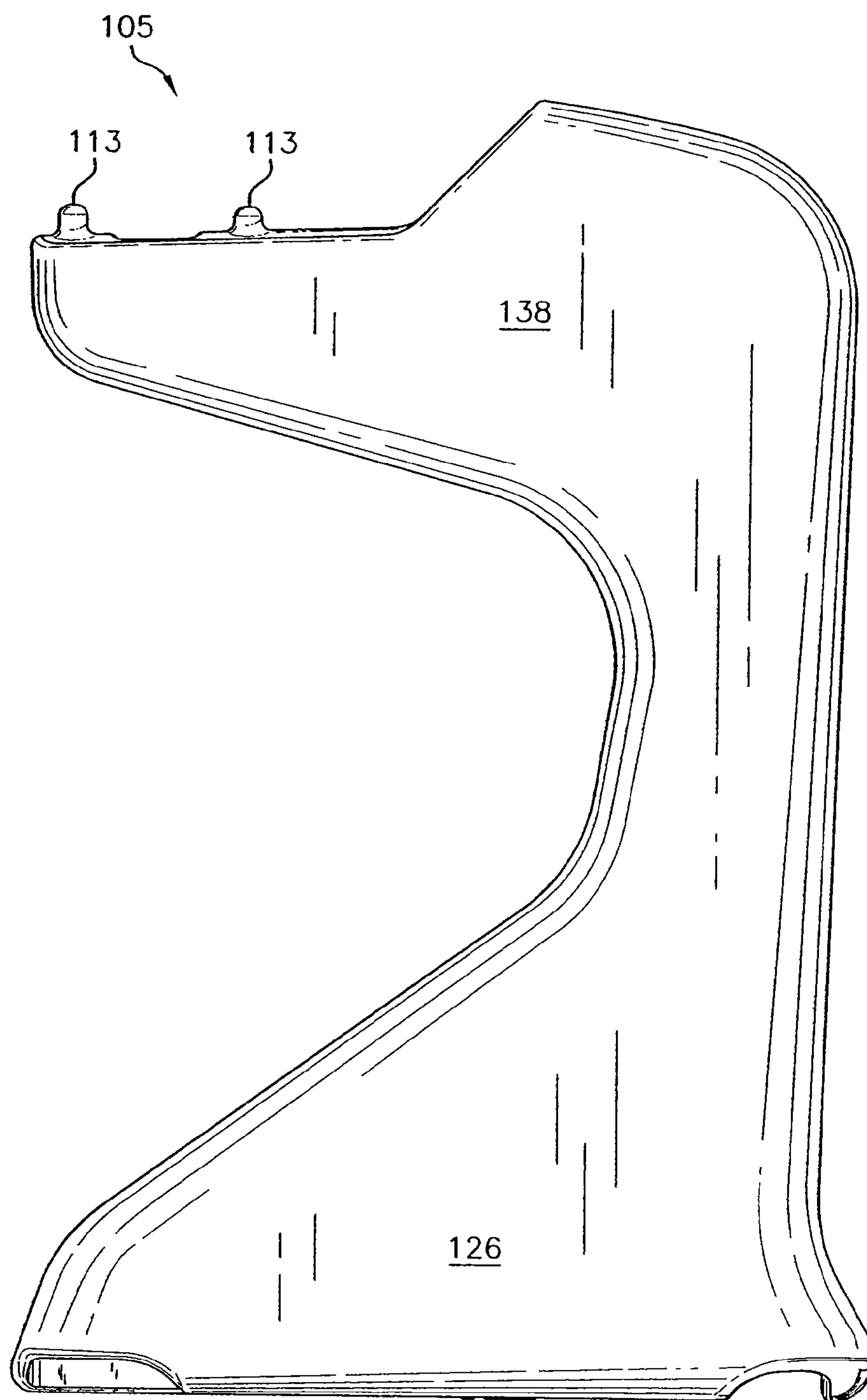

FIG. 5B

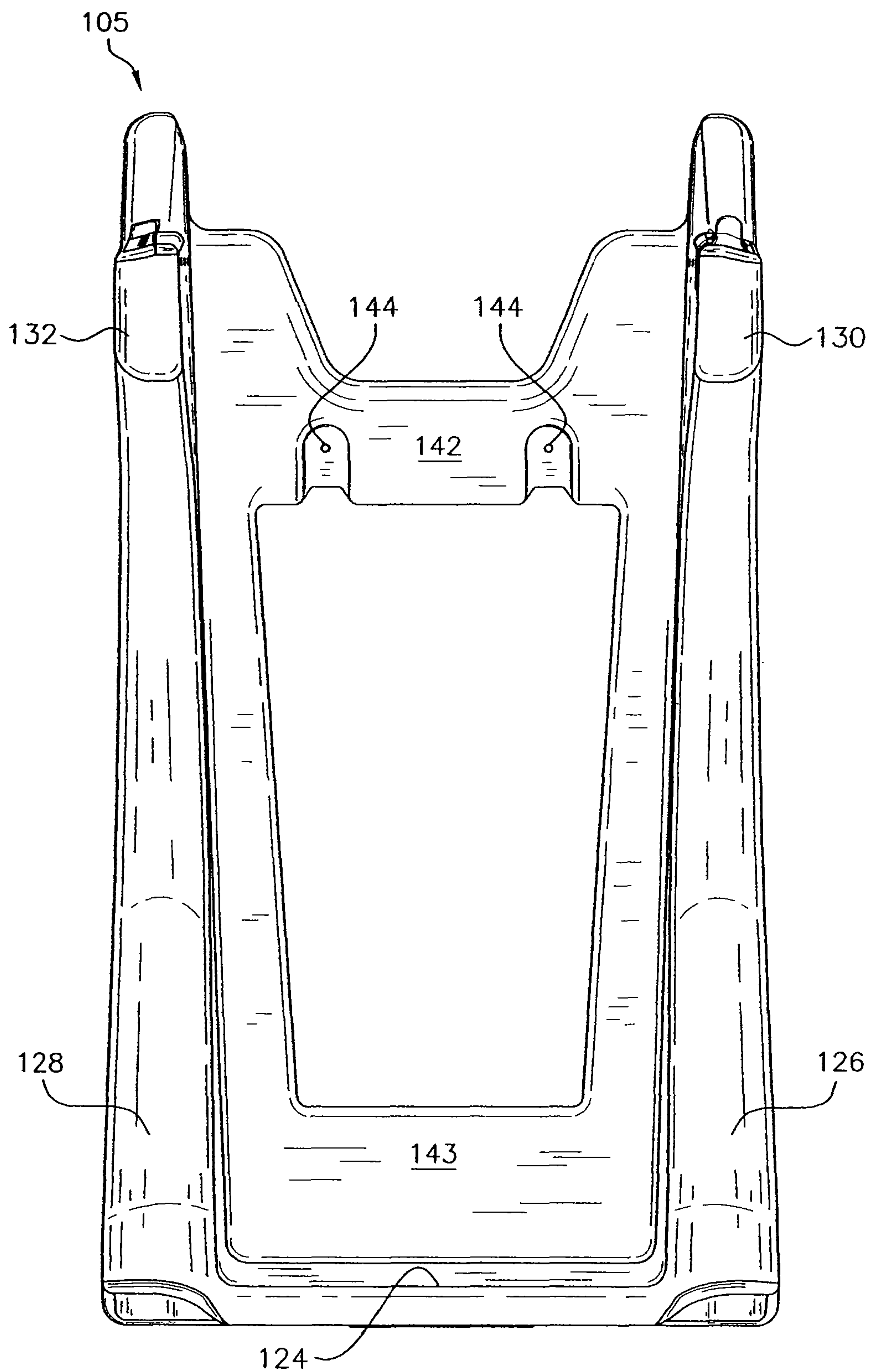

FIG. 5C

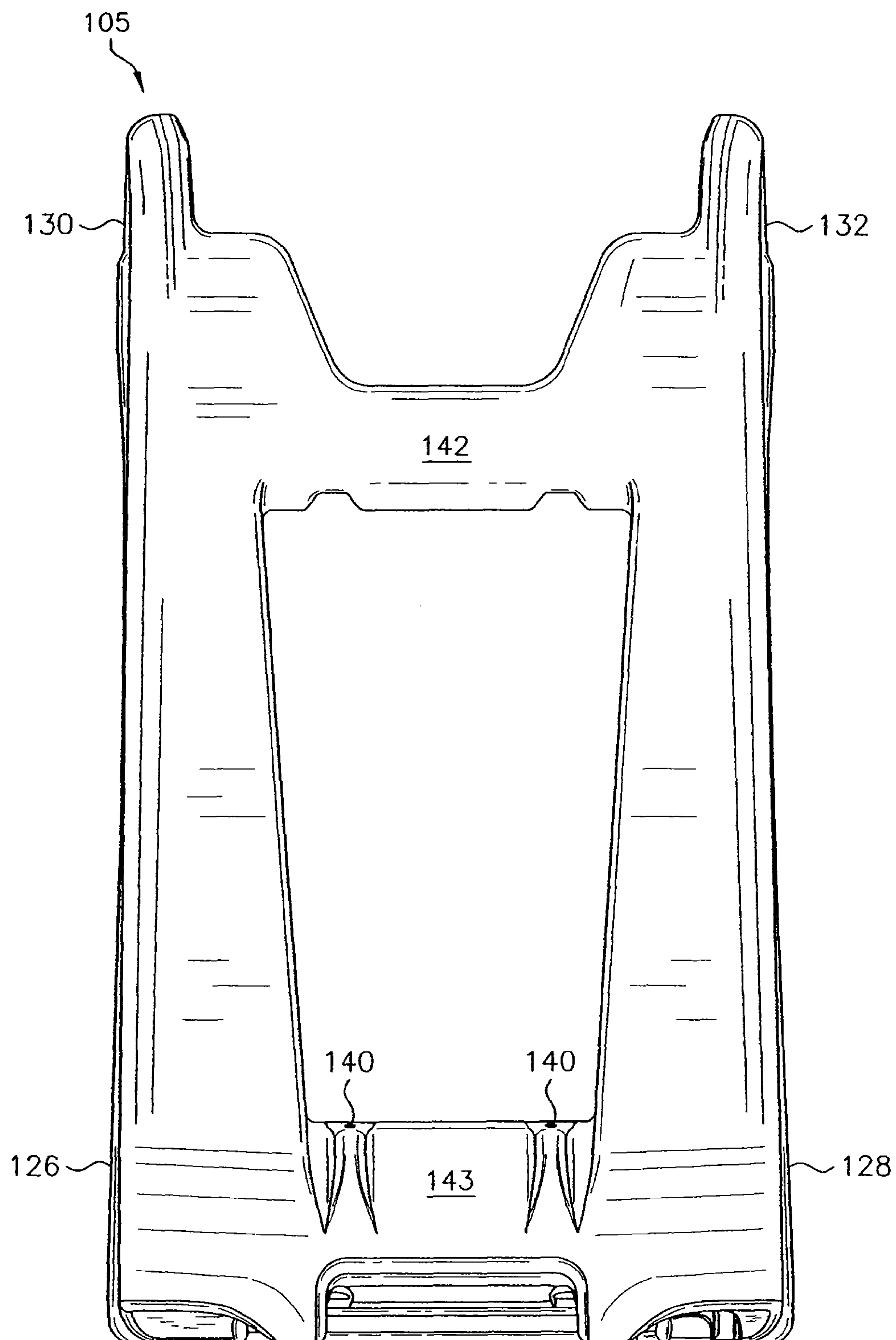

FIG. 5D

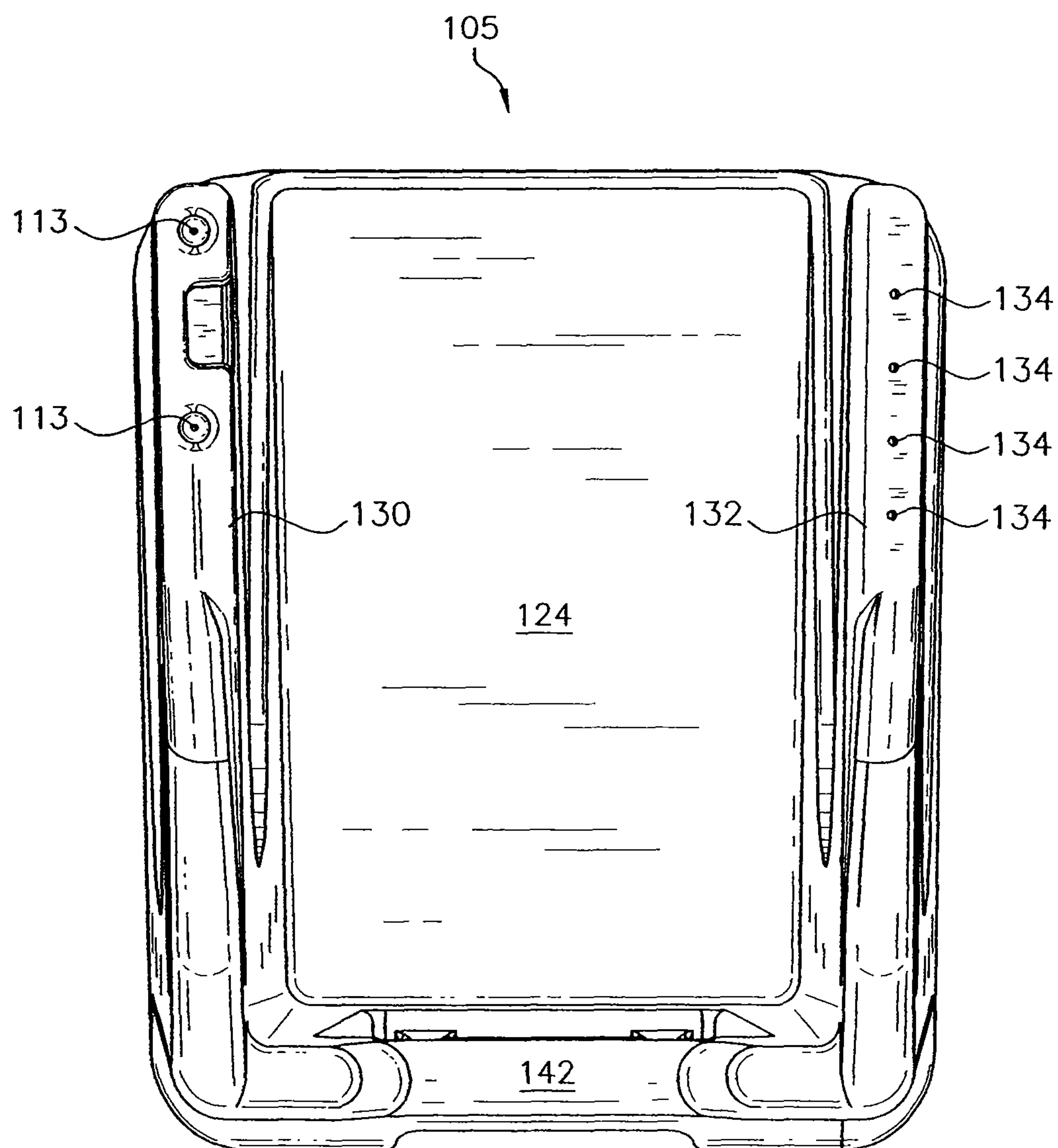

FIG. 5E

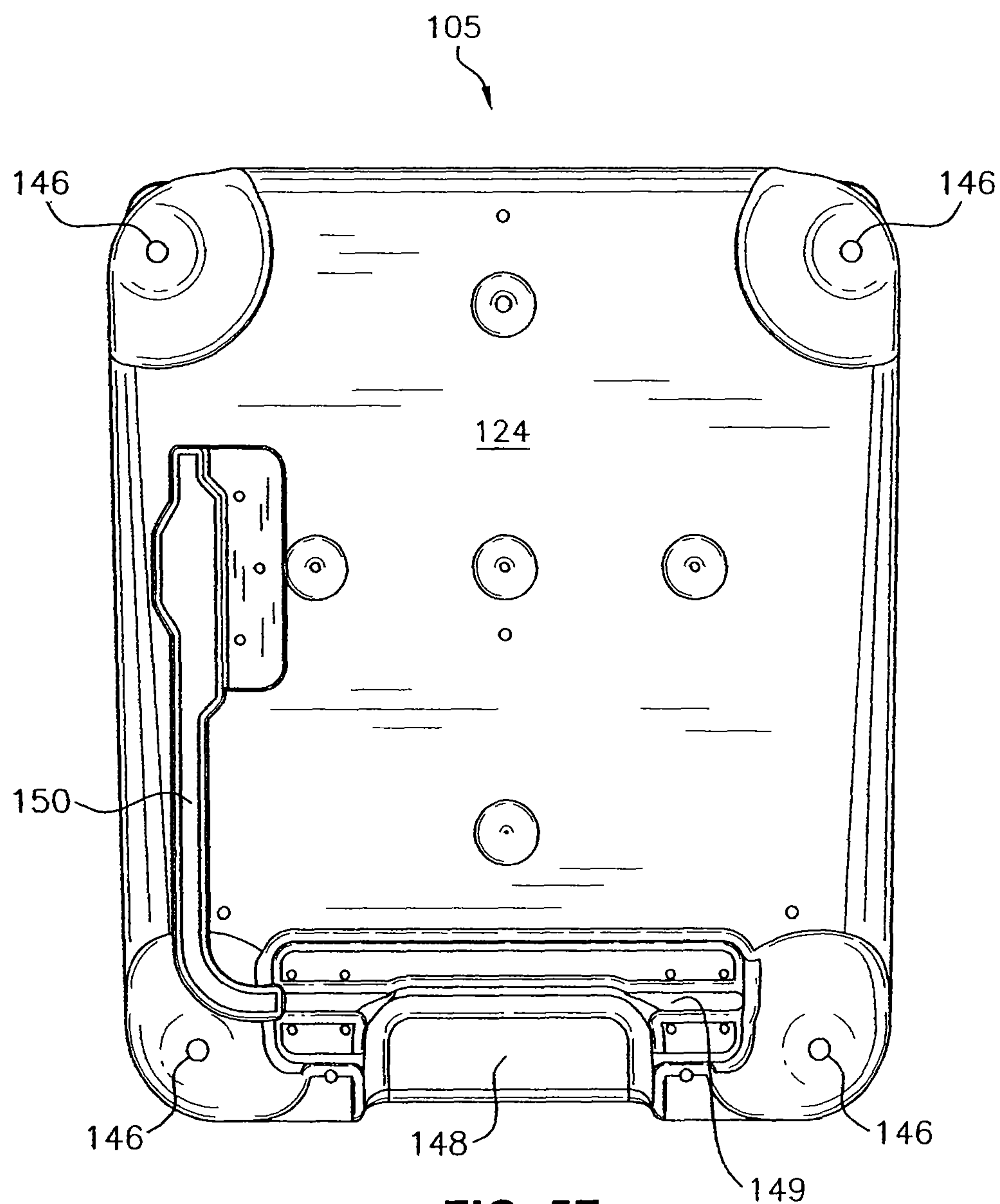

FIG. 5F

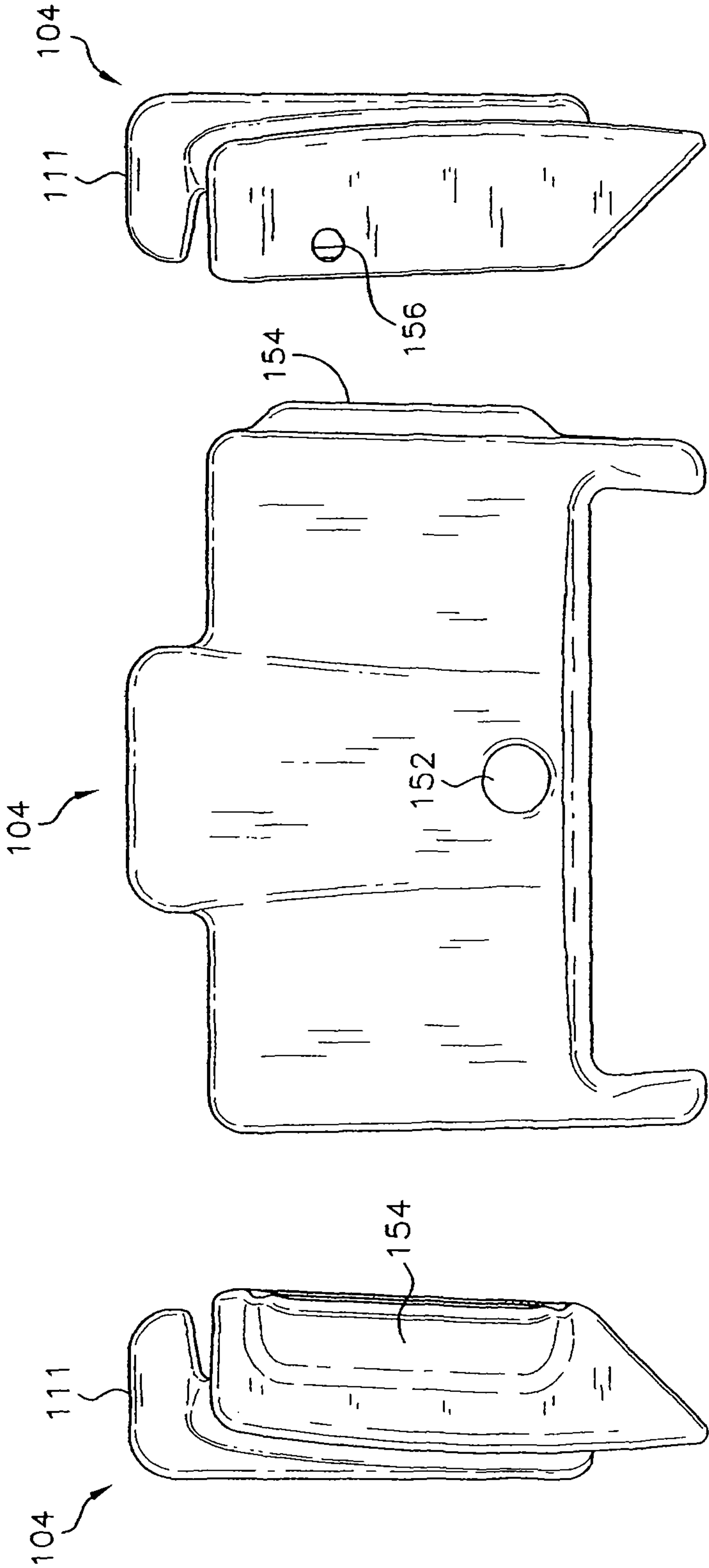

FIG. 6C

FIG. 6A

FIG. 6B

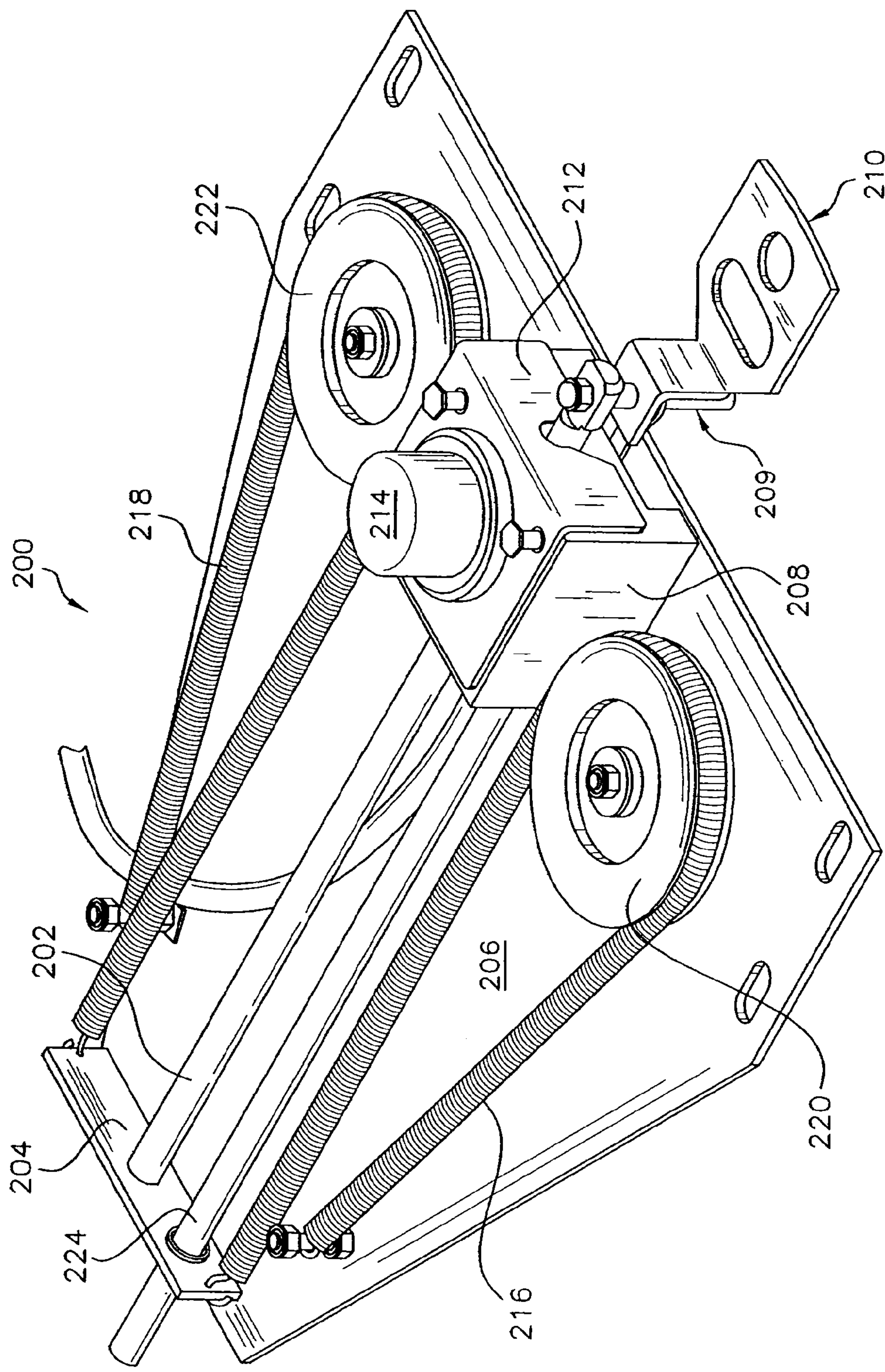
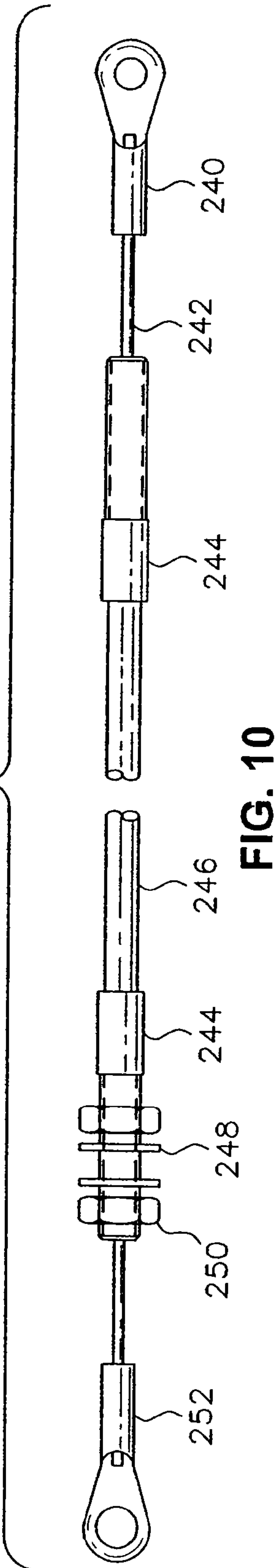
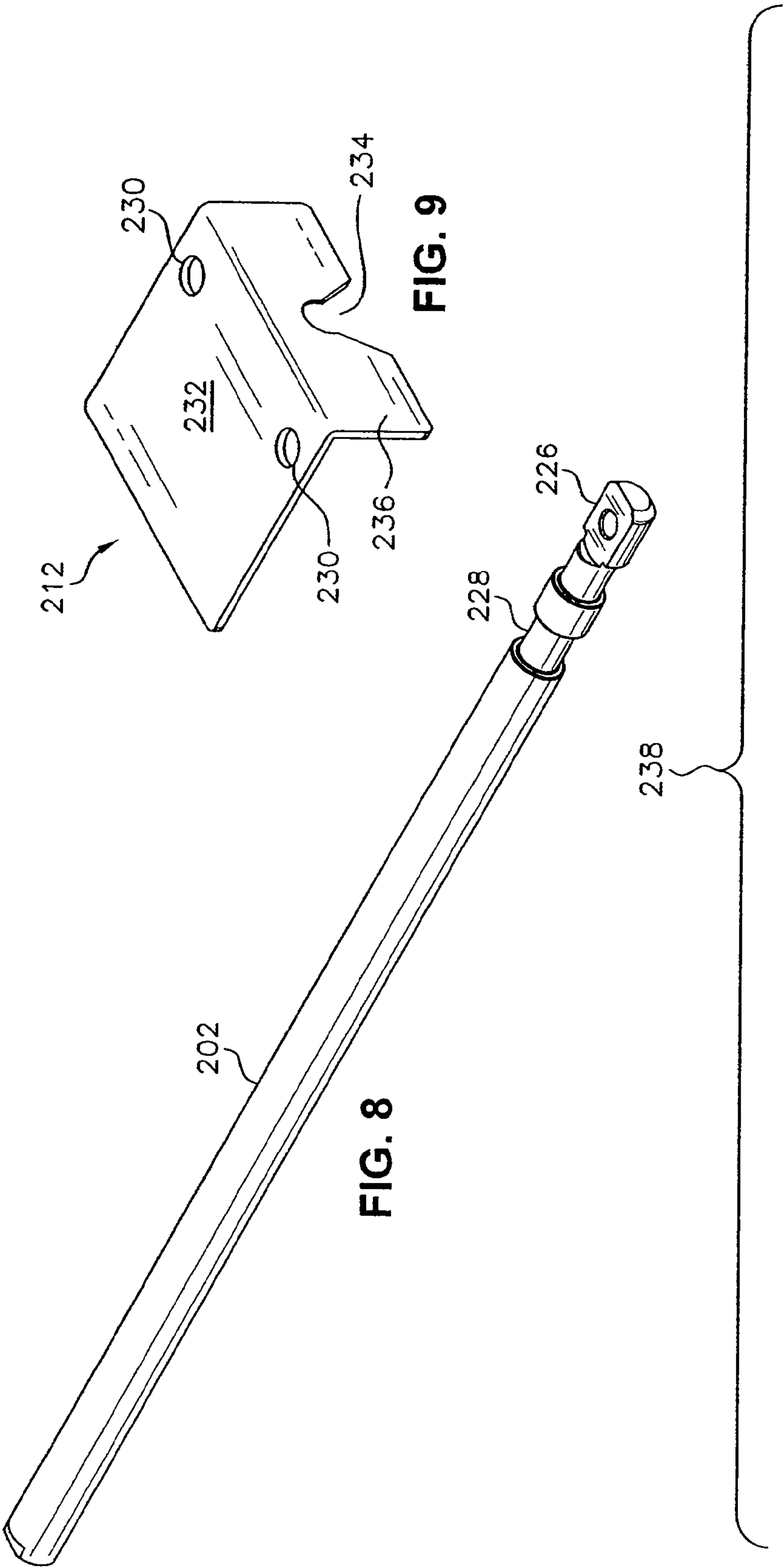

FIG. 7



MEDICAL WASTE DISPOSAL CONTAINER SYSTEM

This application is a Continuation of prior application Ser. No. 10/792,361, filed Mar. 3, 2004, now U.S. Pat. No. 7,364,049 which is a Continuation of prior application Ser. No. 09/845,976, filed Apr. 30, 2001, now U.S. Pat. No. 7,114,629. The entire disclosure of U.S. patent application Ser. No. 09/845,976 is expressly incorporated by reference herein.

FIELD OF THE INVENTION

This invention relates generally to the disposal of contaminated items and, in particular, to a system for use in a hospital or a similar environment where contaminated items are to be collected and disposed of without creating a hazard for patients or hospital personnel.

BACKGROUND OF THE INVENTION

In hospitals, clinics and similar medical institutions, contamination continues to be of upmost concern. The prevention of the spread of communicable diseases is a major priority; therefore, disposable, single-use, patient care products have become prevalent.

Such patient care products are contaminated, once used, and can transmit disease. These patient care products include devices such as hypodermic needles, intravenous needles, lasers, scalpel blades or other sharps—all of which are required to be disposed at their point of usage under current guidelines of the United States Centers for Disease Control.

Various disposal containers for medical waste have been proposed for the purpose of preventing individuals from gaining access to contaminated items, such as sharps, once the waste has been deposited into the container. For example, a waste container having a top with a slidable closure is disclosed by Mosior in U.S. Pat. No. 5,531,346. The top of the waste container disclosed by Mosior has an access aperture, and the slidable closure on the top is positioned to slide between opened and closed positions. The closure includes a handle to facilitate sliding movement of the closure. The closure disclosed by Mosior can be temporarily retained in a first closed position over the aperture, and can be permanently retained in a second closed position over the aperture.

A protective container is disclosed by Marek in U.S. Pat. No. 3,333,721. A removable cover of the container disclosed by Marek is interlockable with panels of the container, and the removable cover has a door opening and a slidable door positioned under the cover. The door of the container disclosed by Marek is moved by means of a cable that passes through the cover and is fastened at its lower end to a foot-pedal.

Despite these proposed containers, there remains a need, however, for an improved medical waste disposal system that can further reduce the chance of contact between the medical personnel and the medical waste and to help prevent unauthorized access to medical waste held within the container.

SUMMARY OF THE INVENTION

The present invention provides a carrier that is configured to hold a container having a door mounted for reciprocation between opened and closed positions. The carrier includes a body that is adapted to receive the container. The carrier also includes an extension that is coupled for reciprocal movement with respect to the body of the carrier. The extension is adapted for engagement with the door of the container. The

reciprocal movement of the extension is adapted to reciprocate the door of the container between the opened and closed positions.

The present invention also provides a container system having the container and the carrier.

BRIEF DESCRIPTION OF THE DRAWING

The invention is best understood from the following detailed description when read in connection with the accompanying drawing. It is emphasized, according to common practice, that various features illustrated in the drawing are not to scale. On the contrary, the dimensions of the various features are arbitrarily expanded or reduced for clarity. Included in the drawing are the following figures:

FIG. 1 is a perspective view of an embodiment of a container system according to this invention.

FIG. 2 is a perspective view of a container than can be used as a component of the container system illustrated in FIG. 1.

FIG. 3 is a perspective view of the container system illustrated in FIG. 1, as the container illustrated in FIG. 2 is being inserted into or withdrawn from a carrier component of the container system illustrated in FIG. 1.

FIG. 4 is a perspective view of a base portion of the container system illustrated in FIG. 1.

FIG. 5A is a perspective view of an embodiment of a body component of the container system illustrated in FIG. 1.

FIG. 5B is a left side view of the body component illustrated in FIG. 5A.

FIG. 5C is a rear view of the body component illustrated in FIG. 5A.

FIG. 5D is a front view of the body component illustrated in FIG. 5A.

FIG. 5E is a top view of the body component illustrated in FIG. 5A.

FIG. 5F is a bottom view of the body component illustrated in FIG. 5A.

FIG. 6A is a top view of an embodiment of a hood component of the container system illustrated in FIG. 1.

FIG. 6B is a right side view of the hood component illustrated in FIG. 6A.

FIG. 6C is left side view of the hood component illustrated in FIG. 6A.

FIG. 7 is a perspective view of an embodiment of an extension or arm control assembly adapted for use in the container system illustrated in FIG. 1.

FIG. 8 is a perspective view of an embodiment of an extension or arm component of the arm control assembly illustrated in FIG. 7.

FIG. 9 is a perspective view of a locking member component of the arm control assembly illustrated in FIG. 7.

FIG. 10 is a plan view of an embodiment of a cable assembly adapted for use in the container system illustrated in FIG. 1.

DETAILED DESCRIPTION OF THE INVENTION

Exemplary details of this invention will now be described with reference to preferred embodiments selected for illustration in the Figures. It will be appreciated that the Figures have not been rendered to any particular scale or proportion. Also, it will be appreciated that the scope of this invention is not limited to the embodiments selected for illustration in the Figures. Instead, the scope of this invention is defined separately in the appended claims.

Generally, referring to the Figures, this invention provides a carrier 100 that is configured to hold a medical waste con-

3

tainer 20 having a door 26 mounted for reciprocation between opened and closed positions. The carrier 100 includes a body 105 that is adapted to receive the medical waste container 20. The carrier 100 also includes an extension or arm 202 coupled for reciprocal movement with respect to the body 105. The arm 202 is adapted for engagement with the door 26 of the medical waste container 20. The reciprocal movement of the arm 202 is adapted to reciprocate the door 26 of the medical waste container 20 between the opened and closed positions.

This invention also provides a container system 10 including the medical waste container 20 in combination with the carrier 100. The system 10 has been discovered to reduce contact between medical professionals and the medical waste container 20 during use. The system 10 has also been discovered to resist unauthorized use of, and unintended access to the interior of, the medical waste container 20.

Referring specifically to FIG. 1, the medical waste container system 10 includes a carrier 100 that can receive the medical waste container 20. The carrier 100 includes several features to facilitate the mobility of the medical waste container system 10. Specifically, the carrier 100 includes four (4) wheels 112 mounted at the base of the carrier 100 so that the medical waste container system 10 can easily and readily be transported from one position to another by a user of the system 10. Two (2) of the four (4) wheels 112 are preferably lockable so that movement of the system 10 along the ground can be prevented or controlled.

Also, an extendable handle 120 extends upwardly and outwardly from the carrier 100 so that the container system 10 can be pulled by a user. More specifically, the handle 120 is formed from thick metallic wire formed into an elongated loop that terminates at its base with a pair of loops 122. Those loops 122 engage a pair of vertically-extending handle guides 118 which are fixed to the body of the carrier 100. A loop 119 extends between the handle guides 118 toward the top portion of the handle guides 118, thereby forming a support against which the upper portion of the handle 120 rests.

It will be understood that the handle 120 can be extended upwardly and outwardly with respect to the carrier 100 by virtue of the sliding relationship between the loops 122 at the base of the handle 120 and the handle guides 118 to which the loops 122 are slidably engaged. As the handle loops 122 slide upwardly along the handle guides 118, the handle 120 extends upwardly and outwardly with respect to the carrier 100, while still resting against the loop 119 toward the top of the handle guides 118. When in this extended position, a user of the system 10 can easily move the carrier 100 from one location to another. When finished, the user can release the handle 120 to the retracted position as the loops 122 at the base of the handle 120 slide downwardly along the handle guides 118.

Referring now to FIG. 2, a preferred embodiment of a medical waste container 20 is illustrated, which container can be used in the medical waste container system 10 illustrated in FIG. 1. An exemplary waste container is disclosed by Mosior in U.S. Pat. No. 5,531,346, which is incorporated herein by reference. An exemplary waste container is also available from Tyco Healthcare Group LP of Mansfield, Mass. (see, e.g., Product Nos. 8938, 8998S, 8935, 8936SA, 8939 and 8934).

The medical waste container 20 includes a receptacle 22 on which a lid 24 is engaged. A door 26 is mounted for sliding reciprocation with respect to the lid 24. More specifically, the door 26 slides with respect to the lid 24 in the direction indicated by the arrow labeled D1. In FIG. 2, the door 26 is shown in the closed position. As the door 26 slides in the direction D1, the door 26 moves from the closed position (as

4

illustrated) to an opened position (not shown in FIG. 1). When the door 26 is in the closed position, access to the interior of the medical waste container 20 is prevented. Conversely, when the door 26 is in the opened position, access is provided to the interior of the receptacle 22 so that medical waste can be inserted for disposal.

It will be understood that the medical waste container system 10 illustrated in FIG. 1, helps to reduce contact between the user of the system 10 and the medical waste container 20. More specifically, as will be described later in further detail, is no longer necessary for the user of the system 10 to make hand contact with the door 26 of the medical waste container 20 in order to open the container 20 and gain access to the interior of the receptacle 22 (in order to discard medical waste) or to close the door 26 to prevent such access. Also, the medical waste container system 10 makes it possible to prevent unauthorized or inadvertent access to the interior of the medical waste container 20, as will be described later in further detail.

Referring now to FIG. 3, the removal of the medical waste container 20 from the carrier 100 is illustrated. A body component 105 of the carrier 100 includes a pair of opposed guide rails 102 (only one shown in FIG. 3) in order to support the medical waste container 20 when it is positioned within the interior defined by the carrier 100. More specifically, the guide rails 102 provide a pair of supports against which the lip of the receptacle 22 and/or skirt of the lid 24 can rest. The container 20 can therefore be suspended and/or supported by the carrier 100.

The carrier 100 also includes a hood component 104 that is coupled by means of a hinge 106 to the body 105 of the carrier 100. The hinge 106 makes it possible to rotate the hood 104 with respect to the body 105 so that the hood 104 can be moved between an opened position (as shown in FIG. 3) and a closed position (as shown in FIG. 1). The view provided in FIG. 3 also reveals a door retractor assembly 108, which is used to open and close the door 26 of the medical waste container 20, as will be described in further detail later.

When the hood 104 is rotated by means of the hinge 106 into a closed position (as shown in FIG. 1), removal of the medical waste container 20 from the carrier 100 is prevented. Also, a lock 110 is preferably provided on the hood 104 in order to lock the hood 104 in a closed position with respect to the body 105 of the carrier 100. Lock 110 can be a simple key lock, wherein rotation of the key brings about (or releases) engagement between the hood 104 and the body 105.

When the medical waste container 20 is desired to be removed from the carrier 100 (e.g., when the container 20 is filled with medical waste), it can be removed from the carrier 100 by unlocking the lock 110 on the hood 104, rotating the hood 104 from the closed position shown in FIG. 1 to the opened position shown in FIG. 3 by virtue of the hinge 106, and removing the medical waste container 20 from the carrier 100 in the direction designated by the arrow D2 in FIG. 3. The removal procedure can be reversed in order to introduce the medical waste container 20, or a replacement container 20, into the interior defined by the carrier 100.

The body 105 of the carrier 100 includes a pair of detents 113 that are positioned to mate with a corresponding pair of recesses 115 in the hood 104. The mating engagement of detents 113 and recesses 115 provides for alignment between the hood 104 and the body 105 when the hood 104 is being closed.

Referring now to FIG. 4, a lower portion of the medical waste container system 10 is illustrated. The carrier 100 of the system 10 includes a lever 114, such as a foot pedal for example, in order to open and close the door 26 of the medical

5

waste container 20. More specifically, the lever 114 is depressed downwardly by the foot of a user in the direction designated in FIG. 4 by the arrow D3. As will be described later in further detail, a cable coupled to the lever 114 runs from the lever, extends through the interior of the hollow body 105 of the carrier 100, and is coupled to a mechanism (arm control assembly 200 shown in FIG. 7) for opening and closing the door 26 of the medical waste container 20.

Although the foot pedal version of lever 114 shown in FIG. 4 can be replaced by a hand operated lever, the preferred operation of the lever 114 by the foot of a user obviates the need for the user to use his or her hand to contact the medical waste container system 10 in order to open the door 26. Instead, the user merely depresses the lever 114 with his or her foot to open the container 20.

Another preferred feature of the medical waste container system 10 is a mechanism for preventing a user from depressing the lever 114. It has been discovered that such a mechanism helps to prevent unauthorized users from opening the medical waste container by mere operation of the lever 114. Also, it has been discovered that such a mechanism helps to prevent authorized users from operating the lever 114 inadvertently. For example, when the waste container 20 is filled and no additional waste should be introduced into the receptacle 22, a mechanism for preventing a user from depressing the lever 114 helps prevent the inadvertent introduction of additional waste.

In the exemplary embodiment illustrated in FIG. 4, a bracket 116 is mounted to the body 105 of the carrier 100 at its ends for rotation with respect to the body 105 of the carrier 100. More specifically, the bracket 116 can be rotated from a retracted position (shown in FIG. 1) to the extended position shown in FIG. 4. It will be appreciated that, when the bracket 116 is in the locking position shown in FIG. 4, it is difficult or impossible for an unauthorized user to move the lever 114 in a direction indicated by the arrow D3. Inadvertent operation of the lever 114 by authorized users is also discouraged by the bracket 116 when it is in the position shown in FIG. 4.

In order to release the locking function of the bracket 116, the bracket 116 can be rotated in the direction indicated by the arrow D4 and returned to the position shown in FIG. 1. The bracket 116 can be operated by the foot of a user when it is located near the bottom of the carrier 100. Foot operation of the bracket 116 is preferred in order to reduce or eliminate hand contact between the user and the system 10. Alternatively, if the lever 114 and bracket 116 are located for hand operation, the user can position the bracket to block the lever by hand.

Referring now to FIGS. 5A-5F, one preferred embodiment of the body component 105 of the carrier 100 is illustrated. It should be noted that the body 105 could be formed in a wide variety of shapes, configurations, materials, sizes, and proportions. The shape and configuration of the body 105 are not dictated by its function. Instead, the configuration of the body 105 provides the carrier 100 with an ornamental appearance that is appealing to the eye.

The body 105 is preferably formed from plastic such as polyethylene (PE) for example, most preferably linear low density polyethylene (LLDPE), but a metallic body is also contemplated. Preferably, when the body 105 is formed from plastic, the body 105 is preferably formed by a molding process. Most preferably, the body 105 is formed by a rotational molding process.

Referring specifically to the perspective view shown in FIG. 5A, the body 105 of the carrier 100 includes a base portion 124 to which the wheels 112 (shown in FIG. 4) can be mounted. The body 105 also includes a pair of lower side

6

portions 126 and 128, a pair of upper side portions 130 and 132, and an upper front portion 142 that extends between the upper side portions 130 and 132.

The upper side portion 132 of the body 105 is provided with a series of hinge mounting holes 134 (four (4) shown), which facilitate the mounting of the hinge connecting the hood 104 to the body 105. The upper side portion 132 of the body 105 is also provided with a series of guide rail mounting holes 136 (three (3) shown) to facilitate the mounting of the guide rails 102 to the body 105. Only one set of guide rail mounting holes 136 is shown in FIG. 5A, and it will be understood that guide rail mounting holes 136 are also provided on the upper side portion 130 of the body 105.

Toward the base portion 124 of the body 105, a pair of bracket mounting holes 138 (only one shown in FIG. 5A) is provided for the mounting of terminal end portions of the bracket 116 shown in FIG. 4. The mounting holes 138 permit rotation of the bracket 116 with respect to the body 105 from a retracted position (FIG. 1) to an extended position (FIG. 4) and back again. Similarly, a pair of handle guide mounting holes 140 are provided near base portion 124 for mounting the lower portions of the handle guides 118. The mounting holes 144 for the upper portions of the handle guides 118 are shown in FIG. 5C and will be described later.

Referring now to FIG. 5B, a left-hand side view of the ornamental body 105 is illustrated. The ornamental body 105 extends from the lower side portion 126 to the upper side portion 130 in a series of contours.

Referring to the rear view of the body 105 illustrated in FIG. 5C, the body 105 includes an ornamental upper front portion 142 that extends between the upper side portions 130 and 132. A pair of handle guide mounting holes 144 is provided on the upper front portion 142 in order to mount the upper portions of the handle guides 118 shown in FIG. 1. A lower front portion 143 of the body 105 extends between the lower side portions 126 and 128.

FIG. 5D, which provides a front view of the body 105, illustrates additional ornamental features of the upper front portion 142 (extending between the upper side portions 130 and 132 of the body 105) and the lower front portion 143 (extending between lower side portions 126 and 128). Also, FIG. 5D illustrates another view of the handle guide mounting holes 140, which accommodate lower portions of the handle guides 118.

Top and bottom views of the body 105 are illustrated in FIGS. 5E and 5F, respectively. FIG. 5E reveals additional ornamental features of the upper side portions 130 and 132 and the upper front portion 142 of the body 105. FIG. 5E also illustrates the hinge mounting holes 134 provided in upper side portion 132 of the body 105.

The bottom of body 105 is illustrated in FIG. 5F, which bottom includes four (4) wheel mounting holes 146 to facilitate the mounting of four (4) wheels 112 to the body 105 of the carrier 100. A recess 148 is provided in the bottom surface of the base portion 124 of the body 105 in order to accommodate the lever or foot pedal 114. The lever 114, when mounted to the base portion 124 of the body 105 as illustrated in FIG. 4, can reciprocate by rotation about an axis defined by a portion of the foot pedal that runs perpendicular to the direction in which the lever 114 is depressed. That portion of the lever 114 extends through a recess 149, and a pair blocks (not shown), each attached to the body 105 by a set of four (4) fasteners, captures the lever 114 so that its movement is limited to rotational movement about the axis of the recess 149.

Another portion of the lever 114 (not shown) extends perpendicularly with respect to axis about which the lever 114 rotates. More specifically, that portion of the lever 114 is

oriented to extend through a channel **150** in the base portion **124**. That portion of the lever **114** moves upwardly when the lever **114** is depressed by the foot of a user. By doing so, as will be described in further detail later, the lever **114** retracts a cable (not shown), thereby actuating the carrier **100** to open the door **26** of the medical waste container **20**.

Referring now to FIGS. **6A-6C**, preferred ornamental features of the hood component **104** of the carrier **100** will now be described. Referring first to the plan view shown in FIG. **6A**, the hood **104** includes an aperture **152** through which a button (shown in FIG. **7**) extends. As is illustrated in the right-side view shown in FIG. **6B**, the hood **104** is preferably provided with an integral hinge stop **154**. More specifically, hinge stop **154**, which can be formed integrally with the hood **104**, provides a limit to the hood's rotation when the hood **104** is fully opened. It will be understood that, when the hood **104** is opened to the position shown in FIG. **3**, a surface of the hinge stop **154** will contact an upper, outer surface of the upper side portion **132**, thereby preventing over-extension of the hinge. Finally, referring to the left-side view illustrated in FIG. **6C**, the hood **104** is provided with an aperture **156** for receiving the lock **110**.

The hood **104** also includes a container retainer portion **111**, which prevents removal of the container **20** from the carrier **100** when the hood **104** is in the closed position. The retainer portion **111** is preferably formed integrally with the hood **104**, but can take a wide variety of shapes, sizes and configurations.

Like the body **105**, the hood **104** is preferably formed from plastic in a rotational molding process. It will be appreciated, however, that the configuration of the hood **104** can take a wide variety of forms, and that the contours selected for the hood **104** contributes to the overall ornamental appearance of the medical waste disposal system **10**.

FIG. **7** illustrates details of one embodiment of a mechanism that can be employed to open and close the door **26** of the medical waste container **20** by operation of the lever **114**. As is illustrated in FIGS. **3** and **7**, an extension or arm control assembly **200** (FIG. **7**) of the door retractor assembly **108** (FIG. **3**) is mounted to the hood **104** of the carrier **100**.

The arm control assembly **200** includes an extension or arm **202** that is mounted at its end to a bracket **204**. The arm **202** extends parallel to a mounting plate **206** and extends through a mounting block **208** that is attached to the plate **206**. A pin **209** is attached at the end of the arm **202** opposite from the bracket **204**, and an optional bracket **210** is attached to the pin **209** for engagement with the door **26** of the lid **24** of the medical waste container **20**. The pin **209** is provided to engage the door of the container. More specifically, the pin **209** extends into the upwardly extending recess **28** formed in the door **26** of the lid **24**.

The bracket **210** is one embodiment of an extension of the arm **202** that can be used to adapt the arm control assembly **200** of the system **10** for use with a variety of containers. For example, containers having a configuration different from that of container **20** can be installed in the carrier **100**, and an extension such as bracket **210** can be used to couple the arm **202** to the lid of the container. Accordingly, it will be understood that the door **26** of the lid **24** is reciprocated between opened and closed positions as the arm **202**, pin **209**, and optional bracket **210** of the arm control assembly **200** reciprocate with respect to the hood **104** of the carrier **100**.

It is preferred for the carrier **100** to include a mechanism that enables a user of the system **10** to lock the door **26** of the medical waste container **20** in the opened position so that sharps can be introduced into the receptacle **22** of the medical waste container **20** without repeated openings of the con-

tainer **20** or continuous depression of the foot pedal or lever **114**. To accomplish this preferred function, the arm control assembly **200** is provided with a locking member **212** which is mounted for movement with respect to the block **208** so that the locking member **212** can be moved towards the plate **206** of the arm control assembly **200**. Preferably, one or more springs are used in the arm control assembly **200**, interposed between surfaces of the block **208** and the locking member **212**, in order to bias the locking member **212** vertically away from the plate **206**.

A button **214** is engaged to a surface of the locking member **212**, preferably by means of an aperture (not shown) provided in the locking member **212**, and is configured to extend upwardly through the aperture **152** provided in the hood **104** (FIG. **6A**). A user of the system therefore has access to the button **214** so that the button **214** and locking member **212** can be depressed, thereby locking the arm **202** of the arm control assembly **200** in a retracted position in order to maintain the door **26** of the medical waste container **20** in the opened position.

Preferred features and the operation of the locking mechanism of the arm control assembly **200** will now be described in greater detail with general reference to FIGS. **7-9**. As is illustrated in FIG. **8**, the arm **202** of the arm control assembly **200** includes a mounting portion **226** to which the pin **209** is connected (e.g., by threaded fasteners). The arm **202** also includes a recess or a reduced diameter portion **228** and is spaced from the mounting portion **226**.

Referring now to FIG. **9**, which illustrates preferred features of the locking member **212** of the arm control assembly **200**, the locking member **212** includes a pair of mounting holes **230** on a mounting portion **232** in order to facilitate the connection between the mounting member **212** and the block **208** of the arm control assembly **200**.

The locking member **212** also includes a locking recess **234** on a locking portion **236**. Locking recess of **234** of locking member **212** facilitates releasable engagement between the locking member **212** and the arm **202** of the arm control assembly **200** when the button **214** and locking member **212** are depressed by a user of the system **10** toward the plate **206** of the arm control assembly **200**. More specifically, referring again to FIG. **7**, the arm **202** of the arm control assembly **200** is preferably biased into the extended position (not shown in FIG. **7**) wherein the arm **202** extends outwardly from the hood **104** as is shown in FIG. **3**. More specifically, arm control assembly **200** includes a pair of coiled tension springs **216** and **218** which are mounted with respect to the plate **206** by means of two guides **220** and **222**, respectively, which are mounted directly to the plate **206**. A guide rod **224** may also be provided in the arm control assembly **200** in order to guide the end of the arm **202** that is connected to the bracket **204** as the arm **202** extends from the retracted position shown in FIG. **7** to the extended position shown in FIG. **3** and to keep the pin **209** in a vertical orientation.

By virtue of the springs **216** and **218** of the arm control assembly **200**, the arm **202** is biased toward the extended position shown in FIG. **3** in that the springs **216** and **218** pull upon the bracket **204**, thereby urging an extension of the arm **202** through the block **208** of the arm control assembly **200**. When the button **214** and locking member **212** are depressed by a user of the system **10** while the arm **202** is in the retracted position shown in FIG. **7** (i.e., while the lever **114** is depressed and while the door **26** of the container is in the opened position), the locking recess **234** extends into the reduced diameter portion **228** of the arm **202** (FIG. **8**). By virtue of the bias of the arm **202** towards the extended position after the lever **114** is released, it will be understood that a facing surface of

9

the reduced diameter portion 228 is urged against a surface of the locking portion 236 of the locking member 212 that is adjacent to the locking recess 234.

Although not shown in FIG. 9, the hidden surface of the locking portion 236 is preferably provided with a counterbore in the radiused portion of the locking recess 234, thereby facilitating greater frictional contact between the facing surface of the reduced diameter portion 228 of the arm 202 and the locking portion 236 of the locking member 212. The button 214 can be released by the user of the system 10, and the fictional engagement between the locking member 212 and the arm 202 will retain the arm 202 in the retracted position shown in FIG. 7.

When a user desires to release the arm 202, thereby allowing the carrier 100 to return the door 26 of the container 20 to the closed position, the user can actuate the lever or foot pedal 114 once again in order to release the engagement between the locking member 212 and the arm 202. More specifically, by actuating the lever 114 to retract the arm 202 farther into the hood 104, the fictional engagement between the locking member 212 and the arm 202 is broken, thereby permitting the button 214 and locking member 212 to return to their original position by action of the springs (not shown) that are interposed between the locking member 212 and the block 208.

Referring now to FIG. 10, a cable assembly 238 of the carrier 100 is illustrated. The cable assembly 238 is provided to couple the lever or foot pedal 114 to the arm 202 and/or pin 209 of the arm control assembly 200. More specifically, depressing the lever 114 downwardly in the direction D3 shown in FIG. 4 retracts the cable assembly 238 against the bias provided by springs 216 and 218 of the arm control assembly 200. In other words, as the lever 114 is actuated, the cable assembly 238 pulls the assembly of the arm 202, pin 209 and optional bracket 210 towards the retracted position shown in FIG. 7.

The cable assembly 238 preferably travels through a plastic conduit assembly in order to protect the cable and to reduce the wear between the cable and the components of the carrier 100. The cable assembly 238 extends through the body 105 of the carrier 100 from the lever 114 and through the hood 104 to the assembly of the arm 202, pin 209 and optional bracket 210.

One preferred embodiment of the cable assembly 238 is illustrated in FIG. 10. The cable assembly 238 includes an eyelet 240 connected to a lubricated metallic cable 242. The lubricated cable 242 extends through a conduit assembly including a pair of threaded conduit fittings 244, a plastic conduit 246, external tooth lockwashers 248, and jam nuts 250. The lubricated cable 242 extends outwardly from the opposite end of the conduit assembly and terminates at another eyelet 252. It will be understood that one end of the cable assembly 238 (e.g., eyelet 240 or 252) is coupled to the lever 114, and the other end of the cable assembly 238 (e.g., eyelet 252 or 240) is coupled to the arm control assembly 200. Accordingly, the cable assembly 238 couples the lever 114 to the arm control assembly 200 so that the depression of the lever 114 by a user of the system 10 brings about the retraction of the arm 202 of the arm control assembly 200 into the hood 104.

The operation of the medical waste container system 10 will now be described with general reference to FIGS. 1-10. A medical waste container 20 is introduced into the interior region defined by the carrier 100 by releasing the lock 110 on the hood 104, rotating the hood 104 by means of the hinge 106 to open the hood 104, sliding the medical waste container 20 into the interior region defined by the carrier 100 until a

10

portion of the medical waste container 20 is supported by the guide rails 102 of the carrier 100, closing the hood 104, and engaging the lock 110, thereby locking the medical waste container 20 within the carrier 100.

In order to remove a filled medical waste container 20 from the carrier 100, the foregoing steps are substantially reversed. Specifically, the lock 110 on the hood 104 is disengaged, the hood 104 is again rotated by means of the hinge 106 into an open position, and the filled medical waste container 20 is then removed in the direction D2 shown in FIG. 3.

In order to open the medical waste container 20 using the system 10 (e.g., in order to deposit waste in the receptacle 22 of the container 20), the lever or foot pedal 114 is depressed by a user in a direction D3, thereby causing the arm 202 to retract into the hood 104 of the carrier 100 and causing the door 26 of the medical waste container 20 to slide into the opened position. Medical waste can then be deposited through the opening in the lid 24 of the medical waste container 20 for receipt in the receptacle 22.

In order to lock the door 26 of the medical waste container 20 in the open position after the depression of the lever 114 in the direction D3, the button 214 of the arm control assembly 200 can be depressed by the user and the lever 114 can be released in order to bring about engagement between the locking member 212 of the arm control assembly 200 and a surface of the reduced diameter portion 228 of the arm 202 of the arm control assembly 200. While the medical waste container 20 is locked in this opened position, a user of the system 10 need not depress the lever 114 (which will remain in the depressed position by virtue of the cable assembly 238 and the engagement between the locking member 212 and the arm 202), and the user can deposit medical waste in the medical waste container 20 through the open door 26.

In order to release the button 214 of the arm control assembly 200, thereby releasing the arm 202 and bringing about closure of the door 26, a user can depress the lever 114 farther. By doing so, the frictional interengagement between the locking member 212 and the arm 202 of the arm control assembly 200 is released so that the arm 202 can be extended from the hood 104, thereby allowing movement of the door 26 to the closed position as the lever 114 is released by the user (by virtue of the bias provided by the springs 216 and 218).

In order to prevent unauthorized or unintended use of the system 10 by operation of the lever 114, the bracket 116 can be rotated downwardly to a position corresponding to the lever 114 as is illustrated in FIG. 4. When in that position, the bracket 116 prevents an individual from depressing the lever 114 in the direction D3. Rotation of the bracket 116 upwardly (into the position shown in FIG. 1) permits operation of the lever 114.

Although this invention has been described with reference to particular embodiments selected for illustration in the Figures, it will be appreciated that many variations and modifications can be made to the system 10 and the components thereof without departing from the spirit or the scope of this invention. The ornamental appearance of the body 105 and hood 104 of the carrier 100 can be modified into a large number of possible configurations. Also, the materials used to form the hood 104 and body 105, as well as the manufacturing techniques used to form those components, can also be modified. Although the body 105 and hood 104 are preferably formed from plastic using a rotational molding technique, metallic and other materials can be used and the body and hood can be formed using other manufacturing techniques.

It will also be appreciated that the mechanism used to couple the lever 114 to the arm 202 can be varied within the scope of this invention. For example, the flexible cable can be

11

replaced with a rigid linkage. Also, the location and form of the lever 114 can be changed. While the lever 114 preferably takes the form of a foot pedal located near the base of the carrier 100, the lever can also be a hand-operated lever located towards an upper portion of the carrier 100.

Additional variations can also be made within the scope of this invention, which is defined separately in the following claims:

What is claimed:

1. A container system comprising:

a container including a receptacle, a lid engagable with the receptacle, and a door mounted to the lid for reciprocation between opened and closed positions; and

a carrier holding the container, the carrier having:

a hood covering at least a portion of the container, the hood being rotatable between a first position and a second position, the hood inhibiting removal of the container from the carrier when the hood is rotated to the first position, the door of the container being movable between the opened and closed positions to selectively provide access to the receptacle when the hood is in the first position; and

a body portion receiving the container, the body portion having at least one protruding surface positioned to inhibit removal of the carrier when the hood is in the first position.

2. The container of claim 1, wherein said upper portion is a first upper portion and the body portion includes a second upper portion opposite the first upper portion, at least a portion of the container being positioned between the first and second upper portions.

3. The container of claim 2, wherein the protruding surface is on the first upper portion.

4. The container of claim 1, wherein the protruding surface of the container engages the hood when the hood is in the first position to inhibit removal from the carrier.

5. A container system comprising:

a container including a receptacle, a lid engagable with the receptacle, and a door mounted to the lid for reciprocation between opened and closed positions; and

a carrier holding the container, the carrier having:

a body portion receiving the container, the body portion having an upper portion including an outer surface; and

a hood coupled to the body portion for rotation between a first position in which the hood covers at least a portion of the container and a second position in which the hood permits removal of the container, the rotatable hood having a stop integral with the hood for limiting a range of movement of the rotatable hood from the first position to the second position and preventing movement of the hood beyond the second position, wherein a surface of the stop contacts the outer surface of the upper portion of the body when the hood is in the second position.

6. The container of claim 5, wherein the hood further includes a container retainer portion configured to prevent removal of the container from the carrier when the hood is in the first position.

7. A container system comprising:

a container including a receptacle, a lid engagable with the receptacle, and a door mounted to the lid for reciprocation between opened and closed positions; and

a carrier configured to hold the container, said carrier having:

12

a body portion at least partially defining a cavity configured and dimensioned to receive the container, the body having a substantially hollow wall portion;

a first arm coupled for reciprocal movement with respect to the body portion, the first arm being configured and dimensioned for engagement with the door of the container, wherein reciprocal movement of the first arm facilitates reciprocation of the door of the container between the opened and closed positions;

a flexible member coupled to the first arm to facilitate reciprocal movement of the first arm, the flexible member extending through an interior of the hollow wall portion of the body portion;

a lever operatively connected to the door of the container to facilitate repositioning of the door between the open position and the closed position; and

a control assembly operatively connected to the lever and the door of the container to facilitate repositioning of the door between the open position and the closed position, wherein the control assembly includes a locking member and a second arm, the locking member and the second arm being configured and dimensioned for selective engagement, the locking member being repositionable between a locked position, wherein the locking member is in engagement with the second arm to maintain the door of the container in the opened position, and an unlocked position, wherein the locking member is disengaged from the second arm to permit the door to return to the closed position.

8. The container system of claim 7, wherein the lever is operatively connected to the first arm via the flexible member.

9. The container system of claim 7, wherein the lever includes a pedal positioned at a lower portion of the carrier, the pedal being configured, dimensioned, and positioned for manual manipulation by a user's foot.

10. The container system of claim 7, wherein the locking member includes a manual member extending outwardly from the carrier, the manual member being depressible to move the locking member into the locked position.

11. The container system of claim 7, wherein the locking member is configured and dimensioned for engagement with the second arm in frictional relation.

12. The container system of claim 11, wherein the second arm includes a reduced diameter portion, and the locking member includes a recessed portion, the recessed portion of the locking member being configured and dimensioned for engagement with the reduced diameter portion of the second arm when the locking member is in the locked position.

13. The container system of claim 7, wherein the locking member is biased towards the unlocked position by a spring.

14. The container system of claim 7, wherein the second arm is movable between retracted and extended positions, the second arm being positioned for engagement with the locking member in the retracted position to maintain the door in the opened position.

15. The container system of claim 14, wherein the second arm is biased towards the extended position by at least one spring.

16. The container system of claim 14, wherein the second arm is biased towards the extended position by a pair of springs.

17. A container system comprising:

a container including a receptacle, a lid engagable with the receptacle, and a door mounted to the lid for reciprocation between opened and closed positions; and

a carrier configured and dimensioned to receive the container, the carrier including:

a first arm configured and dimensioned for engagement with the door of the container, the first arm being movable between first and second positions to cause 5 corresponding movement of the door between the opened and closed positions; and

a control assembly operatively connected to the lever and the door of the container to regulate movement of the first arm between the first and second positions, 10 the control assembly including a locking member and a second arm, the locking member and the second arm being configured and dimensioned for selective engagement. The locking member being repositionable between a locked position, wherein the locking 15 member is in engagement with the second arm to maintain the door of the container in the opened position, and an unlocked position, wherein the locking member is disengaged from the second arm to permit the door to return to the closed position. 20

18. The container system of claim 17, wherein the second arm includes a reduced diameter portion, and the locking member includes a recessed portion, the recessed portion of the locking member being configured and dimensioned for engagement with the reduced diameter portion of the second 25 arm when the locking member is in the locked position.

* * * * *

UNITED STATES PATENT AND TRADEMARK OFFICE
CERTIFICATE OF CORRECTION

PATENT NO. : 8,695,834 B2
APPLICATION NO. : 12/047784
DATED : April 15, 2014
INVENTOR(S) : Robert Joseph Panek, Jr.

Page 1 of 1

It is certified that error appears in the above-identified patent and that said Letters Patent is hereby corrected as shown below:

In the Claims:

Column 13, Claim 17, Lines 13-15:

being configured and dimensioned for selective engagement. The locking member being repositionable between a locked position,

Should read:

being configured and dimensioned for selective engagement, the locking member being repositionable between a locked position,

Signed and Sealed this
Eleventh Day of November, 2014



Michelle K. Lee
Deputy Director of the United States Patent and Trademark Office