



US008677674B2

(12) **United States Patent**  
**Glimpse et al.**

(10) **Patent No.:** **US 8,677,674 B2**  
(45) **Date of Patent:** **Mar. 25, 2014**

(54) **GUN SIGHT**

(75) Inventors: **Bryan R. Glimpse**, Trenton, MI (US);  
**Robert W. Condra**, New Hudson, MI  
(US); **Joshua Lee Varner**, Commerce,  
MI (US); **Joseph R. Adkins**, Howell, MI  
(US)

3,184,851 A 5/1965 Simmons  
3,439,970 A \* 4/1969 Rickert ..... 42/131  
3,641,676 A 2/1972 Knutsen et al.  
3,698,091 A 10/1972 Merrill et al.  
3,700,339 A 10/1972 Steck, III  
3,777,380 A 12/1973 Theodore  
3,916,530 A 11/1975 Tellie  
4,015,354 A 4/1977 Brouters

(Continued)

(73) Assignee: **Trijicon, Inc.**, Wixom, MI (US)

(\* ) Notice: Subject to any disclaimer, the term of this  
patent is extended or adjusted under 35  
U.S.C. 154(b) by 27 days.

**FOREIGN PATENT DOCUMENTS**

EP 470016 A1 2/1992  
WO 2010034458 A1 4/2010

(21) Appl. No.: **13/222,740**

(22) Filed: **Aug. 31, 2011**

(65) **Prior Publication Data**

US 2012/0144721 A1 Jun. 14, 2012

**Related U.S. Application Data**

(60) Provisional application No. 61/422,728, filed on Dec.  
14, 2010.

(51) **Int. Cl.**  
**F41G 1/00** (2006.01)

(52) **U.S. Cl.**  
USPC ..... 42/132; 42/131

(58) **Field of Classification Search**  
USPC ..... 42/131, 132  
See application file for complete search history.

(56) **References Cited**

**U.S. PATENT DOCUMENTS**

558,402 A 4/1896 Lyman  
1,363,553 A 12/1920 Barringer  
1,922,302 A 8/1933 King  
2,706,335 A 4/1955 Munsey  
2,931,101 A 4/1960 Hermann

**OTHER PUBLICATIONS**

[http://web.archive.org/web/20060524161152/http://www.10-8per-  
formance.com/](http://web.archive.org/web/20060524161152/http://www.10-8performance.com/); 10-8 Performance, Duty Ready 1911s; Hilton Yam;  
May 24, 2008; 2 Pages.

(Continued)

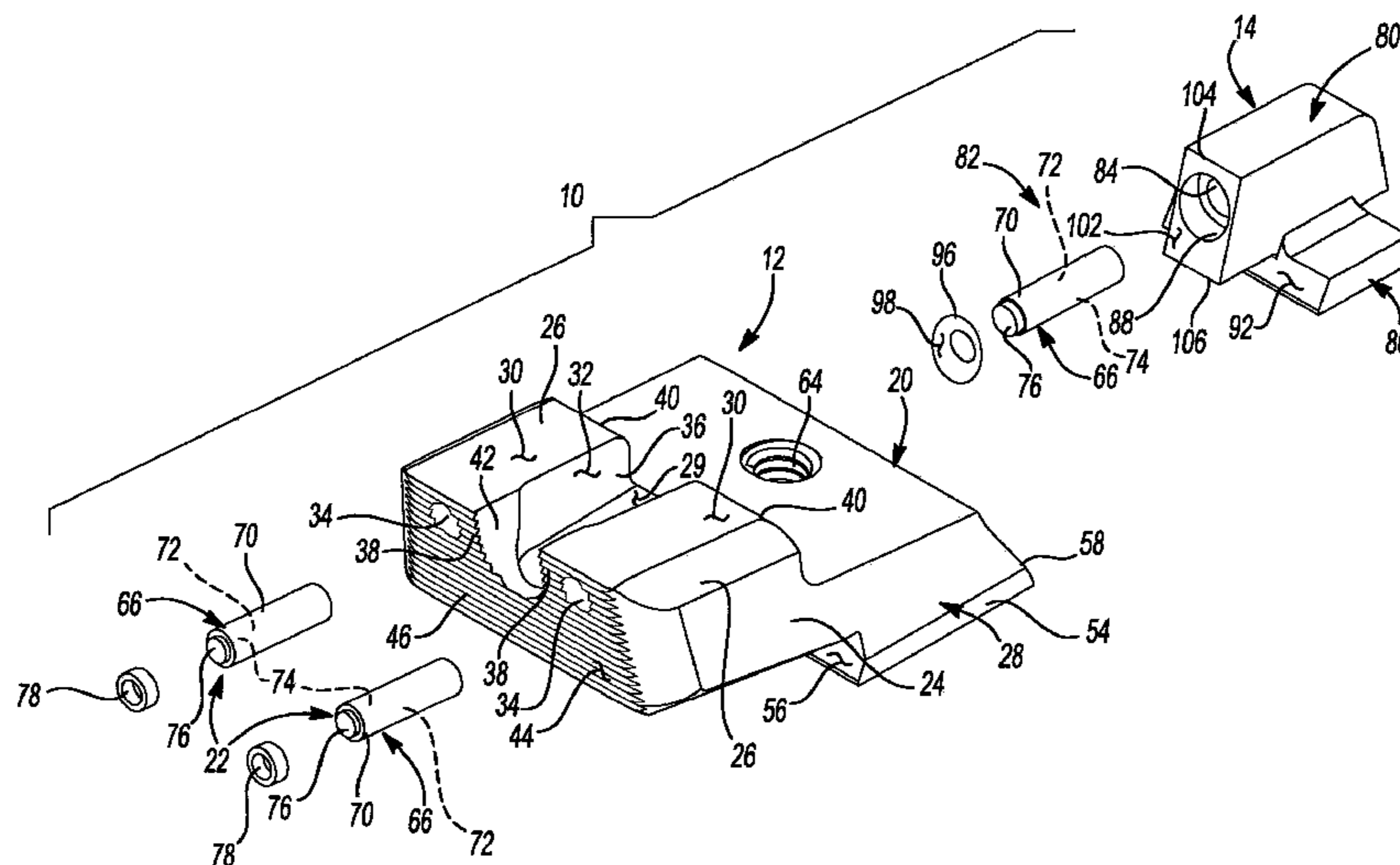
*Primary Examiner* — Samir Abdosh

(74) *Attorney, Agent, or Firm* — Harness, Dickey & Pierce,  
P.L.C.

(57) **ABSTRACT**

A sighting system for a firearm is provided and may include a rear-sight assembly having a rear surface opposing a shooter, a pair of rear-aiming points, and a U-shaped opening disposed between the pair of rear-aiming points. The rear surface may be formed at an angle relative to a top surface of the firearm such that a bottom portion of the rear surface disposed proximate to the top surface of the firearm is farther away from a shooter than a top portion of the rear surface. The sighting system may also include a front-sight assembly including a housing having a front-aiming point, a brightly colored material surrounding the front-aiming point, and a top coat extending over the brightly colored material and the front-aiming point.

**13 Claims, 12 Drawing Sheets**



(56)

References Cited

U.S. PATENT DOCUMENTS

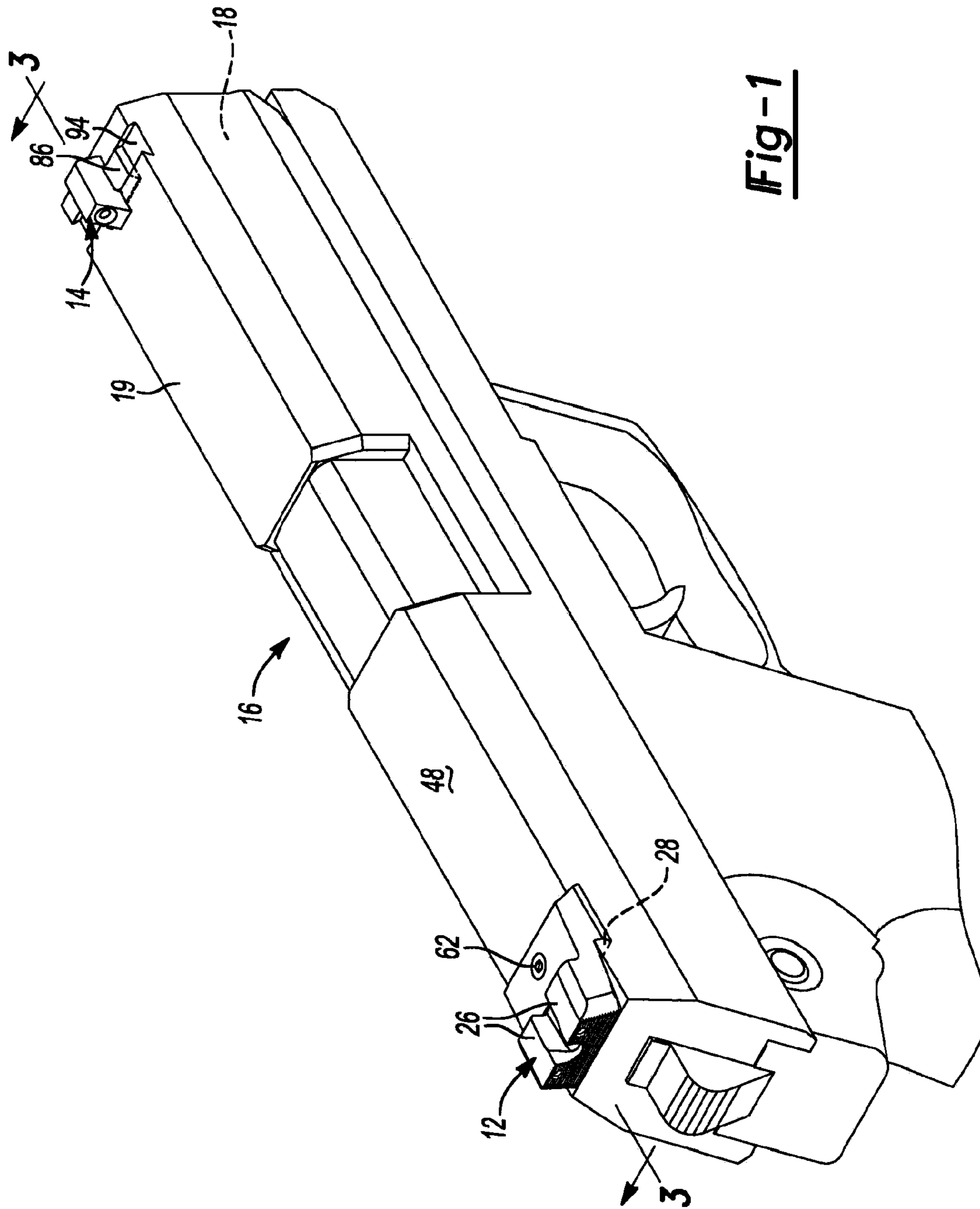
D247,856 S 5/1978 Korzeniewski  
 4,366,625 A 1/1983 Gehmann  
 D273,217 S 3/1984 Swenson  
 D296,227 S 6/1988 Novak  
 D301,512 S 6/1989 Novak  
 D305,146 S 12/1989 Novak  
 D305,561 S 1/1990 Novak  
 D315,776 S 3/1991 Novak  
 5,065,519 A 11/1991 Bindon  
 5,070,619 A 12/1991 Santiago  
 5,103,567 A 4/1992 Loving  
 D352,087 S 11/1994 Stevens et al.  
 5,359,800 A 11/1994 Fisher et al.  
 5,426,882 A 6/1995 Dornaus  
 5,442,861 A 8/1995 Lorocco  
 D363,334 S 10/1995 De Oliveira Masina  
 5,471,777 A 12/1995 McDonald  
 RE35,347 E 10/1996 Bindon  
 5,638,604 A 6/1997 Lorocco  
 D382,038 S 8/1997 Nigh  
 D387,844 S 12/1997 Emerson  
 5,735,070 A 4/1998 Vasquez et al.  
 D399,291 S 10/1998 Emerson  
 D399,292 S 10/1998 Emerson  
 5,836,100 A 11/1998 Stover  
 D403,734 S 1/1999 Kay  
 5,862,618 A 1/1999 Brown  
 D406,630 S 3/1999 Emerson  
 5,878,503 A 3/1999 Howe et al.  
 5,878,521 A 3/1999 Warnock  
 5,887,352 A 3/1999 Kim  
 5,956,854 A 9/1999 Lorocco  
 5,965,854 A 10/1999 Umemura  
 6,014,830 A 1/2000 Brown et al.  
 6,016,608 A 1/2000 Lorocco  
 6,035,539 A 3/2000 Hollenbach et al.  
 6,058,615 A 5/2000 Uhlmann et al.  
 6,058,616 A 5/2000 Bubits  
 6,070,355 A 6/2000 Day  
 6,085,427 A 7/2000 Persson  
 6,122,833 A 9/2000 Lorocco  
 D435,625 S 12/2000 Ling, Jr.  
 D436,393 S 1/2001 Ling, Jr.  
 6,216,351 B1\* 4/2001 Flubacher et al. .... 42/145  
 6,216,352 B1 4/2001 Lorocco  
 D443,016 S 5/2001 Nigh  
 6,233,836 B1 5/2001 Uhlmann et al.  
 D447,205 S 8/2001 Keng  
 6,279,976 B1 8/2001 Ball  
 6,360,471 B1 3/2002 Stein  
 6,360,472 B1 3/2002 Lorocco  
 6,367,189 B1 4/2002 Clay  
 6,421,946 B1 7/2002 LoRocco  
 6,446,377 B1 9/2002 Hollenbach et al.  
 6,571,504 B2 6/2003 Carlson  
 6,622,413 B1 9/2003 Bickett  
 6,640,482 B2 11/2003 Carlson  
 6,711,846 B1 3/2004 Nasef  
 D492,747 S 7/2004 LoRocco  
 6,769,210 B2 8/2004 Bubits  
 6,834,457 B1 12/2004 Warren  
 6,860,056 B2 3/2005 Howe

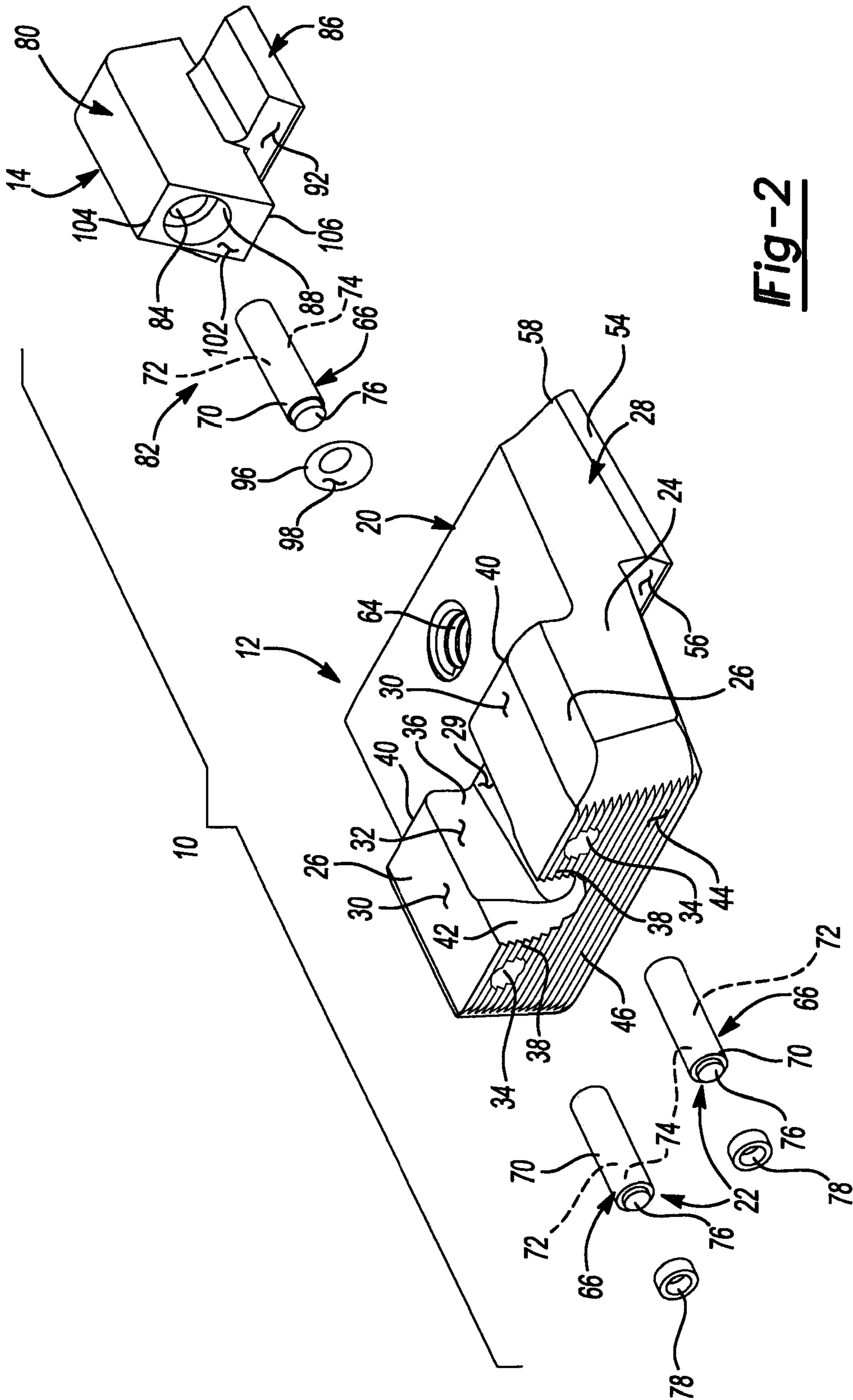
D512,118 S 11/2005 Warren  
 D512,760 S 12/2005 Warren  
 D515,170 S 2/2006 Price  
 D520,099 S 5/2006 Warren  
 D520,592 S 5/2006 Warren  
 D521,101 S 5/2006 Warren  
 D521,591 S 5/2006 Warren  
 D526,695 S 8/2006 Warren  
 D527,068 S 8/2006 Warren  
 D531,693 S 11/2006 Warren et al.  
 D533,616 S 12/2006 Warren  
 D533,617 S 12/2006 Warren  
 D534,986 S 1/2007 Warren et al.  
 D541,897 S 5/2007 Warren et al.  
 D546,915 S 7/2007 Price  
 7,287,351 B1 10/2007 Warren  
 D560,744 S 1/2008 Warren et al.  
 D565,144 S 3/2008 Price  
 7,451,566 B1 11/2008 Price  
 7,458,180 B2\* 12/2008 Liang ..... 42/123  
 7,562,486 B2\* 7/2009 LoRocco ..... 42/132  
 7,565,762 B2 7/2009 Lackey  
 7,627,976 B1 12/2009 Olson  
 D611,112 S 3/2010 Kay  
 7,676,137 B2 3/2010 Schick et al.  
 7,886,475 B2 2/2011 Dubois  
 7,905,044 B2 3/2011 Clouser  
 7,908,783 B2 3/2011 Howe et al.  
 8,037,634 B2 10/2011 Price  
 8,132,352 B2 3/2012 Lippard  
 8,189,967 B1\* 5/2012 Olson ..... 385/12  
 8,230,637 B2\* 7/2012 Lamb ..... 42/145  
 8,261,481 B1 9/2012 Shebaro  
 2002/0157298 A1 10/2002 Carlson  
 2002/0166278 A1 11/2002 Carlson  
 2004/0025398 A1 2/2004 Howe  
 2006/0123687 A1 6/2006 Howe et al.  
 2006/0207157 A1 9/2006 Keng  
 2007/0240354 A1 10/2007 Warren  
 2008/0092424 A1\* 4/2008 Keng ..... 42/137  
 2009/0013581 A1\* 1/2009 LoRocco ..... 42/132  
 2009/0126251 A1 5/2009 Howe et al.  
 2010/0088944 A1\* 4/2010 Callihan ..... 42/145  
 2010/0170138 A1 7/2010 Zukowski  
 2011/0067286 A1 3/2011 Price  
 2011/0107650 A1 5/2011 Howe et al.  
 2011/0197491 A1 8/2011 McCann  
 2011/0225867 A1\* 9/2011 Moore et al. .... 42/114  
 2011/0314721 A1 12/2011 Lamb  
 2012/0144721 A1\* 6/2012 Glimpse et al. .... 42/132

OTHER PUBLICATIONS

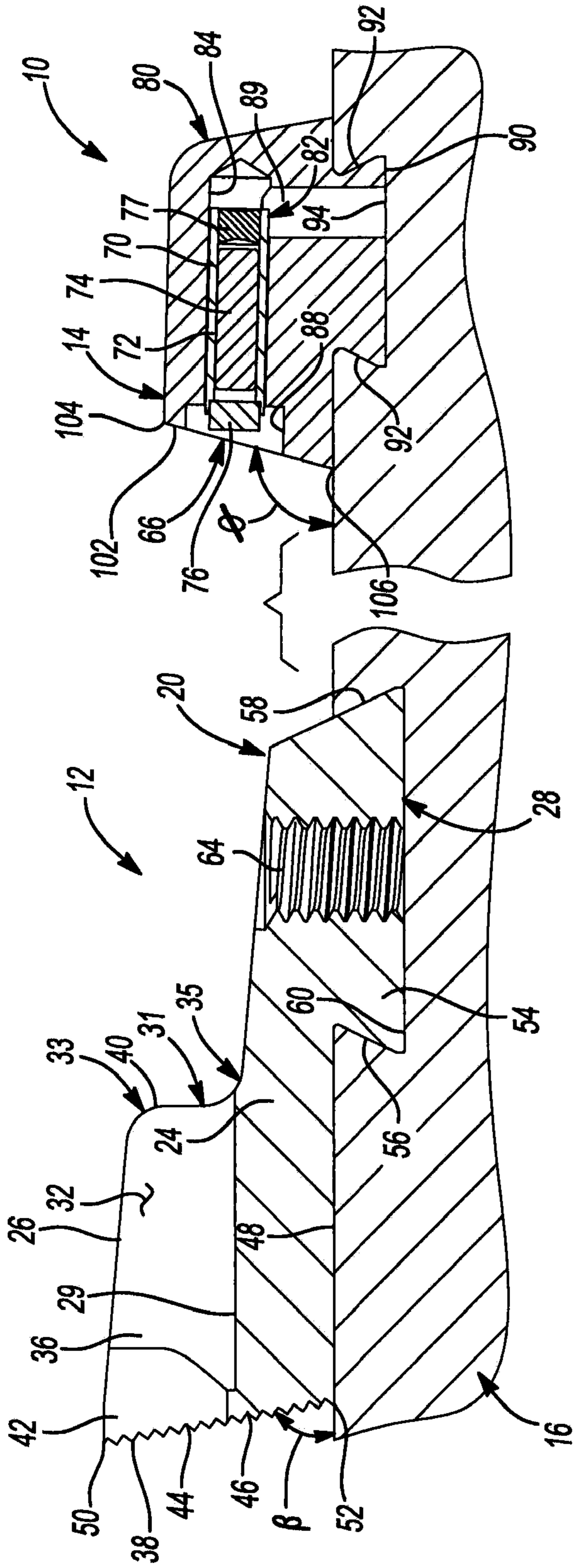
Patent Examination Report No. 1 regarding Patent Application No. 2011253529, dated Mar. 21, 2013.  
 Non-Final Office Action in U.S. Appl. No. 13/285,537, mailed Apr. 15, 2013.  
 Non-Final Office Action in U.S. Appl. No. 13/793,505, mailed May 9, 2013.  
 Non-Final Office Action in U.S. Appl. No. 13/793,424, mailed May 23, 2013.  
 Patent Examination Report No. 3 regarding Patent Application No. 2011253529, dated Dec. 16, 2013.

\* cited by examiner

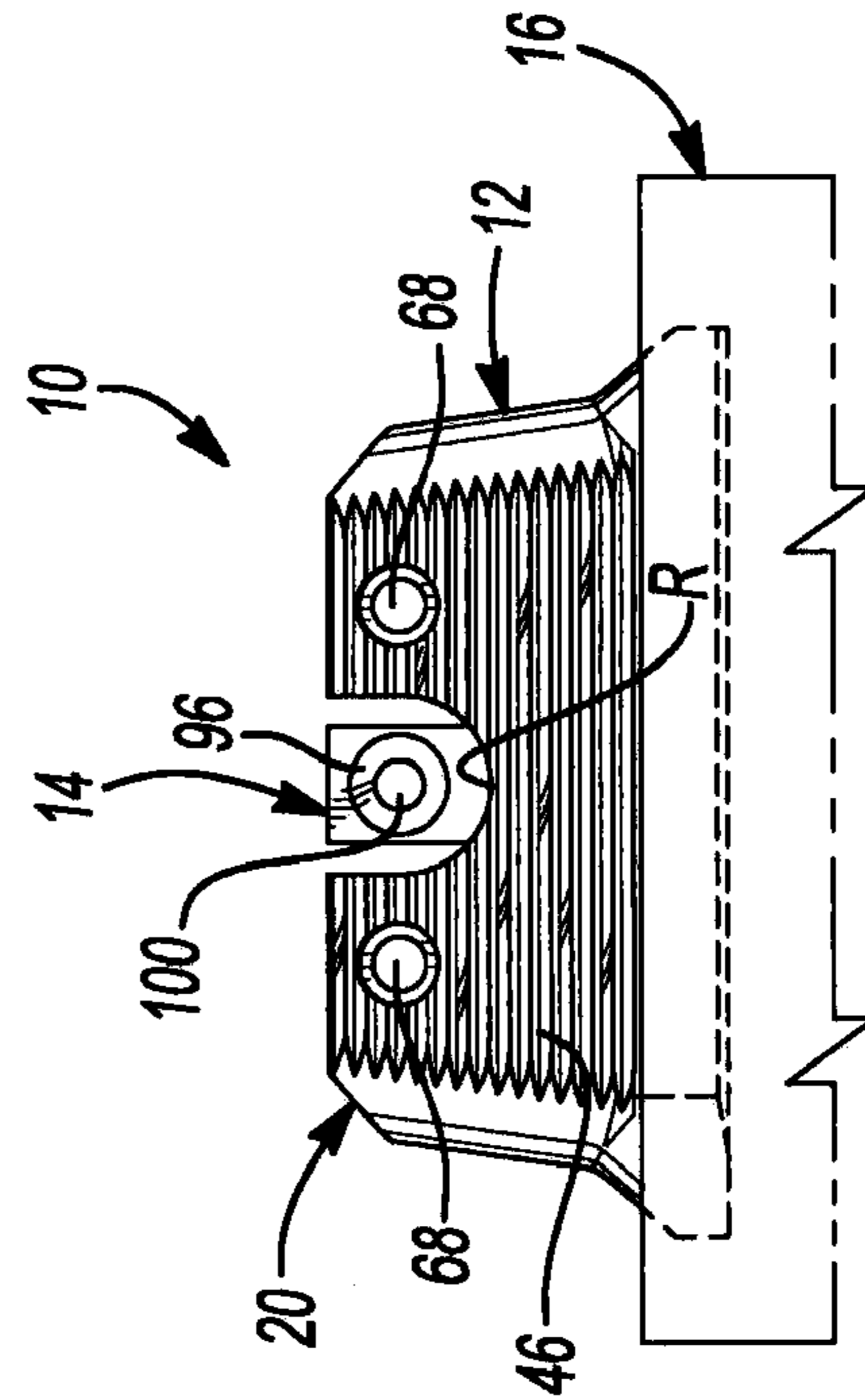




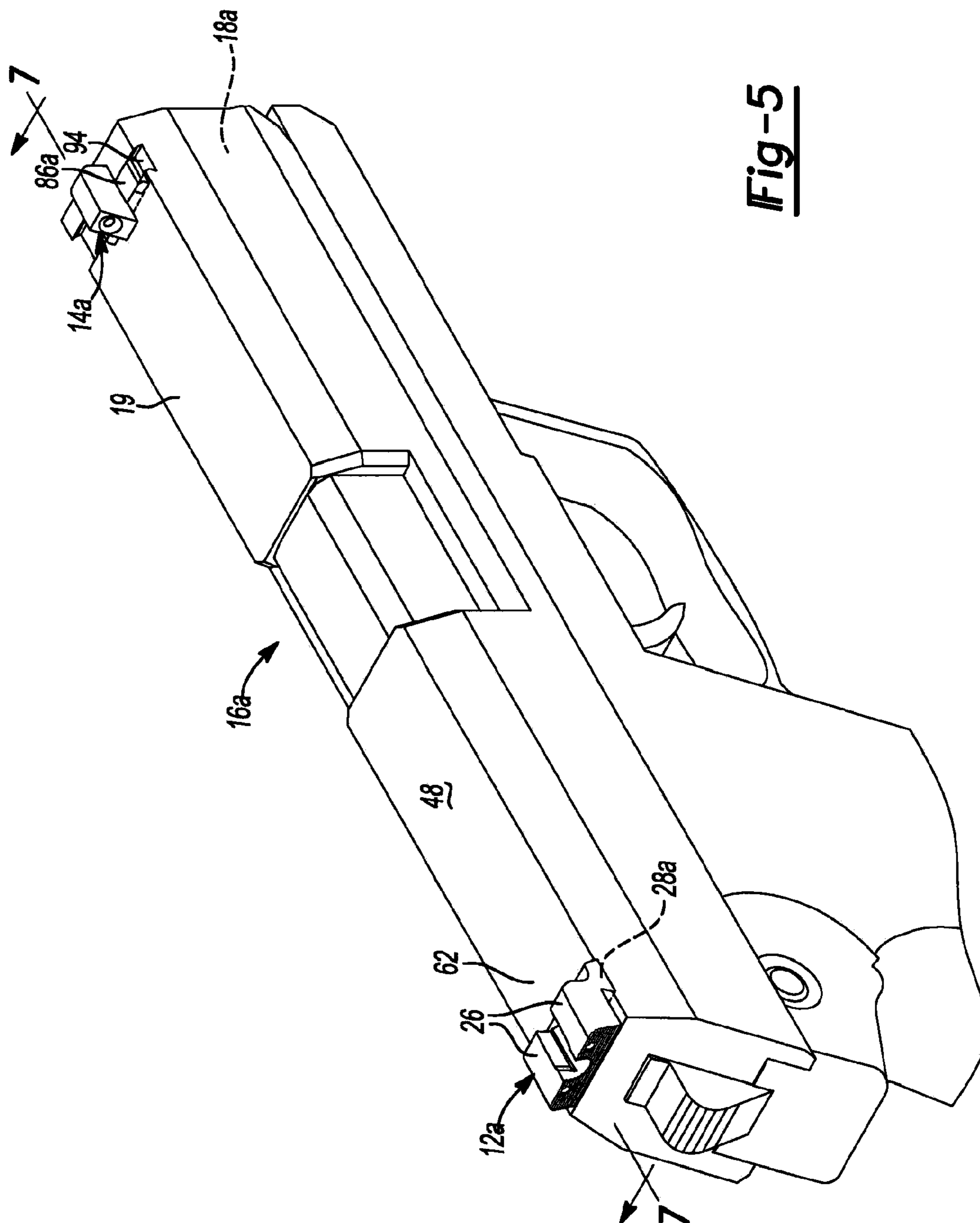
**Fig-2**

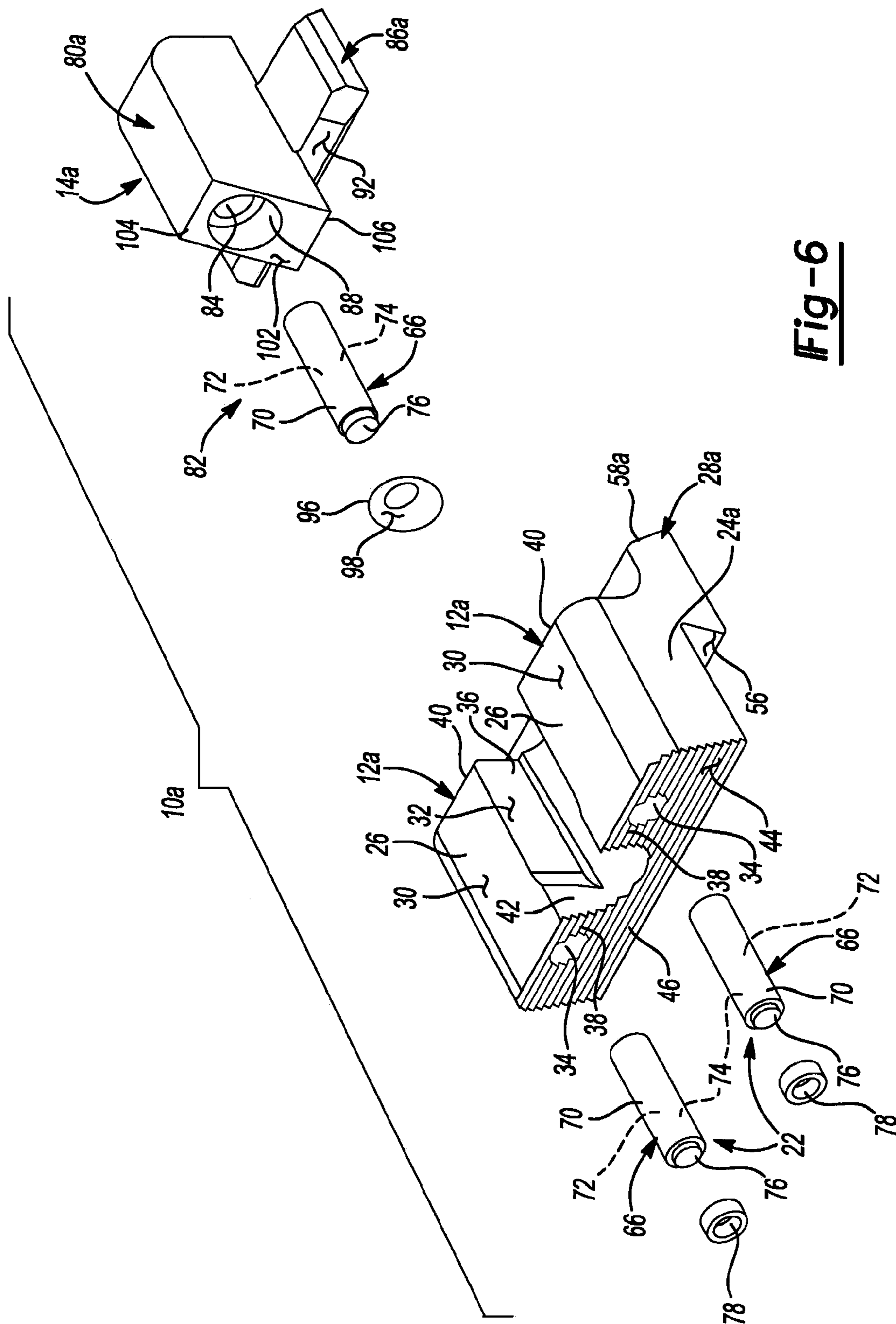


**Fig-3**



**Fig-4**





**Fig-6**

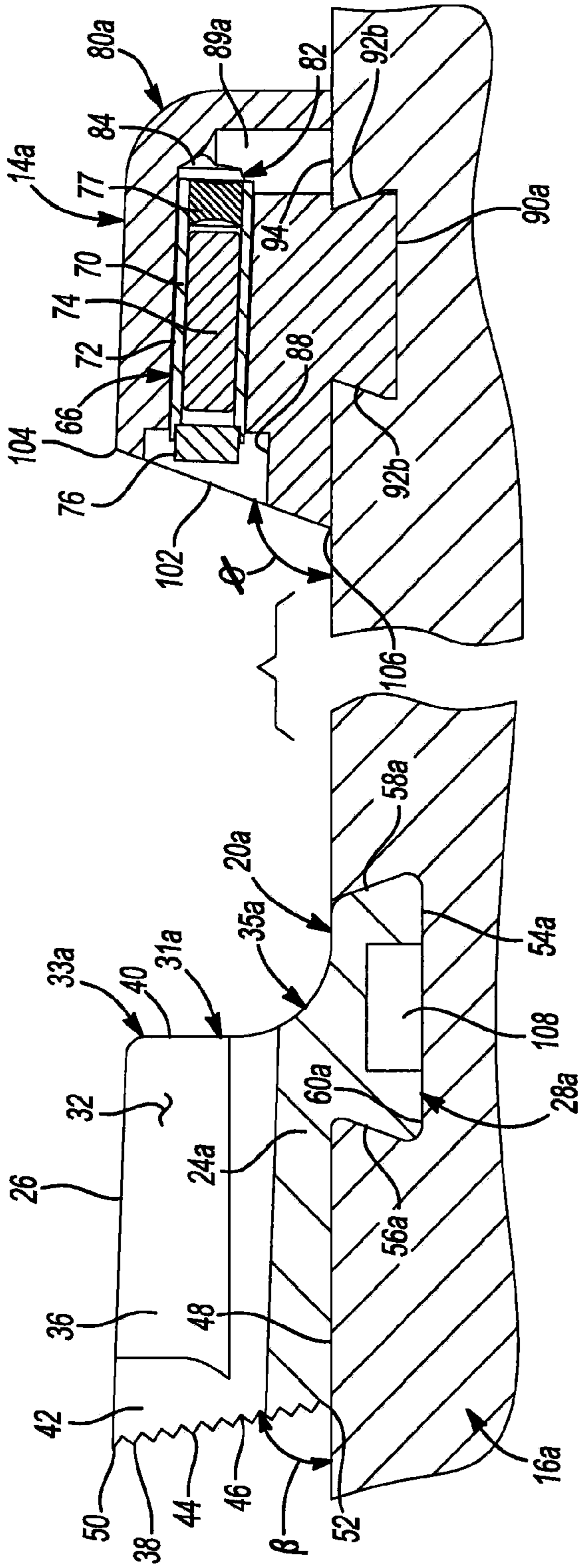


Fig-7

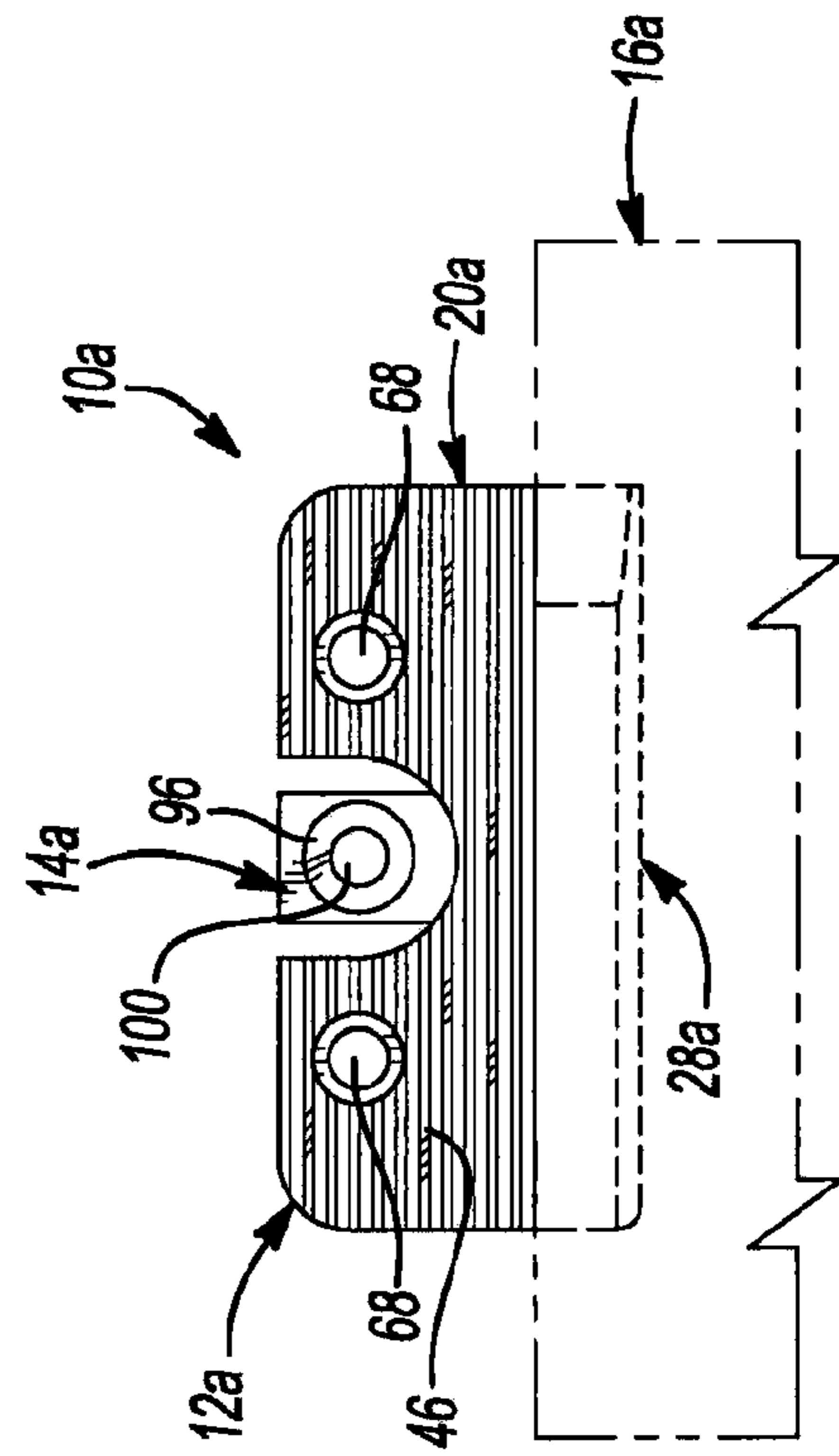


Fig-8



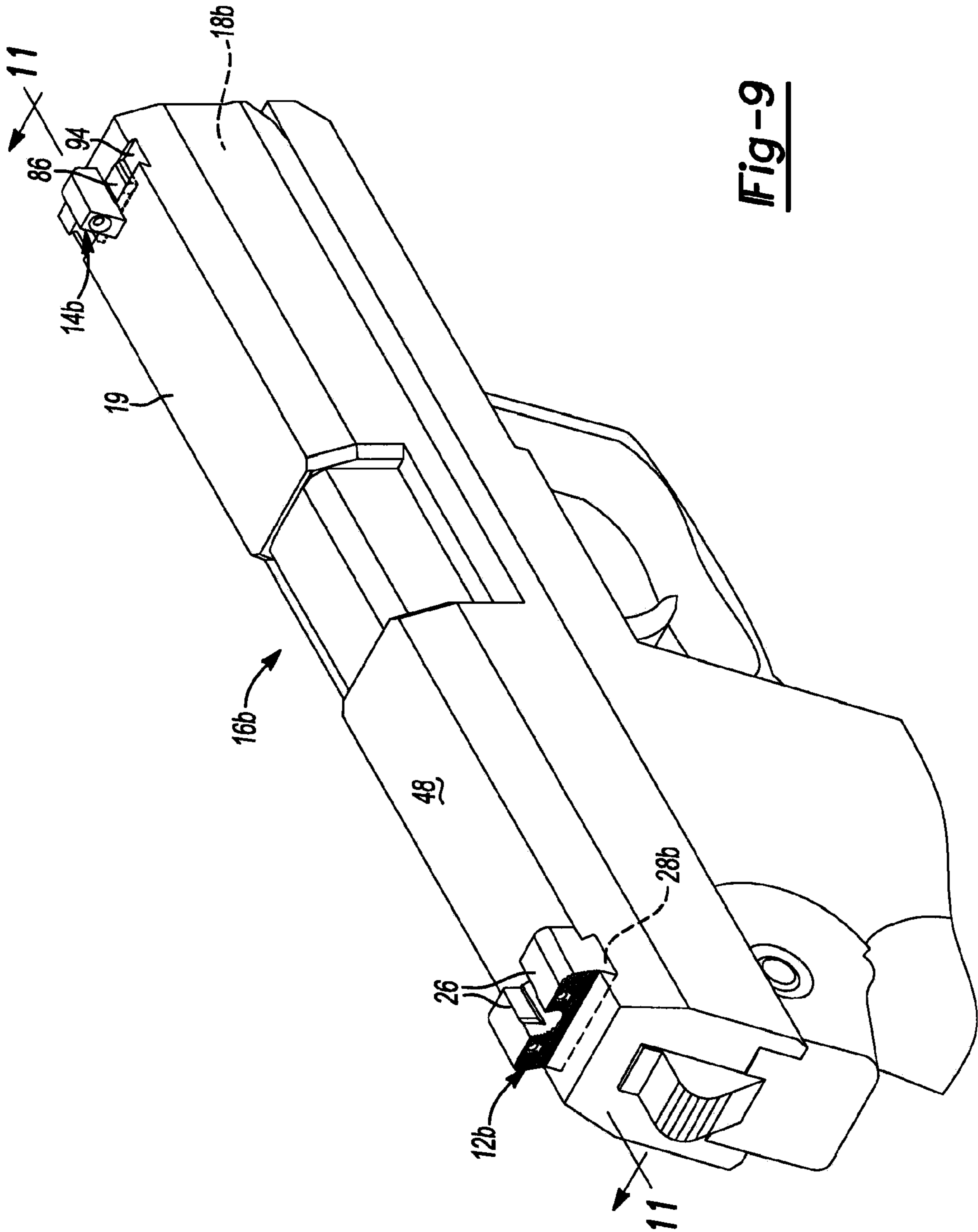
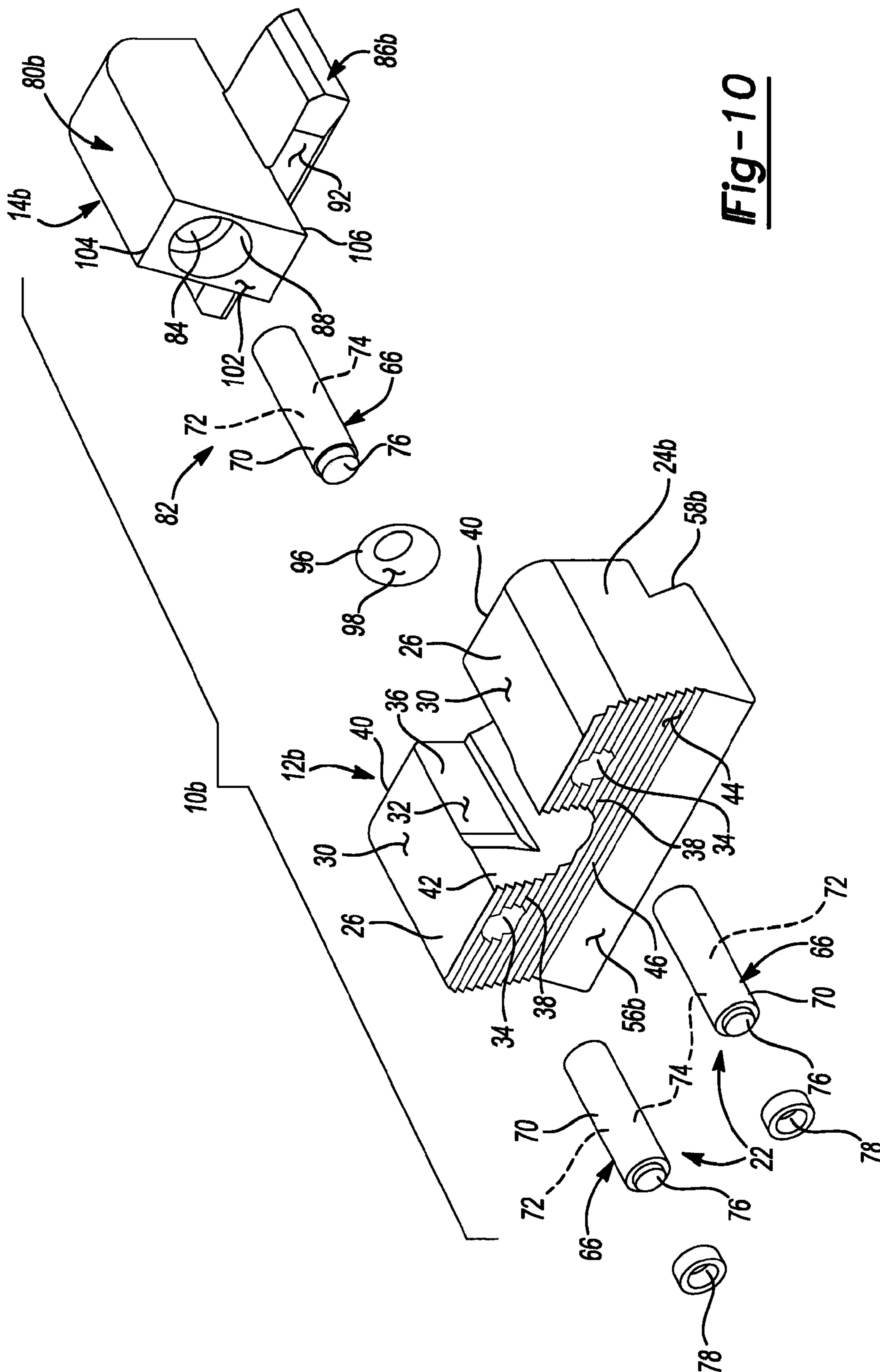
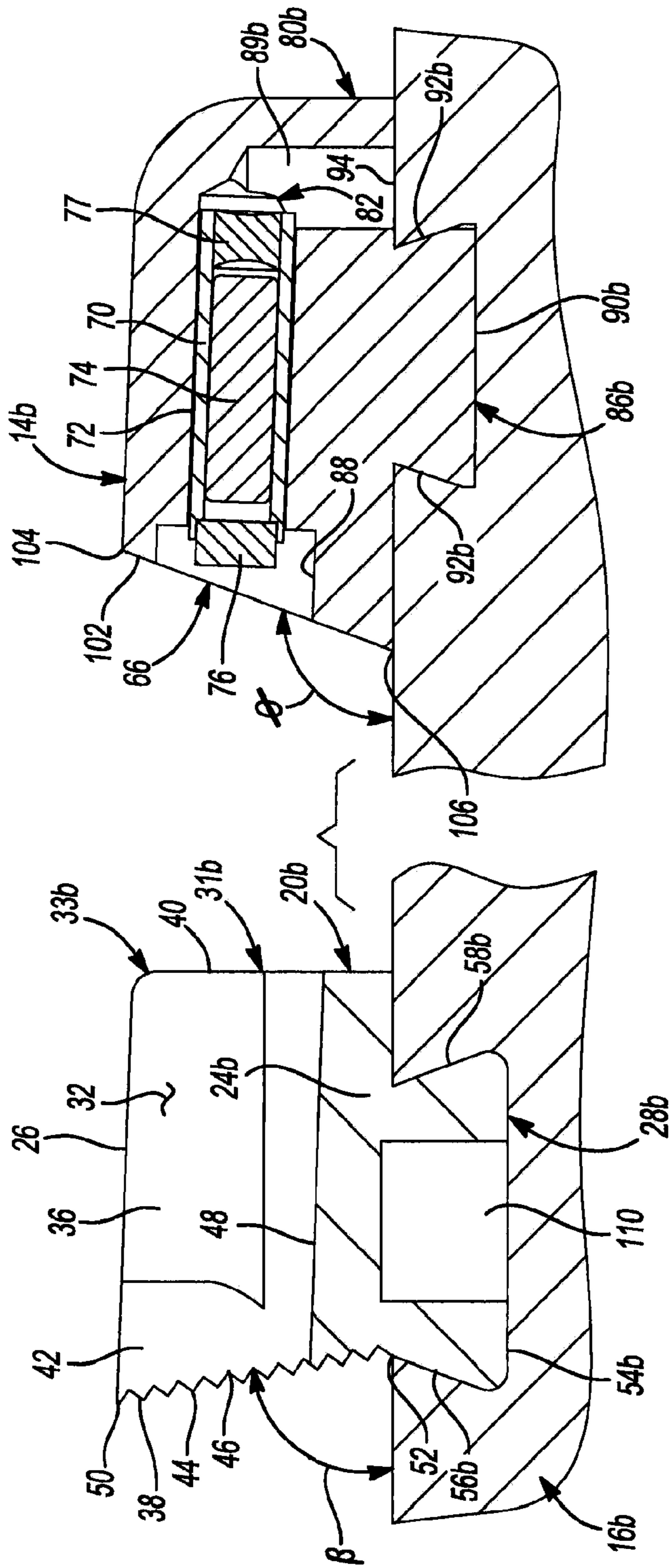


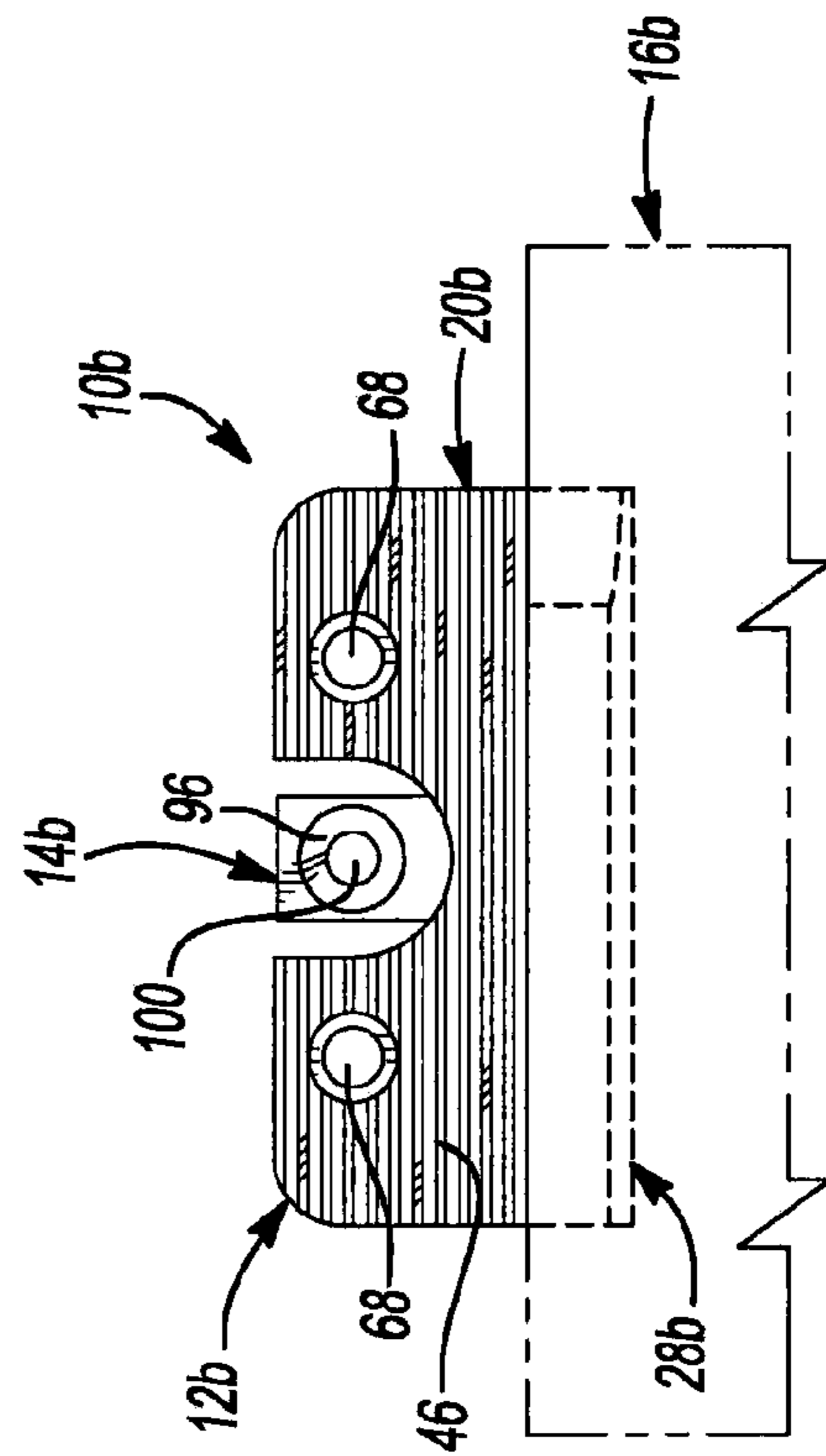
Fig-9



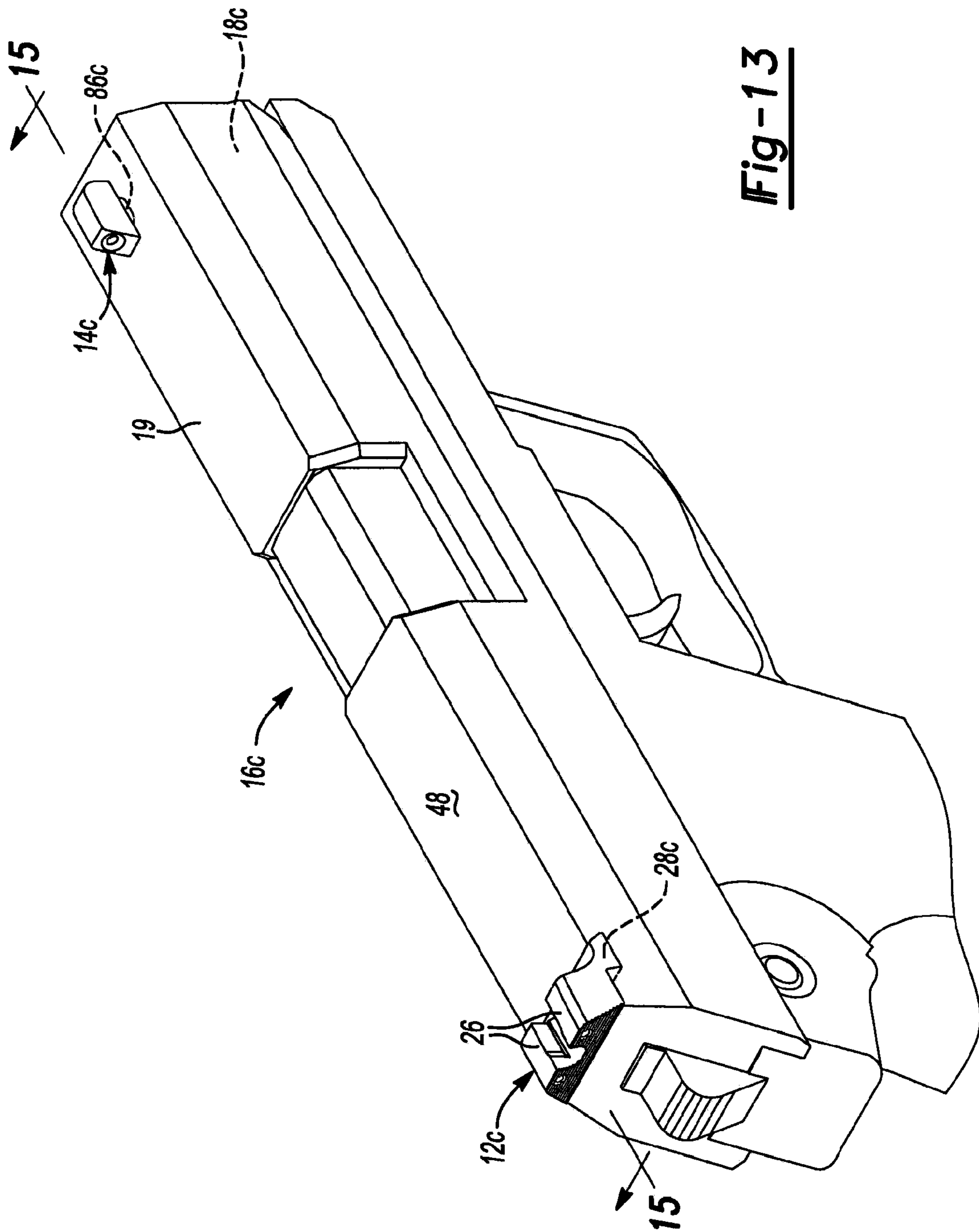
**Fig-10**



**Fig-11**



**Fig-12**



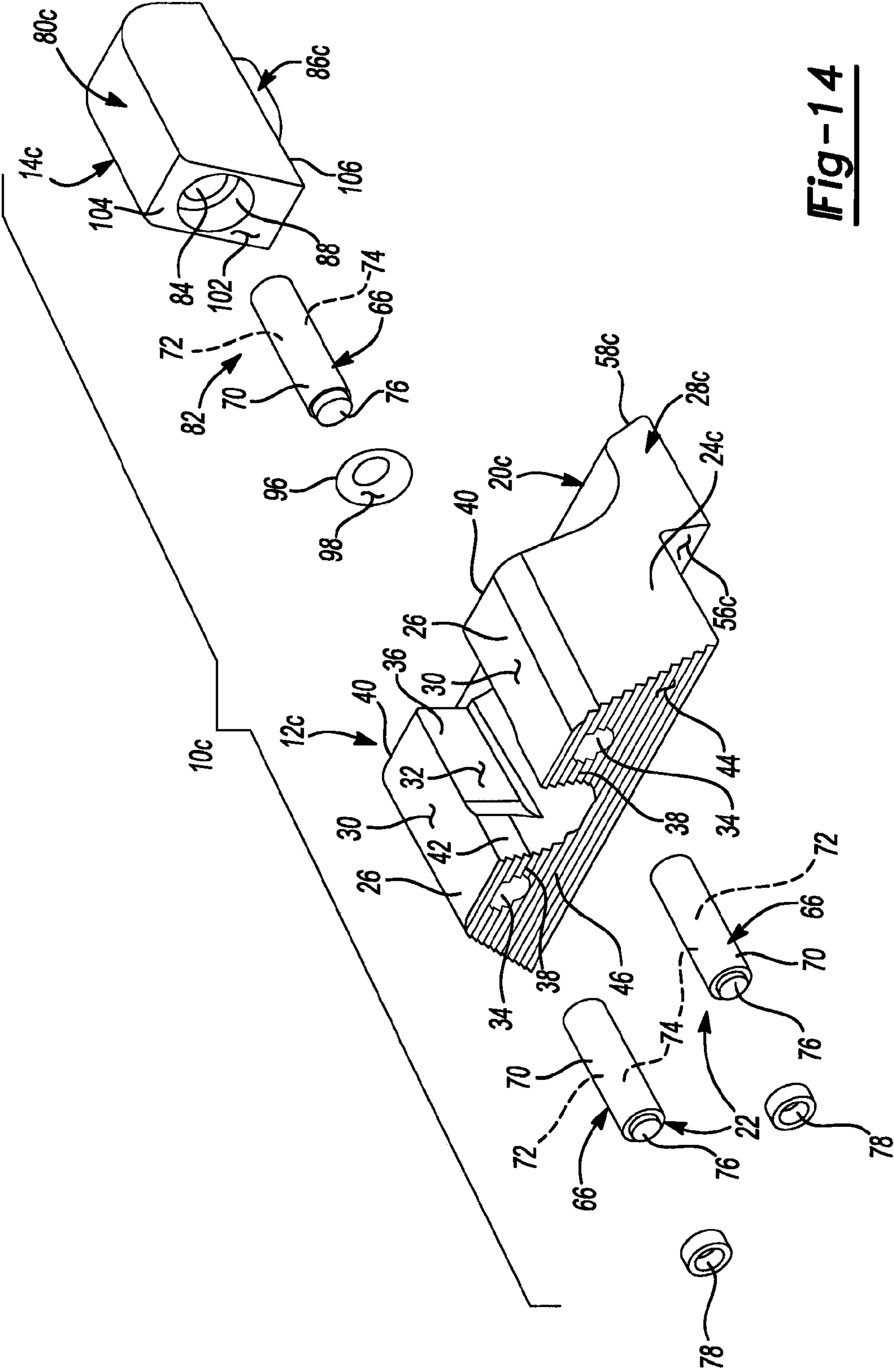
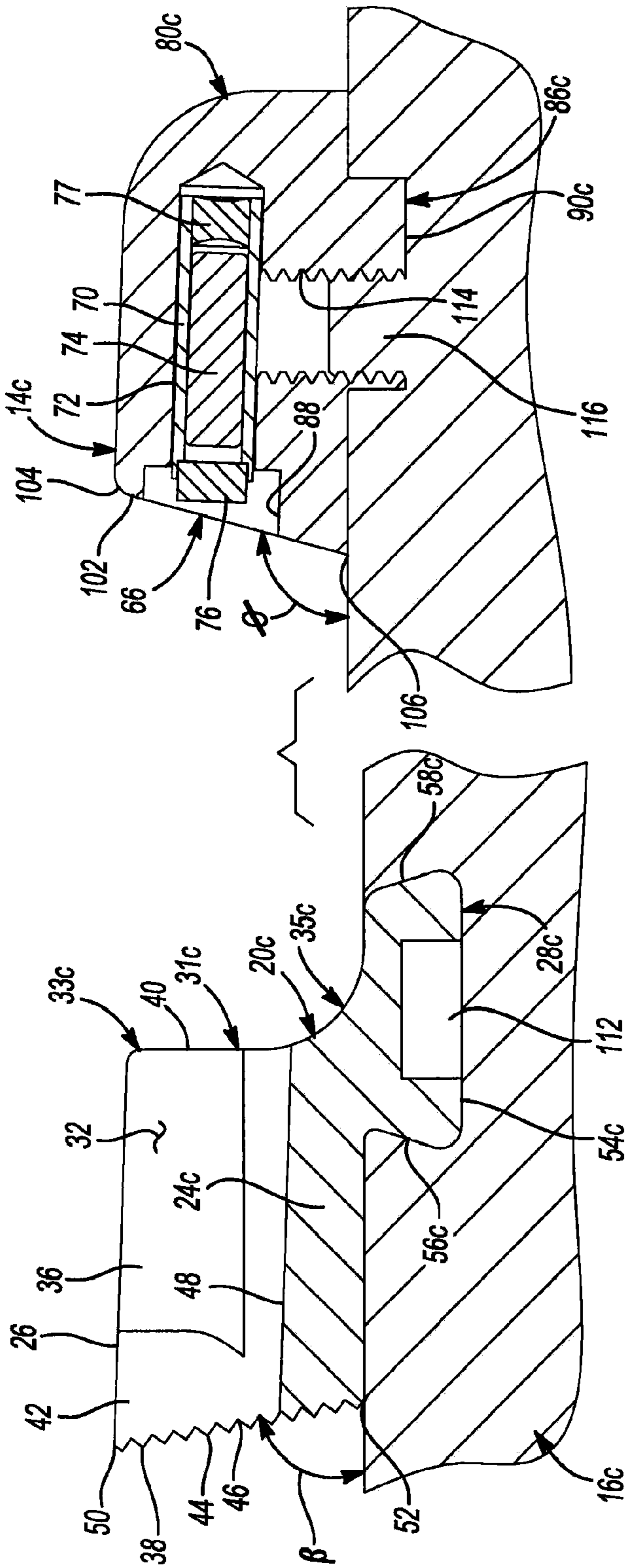
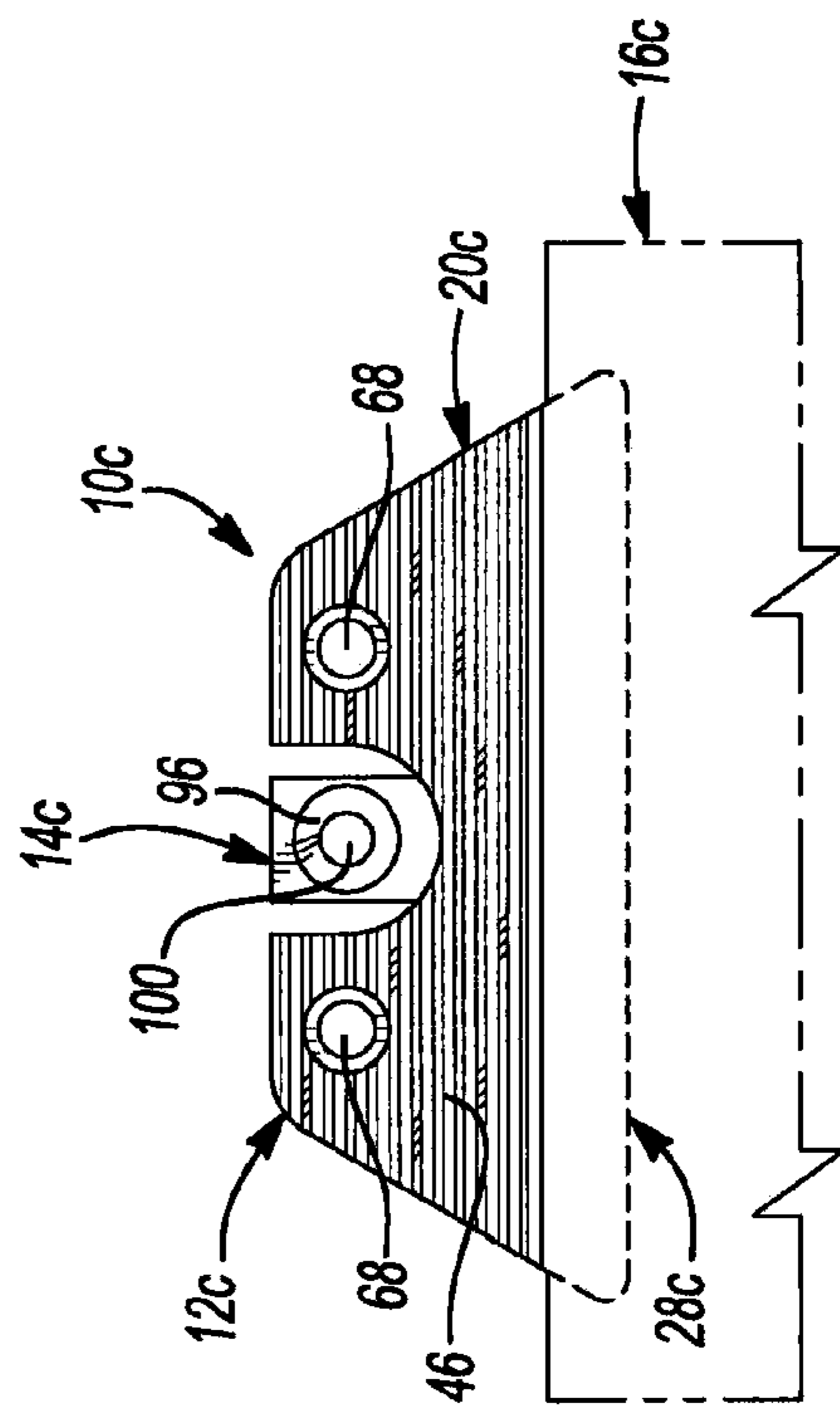


Fig-14



**Fig-15**



**Fig-16**

# 1

## GUN SIGHT

### CROSS-REFERENCE TO RELATED APPLICATION

This application claims the benefit of U.S. Provisional Application No. 61/422,728 filed on Dec. 14, 2010. The disclosure of the above application is herein incorporated by reference in its entirety.

### FIELD

The present disclosure relates to a sighting system and more particularly to a sighting system incorporating a pair of sight assemblies.

### BACKGROUND

This section provides background information related to the present disclosure which is not necessarily prior art.

Aiming sights for weapons are commonly used to properly align a weapon with a target. When used in conjunction with a small firearm such as a handgun, sighting systems typically include at least one fixed aiming point disposed at a distal end of a barrel of the firearm. The aiming point may be used by a shooter to align the barrel of the firearm with a target to increase the likelihood that a projectile fired from the firearm will impact a target at a desired location.

Prior-art sighting systems are not limited to a single, fixed aiming point disposed at a distal end of a barrel of a firearm. Rather, conventional sighting systems for use in conjunction with small firearms may include a second sight mechanism disposed proximate to a rear portion of the firearm to aid a shooter in properly aligning the firearm relative to a target. For example, a sighting system may include a rear sight disposed proximate to the shooter and a forward sight disposed proximate to a distal end of a barrel of the firearm. The rear sight may be used in conjunction with the front sight to properly align the elevation and/or windage of the firearm relative to a target. Such systems incorporating a rear sight and a front sight may include a front-aiming point associated with the front sight and a pair of rear-aiming points associated with the rear sight. In such a configuration, alignment of the front-aiming point with the rear-aiming points properly aligns the firearm relative to a target.

While prior-art sighting systems adequately aid a shooter in aligning a barrel of a firearm relative to a target by properly aligning a front-aiming point with a pair of rear-aiming points, such prior-art sighting systems do not include features that allow a shooter to quickly differentiate between the front-aiming point and the rear-aiming points to quickly and accurately align the front-aiming point with the rear-aiming points.

### SUMMARY

This section provides a general summary of the disclosure, and is not a comprehensive disclosure of its full scope or all of its features.

A sight assembly for a firearm is provided and may include a main body operable to be attached to the firearm and a pair of projections extending from the main body and defining a first surface opposing a shooter and a second surface formed on an opposite side of the projections than the first surface. The first surface may be formed at an angle relative to a top surface of the firearm such that a bottom portion of the first surface disposed proximate to the top surface of the firearm is

# 2

farther away from a shooter than a top portion of the first surface. The sight assembly may further include a U-shaped opening disposed between the pair of projections and in communication with a passage defined by the pair of projections, whereby the passage widens along a length of the pair of projections in a direction extending from the first surface to the second surface.

In another configuration, a sight assembly for a firearm is provided and may include a housing operable to be attached to the firearm. The sight assembly may further include an aiming point defined by the housing and a brightly colored material surrounding the aiming point, whereby the brightly colored material provides a concave surface encircling the aiming point.

In yet another configuration, a sighting system for a firearm is provided and may include a rear-sight assembly having a rear surface opposing a shooter, a pair of rear-aiming points, and a U-shaped opening disposed between the pair of rear-aiming points. The rear surface may be formed at an angle relative to a top surface of the firearm such that a bottom portion of the rear surface disposed proximate to the top surface of the firearm is farther away from a shooter than a top portion of the rear surface. The sighting system may also include a front-sight assembly including a housing having a front-aiming point, a brightly colored material surrounding the front-aiming point, and a top coat extending over the brightly colored material and the front-aiming point.

Further areas of applicability will become apparent from the description provided herein. The description and specific examples in this summary are intended for purposes of illustration only and are not intended to limit the scope of the present disclosure.

### DRAWINGS

The drawings described herein are for illustrative purposes only of selected embodiments and not all possible implementations, and are not intended to limit the scope of the present disclosure.

FIG. 1 is a perspective view of a firearm incorporating a sighting system in accordance with the principles of the present disclosure;

FIG. 2 is an exploded view of the sighting system of FIG. 1;

FIG. 3 is a cross-sectional view of the sighting system of FIG. 1 taken along lines 3-3 of FIG. 1;

FIG. 4 is a front view of the sighting system of FIG. 1 showing alignment between a rear-sight assembly and a front-sight assembly;

FIG. 5 is a perspective view of a firearm incorporating a sighting system in accordance with the principles of the present disclosure;

FIG. 6 is an exploded view of the sighting system of FIG. 5;

FIG. 7 is a cross-sectional view of the sighting system of FIG. 5 taken along lines 7-7 of FIG. 5;

FIG. 8 is a front view of the sighting system of FIG. 5 showing alignment between a rear-sight assembly and a front-sight assembly;

FIG. 9 is a perspective view of the firearm incorporating a sighting system in accordance with the principles of the present disclosure;

FIG. 10 is an exploded view of the sighting system of FIG. 9;

FIG. 11 is a cross-sectional view of the sighting system of FIG. 9 taken along lines 11-11 of FIG. 9;

3

FIG. 12 is a front view of the sighting system of FIG. 9 showing alignment between a rear-sight assembly and a front-sight assembly;

FIG. 13 is a perspective view of a firearm incorporating a sighting system in accordance with the principles of the present disclosure;

FIG. 14 is an exploded view of the sighting system of FIG. 13;

FIG. 15 is a cross-sectional view of the sighting system of FIG. 13 taken along lines 15-15 of FIG. 13; and

FIG. 16 is a front view of the sighting system of FIG. 13 showing the relationship between a rear-sight assembly and a front-sight assembly.

Corresponding reference numerals indicate corresponding parts throughout the several views of the drawings.

### DETAILED DESCRIPTION

Example embodiments will now be described more fully with reference to the accompanying drawings.

With reference to the figures, a sighting system 10 is provided and includes a rear-sight assembly 12 and a front-sight assembly 14. The rear-sight assembly 12 and the front-sight assembly 14 may be attached to a firearm or other weapon 16 to align a barrel 18 of the firearm 16 relative to a target.

With particular reference to FIG. 2, the rear-sight assembly 12 may include a housing 20 and an illumination device 22. The housing 20 may include a main body 24 having a pair of projections 26 extending therefrom and an attachment feature 28 for selectively attaching the housing 20 to a slide 19 or top surface 48 of the firearm 16. The projections 26 may each include a top surface 30, opposing side surfaces 32, and a bore 34 at least partially formed therethrough. The projections 26 may extend from the main body 24 and may be spaced apart from one another to define a channel 36 therebetween.

The housing 20 may also include a substantially rear vertical surface 31 flanked by rounded or radiused surfaces 33 and 35. The vertical surface 31 may be substantially perpendicular to a top surface 48 of the firearm 16 and/or to the main body 24 of the housing 20. The substantially vertical surface 31 allows a shooter to manipulate the slide 19 using a single hand by providing a surface (i.e., surface 31) against which a force may be applied to actuate the slide 19. For example, the surface 31 may be positioned adjacent virtually any external surface such as, for example, a door jam, table, or belt (none shown) to allow the shooter to apply a force to the slide 19 via engagement between surface 31 of the rear-sight assembly 12 and the external surface. The substantially vertical surface 31 therefore provides a shooter with the ability to cycle the slide 19 using one hand. The rounded surfaces 33, 35 are provided to prevent inadvertent cycling of the slide 19. For example, the rounded surfaces 33, 35 prevent “snag” when the firearm 16 is holstered.

The channel 36 may extend along a length of each projection 26 from a front end 38 of each projection 26 to a rear end 40 of each projection 26 to define the channel 36. In one configuration, the channel 36 may include a substantially U-shaped opening 42 proximate to the front end 38 of each projection 26 having a bottom portion with a radius (R)(FIG. 4). The U-shape 42 may be used in conjunction with the front-sight assembly 14 to properly align the rear-sight assembly 12 relative to the front-sight assembly 14 and, thus, the barrel 18 of the firearm 16 relative to a target. The U-shape 42 is sized to provide sufficient clearance for a shooter to view the front-sight assembly 14 and may include a sufficient width that permits a gap on either side of the front-sight

4

assembly 14 when viewed through the U-shaped opening 42 to permit a shooter to clearly and accurately view the front-sight assembly 14.

Regardless of the particular size of the U-shaped opening 42, the channel 36 may be widened and deepened (i.e., into the main body 24) in a direction toward the front-sight assembly 14 to prevent a “hallway” effect when viewing the front-sight assembly 14 through the U-shaped opening 42. Specifically, widening and deepening the channel 36 in a direction toward the front-sight assembly 14 prevents the shooter from seeing the opposing side surfaces 32 and bottom surface 29 that define the channel 36 when viewing the front-sight assembly 14 through the U-shaped opening 42 and, as a result, provides the shooter with a clear view of the front-sight assembly 14. Because the channel 36 widens and deepens toward the front-sight assembly 14, the distance between the side surfaces 32 increases and the bottom surface 29 extends into the main body 24 further in a direction extending away from the U-shaped opening 42 and toward the front-sight assembly 14.

The front end 38 of each projection 26 may terminate at a common surface 44 of the housing 20, whereby the surface 44 extends substantially across the front end 38 of each projection 26 and joins the projections 26 at an area proximate to the opening of the channel 36 and the U-shaped opening 42. The surface 44 may include a series of serrations 46 and may be formed at an angle ( $\beta$ ) (FIG. 3) relative to the top surface 48 of the firearm 16. In one configuration, the angle ( $\beta$ ) provides the surface 44 with a back angle such that a top 50 of the front end 38 is positioned closer to a rear portion of the firearm 16 and, therefore, closer to a shooter than is a bottom 52 of the front end 38. Positioning the front end 38 at a back angle ( $\beta$ ) relative to the top surface 48 of the firearm 16 in combination with providing the surface 44 of the housing 20 with serrations 46 reduces glare experienced by the shooter when attempting to align the rear-sight assembly 12 with the front-sight assembly 14.

With particular reference to FIG. 3, the attachment feature 28 extends generally from the main body 24 and may extend from the main body 24 in an opposite direction than do the projections 26. In one configuration, the attachment feature 28 includes a base 54 and a pair of tapered surfaces 56, 58. The base 54—due to the tapered surfaces 56, 58—widens in a direction extending away from the main body 24 and toward the firearm 16. The base 54 may be slidably received within a mating slot 60 formed in the firearm 16 to prevent inadvertent removal of the rear-sight assembly 12 from the firearm 16. Because the base 54 widens as the base 54 extends from the main body 24 and into the firearm 16, the tapered surfaces 56, 58 engage the slot 60 to concurrently prevent inadvertent removal of the housing 20 from the firearm 16 and allow selective removal of the housing 20 from the firearm 16 when a force is applied to the housing 20 in a direction substantially perpendicular to a longitudinal axis of the barrel 18 of the firearm 16. Allowing removal of the housing 20 allows removal of the rear-sight assembly 12 from the firearm 16 to provide a shooter with the ability to use the firearm 16 both with and without the rear-sight assembly 12.

During installation, the rear-sight assembly 12 may be positioned relative to the firearm 16 such that the base 54 is slidably received within the slot 60. A force may be applied to the housing 20 of the rear-sight assembly 12 in a direction substantially perpendicular to a longitudinal axis of the firearm 16 to position the housing 20 and, thus, the rear-sight assembly 12 relative to the firearm 16 within the slot 60. Once a desired position of the housing 20 is achieved, a set screw or other fastener 62 (FIG. 1) may be received within a threaded



5

aperture 64 formed through the housing 20 (FIG. 3) to secure the housing 20 relative to the slot 60. Sufficient rotation of the fastener 62 relative to the housing 20 within the threaded aperture 64 causes a distal end (not shown) of the fastener 62 to engage the firearm 16 within the slot 60 to restrict movement of the housing 20 in a direction substantially perpendicular to the longitudinal axis of the firearm 16 once a desired position of the housing 20 relative to the firearm 16 is achieved. Should removal of the housing 20 from the firearm 16 be desired, the fastener 62 may be rotated relative to the housing 20 in an opposite direction to disengage the distal end of the fastener 62 from the firearm 16. Disengaging the distal end of the fastener 62 from the firearm 16 once again permits movement of the housing 20 relative to the firearm 16 in a direction substantially perpendicular to the longitudinal axis of the firearm 16. As described above, such movement of the housing 20 relative to the firearm 16 allows removal of the rear-sight assembly 12 from the firearm 16.

With particular reference to FIG. 2, the rear-sight assembly 12 may include an illumination device 22. The illumination device 22 may include a pair of tritium lamps 66 that provide the rear-sight assembly 12 with a pair of rear-aiming points 68 (FIG. 4). Each tritium lamp 66 may be received within a respective bore 34 of a respective projection 26 during manufacturing of the rear-sight assembly 12 and may be retained therein by a suitable adhesive. Each tritium lamp 66 may include an outer tube 70, an inner tube 72, a gaseous tritium source 74, a sapphire lens 76, and a plug 77 that seals the outer tube 70. The outer tube 70 may be formed from Aluminum and may support the inner tube 72. The inner tube 72 may be formed from glass and may contain the gaseous tritium source 74. The plug 77 may be formed from any suitable sealant such as, for example, silicone, to seal the outer tube 72.

While the outer tube 70 is described as being formed from Aluminum and the inner tube 72 as being formed from glass, any suitable material could be used when forming the outer tube 70 and the inner tube 72. Furthermore, while the illumination device 22 is described and shown as including an outer tube 70, the outer tube 70 may or may not be utilized. If the illumination device 22 does not include an outer tube 70, the inner tube 72 may be directly received by the respective bores 34 of the projections 26.

An area generally surrounding the rear-aiming points 68 may include a similar—if not identical—color to that of the surface 44 of the housing 20 to provide the rear-sight assembly 12 with a surface that opposes a shooter with a substantially uniform appearance. In one configuration, the color applied is black and is achieved by applying a black paint to the area surrounding the rear-aiming points 68. The black paint causes the illuminated rear-aiming points 68 to be subdued to prevent the rear-aiming points from distracting the shooter during use in daylight or in well-lit areas and to accentuate the front-sight assembly 14. While the black paint is described as being directly applied to an area surrounding the rear-aiming points 68, the black outline could alternatively be implemented as a pair of collars 78 that surround respective rear-aiming points 68. Further, while a black paint is described, any paint and/or material that reduces the glare of the opening and causes the rear-aiming points 68 to be subdued could be implemented.

With continued reference to FIGS. 2 and 3, the front-sight assembly 14 is provided and may include a housing 80 and an illumination device 82. The housing 80 may include a bore 84 at least partially formed therethrough and an attachment feature 86. The bore 84 may be at least partially formed through the housing 80 and may include an enlarged opening 88 and

6

a cross bore 89 (FIG. 3). The attachment feature 86 may extend generally away from the housing 80 and may include a cross bore 89 and base 90 connected to the housing 80 via a pair of tapered surfaces 92. As with the rear-sight assembly 12, the base 90 includes an increasing width as the base 90 extends away from the housing 80 due to the tapered surfaces 92. Therefore, the widened base 90, in conjunction with the tapered surfaces 92, helps retain the housing 80 and, thus, the front-sight assembly 14, within a slot 94 formed in the firearm 16.

In one configuration, the base 90 includes the same—if not identical—shape as the slot 94 formed in the firearm 16. Therefore, when the housing 80 is positioned relative to the firearm 16 such that the base 90 is slidably received within the slot 94, a force may be applied to the housing 80 in a direction substantially perpendicular to the longitudinal axis of the firearm 16 to position the housing 80 and, thus, the front-sight assembly 14, in a desired position relative to the firearm 16. Depending on the particular firearm 16, the slot 94 may be formed in the slide 19 or top surface 48 of the firearm 16. Therefore, movement of the housing 80 in a direction substantially perpendicular to the longitudinal axis of the firearm 16 positions the housing 80 and, thus, the front-sight assembly 14, relative to the barrel 18. Once the desired position of the front-sight assembly 14 within the slot 94 is achieved, removal of the front-sight assembly 14 from the firearm 16 is restricted due to the shape of the base 90 and its mating relationship with the slot 94.

As described above and shown in FIGS. 1-4, the attachment feature 28 of the rear-sight assembly 12 and the attachment feature 86 of the front-sight assembly 14 include a configuration that matingly engages slots 60 and 94, respectively, of the firearm 16 to selectively attach the rear-sight assembly 12 and the front-sight assembly 14 to the firearm 16. The overall shape and configuration of the attachment features 28, 86—as shown in FIGS. 1-4—are configured to accommodate a Smith & Wesson Military and Police handgun to allow the attachment features 28, 86 to be matingly received within slots 60, 94 that are specific to a Smith & Wesson Military and Police handgun. While the sighting system 10 is described as including a rear-sight assembly 12 and a front-sight assembly 14 respectively including attachment features 28, 86 designed and configured to matingly engage slots 60, 94 of a Smith & Wesson Military and Police handgun 16, the sighting system 10 could be used in conjunction with any firearm that accommodates the attachment features 28, 86 of the rear-sight assembly 12 and front-sight assembly 14.

The illumination device 82 may include a single tritium lamp 66. The tritium lamp 66 may include the same—if not identical—construction as the tritium lamps 66 associated with the rear-sight assembly 12. Because the tritium lamp 66 associated with the front-sight assembly 14 is similar if not identical to the tritium lamps 66 of the rear-sight assembly 12, a detailed description of the tritium lamp 66 associated with the front-sight assembly 14 is foregone.

During manufacturing, the illumination device 82 may be slidably received within the bore 84 of the housing 80 and may be secured therein via a suitable adhesive in a similar fashion as the illumination devices 22 associated with the rear-sight assembly 12. The cross bore 89 of the housing 80 permits air disposed within the housing 80 to escape via the cross bore 89 when displaced by installation of the illumination device 82.

A brightly colored material may be applied directly within the enlarged opening 88 of the housing 80 and, once cured, may include a concave surface 98. The brightly colored mate-

rial may include any color including, but not limited to, yellow, pink, orange, green, and/or white. The brightly colored material may include a fluorescent and/or photoluminescent material and, in one configuration, may be a paint applied directly within the enlarged opening **88**.

While the front-sight assembly **14** is described as including a brightly colored material applied directly to the enlarged opening **88** of the housing **80**, the brightly colored material may be a collar **96**. The collar **96** may be received within the enlarged opening **88** proximate to the bore **84** to generally surround the illumination device **82**. As described above, the brightly colored material of the collar **96** may include any color including, but not limited to, yellow, pink, orange, green, and/or white. The brightly colored material may likewise include a fluorescent and/or photoluminescent material.

Regardless of the particular color and composition, the brightly colored material helps to illuminate the area of the illumination device **82** to aid a shooter in aligning the U-shaped opening **42** of the rear-sight assembly **12** with the front-sight assembly **14**. The brightly colored material, in conjunction with the illumination device **82**, provides the front-sight assembly **14** with an illuminated front-aiming point **100** (FIG. 4).

In addition to the brightly colored material, the area of the front-aiming point **100** may include a top coat (not shown) such as a clear coating disposed over the concave surface **98** that covers the brightly colored material to protect the brightly colored material from becoming damaged. Once cured, the top coat may at least partially fill the concave surface **98** and, in one configuration, may be an epoxy. Regardless of the particular material of the top coat, the top coat may provide the front-sight assembly **14** with a substantially planar front surface **102**, or may generally follow the concave surface **98**.

As shown in FIG. 3, the front surface **102**—regardless of the top coat—may be formed at an angle ( $\theta$ ) relative to the top surface **48** of the firearm **16** such that a top **104** of the front surface **102** is disposed a greater distance away from the rear-sight assembly **12** than is a bottom **106** of the front surface **102**. Positioning the front surface **102** of the housing **80** at an angle ( $\theta$ ) relative to the firearm **16** exposes the brightly colored material surrounding the illumination device **82** and enhances the ability of the brightly colored material in reflecting light. Allowing the brightly colored material to reflect light accentuates the area surrounding the illumination device **82** to allow a shooter to quickly and easily identify the illuminated front-aiming point **100** of the front-sight assembly **14**.

Providing for quick and easy identification of the illuminated aiming point **100** of the front-sight assembly **14** reduces the time required to properly align the illuminated aiming point **100** with the rear-aiming point **68** of the rear-sight assembly **12** when shooting in dark or dimly lit conditions. Likewise, providing for quick and easy identification of the illuminated aiming point **100** of the front-sight assembly **14** reduces the time required to properly align the illuminated aiming point **100** within the U-shaped opening **42** of the rear-sight assembly **12** when shooting in daylight or brightly lit conditions.

As described above, the U-shaped opening **42** is larger than the front-sight assembly **14** to permit the front-sight assembly **14** to be fully viewed when looking through the U-shaped opening **42**. Therefore, the entirety of the brightly colored material—as well as the entire housing **80**—may be seen by a shooter when looking through the U-shaped opening **42** of the rear-sight assembly **12**. Providing sufficient clearance for the brightly colored material and housing **80** of the front-sight

assembly **14** further enhances the ability of the shooter to quickly and accurately align the front-aiming point **100** with the rear-sight assembly **12**.

With particular reference to FIGS. 1 and 4, operation of the sighting system **10** will be described in detail. Once the rear-sight assembly **12** and front-sight assembly **14** are installed on the firearm **16**, the rear-sight assembly **12** and the front-sight assembly **14** may be used to properly align the barrel **18** of the firearm **16** relative to a target. Specifically, the front-sight assembly **14** may first be aligned with a target such that the illuminated front-aiming point **100** is positioned on a target. The firearm **16** may then be moved until the rear-aiming points **68** are aligned with the illuminated front-aiming point **100** if shooting in dark conditions or until the top of the rear-sight assembly **12** is aligned with the top of the housing **80** if shooting in well-lit conditions, as shown in FIG. 4 to account for elevation and/or windage. Properly aligning the front-sight assembly **14** with the rear-sight assembly **12** aides a shooter in properly aligning the barrel **18** of the firearm **16** relative to a target and, therefore, increases the likelihood that a projectile shot from the firearm **16** will impact a target at a desired location.

With particular reference to FIGS. 5-7, a sighting system **10a** is provided and may include a rear-sight assembly **12a** and a front-sight assembly **14a**. In view of the substantial similarity in structure and function of the components associated with the sighting system **10** with respect to the sighting system **10a**, like reference numerals are used hereinafter and in the drawings to identify like components while like reference numerals containing letter extensions are used to identify those components that have been modified.

The sighting system **10a** includes a pair of rear-aiming points **68** and a front-aiming point **100** that cooperate to facilitate alignment of the barrel **18a** of the firearm **16a** relative to a target in a similar fashion as the sighting system **10**. However, the sighting system **10a** includes an attachment feature **28a** extending from the main body **24a** of housing **20a** that accommodates installation of the sighting system **10a** on a Springfield XD handgun rather than on a Smith and Wesson handgun. While the attachment feature **28a** is configured for installation on a Springfield XD handgun, the sighting system **10a** could be used in conjunction with any firearm that accommodates the attachment feature **28a**. Specifically, the attachment feature **28a** allows the rear-sight assembly **12a** to be properly installed in a slot **60a** of the Springfield XD handgun **16a** and includes a recess **108a** and a base **54a** (including surfaces **56a**, **58a**) having a different configuration than the attachment feature **28**. As with the housing **20**, the housing **20a** may also include a substantially rear vertical surface **31a** flanked by rounded or radiused surfaces **33a** and **35a**.

The front-sight assembly **14a** includes a somewhat different configuration when compared to the front-sight assembly **14**, as the cross bore **89a** is shifted relative to the base **90a**. Further, the attachment feature **86a** is somewhat different than the attachment feature **86** of the rear-sight assembly **12**, as the cross bore **89a** does not extend completely through the base **90a**.

While the attachment features **28a**, **86a** include a different shape and configuration than the attachment features **28**, **86** of the rear-sight assembly **12** and the front-sight assembly **14**, respectively, the attachment features **28a**, **86a** are similarly slidably received within respective slots **60a**, **90** of the firearm **16a**. As such, each of the rear-sight assembly **12a** and the front-sight assembly **14a** may be adjusted in a direction substantially perpendicular to a longitudinal axis of the firearm **16a** to properly position the rear-sight assembly **12a** and the

front-sight assembly **14a** relative to the firearm **16a**. Once properly positioned, the attachment features **28a**, **86a** cooperate with the respective slots **60a**, **94** and, due to the shape of the bases **54a**, **90a**, are restricted from being inadvertently removed from the firearm **16a**. Once assembled to the firearm **16a**, the front-sight assembly **14a** cooperates with the rear-sight assembly **12a** to aid a shooter in aligning the barrel **18a** of the firearm **16a** relative to a target in a similar fashion, as described above with respect to the sighting system **10**.

With particular reference to FIGS. 9-11, a sighting system **10b** is provided and may include a rear-sight assembly **12a** and a front-sight assembly **14b**. In view of the substantial similarity in structure and function of the components associated with the sighting system **10** with respect to the sighting system **10b**, like reference numerals are used hereinafter and in the drawings to identify like components while like reference numerals containing letter extensions are used to identify those components that have been modified.

The sighting system **10b** includes a rear-sight assembly **12b** and a front-sight assembly **14b** that respectively include a housing **20b**, **80b** having an attachment feature **28b**, **86b** configured to matingly engage a respective slot **60b**, **94** of a Sig Sauer firearm **16b** while the attachment feature **28b** is designed for use with a Sig Sauer firearm, the sighting system **10b** could be used in conjunction with any firearm that accommodates the attachment feature **28b**. As with the sighting system **10**, the attachment feature **28b** extends from a main body **24b** and includes a base **54b** having a pair of tapered surfaces **56b**, **58b** slidably received within the slot **60b** of the firearm **16b** and the front-sight assembly **14b** includes a base **90b** having a pair of tapered surfaces **92b** slidably received within a slot **94** of the firearm **16b**.

A force may be applied to the rear-sight assembly **12** to move the rear-sight assembly **12a** in a direction substantially perpendicular to a longitudinal axis of the firearm **16b** to properly position the rear-sight assembly **12b** relative to the firearm **16b**. A force may also be applied to the front-sight assembly **14b** in a direction substantially perpendicular to a longitudinal axis of the firearm **16b** to position the front-sight assembly **14b** relative to the firearm **16b**. Once the rear-sight assembly **12b** and the front-sight assembly **14b** are properly positioned relative to the firearm **16b**, interaction between the base **54b** and the slot **60b** of the firearm **16b** and between the base **90b** and the slot **94** of the firearm **16b** restricts inadvertent removal of the rear-sight assembly **12b** and the front-sight assembly **14b** from the firearm **16b**.

While the base **54b** is similar to the base **54** of the sighting system **10**, the base **54b** may include a recess **110** disposed proximate to a center of the base **54b**. The recess **110** reduces the overall weight of the rear-sight assembly **12a** and may aid in positioning the rear-sight assembly **12b** relative to the firearm **16b**. Further, the front-sight assembly **14b** may include a cross bore **89b** (FIG. 11) that is shifted relative to the cross bore **89** of the front-sight assembly **14**.

Upon installation of the rear-sight assembly **12b** and front-sight assembly **14b** on the firearm **16b**, the rear-sight assembly **12b** and the front-sight assembly **14b** may be used by a shooter to facilitate alignment of the barrel **18b** of the firearm **16b** in a similar fashion, as described above with respect to the sighting system **10**.

With particular reference to FIGS. 13-16, a sighting system **10c** is provided and may include a rear-sight assembly **12c** and a front-sight assembly **14c**. In view of the substantial similarity in structure and function of the components associated with the sighting system **10** with respect to the sighting system **10c**, like reference numerals are used hereinafter and in the drawings to identify like components while like refer-

ence numerals containing letter extensions are used to identify those components that have been modified.

The rear-sight assembly **12c** may include a housing **20c** having an attachment feature **28c** that is matingly received within a slot **60c** of the firearm **16c**. The attachment feature **28c** may include a recess **112** formed in a base **54c** that reduces the overall weight of the rear-sight assembly **12c** and may serve to facilitate prompt alignment of the rear-sight assembly **12c** relative to the firearm **16c**. As with the housing **20**, the housing **20c** may also include a substantially rear vertical surface **31c** flanked by rounded or radiused surfaces **33c** and **35c**.

The front-sight assembly **14c** may likewise include an attachment feature **86c** having a threaded bore **114** formed in a housing **80c** thereof. The threaded bore **114** may matingly engage a threaded post **116** disposed within a slot **94c** of the firearm **16c**. The threaded bore **114** may threadably engage the threaded post **116** to secure the housing **80c** of the front-sight assembly **14c** to the firearm **16c** to prevent inadvertent removal of the front-sight assembly **14c** from the firearm **16c**. The attachment features **28c**, **86c** may be configured to allow the rear-sight assembly **12c** and front-sight assembly **14c** to be properly installed on a Glock firearm **16c**. While the attachment feature **28c** is designed for use with a Glock firearm, the sighting system **10c** could be used with any firearm that accommodates the attachment feature **28c**.

Once the rear-sight assembly **12c** is properly positioned within the slot **60c** of the firearm **16c** and the front-sight assembly **14c** is threadably engaged with the threaded post **116** of the slot **94c**, the rear-sight assembly **12c** is properly positioned relative to the front-sight assembly **14c**. In this configuration, the rear-sight assembly **12c** and front-sight assembly **14c** may be used to aid a shooter in properly aligning the barrel **18c** of the firearm **16c** relative to a target in a similar fashion, as described above with respect to the sighting system **10**.

The foregoing description of the embodiments has been provided for purposes of illustration and description. It is not intended to be exhaustive or to limit the disclosure. Individual elements or features of a particular embodiment are generally not limited to that particular embodiment, but, where applicable, are interchangeable and can be used in a selected embodiment, even if not specifically shown or described. The same may also be varied in many ways. Such variations are not to be regarded as a departure from the disclosure, and all such modifications are intended to be included within the scope of the disclosure.

What is claimed is:

1. A sight assembly for a firearm, the sight assembly comprising:
  - a housing operable to be attached to the firearm and including a first surface;
  - an aiming point defined by said housing;
  - a brightly colored material surrounding said aiming point, said brightly colored material providing a concave surface encircling said aiming point; and
  - an epoxy top coat disposed over said concave surface and being substantially flush with said first surface to provide said housing with a substantially planar surface opposing a shooter during use.
2. The sight assembly of claim 1, wherein said brightly colored material includes at least one of a photoluminescent material and a fluorescent material.
3. The sight assembly of claim 1, wherein said brightly colored material is paint.
4. The sight assembly of claim 1, wherein said aiming point includes an illumination device.

5. The sight assembly of claim 4, wherein said illumination device includes a Tritium lamp.

6. The sight assembly of claim 1, further comprising a second sight assembly spaced apart and separated from said housing and including a main body defining a pair of 5 upwardly extending projections, said upwardly extending projections defining a passage therebetween for alignment with said aiming point.

7. The sight assembly of claim 6, wherein said projections define a second surface opposing a shooter, said second surface being back-angled toward the shooter. 10

8. The sight assembly of claim 6, wherein said second surface includes a series of serrations.

9. The sight assembly of claim 6, wherein each of said projections includes an aiming point. 15

10. The sight assembly of claim 9, wherein each of said aiming points of said projections includes an illumination device.

11. The sight assembly of claim 10, wherein each of said illumination devices includes a Tritium lamp. 20

12. The sight assembly of claim 6, wherein said pair of projections define a U-shaped opening.

13. The sight assembly of claim 6, wherein said second sight assembly includes a surface formed substantially perpendicular to said main body to provide a surface against 25 which a force may be applied to actuate a slide mechanism of the firearm.

\* \* \* \* \*

UNITED STATES PATENT AND TRADEMARK OFFICE  
**CERTIFICATE OF CORRECTION**

PATENT NO. : 8,677,674 B2  
APPLICATION NO. : 13/222740  
DATED : March 25, 2014  
INVENTOR(S) : Bryan R. Glimpse et al.

Page 1 of 1

It is certified that error appears in the above-identified patent and that said Letters Patent is hereby corrected as shown below:

On Title Page 2,

Item (56) References Cited, U.S. PATENT DOCUMENTS, Column 2, Line 33, after “Shebaro”, insert  
--8,296,990 B2 10/2012 Zukowski et al.-- therefor.

On Title Page 2,

Item (56) References Cited, U.S. PATENT DOCUMENTS, Column 2, Line 50, after “42/132”, insert  
--20120151817 A1 6/2012 Howe et al.  
20120198750 A1 8/2012 Mansfield  
20130061511 A1 3/2013 Strayer  
20130180156 A1 7/2013 Shebaro-- therefor.

On Title Page 2,

Item (56) References Cited, OTHER PUBLICATIONS, Column 2, Line 10, after “Dec. 16, 2013”  
insert --Patent Examination Report No. 2 regarding Patent Application No. 2011253529, dated Aug.  
5, 2013. Final Office Action in U.S. Appl. No. 13/285,537, mailed Jul. 25, 2013.-- therefor.

Signed and Sealed this  
Seventh Day of October, 2014



Michelle K. Lee  
*Deputy Director of the United States Patent and Trademark Office*