



US008297401B1

(12) **United States Patent**
Schneider et al.

(10) **Patent No.:** **US 8,297,401 B1**
(45) **Date of Patent:** **Oct. 30, 2012**

(54) **VEHICLE STEERING SYSTEM TRANSMISSION**

7,905,317 B2 * 3/2011 Kruttschnitt et al. 180/444
2002/0119854 A1 8/2002 Mohr et al.
2005/0121251 A1 * 6/2005 Ueno et al. 180/444

(75) Inventors: **Dean Schneider**, Washington, MI (US);
Alexander Serkh, Troy, MI (US)

FOREIGN PATENT DOCUMENTS

JP 2000320626 11/2000
JP 1113840 11/2011

(73) Assignee: **The Gates Corporation**, Denver, CO
(US)

OTHER PUBLICATIONS

(*) Notice: Subject to any disclaimer, the term of this patent is extended or adjusted under 35 U.S.C. 154(b) by 0 days.

“Noise and Life of Helical Belt Drive”, Ueda et al., Transactions of the ASME, vol. 121, Jun. 1999.

* cited by examiner

(21) Appl. No.: **13/293,212**

Primary Examiner — Lesley D Morris
Assistant Examiner — Marc Scharich

(22) Filed: **Nov. 10, 2011**

(74) *Attorney, Agent, or Firm* — J.A. Thurnau, Esq.; P.N. Dunlap, Esq.

(51) **Int. Cl.**
B62D 5/04 (2006.01)

(57) **ABSTRACT**

(52) **U.S. Cl.** **180/444**; 180/443; 474/32

A vehicle steering system transmission comprising a housing, an input shaft journaled to the housing, an electric motor connected to the housing and coupled to the input shaft, an output shaft journaled to the housing, the input shaft and the output shaft coupled by a first pair of sprockets having a first belt trained therebetween and having a first ratio, the first belt and first pair of sprockets comprising a helical tooth configuration, the input shaft and the output shaft coupled by a second pair of sprockets having a second belt trained therebetween and having a second ratio, and the input shaft and the output shaft coupled by a third pair of sprockets having a third belt trained therebetween and having a third ratio.

(58) **Field of Classification Search** 180/443, 180/444, 446; 474/32, 33, 36

See application file for complete search history.

(56) **References Cited**

U.S. PATENT DOCUMENTS

4,403,979 A 9/1983 Wujick
4,840,608 A 6/1989 Araki et al.
5,209,705 A 5/1993 Gregg
6,685,785 B1 2/2004 Morris et al.
7,237,647 B2 * 7/2007 Nakamura et al. 180/444
7,490,696 B2 * 2/2009 Saruwatari et al. 180/444
7,887,446 B2 2/2011 Hironaka

14 Claims, 8 Drawing Sheets

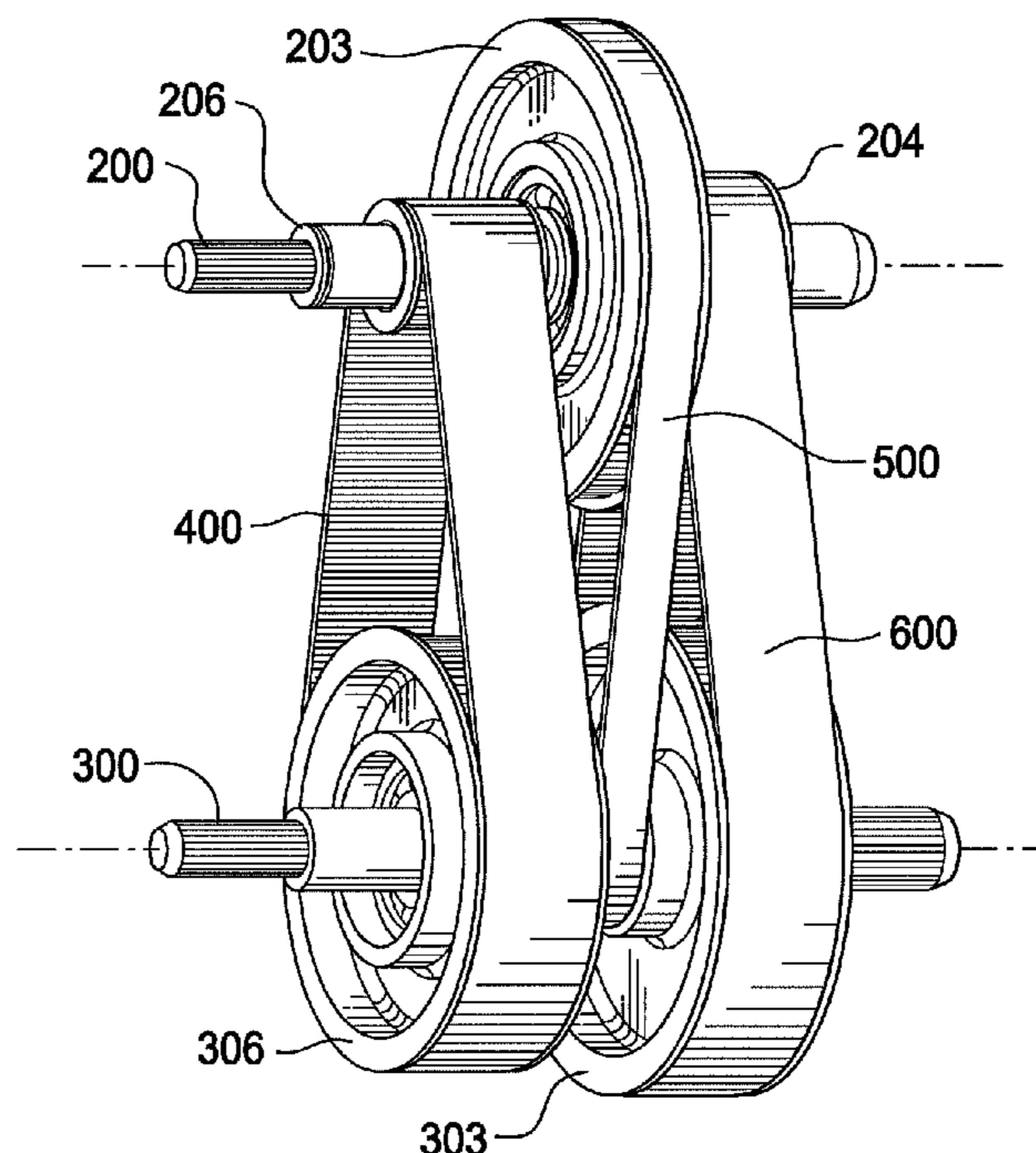

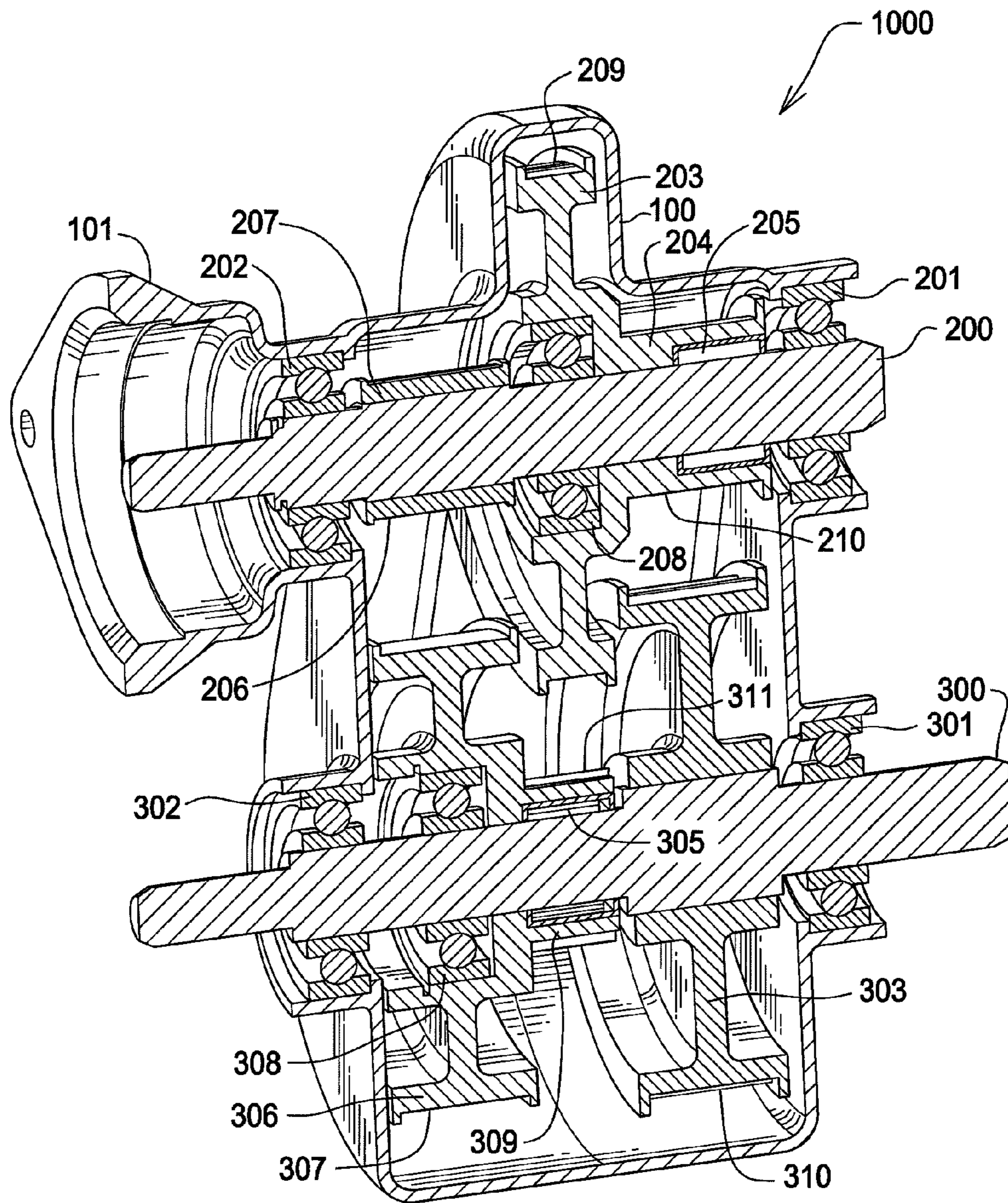
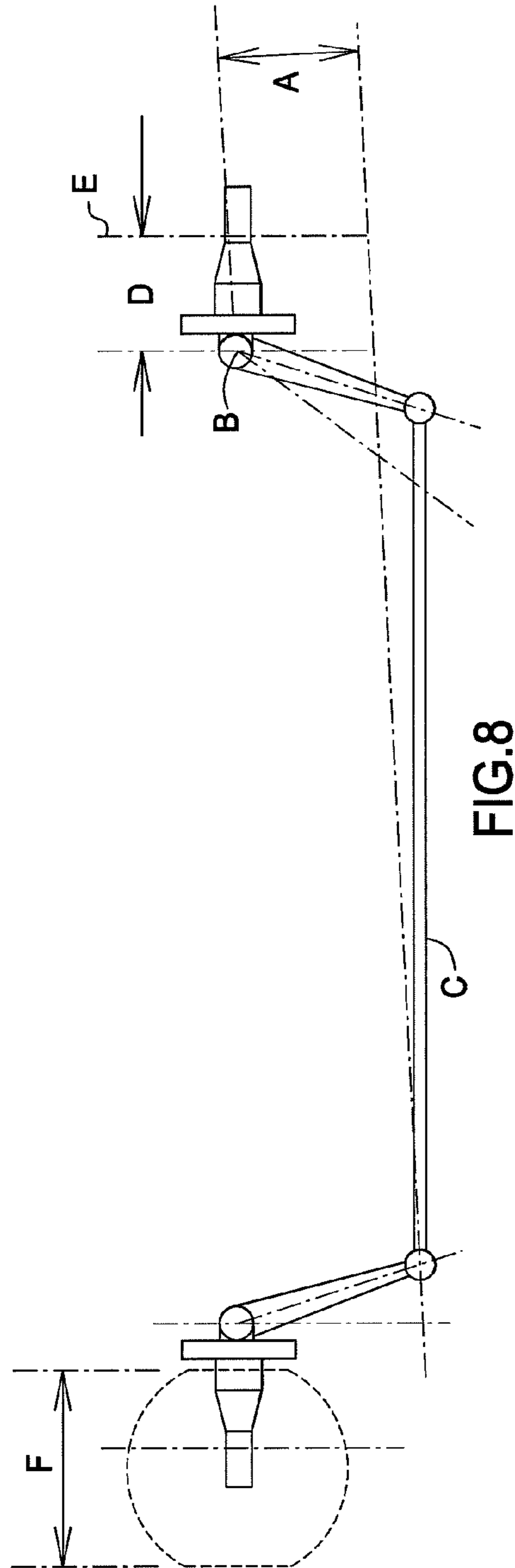
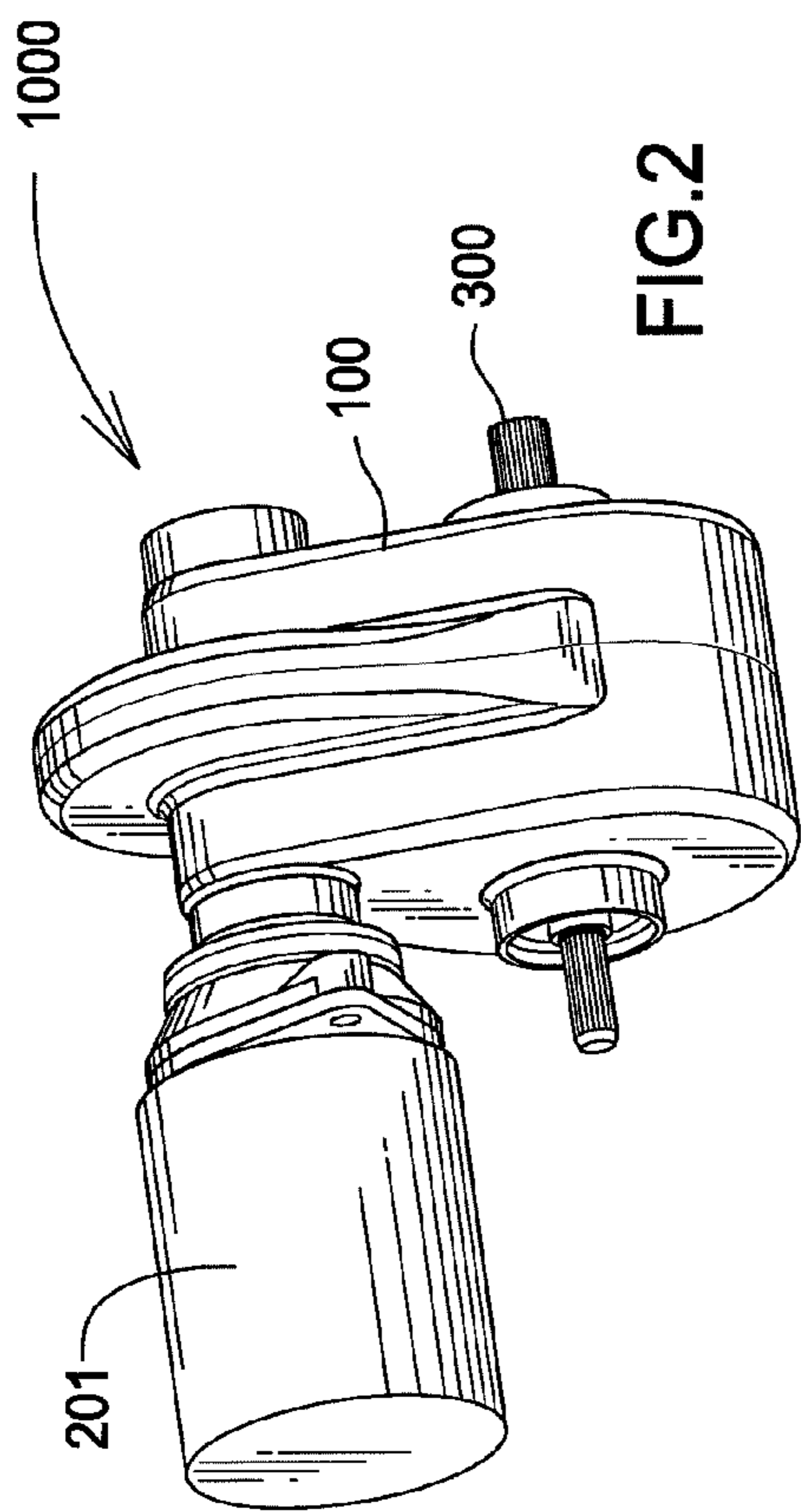

FIG. 1



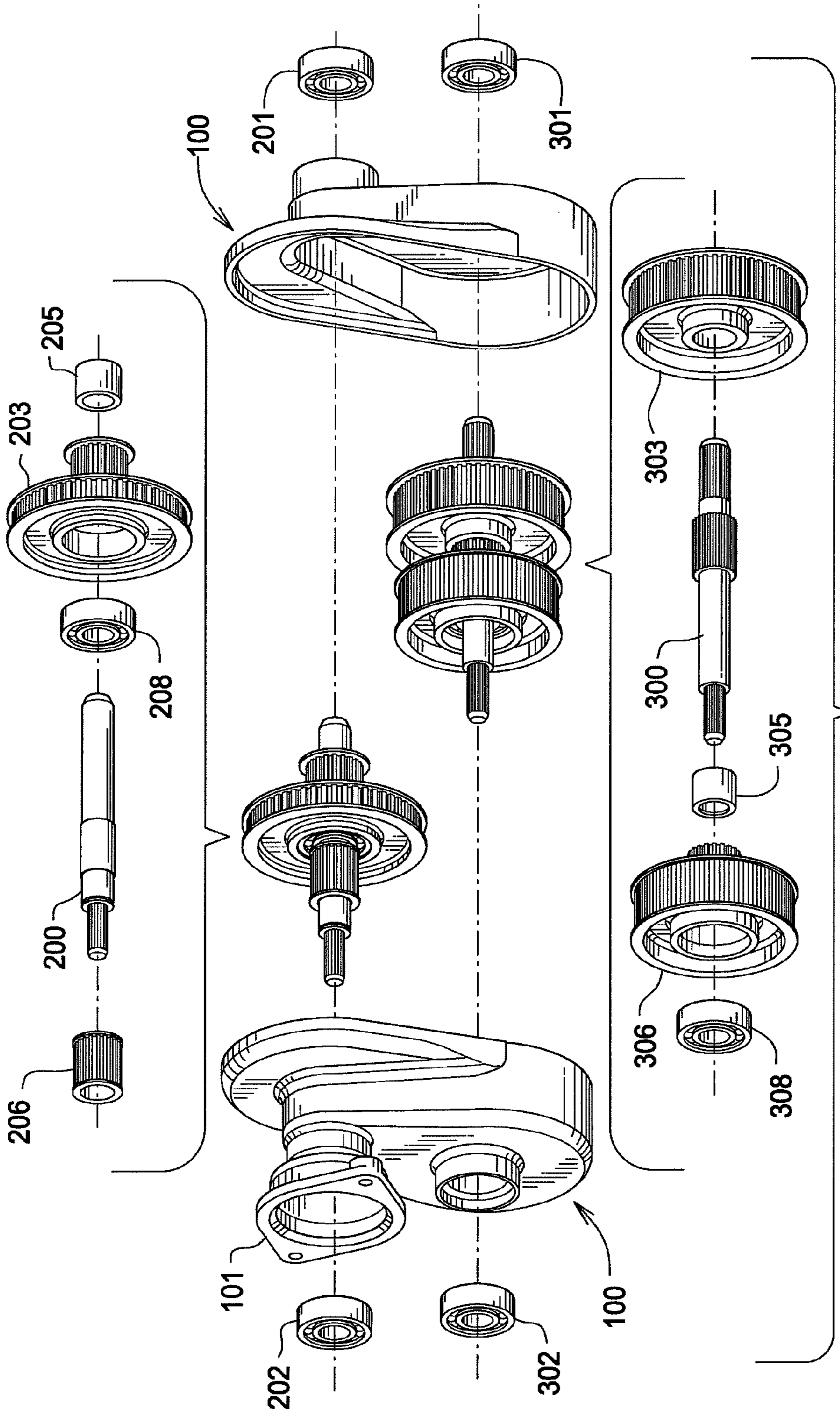
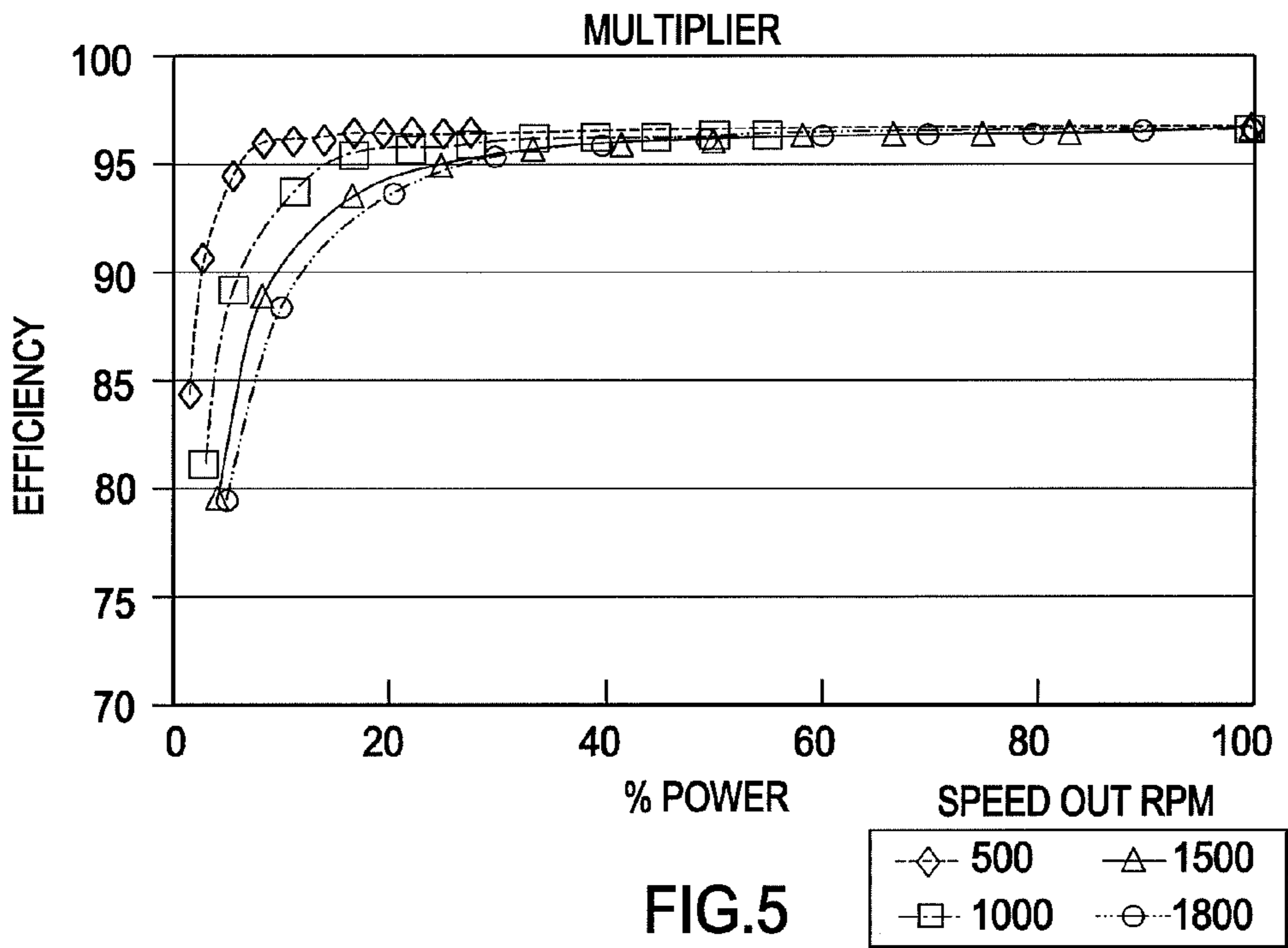
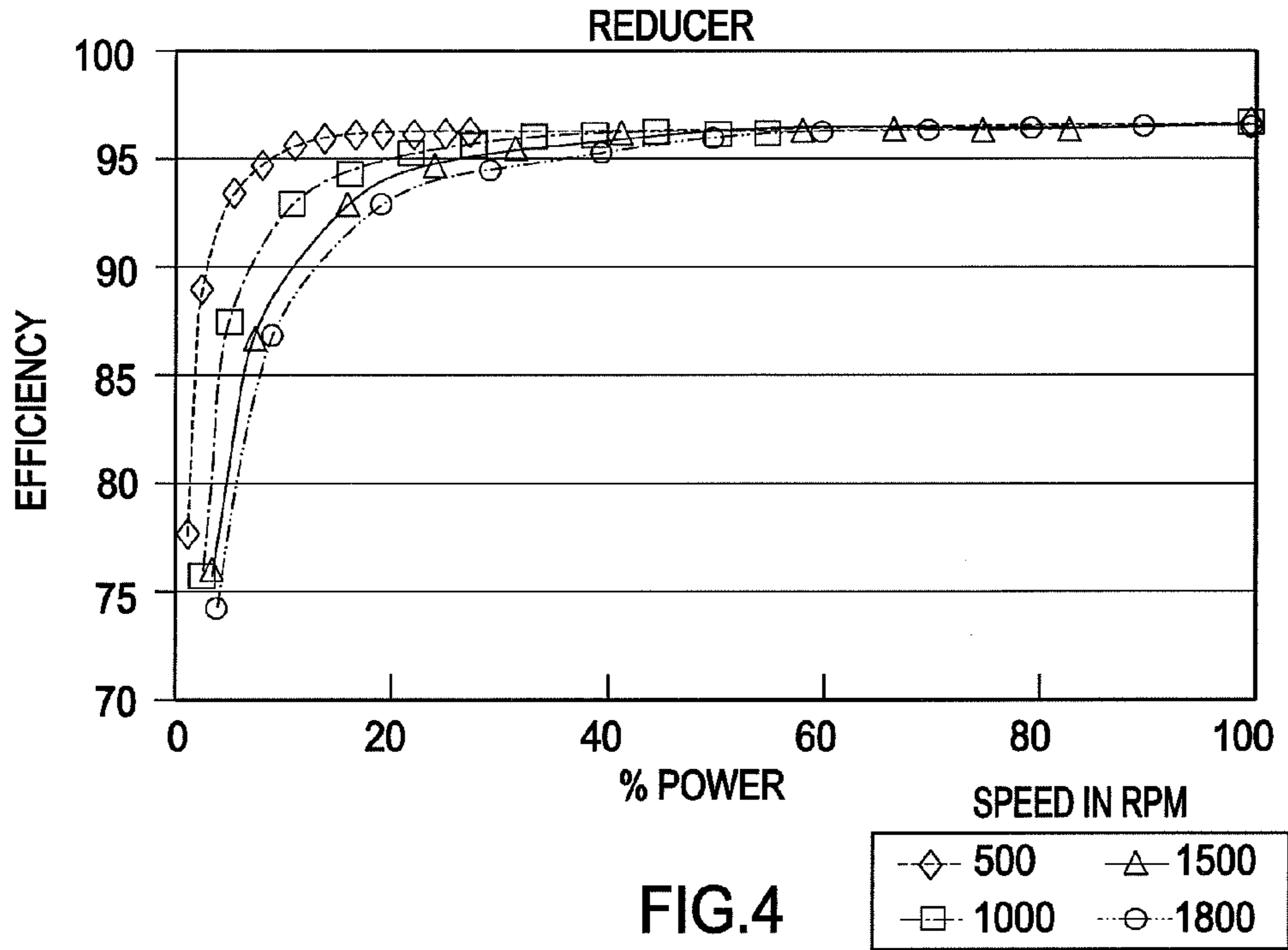
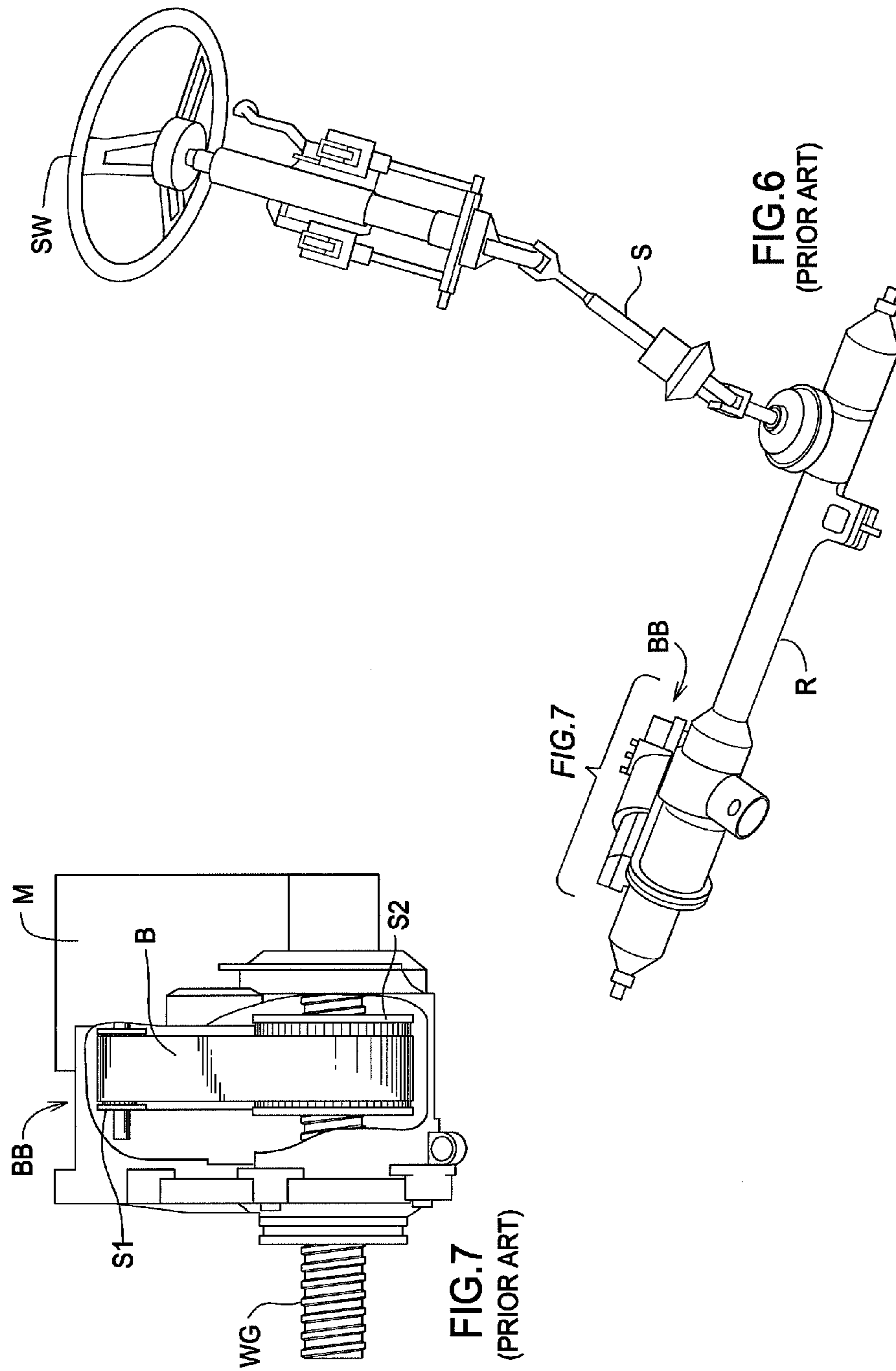

FIG.3





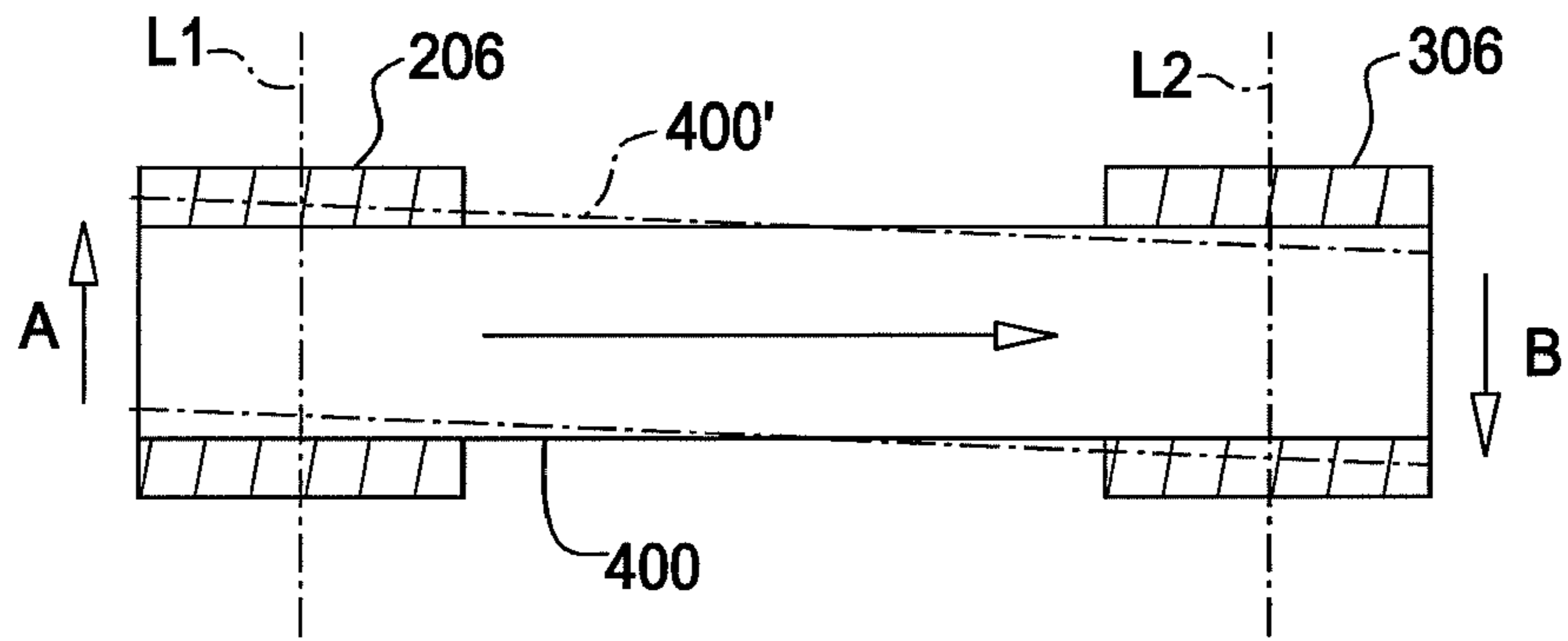

FIG. 9

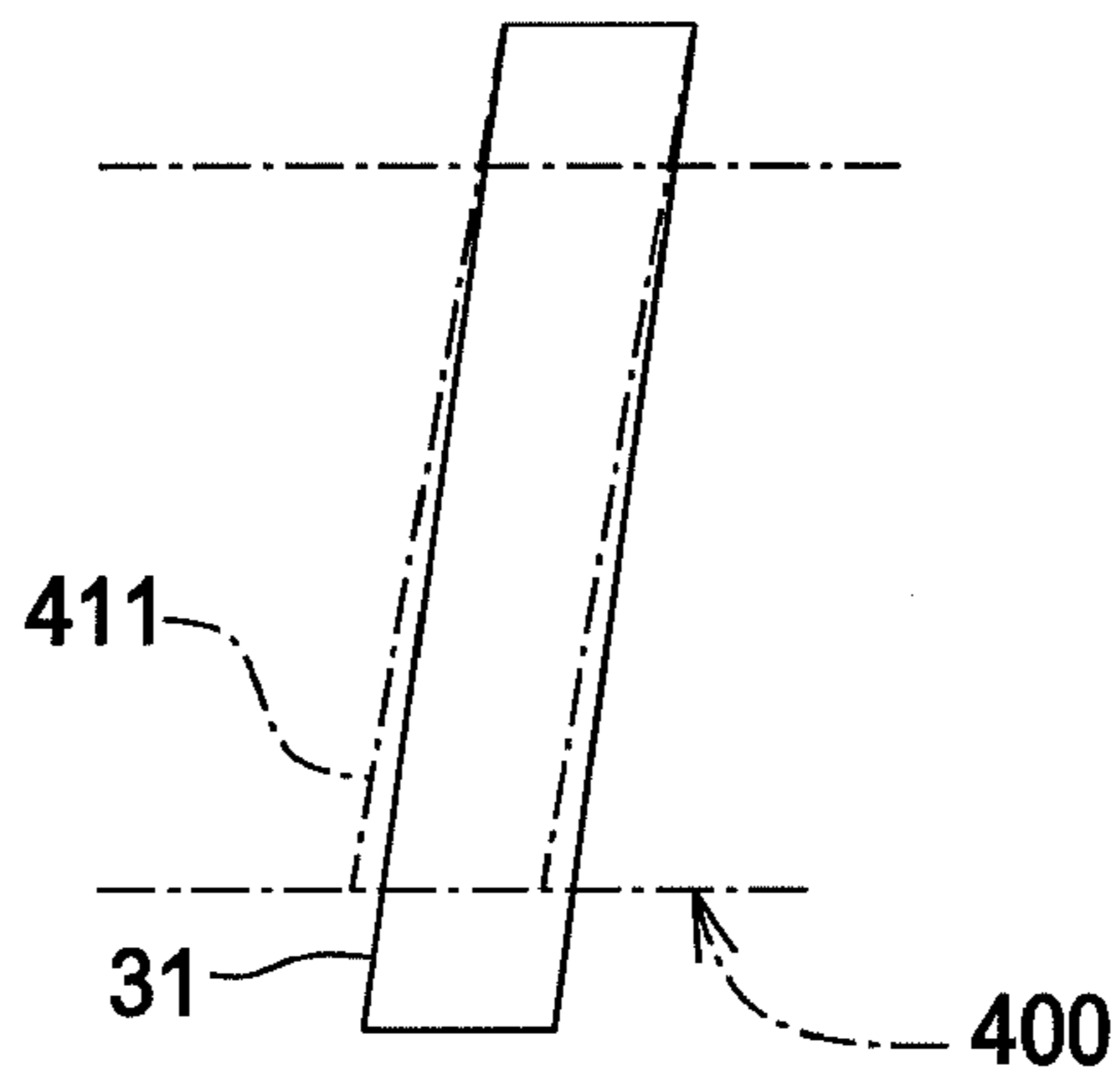

FIG. 10

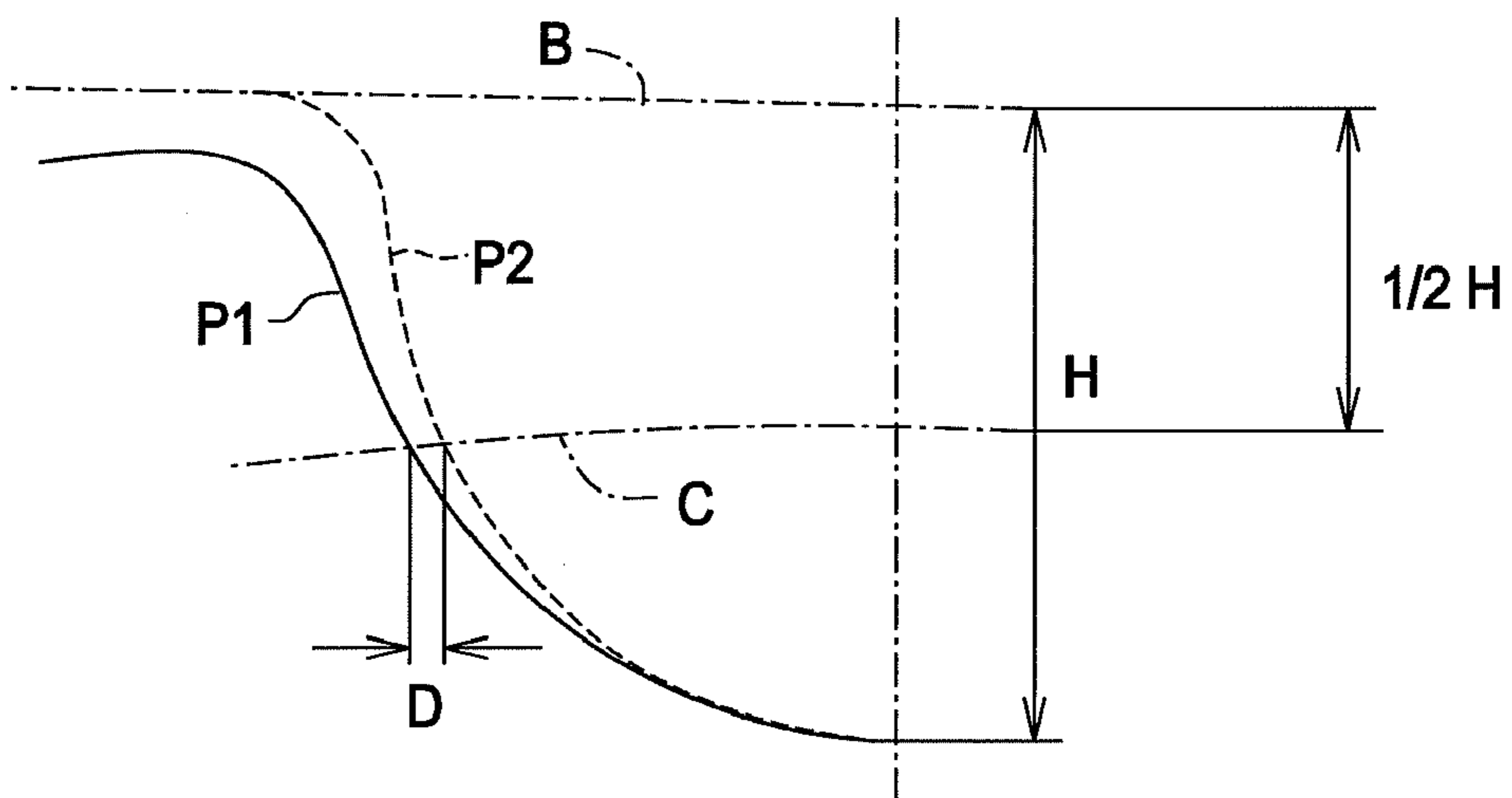
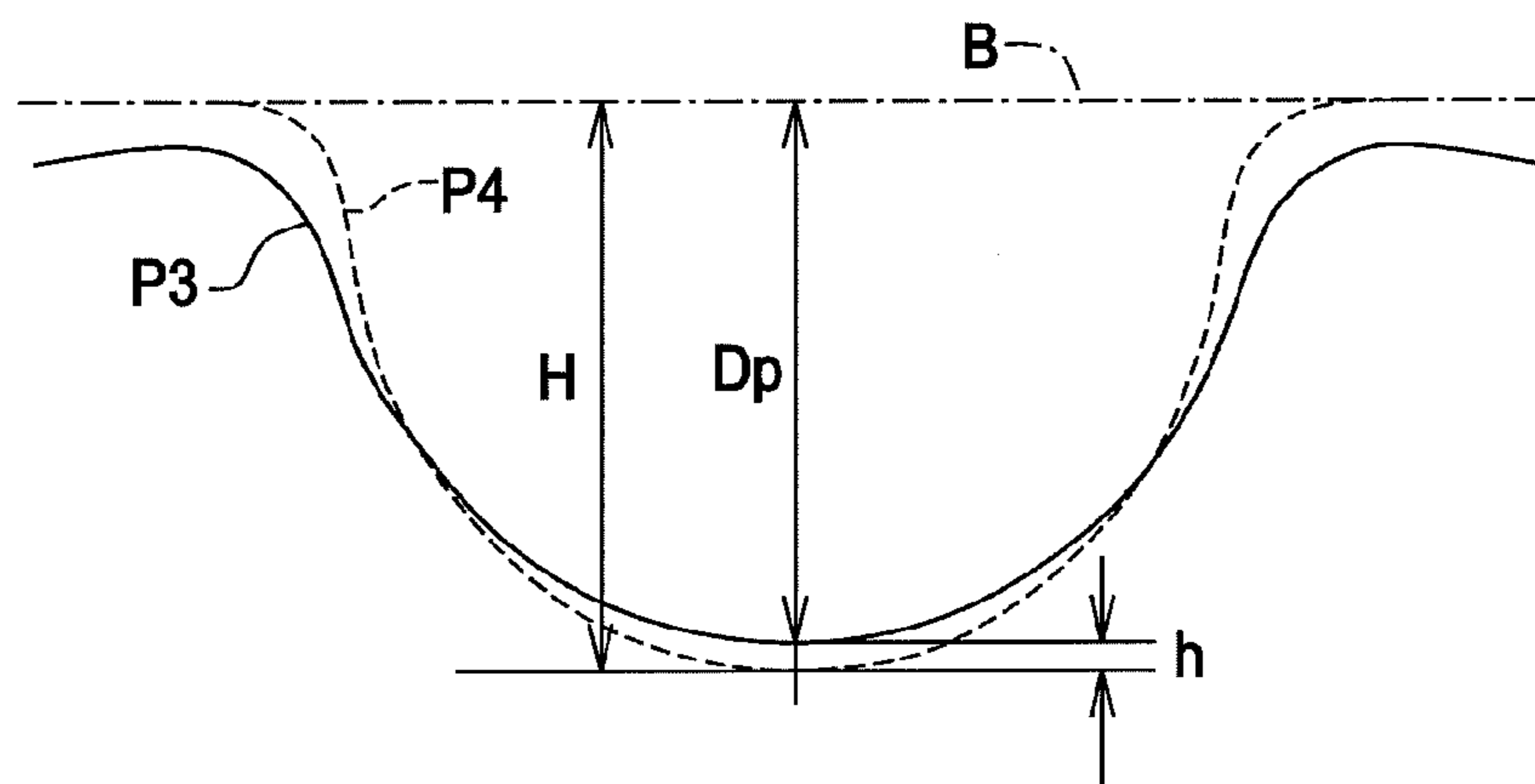
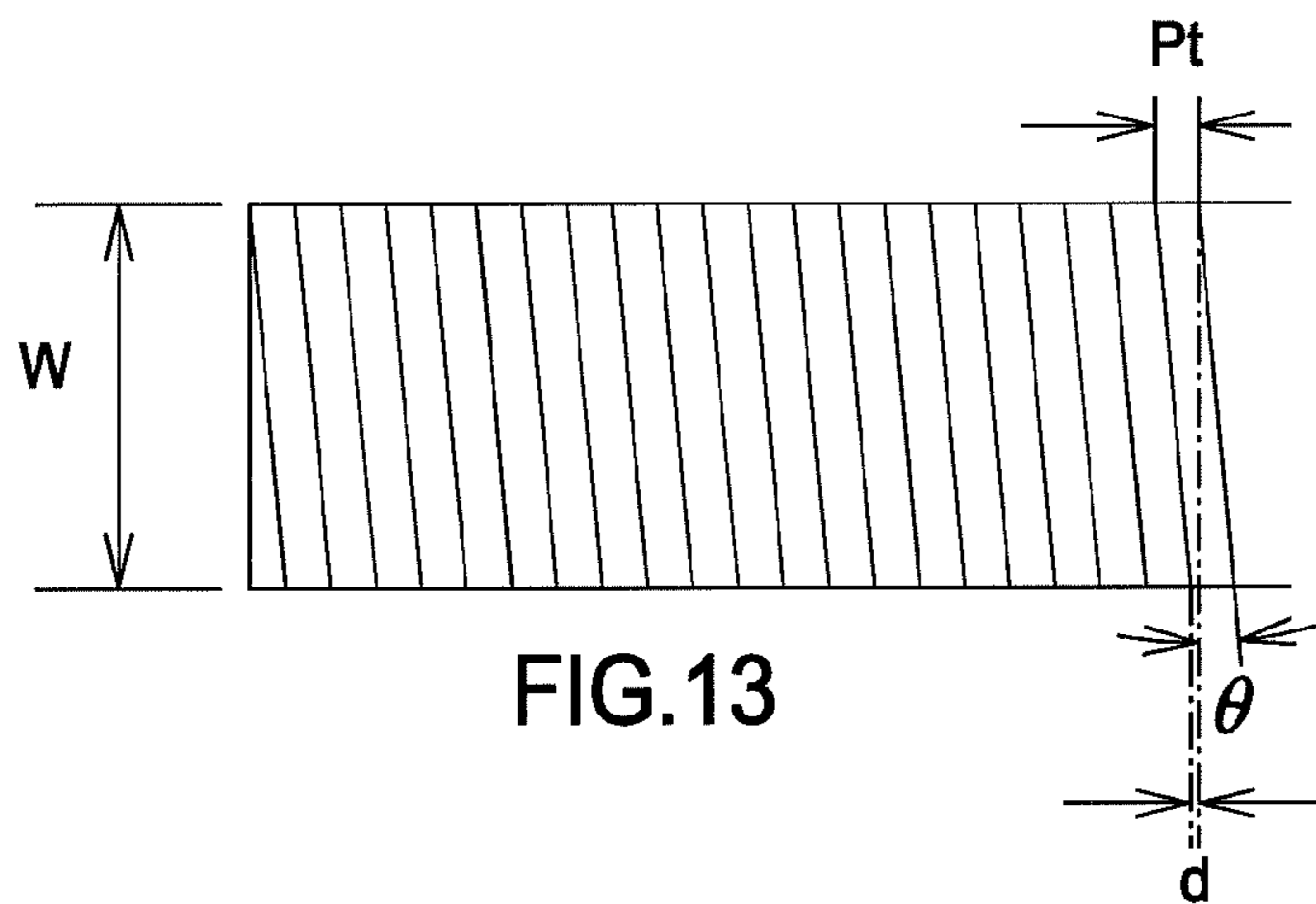
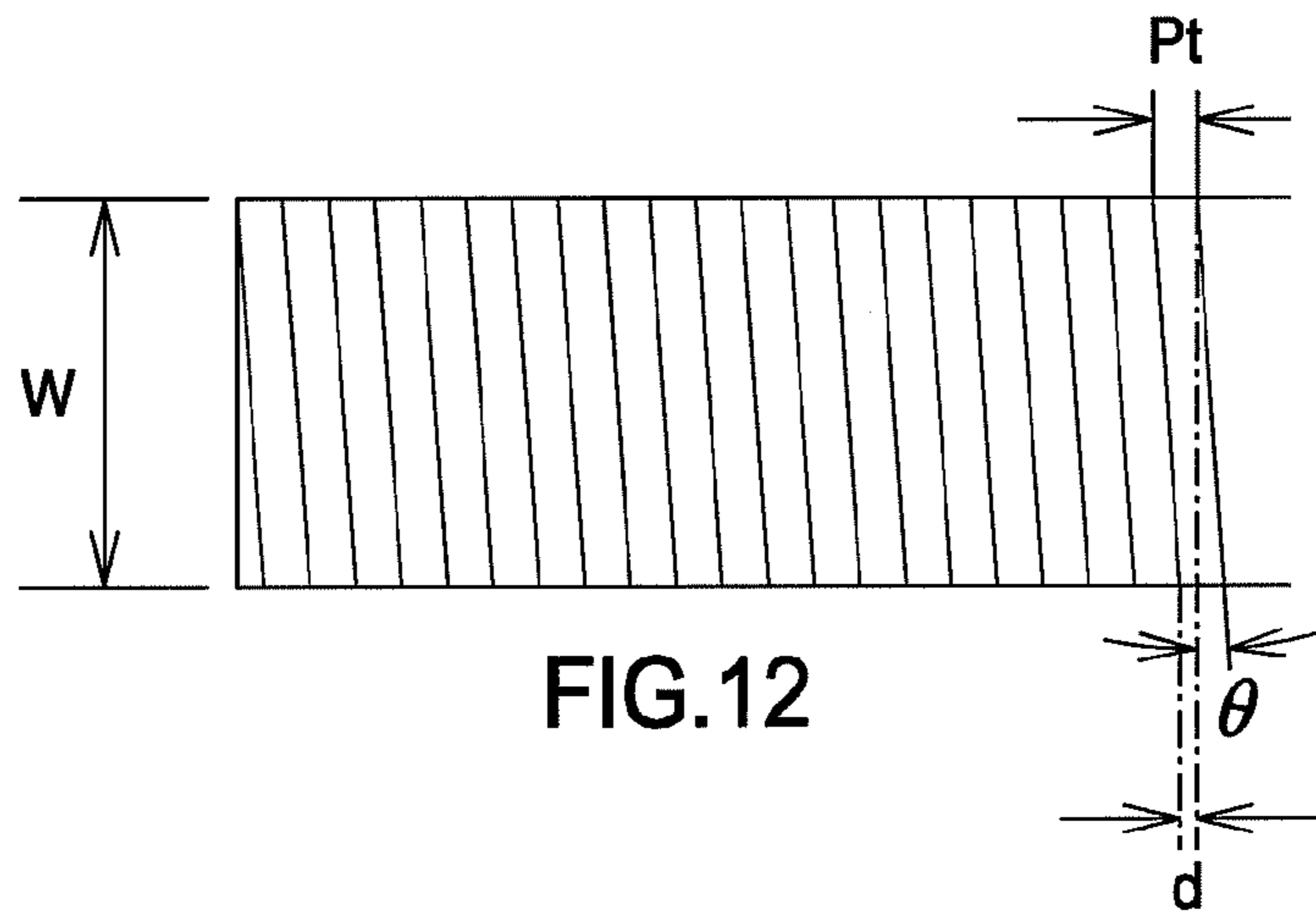

FIG. 11



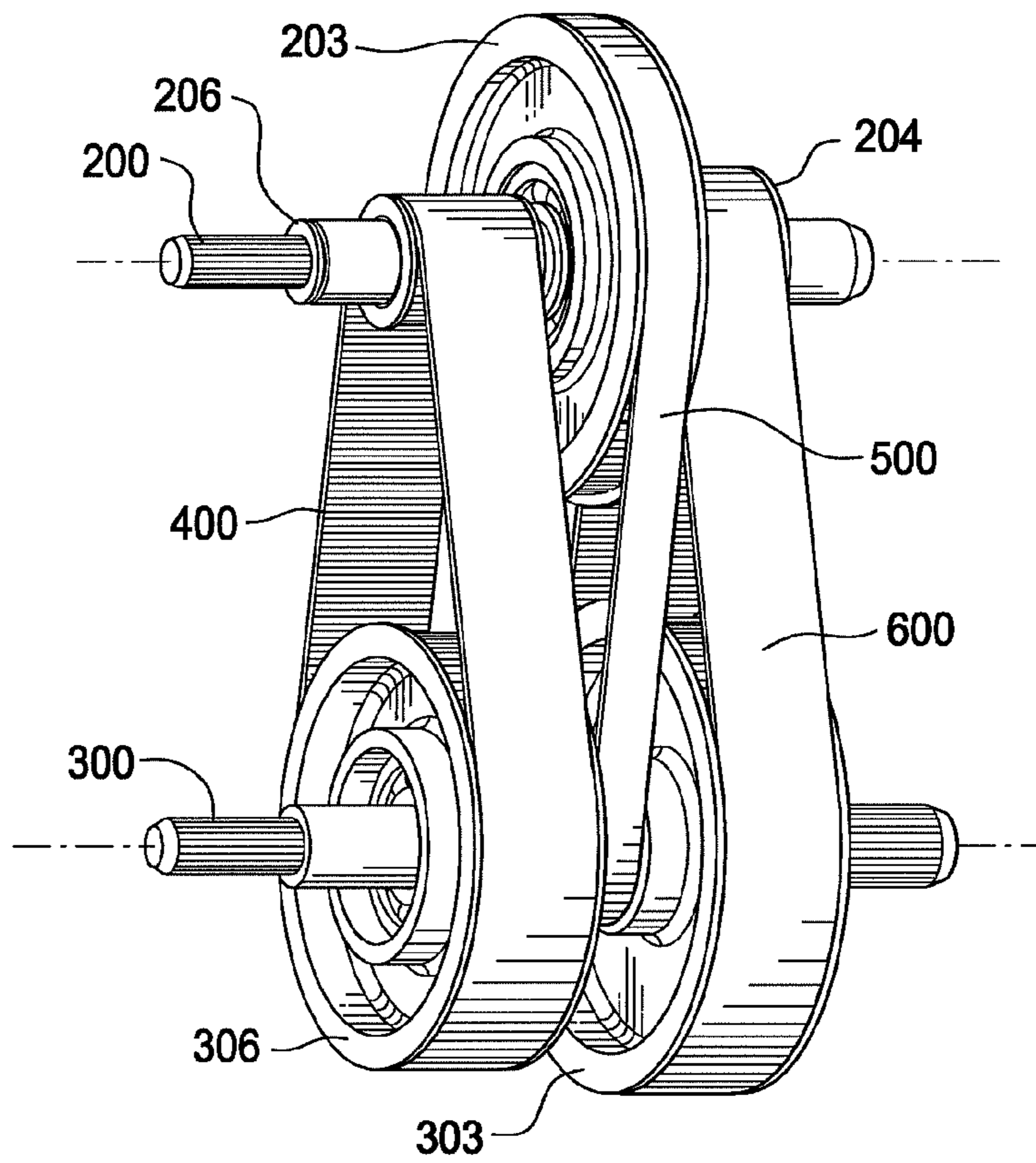

FIG. 15

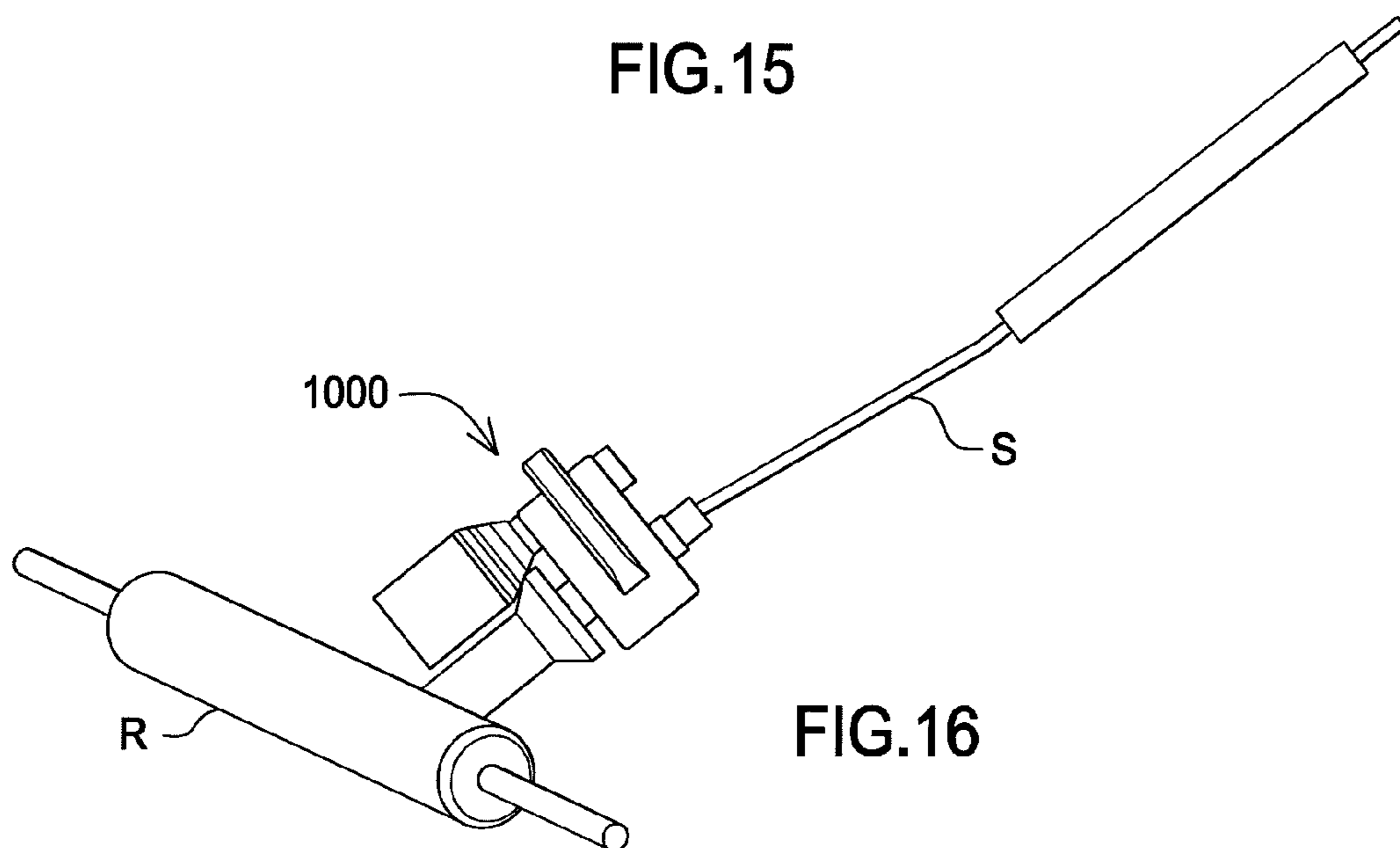

FIG. 16

1

VEHICLE STEERING SYSTEM TRANSMISSION

FIELD OF THE INVENTION

The invention relates to a vehicle steering system transmission, and more particularly to a vehicle steering system transmission comprising an input shaft and an output shaft coupled by a first pair of sprockets having a ratio, a second pair of sprockets having a ratio and the third pair of sprockets having a ratio.

BACKGROUND OF THE INVENTION

Electric power assist steering systems (EPAS) have been around since the 1960's. Hydraulic power assist steering has traditionally dominated the market. Hydraulic systems have high parasitic energy loss when the hydraulic pump is pumping, but power assist is not required. Early attempts to eliminate this parasitic loss involved fitting an electric motor to the pump and only driving the pump when necessary.

Electric hydraulic assisted power steering systems use an electric motor to drive a hydraulic pump to feed a hydraulic power steering system. These systems are an intermediate step by the industry and their use will likely fade with the increased use of EPAS. EPAS systems allow realization of reduced noise, reduced energy use, active safety features, and adjustability to meet driving conditions. However, the use of these systems has remained limited until recent C.A.F.E. requirements became more difficult to meet. This is driving automotive manufacturers to turn to EPAS systems more and more in an effort to improve vehicle fuel economy. EPAS systems eliminate the parasitic losses typically found in hydraulic assist power steering systems. System manufacturers such as Nexteer make claims of 6% fuel economy improvements.

For example, one difficulty that slowed implementation of EPAS systems was meeting the power requirement with a 12 volt electric motor. Recently systems have been developed that successfully solve this problem. Further, all EPAS systems require a control module to sense driver input and control the electric motor to provide the desired assist. The control module measures driver input torque and uses this to determine the amount of assist required. Assist can be tuned to meet the drivers need depending on driving conditions. The system can even have a tunable "feel" available to the driver.

Even though the main driver for automotive EPAS is fuel economy improvement, EPAS has additional benefits. The system can make steering assist available even when the vehicle's engine is not running. It also enables the use of the automatic parallel parking systems available today.

There are two main types of EPAS systems; column assist and rack assist. Rack assist EPAS systems have an electric motor that is connected to the steering rack. The electric motor assists the rack movement usually through driving a lead screw mechanism. Column assist EPAS systems have an electric motor connected to the steering column. The electric motor assists the movement of the column shaft usually through a worm gear type arrangement. One advantage of these types of systems is the electric motor can be placed in the passenger compartment freeing up valuable space under the hood. This also keeps any sensitive electrical components out of the harsh under hood environment.

Worm drive column assist systems are usually used in small cars where the assist power requirements are lower than what would be needed in a large heavy vehicle. These systems are limited by the speed of the steering wheel and the ratio of

2

the worm drive. The steering wheel at its fastest speed rotates relatively slowly at approximately 60 rpm. With a 60 rpm speed of the steering wheel and a worm drive ratio of 15:1, the max speed of the electric motor would only be 900 rpm.

Worm drives are limited to ratios under 20:1 because ratios higher than that cannot be back-driven.

The steering system must be able to be operated with no power. This requires the worm drive be able to operate with the gear driving the worm (back-driven). Having a low motor speed and limited ratio worm drive causes the need for high torque motor. Even with a high torque motor, these types of systems have not been made successful on heavy vehicles. Small vehicles are light and require less steering effort thus enabling the use of these systems. Worm drive column assist EPAS systems are the lowest cost systems and thus also lend themselves to smaller less expensive vehicles.

Typical steering systems with worm drive assists are limited in their efficiency. EPAS systems must be designed to operate when there is no power available. Due to the nature of worm drive's tendency to lock up during back driving when ratios exceed approximately 20:1, worm drive EPAS systems efficiency is not greater than approximately 85% and nearer to 65% during back-driving conditions.

Today there are no column assist SPAS systems commonly available that use anything other than a worm drive to facilitate the assist. These column systems are unable to provide enough assist for large heavy vehicles.

Representative of the art is U.S. Pat. No. 7,887,446 which discloses a helically-toothed-belt transmission device. A backlash "D" is selectively enlarged in a helically-toothed-belt transmission device that transmits drive force by meshing between a helically toothed belt and a helically toothed pulley, that is, a tooth helix angle " θ " is set in a range of $-0.2 \leq 1 - Wx\theta/Pt \leq 0.75$, with "Pt" being a tooth pitch, " θ " a tooth helix angle, and W the width of the belt. The backlash "D" between the helically toothed belt and the helically toothed pulley is set to be 1.6%-3% of the tooth pitch "Pt".

What is needed is a vehicle steering system transmission comprising an input shaft and an output shaft coupled by a first pair of sprockets having a ratio, a second pair of sprockets having a ratio and the third pair of sprockets having a ratio. The present invention meets this need.

SUMMARY OF THE INVENTION

The primary aspect of the invention is to provide a vehicle steering system transmission comprising an input shaft and an output shaft coupled by a first pair of sprockets having a ratio, a second pair of sprockets having a ratio and the third pair of sprockets having a ratio.

Other aspects of the invention will be pointed out or made obvious by the following description of the invention and the accompanying drawings.

The invention comprises a vehicle steering system transmission comprising a housing, an input shaft journaled to the housing, an electric motor connected to the housing and coupled to the input shaft, an output shaft journaled to the housing, the input shaft and the output shaft coupled by a first pair of sprockets having a first belt trained therebetween and having a first ratio, the first belt and first pair of sprockets comprising a helical tooth configuration, the input shaft and the output shaft coupled by a second pair of sprockets having a second belt trained therebetween and having a second ratio, and the input shaft and the output shaft coupled by a third pair of sprockets having a third belt trained therebetween and having a third ratio.

BRIEF DESCRIPTION OF THE DRAWINGS

The accompanying drawings, which are incorporated in and form a part of the specification, illustrate preferred embodiments of the present invention, and together with a description, serve to explain the principles of the invention.

FIG. 1 is a cross sectional view of the inventive transmission.

FIG. 2 is a perspective view of the inventive transmission.

FIG. 3 is an exploded view of the inventive transmission.

FIG. 4 is a graph of the efficiency of the transmission as a speed reducer.

FIG. 5 is a graph of the efficiency of the transmission as a speed multiplier.

FIG. 6 is a perspective view of a prior art electric power assist rack system.

FIG. 7 is a detail of FIG. 6.

FIG. 8 is a schematic of a steering system.

FIG. 9 schematically shows an arrangement of an endless helically-toothed belt installed on a helically-toothed pulley, which is viewed from a back side of the belt.

FIG. 10 is a schematic enlarged view showing the relations between the teeth traces of the helically-toothed pulley and the teeth traces of the helically-toothed belt engaged thereto.

FIG. 11 illustrates half tooth profiles of the belt and pulley.

FIG. 12 illustrates an angle of the helical tooth applied to the endless belt.

FIG. 13 illustrates the helically-toothed belt.

FIG. 14 shows a form of a compressible tooth profile.

FIG. 15 is a detail of the belt arrangement.

FIG. 16 is a perspective view of the inventive transmission in a steering system.

DETAILED DESCRIPTION OF THE PREFERRED EMBODIMENT

FIG. 1 is a cross sectional view of the inventive transmission. The inventive transmission 1000 comprises a housing 100. Contained within the housing is an input shaft 200. The input shaft is coupled to an electric motor 201. The electric motor is a 12 V DC motor known in the art. The electric motor is attached to the housing at a motor mount 101.

Input shaft 200 is journaled to the housing by a first bearing 201 and a second bearing 202.

Sprocket 206 is press fit to shaft 200. Sprocket 206 comprises a toothed surface 207 for engaging a toothed belt 400.

An intermediate sprocket 203 is journaled to shaft 200 by a bearing 208 and a needle bearing 205. Sprocket 203 freely rotates on shaft 200. Intermediate sprocket 203 is connected to sprocket 204, in other words they are a single unit. Intermediate sprocket 203 comprises a toothed surface 209, and sprocket 204 comprises a toothed surface 210, each for engaging a toothed belt. The diameter of toothed surface 209 is greater than a diameter of toothed surface 210. The diameter of sprocket 206 is less than the diameter of sprocket 204. Of course, any combination of diameters is possible in order to achieve the desired ratio.

An output shaft 300 is journaled to the housing by a first bearing 301 and a second bearing 302.

Sprocket 306 is journaled to output shaft 300 by a bearing 308 and a needle bearing 305. Sprocket 306 comprises a toothed surface 307 for engaging a toothed belt. Sprocket 306 is connected to sprocket 309 which also comprises a surface for engaging a toothed belt. The diameter of sprocket 306 is greater than the diameter of sprocket 309. The diameter of sprocket 306 is less than the diameter of sprocket 303. Of

course, any combination of diameters is possible in order to achieve the desired ratio for each pair of sprockets.

Sprocket 303 is press fit to shaft 300. Sprocket 303 comprises a toothed surface 310 for engaging a toothed belt.

A toothed belt 400 is trained between the first pair of sprockets, namely, sprocket 206 and sprocket 306. The ratio between sprocket 306 and 206 is 3.4:1. Toothed belt 400 comprises a helical belt which is more fully described elsewhere in this specification.

A toothed belt 500 is trained between the second pair of sprockets, namely, sprocket 203 and sprocket 309. The ratio between sprocket 203 and 309 is 3.0:1. A toothed belt 600 is trained between the third pair of sprockets, namely, sprocket 204 and sprocket 303. The ratio between sprocket 303 and 204 is 3.0:1. Toothed belt 500 and toothed belt 600 do not comprise a helical belt as is the case for toothed belt 400.

The dimensions given in this specification are examples only and are not intended to limit the scope of the inventive transmission.

Helical Belt.

Helical belt 400 and helical sprockets 206, 306 are described next. FIG. 9 schematically shows an arrangement of an endless helically-toothed belt installed on a helically-toothed pulley, which is viewed from a back side of the belt. As shown in the figure, the helically-toothed belt 400 is entrained around a pair of helically-toothed pulleys 206 and 306 which are rotatable about respective axes "L1" and "L2". For example, the helically-toothed pulley 306 is a drive pulley and the rotational power of the helically-toothed pulley 306 is transmitted to the driven pulley 206 via the helically-toothed belt 400. In FIG. 9, the helically-toothed belt 400 described by a solid line indicates an arrangement of the helically-toothed belt immediately after the belt installation. On the other hand, a phantom line indicated by a reference number 400' represents a position of the helically-toothed belt 400 after the belt-drive transmission device is driven.

Immediately after the helically-toothed belt 400 is installed on the helically-toothed pulleys 206 and 306 (before the belt-drive transmission device is driven), teeth traces of the helically-toothed belt 400 coincide with teeth traces of the helically-toothed pulleys 206 and 306, so that the longitudinal direction of the helically-toothed belt 400 is made substantially perpendicular to the rotational axes "L1" and "L2" of the helically-toothed pulleys 206 and 306. However, when the helically-toothed pulley 306 or the drive pulley is driven and the load bears upon the helically-toothed belt 400, the helically-toothed belt 400 skids along the teeth traces of the pulleys, thus a thrust occurs. Namely, when the belt-drive transmission device is driven, the helically-toothed belt 400 skids on the helically-toothed pulley 206 in the "A" direction along the rotational axis "L1", and skids on the helically-toothed pulley 306 in the "B" direction, which is opposite to the "A" direction, along the rotational axis "L2", as shown in FIG. 9. Thereby, the helically-toothed belt 400, represented by the solid line, is moved to the position 10' which is represented by the phantom line. This type of thrust is prominent when the belt-drive transmission device is operated under a heavy load or at a high-speed rotation.

FIG. 10 is a schematic enlarged view showing the relations between the teeth traces of the helically-toothed pulley 306 and the teeth traces of the helically-toothed belt 400 engaged thereto, after the belt-drive transmission device operation is started or after thrust has occurred. As shown in the figure, a tooth trace 411 of the helically-toothed belt 400 is inclined against a tooth trace 31 of the helically-toothed pulley 306 to the amount of angles where the belt has slanted by the skid, so that the tooth trace 411 slips out of the tooth trace 31. When a

gap is induced between the tooth trace of the helically-toothed belt **400** and the tooth trace of the helically-toothed pulley **306**, inadequate contact is generated between the pulley and the belt. For example a shoulder (a part connecting a working flank and a tooth tip cylinder) of the pulley contacts a mating flank of the belt, or the like. Such inadequate engagement generates noise and vibration. Note that, as can be seen from FIG. **9**, the same phenomena are induced on the helically-toothed pulley **206**.

In order to solve such problems, backlash between the belt and the pulley is selectively enlarged in a first embodiment of the present invention, so as to prevent inadequate contact between the pulley teeth and the belt teeth and reduce noise and vibration. Referring to FIG. **11**, the definition of backlash in the present embodiment will be explained.

FIG. **11** illustrates half tooth profiles of the belt and pulley. A solid curve "P1" describes the tooth profile of the pulley and a broken curve "P2" describes the tooth profile of the belt. A straight line "B", a dash-dotted line, is the base line on a bottom land of the belt, so that a tooth height "H" is defined by the height from the base line B to the tip of the belt tooth. Further, is an arc "C", which is also indicated by a dash-dotted line, is an arc that passes through a point that is distant from the base line "B" by a half of the distance of the tooth height "H" ($\frac{1}{2}H$), and its center coincides with the center of the pulley. Namely, the diameter of the arc "C" is equivalent to a value where the tooth heights "H" are subtracted from the outside diameter of the pulley. The backlash between the belt and the pulley is defined by the distance "D" between the pulley tooth and the belt tooth at a position along the arc "C" (the distance between the intersection of the curve "P1" and the arc "C", and the intersection of the curve "P2" and the arc "C").

Next, referring to FIG. **12**, an angle of the helical tooth applied to the endless belt of the first embodiment will be explained. FIG. **12** is a part of a schematic development of the helically-toothed belt **400**, which is applied to the first embodiment. The teeth traces of the helically-toothed belt **400** are represented by the slanted solid lines which lie in the lateral direction of the belt. Here, the pitch of the belt teeth is denoted by "Pt" and the width is denoted by "W". Further, when denoting an angle (tooth helix angle) between the line in the lateral direction of the belt (or the line perpendicular to the belt longitudinal direction) and the tooth trace as " θ ", a space "d" between the end of the first tooth engagement and the beginning of the neighboring second tooth engagement are represented by $d = Pt - W \times \theta$, using the pitch "Pt", the belt width "W", and the tooth helix angle " θ ". In the first embodiment, the tooth helix angle " θ " is set so as to satisfy

$$-0.2 \leq d/Pt = 1 - W \times \theta / Pt \leq 0.75$$

In a conventional helically-toothed-belt transmission device, although the backlash "D" is set to about 1.5% with respect to the tooth pitch "Pt", the backlash "D" of the helically-toothed-belt transmission device of the first embodiment, is set in a range of 1.6% to 3% ($D/Pt \times 100$) of the tooth pitch "Pt".

Namely, in the helically-toothed-belt transmission device of the first embodiment, an inadequate contact between the teeth of the pulley and the belt is prevented, even when thrust is induced on the belt when a heavy load is placed upon the belt during operation, by setting the backlash "D" widely (wide backlash), such as at 1.6% to 3% of the tooth pitch "Pt". Further, this is particularly effective for the tooth helix angles " θ " that satisfy $-0.2 \leq d/Pt \leq 0.75$. Namely, over a wide range of tooth helix angles " θ " (even for a small angle which is not very effective for a compressible tooth profile), the noise and

the vibration can be reduced. As described above, according to the first embodiment, noise and vibration are effectively reduced for the helically-toothed-belt transmission device which is driven under a heavy load or at a high-speed rotation.

Next, with reference to FIG. **13** and FIG. **14**, a belt-drive transmission device of a second embodiment of the present invention will be explained. FIG. **13** is part of a schematic development of the helically-toothed belt **400**, which is applied to the second embodiment. The teeth traces of the helically-toothed belt **400** are represented by the slanted solid lines which lie in the lateral direction of the belt. Further, FIG. **14** shows a form of a compressible tooth profile applied in the second embodiment.

In the belt-drive transmission belt of the second embodiment, the tooth helix angle " θ " is set in a range of $d/Pt = 1 - W \tan \theta / Pt \leq 0$. Namely, as shown in FIG. **13**, a value of "d" is "0" or negative, so that the engagement of the neighboring second tooth starts before the end of the first tooth engagement (or simultaneously with the end of the engagement).

In FIG. **14**, a curve "P3" indicated by a solid line represents the tooth profile of the helically-toothed pulleys **206** and **306** of the second embodiment, and a curve "P4" indicated by a broken line represents the tooth profile of the helically-toothed belt **400** of the second embodiment. Further, a dash-dotted line "B" represents the base line of the belt when the belt is installed. A groove depth "Dp", a depth from the base line "B" to the tooth root cylinder of the pulley, is smaller than the tooth height "H" of the belt by "h". Therefore, when the helically-toothed belt **400** is entrained about the helically-toothed pulleys **206** and **306**, and tension is given, the belt teeth are pressed against the tooth root cylinder of the pulley and compressed. Thereby, positioning accuracy of each of the belt teeth to the pulley grooves is improved, so that a cumulative error between the belt teeth and the pulley teeth is reduced, and the inadequate contact between the belt teeth and the pulley teeth is prevented. Note that, in the second embodiment, the compressibility ($h/H \times 100$) of the helically-toothed belt is set within 1.5% to 5%.

As described above, according to the second embodiment, noise and vibration are effectively reduced from the helically-toothed-belt transmission device where the tooth helix angle " θ " is within the range of $d/Pt = 1 - W \theta / Pt \leq 0$, and where the device is driven under a heavy load or at a high-speed rotation, by preventing the inadequate contact between the belt teeth and the pulley teeth. Note that, the helically-toothed-belt transmission device of the second embodiment is particularly effective around a span resonance frequency.

Steering ratio is the ratio of the number of degrees of steering wheel movement per one degree of front wheel movement. A 20:1 steering ratio requires 20 degrees of steering wheel movement to move the front wheels one degree. Most power steering systems have ratios somewhere between 12:1 and 24:1. Ratios of 12:1 are for sports cars. A large pick-up truck may have a ratio near 24:1.

The inventive system consists of a series of belts arranged on two common axis, namely, the input and output shafts. The inventive system provides a torque multiplication ratio of 30.6:1 from the electric motor to the output shaft **300**. This is accomplished through three stages of 3.4:1, 3:1 and 3:1.

The initial stage nearest the electric motor **201** is configured for the 3.4:1 ratio. First stage sprockets **206** and **306** utilize a helical sprockets and a helical belt to minimize noise on this high speed belt. The next two sprocket stages utilize a 5 mm pitch toothed belt. The sprocket tooth combinations chosen enable the design to maintain the same center distance for both pitch designs.

FIG. 6 is a perspective view of a prior art electric power assist rack system. The system typically comprises a steering column (S) and a rack (R). A steering wheel is connected to the steering column by which a driver input is received to steer a vehicle. The rack is also known in the art as a “rack and pinion” steering system.

Rack and pinions are commonly defined by the number of inches of travel of the rack per revolution of the pinion. The exact required rack ratio is dependent on the steering geometry. Steering ratios of 24:1 and 12:1 may have a rack ratio of 1.57:1 and 2.62:1 respectively. The ratio of a rack and pinion can be varied across the rack. This is accomplished through altering the profile of the teeth of the rack along the rack. This changes the contact radius with the pinion. Changing the contact radius changes the amount of rack travel per turn of the pinion. This ratio change is limited to a maximum of 15% across the rack.

FIG. 7 is a detail of FIG. 6. The prior art electric power assist steering system comprises a belt (B) driven by an electric motor (M). The belt is trained between two sprockets (S1) and (S2) and drives a worm gear rack (WG). As a driver turns the steering wheel a control module (not shown) receives a signal which then energizes the motor (M) accordingly in order to drive the belt. As the belt rotates, sprocket (S2) drives the worm gear rack axially in order to move the vehicle wheels to steer.

The power required to steer the front wheels of a vehicle is a maximum when the vehicle is not moving. A heavier vehicle requires more power to steer as well. The following is an example calculation of the power required to steer front wheels of a stopped vehicle.

It is necessary to describe a geometry terms as applied to steering systems. The minimum effective radius arm length (A) is the shortest effective distance from the turning center (B) to the tie rod (C). Usually this is taken when the wheels are fully turned. King pin offset (D) is the distance from the centerline of the wheel (E) to the turning center (B). Tire width (F) is the width of the patch of contact between the tire and the road surface.

For the purpose of illustrating the invention, the following information is given:

Vehicle weight on front axle	900 Kg	Gs
Tire width	200 mm	B
Friction; Tire to road	0.8	μ
Min effective radius arm for str.	0.1 m	r
King pin offset	100 mm	e

The torque M required to steer the wheels can be calculated using the following formula:

$$M = 0.05 * Gs * \frac{1}{\left(1 + \frac{e}{B}\right)} * \frac{B}{200} * \frac{\mu}{0.7}$$

$$M = 336 \text{ Nm}$$

If one assumes the wheel total angular displacement is degrees and it takes 2 seconds to turn the steering wheel from lock to lock, the power requirement can be calculated as follows:

Wheel angular displacement	85 deg
Time to turn lock to lock	2 sec

Then the angular speed of wheels during turning:

$$\omega = \frac{\text{angular displacement}(\text{rev})}{\text{time}(\text{sec.})} * 60 \left(\frac{\text{sec}}{\text{min}}\right)$$

$$\omega = \frac{\left(\frac{85}{360}\right)}{2} * 60$$

$$\omega = 7.08 \text{ rpm}$$

Power required without any system losses:

$$P = T * \omega * \left(\frac{2\pi}{60}\right)$$

$$P = 336 * 7.08 * \left(\frac{2\pi}{60}\right)$$

$$P = 249 \text{ watt}$$

If it is assumed the vehicle steering system has an efficiency of 70%, the system has an efficiency of 80%, and the worm gear has an efficiency of 80%, the power requirement is:

$$P = \frac{P}{e}$$

$$P = \frac{249}{(0.7 * 0.8 * 0.8)}$$

$$P = 556 \text{ watt}$$

On the other hand, the inventive system uses three belt stages. FIG. 4 is a graph of the efficiency of the transmission as a speed reducer. FIG. 5 is a graph if the efficiency of the transmission as a speed multiplier. Using this information as a surrogate for determining the efficiency of the proposed system, it is expected that the inventive system would have efficiencies consistently above 95%.

Operation, Electric Motor Assist Mode.

In operation a driver will turn a vehicle steering wheel which is connected to shaft 300. A typical vehicle system will include a control module to sense driver input and control the electric motor 201 to provide the desired assist through the transmission 1000. For example, the control module measures driver input torque and uses this to determine the amount of assist required from the electric motor 201. Assist can be tuned to meet the drivers need depending on driving conditions.

When assist is being demanded by the control module or ECU, the energized electric motor will apply torque to shaft 200, this in turn provides torque to sprocket 206. During operation input shaft 200 may rotate at up to 1800 RPM. This results in a rotational speed of the output shaft of approximately 60 RPM given a reduction through the transmission of 30.6:1, which represents a typical upper limit. Use of the helical belt 400 and helical sprockets 206, 306 significantly quiet the relatively high speed operation of the belts. Straight toothed belts, such as belt 500 and belt 600, can produce a noise or whine when operated and high speeds. The helical

tooth design allows for a more gradual meshing between the teeth of the belt and the sprocket grooves during operation.

The shaft speed is not a significant issue for belt **500** and belt **600** since these operate at the maximum speed of $1800/3.4=529$ RPM (belt **400**) and $529/3.0=176$ RPM (belt **500**) and $176/3.0=58$ RPM (belt **600**).

Toothed belt **400** transmits the force from sprocket **206** to sprocket **306**, which in turn applies a torque to sprocket **309**. Sprocket **309** drives sprocket **203** through belt **500**. Sprocket **204** drives sprocket **303** through belt **600**.

Hence, the torque flow during assist mode is from the electric motor **201** to shaft **200** to sprocket **206** to belt **400** to sprocket **306** to sprocket **309** to belt **500** to sprocket **203** to sprocket **204** to belt **600** to sprocket **303** to shaft **300**.

Operation, No Assist Mode.

When no electric assist is required by the control module, a driver input will apply a torque to shaft **300**. Even though shaft **300** rotates, since electric motor **201** is de-energized it will rotate freely and the system will operate as though no electric motor is present.

FIG. **2** is a perspective view of the inventive transmission. Electric motor **201** is mounted to housing **100**. Housing **100** encases the sprockets and belts to protect them from debris.

FIG. **3** is an exploded view of the inventive transmission. The inventive system is relatively compact. The three belt stages are contained in a single housing **100**. The housing is sufficiently compact to allow installation in a vehicle steering system. Depending upon torque requirements, the width of each belt may be increased or decreased as well.

The inventive system is completely scalable. Based on calculations of small car system steering efforts, the worm drive systems provide approximately 80% of the torque needed to steer a stopped vehicle. Existing worm systems provide approximately 30 Nm of assist. The inventive system is designed to provide assist for heavy pick-up truck type vehicles requiring 70 Nm of assist. In order to provide the same level of torque assist as the existing worm drive systems, the belt widths could be narrowed to optimize their design width and the motor torque requirement could be reduced to account for the additional mechanical advantage of the 30.6:1 ratio for the inventive transmission. It is expected the inventive transmission could provide up to approximately 150 Nm of assist.

The belts can also be made wider to provide greater assist for applications such as heavy trucks and buses. It is estimated that a large pickup truck requires approximately 90 Nm to turn the wheels on a stopped vehicle which translates to approximately 70 Nm of assist required.

FIG. **15** is a detail of the belt arrangement. A toothed belt **400** is trained between the first pair of sprockets, namely, sprocket **206** and sprocket **306**. A toothed belt **500** is trained between the second pair of sprockets, namely, sprocket **203** and sprocket **309**. A toothed belt **600** is trained between the third pair of sprockets, namely, sprocket **204** and sprocket **303**.

FIG. **16** is a perspective view of the inventive transmission in a steering system. A steering column (S) is connected to one end of shaft **300**. The other end of shaft **300** is connected to an input portion of a steering rack (R). Steering rack (R) is known in the art and is typically included in a system known as a "rack and pinion" steering system. Steering column (S) is typically connected to a steering wheel by which a driver steers the vehicle.

Although a form of the invention has been described herein, it will be obvious to those skilled in the art that

variations may be made in the construction and relation of parts without departing from the spirit and scope of the invention described herein.

We claim:

1. A vehicle steering system transmission comprising:
 - a housing;
 - an input shaft journaled to the housing;
 - an electric motor connected to the housing and coupled to the input shaft;
 - an output shaft journaled to the housing;
 - the input shaft and the output shaft coupled by a first pair of sprockets having a first belt trained therebetween and having a first ratio, the first belt and first pair of sprockets comprising a helical tooth configuration;
 - the input shaft and the output shaft coupled by a second pair of sprockets having a second belt trained therebetween and having a second ratio; and
 - the input shaft and the output shaft coupled by a third pair of sprockets having a third belt trained therebetween and having a third ratio.
2. The vehicle steering system transmission as in claim 1, wherein the second belt and the third belt are toothed.
3. The vehicle steering system transmission as in claim 1, wherein the first ratio is 3.4:1.
4. The vehicle steering system transmission as in claim 3, wherein the second ratio is 3:1.
5. The vehicle steering system transmission as in claim 3, wherein the third ratio is 3:1.
6. The vehicle steering system transmission as in claim 1, wherein the electric motor comprises a 12 V DC motor.
7. A vehicle steering system transmission comprising:
 - a housing;
 - an input shaft journaled to the housing;
 - a steering column coupled to an output shaft;
 - the output shaft coupled to a steering rack;
 - an electric motor connected to the housing and coupled to the input shaft;
 - the output shaft journaled to the housing;
 - the input shaft and the output shaft coupled by a first pair of sprockets having a first belt trained therebetween and having a first ratio;
 - the input shaft and the output shaft coupled by a second pair of sprockets having a second belt trained therebetween and having a second ratio; and
 - the input shaft and the output shaft coupled by a third pair of sprockets having a third belt trained therebetween and having a third ratio.
8. The vehicle steering system transmission as in claim 7, wherein the first belt and first pair of sprockets comprise a helical tooth configuration.
9. The vehicle steering system transmission as in claim 7, wherein the second belt and the third belt are toothed.
10. The vehicle steering system transmission as in claim 7, wherein the first ratio is 3.4:1.
11. The vehicle steering system transmission as in claim 10, wherein the second ratio is 3:1.
12. The vehicle steering system transmission as in claim 10, wherein the third ratio is 3:1.
13. A vehicle steering system transmission comprising:
 - a housing;
 - an input shaft journaled to the housing;
 - an electric motor connected to the housing and coupled to the input shaft;
 - an output shaft journaled to the housing;

11

the input shaft and the output shaft coupled by a first pair of sprockets having a first belt trained therebetween and having a ratio of 3.4:1, the first belt and first pair of sprockets comprising a helical tooth configuration;
the input shaft and the output shaft coupled by a second pair of sprockets having a second belt trained therebetween and having a ratio of 3:1; and

12

the input shaft and the output shaft coupled by a third pair of sprockets having a third belt trained therebetween and having a ratio of 3:1.

14. The vehicle steering system transmission as in claim **13**, wherein the electric motor comprises a 12 V DC motor.

* * * * *