

US008258886B2

(12) **United States Patent**
Gilbert

(10) **Patent No.:** **US 8,258,886 B2**
(45) **Date of Patent:** **Sep. 4, 2012**

(54) **SYSTEM AND METHOD FOR IMPROVED START-UP OF SELF-OSCILLATING ELECTRO-MECHANICAL SURGICAL DEVICES**

(75) Inventor: **James A. Gilbert**, Boulder, CO (US)

(73) Assignee: **TYCO Healthcare Group LP**, Mansfield, MA (US)

(*) Notice: Subject to any disclaimer, the term of this patent is extended or adjusted under 35 U.S.C. 154(b) by 175 days.

(21) Appl. No.: **12/750,419**

(22) Filed: **Mar. 30, 2010**

(65) **Prior Publication Data**

US 2011/0241786 A1 Oct. 6, 2011

(51) **Int. Cl.**

H03B 5/30 (2006.01)

A61B 8/00 (2006.01)

A61B 17/32 (2006.01)

(52) **U.S. Cl.** **331/154; 331/173; 331/185; 310/318; 600/437; 606/169**

(58) **Field of Classification Search** 331/116 FE, 331/116 M, 116 R, 154, 158, 160, 172, 173, 331/185; 310/318; 327/143; 600/437; 606/169
See application file for complete search history.

(56) **References Cited**

U.S. PATENT DOCUMENTS

3,469,211 A	9/1969	Shoh et al.	
4,277,710 A	7/1981	Harwood et al.	
4,587,958 A	5/1986	Noguchi et al.	
4,827,911 A	5/1989	Broadwin et al.	
4,896,122 A *	1/1990	Tahernia et al.	331/158
4,922,902 A	5/1990	Wuchinich et al.	
4,965,532 A	10/1990	Sakurai	

4,973,876 A	11/1990	Roberts	
5,041,802 A *	8/1991	Wei et al.	331/116 FE
5,180,363 A	1/1993	Idemoto et al.	
5,208,558 A *	5/1993	Shigehara et al.	331/116 FE
5,216,338 A	6/1993	Wilson	
5,421,829 A	6/1995	Olichney et al.	
5,532,539 A	7/1996	Heilscher	
5,534,826 A *	7/1996	Logan	331/158
5,637,947 A	6/1997	Kising et al.	
5,700,952 A	12/1997	Andersen	
5,816,476 A	10/1998	Buice et al.	
5,834,982 A *	11/1998	Watanabe et al.	331/109
5,982,246 A *	11/1999	Hofhine et al.	331/116 FE
6,163,100 A	12/2000	Morizaki et al.	
6,191,662 B1 *	2/2001	Volk	331/158
6,320,298 B1	11/2001	Kawabe	

(Continued)

FOREIGN PATENT DOCUMENTS

AU 200179486 5/2002

(Continued)

Primary Examiner — Levi Gannon

(57) **ABSTRACT**

An oscillating circuit for determining a resonant frequency of an electro-mechanical oscillating device and for driving the electro-mechanical oscillating device at the determined resonant frequency includes a driving circuit and a start-up, impetus injection circuit. The driving circuit is configured to receive one or more reference signals and further configured to provide a driving signal related to the reference signals to the electro-mechanical oscillating device. The start-up, impetus injection circuit is operably coupled to the electro-mechanical oscillating device and configured to selectively provide a start-up excitation signal to the electro-mechanical oscillation device. The start-up, impetus injection circuit is activated upon start-up of the oscillating circuit to drive the electro-mechanical oscillation device and the driving circuit determines a resonant frequency by measuring a parameter related to the resonant frequency of the electro-mechanical oscillating device.

21 Claims, 6 Drawing Sheets

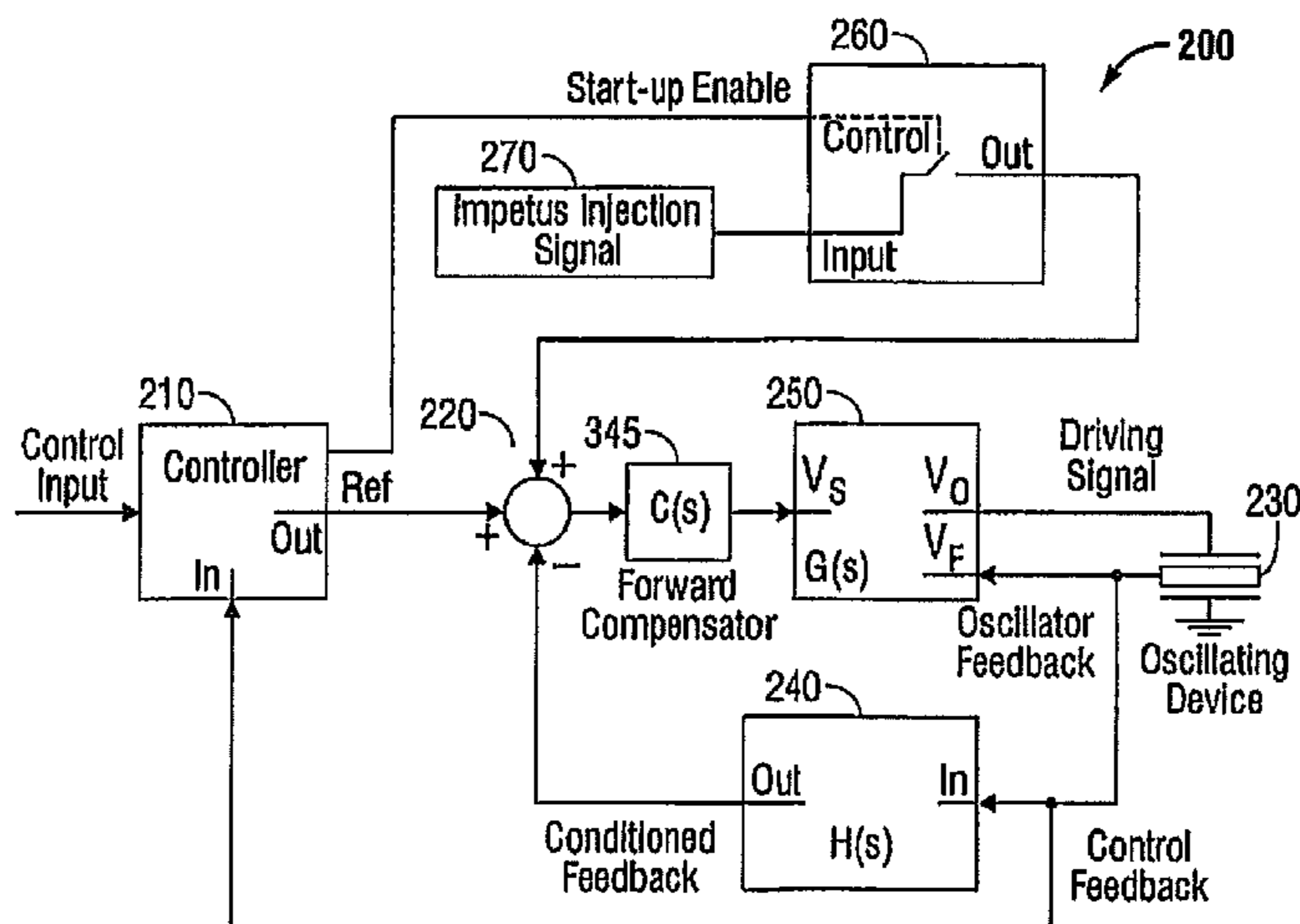

US 8,258,886 B2

Page 2

U.S. PATENT DOCUMENTS

6,480,796 B2 11/2002 Wiener
6,569,109 B2 5/2003 Sakurai et al.
6,588,277 B2 7/2003 Giordano et al.
6,626,926 B2 9/2003 Friedman et al.
6,678,621 B2 1/2004 Wiener et al.
6,679,899 B2 1/2004 Wiener et al.
6,761,690 B2 7/2004 Sakurai et al.
6,819,195 B1* 11/2004 Blanchard et al. 331/173
6,898,536 B2 5/2005 Wiener et al.
6,984,919 B2 1/2006 Iino et al.
7,123,113 B1* 10/2006 Brennan et al. 331/158
7,179,271 B2 2/2007 Friedman et al.
7,270,646 B2 9/2007 Sakurai et al.
7,273,483 B2 9/2007 Wiener et al.
7,292,114 B2* 11/2007 Greenberg 331/158
7,332,979 B2* 2/2008 Connell et al. 331/183

7,475,801 B2 1/2009 Johansen et al.
7,482,888 B1* 1/2009 Kleveland 331/173
7,513,160 B2 4/2009 Lynch et al.
7,514,844 B2 4/2009 Unkrich
7,528,670 B2 5/2009 Soh
7,614,878 B2 11/2009 Paschke et al.
7,859,353 B2* 12/2010 Liu et al. 331/160
2005/0027311 A1 2/2005 Wiener et al.
2005/0070800 A1 3/2005 Takahashi
2009/0118751 A1 5/2009 Wiener et al.

FOREIGN PATENT DOCUMENTS

CA 2359403 4/2002
EP 1199046 4/2002
EP 1201196 3/2006
JP 2000237204 9/2000

* cited by examiner

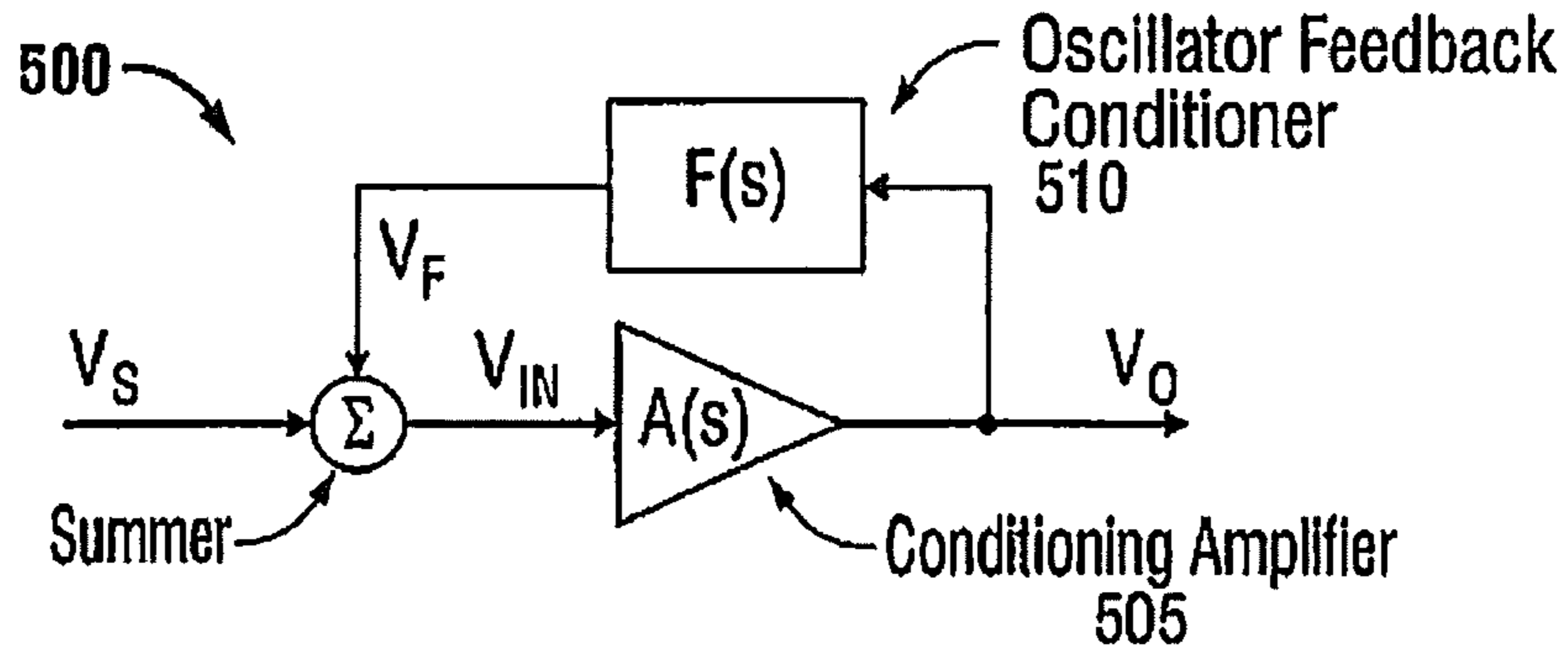

FIG. 1A (PRIOR ART)

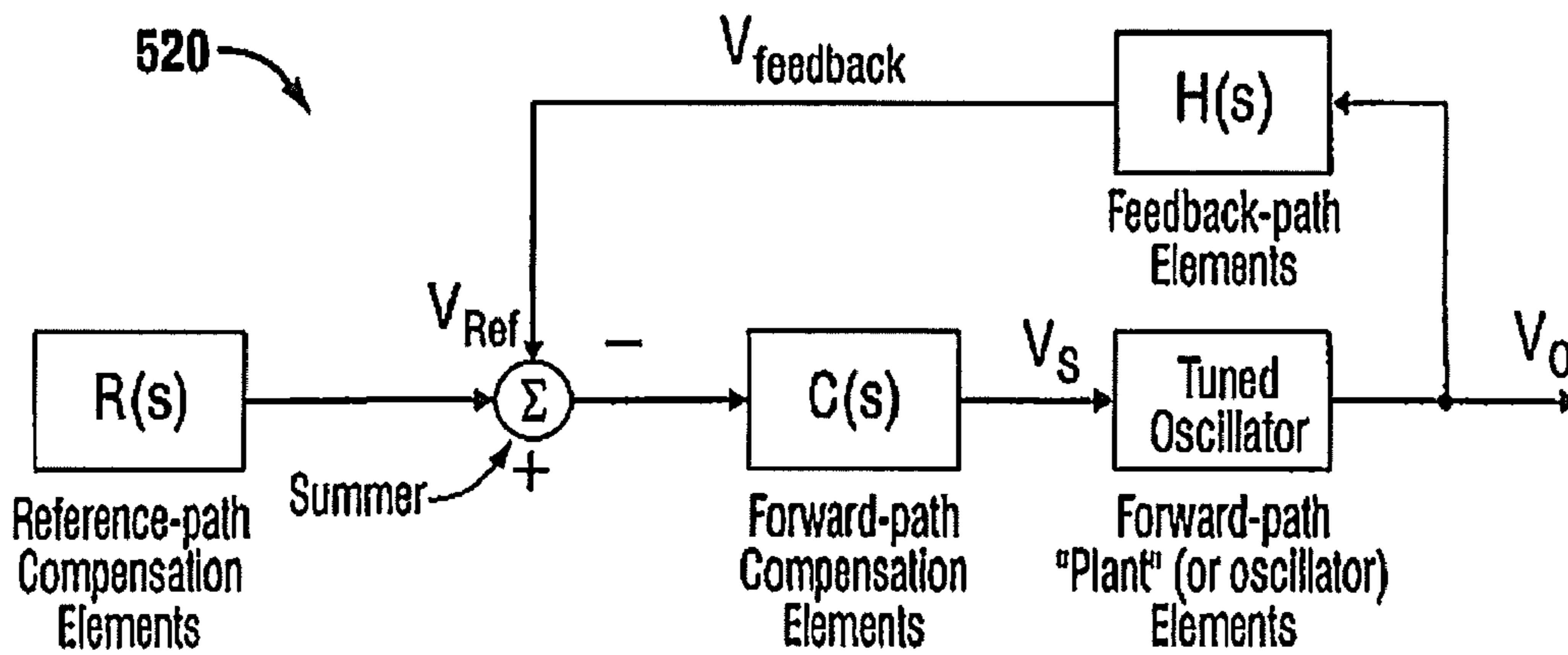

FIG. 1B (PRIOR ART)

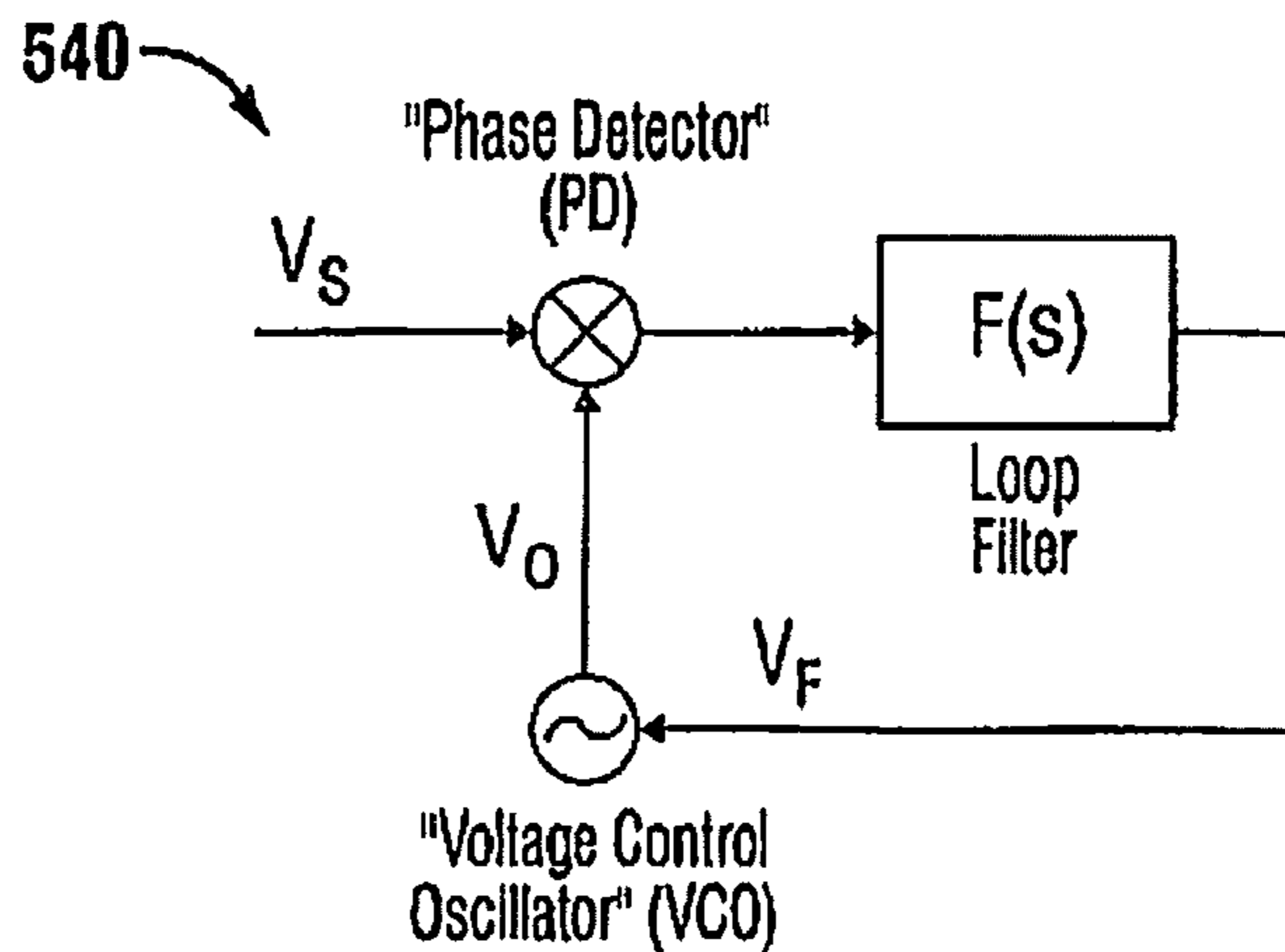

FIG. 1C
(PRIOR ART)

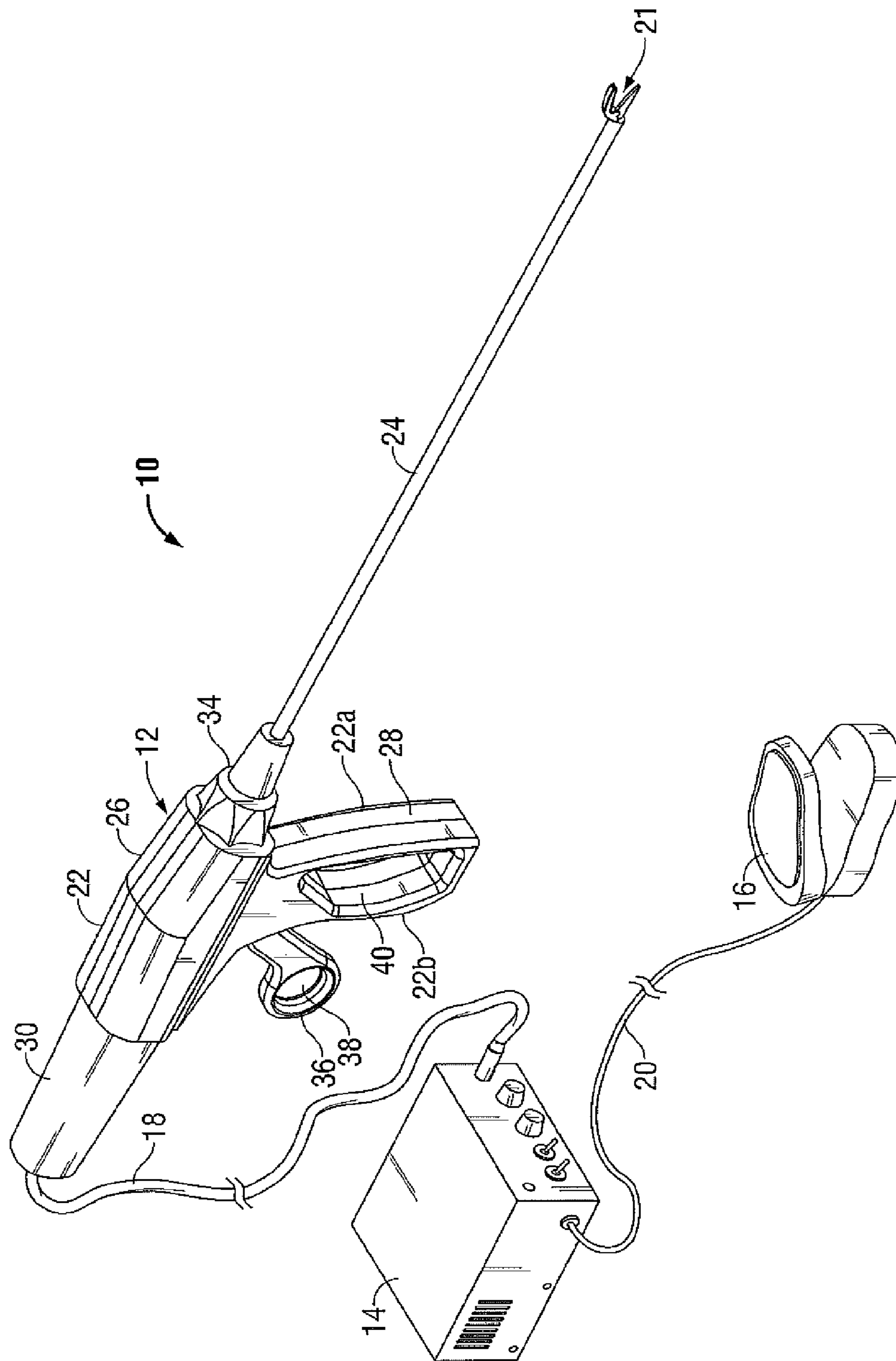

FIG. 2

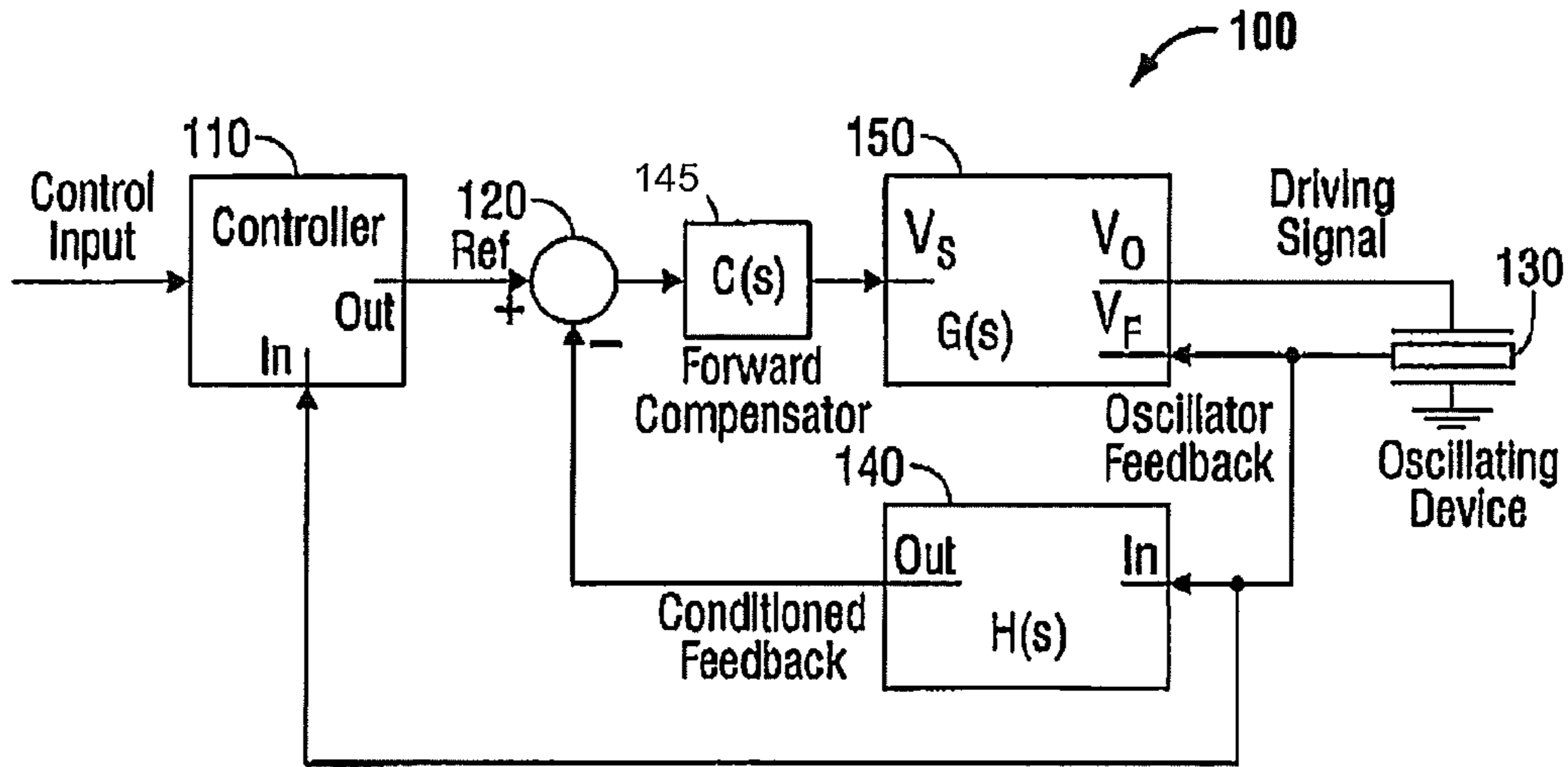

FIG. 3

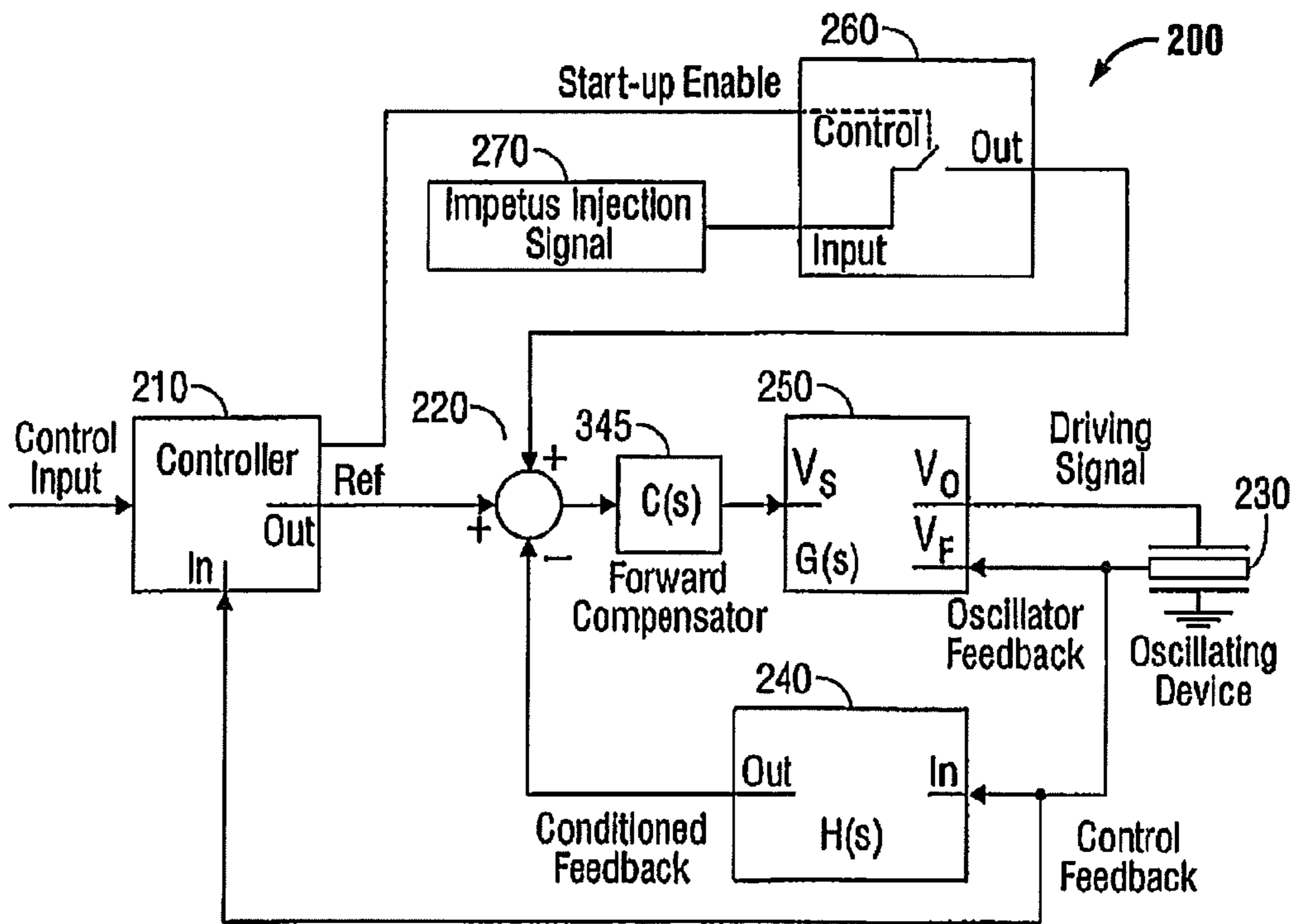

FIG. 4

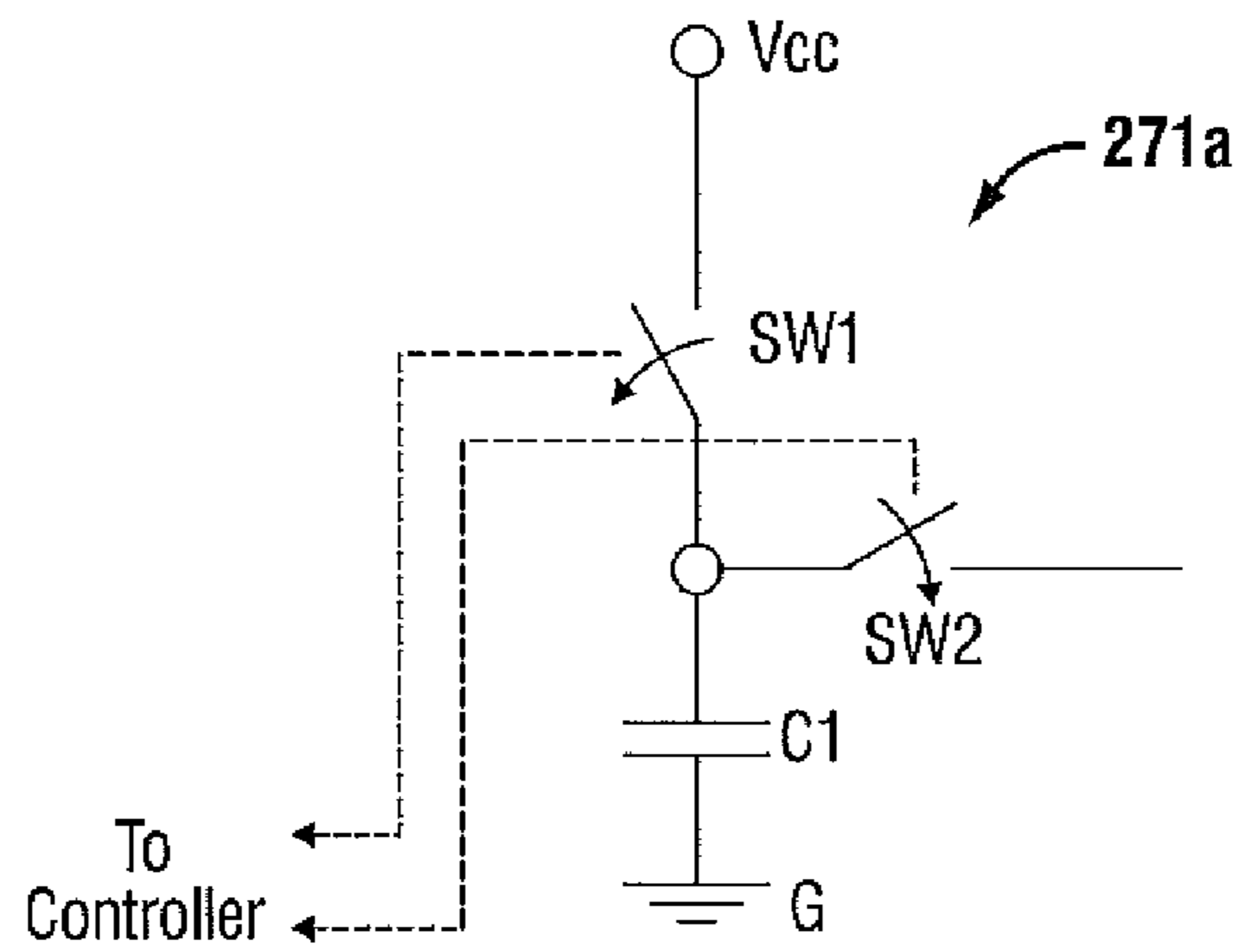

FIG. 5

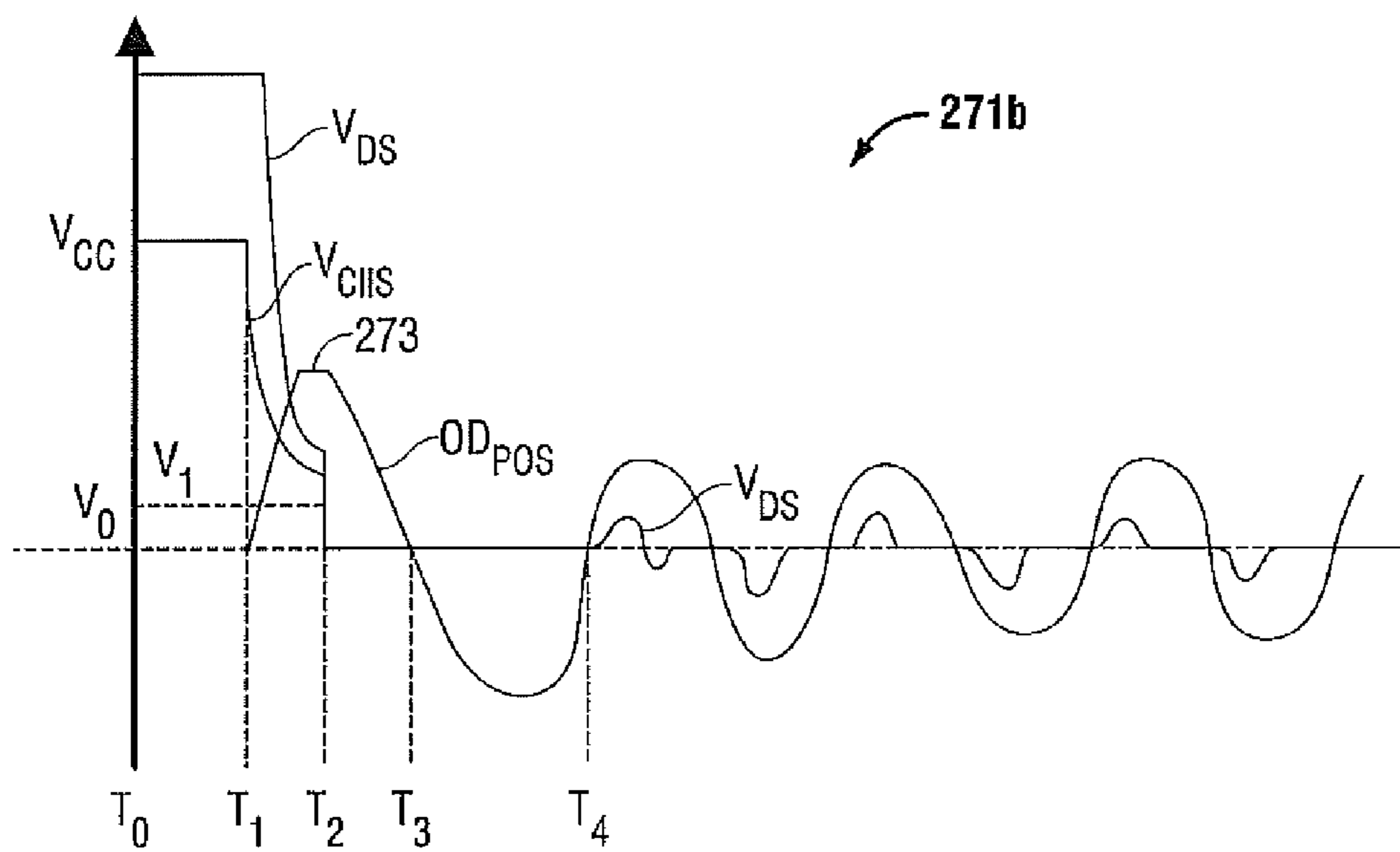

FIG. 6

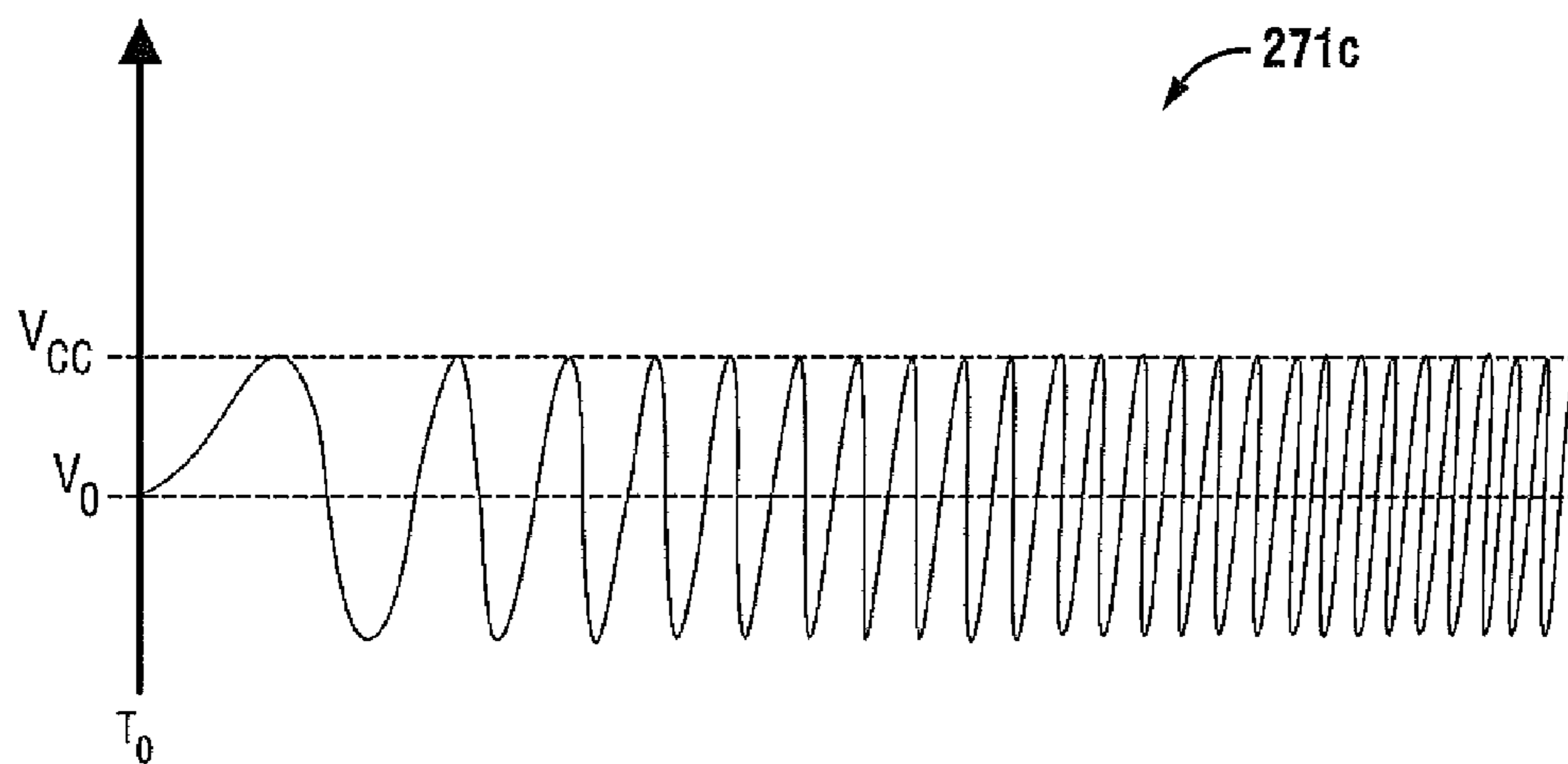

FIG. 7

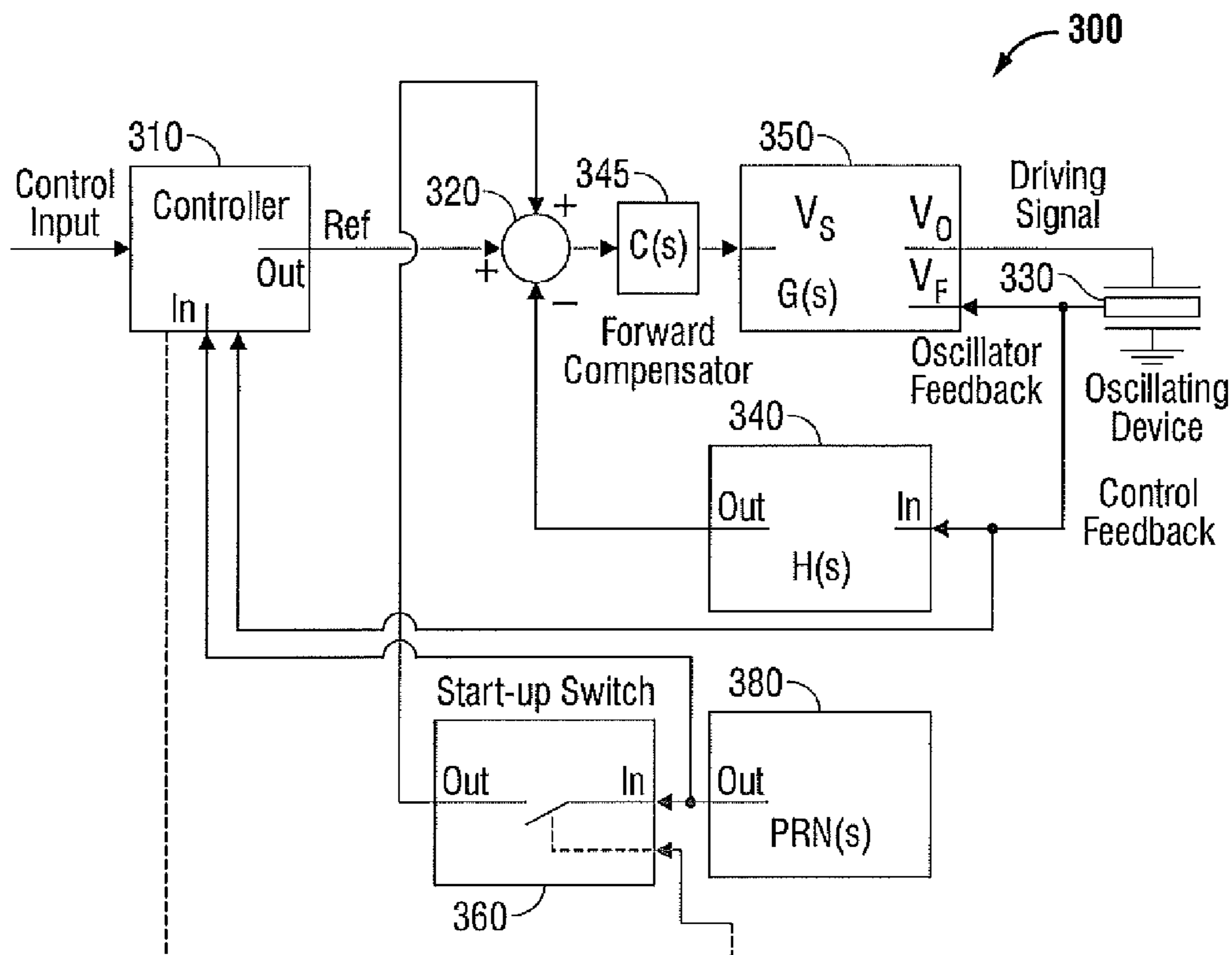

FIG. 8

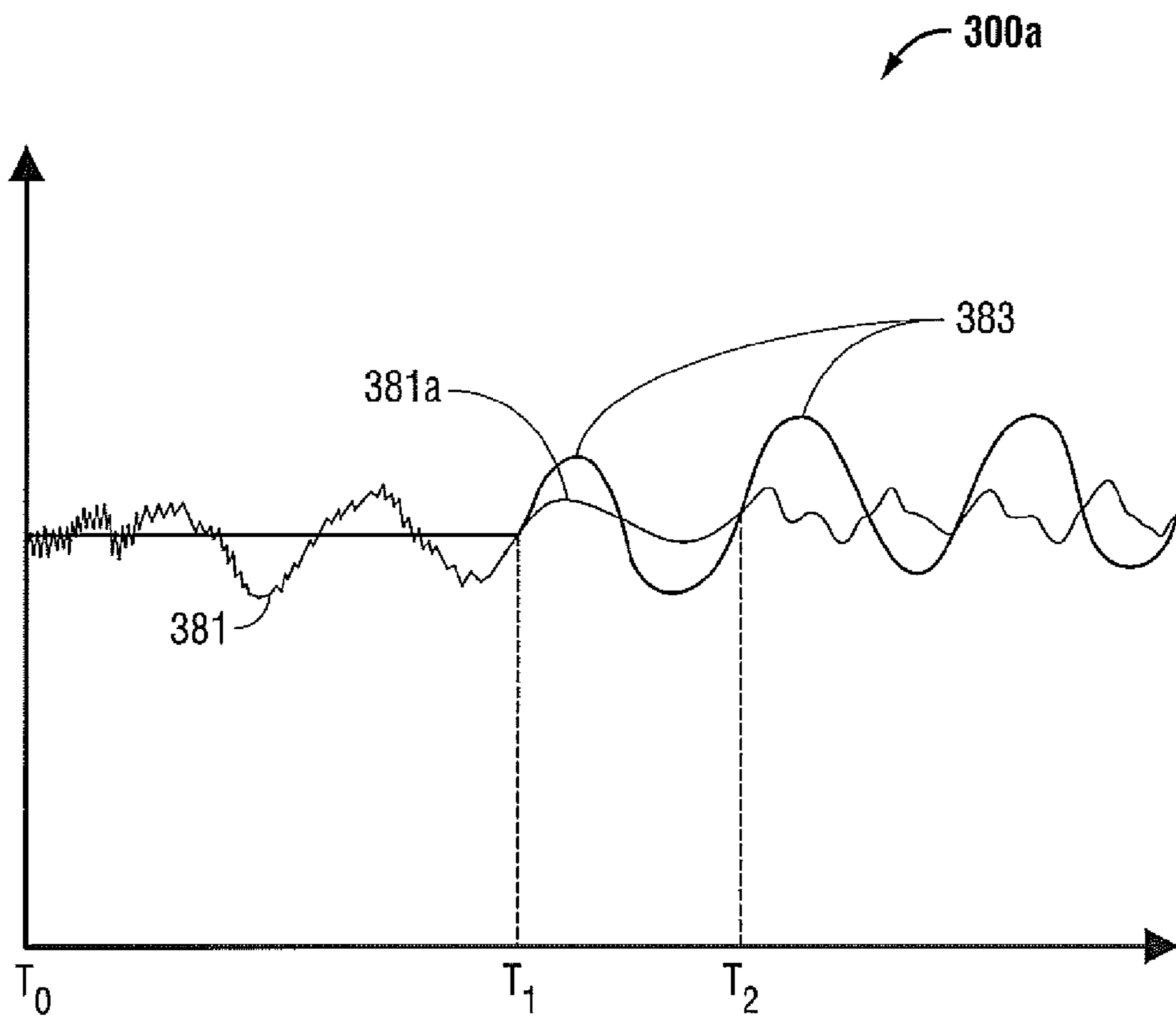

FIG. 9

1

**SYSTEM AND METHOD FOR IMPROVED
START-UP OF SELF-OSCILLATING
ELECTRO-MECHANICAL SURGICAL
DEVICES**

BACKGROUND

1. Technical Field

The invention relates generally to electronic oscillator circuits, and more specifically, circuits and methods for decreasing the start-up time of an oscillating circuit used to drive an electro-mechanical ultrasonic medical device.

2. Background of Related Art

The benefits associated with the use of ultrasonic energy powered devices, and in particular ultrasonic instruments for surgical use, are well known. For example, the use of an ultrasonic generator in conjunction with a surgical scalpel facilitates faster and easier cutting of organic tissue while accelerating coagulation. Improved cutting results from increased body tissue to scalpel contact caused by the high frequency of vibration of the scalpel blade with respect to body tissue. Improved coagulation results from heat generated by contact between the scalpel blade and the body tissue as the scalpel blade is vibrated at a high frequency.

Conventional ultrasonic instruments include a variety of probes (e.g., cutting blades, shears, hook, ball, etc.) adapted for specific medical procedures. The ultrasonic probe is disposed at a distal end, the end furthest away from the surgeon, of the ultrasonic instrument. These ultrasonic instruments are primarily used in a variety of medical procedures including open surgical procedures, luminal procedures and endoscopic procedures.

Ultrasonic instruments are typically intermittently energized by a clinician to create the desired surgical effect (e.g., cutting, bonding, coagulation, etc.). Ideally, the ultrasonic instrument provides an instantaneous response or zero delay time between the time when the clinician energizes the instrument and the time when the surgical effect is delivered. Unfortunately, unlike electro-surgical instruments such as an RF or microwave powered instrument, an ultrasonic instrument is an electro-mechanical system that requires a start-up period during which the mechanical portion of the end effector begins to resonate at the proper oscillation frequency.

The present disclosure provides alternative methods of initiating the start-up of an oscillation circuit. Alternative methods of providing impetus injection for initiating a start-up are also disclosed that may be employed independent of the oscillation feedback type (e.g., positive or negative feedback oscillators, adaptive or fixed frequency oscillators, or self-oscillating PLL based systems).

SUMMARY

The present disclosure relates to an oscillating circuit that determines a resonant frequency of an electro-mechanical oscillating device and drives the electro-mechanical oscillating device at the determined resonant frequency. The oscillating circuit includes a driving circuit and a start-up, impulse injection circuit. The driving circuit is configured to receive one or more reference signals and further configured to provide a driving signal related to the reference signals to the electro-mechanical oscillating device. The start-up, impulse injection circuit is operably coupled to the electro-mechanical oscillating device and configured to selectively provide a start-up excitation signal to the electro-mechanical oscillating device. The start-up, impulse injection circuit is activated upon start-up of the oscillating circuit to drive the electro-

2

mechanical oscillation device and the driving circuit determines a resonant frequency by measuring a parameter related to the resonant frequency of the electro-mechanical oscillating device.

5 In one embodiment, the driving circuit may determine a resonant frequency of the electro-mechanical oscillating device within one-half cycle of the resonant frequency and in another embodiment the driving circuit may determine a resonant frequency of the electro-mechanical oscillating device within three cycles of the resonant frequency.

The parameter related to the resonant frequency may also be related to the motion of the electro-mechanical oscillating device. The parameters may be selected from a group consisting of current, voltage and mechanical position.

15 In a further embodiment, the oscillating circuit includes an excitation signal generating circuit and a start-up switch configured to selectively couple the excitation signal generating circuit to the electro-mechanical oscillating device. The excitation signal generating circuit includes a DC voltage source and an energy storage device. The excitation signal generating circuit may be operatively coupled to the DC voltage source in a first condition and operatively coupled to the start-up switch in a second condition. In the first condition, the DC voltage source charges the energy storage device, and, in the second condition, the energy storage device drives the electro-mechanical oscillating device to a position related to a point of maximum amplitude. The energy storage device may include a capacitor.

25 In another embodiment, the excitation signal generating circuit includes a digital-to-analog signal converter operatively coupled to the start-up switch and configured to generate a time-frequency varying driving signal. The electro-mechanical oscillating device is driven by the time-frequency varying driving signal generated by the digital-to-analog signal converter. The frequency of the time-frequency varying driving signal may vary linearly or exponentially with respect to time.

30 In another embodiment the excitation signal generating circuit includes a narrowband, pseudo-random noise amplifier circuit configured to generate the excitation signal by a known "pseudo-random" noise sequence signal within a resonant bandwidth or amplifying the noise signal of an external thermal and/or Schottky source band-limited to the resonant bandwidth of the electro-mechanical device. The narrowband, random noise circuit may include a bandpass filter and the bandpass filter may include an analog circuit. The pseudo-random noise sequence may be used by the controller to further identify the characteristics of the electro-mechanical device at resonance using correlative techniques.

35 A method for starting an electro-mechanical oscillating device having a varying resonant frequency is also disclosed and includes the steps of: generating a start-up excitation signal; applying the start-up excitation signal to an electro-mechanical oscillating device; driving the electro-mechanical oscillating device to a position related to a point of maximum amplitude; removing the excitation signal from the electro-mechanical oscillating device when the electro-mechanical oscillating device is at a position related to the point of maximum amplitude; measuring one or more parameters related to a resonant frequency of the electro-mechanical oscillating device; determining a resonant frequency of the electro-mechanical oscillating device, and driving the electro-mechanical oscillating device at the determined resonant frequency. The parameters may be selected from a current, a voltage and mechanical position.

40 Another method for starting an electro-mechanical oscillating device having a varying resonant frequency is also

disclosed and includes the steps of: generating a time-frequency varying start-up excitation signal; applying the time-frequency varying start-up excitation signal to an electro-mechanical oscillating device; measuring one or more parameters related to a resonant frequency of the electro-mechanical oscillating device while driving the electro-mechanical oscillating device with the time-frequency varying excitation signal; determining the resonant frequency of the electro-mechanical oscillating device; and driving the electro-mechanical oscillating device at the determined resonant frequency. The parameter may be selected from a current, a voltage and mechanical position.

In yet another method for starting an electro-mechanical oscillating device having a varying resonant frequency includes the steps of: generating a noise signal by analog or digital means; amplifying or otherwise limiting a portion of the generated noise signal within a resonant bandwidth; driving the electro-mechanical oscillating device with the start-up excitation signal; measuring one or more parameters related to a resonant frequency of the electro-mechanical oscillating device; determining the resonant frequency of the electro-mechanical oscillating device; and driving the electro-mechanical oscillating device at the determined resonant frequency. The parameters may be selected from a current, a voltage and mechanical position.

BRIEF DESCRIPTION OF THE DRAWINGS

FIG. 1A is a generalized block diagram of a basic oscillator system;

FIG. 1B is a generalized block diagram of the oscillator system in FIG. 1A included within a feedback control loop;

FIG. 1C is generalized block diagram of a basic oscillator system including a Phase-locked loop (PLL);

FIG. 2 is a perspective view of an ultrasonic dissection and coagulation system for use with an ultrasonic instrument;

FIG. 3 is a control block diagram of an oscillation circuit for use with the present disclosure;

FIG. 4 is the control block diagram of the oscillating circuit of FIG. 3 including a start-up, impulse injection control block according to an embodiment of the present disclosure;

FIG. 5 is a circuit diagram for a capacitive, impulse injection circuit according to another embodiment of the present disclosure;

FIG. 6 is a signal diagram of a start-up of an oscillation circuit implementing the capacitive impulse injection circuit of FIG. 4;

FIG. 7 is a graphical illustration of a chirp, impulse-injection signal according to another embodiment of the present disclosure;

FIG. 8 is a control block diagram of the oscillating circuit of FIG. 3 including a start-up, narrowband, pseudo-random noise injection block according to an embodiment of the present disclosure, and

FIG. 9 is a signal diagram of a start-up implementing the start-up, narrowband, pseudo-random noise injection block of FIG. 8.

DETAILED DESCRIPTION

Embodiments of the present disclosure are described hereinbelow with reference to the accompanying drawings; however, it is to be understood that the disclosed embodiments are merely exemplary of the disclosure, which may be embodied in various forms. Well-known functions or constructions are not described in detail to avoid obscuring the present disclosure in unnecessary detail. Therefore, specific structural and

functional details disclosed herein are not to be interpreted as limiting, but merely as a basis for the claims and as a representative basis for teaching one skilled in the art to variously employ the present disclosure in virtually any appropriately detailed structure.

Oscillator Systems

Tuned oscillator systems are described in “Bipolar and MOS analog Integrated Circuit Design, by Alan Grebene (2003) herein incorporated by reference. A tuned oscillator system is normally made up of two basic circuit sections: (1) an amplifier which provides the necessary signal gain; and (2) a feedback network which feeds a part of the amplifier output back to the input. FIG. 1A shows a generalized block diagram 500 of such an oscillator system wherein V_s is the input signal voltage, V_f is the feedback voltage signal generated by feedback network, V_{in} is the sum of V_s and V_f and V_o is equal to V_{in} amplified by the conditioning amplifier 505. For the circuit to oscillate, the conditioning amplifier 505 must provide sufficient gain and the oscillator feedback conditioner 510 must shift the phase of the output signal a sufficient amount such that V_f is in phase with the input signal, V_{in} . The total gain around the feedback loop is:

$$V_f/V_{in} = A(j\omega) * F(j\omega)$$

Two Barkhausen Criteria for a circuit to sustain oscillations independent of the input signal voltage are: (a) the signal gain around the loop is a magnitude such that:

$$|V_f/V_{in}| = |A(j\omega)| * |F(j\omega)| \geq 1.0;$$

And, (b) the phase of the signal, ϕ , around the loop is

$$\text{Arg}(V_f/V_{in}) = \phi_A + \phi_F = 0 \text{ or } 360^\circ$$

The amplitude at V_o in this simplified representation may be further regulated by including it within a feedback control loop (either by means of a classic PID compensator or a modern Linear Quadratic Regulator (LQR)), as illustrated in FIG. 1B and shown as 520. (See also, *Linear Control System Analysis and Design*, by John D’Azzo et al., (1995), and *Applied Optimal Control and Estimation: Digital Design and Implementation*, by Frank L. Lewis, (1992), both of which are herein incorporated by reference.)

The “tuned oscillators” 525, represented by $G(s)$ in FIG. 1B, may include negative feedback oscillators, positive feedback oscillators, relaxation oscillators, phase-locked loops (PLL) or any other suitable oscillator.

Negative feedback oscillators include a feedback element arranged to introduce about 180° of phase shift at the desired frequency of oscillation, while the amplifier inverts the signal and introduces a sufficient loop gain ≥ 1 . This type of oscillator includes, but is not limited to, the common named “Colpitts”, “Hartley”, Phase-shift”, and “Twin-Tee/Notch” oscillators.

Positive feedback oscillators have the feedback elements arranged for minimal phase shift at the desired frequency of oscillation, while the amplifier is non-inverting and introduces sufficient loop gain ≥ 1 . This type of oscillator includes, but is not limited to, the common named “Wien-Bridge” and LC-Tuned” oscillators.

Relaxation oscillators (or “multi-vibrators”) alternatively charge and discharge a timing capacitor at controlled rates to produce periodic output waveforms. This type of oscillator is typically not used for electro-mechanical medical devices, except as input signal generators for V_s .

Phase-locked loops (PLL) are not strictly oscillators, but may be used within a control structure, such as the control system 520 illustrated in FIG. 1B, to operate an electro-mechanical medical device. The block diagram for a PLL

540, as illustrated in FIG. 1C, may be immediately recognized as similar in structure and operation as the oscillator system **500** of FIG. 1A. PLL systems and circuits are taught in *Phase Lock Techniques*, by Floyd Gardner (1979), herein incorporated by reference.

Self-Oscillating Systems

Unlike the “tuned oscillators” described hereinabove, a “self-oscillating” electro-mechanical system (EM system) is one in which the resonance of the electro-mechanical medical device is used within the oscillator feedback loop to provide the band passed oscillation frequency.

The resonant frequency of an electro-mechanical medical device can vary widely depending on temperature and electro-mechanical loading (such as additional mass and/or compliance at the distal end of the system). In addition, each individual electro-mechanical medical device may have its own resonant frequencies that are based on certain parameters such as the materials used, construction and geometry. As such, “driven” or fixed-frequency generators that employ a very narrowband Phase Lock Loop circuit (PLL circuit) or an oscillation circuit that utilizes an oscillating crystal to simply set the resonant frequency are not suitable for dynamically generating the sufficient range of frequencies required for an electro-mechanical medical device.

The electro-mechanical medical device couples to the oscillating circuit to provide energy at the desired resonant frequency to maintain oscillation. The electro-mechanical medical device also couples to the feedback circuitry of the oscillating circuit to provide feedback related to the physical position and/or oscillations of the electro-mechanical medical device. Before the oscillation circuit begins, the electro-mechanical medical device is motionless resulting in no feedback to the oscillating circuit. Therefore, the resonator and accompanying feedback circuit must receive energy from an external source in order for oscillation to commence.

It is generally known that an oscillator start-up requires energy from an external source to overcome mechanical inertia that, to the control loop, exemplifies dead band behavior. The energy from an external source may be applied to a crystal in a nonzero energy state from which the oscillator state evolves. The most efficient stimulus has a frequency equal to the resonant frequency as energy at other frequencies will be rejected by the oscillator. The use of a fixed-frequency oscillator external source for the generation of start-up energy works well for systems with a fixed or known resonant frequency, but this method is ineffective for oscillators with a varying resonant frequency, such as electro-mechanical medical devices.

One solution for this problem is to configure the oscillating circuit so that the circuit is sensitive to thermal and Schottky noise during start-up. Thermal and Schottky noise are low energy white noise and are always present in amplifying circuits. The thermal noise, often referred to as “Johnson noise”, due to the thermal agitation of electrons in a conductor is random and uniformly covers all frequencies. The shot noise, often referred to as “Schottky noise” due to random fluctuations in the motion of charge carriers in a conductor, is also random and uniformly covers all frequencies. The oscillation circuit would receive energy across a wide bandwidth as well as at its resonant frequency without the circuit designer having to determine and target the resonant frequency. Oscillation circuits that apply this method involve placing the circuit into two different states. During start-up, the circuit is placed in a first state that amplifies and allows a large amount of noise in the circuit. This high level of noise

overcomes the mechanical inertia and decreases the start-up time. After start-up, the circuit transfers into a low noise state for proper operation.

Related support circuits are utilized to determine when oscillation begins so that the primary oscillating circuit can be switched into an operational state at the soonest possible time. These support circuits act to minimize the start-up time, however, power is wasted since white noise has just as much spectral power at the target frequency as it does at other frequencies. The resulting low power of the random wideband noise also limits energy delivery to the oscillating circuit at its resonance, which also increases the required start-up time.

This method for starting self-oscillating electro-mechanical surgical systems is commonly referred to as “kick gain” start-up method. A simple non-surgical system developed by Soh in U.S. patent application Ser. No. 12/098,654 (Soh), and hereby incorporated by reference, utilizes a MOSFET as a gain resistor to increase the loop gain of the common Weinbridge positive feedback oscillator during the start-up period. While the circuit in Soh delivers some useful energy to the oscillator, much of the energy in the wideband random noise is wasted and the electro-mechanical amplitude is relatively uncontrolled during the start-up period.

Another known method attempts to inject an “impetus” signal into the oscillator through a coupling capacitor—a so-called “Single Frequency Impetus Injection” (SFII) start-up method. U.S. patent application Ser. No. 11/827,947 to Kleveland, and hereby incorporated by reference, discloses an impetus signal injected into the oscillator with a frequency that is an estimate of the resonant frequency of the oscillator and the frequency of the tunable oscillator. The SFII start-up method is well suited for applications where the resonant frequency remains constant or unchanged or the resonant frequency is easily predicted. The SFII start-up method, while effective for electronic systems, is not well suited for applications where the resonant frequency can vary widely, such as, for example, temperature sensitive systems or electro-mechanical systems under load.

FIG. 2 illustrates an ultrasonic dissection and coagulation system shown generally as system **10**. System **10** includes an ultrasonic instrument **12**, an ultrasonic generator module **14**, and a remote actuator **16**. Ultrasonic generator module **14** is operatively connected to ultrasonic instrument **12** by an electrically conductive cable **18** and functions to control the power and frequency of current supplied to ultrasonic instrument **12**. Any suitable controller capable of delivering power to ultrasonic instrument **12** can be used. Remote actuator **16**, e.g., pedal actuator, is operatively connected to ultrasonic generator module **14** by remote actuator cable **20** and can be actuated to initiate the supply of power to ultrasonic instrument **12** via ultrasonic generator module **14** to effect vibratory motion of ultrasonic instrument **12** to cut and coagulate tissue.

The ultrasonic instrument **12** includes housing **22** and elongated body portion **24** extending distally therefrom. Housing **22** is formed from molded housing half-sections **22a** and **22b** and includes a barrel portion **26** having a longitudinal axis aligned with the longitudinal axis of elongated body portion **24** and a stationary handle portion **28** extending obliquely from barrel portion **26**. Ultrasonic transducer **30** is supported within and extends from the proximal end of housing **22** and is connected to ultrasonic generator module **14** via electrically conductive cable **18**. The ultrasonic transducer **30** can be a separate component or incorporated into the ultrasonic instrument **12**. The ultrasonic generator module **14** supplies electrical energy having ultrasonic frequency to the ultrasonic

transducer **30** to cause oscillation thereof. The ultrasonic transducer **30**, which may be one of a variety of electromechanical types, e.g., electrodynamic, piezoelectric, magnetostrictive, is connected to the ultrasonic probe **21** through a vibration coupler (not explicitly shown, contained within barrel portion **26** and elongated body portion **24**) and causes ultrasonic oscillation thereof.

The ultrasonic probe **21** is disposed adjacent the distal end of elongated body portion **24** and is actuated by moving the movable handle **36** with respect to stationary handle portion **28**. Movable handle **36** and stationary handle portion **28** may include openings **38** and **40**, respectively, defined therein that facilitate gripping and actuation of ultrasonic instrument **12**. Elongated body portion **24** is supported within rotatable knob **34** and may be selectively rotated by rotatable knob **34** with respect to housing **22** to change the orientation of the distal end of ultrasonic instrument **12**.

Those skilled in the art will understand that the ultrasonic probe **21** is an illustrative embodiment of an ultrasonic device and that other types and/or forms of ultrasonic implements are envisioned, such as a blade, a hook, or a ball, and/or an aspirator assembly. An example of an ultrasonic aspirator instrument is shown and described in commonly-owned U.S. Pat. No. 4,922,902 entitled "METHOD FOR REMOVING CELLULAR MATERIAL WITH ENDOSCOPIC ASPIRATOR".

Those skilled in the art will also understand that the ultrasonic dissection and coagulation system **10** and the ultrasonic generator module **14** are provided and explained in detail for example only and should not be construed as limiting the embodiments of the present disclosure. The embodiments disclosed herein may be employed in non-surgical applications including ultrasonic welding, ultrasonic mass flow meters, ultrasonic atomizers or any other suitable electromechanical ultrasonic system that requires the ability to perform intermittent operation.

FIG. **3** is a control block diagram of an oscillation circuit **100** used to drive an oscillating device. Oscillation circuit **100** is disposed within the ultrasonic generator module **14** of FIG. **2** on one or more processors, analog circuits and analog circuit components as is known in the art. Details of the hardware and/or software that implements the various control block embodiments described herein are not provided in detail as implementation of a control system is well known in the art.

Oscillation circuit **100** includes a controller **110**, summer **120**, a compensator or control process **145**, an oscillator conditioner and amplifier **150** and a feedback conditioner **140** that generates and provides a driving signal to the oscillating device **130**. The functionality of the individual components **110**, **120**, **140**, **145**, **150** of the oscillation circuit **100** are provided to illustrate the embodiments of the present disclosure. The functionality of each functional block may be accomplished by a plurality of devices or components or the functionality of any two or more functional blocks may be consolidated into a single device or component.

Controller **110** provides a reference signal to summer **120** and receives a feedback signal from the oscillating device **130**. Controller **110** may be any suitable processor capable of executing logical instructions, performing signal analysis, performing digital signal processing and/or generating a suitable ultrasonic reference signal. Feedback signal received by the controller **110** may be a raw feedback signal from the oscillating device **130**, a conditioned feedback signal from the output of the feedback conditioner **140** or both. The controller **110** may also include the elements of forward compensator **145**. Oscillating device **130** may include an ultra-

sonic transducer **30**, vibration coupler and/or ultrasonic probe **21** as discussed hereinabove and illustrated in FIG. **2** or any other suitable ultrasonic oscillating device, instrument or arrangement. Feedback is related to the mechanical oscillation of the oscillating device **130** and may be determined by monitoring the physical position of the oscillating device **130**, measuring the current and/or voltage of the driving signal and/or generating an electrical signal related to the position of the oscillating device **130** from the movement thereof. Oscillator conditioner and amplifier **150** receives the feedback from the oscillating device **130**.

Feedback conditioner **140** is configured to condition the feedback signal from the oscillating device **130**. Conditioning of the feedback signal may include filtering and/or amplifying the feedback signal. Feedback conditioner **140** may also be configured to analyze the feedback signal to determine the frequency components thereof. A conditioned feedback signal related to the feedback signal or a generated feedback signal related to one or more parameters of the analysis of the feedback signal is provided to the summer **120**. Feedback conditioner **140** and summer **120** may be incorporated into controller **110** in whole or in part and may include analog and/or digital components.

Summer **120** compares the reference signal and the conditioned feedback signal and provides the difference to the forward compensator **145**. Forward compensator **145** provides forward path control compensation sufficient for sustaining oscillation at the desired control input settings provided to the controller **110**. The oscillator conditioner and amplifier **150** amplifies the reference signal and provides a driving signal to the oscillating device **130**. Controller **110**, summer **120**, forward compensator **145** and feedback conditioner **140** constitute a feedback control system configured to maintain the oscillating device **130** in a state of oscillation at a resonant frequency provided the oscillator conditioner and amplifier **150** have sufficient operational parameters.

FIG. **4** is the control block diagram of the oscillation circuit **100** of FIG. **3** further including a start-up, impetus injection circuit **270** and a start-up switch **260** according to an embodiment of the present disclosure, the oscillating circuit shown generally as **200**. Oscillating circuit **200** includes controller **210**, summer **220**, forward compensator **345**, feedback conditioner **240** and oscillator conditioner and amplifier **250** as described hereinabove and illustrated in FIG. **3** and further includes a start-up switch **260** and start-up, impetus injection circuit **270** operably coupled to the oscillating device **230**.

The start-up switch **260** and impetus injection circuit **270** are activated upon start-up of the oscillating circuit **200** to drive the oscillating device **230**. For example, the start-up switch **260** may be enabled for a predetermined period of time during the initial start-up of the oscillation circuit **200** such that an excitation signal generated by the start-up, impetus injection circuit **270** is provided to the summer **220**. The starting time and the duration of time that the start-up switch **260** is enabled are dependant on the method of start-up, the type of device driven by the oscillation circuit **100** and/or the properties of the excitation signal generated by the start-up, impetus injection circuit **270**.

In one embodiment, the start-up switch **260** "enable" signal is provided by the controller **210**. Controller **210** may receive one or more user inputs that may be used to enable and/or disable the oscillation circuit **200** or controller **210** may use the one or more inputs as conditions and/or criteria to determine when to enable and/or disable the oscillation circuit **200**. For example, an input may be provided from an actuator such as, for example, the remote actuator **16** from FIG. **2**. Alternatively, the input may be provided from a clinician. The start-

up, impetus injection circuit **270** is activated upon start-up of the oscillation circuit **100** to drive the oscillating device **230** and the oscillation circuit **100** (i.e., the controller) determines a resonant frequency by measuring a parameter related to the resonant frequency of the oscillating device **230**.

In another embodiment, controller **210** may selectively implement the start-up, impetus injection circuit **270**. For example, controller may determine if start-up of the oscillating circuit **200** requires implementation of the start-up, impetus injection circuit **270** based on the feedback received from the oscillating device.

Start-up, impetus injection circuit **270** may include an analog circuit that generates an analog signal or may include any suitable algorithm that provides and/or generates an analog or digital signal. Regardless of how the signal is generated (circuit and/or algorithm) or the type of signal generated (analog and/or digital) the signal provided from the start-up, impetus injection circuit **270** is configured to aid in the initialization or start-up of the oscillation circuit **200**. Start-up, impetus injection circuit **270** may drive the oscillating device **230** and/or may aid in determining the resonant frequency of the oscillating device **230**. FIGS. **5** and **6** describe a circuit diagram **271a** and signal diagram **271b**, respectively, of a capacitive, impulse-injection circuit according to another embodiment of the present disclosure. System identification by way of impulse response is well known in the art. For example, impulse response is used in hammer impact modal testing. In this implementation of impulse response, unlike previous systems, a capacitor is used to inject an impulse of charge.

FIG. **5** is a circuit diagram of a capacitive impulse injection circuit **271a**. The capacitive impulse injection circuit **271a** includes a capacitor **C1**, a first and a second switch **SW1**, **SW2** and a voltage supply V_{CC} . In a first state, the first switch **SW1** is closed and the second switch **SW2** is open. Capacitor **C1** connects between the voltage supply V_{CC} and the ground **G**. The capacitor **C1** is pre-charged until the voltage across the capacitor **C1** is about equal to the voltage of the voltage supply V_{CC} . On start-up, the capacitive impulse injection circuit **271a** transitions from a first state to a second state. In the second state the first switch **SW1** is open, the second switch **SW2** is closed and the capacitor discharges through the second switch **SW2** to the capacitive impulse injection input on the start-up switch **260**.

In one embodiment, first switch **SW1** and second switch **SW2** are controlled by the controller **210** of FIG. **4**. Controller **210** may selectively utilize the capacitive impulse injection circuit **271a**. For example, controller **210** may only utilize the capacitive impulse injection circuit **271a** if the resonant frequency of the oscillating device **230** is unknown or a condition occurs that may have changed the resonant frequency of the oscillating device **230**. In another embodiment, the capacitive impulse injection circuit **271a** is enabled and/or disabled by another controller or other suitable user input or control device.

FIG. **6** is a signal diagram **271b** of a start-up circuit implementing the capacitive impulse injection circuit **271a** of FIG. **5**. At time T_0 the capacitive impulse injection signal V_{CIS} is equal to V_{CC} and the capacitor **C1** of the circuit diagram **271a** of FIG. **5** is fully charged. At time T_1 , start-up of the oscillation circuit **200** is enabled, the system transitions from the first state to the second state, as discussed hereinabove, wherein the capacitor **C1** discharges through the second switch **SW2** and the capacitive impulse injection signal V_{CIS} is provided to a summer **220**. At time T_1 the reference from the controller **210** has not been enabled and the feedback from the oscillating device **230** is about equal to zero. As such, the output of the summer **220** is about equal to the capacitive

impulse injection signal V_{CIS} . Oscillator conditioner and amplifier **250** amplifies the capacitive impulse injection signal V_{CIS} from the summer **220** and provides a driving signal V_{DS} to the oscillating device **230** as illustrated in the signal diagram **271b**.

Between time T_1 and T_2 , the driving signal V_{DS} drives the oscillating device **230** to a position at (or near) a point of maximum amplitude **273**. The oscillating device position is indicated in the signal diagram as OD_{POS} . At time T_2 the system transitions from the second state to the first state, as discussed hereinabove, and the capacitive impulse injection signal from the start-up switch **260** is disabled. The oscillating device **230**, now no longer driven by the driving signal V_{DS} to the position near maximum amplitude **273**, is released. Releasing the oscillating device **230** results in the oscillating device oscillating at one or more resonate frequencies as further illustrated in signal diagram **271b**. Oscillator conditioner and amplifier **250** may be pre-configured to sustain oscillation at just a single selected frequency mode of the oscillating device **230** after mechanical inertia has been overcome by the impulse injection.

Most solid objects when struck or released from a position as discussed hereinabove will resonate at one or more resonant frequencies. This reaction is more profound when the object struck or released is specifically designed to resonate. One common example is a tuning fork. A tuning fork is specifically dimensioned and/or designed to oscillate at one specific frequency when struck against a surface, i.e., an impulse. Similarly, the oscillating device **230** is also specifically dimensioned and designed to electro-mechanically resonate at one specific frequency. As such, when released from the driving signal, the oscillating device **230** reacts in a similar manner to the tuning fork by resonating at one or more resonating frequencies. Here, driving the oscillating device **230** with the capacitive impulse injection signal V_{CIS} is analogous to striking the tuning fork, wherein driving the oscillating device **230** to the point of maximum amplitude **273** provides kinetic energy to the oscillating device **230** and the release from the point of maximum amplitude **273** provides energy to drive the oscillations.

Between time T_2 and time T_4 , the controller **210** measures a parameter related to the resonant frequency of the oscillating device **230** and determines at least one resonant frequency therefrom. For example, the controller **210** may measure a parameter related to the position feedback of the oscillating device **230**. The parameter may be a current, a voltage, a parameter related to the mechanical position of the oscillating device **230** and/or calculated velocity or acceleration of the oscillating device **230**. Using the parameter, the controller **210** determines at least one resonant frequency of the oscillating device **230**.

The measured parameter may be used to determine the equilibrium position (i.e., maximum velocity and acceleration equal to zero), the maximum displacement (i.e., zero velocity and maximum (absolute) acceleration) or any combination thereof. The controller **210** may determine at least one resonant frequency by measuring the time therebetween. For example, a resonant frequency may be determined by measuring the time between two equilibrium positions. As such, the controller may determine a resonant frequency within one half-cycle of the resonant frequency. After determining a resonant frequency, the controller **210** maintains the oscillations of the oscillating device **230** by generating a suitable driving signal.

In another embodiment, a resonant frequency is determined by measuring the period of the oscillations that occur between time T_1 and time T_3 and the controller **210** may

resume control of the oscillations after receiving feedback from as few as one-half cycles of the oscillating device **230**. In another embodiment, the controller may determine a plurality of resonant frequencies from measurements made during the first three cycles of the oscillating device **230**. A start-up resonant frequency algorithm may utilize the plurality of resonant frequencies and determine a start-up resonant frequency. The algorithm may select the start-up resonant frequency by any calculation or statistical analysis of the plurality of resonant frequencies. For example, the algorithm may include a mean calculation such as, for example, an arithmetic mean, the geometric mean or harmonic mean, a calculation to determine the median frequency and/or any other suitable statistical calculations, such as, for example, a standard deviation calculation to eliminate erroneous frequency values from the plurality of resonant frequencies.

FIG. 7 is a graphical illustration of a chirp, impulse-injection signal **271c** that may be utilized by the start-up, impetus injection circuit **270**, the start-up switch **260** and the oscillation circuit **200** of FIG. 4. Chirp, impulse-injection signal **271c** is applied in a similar manner as a frequency sweep but, instead, the chirp, impulse-injection signal **271c** rapidly sweeps frequencies up (or down) at a rate much faster than a full period of any single frequency range. The frequency sweep may be done linearly, as illustrated in FIG. 7. Alternatively, the frequency sweep may be done exponentially over the expected range of resonant frequencies for the specific oscillating device **230**. With reference to FIG. 4, a “chirp” signal is generated by the start-up, impetus injection circuit **270**. Start-up, impetus injection circuit **270** may include a digital-to-analog signal converter, operatively coupled to the oscillating device **230**, configured to generate a time-frequency varying driving signal to drive the oscillating device **230**. System identification by way of chirp response is also well known in the art. For example, chirp response is widely used in Time Delay Spectrometry (TDS).

The starting frequency (i.e., the frequency of the first cycle of the chirp signal) and the ending frequency of the chirp, impetus-injection signal **271c** (i.e., the frequency of the last cycle of the chirp signal) are selected such that the resonance frequency of the oscillating device **230**, or at least the estimated or expected resonance frequency of the oscillating device **230**, is represented at or near the midpoint of the chirp, impetus-injection signal **271c**.

With reference to FIGS. 4 and 7, the oscillating device **230** is driven with the chirp, impetus-injection signal **271c** illustrated in FIG. 7, wherein the resonant frequency of the oscillating device **230** is contained within the frequency range of the chirp, impetus-injection signal **271c**. The oscillating device **230** resonates at or about the resonant frequency (contained within the chirp, impetus injection signal **271c**) while absorbing all other frequencies. The controller **210** then determines a specific resonant frequency of the oscillating device **230** by monitoring the feedback of the oscillating device **230**.

The use of a “chirp” signal is frequently employed in echo-location systems, such as, for example, sonar systems. Chirp signals have also been employed in audio frequency system identification equipment, such as for example, Time Delay Spectrometry (TDS) devices. In these systems and devices a transducer transmits an ultrasonic frequency varying “chirp” signal and the echo received by a receiving transducer identifies specific objects or locations based on knowledge of the ultrasonic frequencies responses. In other words, the specific signature received from an object is used to identify the object. Unlike sonar systems and TDS devices, the oscillating circuit electro-mechanically drives the oscillating

device **230** with the chirp, impulse-injection signal **271c** and the controller receives a time varying response from the feedback of the oscillating device **230**. Initial oscillation after the chirp has overcome mechanical inertia are sustained by the oscillator conditioner and amplifier **250** pre-configured for a selected resonant frequency mode.

In another embodiment, the frequency of the chirp, impulse-injection signal **271c** varies exponentially. One advantage of an exponentially, timed-based chirp, impetus-injection signal is that a broad range of frequencies may be included in the chirp signal as compared with a linearly, time-based chirp, impetus-injection signal. In addition, an exponentially time-based chirp, impetus-injection signal may be better suited to aid in determining the resonant frequency of ultrasonically oscillating medical devices because the resonant frequency of these devices tend to vary non-linearly with time.

FIG. 8 is a control block diagram of the oscillation circuit **100** of FIG. 3 including a start-up, narrowband, pseudo-random noise generator **380** and a start-up switch **360** according to an embodiment of the present disclosure. The control block is shown generally as **300**. Control block **300** includes controller **310**, summer **320**, forward compensator **345**, feedback conditioner **340** and oscillator conditioner and amplifier **350** as described hereinabove and illustrated in FIG. 3 and further includes a pseudo-random noise generator **380** and pseudo-random noise start-up switch **360**.

The pseudo-random noise start-up switch **360** is enabled for a predetermined period of time during the start-up of the oscillation circuit **300** and provides a waveform generated by the narrowband pseudo-random noise generator **380** to the summer **220**. The use of the pseudo-random noise generator **380**, its specific pseudo-random number sequence, and the duration of use may be determined by the controller **310**, a user input or any other suitable control system.

In one embodiment, the pseudo-random noise start-up switch **360** “enable” signal is provided by the controller **310**. Controller **310** may receive one or more inputs that subsequently enable the oscillation circuit **300**. For example, input may be provided from an actuator, such as, for example, the remote actuator **16** from FIG. 2, or input may be a user generated input from a clinician.

Controller **310** may selectively implement the use of the pseudo-random noise generator **380**. For example, pseudo-random noise start-up switch **360** enable signal may be an internally generated signal that enables the pseudo-random noise start-up switch **360** if the resonance frequency of the oscillating device **330** is unknown, has changed or if the oscillating device **330** has been replaced, changed or modified. System identification by pseudo-random noise sequences is well known in the art. For example, pseudo-random noise sequences are used for loudspeaker measurements by way of maximum length sequences.

With reference to FIGS. 4 and 8, the controller **210** may receive conditioned feedback from the feedback conditioner **240**, as illustrated in FIG. 4, or controller **310** may receive feedback directly from the oscillating device **330**. Feedback may be a voltage feedback, a current feedback, feedback related to the real-time mechanical position of the oscillating device **230**, **330** or any other suitable feedback that may be used to control an electro-mechanical oscillating device.

FIG. 9 is a signal diagram **300a** of a start-up circuit implementing the start-up, narrowband, pseudo-random noise generator **380** of FIG. 8. The narrowband, pseudo-random noise signal **381** is injected into the summer **320** of FIG. 8 to drive the oscillating device. At Time T_0 , the narrowband, pseudo-random noise signal **381** includes a broad range of frequen-

cies (i.e., frequencies typically contained in a noise signal). The pseudo-random noise generator **380** may be selectively designed such that it contains only those frequency bands falling primarily within the resonant bandwidth of the oscillating device **330**. Over time, the predominant frequencies within the resonant bandwidth remain and all other frequencies are attenuated or non-existent in the sequence, wherein the predominant frequencies are related to the one or more resonant frequencies of the oscillating device **330**. At time T_1 , the majority of the frequencies outside of the primary resonant bands have been eliminated and the majority of the signal strength of the pseudo-random noise signal **381** is at the resonant frequency of the oscillating device **330**.

Between Time T_0 and time T_1 the pseudo-random noise signal **381** is provided by the narrowband, pseudo random noise generator **380** of the oscillating circuit **300**. At time T_1 the resonant frequency of the oscillating device **330** is determined by the controller **310**, the start-up is complete and the pseudo-random noise start-up switch **360** disables the narrowband, pseudo-random amplifier **380** from injecting the narrowband, pseudo-random noise signal **381** into the summer **320**.

With continued reference to FIGS. **8** and **9**, at time T_1 the driving signal **381a** may no longer be provided from the pseudo-random noise start-up switch **360**. The controller **310** provides a reference to the summer **320** and the oscillation position **383** of the oscillating device **320** is driven by the narrowband, pseudo-random noise signal **381**. Oscillation is sustained by the oscillator conditioner and amplifier **350** pre-configured for a selected resonant frequency mode. Alternatively, the start-up switch **360** could remain closed and system identification and measurement continued for adaptive control by controller **310** of amplitude and/or resonant frequency of oscillating device **330**.

A method of starting an oscillating circuit according to an embodiment of the present disclosure is also disclosed and includes the steps of enabling an impetus injection circuit according to one embodiment of the present disclosure, driving an electro-mechanical oscillating device from a signal provided from the impetus injection circuit, overcoming inertia and determining the resonant frequency of the electro-mechanical oscillating device, disabling the impetus-injection circuit and driving the electro-mechanical oscillating device at the determined resonant frequency.

Another method for starting an electro-mechanical oscillating device, the electro-mechanical oscillating device having a varying resonant frequency, includes the steps of: generating a start-up excitation signal, applying the start-up excitation signal to an electro-mechanical oscillating device, driving the electro-mechanical oscillating device to a position related to a point of maximum amplitude, removing the excitation signal from the electro-mechanical oscillating device when the electro-mechanical oscillating device is at a position related to the point of maximum amplitude, measuring at least one parameter related to a resonant frequency of the electro-mechanical oscillating device, determining a resonant frequency of the electro-mechanical oscillating device, and driving the electro-mechanical oscillating device at the determined resonant frequency. The at least one parameter may be selected from a current, a voltage and mechanical position.

In another method for starting an electro-mechanical oscillating device, the electro-mechanical oscillating device having a varying resonant frequency, includes the steps of: generating a time-frequency varying start-up excitation signal, applying the time-frequency varying start-up excitation signal to an electro-mechanical oscillating device, measuring at

least one parameter related to a resonant frequency of the electro-mechanical oscillating device while driving the electro-mechanical oscillating device with the time-frequency varying excitation signal, determining the resonant frequency of the electro-mechanical oscillating device, and driving the electro-mechanical oscillating device at the determined resonant frequency.

In yet another method for starting an electro-mechanical oscillating device, the electro-mechanical oscillating device having a varying resonant frequency, includes the steps of: generating a start-up excitation signal from a pseudo-random noise signal with a narrow bandwidth at or around the resonant frequency, driving the electro-mechanical oscillating device with the start-up excitation signal, measuring at least one parameter related to a resonant frequency of the electro-mechanical oscillating device, determining the resonant frequency of the electro-mechanical oscillating device, and driving the electro-mechanical oscillating device at the determined resonant frequency.

Modification of the above-described systems and methods for using the same, and variations of aspects of the disclosure that are obvious to those of skill in the art are intended to be within the scope of the claims.

What is claimed is:

1. An oscillating circuit for determining a resonant frequency of an electro-mechanical oscillating device and for driving the electro-mechanical oscillating device at the determined resonant frequency, the oscillating circuit comprising:
 - a driving circuit configured to receive at least one reference signal and further configured to provide a driving signal related to the at least one reference signal to the electro-mechanical oscillating device, wherein the driving circuit determines a resonant frequency by measuring a parameter related to the resonant frequency of the electro-mechanical oscillating device;
 - a start-up, impetus injection circuit operably coupled to the electro-mechanical oscillating device, wherein the start-up, impetus injection circuit is configured to selectively provide a start-up excitation signal to the electro-mechanical oscillation device, and wherein the start-up, impetus injection circuit is activated upon start-up of the oscillating circuit to drive the electro-mechanical oscillation device; and
 - an excitation signal generating circuit including:
 - a DC voltage source; and
 - an energy storage device operatively coupled to the DC voltage source in a first condition and operatively coupled to the start-up switch in a second condition; and
 - a start-up switch configured to selectively couple the excitation signal generating circuit to the electro-mechanical oscillating device,
 wherein in the first condition, the DC voltage source charges the energy storage device, and, in the second condition, the energy storage device drives the electro-mechanical oscillating device to a position related to a point of maximum amplitude.
2. The oscillating circuit of claim 1, wherein the driving circuit determines a resonant frequency of the electro-mechanical oscillating device within one-half cycle of the resonant frequency.
3. The oscillating circuit of claim 1, wherein the driving circuit determines a resonant frequency of the electro-mechanical oscillating device within three cycles of the resonant frequency.

15

4. The oscillating circuit of claim 1, wherein the parameter is related to the resonant frequency and is related to motion of the electro-mechanical oscillating device.

5. The oscillating circuit of claim 4, wherein the parameter related to the resonant frequency is selected from a group consisting of current, voltage and mechanical position.

6. The oscillating circuit of claim 1, wherein the energy storage device includes a capacitor.

7. The oscillating circuit for determining a resonant frequency of an electro-mechanical oscillating device and for driving the electro-mechanical oscillating device at the determined resonant frequency, the oscillating circuit comprising:

a driving circuit configured to receive at least one reference signal and further configured to provide a driving signal related to the at least one reference signal to the electro-mechanical oscillating device, wherein the driving circuit determines a resonant frequency by measuring a parameter related to the resonant frequency of the electro-mechanical oscillating device;

a start-up, impetus injection circuit operably coupled to the electro-mechanical oscillating device, wherein the start-up, impetus injection circuit is configured to selectively provide a start-up excitation signal to the electro-mechanical oscillation device, and wherein the start-up, impetus injection circuit is activated upon start-up of the oscillating circuit to drive the electro-mechanical oscillation device; and

an excitation signal generating circuit including:

an digital-to-analog signal converter configured to generate a time-frequency varying driving signal operatively coupled to the start-up switch,

wherein the electro-mechanical oscillating device is driven by the time-frequency varying driving signal generated by the digital-to-analog signal converter; and

a start-up switch configured to selectively couple the excitation signal generating circuit to the electro-mechanical oscillating device.

8. The oscillating circuit of claim 7, wherein the frequency of the time-frequency varying driving signal varies linearly with respect to time.

9. The oscillating circuit of claim 7, wherein the frequency of the time-frequency varying driving signal varies exponentially with respect to time.

10. The oscillating circuit of claim 7, wherein the driving circuit determines a resonant frequency of the electro-mechanical oscillating device within one-half cycle of the resonant frequency.

11. The oscillating circuit of claim 7, wherein the driving circuit determines a resonant frequency of the electro-mechanical oscillating device within three cycles of the resonant frequency.

12. New The oscillating circuit of claim 7, wherein the parameter is related to the resonant frequency and is related to motion of the electro-mechanical oscillating device.

13. The oscillating circuit of claim 12, wherein the parameter related to the resonant frequency is selected from a group consisting of current, voltage and mechanical position.

14. A method for starting an electro-mechanical oscillating device, the electro-mechanical oscillating device having a varying resonant frequency, the method comprising the steps of:

generating a start-up excitation signal by activating a start-up switch coupling an excitation signal generating circuit to the electromechanical oscillating device, wherein the excitation signal generating circuit includes a DC voltage and an energy storage device such that the

16

energy storage device is operatively coupled to the DC voltage source in a first condition and operatively coupled to the start-up switch in a second condition, wherein in the first condition, the DC voltage source charges the energy storage device, and, in the second condition, the energy storage device drives the electro-mechanical oscillating device;

applying the start-up excitation signal to the electro-mechanical oscillating device;

driving the electro-mechanical oscillating device to a position related to a point of maximum amplitude;

removing the excitation signal from the electro-mechanical oscillating device when the electro-mechanical oscillating device is at a position related to the point of maximum amplitude;

measuring at least one parameter related to a resonant frequency of the electro-mechanical oscillating device; determining a resonant frequency of the electro-mechanical oscillating device; and

driving the electro-mechanical oscillating device at the determined resonant frequency.

15. The method of claim 14, wherein the at least one parameter is selected from the group consisting of current, voltage and mechanical position.

16. A method for starting an electro-mechanical oscillating device, the electro-mechanical oscillating device having a varying resonant frequency, the method comprising the steps of:

generating a time-frequency varying start-up excitation signal by activating a start-up switch coupling an excitation signal generating circuit to the electromechanical oscillating device, wherein the excitation signal generating circuit includes a DC voltage and an energy storage device such that the energy storage device is operatively coupled to the DC voltage source in a first condition and operatively coupled to the start-up switch in a second condition, wherein in the first condition, the DC voltage source charges the energy storage device, and, in the second condition, the energy storage device drives the electro-mechanical oscillating device;

applying the time-frequency varying start-up excitation signal to the electro-mechanical oscillating device;

driving the electromechanical oscillating device to a position related to a point of maximum amplitude;

measuring at least one parameter related to a resonant frequency of the electro-mechanical oscillating device while driving the electro-mechanical oscillating device with the time-frequency varying excitation signal;

determining the resonant frequency of the electro-mechanical oscillating device; and

driving the electro-mechanical oscillating device at the determined resonant frequency.

17. The method of claim 16, wherein the at least one parameter is selected from the group consisting of current, voltage and mechanical position.

18. A method for starting an electro-mechanical oscillating device, the electro-mechanical oscillating device having a varying resonant frequency, the method comprising the steps of:

generating a start-up excitation signal by activating a start-up switch coupling an excitation signal generating circuit to the electromechanical oscillating device, wherein the excitation signal generating circuit includes a digital-to-analog signal converter configured to generate a time-frequency varying driving signal operatively coupled to the start-up switch, such that the electro-

17

mechanical oscillating device is driven by the time-frequency varying driving signal generated by the digital-to-analog signal converter;
 applying the start-up excitation signal to an electro-mechanical oscillating device;
 driving the electro-mechanical oscillating device to a position related to a point of maximum amplitude;
 removing the excitation signal from the electro-mechanical oscillating device when the electro-mechanical oscillating device is at a position related to the point of maximum amplitude; measuring at least one parameter related to a resonant frequency of the electro-mechanical oscillating device;
 determining a resonant frequency of the electro-mechanical oscillating device; and
 driving the electro-mechanical oscillating device at the determined resonant frequency.

19. The method of claim **18**, wherein the at least one parameter is selected from the group consisting of current, voltage and mechanical position.

20. A method for starting an electro-mechanical oscillating device, the electro-mechanical oscillating device having a varying resonant frequency, the method comprising the steps of:

generating a time-frequency varying start-up excitation signal by activating a start-up switch coupling an exci-

18

tation signal generating circuit to the electromechanical oscillating device, wherein the excitation signal generating circuit includes a digital-to-analog signal converter configured to generate a time-frequency varying driving signal operatively coupled to the start-up switch, such that the electro-mechanical oscillating device is driven by the time-frequency varying driving signal;
 applying the time-frequency varying start-up excitation signal to an electro-mechanical oscillating device;
 driving the electro-mechanical oscillating device to a position related to a point of maximum amplitude;
 measuring at least one parameter related to a resonant frequency of the electro-mechanical oscillating device while driving the electro-mechanical oscillating device with the time-frequency varying excitation signal; and
 determining the resonant frequency of the electro-mechanical oscillating device; and driving the electro-mechanical oscillating device at the determined resonant frequency.

21. The method of claim **20**, wherein the at least one parameter is selected from the group consisting of current, voltage and mechanical position.

* * * * *