

US008075522B2

(12) **United States Patent**
Larsen et al.

(10) **Patent No.:** **US 8,075,522 B2**
(45) **Date of Patent:** ***Dec. 13, 2011**

(54) **DISPOSABLE DOUBLE POINTED
INJECTION NEEDLE, AND AN INSULIN
INJECTION SYSTEM COMPRISING A
DISPOSABLE DOUBLE POINTED
INJECTION NEEDLE**

(75) Inventors: **Carsten Gerner Larsen**, Kgs. Lyngby
(DK); **Lars Stenholt**, Humlebaek (DK);
Anders Molin, København K (DK);
Jørn Rex, Roskilde (DK); **Bjørn Gullak
Larsen**, Bagsvaerd (DK)

(73) Assignee: **Novo Nordisk A/S**, Bagsvaerd (DK)

(*) Notice: Subject to any disclaimer, the term of this
patent is extended or adjusted under 35
U.S.C. 154(b) by 1092 days.

This patent is subject to a terminal dis-
claimer.

(21) Appl. No.: **11/097,414**

(22) Filed: **Apr. 1, 2005**

(65) **Prior Publication Data**

US 2005/0171485 A1 Aug. 4, 2005

Related U.S. Application Data

(63) Continuation of application No. 10/379,021, filed on
Mar. 4, 2003, now abandoned, which is a continuation
of application No. 09/870,276, filed on May 30, 2001,
now Pat. No. 6,547,764.

(60) Provisional application No. 60/254,051, filed on Dec.
7, 2000.

(30) **Foreign Application Priority Data**

May 31, 2000 (EP) 00610052
Nov. 28, 2000 (DK) 2000 01790

(51) **Int. Cl.**
A61M 5/00 (2006.01)

(52) **U.S. Cl.** 604/110

(58) **Field of Classification Search** 604/192,
604/198, 188, 171, 111, 110, 197
See application file for complete search history.

(56) **References Cited**

U.S. PATENT DOCUMENTS

3,021,942 A 2/1962 Hamilton
(Continued)

FOREIGN PATENT DOCUMENTS

DE 100 09 814 9/2001
(Continued)

OTHER PUBLICATIONS

Notice of Opposition and Response in Opposition of EP Pat. No. 1
448 256.

(Continued)

Primary Examiner — Manuel A Mendez

(74) *Attorney, Agent, or Firm* — Wesley A. Nicolas; Marc A.
Began

(57) **ABSTRACT**

A disposable double pointed injection needle has a needle
hub to which a thin needle cannula is permanently fasten and
which needle hub can be mounted on to a syringe comprising
a dose setting and injection mechanism and a cartridge con-
taining a liquid medicine to be injected subcutaneously into a
human body. The needle hub is provided with a safety shield
guided on the outside surface of the needle hub. The safety
shield is urged in a direction away from the needle hub by a
spring located between the needle hub and the safety shield.
The safety shield has a number of protrusions guided in
guiding tracks on the outside surface of the needle hub. The
guiding tracks are designed such that the safety shield during
injection is moved towards the needle hub, and after injection
is moved away from the needle hub by the spring and locked
in an irreversible position where the safety shield covers the
needle cannula and prevents accidental needle stick injuries.

2 Claims, 5 Drawing Sheets

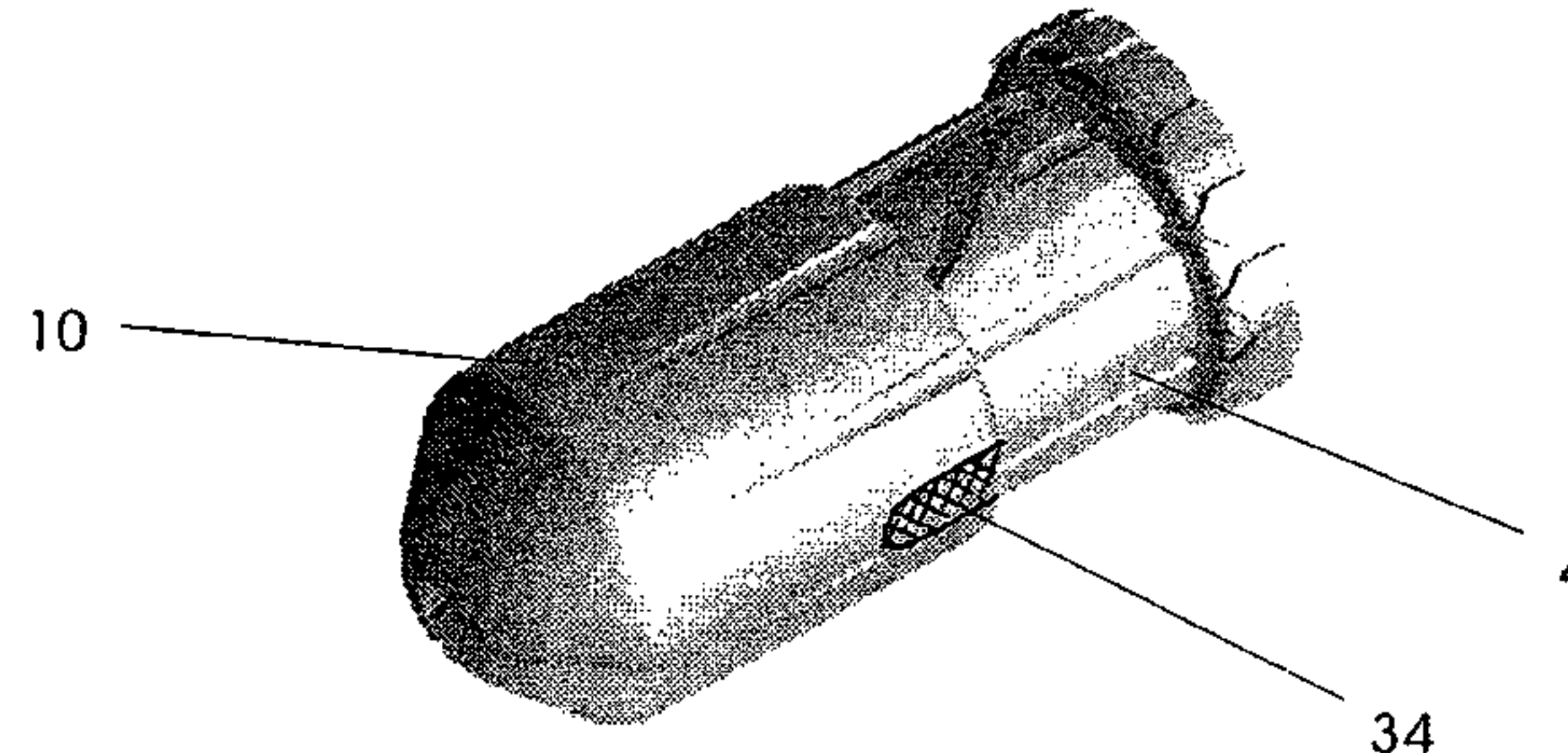
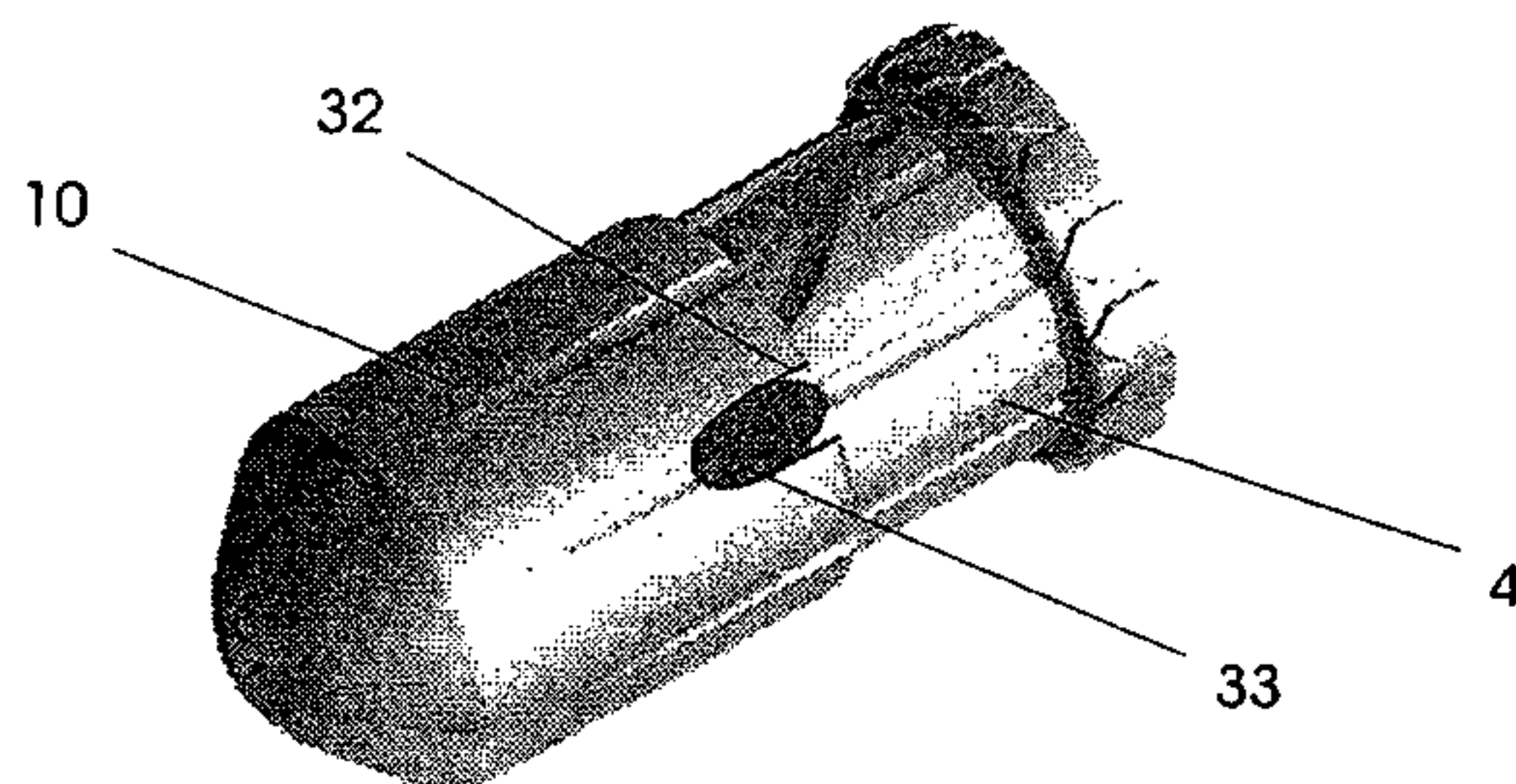

U.S. PATENT DOCUMENTS

3,114,455	A	12/1963	Claisse et al.		5,980,494	A	11/1999	Malenchek et al.
3,390,759	A	7/1968	Vanderbeck		5,984,906	A	11/1999	Bonnichsen et al.
3,916,893	A	11/1975	De Felice		6,001,080	A	12/1999	Kuracina et al.
4,244,378	A	1/1981	Brignola	128/766	6,001,082	A	12/1999	Dair et al.
4,248,246	A	2/1981	Ikeda		6,004,297	A	12/1999	Steenfeldt-Jensen et al.
4,723,943	A	2/1988	Spencer		6,017,329	A	1/2000	Hake
4,767,413	A *	8/1988	Haber et al.	604/198	6,077,253	A	6/2000	Cosme
4,795,432	A	1/1989	Karczmer		6,110,149	A	8/2000	Klitgaard et al.
4,813,940	A	3/1989	Parry		6,126,646	A	10/2000	Hansen et al.
4,863,436	A	9/1989	Glick		6,132,401	A	10/2000	Van Der Meyden et al. . 604/195
4,894,055	A	1/1990	Sudnak		6,162,197	A	12/2000	Mohammad 604/195
4,915,701	A	4/1990	Halkyard		6,190,361	B1	2/2001	Gettig et al.
5,002,536	A	3/1991	Thompson et al.		6,203,529	B1	3/2001	Gabriel
5,053,018	A	10/1991	Talonn et al.		6,319,225	B1	11/2001	Sugita et al.
5,104,386	A	4/1992	Alzain		6,322,540	B1	11/2001	Grabis et al.
5,169,392	A	12/1992	Ranford et al.		6,379,337	B1	4/2002	Mohammed
5,188,599	A *	2/1993	Botich et al.	604/110	6,391,003	B1	5/2002	Lesch, Jr.
5,195,985	A	3/1993	Hall		6,409,706	B1	6/2002	Loy
5,197,953	A	3/1993	Colonna		6,419,661	B1	7/2002	Kuhr
5,201,708	A	4/1993	Martin		6,436,086	B1	8/2002	Newby et al.
5,201,721	A	4/1993	Lee et al.		6,494,865	B1	12/2002	Alchas
5,242,401	A	9/1993	Colsky		6,547,764	B2 *	4/2003	Larsen et al. 604/192
5,250,037	A	10/1993	Bitdinger		6,569,123	B2	5/2003	Alchas et al.
5,267,961	A *	12/1993	Shaw	604/110	6,733,465	B1	5/2004	Smutney et al.
5,292,314	A	3/1994	D'Alessio et al.		6,773,415	B2	8/2004	Heiniger
5,295,975	A	3/1994	Lockwood, Jr.		6,855,129	B2	2/2005	Jensen et al.
D347,894	S	6/1994	Hansen et al.		6,986,760	B2	1/2006	Giambattista et al.
5,324,264	A	6/1994	Whitaker	604/110	7,074,211	B1	7/2006	Heiniger et al.
5,338,310	A	8/1994	Lewandowski		7,314,464	B2	1/2008	Giambattista et al.
5,338,311	A	8/1994	Mahurkar		7,553,293	B2	6/2009	Jensen et al.
5,346,480	A	9/1994	Hess et al.		2001/0049506	A1	12/2001	Schoenfeld et al.
5,385,551	A	1/1995	Shaw		2002/0004648	A1	1/2002	Larsen et al.
5,389,085	A	2/1995	D'Alessio et al.		2003/0093035	A1	5/2003	Mohammed
5,395,339	A	3/1995	Talonn et al.		2003/0137905	A1	7/2003	Emberly et al.
5,403,286	A	4/1995	Lockwood, Jr.		2005/0033230	A1	2/2005	Alchas et al.
5,405,362	A	4/1995	Kramer et al.		2005/0038392	A1	2/2005	DeSalvo
5,415,645	A	5/1995	Friend et al.		2005/0065476	A1	3/2005	Jensen et al.
5,417,662	A	5/1995	Hjertman et al.		2005/0107740	A1	5/2005	Jensen et al.
5,429,612	A	7/1995	Berthier		2005/0171485	A1	8/2005	Larsen et al.
5,433,712	A	7/1995	Stiles et al.		2006/0184133	A1	8/2006	Pessin
5,462,535	A	10/1995	Bonnichsen		2007/0293819	A1	12/2007	Giambattista et al.
5,472,430	A	12/1995	Vaillancourt et al.					
5,478,316	A	12/1995	Bitdinger et al.					
5,486,164	A	1/1996	Streck					
5,489,275	A	2/1996	Thompson et al.	604/264				
5,545,145	A	8/1996	Clinton et al.					
5,549,558	A	8/1996	Martin					
5,591,138	A	1/1997	Vaillancourt					
5,593,390	A	1/1997	Castellano et al.					
5,611,785	A	3/1997	Mito et al.					
5,626,566	A	5/1997	Petersen et al.					
5,634,910	A	6/1997	Kanner et al.					
5,674,203	A	10/1997	Lewandowski					
5,674,204	A	10/1997	Chanoch	604/211				
5,681,291	A	10/1997	Galli					
5,688,241	A	11/1997	Asbaghi					
5,693,027	A	12/1997	Hansen et al.					
5,709,662	A	1/1998	Olive et al.					
5,746,727	A	5/1998	Graves et al.					
5,755,709	A *	5/1998	Cuppy	604/164.12				
5,769,826	A	6/1998	Johnson et al.					
5,795,336	A	8/1998	Romano et al.					
5,823,997	A	10/1998	Thorne					
5,843,036	A	12/1998	Olive et al.					
5,873,462	A	2/1999	Ngueyn et al.					
5,873,856	A	2/1999	Hjertman et al.					
5,885,249	A	3/1999	Irisawa					
5,893,845	A	4/1999	Newby et al.					
5,921,964	A	7/1999	Martin					
5,931,817	A	8/1999	Nguyen et al.					
5,941,857	A	8/1999	Ngueyn et al.					
5,944,700	A	8/1999	Ngueyn et al.					
5,951,530	A	9/1999	Steengaard et al.					
5,961,495	A	10/1999	Walters et al.					
5,964,731	A	10/1999	Kovelman					
5,968,021	A	10/1999	Ejlersen					
5,971,966	A	10/1999	Lav					
5,980,491	A	11/1999	Hansen					

FOREIGN PATENT DOCUMENTS

EP	0 409 180	A1	1/1991
EP	0 520 930	A1	12/1992
EP	0 555 974	A1	8/1993
EP	0903157		3/1999
EP	1557191		7/2005
FR	2529086		12/1983
GB	2214082		8/1989
JP	3-139363		6/1991
JP	5-337182		12/1993
JP	6-502787		3/1994
JP	3039310		9/1996
JP	9-117507		5/1997
JP	11-137687		5/1999
JP	11-511364		10/1999
JP	2000 167052		6/2000
JP	2001-526095		12/2001
WO	91/11212		2/1991
WO	WO 91/11212		8/1991
WO	93/00948		7/1992
WO	WO 92/19296		12/1992
WO	WO 93/00122		1/1993
WO	WO 93/00948		1/1993
WO	WO 93/16746		9/1993
WO	WO 95/29721		11/1995
WO	WO97/10864		3/1997
WO	WO 97/14455		4/1997
WO	97/23253		7/1997
WO	WO 97/23253		7/1997
WO	WO 97/39787		10/1997
WO	99/22790		5/1999
WO	WO 99/22790		5/1999
WO	WO 99/25402		5/1999
WO	WO 99/32177		7/1999
WO	WO99/32177		7/1999
WO	WO 01/32255		5/2001
WO	WO 01/37898		5/2001

WO	WO 01/64270	9/2001
WO	WO01/64271	9/2001
WO	WO 01/76665	10/2001
WO	02/09797	2/2002
WO	WO 03/066141	8/2003

OTHER PUBLICATIONS

U.S. Appl. No. 95/000,288. (inter partes Reexamination of U.S. Pat. No. 6,885,129).

Unverified English Language Translation of WO 99/25402.

Decision Rejecting Opposition in EP Application No. 02 803 754.7 (Patent No. 1448256) mailed May 30, 2008.

Minutes of Oral Proceedings before the Opposition Division opened on May 6, 2008 in EP Application No. 02 803 754.7 (Patent No. 1448256) mailed May 30, 2008.

English Language Machine Translation of FR2529086.

Patent Owner Appeal Brief mailed Mar. 9, 2009 in inter partes Reexamination Application No. 95/000,288.

Third Party Requestor Cross-Appeal Brief mailed Mar. 5, 2009 in inter partes Reexamination Application No. 95/000,288.

Notice of Opposition to European Patent 1 289 587 dated May 3, 2006.

Written Opinion mailed Apr. 3, 2009 of EP Opposition of EP Patent No. 1,289,587.

Minutes of oral proceeding held Feb. 10, 2009, and mailed Apr. 2, 2009 of EP Opposition of EP Patent No. 1,289,587.

Patent Owner Respondent Brief mailed Apr. 6, 2009 in inter partes Reexamination Application No. 95/000,288.

Third Party Respondent Brief mailed Apr. 8, 2009 in inter partes Reexamination Application No. 95/000,288.

Diggle et al., Effect of needle length on incidence of local reactions to routine immunization in infants aged 4 months: randomized controlled trial (Abstract) pp. 931-933, BMJ vol. 321, Oct. 14, 2000.

Non-Final Office Action in inter partes Reexamination Application No. 95/000,288 mailed Feb. 29, 2008.

Amendment and Response by Patentee in inter partes Reexamination Application No. 95/000,288 submitted Apr. 29, 2008.

3rd Party Comments in inter partes Reexamination Application No. 95/000,288 submitted May 29, 2008.

Action Closing Prosecution in inter partes Reexamination Application No. 95/000,288 mailed Aug. 22, 2008.

Amendment and Response by Patentee in inter partes Reexamination Application No. 95/000,288 submitted Sep. 22, 2008.

3rd Party Comments in inter partes Reexamination Application No. 95/000,288 submitted Oct. 22, 2008.

Right of Appeal Notice in inter partes Reexamination Application No. 95/000,288 mailed Nov. 20, 2008.

Notice of Allowance Mailed Aug. 30, 2004 for U.S. Appl. No. 10/307,054, filed Nov. 29, 2002 by Jensen et al.

Non-Final Office Action Mailed Aug. 31, 2005 for U.S. Appl. No. 10/978,760, filed Nov. 1, 2004 by Jensen et al.

Final Office Action Mailed Feb. 9, 2006 for U.S. Appl. No. 10/978,760, filed Nov. 1, 2004 by Jensen et al.

Notice of Allowance Mailed Sep. 19, 2006 for U.S. Appl. No. 10/978,760, filed Nov. 1, 2004 by Jensen et al.

Non-Final Office Action Mailed Jan. 9, 2007 for U.S. Appl. No. 10/978,760, filed Nov. 1, 2004 by Jensen et al.

Final Office Action Mailed Aug. 21, 2008 for U.S. Appl. No. 10/978,760, filed Nov. 1, 2004 by Jensen et al.

Notice of Allowance Mailed May 7, 2009 for U.S. Appl. No. 10/978,760, filed Nov. 1, 2004 by Jensen et al.

Non-Final Office Action Mailed Apr. 14, 2006 for U.S. Appl. No. 11/017,116, filed Dec. 20, 2004 by Jensen et al.

Non-Final OA Mailed Apr. 7, 2010 in U.S. Appl. No. 12/470,098, filed May 21, 2009 by Jensen et al.

Notice of Appeal and Petition Under 37 CFR 1.181 in inter partes Reexamination Application No. 95/000288 Mailed Dec. 22, 2008.

Office Action Mailed May 26, 2010 Regarding Third Party Requester's Non-Compliant Cross Appeal in Reexam No. 95/000288, US Patent No. 6,547,764, Issue Date: Apr. 15, 2003, U.S. Appl. No. 09/870,276, filed May 30, 2001, Inventors: Larsen et al.

English Abstract of JP 3-139363 Filed June 13, 1991.

English Abstract of 5-337182 Filed Dec. 21, 1993.

Machine Translation of JP 11-137687 Filed May 25, 1999.

Order Returning Undocketed Appeal to Examiner Mailed May 20, 2010 in Reexam No. 95/000288, US Patent No. 6,547,764, Issue Date: Apr. 15, 2003, U.S. Appl. No. 09/870,276, filed May 30, 2001, Inventors: Larsen et al.

Decision Dismissing Patent Owner's Petition Mailed Jun. 2, 2010 in Reexam No. 95/000,288, US Patent No. 6,547,764, Issue Date: April 15, 2003, U.S. Appl. No. 09/870,276, filed May 30, 2010, Inventors: Larsen et al.

Submission of Patentee Novo Nordisk in Opposition of EP Pat. No. 1 448 256 Dated Apr. 3, 2007.

English Language Machine Translation of JP 3039310.

English Language Machine Translation of JP 2000 167052.

Non-Final Office Action Mailed Apr. 7, 2010 in U.S. Appl. No. 12/470,098, filed May 21, 2009, Inventors: Jensen et al.

Corrected Third Party Respondent's Brief Filed Oct. 9, 2009 in Reexam No. 95/000,288 (Which is an inter partes Reexamination of US Patent No. 6,547,764, Issued: Apr. 15, 2003), Inventors: Larsen et al.

Examiner's Answer Mailed Nov. 17, 2009 in Reexam No. 95/000,288 (Which is an inter partes Reexamination of US Patent No. 6,547,764, Issued: Apr. 15, 2003), Inventors: Larsen et al.

Rebuttal Brief for Appellant/Patent Owner in Response to Examiner's Answer Filed Dec. 17, 2009 in Reexam No. 95/000,288 (Which is an inter partes Reexamination of US Patent No. 6,547,764, Issued: Apr. 15, 2003), Inventors: Larsen et al.

Board of Patent Appeals and Interferences Decision on Appeal (Reexamination 95/000,288 of U.S. Patent No. 6,547,764) mailed Feb. 14, 2011.

Board of Patent Appeals and Interferences Decision on Request for Rehearing (Reexamination 95/000,288 of U.S. Patent No. 6,547,764) mailed Jul. 18, 2011.

* cited by examiner

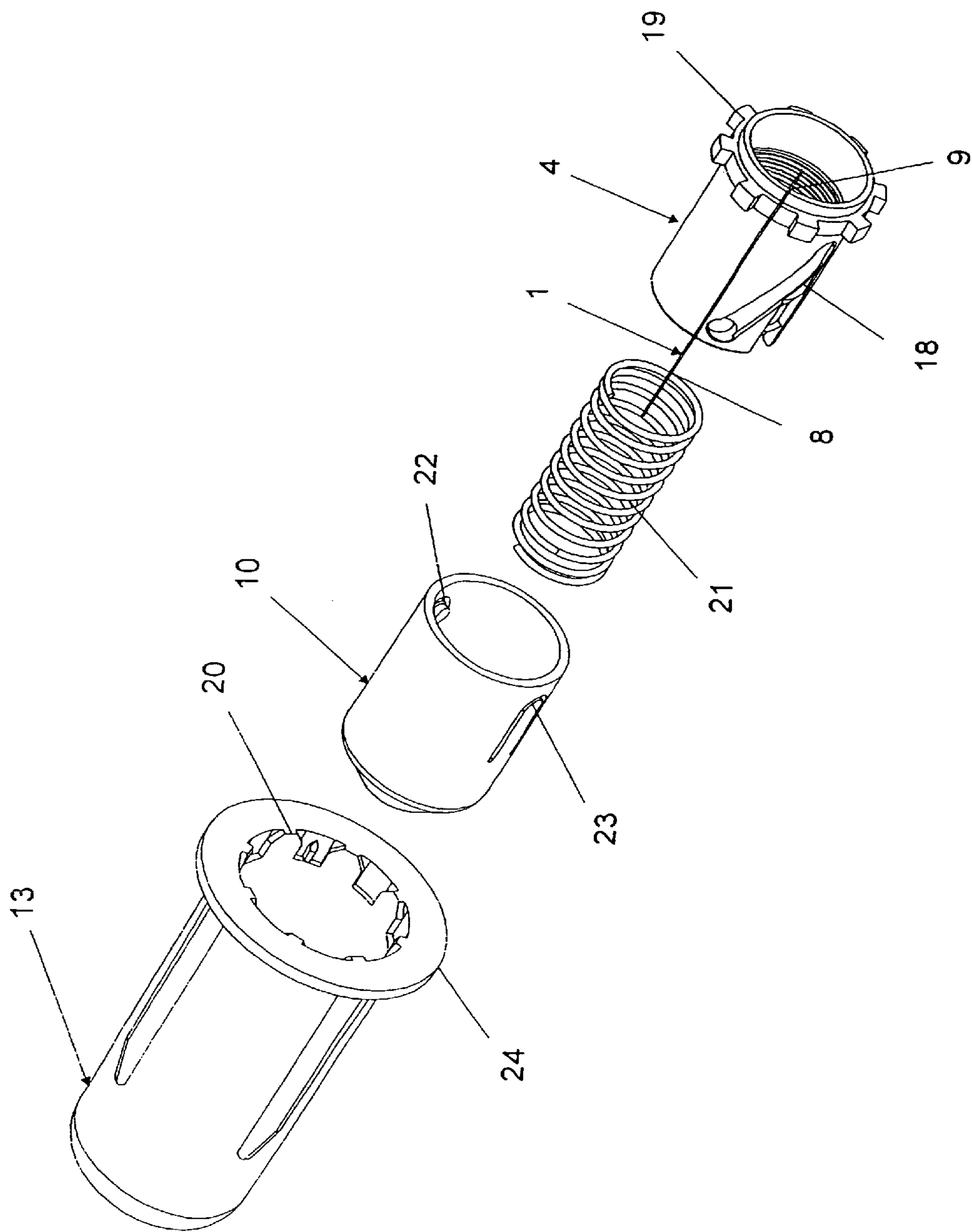

Fig. 1

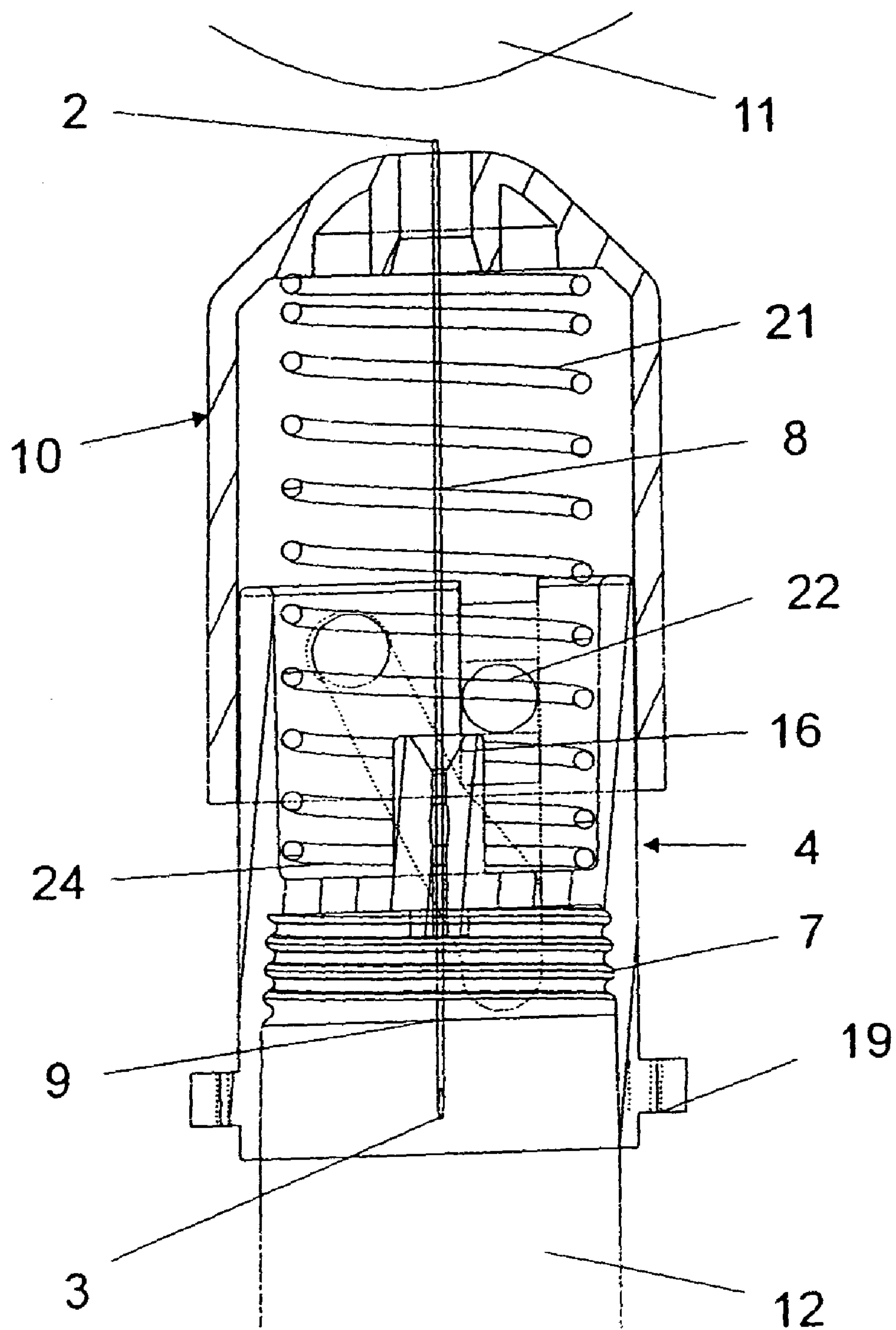

Fig. 2

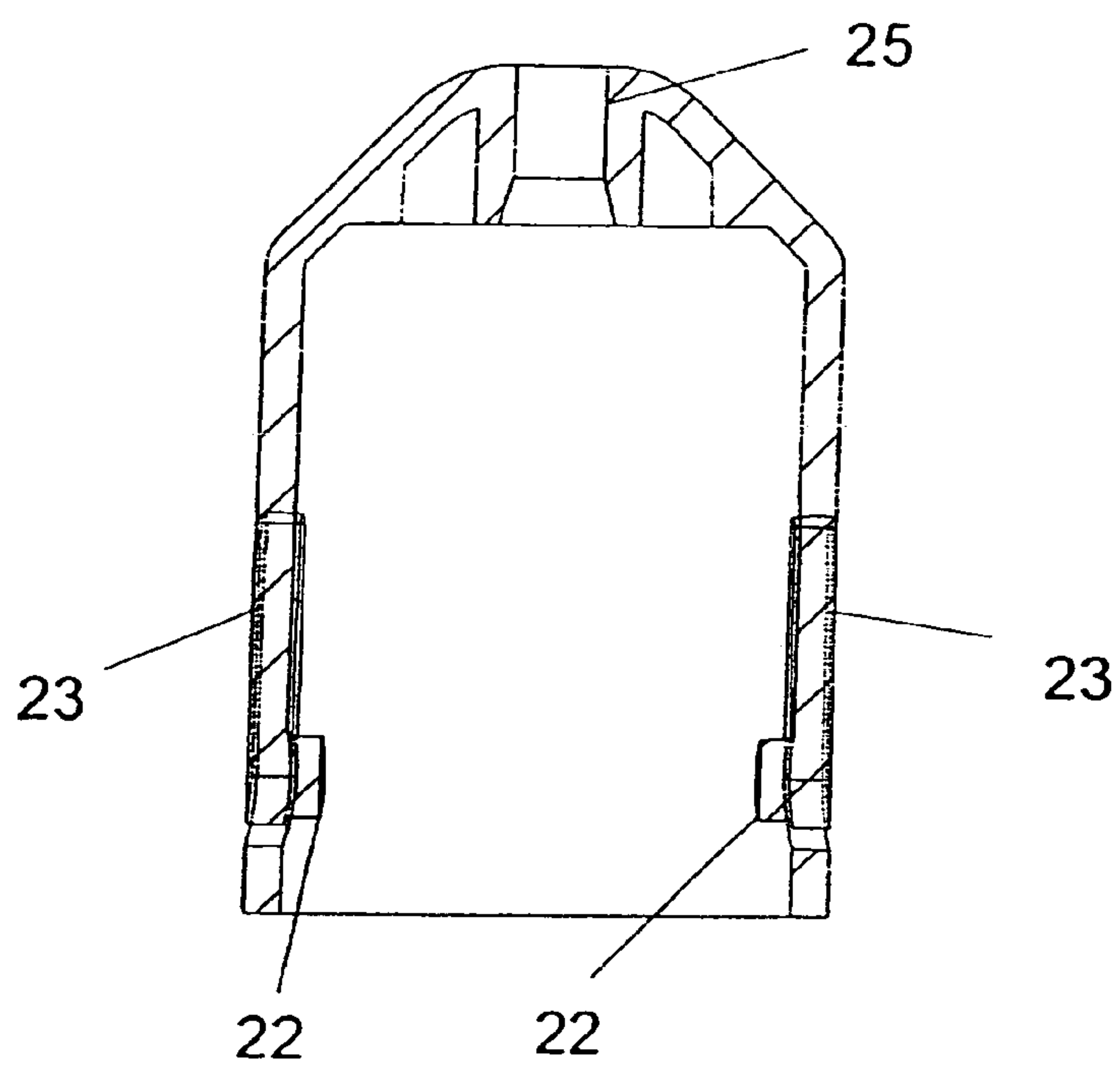

Fig. 3

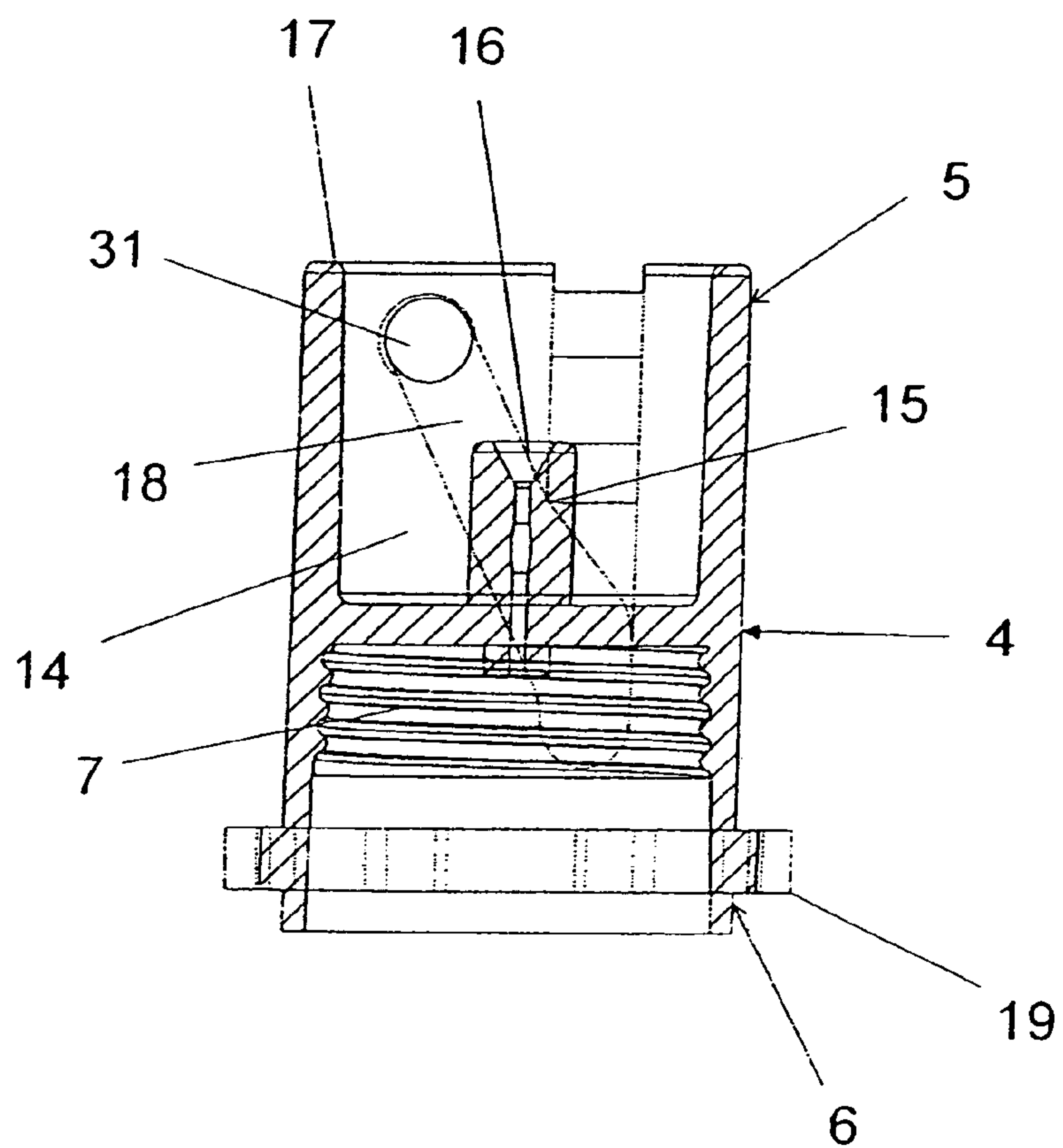

Fig. 4

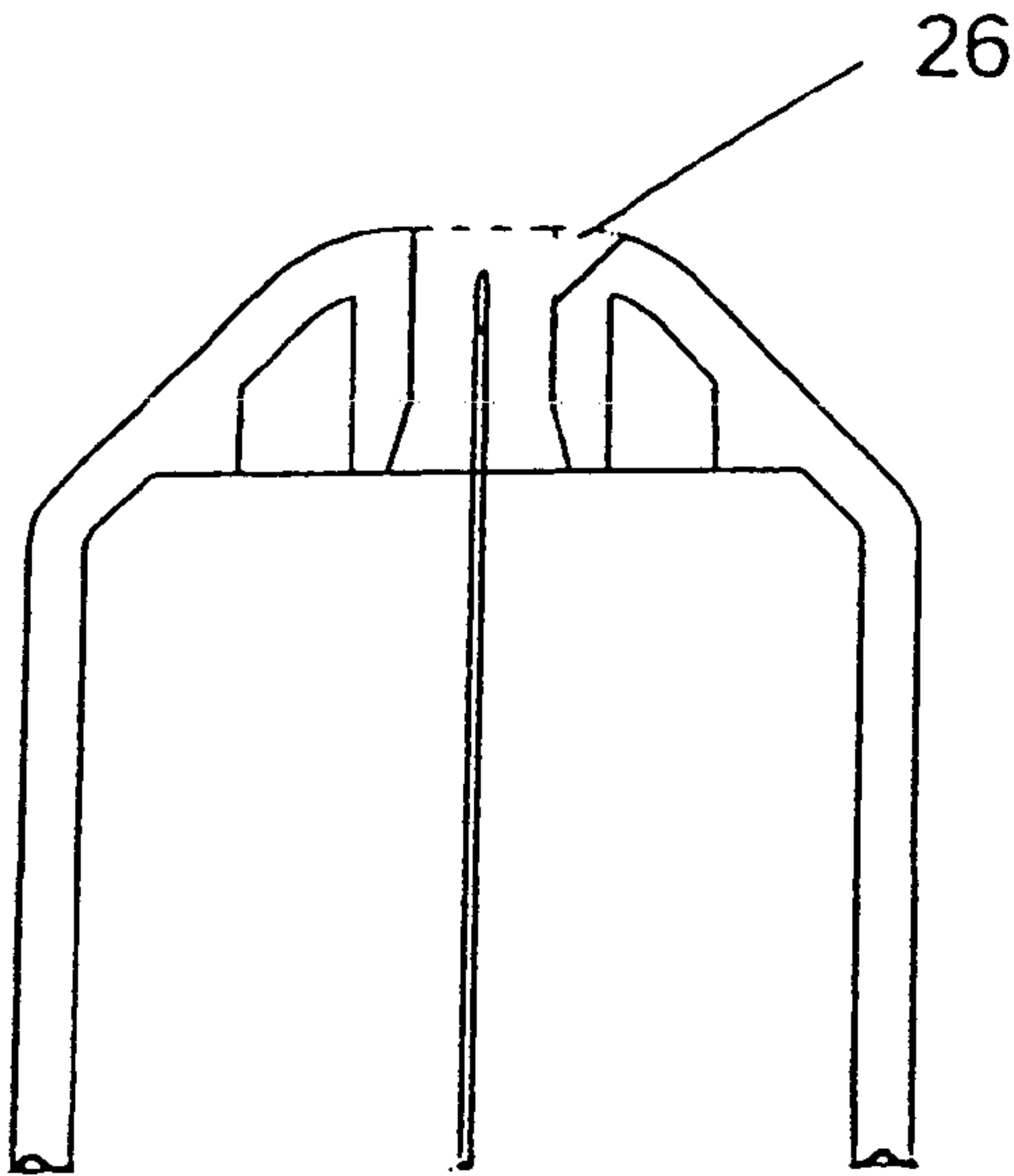

Fig. 5

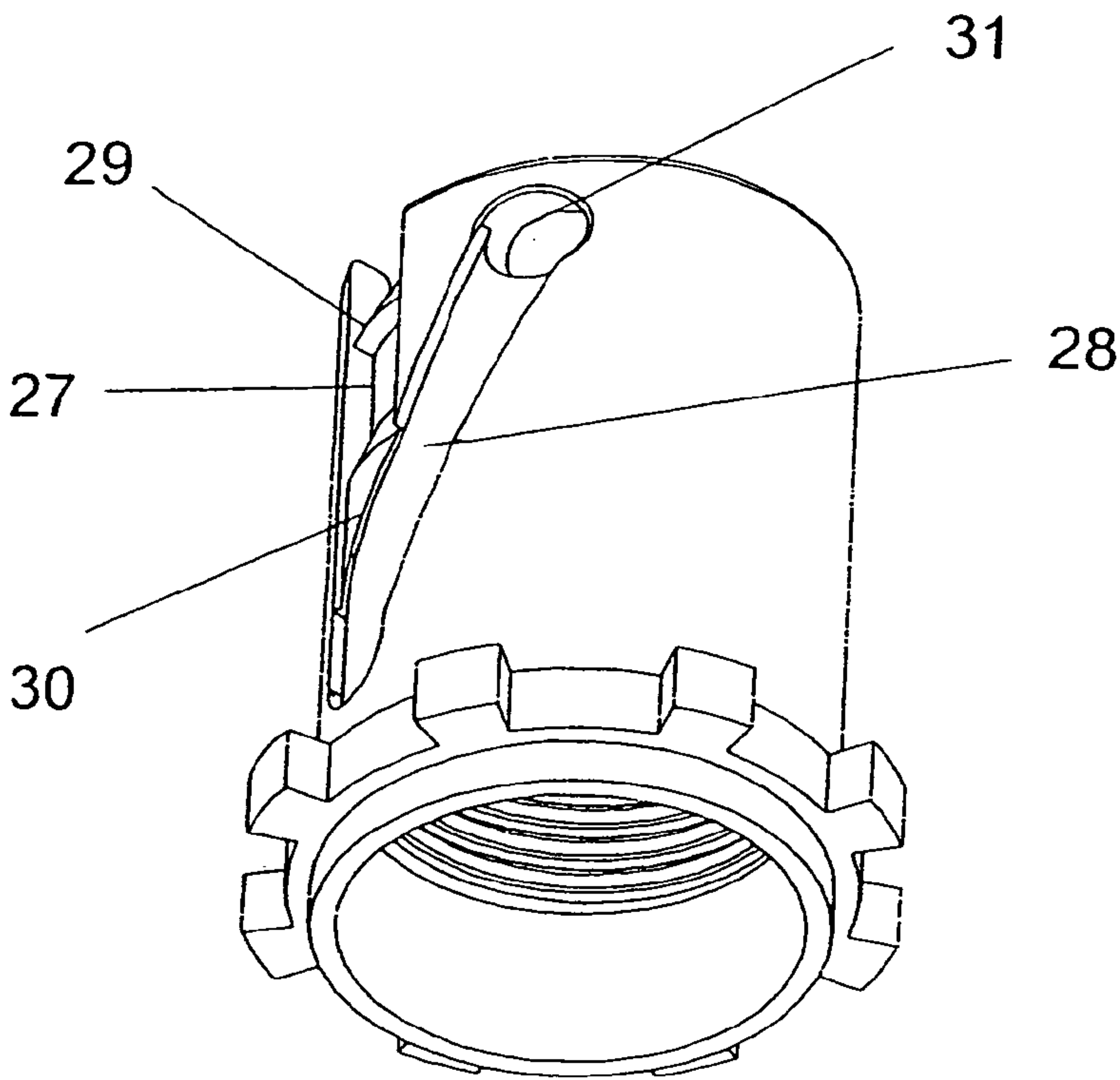

Fig. 6

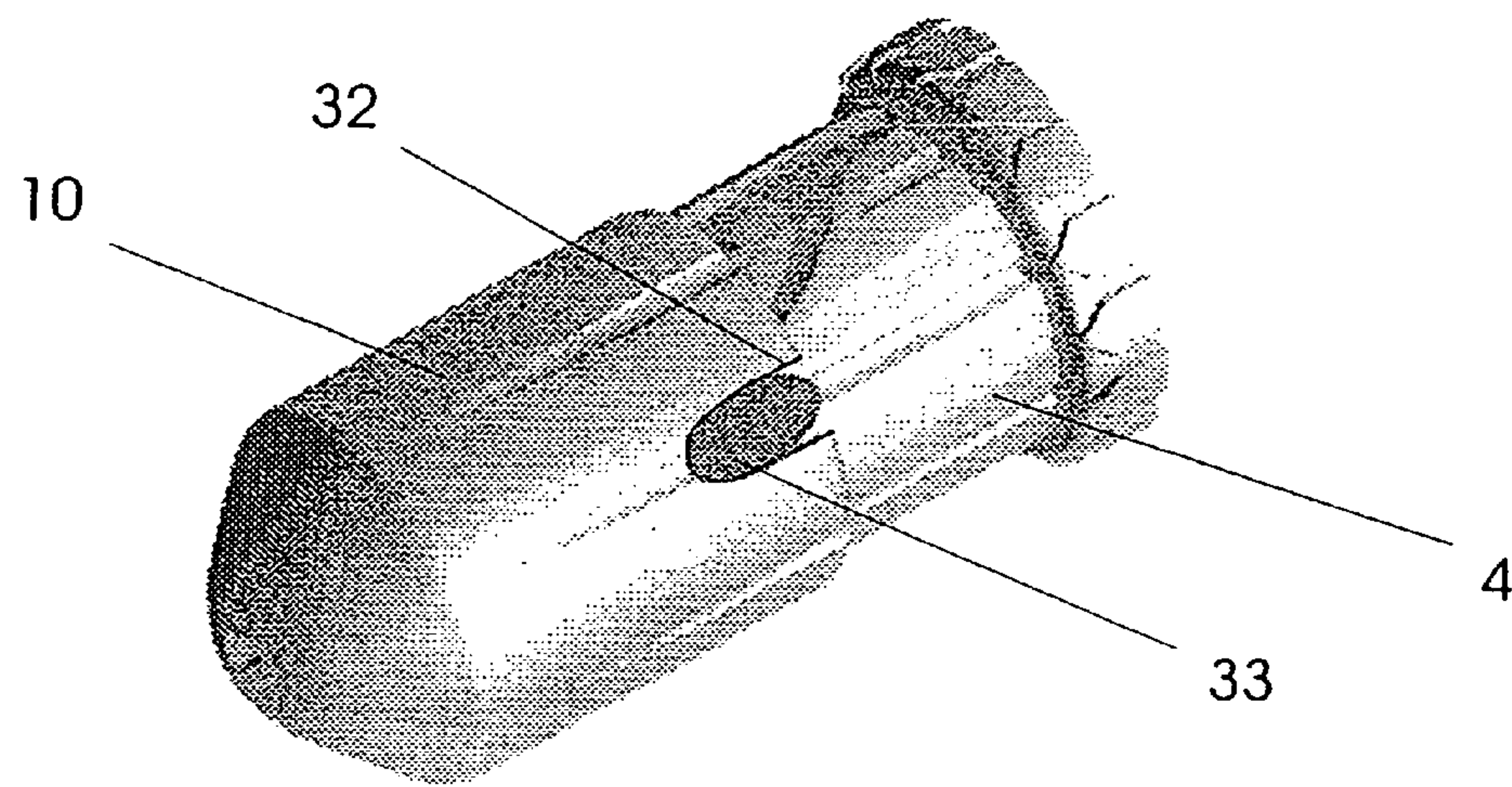

Fig. 7

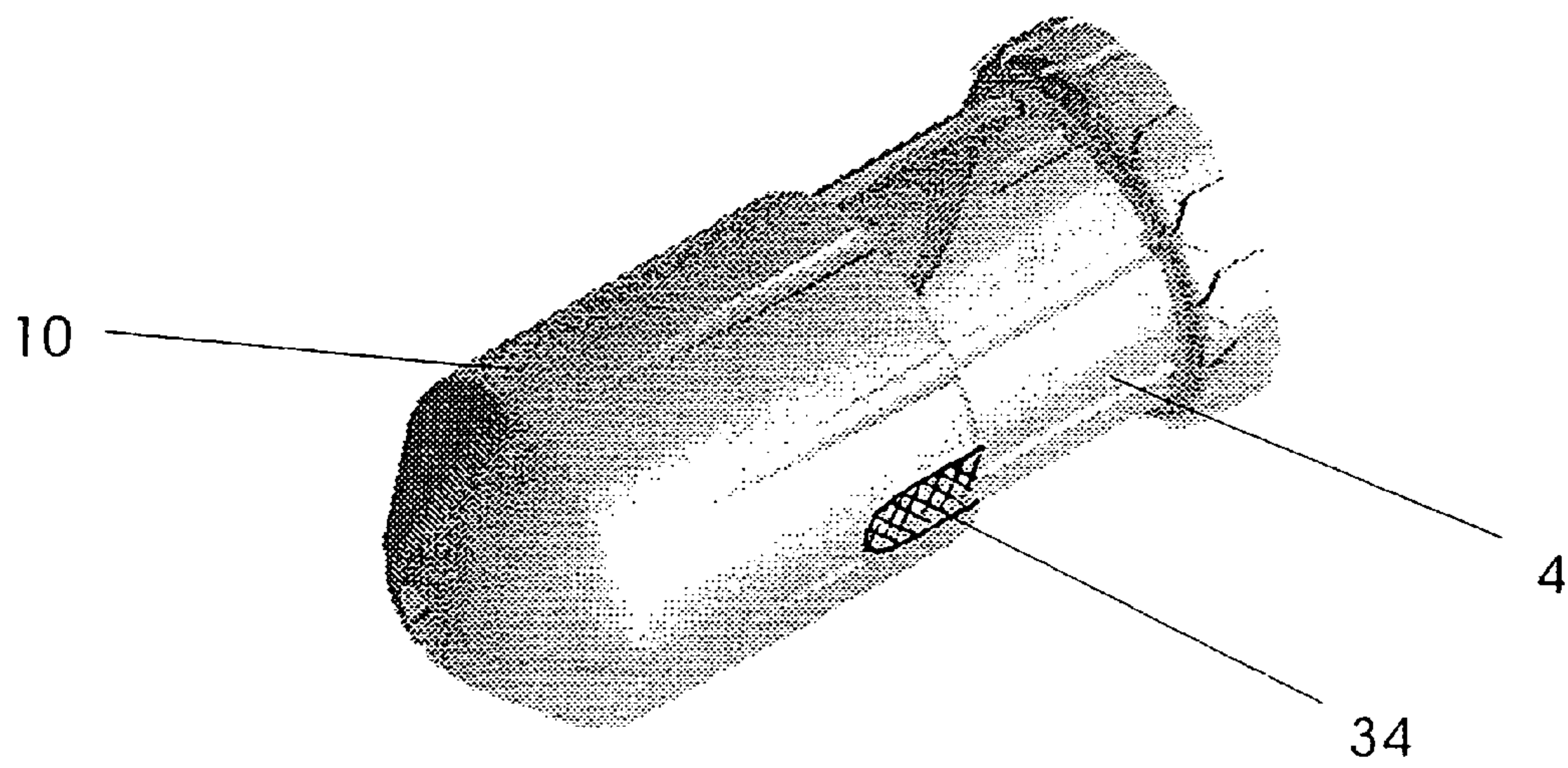

Fig. 8

1

**DISPOSABLE DOUBLE POINTED
INJECTION NEEDLE, AND AN INSULIN
INJECTION SYSTEM COMPRISING A
DISPOSABLE DOUBLE POINTED
INJECTION NEEDLE**

CROSS-REFERENCE TO RELATED
APPLICATIONS

This application is a continuation of U.S. application Ser. No. 10/379,021 filed on Mar. 4, 2003, now abandoned, which is a continuation of U.S. application Ser. No. 09/870,276 filed May 30, 2001 and issued as U.S. Pat. No. 6,547,764, and claims priority under 35 U.S.C. 119 of Danish application PA 2000 01790 filed Nov. 28, 2000; European application EPO 00610052.3 filed May 31, 2000 and U.S. provisional application 60/254,051 filed Dec. 7, 2000, the contents of all of these applications are fully incorporated herein by reference.

THE TECHNICAL FIELD OF THE INVENTION

The invention relates to a disposable double pointed injection needle having an injection part with a skin piercing end and a cartridge part for inserting into a cartridge containing a liquid medicine to be injected subcutaneously. The cannula of the injection needle is fastened in a needle hub for mounting on a syringe, which syringe supports the cartridge into which the cartridge part of the injection needle penetrates.

The invention further relates to an insulin injection system comprising a pen shaped syringe supporting a cartridge with insulin, a dose setting and injection mechanism and a disposable double pointed injection needle.

DESCRIPTION OF RELATED ART

Injections where a liquid is expelled into the human body are usually performed either as intramuscular injections i.e. injections into the muscle tissue, or as subcutaneously injections i.e. injections into the subcutaneous tissue lying between the cutis and the muscle tissue.

When performing intramuscular injections of a vaccine it is according to British Medical Journal, volume 321, p. 931, important to use long injection needles in order to avoid local reactions such as redness and swelling. According to the article, use of injection needles having a length of 25 mm reduced the rate of local reaction significantly compared to an injection needle having a length of 16 mm.

Long injection needles must have a relatively large diameter in order not to break during injection. The injection needles referred to in the above mentioned article has a diameter of 23 G for the 25 mm long injection needle and 25 G for the 16 mm long injection needle.

The outside diameters of injection needles are indicated by a "G" and a gauge number increasing with thinner needles. Thus the outside diameter of a G 23 is 0,60 mm and of a G 25 0,50 mm

It has for some years been known to provide long injection needles with safety protective devices in order to prevent accidental needle stick injuries. Such safety protective devices are e.g. known from EP 409.180 and U.S. Pat. No. 4,813,940. These known safety protective devices comprises a number of telescopic sleeves, which telescopic sleeves slides into each other in order to expose an injection needle covered by the telescopic sleeves when not in use. The injection needles used has opposite the skin piercing end a needle connector for connecting the injection needle with an ordinary hypodermic syringe. By the expression "ordinary hypo-

2

dermic syringe" is meant a syringe of the type where the medicine to be injected is drawn from a vial into the syringe prior to each injection. In practical use the medicine has to flow through the injection needle twice for every injection when using such an ordinary hypodermic syringe, but due to the large diameter and the large bore of a long injection needle clogging is not a problem.

U.S. Pat. No. 5,429,612 discloses yet another long injection needle having a safety protective sleeve which can be moved into a position where the safety protective sleeve covers the injection part of the needle cannula. As can be seen in FIG. 1 of U.S. Pat. No. 5,429,612 the injection part of the needle cannula has a length, which makes it necessary to support the needle cannula by at least one disk **21**. The syringe is loaded with a flask containing the medicament to be injected. Since the syringe has no dose setting and injection mechanism like the ones known from insulin injection pens, the entire content of the flask is emptied into the patient in one injection, which is the usual procedure when injecting anesthesia in dentistry. When using the embodiments shown in FIG. **2** and **3**, the user must manually rotate the shield after use in order to bring the tongue **26** from the first track **23** and into the second track **24**. Doing so the user is exposed to a great danger, since the rotation must be done after the contaminated needle cannula has been retracted from the body of the patient.

When providing long injection needle with safety protective sleeves there are hardly any limitation to the length of the injection needle as long as the relationship between the length and the diameter is sufficient to prevent unwanted needle breakage. The muscular tissue is in a human body normally located approximately 10 to 14 mm below the surface of the skin. The part of a long injection needle entering the human body therefore has to be at least 14 mm in order to reach into the muscular tissue of the human body. As can be seen from the prior art injection needles, the length of the needle cannula from its fastenings point in the needle connector to its skin piercing end is substantially longer than the part of the needle cannula, which enters the human body during injection. This presents however no problem since these needle has a large diameter sufficient to withstand breakage.

Some medicines however has to be injected subcutaneously i.e. in the subcutis lying between the cutis and a muscle membrane which cover the underlying muscles. If for instead insulin for treating diabetes is injected into the muscle tissue it will be absorbed in the body to quickly and an unwanted drop in the blood sugar may be the result. In order to prevent intramuscular injection of insulin it is quite common for people suffering from diabetes to inject into a lifted skin fold. It is however becoming more and more preferred by diabetic persons to inject directly at an angle of 90° without the skin fold, using an extra short needle. The extra short needle must have an overall length of the injection part of the needle cannula short enough to avoid intramuscular injections. Such extra short needles are e.g. known from WO 97.233, which discloses an injection needle having an overall length of the injection part laying in the interval 4 to 6 mm.

Very short injection needle are not subject to breakage in the same degree as long injection needles, and can therefore be made with a much smaller diameter. WO 93.00948 reveals a short injection needle, having an injection part in the interval 8 to 12 mm, for injecting insulin. The diameter of the needle cannula is thinner than G 29. Such short and thin needles cannot be used in connection with an ordinary hypodermic syringe where the medicine is drawn up from a vial prior to each injection since this requires the medicine to flow through the needle twice for every injection, which can result

3

in clogging of the bore of the injection needle, especially if the medicine is a suspension. However when the short and thin needle are used in connection with a syringe supporting a cartridge containing the medicine to be injected, the medicine only has to flow through the injection needle once which in itself halves the risk of clogging, and thereby allows very thin injection needles to be used. At the same time, when an injection needle has only a small diameter both outside and inside, the pressure needed to force a liquid through the bore of the injection needle is high when the injection needle is long, but substantially smaller if the injection needle is short.

DESCRIPTION OF THE INVENTION

These known short and thin injection needles are however not provided with any safety protective devices, while the safety protective sleeves known from the prior art would permanently cover a large part of the injection part of the injection needle thereby preventing a short injection needle from penetrating through the cutis layer, which layer usually is between 2 to 3 mm thick, and into the subcutis layer of a human body.

Injection needles with relatively thin diameter and with a length of the injection part of the needle cannula between 4 to 12 mm are often used for self-injection of insulin i.e. where the patient injects him or herself. However for self-injection in private settings, safety protective devices providing safety against accidental needle stick injuries are not considered to be important, since no other person beside the patient performing the self-injection has contact with the injection needle. Safety protective devices providing safety against accidental needle stick injuries would however be preferred in domestic residences if other people, and especially children, are present in the domestic residence.

It is however very important in hospital settings where many people interacts to use injection needles, which are provided with some kind of safety protective device preventing accidental needle stick injuries. All the prior art injection needles provided with safety protective devices are long injection needles for intramuscular injections. These long injection needles are often of the type used on traditional hypodermic syringes where the medicine has to flow through the bore of the needle twice for every injection thereby limiting the minimum diameter of the bore and the outside diameter of the injection needle. Hospitalised people suffering from diabetes are usually injected with these long injection needles having a relatively large outside diameter. This is also the case with senior citizens in retirement homes, with children in schools and in day-care facilities, in fact every place an insulin injection is performed by a professional health care worker long injection needles are used, since they are the only ones providing sufficient safety for the health care worker. The health care worker giving the injection using a long needle has to be very careful only to penetrate into the subcutis layer in order for the insulin to be correctly absorbed in the human body, and at the same time the large diameter of a long injection needle gives the patient a high pain perception. No matter how careful health care workers are when injecting insulin, the insulin will sometimes unintended be injected into the muscle tissue, with the subsequent changes in insulin absorption and diabetes control. Patients which are newly diagnosed with diabetes and not familiar with self-injection often finds a long injection needle with a large diameter very intimidating, which is also the case with children. At the same time needles with large diameters tends to fracture the skin more than thin needles.

4

It is an object of the present invention is to provide a short and thin disposable double pointed injection needle for subcutaneously injection, which overcomes the deficiencies of the prior art. It is further an object to provide a short and thin disposable double pointed injection needle which is equipped with a safety protective device preventing accidental needle stick injuries, and which injection needle could be used on a modern type syringe supporting a cartridge containing a liquid medicine.

This is obtained by a disposable double pointed injection needle according to claim 1.

The short and thin injection needle is provided with a movable needle protector which allows normal use of the injection needle during injection, and which movable needle protector once the injection is done can be shifted manually or automatically into a position where the movable needle protector covers the skin piercing end of the needle cannula in an irreversible manner. When the skin-piercing end of the cannula is covered, the injection needle can be removed from the syringe and disposed off without endangering the people performing the injection and the people disposing of the used injection needles. The cartridge part of the needle cannula is permanently covered by the hub preventing the cartridge part of the needle cannula from accidental penetrating the skin of the persons handling the injection needle.

Hospitalised people suffering from diabetes or a similar disease is hereby provided with a disposable double pointed injection needle which only penetrates into the subcutis layer of the human body during injection and which at the same time offers sufficient protection against accidental needle sticks. This will relieve the patients from the variations in the depth of penetration occurring when injections are given using long injection needles and provide safety for the health care workers at the same time. Since the disposable double pointed injection needle is both short and thin, the pain perception will be very low.

Since especially children are very sensible to the appearance of the injection needle, a short disposable double pointed injection needle where a major part of the injection part of the needle cannula is hidden inside the boundaries of a safety shield prior to injection will make it psychologically easier for a child to accept the fact that daily injections of a liquid medicament such as insulin or growth hormone is needed.

When as disclosed in claim 2, the movable needle protector is a cylinder-shaped safety shield surrounding at least the major part of the injection part of the needle cannula when the needle cannula is in an unused state, and which cylinder-shaped safety shield can be longitudinal moved relatively to the needle cannula, such that the safety shield is first moved in the proximal direction when the injection part of the cannula is penetrated into the subcutis layer of a human body, thereby exposing the major part of the injection part to the human body, and which safety shield automatically moves in the distal direction until the cannula is fully surrounded by the safety shield when the injection part of said cannula is removed from the subcutis layer of a human body, it is ensured that the entire injection part of the needle cannula is securely covered at all times during the injection.

In a preferred embodiment of the disposable double pointed injection needle according to the invention the safety shield is automatically moved in the distal direction when the injection part of the cannula is removed from the subcutis layer of the human body by a resilient element such as a helical spring, which resilient element is located between the needle hub and the safety shield, and which resilient element is tighten when the injection part of said cannula is penetrated into the subcutis layer of the human body. Such an automatic

5

movement by a spring or another resilient element ensures that the shield is always moved into the position where it covers the injection part of the needle cannula without the need of the user to manually push the shield into this position. Any type of resilient element can be utilized, although it is preferred to use a helical spring. Such a helical spring can be either metallic or made from a polymeric material.

When as disclosed in claim 4, the safety shield is guided on the outside surface of the needle hub, it is ensured that the safety shield can be pushed all the way back such that a major part of the injection part of the needle cannula of the injection needle is exposed to the human body during injection thereby limiting the overall length of the needle cannula of the injection needle.

When, as disclosed in claim 5, the safety shield is provided with a number of inwardly pointed projections guided in guiding tracks provided on the external surface of the needle hub, it is ensured that the shield moves relatively to the needle cannula and the needle hub in a predetermined pattern.

In yet a preferred embodiment of the disposable double pointed injection needle according to the invention at least two guiding tracks are located opposite each other on the needle hub each comprises a first part being substantially parallel to the needle cannula and a second part being connected to the first part at an acute angle. Two, three or more guiding tracks provide stability to the shield, and an acute angle between the two parts of each track provides a smooth movement of the shield.

When, as disclosed in claim 7, one of the parts of the guiding tracks is open at the distal end of the needle hub allowing the projections to enter each guiding track, and that the open part of each guiding track at the distal end is provided with an elevation, it is ensured that the projections are easily inserted in the tracks, and that once located in the guiding tracks is prevented from sliding out of grip with the guiding track. The part of the guiding tracks being open at the distal end can either be the first part or the second part.

In another embodiment of the disposable double pointed injection needle according to the invention, each projection can be shifted between three different locations in the guiding track:

a first location where the safety shield surrounds at least the major part of the injection part of said cannula, and in which location said needle cannula is in an unused state

a second location where the major part of the injection part is exposed to the human body, and in which location the needle cannula is penetrated into the human body, and

a third location where the safety shield fully surrounds the injection part of the cannula, and in which location the cannula is fully removed from the human body.

By having the projections and the shield move relatively to the needle hub in the pattern described in claim 8, it is ensured that the major part of the needle cannula extending in the distal direction from the needle hub is inserted into the human body during injection.

When, as disclosed in claim 9, at least one of the guiding track has at least one elevation with a steep front preventing the projection from moving backwards in the guiding track when the projection has entered the second or/and the third position, it is ensured that the safety shield can not be moved in the backward direction once an injection has commenced

When, as disclosed in claim 10, one of the elevations is formed as a hole or a well located at the end of one of the guiding tracks near to the distal top end of the needle hub, and the projection drops into the hole or well when the projection is in the third location, such that the safety shield is irreversibly locked to the needle hub when said cannula is fully

6

removed from the human body, it is ensured that the safety shield is irreversibly locked to the needle hub when the needle cannula is fully removed from the human body thereby preventing reuse of said injection needle.

When, as disclosed in claim 11, the disposable double pointed injection needle further comprises a container surrounding the needle hub, the needle cannula, the resilient element and the safety shield, and which container has inwardly pointing ribs engaging similar outwards pointing ribs on the needle hub, it is ensured that the rotational force emerging when the container is rotated is transferred to the needle hub.

It is also an object of the present invention to provide a pen based insulin injection system, which can be used in hospital settings or other public places without exposing the professional people working in these places to accidental needle stick injuries.

This is obtained by an insulin injection system according to claim 12.

By having a complete system comprising both a pen shaped syringe supporting a cartridge and a short and thin safety engineered injection needle with a needle protector, a complete pen based injection system for the treatment of diabetes can now be used in hospitals only using needle-based medical devices designed to provide health care workers with additional protection against accidental needle stick injuries and potential exposure to infectious diseases. In one embodiment of the disposable double pointed injection needle according to the invention the injection needle is further provided with means providing the user with a visual indication when the injection needle is in a potentially unsafe position. In another embodiment of the disposable double pointed injection needle according to the invention the injection needle is further provided with means providing the user with a visual indication when said disposable double pointed injection needle is in a potentially safe position. As the disposable double pointed injection needle according to the invention has previously been described it is somewhat difficult for the user to visible inspect if the disposable double pointed injection needle has been used. This problem is overcome by providing the disposable double pointed injection needle with means according to claim 13 and/or 14.

When, as disclosed in claim 15, the means providing the user with a visual indications comprises at least one transparent area in the movable needle protector and at least one first area and/or at least one second area located on the outside surface of the needle hub, and as disclosed in claim 16, the first areas located on the outside surface of the needle hub is visible through the transparent areas when the projection is in the first location, and/or that said second areas located on the outside surface of the needle hub is visible through the transparent areas in said movable needle protector when the projection is locked in said third location, it becomes very simple for an user to inspect whether the disposable double pointed injection needle is unused or not.

When, as disclosed in claim 17, the first areas and/or the second areas are provided with different colours or symbols, it is ensured that even users with poor sight can visible inspect whether the disposable double pointed injection needle has been used or not.

In the present context, the term 'injection' is taken to mean expelling a liquid along a hollow needle or another hollow conduit and into a human body, in which human body a part of the hollow needle or conduit is temporarily inserted.

Although the wording "human body" is used through out this application, the disposable double pointed injection

needle claimed could as well be used on any mammal body without dispersing from the scope of the claims.

In the present context, the term “cartridge” is taken to mean a hollow tube-like container having one end permanently sealed by a membrane, which membrane is penetrated by the cartridge part of the needle cannula when the double pointed injection needle is attached to the cartridge or the syringe. The other end of the cartridge is a displaceable plate or cylinder that fits tightly against the inner walls of the cartridge. A discrete dose is expelled through the double pointed injection needle attached to the cartridge or the syringe if the plate or cylinder is displaced in the direction towards the permanent membrane penetrated by the cartridge part of the double pointed injection needle.

The cartridge containing the medicine is usually supported in the distal end of the housing of the syringe. The cartridge can either be permanently fastened in the housing or it can be exchangeable. If the cartridge is permanently fastened in the housing, the entire syringe is disposed of when the cartridge is empty, but if the cartridge is exchangeable then only the empty cartridge is disposed of and a new, full cartridge is loaded into the housing of the syringe.

It is to be understood that the wording “pen shaped syringe”, used throughout this application, merely refers to a syringe having an oblong or elongated shape and which fits into one hand, somewhat like a pen for writing. Although such writing pens usually have a tubular cross-section, modern writing pens often have a different cross-section such as triangular, rectangular or square. Pen shaped syringes can in a similar way have a large variety of different cross-sections.

When referring to the disposable double pointed injection needle according to the present application the term “relatively thin outside diameter” is taken to mean a needle cannula having an outside diameter thinner than G28. The use of G28 needle cannulas for injecting insulin has for many years been widely accepted as the standard size, and G29 or thinner needle cannulas are therefore often referred to as “thin injection needles”. The needle cannula of the disposable double pointed injection needle can be as thin as 31G or even 32G.

A “G” and a gauge number increasing with thinner needles indicate the outside diameter of the needle cannula. The following table indicates the relation between the gauge number and the outside diameter of the needle cannula, for the gauge numbers referred to in the present application.

	Gauge:						
	23G	25G	27G	29G	30G	31G	32G
Diameter:	0.60 mm	0.50 mm	0.40 mm	0.33 mm	0.30 mm	0.25 mm	0.23 mm

The part of the needle cannula referred to as the “cartridge part” is the part entering the cartridge, which is to be understood as the part extending in the proximal direction from its fastening point in the needle hub, while the part referred to as the “injection part” of the needle cannula is the part entering the human body during injection, which is to be understood as the part extending in the proximal direction from its fastenings point in the needle hub. The injection part extending in the proximal direction from its fastening point in the needle hub is often a little longer than the part actually penetrating into the human body. The length different between the injection part and the part actually penetrating into the human body depends on the height of the hub tower and the wall thickness of the top surface of the safety shield. Usually the part of the

needle cannula, which penetrates into the human body has a length between 4 to 12 mm, such that the depth of penetration lies between 4 to 12 mm. In the present context, the term “dose setting and injection mechanism” is taken to mean a mechanism by which a desired dose of a liquid medicine contained in a cartridge can first be set and later injected, leaving the remaining part of the liquid medicine in the cartridge. The mechanism can either be mechanical or electronic, or both. The injection is usually done by having a mechanical element pressing forward the plate or cylinder inside the cartridge in correspondence with the set dose. The force used for driving forward this mechanical element is preferably delivered either physically by the user or by an electrical motor.

In the present context, the term “subcutaneously” refers to the subcutis layer of the human body, which are the layer located between the cutis and a muscle membrane covering the muscular tissue. By a number of measurements it is found that the average depth of the muscle membrane is 9,5 mm for males and 13,8 for females, measured from the outside of the human skin. Recognizing that the emission of liquid from an injection needle, due to the oblique cut end of the skin piercing end of the needle cannula, takes place in a distance from the skin piercing end in the range 0,4 to 1,2 mm, an injection needle for subcutaneously injections should preferably have an length of the part penetrating into the subcutaneous layer shorter than approximately 10 mm. Although an injection needle having a length of this part, which equals the depth of penetration, up to approximately 14 mm would be acceptable for females. In order to ensure penetration of the cutis of a human being, the minimum length of the part of the needle cannula penetrating the subcutaneous layer must be longer than approximately 4 mm.

BRIEF DESCRIPTION OF THE DRAWINGS

The invention will be explained more fully below in connection with a preferred embodiment and with reference to the drawings in which:

FIG. 1 Shows an exploded view of the disposable double pointed injection needle according to the invention.

FIG. 2 Shows a sectional view of the disposable double pointed injection needle according to the invention.

FIG. 3 Shows a sectional view of the safety shield according to an embodiment of the invention.

FIG. 4 Shows a sectional view of the needle hub according to an embodiment of the invention.

FIG. 5 Shows a sectional view of the top of the safety shield and of the skin-piercing end of the needle cannula.

FIG. 6 Shows a perspective view of the needle hub according to an embodiment of the invention.

FIG. 7 Shows a perspective view of the disposable double pointed injection needle with the visual indication showing that the disposable double pointed injection needle is in an unlocked position.

FIG. 8 Shows a perspective view of the disposable double pointed injection needle with the visual indication showing that the disposable double pointed injection needle is in a locked position.

The figures are schematic and simplified for clarity, and they just show details, which are essential to the understanding of the invention, while other details are left out. Throughout, the same reference numerals are used for identical or corresponding parts.

DETAILED DESCRIPTION OF EMBODIMENT

Initially it may be convenient to define that, the term “distal end” of the disposable double pointed injection needle

according to the invention is meant to refer to the end 2 penetrating into the human body 11, whereas the term "proximal end" is meant to refer to the opposite end 3 entering into the cartridge 12.

FIG. 1 and 2 shows the disposable double pointed injection needle according to the invention. The injection needle comprises of five main parts: a needle cannula 1, a needle hub 4, a safety shield 10, a resilient element 21 and a container 13.

The needle cannula 1 is elongated and both ends 2, 3 are sharpened usually by being cut in an oblique cut. The needle cannula 1 is firmly fastened in a needle hub 4. The distal part of the needle cannula 1 extending from the fastening point in the needle hub 4 is referred to as the injection part 8, and the part extending in the proximal direction from its fastening point in the needle hub 4 is referred to as the cartridge part 9.

The needle hub 4, which is separately shown in FIG. 4, has a distal end 5 and a proximal end 6. The proximal end 6 is on the interior surface provided with a thread 7, which fits over an external thread on the cartridge 12 or on a not shown syringe carrying the cartridge 12. In this way the disposable double pointed injection needle can easily be connected and disconnected to the cartridge 12 or the syringe carrying the cartridge 12. The needle hub 4 can be provided with a not shown cover covering the cartridge part 9 of the needle cannula 1. This not shown cover can be connected to the needle hub 4 by a hinge, such that the cover can be opened prior to connecting the needle hub 4 to a syringe, and closed when the needle hub 4 has been disconnected from a syringe.

The needle hub 4 has at the distal end a centrally located hub tower 15 surrounded by a circular well 14 through which a channel 16 reaching all the way through the needle hub 4 to the proximal end 6 is formed. The needle cannula 1 is under manufacturing placed in this channel 16, and the channel is filled with glue or other material, which can firmly fasten the needle cannula 1 to the needle hub 4. The glue used could e.g. be ordinary glue for gluing metal to a polymeric material, or it could be glue which is harden by use of UV light. Instead of using glue, the material of the hub 4 could be melted to fasten the needle cannula 1 to the hub 4. The height of the hub tower 15 and the length of the channel 16 can vary depending on the type of the disposable double pointed injection needle. A longer channel 16 gives a better control over the sideways movements of the needle cannula 1 during manufacturing. If wanted the hub tower 15 can have a height such that the distal end of the hub tower 15 aligns the distal top surface 17 of the needle hub 4. The depth of the well 14 is chosen such that the well 14 can support a resilient element in the form of a helical spring 21 which is located between the needle hub 4 and the safety shield 10 pressing the safety shield 10 away from the needle hub 4.

The needle hub 4 is on the outside surface provided with a number of tracks 18 into which tracks 18 a number of projections 22 located on the safety shield 10 fits. At the proximal end 6, the needle hub 4 is provided with a number of outward pointing ribs 19, which interacts with a number of inwardly pointing ribs 20 located on the inside surface of the container 13.

The safety shield 10, which is shown in FIG. 3 is guided on the outside surface of the needle hub 4 as shown in FIG. 2. The safety shield 10 is on the inside surface provided with a number of inwardly pointing projections 22. Each of these projections 22 can, as shown, be carried on a resilient arm 23 formed as an integral part of the safety shield 10. The projections 22 can however be moulded directly on the inside surface of the safety shield in which case they would not be visible from outside the safety shield 10, as shown in FIG. 7 and FIG. 8. The safety shield 10 is formed as a cup or a hat and

closed on all sides except the proximal side, which fits over the needle hub 4. At the distal end, the safety shield 10 is provided with a bore 25 large enough for the needle cannula 1 to pass through.

When the safety shield 10 is located on the needle hub 4 and the disposable double pointed injection needle is in its initial position, the skin-piercing end 2 of the needle cannula 1 could be located a little above the safety shield 10 as shown in FIG. 2. Prior to each injection, the user must perform a so-called airshot in order to press any air contained in the cartridge 12 out through the needle cannula 1. When doing this, it is somewhat important that the user can visible inspect that all the air is pressed out and only fluent medicine is expelled from the needle cannula 1. Due to this the skin-piercing end 2 of the needle cannula 1 must be visible. One way of making the skin-piercing end 2 of the needle cannula 1 visible is by making the needle cannula 1 long enough to extend a little beyond the safety shield 10, although having the skin-piercing end 2 of the needle cannula 1 align the top surface of the safety shield 10 would be sufficient. Another solution could be to make the needle cannula 1 short enough to be within the boundaries of the safety shield 10 and make the safety shield 10 transparent or partly transparent. Yet another solution could be to keep the needle cannula 1 short enough to be within the boundaries of the safety shield 10 and to cut away a fraction 26 of the top of the safety shield 10 making the skin-piercing end 2 of the needle cannula 1 partly visible, as indicated with dashed lines in FIG. 5.

The hub 4 is on the outside provided with a number of tracks 18, which is best seen in FIG. 4 and in FIG. 6. Each track 18 has a first part 27 being substantially parallel to the needle cannula 1 and open at the top surface of the needle hub 4. A second part 28 of the track 18 is connected to the first part 27 at an acute angle and extends in the direction towards the distal end of the needle hub 4. When the safety shield 10 is mounted over the needle hub 4, the projection 22 is passed into the first part 27 of the track 18. This first part 27 of the track 18 is provided with an elevation 29 having a sloping front allowing the projection 22 to pass over the elevation 29 and a step backside preventing the projection 22 from moving out of the track 18 once located there.

If wanted the second part 28 of the track 18 could be the part parallel to the needle cannula 1, the first part 27 would then be connected to the second part at an acute angle.

A certain degree of resiliency between the projections 22 and the tracks 18 is desired. Such a resiliency can be obtained either by providing the safety shield 10 with resilient arms 23 carrying the projections, or by making the bottom of the tracks 18 resilient e.g. by only connecting the bottom of the tracks 18 to the needle hub 4 in some areas.

During injection, as shown in FIG. 2, the safety shield 10 is pressed back against the force of the helical spring 21 by the skin of a human body 11. When the needle cannula 1 is fully inserted into the subcutaneous layer of the human body, the projection 22 enters into the second part 28 of the track 18. The two parts 27, 28 of the track 18 is separated from each other by yet an elevation, which elevation has a steep backside preventing the projection 22 from sliding back into the first part 27 of the track 18 once the projection 22 has entered into the second part 28 of the track 18. When the needle cannula 1 is removed from the subcutaneous layer of the user, the projection 22 will slide along the second part 28 of the track 18, and once the needle cannula 1 is fully retracted from the user the projection 22 will drop into a hole or well 31 where it will be permanently locked.

While commencing the injection the projection 22 is located in the first part 27 of the track 18 between the first

11

elevation 29 and the second elevation, as indicated in FIG. 2, where the position of the track 18 is indicated with dashed lines. The front of the second elevation has a sloping surface, which the projection 22 has to climb before entering the second part 28. The slope of this front is chosen such that the user must overcome a certain force before the projection 22 reaches the top of the elevation. For people suffering from needle anxiety it is preferred to locate the skin-piercing end 2 of the needle cannula 1 out of sight i.e. inside the boundaries of the safety shield 10, and to maximize the force a user has to apply before the safety shield 10 starts to move. Making the slope of the front of the second elevation 30 steep can maximize this force. By doing so a certain force applied by the user has to be build up before the safety shield 10 starts to move, the movement will then be rather sudden once the force is release, which is done when the projection 22 has started to be lifted over the elevation 30. The sudden release of the build up force will result in a very rapid insertion of the skin-piercing end 2 of the needle cannula 1 into the subcutaneous layer of the human body.

The most distal end of the safety shield 10 could be moulded with a textured outside surface in order to increase the friction between the skin of the human body and the surface of the safety shield 10 during injection.

When the injection needle is in the initial position ready to be inserted into the human body the safety shield 10 surrounds at least the major part of the injection part 8 of the needle cannula 1, leaving only the tip of the skin piercing end 2 of the needle cannula 1 free to be inspected when an air-shot is performed, as shown in FIG. 2. Once the needle cannula 1 is fully inserted into the human body, the major part of the injection part 8 is exposed to the human body. The only part of the injection part 8 of the needle cannula 1 not being exposed to the human body is the part lying between the fastening point in the needle hub 4 and the top surface of the safety shield 10. The length of this part depends on the height of the hub tower 15 and the wall thickness of the top surface of the safety shield 10.

In order to provide the user with a clear visible indication that the injection needle has been used, the safety shield 10 can be provided with at least one transparent area 32, which in its simplest form could be a hole in the safety shield 10. Through this transparent area 32 the user can see a first area 33 on the outside surface of the needle hub 4. Since the first part 27 of the tracks 18 is located at an acute angle to the second part 28, the safety shield 10 will rotate some degrees—depended upon the angle—relatively to the needle hub 4 when an injection is performed. This rotation will bring the transparent area 32 to a second area 34 also located on the outside surface of the needle hub 4.

If more than one transparent area 32 are provided, a corresponding numbers of first areas 33 and second areas 34 can be provided, such that a first area 33 is visible through each transparent area 32 prior to use, and that a second area 34 is visible through each transparent area 32 when the shield 10 is irreversible locked in the third position after use.

When the injection needle is in the initial position ready to be inserted into the human body, the projection 22 is located in the first part 27 of the track 18. In this position the first area 33 on the outside surface of the hub 4 is visible through the transparent area 32 of the safety shield 10. After the injection, the projection 22 is located in the hole or well 31, and the transparent area 32 of the safety shield 10 is dislocated such that the second area 34 is now visible through the transparent area 32.

Since the colour of the first area 33 indicates that the disposable double pointed injection needle is ready for use,

12

this colour is usually green, black, blue or white. The second area 34 indicating that the disposable double pointed injection needle has been used will typically be red, orange or yellow. However it could be possible to indicate that the safety needle is in a potential unsafe position by colouring the first area 33 in a colour indicating danger, and henceforth colour the second area 34 in a colour indicating that the safety needle is in a potentially safe position. Instead of colouring the areas 33, 34 symbols or letters indicating the state of the disposable double pointed injection needle could be used. The colours, symbols or letters can be applied to the outside surface of the needle hub using inks, coatings or mouldings. The areas 33, 34 could be moulded with a depressed or textured surface in order to enhance the adherence of the colour.

The disposable double pointed injection needle is delivered ready to use either in a sterile peel bag or in a container 13. The container 13 fully houses the needle hub 4, the needle cannula 1, the helical spring 21 and the safety shield 10 before use. The proximal end of the container 13 constitutes a peripheral surface 24 onto which a not shown peelable barrier is fastened. The barrier could be a sheet made of paper or from a polymeric or metallic sheet, and is preferably glued, melted or welded on to the surface 24. The barrier is impermeable by germs such that the inside of the container is kept sterile until the barrier is broken. Although the barrier is impermeable to germs and the like, it is possible to sterilize the interior of the sheath e.g. with steam.

The proximal end of the container 13 is on the inside surface provided with a number of inwardly pointing ribs 20, which interacts with a similar number of outwardly pointing ribs 19 located on the proximal end 6 of the needle hub 4. If the fastening mechanism located on the inside surface of the needle hub 4 is a thread 7 as shown in FIG. 2, this thread 7 has to be screwed onto the thread of the cartridge 12 or the not shown syringe in order to connect these two parts. This is done by rotating the container 13 containing the disposable double pointed injection needle. When the rotational force emerging when the container 13 is rotated relatively to the cartridge 12 or the not shown syringe is transferred directly to the needle hub 4, the rotational force is prevented from damaging the tracks 18 and the projections 22.

Instead of delivering the disposable double pointed injection needle to the consumer in a separate container, the safety shield 10 itself could be used as a sterile confinement simply by prolonging the safety shield 10 in the proximal direction such that the safety shield 10 fully surrounds the needle hub 4 when the safety shield 10 is in its ready-to-use position shown in FIG. 2. The proximal end of the safety shield 10 would then have to be sealed by a peelable barrier, and the hole 25 through which the needle cannula 1 passes during injection would also have to be sealed by a peelable barrier or by a drop of a soft material which can be penetrated by the needle cannula 1 e.g. silicone. The resilient arms 23 carrying the projections 22 could then be made such that the surface of the safety shield 10 was not penetrated as shown in FIG. 7 and in FIG. 8.

Some preferred embodiments have been shown in the foregoing, but it should be stressed that the invention is not limited to these, but may be embodied in other ways within the subject matter defined in the following claims.

The invention claimed is:

1. A safety pen-needle assembly comprising:

- a. a needle hub;
- b. a needle having a cannula having a first portion with a sharpened distal end, the first portion protruding distally

13

- from the hub and a second portion protruding proximally from the hub and having an end for piercing a sealable membrane;
- c. a sliding cover that slides over the cannula to conceal the sharp end of the first portion of the cannula, the cover 5 being capable of sliding in a proximal direction away from the sharp end thereby exposing the sharp end so that it may be used to penetrate a portion of skin on a patient
- d. a biasing means for keeping the cover over the sharp end 10 of the first portion unless a force is exerted to slide the cover proximally away from the sharp end of the first portion;
- e. a locking means for irreversibly locking the cover over the sharpened end of the first portion after an injection has been administered with the needle;

14

- f. a visual indicating means for visually indicating that the needle has been previously used to administer an injection.
- 2.** An injection needle assembly comprising:
- a. a needle hub;
- b. a needle cannula mounted in the hub, at least a portion of the cannula protruding distally from the hub and having a sharpened skin piercing end;
- c. a means for covering and uncovering the sharpened end;
- d. a means for irreversibly locking the covering means over the sharpened end;
- e. a means for visually indicating that the covering means is locked over the sharpened end.

* * * * *

UNITED STATES PATENT AND TRADEMARK OFFICE
CERTIFICATE OF CORRECTION

PATENT NO. : 8,075,522 B2
APPLICATION NO. : 11/097414
DATED : December 13, 2011
INVENTOR(S) : Carsten G. Larsen et al.

Page 1 of 1

It is certified that error appears in the above-identified patent and that said Letters Patent is hereby corrected as shown below:

Title Page, item 57

**** Please replace “fasten” with the word “fastened” in the second line of the Abstract ****

Signed and Sealed this
Fourteenth Day of February, 2012

A handwritten signature in black ink, reading "David J. Kappos". The signature is written in a cursive, flowing style with a large initial 'D' and 'K'.

David J. Kappos
Director of the United States Patent and Trademark Office