



US007563991B2

(12) **United States Patent**
Twitchell, Jr. et al.

(10) **Patent No.:** **US 7,563,991 B2**
(45) **Date of Patent:** **Jul. 21, 2009**

(54) **ALL WEATHER HOUSING ASSEMBLY FOR ELECTRONIC COMPONENTS**

5,117,501 A 5/1992 Childress et al.
5,129,096 A 7/1992 Burns
5,210,540 A 5/1993 Masumoto

(75) Inventors: **Robert W. Twitchell, Jr.**, Cumming, GA (US); **Richard A. Clark**, Alpharetta, GA (US)

(Continued)

(73) Assignee: **Terahop Networks, Inc.**, Alpharetta, GA (US)

FOREIGN PATENT DOCUMENTS

EP 0467036 A2 1/1992

(*) Notice: Subject to any disclaimer, the term of this patent is extended or adjusted under 35 U.S.C. 154(b) by 616 days.

(Continued)

OTHER PUBLICATIONS

(21) Appl. No.: **11/423,127**

“Scalable Routing Strategies for Ad hoc Wireless Networks”, Atsushi Iwata et al., IEEE Journal on Selected Areas in Communications, Special Issue on Adhoc Networks, Aug. 1999, pp. 1369-1379.

(22) Filed: **Jun. 8, 2006**

(65) **Prior Publication Data**

(Continued)

US 2006/0289204 A1 Dec. 28, 2006

Related U.S. Application Data

Primary Examiner—Hung V Ngo
(74) *Attorney, Agent, or Firm*—Tillman Wright, PLLC; Chad D. Tillman; James D. Wright

(60) Provisional application No. 60/688,737, filed on Jun. 8, 2005.

(57) **ABSTRACT**

(51) **Int. Cl.**

H01R 13/502 (2006.01)
H01L 23/02 (2006.01)
H05K 5/06 (2006.01)

An all weather housing assembly for protection of electrical components includes a first housing having an open end and defining a first compartment for receipt therein of electronic components; a cover attached to the first housing for enclosing the first compartment, the cover further including a mounting structure for receiving and retaining a power source which structure is mounted on a side of the cover that is exterior to the enclosed first compartment; and a second housing having an open end and defining a second compartment that is dimensioned to cover and protect a power source when received and retained by the mounting structure of the cover, the second housing being connected to the first housing independent of the attachment of the cover to the first housing.

(52) **U.S. Cl.** **174/560**; 174/564

(58) **Field of Classification Search** 174/50, 174/382, 387, 559, 560, 564; 361/752
See application file for complete search history.

(56) **References Cited**

U.S. PATENT DOCUMENTS

4,613,990 A 9/1986 Halpern
4,680,583 A 7/1987 Grover
4,895,999 A * 1/1990 Calderon 174/67
5,040,238 A 8/1991 Comroe et al.

18 Claims, 7 Drawing Sheets

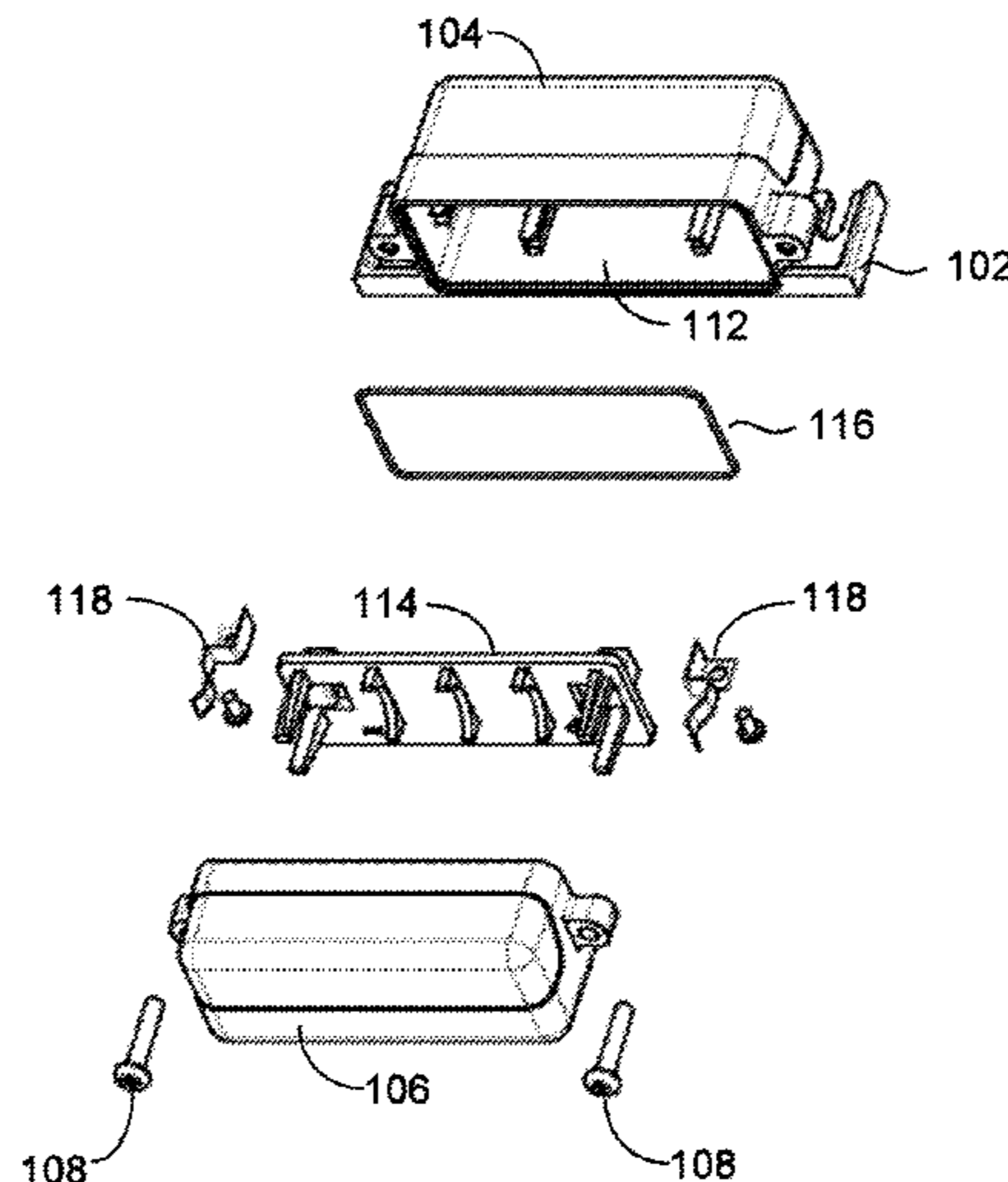

U.S. PATENT DOCUMENTS

5,265,025 A 11/1993 Hirata
 5,295,154 A 3/1994 Meier et al.
 5,331,637 A 7/1994 Francis et al.
 5,369,784 A 11/1994 Nelson
 5,400,254 A 3/1995 Fujita
 5,425,051 A 6/1995 Mahany
 5,442,758 A 8/1995 Slingwine et al.
 5,511,232 A 4/1996 O'Dea et al.
 5,579,306 A 11/1996 Dent
 5,590,409 A 12/1996 Sawahashi et al.
 5,596,652 A 1/1997 Piatek et al.
 5,604,892 A 2/1997 Nuttall et al.
 5,640,151 A 6/1997 Reis et al.
 5,652,751 A 7/1997 Sharony
 5,682,379 A 10/1997 Mahany et al.
 5,686,902 A 11/1997 Reis et al.
 5,732,077 A 3/1998 Whitehead
 5,761,195 A 6/1998 Lu et al.
 5,790,946 A 8/1998 Rotzoll
 5,793,882 A 8/1998 Piatek et al.
 5,833,910 A 11/1998 Teixeira
 5,890,054 A 3/1999 Logsdon et al.
 5,907,491 A 5/1999 Canada et al.
 5,917,423 A 6/1999 Duvall
 5,939,982 A 8/1999 Gagnon et al.
 5,943,610 A 8/1999 Endo
 5,950,124 A 9/1999 Trompower et al.
 5,974,236 A 10/1999 Sherman
 5,977,913 A 11/1999 Christ
 6,005,884 A 12/1999 Cook et al.
 6,006,100 A 12/1999 Koenck et al.
 6,072,784 A 6/2000 Agrawal et al.
 6,078,789 A 6/2000 Bodenmann et al.
 6,091,724 A 7/2000 Chandra et al.
 6,097,707 A 8/2000 Hodzic et al.
 6,104,512 A 8/2000 Batey, Jr. et al.
 6,118,988 A 9/2000 Choi
 6,125,306 A 9/2000 Shimada et al.
 6,127,976 A 10/2000 Boyd et al.
 6,134,587 A 10/2000 Okanoue
 6,192,400 B1 2/2001 Hanson et al.
 6,198,913 B1 3/2001 Sung et al.
 6,201,974 B1 3/2001 Lietsalmi et al.
 6,256,303 B1 7/2001 Drakoulis et al.
 6,313,745 B1 11/2001 Suzuki
 6,354,493 B1 3/2002 Mon
 6,360,169 B1 3/2002 Dudaney
 6,381,467 B1 4/2002 Hill et al.
 6,404,082 B1 6/2002 Rasinski et al.
 6,405,102 B1 6/2002 Swartz et al.
 6,409,082 B1 6/2002 Davis et al.
 6,418,299 B1 7/2002 Ramanathan
 6,424,260 B2 7/2002 Maloney
 6,424,264 B1 7/2002 Giralдин et al.
 6,427,913 B1 8/2002 Maloney
 6,473,607 B1 10/2002 Shohara et al.
 6,492,590 B1* 12/2002 Cheng 174/50
 6,512,478 B1 1/2003 Chien
 6,529,142 B2 3/2003 Yeh et al.
 6,542,114 B1 4/2003 Eagleson et al.
 6,547,137 B1 4/2003 Begelfer et al.
 6,559,620 B2 5/2003 Zhou et al.
 6,600,418 B2 7/2003 Francis et al.
 6,611,556 B1 8/2003 Koener et al.
 6,614,349 B1 9/2003 Proctor et al.
 6,649,836 B2* 11/2003 Brechbill et al. 174/60
 6,665,585 B2 12/2003 Kawase
 6,700,533 B1 3/2004 Werb et al.
 6,720,888 B2 4/2004 Eagleson et al.
 6,737,974 B2 5/2004 Dickinson
 6,745,027 B2 6/2004 Twitchell, Jr.

6,747,562 B2 6/2004 Giralдин et al.
 6,753,775 B2 6/2004 Auerbach et al.
 6,760,578 B2 7/2004 Rotzoll
 6,761,312 B2 7/2004 Piatek et al.
 6,765,484 B2 7/2004 Eagleson et al.
 6,816,063 B2 11/2004 Kubler et al.
 6,836,402 B1* 12/2004 Huang 361/601
 6,847,892 B2 1/2005 Zhou et al.
 6,934,540 B2 8/2005 Twitchell, Jr.
 6,935,894 B2* 8/2005 Fung 439/606
 6,940,392 B2 9/2005 Chan et al.
 6,975,614 B2 12/2005 Kennedy
 7,012,529 B2 3/2006 Sajkowsky
 7,027,773 B1 4/2006 McMillin
 7,098,784 B2 8/2006 Easley et al.
 7,126,470 B2 10/2006 Clift et al.
 7,133,704 B2 11/2006 Twitchell, Jr.
 7,142,121 B2 11/2006 Chan et al.
 7,155,264 B2 12/2006 Twitchell, Jr.
 7,191,934 B2 3/2007 Miller et al.
 7,200,132 B2 4/2007 Twitchell, Jr.
 7,209,468 B2 4/2007 Twitchell, Jr.
 7,209,771 B2 4/2007 Twitchell, Jr.
 7,221,668 B2 5/2007 Twitchell, Jr.
 7,390,978 B2* 6/2008 Dean et al. 174/521
 2001/0000019 A1 3/2001 Bowers et al.
 2002/0039896 A1 4/2002 Brown
 2002/0098861 A1 7/2002 Doney et al.
 2002/0119770 A1 8/2002 Twitchell, Jr.
 2002/0146985 A1 10/2002 Naden
 2003/0083064 A1 5/2003 Cooper
 2003/0141973 A1 7/2003 Yeh et al.
 2003/0144020 A1 7/2003 Challa et al.
 2003/0179073 A1 9/2003 Ghazarian
 2003/0209601 A1 11/2003 Chung
 2004/0021572 A1 2/2004 Schoen et al.
 2004/0041731 A1 3/2004 Hisano
 2004/0065466 A1* 4/2004 Compagnone, Jr. 174/66
 2004/0082296 A1 4/2004 Twitchell, Jr.
 2004/0100415 A1 5/2004 Veitch et al.
 2004/0121793 A1 6/2004 Weigele et al.
 2004/0135691 A1 7/2004 Duron et al.
 2004/0183673 A1 9/2004 Nageli
 2005/0043068 A1 2/2005 Shohara et al.
 2005/0093702 A1 5/2005 Twitchell, Jr.
 2005/0093703 A1 5/2005 Twitchell, Jr.
 2005/0215280 A1 9/2005 Twitchell, Jr.
 2005/0226201 A1 10/2005 McMillin

FOREIGN PATENT DOCUMENTS

EP 0748083 12/1996
 EP 0748085 12/1996
 EP 0829995 3/1998
 EP 1317733 A2 6/2003
 EP 1692599 A2 8/2006
 EP 1692668 A2 8/2006
 WO WO0068907 11/2000
 WO WO0069186 11/2000

OTHER PUBLICATIONS

“Cluster Based Routing Protocol”, Internet-Draft Mingliang, Jiang et al., National University of Singapore, Jul. 1999.
 Gary Morgan, Miniature Tags Provide Visibility & Cohesion for an LIA Battalion Level ‘Proof of Principle’, Pacific NW National Laboratory, Apr. 2001, Gary.morgan@pnl.gov.
 Ben Sommer et al., Group 4, Passive RF Tags.
 Kevin Sharp, Physical Reality: A Second Look, Supply Chain Systems, http://www.idsystems.com/reader/1999_03/phys0399_pt2/index.htm, Mar. 1999, Helmers Publishing, Inc.
 U.S. Appl. No. 60/444,029, of Nageli, filed Jan. 31, 2003.
 Ram Ramanathan et al., Hierarchically-Organized, Multihop Mobile Wireless Networks for Quality-of-Service Support, pp. 1-35, 1998.

Guangyu Pei et al., Mobility Management in Hierarchical Multi-hop Mobile Wireless Networks, 6 pages, 1999.

<http://www.iprg/nokia.com/charliep/txt/manet/term.txt>, Mobile Ad Hoc Networking Terminology, C. Perkins, Nov. 17, 1998, visited Nov. 13, 2000.

Daniel Lihui Gu et al., C-ICAMA, A Centralized Intelligent Channel Assigned Multiple Access for Multi-Layer Ad-Hoc Wireless Networks with UAVs, 6 pages, 2000.

Atsushi Iwata, et al., Scalable Routing Strategies for Ad Hoc Wireless Networks, IEEE Journal on Selected Areas in Communications, vol. 17, No. 8, Aug. 1999, pp. 1369-1379.

<http://www.cs.ucla.edu/NRL/wireless/PAPER/draft-ietf-manet-admrp-02.txt>, Sung-Ju Lee et al., On-Demand Multicast Routing Protocol (ODMRP) for Ad Hoc Networks, Jan. 2000, visited Nov. 13, 2000.

Guangyu Pei, et al., A Wireless Hierarchical Routing Protocol with Group Mobility, 1998 IEEE, 5 pages.

Charles E. Perkins, AD HOC Networks, Jan. 2001, table of contents, chapters 1, 4, and 11.

J.J. Gardia-Luna-Aceves et al., Source-Tree Routing in Wireless Networks, 1999, 10 pages.

Jean-Pierre Hubaux et al., Toward Self-Organized Mobile Ad Hoc Networks: The Terminodes Project, IEEE Communications Magazine, Jan. 2001, pp. 118-124.

Jaap Haartsen et al., Bluetooth: Vision, Goals, and Architecture, Mobile Computing & Communications Review, vol. 1, No. 2, 1998, 8 pages.

Jaap Haartsen, Bluetooth—The Universal Radio Interface for Ad Hoc, Wireless Connectivity, Ericsson Review No. 3, pp. 110-117, 1998.

Ezio Valdevit, Cascading in Fibre Channel: How to Build a Multi-Switch Fabric, pp. 1-12.

Daniel Lihui Gu et al., Hierarchical Routing for Multi-Layer Ad-Hoc Wireless Networks with UAV's, 5 pages, 2000.

U.S. Appl. No. 60/499,338, of Easley et al., filed Sep. 3, 2003.

Keshavarzian et al., Energy-Efficient Link Assessment in Wireless Sensor Networks, INFOCOM 2004. 23rd Annual Joint Conference of the IEEE Computer and Communications Societies, vol. 3, 2004, pp. 1751-1761.

Stojmenovic et al., Design Guidelines for Routing Protocols in Ad Hoc and Sensor Networks with a Realistic Physical Layer, Communications Magazine, IEEE, vol. 43, Issue 3, Mar. 2005, pp. 101-106.

Melodia et al., On the Interdependence of Distributed Topology Control and Geographical Routing in Ad Hoc and Sensor Networks, Selected Areas in Communications, IEEE Journal, vol. 23, Issue 3, Mar. 2005, pp. 520-532.

* cited by examiner

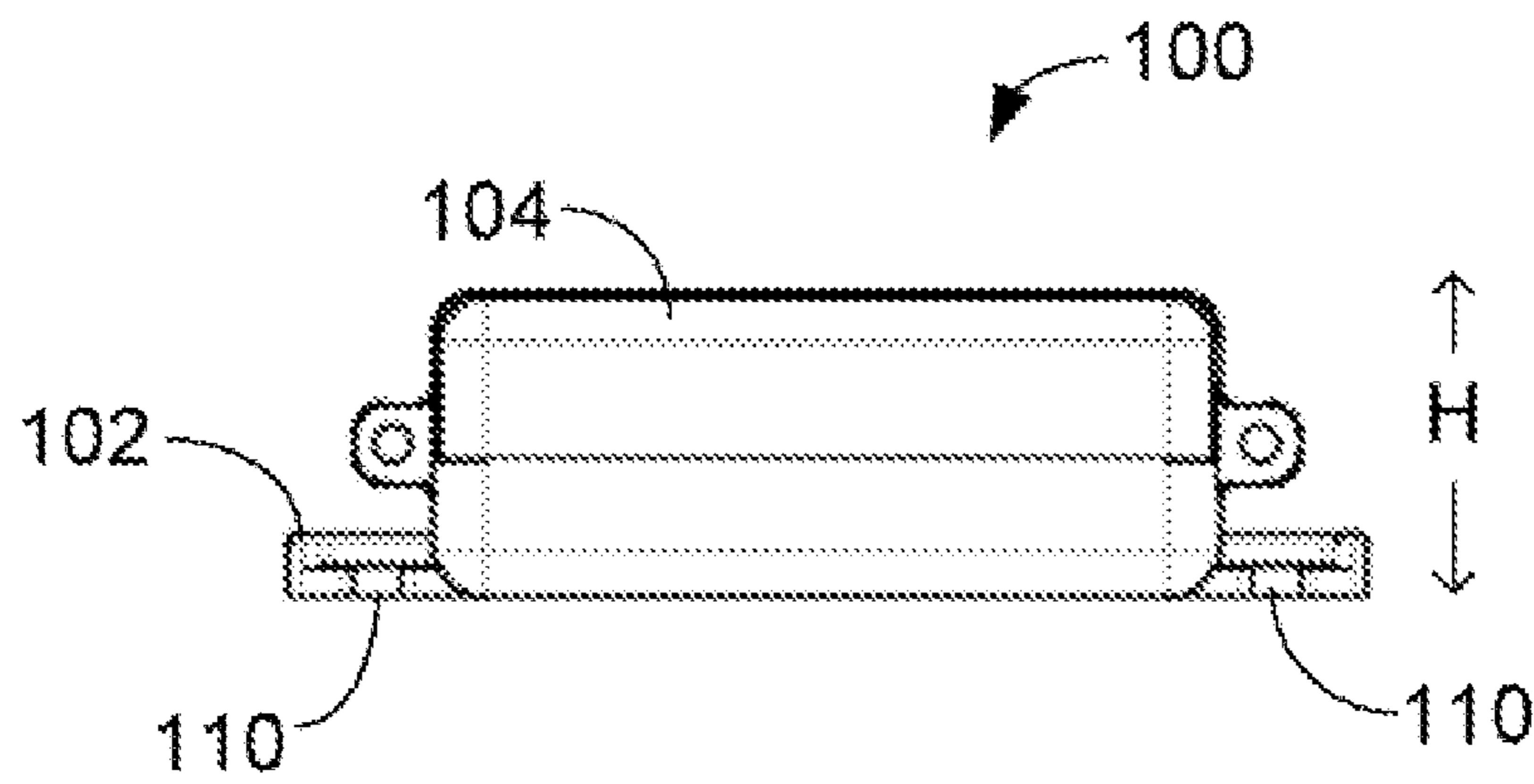

FIG. 1A

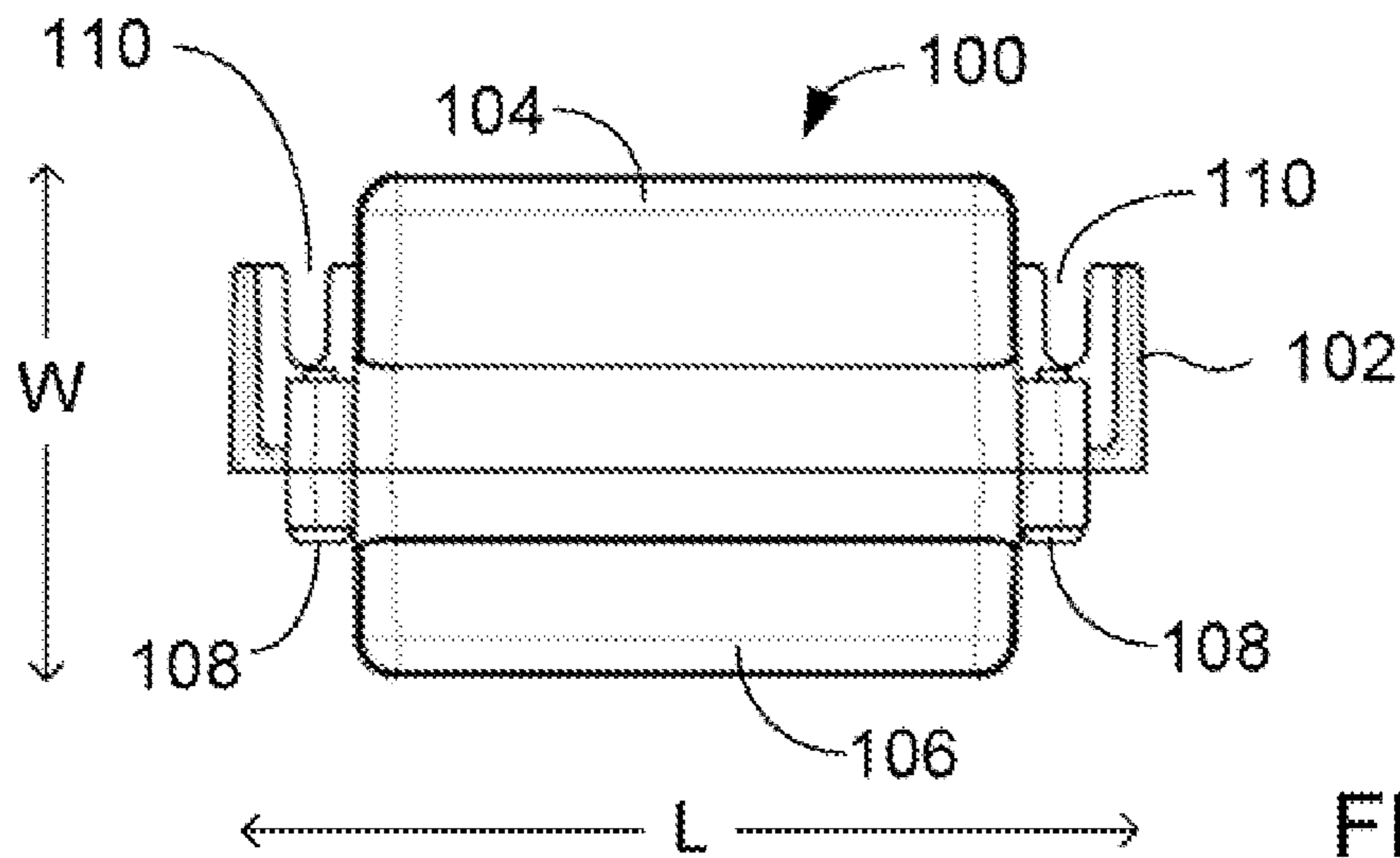

FIG. 1B

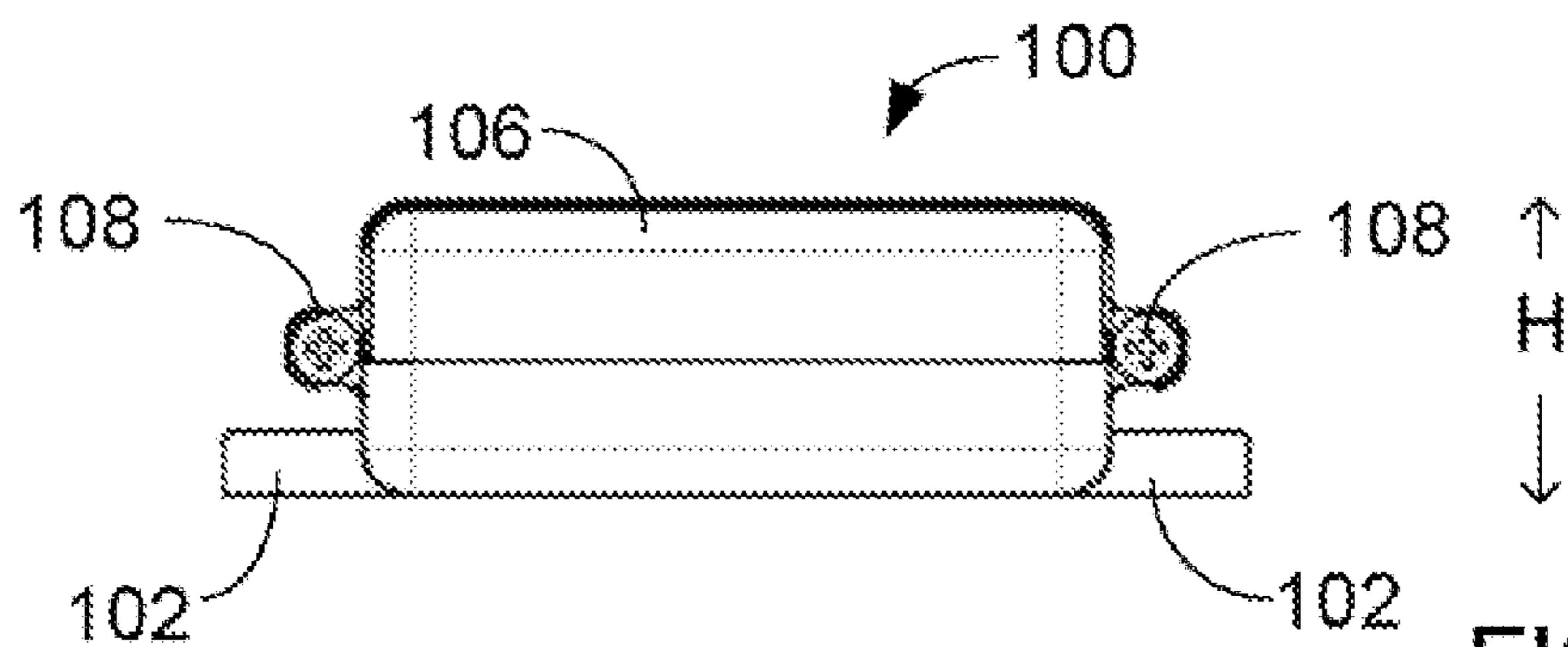

FIG. 1C

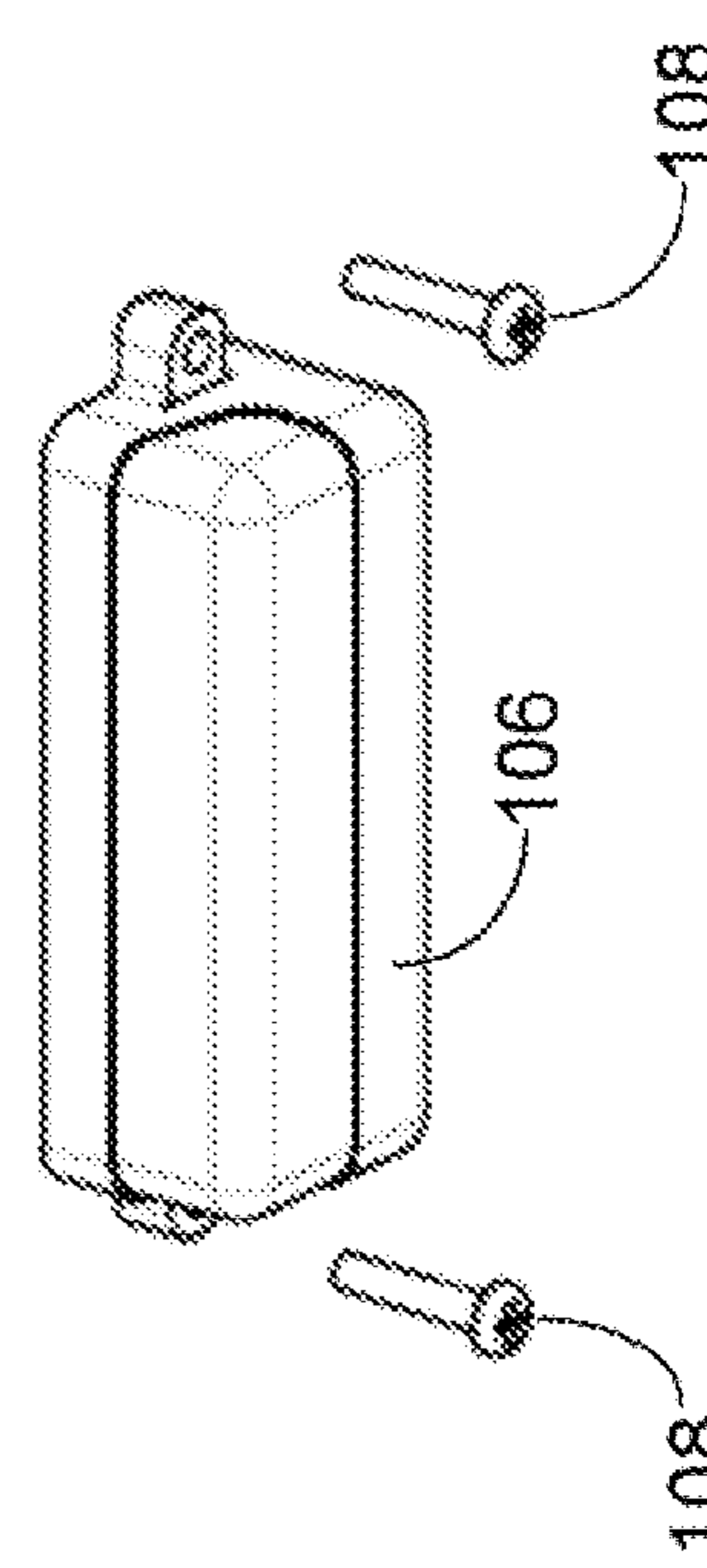
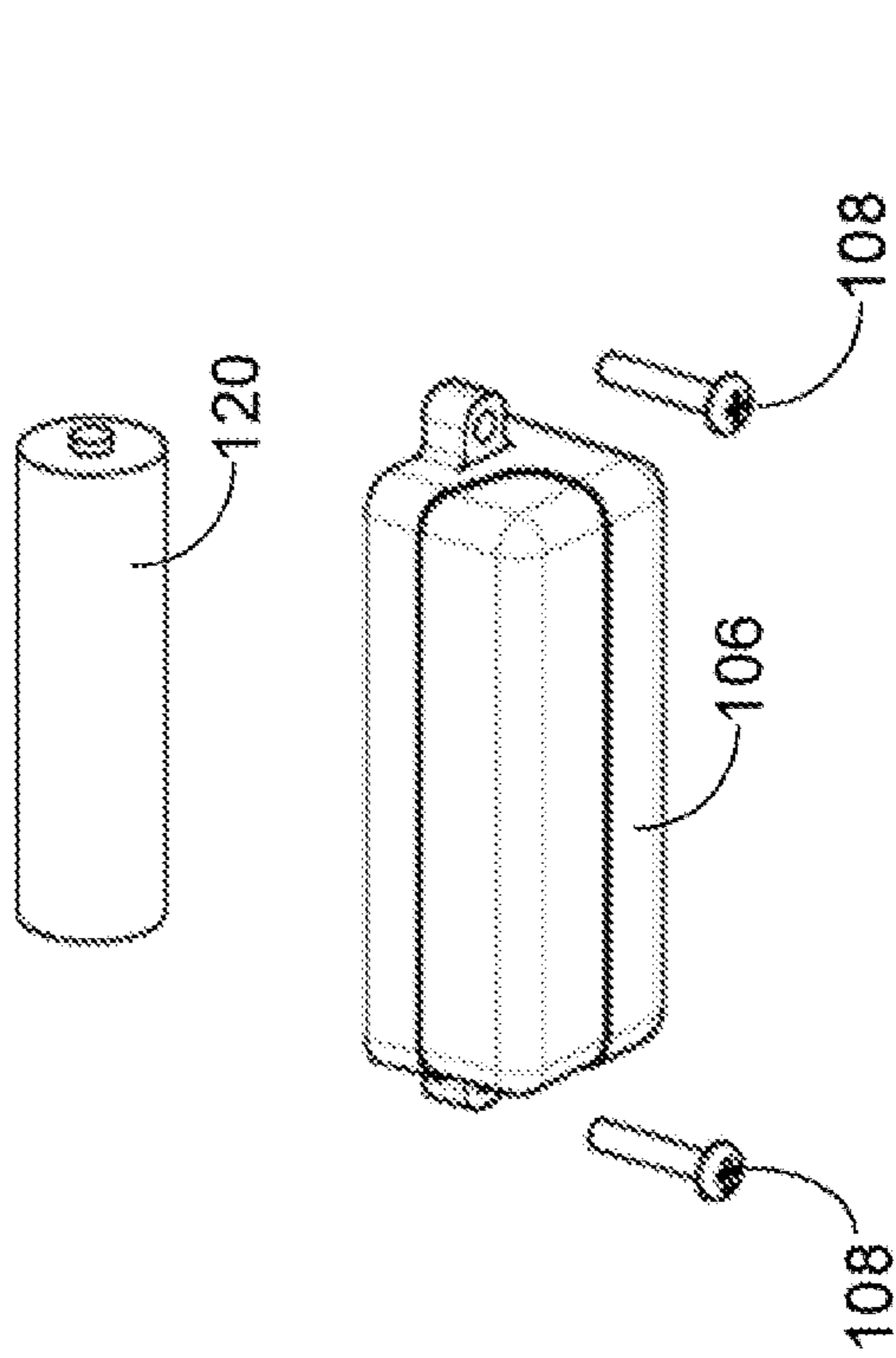
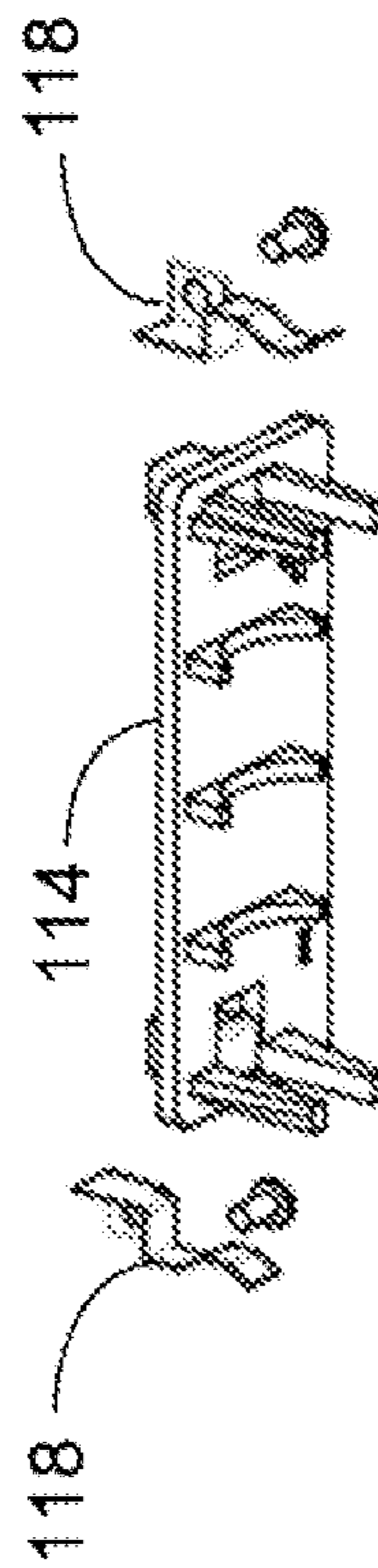
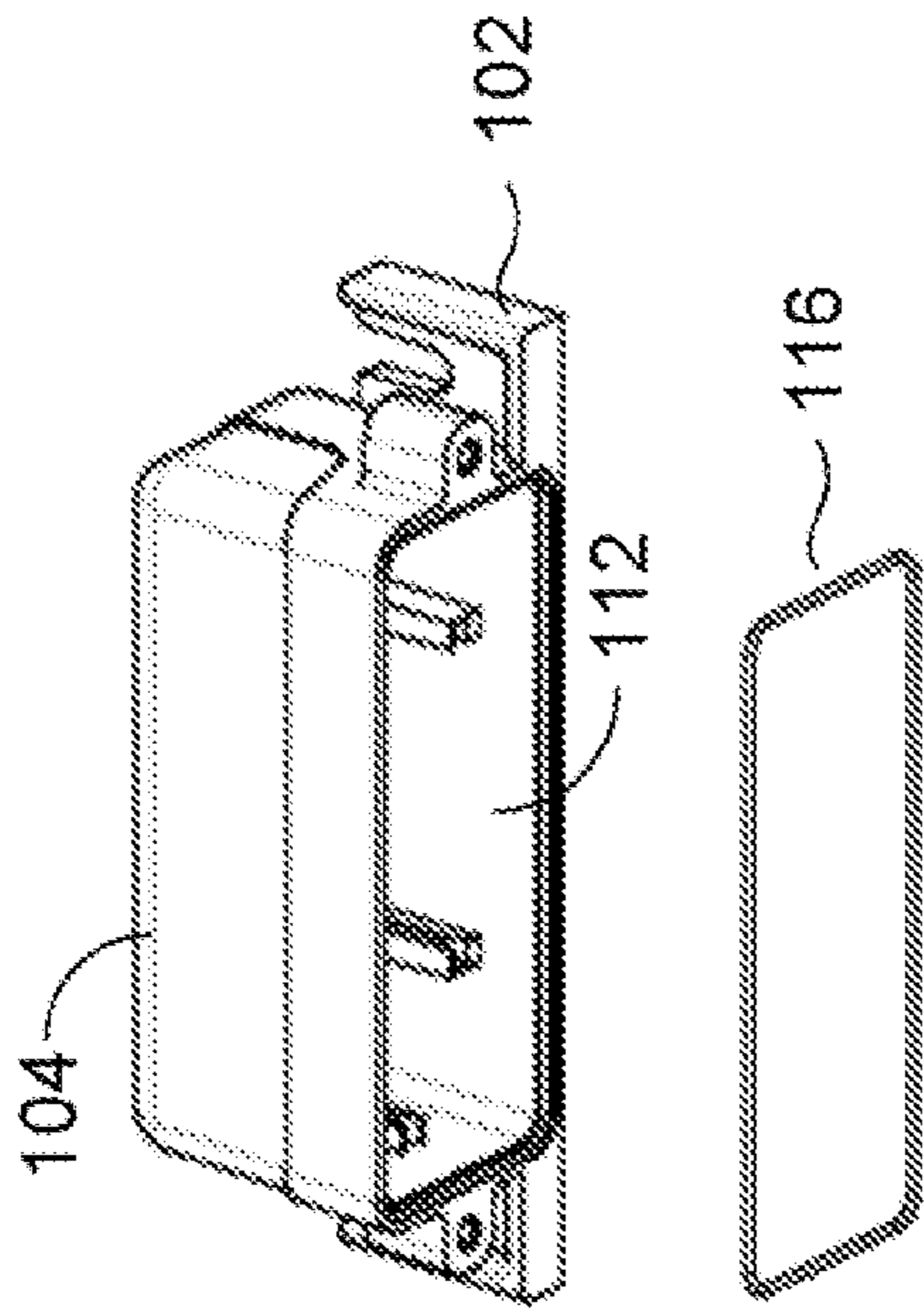
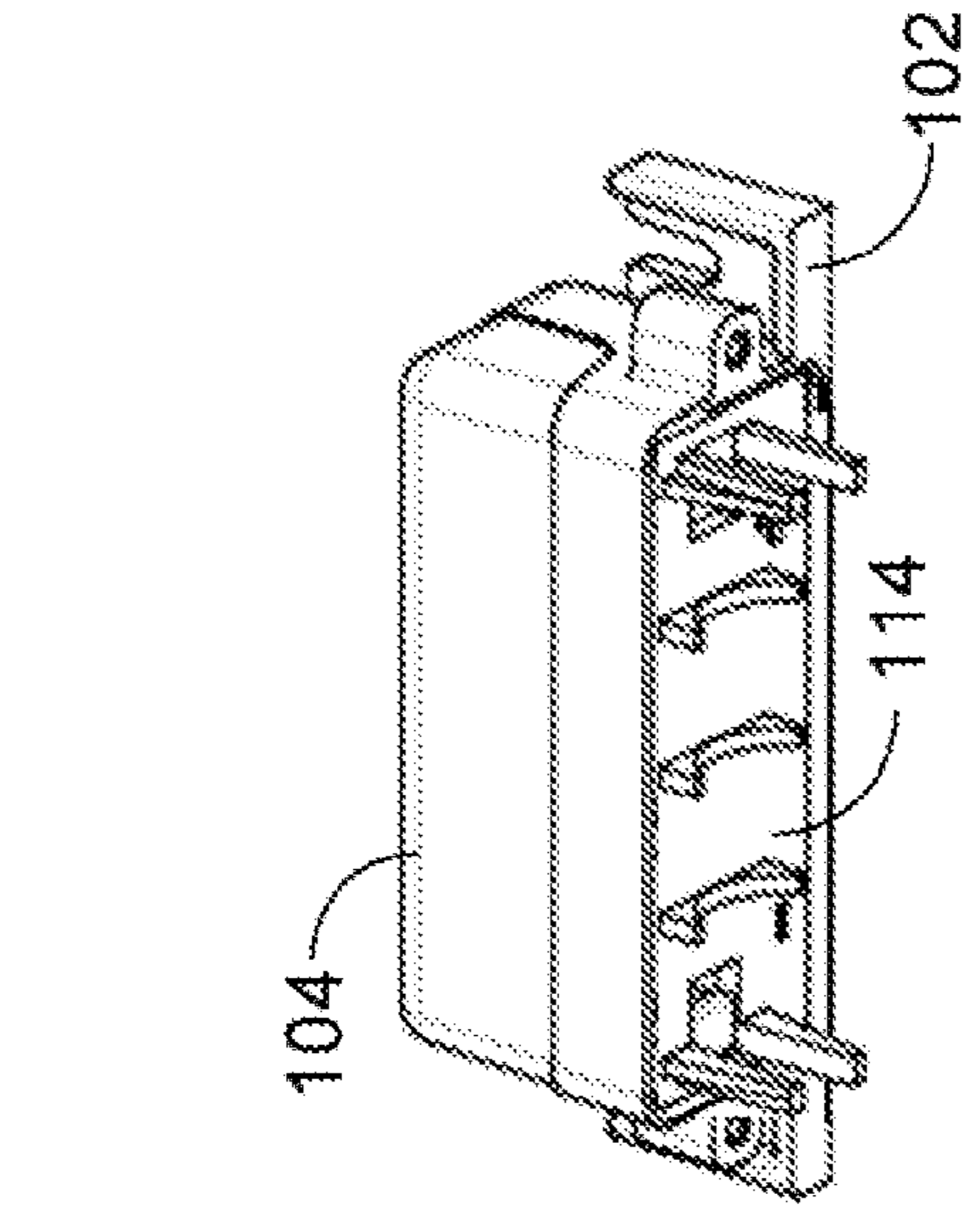

FIG. 3

FIG. 2

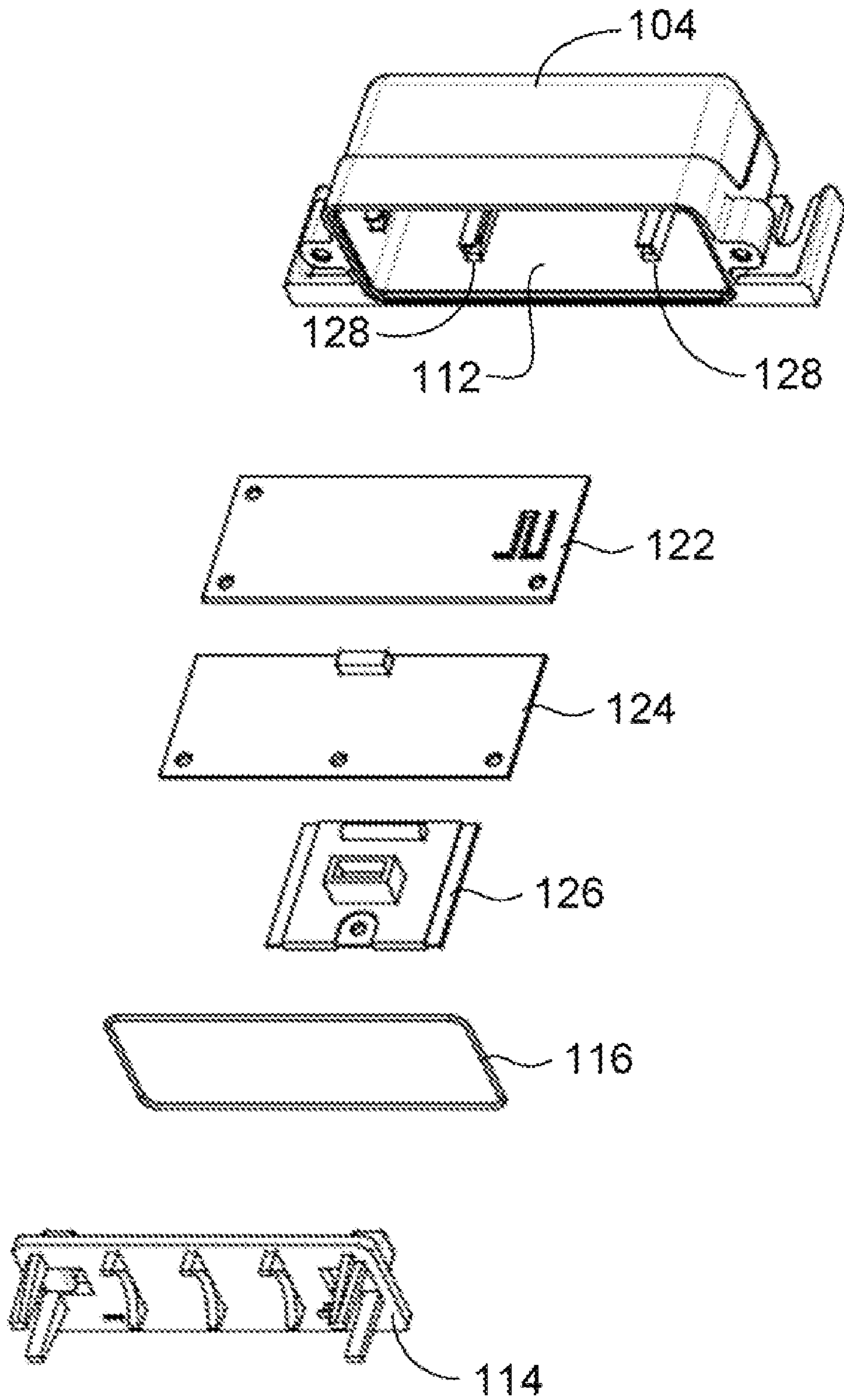
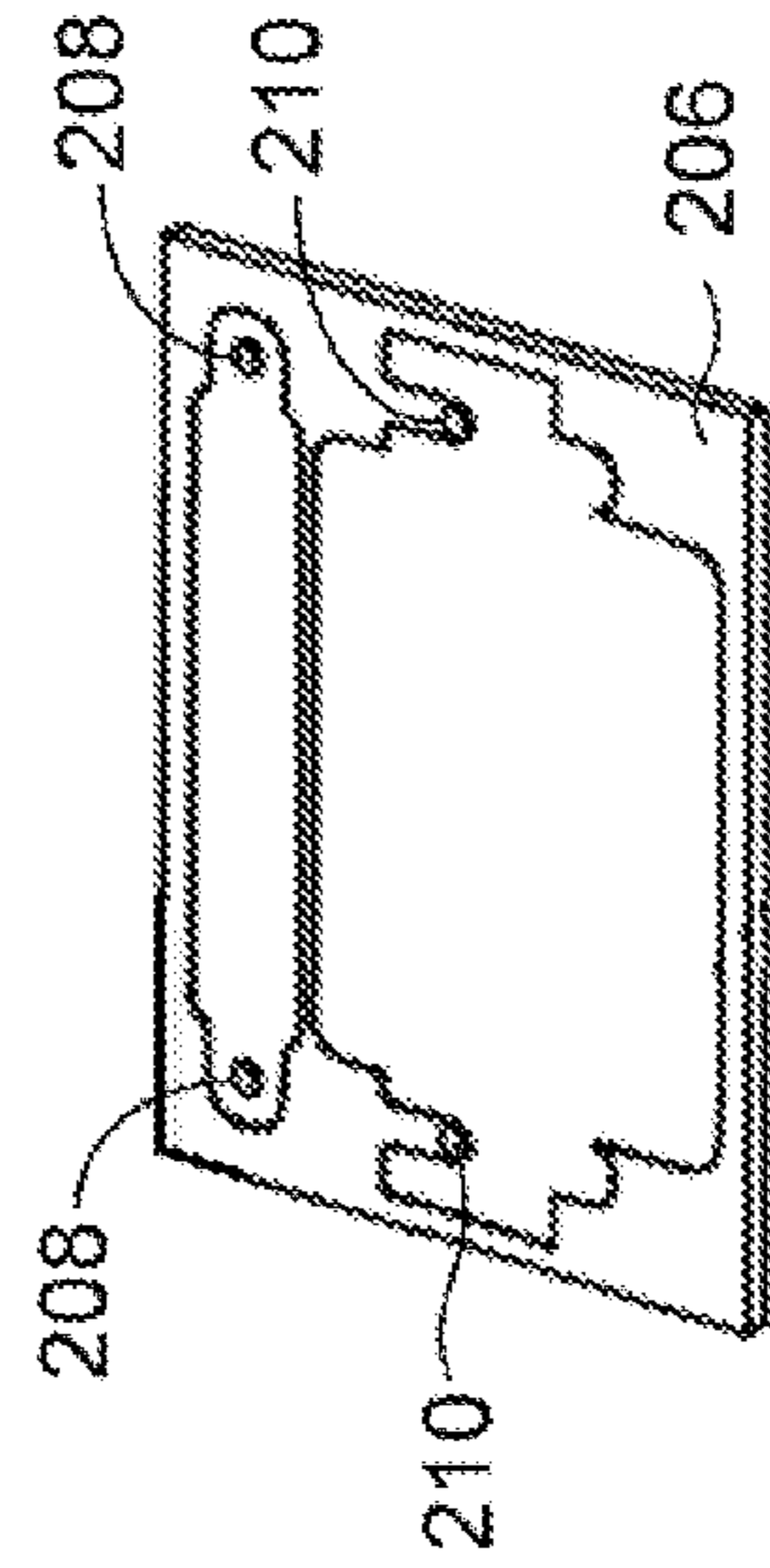
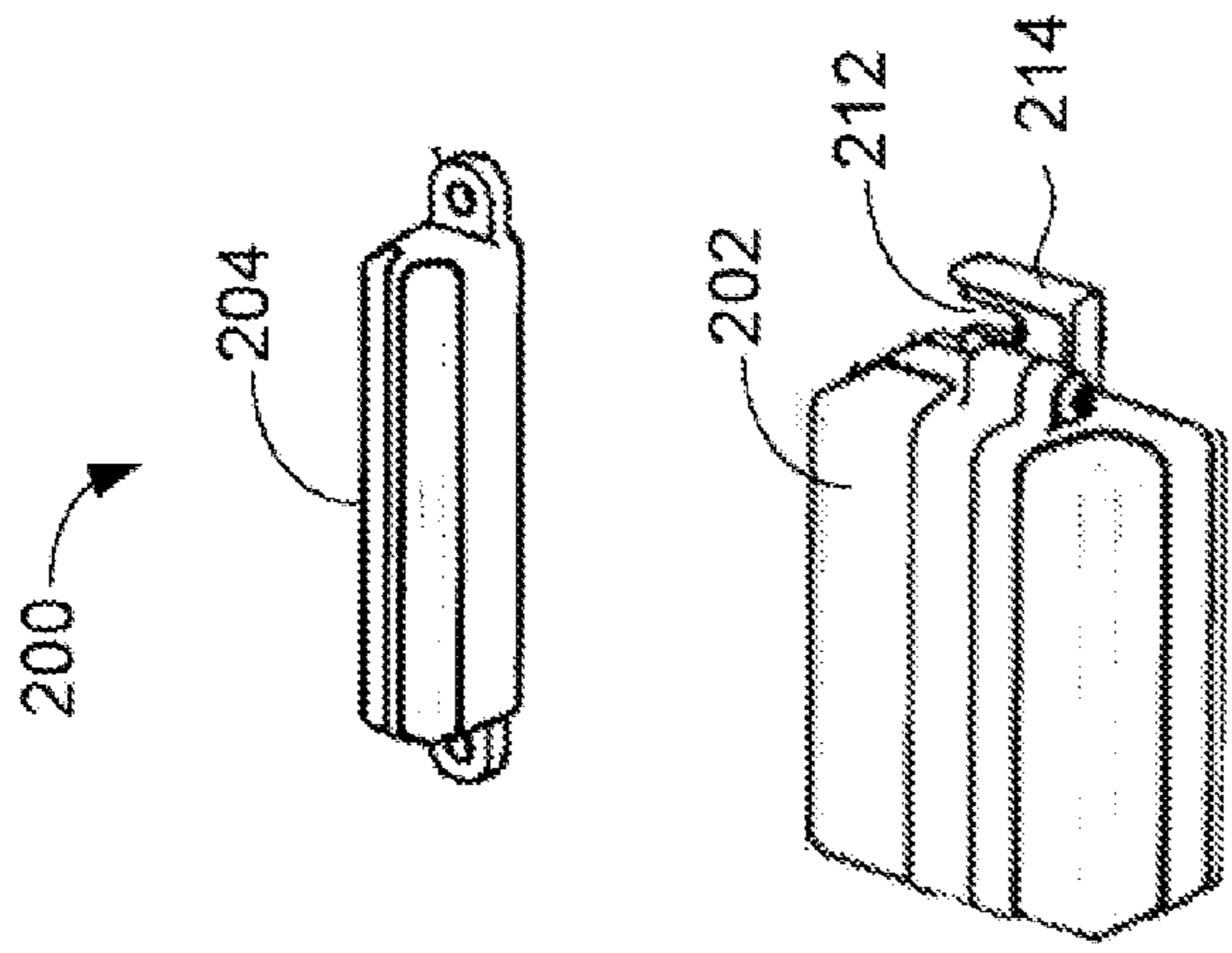
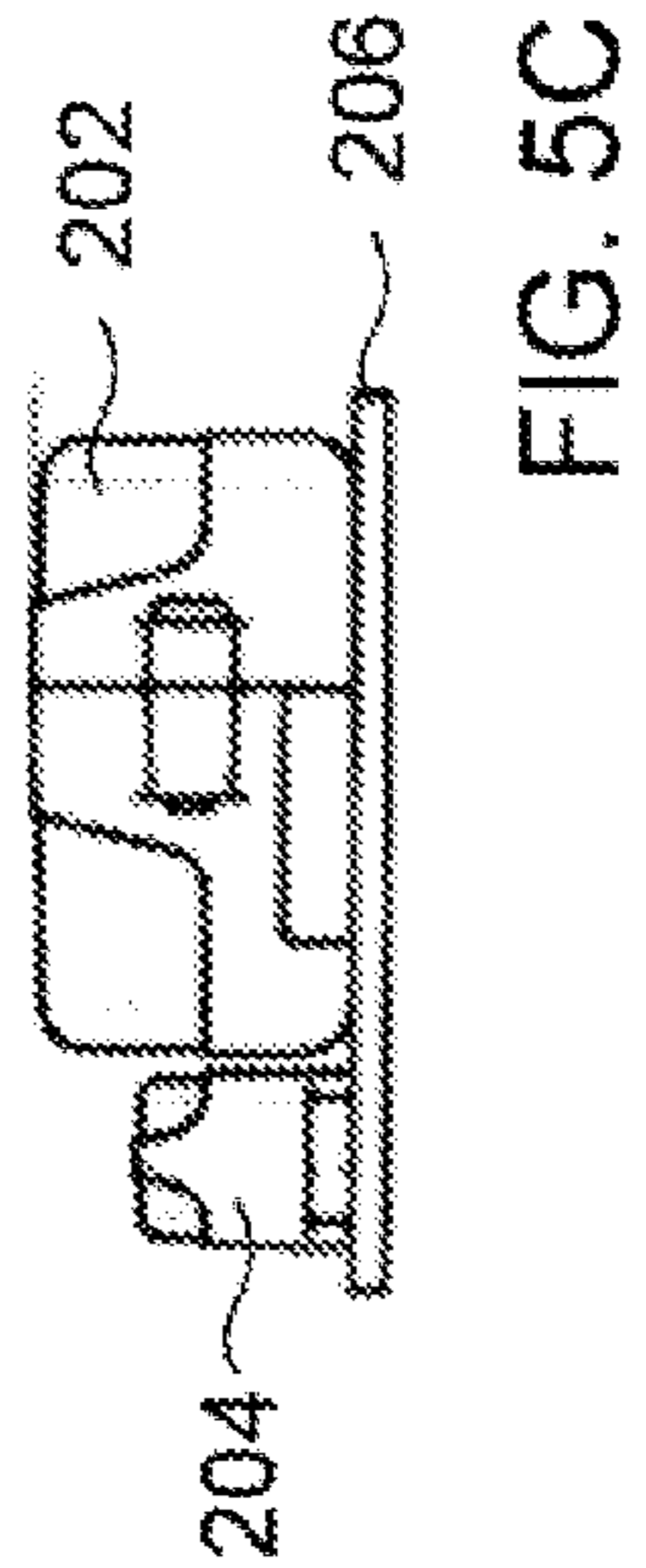
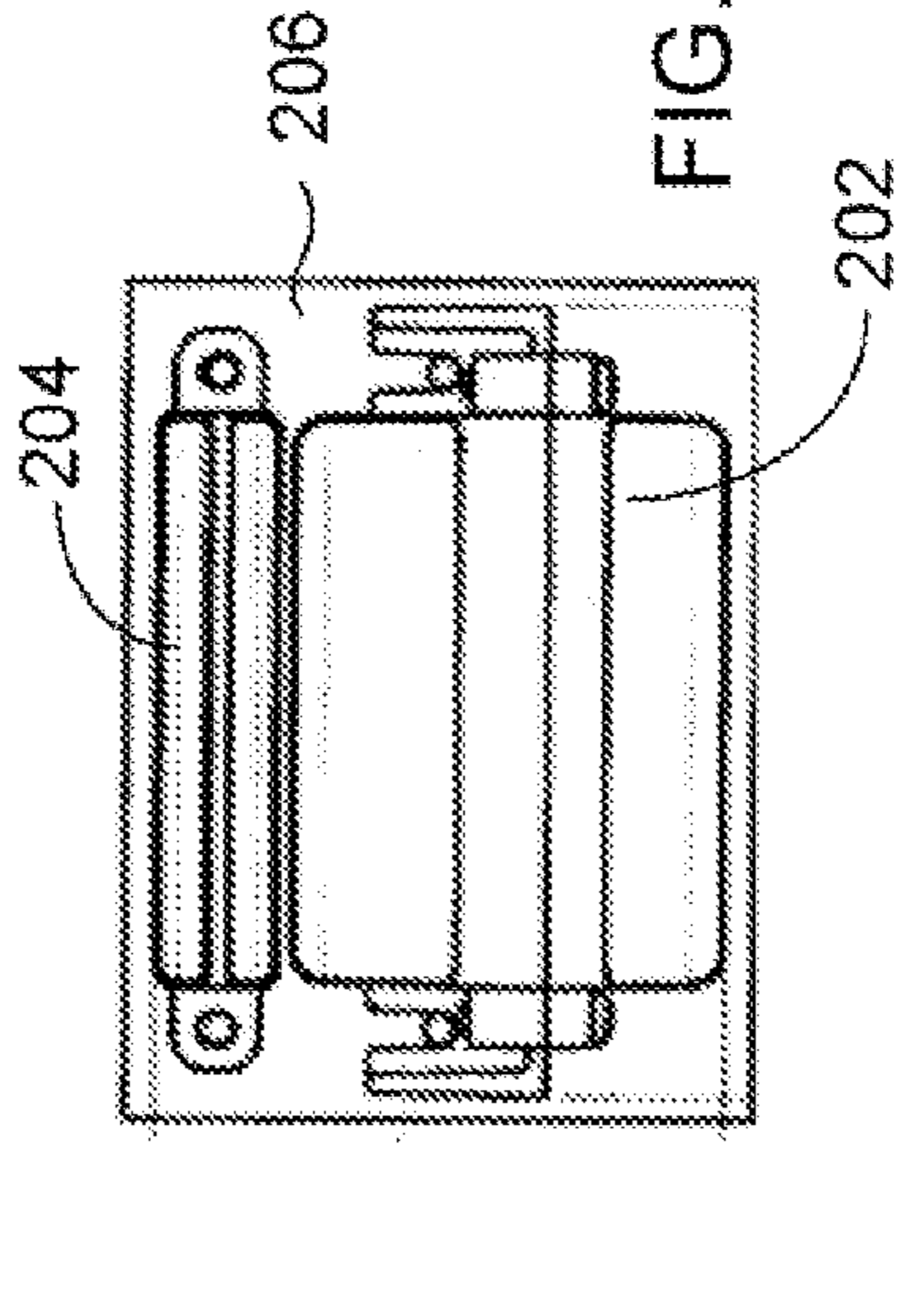
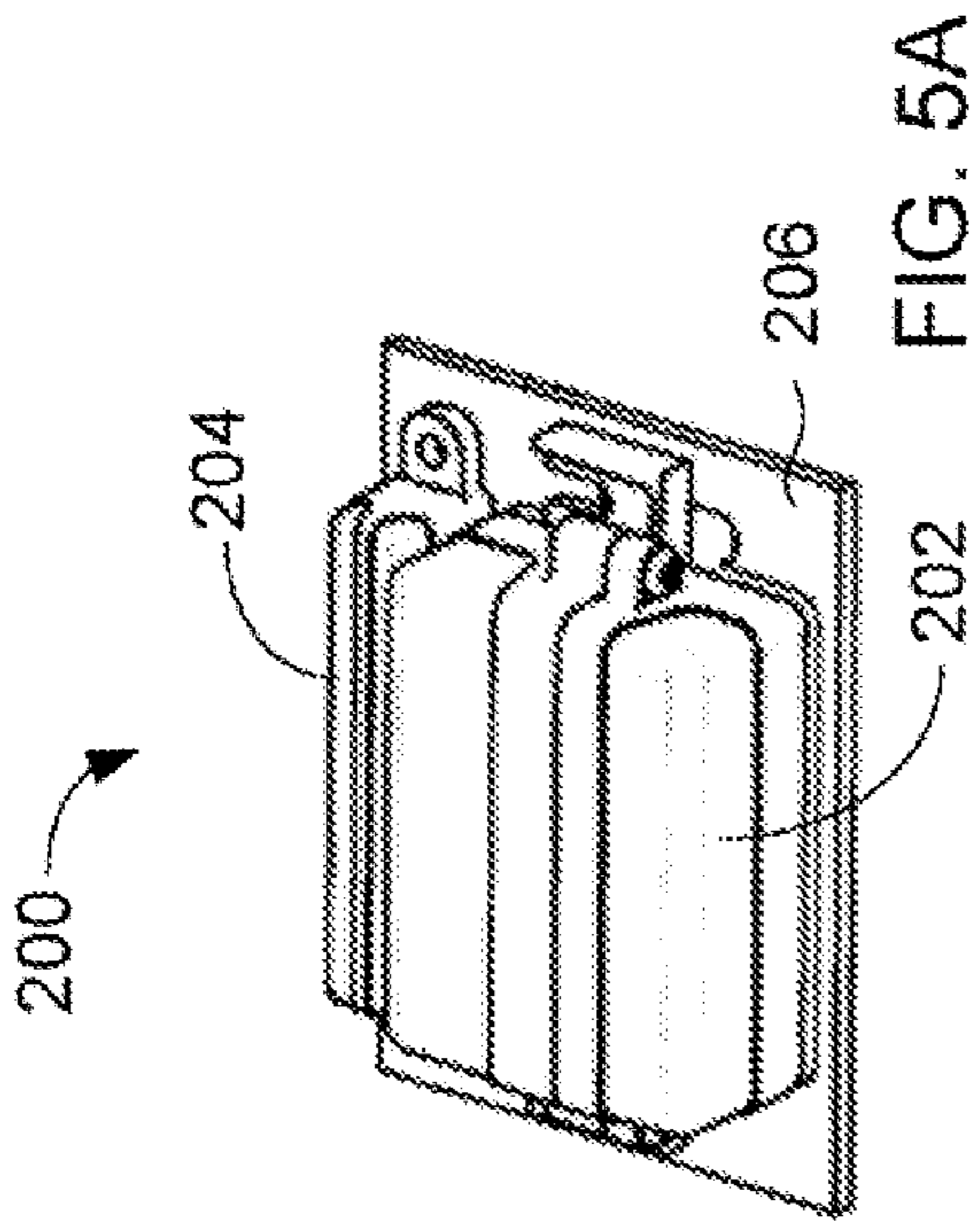

FIG. 4



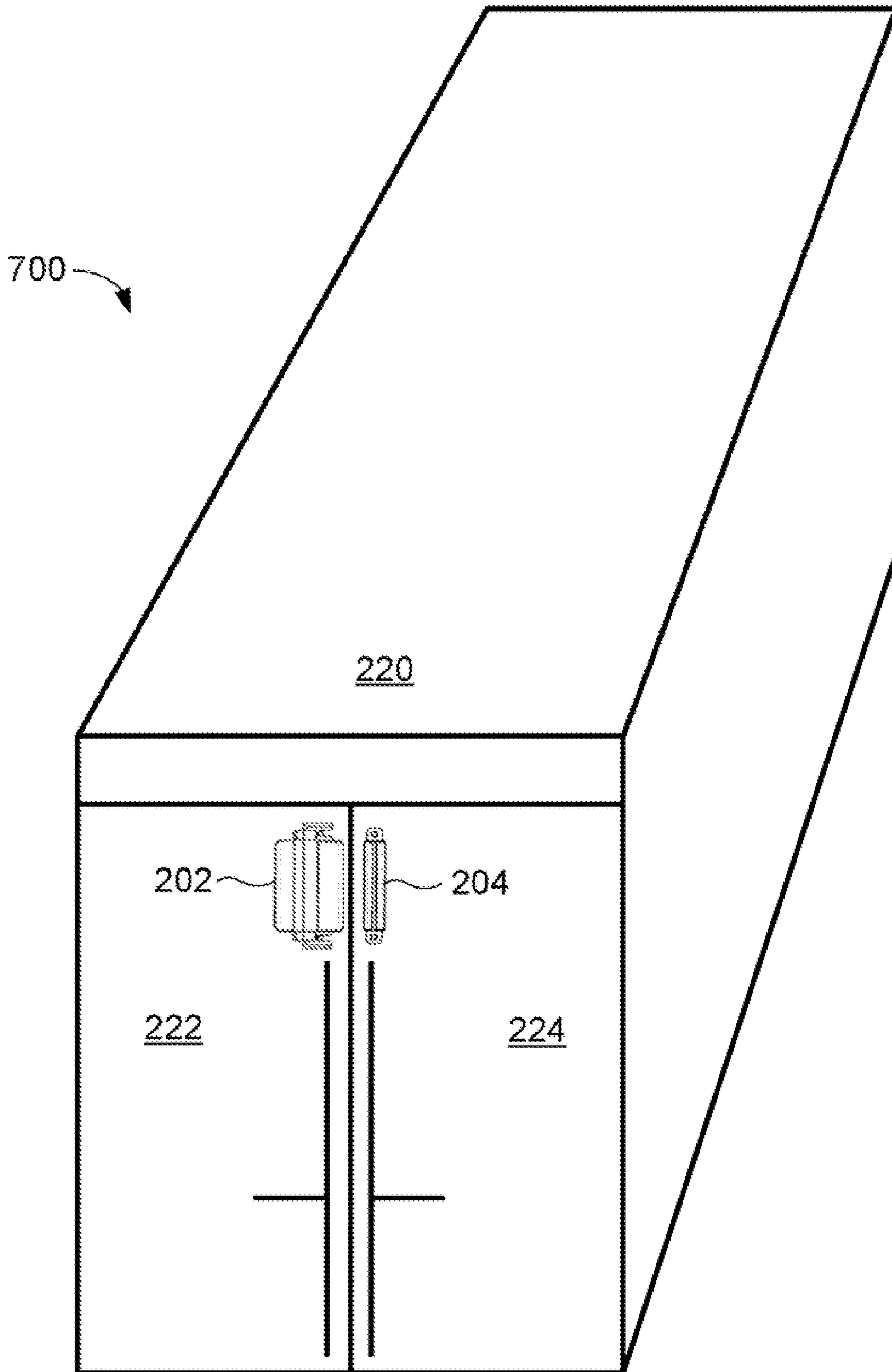

FIG. 7A

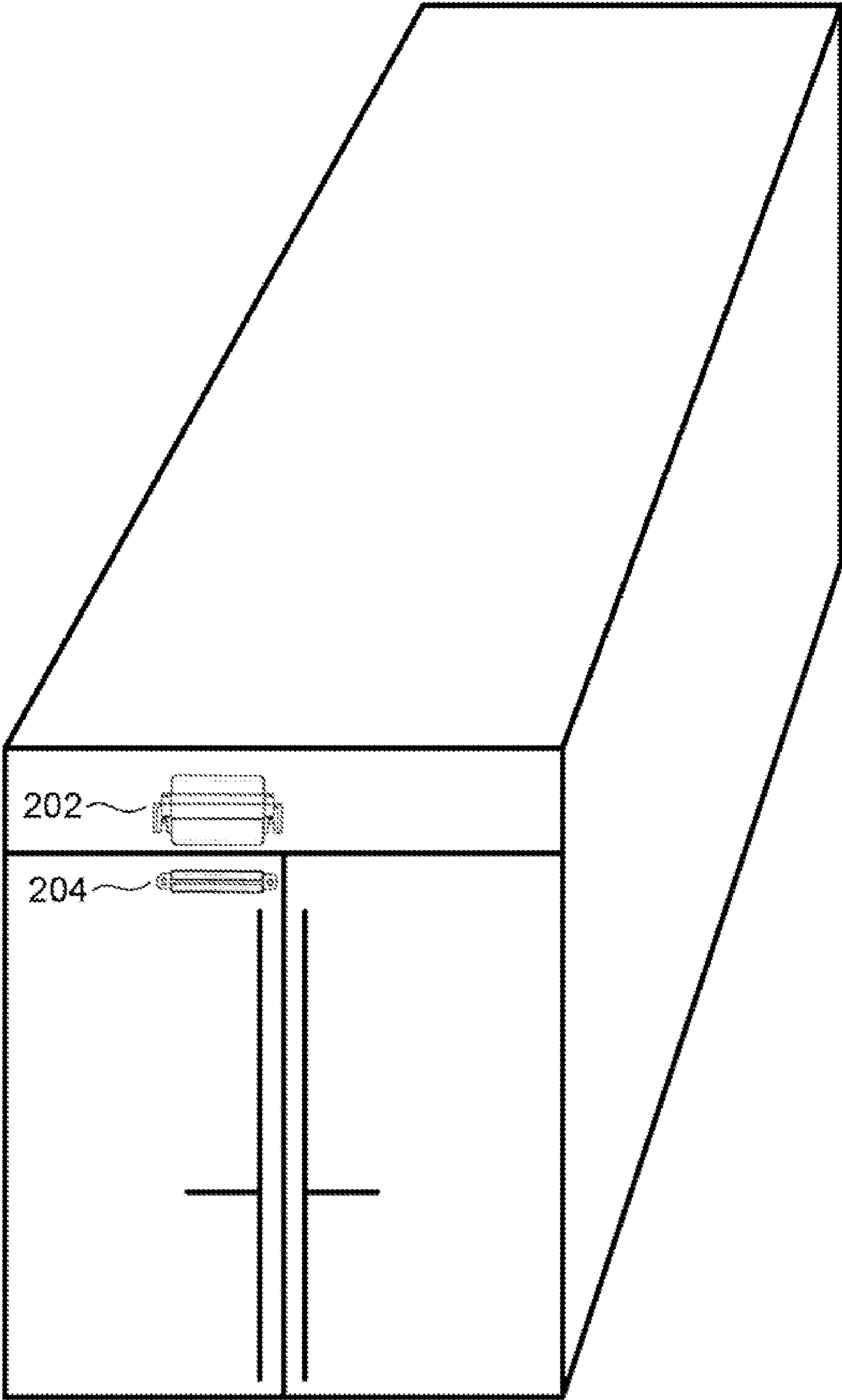

FIG. 7B

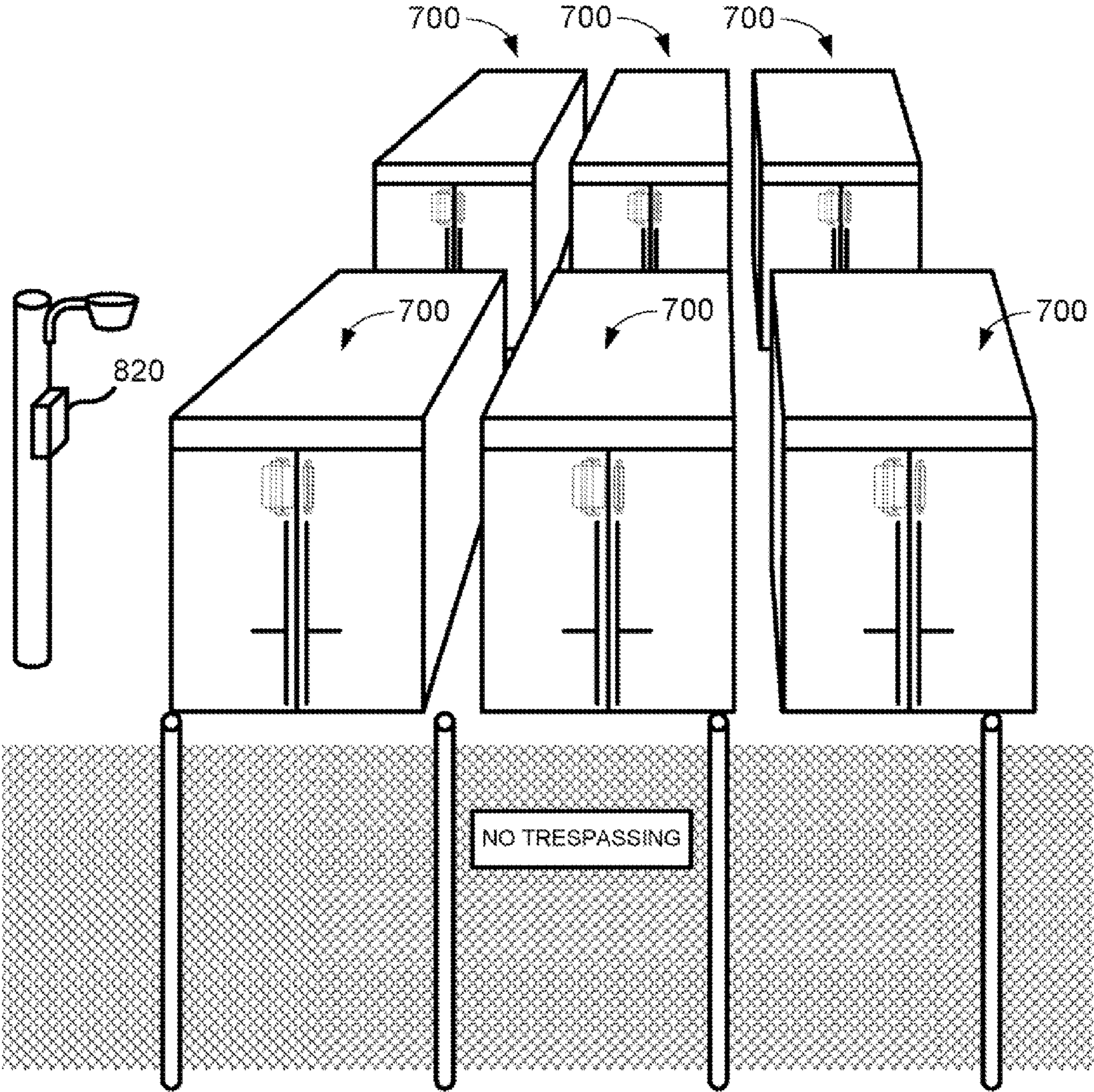

FIG. 8

ALL WEATHER HOUSING ASSEMBLY FOR ELECTRONIC COMPONENTS

I. CROSS-REFERENCE TO RELATED APPLICATION

The present application is a nonprovisional of, and claims priority under 35 U.S.C. § 119(e) to Twitchell, U.S. Provisional Patent Application No. 60/688,737 filed Jun. 8, 2005. The entire disclosure of this patent application is hereby incorporated herein by reference. The present application further hereby incorporates by reference each of: U.S. Pat. No. 6,753,775 B2; U.S. Pat. No. 6,745,027 B2; U.S. Pat. No. 6,665,585 B2; U.S. Pat. No. 5,458,042; International Patent Application Publication No. WO 03/032501 A2 (designating the United States and published in English); International Patent Application Publication No. WO 03/098851 A1 (designating the United States and published in English); U.S. Patent Application Publication No. 2004/0082296 A1; U.S. Patent Application Publication No. 2004/0183673 A1; and U.S. Patent Application Publication No. 2004/0021572 A1.

II. COPYRIGHT STATEMENT

All of the material in this patent document is subject to copyright protection under the copyright laws of the United States and other countries. The copyright owner has no objection to the facsimile reproduction by anyone of the patent document or the patent disclosure, as it appears in official governmental records but, otherwise, all other copyright rights whatsoever are reserved.

III. BACKGROUND OF THE INVENTION

The present invention generally relates to an assembly comprising a remote sensor interface (RSI). RSIs are utilized for remotely collecting data in the field and communicating the collected data to one or more centralized locations. For example, RSIs are utilized in tracking and monitoring assets that are stored and/or transported in association with wireless transceivers, such as radio frequency identification tags (RFIDs). In such implementations, an RSI has been previously referred to as a wireless reader tag or WRT. The data regarding the tracked and monitored assets is communicated by an RSI to one or more central servers for processing. Such data is useful, for instance, in supply chain management. Such data further is useful, for instance, in homeland security, especially when the assets being tracked and monitored are being imported into the United States from foreign countries.

Of course, the RSI of the present invention preferably is capable of wireless communications with external devices. For example, the RSI preferably communicates with other RSIs in forming one or more wireless networks. Furthermore, the RSI preferably communicates with a gateway that itself serves as a bridge to other networks, such as the Internet, a cellular network, or a Satellite network.

The present invention relates in particular to an assembly of an RSI that includes a first housing having an internal compartment for electronic components and a second housing for receiving power source components. The housing for power source components is capable of being opened separately from the housing for the electronic components for protection of the electronic components when the power source components are serviced or replaced. For example, a battery of an RSI can be replaced without exposure of electronic components thereof to an outdoor and potentially harsh

environment such as that of a sea port, the deck of a sea vessel, a railroad yard, or a truck loading area.

IV. BRIEF DESCRIPTION OF THE DRAWINGS

One or more embodiments of the present invention will be described in detail with reference to the accompanying drawings which are briefly described below, wherein the same elements are referred to with the same reference numerals, and wherein various elements are not necessarily shown in conformance to any particular absolute or relative scale.

FIG. 1A is a front elevational view of a remote sensor interface (RSI) according to an embodiment of the invention.

FIG. 1B is a top plan view of the RSI of FIG. 1A.

FIG. 1C is a back elevational view of the RSI of FIG. 1A.

FIG. 2 is an exploded perspective view of the RSI of FIG. 1A.

FIG. 3 is a partially exploded perspective view of the RSI of FIG. 1A with a battery.

FIG. 4 is a perspective view of a first housing, seal, and cover of the RSI of FIG. 1A, shown with optional electronic components.

FIG. 5A is a perspective view of a wireless magnetic seal kit according to a preferred embodiment of the invention.

FIG. 5B is a top plan view of the wireless magnetic seal kit of FIG. 5A.

FIG. 5C is a side elevational view of the wireless magnetic seal kit of FIG. 5A.

FIG. 6 is a partially exploded perspective view of the wireless magnetic seal kit of FIG. 5A.

FIG. 7A illustrates an embodiment of a shipping container including the RSI and the magnet housing of the kit of FIG. 5A.

FIG. 7B illustrates a shipping container and an RSI in an arrangement alternative to that of FIG. 7A.

FIG. 8 illustrates a shipping yard including a plurality of the shipping containers of FIG. 7A.

V. DETAILED DESCRIPTION

As a preliminary matter, it will readily be understood by one having ordinary skill in the relevant art (“Ordinary Artisan”) that the present invention has broad utility and application. Furthermore, any embodiment discussed and identified as being “preferred” is considered to be part of a best mode contemplated for carrying out the present invention. Other embodiments also may be discussed for additional illustrative purposes in providing a full and enabling disclosure of the present invention. Moreover, many embodiments, such as adaptations, variations, modifications, and equivalent arrangements, will be implicitly disclosed by the embodiments described herein and fall within the scope of the present invention.

Accordingly, while the present invention is described herein in detail in relation to one or more embodiments, it is to be understood that this disclosure is illustrative and exemplary of the present invention, and is made merely for the purposes of providing a full and enabling disclosure of the present invention. The detailed disclosure herein of one or more embodiments is not intended, nor is to be construed, to limit the scope of patent protection afforded the present invention, which scope is to be defined by the claims and the equivalents thereof. It is not intended that the scope of patent protection afforded the present invention be defined by reading into any claim a limitation found herein that does not explicitly appear in the claim itself.

Thus, for example, any sequence(s) and/or temporal order of steps of various processes or methods that are described herein are illustrative and not restrictive. Accordingly, it should be understood that, although steps of various processes or methods may be shown and described as being in a sequence or temporal order, the steps of any such processes or methods are not limited to being carried out in any particular sequence or order, absent an indication otherwise. Indeed, the steps in such processes or methods generally may be carried out in various different sequences and orders while still falling within the scope of the present invention. Accordingly, it is intended that the scope of patent protection afforded the present invention is to be defined by the appended claims rather than the description set forth herein.

Additionally, it is important to note that each term used herein refers to that which the Ordinary Artisan would understand such term to mean based on the contextual use of such term herein. To the extent that the meaning of a term used herein—as understood by the Ordinary Artisan based on the contextual use of such term—differs in any way from any particular dictionary definition of such term, it is intended that the meaning of the term as understood by the Ordinary Artisan should prevail.

Furthermore, it is important to note that, as used herein, “a” and “an” each generally denotes “at least one,” but does not exclude a plurality unless the contextual use dictates otherwise. Thus, reference to “a picnic basket having an apple” describes “a picnic basket having at least one apple” as well as “a picnic basket having apples.” In contrast, reference to “a picnic basket having a single apple” describes “a picnic basket having only one apple.”

When used herein to join a list of items, “or” denotes “at least one of the items,” but does not exclude a plurality of items of the list. Thus, reference to “a picnic basket having cheese or crackers” describes “a picnic basket having cheese without crackers”, “a picnic basket having crackers without cheese”, and “a picnic basket having both cheese and crackers.” Finally, when used herein to join a list of items, “and” denotes “all of the items of the list.” Thus, reference to “a picnic basket having cheese and crackers” describes “a picnic basket having cheese, wherein the picnic basket further has crackers,” as well as describes “a picnic basket having crackers, wherein the picnic basket further has cheese.”

Turning now to FIGS. 1A-1C, in a preferred embodiment of the invention, a remote sensor interface (RSI) 100 includes a base 102, a first housing 104 attached to the base, and a second housing 106 connected to the first housing 104 by connectors 108. The second housing 106 is capable of being opened separately from the first housing 104. For example, in the embodiment illustrated in FIG. 1, the connectors 108 are threaded screws that can be removed to allow the second housing to be separated from the first housing. Slots 110 are formed in the base 102 for attaching or otherwise mounting of the RSI 100 to a structure such as a wall. For example, various connectors such as screws, bolts, rivets, and nails can be passed through the slots and attached to a surface upon which the RSI is to be mounted.

In the embodiment illustrated in FIG. 1A-1C, the RSI 100 has outer dimensions of length (L), width (W), and height (H). Though it should be appreciated that the descriptions herein and the accompanying drawings are not limited to any particular scale or dimension, the RSI 100 described herein as an exemplary embodiment has an approximate length of 3.3 inches, an approximate width of 2.4 inches, and an approximate height of 1.0 inch.

As shown in FIG. 2, the first housing 104 defines a first compartment 112 that is capable of being closed and sealed.

Closure and sealing of the first compartment 112 is obtained by pressing a cover 114 into engagement with the first housing 104 with the seal 116 between the cover and first housing. In the illustrated embodiment, the seal is a pliable gasket received by a channel of the first housing and retained therein by the cover when the cover is engaged with the first housing in a press fit engagement. The engagement of the cover with the first housing can be further supported by an adhesive or connectors such as clips or screws. The first housing 104 and cover 114 are engaged in FIG. 3 such that closure and sealing of the first compartment is obtained.

As further shown in FIG. 2, electrical contacts 118 are provided for conducting electrical current from a power source to the interior of the first compartment 112. Furthermore, the cover 114 is formed to receive a power source 120, such as a battery, such that the electrical contacts 118 conduct electrical current from the power source, through the cover 114, and into the closed and sealed first compartment when the cover 114 and first housing 104 are engaged as shown in FIG. 3. Moreover, the second housing is dimensioned to cover and protect the power source when the second housing 106 is connected to the first housing 104 (FIG. 1).

In the illustrated embodiment, the cover 114 is particularly formed to receive a standard AA battery having opposing positive and negative terminals; the electrical contacts 118 are formed and disposed to contact the opposing terminals of the battery; and, the second housing 106 is dimensioned to cover and protect the AA battery. It should be appreciated, however, that in other embodiments according to the invention, other battery sizes and power sources can be accommodated by differently shaped and configured cover, electrical contacts, and second housing, as desired, so long as such elements are designed for sealing engagement with the first housing 104.

Various electronic components optionally are disposed within the first compartment 112. The electronic components are powered by the power source 120 by way of the electrical contacts 118. The electronic components are sealed and protected between the first housing 104 and cover 114 when closure and sealing of the first compartment is obtained as shown in FIG. 3. Sealing and closure of the first compartment is not lost when the second housing 106 is separated from the first housing 104. Thus the power source 120 can be routinely serviced or replaced without disturbing the first compartment and without exposing any electronic components within the first compartment to potentially harsh external conditions. For example, insofar as the RSI 100 is attached to a land-sea container on the deck of a cargo ship, the battery of the RSI can be replaced without exposing the electronic components of the RSI to moisture and corrosive salty conditions.

Several exemplary electronic components are shown in FIG. 4 as printed circuit assembly (PCA) cards, which preferably include printed circuit boards. A first PCA card 122 preferably includes components comprising a wake-up receiver circuit for receiving wireless wake-up signals and prompting wake up of the RSI. The components of the wake-up receiver circuit include an etched antenna on the printed circuit board of the PCA card. The wake-up receiver circuit preferably has a relatively low power consumption rate compared to that of a standards based radio of the RSI. Furthermore, the wake-up receiver circuit preferably executes a stepped wake up sequence for minimizing power consumption of the RSI to avoid frequent power source servicing such as the changing of a battery.

Another PCA card 124 preferably includes a standards based radio for two-way wireless communications with one or more gateways and/or one or more other RSIs. Such standards based radio preferably comprises a Bluetooth radio or

5

WiFi radio. The PCA card **124** preferably communicates with a gateway for receiving commands, communicating data acquired via its sensors, and/or forwarding data collected and communicated from another RSI. In this regard, the PCA card **124** preferably is used by the RSI in forming ad-hoc networks and in relaying communications between other RSI units and a gateway.

As further shown in FIG. **4**, a PCA card **126** comprising a sensor interface also is provided for acquiring data from one or more sensors associated with the RSI. Insofar as the RSI is associated with assets, such as shipping containers and contents thereof, the RSI preferably is capable of interfacing with sensors that, for example, monitor the assets, environmental characteristics of the assets, and/or geographical locations of the assets. In some embodiments, the sensor is included within the RSI, as in the example of FIGS. **5-7**; in other embodiments, the sensor is external to the RSI but nevertheless disposed in electronic communication with the sensor interface for data exchange there between. Electronic communication between the sensor interface and a sensor is exchanged wirelessly in some embodiments of the invention and by way of cabled connections in other embodiments. In at least one embodiment, the sensor interface comprises a multi-conductor connector, such as a ribbon cable, that passes from the interior of an RSI and to an external sensor, sensor array, or docking station that receives the RSI. Exemplary sensors include, but are not limited to, electronic seals, magnetic seals, cameras, microphones, temperature sensors, humidity sensors, radiation sensors, and motion sensors.

Each PCA card **122,124,126** of FIG. **4** has a number of electrical contacts (not shown) corresponding to electrical contacts of the first housing **104**. In assembling the RSI, each card is pressed into an available card slot in the first compartment **112** of the first housing **104** with the electrical contacts of the card abutting corresponding electrical contacts of the first housing **104**. The cards are physically supported by rails within the first compartment when pressed into an available slot. For example, rails **128** for receiving and supporting the PCA card **126** comprising the sensor interface are visible in FIG. **4**. Accordingly, it will be appreciated that each PCA card is easily installed and removed for replacement, upgrade, or servicing, much like card components of a personal computer.

When the PCA cards **122,124,126** of FIG. **4** are installed within the first compartment **112**, and the cover **114** and first housing **104** are engaged with the seal **116** therebetween, closure and sealing of the first compartment is obtained. Servicing or replacing of the battery **120** is possible, as shown in FIG. **3**, without removing the cover from engagement with the first housing **104**.

Turning now to an illustrative example according to a preferred embodiment of the invention, as shown in FIGS. **5A-5C** and FIG. **6**, a wireless magnetic seal kit **200** includes an RSI **202**, a magnet housing **204**, and a mounting template **206**. The RSI **202** includes at least a PCA card **124** comprising a standards based radio as shown in FIG. **4**, and a PCA card **126** comprising a sensor interface that includes, in this particular embodiment, a magnetic field sensor. The magnet housing **204** includes a magnet having a magnetic field. Close proximity of the magnet housing **204** to the RSI **202**, as shown in FIG. **5C**, may be indicative of, for example, the presence of a monitored asset, or the closure of a monitored door, cover, or window. Conversely, removal of the magnet housing **204** from close proximity to the RSI may be indicative of, for example, the loss of presence of a monitored asset, or the opening of a monitored door, cover, or window. Moreover, removal of the magnet housing from close proximity to the

6

RSI is an event detected by the magnetic field sensor of the sensor interface of the RSI, and such event may be evidence that, for example, a monitored asset has been lost or subjected to tampering, or that a monitored door, cover, window, closure, or seal has been opened, compromised, or defeated. Detection of such an event preferably results in the RSI reporting the event to a central location via one or more RSIs and/or a gateway. Furthermore the RSI may promptly send a signal reporting the event, or the RSI may record the event for later reporting, particularly if the RSI is out of communication range with one or more RSIs and/or a gateway.

The mounting template **206** of the kit **200** is provided to facilitate convenience in mounting the RSI **202** and magnet housing **204** onto respective surfaces. Guide holes **208** formed in the template **206** correspond to mounting holes formed in the magnet housing **204**. Guide holes **210** formed in the template correspond to the slots **212** formed in the base **214** of the RSI **202**. The guide holes of the template are useful to guide a marking pen or drill bit so that respective surfaces upon which the RSI and magnet housing are to be mounted can be pre-drilled with holes for receiving mounting connectors such as screws, bolts, or rivets. Once such holes are formed, the RSI and magnet housing are mounted to the respective surfaces.

Continuing in the illustrative example, in FIG. **7A**, which is not intended to be drawn to scale, an embodiment **700** in accordance with the invention includes an RSI **202** mounted to a first door **222** of a container **220**, such as a maritime or land-sea shipping container. A magnet housing **204** is mounted to a second door **224**. So long as the doors remain closed, close proximity of the magnet housing to the RSI is maintained. However, if either door is opened, close proximity of the magnet housing to the RSI is lost and opening of the door is detected by the RSI, and the detection preferably is reported to an external device such as a gateway.

In another illustrative arrangement, in FIG. **7B**, the RSI **202** is mounted to a frame member of a shipping container and the magnet housing **204** is mounted to a door of the container. In this arrangement, the RSI **202** remains stationary as the door is opened and closed, thus fatigue of the RSI **202** by mechanical vibration is minimized. In yet another arrangement, an RSI is mounted within a container and thus is sheltered from environmental conditions external to the container.

A shipping yard including a plurality of embodiments **700** according to FIG. **7A** is illustrated in FIG. **8**. As will be appreciated, each RSI monitors the state of its respective shipping container, i.e., whether the container is closed or open, and/or whether the state has changed, i.e., whether the container has been closed or opened. Further data monitoring may include the time period in which the container is in a particular state. Each RSI communicates wirelessly via the standards based radio of its respective PCA card **124** with one or more other RSIs and/or the gateway **820**, which gateway **820** preferably is disposed in electronic communication with a wide area network, such as the Internet, a Satellite network, and/or a cellular network. In this regard, the gateway **820** may be connected via wire or cable, or wirelessly, to the wide area network.

Based on the foregoing description, it will be readily understood by those persons skilled in the art that the present invention is susceptible of broad utility and application. Accordingly, while one or more embodiments of the present invention have been described herein in detail, it is to be understood that this disclosure is only illustrative and exemplary and is made merely for the purpose of providing a full and enabling disclosure of the invention. The foregoing disclosure is not intended to be construed to limit the present

invention or otherwise exclude any other embodiments, adaptations, variations, modifications or equivalent arrangements, the scope of the invention being limited only by the claims of an issued patent and the equivalents thereof.

What is claimed is:

1. An weather housing assembly for protection of electrical components, the housing assembly comprising: (a) a first housing having an open end and defining a first compartment for receipt therein of electronic components; (b) a cover attached to the first housing for enclosing the first compartment, the cover further including a mounting structure for receiving and retaining a power source which structure is mounted on a side of the cover that is exterior to the enclosed first compartment; and (c) a second housing having an open end and defining a second compartment that is dimensioned to cover and protect a power source when received and retained by the mounting structure of the cover, the second housing being connected to the first housing independent of the attachment of the cover to the first housing.

2. The housing assembly of claim 1, wherein the first and second housings are connected together in open-end to open-end disposition.

3. The housing assembly of claim 1, wherein the second housing is connected to the first housing by connectors, and wherein the connectors comprise threaded screws that can be removed to allow the second housing to be separated from the first housing.

4. The housing assembly of claim 1, wherein the second housing is separately removable from the first housing without detaching the cover from the first housing, whereby a power source received and retained by the mounting structure of the cover is serviceable and is replaceable without opening of the first compartment.

5. The housing assembly of claim 1, wherein the attachment of the cover to the first housing comprises a press-fit engagement.

6. The housing assembly of claim 5, wherein the cover is further attached to the first housing by an adhesive.

7. The housing assembly of claim 5, wherein the cover is further attached to the first housing by mechanical fasteners.

8. The housing assembly of claim 1, further comprising a power source received and retained by the mounting structure of the cover and electrical contacts for conducting electrical current from the power source into the first compartment of the housing, and wherein the power source comprises a battery.

9. The housing assembly of claim 1, further comprising a sealing member abutting both said cover and said first hous-

ing such that the first compartment between closed and sealed by pressing a cover into engagement with the first housing with the seal between the cover and first housing.

10. The housing assembly of claim 9, wherein said sealing member comprises a pliable gasket received by a channel of the first housing and retained therein by the cover when the cover is attached to the first housing.

11. The housing assembly of claim 1, further comprising a base having slots formed therein for attaching the assembly to a structure such as a wall.

12. The housing assembly of claim 11, further comprising at least one of the group of screws, bolts, rivets, and nails extending through the slots in the base into a structure such as a wall.

13. The housing assembly of claim 1, further comprising electronic components disposed within the first compartment, and wherein the second housing is separately removable from the first housing without detaching the cover from the first housing, whereby the electrical components remain enclosed when the second housing is removed from the first housing.

14. The housing assembly of claim 13, further comprising a power source received and retained by the mounting structure of the cover and electrical contacts for conducting electrical current from the power source into the first compartment of the housing, and wherein the electronic components are powered by the power source by way of the electrical contacts.

15. The housing assembly of claim 13, wherein the electronic components comprise a printed circuit assembly (PCA) card, the PCA card being physically supported within the first housing by rails including in the first housing, opposite sides of the PCA card being received and retained by the rails.

16. The housing assembly of claim 13, wherein a standards based radio for two-way wireless communications.

17. The housing assembly of claim 13, wherein the electronic components comprise a sensor interface for acquiring data from one or more sensors associated with the assembly.

18. The housing assembly of claim 1, wherein the first compartment is water impenetrable for protection of electric components disposed therein, whereby a user may access the second compartment of the second housing without accessing the first compartment of the first housing thereby reducing risk of damage to said electronic components of said remote sensor interface.

* * * * *