

US007389563B2

(12) **United States Patent**  
**Martinez et al.**

(10) **Patent No.:** **US 7,389,563 B2**  
(45) **Date of Patent:** **Jun. 24, 2008**

(54) **CLEANING DEVICE WITH PIVOTING TANK**

(75) Inventors: **David Martinez**, Williamsport, PA (US);  
**Robert L. Crevling, Jr.**, Williamsport,  
PA (US)

(73) Assignee: **Shop Vac Corporation**, Williamsport,  
PA (US)

(\*) Notice: Subject to any disclaimer, the term of this  
patent is extended or adjusted under 35  
U.S.C. 154(b) by 98 days.

(21) Appl. No.: **11/294,025**

(22) Filed: **Dec. 5, 2005**

(65) **Prior Publication Data**

US 2007/0124885 A1 Jun. 7, 2007

(51) **Int. Cl.**  
**A47L 9/00** (2006.01)

(52) **U.S. Cl.** ..... **15/327.1; 15/327.2; 15/353**

(58) **Field of Classification Search** ..... None  
See application file for complete search history.

(56) **References Cited**

**U.S. PATENT DOCUMENTS**

763,855	A *	6/1904	Charlebois	.....	248/132
1,220,640	A *	3/1917	Kelly	.....	248/129
2,043,896	A *	6/1936	Larsen et al.	.....	248/132
3,930,630	A *	1/1976	Wulff	.....	248/129
4,193,161	A *	3/1980	Scott	.....	15/352
5,979,014	A	11/1999	Reichow et al.		
6,302,380	B1	10/2001	Ultimo, Sr. et al.		

6,318,808	B1	11/2001	Shayne
6,536,846	B1	3/2003	Felty
6,755,479	B1	6/2004	Meeks
2005/0200190	A1	9/2005	Nye

**OTHER PUBLICATIONS**

Clarke Company, "Flood Sucker" Vacuum (WAP SQ17AE).  
Goodway, Commercial Title Wet-Dry Vacuum 115V (EV-60-T).  
Nilfisk-ALTO, Wet & Dry Vacuum (ATTIX 761-21 XC 230/50 EU).  
Nilfisk-ALTO, Wet & Dry Vacuum (ATTIX 751-11 230/1/50 EU).  
Nilfisk-ALTO, Wet & Dry Vacuum (ATTIX 751-21 230/1/50 EU).  
Nilfisk-ALTO, Wet & Dry Vacuum (MAXXI WD7 230/1/50/ EU).

\* cited by examiner

*Primary Examiner*—David A Redding  
(74) *Attorney, Agent, or Firm*—Marshall, Gerstein & Borun  
LLP

(57) **ABSTRACT**

The disclosed cleaning device has a suction unit that can be used to take in liquid, a tank that can be used to hold the liquid, a mouth that can be used to pour liquid from the tank, and wheels that form a base. It also has a pivot that can be used to rotate the tank between a normal use position and a pouring position. The pivot is arranged so that in the pouring position, the center of gravity of the unit remains within the horizontal range of the base, even as the mouth of the tank falls outside the horizontal range of the base. As shown, the pivot is 12 inches above the floor and within the horizontal range of the base. In this position, it remains laterally between the center of gravity of the tank and the edge of the base when the tank is emptied.

**9 Claims, 2 Drawing Sheets**

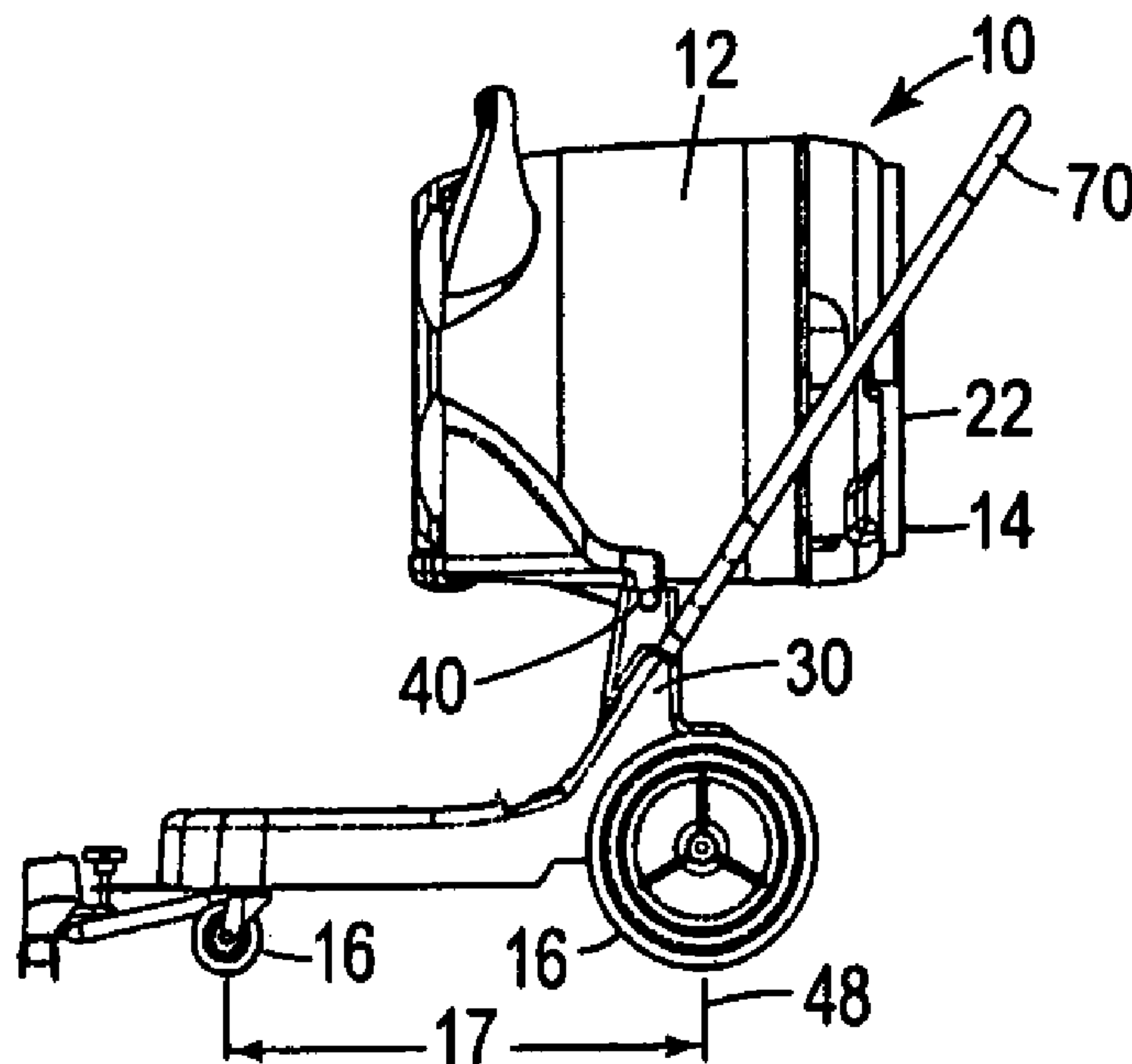

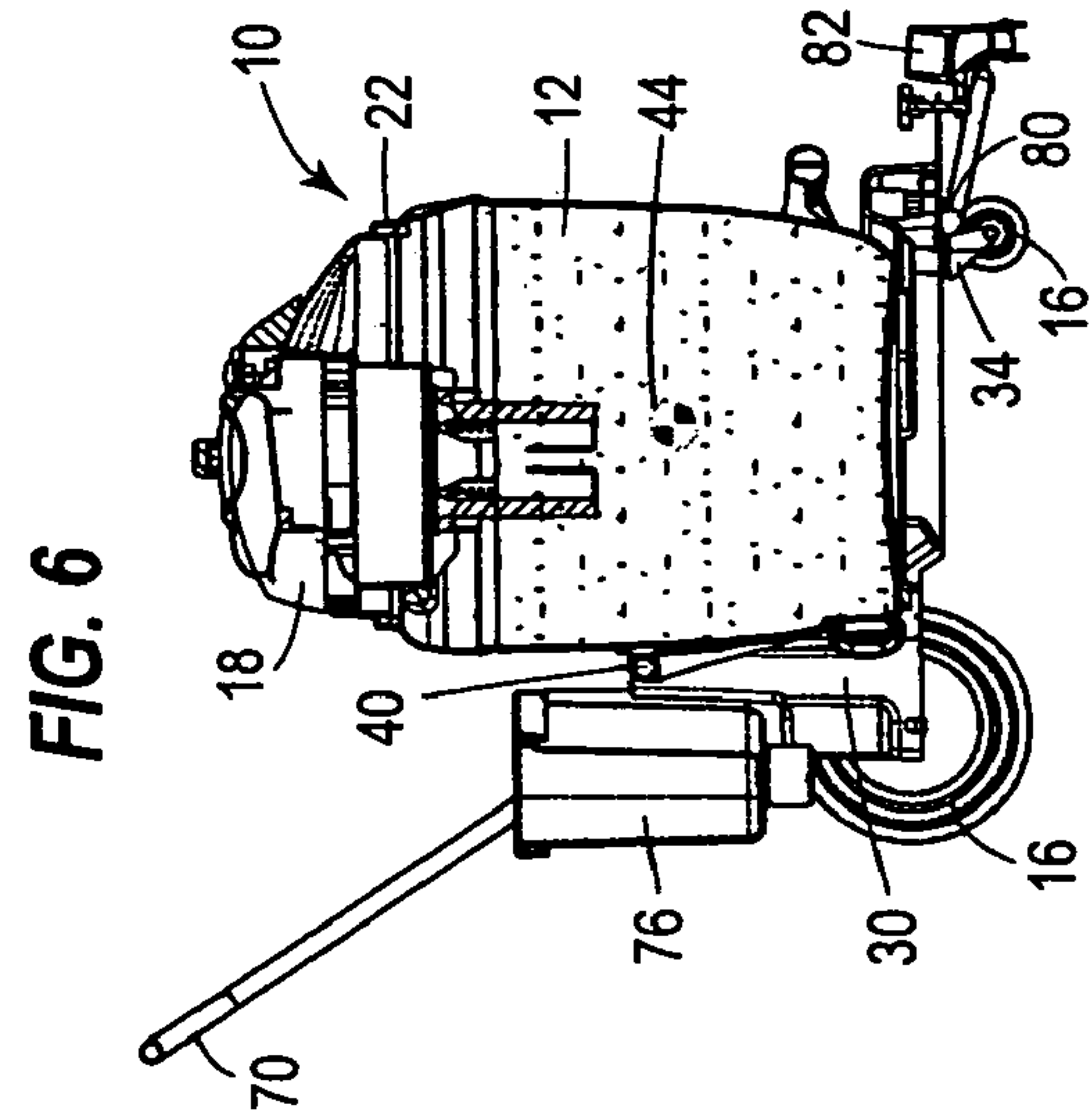
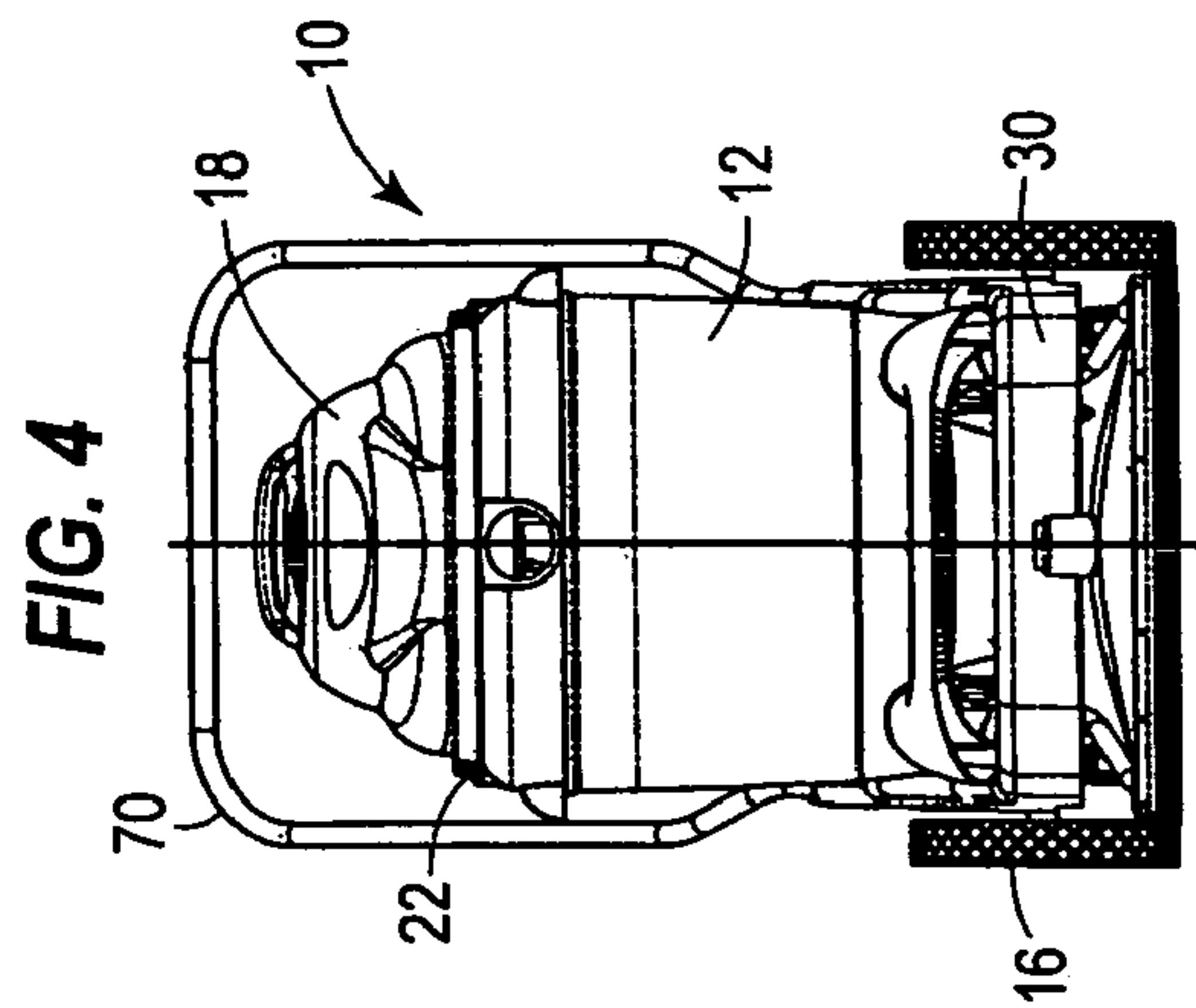
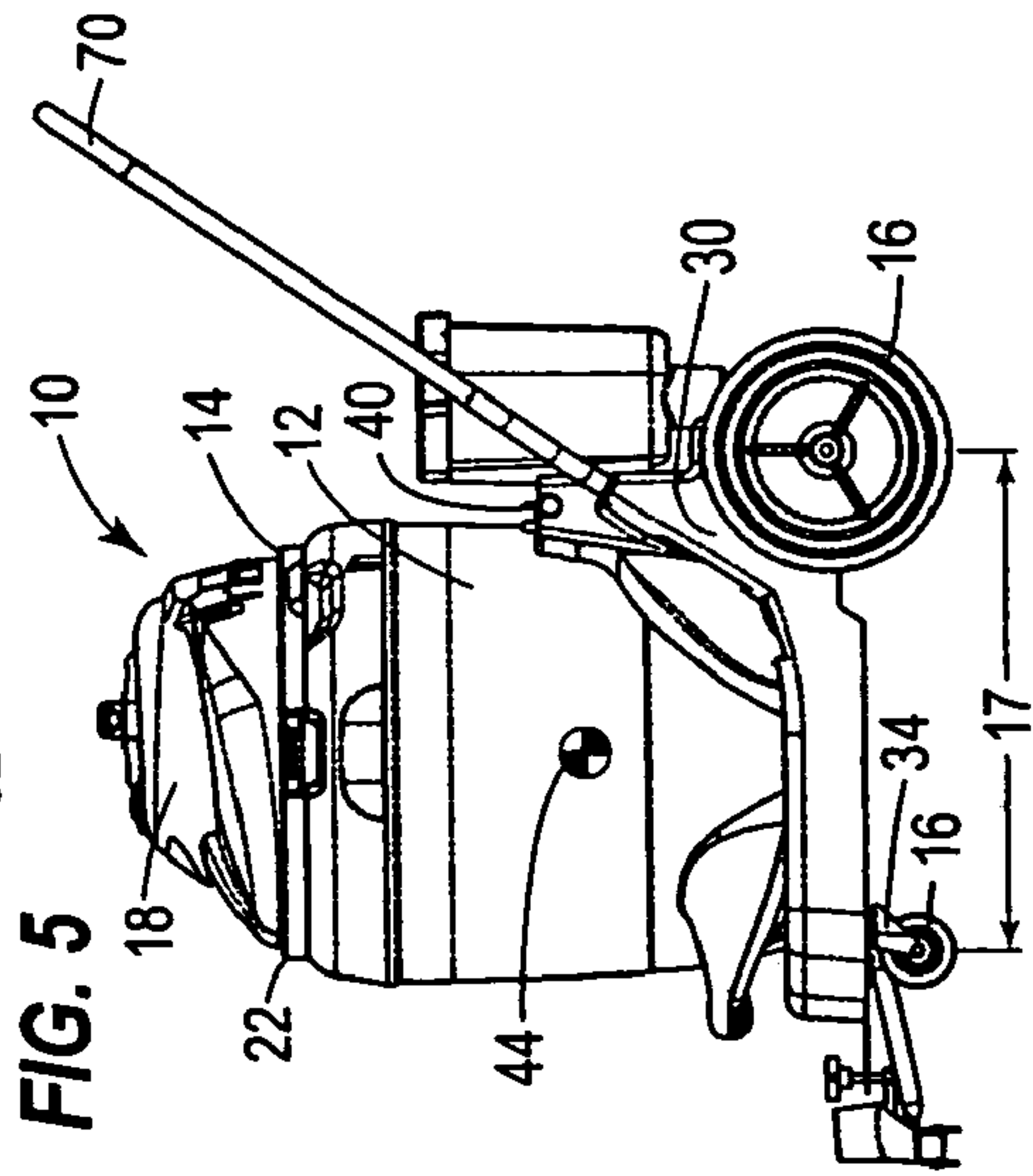
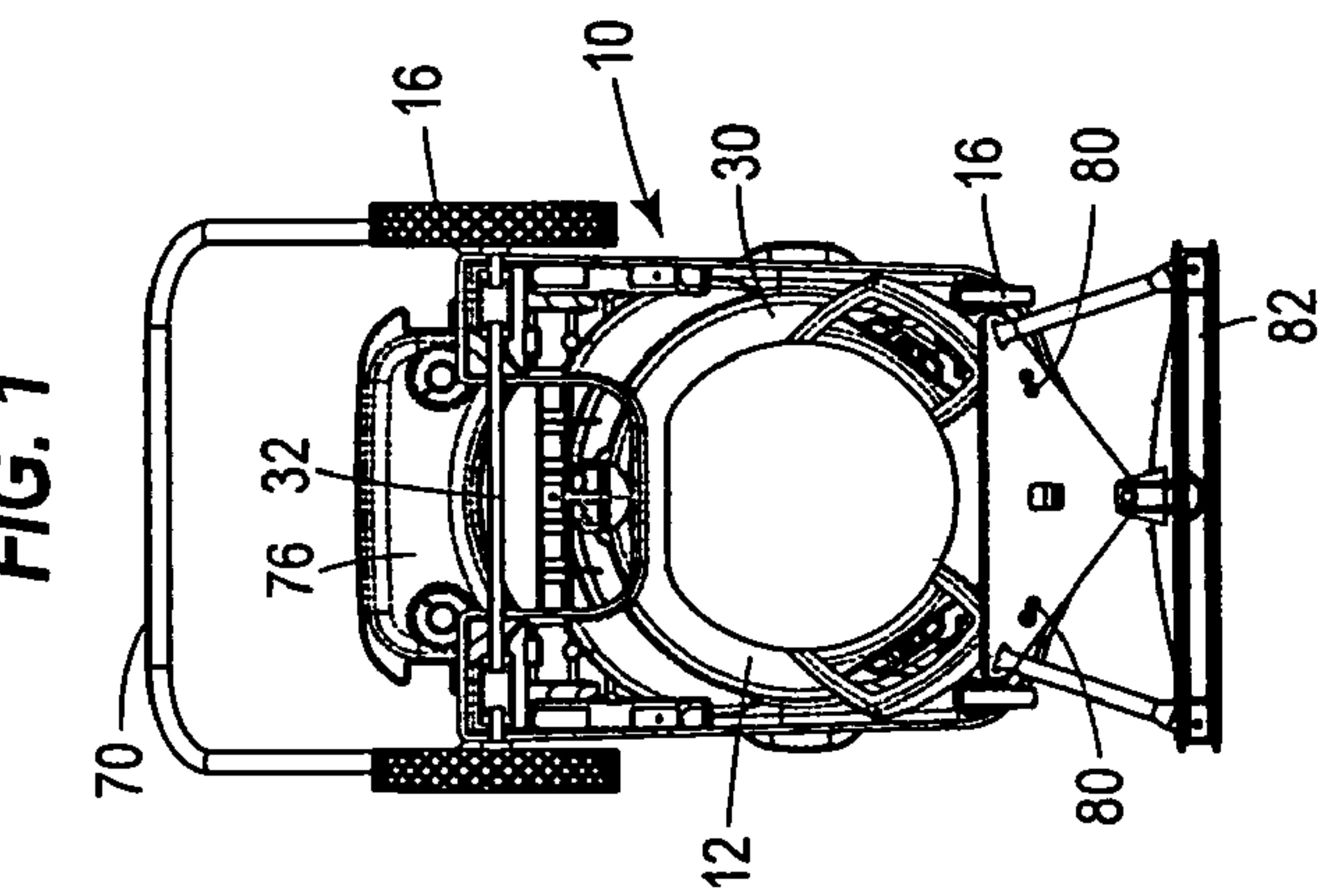
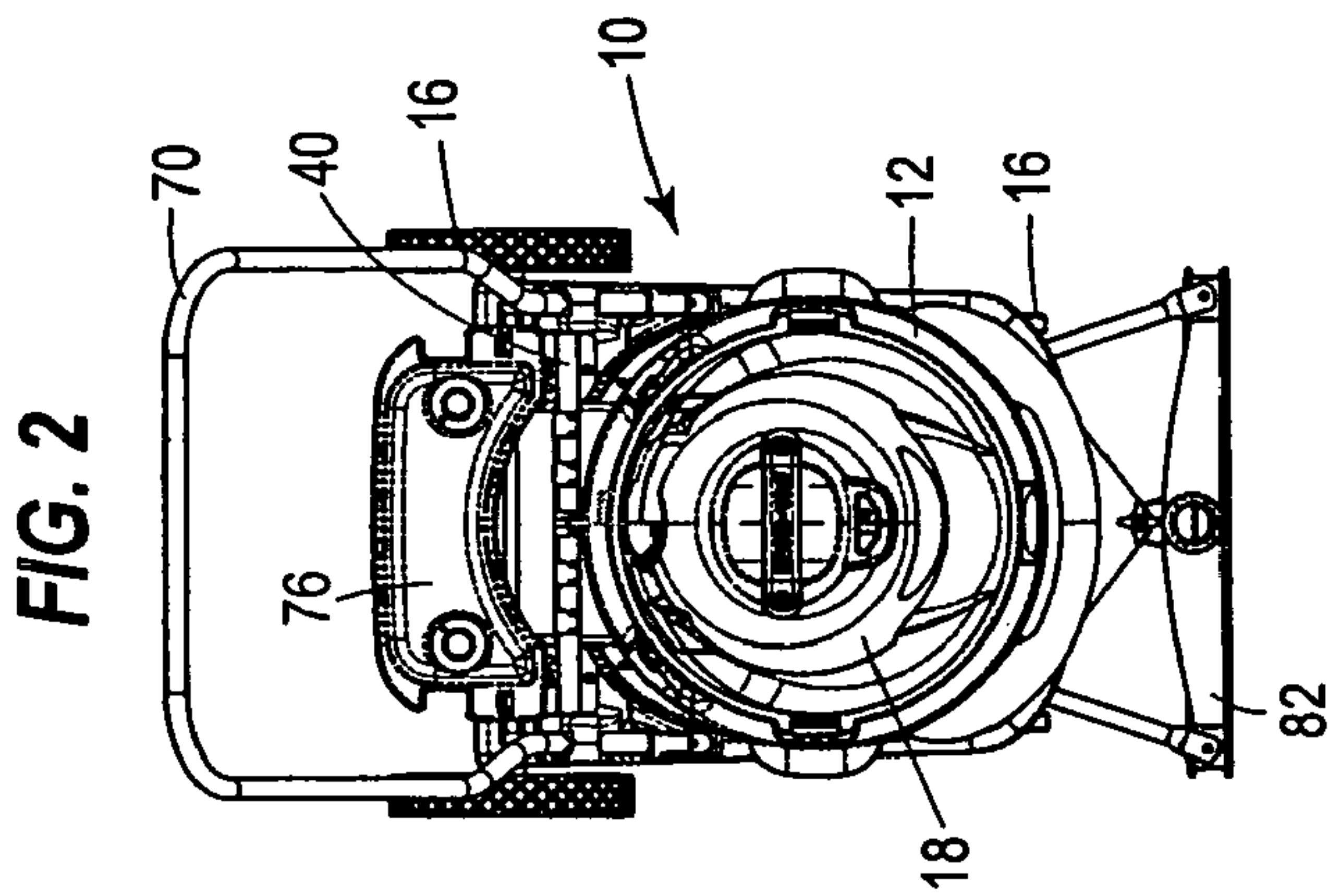
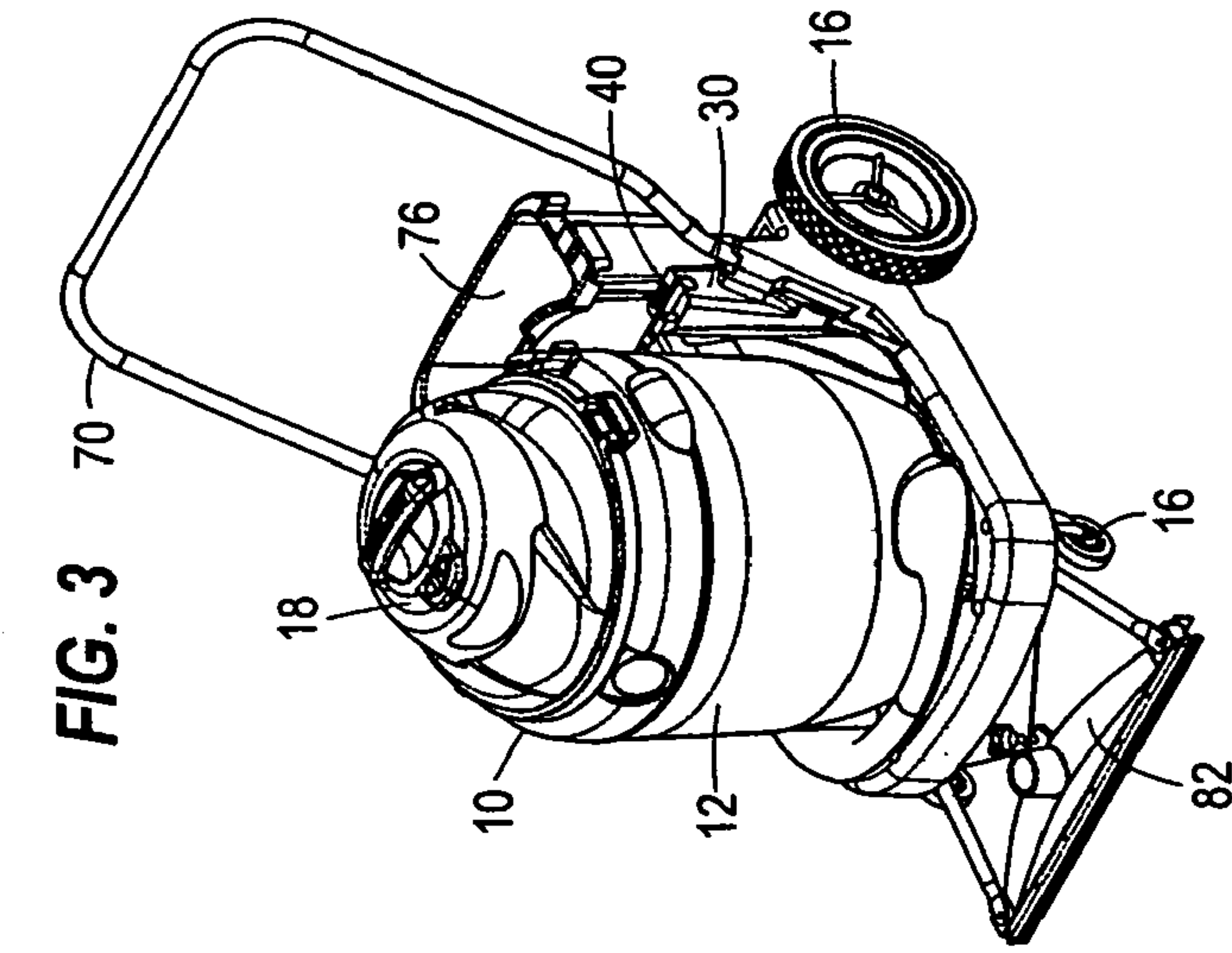



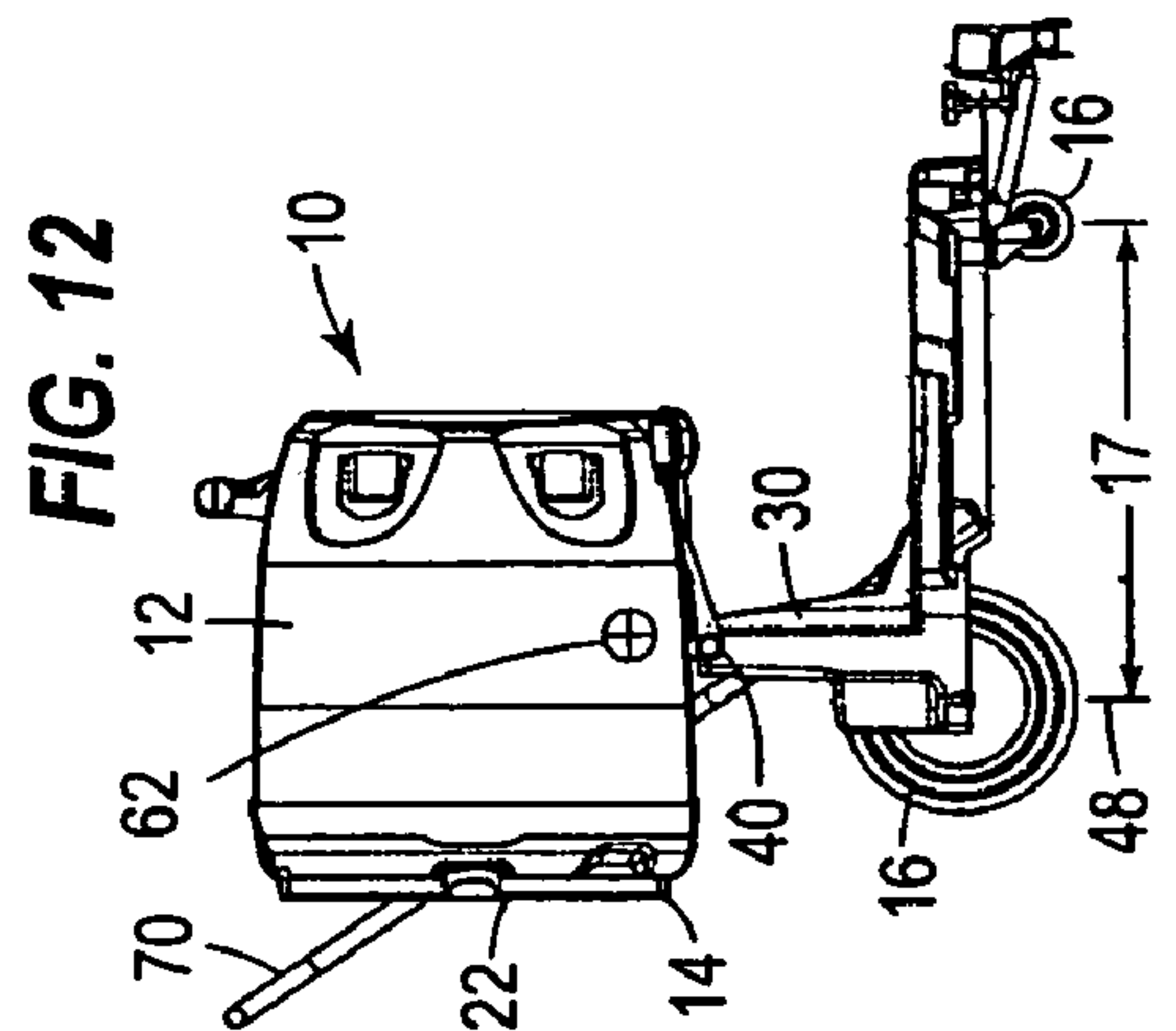
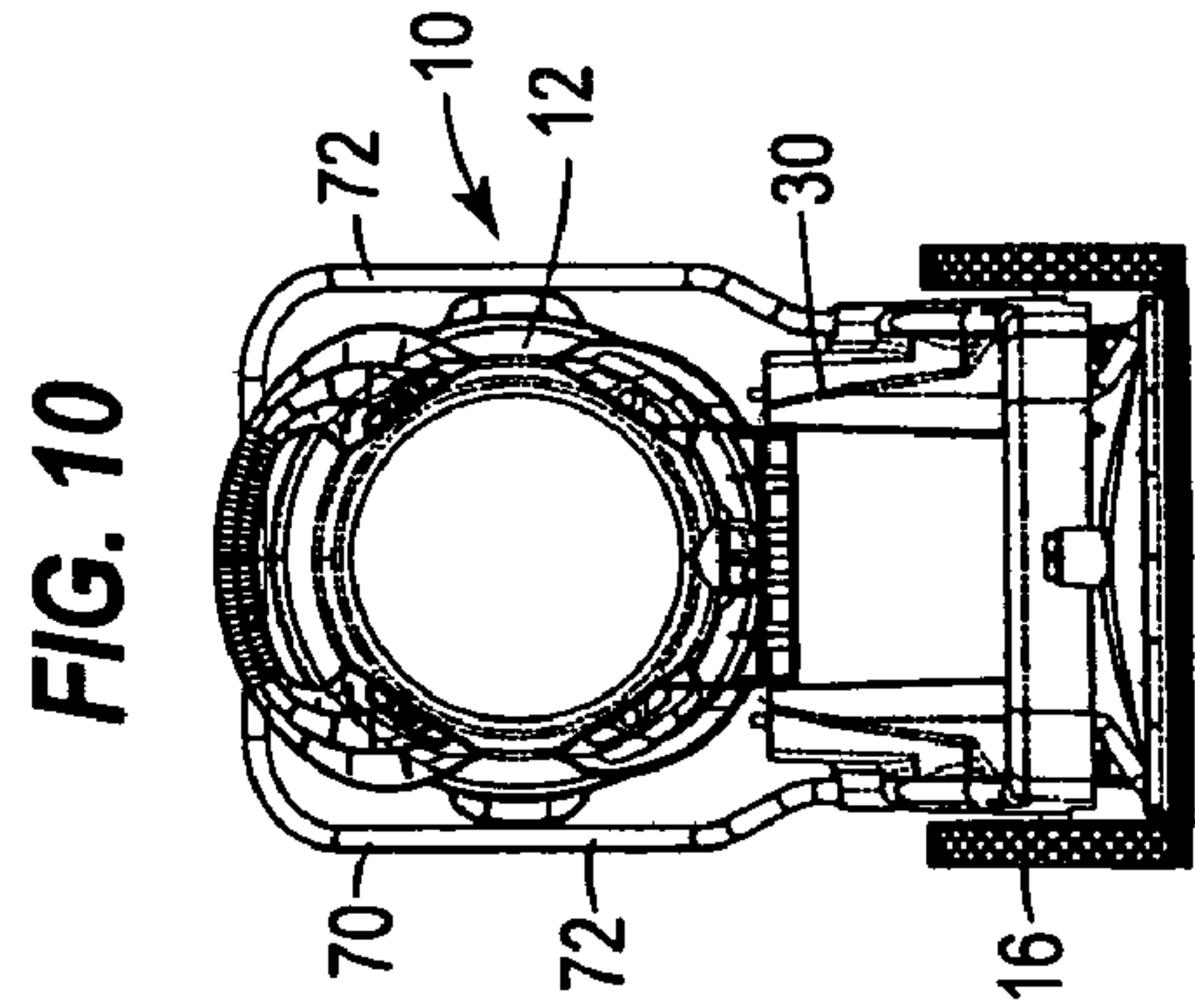
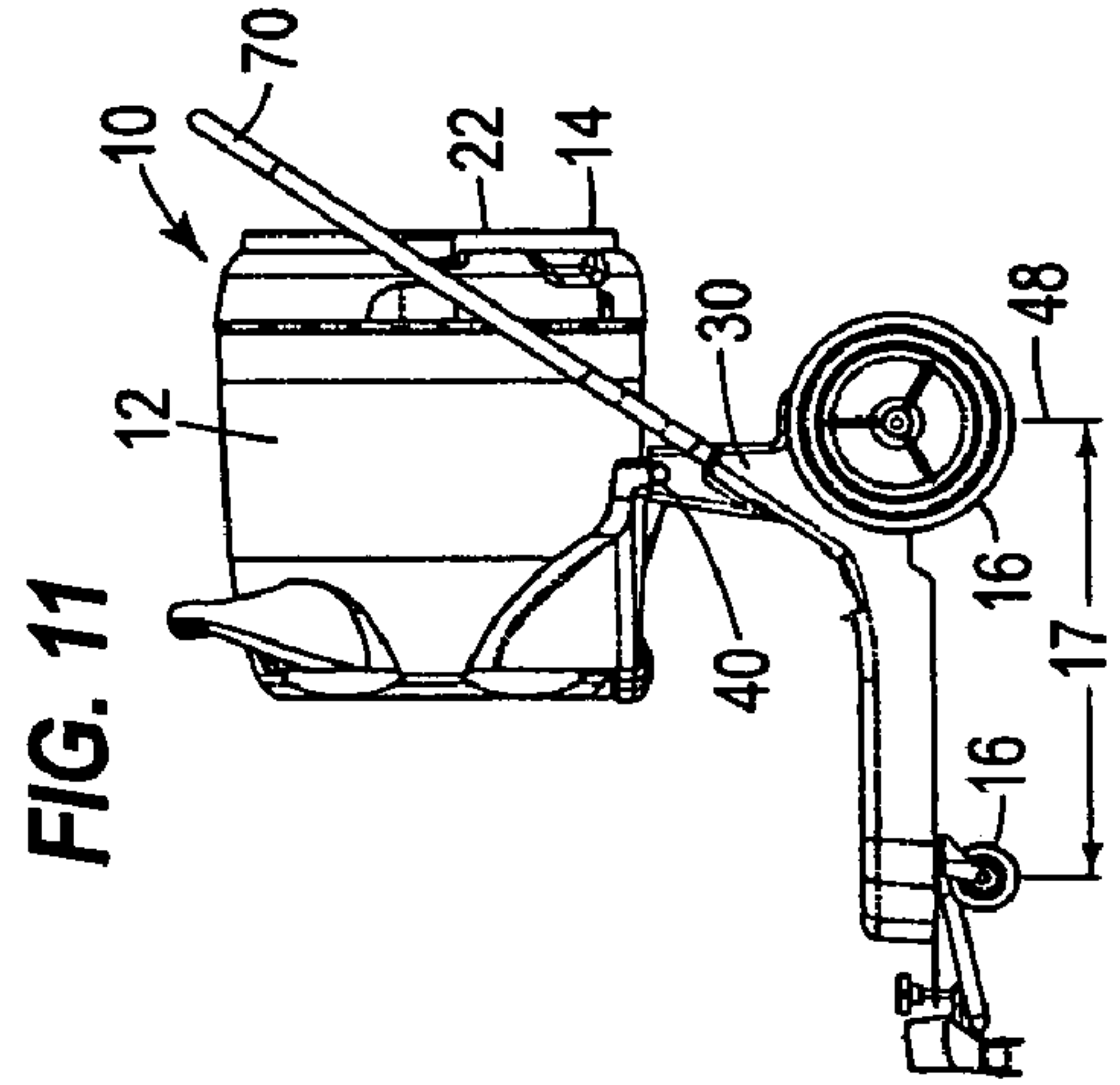
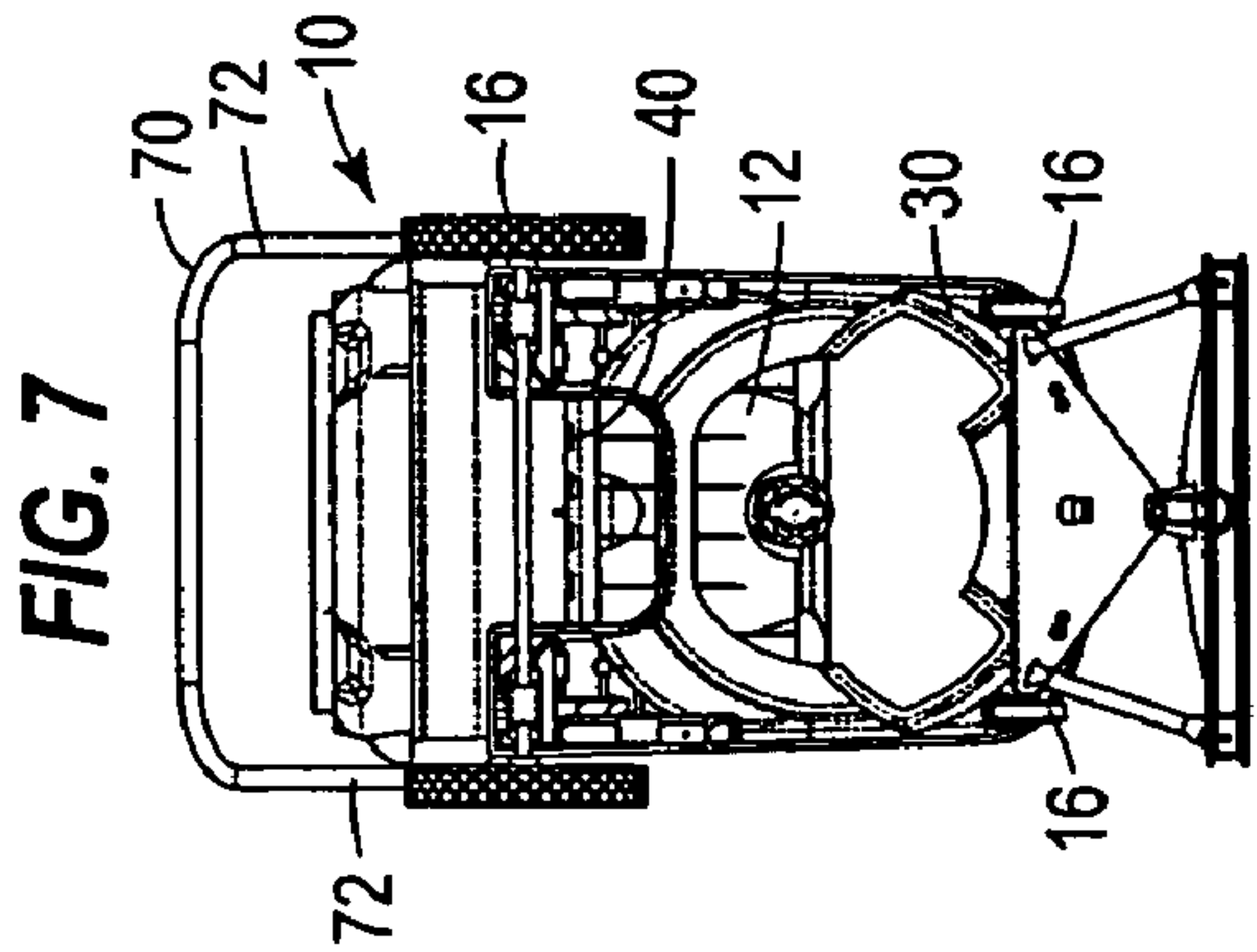
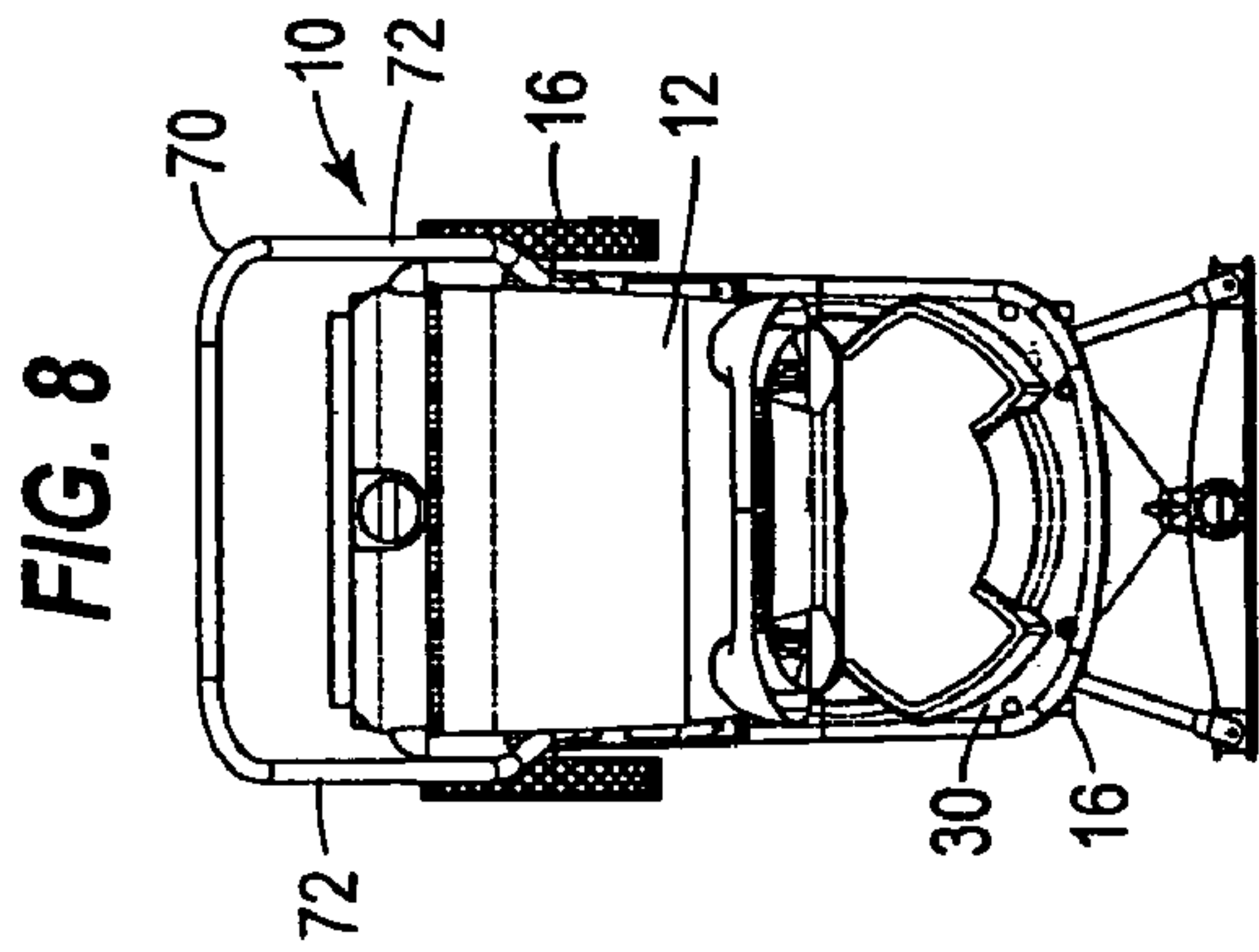
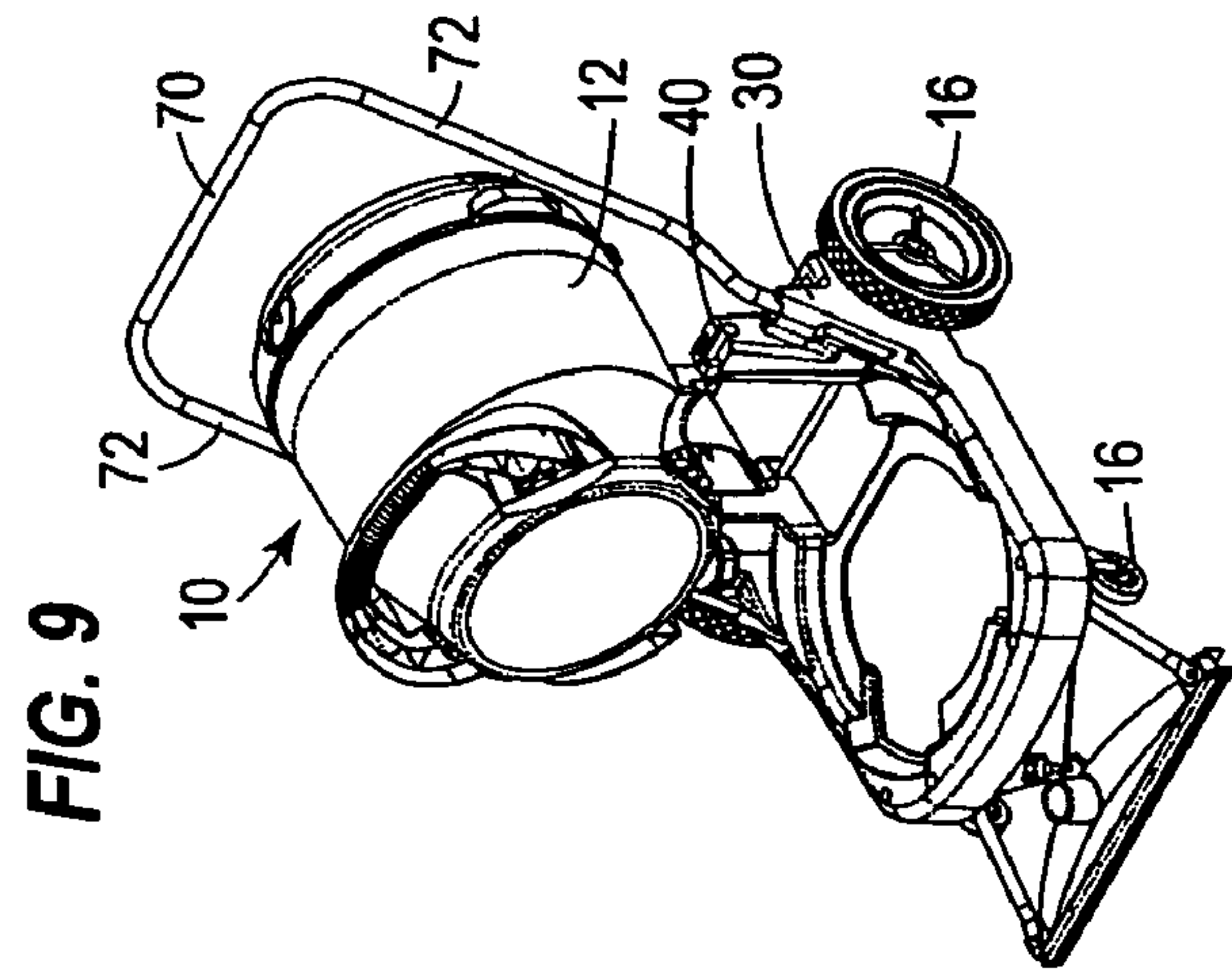



**1****CLEANING DEVICE WITH PIVOTING TANK****CROSS-REFERENCE TO RELATED APPLICATIONS**

Not applicable.

**BACKGROUND OF THE INVENTION**

The present invention relates generally to cleaning devices, and more particularly to cleaning devices that can take in liquid; devices such as wet/dry vacuums. Wet/dry vacuums include a tank that can be used to hold the liquid, and often have a mouth that can be used to pour liquid from the tank.

When filled with liquid, the tank in a wet/dry vacuum can be heavy. For large units, such as those for heavy-duty use in commercial or industrial settings, the weight can make it difficult to unload the tank.

Heavy-duty wet-dry vacuums are sometimes mounted on carts. For ease of emptying, tilt bars are sometimes provided on the cart. The tilt bar provides a support that can be used to help tilt the tank for emptying.

The use of a tilt bar can be awkward. Generally, when emptying a tank, it is desirable to position the mouth of the tank outside the base of the unit so that the liquid pours into another receptacle, rather than onto the base of unit itself. When using conventional tilt bars, the tank can sometimes flip over the tilt bar, or the cart itself can tip over. Both are usually undesirable.

**BRIEF SUMMARY OF THE INVENTION**

The applicants have developed an improved cleaning device that may be more stable during emptying of the tank. Like prior known devices, the cleaning device has a suction unit that can be used to take in liquid, a tank that can be used to hold the liquid, a mouth that can be used to pour liquid from the tank, and wheels that form a base. It also has a pivot that can be used to rotate the tank between a normal use position and a pouring position.

In the new arrangement, the pivot is arranged so that even in the pouring position, the center of gravity of the unit remains within the horizontal range of the base. The mouth of the tank may fall outside the horizontal range of the base.

Optionally, the pivot may be located within the horizontal range of the base, in a position where it remains laterally between the center of gravity of the tank and the edge of the base when the tank is emptied. In one embodiment of this arrangement, the pivot is positioned at least 12 inches above the floor.

It is also optional to arrange the unit so that the tank is tipped toward an opening formed between opposed arms of the handle. A removable storage basket may sometimes be fitted within that opening when the tank is in the normal, use position.

**BRIEF DESCRIPTION OF THE DRAWINGS**

The invention may be better understood by referring to the accompanying drawings, in which:

FIGS. 1 and 2 are bottom and top plan views of one embodiment of a cleaning device that incorporates the invention.

FIG. 3 is a perspective view of the device seen in FIGS. 1 and 2.

FIGS. 4 and 5 are elevational side and front views of the device.

**2**

FIG. 6 is a cross-sectional side view of the device.

FIGS. 7-12 are views, corresponding to the views of FIGS. 1-6, of the same device in a pouring position. In this position, the power head of the device has been removed.

**DETAILED DESCRIPTION**

The cleaning device **10** seen in the figures can be used to take in liquid. The device includes a tank **12** that can be used to hold the liquid, a mouth **14** (FIGS. 1, 11, 12) that can be used to pour liquid from the tank, and wheels **16** that form a base **17** (FIG. 5). A conventional suction unit is located within a power head **18** (FIGS. 1-6) that sits atop the tank in the normal use position, and can be removed for pouring liquid from the tank.

The illustrated tank **12** is a nominal 22-gallon plastic tank that is about 21 inches high and about 21 inches wide. When the tank is filled to its wet capacity and the power head **18** is removed, the liquid level is approximately 5 inches below the upper rim **22** (FIGS. 4-6) of the tank. The illustrated mouth **14** (FIGS. 11, 12) is part of the upper rim of the tank, and is positioned approximately 10 inches from the centerline of the tank. Metal tanks and tanks and mouths of other sizes, and shapes, and arrangements can also be used.

The wheels **16** are part of a dolly **30**. The illustrated wheels include a pair of 10-inch diameter rear wheels that are about 20 inches apart on a rear axle **32** (FIG. 1), and a pair of 3-inch diameter front wheels on front casters **34** (FIG. 6). The casters have stems that are about 16¾ inches apart and about 19½ inches from the rear axle. The wheels define the base **17**, and wheels of sizes and arrangements other than those illustrated can be used, and may be advantageous depending upon the size and configuration of the other elements of the device. In this example, the horizontal range of the base extends from the rear axle to the limits of the front wheels. A large base is preferred for stability.

The illustrated device **10** includes a pivot **40** that enables the tank **12** to rotate between a normal use position and a pouring position. In the use position (seen in FIGS. 1-6), both the mouth **14** and the in-use position center of gravity **44** of the device are between the rear axle **32** and the front casters **34** on the dolly **30** and are thus within the horizontal range of the base **17**. When the tank is rotated to the pouring position (seen in FIGS. 7-13), the mouth moves to a location outside the horizontal range of the base. Although not always necessary, this movement of the mouth usually makes it easier to empty the tank into another receptacle. The illustrated device is designed so that the tank can be emptied by tilting it toward the rear axle **32** of the dolly. In this arrangement, the rear axle may be designated as the "pouring-side edge" **48** of the base (FIG. 12). Other arrangements can also be used.

The illustrated pivot **40** is a hinge with a horizontal axis. One side of the hinge is fixed on a section of the dolly **30**, and the other side of the hinge is fixed to the tank **12** or to an adapter on the tank. In the illustrations, the pivot is located within the horizontal range of the base **17**, approximately 2 or 3 inches inwards from the pouring-side edge **48** of the base, approximately 15 inches above the floor (and about 12 inches above the bottom of the tank), and approximately 11 inches below the mouth **14**. Although these dimensions can be varied, the illustrated distance between the pivot and the floor (given the illustrated 2- or 3-inch distance between the axis of the pivot and the inside surface of the tank) may be advantageous for pouring the tank into a standard-height toilet.

In some previously-known devices, tilt bars are positioned outside the horizontal range of the base. While these arrangements may be stable in the normal use position, tilting the



3

tank during emptying operations generally causes the center of gravity of the unit and any contained liquid to move. If the center of gravity of the unit and any contained liquid moves rearwardly of the pouring-side edge, the unit can become unstable and tip over. Similarly, if the center of gravity of the tank itself and any contained liquid move rearwardly of the tilt bar, the tank can tip over the tilt bar.

Incoming liquid will also move the in-use center of gravity **44** of the device **10**. However, arranging the device so that none of the internal volume of the tank **12** is located outside the pivot **40** or outside horizontal extent of the base **17** assures that—so long as the unit is kept level—the in-use position center of gravity will not move outside the base, no matter how much liquid is added.

More importantly, the new arrangement tends to keep the shifting center of gravity **62** (FIG. **12**) of the device **10** and any contained liquid within the horizontal range of the base **17** even when the tank **12** is being emptied. Although tipping the tank rearwardly may cause the shifting center of gravity of the device and any contained liquid to move up and back, the pivot **40** is sufficiently high and inward from the pouring-side edge **48** to tend to keep the shifting center of gravity of the device and any contained liquid within the horizontal extent of the base, even as the mouth **14** moves outside the base and liquid begins to pour out of the tank. As a result, the illustrated arrangement minimizes the possibility of the unit tipping over when the tank is emptied.

Similarly, the illustrated arrangement keeps the center of gravity of the tank **12** itself and any contained liquid forward of the pivot **40**, minimizing the risk of the tank from tipping over the pivot during emptying. This is not always necessary, however, and other arrangements can also be used.

The illustrated device **10** also has a rearwardly-extending handle **70** that has opposed arms **72** (FIG. **9**). The opposed arms form an opening that the tank **12** moves into when being emptied. A removable storage basket **76** (FIGS. **1-3**) can be mounted within that opening when the tank is in the normal use position.

Optional mounts **80** (FIGS. **1, 6**) on the front of the dolly **30** permit attachments to be added. An optional floor nozzle **82** is illustrated. Other attachments can also be used.

This description of various embodiments of the invention has been provided for illustrative purposes. Revisions or modifications may be apparent to those of ordinary skill in the art without departing from the invention. The full scope of the invention is set forth in the following claims.

The invention claimed is:

**1.** A vacuum cleaner that has:

a wheelbase;

a tank that has an outer, circumferential wall and holds liquid;

4

a suction unit that connects to the tank and takes in liquid; a mouth on the tank that can be used to pour liquid from the tank;

a hinge that is connected to an elevated portion of the outer wall and has an axis that is tangent to the outer wall; and

a pivot that is positioned within the wheelbase, connects the hinge to a raised portion of the base, and enables the tank to rotate between a use position and a pouring position while maintaining the center of gravity of the device and any contained liquid within the wheelbase.

**2.** A vacuum cleaner as recited in claim **1**, in which the mouth moves to a location outside the wheelbase when the tank is rotated to the pouring position.

**3.** A cleaning device as recited in claim **1**, in which:

the pivot is located between a use-position center of gravity of the cleaning device and a pouring-side edge of the base; and

the device is arranged so that as liquid is poured from the tank, the pivot remains between a center of gravity of the tank itself and the pouring-side edge of the base.

**4.** A cleaning device as recited in claim **1**, in which, in the use position, the pivot is located at least 12 inches above the floor.

**5.** A cleaning device as recited in claim **1**, in which, in the use position, the pivot is located between a center of gravity of the tank itself and a pouring-side edge of the base.

**6.** A cleaning device as recited in claim **1**, in which, in the use position, the pivot is located between a center of gravity of the tank itself and a pouring-side edge of the base, and at least 12 inches above the floor.

**7.** A cleaning device as recited in claim **1**, in which the device also has a handle with opposed arms that form an opening that the tank moves into when being moved to the pouring position.

**8.** A cleaning device as recited in claim **1**, in which the device also has a handle with opposed arms that form an opening that the tank moves into when being moved to the pouring position, and a removable storage basket that fits within that opening when the tank is in the use position.

**9.** An improved cleaning device with a suction unit that can be used to take in liquid, a tank that can be used to hold the liquid, a mouth that can be used to pour liquid from the tank, a wheelbase, and a pivot that is attached to and has an axis that is tangent to an outer wall of the tank, enables the tank to rotate between a use position and a pouring position, and moves the mouth to a location outside the wheelbase, the improvement being:

that the pivot is positioned inside the wheelbase.

\* \* \* \* \*