

US007196266B2

(12) **United States Patent**
Binder et al.

(10) **Patent No.:** **US 7,196,266 B2**
(45) **Date of Patent:** ***Mar. 27, 2007**

(54) **ADAPTER FOR MOUNTING A FACEPLATE OF A FIRST STYLE TO AN ELECTRICAL OUTLET CAVITY OF A SECOND STYLE**

(75) Inventors: **Yehuda Binder**, Hod Hasharon (IL);
Ami Hazani, Ra'anana (IL)

(73) Assignee: **Serconet Ltd.**, Ra'anana (IL)

(*) Notice: Subject to any disclaimer, the term of this patent is extended or adjusted under 35 U.S.C. 154(b) by 0 days.

This patent is subject to a terminal disclaimer.

(21) Appl. No.: **11/453,831**

(22) Filed: **Jun. 16, 2006**

(65) **Prior Publication Data**

US 2006/0231281 A1 Oct. 19, 2006

Related U.S. Application Data

(63) Continuation of application No. 11/006,582, filed on Dec. 8, 2004, now Pat. No. 7,109,418, which is a continuation of application No. 10/451,544, filed as application No. PCT/IL01/00896 on Sep. 25, 2001, now Pat. No. 6,927,340.

(51) **Int. Cl.**
H02G 3/14 (2006.01)

(52) **U.S. Cl.** **174/66; 174/67; 220/241**

(58) **Field of Classification Search** **174/66, 174/67; 220/240, 241; 33/528; 312/328; D8/353; D13/177**

See application file for complete search history.

(56) **References Cited**

U.S. PATENT DOCUMENTS

6,184,468 B1 2/2001 Speziale
6,373,944 B1* 4/2002 Beavers 379/438

FOREIGN PATENT DOCUMENTS

DE 43 11 137 A1 10/1994
DE 195 36 943 A 4/1997
DE 299 07 456 U1 7/1999
WO WO 98/54806 12/1998

* cited by examiner

Primary Examiner—Dhiru R. Patel

(74) *Attorney, Agent, or Firm*—Browdy and Neimark, PLLC

(57) **ABSTRACT**

An adapter for mounting electrical outlet faceplates designed for mounting on rectangular junction boxes in hollow walls onto solid walls with cylindrical cavities and sleeves. Junction box mounting is popular in North America, whereas cavity mounting is popular in Europe and the Middle East. Such an adapter provides universal mounting for specialized faceplates which are designed and intended for junction box mounting. The adapter features clamps for gripping the inner surface of a wall cavity or sleeve and a rectangular plate for mounting an faceplate designed for junction box mounting. The rectangular plate has mounting points with a nominal center-to-center distance of 3 inches, corresponding to the requirements of junction box mounting.

14 Claims, 7 Drawing Sheets

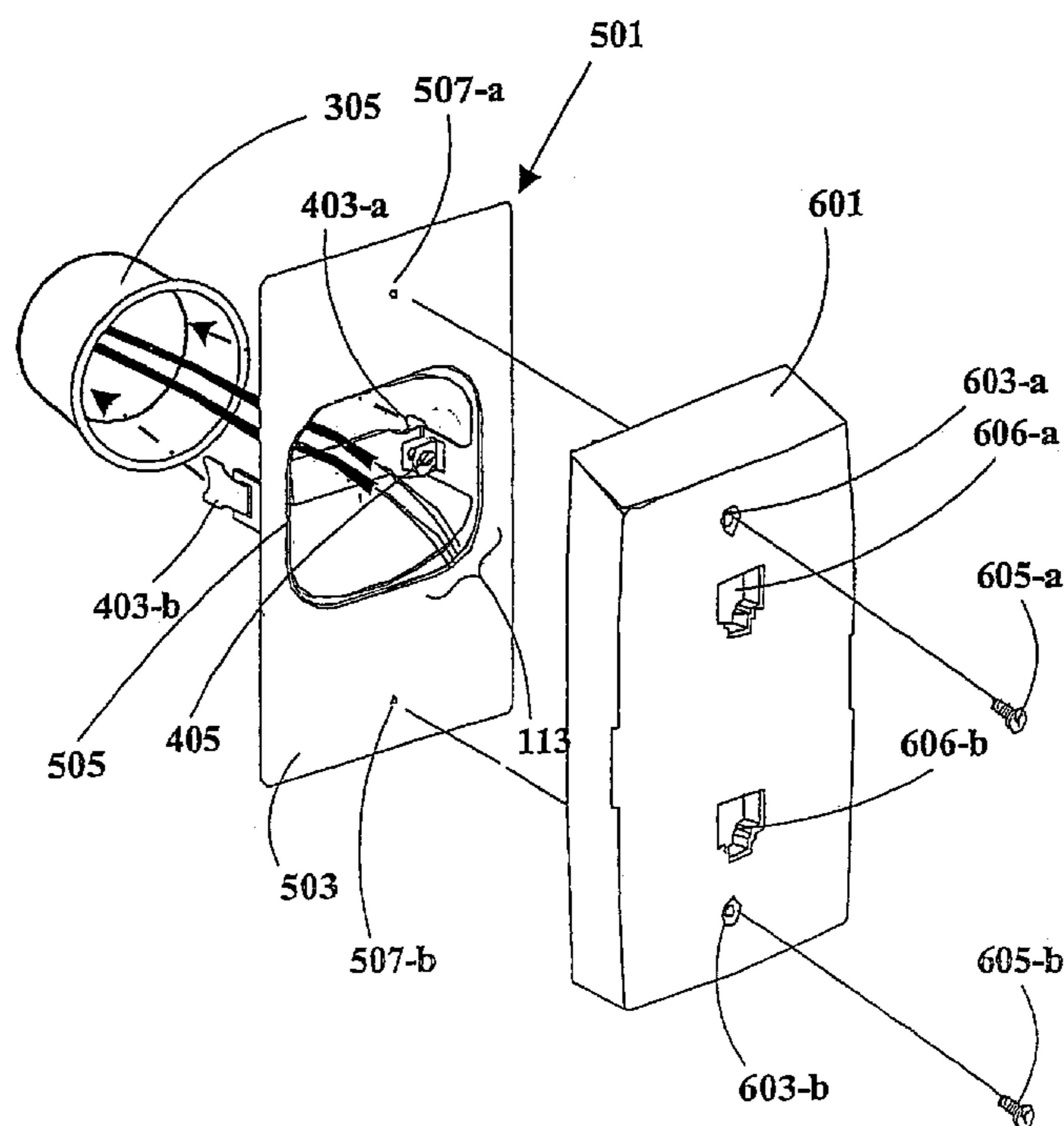

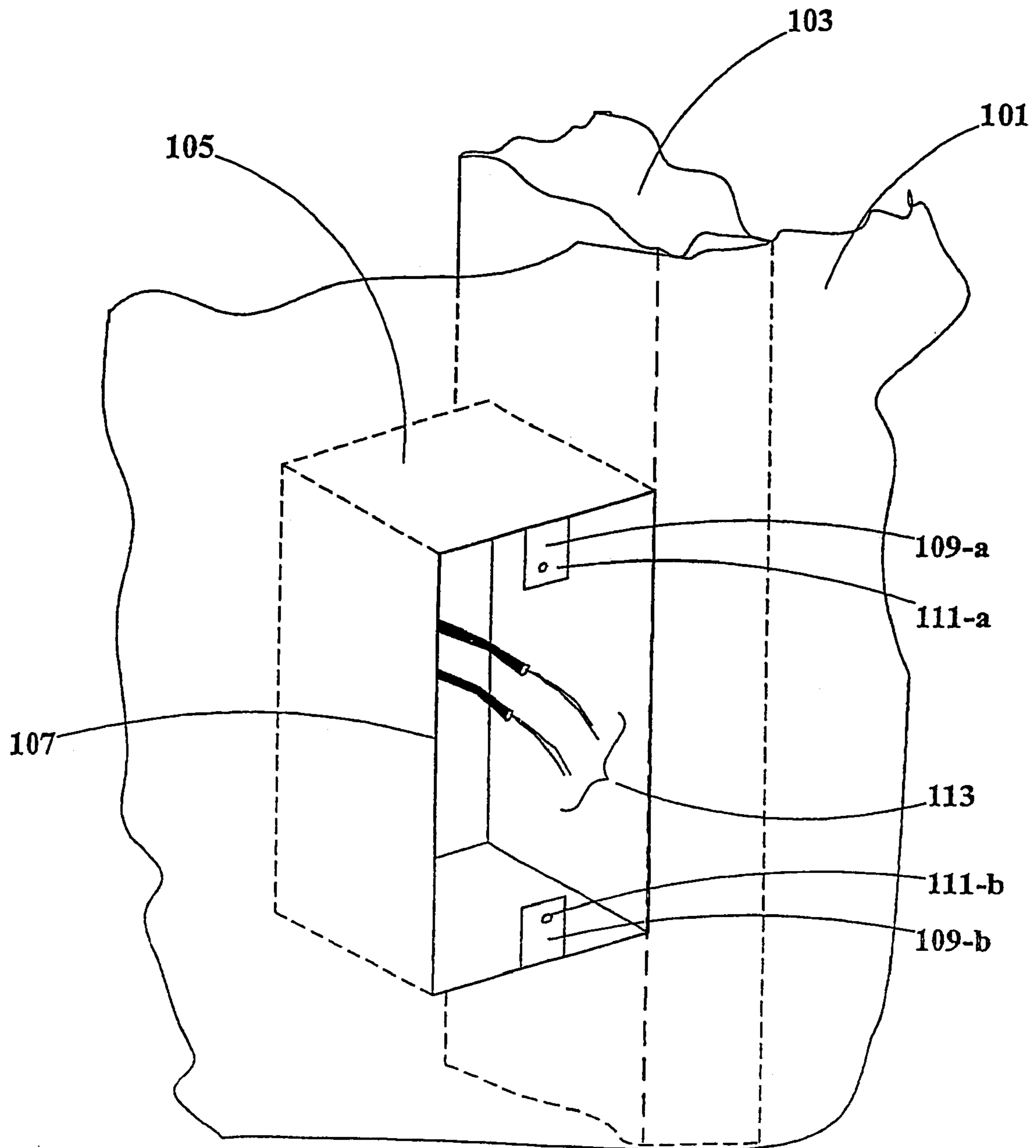

FIG. 1 (PRIOR ART)

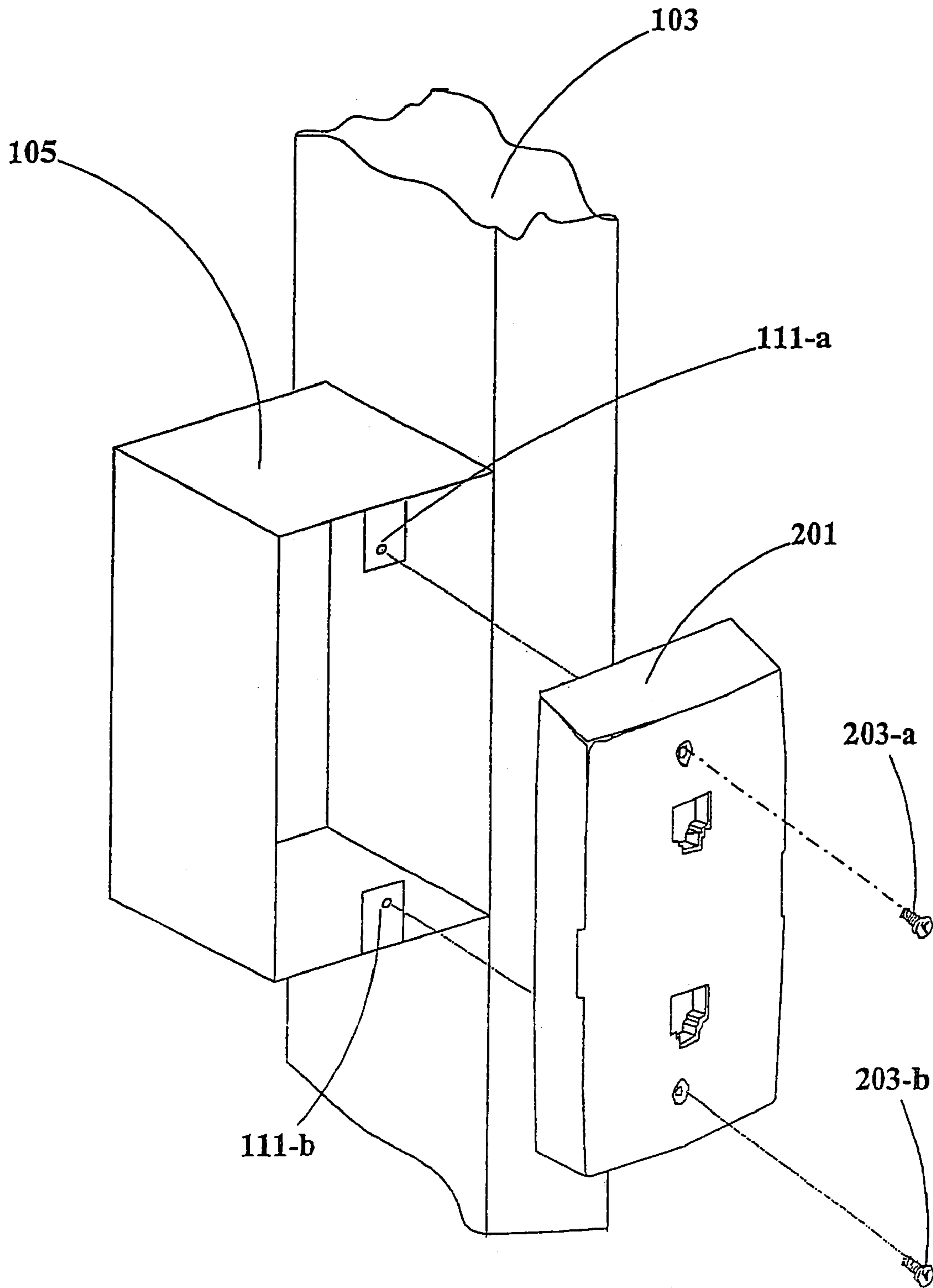

FIG. 2 (PRIOR ART)

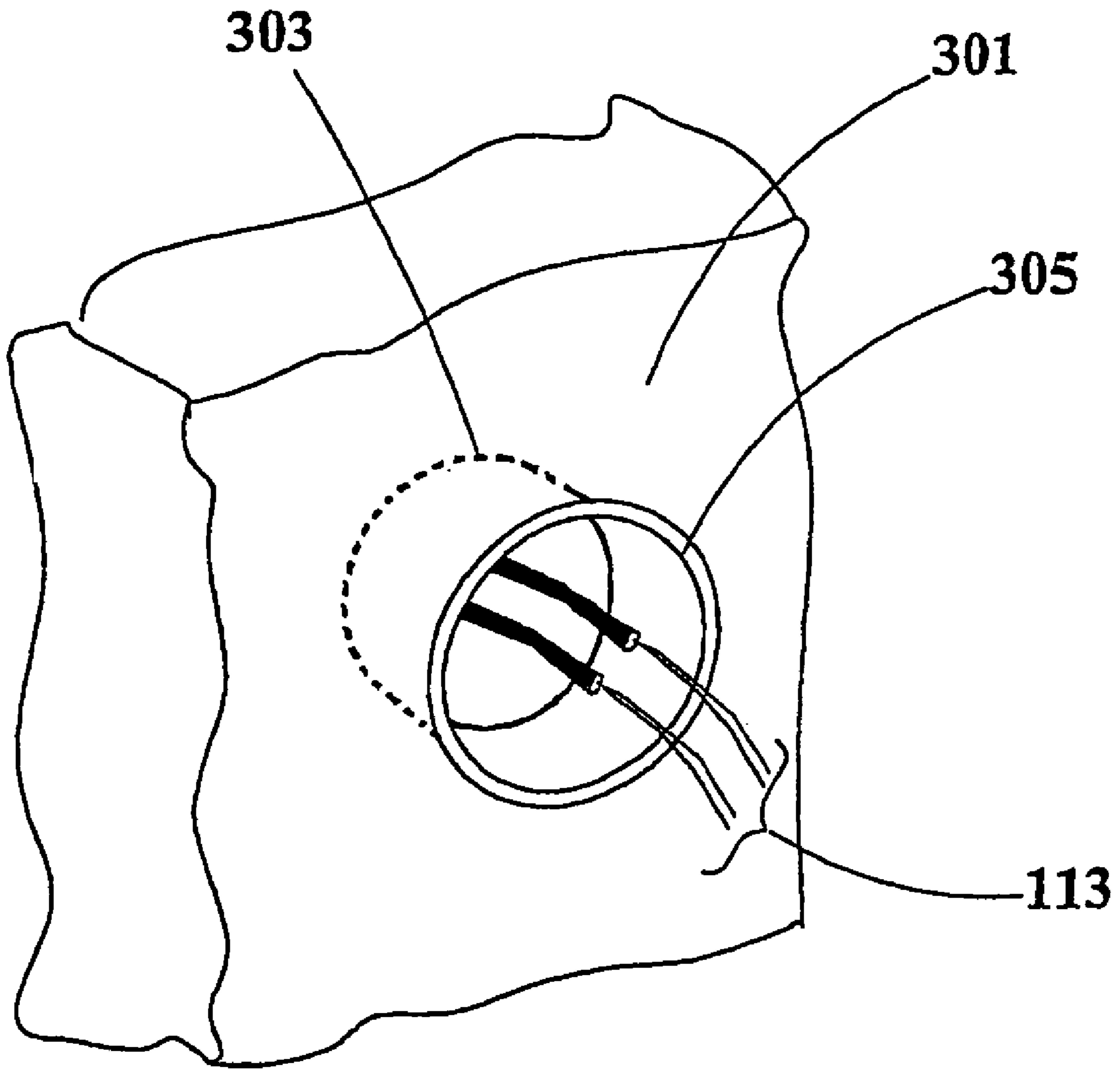

FIG. 3 (PRIOR ART)

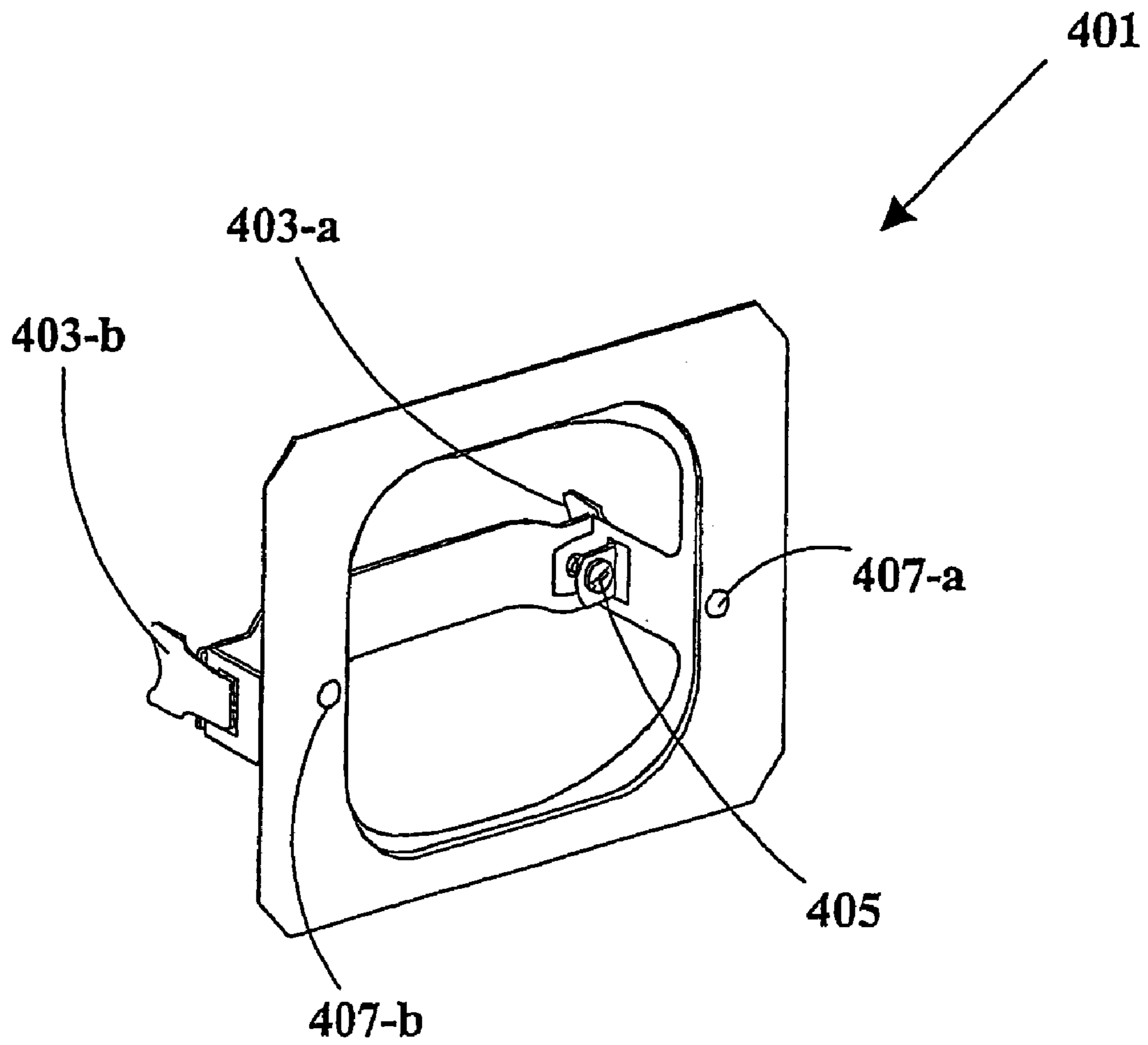

FIG. 4 (PRIOR ART)

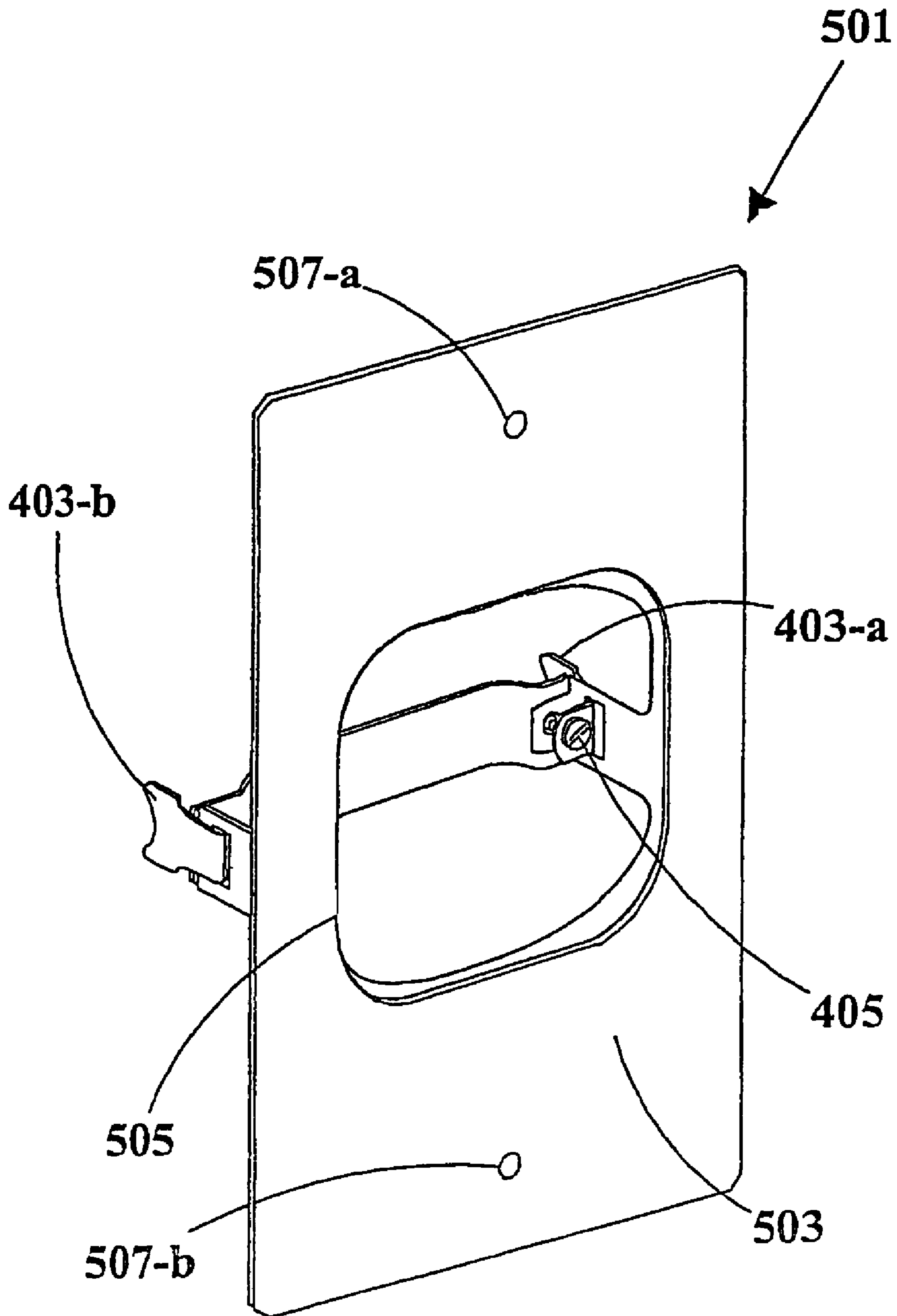

FIG. 5

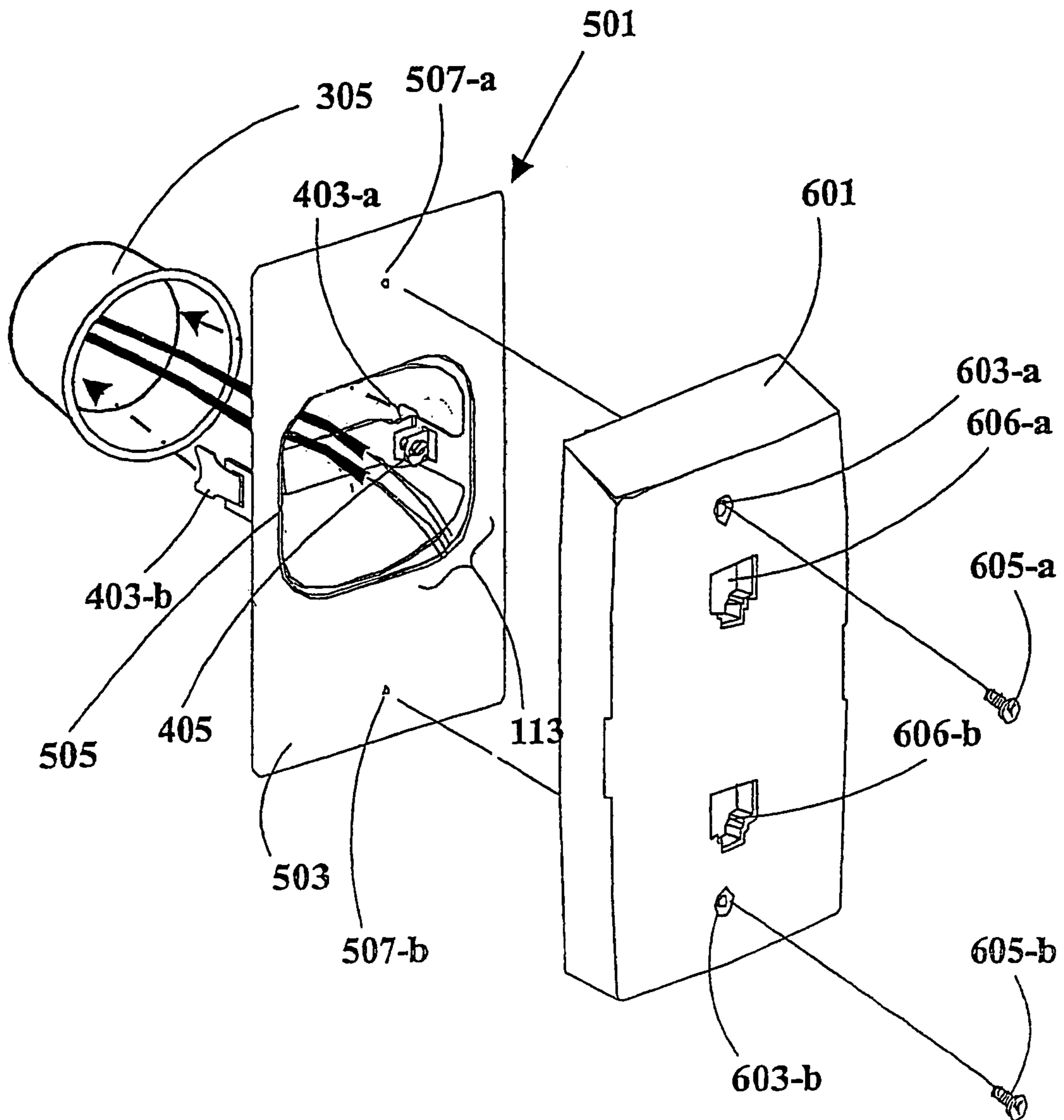

FIG. 6

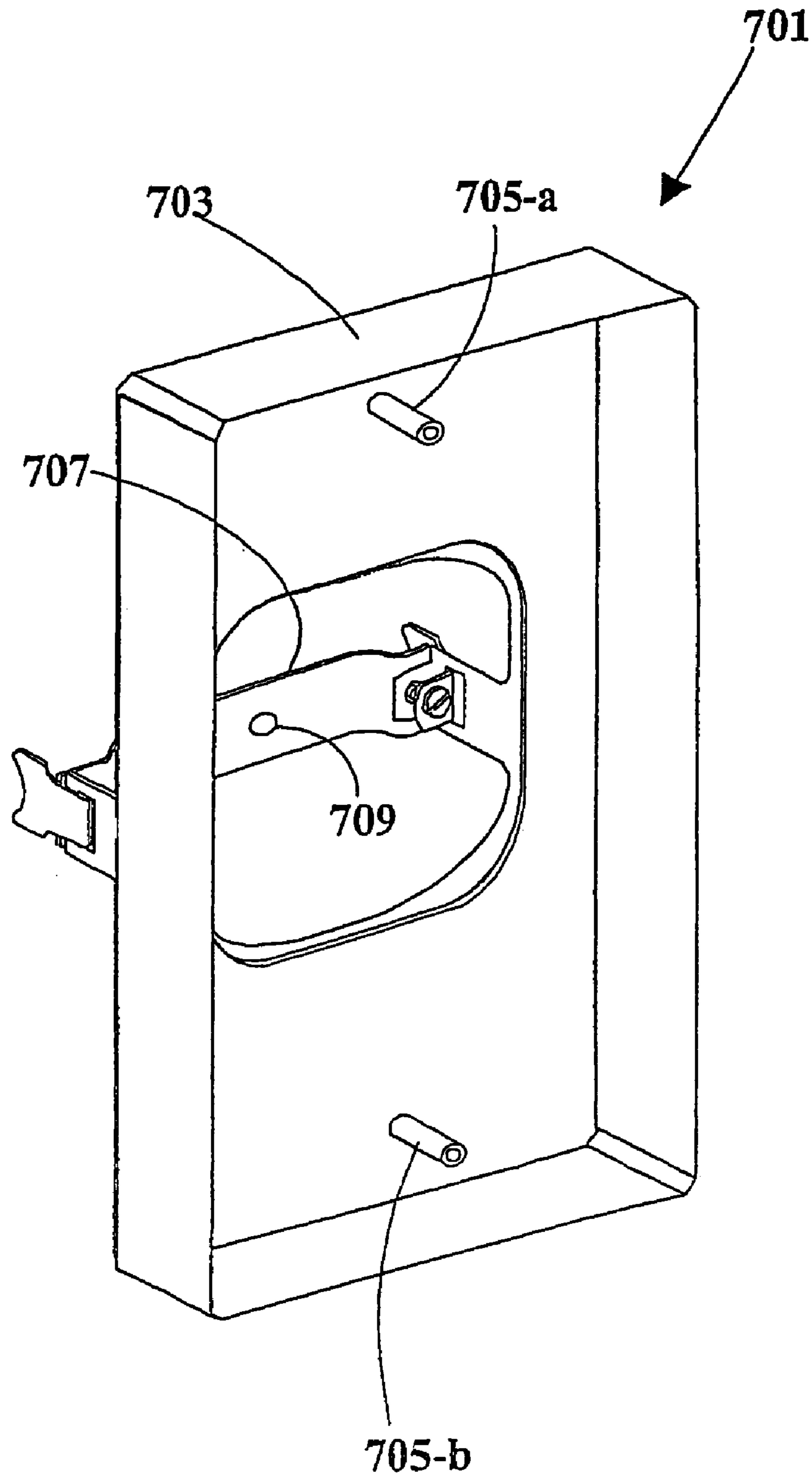

FIG. 7

**ADAPTER FOR MOUNTING A FACEPLATE
OF A FIRST STYLE TO AN ELECTRICAL
OUTLET CAVITY OF A SECOND STYLE**

CROSS REFERENCE TO RELATED
APPLICATIONS

This is a continuation of application Ser. No. 11/006,582 filed Dec. 8, 2004 now U.S. Pat. No. 7,109,418, which is itself a continuation of parent application Ser. No. 10/451,544, nationalized Jun. 24, 2003, which parent application is the national stage of international application PCT/IL01/00896, filed Sep. 25, 2001, and is now U.S. Pat. No. 6,927,340, issued on Aug. 9, 2005.

FIELD OF THE INVENTION

The present invention relates to a mechanical mounting adapter for electrical fixtures and the like, and, more particularly, to a wall mounting adapter for outlets and similar fixtures.

BACKGROUND OF THE INVENTION

Wall outlets for electrical apparatus and the like are in widespread use, allowing convenient connection of devices such as electrical appliances, telephones, cable television receivers, and computers to electrical power mains and communication networks. In addition, similar fixtures are often attached to walls, floors, and ceilings, and are connected in like manner to electrical power and communications networks. The term "wall" herein denotes any fixed surface to which socket outlets are commonly connected and includes, without limitation, walls of a building or similar structure regardless of orientation (including, but not limited to vertical walls, as well as floors and ceilings), as well as surfaces of other structures to which socket outlets may be fixed, such as cupboards and desk tops particularly when fixedly mounted in a room. Likewise, the term "outlet" herein denotes a non-limiting instance of a fixture for attachment to a wall or other fixed structure, enabling access to in-wall wiring, commonly via faceplate panel connector. Other fixture types include, but are not limited to, wall-mounted electrical lighting and appliances, controls, switches, sensors, data devices, telephony equipment, and intercommunication devices. Outlets commonly uses in-wall dedicated cavity, but some types are surface-mount, fully installed over the wall surface.

Outlets commonly comprise two distinct parts:

(a) Faceplate. The outer part of the outlet, commonly formed of plastic and comprising a front panel accommodating a standard connector for connecting to the in-wall wiring. The front panel of the faceplate is usually decorative, being the only exposed outlet part after the installation.

(b) Wall mounting fixture. This fixture is mechanically attached to the wall on the wall inner side, and is attached to the faceplate on the wall outer side thereby fixing the outlet to the wall. Commonly, the faceplate is attached to the wall-mounting fixture by means of two screws.

There are two principal outlet types that are in common use, depending on the style of wall construction and the opportunities consequently available for mechanically attaching fixtures to a wall and providing electrical or signal connections thereto.

One such wall mounting fixture system is the "junction box" style as illustrated in FIG. 1. The junction box style is common in North America and is used with a hollow wall

construction in which a wall section **101** is held in place and supported by a support beam **103**, wherein such support beams are placed at suitable intervals. Typically, wall section **101** may be a relatively thin panel of gypsum or other material (approximately one-half inch thick), and the support beam **103** is usually of wood or metal. A rectangular junction box **105** is securely fastened to the support beam **103**, but may alternatively be affixed to any other suitable supporting structure. The junction box **105** has an open face **107**, which is exposed through a matching opening cut into the wall section **101**. Commonly, the junction box **105** is made of metal or plastic, although other suitable materials may be employed. Mounting tabs **109-a** and **109-b** are provided on opposing sides of the face **107** and accommodate threaded mounting holes **111-a** and **111-b** allowing the attachment of various electrical fixtures to the junction box **105**. It is to be noted that the nominal center distance between the mounting holes **111-a** and **111-b** is substantially three and one-quarter (3¼) inches. Media **113** enters the junction box **105**, optionally via a conduit (not shown), which connects to the junction box **105** in one of several optional apertures (not shown) in the closed faces. Media **113** can carry electrical power, telephony signals, or other signals for sensing, data, or control. Any number of media **113** can be used, and can include different combinations and configurations of electrical conductors, such as wires or coaxial cable; or non-conducting media, such as optical fiber.

FIG. 2 illustrates how a faceplate **201** (or similar fixture) is mounted according to the junction box system (wall section **101** in FIG. 1 is omitted for clarity). Screws **203-a** and **203-b** affix faceplate **201** to junction box **105** through the mounting holes **111-a** and **111-b**, respectively. Because junction box **105** is secured to the support beam **103** (or other suitable supporting structure), the faceplate **201** is thereby securely fastened in place. Faceplate **201** comprises two telephony connectors (such as RJ-11), connected to in-wall telephone-wiring, hence being part of telephone outlet. As can be seen in FIG. 2, the faceplate **201** is designed to be coupled to the wall mounting fixture **105**, by means of mechanical size and rectangular shape, intended to cover all fixture **105** cavity, and holes matched for screws **203** to fit threads **111**.

The second commonly used wall mounting method is the "cylindrical cavity and sleeve" style as illustrated in FIG. 3. The cylindrical cavity and sleeve style is common in Europe and the Middle East and is used with a construction in which a wall section **301** is made of solid, or substantially solid masonry or similar rigid material which is self-supporting and requires no additional structural elements for stability. A cylindrical cavity **303** is formed in the wall section **301**, and an optional sleeve **305** is inserted therein from the outside. The sleeve **305** is commonly of plastic or other semi-flexible material, and typically is in the shape of a cup with a lip and closed back. The sleeve **305** may also have mounting screws (not shown) for affixing to the wall section **301**.

FIG. 4 shows a prior art wall mounting fixture device **401** for the cylindrical cavity and sleeve style of wall mounting. A pair of expandable clamps **403-a** and **403-b** is positioned to grip the inside of the sleeve **305** (FIG. 3), or alternatively the inside of the cavity **303** if no sleeve **305** is present. Cavities are typically cylindrical with an inside diameter of approximately 5.5 centimeters, but other cavity shapes and sizes are in general also possible. Clamp **403-a** can be expanded outward to engage a grip on the inside of sleeve **305** (and subsequently increase the grip strength) by tightening a screw **405**, and clamp **403-b** can likewise be

expanded outward for this purpose by a similar screw (not shown). It is also possible to use a single expandable clamp in conjunction with a fixed clamp or similar projection that is capable of gripping the inner surface of sleeve **305** or the inside of cavity **303** if no sleeve **305** is present. Once the wall mounting sure device **401** has been secured inside the cavity **303**, the faceplate (not shown) may be fastened to attachment device **401** by means of screws driven into mounting holes **407-a** and **407-b**. It is to be noted that the nominal center distance between mounting holes **407-a** and **407-b** is six (6.0) centimeters, which is approximately 2.36 inches. The faceplate is also well suited to the wall mounting fixture, being of square shape, and having screw holes suitable for affixing the faceplate into the wall mounting fixture.

It is further noted that:

the prior art wall mounting fixture device as illustrated in FIG. **4** and described herein is capable of mounting substantially all commonly-used fixtures and outlets intended for cylindrical cavity and sleeve wall mounting;

all variations in the design and configuration of such prior art wall mounting fixture devices are minor, so that all such prior art wall mounting fixture devices are substantially identical in appearance, use, and function;

wall mounting fixtures and faceplates designed for the junction box style of wall mounting are incompatible with, and cannot be mounted in, cylindrical cavity and sleeve construction using the available prior fixture attachment devices (as illustrated in FIG. **4** and as described herein); and

no means of readily mounting fixtures and outlets designed for the junction box style of wall mounting is currently available for cylindrical cavity and sleeve construction.

All common fixture and outlet types (such as electrical power outlets, telephone jacks, and lighting fixtures) are widely available for both of the above wall mounting styles. Thus, regardless of which style of wall mounting is employed within a building, it is easy to obtain these common fixtures and outlet types for that wall mounting style.

Many specialized fixtures and outlets, however, are now becoming available for specific purposes. Non-limiting examples of such specialized fixtures and outlets include outlets for data networking, multi-media, sensors, control units, and the like. Such fixtures and outlets may not be readily available for both wall mounting styles. In general, such specialized wall mounting fixtures and faceplates tend to be available for the wall mounting style that is prevalent in the region where their most important market is located. In particular, because of the size and importance of the North American market, most such specialized wall mounting fixtures and faceplates tend to be available primarily for the junction box style of wall mounting, as illustrated in FIG. **1** and FIG. **2**. In many cases, such specialized wall mounting fixtures and faceplates are not available for the cylindrical cavity and sleeve style. Where this is the case, specialized wall mounting fixtures and faceplates cannot easily be installed in buildings whose construction utilizes the cylindrical cavity and sleeve style of wall mounting without expensive and unsightly external retrofitting of junction boxes **105** within the smaller cavities **303** provided for the sleeves **305**, and therefore the utility provided by such specialized wall mounting fixtures and faceplates is difficult and expensive to provide for those buildings.

There is thus a widely recognized need for, and it would be highly advantageous to have, an adapter which provides easy installation of faceplates designed for the junction box

style of wall mounting in buildings whose construction utilizes the cylindrical cavity and sleeve style of wall mounting. More generally, there is a need for an adapter allowing a faceplate of one style to be installed in a cavity suitable for another distinct style. This goal is met by the present invention.

SUMMARY OF THE INVENTION

The present invention provides an adapter that permits mounting a fixture or outlet designed for the junction box style of wall mounting to be installed in a cylindrical or other shaped cavity, with or without a sleeve.

The adapter according to the present invention readily installs into a wall cavity with or without a sleeve, and accepts the attachment of a fixture or outlet designed for the junction box style of wall mounting.

Therefore, according to the present invention there is provided an adapter for mounting a faceplate of a first style on to an outlet cavity of a second style, the adapter comprising:

a plate having an opening for passing therethrough media for connecting to at least one connector mounted in said faceplate,

at least one fastener fixed to the plate for fixedly attaching the adapter to the outlet cavity; and

at least one mounting point for attaching the faceplate thereto.

Preferably, a pair of spaced apart mounting points are provided in the plate separated by a distance of substantially $3\frac{1}{4}$ inches, conforming to the mutual separation between corresponding mounting holes of commercially available junction box faceplates.

BRIEF DESCRIPTION OF THE DRAWINGS

In order to understand the invention and to see how it may be carried out in practice, a preferred embodiment will now be described, by way of non-limiting example only, with reference to the accompanying drawings, in which:

FIG. **1** illustrates the prior art junction box style of wall mounting fixture.

FIG. **2** illustrates the prior art installation of a faceplate onto a junction box style wall mounting fixture.

FIG. **3** illustrates the prior art cylindrical cavity and sleeve style of wall mounting cavity.

FIG. **4** illustrates a prior art wall mounting fixture device for the cylindrical cavity and sleeve style.

FIG. **5** illustrates an adapter according to the present invention for installing a faceplate designed for the junction box style to a wall mounting fixture in a cylindrical cavity.

FIG. **6** illustrates the installation of a outlet faceplate onto an adapter according to the present invention into a cylindrical cavity sleeve.

FIG. **7** illustrates an embodiment of the present invention having boxed sides and mounting posts.

DETAILED DESCRIPTION OF THE INVENTION

The principles and operation of an adapter according to the present invention may be understood with reference to the drawings and the accompanying description, wherein components that are common to different embodiments are referenced by identical reference numerals.

FIG. **5** illustrates an adapter **501** having a rectangular plate **503** with an opening **505** for passing media **113** (FIG.

5

3) therethrough and having expandable clamps **403-a** and **403-b** for gripping to the interior surface of a wall cavity or sleeve. A screw **405** expands clamp **403-a**, and a similar screw (not shown) expands clamp **403-b**. Mounting points **507-a** and **507-b** permit attachment of a faceplate designed for the junction box style of wall mounting. Accordingly, the nominal center distance between mounting points **507-a** and **507-b** is substantially three and one-quarter ($3\frac{1}{4}$) inches. Non-limiting examples of mounting points **507-a** and **507-b** include holes and posts, which may be threaded as well as friction or snap-fit.

FIG. 6 illustrates the mounting of an faceplate **601** designed for junction box style mounting on to adapter **501**, which inserts into sleeve **305** and attaches therein with clamps **403-a** and **403-b** when the respective screws **405** are tightened (for clarity, wall section **301** is not shown). Having thus been securely fastened, the adapter **501** is then ready for the mounting of faceplate **601** against the rectangular plate **503**. Faceplate **601** has mounting holes **603-a** and **603-b**, into which screws **605-a** and **605-b**, respectively, are passed and affixed into mounting points **507-a** and **507-b**, respectively, which may for example be threaded screw holes. Prior to mounting, media **113** is passed through opening **505** for connection to an appropriate device (not shown) fixed within the faceplate **601**.

In the manner illustrated in FIG. 6 and described above, a customized faceplate designed for junction box mounting can be flush mounted neatly and easily on a wall featuring the cavity and sleeve style of wall mounting.

Faceplate **601** as illustrated in FIG. 6 has a raised body intended for surface mounting on a wall such that the plate **503** mounts flush against the wall. An alternative embodiment of the present invention, however, is for mounting faceplates and other fixtures intended for mounting inside a junction box. FIG. 7 illustrates such an adapter wherein the plate **503** shown in FIG. 6 serves as a back plate supporting around a perimeter thereof a generally boxlike construction comprising outer sides **703** forming a junction box, and accommodating therein mounting points **705-a** and **705-b** in the form of raised posts. The raised posts have a threaded bore for threadably attaching the faceplate **601** thereto. The outer sides **703** are positioned so that when mounted, the adapter gives an appearance of a junction box flush to the wall. Outer sides **703** can be made with a variety of heights, so that a shallow and more attractive junction box is possible.

While the invention has been so far described with respect to a rectangular, junction-box style faceplate mounted into circular wall cavity, it will be appreciated that the invention can be equally applied to any case wherein a faceplate of one style is required to be mounted on to an outlet cavity conforming to a different style.

Likewise, while the invention has been described with respect to a limited number of embodiments, it will be appreciated that many variations, modifications, and other applications of the invention may be made. All such embodiments are contemplated as fall within the scope of the appended claims.

Thus, for example, although a pair of spaced apart clamps is shown in FIGS. 6 and 7 for fixing the adapter to the outlet cavity or sleeve, it will be appreciated that other means of attachment are possible. For example, an aperture may be formed in the plate **503** at a location that falls within the circumferences of the cavity **303** or the sleeve **305**, thus allowing the plate to be screwed to the wall **101** through the cavity **303**: or the sleeve **305**. Likewise, in FIG. 7, the clamps are interconnected by an armature shown as **707** and

6

having a central aperture **709**, thus again allowing the plate to be screwed to the wall **101** through the cavity **303** or the sleeve **305** and obviating the need for the clamps.

The faceplate **601** shown in FIG. 6 includes a pair of apertures **606-a** and **606-b** each for accommodating a respective connector. Such connector can include a telephone connector, **609-a**, **609-b**, as shown in FIG. 6, a power/electricity connector or a CATV connector. In the case that the faceplate **601** accommodates multiple apertures (which is not mandatory), the apertures may, if desired, be of different contours so as to allow different types of connector to be mounted therein. By such means, for example, a telephone connector and a computer data connector can be accommodated in the same connector and connected to appropriate media, the faceplate **601** being fixed to the cavity **303** or to the sleeve **305** via the adapter **501** or **701**.

The invention also contemplates a method for installing a faceplate of a first style into an electrical outlet cavity of a second style, the method comprising:

- (a) mounting to the outlet cavity an adapter according to the invention,
- (b) connecting the media to at least one connector mounted in the faceplate of the adapter, and
- (c) fixing the faceplate to the adapter via the at least one mounting point.

Likewise, the invention contemplates an electrical outlet comprising a faceplate of a first style mounted on to an outlet cavity of a second style via an adapter according to the invention.

What is claimed is:

1. An adapter to mount a faceplate having a rectangular shape to an electrical outlet cavity having a circular shape, the faceplate carrying at least one connector, the adapter comprising:

a plate having an opening for passage therethrough of media for connecting to the at least one connector mounted in the faceplate having a rectangular shape, said plate having at least one mounting element located and configured to attach the faceplate to said plate; and at least one fastener fixed to said plate and configured to fixedly attach said adapter to the electrical outlet cavity.

2. The adapter according to claim 1, wherein the at least one fastener comprises a pair of spaced apart clamps for engaging an inner surface of the outlet cavity.

3. The adapter according to claim 1, wherein the at least one fastener comprises a pair of spaced apart clamps for engaging an inner surface of a sleeve fixed in the outlet cavity.

4. The adapter according to claim 1, wherein said at least one mounting element comprises a pair of spaced apart mounting points for attaching the faceplate to said plate.

5. The adapter according to claim 4, wherein the pair of mounting points are mutually separated by a distance of $3\frac{1}{4}$ inches.

6. The adapter of claim 1, wherein the at least one mounting element consists of one of: holes, posts, threaded holes, threaded posts, friction-fit posts and snap-fit posts.

7. The adapter of claim 1, wherein said plate serves as a back plate having a perimeter supporting a generally boxlike construction comprising outer sides, thereby forming a junction box.

8. The adapter according to claim 7, wherein the at least one mounting element comprises a pair of raised posts.

9. An electrical outlet comprising: said faceplate having said rectangular shape; and said adapter according to claim

7

1 to which said faceplate is attachable and which is attachable to the electrical outlet cavity having the second configuration.

10. The electrical outlet according to claim 9, wherein the at least one connector includes a telephone connector.

11. The electrical outlet according to claim 9, wherein the at least one connector includes a power/electricity connector.

12. The electrical outlet according to claim 9, wherein the at least one connector includes a cable television connector.

13. The electrical outlet according to claim 9, wherein the at least one connector includes a computer data connector.

8

14. A method for installing a faceplate having a rectangular shape to an electrical outlet cavity having a circular shape, the faceplate carrying at least one connector, the method comprising:

- (a) mounting to the outlet cavity said adapter according to claim 1;
- (b) connecting the media to the at least one connector carried by the faceplate; and
- (c) fixing the faceplate to the adapter via the at least one mounting element.

* * * * *