

US007118475B2

(12) **United States Patent**  
**Schenk**

(10) **Patent No.:** **US 7,118,475 B2**  
(45) **Date of Patent:** **Oct. 10, 2006**

(54) **MECHANISM AND METHOD FOR  
AUTOMATICALLY TRANSVERSELY  
POSITIONING THE PINCH-POINT OF A  
CONCAVE**

(75) Inventor: **Charles R. Schenk**, South Bend, IN  
(US)

(73) Assignee: **CHN America LLC**, New Holland, PA  
(US)

(\*) Notice: Subject to any disclaimer, the term of this  
patent is extended or adjusted under 35  
U.S.C. 154(b) by 130 days.

(21) Appl. No.: **10/755,806**

(22) Filed: **Jan. 12, 2004**

(65) **Prior Publication Data**

US 2005/0176484 A1 Aug. 11, 2005

(51) **Int. Cl.**  
**A01F 12/28** (2006.01)

(52) **U.S. Cl.** ..... **460/109**

(58) **Field of Classification Search** ..... 460/109,  
460/107

See application file for complete search history.

(56) **References Cited**

**U.S. PATENT DOCUMENTS**

509,490 A *	11/1893	Richter	460/109
636,026 A *	10/1899	Donovan	460/46
740,215 A *	9/1903	Bartholow	460/109
892,529 A *	7/1908	Landis	460/109
2,299,687 A *	10/1942	Farrand	52/108
2,484,228 A *	10/1949	Isay	460/46

3,385,438 A	5/1968	Fisher	
3,470,881 A	10/1969	Knapp et al.	
3,593,719 A	7/1971	Islington et al.	
3,631,862 A	1/1972	Rowland-Hill et al.	
3,871,384 A	3/1975	Depauw et al.	
3,974,837 A *	8/1976	Applegate	460/105
4,330,000 A	5/1982	Peiler	
4,375,221 A	3/1983	Bernhardt et al.	
4,425,925 A	1/1984	Kersting et al.	
4,712,568 A	12/1987	Strong et al.	
4,802,496 A	2/1989	Bennett	
4,805,643 A	2/1989	Tetaka	
4,897,072 A	1/1990	Bestland	
5,041,059 A	8/1991	Ricketts et al.	
5,395,287 A	3/1995	Coers	
5,489,239 A	2/1996	Matousek et al.	
5,919,087 A	7/1999	Strong et al.	
6,358,142 B1	3/2002	Imel et al.	
6,443,835 B1	9/2002	Imel et al.	
6,485,364 B1	11/2002	Gryspeerd et al.	
6,485,365 B1	11/2002	Imel et al.	
6,503,142 B1	1/2003	Imel et al.	
6,530,833 B1	3/2003	Imel et al.	
6,958,012 B1 *	10/2005	Duquesne et al.	460/76

\* cited by examiner

*Primary Examiner*—Meredith C. Petravick

(74) *Attorney, Agent, or Firm*—Michael G. Harms; John  
William Stader; Stephen A. Bucchioneri

(57) **ABSTRACT**

A device and method is disclosed for allowing a combine operator, from the operator's station, to automatically transversely position a pinch-point of a concave relative to a rotor of a combine in accordance with the clearance spacing set between the concave and the rotor, thereby minimizing operator effort without sacrificing combine performance.

**42 Claims, 9 Drawing Sheets**

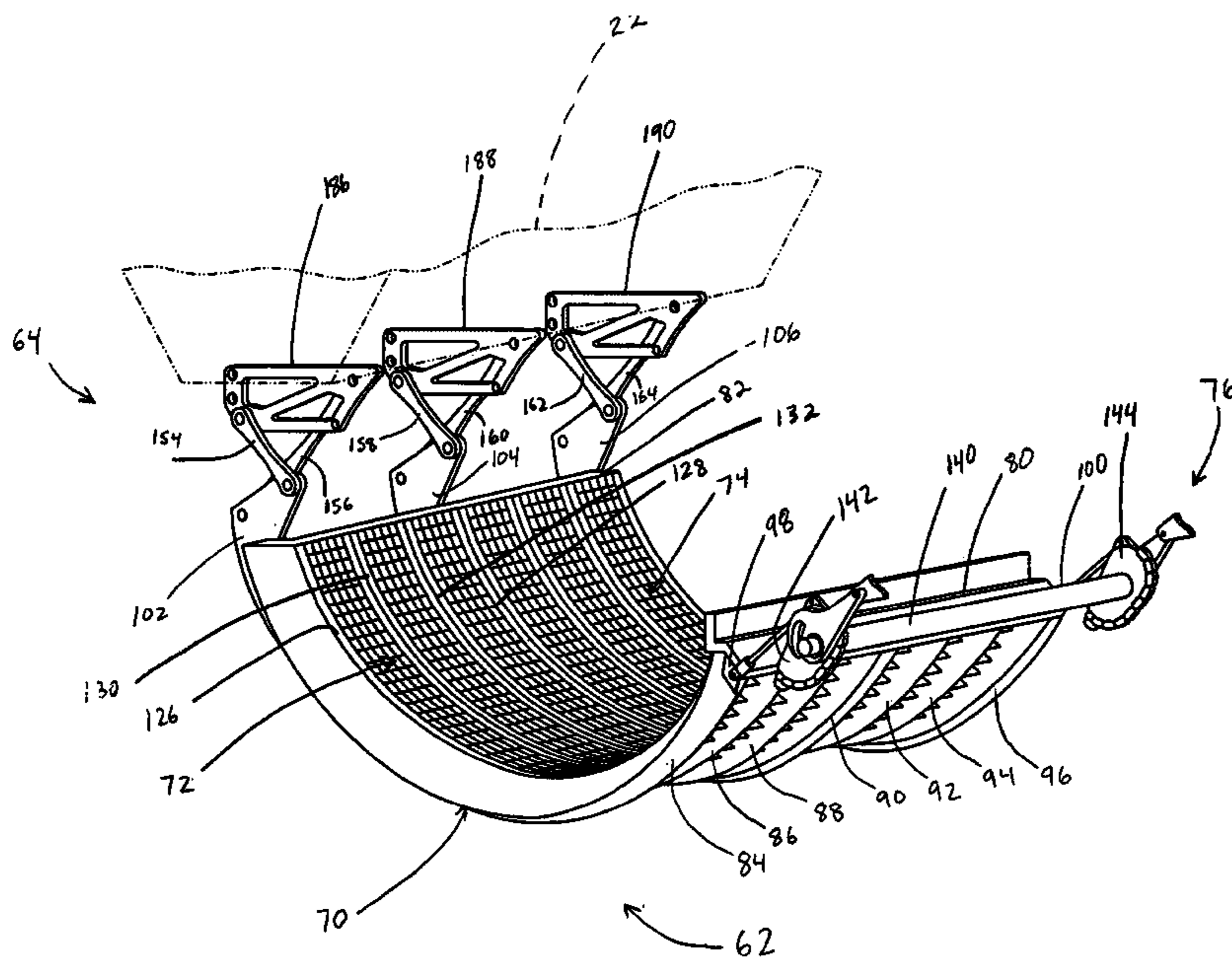

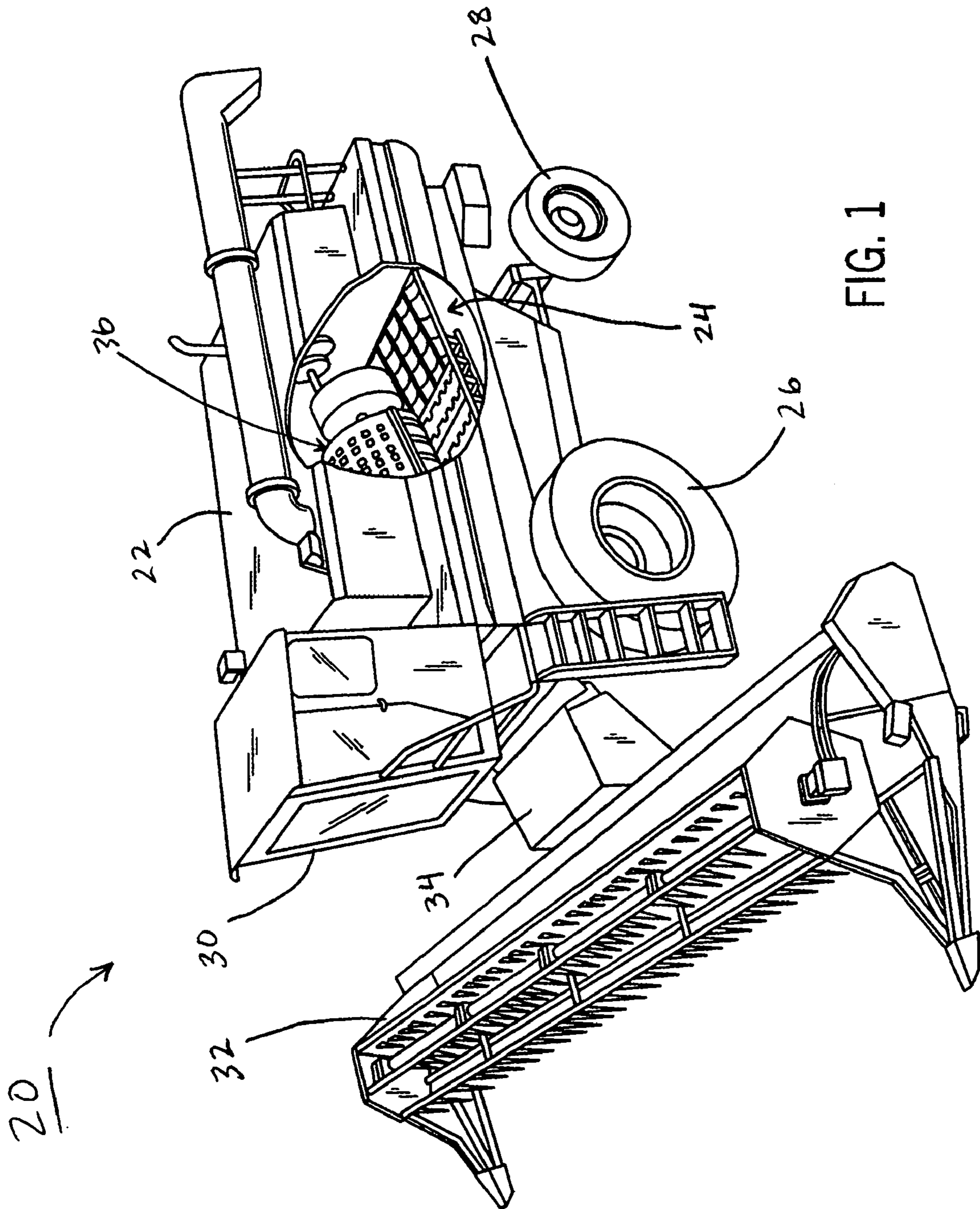

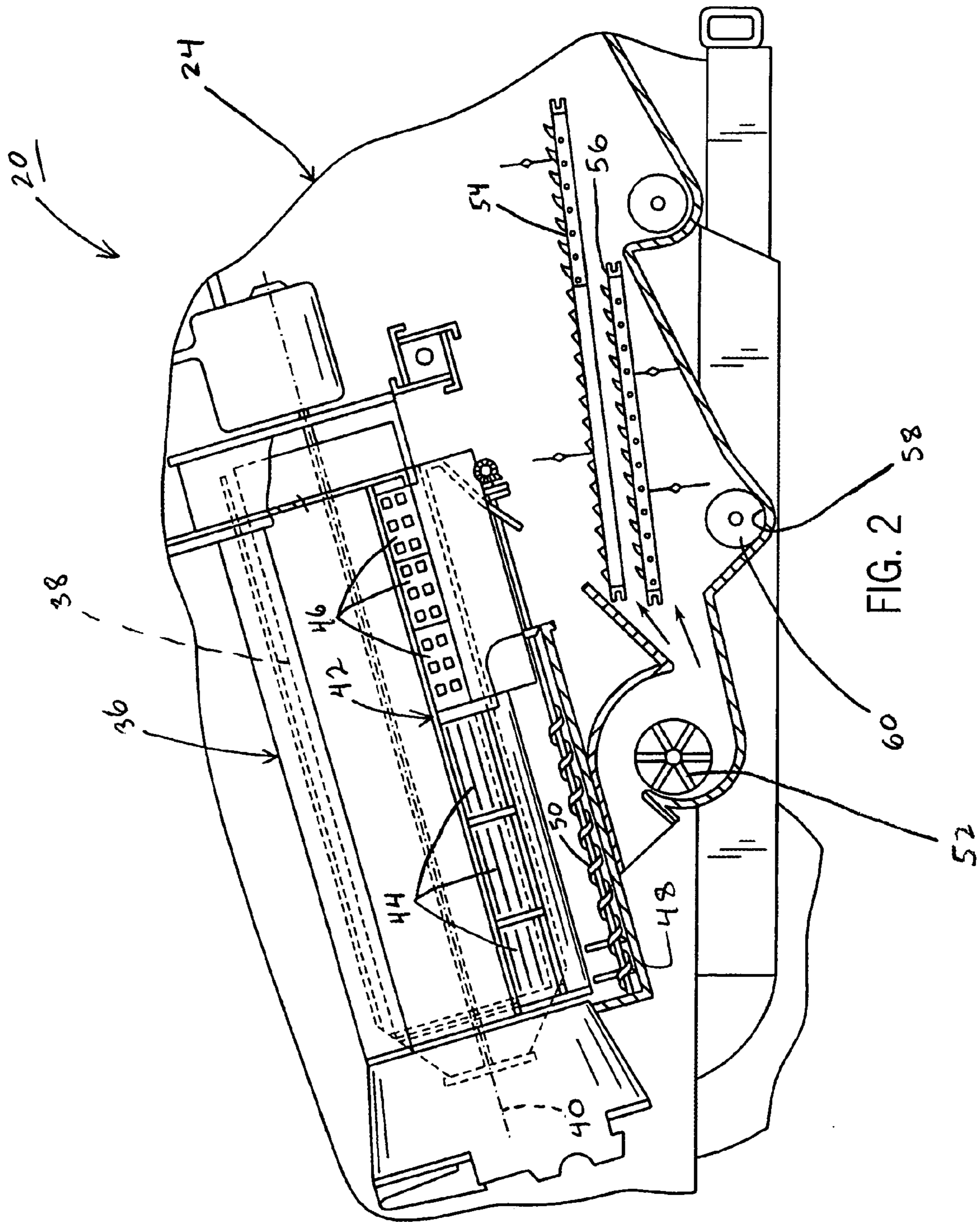

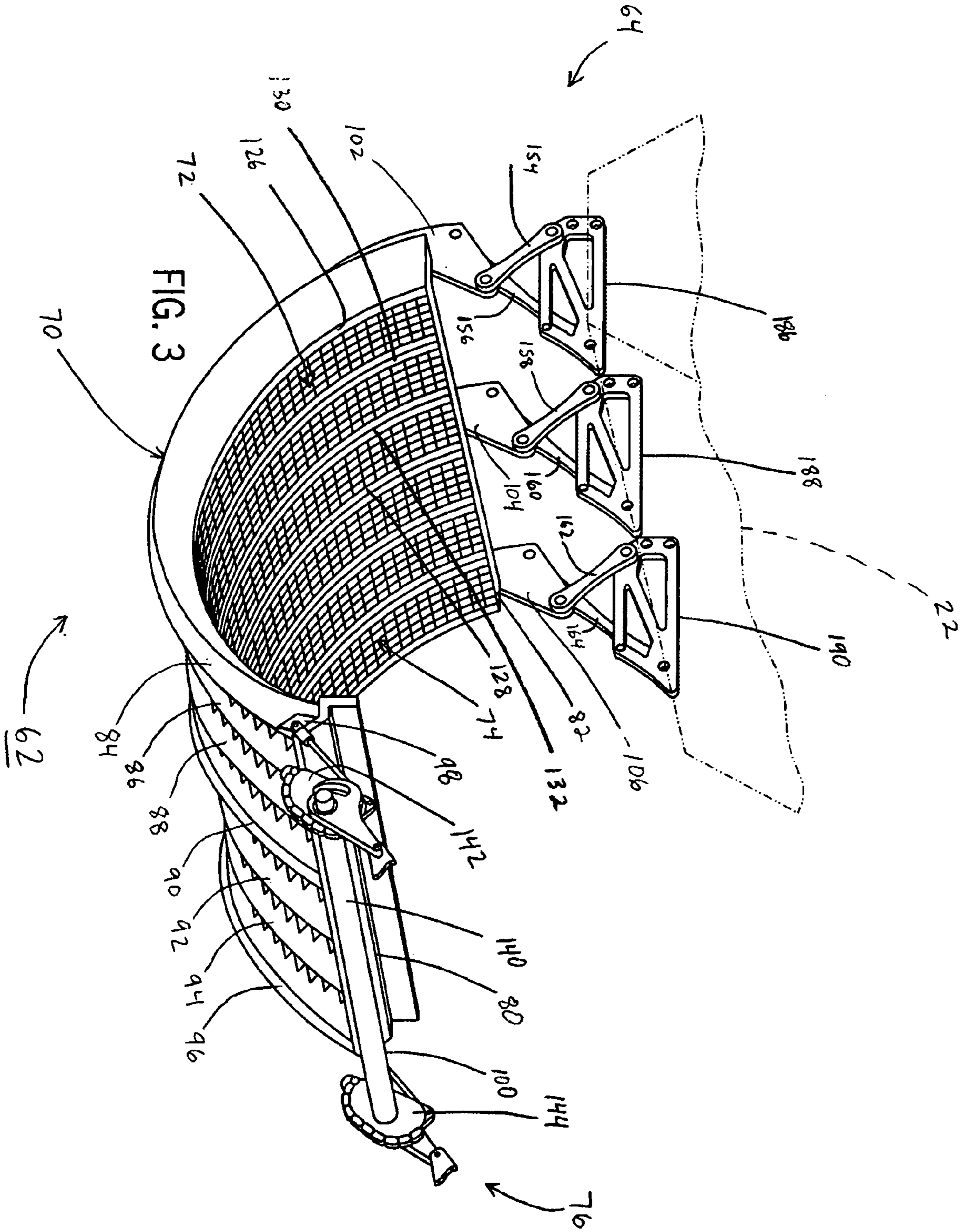

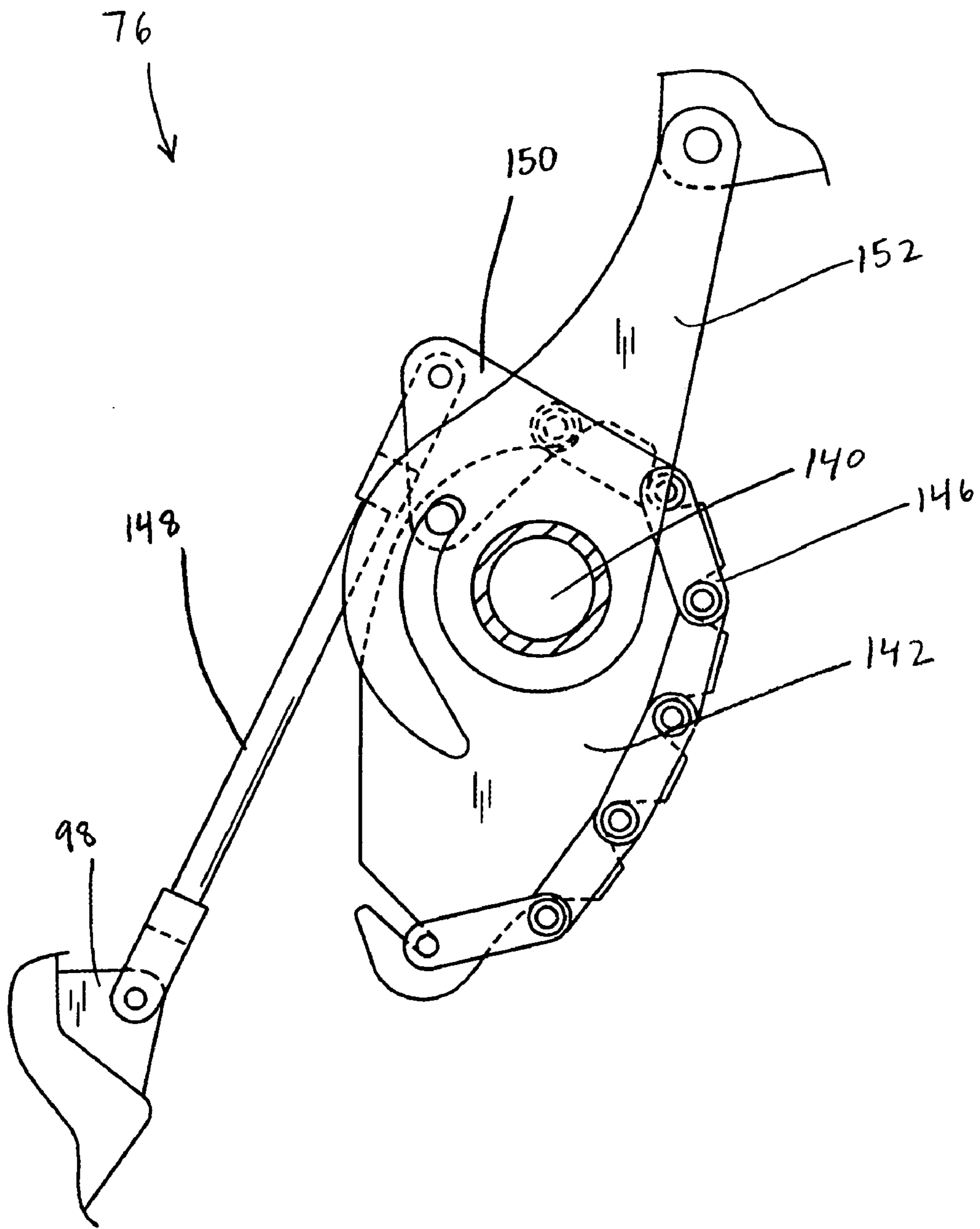

FIG. 4

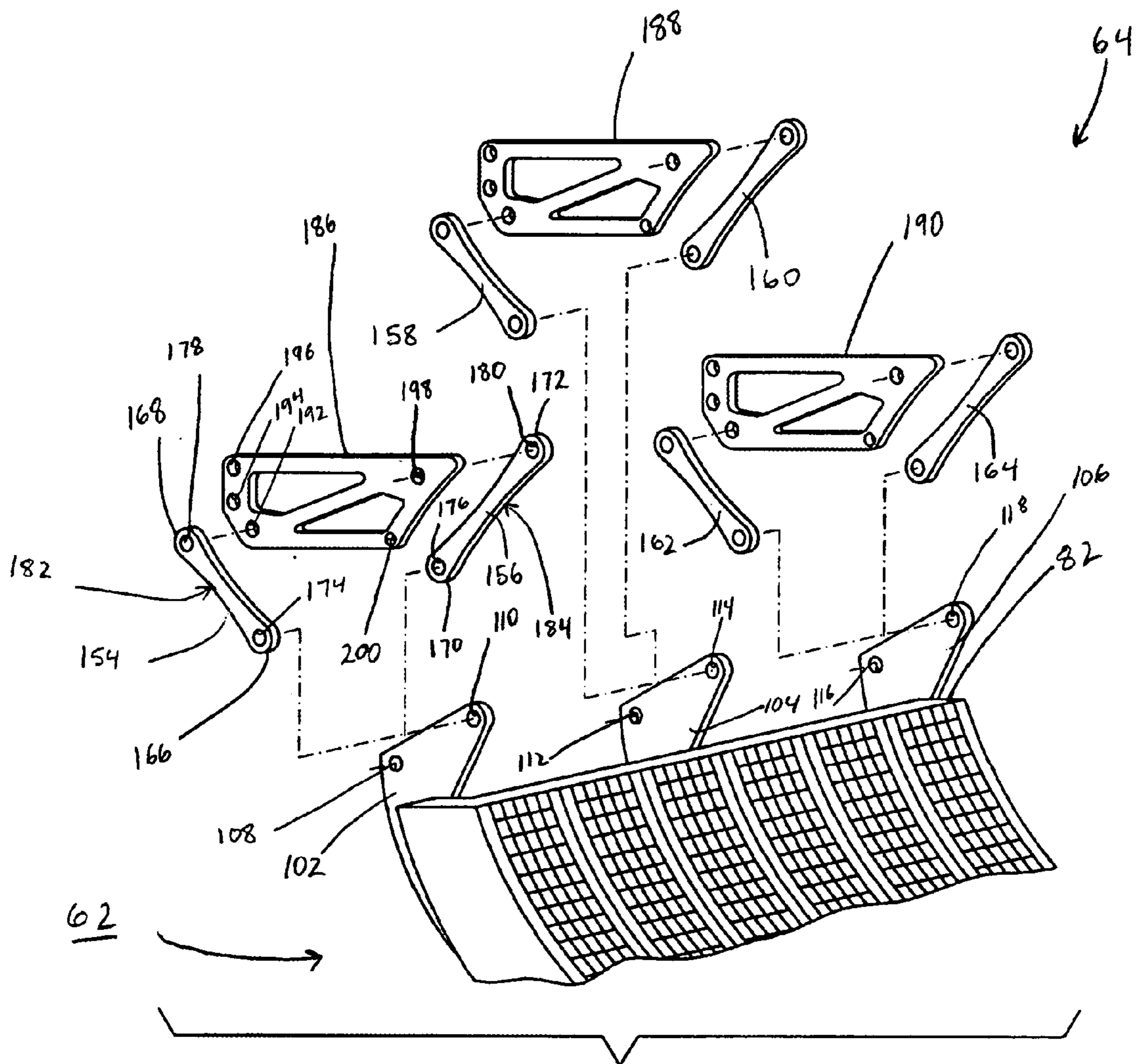
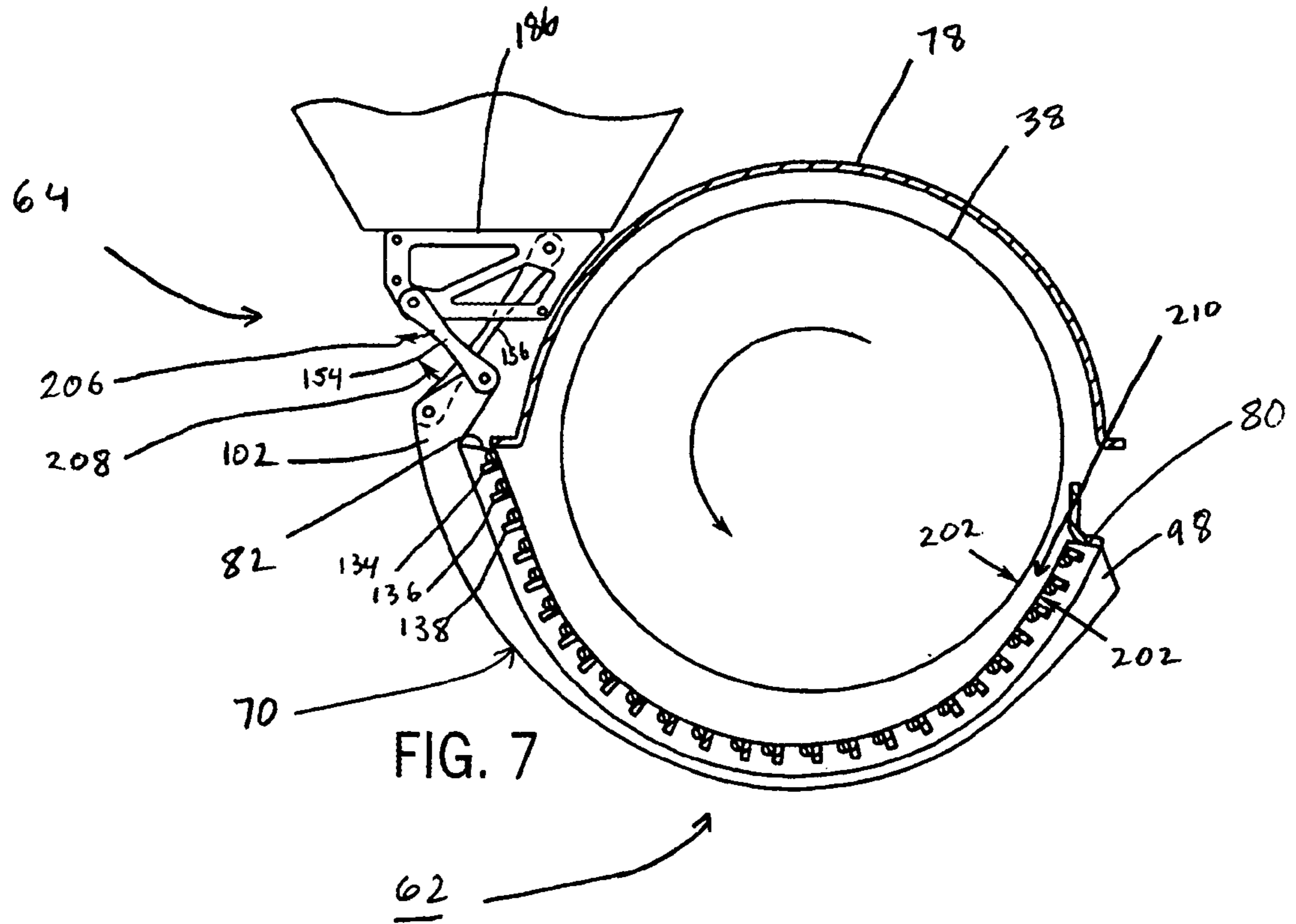
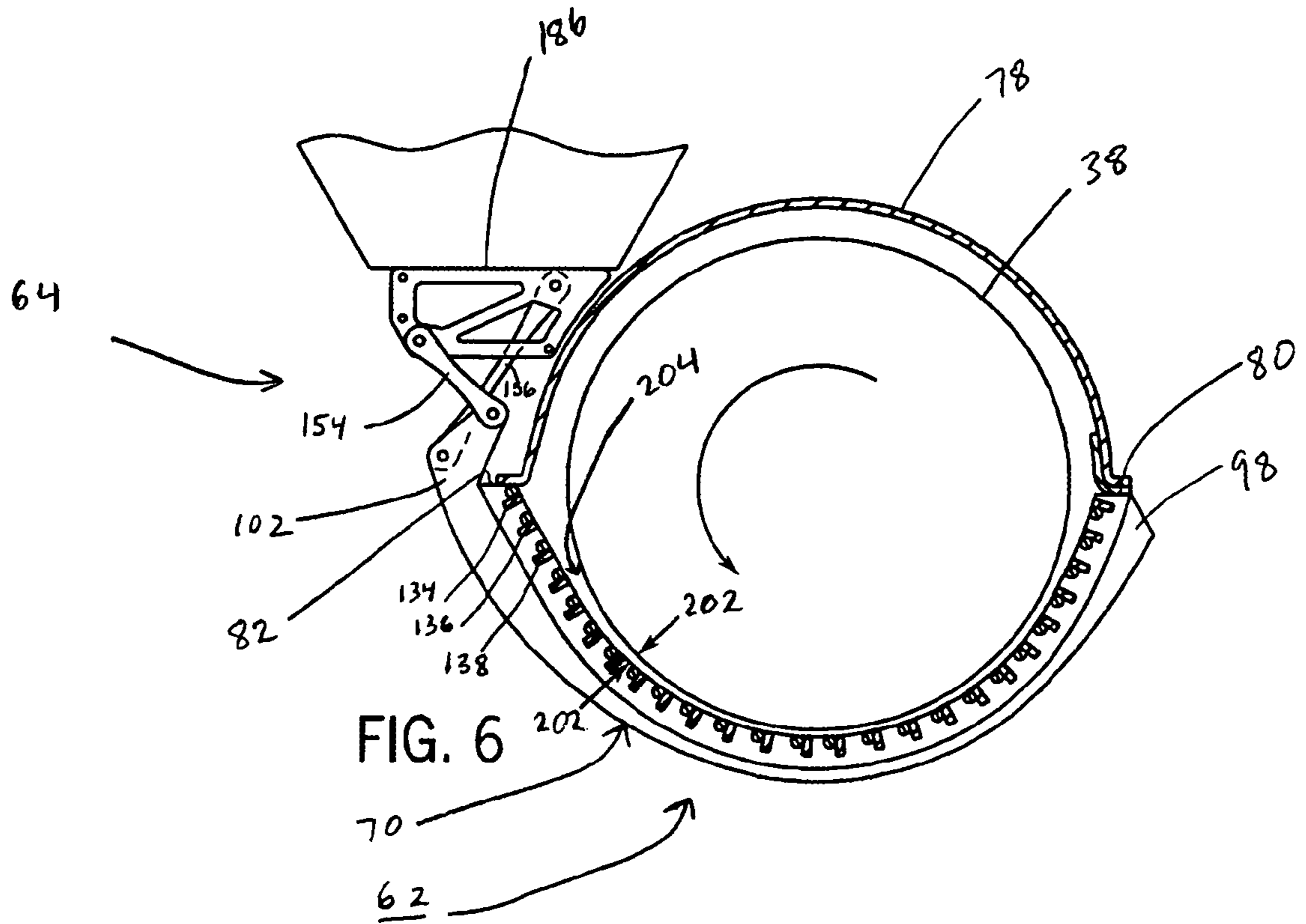

FIG. 5



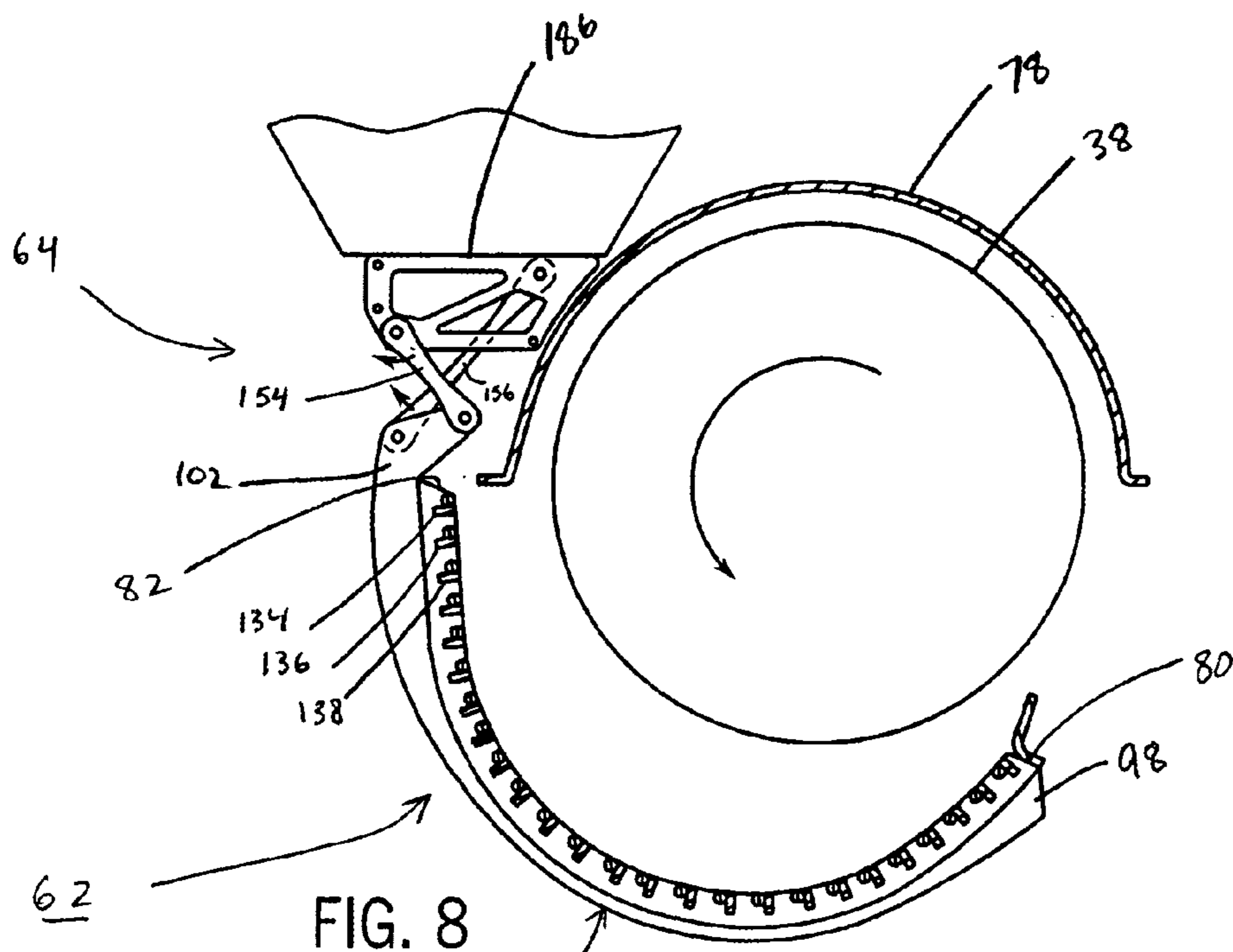

FIG. 8

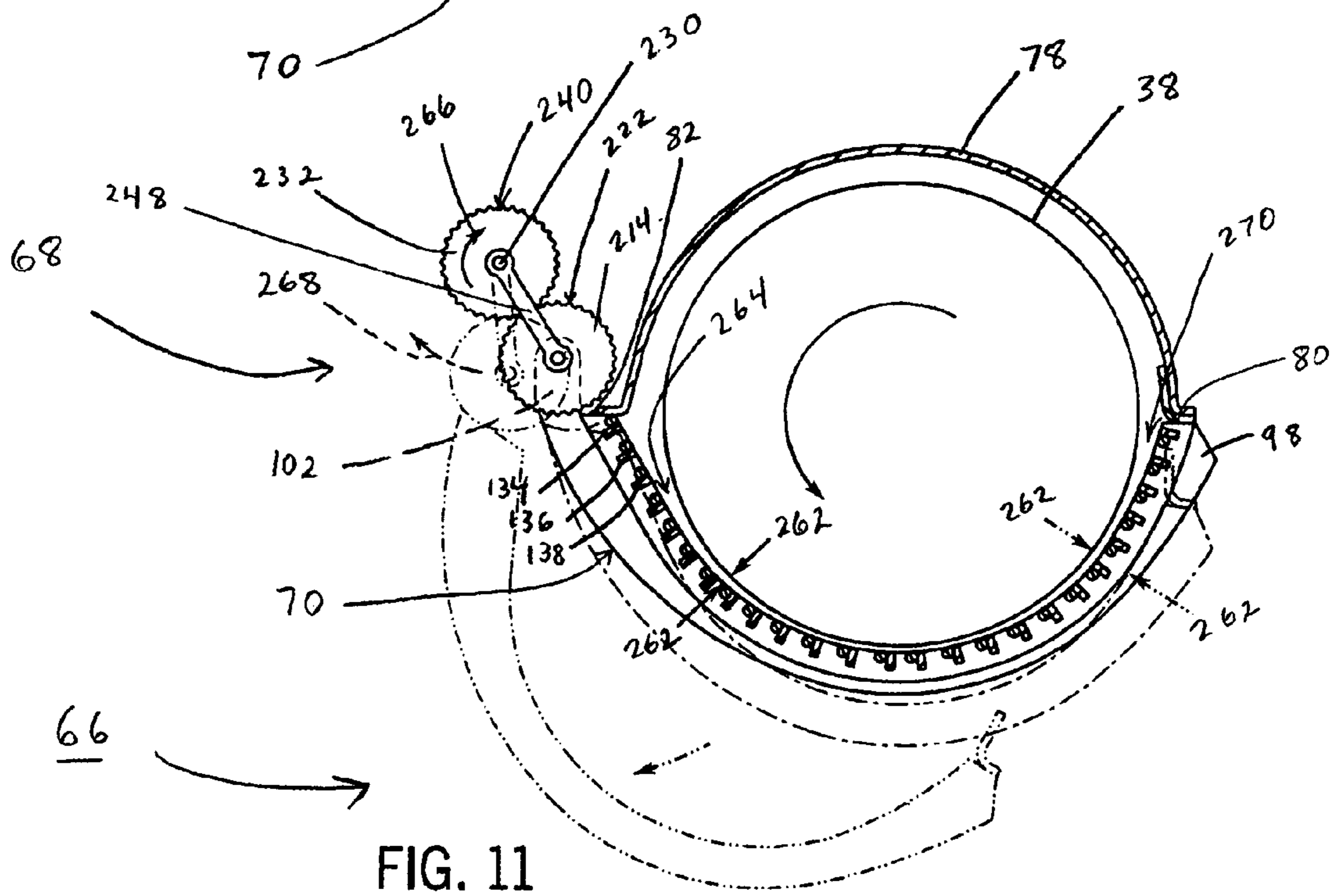
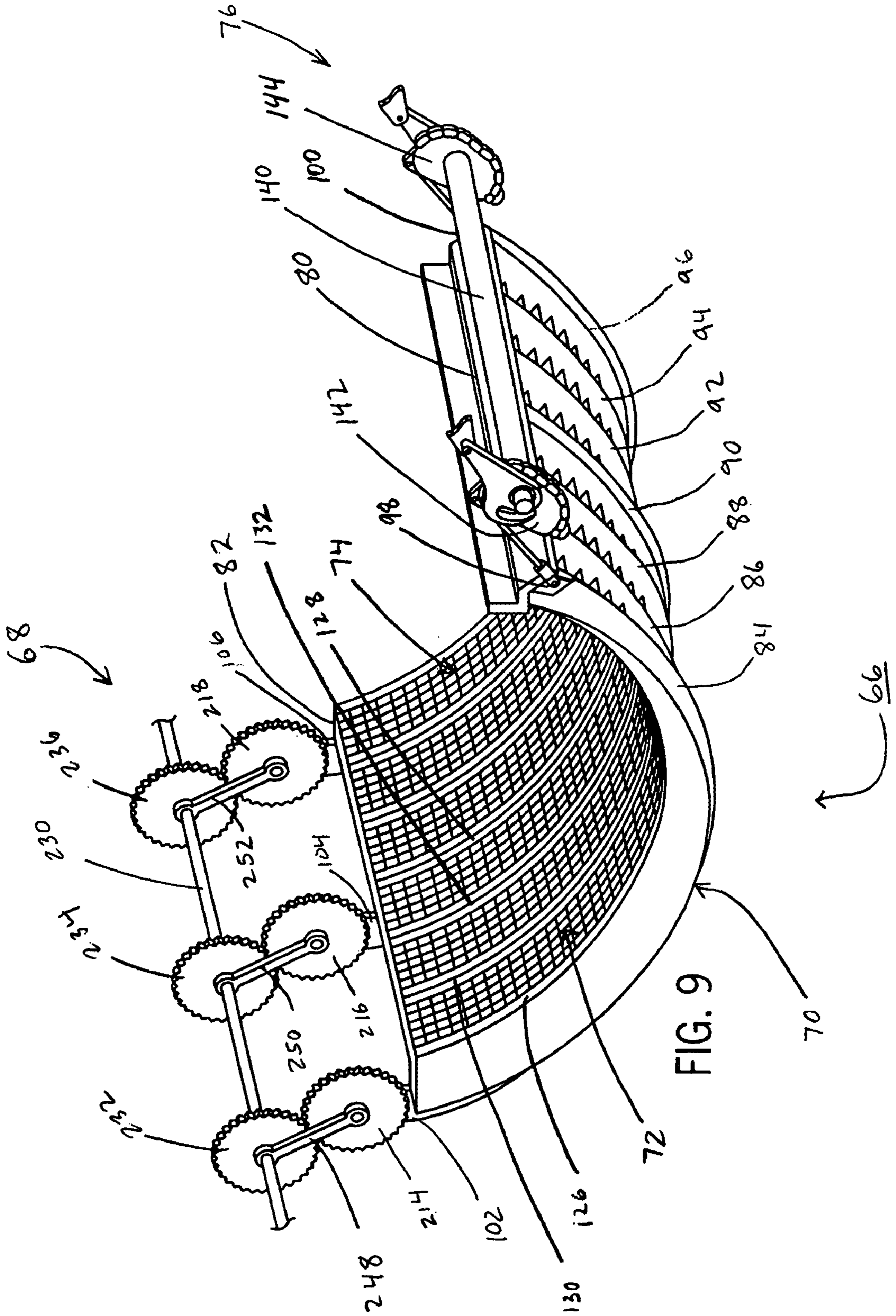

FIG. 11





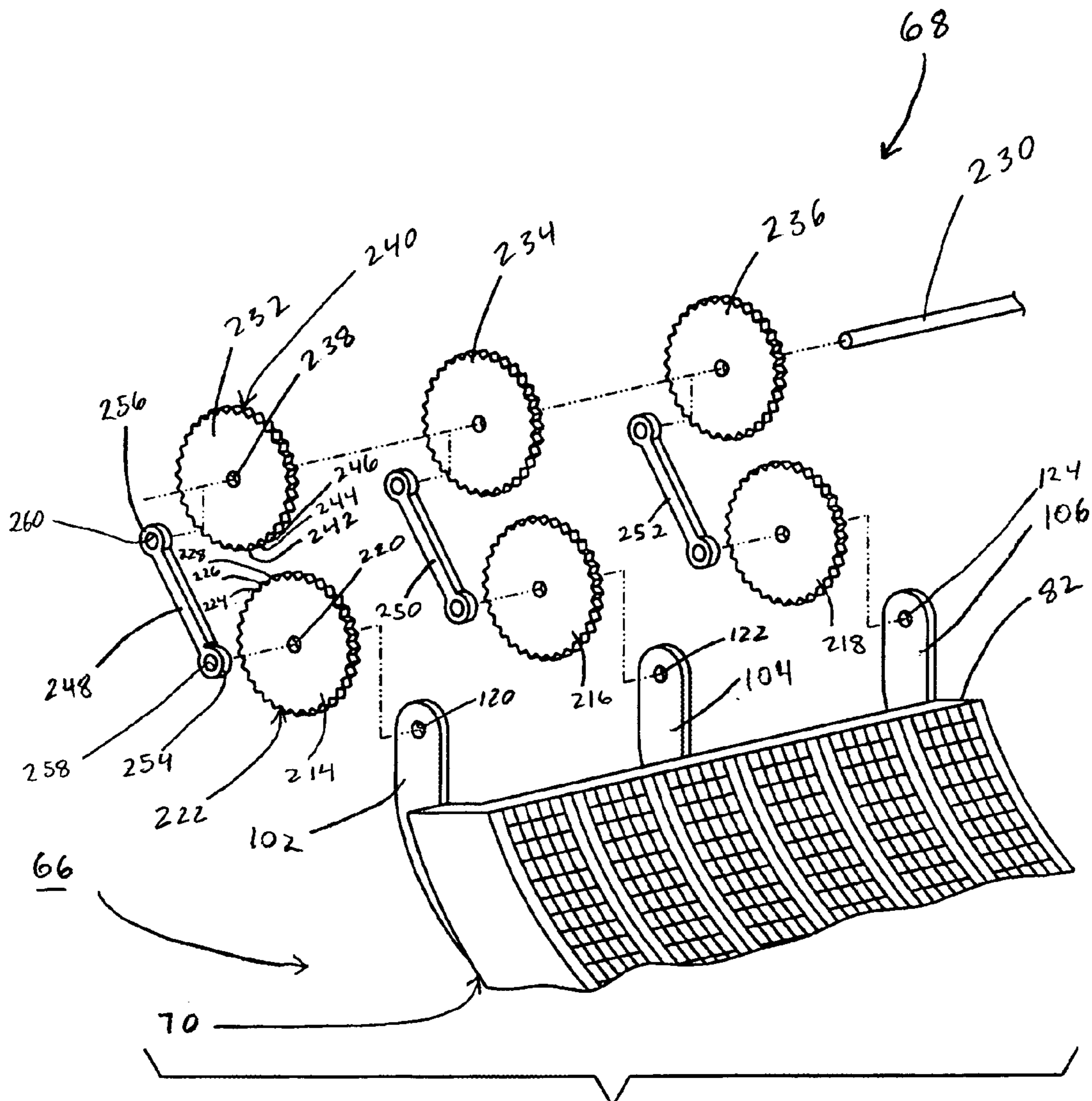

FIG. 10

1

**MECHANISM AND METHOD FOR  
AUTOMATICALLY TRANSVERSELY  
POSITIONING THE PINCH-POINT OF A  
CONCAVE**

BACKGROUND OF THE INVENTION

Field of the Invention—The present invention relates generally to a mechanism and method for automatically transversely positioning a pinch-point of a concave relative to a rotor of a combine according to the clearance spacing set between the concave and the rotor, the mechanism and method minimizing operator effort without sacrificing combine performance.

Agricultural combines are well known in the art for harvesting and threshing a number of various agricultural crops, including for example wheat, soybeans, corn, etc. Usually, agricultural combines include a harvesting apparatus, an infeed mechanism, and a separating apparatus. In operation, the harvesting apparatus reaps the crop, which is planted in the ground. After reaping, the infeed mechanism feeds the crop to the separating apparatus.

Typically, the separating apparatus in a rotary combine includes at least one rotor, which can extend axially or transversely within the body of the combine, and which is surrounded at least in part by a perforated concave having a plurality of apertures. As shown for example in U.S. Pat. No. 5,489,239 titled “Rotary Combine” and issued Feb. 6, 1996 to Case Corporation, the same assignee as for the present application, the concave can include a series of concave inserts arranged in a side-by-side configuration, with each concave insert extending partially circumferentially around the rotor. Generally, it is desirable to provide for an adjustment of the concave relative to the rotor of the combine.

To optimize the threshing potential of different crop types and threshing conditions, a combine operator must set the appropriate clearance spacing between the concave and the rotor. Additionally, the operator must also transversely pivot the concave relative to the rotor to properly position the “pinch-point” (e.g. the primary area where the rotor threshes the crop grain against the concave) according to the type of crop grain to be threshed.

For example, for the “hard threshing” of wheat, it is beneficial for the pinch-point to be positioned at the “lead in” section of the concave so that the rotor will contact the crop grain immediately upon its downward rotation toward the concave. In contrast, for the “easy threshing” of corn, it is advantageous to position the pinch-point at the “lead out” section of the concave so that the rotor will contact the crop grain upon its upward rotation away from the concave. Accordingly, proper positioning of the pinch-point maximizes threshing potential.

While the benefits and advantages of properly positioning the pinch-point of a concave are known, current positioning mechanisms and methods prove cumbersome and inefficient. For example, current mechanisms and methods do not allow a combine operator to seamlessly switch between the threshing of “hard” crop grain and the threshing of “easy” crop grain. Instead, the operator must first stop and exit the combine and adjust the concave pivot I-bolts before switching to the threshing of a different type of crop grain. Such a process can be physically demanding and time consuming and can increase machine setup complexity and reduce overall machine capacity.

Accordingly, the drawbacks of the currently known mechanisms and methods for adjusting and positioning the pinch-point of a concave relative to the rotor of a combine

2

have been known within the industry without any marked improvement to date. Thus, the need exists for the present invention, which provides a mechanism and method for automatically positioning the pinch-point of a concave in accordance with the clearance spacing set by the operator.

It is accordingly the primary objective of the present invention that it provide an improved transverse concave pivot assembly mechanism and method for optimizing threshing potential for different types of crop grain and different threshing conditions.

It is another objective of the present invention that it provide at least one transverse pivot axis for allowing automatic transverse positioning of the pinch-point of a concave in accordance with the clearance spacing set between the concave and the rotor.

It is yet an additional objective of the present invention that it be efficient and effortless so as to minimize operator effort without sacrificing combine performance.

The transverse pivot assembly mechanism and method of the present invention must also be of a construction which is both durable and long lasting, and it should also require little or no maintenance to be provided by the user throughout its operating lifetime. In order to enhance the market appeal of the transverse pivot assembly mechanism and method of the present invention, it should also be of inexpensive construction to thereby afford it the broadest possible market. Finally, it is also an objective that all of the aforesaid advantages and objectives be achieved without incurring any substantial relative disadvantage.

SUMMARY OF THE INVENTION

The disadvantages and limitations of the background art discussed above are overcome by the present invention. With this invention, a mechanism and method for automatically transversely positioning a pinch-point of a concave relative to a rotor of a combine according to the clearance spacing set between the concave and the rotor, is provided. Accordingly, the present invention is used in conjunction with a combine for harvesting crop grain material.

Commonly, such combines include a mobile frame and at least one crop-threshing rotor having a longitudinal axis of rotation, the rotor being supported by the frame. A concave having a first side and a second side is movably supported at least partially around the circumference of the rotor at a clearance spacing extending generally radially outward therefrom. The concave further includes a plurality of concave inserts outwardly removable away from the rotor in a direction transverse to the longitudinal axis of said rotor.

Generally, a first side of the concave is coupled to the combine by a pivot assembly, which, historically, allowed for pivotal movement of the concave outward relative to the rotor of the combine. Additionally, an adjustment mechanism couples a second side of the concave to the combine and allows for the adjustment of clearance spacing between the concave and the rotor.

Depending on the clearance spacing and the transverse positioning of the concave relative to the rotor, different types of crop grain can be threshed. For example, for the “hard threshing” of wheat, the concave is generally transversely positioned so that the pinch-point is at the lead in section of the concave. Alternatively, for the “easy threshing” of corn, the pinch-point is generally transversely positioned toward the lead out section of the concave.

The present invention allows a combine operator, while in the operator’s station, to automatically transversely position the concave pinch-point in accordance with the clearance

spacing set between the concave and the rotor. Thus, previously known manual mechanisms and methods are made obsolete as the present invention works efficiently and effortlessly, thereby minimizing operator effort without sacrificing combine performance.

In a preferred embodiment of the present invention, the transverse pivot assembly mechanism includes a linking assembly, which pivotally couples a first side of the concave to the combine, the pivot assembly defining at least one transverse pivot axis.

In another aspect of the embodiment, the linking assembly includes at least one set of linking members, each set of linking members generally including a first linking member and a second linking member, the sets of linking members being substantially similar in size and shape and having first and second ends. Alternatively, in another aspect of the present invention, one linking member of each set is generally longer than the other linking member of the set.

In yet a further aspect of the present invention, the linking assembly further includes at least one mounting bracket securely mounted to the body of the combine. Preferably, a corresponding mounting bracket exists for each set of linking members. Accordingly, in a preferred aspect of the present embodiment, the first ends of each linking member of each set are pivotally coupled to the first side of the concave while the second ends of each linking member of each set are pivotally coupled to a corresponding mounting bracket.

In yet another aspect of the preferred embodiment of the present invention, the second ends of each of the linking members are pivotally coupled directly to the body of the combine rather than to a corresponding mounting bracket. Regardless, it is contemplated that, when properly mounted, the first linking member of each set will be positioned substantially angular relative to the second linking member of the set, thereby forming a generally "crossed" or "X-shaped" configuration.

In yet an additional aspect of the present invention, the first end of the first linking member of each set is pivotally coupled to the concave in a horizontal plane different than the horizontal plane in which the first end of the second linking member of each set is pivotally coupled. In a related aspect of the present invention, the second end of the first linking member of each set is pivotally coupled to a corresponding mounting bracket or the combine in a horizontal plane different than the horizontal plane in which the second end of the second linking member of each set is pivotally coupled.

However, it should be understood that instead of the first ends and second ends of each set of linking members being pivotally coupled in different horizontal planes, the linking members could alternatively have similar or identical lengths and have first and second ends pivotally coupled in similar or identical horizontal planes.

In an alternative preferred embodiment of the present invention, the linking assembly includes at least one non-rotatable member, at least one rotatable shaft, at least one rotatable member, and at least one linking member. In one aspect of the alternative preferred embodiment, the non-rotatable member is mounted to, or unitarily configured with, the first side of the concave while the rotatable member is mounted to the rotatable shaft for rotation therewith.

In yet an additional aspect of the alternative preferred embodiment, the linking member couples at least one of the non-rotatable member and the first side of the concave with at least one of the rotatable shaft and the rotatable member.

In yet another aspect of the alternative preferred embodiment, the non-rotatable member can be a gear having a plurality of tines upon its peripheral surface. In a related aspect, the rotatable member can also be a gear having a plurality of tines upon its peripheral surface, the plurality of tines of the rotatable gear being engageable with the plurality of tines of the non-rotatable gear.

In a final aspect of the present invention, a method is provided for automatically transversely pivoting and positioning a pinch-point of a concave in accordance with the clearance spacing set by the operator. In line with the aforementioned preferred embodiments of the present invention, the method includes: providing a rotor having a longitudinal axis of rotation; providing at least one concave having a first side and a second side spaced circumferentially around the rotor and including a plurality of concave inserts outwardly removable away from the rotor in a direction transverse to the longitudinal axis of the rotor; providing a transverse pivot assembly mechanism for automatically positioning a pinch-point of the concave relative to the rotor of the combine, the transverse pivot assembly mechanism including a linking assembly for pivotally coupling the first side of the concave to the combine; providing an adjustment mechanism, the adjustment mechanism adjustably coupling the second side of the concave to the combine; and actuating the adjustment mechanism to effect movement and clearance spacing of the concave relative to the rotor of the combine, the pinch-point being automatically transversely positioned according to the clearance spacing set between the concave and the rotor.

The transverse pivot assembly mechanism of the present invention is of a construction which is both durable and long lasting, and which will require little or no maintenance to be provided by the user throughout its operating lifetime. The transverse pivot assembly mechanism of the present invention is also of inexpensive construction to enhance its market appeal and to thereby afford it the broadest possible market. Finally, all of the aforesaid advantages and objectives are achieved without incurring any substantial relative disadvantage.

#### DESCRIPTION OF THE DRAWINGS

These and other advantages of the present invention are best understood with reference to the drawings, in which:

FIG. 1 is a perspective view, partially broken away, of an agricultural combine;

FIG. 2 is a partial side view of a separating apparatus of the combine shown in FIG. 1;

FIG. 3 is a front, right side perspective view showing a concave adjustment mechanism and a preferred embodiment of a transverse pivot assembly mechanism of the separating apparatus shown in FIG. 2;

FIG. 4 is an enlarged, partial front end longitudinal view of the concave adjustment mechanism shown in FIG. 3;

FIG. 5 is a partial exploded view of the transverse pivot assembly mechanism shown in FIG. 3;

FIG. 6 is an enlarged front end longitudinal view, in the "hard threshing position," of the transverse pivot assembly mechanism shown in FIG. 3;

FIG. 7 is an enlarged front end longitudinal view, in the "easy threshing position," of the transverse pivot assembly mechanism shown in FIG. 3;

FIG. 8 is an enlarged front end longitudinal view, in the "fully opened position" (i.e. extended range), of the transverse pivot assembly mechanism shown in FIG. 3;

## 5

FIG. 9 is a front, right side perspective view showing a concave adjustment mechanism and an alternative preferred embodiment of a transverse pivot assembly mechanism of the separating apparatus shown in FIG. 2;

FIG. 10 is a partial exploded view of the transverse pivot assembly mechanism shown in FIG. 9; and

FIG. 11 is an enlarged front end longitudinal view, in the "hard threshing position," "easy threshing position (shown in broken lines)," and "fully opened position" (i.e. extended range) (shown in broken lines), of the transverse pivot assembly mechanism shown in FIG. 9.

#### DETAILED DESCRIPTION OF THE PREFERRED EMBODIMENTS

Referring to the drawings, FIG. 1 shows a conventional self-propelled rotary combine 20 that includes a housing or body 22 defining an internal open area or space 24. The body 22, which can include a supporting frame, is supported on front drive wheels 26 and steerable rear wheels 28. The combine 20 is powered by an engine (not shown) and controlled from an operator's station 30.

A crop harvesting apparatus 32, otherwise referred to as a header, and an infeed mechanism 34 are attached at a forward end of the combine 20. The infeed mechanism 34 feeds crop materials to a rotor assembly 36 enclosed within the body 22. One example of a rotary combine configured with a rotary assembly 36 is disclosed in U.S. Pat. No. 5,489,239, titled "Rotary Combine" and which issued Feb. 6, 1996 to Case Corporation, the same assignee as the present application, and which is hereby incorporated herein by reference.

As best shown in FIG. 2, the rotor assembly 36 is preferably configured as a single axial unit that threshes and separates crop materials presented thereto into grain and other materials. However, it should be appreciated that the rotary combine 20 could be configured with more than one rotary assembly 36, for example, with two units arranged in a parallel configuration. The rotor assembly 36 is mounted in the internal area 24 defined by the body 22 (FIG. 1).

The rotor assembly 36 includes a rotor 38 with a longitudinal extent rotatably mounted to the body 22 about a longitudinal axis of rotation 40, which extends axially along the length of the combine 20. It should be understood that the term "longitudinal" means of or relating to length or the lengthwise dimension. It should also be understood that the rotor 38, with its longitudinal extent, could be mounted within the body 22 so as to extend laterally from side-to-side within the combine 20.

It should be understood that the terms "left side," "right side," "right," "front," "rear," "upper," "lower," "top," and "bottom," and their derivatives, as used herein, are intended to indicate directions relative to the views presented in the Figs., and in particular, from a perspective when viewing the rotary combine of FIG. 1, and the internal components thereof, from the crop harvesting apparatus 32 toward the steerable rear wheels 28.

Referring back to FIG. 2, between the upstream, or front end, and the downstream, or rear end, of the rotor assembly 36, the crop material is threshed as it spirals around the rotor 38 against a concave 42 disposed at least partially, circumferentially around the rotor 38. The rotor 38 can be dimensioned with a broad range of diameters, depending on the desired size and performance characteristics of the combine 20.

For example, suitable rotors 38 may have a diameter in the range of fifteen inches to thirty inches, although it should

## 6

be appreciated that other diameters, larger and smaller, would also work for the purposes of this invention. The rotor 38 is configured with suitable instrumentalities (not shown) mounted on the peripheral surface thereof that cooperate with the concave 42 to thresh the crops introduced therebetween.

As shown in FIG. 2, the concave 42 can include various semi-cylindrical concave inserts 44 and grate inserts 46, which are generally provided in a lower arcuate fashion and supported by a concave frame (not shown). The rotor 38 is preferably made of steel, and is generally rotated at speeds of between 150 to 1500 revolutions per minute, depending on the type of crop being threshed, and the conditions under which the threshing is being performed. It should be understood, however, that the speed of the rotor 38 is not critical to the operation of the invention, and that other speeds, faster and slower, may be desired and suitable for the purposes of the present invention without detracting or departing from the scope thereof.

Still referring to FIG. 2, the concave inserts 44 and grate inserts 46 each have a plurality of apertures that allow the grain to be separated from the other crop material as the grain passes through the apertures. Most of the grain drops onto a grain pan 48. The grain is thereafter conveyed rearward from the grain pan 48 by an auger mechanism 50 for subsequent cleaning and collection. Straw, tailings and other waste crop material are impelled rearwardly out of the discharge end of the rotor assembly 36 where a rotary beater throws the straw and other waste material rearwardly from the combine.

The combine 20 further includes a cleaning system for cleaning chaff, straw, tailings and other foreign material from the grain. For example, the cleaning system can include a cleaning fan 52, a chaffer sieve 54, a grain sieve 56, and a clean grain collector 58. A suitable auger mechanism 60 directs clean grain from the clean grain collector 58 into a hopper or grain bin (not shown). It should be understood that other cleaning systems would be suitable for the purposes of the present invention without detracting or departing from the scope thereof.

Referring now to FIGS. 3, and 5-8, shown is a concave 62, including a preferred transverse pivot assembly mechanism 64. Referring next to FIGS. 9-11, shown is a concave 66, including an alternative preferred transverse pivot assembly mechanism 68. It should be understood that each of the concaves 62 and 66 are preferably structurally identical with the exception of certain structural aspects of the preferred transverse pivot assembly mechanism 64 and the alternative preferred transverse pivot assembly mechanism 68.

Accordingly, the structure of the concaves 62 and 66 will be discussed together and will include identical numbering for identical structural parts. However, any discussion regarding unique structural and operational aspects of the preferred transverse pivot assembly mechanism 64 and the alternative preferred transverse pivot assembly mechanism 68 will be discussed separately and include distinct numbering.

Referring to FIGS. 3 and 9, it can be seen that the concaves 62 and 66 each include a concave frame 70, which supports a plurality of concave inserts, such as a concave insert 72 and a concave insert 74. The concaves 62 and 66 further include a concave adjustment mechanism 76, such as known in the art and as will be discussed in further detail later.

As further shown in FIGS. 3 and 5-11, it can be seen that the concave frame 70 extends generally circumferentially

around, and longitudinally along, the lower hemisphere of the rotor **38**. A rotor shield **78** extends generally circumferentially around, and longitudinally along, the upper hemisphere of the rotor **38**. Included as part of the concave frame **70** is a longitudinally extending right frame rail **80** and a longitudinally extending left frame rail **82**.

The right frame rail **80** and the left frame rail **82** are preferably spaced between about 160 degrees to about 190 degrees relative to each other, and more preferably at about 180 degrees. However, it should be understood that the right frame rail **80** and the left frame rail **82** can be spaced at lesser angles, such as 120 degrees or less.

As illustrated in FIGS. **3** and **9**, the concave frame **70** further includes a plurality of rib members, such as a primary rib member **84**, a secondary rib member **86**, a secondary rib member **88**, a primary rib member **90**, a secondary rib member **92**, a secondary rib member **94**, and a primary rib member **96**. The plurality of rib members **84**, **86**, **88**, **90**, **92**, **94**, and **96** extend transversely between the right frame rail **80** and the left frame rail **82** of the concave frame **70**.

It is preferred that the plurality of rib members **84**, **86**, **88**, **90**, **92**, **94**, and **96** be longitudinally spaced from one another so that a series of openings are formed between each successive rib member. It should be appreciated that additional or fewer rib members could be used to define more or less openings. Regardless, it is preferred that each one of the plurality of rib members **84**, **86**, **88**, **90**, **92**, **94**, and **96** be generally arcuate in shape and have an upper arcuate edge (not shown) and a radius substantially the same as, or slightly greater than, the radius of the rotor **38**.

As shown generally in FIGS. **3** and **9**, the primary rib members **84** and **96** define lugs, such as a rib lug **98** and a rib lug **100**, adjacent to the right frame rail **80** of the concave frame **70**. As further illustrated in FIGS. **3**, **5**, **9**, and **10**, the primary rib members **84**, **90**, and **96** define additional lugs, such as a shoulder lug **102**, a shoulder lug **104**, and a shoulder lug **106**, adjacent to the left frame rail **82**.

Referring now to FIG. **5**, and in reference to the preferred transverse pivot assembly mechanism **64**, it can be seen that the shoulder lugs **102**, **104**, and **106** each include a set of apertures, such as a lower aperture **108** and an upper aperture **110**, a lower aperture **112** and an upper aperture **114**, and a lower aperture **116** and an upper aperture **118**. In contrast, and in reference to the alternative preferred transverse pivot assembly mechanism **68** shown in FIG. **10**, the shoulder lugs **102**, **104**, and **106** can alternatively include only a single aperture, such as an aperture **120**, an aperture **122**, and an aperture **124**, respectively.

Turning back to FIGS. **3** and **9**, it can be seen that each of the concaves **62** and **66** further includes concave inserts **72** and **74**. In general, the concave inserts **72** and **74** are releasably mounted to the concave frame **70** in a side-by-side configuration. As shown in FIGS. **3** and **9**, each of the concave inserts **72** and **74** are generally arcuate in shape and have a circumferential span of approximately 90 degrees. Because both of the concave inserts **72** and **74** are preferably structurally identical, it will be appreciated that only a detailed description will be made in reference to the concave insert **72**.

As illustrated by the concave insert **72**, two opposite side frame members, such as a side frame member **126** and a side frame member **128**, transversely extend along the circumferential span of the concave insert **72**. Similarly, an intermediate frame member **130** and an intermediate frame member **132** also transversely extend along the circumferential span of the concave insert **72**.

Turning now to FIGS. **6–8** and **11**, it can further be seen that the concave insert **72** includes a plurality of longitudinal frame members, such as a longitudinal frame member **134**, a longitudinal frame member **136**, a longitudinal frame member **138**, etc. Each of the longitudinal frame members **134**, **136**, **138**, etc. extends longitudinally between the side frame members **126** and **128** (not shown in FIGS. **6–8** and **11**) of the concave insert **72**. Thus, in cooperation with the concave frame **70**, the concave insert **72** forms a plurality of apertures through which crop grain product passes for collection by the grain pan **48** (not shown).

Referring again to FIGS. **3** and **9**, it can be seen that each of the concaves **62** and **66** further includes a concave adjustment mechanism **76**. One example of a preferred concave adjustment mechanism **76** is depicted by FIGS. **3**, **9**, and, more specifically, FIG. **4**, and is disclosed in a copending U.S. patent application Ser. No. 10/755,774, titled “Apparatus and Method for Effecting Movement and Clearance Spacing of a Concave”, filed Jan. 12, 2004 on behalf of CNH America LLC, the same assignee as in the present application, and which is hereby incorporated herein by reference.

Generally, the concave adjustment mechanism **76** includes a rotatable shaft **140** that extends longitudinally above and along the right frame rail **80** of the concave frame **70**. An actuation motor (not shown), operable from the operator’s station **30** (not shown) of the combine **20** (not shown), is preferably coupled to the rotatable shaft **140** to provide rotational force for activation of the adjustment mechanism **76**.

Mounted upon the rotatable shaft **140** at each end is a suitable rotatable member, such as a cam sprocket **142** and a cam sprocket **144**. It can be seen that the cam sprockets **142** and **144** are securely mounted to the rotatable shaft **140** for rotation therewith. Because both the cam sprockets **142** and **144** are preferably structurally identical and include preferably structurally identical related components, it will be understood that only a detailed description will be made in reference to the cam sprocket **142** and its associated components.

Focusing now on FIG. **4**, an enlarged longitudinal view of the concave adjustment mechanism **76** is shown. As illustrated it is preferred that the cam sprocket **142** be configured to accommodate a flexible linkage, such as a chain **146**, a rigid link **148**, and a connection link **150**, which couples the chain **146** to the rigid link **148**. The concave adjustment mechanism **76** further includes a capturing device **152**, which generally acts as a travel limit to prevent the concaves **62** and **66** from being raised into the rotor **38** and damaged.

Turning now to FIGS. **3** and **5–8**, the preferred transverse pivot assembly mechanism **64** of the present invention will be discussed. As depicted in FIGS. **3** and **5**, it is desired that the preferred transverse pivot assembly mechanism **64** include three sets of linking members, such as a linking member **154** and a linking member **156**, a linking member **158** and a linking member **160**, and a linking member **162** and a linking member **164**.

However, it is also contemplated that additional or fewer sets of linking members could be used, depending upon factors such as the dimensions of the concave **62**, the rotor **38**, etc. Regardless, it will be appreciated that because each set of the three sets of linking members **154** and **156**, **158** and **160**, and **162** and **164** are preferably structurally identical, only a detailed description will be made in reference to the first set of linking members **154** and **156**.

Focusing now on FIG. **5**, it can be seen that the linking members **154** and **156** are generally similarly shaped, such

as in a “dog bone” configuration, with the linking member **156** being slightly longer than the linking member **154**. However, it is contemplated that the linking members **154** and **156** could alternatively be inconsistently or identically shaped and dimensioned.

Regardless, it is preferred that the linking member **154** includes a first end **166** and a second end **168**. Likewise, it is preferred that the linking member **156** includes a first end **170** and a second end **172**. Located preferably at the first ends **166** and **170** of the linking members **154** and **156** are apertures, such as a lower aperture **174** and a lower aperture **176**, respectively. Similarly, located preferably at the second ends **168** and **172** of the linking members **154** and **156** are apertures, such as an upper aperture **178** and an upper aperture **180**, respectively.

Joining the first end **166** and the second end **168** of the linking member **154** is a span portion **182**. Likewise, joining the first end **170** and the second end **172** of the linking member **156** is a span portion **184**. It is contemplated that each of the span portions **182** and **184** has a lesser width dimension than the width dimensions defined by each of the first ends **166** and **170** and the second ends **168** and **172** of the linking members **154** and **156**.

However, it should be understood that the size and shape of the linking members **154** and **156** are generally unimportant and may be altered as desired. Further, while it is preferred that the linking members **154** and **156** be sufficiently rigid, they could alternatively be constructed of any suitable load-bearing metal, alloy, or flexible material.

Referring again to FIGS. **3** and **5**, it can be seen that the preferred transverse pivot assembly mechanism **64** further preferably includes a mounting bracket **186**, a mounting bracket **188**, and a mounting bracket **190**. It is contemplated that a single mounting bracket, such as the mounting bracket **186**, will correspond to a single set of linking members, such as the linking members **154** and **156**. However, additional or fewer mounting brackets could alternatively correspond to any of the sets of linking members **154** and **156**, **158** and **160**, and **162** and **164**, depending upon factors such as the dimensions of the concave **62**, the rotor **38**, etc.

Regardless, it will be appreciated that because each of the mounting brackets **186**, **188**, and **190** are preferably structurally identical, only a detailed description will be made in reference to the mounting bracket **186**. As specifically illustrated in FIG. **5**, the mounting bracket **186** is preferably a unitary embodiment of any suitable size or shape and constructed of a suitable rigid material, such as steel. The mounting bracket **186** preferably includes a plurality of mounting apertures, such as a mounting aperture **192**, a mounting aperture **194**, a mounting aperture **196**, a mounting aperture **198**, and a mounting aperture **200**. The mounting apertures **192**, **194**, **196**, **198**, and **200** allow for the accommodation of different dimensions of linking members **154** and **156**, concaves **62**, rotors **38**, etc. Accordingly, it is contemplated that the mounting bracket **186** could include additional or fewer mounting apertures, as needed.

In further reference to FIG. **5**, an exemplary assembly of the preferred transverse pivot assembly mechanism **64** is provided. It will be understood that because of the preferred structural similarities between each of the three sets of linking members **154** and **156**, **158** and **160**, and **162** and **164** and the mounting brackets **186**, **188**, and **190**, only a detailed description will be made in reference to the exemplary assembly of the linking members **154** and **156** and the mounting bracket **186**.

As illustrated in FIG. **5**, the lower aperture **174** of the linking member **154** is preferably pivotally coupled, through

use of a suitable fastener, such as a pivot pin, with the upper aperture **110** of the shoulder lug **102**. Similarly, the lower aperture **176** of the linking member **156** is preferably pivotally coupled, through use of a suitable fastener, such as a pivot pin, with the lower aperture **108** of the shoulder lug **102**. Transverse pivot axes are preferably defined at each pivotal coupling.

In completing the transverse pivot assembly of the preferred transverse pivot assembly mechanism **64**, the linking members **154** and **156** are further pivotally coupled to the mounting bracket **186**. The mounting bracket **186** is preferably secured to the body **22** (FIG. **3**) of the combine **20** (not shown) in an area above the left frame rail **82** of the concave frame **70** through use of suitable fasteners (not shown), such as bolts, welds, rivets, etc.

More specifically, as illustrated in FIG. **5**, it can be seen that the upper aperture **178** of the linking member **154** is preferably pivotally coupled, through use of a suitable fastener, such as a pivot pin, to the mounting aperture **192** of the mounting bracket **186**. Similarly, the upper aperture **180** of the linking member **156** is preferably pivotally coupled, through use of a suitable fastener, such as a pivot pin, to the mounting aperture **198** of the mounting bracket **186**.

While pivotal coupling of the linking members **154** and **156** to the mounting apertures **192** and **198**, respectively, is preferred, it should be understood that any of the other mounting apertures **194**, **196**, and **200** could alternatively be used, depending upon such factors as the dimensions of the linking members **154** and **156**, the concave **62**, the rotor **38** (not shown), etc. Additionally, while use of pivot pins are preferred for the pivotal couplings, other suitable fasteners, such as rivets, bolts, etc., could also be used. Regardless, transverse pivot axes are preferably defined at each pivotal coupling.

In a related preferred embodiment, the first ends **166** and **170** of the linking members **154** and **156** are pivotally coupled directly to the body **22** of the combine **20** (not shown) rather than to the mounting bracket **186**. However, regardless of the mounting location, when properly mounted, it is preferred that the linking member **154** will be positioned substantially angular relative to the linking member **156**, in a generally “crossed” or “X-shaped” configuration. (See FIG. **3**.)

Referring now to FIGS. **6–8**, operation of the preferred transverse pivot assembly mechanism **64** will be discussed. As shown in FIG. **6**, the concave **62** is drawn near the rotor **38** of the combine **20** for the hard threshing of, for example, wheat. It can be seen that a pinch-point **202** is positioned at the lead in section **204** of the concave **62** so that the rotor will contact the crop grain immediately upon its downward rotation toward the concave **62**.

Turning now to FIG. **7**, it can be seen that the clearance spacing between the concave **62** and the rotor **38** has increased. Specifically, as the operator commands an increase of clearance spacing (e.g. through downward rotation of the adjustment mechanism **76**) from within the operator’s station **30** (not shown), the preferred transverse pivot assembly mechanism **64** automatically transversely pivots the concave **62** relative to the rotor **38**.

More specifically, as indicated by the single-headed arrow **206**, the linking member **154** transversely pivots in a generally right-to-left direction at the pivot axes defined by the coupling of the linking member **154** with the shoulder lug **102** and the mounting bracket **186**. Further, as illustrated by the single-headed arrow **208**, the linking member **156** pivots in a generally lower right-to-upper left direction at the pivot

## 11

axes defined by the coupling of the linking member 156 with the shoulder lug 102 and the mounting bracket 186.

Accordingly, the simultaneous pivoting of the linking members 154 and 156 act to transversely position the pinch-point 202 from the lead in section 204 of the concave 62 to the lead out section 210 of the concave 62, where the rotor 38 will contact the crop grain upon its upward rotation away from the concave 62.

Turning now to FIG. 8, it can be seen that as the clearance spacing between the concave 62 and the rotor 38 continues to increase, the pinch-point 202 (not shown) disappears, allowing for the removal of lodged material from between the concave 62 and the rotor 38.

Thus, as discussed above, the preferred transverse pivot assembly mechanism 64 will automatically transversely position the pinch-point 202 of the concave 62 relative to the rotor 38 of the combine 20 in accordance with the clearance spacing set by the combine operator. Accordingly, it will be understood that when the concave 62 is lifted upward toward the rotor 38 from the position in FIG. 8 to the position in FIG. 6, the concave 62 will transversely pivot in an opposite manner (e.g. from left-to-right) than as described above.

While the preceding preferred transverse pivot assembly mechanism 64 is most desired, an alternative preferred transverse pivot assembly mechanism 68 is also contemplated. For example, the alternative preferred transverse pivot assembly 68 includes an alternative linking assembly having a plurality of non-rotatable members, such as a non-rotatable member 214, a non-rotatable member 216, and a non-rotatable member 218.

While the non-rotatable members 214, 216, and 218 are preferred, additional or fewer non-rotatable members could be used, depending upon factors such as the dimensions of the concave 66, the rotor 38 (not shown), etc. However, it will be understood that because the non-rotatable members 214, 216, and 218 are preferably structurally identical, only a detailed description will be made in reference to the non-rotatable member 214.

As illustrated in FIG. 10, the non-rotatable member 214 is preferably a gear constructed of a rigid material, such as metal, hardened plastic, hardened rubber, etc. A center-mounting aperture 220 is preferably defined within the non-rotatable member 214 for secure attachment to the shoulder lug 102 of the concave 66. However, it is also contemplated that instead of being a separable component, the non-rotatable member 214 could alternatively be unitarily configured as part of the shoulder lug 102. Regardless, it is preferred that the non-rotatable member 214 have a peripheral surface 222 defining a plurality of tines, such as a tine 224, a tine 226, a tine 228, etc.

Turning to FIGS. 9 and 10, it can be seen that the alternative preferred transverse pivot assembly mechanism 68 further includes a rotatable shaft 230, which is supported by the body 20 (not shown) of the combine 22 (not shown) in a longitudinal extent above the left frame rail 82 of the concave frame 70. The rotatable shaft 230 is adapted to accommodate a plurality of rotatable members, such as a rotatable member 232, a rotatable member 234, and a rotatable member 236, for rotation therewith.

While the rotatable members 232, 234, and 236 are preferred, it is contemplated that additional or fewer rotatable members could alternatively be used, depending upon factors such as the dimensions of the concave 66, the rotor 38, etc. Regardless, because the rotatable members 232, 234, and 236 are preferably structurally identical, it will be understood that only a detailed description will be made in reference to the rotatable member 232.

## 12

Accordingly, as depicted in FIG. 10, the rotatable member 232 is preferably a gear constructed of a rigid material, such as metal, hardened plastic, hardened rubber, etc. A center-mounting aperture 238 is defined through the center of the rotatable member 232, which allows the rotatable member 232 to be axially mounted to the rotatable shaft 230 for rotation therewith. The rotatable member 232 preferably further includes a peripheral surface 240 defining a plurality of tines, such as a tine 242, a tine 244, a tine 246, etc.

The alternative preferred transverse pivot assembly mechanism 68 further preferably includes multiple linking members, such as a linking member 248, a linking member 250, and a linking member 252. Accordingly, it is contemplated that a single linking member, such as the linking member 248, will correspond to a single non-rotatable member and rotatable member, such as the non-rotatable member 214 and the rotatable member 232.

However, additional or fewer linking members could be used, depending upon factors such as the dimensions of the concave 66, the rotor 38, etc. Regardless, because the linking members 248, 250, and 252 are preferably structurally identical, it will be understood that only a detailed description will be made in reference to the linking member 248.

Accordingly, as further illustrated by FIG. 10, it can be seen that the linking member 248 includes a first end 254 and a second end 256. Configured within the first end 254 is a lower aperture 258 for coupling with at least one of the non-rotatable member 214 and the shoulder lug 102. Similarly, an upper aperture 260 is configured within the second end 256 for coupling with at least one of the rotatable shaft 230 and the rotatable member 232.

Focusing further on FIG. 10, an exemplary assembly of the alternative transverse pivot assembly mechanism 68 is provided. It will be understood that because of the preferred structural similarities between each of the non-rotatable members 214, 216, and 218; the rotatable members 232, 234, and 236; and the linking members 248, 250, and 252, only a detailed description will be made in reference to the exemplary assembly of the non-rotatable member 214, the rotatable member 232, and the linking member 248.

Accordingly, it can be seen that the non-rotatable member 214 is preferably securely affixed, at its center-mounting aperture 220, to the aperture 120 of the shoulder lug 102. It is contemplated that any suitable fastener, such as a bolt, rivet, weld, etc., capable of securely affixing the non-rotatable member 214 to the shoulder lug 102, could be used.

As further illustrated, the rotatable member 232 is axially mounted to the rotatable shaft 230, at its center-mounting aperture 238, for rotation therewith. It is contemplated that any suitable fastener, such as a weld, adhesive, lock-nut etc., capable of securely affixing the rotatable member 232 to the rotatable shaft 230 for rotation therewith, could be used.

In completing the transverse pivot assembly, the linking member 248 is preferably securely affixed, at its lower aperture 258, to the center-mounting aperture 220 of the non-rotatable member 214 and the aperture 120 of the shoulder lug 102. While it is preferred that the first end 254 of the linking member 248 be securely (e.g. non-pivotally) coupled to the non-rotatable member 214 and the shoulder lug 102, the first end 254 of the linking member 248 could alternatively be pivotally coupled to the non-rotatable member 214 and the shoulder lug 102. Regardless, it is contemplated that any suitable fastener, such as a weld, rivet, bolt, etc., could be used to affix the first end 254 of the linking member 248 to the non-rotatable member 214 and the shoulder lug 102.



Finally, the second end **256** of the linking member **248** is preferably pivotally coupled, at its upper aperture **260**, to the rotatable shaft **230** and the rotatable member **232**. While it is preferred that the second end **256** of the linking member **248** be pivotally coupled to the rotatable shaft **230** and the rotatable member **232**, the second end **256** could alternatively be securely (e.g. non-pivotally) coupled to the rotatable shaft **230** and the rotatable member **232** for rotation therewith.

Referring now to FIG. **11**, operation of the alternative transverse pivot assembly mechanism **68** will be discussed. As shown by the solid lines of the concave **66** in FIG. **11**, the concave **66** is positioned near the rotor **38** of the combine **20** for the hard threshing of, for example, wheat. Specifically, the pinch-point **262** of the concave **66** is positioned at the lead in section **264** of the concave **66** so that the rotor **38** will contact the crop grain immediately upon its downward rotation toward the concave **66**.

Referring now to the broken lines nearest the rotor **38**, it can be seen that the clearance spacing between the concave **62** and the rotor **38** has increased. Specifically, as the operator commands an increase of clearance spacing (e.g. through downward rotation of the adjustment mechanism **76**) from within the operator's station **30** (not shown), the alternative preferred transverse pivot assembly mechanism **68** automatically transversely pivots the concave **66** relative to the rotor **38**.

More specifically, and in reference to the single-headed arrow **266**, as the rotatable member **232** rotates relative to the non-rotatable member **214**, the tines **242**, **244**, **246**, etc. (see FIG. **10**) of the rotatable member **232** engage the tines **224**, **226**, **228** etc. (see FIG. **10**) of the non-rotatable member **214**.

The engagement causes the concave **66** to automatically transversely pivot in a generally right-to-left direction (see broken line arrow **268**) relative to the rotor **38**. Accordingly, the pivoting of the concave **66** acts to transversely position the pinch-point **262** from the lead in section **264** to the lead out section **270** of the concave **66**. In the lead-out section **270**, the rotor **38** will contact the crop grain upon its upward rotation away from the concave **66**.

Turning now to the broken lines furthest from the rotor **38**, it can be seen that as the clearance spacing between the concave **66** and the rotor **38** continues to increase, the pinch-point **262** disappears, allowing for the removal of lodged material from between the concave **66** and the rotor **38**.

Thus, as discussed above, the alternative transverse pivot assembly mechanism **68** will automatically transversely pivot and position the pinch-point **262** of the concave **66** relative to the rotor **38** of the combine **20** (not shown) in accordance with the clearance spacing set by the combine operator. Accordingly, it will be understood that when the concave **66** is lifted upward from the broken lines furthest from the rotor **38** to the solid lines nearest to the rotor **38**, the concave **66** will transversely pivot in an opposite manner (i.e. from left-to-right) than as described above.

Accordingly, the present invention provides an improved transverse concave pivot assembly mechanism and method for optimizing threshing potential for different crop grain material and different threshing conditions. More specifically, the present invention provides at least one transverse pivot axis, which allows automatic transverse positioning of the pinch-point of a concave relative to a rotor of a combine in accordance with the clearance spacing set between the concave and the rotor, thereby minimizing operator effort without sacrificing combine performance.

Although an exemplary embodiment of the transverse pivot assembly mechanism and method has been shown and described with reference to particular embodiments and applications thereof, it will be apparent to those having ordinary skill in the art that a number of changes, modifications, or alterations to the invention as described herein may be made, none of which depart from the spirit or scope of the present invention. All such changes, modifications, and alterations should therefore be seen as being within the scope of the present invention.

What is claimed is:

**1.** A transverse pivot assembly mechanism for automatically positioning a pinch-point of a concave relative to a rotor of a combine, the mechanism comprising:

a remotely operative adjustment mechanism coupled to one end of said concave; and

a linking assembly pivotally coupling another end of said concave to said combine, said linking assembly defining at least one transverse pivot axis, said transverse pivot axis allowing automatic remotely operative adjustment mechanism providing selective transverse pivoting of said concave along said transverse pivot axis and relative to said rotor in accordance with selectively defined clearance spacing between said concave and said rotor, wherein said linking assembly includes at least a first linking member and a second linking member, said first linking member and said second linking member substantially similar in shape, said first linking member being positioned substantially angular relative to said second linking member, wherein said substantially angular positioning of said first linking member relative to said second linking member defines a generally "X-shaped" configuration.

**2.** The transverse pivot assembly mechanism of claim **1**, wherein at least one of said first linking member and said second linking member is rigid.

**3.** The transverse pivot assembly mechanism of claim **1**, wherein at least one of said first linking member and said second linking member is flexible.

**4.** The transverse pivot assembly mechanism of claim **1**, wherein one of said first linking member and said second linking member has a greater length dimension than the other of said first linking member and said second linking member.

**5.** The transverse pivot assembly mechanism of claim **1**, wherein said linking assembly further includes at least a third linking member and a fourth linking member, said third linking member and said fourth linking member being substantially similar in shape, said third linking member being positioned substantially angular relative to said fourth linking member.

**6.** The transverse pivot assembly mechanism of claim **5**, wherein one of said third linking member and said fourth linking member has a greater length dimension than the other of said third linking member and said fourth linking member.

**7.** The transverse pivot assembly mechanism of claim **5**, wherein said substantially angular positioning of said third linking member relative to said fourth linking member defines a generally "X-shaped" configuration.

**8.** The transverse pivot assembly mechanism of claim **5**, wherein said linking assembly further includes at least a fifth linking member and a sixth linking member, said fifth linking member and said sixth linking member being substantially similar in shape, said fifth linking member being positioned substantially angular relative to said sixth linking member.

## 15

9. The transverse pivot assembly mechanism of claim 8, wherein one of said fifth linking member and said sixth linking member has a greater length dimension than the other of said fifth linking member and said sixth linking member.

10. The transverse pivot assembly mechanism of claim 8, wherein said substantially angular positioning of said fifth linking member relative to said sixth linking member defines a generally "X-shaped" configuration.

11. The transverse pivot assembly mechanism of claim 8, wherein said first linking member, said third linking member, and said fifth linking member have substantially similar length dimensions, and wherein said second linking member, said fourth linking member, and said sixth linking member have substantially similar length dimensions.

12. The transverse pivot assembly mechanism of claim 11, wherein said substantially angular positioning of said first linking member relative to said second linking member, said third linking member relative to said fourth linking member, and said fifth linking member relative to said sixth linking member define generally "X-shaped" configurations.

13. The transverse pivot assembly mechanism of claim 1, wherein said first linking member includes a first end and a second end and said second linking member includes a first end and a second end, said first end of said first linking member being pivotally coupled to said concave and said second end of said first linking member being pivotally coupled to said combine, said first end of said second linking member being pivotally coupled to said concave and said second end of said second linking member being pivotally coupled to said combine.

14. The transverse pivot assembly mechanism of claim 13, wherein said substantially angular positioning of said first linking member relative to said second linking member defines a generally "X-shaped" configuration.

15. The transverse pivot assembly mechanism of claim 13, wherein said pivotal coupling of said first end of said first linking member to said concave is located in a different horizontal plane than said pivotal coupling of said first end of said second linking member to said concave.

16. The transverse pivot assembly mechanism of claim 13, wherein said pivotal coupling of said second end of said first linking member to said combine is located in a different horizontal plane than said pivotal coupling of said second end of said second linking member to said combine.

17. The transverse pivot assembly mechanism of claim 13, wherein said pivotal coupling of said first end of said first linking member to said concave is located in a different horizontal plane than said pivotal coupling of said first end of said second linking member to said concave, and wherein said pivotal coupling of said second end of said first linking member to said combine is located in a different horizontal plane than said pivotal coupling of said second end of said second linking member to said combine.

18. The transverse pivot assembly mechanism of claim 1, wherein said linking assembly further includes at least a first mounting bracket mounted to said combine.

19. The transverse pivot assembly mechanism of claim 18, wherein said first mounting bracket includes a plurality of mounting apertures said mounting apertures allowing accommodation of varying dimensions of linking members, concaves, and rotors.

20. The transverse pivot assembly mechanism of claim 18, wherein said first linking member includes a first end and a second end and said second linking member includes a first end and a second end, said first end of said first linking member being pivotally coupled to said concave and said

## 16

second end of said first linking member being pivotally coupled to said mounting bracket, said first end of said second linking member being pivotally coupled to said concave and said second end of said second linking member being pivotally coupled to said mounting bracket.

21. The transverse pivot assembly mechanism of claim 20, wherein said substantially angular positioning of said first linking member relative to said second linking member defines a generally "X-shaped" configuration.

22. The transverse pivot assembly mechanism of claim 20, wherein said pivotal coupling of said first end of said first linking member to said concave is located in a different horizontal plane than said pivotal coupling of said first end of said second linking member to said concave.

23. The transverse pivot assembly mechanism of claim 20, wherein said pivotal coupling of said second end of said first linking member to said first mounting bracket is located in a different horizontal plane than said pivotal coupling of said second end of said second linking member to said first mounting bracket.

24. The transverse pivot assembly mechanism of claim 20, wherein said pivotal coupling of said first end of said first linking member to said concave is located in a different horizontal plane than said pivotal coupling of said first end of said second linking member to said concave, and wherein said pivotal coupling of said second end of said first linking member to said first mounting bracket is located in a different horizontal plane than said pivotal coupling of said second end of said second linking member to said first mounting bracket.

25. A transverse pivot assembly mechanism for automatically positioning a pinch-point of a concave relative to a rotor of a combine, the mechanism comprising:

a linking assembly pivotally coupling said concave to said combine, said linking assembly defining at least one transverse pivot axis, said transverse pivot axis allowing automatic transverse pivot of said concave relative to said rotor in accordance with adjustably set clearance spacing between said concave and said rotor, said linking assembly including at least a first linking member and a second linking member, said first linking member and said second linking member being substantially similar in shape, said first linking member including a first end and a second end and said second linking member including a first end and a second end, at least a first mounting bracket mounted to said combine, said first mounting bracket including a plurality of mounting apertures, said mounting apertures allowing accommodation of varying dimensions of linking members, concaves, and rotors, wherein said first end of said first linking member is pivotally coupled to said concave and said second end of said first linking member is pivotally coupled to said first mounting bracket, and wherein said first end of said second linking member is pivotally coupled to said concave and said second end of said second linking member is pivotally coupled to said first mounting bracket, said first linking member being positioned substantially angular relative to said second linking member, wherein said substantially angular positioning of said first linking member relative to said second linking member defines a generally "X-shaped" configuration.

26. The transverse pivot assembly mechanism of claim 25, wherein said pivotal coupling of said first end of said first linking member to said concave is located in a different horizontal plane than said pivotal coupling of said first end

of said second linking member to said concave, and wherein said pivotal coupling of said second end of said first linking member to said first mounting bracket is located in a different horizontal plane than said pivotal coupling of said second end of said second linking member to said first mounting bracket. 5

27. The transverse pivot assembly mechanism of claim 25, wherein one of said first linking member and said second linking member has a greater length dimension than the other of said first linking member and said second linking member. 10

28. A transverse pivot assembly mechanism for automatically positioning a pinch-point of a concave relative to a rotor of a combine, the mechanism comprising:

a linking assembly pivotally coupling said concave to said combine, said linking assembly defining at least one transverse pivot axis, said transverse pivot axis allowing automatic transverse pivot of said concave relative to said rotor in accordance with adjustably set clearance spacing between said concave and said rotor, said linking assembly including at least a first linking member and a second linking member, said first linking member and said second linking member being substantially similar in shape, said first linking member including a first end and a second end and said second linking member including a first end and a second end, at least a first mounting bracket mounted to said combine, said first mounting bracket including a plurality of mounting apertures, said mounting apertures allowing accommodation of varying dimensions of linking members, concaves, and rotors, wherein said first end of said first linking member is pivotally coupled to said concave and said second end of said first linking member is pivotally coupled to said first mounting bracket, and wherein said first end of said second linking member is pivotally coupled to said concave and said second end of said second linking member is pivotally coupled to said first mounting bracket, said pivotal coupling of said first end of said first linking member to said concave being located in a different horizontal plane than said pivotal coupling of said first end of said second linking member to said concave, said pivotal coupling of said second end of said first linking member to said first mounting bracket being located in a different horizontal plane than said pivotal coupling of said second end of said second linking member to said first mounting bracket, said first linking member being positioned substantially angular relative to said second linking member, said substantially angular positioning of said first linking member relative to said second linking member defining a generally "X-shaped" configuration. 40

29. A rotary combine comprising:

a rotor having a longitudinal axis of rotation;

a concave including a first side and a second side, said concave spaced circumferentially around said rotor and comprising a plurality of concave inserts outwardly removable away from said rotor in a direction transverse to said longitudinal axis of said rotor;

a transverse pivot assembly mechanism coupling said first side of said concave to said combine, said transverse pivot assembly mechanism comprising:

a linking assembly pivotally coupling said concave to said combine, said linking assembly defining at least one transverse pivot axis, said transverse pivot axis allowing automatic transverse pivot of said concave relative to said rotor in accordance with adjustably set clearance spacing between said concave and said rotor, said linking assembly including at least a first

linking member and a second linking member, said first linking member and said second linking member being substantially similar in shape, said first linking member being positioned substantially angular relative to said second linking member, wherein said substantially angular positioning of said first linking member relative to said second linking member defines a generally "X-shaped" configuration; and

an adjustment mechanism coupling said second side of said concave to said combine, said adjustment mechanism allowing adjustment of clearance spacing between said concave and said rotor.

30. The rotary combine of claim 29, wherein one of said first linking member and said second linking member has a greater length dimension than the other of said first linking member and said second linking member. 15

31. The rotary combine of claim 29, wherein said first linking member includes a first end and a second end and said second linking member includes a first end and a second end, said first end of said first linking member being pivotally coupled to said first side of said concave and said second end of said first linking member being pivotally coupled to said combine, said first end of said second linking member being pivotally coupled to said first side of said concave and said second end of said second linking member being pivotally coupled to said combine. 20

32. The rotary combine of claim 31, wherein said substantially angular positioning of said first linking member relative to said second linking member defines a generally "X-shaped" configuration. 25

33. The rotary combine of claim 31, wherein said pivotal coupling of said first end of said first linking member to said first side of said concave is located in a different horizontal plane than said pivotal coupling of said first end of said second linking member to said first side of said concave. 30

34. The rotary combine of claim 31, wherein said pivotal coupling of said second end of said first linking member to said combine is located in a different horizontal plane than said pivotal coupling of said second end of said second linking member to said combine. 35

35. The rotary combine of claim 31, wherein said pivotal coupling of said first end of said first linking member to said first side of said concave is located in a different horizontal plane than said pivotal coupling of said first end of said second linking member to said first side of said concave, and wherein said pivotal coupling of said second end of said first linking member to said combine is located in a different horizontal plane than said pivotal coupling of said second end of said second linking member to said combine. 40

36. The rotary combine of claim 29, wherein said linking assembly further includes at least a first mounting bracket mounted to said combine, and wherein said first linking member includes a first end and a second end and said second linking member includes a first end and a second end, said first end of said first linking member being pivotally coupled to said first side of said concave and said second end of said first linking member being pivotally coupled to said first mounting bracket, said first end of said second linking member being pivotally coupled to said first side of said concave and said second end of said second linking member being pivotally coupled to said first mounting bracket. 45

37. The rotary combine of claim 36, wherein said first mounting bracket includes a plurality of mounting apertures, said mounting apertures allowing accommodation of varying dimensions of linking members, concaves, and rotors. 50

19

38. The rotary combine of claim 36, wherein said substantially angular positioning of said first linking member relative to said second linking member defines a generally "X-shaped" configuration.

39. The rotary combine of claim 36, wherein said pivotal coupling of said first end of said first linking member to said first side of said concave is located in a different horizontal plane than said pivotal coupling of said first end of said second linking member to said first side of said concave.

40. The rotary combine of claim 36, wherein said pivotal coupling of said second end of said first linking member to said first mounting bracket is located in a different horizontal plane than said pivotal coupling of said second end of said second linking member to said first mounting bracket.

41. The rotary combine of claim 36, wherein said pivotal coupling of said first end of said first linking member to said first side of said concave is located in a different horizontal plane than said pivotal coupling of said first end of said second linking member to said first side of said concave, and wherein said pivotal coupling of said second end of said first linking member to said first mounting bracket is located in a different horizontal plane than said pivotal coupling of said second end of said second linking member to said first mounting bracket.

42. A method for automatically transversely pivoting and positioning a pinch-point of a concave relative to a rotor of a combine, the method comprising the steps of:

providing a rotor having a longitudinal axis of rotation;

providing at least one concave, said concave including a

first side and a second side spaced circumferentially

around said rotor and including a plurality of concave

inserts outwardly removable away from said rotor in a

direction transverse to said longitudinal axis of said

rotor;

20

providing a transverse pivot assembly mechanism, said transverse pivot assembly mechanism coupling said first side of said concave to said combine, said transverse pivot assembly mechanism comprising:

a linking assembly pivotally coupling said first side of said concave to said combine, said linking assembly defining at least one transverse pivot axis, said transverse pivot axis allowing automatic transverse pivot of said concave relative to said rotor in accordance with adjustably set clearance spacing between said concave and said rotor, said linking assembly including at least a first linking member and a second linking member, said first linking member and said second linking member being substantially similar in shape, said first linking member being positioned substantially angular relative to said second linking member, wherein said substantially angular positioning of said first linking member relative to said second linking member defines a generally "X-shaped" configuration;

providing a remotely operative adjustment mechanism, said remotely operative adjustment mechanism adjustably coupling said second side of said concave to said combine for effecting movement and clearance spacing of said concave relative to said rotor of said combine; and

selectively actuating said remotely operative adjustment mechanism to effect movement and clearance spacing of said concave relative to said rotor of said combine.

\* \* \* \* \*