



US006868703B2

(12) **United States Patent**
Molzer

(10) **Patent No.:** **US 6,868,703 B2**
(45) **Date of Patent:** ***Mar. 22, 2005**

- (54) **HANDLE AND LOCK**
- (75) Inventor: **Klaus Molzer, Jassjo (SE)**
- (73) Assignee: **Austin Hardware, Inc., Minneapolis, MN (US)**
- (*) Notice: Subject to any disclaimer, the term of this patent is extended or adjusted under 35 U.S.C. 154(b) by 0 days.

2,473,937 A	6/1949	Cameron	292/348
2,701,735 A	2/1955	Segal	292/348
2,707,121 A	4/1955	Behnke	292/228
2,851,871 A	9/1958	Newell	70/150
2,949,328 A	8/1960	Kaiser	292/207
3,159,994 A	12/1964	Schulz	70/146
4,583,775 A	4/1986	Bisbing	292/64
4,732,418 A	3/1988	Crown et al.	292/207

(List continued on next page.)

This patent is subject to a terminal disclaimer.

Primary Examiner—Daniel P. Stodola
Assistant Examiner—Christopher Boswell
(74) *Attorney, Agent, or Firm*—Vidas, Arrett & Steinkraus, P.A.

- (21) Appl. No.: **10/689,170**
- (22) Filed: **Oct. 20, 2003**
- (65) **Prior Publication Data**
US 2004/0079124 A1 Apr. 29, 2004

Related U.S. Application Data

- (60) Continuation of application No. 10/079,841, filed on Feb. 19, 2002, now Pat. No. 6,662,605, which is a division of application No. 09/448,646, filed on Nov. 24, 1999, now Pat. No. 6,354,119.
- (51) **Int. Cl.**⁷ **E05B 13/10**
- (52) **U.S. Cl.** **70/210; 70/224; 70/215; 70/DIG. 31; 292/336.3**
- (58) **Field of Search** **70/209–210, 207, 70/190, 215, 217, 224, 445, DIG. 31, DIG. 67; 292/336.3, 350, DIG. 59, DIG. 71**

(56) **References Cited**

U.S. PATENT DOCUMENTS

1,812,334 A	6/1931	Gloekler	292/205
2,160,611 A	5/1939	Alexander	292/348
2,459,920 A	1/1949	Clark	70/223

(57) **ABSTRACT**

A handle and lock which generally includes a base having an index pin, a stop positioned in a circular channel, and an aperture traversing the base. A shaft is rotatably engaged to the base. The shaft includes a nut-shaped platform and an arcuate positioning limiter disposed in the circular working channel. The nut shaped platform preferably includes a threaded bore to receive a fastener used to releasably attach a handle to the shaft. The handle generally includes a head portion having a nut shaped receiving area and an arcuate protruding positioning member for placement within the circular working channel. The nut shaped receiving area preferably covers the platform during rotation of the handle relative to the base. The head portion may also include a lock having a locking barrier connected to a locking cylinder. The locking barrier is also adapted for removable positioning within the circular working channel to prevent rotation between the rotational limiter and the stop thereby restricting rotation of the handle and shaft relative to the base. The shaft further includes a latch member designed to engage a latch receiver integral to a door frame used for latching of a door in a closed position.

21 Claims, 4 Drawing Sheets

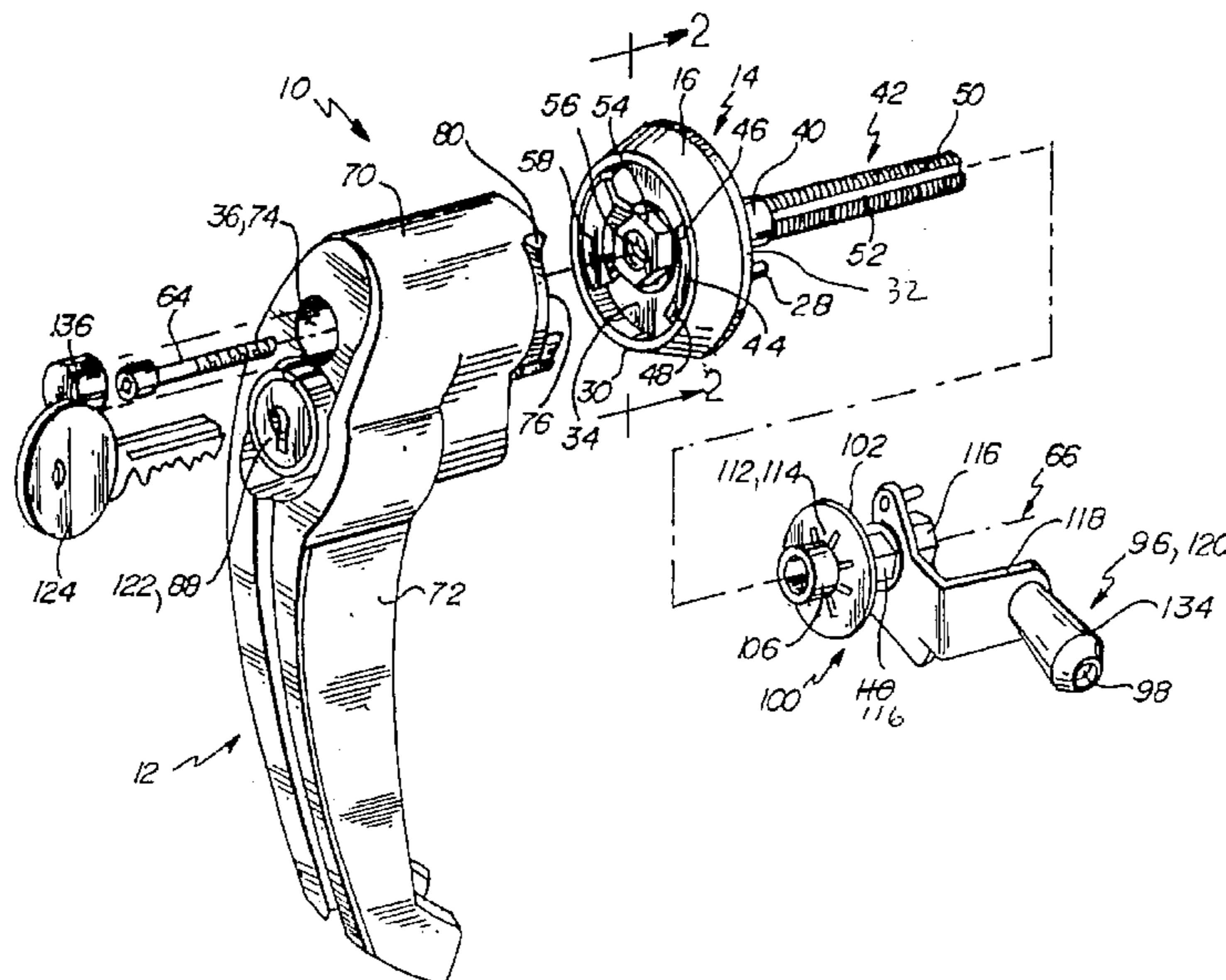

US 6,868,703 B2

Page 2

U.S. PATENT DOCUMENTS

4,763,935 A	8/1988	Bisbing	292/66	5,664,448 A	9/1997	Swan et al.	70/224
5,172,944 A	12/1992	Munich et al.	292/39	5,666,695 A	9/1997	Jegers et al.	16/381
5,184,853 A	2/1993	Whatley	292/205	D385,768 S	11/1997	Nutter et al.	D8/308
D343,347 S	1/1994	Lau et al.	D8/301	5,683,005 A	11/1997	Mordick	220/3.7
5,292,189 A	3/1994	Lau et al.	312/265.3	5,704,100 A	1/1998	Swan	
5,299,597 A	4/1994	Fort et al.	137/385	D391,143 S	2/1998	Jancsek	D8/308
5,390,517 A	2/1995	Yamada	70/210	5,722,121 A	3/1998	Lau et al.	16/381
5,408,853 A	4/1995	Yamada	70/210	D396,397 S	7/1998	Swan	D8/331
D360,345 S	7/1995	Swan et al.	D8/308	D400,076 S	10/1998	Jancsek et al.	D8/331
5,469,725 A	11/1995	Yamada	70/208	5,862,690 A	1/1999	Jancek	70/224
5,481,889 A	1/1996	Richard et al.	70/118	5,879,035 A	3/1999	Jancek et al.	292/202
5,509,703 A	4/1996	Lau et al.	292/1	D411,433 S	6/1999	Swan et al.	D8/306
5,520,427 A	5/1996	Mader	292/336.3	6,068,308 A	5/2000	Molzer	292/336.3
D371,300 S	7/1996	Mordick	D8/343	6,086,308 A	7/2000	Sjogren et al.	414/373
5,582,042 A	12/1996	Mordick	70/14	6,101,856 A	8/2000	Pelletier et al.	70/472
5,582,443 A	12/1996	Finkelstein et al.	292/202	6,318,770 B1	11/2001	Molzer	292/241
5,620,290 A	4/1997	Homfeldt et al.	411/533	6,354,119 B1	3/2002	Molzer	70/210
5,630,632 A	5/1997	Swan	292/240	6,474,119 B1	11/2002	Halvorson et al.	70/208
5,634,357 A	6/1997	Nutter et al.	70/210	6,662,605 B2 *	12/2003	Molzer	70/210
5,642,909 A	7/1997	Swan et al.	292/39				

* cited by examiner

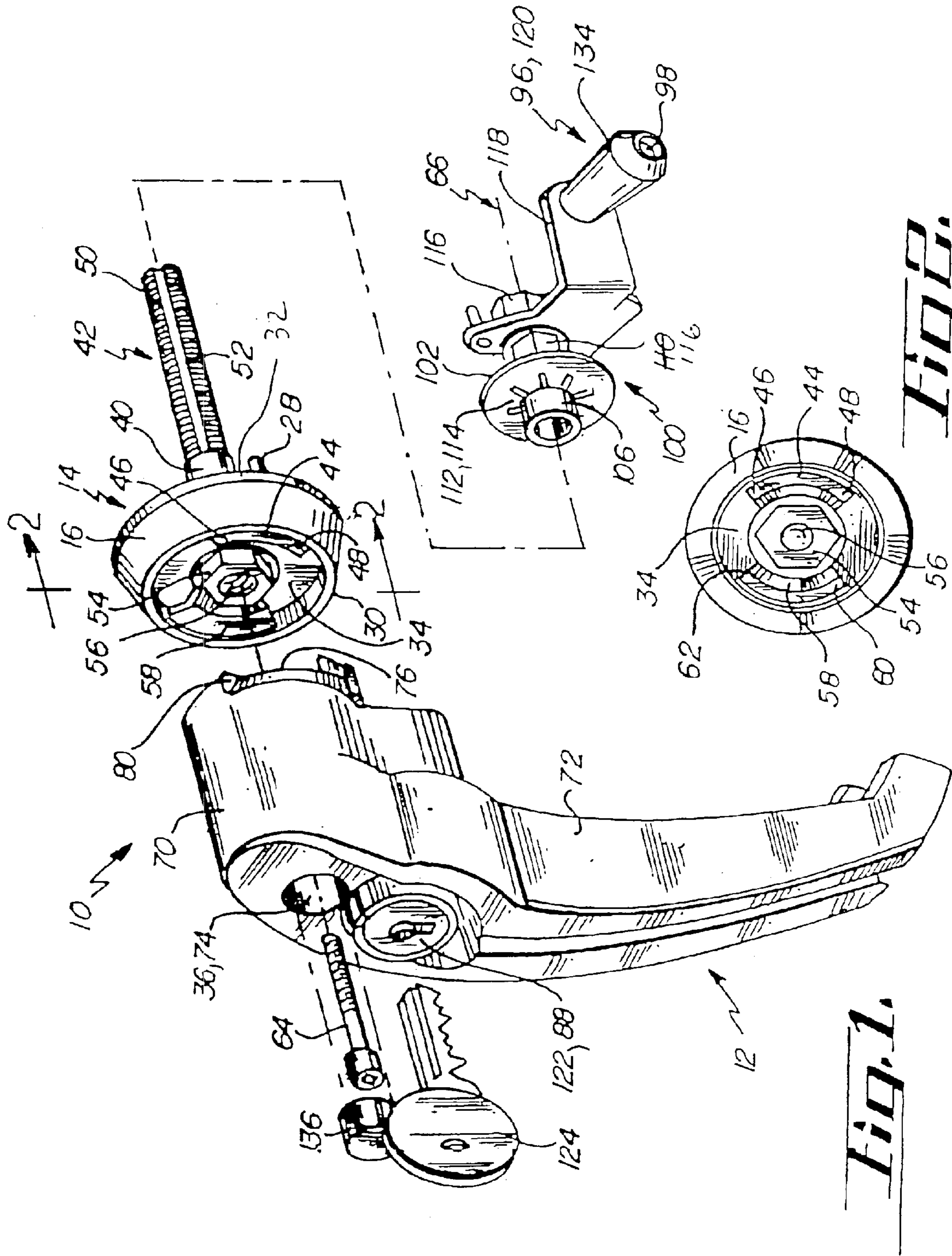

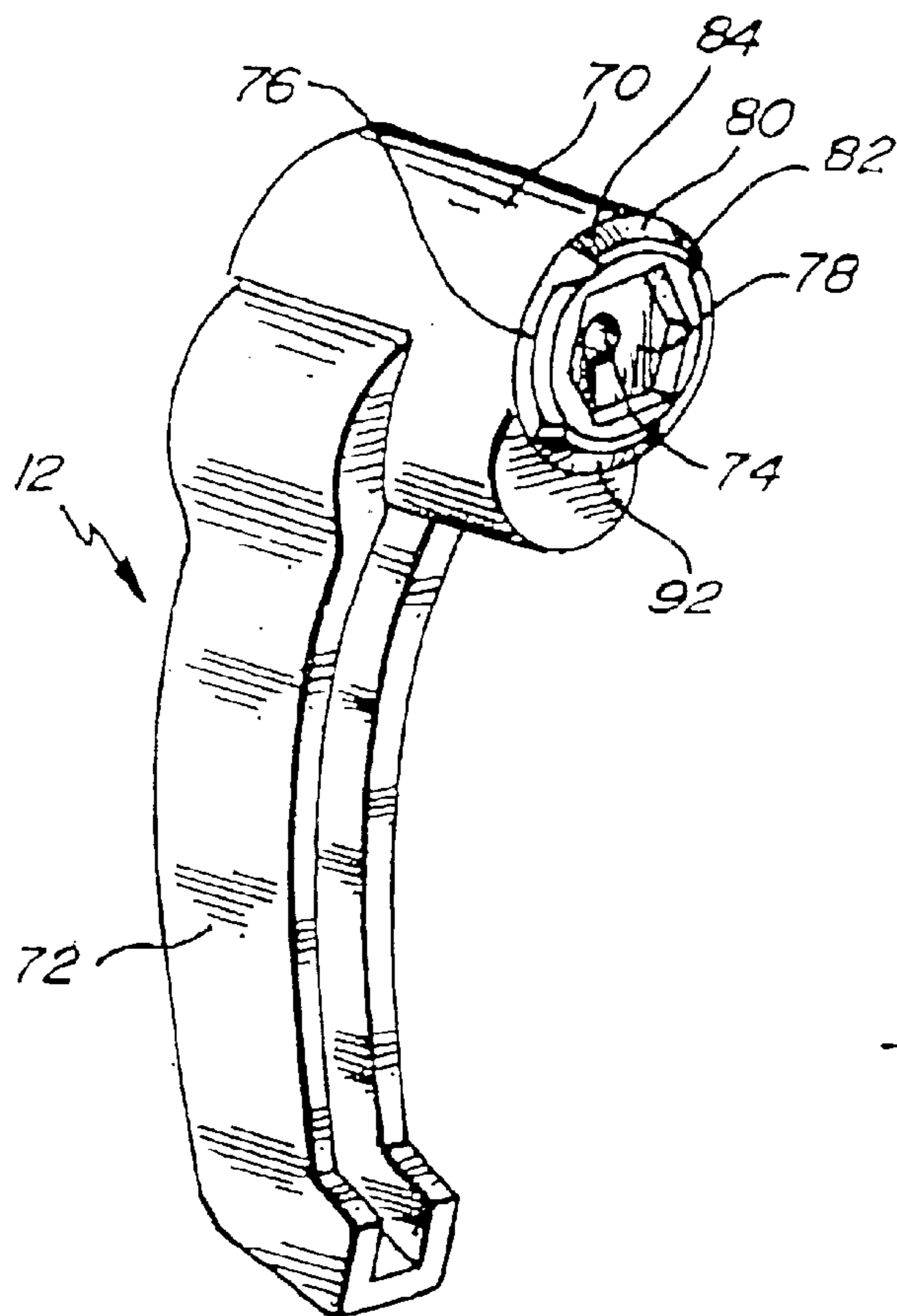

Fig. 3.

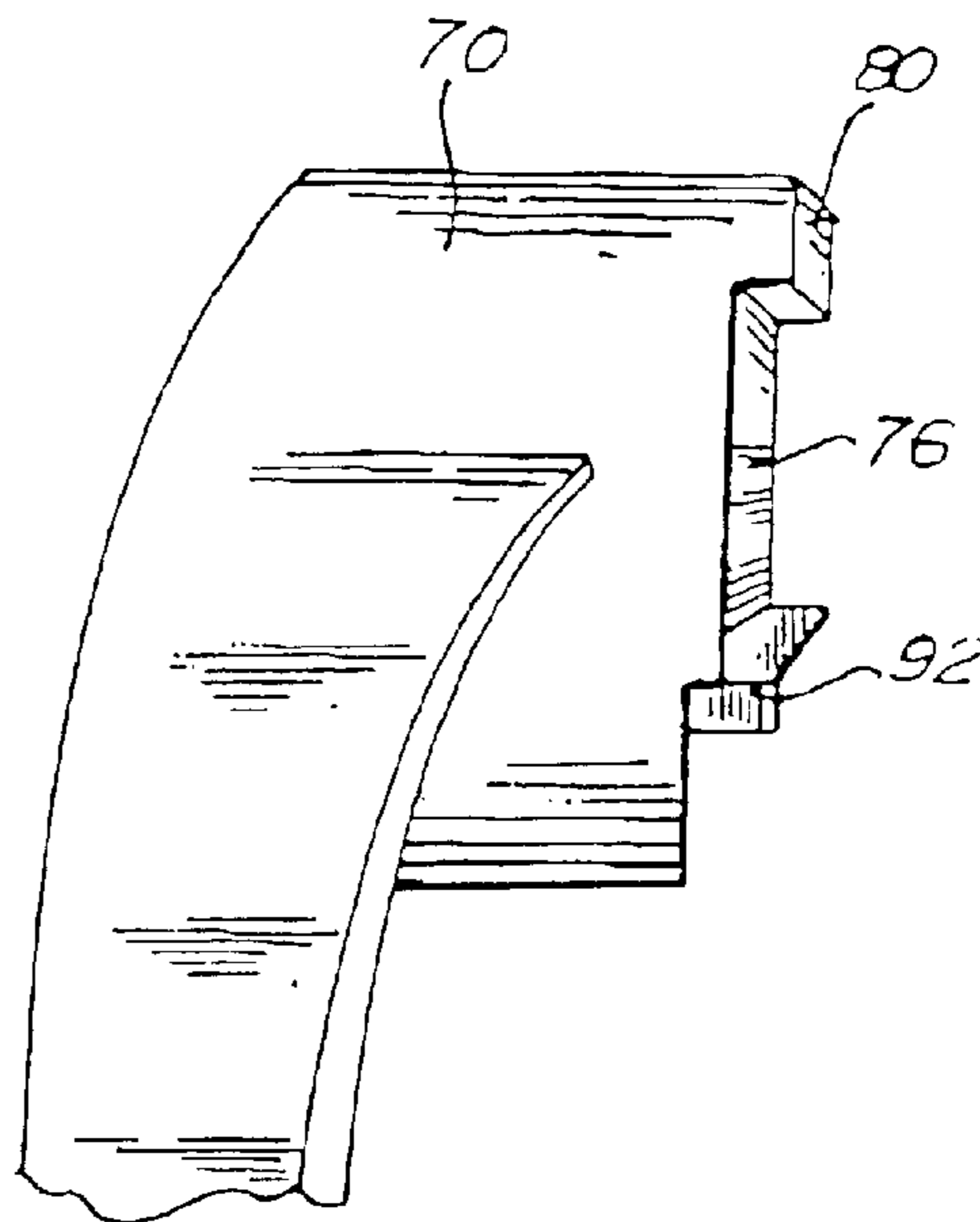

Fig. 4.

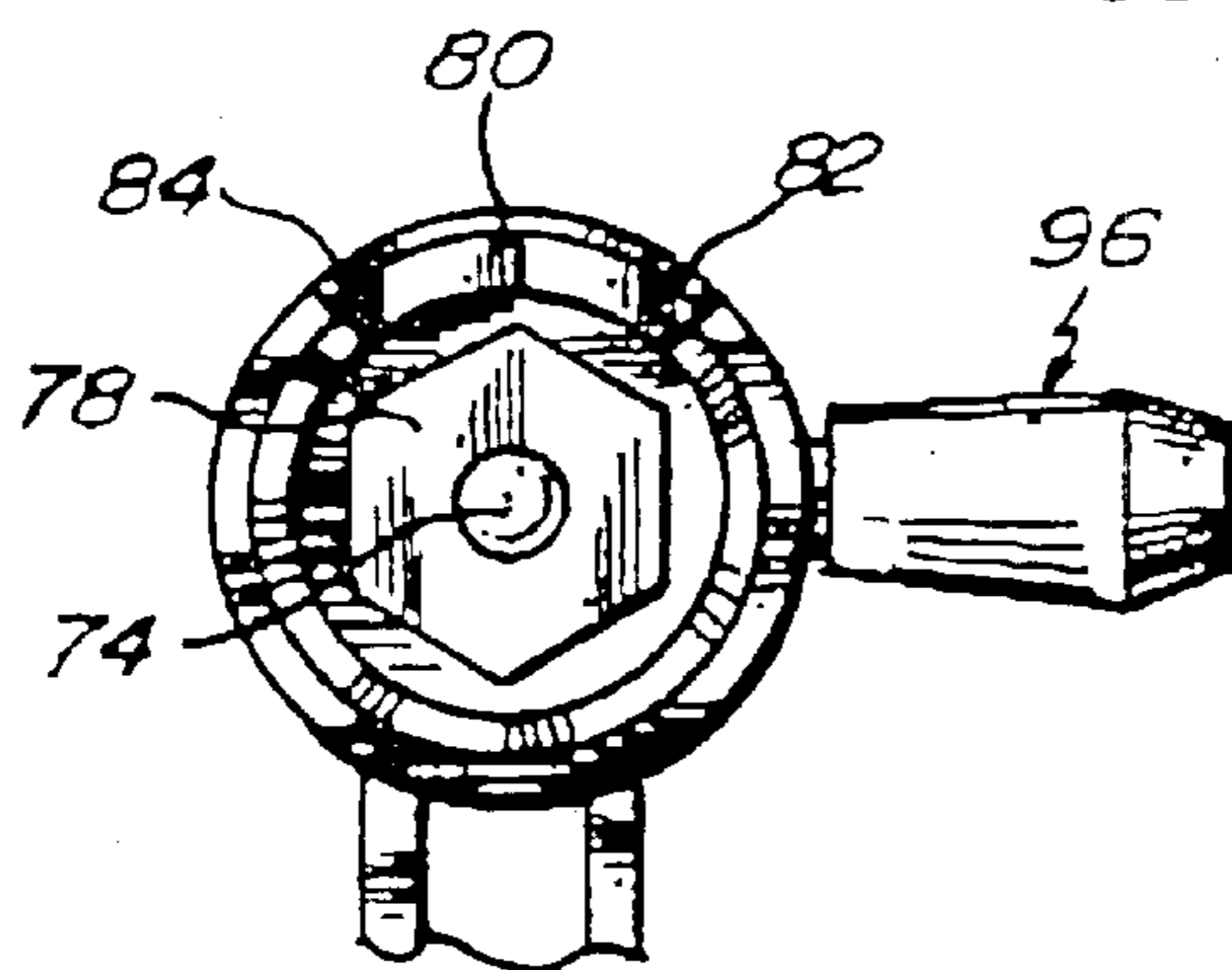

Fig. 5.

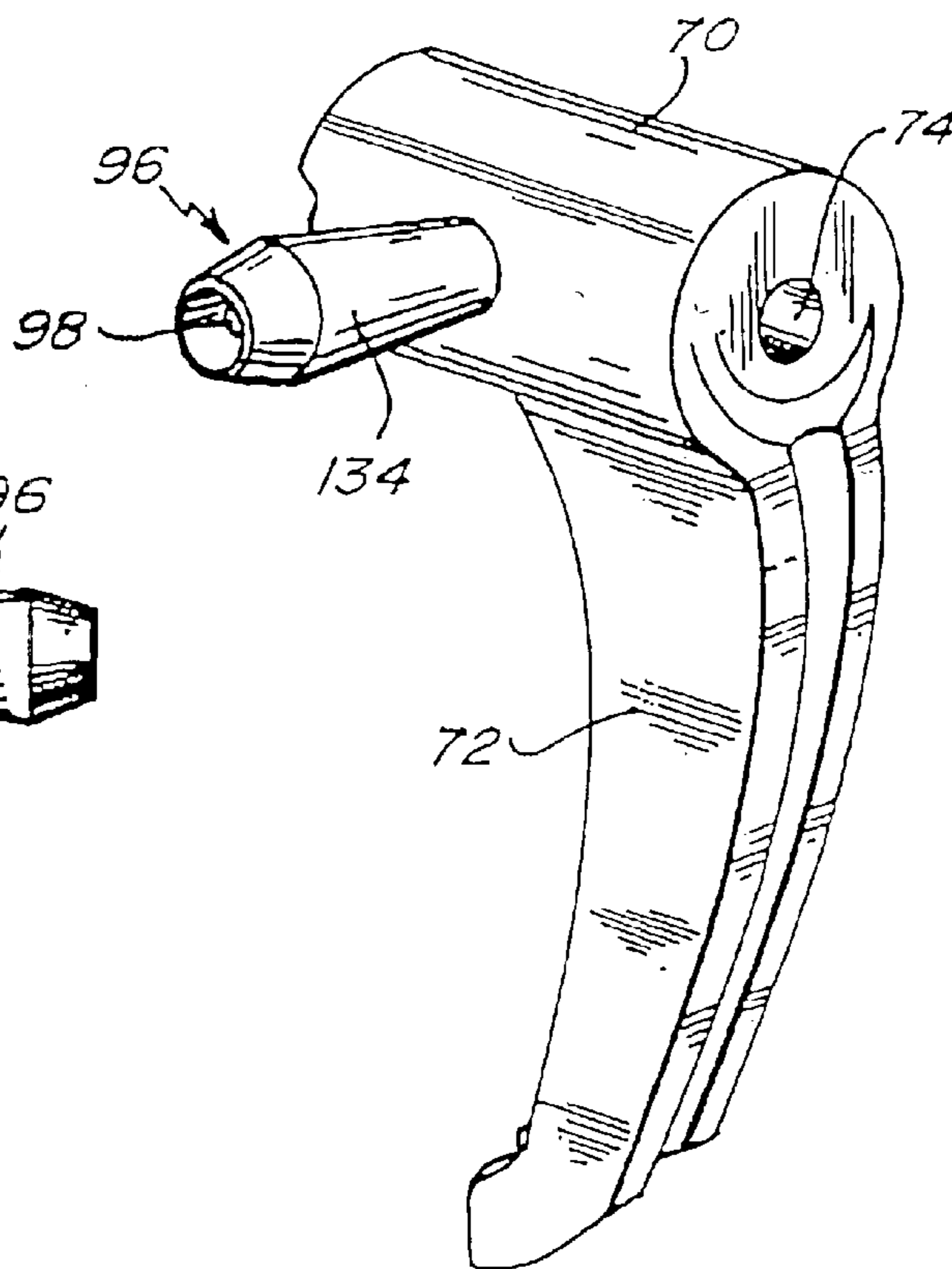

Fig. 6.

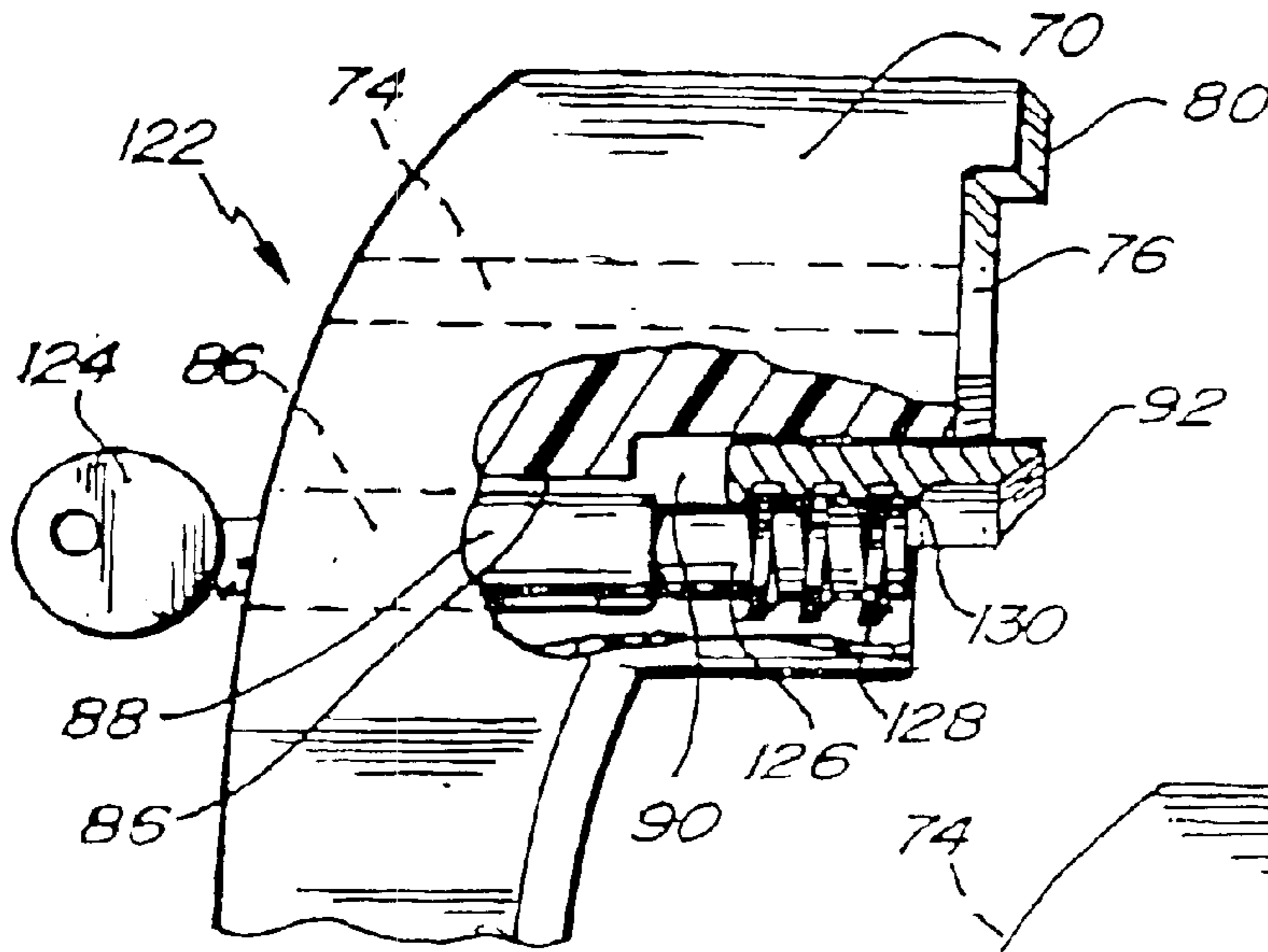

Fig. 7.

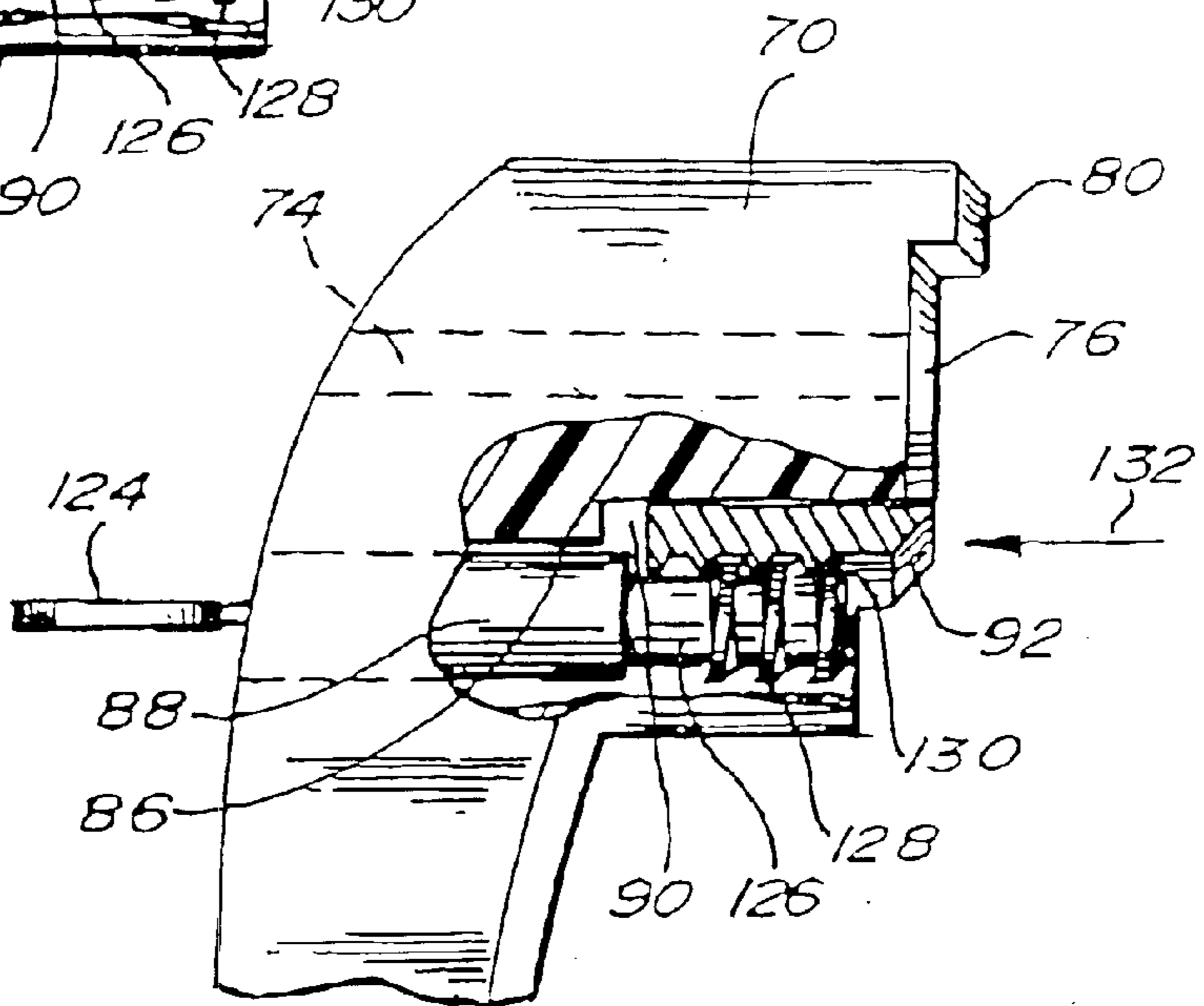

Fig. 8.

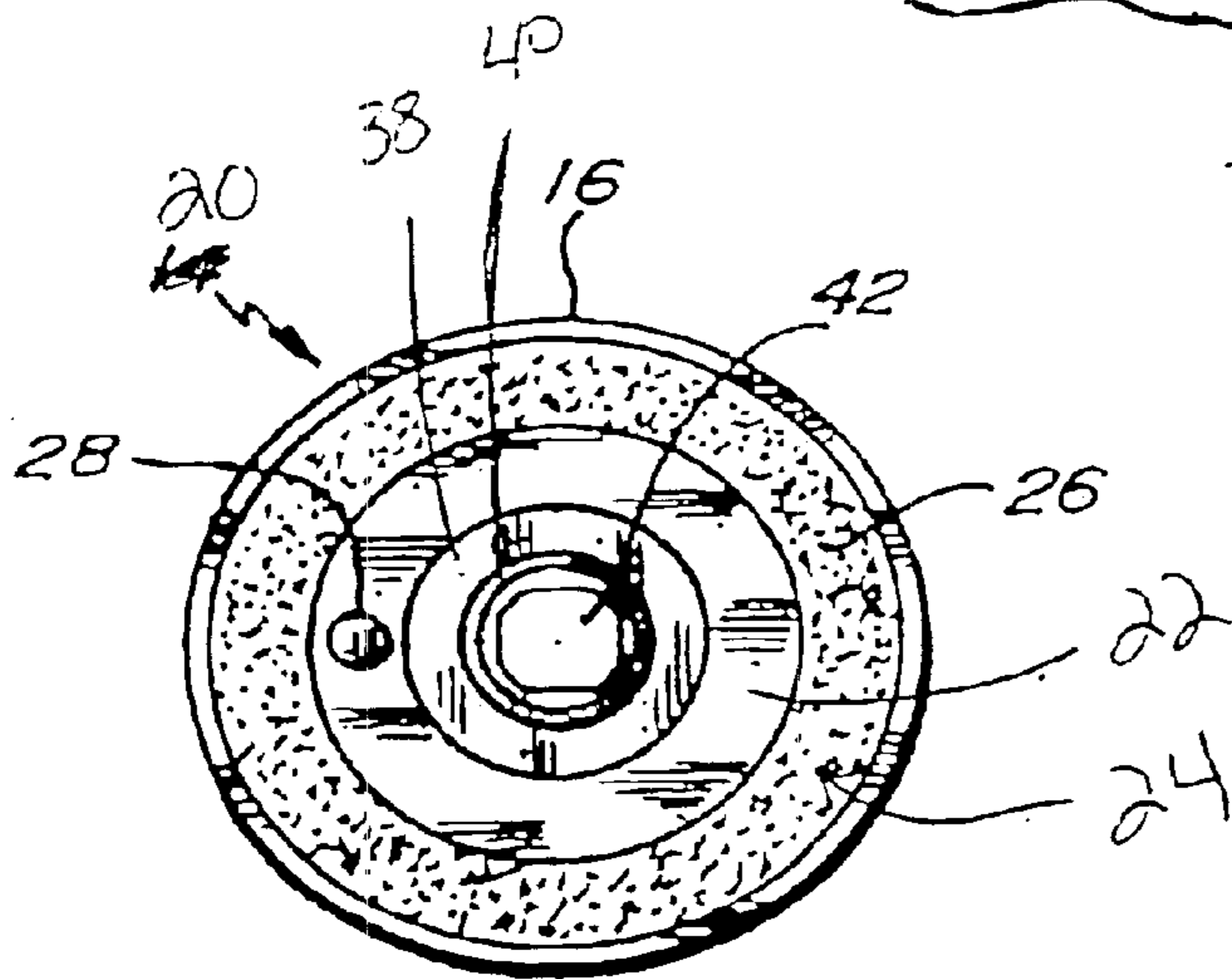

Fig. 13.

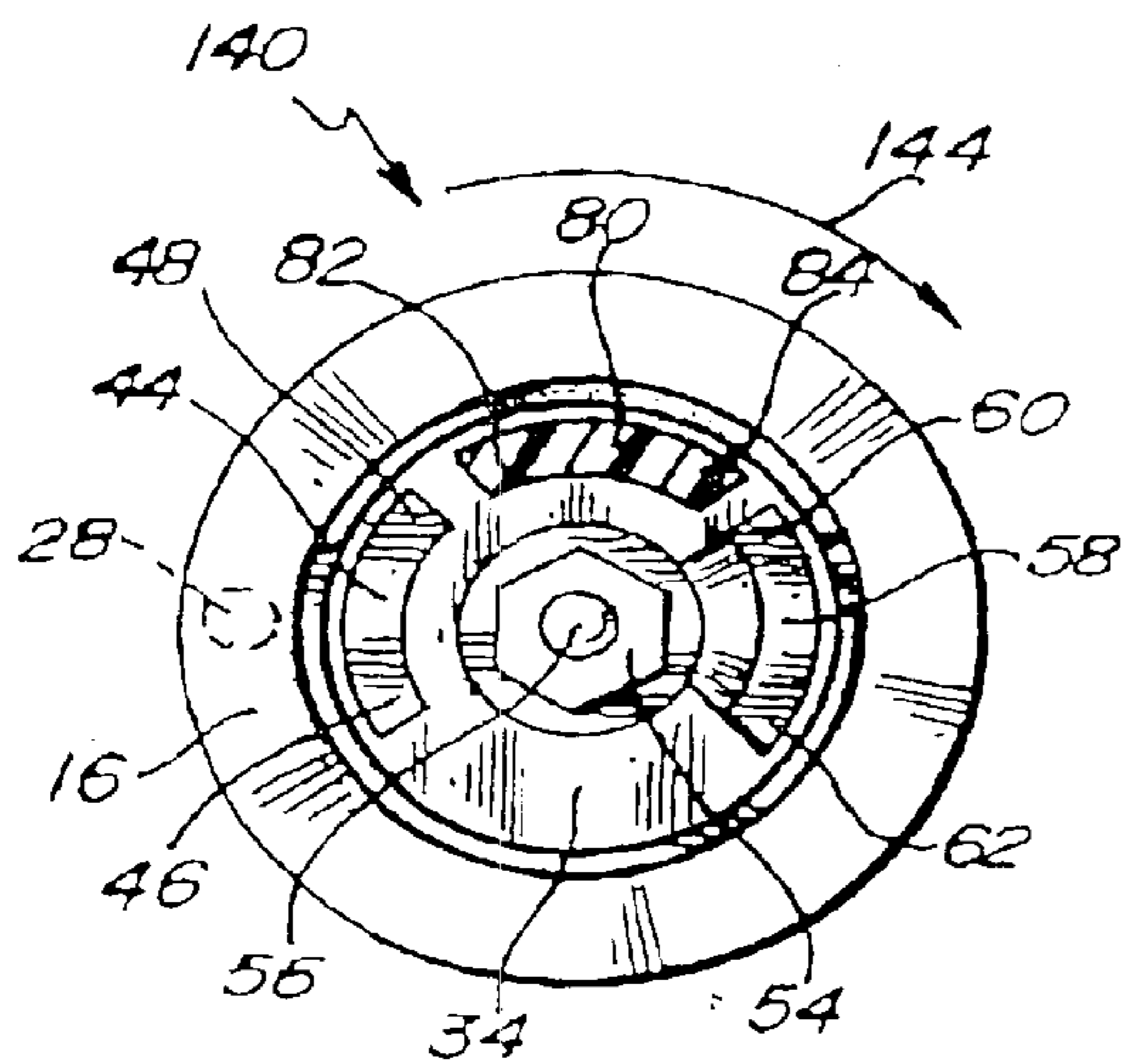

Fig. 9.

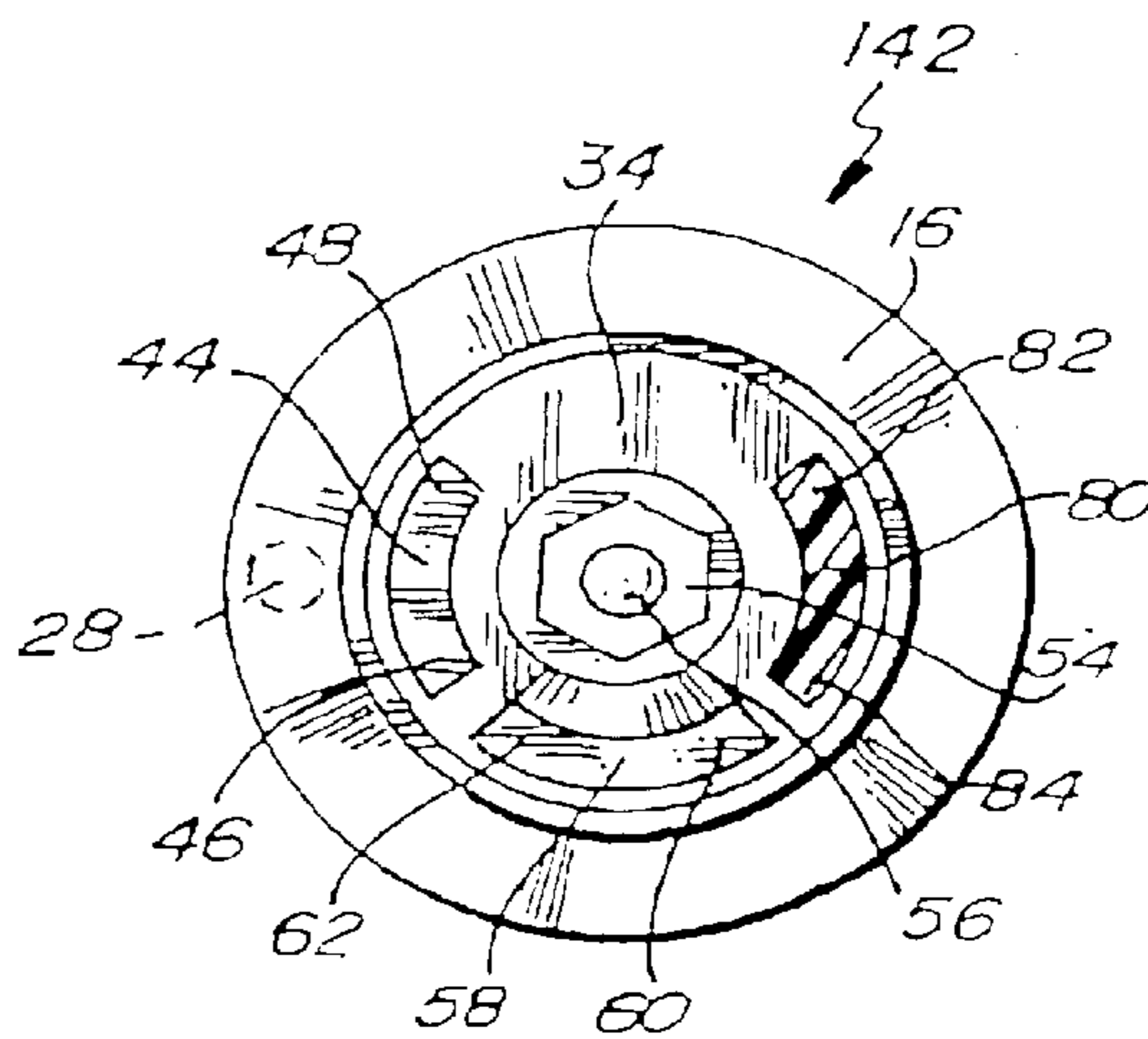

Fig. 10.

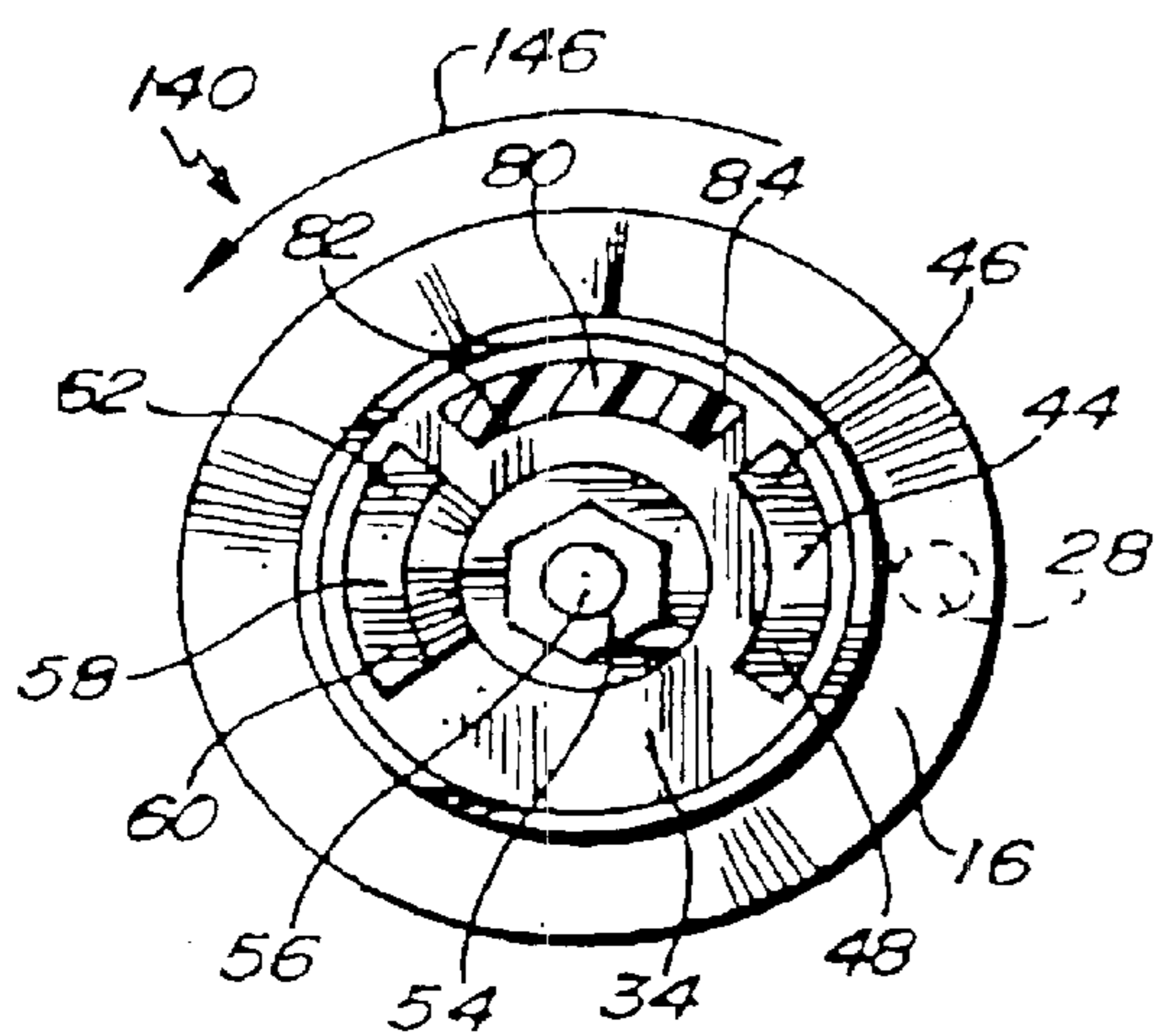

Fig. 11.

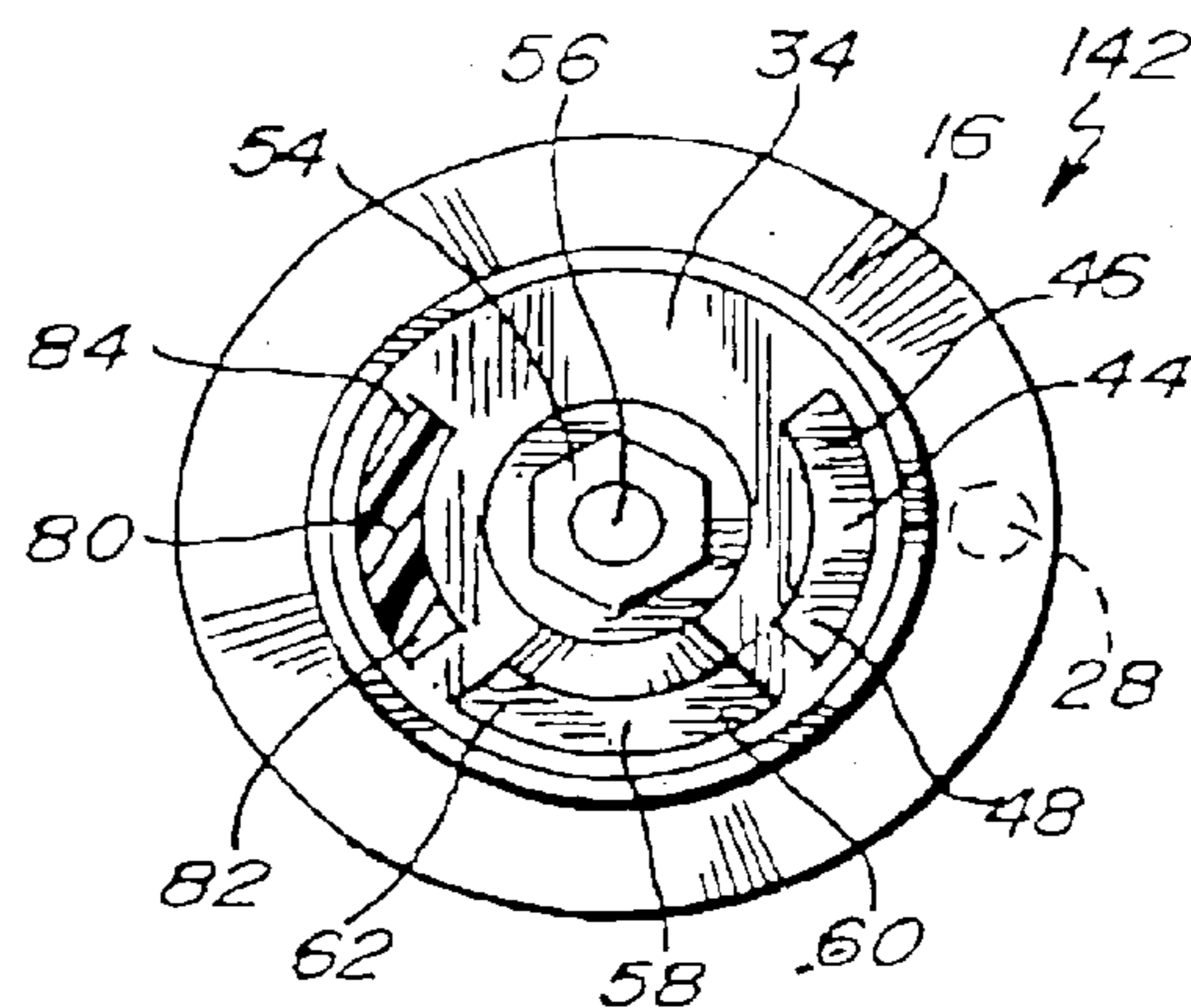

Fig. 12.

HANDLE AND LOCK**CROSS-REFERENCE TO RELATED APPLICATIONS**

This application is a continuation application from U.S. application Ser. No. 10/079,841, filed Feb. 19, 2002, now issued U.S. Pat. No. 6,662,605 issued Dec. 16, 2003, which application is a divisional application of U.S. Utility application Ser. No. 09/488,646 filed Nov. 24, 1999, now U.S. Pat. No. 6,354,119 issued Mar. 12, 2002, the entire contents of all of which are incorporated herein by reference in their entirety.

BACKGROUND OF THE INVENTION

This invention relates to latches and more particularly relates to latch assemblies utilizing handles and handle latching mechanisms for use with ceiling and air conditioning, ventilation and/or refrigeration units or cabinets and the like.

Latch assemblies with handles are known which are lockable by utilization of an internal lock cylinder which prevent the handle from rotating. Typically these latch assemblies may be locked and unlocked and remain in the unlocked position whereby the handle and door attached thereto may be opened with one hand.

In the past, the handles as known for use with ceiling and/or air conditioning or refrigeration cabinets have not provided a desired level of insulating qualities to prevent thermal transfer from occurring within a compartment. In addition, the handles as known did not provide sufficient insulating qualities to prevent condensation or frosting from occurring upon the handle and the associated temperature increases, air pressure and/or heat transfer from escaping from the interior of a compartment. In addition, no handle is known which provides a thermal break or barrier to insulate a handle used on a ceiling/air conditioning or refrigeration cabinet to provide a temperature and/or air seal for a ventilation and/or refrigerated structure.

A handle surface having a reduced temperature frequently occurs due to the use of non-insulating grooves, handle shaft air leakage and set screws for affixation of the handle to a door. The use of grooves and set screws frequently enable air to leak through the grooves which in turn causes an air leakage to occur on the handle which in turn causes a condensation to form upon the door handle. In addition, the use of grooves and set screws for affixation of a handle to a ventilation and/or air conditioning door frequently result in the loss of cool air from the interior of a air conditioned compartment into a heated environment.

There has been minimal development of efficient and convenient latching assemblies which solve these identified problems. Additional locking features to accommodate a padlock may also be desirable for use with a ceiling and/or air conditioning cabinet. Further, prior art latch assemblies, particularly locking latch assemblies normally lack flexibility in being adaptable for varying applications, for example, a left or right handed application with a door for a ventilation and/or refrigerated structure.

BRIEF DESCRIPTION OF THE INVENTION

The present invention provides a latching assembly for a ceiling and/or air conditioning or refrigeration cabinet for establishment of an effective insulation thermal barrier to effectively thermally seal or insulate a compartment from the loss of air from within a structure. The thermal handle

and latch includes a base having an index pin; a stop fixedly positioned in a circular working channel; an aperture traversing the base; a support stem positioned in the aperture for rotatably attaching the shaft to the base. The shaft includes a threaded end and an affixation end having a nut-shaped platform and arcuate positioning limiter. The positioning limiter is designed for rotational placement within the circular working channel and is further adapted to engage the stop. The nut-shaped platform further includes a centrally positioned threaded bore used to affix the handle to the shaft through the use of a threaded fastener. The handle includes a grasping end and head portion. The head portion includes a nut shaped receiving area and an arcuate protruding positioning member. The protruding positioning member is adapted for positioning and rotation within the circular working channel. The nut shaped receiving area preferably covers the nut shaped platform. The rotation of the handle causes the rotation of the nut shaped receiving area, and the arcuate protruding positioning member, which in turn cooperate to move the positioning limiter within the circular working channel towards or away from the stop during the latching or unlatching of a door to a structure. The central aperture further traverses the head portion of the handle and is adapted to receive the threaded fastener used to affix the shaft to a handle. A lock may also be included with the handle. The lock preferably is formed of a locking cylinder adapted to receive a key. The insertion of a key permits rotation of a locking cylinder to elevate one or more pins to permit the cylinder to be turned approximately 90° relative to the handle. At the distal end of the cylinder is preferably an arm having a worm gear which is rotatably engaged to teeth as integral to a linearly sliding arcuate locking barrier. Rotation of the key 90° clockwise causes the worm gear to rotate and to retract the linearly sliding arcuate locking barrier into a cavity and out of the circular working channel, thereby, permitting rotation of the handle, nut-shaped platform, arcuate positioning limiter, shaft and protruding positioning member for unlatching of the latch member as integral of the shaft from the keeper or latch receiver integral to the interior door frame during opening of a door for a refrigerated cabinet. An escutcheon is preferably affixed to the shaft between the interior of the door and the latch member to establish a thermal barrier preventing undesirable heat or cold transfer, frost and/or cooling loss through the handle, latch, and/or lock into an exterior environment.

The lock mechanism may include an arcuate locking or interference barrier which may slide linearly with respect to the shaft to prevent or permit rotation of the handle and shaft relative to the base. The locking or interference barrier may be operatively connected to the locking cylinder so that upon rotational movement of the key, the locking or interference barrier is brought into and out of engagement from the working channel in the base.

A principal object of the present invention is the provision of a ventilation and/or refrigeration handle and lock which is formed of relatively simply and inexpensive design, construction, and operation and which is safe and fulfills the intended purpose of providing a thermal barrier for a refrigerated compartment without risk of injury to persons and/or damage to property.

Another principal object of the present invention is the provision of a handle and lock which establishes a thermal barrier to prevent cooling of the handle when used upon a door for a ventilation and/or refrigerated structure.

Still another principal object of the present invention is the provision of a handle and lock which establishes a thermal barrier to enhance insulating properties of a venti-

lation and/or refrigeration structure by minimizing dissipation of cool air and the influx of heat through a structure into a refrigerated compartment.

Still another principal object of the present invention is the provision of a handle and lock which is energy and cost efficient.

Still another principal object of the present invention is the provision of a handle and lock which is flexible enabling either left handed or right handed operation.

Still another principal object of the present invention is the provision of a handle and lock which is flexible enabling an individual to use a thermal block or barrier with any preferred thickness of door used upon a refrigerated cabinet to enhance the insulating properties of the handle and lock.

Still another principal object of the present invention is the provision of a handle and lock which reduces condensation on the handle when used upon the door for a refrigerated structure.

Still another principal object of the present invention is the provision of a handle and lock which increases the comfort to individuals by minimizing cooling of the handle during use upon a door for a refrigerated structure.

Still another principal object of the present invention is the provision of a handle and lock which does not leak air and which provides a sealed refrigeration compartment.

Still another principal object of the present invention is the provision of a handle and lock which has improved compression properties thru adjustment.

A feature of the present invention is a provision of a handle and lock having a first thermal barrier between a base and the exterior surface of a door for a refrigerated structure.

Another feature of the present invention is a provision of a handle and lock having a thermal barrier between a shaft and the interior surface of a door for a refrigerated structure.

Still another feature of the present invention is a provision of a handle and lock having a thermal barrier which is positionable at a variety of locations relative to a base, shaft, and/or latch to improve insulating properties for a refrigerated structure.

Still another feature of the present invention is the provision of a handle and lock having a base formed of thermal insulating material.

Still another feature of the present invention is the provision of a handle and lock having a base having a housing defining a circular lip and a circular working channel.

Still another feature of the present invention is the provision of a handle and lock having an index pin adapted to engage a door to prevent rotation of the base relative to the door.

Still another feature of the present invention is the provision of a handle and lock having a base having a centrally positioned aperture and a support stem positioned in the aperture where the support stem rotatably connects a shaft to the base.

Still another feature of the present invention is the provision of a handle and lock having a base having an arcuate shaped stop positioned within the circular working channel to restrict the rotation of the shaft relative to the base.

Still another feature of the present invention is the provision of a handle and lock having a shaft having an elongate central support section terminating in a threaded section.

Still another feature of the present invention is the provision of a handle and lock having a shaft having an hexagonal shaped nut cap end having a centrally positioned threaded bore therein.

Still another feature of the present invention is the provision of a handle and lock having a shaft having a rotational limiter integral or affixed to the hexagonal shape nut cap end where the rotational limiter is adapted to engage the stop to restrict rotation of the handle relative to the base.

Still another feature of the present invention is the provision of a handle and lock having a handle having a head portion and a grasping portion.

Still another feature of the present invention is the provision of a handle and lock having a head portion having a centrally positioned aperture therethrough.

Still another feature of the present invention is the provision of a handle and lock having a handle having a head portion which includes an hexagonal shaped receiving area adapted to engage and cover the nut cap of the shaft.

Still another feature of the present invention is the provision of a handle and lock having a handle having a head portion which includes an arcuate shaped protruding positioning member adapted for positioning within the circular working channel and further adapting for engagement to the stop.

Still another feature of the present invention is the provision of a handle and lock formed of thermal insulating material.

Still another feature of the present invention is the provision of a handle and lock having a threaded fastener adapted for positioning through the aperture of the head portion and for engagement to the threaded bore of the shaft to secure the handle to the shaft.

Still another feature of the present invention is the provision of a handle and lock having thermal barrier escutcheon adapted for engagement to the shaft.

Still another feature of the present invention is the provision of a handle and lock having a thermal barrier escutcheon which includes a disk portion and cylindrical portion extending from the disk portion.

Still another feature of the present invention is the provision of a handle and lock having a thermal barrier escutcheon having an affixation face having a plurality of graspers adapted to securely affix the escutcheon to the shaft at any desired location.

Still another feature of the present invention is the provision of a handle and lock having an escutcheon having a disk portion which includes a lip and recessed portion adapted to receive a disk-shaped affixation face which includes a plurality of graspers.

Still another feature of the present invention is the provision of a handle and lock having an escutcheon having a disk-shaped affixation face which includes a centrally positioned opening which is aligned with the cylindrical portion to permit passing of the shaft therethrough.

Still another feature of the present invention is the provision of a handle and lock having a base having a disk-shaped housing which is securely attached to a base plate through a press fit.

Still another feature of the present invention is the provision of a handle and lock having an escutcheon formed of thermal insulating material.

Still another feature of the present invention is the provision of a handle and lock having one or more nuts and a latch member securely engaged to the shaft where rotation of the handle causes the latch member to rotate for latching or unlatching of a keeper or latch receiver affixed to a door frame for opening of a door to provide access to a refrigerated cabinet.

5

Still another feature of the present invention is the provision of a handle and lock having a handle having a cylindrical bore and a lock disposed in the cylindrical bore.

Still another feature of the present invention is the provision of a handle having a lock having a lock shaft including a worm gear.

Still another feature of the present invention is the provision of a handle and lock having an arcuate locking barrier having a plurality of teeth or grooves engaged to the worm gear for insertion or retraction of the arcuate locking barrier from positioning with the circular working channel thereby permitting rotation of the handle and shaft relative to the base to unlatch the latching member from the latch receiver to open the door of a ventilation and/or refrigeration cabinet.

Still another feature of the present invention is the provision of a handle and lock having a head portion which includes an arcuate cavity adapted to hold the arcuate locking barrier.

Still another feature of the present invention is the provision of a handle and lock having a lock which may be released by a key which elevates pins permitting rotation of the lock cylindrical with the cylindrical bore.

Still another feature of the present invention is the provision of a handle and lock having a base having a cylindrical groove adapted for receiving engagement of a gasket used to form an air tight seal between the base and the exterior surface of a door for a refrigerated cabinet.

Still another feature of the present invention is the provision of a handle and lock having a base having a transition area between a circular lip and an interior ring.

Still another feature of the present invention is the provision of a handle and lock having a roller cam engaged to the head portion of the handle.

Still another feature of the present invention is the provision of a handle and lock having a roller cam having a central aperture and a body which enhance and structural strength of the head portion of the handle.

Still another feature of the present invention is the provision of a handle and lock having a roller cam having a rotatable sleeve to facilitate the ease of use of the handle.

Still another feature of the present invention is the provision of a handle and lock having a transversely extending second bore adapted to receive the roller cam.

Still another feature of the present invention is the provision of a handle and lock having a base having a centrally position aperture and a affixation stem positioned in the aperture where the affixation stem rotatably connects the shaft to the base.

BRIEF DESCRIPTION OF THE SEVERAL VIEWS OF THE DRAWING(S)

FIG. 1 is an exploded isometric view of the handle and lock showing the handle, base, shaft, escutcheon, and latching member.

FIG. 2 is an end view of the base taken along the line 2—2 of FIG. 1.

FIG. 3 is an isometric view of the handle.

FIG. 4 is a side view of the head portion of the handle.

FIG. 5 is an end view of the head portion of the handle having a roller cam.

6

FIG. 6 is an alternative isometric view of the handle having a roller cam.

FIG. 7 is a partial cutaway view of the head portion showing the locking cylinder and extended locking barrier.

FIG. 8 is an alternative partial cutaway view of the head portion showing the locking cylinder and the retracted locking barrier.

FIG. 9 is a cross-sectional end view of the base taken along the line of 2—2 of FIG. 1.

FIG. 10 is an alternative end view of the base taken along the line of 2—2 of FIG. 1.

FIG. 11 is an alternative cross-sectional end view of the base taken along the line of 2—2 of FIG. 1.

FIG. 12 is an alternative end view of the base taken along the line of 2—2 of FIG. 1.

FIG. 13 is a rear view of the base.

DETAILED DESCRIPTION OF PREFERRED EMBODIMENT

While this invention may be embodied in many different forms, there are described in detail herein specific preferred embodiments of the invention. This description is an exemplification of the principles of the invention and is not intended to limit the invention to the particular embodiments illustrated.

One form of the handle and lock is illustrated and described herein. In general, the handle and lock is illustrated by the numeral 10. The handle and lock 10 is preferably designed for use with refrigeration units, ventilation units, ceiling and air conditioning units and/or refrigerated cabinets. The handle and lock 10 may be used to thermally insulate a refrigerated environment from ambient or heated temperature conditions within an adjacent room. The handle and lock 10 preferably prevents perspiration and/or frost from accumulating upon, or the cooling of, the handle 12 which may be undesirable to individuals. The handle and lock 10 is preferably formed of thermal insulating materials which assist to seal and prevent air flow from traversing an insulated refrigerator door. In addition, the handle and lock 10 as formed of the thermal insulating materials preferably reduces the cooling of the handle 12 and base 14 positioned adjacent to the exterior of a refrigerated cabinet. Cost and energy efficiency for a refrigerated unit is thereby enhanced. It should be noted that the handle and lock 10 is preferably adapted for either left or right handed operation or rotation at the discretion of an individual dependent upon the orientation of the base 14 relative to an insulated door.

The base 14 is preferably formed of a disk shaped housing 16 which is formed of thermally insulating material. The rear surface of the disk shaped housing 16 preferably includes a circular recessed portion 18 which is preferably adapted for receiving engagement of the rear face member 20. The rear face member 20 preferably has an elevated central portion 22 which preferably defines a circular groove 24 which is adapted for receiving engagement of a thermally insulating gasket 26. The rear face member 20, elevated central portion 22 and gasket 26 are preferably adapted for positioning adjacent to a thermally insulated door of a ventilation and/or refrigeration cabinet.

An index pin 28 preferably extends outwardly from the elevated central portion 22. The index pin 28 is preferably adapted for penetrating engagement into a hole within a refrigerated door or cabinet. The positioning of the index pin 28 within the hole prevents rotation of the base 14 relative

to the insulated door during use of the handle and lock **10**. It should be noted that the location of the index pin **28** and hole within the thermally insulated door may dictate whether the handle and lock **10** may be rotated in either a left handed or right handed manner for use by an individual.

The disk shaped housing **16** of the base **14** preferably functions as a transition area between a circular lip **30** and an interior ring **32** which is positioned proximate to the circular recessed portion **18** and rear faced member **20**.

A recessed circular working channel **34** is interior to the circular lip **30**. A centrally positioned aperture **36** preferably traverses the base **14** and the rear face member **20**.

A support stem **38** formed of thermally insulating material is preferably positioned within the centrally positioned aperture **36** through the rear faced member **20**. The support stem **38** preferably has an outwardly extending collar portion **40**. The support stem **38** is preferably adapted for rotatable engagement to a shaft **42**. The support stem **38** is preferably positioned within the centrally positioned aperture **36** and engaged to the rear faced member **20** through a press fit. The support stem **38** is also formed of the thermally insulating material which preferably functions as a thermal barrier to prevent temperature loss through the insulating door.

An arcuate shaped stop **44** is preferably positioned within the recessed circular working channel **34**. The arcuate shaped stop **44** preferably has a first end **46** and a second end **48**. The arcuate shaped stop **44** preferably functions to restrict the rotation of the shaft **42** relative to the base **14** during rotation of the handle **12** for opening of the thermally insulated door of a refrigerated cabinet or structure.

As may be seen in FIG. **1**, the shaft **42** preferably extends through the centrally positioned aperture **36** of the base **14**. The shaft **42** also preferably passes through the support stem **38** and is rotatably connected to the outwardly extending collar portion **40**.

The shaft **42** preferably includes a threaded section or end **50**, an elongate central support section **52** and a hexagonal shaped nut cap end or platform **54**. A threaded bore **56** is preferably positioned centrally within the hexagonal shaped nut cap end **54** as may be seen in FIGS. **1** and **2**. A rotational limiter **58** is preferably integral or affixed to the hexagonal shaped nut cap end or platform **54**. The rotational limiter is preferably adapted for positioning in the recessed circular working channel **34** opposite to the stop **44**. The rotational limiter **58** is preferably adapted for rotation within the working channel **34** during manipulation of the handle **12**.

The rotational limiter **58** preferably includes a third end **60** and a fourth end **62**. The rotational limiter **58** is preferably arcuate in shape and is a mirror image of the stop **44**.

The threaded bore **56** is preferably adapted to receive a threaded fastener **64** which may be utilized to affix the handle **12** to the base **14**. It should be noted that the nut cap end or platform **54** may be hexagonal, octagonal, square, triangular, and/or rectangular at the preference of an individual. It should further be noted that the rotational limiter **58** is not restricted to an arcuate shape for positioning within the working channel **34**.

During rotation of the handle **12**, the fourth end **62** of the rotational limiter **58** is preferably adapted for engagement to the first end **46** of the stop **44** to limit rotation of the handle **12** from a first position **140** which is substantially vertical, to a second position **142** which is substantially horizontal with respect to a ground or floor surface (FIGS. **9-12**). It should be noted that during rotation of the shaft **42** the base **14** via the use of the index pin **28** is maintained in a stationary position relative to a door surface. It should

further be noted that the support stem **38** and outwardly extending collar portion **40** are also maintained in a stationary position relative to a door surface during rotation of the nut cap end or platform **54**, shaft **42**, and/or rotational limiter **58** during the unlatching of a door. The stop **44** is also maintained in a stationary position following the fastening of the base **14** to a refrigerated door surface.

The rotation of the nut cap end or platform **54** causes the fourth end **62** of the rotational limiter **58** to arcuately move within the recessed working channel **34** for contact with the first end **46** of the stop **44** to limit rotation therebetween. The engagement between the fourth end **62** and the first end **46** of the stop **44** preferably defines the second position **142** for the handle **12** permitting release of the latch **66** from a latch receiver **68** which may be integral or affixed to the interior door frame for a refrigerated cabinet and/or structure.

The handle **12**, head portion **70**, and/or grasping portion **72** are preferably formed of thermally insulating material designed to resist heat or cold transfer through the shaft **42** and base **14** to the handle **12**.

As may be seen in FIGS. **1, 3, 4, 5, and 6**, the handle **12** preferably includes a head portion or end **70** and a grasping portion or end **72**. A central aperture **74** preferably traverses the head portion **70** in a direction normal to the centrally positioned aperture **36** and is adapted for alignment therewith. The central aperture **74** is preferably adapted for receiving engagement of the threaded fastener **64** used for affixation of the head portion or end **70** to the base **14**. It should be noted that the threaded fastener **64** is preferably adapted for passing through the central aperture **74** and into the threaded bore **56** to affix the head portion **70** to the base **14**.

The head portion or end **70** preferably includes a front face **76**. The front face **76** preferably includes a nut or hex shaped receiving area **78** which is preferably adapted to cover the hexagonal shaped nut cap end or platform **54** (FIG. **3**). Proximate to the top of the front face **76** is preferably located an arcuate shaped protruding positioning member **80** which is preferably adapted for penetrating placement within the working channel **34** between the stop **44** and the rotational limiter **58**. The protruding positioning member **80** preferably includes a fifth end **82** and a sixth end **84**.

The arcuate shaped protruding positioning member **80** is preferably adapted for rotational movement within the working channel **34** during rotation of the grasping portion **72** from the first position **140** to the second position **142** (FIGS. **9-12**).

The head portion **70** may further include a lock bore **86** which is preferably designed for receiving engagement of a locking cylinder **88**. The lock bore **86** preferably extends normally to the direction of the central aperture **74** and is positioned between the central aperture **74** and the grasping portion **72** of the handle **12**.

The head portion **70** further includes an arcuate lock cavity **90** which is in communication with the lock bore **86**. An arcuate locking barrier **92** is preferably disposed in the lock cavity **90** and is in communication with the lock bore **86** for locking of the handle **12** in a first position **140** relative to the base **14** during periods of non-use.

A traverse bore **94** may be provided to extend through the head portion **70** perpendicular to the central aperture **74**. The traverse bore **94** preferably crosses the central aperture **74** and is adapted to receive a roller cam **96** which may be rotatably affixed to the head portion **70** via the use of a fastener **98**.

An escutcheon **100** is preferably affixed to the threaded section or end **50** of the shaft **42**. The escutcheon **100** is

preferably formed of thermal insulating material which prevents the transfer of cooled air through the shaft from the interior of a refrigerated compartment.

The escutcheon **100** is preferably formed of a disk portion **102** having a face. A cylindrical stem portion **106** preferably extends outwardly from the face. The cylindrical stem portion **106** includes a central opening adapted for receiving engagement of the shaft **42**.

A disk shaped affixation face **112** having a plurality of graspers and/or fingers **114** is preferably press fit to the disk portion **102**. Alternatively, the disk shaped affixation face **112** may be snap fit within the disk portion **102** at the preference of an individual.

The disk shaped affixation face **112** preferably has a centrally positioned opening which is aligned with the opening through the cylindrical stem portion **106** for passing engagement of the shaft **42** therethrough.

The escutcheon **100** is preferably affixed to the shaft **42** between the interior of a door and the latch member **66**. The graspers and/or fingers **114** of the disk shaped affixation face **112** are preferably lockingly engaged to the threads of the threaded section **50** of the shaft **42** to prevent separation therebetween. The cylindrical stem portion **106** of the escutcheon **100** is preferably adapted for positioning within the opening which traverses a thermally insulated door for positioning of the face adjacent to the interior door surface. The use of the escutcheon **100** preferably creates a thermal block and/or barrier between the interior of the door and shaft **42** which promotes the insulating properties of the handle and lock **10** to thermally insulate a refrigerated compartment. The use of the escutcheon **100** upon the shaft **42** preferably prevents heat transfer along the shaft **42** reducing condensation or frost upon the handle **12**. Further, the use of the escutcheon **100** as affixed to the shaft **42** preferably minimizes and/or prevents the leaking of air through the opening traversing an insulated thermal door and in conjunction with the base **14** prevents the exit of cooled air from the interior of a refrigerated structure.

Again referring to FIG. 1, the latch member **66** may be secured to the threaded section **50** of the shaft **42** via the use of one or more nuts **116**. The latch member **66** may be formed of a bracket **118** which may be L-shaped or any other shape as preferred by an individual. The latch member **66** may include a roller cam **120** which may be rotatably secured to a bracket **118** via the use of a fastener. The latch member **66**, bracket **118** and roller cam **120** are preferably securely engaged to the shaft **42** where rotation of the handle **12** causes the elevation of the latch member **66** upwardly for unlatching of a keeper and/or latch receiver which may be affixed to or is integral with the interior door frame of a thermally insulated door. The rotation of the handle **12** and the disengagement between the latch member **66** and the keeper and/or latch receiver permits opening of a thermally insulated door to provide access into a refrigerated cabinet.

As may be seen in FIGS. 7 and 8, a lock **122** is depicted as positioned within the lock bore **86**. The lock **122** is preferably formed of a locking cylinder **88** which may be operated by a key **124**. Rotation of the key **124** preferably elevates locking pins (not shown) permitting rotation of a locking shaft **126**. The locking shaft **126** preferably includes a worm gear **128** which rotates as the key **124** is manipulated. The lock **122**, and locking cylinder **88** are preferably disposed within the lock bore **86**.

The arcuate locking barrier **92** is preferably disposed within the lock cavity **90** adjacent to the locking shaft **126** and worm gear **128**. The arcuate locking barrier **92** prefer-

ably includes a plurality of teeth **130** which are coupled to the worm gear **128**. The rotation of the key **124** thereby provides for the linear positioning of the arcuate locking barrier **92** into and out of the lock cavity **90** and into or out of the circular working channel **34** when the head portion **70** is affixed to the base **14**.

The arcuate locking barrier **92** is preferably positioned within the working channel **34** opposite to the protruding positioning member **80** between the stop **44** and the rotational limiter **58**. The arcuate locking barrier **92** as positioned within the working channel **34** prevents rotation of the protruding positioning member **80** and rotational limiter **58** within the working channel **34** thereby fixedly positioning the handle **12** relative to the base **14**. The manipulation of the key **124** and locking cylinder **88** preferably retract the arcuate locking barrier as depicted by arrow **132** of FIG. 8 into the lock cavity **90** permitting rotation of the protruding positioning member **80** and rotational limiter **58** within the working channel **34** to permit elevation of the handle **12** to unlatch the latch member **66** from the keeper/receiver for opening of a thermally insulated door.

Rotation of the key **124** causes the worm gear **128** to rotate and to retract the linear sliding arcuate locking barrier **92** from the working channel **34** into the lock cavity **90** which in turn permits rotation of the handle **12**, nut shaped platform **54**, arcuate protruding positioning member **80**, rotational limiter **58**, and shaft **42** for unlatching of a thermally insulated door.

The locking barrier **92** may be securely positioned within the lock cavity **90** by any preferred means including but not limited to the use of fasteners and/or snaps. The lock cavity **90** is preferably positioned above the lock bore **86** proximate to the front face **76** of the head portion **70**. The locking barrier **92** may include a first rotational restrictor to prevent outward separation of the teeth **130** from the worm gear **128** and the separation of the locking barrier **92** from the lock cavity **90**. In addition, the locking barrier **92** may include a second rotational restrictor to limit the retraction of the locking barrier **92** within the lock cavity **90** where the forward surface of the locking barrier **92** is flushly aligned with the front face **76** as depicted in FIG. 8. As depicted in FIG. 9, the locking barrier **92** preferably extends forwardly approximately the same distance as the protruding positioning member **80** for insertion into the working channel **34**.

As may be seen in FIGS. 1 and 6, a roller cam **96** may be engaged to head portion **70** or to the latch member **66** at the preference of an individual. In general, the roller cam **96** is mounted upon either the head portion **70** or latch **66** via the use of a fastener **98**. The roller cam **96** may also include a sleeve member **134** which may freely rotate relative to the fastener **98** at the preference of an individual. The roller cam **96** as secured to the head portion **70** preferably facilitates the manipulation of the handle **12** between the first latch position **140** and the second unlatched position **142** during the opening of a thermally insulated door. The roller cam **96** as affixed to the latch **66** preferably facilitates the engagement and disengagement of the latch **66** to the latch receiver **68** during the latching and/or release of the thermally insulated door from the interior door frame of a refrigerated compartment.

It should be noted that the roller cam **96** may be attached to either the head portion **70** and/or the latch member **66** by any means as preferred by an individual. It should further be noted that the fastener **98** used to secure the roller cam **96** to the head portion **70** preferably does not extend through the centrally positioned aperture **36** for interference with the

11

fastener 64 used to attach the handle 12 to the base 14. Alternatively, the fastener 98 may include an opening which will permit the passing of the fastener 64 through the handle 12, centrally positioned aperture 36, and base 14 when the roller cam fastener 98 is secured to the head portion 70.

In an alternative embodiment, the exterior surface of a thermally insulated door may include a padlock bracket having an aperture which is adapted for positioning adjacent to a padlock tab which may be affixed, or may be integral to, the head portion 70 of the handle 12. The alignment between the aperture of the padlock tab and the padlock bracket may permit the use of a secondary padlock for affixation of the handle 12 in the first lock position to securely seal the thermally insulated door for a refrigerated compartment.

As depicted in FIG. 1, a plug cap 136 may be used for placement over the exterior end of the fastener 64 and insertion within the distal end of the centrally positioned aperture 74, 36 to provide a flush rearward surface for the head portion 70. The use of the plug cap 136 may also reduce the risk of tampering and/or the undesirable separation of the head portion 70 from the base 14. The plug cap 36 may include one or more penetrating affixation tabs which may be utilized to permanently attach the plug cap 136 within the centrally positioned aperture 74, 36 following assembly of the handle and lock 10.

Referring to FIGS. 9–12, the interaction between the handle 12 and the base 14 is shown. Referring to FIG. 9, the left handed operation of the handle and lock 10 is shown. The base 14 is depicted where the index pin 28 is positioned at a compass location of approximately 270° where the handle 12 is positioned downwardly. The first position 140 of the handle 12 is shown. In this configuration, the stop 44 is depicted proximate to the index pin 28 where the first end 46 is positioned downwardly relative to the second end 48. Opposite to the stop 44 is preferably located the rotational limiter 58. The fourth end 62 of the rotational limiter 58 is preferably positioned downwardly with respect to the third end 60. Between the second end 48 and the third end 60 is preferably located the protruding positioning member 80 where the fifth end 82 is adjacent to the second end 48 and the sixth end 84 is adjacent to the third end 60. The locking barrier 92 has been retracted from a position between the first end 46 and the fourth end 62 within the working channel 34.

Directional arrow 144 of FIG. 9 represents the rotational elevation of the handle 12 upwardly towards the left from a vertical orientation of the first position 140 to a perpendicular horizontal second position 142 for release of the latch 66 from the latch receiver 68 for the opening of a thermally insulated door from the door frame for a refrigerated compartment. It should be noted that the rotation of the handle 12 as indicated by directional arrow 144 may only occur upon the retraction of the locking barrier 92 from the working channel 34 as earlier described. In the second position 142 as indicated in FIG. 10, the protruding positioning member 80 as integral to the handle 12 and the rotational limiter 58 as integral to the nut cap end 54 of the shaft 42 have been rotated within the working channel 34 towards the stop 44. In the second position 142 the fourth end 62 of the rotation limiter 58 is adjacent to the first end 46 of the stop 44. The sixth end 84 of the positioning member 80 is adjacent to the third end 60 of the rotational limiter and a space has been provided between the second end 48 of the stop 44 and the fifth end 82 of the positioning member 80.

As may be seen in FIGS. 11 and 12, the right handed operation of the handle and lock 10 is depicted. In FIG. 11,

12

the index pin 28 is preferably positioned at a compass location of approximately 90° where the handle 12 is downward for right handed operation. FIG. 11 represents the handle 12 positioned in the first position 140 relative to the base 14. In this configuration the stop 44 is proximate to the index pin 28 where the first end 46 is positioned above the second end 48. Opposite to the stop 44 is preferably located the rotation limiter 58 where the fourth end 62 of the rotation limiter 58 is above the third end 60. The protruding positioning member 80 is disposed between the first end 46 and the fourth end 62. It should be noted that the fifth end 82 of the positioning member 80 is proximate to the fourth end 62 of the rotation limiter and the sixth end 84 of the positioning member 82 is proximate to the first end 46 of the stop 44. Upon the retraction of the locking barrier 92 within the lock cavity 90, rotation of the handle 12 relative to the base 14 may occur as indicated by directional arrow 146.

The rotation of the handle 12 upwardly from vertical to the right from the first position 140 to the perpendicular horizontal second position 142 preferably in turn releases the latch 66 from the latch receiver 68 permitting the thermally insulated door to be opened relative to a door frame of a refrigerated compartment. Upon acquisition of the second position 142 the relative locations of the stop 44, rotation limiter 58 and protruding positioning member 80 are depicted in FIG. 12. In this configuration the third end 60 of the rotation limiter 58 is adjacent to the second end 48 of the stop 44. In addition, the fifth end 82 of the positioning member 80 is adjacent to the fourth end 62 of the rotation limiter 58. Further, an opening has been established within the working channel 34 between the sixth end 84 of the positioning member 80 and the first end 46 of the stop 44.

It should therefore be noted that the handle and lock 10 as illustrated and described herein may be easily adaptable for either right handed or left handed use dependent upon the positioning of the index pin 28 relative to the exterior surface of a thermally insulated door for a ventilation and/or refrigeration compartment. An individual may easily position the index pin at either the 90° or 270° direction relative to the exterior of a thermally insulated door to enable right handed or left handed operation of the handle 12 at the discretion of an individual.

The above Examples and disclosure are intended to be illustrative and not exhaustive. These examples and description will suggest many variations and alternatives to one of ordinary skill in this art. All these alternatives and variations are intended to be included within the scope of the attached claims. Those familiar with the art may recognize other equivalents to the specific embodiments described herein which equivalents are also intended to be encompassed by the claims attached hereto.

What is claimed is:

1. A latch assembly adapted for attachment to a door in a door frame, the latch assembly comprising:
 - a) a base having a recessed working channel, an aperture, and a stop positioned in the working channel;
 - b) a shaft extending through the aperture, said shaft having a rotational limiter, said rotational limiter being positioned in said working channel said stop being separated from said rotational limiter within said working channel; and
 - c) a handle fixed to the shaft whereby the handle and shaft are at least partially rotatable with respect to the base between a first position and a second position, the handle being connected to the shaft, the handle having a grasping portion and a protruding positioning mem-

13

ber said protruding positioning member constructed for movement between said stop and said rotational limiter.

2. The latch assembly of claim 1, said shaft comprising a nut cap end.

3. The latch assembly of claim 2, said handle comprising a head portion connecting to the shaft.

4. The latch assembly of claim 3, wherein said grasping portion extends from said head portion, the head portion configured for engagement with the base.

5. The latch assembly of claim 4, the head portion comprising a nut receiving area, the nut receiving area adapted for positioning over the nut cap end.

6. The latch assembly of claim 5, said stop comprising a first end and a second end wherein the stop is fixedly positioned within said working channel.

7. The latch assembly of claim 6, said rotational limiter comprising a third end and a fourth end, said fourth end being adapted to engage said first end of said stop during rotation of said handle from said first position to said second position.

8. The latch assembly according to claim 7, said protruding positioning member comprising a fifth end and a sixth end.

9. The latch assembly according to claim 8, wherein said fifth end is adapted to engage said second end and said sixth end is adapted to engage said third end when said handle is at said first position.

10. The latch assembly according to claim 8, wherein said fifth end engages said second end and said fourth end engages said first end when said handle is at said second position.

14

11. The latch assembly according to claim 7, wherein said protruding positioning member is adapted for positioning in said working channel between said second end and said third end.

12. The latch assembly of claim 5, said base further comprising a support stem positioned in said aperture.

13. The latch assembly of claim 12, said base further comprising an index pin extending from said base.

14. The latch assembly of claim 12, wherein said shaft is rotatably engaged to said support stem.

15. The latch assembly of claim 5, wherein said stop is arcuate in shape.

16. The latch assembly according to claim 3, said handle further comprising a lock bore through said head portion.

17. The latch assembly of claim 2, wherein said rotational limiter is integral to said nut cap end.

18. The latch assembly of claim 1, wherein said stop and said rotational limiter are disposed at substantially opposite locations within said working channel.

19. The latch assembly of claim 1, wherein said protruding positioning member is arcuate in shape.

20. The latch assembly according to claim 1, further comprising an escutcheon engaged to said shaft.

21. The latch assembly according to claim 20, said escutcheon comprising; a plurality of graspers adapted to engage said shaft.

* * * * *