



US006266981B1

(12) **United States Patent**  
von Resch et al.

(10) **Patent No.:** **US 6,266,981 B1**  
(45) **Date of Patent:** **Jul. 31, 2001**

(54) **LOCK, IN PARTICULAR MORTISE LOCK FOR AN EXTERIOR DOOR**

(75) Inventors: **Julius von Resch**, Stuttgart; **Walter Renz**, Ditzingen; **Daniel Gründler**, Leonberg; **Udo Dieners**, Besigheim/Ottmarsheim, all of (DE)

(73) Assignee: **Gretsch-Unitas GmbH**, Ditzingen (DE)

(\* ) Notice: Subject to any disclaimer, the term of this patent is extended or adjusted under 35 U.S.C. 154(b) by 0 days.

(21) Appl. No.: **09/073,193**

(22) Filed: **May 6, 1998**

(30) **Foreign Application Priority Data**

Nov. 5, 1997 (DE) ..... 297 19 611

(51) **Int. Cl.<sup>7</sup>** ..... **E05B 59/00**

(52) **U.S. Cl.** ..... **70/107; 70/110; 292/34**

(58) **Field of Search** ..... **70/107, 108, 110, 70/111; 292/34, 36, 40, 336.3, 336.5, 165**

(56) **References Cited**

**U.S. PATENT DOCUMENTS**

1,290,439 \* 1/1919 Weller ..... 70/107  
4,011,741 \* 3/1977 Nolin ..... 70/107

4,578,967 \* 4/1986 Yu ..... 70/107  
4,606,203 \* 8/1986 Esser ..... 70/107  
4,870,841 \* 10/1989 Cudd ..... 70/107  
5,027,625 \* 7/1991 Krachten ..... 70/107  
5,301,525 \* 4/1994 Doring ..... 70/107  
5,813,255 \* 9/1998 Tell, III et al. .... 70/107  
5,819,562 \* 10/1998 Christ ..... 70/107  
5,878,605 \* 3/1999 Renz ..... 70/107

**FOREIGN PATENT DOCUMENTS**

8902020 \* 3/1989 (WO) ..... 70/107

\* cited by examiner

*Primary Examiner*—Suzanne Dino Barrett

(74) *Attorney, Agent, or Firm*—Jones, Tullar & Cooper, P.C.

(57) **ABSTRACT**

A lock for a door including a latch bolt and a further bolt mounted in a housing for parallel displacement relative to the housing. A bearing is fixed in place in the housing and along with a turning element and a two-armed hinged lever, also mounted to the housing operate on the latch bolt and the further bolt. The two arms of the two-armed hinged lever are pivotably connected with each other at their free ends with one of the arms receiving the fixed bearing between its ends, and with one of the arms being connected to the turning element and the other of its arms being connected to the further bolt.

**21 Claims, 9 Drawing Sheets**

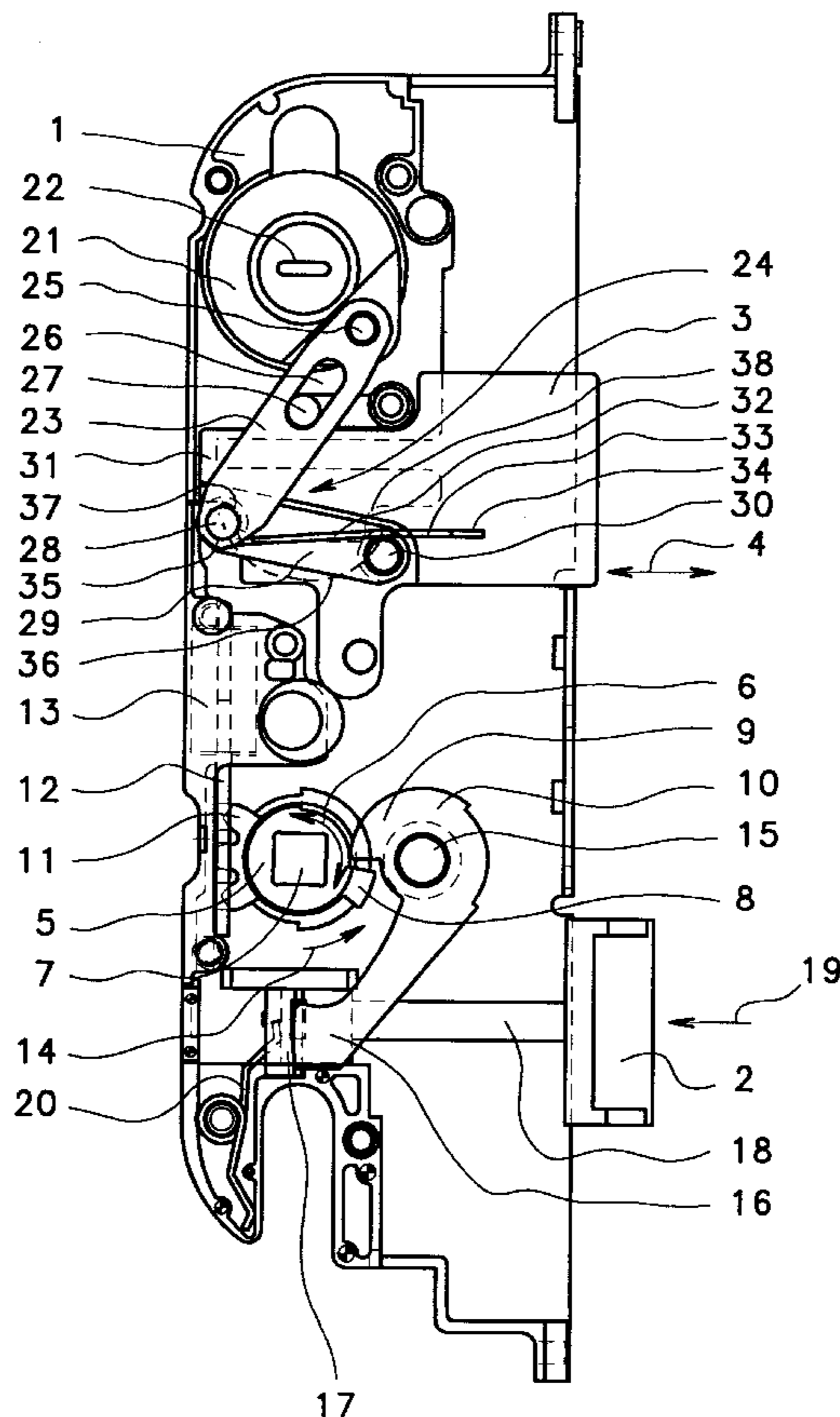

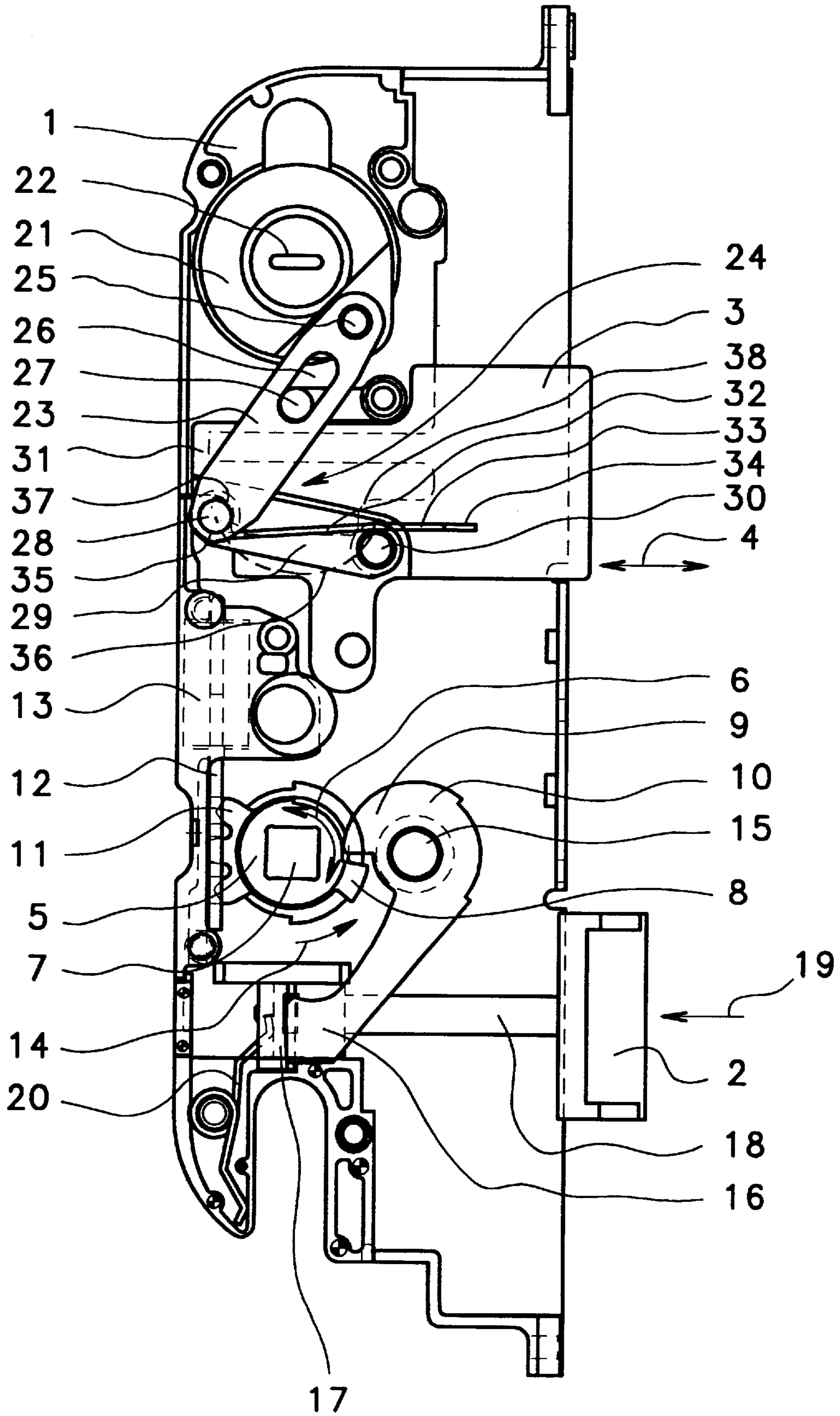
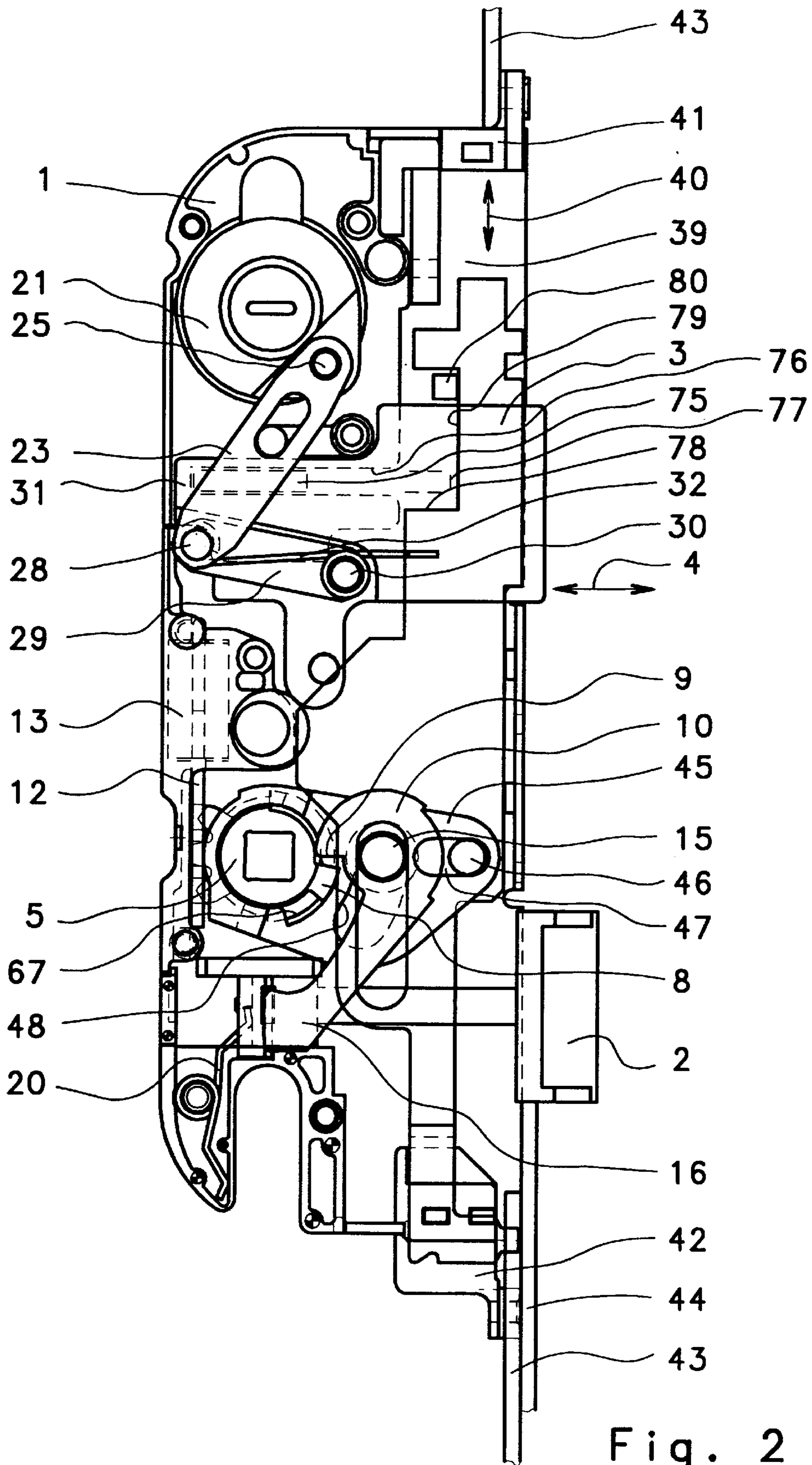

Fig. 1



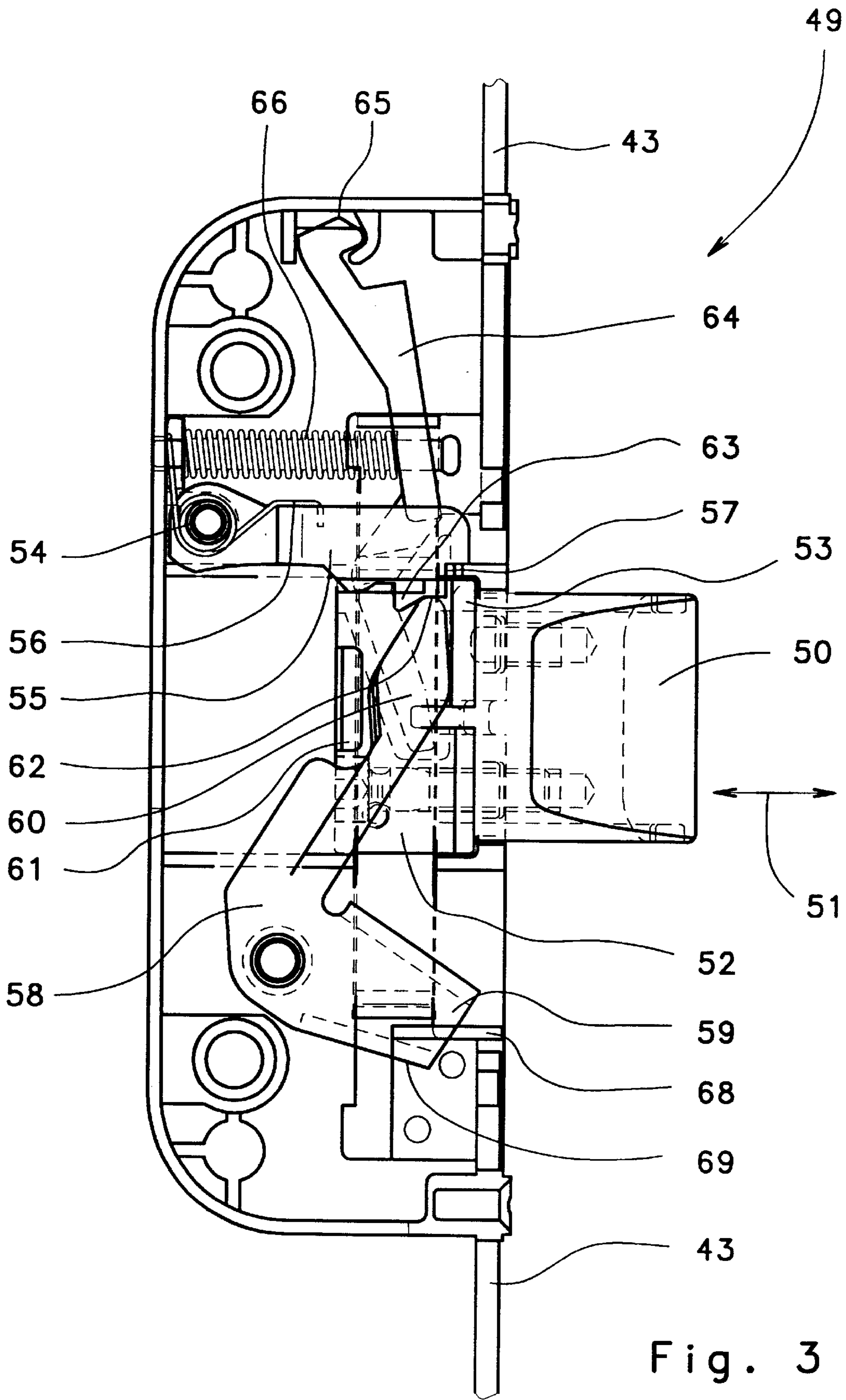

Fig. 3

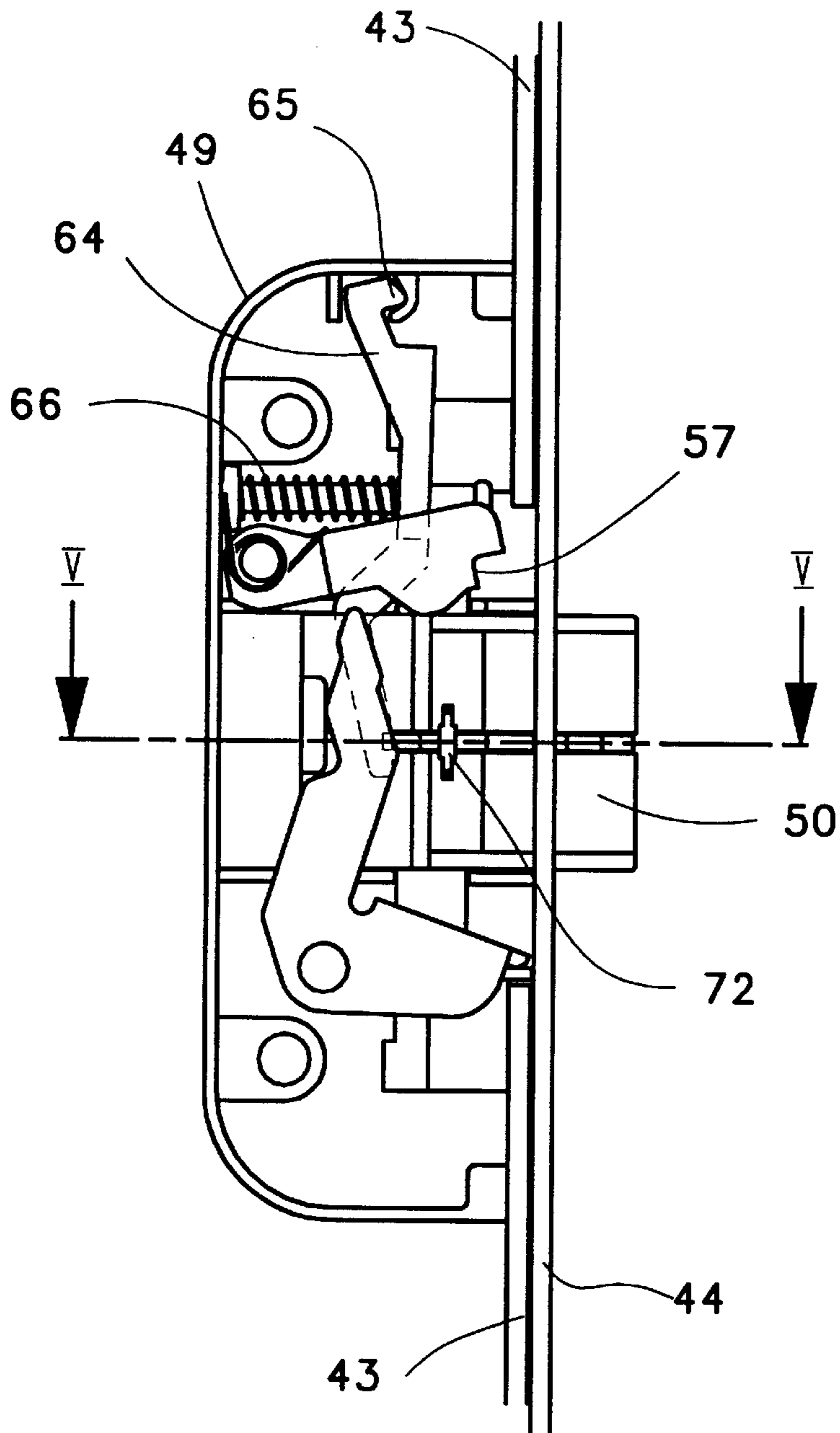

Fig. 4

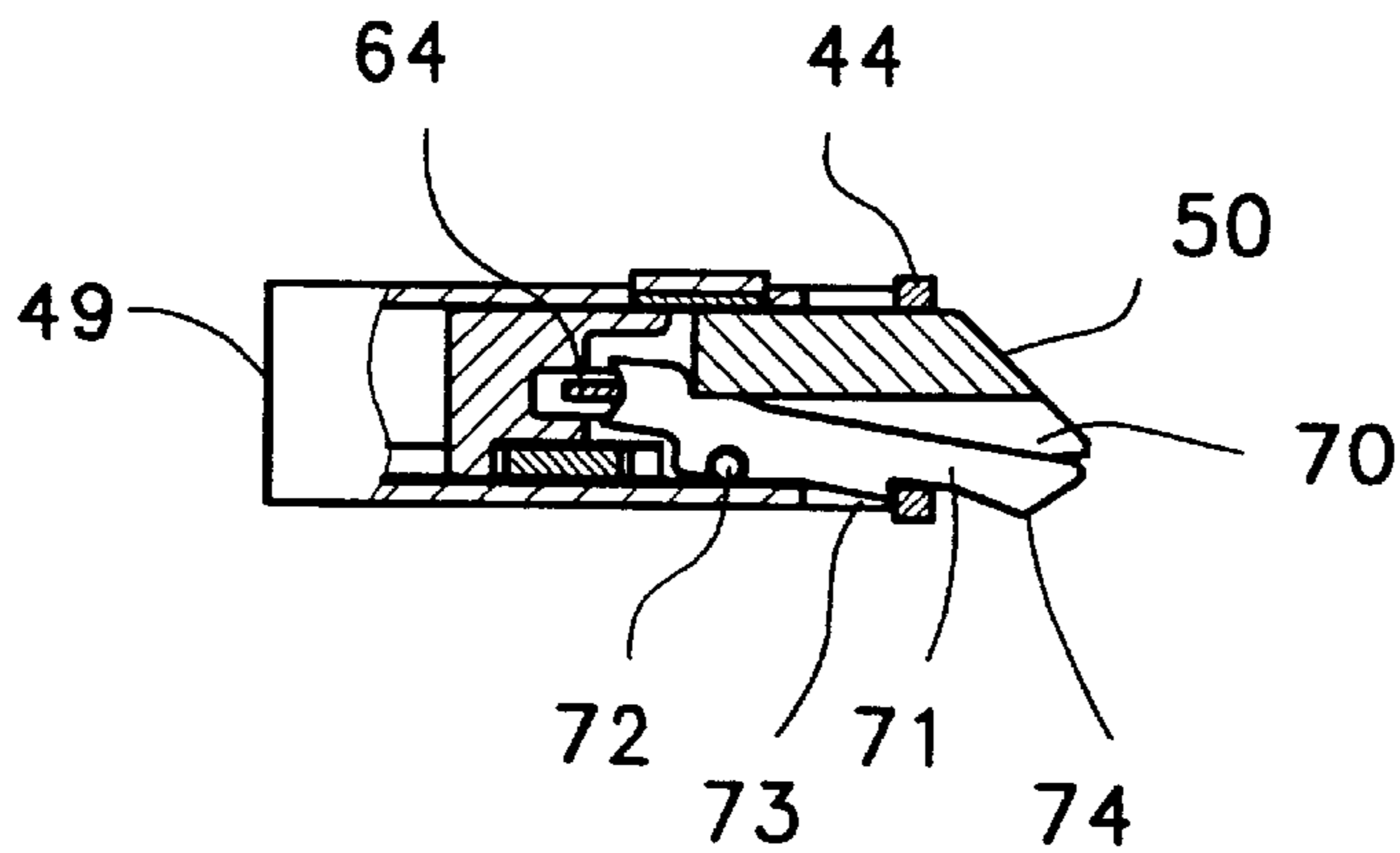

Fig. 5

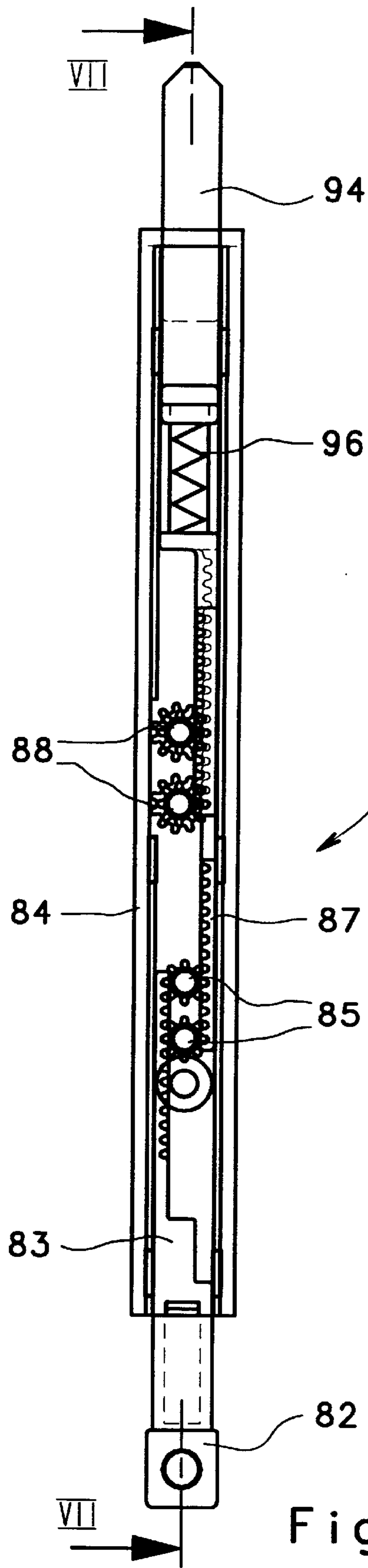

Fig. 6

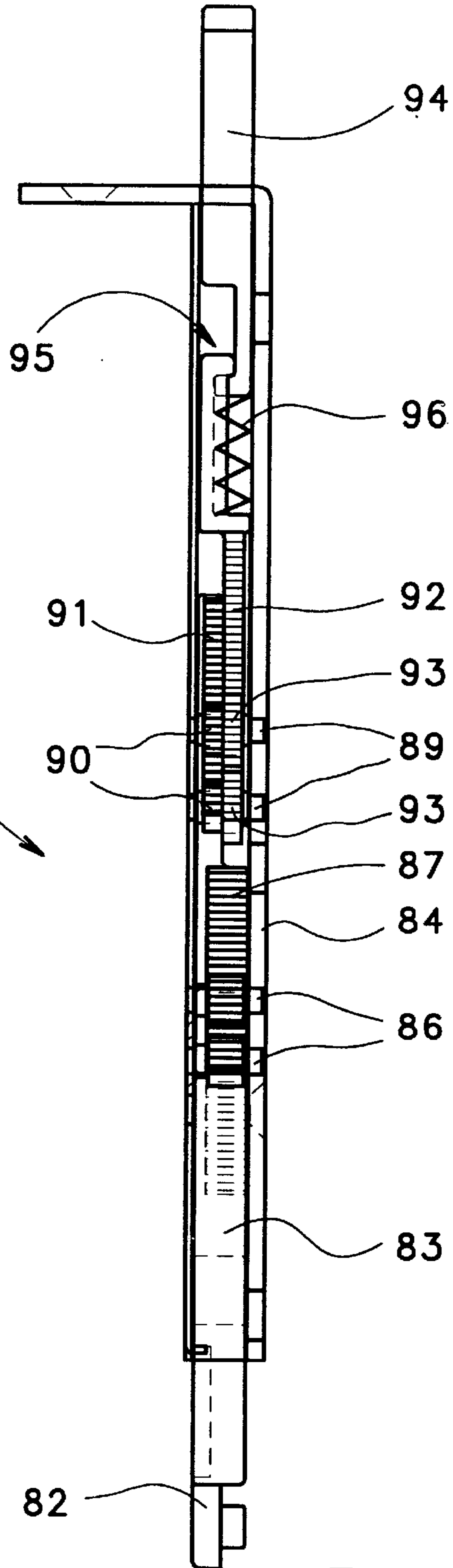

Fig. 7

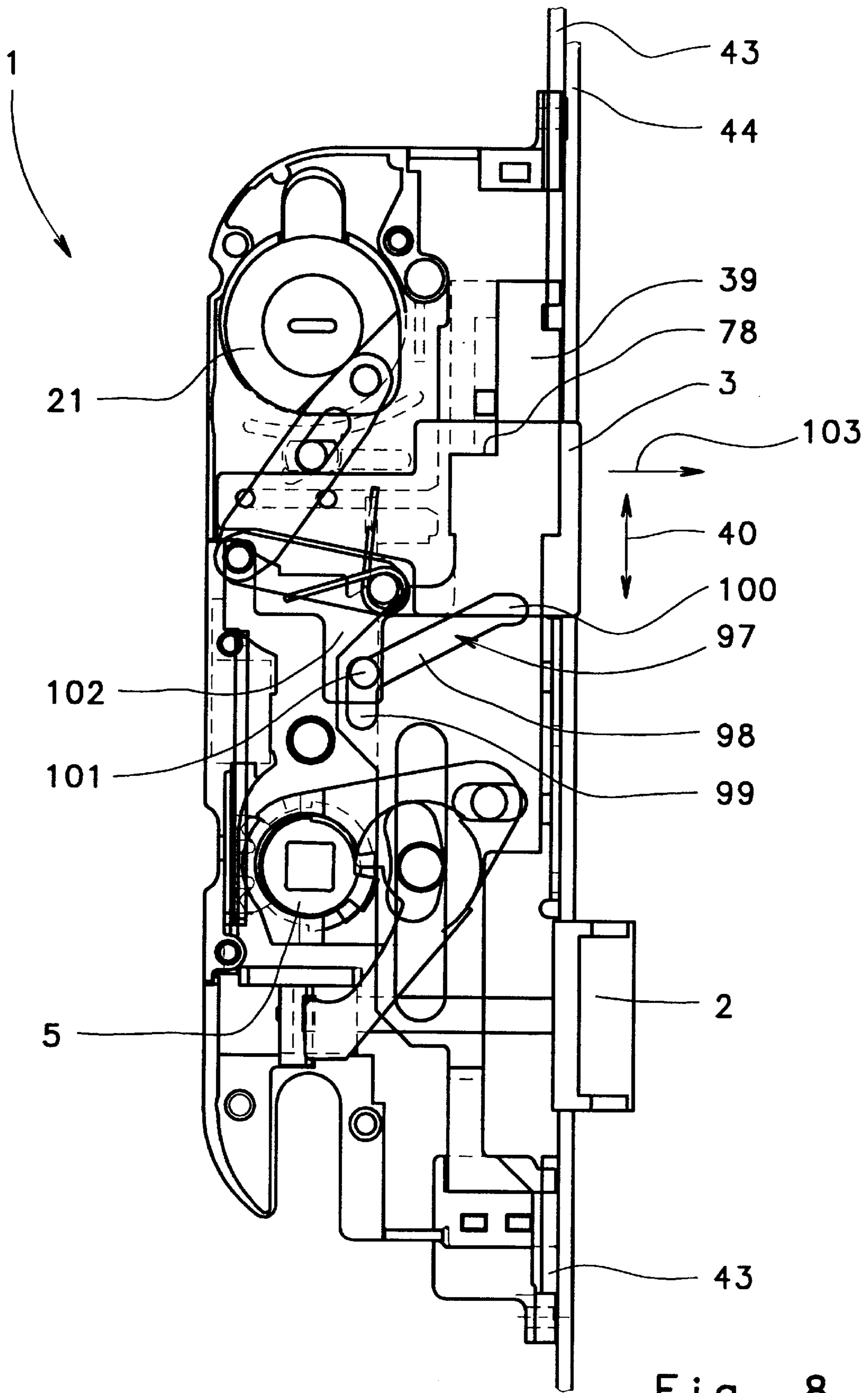

Fig. 8

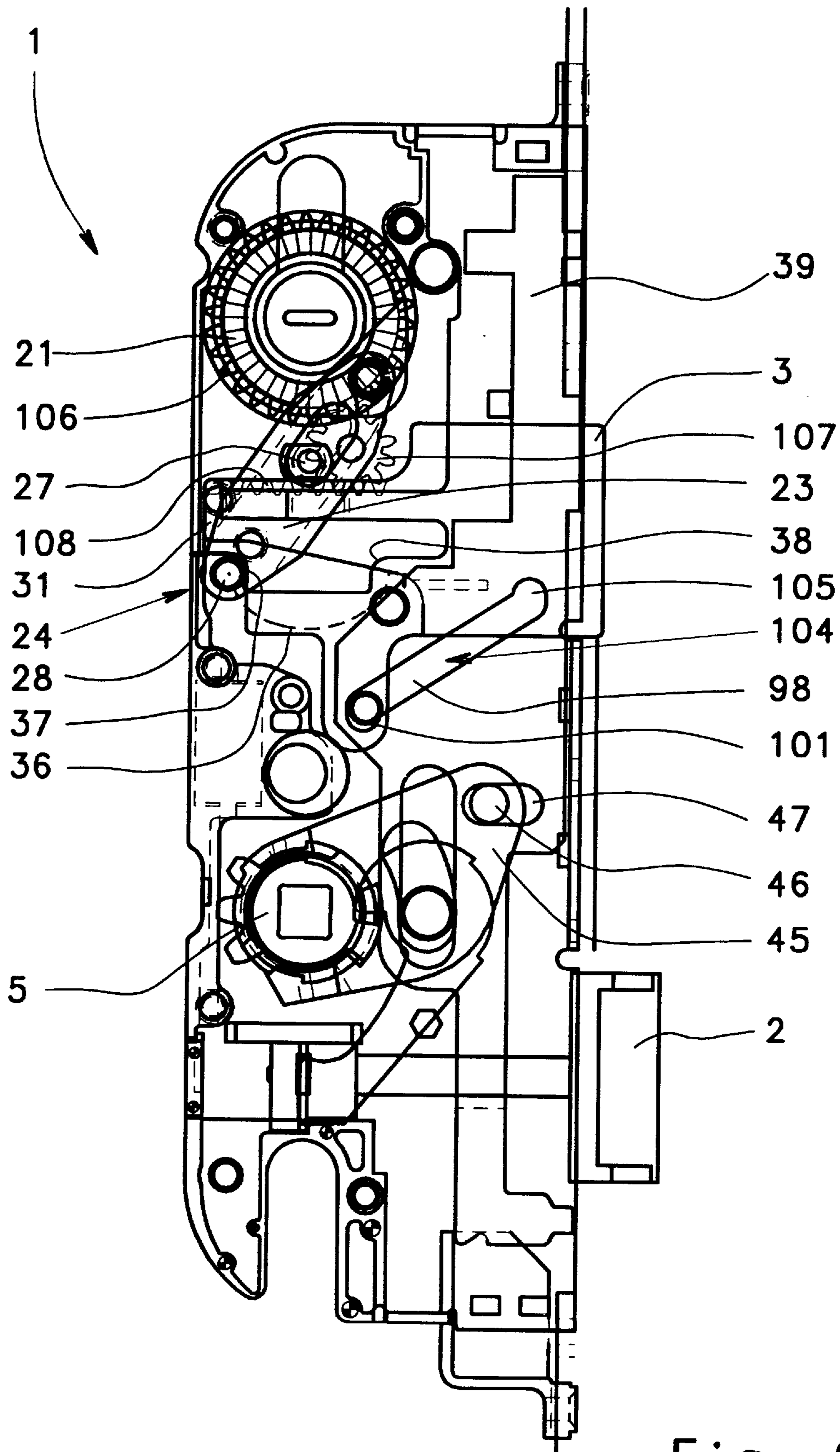

Fig. 9



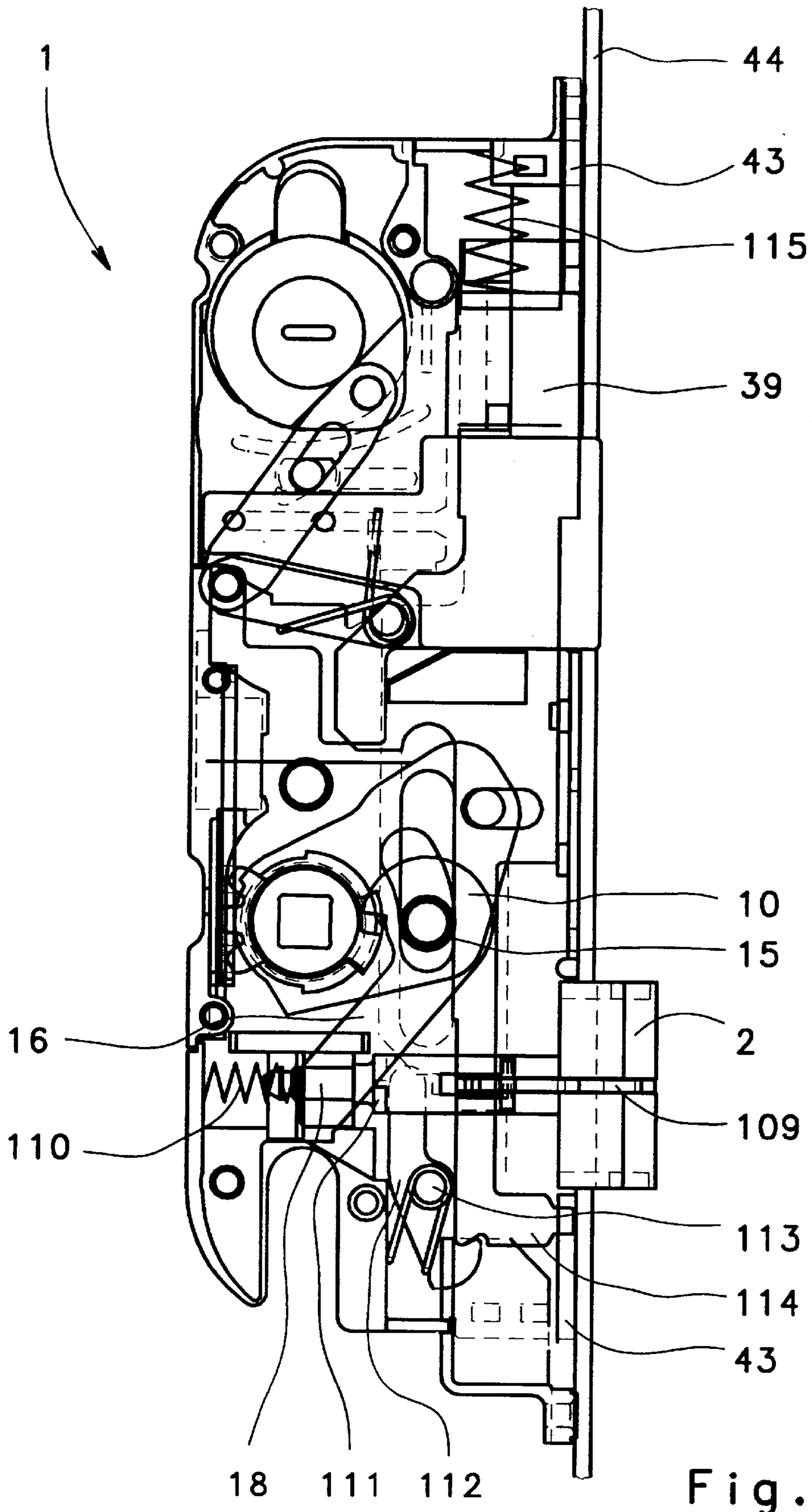

Fig. 10

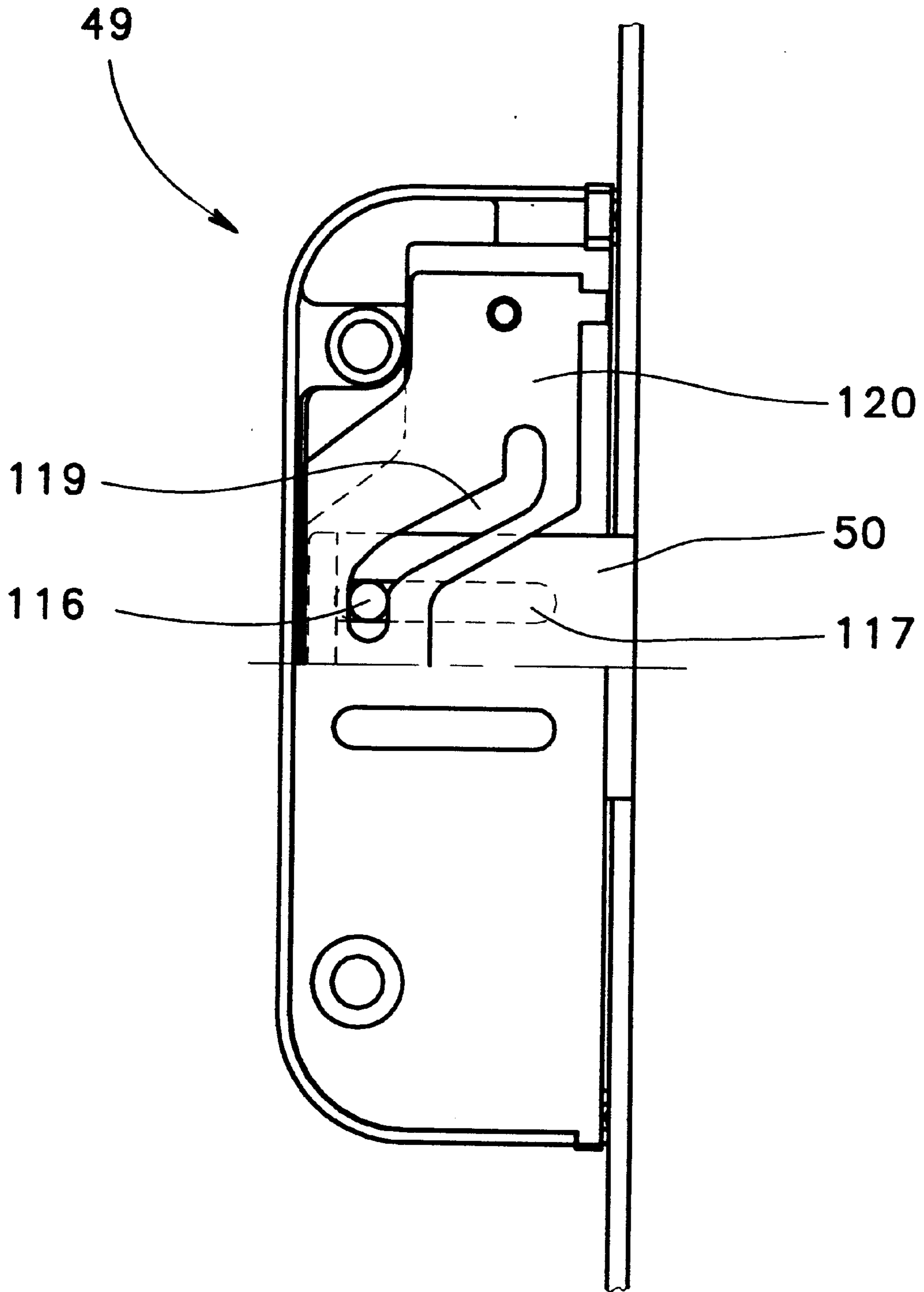

Fig. 11

## LOCK, IN PARTICULAR MORTISE LOCK FOR AN EXTERIOR DOOR

### FIELD OF THE INVENTION

The present invention relates to a lock, and in particular a mortise lock for an exterior door. The door has a latch bolt and a further bolt located displaceably parallel with each other in a housing, wherein the further bolt can be operated by means of a key and/or a turning knob, and the latch bolt can be selectively operated by means of a latch with a follower or by means of a key or by means of a turning knob.

### BACKGROUND OF THE INVENTION

A lock for an exterior door is known from German Patent Publication DE 92 08 526 U1. This known lock has a latch bolt which can be retracted into the lock housing by means of a follower on which the latch is fastened. A further bolt is located underneath the latch bolt, which can be unlocked from the lock housing by means of a profiled cylinder. In addition, the profiled cylinder can be pulled into the latch bolt by means of a changer. Such a lock was developed for the German, or the European market.

American locks have the peculiarity that, as a rule, the latch with the follower and latch bolt are arranged at the bottom and the further bolt at the top in the lock housing. Furthermore, as a rule the further bolt is operated by means of a key on the one side and a turning knob on the other side. Such locks have properties which are comparable with the locks mentioned at the outset. However, it is not possible to couple connecting rods with such locks, by means of which supplemental lock boxes, or respectively supplemental bolts are attached, through which the resistance of the door to break-ins could be increased.

### OBJECT AND SUMMARY OF THE INVENTION

It is therefore an object of the present invention to provide the lock mentioned at the outset that meets the requirements of the American market and can be used in the same way as American locks, and that furthermore as many components as possible can be taken over, or respectively only small changes need to be made.

This object is attained in accordance with the present invention in that the further bolt is connected via a two-armed hinged lever with a turning element actuated by the key or turning knob, that one arm of the hinged lever is pivotably coupled with the turning element and the other arm pivotably with the further bolt, and that the two arms are pivotably connected with each other with their free ends, wherein one arm is rotatably and, if required displaceably, seated between its ends on a bearing fixed in place in the housing.

By means of this embodiment in accordance with the present invention a lock, which is based on the features of a European mortise lock, is made available for the American market. It is therefore possible to use a mortise lock having a known lock housing, known, for example, from German Patent Publication DE 92 08 526 U1. This lock is merely turned over, so that the latch bolt is at the bottom and the further bolt at the top. In order to obtain a correct turning direction for turning the further bolt forward, i.e. for extending it, with this turned-over lock, a reversal of the direction of turning is created by means of a hinged lever. The key, or respectively the turning knob, drives a first hinge arm of the hinged lever, which is pivotably fastened on the rotating element and can be rotated around a shaft fixed in place in

the housing. A reversal of the turning direction is created in this way, which is transferred by the other end of this pivot arm to a second pivot arm, which acts on the further bolt and extends it out of the lock housing. With the lock in accordance with the present invention, the further bolt is extended in that the turning element is turned either by the lock or by the turning knob in the conventional direction, i.e. in that the upper half of the key, or respectively of the turning knob is turned in the locking direction. Such a mortise lock can also be connected with a connecting rod.

Further advantages, characteristics and details of the present invention ensue from the following description, wherein several exemplary embodiments are described in detail, making reference to the drawings. The features represented in the drawings as well as in the specification can be essential to the present invention both individually per se and in any arbitrary combination.

### BRIEF DESCRIPTION OF THE DRAWINGS

FIG. 1 is a top view of a first embodiment of a lock according to the present invention with the housing cover removed;

FIG. 2 is a top view of a second embodiment of a lock according to the present invention with the housing cover removed;

FIG. 3 is a top view of an enlarged representation of a supplemental bolt lock with the housing cover removed;

FIG. 4 is a top view of a further embodiment of a supplemental bolt lock with the housing cover removed;

FIG. 5 shows a section V—V through the supplemental bolt lock in accordance with FIG. 4;

FIG. 6 is a longitudinal section through a connecting rod extender with a gear;

FIG. 7 is a section taken along lines VII—VII through the connecting rod extender in accordance with FIG. 6;

FIG. 8 is a top view of a third embodiment of a lock according to present invention with the housing cover removed;

FIG. 9 is a top view of a fourth embodiment of a lock according to the present invention with the housing cover removed;

FIG. 10 is a top view of a fifth embodiment of a lock according to the present invention with the housing cover removed; and

FIG. 11 is a top view of a further supplemental bolt lock according to the present invention, partially in section.

### DETAILED DESCRIPTION OF THE PREFERRED EMBODIMENTS

A lock housing, identified as a whole by 1 and with the cover removed, is shown in FIG. 1. A latch bolt 2 and a further bolt 3 in the interior of the housing can be displaced in the direction of the double-headed arrow 4. Furthermore, a follower 5 is seated, rotatable in the direction of the double-headed arrow 6, in the lock housing 1. The follower 5 has an opening 7, in particular a square opening, for receiving a square pin of a latch or similar actuating element. A radially extending shoulder 8 of the follower 5 is located underneath a protrusion 9 of a latch bolt arm 10, by means of which the latch can be turned back. Furthermore, the follower 5 has a partial gear ring 11, which engages a toothed rack 12, which is held in the standby position represented in FIG. 1 by means of a restoring spring, not shown, located in a spring housing 13. The toothed rack 12

can be displaced in both directions from this standby position. If therefore the follower **5** is turned in the direction of the arrow **14**, this causes a compression of the restoring spring on the one hand and, on the other, the shoulder **8** comes to rest against the protrusion **9** of the latch bolt arm **10** and pivots the latter in a clockwise direction around a bearing **15**. By means of this action an actuating arm **16** is displaced and engages a shoulder **17** of a latch bolt tail **18**. This causes the latch bolt **2** to be turned back into the lock housing **1** in the direction of the arrow **19**. The extension of the latch bolt **2** after the latch has been released and after the restoration of the follower **5** by means of the restoring spring, not shown, is aided by a torsion spring **20**, which is supported on the one side on the lock housing **1**, and acts on the shoulder **17** with the other leg and pushes the latch bolt **2** out of the lock housing **1**. In this case the extension movement is approximately 10 mm.

Furthermore, a turning element **21** is rotatably seated in the lock housing **1**, wherein the turning element **21** is provided with a slit **22**. A corresponding wedge of a turning knob engages this slit **22** on the one side, for example, and on the other side a corresponding wedge of a cylinder, which can be actuated by means of a key. In this case the turning element **21** is designed in such a way that it can be installed in already existing recesses, into which a profile cylinder can be inserted. A first arm **23** of a hinged lever **24** is fastened, pivotable around a bolt **25**, on the turning element **21**. The first arm **23** furthermore has an elongated hole **26**, which is engaged by a pin **27** fixed in place on the housing. On the side opposite the bolt **25**, the first arm **23** is pivotably connected via a pivot bearing **28** with a second arm **29**, wherein the second arm **29** acts on a bolt tail **31** of the further bolt **3** by means of a bolt **30**. A torsion spring **32** is seated around the bolt **30** and is supported by means of its leg **33** in a receptacle **34** of the further bolt **3**, while with its other leg **35** it extends around the pivot bearing **28**. The torsion spring **32** is laid out in such a way that the pivot bearing **28** is urged around the bolt **30** in a clockwise direction.

The lock in accordance with a first exemplary embodiment represented in FIG. 1 has the important advantage that, in the manner of American locks, it has a latch bolt **2** on the bottom and a further bolt **3** at the top, wherein the further bolt **3** can be moved forward out of the key housing by actuating the turning element **21** by means of a key or by means of a turning knob in a clockwise direction (in the position represented). In this case the extension is approximately 25 mm.

The forward displacement of the further bolt **3** by rotating the turning element **21** in a clockwise direction takes place in that in the course of rotation of the turning element **21**, the first arm **23** is taken along by the bolt **25** and turned in a counterclockwise direction around the pin **27**, and in addition is displaced in the direction toward the elongated hole **26**. This causes the second arm **29** to be displaced essentially in the extension direction of the further bolt **3** (toward the right). In addition, the bolt or pivot bearing **28** performs an arc-shaped movement suggested by the dashed line **36**. On its side facing away from the viewer, the pivot bearing **28** has an axial protrusion which, in the position of the hinged lever **24** represented in FIG. 1, extends behind a shoulder **37** fixed in place on the housing. In this way displacement of the further bolt **3** out of the lock housing **1** is prevented without actuation of the turning element **21**. In the end position of the pivot bearing **28** with the further bolt **3** extended, not shown in FIG. 1, the axial protrusion of the pivot bearing **28** is located behind a second shoulder **38** fixed in place on the housing, by means of which it is accomplished that the

extended further bolt **3** cannot be pushed back into the lock housing **1** without rotating the turning element **21**.

FIG. 2 represents a second exemplary embodiment of the lock in accordance with the present invention, wherein like components are identified with the same reference numerals. In this exemplary embodiment a connecting rod plate **39** is seated in the lock housing **1** and is moveable in the direction of the two-headed arrow **40**. Connecting rods **43** are connected at **41** and **42** to this connecting rod plate **39**. These connecting rods **43** are located behind cover rails **44** which, in the installed position of the lock **1**, finish and cover it on the visible side.

In FIG. 2, a turning slider **45** is rotatably fastened to the follower **5**. If the follower **5** is activated, the turning slider **45** is taken along, which will be explained further below. The turning slider **45** has a bolt **46**, which engages an elongated hole **47** in the connecting rod plate **39**. The turning slider **45** furthermore has a curved elongated hole **48**, by means of which the bearing **15** is bypassed.

Thus, if the follower **5** is moved counterclockwise, for example, the protrusion **9** of the latch bolt arm **10** is taken along by the shoulder **8** and is moved around the bearing **15** in a clockwise direction, as a result of which the latch bolt **2** is pushed into the lock housing **1**. Furthermore, the turning slider **45** is pivoted by the rotating movement of the follower **4** and the bolt **46** is displaced upwardly, as a result of which the connecting rod plate **39** is also displaced upwardly. In this way, the connecting rods **43** are pushed upwards.

A supplemental lock **49** is represented in FIG. 3, wherein the cover has also been removed. This supplemental lock **49** is connected with the lock housing **1** of the mortise lock by means of the connecting rod **43**. A latch bolt **50** is seated, displaceable in the direction of the two-headed arrow **51**, in the supplemental lock **49**. In the representation shown, this latch bolt **50** is in its turned-forward position. The latch bolt **50** has a latch bolt tail **52** including a protrusion **53**.

It is furthermore possible to see in FIG. 3, that a latch bolt detent lever **55** is pivotably seated around a bearing bolt **54**, and is spring-loaded in a clockwise direction by means of a detent lever spring **56** embodied as a torsion spring. If the latch bolt **50** is in the completely extended position, i.e. in the locking position, a latch detent edge **57** extends around the protrusion **53**. Although a short gap can exist between the protrusion **53** and the latch detent edge **57**, as represented in FIG. 3, the latch detent edge **57** extends into the displacement track of the protrusion **53**, so that the latch bolt **50** cannot easily be inserted into the housing of the supplemental lock **49**. Thus, in its locked position the latch bolt **50** is locked against unauthorized insertion.

If a latch restoration lever **58**, which rests with its one arm **59** against the free end of the connecting rod **43**, and with its other arm **60** against a further protrusion **61** of the latch bolt tail **52**, is pivoted via the connecting rod **43**, a protrusion **62** of the free arm **60** engages a crank **63** of the latch bolt detent lever **55** and lifts it sufficiently out of its locked position in which the latch detent edge **57** extends behind the protrusion **53**, so that the latch detent edge **57** moves out of the displacement track of the protrusion **53**. The arm **60** furthermore rests against the protrusion **61** and, in the course of the pivoting of the latch restoration lever **58**, it pulls the latch bolt **50** into the supplemental lock **49**. The extension of the latch bolt **50** takes place by means of a latch extension lever **64**, which is seated at the bearing **65** and is driven in a counterclockwise direction around the bearing **65** by a latch extension spring **66**. With its free end, the latch extension lever **64** acts on the latch bolt **50** and attempts to move it out of the supplemental lock **49**.

Now, if the follower **5** (FIG. 2) is moved into the locking position (turned in a clockwise direction), the latch bolt **50** of the supplemental lock **49** is turned forward. Since the shoulder **8**, by means of which the turning slider **45** is taken along, moves in a curved cutout **67**, the turning slider **45**, and therefore also the connecting rod plate **39**, remains in the deflected position when the follower **5** is restored into the initial position, represented in FIG. 2, by means of the restoring spring. The latch bolt **50** therefore remains extended.

If the follower **5** is moved in a counterclockwise direction by pushing down the latch, the latch bolt arm **10**, for one, and the turning slider **45**, for another, are moved via the shoulder **8**, as represented in FIG. 2, and thereby the latch bolt **2** is turned back and the connecting rod plate **39** is pushed into its initial position, as a result of which the arm **59** of the latch restoration lever **58** is moved via the coupled connecting rod **43** in that a slider **68** acts on a protrusion **69** of the arm **59** and pivots it in a counterclockwise direction. In the process and as described above, following the unlocking of the latch bolt **50** the arm **60** pulls the latch bolt **50** back over the protrusion **61** into the housing of the supplemental lock **49**.

A second exemplary embodiment of the supplemental lock **49** is represented in FIG. 4. With this supplemental lock **49** the latch bolt **50** is automatically pushed out of the lock housing when the door is closed. To this end the latch bolt **50** is provided with a groove **70**, extending in its longitudinal direction and open at one side. A detent element **71** is located in this groove **70**, which is seated, pivotable around a clamping sleeve **72**, in the groove **70** and therefore in the latch bolt **50**. This detent element **71** is provided with a detent protrusion **73** as well as with a triggering protrusion **74**.

In the latch position represented in FIG. 5, the detent protrusion **73** extends behind the cover rail **44** and prevents further extension of the latch bolt **50**, which is spring-loaded. This spring force, as already mentioned above, is provided by the latch extension spring **66** (FIG. 4), which has been pushed onto a guide pin and is supported on the one side on the inner wall of the housing of the supplemental lock **49** and on the other side on the latch extension lever **64**. This latch extension lever **64** is pivotably seated in the bearing **65**. The end of the latch extension lever **64** opposite the bearing **65** acts on the end of the detent element **71** located opposite the trigger protrusion **74** and urges it in the extension direction under the force of the latch extension spring **66**. Since the detent element **71** is connected via the clamping sleeve **72** with the latch bolt **50**, the latter is also urged in the extension direction. It can be seen in FIG. 5 that, although the latch extension lever **64** acts on the detent element **71**, the direction of the force of the latch extension lever **64** does not pass through the pivot bearing of the detent element constituted by the clamping sleeve **71**, so that the latch extension lever **64** exerts a pivot moment in the clockwise direction on the detent element **71**. The detent protrusion **73** as well as the triggering protrusion **74** are pivoted out of the groove **70** by means of this pivot moment.

With the door open (not shown), the latch bolt **50** is therefore in the latch position represented in FIGS. 4 and 5, in which a further extension is prevented because the detent protrusion **73** extends behind the cover rail **44**.

In the course of closing or pushing the door closed, the latch bolt **50** is inserted into the supplemental lock **49** over the locking plate attached to the door frame, not shown. If the door is in its closed position and the latch bolt **50** is

aligned with a latch opening in the locking plate on the side of the door frame, the fully inserted latch bolt **50** is pushed out of the supplemental lock **49** by means of the latch extension lever **64**. In the course of this extension movement, the locking element **71** is simultaneously pivoted in a clockwise direction around the clamping sleeve **72**. In the process, the trigger protrusion **74** comes into contact with the edge of the latch opening of the locking plate facing it, as a result of which the detent element **71** is pushed against the pivot moment sufficiently far into the groove **70**, so that the detent protrusion **73** can slide past the cover rail **44**. An arrestment of the latch bolt **50** in the latch position in accordance with FIG. 5 is prevented in this way, so that the latch bolt **50** can be extended into the locking position. In this locking position the latch bolt **50** has been extended approximately 10 mm 15 mm farther out of the supplemental lock **49** than in the latch position in accordance with FIG. 5.

There is a suggestion in FIG. 2, that the latch tail **31** be provided with a detent extension **75** on its underside, which projects downwardly and is seated, displaceable in the direction of the two-headed arrow **4**, in a receiving groove **76** fixed in place on the housing. The further bolt **3** is guided by this detent extension **75**. Furthermore, when turning the further bolt **3** forward (not shown), the detent extension **75** is pushed out of the receiving groove in the extension direction sufficiently far, so that it extends behind a shoulder **78** of the connecting rod plate **39**, as represented by the dash-dotted line **77**. With the further bolt **3** turned forward, the connecting rod plate **39** is essentially fixed in place in this manner in the position represented in FIG. 2. With its cutout **79**, the connecting rod plate **39** can only be displaced between the detent extension **75** (**77**) and a guide block **80**, which is fixed in place on the housing. However, the connecting rod plate **39** can no longer be displaced backward, i.e. upward. When the further bolt **3** has been extended by means of a key, opening of the lock can no longer be accomplished by actuating the follower **5**.

A rack extension **81** is represented in FIGS. 6 and 7, which is coupled by means of a coupling **82** with a connecting rod **43**, not shown. This coupling **82** is located on a first toothed rack **83**, which terminates in the housing **84** of the rack extension **81**. The first toothed rack **83** drives two gear wheels **85** seated in journals **86** fixed in place on the housing. A second toothed rack **87** is driven by means of these gear wheels **85**, which now moves opposite with respect to the first toothed rack **83**. Thus, a reversal of direction is provided by means of these gear wheels **85**. The second toothed rack **87** transmits the movement to two pairs of gear wheels **88** seated on journals **89**. The smaller gear wheels **90** of these pairs of gear wheels **88** are driven by means of the second toothed rack **87**. To this end the toothed rack **87** is provided with a toothed rack element **91** which is embodied to be considerably more narrow than the toothed rack **87**, but has a greater thickness, which can be seen in FIG. 6. A third toothed rack **92** located laterally next to the toothed rack element **91**, is of lesser thickness and meshes with the larger gear wheel **93** of the pair of gear wheels **88**. Together with the gear wheel pair **88**, the toothed rack element **91** and the third toothed rack **92** constitute a transmission gear, so that the displacement movement of the connecting rod **43** generates an extension of the detent pin **94** of approximately 25 mm. This detent pin **94** is connected via a hook connection **95** with the third toothed rack **92**, wherein the lower end of the detent pin **94** is loaded in the extension direction by means of a compression spring **96**. It is possible in this way to uncouple the detent pin **94** from the

further extending third toothed rack **92** at the completion of extension, so that damage to the transmission gear, or respectively the rack extension **81** are prevented in general.

The exemplary embodiment represented in FIG. **8** shows a further variant of the mortise lock in accordance with the present invention, wherein the connecting rod plate **39** is provided with a crank **97**. A guide pin **101**, which projects from a bolt extension **102**, acts on this crank **97**, which is being constituted by an obliquely extending section **98** and a section **99** extending in the direction of the two-headed arrow **40**, as well as an end section **100** orthogonally with respect to it. If the further bolt **3** is actuated by means of the turning element **21**, i.e. by means of a key or the turning knob, which has been described further above, the guide pin **101** is moved in the crank **97**. In the course of turning the further bolt **3** forward, the guide pin **101** is displaced in the direction of the arrow **103**. This leads to a movement of the guide pin **101** in the oblique section **98**, as a result of which connecting rod plate **39** is displaced downwardly until the guide pin **101** comes to lie in the end section **100**. It is possible in this way to actuate the connecting rod **43** by moving the further bolt **3** forward, actuated by a key or the turning knob. Furthermore, in the extended position of the further bolt **3**, the connecting rod plate **39** is blocked in that, as described in connection with FIG. **2**, the detent extension **75** represented there extends behind the shoulder **78** of the connecting rod plate **39**.

A further variant of the lock in accordance with the present invention is represented in FIG. **9**, wherein the forward movement of the further bolt **3** takes place by actuation of the follower **5** in a clockwise direction. Such a lock is also called a "fast lock". With this lock the connecting rod plate **39** also has a crank **104**, which has an oblique section **98**, but has an end section **105** extending in the direction of movement of the connecting rod plate **39**. The guide pin **101** is guided in this crank **104**. If now the follower **5** is turned in a clockwise direction, the bolt **46**, which engages an elongated hole **47** of the connecting rod plate **39**, is moved downward via the turning slider **45**. This causes the guide pin **101** to be displaced in the extension direction of the further bolt **3** in the oblique section **98**, which is also moved downward, as a result of which the further bolt **3** is moved forward. In the process, a toothed rack **108** of the bolt tail **31** meshes with a pinion **107**, which in turn meshes with a crown gear **106** of the turning element **21**. The turning element **21** is rotated in this way past the bolt extension, as a result of which the arm **23** of the hinged lever **24** is rotated in a counterclockwise direction around the journal **27**, so that the pivot bearing travels the curved track **36** described in FIG. **1** and therefore the axial protrusion moves around the shoulder **37** fixed in place on the housing and comes to lie behind the shoulder **38**. The further bolt **3** is secured against unauthorized retraction by this shoulder **38**.

However, this bolt extension can also take place in that the turning element **21** is rotated, so that the crown gear **106** meshes with the toothed rack **108** of the bolt tail **31** and the bolt **3** is moved forward in this way. However, with the further bolt **3** extended, the toothed rack **108**, which is made appropriately short, comes out of engagement with the pinion **107** in every case. If an attempt is now made to displace the connecting rod plate **39** upward, i.e. in the opening direction, by turning the follower **5** in a counterclockwise direction, this movement is blocked by the shoulder **38**, fixed in place on the housing, with which the axial protrusion of the pivot bearing **28** comes into contact. The bolt can therefore not be pushed back past the latch, or respectively the follower **5**. Therefore unlocking can only

exclusively be performed via the turning element **21**, i.e. by means of a key or by means of the turning knob. To this end the turning element **21** is provided with a ratchet constituted by two disks equipped with saw teeth on the sides facing each other. These saw teeth are arranged in such a way that they are permanently in engagement in one direction and, in the other direction of rotation, become disengaged starting at a defined torque.

Locking of the further bolt **3** by means of the shoulder **38** fixed in place on the housing is cancelled in that the turning element **21** is rotated counterclockwise in the opening direction. Since the pinion **107** is out of engagement with the toothed rack **108**, the latter, and therefore the further bolt **3**, are not taken along. Although the arm **23** of the hinged lever **24** is pivoted, the released pivot bearing **28** opens and becomes disengaged from the arm **29**. In FIG. **9** the arm **29** has not been drawn in for the sake of clarity. Since the pivot bearing **28** moves on the curved track **36**, the axial protrusion comes free of the shoulder **38** and is displaced behind the shoulder **37**. The further bolt **3** remains extended, but is no longer secured. It is now possible to displace the connecting rod plate **39** upward by pushing the latch down and to pull back the further bolt **3** via the crank **104**. In the process the toothed rack **108** again comes into engagement with the pinion **107** and drives it and therefore also the crown gear **106**. Since the turning element **21** is already in its end position assigned to the open position, the ratchet is actuated, so that no damage of the turning element **21** occurs.

A further exemplary embodiment of the lock in accordance with the present invention is represented in FIG. **10**, wherein the latch bolt **2** has the structure corresponding to the latch bolt **50** represented in FIGS. **4** and **5**. If a door with such a lock **1** is closed, the blocking of the blocking element **109** is automatically cancelled and the latch bolt **2** is moved forward by the force of a compression spring **110** acting on the latch bolt tail **18**. In the process, the actuating arm **16** of the latch bolt arm **10** is pivoted counterclockwise around the bearing **15**. The latch bolt tail **18** furthermore has a protrusion **111**, which acts on a blocking lever **112**, which can be pivoted around a bolt **113** fixed in place on the housing. This blocking lever **112** extends behind the free end **114** of the connecting rod plate **39** and blocks it against a downward displacement, in which direction the connecting rod plate **39** is loaded by a compression spring **115**. If, however, the blocking lever **112** is pivoted in a clockwise direction around the bolt **113** past the protrusion **111**, the engagement behind the free end is cancelled and the connecting rod plate **39** can be displaced downwardly.

With the fully automatic extension of the latch bolt **2**, the latch bolts **50** coupled with the connecting rod **43** are also extended. A simple latch bolt **50** of this type is represented, for example, in the supplemental lock **49** in FIG. **11**, wherein the latch bolt **50** is guided via a guide pin **116** in an elongated hole **117** of the housing cover **118** as well as in the crank **119** of a drive plate **120**. This drive plate **120** is coupled with the connecting rod **43**.

The lock in accordance with the present invention has the essential advantage of having a multitude of conventional components, but can still be used in the US market.

What is claimed is:

1. A lock for a door, comprising:

a housing including an opening;

a latch bolt and a further bolt both mounted to said housing for parallel displacement relative to said housing, said further bolt being operated for said par-

9

allel displacement by one of a key, a turning knob, and a key and turning knob, and said latch bolt being selectively operated by one of a latch with a follower, a key, and the turning knob;

a turning element mounted to said housing, said turning element being actuated by a key or a turning knob;

a two-armed hinged lever pivotably connected to said turning element with one arm of said two-armed hinged lever and pivotably coupled to said further bolt with the other arm of said two-armed hinged lever; and

a bearing fixed in place in said housing;

wherein the two arms of said two-armed hinged lever each have a free end and are pivotably connected with each other at their free ends, with one arm of said two-armed hinged lever receiving said bearing between the ends thereof.

2. The lock as defined in claim 1, further comprising:

a bolt for connecting said two arms of said two-armed hinged lever at their free ends, said bolt having an axial protrusion relative to said housing.

3. The lock as defined in claim 2, wherein said bolt traverses a curved path when said turning element and said two-armed hinged lever are actuated.

4. The lock as defined in claim 3, wherein said curved path defines an end position, and wherein said bolt is at said end position of said curved path when said further bolt is extended.

5. The lock as defined in claim 4, further comprising:

a first shoulder fixed in place in said housing, said first shoulder being located behind said bolt when said bolt is at said end position associated with the retracted direction of said further bolt.

6. The lock as defined in claim 3, further comprising:

a second shoulder fixed in place in said housing, said second shoulder being located behind said bolt when said bolt is at said end position associated with the extended direction of said further bolt.

7. The lock as defined in claim 2, wherein said bolt is spring loaded in the direction of said free ends of said two-armed hinged lever.

8. The lock as defined in claim 1, further comprising:

a connecting rod plate, from which connecting rods are suspended; and

a follower for actuating said connecting rod plate.

9. The lock as defined in claim 8, wherein said further bolt has a detent extension which blocks said connecting rod plate in an end position when said further bolt is extended.

10. The lock as defined in claim 8, further comprising:

a supplemental bolt lock connected by means of at least one of said connecting rods, wherein said latch bolt can be extended or retracted by means of said connecting rods actuated by said connecting rod plate.

10

11. The lock as defined in claim 10, further comprising: a spring for spring-loading said latch bolt, wherein said latch bolt is spring-loaded in its extended direction, and wherein said latch bolt has a detent element which maintains said latch bolt in a partially retracted position when the door of said lock is open, and is triggered when the door is closed, so that said latch bolt automatically changes into the extended position under the force of said spring.

12. The lock as defined in claim 8, wherein said at least one connecting rod is provided with a gear, in the form of one of a transmission gear, a reversing gear, and a transmission gear and reversing gear.

13. The lock as defined in claim 12, further comprising: a rack extension, extendible in the axial direction of said at least one connecting rod, wherein said gear is coupled with said rack extension.

14. The lock as defined in claim 8, wherein said connecting rod plate is coupled with said further bolt.

15. The lock as defined in claim 14, wherein said connecting rod plate includes a crank, and wherein said further bolt includes a guide pin which engages said crank.

16. The lock as defined in claim 15, wherein on its one end, at which said guide pin is located when said further bolt is extended, said crank includes a section which extends in the displacement direction of said connecting rod plate.

17. The lock as defined in claim 1, further comprising: a pinion; and a toothed rack formed on the tail of said further bolt, wherein said turning element includes a crown gear on its circumferential surface, and wherein said crown gear meshes via said pinion with said toothed rack.

18. The lock as defined in claim 8, wherein said latch bolt is spring-loaded in the extension direction, said latch bolt including a blocking element which, when the door of said housing is open, maintains said latch bolt in the retracted position and which is triggered when the door is closed, so that said latch bolt automatically changes into its extended position by the force of its spring load.

19. The lock as defined in claim 17, further comprising: a compression spring; and a blocking lever which extends behind and locks said connecting rod plate in its end position assigned to unlocking, wherein the force of said compression spring acts on said connecting rod plate in the direction toward the position assigned to locking.

20. The lock as defined in claim 2, wherein said bolt serves as a releasable pivot bearing, and wherein the two arms of said two-armed hinged lever are connected to each other by said releasable pivot bearing.

21. The lock as defined in claim 20, wherein said releasable pivot bearing is released in one direction, including the unlocking direction.

\* \* \* \* \*