

US 20230165515A1

(19) **United States**

(12) **Patent Application Publication**
Arnold et al.

(10) **Pub. No.: US 2023/0165515 A1**

(43) **Pub. Date: Jun. 1, 2023**

(54) **WEARABLE HEALTH MONITORING
DEVICE**

(71) Applicants: **KNOW BIOLOGICAL, INC.**, Milton,
GA (US); **National Technology &
Engineering Solutions of Sandia,
LLC**, Albuquerque, NM (US)

(72) Inventors: **Gary Stephen Arnold**, Cumming, GA
(US); **Matthew Wallace Moorman**,
Albuquerque, NM (US); **Joshua
Jonathan Whiting**, Albuquerque, NM
(US)

(21) Appl. No.: **18/069,047**

(22) Filed: **Dec. 20, 2022**

Related U.S. Application Data

(60) Division of application No. 17/340,195, filed on Jun.
7, 2021, now Pat. No. 11,559,246, which is a contin-
uation-in-part of application No. 17/242,441, filed on
Apr. 28, 2021, now Pat. No. 11,272,875, which is a
division of application No. 16/874,229, filed on May
14, 2020, now Pat. No. 11,020,042.

(60) Provisional application No. 62/848,319, filed on May
15, 2019.

Publication Classification

(51) **Int. Cl.**

A61B 5/00 (2006.01)

A61B 10/00 (2006.01)

G01N 30/64 (2006.01)

G01N 30/20 (2006.01)

G01N 30/80 (2006.01)

G01N 30/00 (2006.01)

G01N 30/60 (2006.01)

A61B 5/145 (2006.01)

(52) **U.S. Cl.**

CPC **A61B 5/4094** (2013.01); **A61B 10/00**
(2013.01); **A61B 5/6831** (2013.01); **A61B**
5/6833 (2013.01); **G01N 30/64** (2013.01);
G01N 30/20 (2013.01); **G01N 30/80**
(2013.01); **A61B 5/443** (2013.01); **G01N**
30/00 (2013.01); **G01N 30/60** (2013.01);
A61B 5/14546 (2013.01); **A61B 2010/0083**
(2013.01); **G01N 2030/025** (2013.01)

(57)

ABSTRACT

A wearable health monitoring device includes a band con-
figured to attach the wearable health monitoring device to a
user's body; a VOC detection device configured to collect
and analyze volatile organic compounds given off from the
user's skin to identify specific health-indicative volatile
organic compounds indicative of a health condition; and a
biomarker sensor configured to detect a biomarker of the
user.

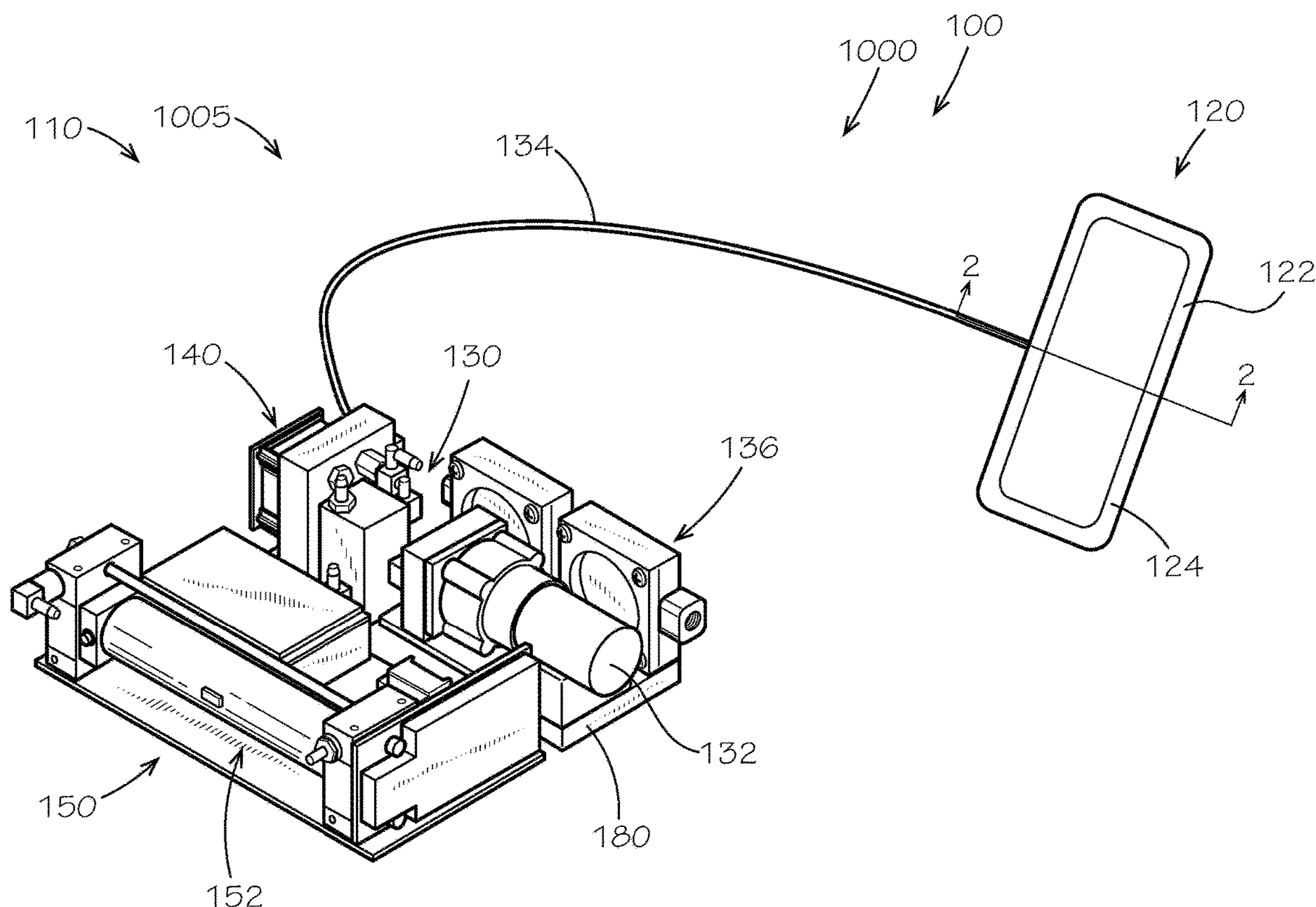

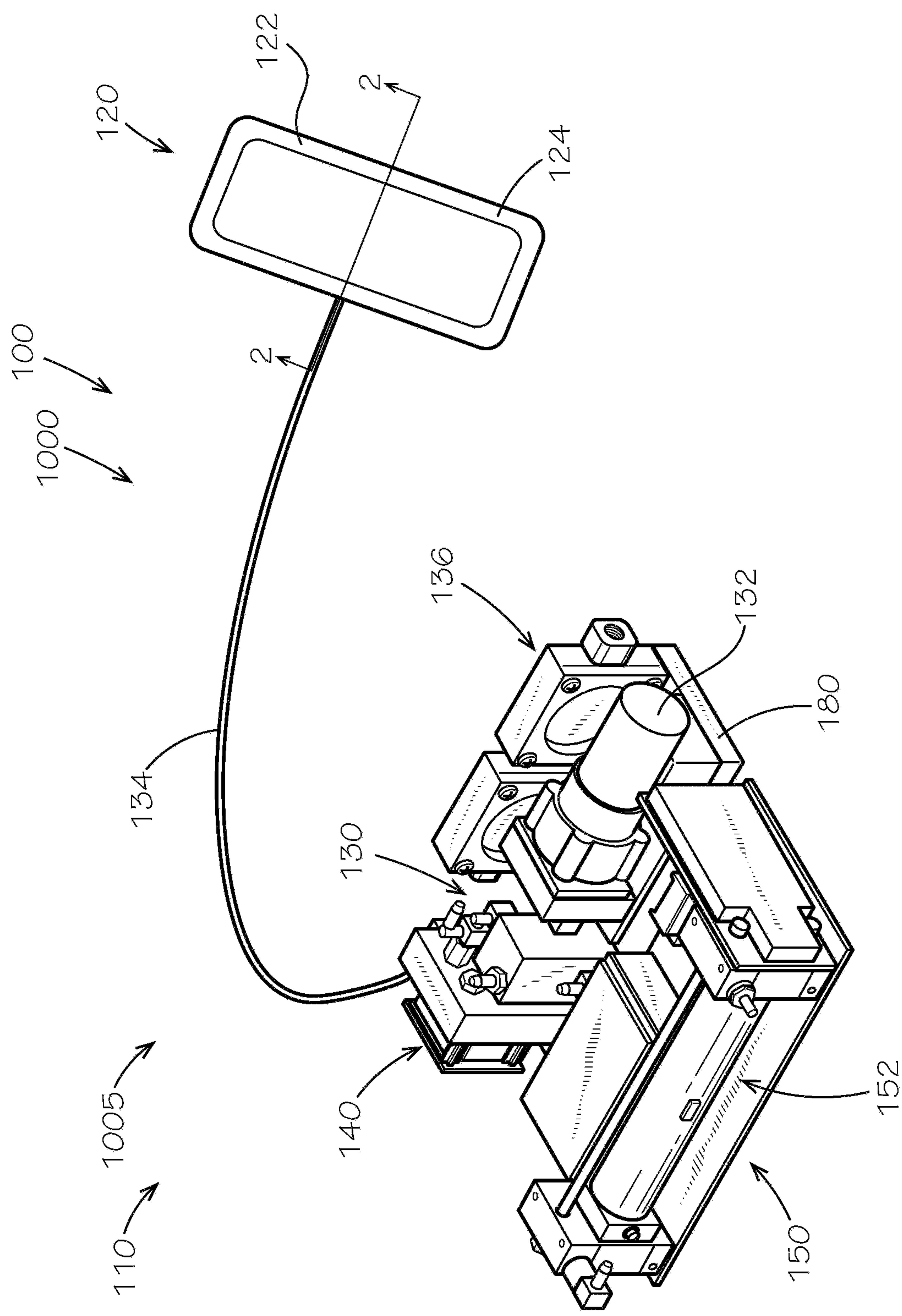

FIG. 1

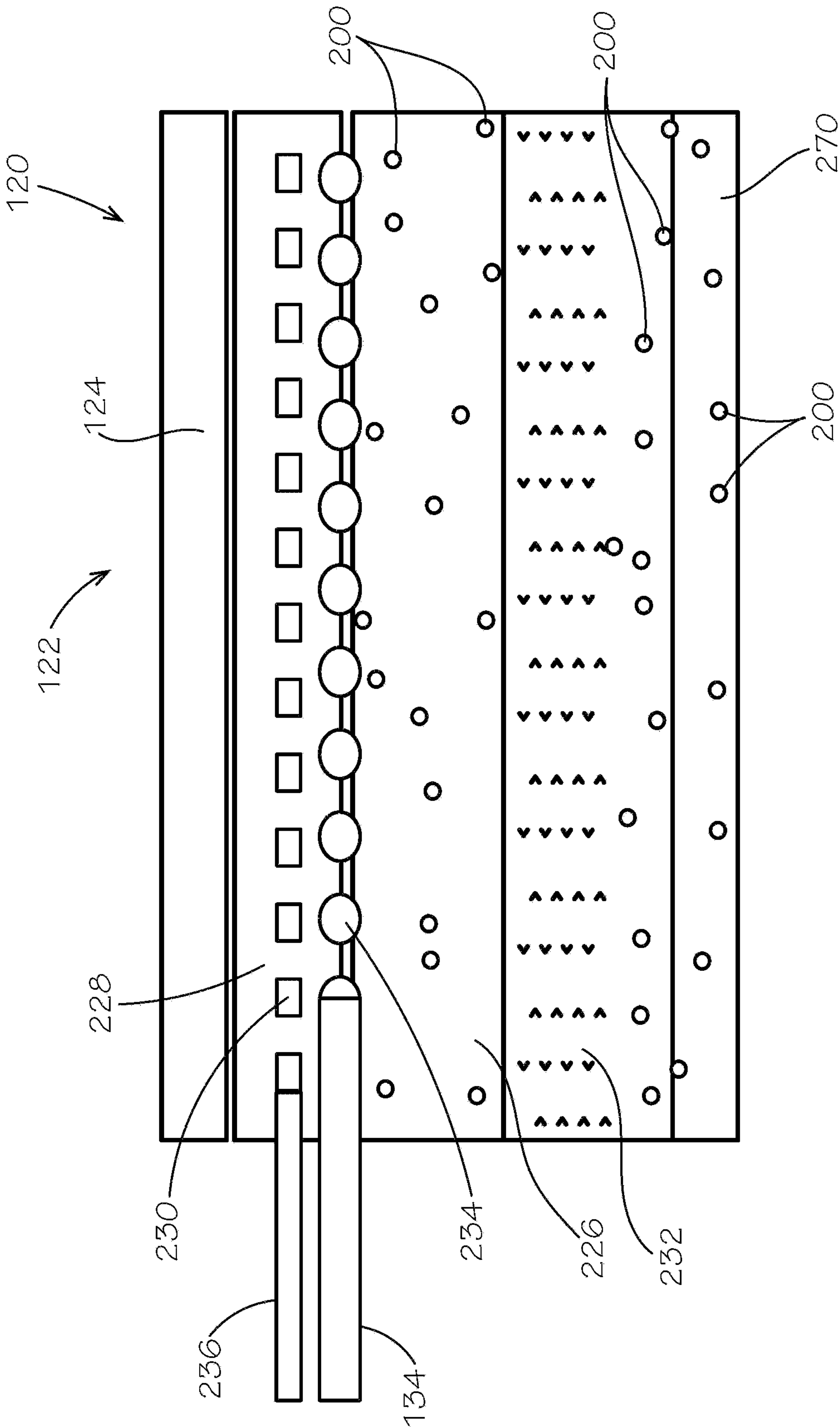

FIG. 2

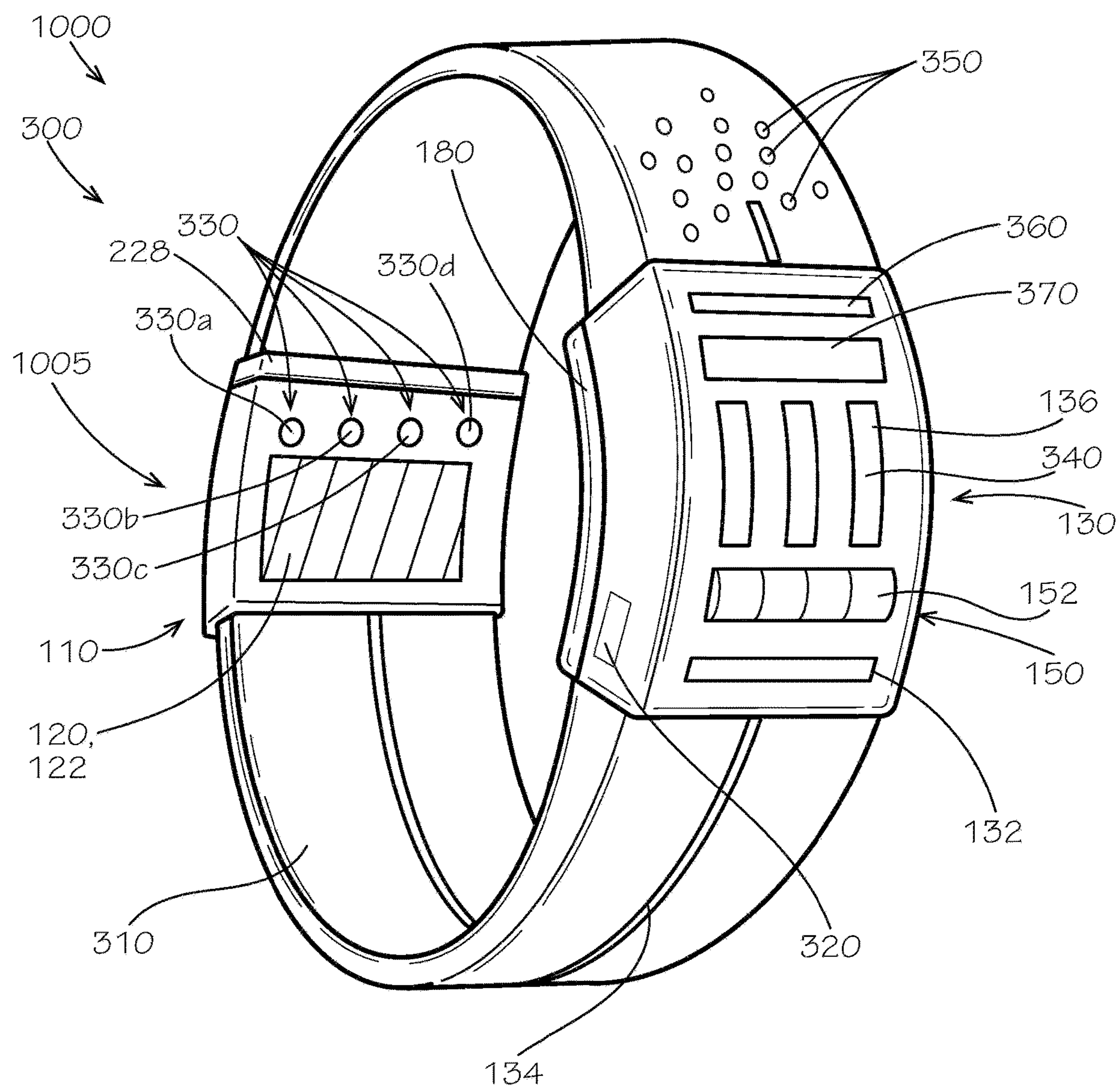

FIG. 3

WEARABLE HEALTH MONITORING DEVICE

CROSS-REFERENCE TO RELATED APPLICATIONS

[0001] The present application is a divisional of U.S. application Ser. No. 17/340,195, filed Jun. 7, 2021, which is a continuation-in-part of U.S. application Ser. No. 17/242,441, filed Apr. 28, 2021, which issued as U.S. Pat. No. 11,272,875 on Mar. 15, 2022, which is a divisional of U.S. application Ser. No. 16/874,229, filed May 14, 2020 and which issued as U.S. Pat. No. 11,020,042 on Jun. 1, 2021, which claims the benefit of U.S. Provisional Application No. 62/848,319, filed May 15, 2019, all of which are hereby specifically incorporated by reference herein in their entireties.

STATEMENT OF GOVERNMENT INTEREST

[0002] This invention was made with government support under Contract No. DE-NA0003525 awarded by the United States Department of Energy/National Nuclear Security Administration. The government has certain rights in the invention.

TECHNICAL FIELD

[0003] This disclosure relates to medical devices. More specifically, this disclosure relates to a seizure detection device.

BACKGROUND

[0004] Epilepsy is the most common neurological disorder in the world after migraine, stroke, and Alzheimer's disease. It is a disorder of the central nervous system, not caused by an underlying, treatable medical condition, characterized by recurring periods of altered brain function caused by abnormal or excessive electrical discharges in the brain, resulting in what is commonly called a seizure. It is one of the world's oldest recognized health conditions, with recorded occurrences dating back to 4,000 BC.

[0005] Worldwide, there are nearly 65 million people who have epilepsy, with more than 3.5 million in the U.S. alone. Worldwide, there are 2.4 million new cases of epilepsy each year, with more than 150,000 new cases each year in the U.S. alone. Over a lifetime, more than one in twenty-six people will be diagnosed with the disease. Medication and medical intervention can control seizures in approximately two-thirds of patients, with the remaining one-third experiencing uncontrolled and unpredictable seizure episodes. There are estimated to be nearly one million deaths directly related to epilepsy each year worldwide, including some 50,000 deaths in the U.S. each year.

[0006] Each year, approximately 80 people out of every 100,000 in the general population will experience new-onset seizures, and approximately 60% of these will have repeated episodes leading to the diagnosis of epilepsy. Misunderstanding, prejudice, and social humiliation have always surrounded epilepsy. This continues in most countries today and can significantly impact the quality of life for people with epilepsy.

[0007] The social consequences of epilepsy are often more impactful than the seizures themselves. The lack of predictability inherent in epilepsy is devastating. Never knowing when a seizure might strike imposes major limitations in

family, social, educational, and vocational activities. In addition to the potential of serious injury from falls and other accidents during seizures, the societal stigma attached to epilepsy and its unpredictability that can cause significant demoralization, irritation, and anxiety. Frustratingly, studies have shown that increased anxiety can lead to increased incidence of seizures, and increased seizures can lead to an even greater increase in chronic anxiety.

[0008] In summation, unexpected seizures can result in accident, injury, embarrassment, and costly trips to the emergency room. They can be difficult to predict and can be dangerous, particularly in instances where the patient is unable to contact family, a friend, or medical personnel when needed. Furthermore, patients often must take daily prophylactic medications that can be toxic and can be accompanied by unpleasant, occasionally life-threatening side effects.

[0009] Additionally, a person's health can be assessed through a set of well-defined biomarkers including exudates, such as volatile organic compounds (VOCs), blood oxygenation, pulse, heart rate variability, body temperature. Every day the human body emits various VOCs through exhalation breath and bodily fluids, such as sweat and saliva. The specific types of VOCs emitted, and the concentrations thereof can be indicative of specific health concerns.

[0010] Volatile organic compounds (VOCs) are gaseous, organic molecules that have a high vapor pressure at room temperature, which relates to a low boiling point. Research indicates more than 1,850 different VOCs can be found in the human body. These compounds are both endogenously produced by the body itself and exogenously introduced from environmental sources. The presence and concentrations of VOCs provides significant insight into the health of the host organism. Specific VOC bouquets are diagnostically relevant as they are indicative of existing or developing health concerns.

[0011] For example, in addition to the nearly 65 million people who have epilepsy, there are more than one billion people who suffer from chronic migraines, multiple billions that experience extreme, debilitating stress, and millions who contract new varieties of viral and bacterial infections each year, such as COVID-19. Unexpected or undiagnosed medical conditions can result in accident, injury, costly trips to the emergency room, and substantial increase in medical costs across the range of health concerns.

SUMMARY

[0012] It is to be understood that this summary is not an extensive overview of the disclosure. This summary is exemplary and not restrictive, and it is intended neither to identify key or critical elements of the disclosure nor delineate the scope thereof. The sole purpose of this summary is to explain and exemplify certain concepts of the disclosure as an introduction to the following complete and extensive detailed description.

[0013] Disclosed is a collector for a seizure detection device comprising a collector material configured to collect volatile organic compounds given off from a patient's skin; a wrapping configured to isolate the collector material from an external environment; a heater comprising a heating element, the heating element configured to emit a thermal pulse to desorb the volatile organic compounds from the collector material; and a mesh layer configured to prevent the collector material from contacting the patient's skin,

wherein the collector material is received between the wrapping and the mesh layer.

[0014] Also disclosed is a seizure detection device comprising a collector comprising a collector material configured to collect volatile organic compounds given off from a patient's skin; a separator comprising a gas chromatography column, the gas chromatography column comprising a chemically-selective film, wherein mixtures of the volatile organic compounds are configured to elute from the collector and to diffuse into and out of the chemically-selective film to separate the mixtures into their constituent chemicals; and an identifier comprising a detector and a processor, the detector configured to receive, ionize, and detect the constituent chemicals eluting from the gas chromatography column, the processor configured to process information about the ionized chemicals to identify volatile organic compounds indicative of a seizure.

[0015] Also disclosed is a method of detecting a seizure comprising collecting volatile organic compounds with a collector material of a collector; separating each of the volatile organic compounds into its constituent chemicals with a gas chromatography column; ionizing the constituent chemicals to create ionized chemicals and detecting the ionized chemicals; and analyzing the ionized chemicals to identify seizure-indicative volatile organic compounds.

[0016] Disclosed is a volatile organic compound detection device comprising a collector comprising a collector material configured to collect volatile organic compounds given off from a user's skin; a separator comprising a gas chromatography column configured to separate mixtures of the volatile organic compounds into their constituent chemicals; and an identifier comprising a detector and a processor, the detector configured to transduce the constituent chemicals into a signal, the processor configured to process the signal to identify specific volatile organic compounds indicative of a health condition

[0017] Additionally, a wearable health monitoring device is disclosed, the wearable health monitoring device comprising a band configured to attach the wearable health monitoring device to a user's body; a VOC detection device configured to collect and analyze volatile organic compounds given off from the user's skin to identify specific health-indicative volatile organic compounds indicative of a health condition; and a biomarker sensor configured to detect a biomarker of the user.

[0018] A method of monitoring a user's health is disclosed, the method comprising collecting volatile organic compounds from a user with a collector material of a collector; separating a mixture of the volatile organic compounds into its constituent chemicals with a gas chromatography column; transducing the constituent chemicals into a signal; and analyzing the signal to identify volatile organic compounds indicative of a health condition.

[0019] Various implementations described in the present disclosure may include additional systems, methods, features, and advantages, which may not necessarily be expressly disclosed herein but will be apparent to one of ordinary skill in the art upon examination of the following detailed description and accompanying drawings. It is intended that all such systems, methods, features, and advantages be included within the present disclosure and protected by the accompanying claims.

BRIEF DESCRIPTION OF THE DRAWINGS

[0020] The features and components of the following figures are illustrated to emphasize the general principles of the present disclosure. Corresponding features and components throughout the figures may be designated by matching reference characters for the sake of consistency and clarity.

[0021] FIG. 1 is a top perspective view of a health monitoring device comprising a seizure detection device, in accordance with one aspect of the present disclosure.

[0022] FIG. 2 is a cross-sectional view of a collector of the seizure detection device of FIG. 1, taken along line 2-2 of FIG. 1.

[0023] FIG. 3 is a perspective view of the health monitoring device in accordance with another aspect of the present disclosure.

DETAILED DESCRIPTION

[0024] The present disclosure can be understood more readily by reference to the following detailed description, examples, drawings, and claims, and the previous and following description. However, before the present devices, systems, and/or methods are disclosed and described, it is to be understood that this disclosure is not limited to the specific devices, systems, and/or methods disclosed unless otherwise specified, and, as such, can, of course, vary. It is also to be understood that the terminology used herein is for the purpose of describing particular aspects only and is not intended to be limiting.

[0025] The following description is provided as an enabling teaching of the present devices, systems, and/or methods in its best, currently known aspect. To this end, those skilled in the relevant art will recognize and appreciate that many changes can be made to the various aspects of the present devices, systems, and/or methods described herein, while still obtaining the beneficial results of the present disclosure. It will also be apparent that some of the desired benefits of the present disclosure can be obtained by selecting some of the features of the present disclosure without utilizing other features. Accordingly, those who work in the art will recognize that many modifications and adaptations to the present disclosure are possible and can even be desirable in certain circumstances and are a part of the present disclosure. Thus, the following description is provided as illustrative of the principles of the present disclosure and not in limitation thereof.

[0026] As used throughout, the singular forms "a," "an" and "the" include plural referents unless the context clearly dictates otherwise. Thus, for example, reference to "an element" can include two or more such elements unless the context indicates otherwise.

[0027] Ranges can be expressed herein as from "about" one particular value, and/or to "about" another particular value. When such a range is expressed, another aspect includes from the one particular value and/or to the other particular value. Similarly, when values are expressed as approximations, by use of the antecedent "about," it will be understood that the particular value forms another aspect. It will be further understood that the endpoints of each of the ranges are significant both in relation to the other endpoint, and independently of the other endpoint.

[0028] For purposes of the current disclosure, a material property or dimension measuring about X or substantially X on a particular measurement scale measures within a range

between X plus an industry-standard upper tolerance for the specified measurement and X minus an industry-standard lower tolerance for the specified measurement. Because tolerances can vary between different materials, processes and between different models, the tolerance for a particular measurement of a particular component can fall within a range of tolerances.

[0029] As used herein, the terms “optional” or “optionally” mean that the subsequently described event or circumstance can or cannot occur, and that the description includes instances where said event or circumstance occurs and instances where it does not.

[0030] The word “or” as used herein means any one member of a particular list and also includes any combination of members of that list. Further, one should note that conditional language, such as, among others, “can,” “could,” “might,” or “may,” unless specifically stated otherwise, or otherwise understood within the context as used, is generally intended to convey that certain aspects include, while other aspects do not include, certain features, elements and/or steps. Thus, such conditional language is not generally intended to imply that features, elements and/or steps are in any way required for one or more particular aspects or that one or more particular aspects necessarily include logic for deciding, with or without user input or prompting, whether these features, elements and/or steps are included or are to be performed in any particular aspect.

[0031] Disclosed are components that can be used to perform the disclosed methods and systems. These and other components are disclosed herein, and it is understood that when combinations, subsets, interactions, groups, etc. of these components are disclosed that while specific reference of each various individual and collective combinations and permutations of these may not be explicitly disclosed, each is specifically contemplated and described herein, for all methods and systems. This applies to all aspects of this application including, but not limited to, steps in disclosed methods. Thus, if there are a variety of additional steps that can be performed it is understood that each of these additional steps can be performed with any specific aspect or combination of aspects of the disclosed methods.

[0032] Disclosed in the present application is a health monitoring device and associated methods, systems, devices, and various apparatus. Example aspects of the health monitoring device can comprise a band, a volatile organic compound detection device, and a biomarker sensor. It would be understood by one of skill in the art that the disclosed health monitoring device is described in but a few exemplary aspects among many. No particular terminology or description should be considered limiting on the disclosure or the scope of any claims issuing therefrom.

[0033] FIG. 1 illustrates a first aspect of a health monitoring device **1000** according to the present disclosure. In the present aspect, the health monitoring device **100** can comprise volatile organic compound detection device **1005**. For example, the volatile organic compound detection device **1005** can comprise a seizure detection device **100**. The seizure detection device **100** can be configured to detect specific seizure-indicative volatile organic compounds (a.k.a. VOCs, and also known as bio-volatile compounds) than can be associated with epileptic seizure onset or occurrence in human patients. In some aspects, as described in further detail below with reference to FIG. 3, the volatile organic compound detection device **1005** (henceforth, the VOC

detection device **1005**) can also or alternatively detect VOCs associated with other health conditions, such as, for example, migraines, stroke, stress, viral and bacterial infections, and the like. For example, the seizure-indicative VOCs can be menthone, menthyl acetate, and/or 3-ethoxy-3,7-dimethyl-1,6-octadiene, which have been identified as seizure biomarkers. In other aspects, the seizure-indicative VOCs can be any other suitable compound that can be associated with seizure in human patients. In some instances, these specific seizure-indicative VOCs may be present, either individually or in any combination, before, during, or after a seizure. Volatile organic compounds (VOCs) **200** (shown in FIG. 2), including the seizure-indicative VOCs, can be emitted as gases from the human patient, for example, through the patient's skin. According to example aspects, the seizure detection device **100** can comprise a sensor device **110** that can detect and analyze VOCs **200** in a three-stage process including pre-concentration (PC), gas chromatography (GC) separation, and detection. Additionally, in some aspects, the health monitoring device **1000** can further comprise one or more biomarker sensors (shown in FIG. 3) configured to detect additional biomarkers, such as, for example, blood oxygenation, pulse, heart rate variability, blood pressure, and/or body temperature that may be altered before, during, or after a seizure.

[0034] According to example aspects, the sensor device **110** can comprise a collector **120**, a separator **130**, and an identifier **150**. The collector **120**, which can also be referred to as a skin volatile collector or SVC, can be formed as a patch **122** that can contact the patient's skin **270** (shown in FIG. 2). In one aspect, the patch **122** can be adhered to the skin **270** by an adhesive. In another aspect, the patch **122** can be applied by another fastener, such as a band or tie, or any other suitable fastener known in the art. In the pre-concentration state, the collector **120** can collect target chemicals (e.g., VOCs **200**) from the environment and can reject interferents. In the present aspect, the collector **120** can comprise a chemically-clean wrapping **124** that can isolate a sorbent collector material **226** (shown in FIG. 2) from possible external environmental contaminants. The collector material **226** can be configured to collect VOCs **200** given off as a gas from the patient's skin **270**, in some aspects, and may also collect other compounds. The collector material **226** can also be isolated from direct physical contact with the patient's skin **270** to minimize contamination by sweat or skin bacteria, as described in further detail below with respect to FIG. 2. According to example aspects, a heater **228** (shown in FIG. 2) can be integrated with the collector material **226** and a thermal pulse from the heater **228** can desorb the VOCs **200** (and possibly other compounds) from the collector material **226**. In some aspects, the heater **228** can be configured to heat the collector material **226** to about 200° C. A pump **132** of the seizure detection device **100** can then pump the desorbed VOCs **200** through a transfer tube **134** to the separator **130**. Example aspects of the transfer tube **134** can comprise a Teflon® material, or any other suitable material.

[0035] In the GC separation stage, the collected VOCs **200** can be injected into a carrier gas (not shown), such as, for example, helium or nitrogen. A small gas plug (e.g., a sample of the carrier gas and VOC mixture) can be injected into a long, rectangular flow column **340** (shown in FIG. 3) of the separator **130**. According to example aspects, a valve

140 can control injection of the gas plug and the direction and flow of the gas plug through the column **340**. Example aspects of the column **340** can be a μ GC (micro gas chromatography) column, while in other aspects, the column **340** can be a conventional GC (gas chromatography) column. In some aspects, the column **340** can be similar to any of the aspects disclosed in U.S. Pat. No. 10,151,732, filed Jan. 11, 2016, U.S. Pat. No. 6,699,392, filed Jun. 10, 2002, and U.S. Pat. No. 6,666,907, filed Jan. 31, 2002 which are hereby incorporated by reference herein in their entireties. In some aspects, the gas plug can undergo a μ GCxGC separation or a conventional GCxGC separation, which can allow for high-fidelity separations and ultra-low false alarm rates. μ GCxGC separation is micro gas chromatography x micro gas chromatography separation, while GCxGC separation is a conventional gas chromatography x gas chromatography separation, both of which can also be known as two-dimensional gas chromatography. In other aspects, the gas chromatography can be one-dimensional.

[0036] According to example aspects, the column **340** can be coated with a chemically-selective film, and the chemically-selective film can be referred to as a stationary phase. As the gas plug flows through the column **340**, individual chemicals from the gas plug (including individual chemicals of the VOCs **200**) diffuse into and out of the stationary phase based on their solubility within the stationary phase. VOCs **200** with a low solubility can quickly flow through the channel, while VOCs **200** with high solubility can spend a relatively long time within the stationary phase. This time-delay separates the complex chemical mixture of the gas plug into its constituent chemicals and introduces valuable spatial and chemical information that is critical for positive chemical identification and false alarm reductions in the detection stage. In example aspects, the column **340** can be a silicon μ GC column that can be about 160 cm in length, about 65 μ m in width, and about 650 μ m deep. In example aspects, heaters (e.g., metal heaters) (not shown) can be integrated with the silicon μ GC column. Furthermore, the high aspect ratio silicon μ GC column can fit on a die **136** that can be about 2 cm by 2 cm on each side of the die **136**, which can be a significant size reduction in comparison to traditional columns. According to example aspects, the reduced size can allow for a μ GC separation to be performed in under 30 seconds by heating the column **340** from 70-200+° C. at an average power of 4.5 W.

[0037] Finally, in the detection stage, the identifier **150** can sense the chemicals eluting from the column **340** and can transduce the chemical information to a recordable signal. For example, the identifier **150** can comprise an Ion Mobility Spectrometer (IMS) detector **152**. In a particular aspect, the IMS detector **152** can be a CIMS (Correlation Ion Mobility Spectrometer) detector. In another particular aspect, the IMS detector **152** can be a LTCC (Low Temperature Co-fired Ceramic) CIMS detector. In other aspects, the identifier **150** can comprise a flame ionization detector (FID), a photoionization detector (PID), a pulsed discharge ionization detectors (PDID), a resonator-based detector including quartz crystal micro balances, surface acoustic wave detectors, and/or micro-fabricated cantilever based resonators, a chemiresistor, a chemicapacitor, a thermal conductivity detector (TCD), a spectroscopic detector including vacuum ultra violet (VUV), ultraviolet, visible, and/or infrared radiation detection, a mass spectrometer detection method (MS), a non-gas chromatographic separation method such as IMS

(ion mobility spectrometry), IMS-MS (ion mobility spectrometry-mass spectrometry), and/or MS-MS (tandem mass spectrometry), or any other suitable detector known in the art. Within the IMS detector **152**, the incoming chemicals can be ionized and pulled down an IMS drift tube (not shown) by a potential gradient. In some aspects, the IMS drift tube can be similar to the drift tube disclosed in U.S. Pat. No. 7,155,812, filed Sep. 4, 2003, which is hereby incorporated by reference herein in its entirety.

[0038] Because the IMS detector **152** can operate at atmospheric pressures, the ionization of the chemicals can be considered a “soft” ionization, in that it minimizes the breakup or fragmentation of the chemicals. The ionized chemicals (also known as ions) can be drawn into the IMS drift tube, and the IMS drift tube can contain a faraday cup detector (not shown) at an end thereof that can count the ionic charge. The speed at which an ion travels down the IMS drift tube is a function of the ion’s size, charge, and the interactions between the ion and other molecules in the IMS drift tube. Careful measurement of a characteristic transit speed down the IMS drift tube, called a reduced mobility value (or K_0), of a parent ion and its adducts can positively identify the target species (e.g., the specific seizure-indicative VOCs associated with seizures). In example aspects, the seizure detection device **100** can comprise a processor (not shown), for example, on a printed circuit board (PCB), for processing the data and determining whether one or more of the seizure-indicative VOCs is present. According to example aspects, a battery **180**, such as a lithium ion battery, or another power source can be provided for powering the sensor device **110**, including the processor.

[0039] When detection of one or more of the seizure-indicative VOCs is made, or detection of a significant concentration of one or more of the seizure-indicative VOCs is made, the processor can activate a signal. In some aspects, the signal can sound an immediate alarm to alert a patient that a seizure may be imminent. In some aspects, the signal can also or alternatively be sent wirelessly (e.g., via Bluetooth) to an external receiving unit, such as an application (also known as an app) on a cellular phone, smartphone, tablet, or other electronic instrument, to activate an additional alarm. In some instances, there can be enough forewarning to introduce an abortive therapy for the oncoming seizure. Furthermore, in some aspects, the seizure detection device **100** can also alert a caregiver or emergency personnel. Memory can be included in the application and/or the device **100** itself that can profile levels of seizure-indicative VOC concentration, duration, and the time and date of occurrence. This data can then be used as a diary of seizure activity for later review by the patient or a physician. In some aspects, the data can also be used to better predict future seizures based on the patient’s individual chemistry pre-seizure. For example, in one aspect, the seizure detection device **100** may detect a slightly elevated concentration of menthone in the patient before multiple seizure occurrences. The processor can analyze this data to detect the pattern of increased menthone pre-seizure, and can identify increased menthone as a seizure-indicative VOC in the patient. The seizure detection device **100** can then alert the patient any time menthone, or a significant concentration of menthone, is detected.

[0040] FIG. 2 illustrates a cross-sectional view of the collector **120** taken along line 2-2 of FIG. 1. As shown, the collector **120** can be applied to the skin **270** of a patient. The

chemically-clean wrapping **124** can define an outer layer of the collector **120**. In some aspects, the chemically-clean wrapping **124** can be a polyimide film, and in the present aspect, the wrapping **124** can be a polyimide film with a silicone adhesive. In other aspects, any other suitable adhesive or other fastener can be used. The collector material **226** can define an intermediate layer of the collector **120**, and in the present aspect, the collector material **226** can be formed from PDMS (polydimethylsiloxane), which is a type of silicone, for example and without limitation. In the present aspect, the heater **228** can be attached to the wrapping **124**, and can be positioned between the wrapping **124** and the collector material **226**, as shown. In other aspects, the heating element of the heater **228** can be integrated with the wrapping **124**. Furthermore, a mesh **232** can define an inner layer of the collector **120** and can be positioned between the collector material **226** and the patient's skin. Example aspects of the mesh can be formed from a polymer, such as polytetrafluoroethylene (PTFE). In other aspects, the mesh can be formed from a metal material or any other suitable material known in the art. The mesh **232** can prevent the collector material **226** from contacting the patient's skin and being contaminated by sweat, oils, and bacteria from the skin, and/or other undesirable elements.

[0041] In other aspects, the collector **120** can be configured to collect VOCs **200** through a patient's sweat, saliva, breath (e.g., exhalation), or any other suitable bodily process. Also in other aspects, the seizure-indicative VOCs can further or alternatively include β -bourbonene, β -cubebene, or any other suitable VOC that may be identified as a seizure biomarker. Furthermore, in some aspects, instead of being in contact with the patient's skin, the collector can be positioned near the patient (e.g., next to a patient's chair or bed, or elsewhere in a patient's room) and can be configured to collect VOCs from the ambient air surrounding the patient, which have been released into the air through the patient's skin and/or through the patient's exhalation.

[0042] Example aspects of the heater **228** can comprise a heating coil **230** configured to emit a thermal pulse, which can desorb VOCs **200** received in the collector material **226** into a flow channel(s) **234** between the heating coil **230** and the collector material **226**. In example aspects, a power cord **236** can be connected to the heater **228** to provide power to the heating coil **230**. In some aspects, the power cord **236** can be connected to the battery **180** or other power source to transfer power to the heating coil **230**. When the VOCs **200** are desorbed from the collector material **226** and into the flow channel **234**, the pump **132** can then sweep the VOCs **200** out of the flow channel **234** and through the transfer tube **134** to the separator **130** (shown in FIG. 1).

[0043] The seizure detection device **100** can allow patients to position themselves such that they can avoid accident, injury, embarrassment, and unnecessary trips to the emergency room. In some aspects, the seizure detection device **100** can also alert families, friends, and medical personnel to oncoming seizures, potentially reducing the amount of prophylactic medications need by patients on a daily basis. As many of these medications can be toxic and accompanied by unpleasant, occasionally life-threatening side effects, any reduction in daily dosage can result in vast improvements in patient wellbeing and functionality. Furthermore, the predictive seizure detection device **100** can allow for the development of rescue protocols in some aspects, which could reduce the severity of an oncoming seizure or, in some

instances, prevent onset altogether, thus reducing or avoiding the damage that seizures can cause to the brain and the body of the patient.

[0044] Evidence indicates the presence of these seizure-indicative VOCs during the preictal (i.e., pre-seizure) stage, building in different patients at different times and at different levels of concentration based on the individual patient's metabolism and blood chemistry. Consequently, the timing of a predictive alert issued by the seizure-protection device **100** can necessarily vary from patient to patient. As a form of reference, the seizure-indicative VOCs can remain in the patient's system anywhere from about five to forty minutes postictal (i.e., post-seizure) based on the individual's metabolism.

[0045] Example aspects of the seizure detection device **100** can be on a small enough scale that the seizure detection device **100** can be easily transported with a patient as they go about daily activities, including working, exercising, eating, and sleeping. As such, various elements of the seizure detection device **100** (e.g., the column **340**, the processor, etc.) can be formed as miniature or micro versions of such elements.

[0046] In addition to seizures and epilepsy, many additional health conditions create their own unique combination of specific health-indicative volatile organic compounds **200**, the identification and detection of which can allow for prophylactic or palliative treatments of additional health concerns. According to example aspects, the VOC detection device **1005** can be configured to monitor specific VOCs **200** associated with additional health conditions. In some aspects, the health monitoring device **1000** can also be configured to monitor other biomarkers, such as blood oxygenation, blood pressure, pulse, heart rate variability, blood pressure, and body temperature, to allow for unprecedented efficacy and efficiency of health care.

[0047] FIG. 3 illustrates the health monitoring device **1000** in accordance with another aspect of the present disclosure. In the present aspect, the health monitoring device **1000** can be a wearable health monitoring device that can be attached to a user's body. For example, the health monitoring device **1000** can be a health monitoring wrist band **300**, as shown, arm band, or the like. The health monitoring wrist band **300** can be configured as a watch, a bracelet, or the like. According to example aspects, the health monitoring wrist band **300** can comprise the VOC detection device **1005** and can be configured to detect and analyze specific volatile organic compounds **200** (shown in FIG. 2) indicative of seizures and/or other health conditions, including but not limited to, migraines, strokes, stress, viral infections, and/or bacterial infections. In some aspects, the VOC detection device **1005** can comprise the seizure detection device **100** (shown in FIG. 1) that can detect and analyze the seizure-indicative VOCs **200**, as well as other health-indicative VOCs **200**, emitted from a user.

[0048] As shown, the health monitoring wrist band **300** can comprise a band **310** configured to wrap around and attach the health monitoring device **1000** to a user's wrist, allowing the user to easily transport the health monitoring device **1000** with them wherever they go. In other aspects, the band **310** can be configured to wrap around the user's arm, leg, ankle, chest, or any other suitable body part. According to example aspects, the health monitoring wrist band **300** can comprise the battery **180** or other power source, such as a lithium ion battery, for powering the health

monitoring device **1000**. As shown, a charging port **320** can be provided for recharging the battery **180**. Example aspects of the health monitoring wrist band **300** can comprise the sensor device **110** for collecting the VOCs **200**. The collector **120**, also known as the skin volatile collector, and the heater **228** of the sensor device **110** are visible in the present aspect. In the present aspect, the collector **120** can be formed as the patch **122** that can contact the user's skin **270** (shown in FIG. 2). In some aspects, the patch **122** can be configured to contact either the inside (palmar side) or the outside (dorsal side) of the user's wrist.

[0049] As described above, the sensor device **110** can be configured to collect VOCs **200**, which can then be analyzed to determine the presence and/or levels of specific VOCs associated with various health conditions. In example aspects, the sensor device **110** can comprise additional biomarker sensors **330** for detecting additional biomarkers. The additional biomarkers can be monitored for detection of seizures and/or other health conditions, or can simply be monitored for informational purposes. In the present aspect, the additional biomarker sensors **330** can comprise a temperature sensor **330a** for detecting temperature, a heart rate sensor **330b** for detecting pulse and/or heart rate variability, a blood pressure sensor **330c** for detecting blood pressure, and a blood oxygen sensor **330d** (e.g., a pulse oximeter) for detecting blood oxygen level. Other aspects of the sensor device **110** can comprise fewer biomarker sensors **330** or additional biomarker sensors **330** for detecting various other biomarkers.

[0050] The health monitoring wrist band **300** can further comprise the transfer tube **134** and the pump **132** configured to pump the collected VOCs **200** through the transfer tube **134** from the collector **120** to the separator **130**. As described above, the collected VOCs **200** can be injected into a carrier gas such as, for example, helium or nitrogen. In some aspects, the carrier gas can be stored in a pressurized cylinder or other gas vessel. A small gas plug (e.g., a sample of the carrier gas and VOC mixture) can be injected into the gas chromatography column(s) **340** of the separator **130**. The column **340** is shown mounted to the die **136**. In the present aspect, the column **340** can be a μ GCxGC column, and the gas plug can undergo a two-dimensional μ GCxGC separation. The identifier **150** (e.g., the IMS detector **152**) can then sense the chemicals eluting from the column **340** and can transduce the chemical information to a recordable signal. In the present aspect, the IMS detector **152** can be a CIMS (Correlation Ion Mobility Spectrometer) detector. According to example aspects, the charging port **320** can also serve as a computer input port, allowing the health monitoring device **1000** to be connected to a computer to transfer the data recorded by the health monitoring device **1000** to the computer. In some aspects, the health monitoring device **1000** can also or alternatively be connected to a smart phone, tablet, or any other suitable electronic device via the charging port **320**. In some aspects, the health monitoring device **1000** can be wireless connected to the computer or other electronic device.

[0051] As shown, example aspects of the health monitoring device **1000** can comprise one or more exhaust portals **350** configured to release the gas plug into the atmosphere after analysis by the identifier **150**. Furthermore, according to example aspects, the health monitoring device **1000** can further comprise a display **360** configured to display information related to at least one of the collected volatile organic

compounds (such as the concentration levels of the relevant VOCs) and the detected biomarker(s). For example, the display **360** can show the detected levels or indicate the presence of various health-indicative VOCs, and/or can show pulse, heart rate variability, blood oxygen level, blood pressure, temperature, and any biomarker detected by the health monitoring device **1000**. In some aspects, the display **360** can display an alert message if the detected VOCs and/or biomarkers are outside of a normal range. Example aspects of the health monitoring device **1000** can further comprise a control mechanism, such as a control button **370**. For example, in the present aspect, the control button **370** can be a hardware and fluid control button, which can be configured to control rebooting the health monitoring device **1000** and releasing moisture from the health monitoring device **1000** through the exhaust portals **350**. In other aspects, the control button **370** can be configured to control additional or alternative aspects of the health monitoring device **1000**.

[0052] In example aspects, the health monitoring device **1000** can be configured as its own platform, such as the seizure detection device **100** of FIG. 1 or the health monitoring wrist band **300** of FIG. 3. The health monitoring device **1000** can alternatively be configured as any other suitable platform, including but not limited to, a desktop unit, laptop unit, tablet unit, mobile phone unit, or the like. In some aspects, such as the desktop unit aspect, the user can swab their skin **270** (shown in FIG. 2), such as the skin on their hand, on the collector **120** to obtain a VOC sample, and the sample can be run through the desktop unit for analysis. In another aspects, a user can simply hold their skin **270** near the collector **120** to obtain the VOC sample. The varying platforms of the health monitoring device **1000** can also comprise any of the biomarker sensors **330** for detecting other biomarkers, such as body temperature, pulse, heart rate variability, blood oxygen level, and blood pressure, which can be detected by the user placing their skin (for example, the skin on their hand or wrist), against or proximate to the varying biomarker sensors **330**. Furthermore, in other aspects, the health monitoring device **1000** can be integrated with an existing platform, such as an existing desktop computer, laptop computer, tablet, mobile phone, watch, or the like.

[0053] Thus, a method of monitoring a user's health can comprise collecting the volatile organic compounds **200** from a user with the collector material **226** of the collector **120**, separating the mixture of the volatile organic compounds **200** into its constituent chemicals with the gas chromatography column **340**, transducing the constituent chemicals into a signal, and analyzing the signal to identify the volatile organic compounds **200** that are indicative of a health condition.

[0054] The method can further comprise transferring the volatile organic compounds **200** from the collector **120** to the gas chromatography column **340**, which can comprise emitting a thermal pulse from the heater **228** to desorb the volatile organic compounds **200** from the collector **120** and pumping the volatile organic compounds **200** through the transfer tube **134** from the collector **120** to the gas chromatography column **340**. Example aspects of the method can further comprise detecting a biomarker of the user with the biomarker sensor **330**. In some aspects, the biomarker sensor can be selected from one of the temperature sensor **330a**, the heart rate sensor **330b**, the blood pressure sensor **330c**, and

the blood oxygen sensor **330d**. Additionally, in example aspects, the health monitoring device **1000** can comprise the collector **120** and the gas chromatography column **340**, and can further comprise the band **310** configured to attach the health monitoring device **1000** to the user's body.

[0055] One should note that conditional language, such as, among others, “can,” “could,” “might,” or “may,” unless specifically stated otherwise, or otherwise understood within the context as used, is generally intended to convey that certain embodiments include, while other embodiments do not include, certain features, elements and/or steps. Thus, such conditional language is not generally intended to imply that features, elements and/or steps are in any way required for one or more particular embodiments or that one or more particular embodiments necessarily include logic for deciding, with or without user input or prompting, whether these features, elements and/or steps are included or are to be performed in any particular embodiment.

[0056] It should be emphasized that the above-described embodiments are merely possible examples of implementations, merely set forth for a clear understanding of the principles of the present disclosure. Any process descriptions or blocks in flow diagrams should be understood as representing modules, segments, or portions of code which include one or more executable instructions for implementing specific logical functions or steps in the process, and alternate implementations are included in which functions may not be included or executed at all, may be executed out of order from that shown or discussed, including substantially concurrently or in reverse order, depending on the functionality involved, as would be understood by those reasonably skilled in the art of the present disclosure. Many variations and modifications may be made to the above-described embodiment(s) without departing substantially from the spirit and principles of the present disclosure. Further, the scope of the present disclosure is intended to cover any and all combinations and sub-combinations of all elements, features, and aspects discussed above. All such modifications and variations are intended to be included herein within the scope of the present disclosure, and all possible claims to individual aspects or combinations of elements or steps are intended to be supported by the present disclosure.

That which is claimed is:

1. A wearable health monitoring device comprising:
 - a band configured to attach the wearable health monitoring device to a user's body;
 - a VOC detection device configured to collect and analyze volatile organic compounds given off from the user's skin to identify specific health-indicative volatile organic compounds indicative of a health condition; and
 - a biomarker sensor configured to detect a biomarker of the user.
2. The wearable health monitoring device of claim 1, further comprising a display configured to display information related to at least one of the biomarker and the volatile organic compounds.
3. The wearable health monitoring device of claim 2, wherein the band is a wristband configured to attach to a user's wrist.
4. The wearable health monitoring device of claim 3, wherein:
 - the VOC detection device comprises a collector;

- the collector comprises a collector material configured to collect the volatile organic compounds given off from the user's skin;

- the display is disposed at a first side of the wristband and the collector material is disposed at a second side of the wristband substantially opposite the first side;

- the collector material is configured to confront a palmar side of the user's wrist; and

- the display is configured to confront a dorsal side of the user's wrist.

5. The wearable health monitoring device of claim 4, wherein the collector further comprises an outer layer and an inner layer, the inner layer configured to prevent the collector material from contacting the user's skin, the collector material received between the outer layer and the inner layer.

6. The wearable health monitoring device of claim 5, wherein the inner layer is a mesh layer.

7. The wearable health monitoring device of claim 5, wherein the collector further comprises a heater comprising a heating element, the heating element configured to emit a thermal pulse to desorb the volatile organic compounds from the collector material.

8. The wearable health monitoring device of claim 4, wherein the VOC detection device further comprises an identifier comprising a processor, the processor configured to process information about the volatile organic compounds to identify the specific health-indicative volatile organic compounds.

9. The wearable health monitoring device of claim 8, wherein:

- the wearable health monitoring device further comprises a separator comprising a gas chromatography column configured to separate mixtures of the volatile organic compounds into their constituent chemicals; and

- the identifier further comprises a detector configured to transduce the constituent chemicals; and

- the processor is configured to process information about the transduced chemicals to identify the specific health-indicative volatile organic compounds.

10. The wearable health monitoring device of claim 9, further comprising a pump and a transfer tube, the pump configured to pump the volatile organic compounds through the transfer tube from the collector to the separator.

11. The wearable health monitoring device of claim 4, wherein the biomarker sensor is selected from one of a temperature sensor, a heart rate sensor, a blood pressure sensor, and a blood oxygen sensor.

12. The wearable health monitoring device of claim 11, wherein the biomarker sensor is a first biomarker sensor, and wherein the wearable health monitoring device further comprises a second biomarker sensor selected from another of the temperature sensor, the heart rate sensor, the blood pressure sensor, and the blood oxygen sensor.

13. The wearable health monitoring device of claim 11, wherein the biomarker sensor is configured to confront the palmar side of the user's wrist.

14. The wearable health monitoring device of claim 4, wherein the biomarker sensor is a temperature sensor.

15. The wearable health monitoring device of claim 4, wherein the biomarker sensor is a heart rate sensor.

16. The wearable health monitoring device of claim 4, wherein the biomarker sensor is a blood pressure sensor.

17. The wearable health monitoring device of claim 4, wherein the biomarker sensor is a blood oxygen sensor.

18. The wearable health monitoring device of claim **1**, wherein the specific health-indicative volatile organic compounds comprise at least one seizure-indicative volatile organic compound.

* * * * *