



US 20170328647A1

(19) **United States**

(12) **Patent Application Publication**
Aston et al.

(10) **Pub. No.: US 2017/0328647 A1**

(43) **Pub. Date: Nov. 16, 2017**

(54) **COMPOSITE HEAT PIPES AND SANDWICH PANELS, RADIATOR PANELS, AND SPACECRAFT WITH COMPOSITE HEAT PIPES**

(71) Applicant: **The Boeing Company**, Chicago, IL (US)

(72) Inventors: **Richard W. Aston**, Brea, CA (US);
Anna Maria Tomzynska, Seal Beach, CA (US)

(21) Appl. No.: **15/153,386**

(22) Filed: **May 12, 2016**

Publication Classification

(51) **Int. Cl.**
F28D 15/02 (2006.01)
B64G 1/50 (2006.01)
B64G 1/50 (2006.01)

F28D 15/04 (2006.01)
B23P 15/26 (2006.01)
(52) **U.S. Cl.**
CPC **F28D 15/0275** (2013.01); **F28D 15/04** (2013.01); **B23P 15/26** (2013.01); **B64G 1/503** (2013.01); **B64G 1/506** (2013.01)

(57) **ABSTRACT**

Composite heat pipes, methods of assembling composite heat pipes, sandwich panels having one or more composite heat pipes, methods of assembling sandwich panels, radiator panels, methods of assembling radiator panels, spacecraft, and methods of assembling spacecraft are disclosed. Composite heat pipes include an elongate conductive casing and one or more fiber reinforced composite layers operatively coupled to one or more lateral sides of the elongate conductive casing. Sandwich panels include two spaced-apart face-sheets, a core positioned between the two spaced-apart face-sheets, and one or more composite heat pipes. Spacecraft include a body and two radiator panels operatively coupled to the body opposite each other.

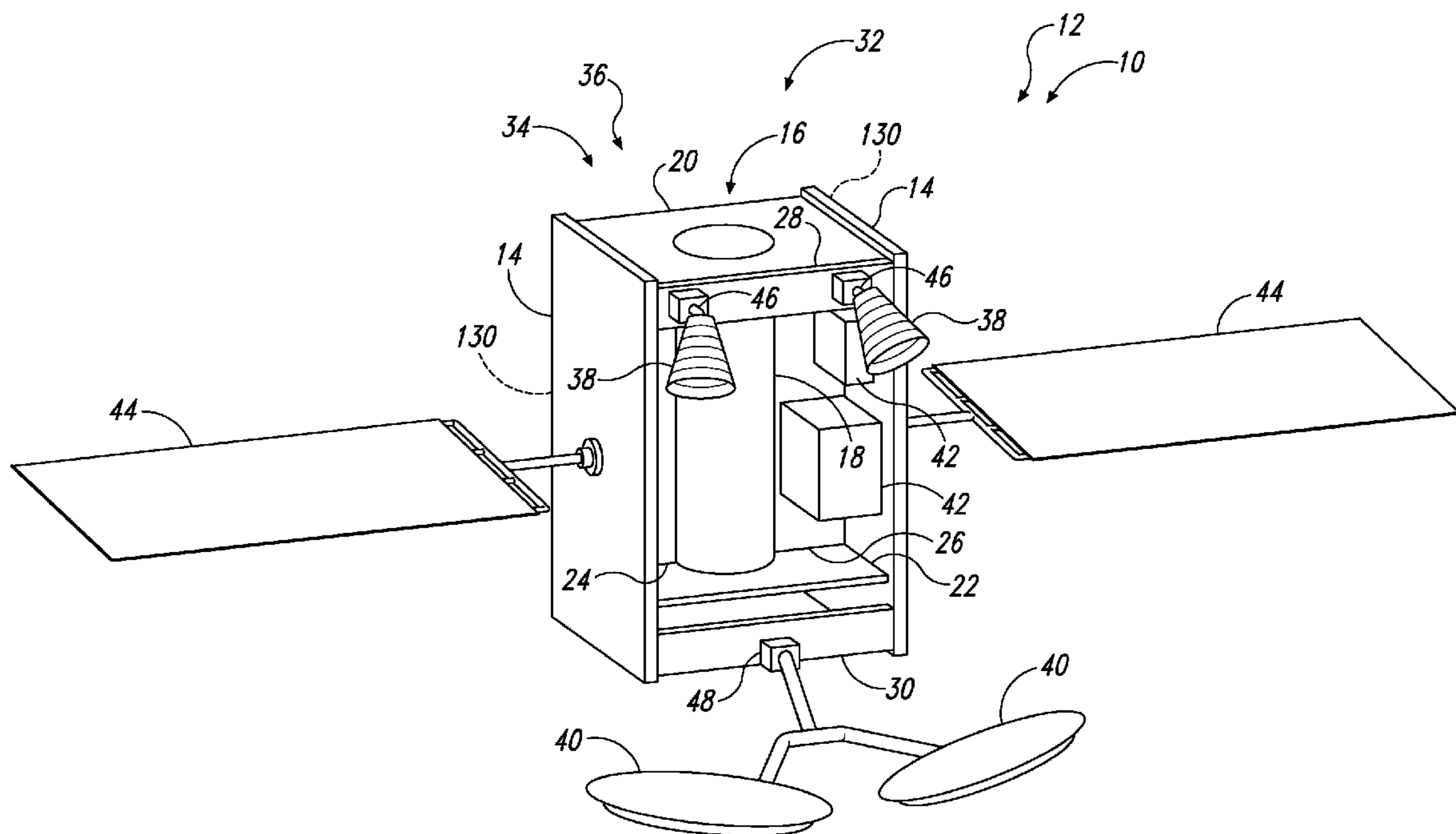

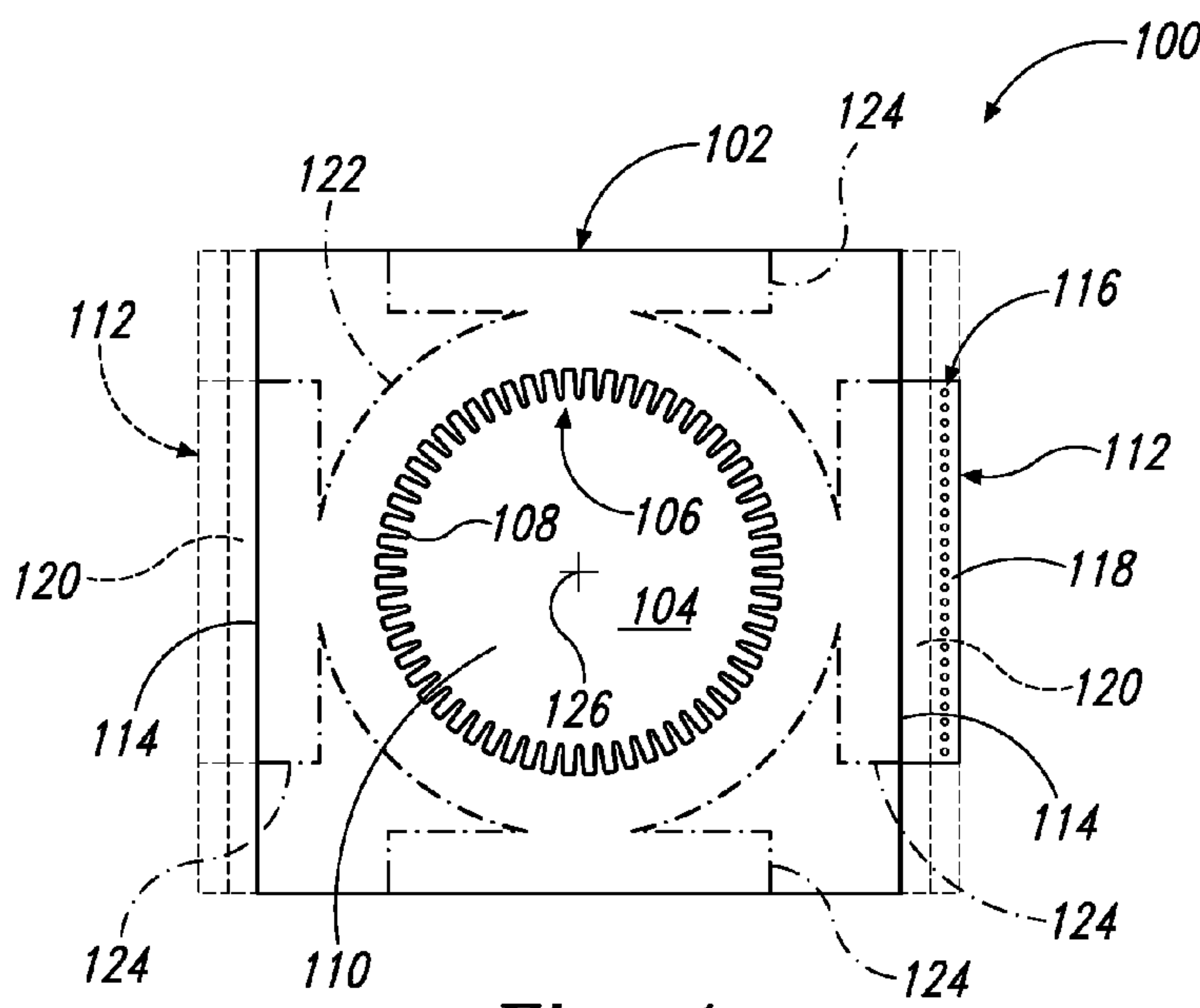

Fig. 1

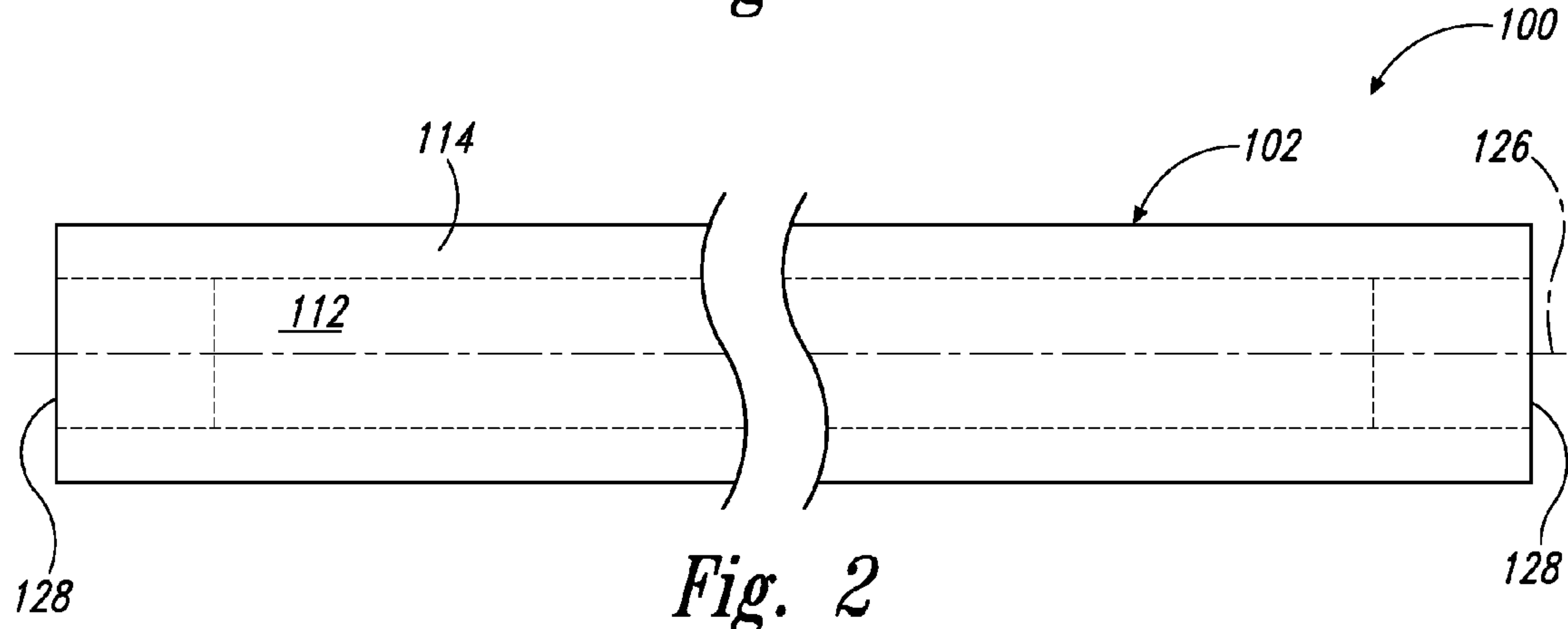

Fig. 2

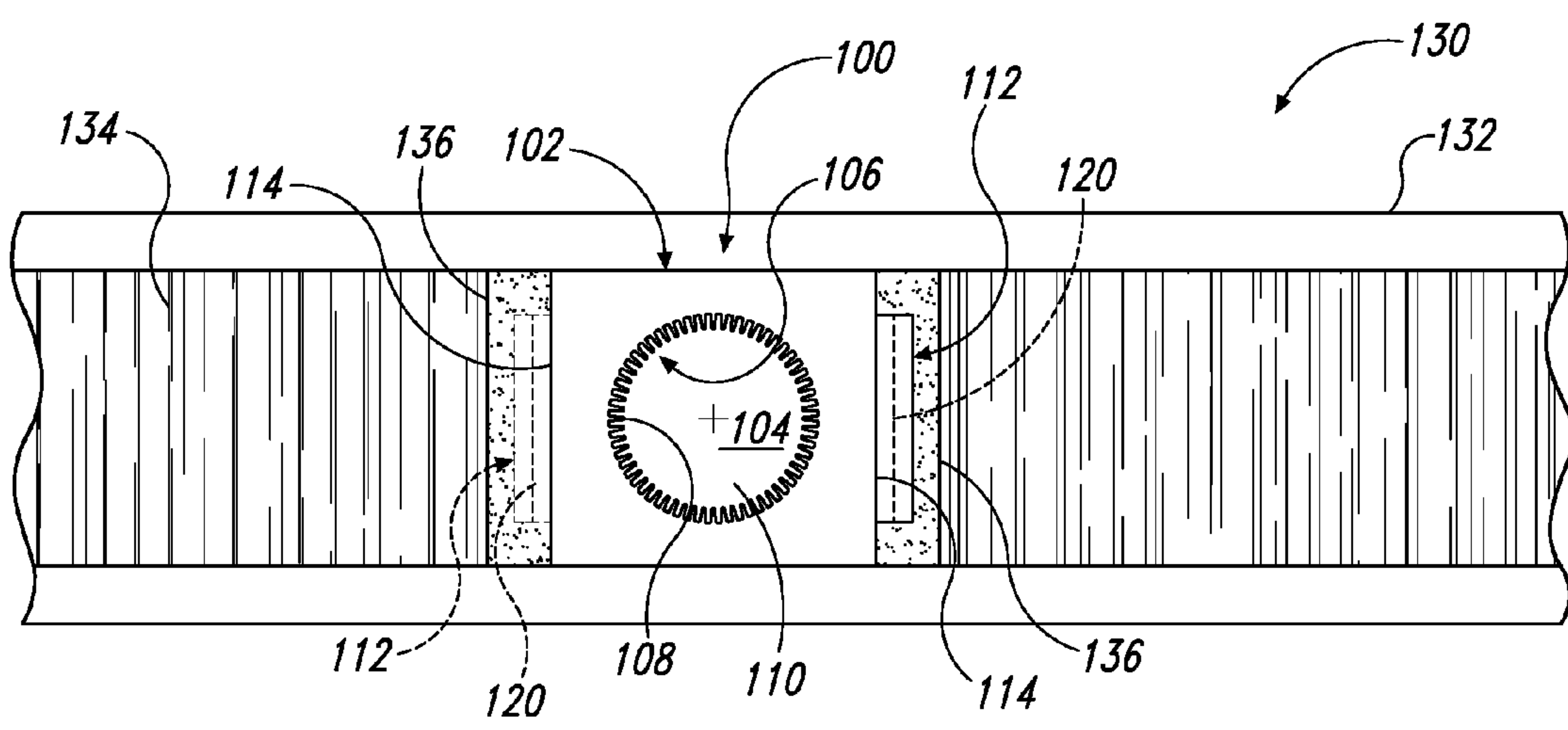

Fig. 3

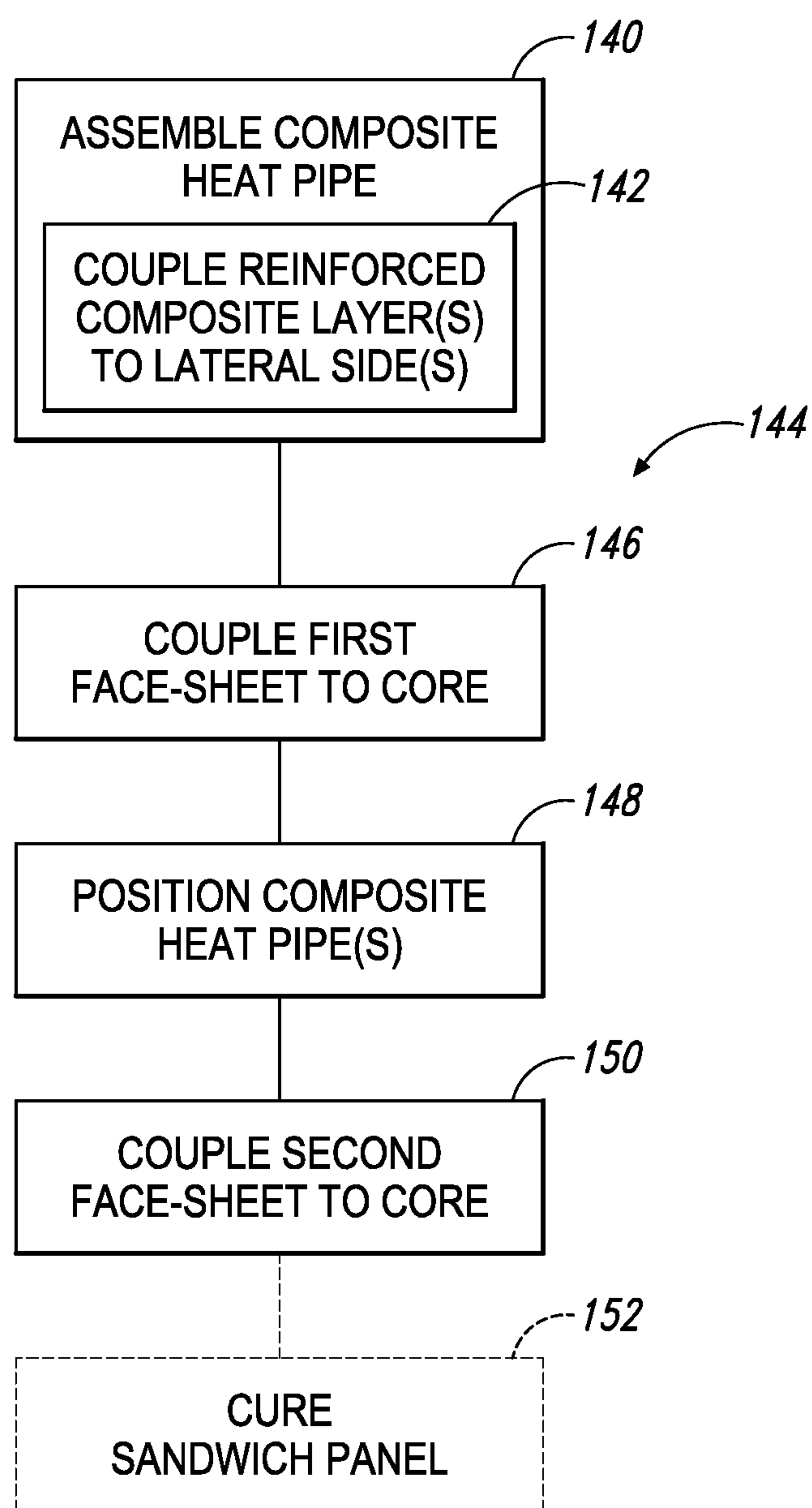

Fig. 4

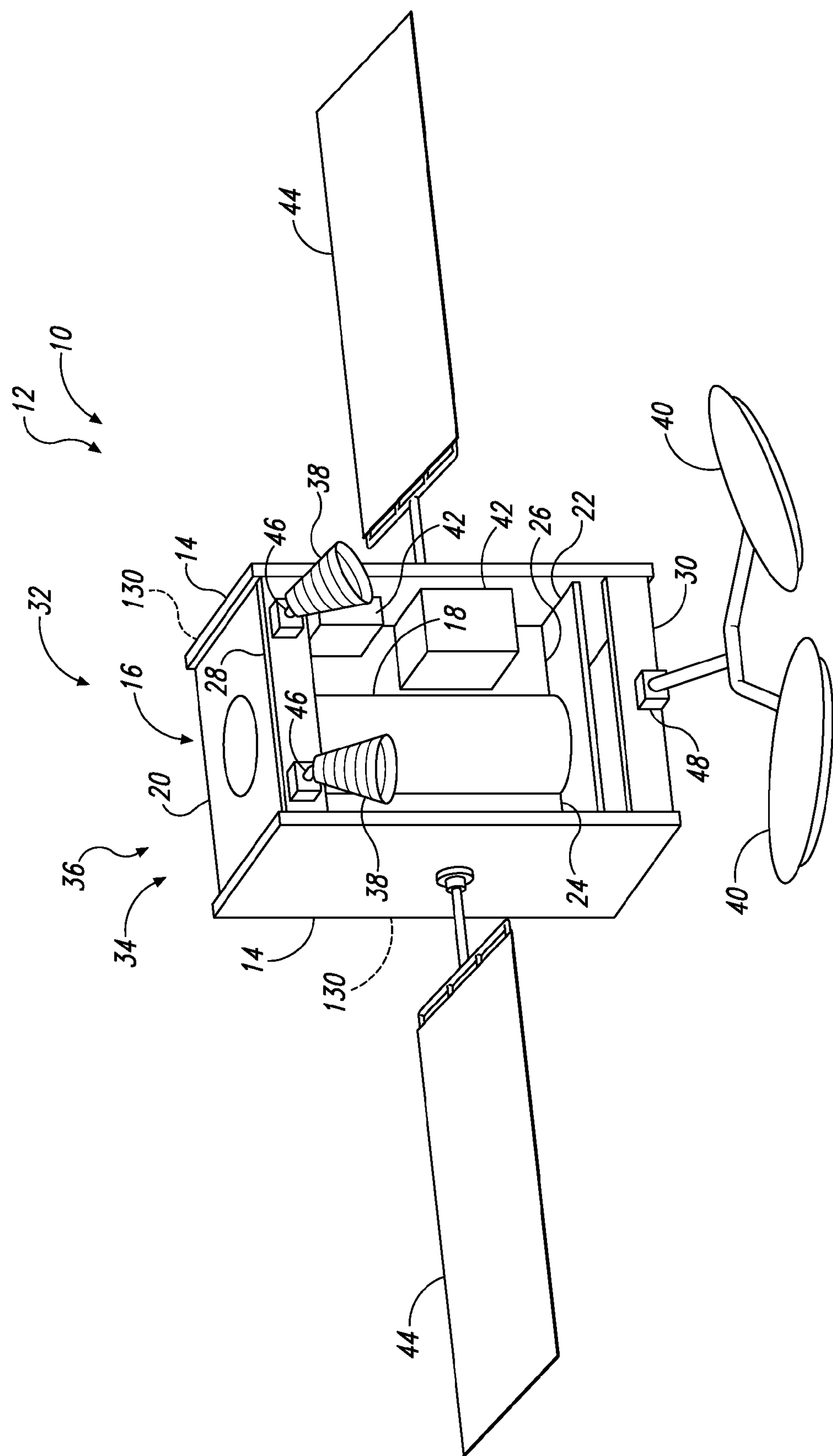

Fig. 5

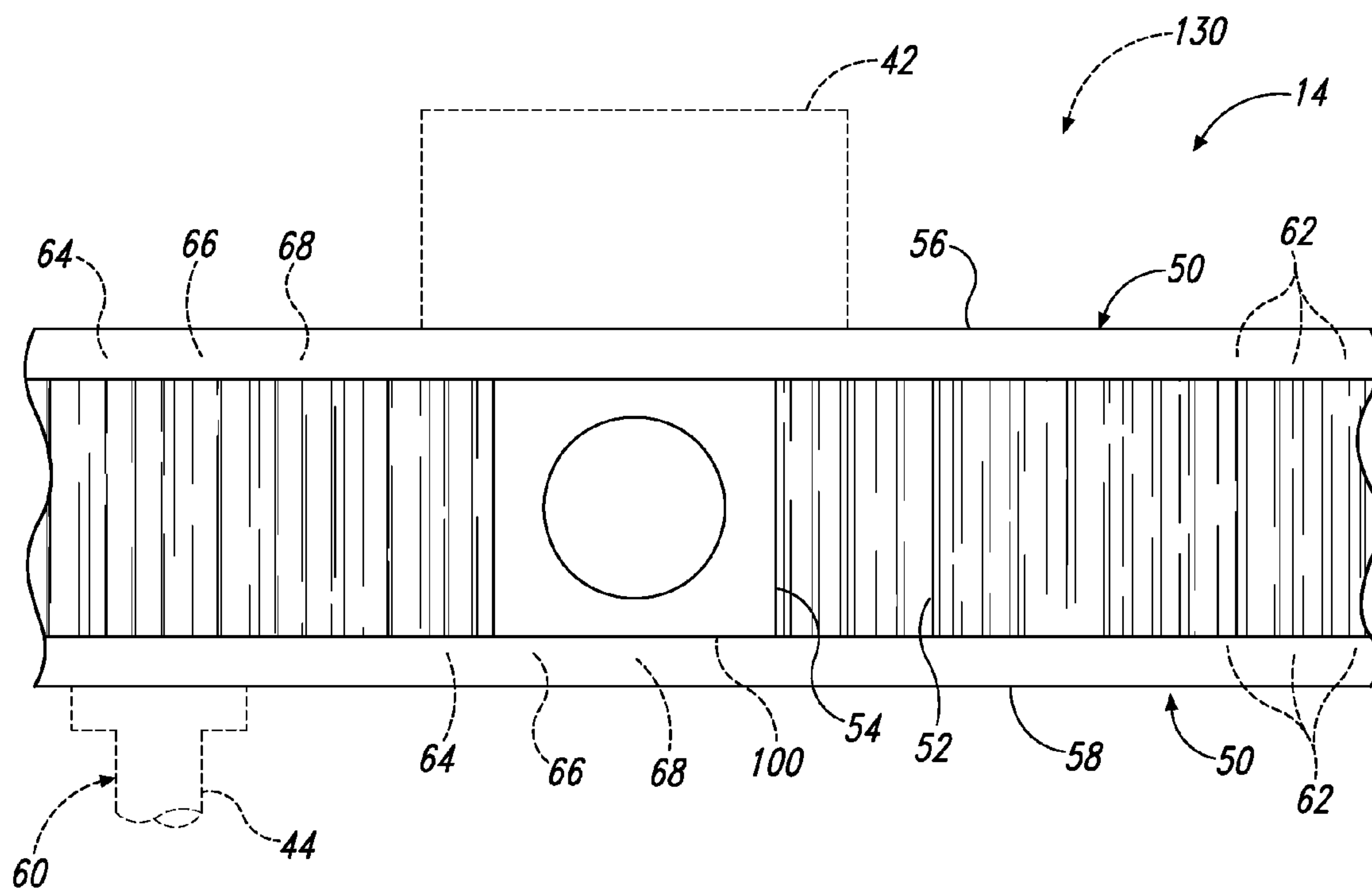

Fig. 6

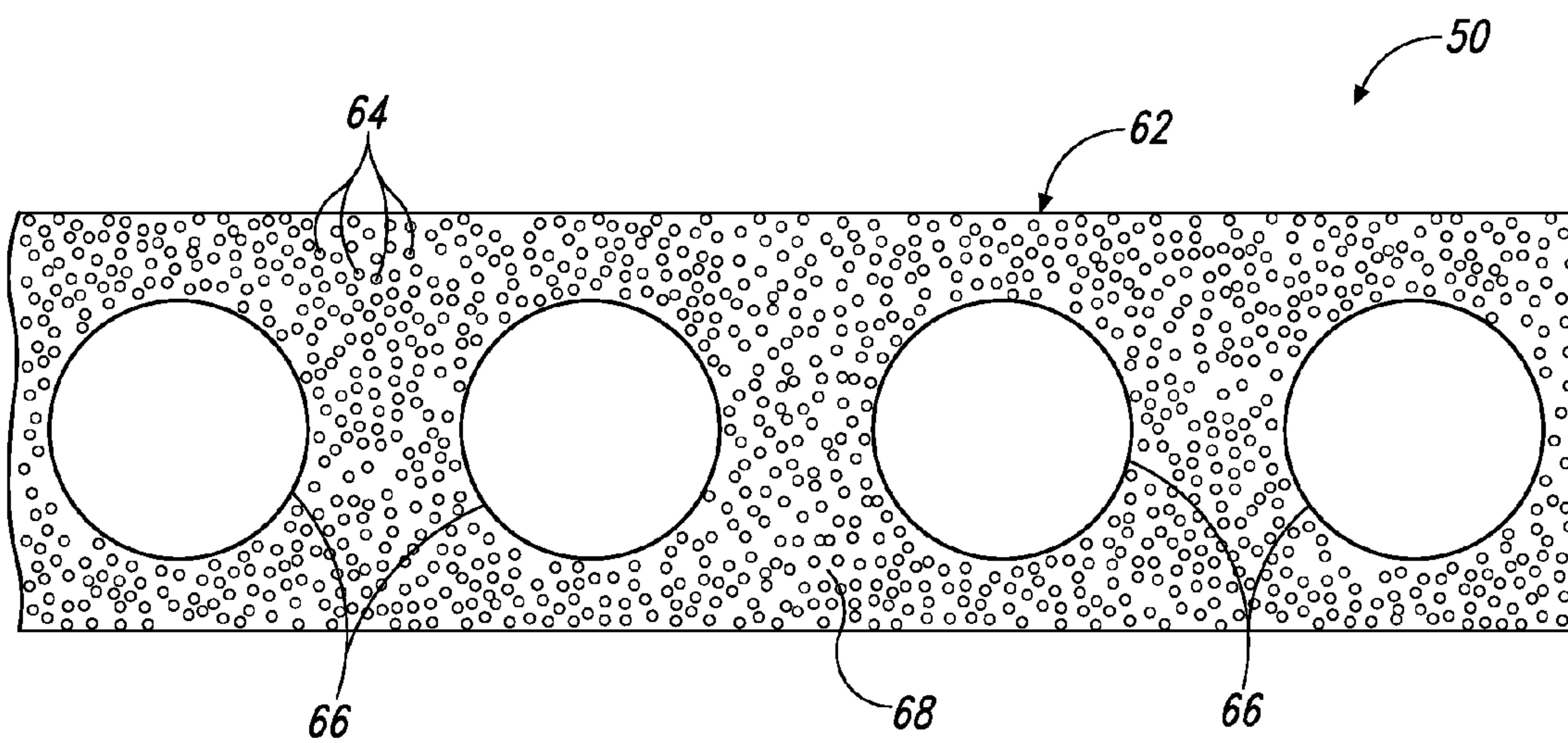

Fig. 7

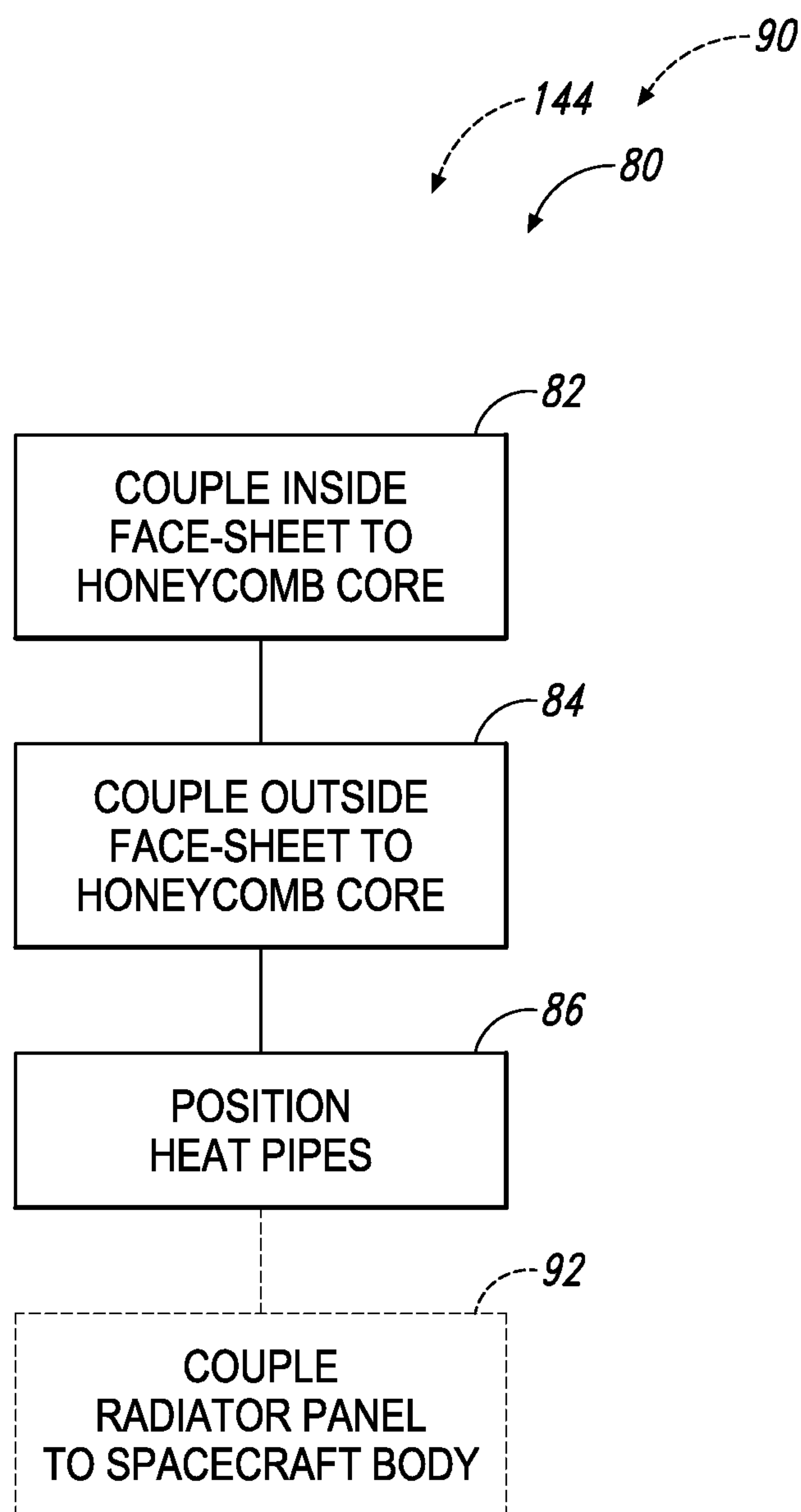

Fig. 8

COMPOSITE HEAT PIPES AND SANDWICH PANELS, RADIATOR PANELS, AND SPACECRAFT WITH COMPOSITE HEAT PIPES

FIELD

[0001] The present disclosure relates to heat pipes and to radiator panels that include heat pipes.

BACKGROUND

[0002] Heat pipes are heat transfer devices that rely on phase transition of a working fluid to transfer heat from one location to another, such as from an electronic device to a heat sink. Heat pipes may be constructed of various materials depending on an application for the heat pipe, but typically the bodies of heat pipes are constructed of a metal, such as aluminum, due to its heat transfer characteristics and density. As an example, heat pipes are often used to draw heat away from electronic equipment to prevent the electronic equipment from overheating. In some applications, thermal expansion and contraction of heat pipes due to extreme temperature changes may be undesirable.

[0003] Spacecraft include a plethora of equipment, such as electronic equipment, that generates heat. This heat must be dissipated, and because space is essentially void of air, the heat must be radiated to outer space. Spacecraft, such as satellites, typically include radiator panels that draw the heat from electronics and other equipment to an outer surface of the spacecraft. Thermal expansion and contraction of a radiator panel may affect the precision of a spacecraft's communication equipment's pointing to Earth and/or to another spacecraft or other object in outer space. For some spacecraft, the precise pointing of communication equipment is critical to its function. Historically, radiator panels have been constructed of materials that have similar coefficients of thermal expansion (CTE) so as to minimize distortions of the radiator panels due to thermal imbalance and thus to minimize the effect on the pointing of communication equipment. Additionally, radiator panels historically have been used as a ground, or power return, for electronic equipment, including communication equipment, that is supported by radiator panels. Accordingly, radiator panels historically have been constructed with aluminum honeycomb cores sandwiched between aluminum face-sheets and with aluminum heat pipes extending through the cores.

SUMMARY

[0004] Composite heat pipes, methods of assembling composite heat pipes, sandwich panels having one or more composite heat pipes, methods of assembling sandwich panels, radiator panels, methods of assembling radiator panels, spacecraft, and methods of assembling spacecraft are disclosed herein.

[0005] Composite heat pipes include an elongate conductive casing that defines an internal volume having an outer peripheral region, a wick structure positioned within the outer peripheral region of the internal volume of the elongate conductive casing, a working fluid within the internal volume of the outer peripheral region, and one or more fiber reinforced composite layers operatively coupled to one or more external, lateral sides of the elongate conductive casing. Each fiber reinforced composite layer comprises a

plurality of elongate fibers longitudinally aligned with the elongate conductive casing and operatively coupled together by a binding material. Methods of assembling composite heat pipes include operatively coupling one or more fiber reinforced composite layers to one or more external, lateral sides of an elongate conductive casing.

[0006] Sandwich panels include two spaced-apart face-sheets, a core positioned between the two spaced-apart face-sheets, and one or more composite heat pipes. Methods of assembling sandwich panels include operatively coupling a first face-sheet to a core, operatively coupling a second face-sheet to the core opposite the first face-sheet, and operatively positioning one or more composite heat pipes between the first face-sheet and the second face-sheet.

[0007] Radiator panels include two spaced-apart face-sheets including an inside face-sheet and an outside face-sheet that are constructed of a fiber reinforced composite material, a honeycomb core positioned between the two spaced-apart face-sheets, and one or more heat pipes extending through the honeycomb core. The fiber reinforced composite material of the face-sheets includes two different types of fibers. Methods of assembling radiator panels include operatively coupling an inside face-sheet to a honeycomb core, operatively coupling an outside face-sheet to the honeycomb core opposite the inside face-sheet, and operatively positioning one or more heat pipes between the inside face-sheet and the outside face-sheet.

[0008] Spacecraft include a body and two radiator panels operatively coupled to the body opposite each other. Methods of assembling spacecraft include operatively coupling a radiator panel to a body of the spacecraft.

BRIEF DESCRIPTION OF THE DRAWINGS

[0009] FIG. 1 is a schematic profile view representing composite heat pipes according to the present disclosure.

[0010] FIG. 2 is a schematic side view representing composite heat pipes according to the present disclosure.

[0011] FIG. 3 is a schematic profile view representing sandwich panels having at least one composite heat pipe according to the present disclosure.

[0012] FIG. 4 is a flowchart schematically representing methods according to the present disclosure.

[0013] FIG. 5 is an isometric view of an example spacecraft that includes two radiator panels according to the present disclosure.

[0014] FIG. 6 is a schematic profile view representing radiator panels according to the present disclosure.

[0015] FIG. 7 is a schematic profile view representing a single ply of a face-sheet of a radiator panel according to the present disclosure.

[0016] FIG. 8 is a flowchart schematically representing methods according to the present disclosure.

DESCRIPTION

[0017] Composite heat pipes, methods of assembling composite heat pipes, sandwich panels having one or more composite heat pipes, methods of assembling sandwich panels, radiator panels, methods of assembling radiator panels, spacecraft, and methods of assembling spacecraft are disclosed herein.

[0018] FIGS. 1 and 2 schematically illustrate composite heat pipes 100 according to the present disclosure. Composite heat pipes 100 include an elongate conductive casing

102, a wick structure **108**, a working fluid **110**, and one or more fiber reinforced composite layers **112**. The elongate conductive casing **102** defines an internal volume **104** having an outer peripheral region **106**. The wick structure **108** is positioned within the outer peripheral region **106**, and the working fluid **110** is within the internal volume **104**. The one or more fiber reinforced composite layers **112** are operatively coupled to one or more external, lateral sides **114** of the elongate conductive casing **102**.

[0019] The elongate conductive casing **102** is schematically represented in solid lines in FIG. 1 with a square profile; however, any suitable profile shape of elongate conductive casing **102** is within the scope of the present disclosure, including, for example, a circular profile or, as schematically represented in FIG. 1 in dash-dot lines, a flanged configuration with a body **122** having a circular profile and four planar extensions **124** spaced-apart around and extending longitudinally along the body **122**. The elongate conductive casing **102** may be constructed of any suitable material that has desirable thermal conductive properties for a particular application, with aluminum, copper, and steel being illustrative, non-exclusive examples. In some examples, the elongate conductive casing **102** may be formed by an extrusion process. In some such examples, the wick structure **108** may be integrally formed with the elongate conductive casing **102** to form a monolithic structure.

[0020] The wick structure **108** of composite heat pipes **100** may take any suitable form depending on a particular application of a composite heat pipe **100**, including (but not limited to) sintered metal powders, screens, and grooves. The schematic representation of composite heat pipes **100** generally shows the wick structure **108** in the form of grooves that are integral with the elongate conductive casing **102**, but composite heat pipes **100** are not limited to such examples, and other configurations of wick structures **108** may be incorporated into composite heat pipes **100** according to the present disclosure.

[0021] The working fluid **110** of composite heat pipes **100** may take any suitable form depending on a particular application of a composite heat pipe **100**, with water, refrigerant, ammonia, alkali metals, nitrogen, oxygen, neon, hydrogen, helium, methanol, ethane, and lithium being illustrative, non-limiting examples.

[0022] As mentioned, composite heat pipes **100** include one or more fiber reinforced composite layers **112** that are operatively coupled to one or more external, lateral sides **114** of the elongate conductive casing **102**. A lateral side **114** of an elongate conductive casing **102** is an external side that is parallel to a longitudinal axis **126** of the elongate conductive casing **102**, for example, in contrast to an end face **128** of the composite heat pipe **100**. In some examples, a lateral side **114** may be planar, but such a configuration is not required in all examples of elongate conductive casings **102**, such as in a composite heat pipe **100** having an elongate conductive casing **102** with a circular profile.

[0023] As schematically illustrated in FIG. 1, each fiber reinforced composite layer **112** includes a plurality of elongate fibers **116** that are longitudinally aligned with the elongate conductive casing **102** and that are operatively coupled together by a binding material **118**. In other words, the elongate fibers **116** are generally parallel to the longitudinal axis **126** of the elongate conductive casing **102**. In some examples, the elongate fibers **116** may be described as

being unidirectional. By being elongate and unidirectional, the elongate fibers **116**, and thus the one or more fiber reinforced composite layers **112** may provide desirable thermal and strength characteristics to the composite heat pipe **100**, as a whole.

[0024] A fiber reinforced composite layer **112** may be constructed in any suitable manner, such as based on manufacturability, ultimate applications, typical temperatures to which a composite heat pipe **100** will be exposed, etc. For example, a fiber reinforced composite layer **112** may comprise and/or be described as a film or a laminate. In some examples, a fiber reinforced composite layer **112** may be described as being formed from a prepreg. Additionally or alternatively, the binding material **118** may comprise an adhesive tape, and the elongate fibers **116** may be adhered to a face of the adhesive tape and/or may be embedded in the adhesive tape. Additionally or alternatively, in some examples, the elongate fibers **116** may be within a matrix of the binding material **118**. The binding material **118** may be any suitable material, depending on the ultimate application of the composite heat pipe **100**, for example, depending on the temperature ranges to which the composite heat pipe **100** is exposed. Illustrative, non-exclusive examples of binding material **118** include (but are not limited to) epoxy, cyanate ester, polyimide, bismaleimide resin, and phenolic resin.

[0025] In some examples of fiber reinforced composite layers **112**, the elongate fibers **116** comprise a density of 0.05-0.10lbs/in.³ within the fiber reinforced composite layer **112**.

[0026] In some examples of fiber reinforced composite layers **112**, and as schematically represented in FIG. 1, the elongate fibers **116** are spaced-apart within the fiber reinforced composite layer **112**.

[0027] The elongate fibers **116** of a fiber reinforced composite layer **112** may be of any suitable material and size such that the elongate fibers **116** have desired properties for a particular application of a composite heat pipe **100**. Illustrative, non-exclusive examples of elongate fibers **116** include (but are not limited to) boron fibers and high strength carbon fibers. In some examples, the elongate fibers **116** have an average diameter in the range of 50-200 μm , 50-150 μm , 50-100 μm , 100-200 μm , 100-150 μm , or 150-200 μm .

[0028] Moreover, in some examples of composite heat pipes **100**, the elongate fibers **116** may be constructed of a material that has tensile and compression strengths that are different than tensile and compression strengths of the material from which the elongate conductive casing **102** is constructed. For example, tensile and/or compression strengths of the elongate fibers **116** may be at least 1.5, at least 2, at least 5, or at least 10 times tensile and/or compression strengths of the elongate conductive casing **102**. As an illustrative, non-limiting example, the elongate fibers **116** may have a tensile strength and/or a compression strength in the range of 500-600ksi. As a result of the elongate fibers **116**, and thus the fiber reinforced composite layer(s) **112**, having a tensile strength and/or a compression strength that differs from a tensile strength and/or a compression strength of the elongate conductive casing **102**, the composite heat pipe **100**, as a whole, may have resultant physical properties that are desirable for using the composite heat pipes **100** in certain applications that are subject to extreme temperature changes. For example, in the application of a composite heat pipe **100** being used in a radiator panel, such as a radiator panel of a spacecraft, deformation

of the radiator panel as a result of an extreme temperature change may be detrimental to the performance of the spacecraft, and a composite heat pipe 100 may diminish or otherwise restrict, or even prevent, undesirable deformation as a result of tensile and/or compression strengths of the elongate fibers 116. Accordingly, a fiber reinforced composite layer 112 may be described as a strap, a restraining strap, and/or a composite restraining strap.

[0029] That is, as a result of the elongate conductive casing 102 having different tensile and/or compression strengths than the elongate fibers 116 and the fiber reinforced composite layer(s) 112, the overall coefficient of thermal expansion of the composite heat pipe may be 25-75%, 30-70%, 40-60%, or about 50% of the coefficient of thermal expansion of the elongate conductive casing 102 by itself, or of a heat pipe that does not include one or more fiber reinforced composite layers 112 according to the present disclosure. As an illustrative example only, an aluminum heat pipe without one or more fiber reinforced composite layers 112 operatively coupled to the heat pipe's casing may have a coefficient of thermal expansion of about 12.5 ppm/° F. In contrast, a composite heat pipe 100 according to the present disclosure with an aluminum elongate conductive casing 102 and one or more fiber reinforced composite layers 112 operatively coupled to lateral sides 114 of the elongate conductive casing 102 may have a coefficient of thermal expansion in the range of 5-7.5ppm/° F.

[0030] With continued reference to FIG. 1, as schematically illustrated in solid lines, composite heat pipes 100 include at least one fiber reinforced composite layer 112 that is operatively coupled to a lateral side 114 of the elongate conductive casing 102. As schematically represented in dashed lines in

[0031] FIG. 1, a composite heat pipe 100 may include two fiber reinforced composite layers 112 that are operatively coupled to opposing external, lateral sides 114 of the elongate conductive casing 102. Such a configuration may be desirable, for example, to restrict undesirable stresses within the elongate conductive casing 102 that otherwise may result when subjected to temperature changes. However, it also is within the scope of the present disclosure that fiber reinforced composite layers 112 are coupled to more than two external, lateral sides 114, and even, optionally, fiber reinforced composite layers 112 that extend, or wrap, completely around the elongate conductive casing 102.

[0032] A fiber reinforced composite layer 112 may span an entire width of a lateral side 114, such as schematically represented in FIG. 1 in dashed lines. However, such a configuration is not required, and additionally or alternatively, a fiber reinforced composite layer 112 may span less than an entire width of a lateral side 114, such as schematically represented in FIG. 1 in solid lines. Similarly, a fiber reinforced composite layer 112 may span an entire length of a lateral side 114 or may span less than an entire length of a lateral side 114. In some examples, a fiber reinforced composite layer 112 may be coextensive, or substantially coextensive, with a lateral side 114, and in other examples, a fiber reinforced composite layer 112 may not be coextensive, or substantially coextensive, with a lateral side 114. The schematic representations of FIGS. 1 and 2 are intended to schematically represent any such configurations of fiber reinforced composite layers 112 relative to lateral sides 114.

[0033] As mentioned, in a composite heat pipe 100, a fiber reinforced composite layer 112 is operatively coupled to an

external, lateral side 114 of the elongate conductive casing 102. By “operatively coupled,” it is meant that the fiber reinforced composite layer 112 may be directly engaging, or touching, a lateral side 114 of the elongate conductive casing 102, or that the fiber reinforced composite layer 112 may be indirectly coupled, and not directly engaging, or touching, a lateral side 114 of the elongate conductive casing 102. For example, when the binding material 118 of a fiber reinforced composite layer 112 comprises an adhesive tape, the adhesive tape may be directly adhered to a lateral side 114 of the elongate conductive casing 102. However, as schematically and optionally illustrated in dashed lines in FIG. 1, a composite heat pipe 100 may further include a separate adhesive layer 120 that is between a fiber reinforced composite layer 112 and a lateral side 114 of the elongate conductive casing 102.

[0034] When present, the adhesive layer 120 may be constructed of any suitable adhesive material, including (but not limited to) an epoxy adhesive, depending on the application of the composite heat pipe 100 and the temperatures to which the composite heat pipe 100 may be subjected. In some applications, it may be desirable to utilize a desired thickness of adhesive, such as with the adhesive layer 120 having a thickness of 0.005-0.025 inches. For example, in some applications, it may be desirable for the adhesive layer 120 to absorb strain between the elongate conductive casing 102 and the fiber reinforced composite layer 112 when the composite heat pipe 100 is subject to temperature changes.

[0035] Turning now to FIG. 3, composite heat pipes 100 may be used as a structural component of a sandwich panel 130. More specifically, a sandwich panel 130 includes two spaced-apart face-sheets 132, a core 134 that is positioned between the two spaced-apart face-sheets 132, and one or more composite heat pipes 100 extending through the core 134 without the one or more fiber reinforced composite layers 112 extending directly between the one or more composite heat pipes 100 and the two spaced-apart face-sheets 132. Sandwich panels 130 may be constructed and utilized for any suitable application, including (but not limited to) radiator panels for spacecraft, radiator panels for phased arrays, and base plates for antennae.

[0036] Face-sheets 132 may be constructed of any suitable material depending on the application and/or desired properties of a sandwich panel 130. As illustrative, non-exclusive examples, face-sheets 132 may be constructed of sheet metal, such as aluminum or steel, or of a composite material, such as a reinforced composite material. As used herein, a “reinforced composite material” refers to a material that includes a polymer or other binding material matrix together with a filler. The filler may be fibers, particulates, or other configurations of material depending on the desired properties of the reinforced composite material. Moreover, the filler may be ordered, such as woven fibers or longitudinally aligned fibers, or the filler may be disordered, such as randomly ordered. Examples of filler include (but are not limited to) carbon particles, carbon fibers, boron fibers, polyaramid fibers, glass fibers, and/or other particles and/or fibers. When the filler includes fibers, the reinforced composite material may be referred to as a fiber reinforced composite material.

[0037] Cores 134 may have any suitable configuration and may be constructed of any suitable material depending on the application and/or desired properties of a sandwich panel 130. In some applications, a core 134 may be a honeycomb

core. For example, honeycomb cores may provide desired compression and weight properties. Honeycomb cores are structures that are defined by a plurality of thin wall sections, or ligaments, that define hollow cells. Typically, although not required in all examples, the cells are hexagonal in cross-section. Illustrative, non-exclusive examples of materials from which a core **134** may be constructed include metal, plastics, and reinforced composite materials, including fiber reinforced composite materials.

[0038] Although not required in all examples, sandwich panels **130** additionally may include a foam adhesive **136** that operatively couples one or more composite heat pipes **100** to the core **134** of a sandwich panel **130**. For example, as schematically illustrated in FIG. 3, the foam adhesive **136**, when present, may extend between the lateral sides of a composite heat pipe **100** and the core **134** to operatively couple the composite heat pipe **100** to the core **134**. An illustrative, non-exclusive example of a suitable foam adhesive **136** in some applications includes the FM 410-1™ foam adhesive from CYTEC SOLVAY GROUP™.

[0039] FIG. 4 schematically provides a flowchart that represents illustrative, non-exclusive examples of methods according to the present disclosure. In FIG. 4, some steps are illustrated in dashed boxes indicating that such steps may be optional or may correspond to an optional version of a method according to the present disclosure. That said, not all methods according to the present disclosure are required to include the steps illustrated in solid boxes. The methods and steps illustrated in FIG. 4 are not limiting and other methods and steps are within the scope of the present disclosure, including methods having greater than or fewer than the number of steps illustrated, as understood from the discussions herein.

[0040] As schematically illustrated in solid boxes in FIG. 4, methods **140** of assembling a composite heat pipe **100** include operatively coupling one or more fiber reinforced composite layers **112** to one or more external, lateral sides **114** of an elongate conductive casing **102**, as indicated at **142**. For example, the one or more fiber reinforced composite layers **112** may be operatively coupled to one of more external, lateral sides **114** by an adhesive layer **120**, as discussed herein.

[0041] In some methods **140**, the operatively coupling **142** is performed in an environment at 50-100° Fahrenheit (F) or at room temperature.

[0042] As also schematically illustrated in FIG. 4, methods **144** of assembling a sandwich panel **130** are within the scope of the present disclosure. As indicated in solid boxes, methods **144** include operatively coupling a first face-sheet **132** to a core **134**, as indicated at **146**, operatively positioning one or more composite heat pipes **100** relative to the first face-sheet **132** and the core **134**, as indicated at **148**, and operatively coupling a second face-sheet **132** to the core **134** opposite the first face-sheet **132**, as indicated at **150**.

[0043] Some methods **144** further include (but are not required to include), prior to the operatively positioning **150**, performing a method **140** of assembling the one or more composite heat pipes **100**. As schematically and optionally illustrated in a dashed box in FIG. 4, some methods **144** also include, following the operatively coupling **146**, the operatively positioning **148**, and the operatively coupling **150**, curing the sandwich panel **130** at an elevated temperature, such as at a temperature of 150-250° F., as indicated at **152**. In some such methods **144** that also include operatively

coupling **142** in an environment at 50-100° Fahrenheit (F) or at room temperature, it may be advantageous that the operatively coupling **142** is performed at a lower temperature than the required curing temperature of the sandwich panel **130** as a whole. More specifically, when the fiber reinforced composite layers **112** are bonded to the elongate conductive casing **102** at a non-elevated temperature (e.g., at room temperature), the bonding results in zero, or near zero, internal stress within the bond. Subsequently, when the sandwich panel **130** is cured with the composite heat pipe **100** between two spaced-apart face sheets **132** at an elevated temperature, the strain between the composite heat pipe **100** and the spaced-apart face sheets **132** is minimized due to the effective coefficient of thermal expansion of the composite heat pipe **100** being lower than if it were not previously cured at the non-elevated temperature. As a result, the integrity of the bond between the spaced-apart face sheets **132** and the composite heat pipe **100** is maintained both during cure and subsequent thermal cycling in use. For example, when a sandwich panel **130** is exposed to an extreme cold temperature, less strain between the one or more fiber reinforced composite layers **112** and the elongate conductive casing **102** may result, than if the operatively coupling **142** also were performed at the elevated temperature at which the sandwich panel **130** is cured as a whole.

[0044] Turning now to FIG. 5, an example spacecraft **10** according to the present disclosure is illustrated. Spacecraft **10** is in the form of a satellite **12** that includes two radiator panels **14**. However, other types of spacecraft **10** are within the scope of the present disclosure, and radiator panels **14** are not limited to being used with satellites, let alone the example satellite **12** illustrated in FIG. 5 and described herein. Moreover, radiator panels **14** may (but are not required to) include and/or be sandwich panels **130** according to the present disclosure.

[0045] Spacecraft **10** and satellites **12** include a structural body **16** to which the radiator panels **14** and other equipment are operatively mounted. In the illustrated example of satellite **12**, the structural body **16** includes a cylindrical core **18**, an upper panel **20**, a lower panel **22**, a left stiffener **24**, a right stiffener **26**, an upper antenna bracket **28**, and a lower antenna bracket **30**. The radiator panels **14** include a left radiator panel **14** that is operatively coupled to the upper panel **20**, the left stiffener **24**, the lower panel **22**, the upper antenna bracket **28**, and the lower antenna bracket **30**, and a right radiator panel **14** that is operatively coupled to the upper panel **20**, the right stiffener **26**, the lower panel **22**, the upper antenna bracket **28**, and the lower antenna bracket **30**. Collectively, the radiator panels **14** and the body **16** of the satellite **12** may be described as a spacecraft bus **32**, with the bus **32** being used to carry various payloads **34** into outer space. The illustrated and described construction of bus **32** is but one example of a spacecraft **10** and satellite **12**, which is provided for illustration purposes only and does not limit the present disclosure to the illustrated example. Additional examples of construction that may be suitable for a spacecraft bus **32** are disclosed in U.S. Patent Application Publication No. 2014/0239124, the disclosure of which is incorporated herein by reference.

[0046] The payload **34** of a spacecraft **10** and satellite **12** may take any suitable form and configuration depending on the ultimate application of the spacecraft **10**. For example, payload **34** may include various communication devices **36**, including (but not limited to) antenna feeds **38** and antenna

reflectors **40**. At a minimum, payload **34** of a satellite **12** typically includes electronic equipment **42** that is operatively mounted to the inner sides of the radiator panels **14**. Accordingly, heat generated by the electronic equipment is conducted to the radiator panels **14**, which in turn radiate the heat to outer space. Payload **34** additionally may include structures that are mounted to the outer sides of the radiator panels **14**, such as (but not limited to) solar arrays **44**, as illustrated in FIG. 5.

[0047] Because the radiator panels **14** define structural components of satellite **12**, their thermal stability may be critical to ensure that communication devices **36** function as desired. For example, the position of a first communication device, such as in the form of an antenna feed **38**, relative to the position of a second communication device, such as in the form of an antenna reflector **40** at which the antenna feed **38** is pointed, may be critical for the effectiveness of the communication devices and thus the satellite **12**. A bus **32**, including radiator panels **14**, therefore may be configured to maintain a desired positional relationship between two communication devices **36** even when the radiator panels **14** are subject to significant thermal changes. This desired positional relationship may be described in terms of the movement of the attachment points of the communication devices to the bus **32**. Using the antenna example, an antenna feed **38** may be coupled relative to the body **16** at a first mount **46**, and an antenna reflector **40** may be coupled relative to the body **16** at a second mount **48**. When one or both of the radiator panels **14** of a satellite **12** is subject to a temperature change between a minimum temperature and a maximum temperature in the range of one or more of $-50-100^{\circ}\text{C.}$, $-20-100^{\circ}\text{C.}$, $-20-80^{\circ}\text{C.}$, $0-100^{\circ}\text{C.}$, $10-100^{\circ}\text{C.}$, $20-100^{\circ}\text{C.}$, $50-100^{\circ}\text{C.}$, and/or $20-80^{\circ}\text{C.}$, the first mount may move, rotate, or pivot, relative to the second mount by less than 0.1 degrees, by less than 0.08 degrees, by less than 0.06 degrees, or by less than 0.04 degrees. Any combination of the aforementioned ranges is within the scope of the present disclosure. Additionally or alternatively, when one or both of the radiator panels **14** begin dissipating heat at a rate in the range of one or more of 100-5000 Watts, 100-2500 Watts, 500-5000 Watts, and/or 500-2500 Watts, that is, go from zero Watts to within one of the enumerated ranges, the first mount may move, rotate, or pivot relative to the second mount by less than 0.1 degrees, by less than 0.08 degrees, by less than 0.06 degrees, or by less than 0.04 degrees. Any combination of the aforementioned ranges is within the scope of the present disclosure. As an illustrative, non-exclusive example, when a radiator panel **14** is dissipating heat at a rate in the range of 100-5000 Watts and/or is subject to a temperature change between a minimum temperature and a maximum temperature in the range of $-50-100^{\circ}\text{C.}$, the first mount may move, rotate, or pivot by less than 0.1 degrees.

[0048] Turning now to FIG. 6, examples of radiator panels **14** are schematically represented. Although not required, radiator panels **14** are generally planar and rectangular. Radiator panels **14** include two spaced-apart face-sheets **50**, a honeycomb core **52** that is positioned between the face-sheets **50**, and one or more heat pipes **54** that extend through the honeycomb core **52** between the face-sheets **50**.

[0049] When a radiator panel **14** is a sandwich panel **130** according to the present disclosure, one or more of heat pipes **54** may be a composite heat pipe **100** according to the present disclosure. The face-sheets **50** include an inside

face-sheet **56** that faces the inside of a bus **32** when installed as a component of the bus, and an outside face-sheet **58** that faces the outside of the bus toward outer space. The honeycomb core **52** gives the radiator panel structural support. The one or more heat pipes **54** draw heat from electronic equipment **42** mounted to the inside face-sheet **56** and transfer the heat to the outside face-sheet **58** to be radiated to outer space. As optionally and schematically illustrated in FIG. 6, one or more structures **60** also may be mounted to the outside face-sheet **58**, with a solar array **44** being an example.

[0050] The honeycomb core **52** of a radiator panel **14** may be constructed of any suitable material, including metal, plastic, and reinforced composite material. A typical example of a metal includes aluminum.

[0051] Face-sheets **50** of a radiator panel are constructed at least in part, and in some examples completely, of a fiber reinforced composite material. In some examples, the face-sheets **50** may be constructed as a laminate of multiple plies **62** of material. For example, a face-sheet **50** may include 2-10, 2-8, 2-6, 2-4, 4-10, 4-8, 4-6, 6-10, 6-8, or 8-10 plies **62** of material; however, other numbers of plies **62** may be included in a face-sheet **50**, including numbers fewer than, greater than, and within the enumerated ranges. Additionally or alternatively, a face-sheet **50** may include at least one metallic foil layer, such as an aluminum foil layer. In some examples, a face-sheet **50** may have a thickness in the range of 200-1000 μm , 200-800 μm , 200-600 μm , 200-400 μm , 400-1000 μm , 400-800 μm , 400-600 μm , 600-1000 μm , 600-800 μm , or 800-1000 μm ; however, other thicknesses of face-sheets **50** also are within the scope of the present disclosure. Any combination of the aforementioned ranges is within the scope of the present disclosure. For example, a face-sheet **50** may include 2-10 plies **62** resulting in a thickness of the face-sheet **50** in the range of 200-1000 μm . FIG. 7 schematically represents example plies **62** of fiber reinforced composite materials that may be used to construct a face-sheet **50**.

[0052] In some examples of face-sheets **50**, the fiber reinforced composite material may include a set of fibers **64** and a set of fibers **66** within a matrix of binding material **68**, and with fibers **64** differing in one or more properties or characteristics from fibers **66**. For example, in some examples of face-sheets **50**, the average diameter of fibers **64** may differ from an average diameter of fibers **66**. As examples, the average diameter of fibers **66** may be at least 2, at least 4, at least 6, at least 8, 2-10, 2-8, 2-6, 2-4, 4-10, 4-8, 4-6, 6-10, 6-8, or 8-10 times the average diameter of fibers **64**. Additionally or alternatively, the average diameter of fibers **64** may be in the range of 5-20 μm , 5-15 μm , 5-10 μm , 10-20 μm , 10-15 μm , or 15-20 μm , and the average diameter of fibers **66** may be in the range of 50-200 μm , 50-150 μm , 50-100 μm , 100-200 μm , 100-150 μm , or 150-200 μm . Other average diameters, as well as ratios of average diameters, are within the scope of the present disclosure. Any combination of the aforementioned ranges is within the scope of the present disclosure. For example, the average diameter of fibers **66** may be at least 2 times the average diameter of fibers **64**.

[0053] In some examples of face-sheets **50**, fibers **64** may be carbon fibers. In some examples of face-sheets **50**, fibers **66** may be boron fibers.

[0054] In some examples of face-sheets **50**, a ratio of a total number of fibers **64** to a total number of fibers **66** within

a face-sheet **50** and/or a ply **62** may be in the range of 100-500, 100-400, 100-300, 100-200, 200-500, 200-400, 200-300, 300-500, 300-400, or 400-500; however, other ratios, including ratios within the enumerated ranges, as well as below and above the enumerated ranges, may be utilized in a face-sheet **50** and/or a ply **62** thereof.

[0055] In some examples of face-sheets **50**, within a single ply **62**, fibers **64** may be spaced apart on average in the range of 0-30 μm , 0-20 μm , 0-10 μm , 10-30 μm , 10-20 μm , or 20-30 μm . In some examples of face-sheets **50**, within a single ply **62**, fibers **66** may be spaced apart on average in the range of 50-200 μm , 50-150 μm , 50-100 μm , 100-200 μm , 100-150 μm , or 150-200 μm . Any ratio of any one of the aforementioned ranges for fibers **64** to any one of the aforementioned ranges for fibers **66** is within the scope of the present disclosure. For example, within a single ply **62**, fibers **64** may be spaced apart on average in the range of 0-30 μm , and fibers **66** may be spaced apart on average in the range of 50-200 μm . Moreover, other spacings, including within the enumerated ranges, as well as below and above the enumerated ranges, may be utilized in a ply **62** of a face-sheet **50**.

[0056] In some examples of face-sheets **50**, fibers **64** may have a coefficient of thermal expansion in the range of -0.8 - 0 ppm/ $^{\circ}\text{F}$. In some examples of face-sheets **50**, fibers **66** may have a coefficient of thermal expansion in the range of 2-3 ppm/ $^{\circ}\text{F}$. Any combination of the aforementioned range for fibers **64** and the aforementioned range for fibers **66** may be used.

[0057] In some examples of face-sheets **50**, fibers **64** may have a thermal conductivity in the range of 75-1100 W/m-K. In some examples of face-sheets **50**, fibers **66** may have a thermal conductivity in the range of 25-400 W/m-K. Any combination of the aforementioned range for fibers **64** and the aforementioned range for fibers **66** may be used.

[0058] In some examples of face-sheets **50**, fibers **64** may have a tensile strength in the range of 400-800 ksi. In some examples of face-sheets **50**, fibers **66** may have a tensile strength in the range of 500-600 ksi. Any combination of the aforementioned range for fibers **64** and the aforementioned range for fibers **66** may be used.

[0059] In some examples of face-sheets **50**, the binding material **68** of the fiber reinforced composite material of a face-sheet **50** or a ply **62** thereof may include epoxy, cyanate ester, polyimide, bismaleimide resin, or phenolic resin. Additionally or alternatively, the binding material **68** also may include a thermal conductivity enhancer, such as one or more of milled carbon fiber, carbon nanotubes, and graphite nanoplatelets.

[0060] As discussed above, the face-sheets **50**, the honeycomb core **52**, and the heat pipes **54** of a radiator panel **14** may have various properties and characteristics depending on a particular example of radiator panel **14**. As a result, the properties and characteristics of a radiator panel **14**, as a whole, also may vary.

[0061] In some examples of radiator panels **14**, the radiator panel, as a whole, may have a coefficient of thermal expansion in the range of 0.5-13 ppm/ $^{\circ}\text{F}$. across its thickness. Additionally or alternatively, the radiator panel, as a whole, may have a coefficient of thermal expansion in the range of 0.25-4 ppm/ $^{\circ}\text{F}$. in a direction parallel to the face-sheets **50**.

[0062] FIG. **8** schematically provides a flowchart that represents illustrative, non-exclusive examples of methods

according to the present disclosure. In FIG. **8**, some steps are illustrated in dashed boxes indicating that such steps may be optional or may correspond to an optional version of a method according to the present disclosure. That said, not all methods according to the present disclosure are required to include the steps illustrated in solid boxes. The methods and steps illustrated in FIG. **8** are not limiting and other methods and steps are within the scope of the present disclosure, including methods having greater than or fewer than the number of steps illustrated, as understood from the discussions herein.

[0063] As schematically illustrated in solid boxes in FIG. **8**, methods **80** of assembling a radiator panel **14** for a spacecraft **10** include operatively coupling an inside face-sheet **56** to a honeycomb core **52**, as indicated at **82**, operatively coupling an outside face-sheet **58** to the honeycomb core **52** opposite the inside face-sheet **56**, as indicated at **84**, and operatively positioning one or more heat pipes **54** between the inside face-sheet **56** and the outside face-sheet **58**, as indicated at **86**. As indicated in FIG. **8**, a method **80** also may be a method **114** according to the present disclosure.

[0064] Methods **90** of assembling a spacecraft **10** also are within the scope of the present disclosure, and as indicated in FIG. **8** at **92** may include at least operatively coupling a radiator panel **14** to a body **16** of the spacecraft **10**. Some methods **90** also may include performing a method **80** of assembling the radiator panel **14** prior to the coupling **92**.

[0065] Illustrative, non-exclusive examples of inventive subject matter according to the present disclosure are described in the following enumerated paragraphs:

[0066] A. A composite heat pipe, comprising:

[0067] an elongate conductive casing that defines an internal volume having an outer peripheral region;

[0068] a wick structure positioned within the outer peripheral region of the internal volume of the elongate conductive casing;

[0069] a working fluid within the internal volume of the outer peripheral region; and

[0070] one or more fiber reinforced composite layers operatively coupled to one or more external, lateral sides of the elongate conductive casing, wherein each fiber reinforced composite layer comprises a plurality of elongate fibers longitudinally aligned with the elongate conductive casing and operatively coupled together by a binding material.

[0071] A1. The composite heat pipe of paragraph A1, wherein each fiber reinforced composite layer comprises a film.

[0072] A2. The composite heat pipe of any of paragraphs A-A1, wherein the binding material comprises an adhesive tape.

[0073] A2.1. The composite heat pipe of paragraph A2, wherein the plurality of elongate fibers is adhered to a face of the adhesive tape.

[0074] A2.2. The composite heat pipe of paragraph A2, wherein the plurality of elongate fibers is embedded in the adhesive tape.

[0075] A3. The composite heat pipe of any of paragraphs A-A2.2, wherein the binding material comprises a matrix of the binding material and the plurality of elongate fibers are within the matrix.

[0076] A4. The composite heat pipe of any of paragraphs A-A3, wherein the binding material comprises, optionally

consists essentially of, optionally consists of, epoxy, cyanate ester, polyimide, bismaleimide resin, or phenolic resin.

[0077] A5. The composite heat pipe of any of paragraphs A-A4, wherein the plurality of elongate fibers comprises a density of 0.05-0.10 lbs/in.³ within each fiber reinforced composite layer.

[0078] A6. The composite heat pipe of any of paragraphs A-A5, wherein the plurality of elongate fibers are spaced-apart within each fiber reinforced composite layer.

[0079] A7. The composite heat pipe of any of paragraphs A-A6, wherein the plurality of elongate fibers comprises, optionally consists essentially of, optionally consists of, boron fibers.

[0080] A8. The composite heat pipe of any of paragraphs A-A7, wherein the plurality of elongate fibers comprises, optionally consists essentially of, optionally consists of, high strength carbon fibers.

[0081] A9. The composite heat pipe of any of paragraphs A-A8, wherein the elongate conductive casing is constructed of a material having a first tensile strength and a first compression strength, and wherein the plurality of elongate fibers are constructed of a material having a second tensile strength that is greater than the first tensile strength and a second compression strength that is greater than the first compression strength.

[0082] A9.1. The composite heat pipe of paragraph A9, wherein second tensile strength is at least 1.5, at least 2, at least 5, or at least 10 times the first tensile strength.

[0083] A9.2. The composite heat pipe of any of paragraphs A9-A9.1, wherein the second compression strength is at least 1.5, at least 2, at least 5, or at least 10 times the first compression strength.

[0084] A10. The composite heat pipe of any of paragraphs A-A9.2, wherein the elongate conductive casing is constructed of aluminum, copper, or steel.

[0085] A11. The composite heat pipe of any of paragraphs A-A10, wherein elongate fibers of the plurality of elongate fibers are unidirectional.

[0086] A12. The composite heat pipe of any of paragraphs A-A11, wherein the one or more fiber reinforced composite layers comprises two fiber reinforced composite layers operatively coupled to opposing external, lateral sides of the elongate conductive casing.

[0087] A13. The composite heat pipe of any of paragraphs A-A12, further comprising:

[0088] an adhesive layer between the one or more fiber reinforced composite layers and the respective one or more external, lateral sides of the elongate conductive casing.

[0089] A13.1. The composite heat pipe of paragraph A13, wherein the adhesive layer has a thickness of 0.005-0.025 inches.

[0090] A13.2. The composite heat pipe of any of paragraphs A13-A13.1, wherein the adhesive layer comprises, optionally consists essentially of, optionally consists of, an epoxy adhesive.

[0091] A14. The use of the composite heat pipe of any of paragraphs A-A13.2 as a structural component of a sandwich panel, a radiator panel, a radiator panel for a spacecraft, a radiator panel for a phased array, or a base plate for an antenna.

[0092] B. A method of assembling a composite heat pipe, the method comprising:

[0093] operatively coupling one or more fiber reinforced composite layers to one or more external, lateral sides of an elongate conductive casing;

[0094] wherein the one or more fiber reinforced composite layers and/or the elongate conductive casing includes the subject matter of any of paragraphs A-A13.3.

[0095] B1. The method of paragraph B, wherein the operatively coupling is performed in an environment at 50-100° F., optionally at room temperature.

[0096] C. A sandwich panel, comprising:

[0097] two spaced-apart face-sheets;

[0098] a core positioned between the two spaced-apart face-sheets; and

[0099] one or more composite heat pipes according to any of paragraphs A-A13.3 extending through the core without the one or more fiber reinforced composite layers extending directly between the one or more composite heat pipes and the two spaced-apart face-sheets.

[0100] C1. The sandwich panel of paragraph C, wherein the core comprises, optionally consists essentially of, optionally consists of, a honeycomb core.

[0101] C2. The sandwich panel of any of paragraphs C-C1, wherein the core is constructed of metal, optionally of aluminum.

[0102] C3. The sandwich panel of any of paragraphs C-C2, wherein the two spaced-apart face-sheets are constructed of a fiber reinforced composite material.

[0103] C4. The sandwich panel of any of paragraphs C-C3, further comprising:

[0104] a foam adhesive that operatively couples the one or more composite heat pipes to the core.

[0105] C5. The sandwich panel of any of paragraphs C-C4, wherein the one or more fiber reinforced composite layers of the one or more composite heat pipes is constructed of a composite laminate that is cured at room temperature prior to the one or more composite heat pipes being bonded to the two spaced-apart face sheets at an elevated temperature.

[0106] C6. The sandwich panel of any of paragraphs C-C5, wherein the sandwich panel comprises one of a radiator panel, a radiator panel for a spacecraft, a radiator panel for a phased array, and a base plate for an antenna.

[0107] C7. The use of the sandwich panel of any of paragraphs C-C6 as a radiator panel, a radiator panel for a spacecraft, a radiator panel for a phased array, or a base plate for an antenna.

[0108] D. A method of assembling a sandwich panel, the method comprising:

[0109] operatively coupling a first face-sheet to a core;

[0110] operatively coupling a second face-sheet to the core opposite the first face-sheet; and

[0111] operatively positioning one or more composite heat pipes between the first face-sheet and the second face-sheet;

[0112] wherein the first face-sheet, the second face-sheet, the core, and/or the one or more composite heat pipes includes the subject matter of any of paragraphs C-C6.

[0113] D1. The method of paragraph D, further comprising:

[0114] prior to the operatively positioning, assembling the one or more composite heat pipes according to the method of any of paragraphs B-B1.

[0115] D2. The method of any of paragraphs D-D1, further comprising:

[0116] following the operatively coupling the first face-sheet, the operatively coupling the second face-sheet, and

the operatively positioning, curing the sandwich panel at an elevated temperature, optionally at a temperature of 150-250° F.

[0117] E. A radiator panel, the radiator panel comprising:
[0118] two spaced-apart face-sheets including an inside face-sheet and an outside face-sheet, wherein the two spaced-apart face-sheets are constructed of a fiber reinforced composite material;

[0119] a honeycomb core positioned between the two spaced-apart face-sheets; and

[0120] one or more heat pipes extending through the honeycomb core.

[0121] E1. The radiator panel of paragraph E, wherein the honeycomb core is constructed of metal, optionally of aluminum.

[0122] E2. The radiator panel of any of paragraphs E-E1, wherein the one or more heat pipes are constructed of metal, optionally of aluminum.

[0123] E3. The radiator panel of any of paragraphs E-E2, wherein the fiber reinforced composite material includes a first set of fibers and a second set of fibers, wherein the fibers of the first set differ from the fibers of the second set in at least one characteristic.

[0124] E3.1. The radiator panel of paragraph E3, wherein the first set of fibers includes fibers having a first average diameter, and wherein the second set of fibers includes fibers having a second average diameter that is different than the first average diameter.

[0125] E3.1.1. The radiator panel of paragraph E3.1, wherein the second average diameter is at least 2, at least 4, at least 6, at least 8, 2-10, 2-8, 2-6, 2-4, 4-10, 4-8, 4-6, 6-10, 6-8, or 8-10 times the first average diameter.

[0126] E3.1.2. The radiator panel of any of paragraphs E3.1-E3.1.1, wherein the first average diameter is in the range of 5-20 μm , 5-15 μm , 5-10 μm , 10-20 μm , 10-15 μm , or 15-20 μm .

[0127] E3.1.3. The radiator panel of any of paragraphs E3.1-E3.1.2, wherein the second average diameter is in the range of 50-200 μm , 50-150 μm , 50-100 μm , 100-200 μm , 100-150 μm , or 150-200 μm .

[0128] E3.2. The radiator panel of any of paragraphs E3-E3.1.3, wherein the fibers of the first set comprise, optionally consist essentially of, optionally consist of, carbon fibers, and wherein the fibers of the second set do not comprise carbon fibers.

[0129] E3.3. The radiator panel of any of paragraphs E3-E3.2, wherein the fibers of the second set comprise, optionally consist essentially of, optionally consist of, boron fibers, and wherein the fibers of the first set do not comprise boron fibers.

[0130] E3.4. The radiator panel of any of paragraphs E3-E3.3, wherein a ratio of a total number of the first set of fibers to a total number of the second set of fibers is in the range of 100-500, 100-400, 100-300, 100-200, 200-500, 200-400, 200-300, 300-500, 300-400, or 400-500.

[0131] E3.5. The radiator panel of any of paragraphs E3-E3.4, wherein within a single ply of the fiber reinforced composite material, fibers of the first set of fibers are spaced apart on average in the range of 0-30 μm , 0-20 μm , 0-10 μm , 10-30 μm , 10-20 μm , or 20-30 μm .

[0132] E3.6. The radiator panel of any of paragraphs E3-E3.5, wherein within a/the single ply of the fiber reinforced composite material, fibers of the second set of fibers

are spaced apart on average in the range of 50-200 μm , 50-150 μm , 50-100 μm , 100-200 μm , 100-150 μm , or 150-200 μm .

[0133] E3.7. The radiator panel of any of paragraphs E3-E3.6, wherein the first set of fibers includes fibers having a coefficient of thermal expansion in the range of -0.8-0 ppm/° F.

[0134] E3.8. The radiator panel of any of paragraphs E3-E3.7, wherein the second set of fibers includes fibers having a coefficient of thermal expansion in the range of 2-3 ppm/° F.

[0135] E3.9. The radiator panel of any of paragraphs E3-E3.8, wherein the first set of fibers includes fibers having a thermal conductivity in the range of 75-1100 W/m-K.

[0136] E3.10. The radiator panel of any of paragraphs E3-E3.9, wherein the second set of fibers includes fibers having a thermal conductivity in the range of 25-400 W/m-K.

[0137] E3.11. The radiator panel of any of paragraphs E3-E3.10, wherein the first set of fibers includes fibers having a tensile strength in the range of 400-800ksi.

[0138] E3.12. The radiator panel of any of paragraphs E3-E3.11, wherein the second set of fibers includes fibers having a tensile strength in the range of 500-600ksi.

[0139] E4. The radiator panel of any of paragraphs E-E3.12, wherein the inside face-sheet includes, optionally consists essentially of, optionally consists of, 2-10, 2-8, 2-6, 2-4, 4-10, 4-8, 4-6, 6-10, 6-8, or 8-10 plies of the fiber reinforced composite material.

[0140] E4.1. The radiator panel of paragraph E4, wherein the inside face-sheet further includes at least one metallic foil layer, optionally an aluminum foil layer.

[0141] E5. The radiator panel of any of paragraphs E-E4.1, wherein the outside face-sheet includes, optionally consists essentially of, optionally consists of, 2-10, 2-8, 2-6, 2-4, 4-10, 4-8, 4-6, 6-10, 6-8, or 8-10 plies of the fiber reinforced composite material.

[0142] E5.1. The radiator panel of paragraph E5, wherein the outside face-sheet further includes at least one metallic foil layer, optionally an aluminum foil layer.

[0143] E6. The radiator panel of any of paragraphs E-E5.1, wherein the inside face-sheet has a thickness in the range of 200-1000 μm , 200-800 μm , 200-600 μm , 200-400 μm , 400-1000 μm , 400-800 μm , 400-600 μm , 600-1000 μm , 600-800 μm , or 800-1000 μm .

[0144] E7. The radiator panel of any of paragraphs E-E6, wherein the outside face-sheet has a thickness in the range of 200-1000 μm , 200-800 μm , 200-600 μm , 200-400 μm , 400-1000 μm , 400-800 μm , 400-600 μm , 600-1000 μm , 600-800 μm , or 800-1000 μm .

[0145] E8. The radiator panel of any of paragraphs E-E7, wherein the fiber reinforced composite material includes a binding material that includes, optionally consists essentially of, optionally consists of, epoxy, cyanate ester, polyimide, bismaleimide resin, or phenolic resin.

[0146] E8.1. The radiator panel of paragraph E8, wherein the binding material further includes a thermal conductivity enhancer, optionally one or more of milled carbon fiber, carbon nanotubes, and graphite nanoplatelets.

[0147] E9. The radiator panel of any of paragraphs E-E8.1, wherein the radiator panel, as a whole, has a coefficient of thermal expansion in the range of 0.5-13 ppm/° F. across a thickness of the radiator panel.

[0148] E10. The radiator panel of any of paragraphs E-E9, wherein the radiator panel, as a whole, has a coefficient of thermal expansion in the range of 0.25-4 ppm/° F. in a direction parallel to the inside face-sheet and the outside face-sheet.

[0149] E11. The radiator panel of any of paragraphs E-E10, wherein the radiator panel is generally planar.

[0150] E12. The radiator panel of any of paragraphs E-E11, wherein the radiator panel is generally rectangular.

[0151] E13. The radiator panel of any of paragraphs E-E12, wherein the one more heat pipes comprise one or more of the composite heat pipe of any of paragraphs A-A13.3.

[0152] E14. The use of the radiator panel of any of paragraphs E-E13 as a structural component of a spacecraft.

[0153] E15. The use of the radiator panel of any of paragraphs E-E13 to improve the precision of communication devices of a spacecraft.

[0154] E16. The use of the radiator panel of any of paragraphs E-E13 as one or more of a radiator panel for a spacecraft, a radiator panel for a phased array, or a base plate for an antenna.

[0155] F. A spacecraft, comprising:

[0156] a body; and

[0157] two radiator panels of any of paragraphs E-E13 operatively coupled to the body opposite each other.

[0158] F1. The spacecraft of paragraph F, further comprising:

[0159] a first communication device operatively coupled relative to the body by a first mount; and

[0160] a second communication device operatively coupled relative to the body by a second mount.

[0161] F1.1. The spacecraft of paragraph F1, wherein the first communication device and the second communication device are electrically grounded to the two radiator panels.

[0162] F1.2. The spacecraft of any of paragraphs F1-F1.1, wherein when one or both of the two radiator panels is subject to a temperature change between a minimum temperature and a maximum temperature in the range of -50-100° C., -20-100° C., -20-80° C., 0-100° C., 10-100° C., 20-100° C., 50-100° C., or 20-80° C., the first mount moves, rotates, or pivots relative to the second mount by less than 0.1 degrees, 0.08 degrees, 0.06 degrees, or 0.04 degrees.

[0163] F1.3. The spacecraft of any of paragraphs F1-F1.2, wherein when one or both of the radiator panels begins dissipating heat at a rate in the range of 100-5000 Watts, 100-2500 Watts, 500-5000 Watts, or 500-2500 Watts, the first mount moves, rotates, or pivots relative to the second mount by less than 0.1 degrees, 0.08 degrees, 0.06 degrees, or 0.04 degrees.

[0164] F2. The spacecraft of any of paragraphs F-F1.3, wherein the first communication device includes an antenna feed, wherein the second communication device includes an antenna reflector, and wherein the antenna feed is pointed at the antenna reflector.

[0165] F3. The spacecraft of any of paragraphs F-F2, wherein the spacecraft is free of one or more of star tracker mounts, stand-alone antenna mounts, and sensor suite optical bench mounts.

[0166] F4. The use of the spacecraft of any of paragraphs F-F3, optionally as a communications satellite.

[0167] G. A method of assembling a radiator panel, the method comprising:

[0168] operatively coupling an inside face-sheet to a honeycomb core;

[0169] operatively coupling an outside face-sheet to the honeycomb core opposite the inside face-sheet; and

[0170] operatively positioning one or more heat pipes between the inside face-sheet and the outside face-sheet;

[0171] wherein the inside face-sheet, the outside face-sheet, the honeycomb core, and/or the one or more heat pipes include the subject matter of any of paragraphs E-E13.

[0172] H. A method of assembling a spacecraft, the method comprising:

[0173] operatively coupling a radiator panel to a body of the spacecraft, wherein the radiator panel includes the subject matter of any of paragraphs E-E13, and wherein the spacecraft includes the subject matter of any of paragraphs F-F3.

[0174] The various disclosed elements of apparatuses and steps of methods disclosed herein are not required to all apparatuses and methods according to the present disclosure, and the present disclosure includes all novel and non-obvious combinations and subcombinations of the various elements and steps disclosed herein. Moreover, one or more of the various elements and steps disclosed herein may define independent inventive subject matter that is separate and apart from the whole of a disclosed apparatus or method. Accordingly, such inventive subject matter is not required to be associated with the specific apparatuses and methods that are expressly disclosed herein, and such inventive subject matter may find utility in apparatuses and/or methods that are not expressly disclosed herein.

1. A composite heat pipe, comprising:

an elongate conductive casing that defines an internal volume having an outer peripheral region;

a wick structure positioned within the outer peripheral region of the internal volume of the elongate conductive casing;

a working fluid within the internal volume of the outer peripheral region; and

one or more fiber reinforced composite layers operatively coupled to one or more external, lateral sides of the elongate conductive casing, wherein each fiber reinforced composite layer comprises a plurality of elongate fibers longitudinally aligned with the elongate conductive casing and operatively coupled together by a binding material.

2. The composite heat pipe of claim 1, wherein the binding material comprises an adhesive tape.

3. The composite heat pipe of claim 2, wherein the plurality of elongate fibers is adhered to a face of the adhesive tape.

4. The composite heat pipe of claim 2, wherein the plurality of elongate fibers is embedded in the adhesive tape.

5. The composite heat pipe of claim 1, wherein the binding material comprises a matrix of the binding material and the plurality of elongate fibers are within the matrix.

6. The composite heat pipe of claim 1, wherein the plurality of elongate fibers comprises a density of 0.05-0.10 lbs/in.³ within each fiber reinforced composite layer.

7. The composite heat pipe of claim 1, wherein the plurality of elongate fibers are spaced-apart within each fiber reinforced composite layer.

8. The composite heat pipe of claim 1, wherein the plurality of elongate fibers comprises boron fibers or high-strength carbon fibers.

9. The composite heat pipe of claim 1, wherein the elongate conductive casing is constructed of a material

having a first tensile strength and a first compression strength, wherein the plurality of elongate fibers are constructed of a material having a second tensile strength and a second compression strength, wherein the second tensile strength is at least 2 times the first tensile strength, and wherein the second compression strength is at least 2 times the first compression strength.

10. The composite heat pipe of claim 1, wherein elongate fibers of the plurality of elongate fibers are unidirectional.

11. The composite heat pipe of claim 1, wherein the one or more fiber reinforced composite layers comprises two fiber reinforced composite layers operatively coupled to opposing external, lateral sides of the elongate conductive casing.

12. The composite heat pipe of claim 1, further comprising:

an adhesive layer between the one or more fiber reinforced composite layers and the respective one or more external, lateral sides of the elongate conductive casing, wherein the adhesive layer has a thickness of 0.005-0.025 inches, and wherein the adhesive layer comprises an epoxy adhesive.

13. A sandwich panel, comprising:

two spaced-apart face-sheets;

a core positioned between the two spaced-apart face-sheets; and

one or more composite heat pipes according to claim 1 extending through the core without the one or more fiber reinforced composite layers extending directly between the one or more composite heat pipes and the two spaced-apart face-sheets.

14. The sandwich panel of claim 13, wherein the one or more fiber reinforced composite layers of the one or more composite heat pipes is constructed of a composite laminate that is cured at room temperature prior to the one or more composite heat pipes being bonded to the two spaced-apart face sheets at an elevated temperature.

15. The sandwich panel of claim 13, wherein the two-spaced face-sheets are constructed of a fiber reinforced composite material, and wherein the elongate conductive casing is constructed of aluminum.

16. A method of assembling the sandwich panel of claim 13, the method comprising:

in an environment at 50-100° F., operatively coupling the one or more fiber reinforced composite layers to the one or more external, lateral sides of the elongate conductive casing;

operatively coupling a first face-sheet of the two spaced-apart face-sheets to the core;

operatively coupling a second face-sheet of the two spaced-apart face-sheets to the core opposite the first face-sheet; and

operatively positioning the one or more composite heat pipes between the first face-sheet and the second face-sheet;

following the operatively coupling the one or more fiber reinforced composite layers, the operatively coupling the first face-sheet, the operatively coupling the second face-sheet, and the operatively positioning, curing the sandwich panel at a temperature of 150-250° F.

17. A radiator panel, the radiator panel comprising:

two spaced-apart face-sheets including an inside face-sheet and an outside face-sheet, wherein the two spaced-apart face-sheets are constructed of a fiber reinforced composite material, wherein the fiber reinforced composite material includes a first set of fibers and a second set of fibers, wherein the fibers of the first set differ from the fibers of the second set in at least one characteristic;

a honeycomb core positioned between the two spaced-apart face-sheets; and

one or more composite heat pipes according to claim 1 extending through the honeycomb core.

18. The radiator panel of claim 17, wherein the first set of fibers includes fibers having a first average diameter, and wherein the second set of fibers includes fibers having a second average diameter that is different than the first average diameter.

19. The radiator panel of claim 18, wherein the first average diameter is in the range of 5-20 μm , and wherein the second average diameter is in the range of 50-200 μm .

20. The radiator panel of claim 17, wherein the fibers of the first set comprise carbon fibers, and wherein the fibers of the second set comprise boron fibers.

21. A spacecraft, comprising:

a body; and

two radiator panels of claim 17 operatively coupled to the body opposite each other.

* * * * *