

US011549666B2

(12) **United States Patent**
Feit

(10) **Patent No.:** **US 11,549,666 B2**
(45) **Date of Patent:** ***Jan. 10, 2023**

(54) **LED LIGHTING FIXTURE ASSEMBLY**

(71) Applicant: **Feit Electric Company, Inc.**, Pico Rivera, CA (US)

(72) Inventor: **Alan Feit**, Encino, CA (US)

(73) Assignee: **FEIT ELECTRIC COMPANY, INC.**, Pico Rivera, CA (US)

(*) Notice: Subject to any disclaimer, the term of this patent is extended or adjusted under 35 U.S.C. 154(b) by 0 days.

This patent is subject to a terminal disclaimer.

(21) Appl. No.: **17/393,841**

(22) Filed: **Aug. 4, 2021**

(65) **Prior Publication Data**

US 2021/0364152 A1 Nov. 25, 2021

Related U.S. Application Data

(60) Continuation of application No. 16/591,956, filed on Oct. 3, 2019, now Pat. No. 11,112,093, which is a (Continued)

(51) **Int. Cl.**
F21V 17/06 (2006.01)
F21V 3/06 (2018.01)
(Continued)

(52) **U.S. Cl.**
CPC *F21V 17/06* (2013.01); *F21S 2/00* (2013.01); *F21V 1/00* (2013.01); *F21V 3/0615* (2018.02);
(Continued)

(58) **Field of Classification Search**
CPC *F21V 17/06*; *F21S 2/00*
See application file for complete search history.

(56) **References Cited**

U.S. PATENT DOCUMENTS

5,749,646 A 5/1998 Brittell
7,063,441 B2 6/2006 Kramer et al.
(Continued)

FOREIGN PATENT DOCUMENTS

GB 191214192 A 6/1913

OTHER PUBLICATIONS

U.S. Appl. No. 16/591,956, filed Oct. 3, 2019, U.S. Pat. No. 11,112,093, Patented.

(Continued)

Primary Examiner — Jason L Vaughan
Assistant Examiner — Amanda Kreiling

(74) *Attorney, Agent, or Firm* — Alston & Bird LLP

(57) **ABSTRACT**

Various embodiments of the present invention provide a light emitting diode (LED) lighting fixture and methods of installing the same. In various embodiments, an LED lighting fixture may comprise: at least one socket comprising a socket opening; at least one LED positioned substantially within the socket opening; at least one shield member positioned adjacent the at least one socket such that the shield substantially encloses the socket opening; at least one decorative light shade; at least one cover comprising a neck portion having an internal surface, the internal surface defining a cover opening. The cover opening is configured to receive there-through at least a portion of a socket and substantially engage the socket. At least a portion of the cover is configured to substantially engage the decorative light shade. Also, at least a portion of the cover is configured to substantially enclose the LED and shield.

20 Claims, 8 Drawing Sheets

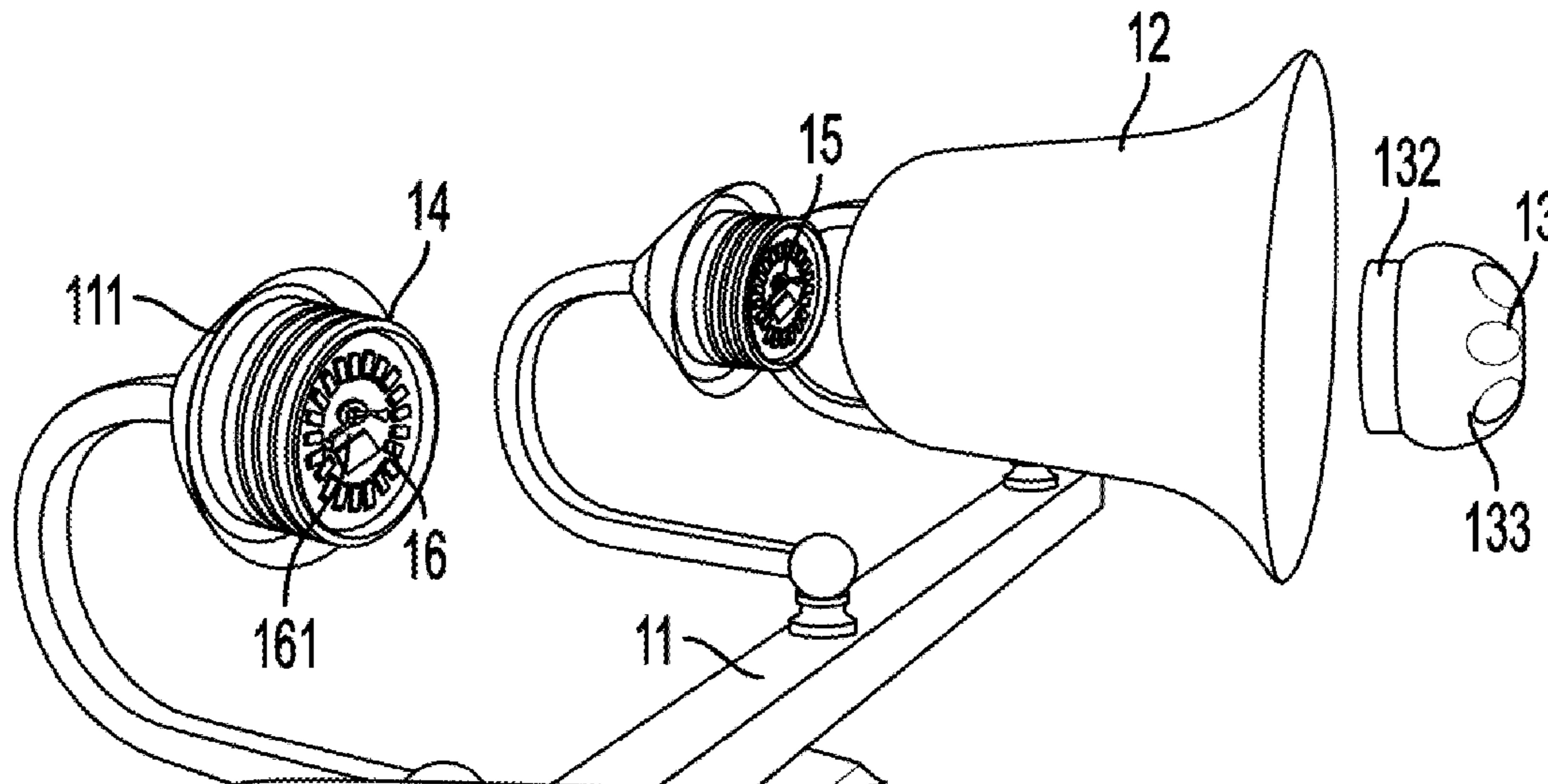

Related U.S. Application Data

continuation of application No. 16/007,636, filed on Jun. 13, 2018, now Pat. No. 10,473,301, which is a continuation of application No. 14/870,460, filed on Sep. 30, 2015, now Pat. No. 10,018,334, which is a division of application No. 13/832,712, filed on Mar. 15, 2013, now Pat. No. 9,194,554.

(51) **Int. Cl.**

F21V 1/00 (2006.01)
F21S 2/00 (2016.01)
F21V 19/00 (2006.01)
F21Y 115/10 (2016.01)

(52) **U.S. Cl.**

CPC *F21V 3/0625* (2018.02); *F21V 19/001* (2013.01); *F21Y 2115/10* (2016.08)

(56)

References Cited

U.S. PATENT DOCUMENTS

7,559,674 B2 7/2009 He et al.
 7,748,877 B1 7/2010 Colby
 7,810,951 B1 10/2010 Lee et al.
 7,866,850 B2 1/2011 Alexander et al.
 7,883,261 B2 2/2011 Yu
 8,246,204 B2 8/2012 McCanless
 8,253,310 B1 8/2012 Xia
 8,317,366 B2 11/2012 Dalton et al.
 8,434,917 B2 5/2013 Lai
 8,465,179 B2 6/2013 Thurgood et al.
 8,794,815 B2 8/2014 Hsien
 8,820,971 B2 9/2014 Markle et al.
 9,194,554 B2 11/2015 Feit
 9,388,946 B1 7/2016 Stagni
 9,416,922 B1 8/2016 Stagni
 9,416,939 B2 8/2016 Roth et al.
 10,018,334 B2 7/2018 Feit
 10,473,301 B2 11/2019 Feit
 11,112,093 B2 9/2021 Feit
 2003/0011323 A1 1/2003 Kirkpatrick et al.

2006/0262544 A1 11/2006 Piegras et al.
 2007/0230197 A1 10/2007 Scannell, Jr.
 2007/0253202 A1 11/2007 Wu et al.
 2008/0298075 A1 12/2008 Liao et al.
 2009/0251923 A1* 10/2009 Yu F21V 31/005
 362/653
 2009/0296402 A1 12/2009 Chang et al.
 2010/0237760 A1 9/2010 Yang
 2011/0075404 A1 3/2011 Allen et al.
 2011/0242813 A1 10/2011 Markle et al.
 2011/0242815 A1 10/2011 Markle et al.
 2011/0316418 A1 12/2011 Lai
 2012/0014100 A1 1/2012 Thurgood et al.
 2012/0250302 A1 10/2012 Edwards et al.
 2012/0314407 A1 12/2012 Souvay
 2013/0058087 A1 3/2013 Chang
 2014/0192536 A1 7/2014 Hsien
 2014/0268742 A1 9/2014 Feit

OTHER PUBLICATIONS

U.S. Appl. No. 16/007,636, filed Jun. 13, 2018, U.S. Pat. No. 10,473,301, Patented.
 U.S. Appl. No. 14/870,460, filed Sep. 30, 2015, U.S. Pat. No. 10,018,334, Patented.
 U.S. Appl. No. 13/832,712, filed Mar. 15, 2013, U.S. Pat. No. 9,194,554, Patented.
 United States Patent and Trademark Office, Office Action for U.S. Appl. No. 13/832,712, dated Feb. 18, 2015.
 United States Patent and Trademark Office, Notice of Allowance for U.S. Appl. No. 13/832,712, dated Jul. 17, 2015.
 United States Patent and Trademark Office, Office Action for U.S. Appl. No. 14/870,460, dated Oct. 5, 2016.
 United States Patent and Trademark Office, Office Action for U.S. Appl. No. 14/870,460, dated Mar. 21, 2017.
 United States Patent and Trademark Office, Office Action for U.S. Appl. No. 14/870,460, dated Jul. 11, 2017.
 United States Patent and Trademark Office, Office Action for U.S. Appl. No. 14/870,460, dated Nov. 17, 2017.
 United States Patent and Trademark Office, Notice of Allowance for U.S. Appl. No. 14/870,460, dated Mar. 21, 2018.

* cited by examiner

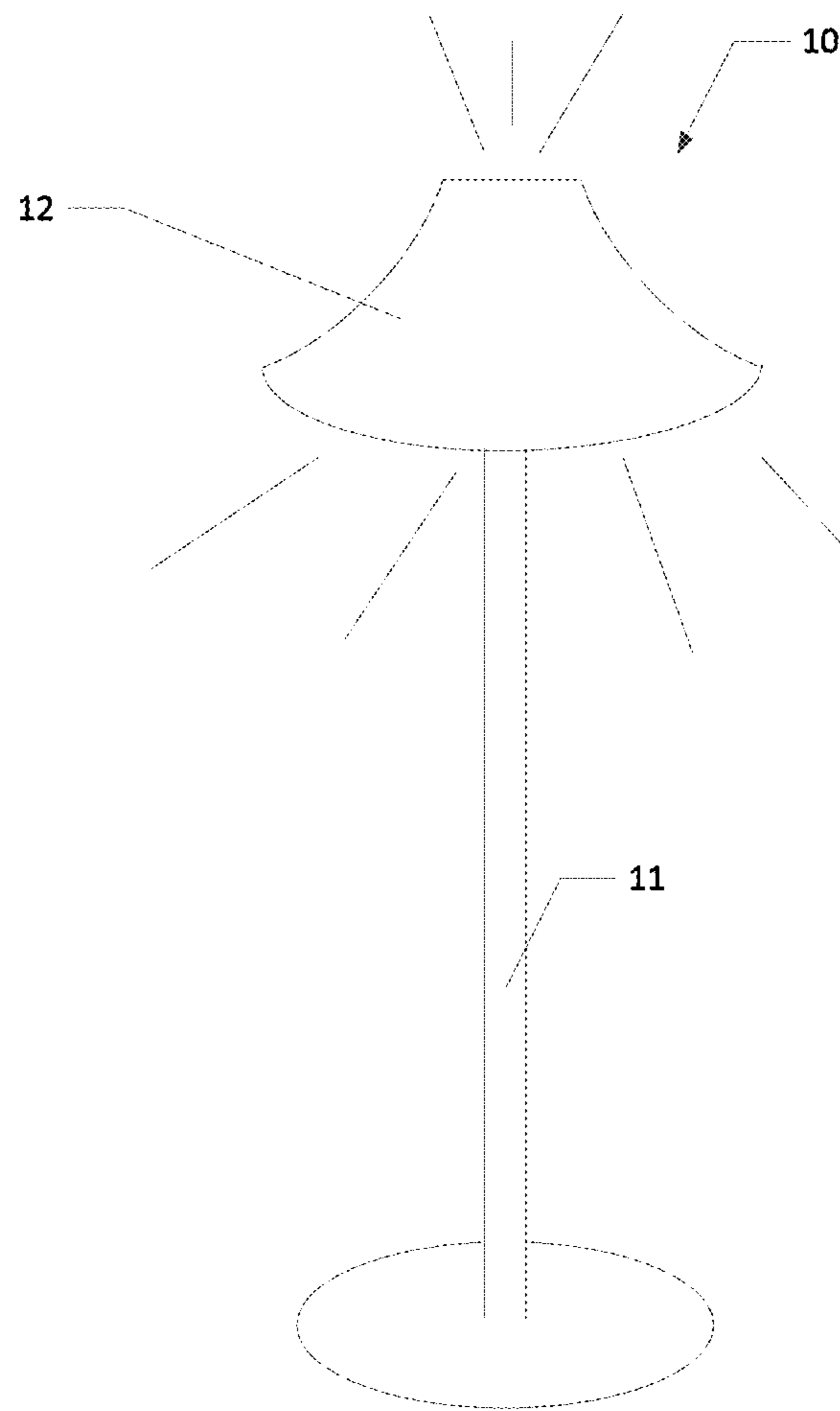

FIG. 1

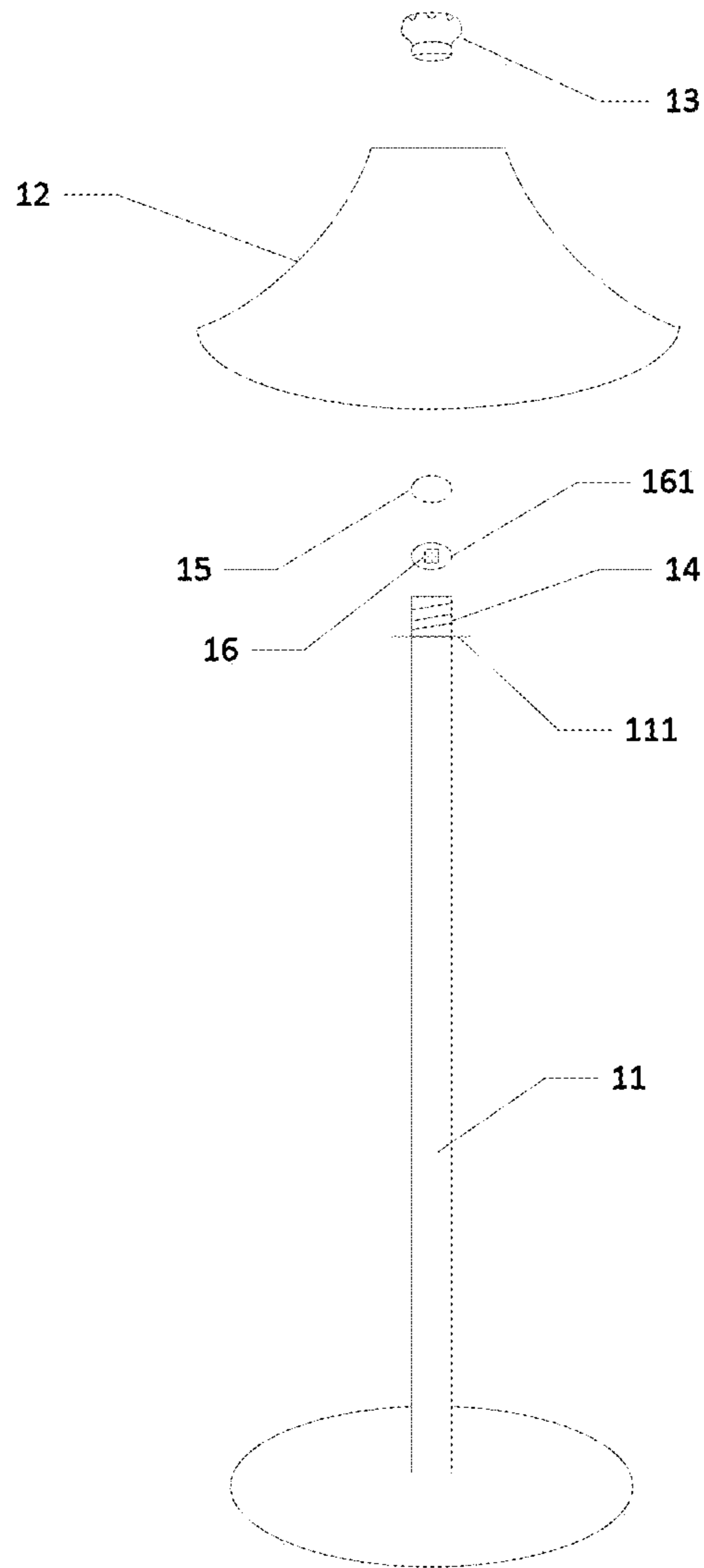

FIG. 2

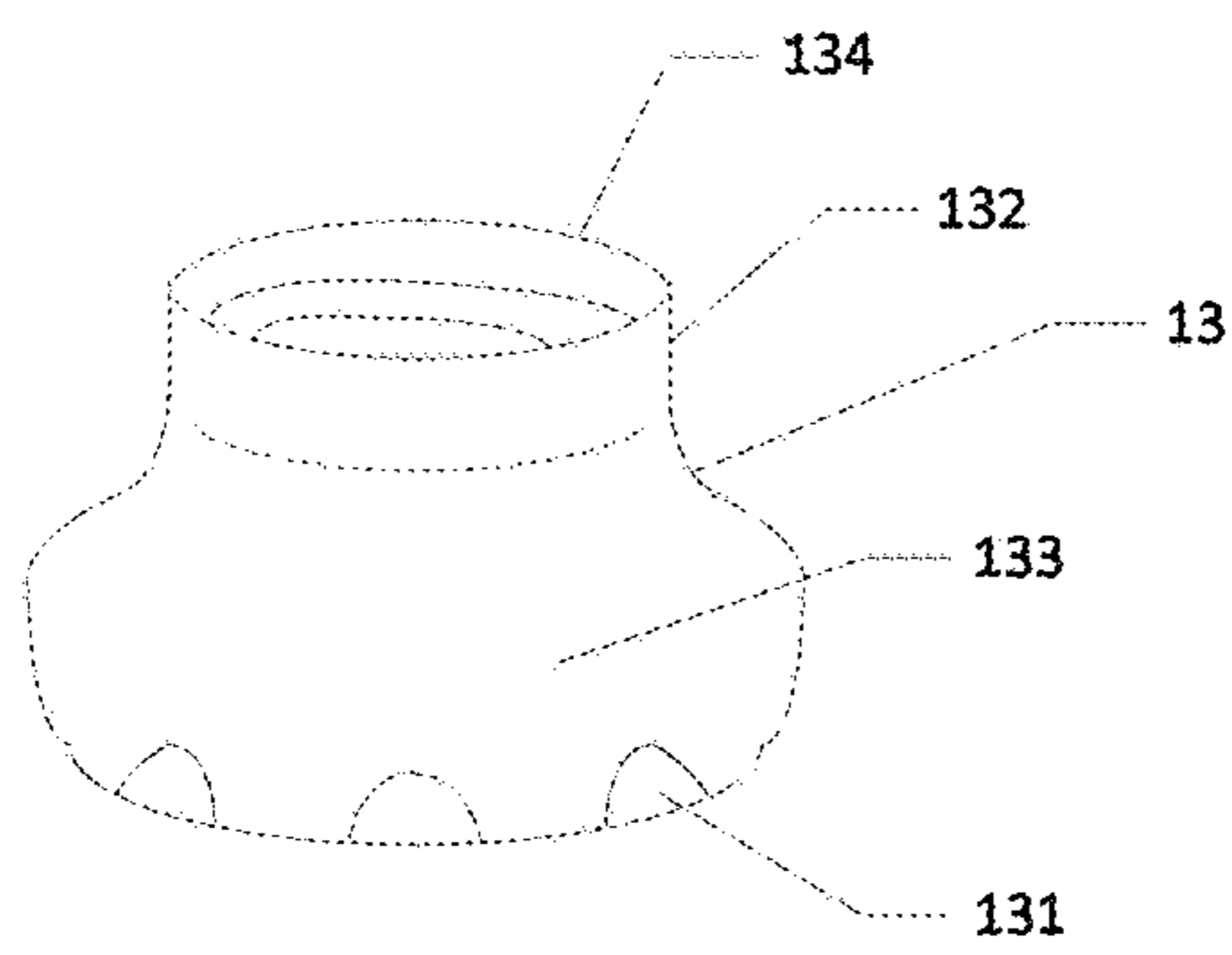

FIG. 3A

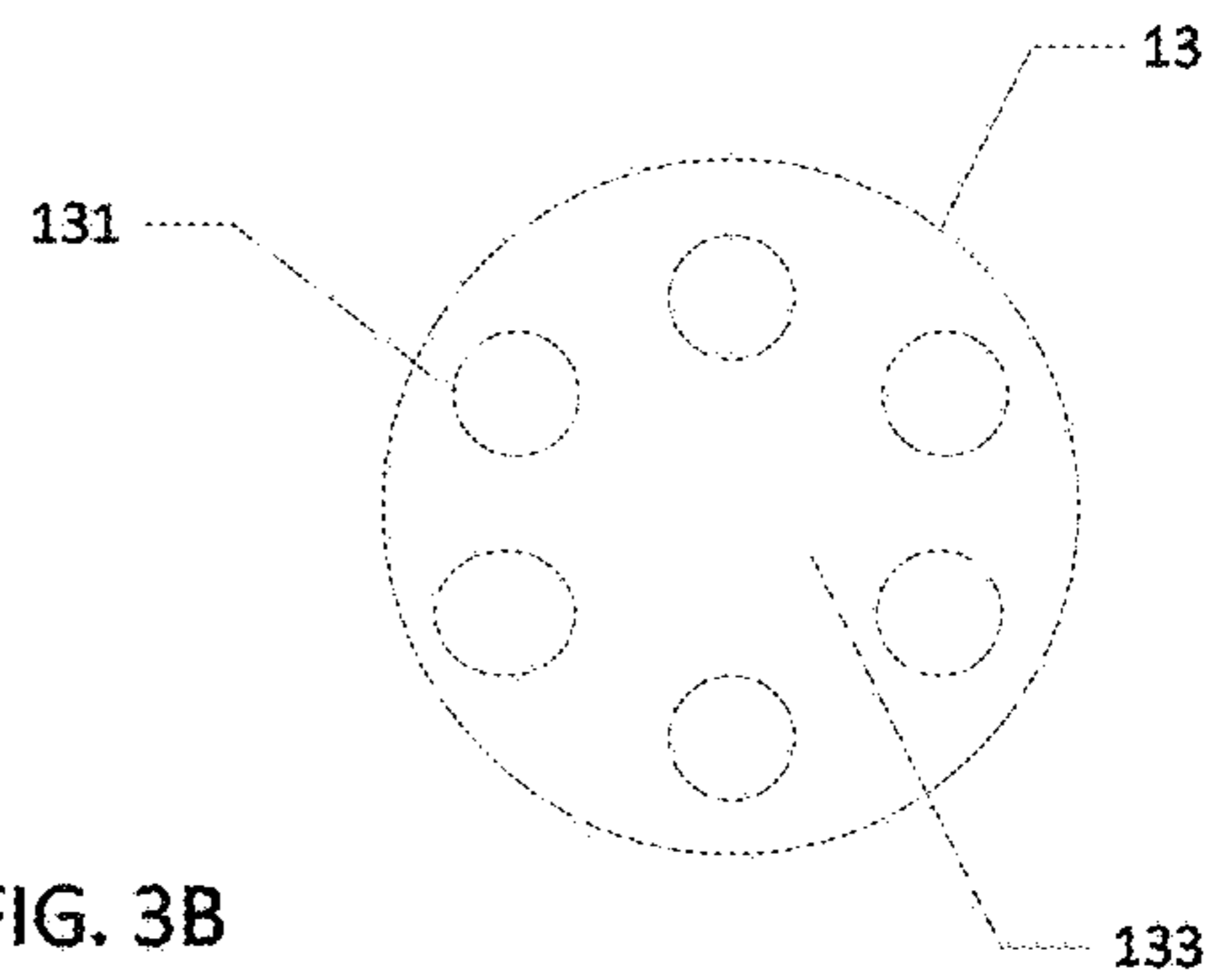

FIG. 3B

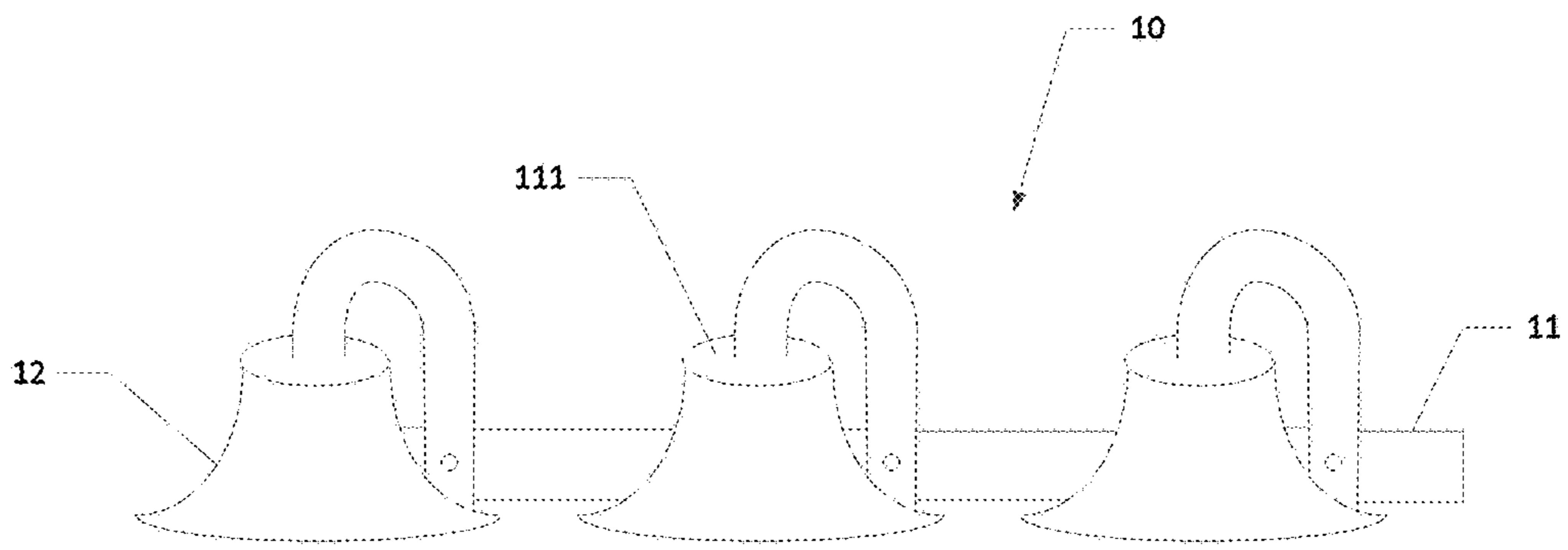

FIG. 4

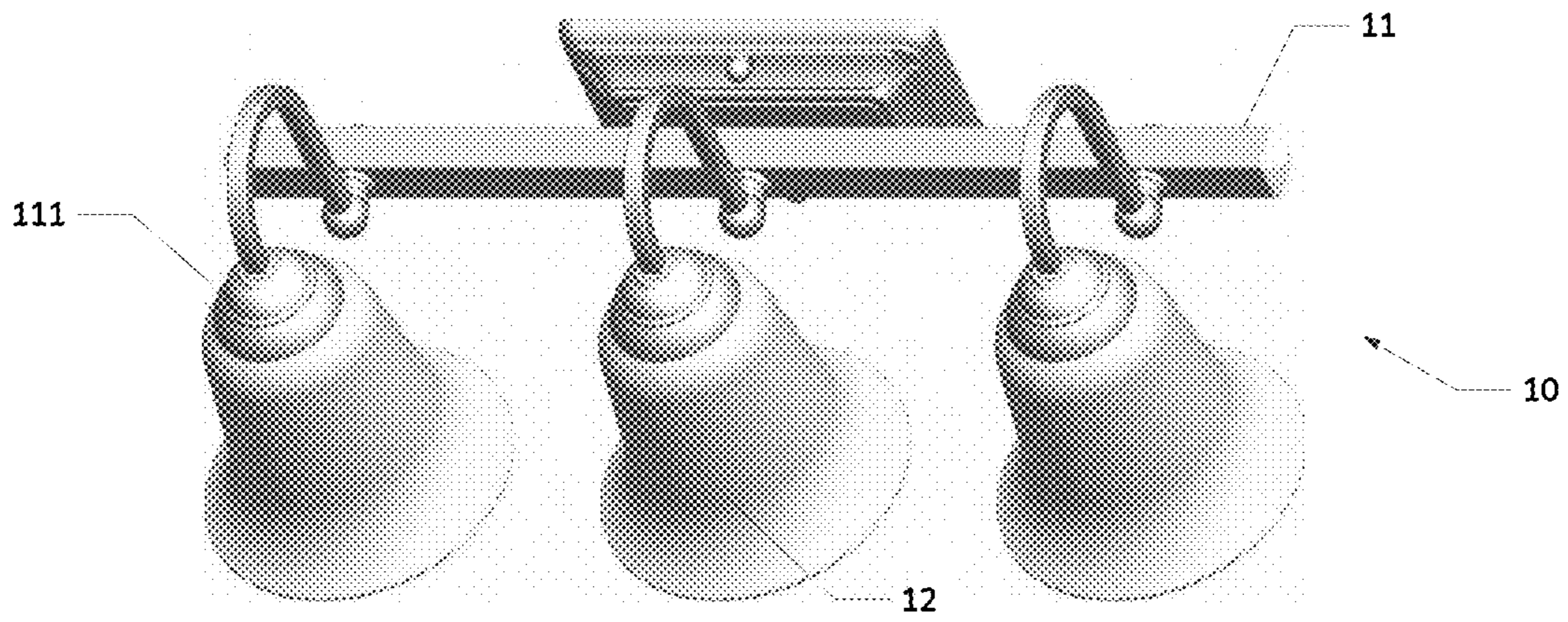

FIG. 5

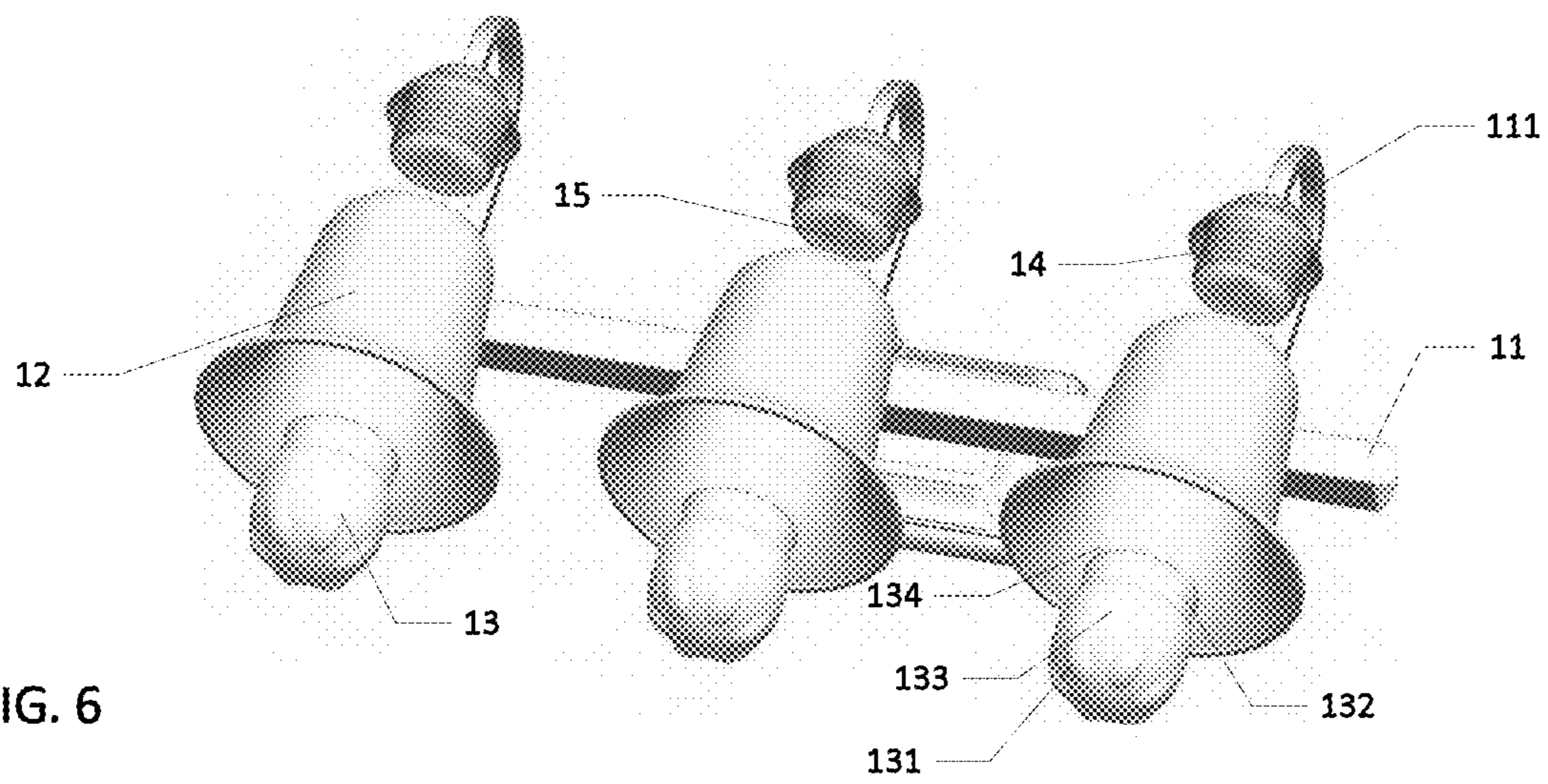

FIG. 6

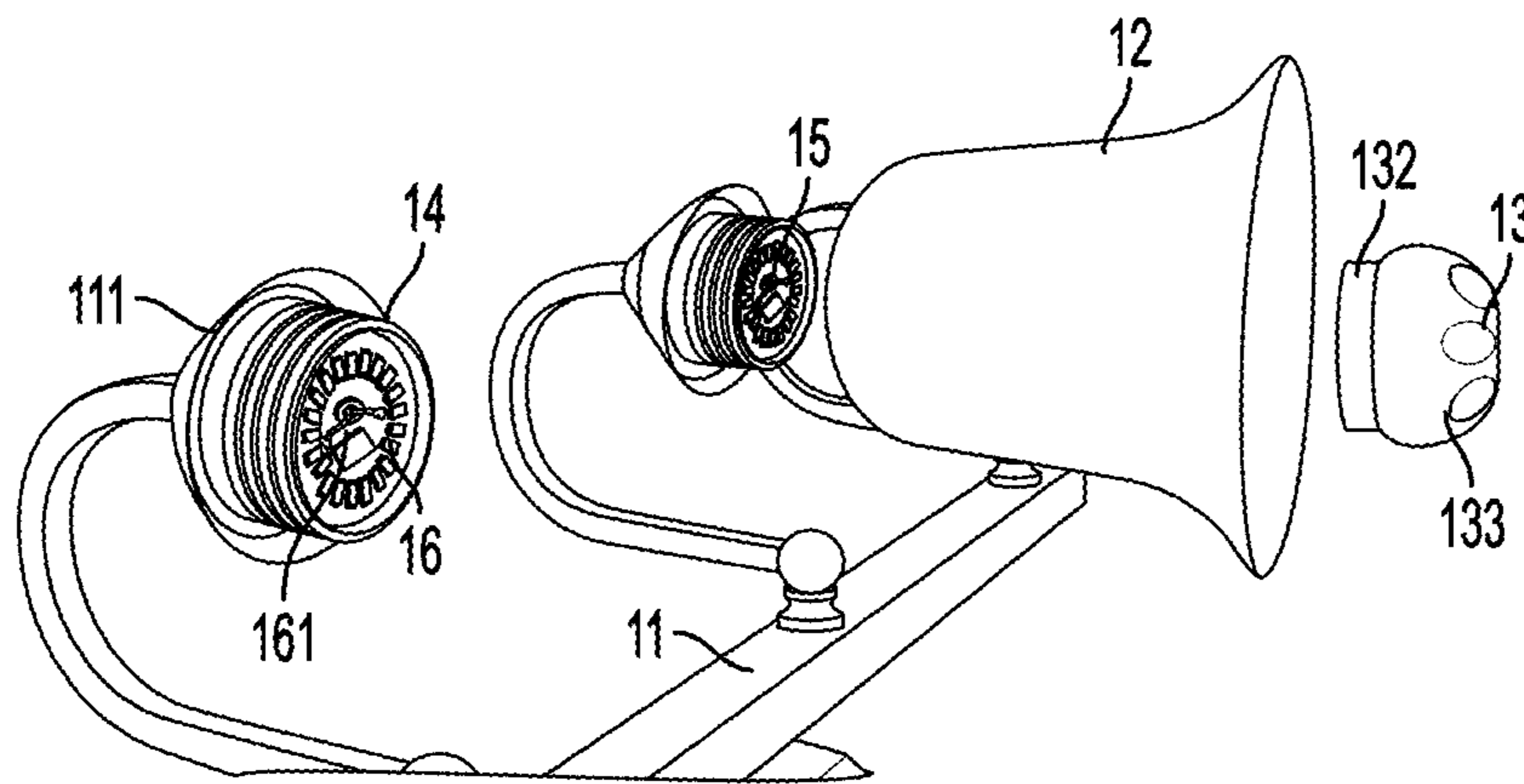

FIG. 7

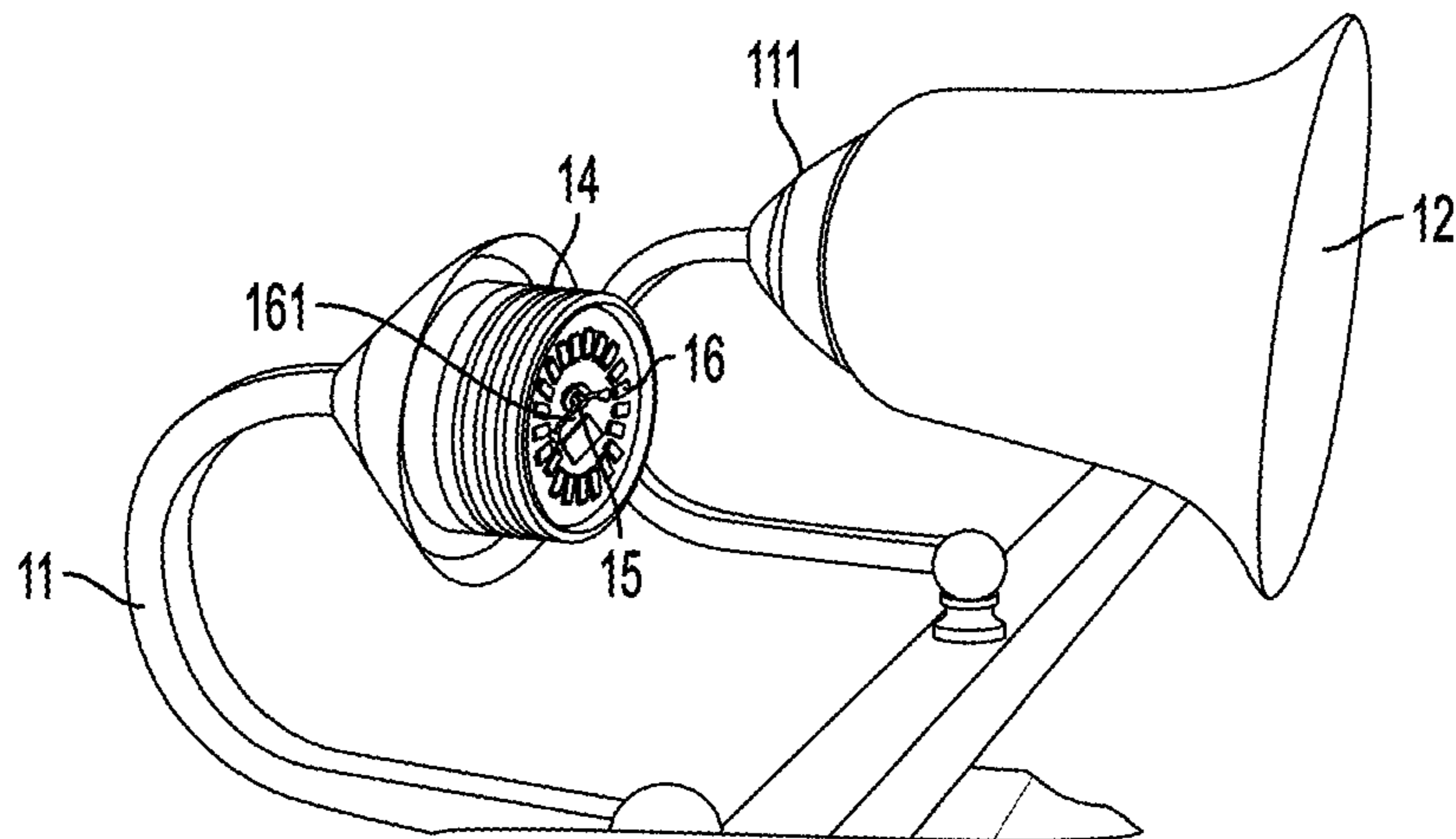

FIG. 8

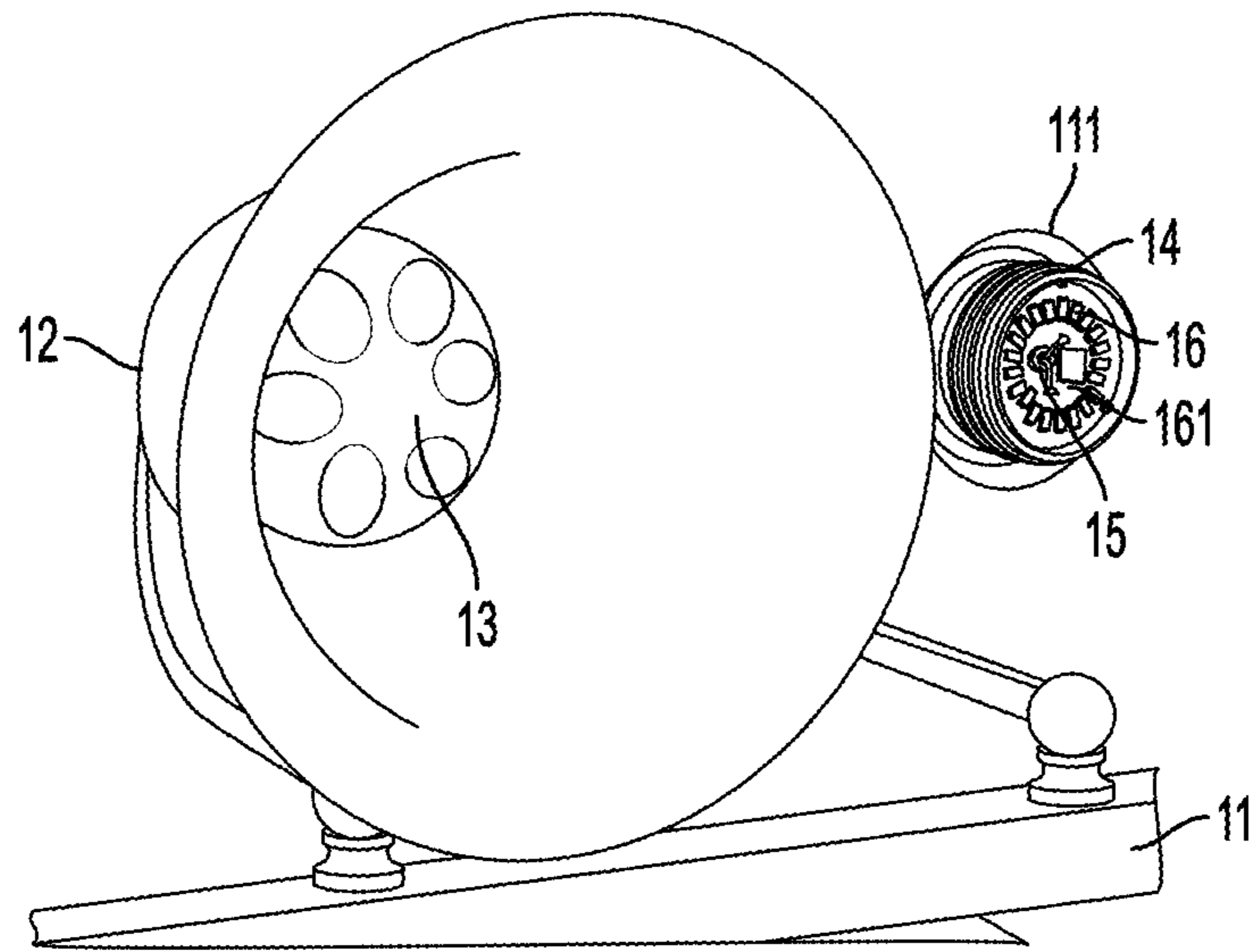

FIG. 9

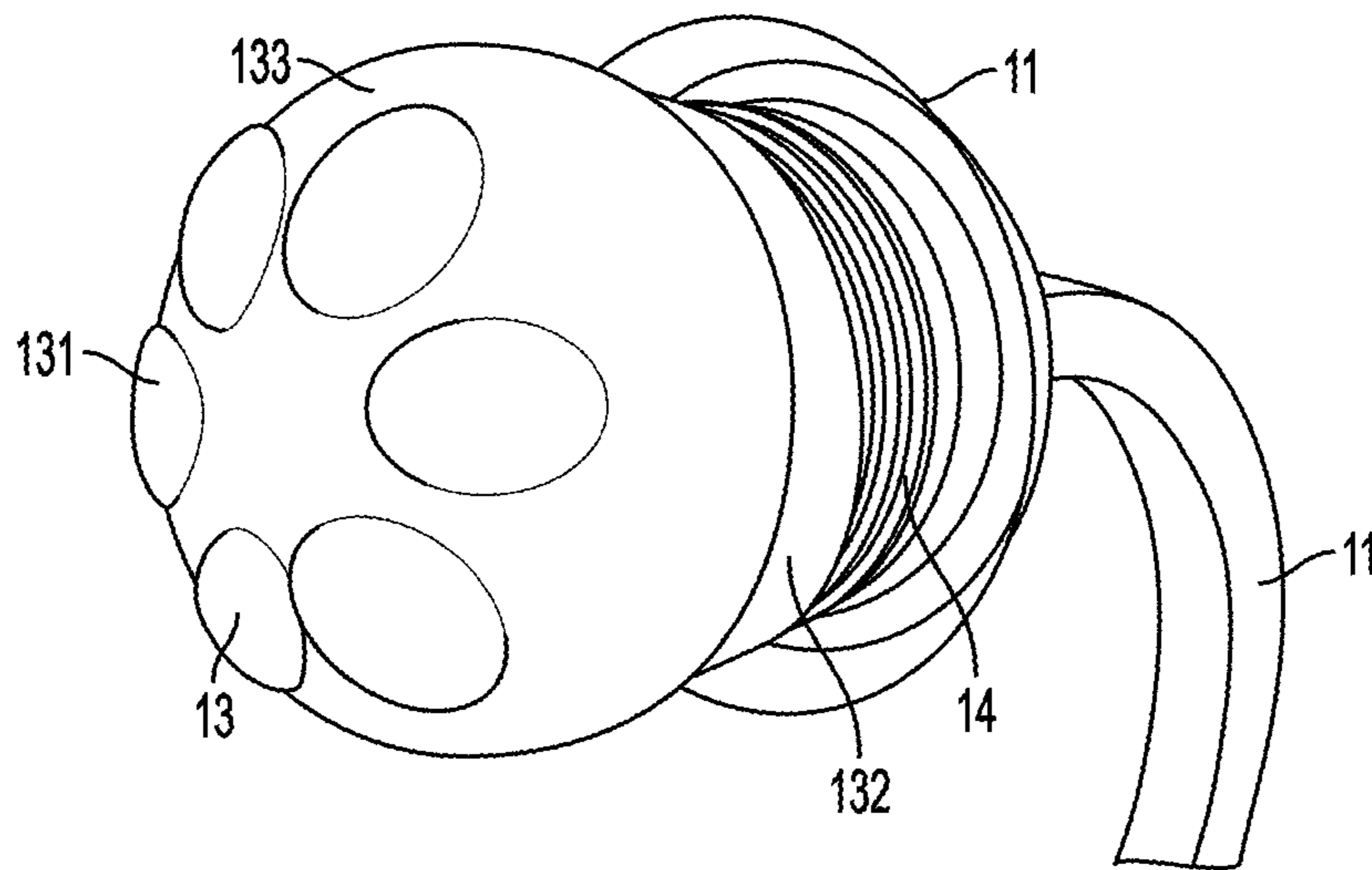

FIG. 10

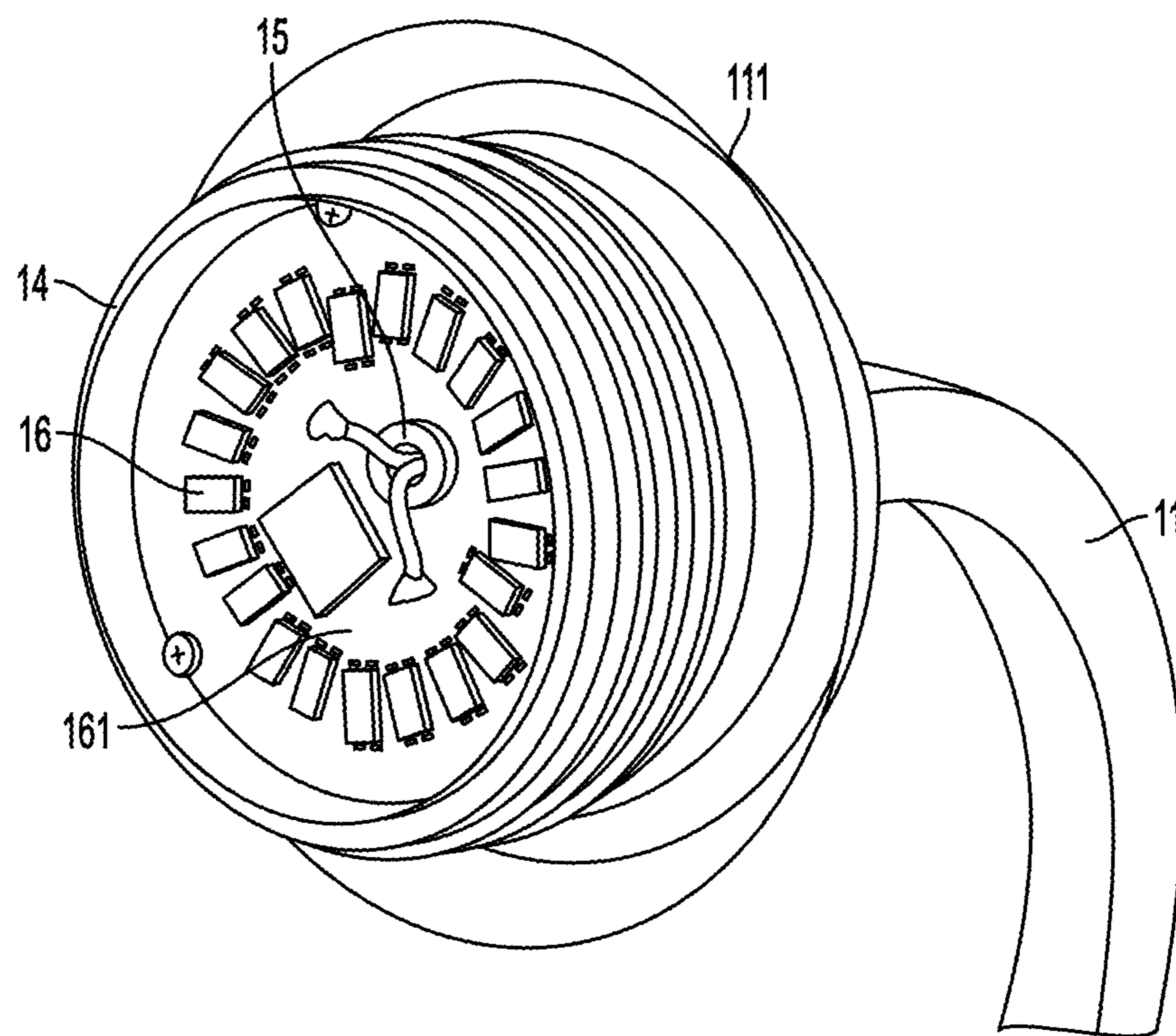

FIG. 11

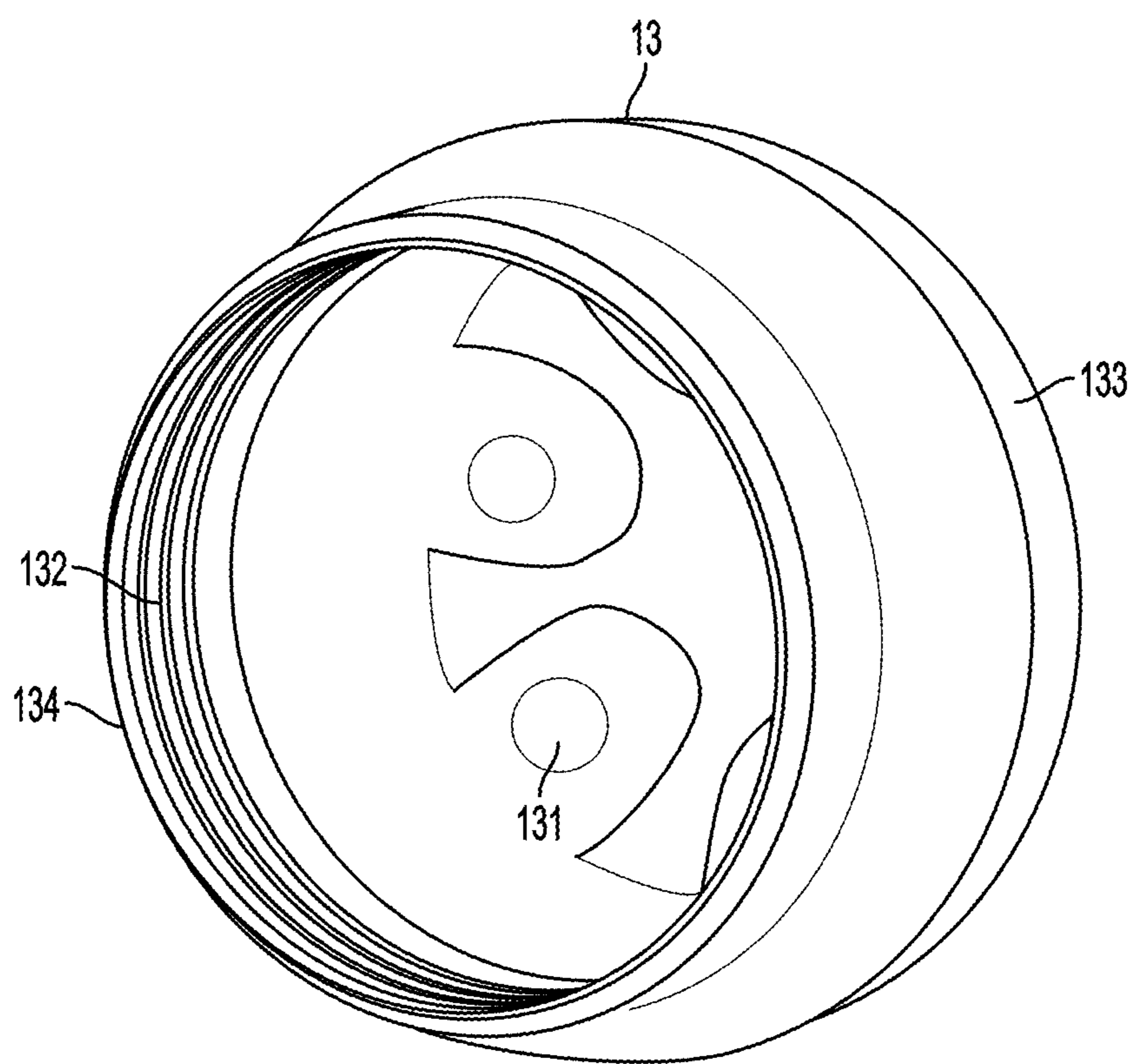

FIG. 12

LED LIGHTING FIXTURE ASSEMBLY**CROSS-REFERENCE TO RELATED APPLICATIONS**

This application is a continuation of U.S. application Ser. No. 16/591,956, filed Oct. 3, 2019, which application is further a continuation of U.S. application Ser. No. 16/007,636, filed Jun. 13, 2018 and also known as U.S. Pat. No. 10,473,301, granted Nov. 12, 2019; which application is further a continuation of U.S. application Ser. No. 14/870,460, filed Sep. 30, 2015 and also known as U.S. Pat. No. 10,018,334, granted Jul. 10, 2018; which application is further a divisional of U.S. application Ser. No. 13/832,712, filed Mar. 15, 2013 and also known as U.S. Pat. No. 9,194,554, granted Nov. 24, 2015; all of which are hereby incorporated by reference in their entireties.

BACKGROUND

Incandescent bulbs are slowly being phased out in favor of more efficient lighting sources. This has led to an increased use of compact fluorescent bulbs which are more efficient than incandescent bulbs, but which tend to contain dangerous gasses, such as mercury. Additionally, many people find the color temperature of light emitted by compact fluorescents to not be aesthetically pleasing for many applications, such as household lighting in kitchens, bathrooms, and living rooms; some commercial applications; and the like.

Recent advances in manufacturing light emitting diodes (LEDs) combined with the efficiency and long lifetime of LEDs have led to an increase in the availability and affordability of LED lamps. LED lamps offer advantages over compact fluorescent bulbs including longer lifetime and the absence of dangerous gasses. Also, LED lamps may be configured to emit light at a wide variety of color temperatures.

Both incandescent bulbs and compact fluorescent bulbs must be designed to maintain a specific environment within the bulb (e.g., a vacuum or a specific mix of gasses). LEDs, by contrast, can function under regular atmospheric conditions. However, because LEDs are small, solid state devices, LED lamps generally utilize board mounted LEDs. Therefore, the electrical components of an LED lamp may be exposed, providing a possible safety hazard.

Thus, there is a need for LED lighting fixtures which are safe for household and commercial uses. Additionally, there is a need for aesthetically pleasing LED lighting fixtures.

BRIEF SUMMARY

The present invention provides a safe, simple, and aesthetically pleasing lighting fixture assembly that utilizes a plurality of LEDs as the light source.

In various embodiments, the lighting fixture assembly comprises a fixture mounting which can be mounted on a wall or ceiling or other surface or can be configured to rest upon a desk or table or the floor, or the like. In other various embodiments, the lighting fixture may be configured to be held in a user's hand or incorporated into a clothing or accessory item that can be worn by the user. In various embodiments, the fixture mounting may contain at least one socket that may have at least one LED mounted within the at least one socket. In various embodiments, a shield may enclose the at least one LED into the socket and may electrically and/or physically isolate the at least one LED

from the user. In various embodiments, the lighting fixture assembly may further comprise at least one decorative light shade. The at least one decorative light shade may have an opening disposed within the decorative light shade that may be configured such that the light shade can be slid onto the socket. In other embodiments, the decorative light shade may be configured to workably connect to the socket by other mechanisms. In various embodiments, the lighting fixture may also comprise at least one cover member which may be configured to rotationally connect to the at least one socket; therefore locking the at least one decorative light shade onto the at least one socket. The at least one cover may also be configured to disperse the light emitted from the one or more LEDs mounted within the at least one socket. Thus, to a user viewing the lighting fixture, it may appear that the light source is suspended within the at least one decorative light shade rather than mounted within the at least one socket.

In various embodiments, an LED lighting fixture is provided. In such embodiments, the LED lighting fixture may comprise: at least one socket comprising a peripheral wall, the peripheral wall having an external surface and an internal surface, the internal surface defining a socket opening; at least one LED positioned substantially within an interior of the socket opening; at least one shield member positioned adjacent the at least one socket such that a perimeter of the at least one shield member is positioned adjacent the peripheral wall so as to substantially enclose the socket opening; at least one decorative light shade; at least one cover comprising a neck portion having an external surface and an internal surface, the internal surface defining a cover opening, wherein: the cover opening is configured to receive there-through at least a portion of the at least one socket, such that the internal surface of the neck portion substantially engages the external surface of the peripheral wall; at least a portion of the cover is configured to substantially engage the decorative light shade; and at least a portion of the cover is configured to substantially enclose the at least one LED and the at least one shield member.

In other embodiments, an LED lighting fixture is provided comprising: at least one socket comprising a socket opening defining an interior socket chamber of the at least one socket; at least one LED substantially positioned within the interior socket chamber; at least one shield substantially secured within the interior socket chamber such that the at least one LED is substantially enclosed within the interior socket chamber by the shield; and at least one cover comprising a cover opening, the cover opening defining an interior cover chamber of the at least one cover, the at least one cover being operatively mounted to the at least one socket such that at least one of the LEDs and at least one of the shields are positioned within at least a portion of the interior cover chamber opening.

In still other embodiments, a vanity lighting fixture is provided, comprising: two or more sockets each comprising a first opening defining an interior chamber of each of the two or more sockets; two or more LEDs wherein at least one LED is positioned within the interior chamber of each of the two or more sockets; two or more shields wherein each shield is positioned within the interior chamber of one of the two or more sockets such that the at least one LED is enclosed within the first chamber by the shield; two or more covers each comprising a second opening defining an interior chamber of each of the two or more covers, the two or more covers each secured to one of the two or more sockets such that the at least one LED positioned within the one of two or more sockets is positioned within the second opening

of one of the covers; and two or more decorative light shades wherein each decorative light shade is secured to one of the two or more sockets via one of the two or more covers.

In another aspect of the present invention, a method of installing an LED lighting fixture is provided, the method comprising the steps of: providing an LED lighting fixture comprising at least one socket comprising a first opening; mounting or placing the lighting fixture on an appropriate surface; sliding a light shade onto at least one of the at least one socket of the lighting fixture; operatively mounting a cover onto the at least one socket wherein mounting the cover secures the light shade to the at least one socket.

BRIEF DESCRIPTION OF THE SEVERAL VIEWS OF THE DRAWING(S)

Having thus described the invention in general terms, reference will now be made to the accompanying drawings, which are not necessarily drawn to scale, and wherein:

FIG. 1 is a side view of an assembled lighting fixture, according to various embodiments of the present invention;

FIG. 2 is an exploded side view of the lighting fixture illustrated in FIG. 1;

FIG. 3A is a side view of a cover, according to various embodiments of the present invention;

FIG. 3B is a front view of a cover, according to various embodiments of the present invention;

FIG. 4 is a side view of an assembled lighting fixture, according to various light embodiments of the present invention;

FIG. 5 is a top view of an assembled lighting fixture, according to various embodiments of the present invention;

FIG. 6 is an exploded view of the lighting fixture illustrated in FIG. 5;

FIG. 7 is an exploded perspective view of part of a lighting fixture, according to various embodiments of the present invention;

FIG. 8 is perspective view of part of a lighting fixture, according to various embodiments of the present invention;

FIG. 9 is a different perspective view of part of a lighting fixture, according to various embodiments of the present invention;

FIG. 10 is a perspective view of a cover secured to a socket, according to various embodiments of the present invention;

FIG. 11 is a perspective view of a socket attached to a fixture mounting, according to various embodiments of the present invention; and

FIG. 12 is a perspective view of a cover, according to various embodiments of the present invention.

DETAILED DESCRIPTION

The present invention now will be described more fully hereinafter with reference to the accompanying drawings, in which some, but not all embodiments of the invention are shown. Indeed, this invention may be embodied in many different forms and should not be construed as limited to the embodiments set forth herein; rather, these embodiments are provided so that this disclosure will satisfy applicable legal requirements. Like numbers refer to like elements throughout.

FIGS. 1, 4, and 5 show various embodiments of assembled lighting fixtures 10, according to various embodiments of the present invention. FIG. 1 illustrates at least one embodiment of a floor lamp style lighting fixture 10. FIGS. 4 and 5 illustrate various embodiments of a wall style

lighting fixture 10. In some embodiments, when the lighting fixture 10 is assembled, the visible components comprise at least one fixture mounting 11 and at least one decorative light shade 12.

FIGS. 2, 6, and 7 show exploded views of various embodiments of a lighting fixture 10. FIG. 2 is an exploded view of various embodiments of the at least one embodiment illustrated in FIG. 1. As shown in FIG. 2, in various embodiments, a single socket 14 is affixed on top of the fixture mounting 11. In various embodiments, at least one LED 16 may be mounted on a board 161. In various embodiments the at least one LED 16 may be inserted into the socket 14. In some such embodiments the at least one LED 16 may be workably connected to an electric power source. A shield 15 may be secured into the socket 14 on top of the at least one LED 16. In various embodiments, the shield 15 may be secured such that the outer surface of shield 15 is flush with the opening in socket 14. In other embodiments, the shield 15 may be secured into socket 14 such that outer surface of the shield 15 is recessed into the socket 14. In various embodiments, the outer or inner surface of socket 14 may be threaded. In these embodiments, the cover 13 may be configured with the mating threads and thus can be secured to the socket 14 via a proper mating of the threads. In other embodiments, the outer or inner surface of a socket 14 may have other means for securing cover 13. Components of various embodiments of the lighting fixture 10 will now be discussed in detail.

Structural Features of Various Embodiments

1. Fixture Mounting 11

Remaining with FIG. 2, in various embodiments, the fixture mounting 11 may provide the structural support for the lighting fixture 10. In various embodiments, the fixture mounting 11 may be configured to be placed on a desk, table, floor, or other surface, whether removably or otherwise. In certain embodiments, the fixture mounting 11 may be configured to be permanently mounted on a wall, ceiling, or other surface. In other embodiments, the fixture mounting 11 may be configured to be mounted in a selectively removable manner on a wall, ceiling, or other surface. Non-limiting examples of wall or ceiling-mounted lighting fixtures according to various embodiments comprise vanity fixtures, wall sconces, and overhead lighting fixtures. In still other embodiments, the fixture mounting 11 may be configured such that a user can choose whether to mount the lighting fixture 10 or to place the lighting fixture 10 on a surface. In yet other embodiments, the lighting fixture 10 may be configured to be held in the user's hand or incorporated into apparel or accessory items that can be worn by the user.

In various embodiments, the fixture mounting 11 may be made out of plastic. In other embodiments, the fixture mounting may be made out of metal or any other suitable material.

In various embodiments, the fixture mounting 11 may comprise the appropriate wiring for lighting fixture 10 to be operated via batteries or some other portable electric power source. In various such embodiments, the fixture mounting 11 may comprise a compartment that may be concealed within the fixture mounting 11 in which the batteries may be mechanically mounted within the fixture mounting 11. This compartment may also comprise a mechanism to electrically connect the batteries to the electrical components of the lighting fixture 10.

In various embodiments, the fixture mounting 11 may include an electrical cord that is workably connected to the

5

electrical components of the lighting fixture **10**. In various such embodiments, a plug configured for being plugged into an electrical socket may be disposed on one end of the electrical cord. In such embodiments, the electrical cord may be disposed in a base of the lighting fixture **10** or a different location on the lighting fixture **10**. In various embodiments, a set of electrical wires may be used rather than a single electrical cord. In other embodiments, the electrical cord or wires may be configured such that the lighting fixture **10** may be directly connected to line voltage. In various such embodiments, the electrical cord or wires may be disposed on the mounting surface of the fixture mounting **11**.

In various embodiments, the fixture mounting **11** may further comprise a power switch workably connected to the lighting fixture **10**. A wide variety of power switches are commonly known and well understood in the art. A few non-limiting examples of power switches which may be employed in various embodiments comprise chain pull switches, touch activated switches, "clap-on" switches, rotationally activated switches, slide activated switches, and the like. In various embodiments, the fixture mounting **11** does not include a power switch. In some such embodiments, the flow of electrical power to the lighting fixture **10** may be controlled through a wall mounted power switch, by plugging and unplugging an electrical cord from an electrical socket, or by other mechanisms.

Of course, it should be understood that, in various embodiments, fixture mounting **11** may have any of a variety of configurations, as such are commonly known and understood in the art, without departing from the scope of the invention.

2. Socket **14**

Still remaining with FIG. **2**, in various embodiments, lighting fixture **10** may further comprise at least one socket **14**. In various embodiments, the at least one socket **14** may provide structural and electrical support for at least one LED **16**. In such embodiments, the at least one LED **16** may be mounted within a socket **14** as will be discussed below. A socket **14** may also provide a mechanism to secure a decorative light shade **12** and/or a cover **13** in various embodiments, as detailed below.

In various embodiments, the at least one socket **14** may be generally circular or elliptical in cross-section. In other embodiments, the at least one socket **14** may be generally rectangular or alternatively shaped in cross-section. In various embodiments, the cross-section of the at least one socket **14** may not be the same at all points along the length of the at least one socket **14**. For example, in at least one embodiment, with a generally circular cross-section, the cross-section may have a different diameter at one point along the length of the at least one socket **14** than at another point along the length of the same socket **14**.

In various embodiments, the at least one socket **14** may be less than a quarter of an inch in diameter. In other embodiments, the at least one socket **14** may be less than an inch in diameter. In some embodiments, the at least one socket **14** may be one to three inches in diameter. In other embodiments, the at least one socket **14** may be larger than three inches in diameter. In various embodiments, the opening in socket **14** may be less than a quarter of an inch deep. In other embodiments, the opening in socket **14** may be a quarter of an inch to half an inch deep. In still other embodiments, the opening in socket **14** may be half an inch to an inch deep. In yet other embodiments, the opening in socket **14** may be deeper than one inch.

The at least one socket **14** may be mechanically connected to fixture mounting **11**, in various embodiments. In some

6

embodiments, the at least one socket **14** may be molded out of the same material as the fixture mounting **11**. In some embodiments, the at least one socket **14** may be co-molded with fixture mounting **11**. In other embodiments, the at least one socket **14** may be made out of a material different from fixture mounting **11**. In various such embodiments, the at least one socket **14** may be made out of aluminum or plastic. In other such embodiments, the at least one socket **14** may be made out of any suitable material. In some embodiments, the at least one socket **14** may be made by a method which is not molding.

In various embodiments, at least a portion of the outer and/or inner surface of the at least one socket **14** may be threaded. In these embodiments, the threads may be configured to engage with threads which may be present on the cover **13**. In other such embodiments, the threads may be configured to engage with threads on the decorative light shade **12**. In various embodiments, the outer and/or inner surface of the at least one socket **14** may not be threaded. In various such embodiments, the outer and/or inner surface of the at least one socket **14** may be smooth or include other mechanisms which may be used to secure the decorative light shade **12** and the cover **13** to the lighting fixture **10**. It should be appreciated that a variety of mechanisms are well known and understood in the art that may be used to operatively mount a cover **13** onto a socket **14** (or vice-versa) without departing from the scope of the present invention. Of course, it should also be understood that various alternatives to even incorporating a socket **14** at all may be employed in still other embodiments, as may be commonly known and used in the art.

In various embodiments, such as those illustrated in FIGS. **6-9**, the lighting fixture **10** may comprise more than one socket **14**. Various embodiments may comprise two, three, four or more sockets **14**. In various such embodiments, at least one LED **16** may be secured in each socket **14**, wherein the at least one LED **16** may be workably connected to an electric power source. In some such embodiments, a shield **15** may be mounted in each socket **14** to electrically isolate the user from the at least one LED **16** mounted within each socket **14**. A decorative light shade **12** may be secured to each socket **14**, in some embodiments. In other embodiments, one or more light shades **12** may be configured such that one decorative light shade **12** may correspond to more than one socket **14**. One non-limiting example of at least one such embodiment may be that a light shade **12** is configured to be secured to two sockets **14**. In various embodiments, a cover **13** is secured to each socket **14**. In other various embodiments, a cover **13** may be configured to be secured to more than one socket **14**. A non-limiting example may be if a light shade **12** is configured to be secured to two sockets **14**, a cover **13** may also be configured to be secured to two sockets **14**.

3. Light Shade Seat **111**

Returning to FIG. **2**, located at or near the base of the at least one socket **14**, in various embodiments, there may be a light shade seat **111**. In certain embodiments, the light shade **111** seat may be engaged by the decorative light shade **12**, as will be described in further detail elsewhere herein. Of course, in other embodiments, the light shade seat **111** may merely serve a decorative function, as may be desirable for particular applications.

In various embodiments, the light shade seat **111** is generally circular or elliptical. In other embodiments, the light shade seat **111** may be generally rectangular or alternatively shaped. In certain embodiments, the light shade seat **111** may comprise one or more prongs. In at least one

embodiment, the light shade seat **111** may comprise three prongs which are evenly spaced around the circumference of the socket **14**. In other embodiments, the light shade seat **111** may be generally semi-circular or semi-elliptical. In various such embodiments, the light shade seat **111** may comprise a half or a third of a circle or ellipse. In other such embodiments, the light shade seat **111** may comprise two portions of a circle which are disposed at different points around a circumference of the socket **14**. As will be appreciated, a number of other shapes are possible for the light shade seat **111** in keeping with various embodiments of the lighting fixture **10**.

In various embodiments, the diameter of a light shade seat **111** is only an eighth of an inch larger than the diameter of the at least one socket **14**. In other embodiments, the diameter of the light shade seat **111** is an eighth to a quarter of an inch larger than the diameter of the at least one socket **14**. In still other embodiments, the diameter of the light shade seat **111** is a quarter to three-quarters of an inch larger than the diameter of the at least one socket **14**. In yet other embodiments, the diameter of the light shade seat **111** is three-quarters of an inch to an inch and a half larger than the diameter of the at least one socket **14**. In certain embodiments, the diameter of the light shade seat **111** is an inch and a half to three inches larger than the diameter of the at least one socket **14**. In certain other embodiments, the diameter of the light shade seat **111** maybe larger than three inches larger than the diameter of the at least one socket **14**.

In various embodiments, the one or more light shade seats **111** are made out of the same material as the fixture mounting **11**. In various such embodiments, the one or more light shade seats **111** may be a different color or include a different finish than the fixture mounting **11**. In other such embodiments, the color or finish of the one or more light shade seats is the same as the fixture mounting **11**. In other embodiments, the one or more light shade seats **111** may be made of any appropriate material, including a material different from the fixture mounting **11**.

In some embodiments, a light shade seat may be mounted at some point along the length of the at least one socket **14**. In certain embodiments, the light shade seat **111** may be mounted half way along the length of the at least one socket **14**. In other embodiments, the light shade seat **111** may be mounted on the fixture mounting **11** below the at least one socket **14**. In some embodiments, the at least one socket **14** may be mounted in the middle of the light shade seat **111**. Other embodiments may not include a light shade seat **111**.

In various embodiments, decorative light shade **12** may rest upon or against light shade seat **111** when light shade **12** is slid or secured onto the socket **14**. In other embodiments, light shade seat **111** may not be used to mechanically hold the light shade **12** in an appropriate position and may be included for aesthetic purposes only. Some embodiments may not include a light shade seat **111**.

In various embodiments, a light shade seat **111** may be planar in nature. In other embodiments, a light shade seat **111** may have a concave curvature. In still other embodiments, a light shade seat **111** may be convex in curvature. In certain embodiments, a light shade seat **111** may comprise portions which are convex, concave, and/or planar in curvature. In various embodiments, the curvature of the light shade seat **111** may be chosen as appropriate for various applications.

As noted above and illustrated in FIGS. 4-9, in various embodiments, more than one socket **14** may be present. In various such embodiments, more than one light shade seat **111** may also be present. In some such embodiments, each

light shade seat **111** may be associated with a single socket **14**. In other various such embodiments, one or more light shade seats **111** may be associated with more than one socket **14**. Of course, it should be understood that any of a variety of alternatives to a light shade seat **111** may be employed, as commonly known and understood in the art, without departing from the scope of the present invention.

4. Light Emitting Diode (LED) **16**

Again returning to FIG. 2, in various embodiments, at least one LED **16** may be secured in the at least one socket **14**. Any circuitry necessary to operate the one or more LEDs **16** may be mounted within the fixture mounting **11** or socket **14** according to various embodiments. In various embodiments, the at least one LED **16** may be an alternating current (AC) driven LED. In other embodiments, the at least one LED **16** may be a direct current (DC) driven LED. In some embodiments, no driver circuitry is necessary to operate the one or more LEDs **16**. In other embodiments, one driver circuit may operate all the LEDs **16** present in lighting fixture **10**. In still other embodiments, multiple driver circuits may be used to operate the one or more LEDs **16**. In some such embodiments a driver circuit may be mounted in each socket **14**.

In various embodiments, the driver circuit (not shown) may comprise a circuit portion configured to convert AC voltage into DC voltage. In some embodiments, the driver circuit may comprise a circuit portion configured to control the current flowing through the one or more LEDs **16**. In certain embodiments, the driver circuit may comprise a circuit portion configured to dim the lighting fixture **10**. In various embodiments, additional circuit components may be present in the driver circuitry. Similarly, in various embodiments, all or some of the circuit portions mentioned here may not be present in the driver circuit. In some embodiments, circuit portions listed herein as separate circuit portions may be combined into one circuit portion. As should be appreciated, a variety of driver circuitry configurations are generally known and understood in the art and any of such may be employed in various embodiments as suitable for the intended application, without departing from the scope of the present invention.

The at least one LED **16** may be of various color temperatures or various colors. In various embodiments, the at least one LED **16** may be white LEDs. In other embodiments, at least one of the at least one LEDs **16** may be a colored LED, such as a red, blue, green, or other colored LED. In various embodiments, different LEDs **16** secured within the same socket **14** may have different color temperatures. In other embodiments, all LEDs **16** in the lighting fixture **10** are designed to have approximately the same color temperature. In still other embodiments, the at least one LED **16** mounted in one socket **14** may be a different color temperature than the at least one LED **16** mounted in a different socket **14**. For each embodiment, the color temperature of the one or more LEDs **16** may be chosen as appropriate for the expected use of lighting fixture **10**.

In various embodiments, the at least one LED **16** may be mounted on a board **161** by any suitable method commonly known and understood in the art. In some such embodiments, any driver circuitry present may also be mounted on the board **161**. In some embodiments, 21 or more LEDs may be mounted on a board **161**. In other embodiments, no more than 5 LEDs are mounted on a board **161**. In other embodiments, six to fifteen LEDs **16** may be mounted on a board **161**. In yet other embodiments, sixteen to twenty LEDs **16** may be mounted on a board **161**.

In various embodiments, the board **161** may be made of a reflective material. In other embodiments, the board **161** may be coated with a reflective material. Therefore, at least some portion of the light emitted from the at least one LED **16** in the direction of the board **161** or light that has been reflected back at the board **161** will be reflected off of the board **161**.

In various embodiments, a board **161** is secured into a socket **14**. In various such embodiments, at least one LED **16** is mounted on board **161**. In various embodiments, driver circuitry may also be mounted to the board **161**. In some such embodiments, the driver circuitry may be mounted on the opposite side of the board **161** than the side on which the at least one LED **16** is mounted. In various embodiments, the board **161** may be mounted into socket **14** via one or more set screws. In some embodiments, the board **161** may be closed into the socket **14** by securing a shield **15** on top of the at least one LED **16** and board **161** in the socket **14**. In other embodiments, the board **161** may be mounted into socket **14** via an appropriate adhesive. In yet other embodiments, the board **161** may be mounted into socket **14** by other suitable mechanisms.

As discussed above and as illustrated in FIGS. **4-9**, various embodiments may comprise two or more sockets **14**. In various such embodiments, a board **161** may be mounted into each socket **14**, at least one socket **14**, or none of the sockets **14**. In some such embodiments, at least one LED **16** is mounted on each board **161**. In various embodiments, at least one LED **16** may be operatively mounted in each socket **14**, as may be desirable for particular applications.

5. Shield **15**

Returning to FIG. **2**, in various embodiments, a shield **15** may be secured within the socket **14** on top of the at least one LED **16** that may be secured into a socket **14**. In various embodiments, the shield **15** may be used to secure the at least one LED **16** into socket **14**. In some embodiments, the shield **15** may be used to electrically and/or physically isolate the user from the electrical components of the lighting fixture **10**. In various such embodiments, the shield **15** may be used to meet various safety standards such as UL Standards or other standards governing the lighting industry or otherwise, as may be necessary for particular applications.

In various embodiments, the shield **15** may be planar, convex, or concave, as suitable for various applications. In various embodiments, the shield **15** may be generally circular or elliptical. In other embodiments, the shield **15** may be generally rectangular or alternatively shaped. In some embodiments, the shield **15** may have the same shape as the cross section of the socket **14**. In other embodiments, the shape of the shield **15** may be different than the cross-section of the socket **14**.

In various embodiments, the shield **15** may have a diameter that is substantially the same as the inner diameter of the socket **14**. In other embodiments, the shield **15** may have a diameter which is larger than the diameter of the socket **14**. In various such embodiments, the diameter of the shield **15** may be small enough that the shield **15** does not prevent the decorative light shade **12** and/or the cover **13** from being secured to the socket **14**. In still other embodiments, the diameter of the shield **15** may be smaller than that of the socket **14**. In yet other embodiments, a lighting fixture **10** may not comprise a shield **15**.

In various embodiments, the shield **15** is configured such that at least some portion of the light emitted by the at least one LED **16** may pass through the shield **15**. In certain embodiments, the shield **15** may be configured such that at

least 10% of the light emitted by the at least one LED **16** passes through the shield **15**. In some embodiments, the shield **15** is configured such that at least a significant fraction of the light emitted by the at least one LED **16** passes through the shield **15**. In certain embodiments, the shield **15** may be configured such that at least 40%, 50%, or 60% of the light emitted by the at least one LED **16** pass through the shield **15**. In some embodiments, the shield **15** is configured such that nearly all of the light emitted by the at least one LED **16** passes through the shield **15**. In certain embodiments, the shield **15** may be configured such that at least 80% or 90% of the light emitted by the at least one LED **16** passes through the shield **15**. In various embodiments the shield **15** may be configured such that a fraction of the light emitted by the at least one LED **16** that is appropriate for the application passes through the shield **15**.

In various embodiments, the shield **15** may be made from a polymerized material, as commonly known and understood in the art. In certain embodiments, the shield **15** may be made of plastic. In other embodiments, the shield **15** may be made out of any appropriate translucent or semi-translucent material. In certain embodiments, the shield **15** may be made out of an opaque material, if suitable for the application.

In various embodiments, the shield **15** is an electrical insulator. In these embodiments, the shield **15** may be configured to electrically and/or physically isolate the at least one LED **16** such that a user cannot come into contact with the at least one LED **16** or other electrical components of lighting fixture **10** while the user is using the lighting fixture **10**. Thus, in these embodiments, the shield **15** may be used to meet various safety standards for consumer products, such as the UL Standards and other pertinent safety standards. In various such embodiments, the shield **15** may be made out of plastic or some other suitable electrically insulating material. In some such embodiments, the electrically insulating material used to make the shield **15** may be translucent or semi-translucent.

In various embodiments, the translucent or semi-translucent material may be configured to permit at least a portion of the light emitted by the at least one LED **16** to pass through the shield **15**. For example, in certain embodiments, the translucent or semi-translucent material may be configured to permit at least 10% or 25% of the light emitted by the at least one LED **16** to pass through the shield **15**. In various embodiments, the translucent or semi-translucent material may be configured to permit a significant fraction of the light emitted by the at least one LED **16** to pass through the shield **15**. For example, in certain embodiments, the translucent or semi-translucent material may be configured to permit at least 40%, 50%, or 60% of the light emitted by the at least one LED **16** to pass through the shield **15**. In other various embodiments, the translucent or semi-translucent material may be configured to permit substantially all of the light emitted by the at least one LED **16** to pass through the shield **15**. For example, in certain embodiments, the translucent or semi-translucent material may be configured to permit at least 80% or 90% of the light emitted by the at least one LED **16** to pass through the shield **15**.

In various embodiments, the shield **15** may be secured into or onto socket **14** via one or more set screws. In other embodiments, the shield **15** may be secured into or onto socket **14** via a suitable adhesive. In still other embodiments, the shield **15** may be secured into or onto socket **14** by other suitable mechanisms.

In various embodiments, the shield **15** may be secured into or onto socket **14** such that the shield **15** rests on top of

11

socket 14. In other embodiments, the shield 15 may be secured into or onto socket 14 such that the outer surface of the shield 15 is substantially flush with the top of the socket 14. In yet other embodiments, the shield 15 may be secured into or onto socket 14 such that the outer surface of shield 15 is recessed within socket 14.

In various embodiments, the shield 15 may be mounted into or onto socket 14 such that an inch or more of space exists between the shield 15 and the top of the at least one LED 16 secured in socket 14. In other embodiments, the shield 15 may be mounted into or onto socket 14 such that a quarter of an inch to an inch of space exists between the bottom of the shield 15 and the top of the at least one LED 16 secured in socket 14. In still other embodiments, the shield may be mounted into or onto socket 14 such that an eighth to a quarter of an inch of space separates the bottom of the shield 15 and the top of the at least one LED 16. In yet other embodiments, less than an eighth of an inch separates the bottom of the shield 15 from the top of the at least one LED 16. In certain embodiments, the shield 15 rests on top of the at least one LED 16.

As previously described herein and as illustrated in FIGS. 4-9, various embodiments of lighting fixture 10 may include more than one socket 14. In various such embodiments, a shield 15 may be secured into or onto each socket 14. In some embodiments, a shield 15 may be secured into or onto at least one socket 14. In other embodiments, no shields 15 may be used. In various embodiments, a shield 15 may be configured to correspond to one socket 14. In other embodiments, a shield 15 may be configured to correspond to more than one socket 14. In some such embodiments, the shield 15 is configured such that the shield 15 that corresponds to more than one socket 14 does not prevent one or more decorative light shades 12 and/or covers 13 from being secured to the more than one socket 14.

6. Decorative Light Shade 12

Again returning to FIG. 2, in various embodiments, a lighting fixture 10 may further comprise a decorative light shade 12. In various embodiments, the light shade 12 may be used to hide the socket 14 and cover 13 from view from at least some lines of sight. In various embodiments, the light shade 12 may be configured to provide an aesthetically pleasing appearance to lighting fixture 10.

In various embodiments, the decorative light shade 12 may function to add a decorative appearance to the lighting fixture 10 and may hide the socket 14 and cover 13 from direct view at least along some lines of sight to the socket 14. In some embodiments, the light shade 12 may hide the socket 14 and/or cover 13 from direct view along various lines of sight accounting for less than $\pi/2$ sr of the solid angle about the socket 14 and/or the cover 13. In various embodiments, the light shade 12 may hide the socket 14 and/or cover from direct view along various lines of sight accounting for $\pi/2$ to π sr of the solid angle about the socket 14 and/or the cover 13. In other embodiments, the light shade 12 may hide the socket 14 and/or cover from direct view along various lines of sight accounting for π to 2π sr of the solid angle about the socket 14 and/or the cover 13. In yet other embodiments, the light shade 12 may hide the socket 14 and/or cover from direct view along various lines of sight accounting for 2π to 3π sr of the solid angle about the socket 14 and/or the cover 13. In certain embodiments, the light shade 12 may hide the socket 14 and/or cover 13 from direct view along nearly every line of sight to the socket 14. Thus, in various embodiments, the decorative light shade 12 may be a variety of shapes. Also, in various

12

embodiments, the decorative light shade 12 may be a variety of sizes relative to the lighting fixture 10.

In various embodiments, the decorative light shade 12 may be configured to permit at least some portion of the light incident upon the light shade 12 to pass through light shade 12. In other embodiments, the decorative light shade 12 may be configured to not permit a portion of the light incident upon the light shade 12 to pass through light shade 12, as may be appropriate for various applications. In some such embodiments, the inside surface of the decorative light shade may be made of a reflective material or coated with a reflective material such that at least a portion of the light incident upon the inside surface of the light shade 12 is reflected. In various such embodiments, the light reflected off the inside surface of light shade 12 may be reflected such that the light is directed toward one or both of the first and second opening of the light shade 12, if one or both of such openings are present.

In various embodiments the decorative light shade 12 may be made of glass, plastic, alabaster, fabric, metal, or any other appropriate material or combination of suitable materials. In various embodiments, the decorative light shade 12 may be made out of more than one material. For example, in some embodiments, a light shade 12 may be constructed by covering a metal frame with fabric, as commonly known in the art. In other embodiments, decorative light shades 12 may be made out of a variety of appropriate materials.

In various embodiments, the material of light shade 12 may be configured to not permit light incident upon the light shade to pass through the light shade 12. In various such embodiments, the light emitted by the one or more LEDs 16 may be emitted by the lighting fixture through the solid angle about the cover 13 not blocked by the decorative light shade 12. In certain such embodiments, the material of the light shade may be configured to permit less than 10% of the light incident upon the light shade 12 to pass through the light shade 12. In other embodiments, the material of the light shade 12 may be configured to permit at least a portion of the light incident upon it to pass through the decorative light shade. In certain such embodiments, the material of light shade 12 is configured to permit at least 10% of the incident light to pass through light shade 12. In various embodiments, the material of light shade 12 may be configured to permit a significant fraction of incident light to pass through decorative light shade 12. In certain embodiments, the material of light shade 12 may be configured to allow at least 40%, 50%, or 60% of the incident light to pass through light shade 12. In some embodiments, the material of light shade 12 is configured to permit nearly all of the incident light to pass through the light shade 12. In certain embodiments, the material of light shade 12 is configured to permit at least 80% or 90% of the incident light to pass through light shade 12.

In various embodiments, a decorative light shade 12 may comprise a first opening. In various such embodiments, the light shade 12 may further comprise a second opening. However, in some embodiments, the light shade 12 may not comprise a second opening. In some embodiments, the light shade 12 may further comprise at least one door which may be used cover the first and/or second opening in the light shade 12. In some embodiments, a door may be hingedly or selectively removably connected to light shade 12. For example, in some embodiments, a door may be connected to light shade 12 by Velcro, snaps, zippers, magnets, selectively removable adhesive, or other suitable mechanisms.

In various embodiments the light shade 12 may be slid onto a socket 14 via the first opening in light shade 12. In

13

various embodiments, the socket 14 may be accessed through a second opening in light shade 12. In some embodiments, the socket 14 may be accessed via a door in light shade 12. In various embodiments, the access to socket 14 may be used to operably mount a cover 13 to the socket 14. In some such embodiments, the cover 13 may be used to secure the light shade 12 to the socket 14.

In various embodiments, a decorative light shade 12 may be secured to the fixture mounting 11 by sliding light shade 12 onto the socket 14 and then operably mounting the cover 13 to the socket 14. In other embodiments, light shade 12 may be secured to the fixture mounting 11 at least in part by cover 13 in addition to other appropriate mechanisms. In various embodiments, the decorative light shade 12 may be in part secured to the lighting fixture 10 by a light shade seat 111. In other embodiments, the decorative light shade 12 may be in contact with a light shade seat 111. In still other embodiments, when the light shade 12 is secured to the lighting fixture 10, the light shade 12 may apply some pressure to a light shade seat 111. In certain embodiments, light shade 12 may engage in some manner with light shade seat 111. In other embodiments, the light shade 12 may not be in physical contact with a light shade seat 111.

As described above and illustrated in FIGS. 4-6, various embodiments of the lighting fixture 10 may comprise more than one socket 14. In various such embodiments, a decorative light shade 12 may be secured to each socket 14. In some embodiments, a light shade 12 may be secured to at least one socket 14. In other embodiments, no decorative light shades 12 may be used. In various embodiments, a light shade 12 may be configured to correspond to one socket 14. In other embodiments, a light shade 12 may be configured to correspond to more than one socket 14. In various embodiments, each light shade 12 is secured to one or more sockets 14 by a cover 13. In some embodiments, each light shade 12 is secured to each socket 14 to which it corresponds by a cover 13. Thus, in various embodiments in which a light shade 12 corresponds to a plurality of sockets 14, a cover 13 which also corresponds to a plurality of sockets 14 may be used to secure light shade 12 to the plurality of sockets 14. In other such embodiments, a plurality of covers 13 may be used to secure light shade 12 to each or at least one of the plurality of sockets 14. In other embodiments, decorative light shade 12 may be secured to the more than one socket 14 by some other suitable mechanism. In certain embodiments, lighting fixture 10 does not comprise a decorative light shade 12. Of course it should be understood that any of a variety of alternatives commonly known and understood in the art may be employed without departing from the scope of the invention.

7. Cover 13

Returning to FIG. 2, various embodiments of the lighting fixture 10 may comprise at least one cover 13. In various embodiments, cover 13 may be configured to secure the cover 13 to a socket 14. In some embodiments, cover 13 is configured to operatively mount the cover 13 and the decorative light shade 12 to a socket 14. Also, in various embodiments, cover 13 may be configured to disperse the light emitted by the at least one LED 16.

In various embodiments, the cover 13 may be configured to permit at least a portion of the light emitted by the at least one LED 16 and incident upon the cover 13 to pass through the cover 13. In various such examples, the cover 13 may be configured to permit at least 10% or 25% of the light incident upon it to pass through the cover 13. In some embodiments, the cover 13 may be configured to allow a significant portion of the light incident upon it to pass

14

through the cover 13. In certain embodiments, the cover may be configured to permit 10-30%, 30-50%, or 50-80% of the light incident upon it to pass through the cover 13. In other certain embodiments, the cover 13 may be configured to permit at least 50% or 60% of the light incident upon it to pass through the cover 13. In still other embodiments, the cover may be configured to permit nearly all the light incident upon it to pass through the cover. In certain such embodiments, the cover 13 may be configured to permit 80% or 90% of the light incident upon it through the cover 13.

In various embodiments, the cover 13 may be made of glass. In other embodiments, the cover 13 may be made from a polymerized material, as commonly known and understood in the art. In certain embodiments, the cover 13 may be made out of plastic. In still other embodiments, the cover 13 may be made of any other suitable material. In various embodiments, the cover 13 may be made of any suitable translucent or semi-translucent material. In some embodiments, the cover 13 may be made out of clear or frosted material. In certain embodiments, the cover 13 may be made out of smart glass or some other material that can transition from clear to frosted and/or vice versa. In certain embodiments, the cover may in part or in whole be made of an opaque material, if appropriate for the application.

In various embodiments, the cover 13 may be made out of one material. In other embodiments, the cover 13 may, at least in part, part be made out of more than one material. In various such embodiments, one or more materials may be used for specific parts of the cover 13 to enhance the ability of the cover 13 to secure the cover 13 and/or the decorative light shade 12 to the socket 14. In other embodiments, one or more materials may be used to enhance the ability of the cover 13 to disperse light emitted by the at least one LED 16 and incident upon the cover 13. In still other embodiments, one or more materials may be used to enhance the aesthetic appearance of the cover 13 or to achieve engineering goals such as weight of, cost of manufacturing of, or other engineering goals for the cover 13.

In various embodiments, the translucent or semi-translucent material may be configured to permit at least a portion of the light incident upon the cover 13 to pass through the cover. In some such embodiments, the translucent or semi-translucent material may be configured to permit at least 10% or 20% of the light incident upon the cover 13 to pass through the cover. In other embodiments, the translucent or semi-translucent material may be configured to permit a significant fraction of the light incident upon the cover 13 to pass through the cover. In certain embodiments, the translucent or semi-translucent material may be configured to permit 10-30%, 30-50%, or 50-80% of the light incident upon the cover 13 to pass through the cover. In still other embodiments, the translucent or semi-translucent material may be configured to permit nearly all the light incident upon the cover 13 to pass through the cover. In certain embodiments, the translucent or semi-translucent material may be configured to permit at least 80% or 90% of the light incident upon the cover 13 to pass through the cover.

In various embodiments, the cover 13 may be generally circular or elliptical in cross-section. In other embodiments, the cover 13 may be generally rectangular or alternatively shaped in cross-section. In various embodiments, the shape of the cross-section of the cover 13 may be different at one point along the length of the cover 13 than at another point along the length of the cover 13.

In various embodiments, the inside diameter of at least a portion of the cover 13 is substantially the same as the outer

diameter of the socket **14**. In other embodiments, the inside diameter of at least a portion of the cover **13** may be substantially different from the outer diameter of the socket **14**. In still other embodiments, the outer diameter of at least a portion of the cover **13** may be substantially the same as the inner diameter of the socket **14**. In yet still other embodiments, the outer diameter of at least a portion of the cover **13** may be substantially different from the inner diameter of the socket **14**. Of course, in some of these and still other embodiments, the diameter of the cover **13** may be different at various points along the length of the cover **13**. As may be desirable, in still other embodiments, the diameter of the cover **13** may be substantially the same at all points along the length of the cover **13**.

In various embodiments, the length of the cover **13** may be chosen as appropriate for the application. In various embodiments, the cover **13** may be less than half an inch in length. In some embodiments, the cover **13** may be half an inch to an inch in length. In other embodiments, the cover **13** maybe one to three inches in length. In still other embodiments, the cover **13** may be three to six inches in length. In yet other embodiments, the cover **13** may be longer than six inches.

As illustrated in FIGS. **3A**, **6-7**, **10**, and **12**, in various embodiments, the cover **13** may include a neck portion **132** and/or an enclosing portion **133**. In various embodiments, the neck portion **132** and the enclosing portion **133** may be made out of the same material. In other embodiments, the neck portion **132** and the enclosing portion **133** may be made of different materials.

In various embodiments, the cover **13** may comprise a neck portion **132** configured to engage the socket **14** and/or other elements of lighting fixture **10**. Thus, in some embodiments, the neck portion **132** may comprise threads disposed on the inside or outside surface of neck portion **132**. In other embodiments, the neck portion **132** may comprise one or more tabs disposed on the inside or outside surface of the neck portion **132**. In still other embodiments, the neck portion **132** may be configured such that the neck portion may expand and contract or stretch and be tightened. In yet other embodiments, neck portion **132** may comprise some other mechanism that may be configured to engage socket **14** and/or other elements of lighting fixture **10**.

As shown in FIG. **12**, in various embodiments, the neck portion **132** may further comprise an approximately flat lip **134** configured to engage the decorative light shade **12**. In some embodiments, the lip **134** may be used to operatively secure and/or retain and/or immobilize the light shade **12** onto and/or relative to the socket and/or the light shade seat **111**. In various embodiments, the lip **134** is about one-sixteenth to one-eighth of an inch wide. In other embodiments, the lip **134** is approximately one-eighth to one-quarter of an inch wide. In still other embodiments, the lip **134** is about one-quarter to half of an inch wide. In still other embodiments, the lip **134** may be half an inch to one inch wide.

In various embodiments, cover **13** may further comprise an enclosing portion **133**. The enclosing portion **133** may be globe-shaped, bulb-shaped, dome-shaped, or flame-shaped, in various embodiments. In other embodiments, the enclosing portion **133** may be cylindrically or alternatively shaped. In various embodiments, the enclosing portion **133** may fully enclose one end of the neck portion **132**. In other embodiments, the enclosing portion **133** may comprise one or more holes disposed within the surface of the enclosing portion **133**.

In some embodiments, the outer surface of the enclosing portion **133** may be smooth. In other embodiments, the outer surface of the enclosing portion **133** may have some texture. In various such embodiments, the interior surface of the enclosing portion **133** may be smooth, have a texture which corresponds with the exterior texture, or have a texture which does not correspond with an exterior texture. In various embodiments, the outer surface of enclosing portion **133** may be smooth while the interior surface of enclosing portion **133** is textured or vice versa. In other embodiments, the outer and interior surfaces of the enclosing portion **133** may both be smooth or both be textured. In the at least one embodiment illustrated in FIGS. **3A-B**, **6-7**, **10**, and **12**, the enclosing portion **133** includes one or more nodules **131**, as viewed from the outer surface. In various embodiments, the nodules **131** may protrude outward relative to the outer surface of the enclosing portion **133**. In some such embodiments, the one or more nodules **131** may appear as dimples when viewed from the inner surface of the enclosing portion **133**.

As shown in FIG. **3B**, in various embodiments, the enclosing portion **133** may include six nodules **131** arranged such that they are placed at equidistance from each other around the outer edge of the front surface of the enclosing portion **133**. In other embodiments, a different number of nodules **131** may be used, such as the non-limiting examples of four or eight nodules **131**. In various embodiments, the nodules **131** may have a generally circular or elliptical cross-section. In other embodiments, nodules **131** may have a generally rectangular or alternatively shaped cross-section. In various embodiments, the nodules **131** may not be evenly distributed around the outer edge of the enclosing portion **133** or about a perimeter of the enclosing portion.

Still further, in some embodiments, one or more nodules **131** may be disposed in the central region of the surface of the enclosing portion **133**. Various embodiments wherein the cover **13** comprises one or more nodules **131** may also comprise additional texture on the surface of the cover **13**. In other embodiments wherein the cover **13** comprises one or more nodules **131** the surface of the cover **13** may be smooth other than the presence of the nodules **131**. In various embodiments, the surface of the cover **13** and the surface of the nodules **131** may be both be smooth or both be textured. In other embodiments, the surface of the cover **13** may be textured and the surface of the nodules **131** may be smooth or vice versa. In some embodiments, the nodules **131** may be made of the same material as the enclosing portion **133**. In other embodiments, the nodules **131** may be made of a different material than the enclosing portion **133**.

In various embodiments wherein cover **13** comprises one or more nodules **131**, the one or more nodules **131** may be of various sizes. In various embodiments, nodules **131** have a diameter of approximately 1 mm. In other embodiments, the diameter of the one or more nodules **131** may be 1-5 mm or 5-10 mm. In still other embodiments, the diameter of the one or more nodules **131** may be 10-25 mm. In yet other embodiments, the diameter of the one or more nodules **131** may be 1 cm or less. In various embodiments, the nodules **131** may have a height of less than 2 mm. In other embodiments, the nodules **131** may have a height of 2-5 mm. In still other embodiments, the nodules **131** may have a height of 5-10 mm. In yet other embodiments, the nodules **131** may have a height of 1 cm or less. In some embodiments, the one or more nodules **131** of a given embodiment may be different sizes. In other embodiments, the one or more nodules **131** of a given embodiment may be substantially the same size.

According to various embodiments, the nodules **131** may be configured as dimples, recesses, protrusions, or the like, as may be generally desirable for a particular application, without being limited to the specific nodular configuration described previously herein. In this regard, the nodules **131** may be alternatively configured in this fashion, however as may be desirable for particular applications.

In various embodiments the at least one cover **13** may be secured to the at least one socket **14**. In some embodiments, the neck portion **132** of cover **13** may be used to engage a socket **14**. In other embodiments, other mechanisms may be used to operatively mount cover **13** onto socket **14**. In some such embodiments, the cover **13** may secure at least one decorative light shade **12** to the at least one socket **14**. In various embodiments, the cover **13** may disperse light emitted by the at least one LED **16**. In various such embodiments, it may appear that the light source of the lighting fixture **10** is located within the cover **13**. In some such embodiments, the cover **13** may be used to make it appear that the decorative light shade **12** is being illuminated by a light source more centrally located within the decorative light shade **12** than the actual location of the at least one LED **16**.

In various embodiments, the portion of the locking mechanism disposed on the cover **13** may be disposed on the neck portion **132**. In various embodiments, the neck portion **132** may be threaded on the inside or outside surface. The threads disposed on the neck portion **132** may be configured to engage threads that may be present on the outer or inner surface of socket **14**. Thus, in these embodiments, the cover **13** may be screwed onto the socket **14**.

In some such embodiments, the neck portion **132** may be configured to expand and contract such that the neck portion may be expanded to fit over socket **14** and then contracted or tightened about socket **14**, thus securing the cover **13** to socket **14**. In other embodiments, the neck portion **132** may comprise a tab that may rotationally engage a groove located on a surface of the socket **14** and thus securing the cover **13** to socket **14**. In other embodiments, other suitable mechanisms may be used to lock the cover **13** onto the socket **14**. In various embodiments, at least some portion of the neck portion **132** may be configured to engage the decorative light shade **12**. In some such embodiments, the cover **13** may be used to operatively mount the light shade **12** onto socket **14**. In various such embodiments, the lip **134** may engage the light shade **12** in order to operatively secure and/or retain and/or immobilize the light shade **12** onto and/or relative to the socket **14** and/or the light shade seat **111**. In some embodiments, the cover **13** may be configured to engage light shade seat **111**.

In various embodiments, the enclosing portion **133** is configured to disperse light emitted by the at least one LED **16**. In various such embodiments, the enclosing portion **133** may be configured to give the appearance that the light source of the lighting fixture **10** is located within the cover **13**. In some such embodiments, the enclosing portion **133** may be configured to give the appearance that the decorative light shade **12** is being illuminated by a light source more centrally located within the decorative light shade **12** than the actual location of the at least one LED **16**.

In various embodiments, the cover **13** is configured to disperse the light emitted by the at least one LED **16**. In some embodiments, the at least one LED **16** may be secured within socket **14** such that the top of the at least one LED **16** is recessed within socket **14**. In various such embodiments, the cover **13** may be configured to make it appear that the light source of lighting fixture **10** is recessed within deco-

orative light shade **12** but not recessed within socket **14**. Some users may find that this increases the aesthetic quality of lighting fixture **10**. In some such embodiments, the cover **13** may be configured to give an appearance that may be similar to that of a lighting fixture comprising an incandescent light bulb.

In various embodiments, at least a portion of the outer and or inner surface of the cover **13** may be textured and/or be comprised of one or more nodules **131**. In various such embodiments, the aforementioned texture and/or nodules may affect the light dispersion qualities of the cover **13**. In some embodiments, the texture and/or nodules may increase the dispersion of light emitted by the at least one LED **16** and incident upon the cover **13**. In other embodiments, any texture and/or nodules on the cover may merely be present for aesthetic purposes. In still other embodiments, the surfaces of the cover **13** may not be textured and/or dimpled, but may still be configured to disperse light emitted by the at least one LED **16**.

In various embodiments, the various other components of the lighting fixture **10** may be combined with the cover **13**. In some embodiments, one component may act as the cover **13** and the shield **15**. In other embodiments, one component may act as the cover **13** and the decorative light shade **12**. Thus, in various embodiments, other components of the lighting fixture **10** may be structurally incorporated into the cover **13**. In other embodiments, the cover **13** may be structurally distinct from the other components of lighting fixture **10**.

As noted above, in various embodiments, the cover **13** may be secured to the socket **14**. In some embodiments, the cover **13** may be used to secure decorative light shade **12** to socket **14**. In other various embodiments, the cover **13** may be secured directly to the fixture mounting **11**. In other embodiments, the cover **13** may be secured to the light shade seat **111**. In some embodiments, the cover **13** may be used to secure the decorative light shade **12** directly to the fixture mounting **11**. In still other embodiments, the cover **13** may be used to secure the light shade **12** to the light shade seat **111**.

In various embodiments, the cover **13** may not be comprised of a neck portion **132** and an enclosing portion **133**. In such embodiments, the cover may still be configured to operatively mount the cover **13** and/or the decorative light shade **12** to the socket **14** or other component of lighting fixture **10**. In various embodiments, the cover **13** may still be configured to give the appearance that the light source of the lighting fixture **10** is located within the cover **13**. In some such embodiments, the cover **13** may be configured to give the appearance that the decorative light shade **12** is being illuminated by a light source more centrally located within the decorative light shade **12** than the actual location of the at least one LED **16**. In some embodiments, the outer and/or inner surface of the cover **13** may be smooth, at least in part. In other embodiments, the outer and/or inner surface of the cover **13** may be textured and/or include one or more nodules **131**, at least on some portion thereof.

As previously discussed herein and illustrated in FIGS. **4-6**, various embodiments of the lighting fixture **10** may comprise more than one socket **14**. In various such embodiments, a cover **13** may be secured to each socket **14**. In various embodiments, a cover **13** may be configured to correspond to one socket **14**. In other embodiments, a cover **13** may be configured to correspond to more than one socket **14**. In various embodiments, each cover **13** is secured to one or more sockets **14**, either via threads disposed on the inner

19

surface of the cover **13** that are configured to mate with threads on the outer surface of the socket **14** or by some other suitable mechanism.

In various embodiments, a cover **13** may be used to secure a decorative light shade **12** to each socket **14**. In some 5
embodiments, a cover **13** is configured to secure an independent light shade **12** to each socket **14**. In other embodiments, a cover **13** may be configured to secure a single light shade **12** to more than one socket **14**. In still other embodiments, more than one cover **13** may be used to secure a 10
single light shade **12** to more than one socket **14**.

Exemplary Methods of Installing Various Embodiments

Methods of installing various embodiments light fixture **10** will now be discussed. First, an exemplary method of installing various embodiments of a “floor-style” lighting fixture, such as that illustrated in FIGS. **1** and **2** shall be discussed. Second, an exemplary method of installing various 20
embodiments of a “wall-style” light fixture, such as that illustrated in FIGS. **5** and **6** will be detailed. Of course it should be understood that numerous variations to the described methods may be implemented, without departing from the scope and nature of the present invention.

In various embodiments, a floor style lighting fixture, such as that illustrated in FIG. **2**, may be provided. The fixture mounting **11** may be placed on an approximately horizontal surface, such as a floor, a patio, a deck, the ground, a table, or a similar surface. In various such embodiments, the at least one LED **16** may be mounted on a board **161**. Any necessary or desired driver circuitry may also be mounted on the board **161**. Once the fixture mounting **11** is placed on an appropriate surface, the at least one LED **16** may be operatively mounted within the socket **14** of fixture 30
mounting **11**. The board **161** may rest on a seat within the socket **14** and/or may be secured with set screws, an appropriate adhesive, or other suitable mechanism, in various embodiments, as has been described previously herein. The shield **15** may be placed in or on the socket **14** on top of the at least one LED **16**. The shield may also, in certain 40
embodiments, be secured with set screws, an appropriate adhesive, or other suitable mechanism.

In various embodiments, the at least one LED **16** and shield **15** may be mounted in socket **14** in a factory setting. 45
In such embodiments, the user may not need to complete the steps of operatively mounting the at least one LED **16** in the socket **14** and securing the shield **15** into or onto the socket. In other embodiments, the at least one LED **16** may be pre-mounted in socket **14** but the user may complete the step 50
of mounting the shield **15** into or onto the socket.

In various embodiments, decorative light shade **12** may then be slid onto socket **14**. Then, in various embodiments, cover **13** may be mounted onto the socket, locking the light shade **12** onto the socket. In some embodiments, cover **13** 55
may be screwed onto socket **14** such that threads disposed on a surface of the socket mate with threads on a surface of the cover. In some such embodiments, the threads of cover **13** may be located on an inside surface of the neck portion **132** of cover.

In other embodiments, a wall style lighting fixture, such as that illustrated in FIG. **6** is provided. In such embodiments, the fixture mounting **11** must be mounted to an appropriate surface, such as an interior or exterior wall. Other embodiments may be configured to be mounted on a 60
ceiling. In some embodiments, at least one LED **16** may already be operatively mounted in each socket **14**. In other

20

embodiments, the user may operatively mount at least one LED **16** in each socket **14** with set screws, an appropriate adhesive, or other mechanism, as may be commonly known and used in the art. In various embodiments, a shield **15** may 5
already be secured in or on each socket **14**. In other embodiments, the user may secure a shield **15** in or on each socket **14** on top of the at least one LED **16** via set screws, an appropriate adhesive, or other mechanisms.

In various embodiments, a decorative light shade **12** may be slid onto the first socket **14**. A cover **13** may then be mounted onto the first socket **14**, in various embodiments. In some such embodiments, mounting the cover **13** onto the socket **14** will likewise operatively secure and/or retain and/or immobilize the light shade **12** onto and/or relative to 10
the socket **14**. In other embodiments, the decorative light shade **12** may be slid onto the first socket **14** and engaged in some manner with the light shade seat **111**. In various such embodiments, the cover **13** may be mounted onto the socket **14** to additionally operatively secure and/or retain and/or immobilize the light shade **12** onto and/or relative to the 20
socket. In still other embodiments, mounting the cover **13** and engaging other mechanisms may operatively secure and/or retain and/or immobilize the light shade **12** onto and/or relative to the socket.

According to various embodiments, for example those involving a wall-style or vanity mounted fixture, a second decorative light shade **12** may be slid onto a second socket **14**, upon installation of a first decorative light shade **12** onto a first socket **14**. A second cover **13** may then be likewise 30
mounted on the second socket **14**, in various embodiments. In this manner, the second decorative light shade **12** may be secured to the second socket **14** via the second cover **13**. It should be understood from this disclosure that, according to various embodiments, the steps of sliding a light shade **12** onto a socket **14** and mounting a cover **13** onto the socket **14** may be repeated until all the sockets **14** of a particular fixture have decorative light shades **12** secured thereon, as may be desirable for particular applications. 35

CONCLUSION

Many modifications and other embodiments of the invention set forth herein will come to mind to one skilled in the art to which these inventions pertain having the benefit of the teachings presented in the foregoing descriptions and the associated drawings. Therefore, it is to be understood that the invention are not to be limited to the specific embodiments disclosed and that modifications and other embodiments are intended to be included within the scope of the 45
appended claims. Although specific terms are employed herein, they are used in a generic and descriptive sense only and not for purposes of limitation.

The invention claimed is:

1. A method of installing a lighting fixture comprising the steps of:
 - providing an LED lighting fixture comprising: (1) at least one socket and (2) at least one LED positioned adjacent the socket; and
 - operatively mounting a cover onto said at least one socket wherein mounting said cover secures a light shade to said at least one socket, 55
wherein:
 - said cover comprises at least an enclosing portion, and
 - the enclosing portion comprises a set of nodules surrounding a central portion of said enclosing portion.

21

2. The method of claim 1, wherein:
a first opening of the socket further defines a light shade seat corresponding to the at least one socket; and
one or more of:
the enclosing portion is configured to enclose the first opening;
said cover further comprises a lip and a neck portion; the lip is configured to engage the light shade; and the neck portion is configured to engage the socket such that the engagement of the light shade by the lip and the engagement of the socket by the neck portion secures the light shade against the light shade seat.

3. The method of claim 2 further comprising the step of mounting at least one shield within said first opening such that at least one LED is enclosed within said first opening by said shield.

4. The method of claim 2 wherein the LED lighting fixture further comprises:
at least one shield substantially secured within said first opening such that said at least one LED is substantially enclosed within an interior socket chamber of said socket by said at least one shield; and
at least one cover comprising a cover opening, said cover opening defining an interior cover chamber of said at least one cover, said at least one cover being operatively mounted to said at least one socket such that said at least one LED is positioned within at least a portion of said interior cover chamber opening.

5. The method of claim 1 wherein the LED lighting fixture is a vanity lighting fixture and comprises:
two or more sockets each comprising a first opening;
two or more LEDs wherein at least one LED is recessed at least in part within said first opening of each of said two or more sockets;
two or more shields wherein each shield is positioned within an interior socket chamber of one of said two or more sockets such that said at least one LED is enclosed within said first chamber by said shield;
two or more covers each comprising a second opening defining an interior cover chamber of each of said two or more covers, said two or more covers each secured to one of said two or more sockets such that said at least one LED positioned within said one of two or more sockets is positioned within said second opening of one of said covers; and
two or more decorative light shades wherein each decorative light shade is secured to one of said two or more sockets via one of said two or more covers.

6. The method of claim 1 wherein the at least one socket comprises a peripheral wall, said peripheral wall having an external surface and an internal surface, said internal surface defining a socket opening.

7. The method of claim 6 wherein the LED lighting fixture further comprises:
at least one shield member positioned adjacent said at least one socket such that a perimeter of said at least one shield member is positioned adjacent said peripheral wall so as to substantially enclose said socket opening, said shield member being made of an electrically insulating material;
at least one decorative light shade;
a neck portion of the cover having an external surface and an internal surface, at least a portion of said internal surface defining a cover opening,
wherein:
said cover opening is configured to receive there-through at least a portion of said at least one socket,

22

such that said internal surface of said neck portion substantially engages said external surface of said peripheral wall;
at least a portion of said neck portion is configured to substantially engage said decorative light shade; and
at least a portion of said cover is configured to substantially enclose said at least one LED and said at least one shield member.

8. A light emitting diode (LED) lighting fixture comprising:
a socket; and
a cover comprising an enclosing portion and being mounted onto said socket,
wherein:
the enclosing portion has a single set of nodules surrounding a central portion of said enclosing portion; and
each nodule within the set of nodules is positioned equidistance from the central portion of said enclosing portion.

9. The LED lighting fixture of claim 8, further comprising:
an LED positioned within a first opening of the socket; at least one shield substantially secured within an interior socket chamber defined by the first opening, such that said at least one LED is substantially enclosed within said interior socket chamber by said at least one shield; and
a cover opening of the cover, said cover opening defining an interior cover chamber of said at least one cover, said at least one cover being operatively mounted to said at least one socket such that at least one of said at least one LED and at least one of said at least one shield are positioned within at least a portion of said interior cover chamber opening.

10. The LED lighting fixture of claim 8, wherein the LED lighting fixture is a vanity lighting fixture and comprises:
two or more sockets each comprising a first opening defining an interior chamber of each of said two or more sockets;
two or more LEDs wherein at least one LED is recessed at least in part within said interior chamber of each of said two or more sockets;
two or more shields wherein each shield is positioned within said interior chamber of one of said two or more sockets such that said at least one LED is enclosed within said first chamber by said shield; and
two or more covers each comprising a second opening defining an interior chamber of each of said two or more covers, said two or more covers each secured to one of said two or more sockets such that said at least one LED positioned within said one of two or more sockets is positioned within said second opening of one of said covers.

11. The LED lighting fixture of claim 8, wherein at least one shield is mounted within a first opening of the socket such that at least one LED is enclosed within said first opening by said shield.

12. The LED lighting fixture of claim 8, wherein:
the fixture further comprises a light shade positioned adjacent the socket;
a first opening of the socket defines a light shade seat corresponding to the at least one socket;
said cover further comprises a lip and a neck portion;
the lip is configured to engage the light shade; and
the neck portion is configured to engage the socket such that the engagement of the light shade by the lip and the

23

engagement of the socket by the neck portion secures the light shade against the light shade seat.

13. A light emitting diode (LED) lighting fixture comprising:

at least one socket comprising a first opening; and
at least one LED recessed at least in part within said first opening.

14. The LED lighting fixture of claim **13**, wherein: the fixture further comprises a cover operatively mounted to said at least one socket, the cover comprises an enclosing portion, and the enclosing portion is configured to enclose the first opening.

15. The LED lighting fixture of claim **14**, wherein the enclosing portion comprises a set of nodules surrounding a central portion of said enclosing portion and configured to affect the light dispersion qualities of the cover.

16. The LED lighting fixture of claim **15**, wherein the enclosing portion further comprises a texture disposed on at least a central region of the enclosing portion.

17. The LED lighting fixture of claim **15**, wherein the one or more nodules are evenly spaced around the central portion of said enclosing portion.

24

18. The LED lighting fixture of claim **13**, wherein: the fixture further comprises a cover operatively mounted to said at least one socket, the cover comprises a lip, a neck portion and an enclosing portion, and the lip, the neck portion, and the enclosing portion are integrally formed.

19. The LED lighting fixture of claim **13**, further comprising at least one shield mounted within said first opening such that at least one LED is enclosed within said first opening by said shield.

20. The LED lighting fixture of claim **13**, further comprising: at least one shield substantially secured within said first opening such that said at least one LED is substantially enclosed within said first opening by said at least one shield; and

a cover having an opening, said cover opening defining an interior cover chamber of said cover, said cover being operatively mounted to said at least one socket such that at least one of said at least one LED and at least one of said at least one shield are positioned within at least a portion of said interior cover chamber opening.

* * * * *

UNITED STATES PATENT AND TRADEMARK OFFICE
CERTIFICATE OF CORRECTION

PATENT NO. : 11,549,666 B2
APPLICATION NO. : 17/393841
DATED : January 10, 2023
INVENTOR(S) : Alan Feit

Page 1 of 1

It is certified that error appears in the above-identified patent and that said Letters Patent is hereby corrected as shown below:

On the Title Page

Under Related U.S. Application Data, Line 1, delete "(60)" and insert -- (63) --, therefor.

Signed and Sealed this
Twenty-second Day of August, 2023



Katherine Kelly Vidal
Director of the United States Patent and Trademark Office