



US011014478B2

(12) **United States Patent**
Benthaus et al.

(10) **Patent No.:** **US 11,014,478 B2**
(45) **Date of Patent:** ***May 25, 2021**

(54) **SEAT SUPPORT LAYER ASSEMBLY**

(71) Applicant: **Lear Corporation**, Southfield, MI (US)

(72) Inventors: **Dirk Benthaus**, Boeblingen (DE);
Zvonko Van Der Meer, Sindelfingen (DE)

(73) Assignee: **Lear Corporation**, Southfield, MI (US)

(*) Notice: Subject to any disclaimer, the term of this patent is extended or adjusted under 35 U.S.C. 154(b) by 0 days.

This patent is subject to a terminal disclaimer.

(21) Appl. No.: **16/376,766**

(22) Filed: **Apr. 5, 2019**

(65) **Prior Publication Data**

US 2019/0232838 A1 Aug. 1, 2019

Related U.S. Application Data

(63) Continuation of application No. 15/404,604, filed on Jan. 12, 2017, now Pat. No. 10,293,725.

(30) **Foreign Application Priority Data**

May 27, 2016 (DE) 10 2016 209 218.9
Jul. 7, 2016 (DE) 10 2016 212 387.4

(51) **Int. Cl.**

B60N 2/66 (2006.01)

B60N 2/56 (2006.01)

(Continued)

(52) **U.S. Cl.**

CPC **B60N 2/665** (2015.04); **A47C 7/467** (2013.01); **B60N 2/5642** (2013.01);

(Continued)

(58) **Field of Classification Search**

CPC B60N 2/665

(Continued)

(56) **References Cited**

U.S. PATENT DOCUMENTS

2,976,916 A * 3/1961 Schladermundt A47C 7/185
297/452.21

3,642,323 A * 2/1972 Taylor A47C 5/125
297/452.17

(Continued)

FOREIGN PATENT DOCUMENTS

CN 101124105 A 2/2008
CN 102602316 A 7/2012

(Continued)

OTHER PUBLICATIONS

Office Action of German Application No. DE 102016212387; dated May 15, 2017; 9 pages.‡

(Continued)

Primary Examiner — Robert Canfield

(74) *Attorney, Agent, or Firm* — Brooks Kushman P.C.

(57) **ABSTRACT**

A seat back assembly and method of manufacture is provided. The seat back includes a foam cushion layer. A support sub-assembly is formed including a rigid support layer with a plurality of cavities and channels defined on a rear surface for receiving components and a generally smooth front surface. At least one component is retained in one of the cavities and a second component is secured on the front surface of the support layer. A trim material covers the cushion layer and secures the sub-assembly to the seat back.

18 Claims, 4 Drawing Sheets

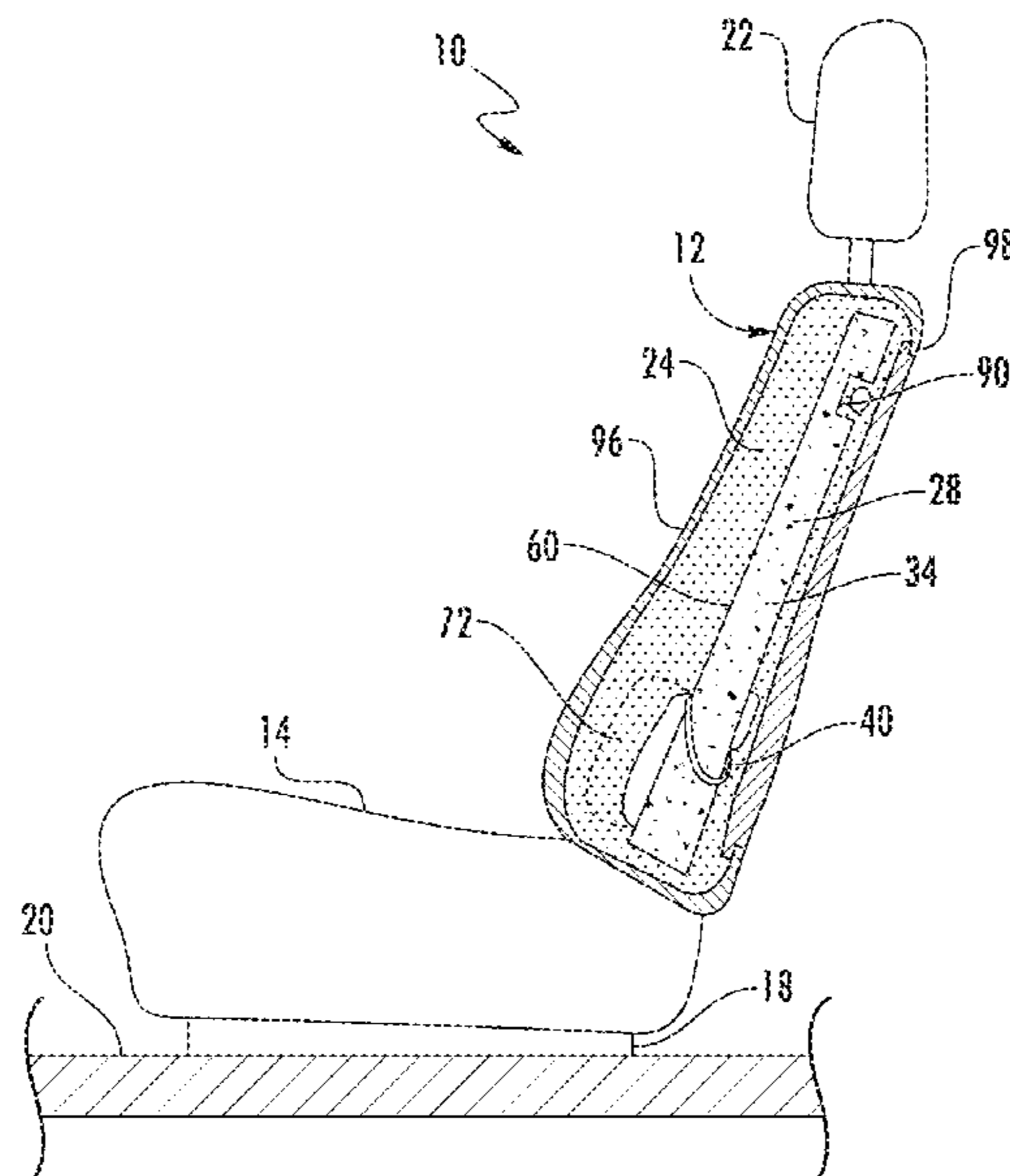

- (51) **Int. Cl.**
B60N 2/68 (2006.01)
B60N 2/90 (2018.01)
B60N 2/02 (2006.01)
A47C 7/46 (2006.01)
B60N 2/868 (2018.01)

- (52) **U.S. Cl.**
 CPC *B60N 2/5657* (2013.01); *B60N 2/5678*
 (2013.01); *B60N 2/868* (2018.02); *B60N*
2002/0264 (2013.01); *Y10S 297/01* (2013.01);
Y10S 297/03 (2013.01)

- (58) **Field of Classification Search**
 USPC 297/284.6, 452.27, 452.41, 452.37,
 297/452.38, 452.31, DIG. 1, DIG. 2,
 297/DIG. 3
 See application file for complete search history.

(56) **References Cited**
 U.S. PATENT DOCUMENTS

3,758,159 A * 9/1973 Morris B60N 2/38
 297/452.14
 4,555,140 A * 11/1985 Nemoto B60N 2/66
 297/452.54
 4,615,563 A ‡ 10/1986 Kobayashi A47C 7/467
 297/284.6
 4,690,456 A * 9/1987 Chiba A47C 7/467
 297/284.6
 5,105,491 A * 4/1992 Yoshiyuki B60N 2/70
 297/DIG. 1
 5,529,377 A ‡ 6/1996 Miller A47C 4/54
 297/28
 5,772,281 A * 6/1998 Massara B60N 2/643
 297/284.4
 5,797,155 A ‡ 8/1998 Maier A61G 5/1043
 297/284.6
 5,975,629 A ‡ 11/1999 Lorbiecki B62J 1/12
 297/20
 6,003,950 A ‡ 12/1999 Larsson A47C 7/74
 297/180.13
 6,062,641 A * 5/2000 Suzuki A47C 7/74
 297/180.1
 6,129,419 A * 10/2000 Neale B60N 2/58
 297/284.4
 6,629,725 B1 ‡ 10/2003 Kunkel B60N 2/5635
 297/180.12
 7,837,271 B2 * 11/2010 Galbreath B60N 2/72
 297/452.48
 8,162,398 B2 ‡ 4/2012 Colja A61H 9/0078
 297/28
 8,215,714 B2 * 7/2012 Galbreath B60N 2/70
 297/452.27
 8,282,164 B2 ‡ 10/2012 Galbreath A47C 7/748
 297/18
 8,696,067 B2 ‡ 4/2014 Galbreath B60N 2/012
 297/452.1
 8,857,908 B2 ‡ 10/2014 Brncick B60N 2/0232
 297/284.1

9,878,755 B2 * 1/2018 Rouland B62J 1/26
 2003/0075960 A1 ‡ 4/2003 Wilkerson A47C 7/467
 297/28
 2003/0160479 A1 ‡ 8/2003 Minuth B60N 2/5628
 297/180.14
 2003/0230913 A1 ‡ 12/2003 Buss B60N 2/5635
 297/180.14
 2005/0200166 A1 ‡ 9/2005 Noh B60N 2/5642
 297/180.14
 2006/0273650 A1 * 12/2006 Embach B60N 2/70
 297/452.27
 2007/0158994 A1 ‡ 7/2007 Brennan A47C 7/74
 297/452.43
 2007/0176471 A1 ‡ 8/2007 Knoll B60N 2/5635
 297/180.14
 2009/0066122 A1 ‡ 3/2009 Minuth B60N 2/5635
 297/180.14
 2009/0189424 A1 ‡ 7/2009 Chi A47C 3/0255
 297/217.4
 2010/0207443 A1 ‡ 8/2010 Brncick B60N 2/686
 297/452.48
 2011/0018329 A1 * 1/2011 Galbreath B60N 2/012
 297/452.18
 2014/0265491 A1 ‡ 9/2014 Galbreath B60N 2/914
 297/28
 2015/0175042 A1 * 6/2015 Galbreath B60N 2/64
 297/452.48
 2015/0274049 A1 ‡ 10/2015 Langensiepen B60N 2/5628
 297/180.12
 2017/0248146 A1 * 8/2017 Wheeler F04D 25/06
 2017/0283070 A1 * 10/2017 Hall B60N 2/686

FOREIGN PATENT DOCUMENTS

CN 203957939 U ‡ 11/2014
 CN 203957939 U ‡ 11/2014
 CN 105383343 A 3/2016
 CN 105584391 A 5/2016
 DE 3334864 A1 * 4/1985 A47C 7/02
 DE 3334864 A1 ‡ 4/1985
 DE 102015205647 A1 10/2015
 JP 07000251 A * 1/1995 A47C 7/18
 JP 2011207443 A ‡ 10/2011
 KR 101241018 B1 ‡ 3/2013
 KR 101241018 B1 3/2013
 WO 09842234 A1 10/1998
 WO WO-09842243 A1 ‡ 10/1998
 WO 2014105316 A1 7/2014
 WO WO-2014105316 A1 ‡ 7/2014 B62J 1/26
 WO 2016141501 A1 9/2016
 WO WO-2016141501 A1 ‡ 9/2016

OTHER PUBLICATIONS

Office Action of Chinese Application No. 2017100567025, dated
 Jan. 18, 2019, 10 pgs.

* cited by examiner
 ‡ imported from a related application

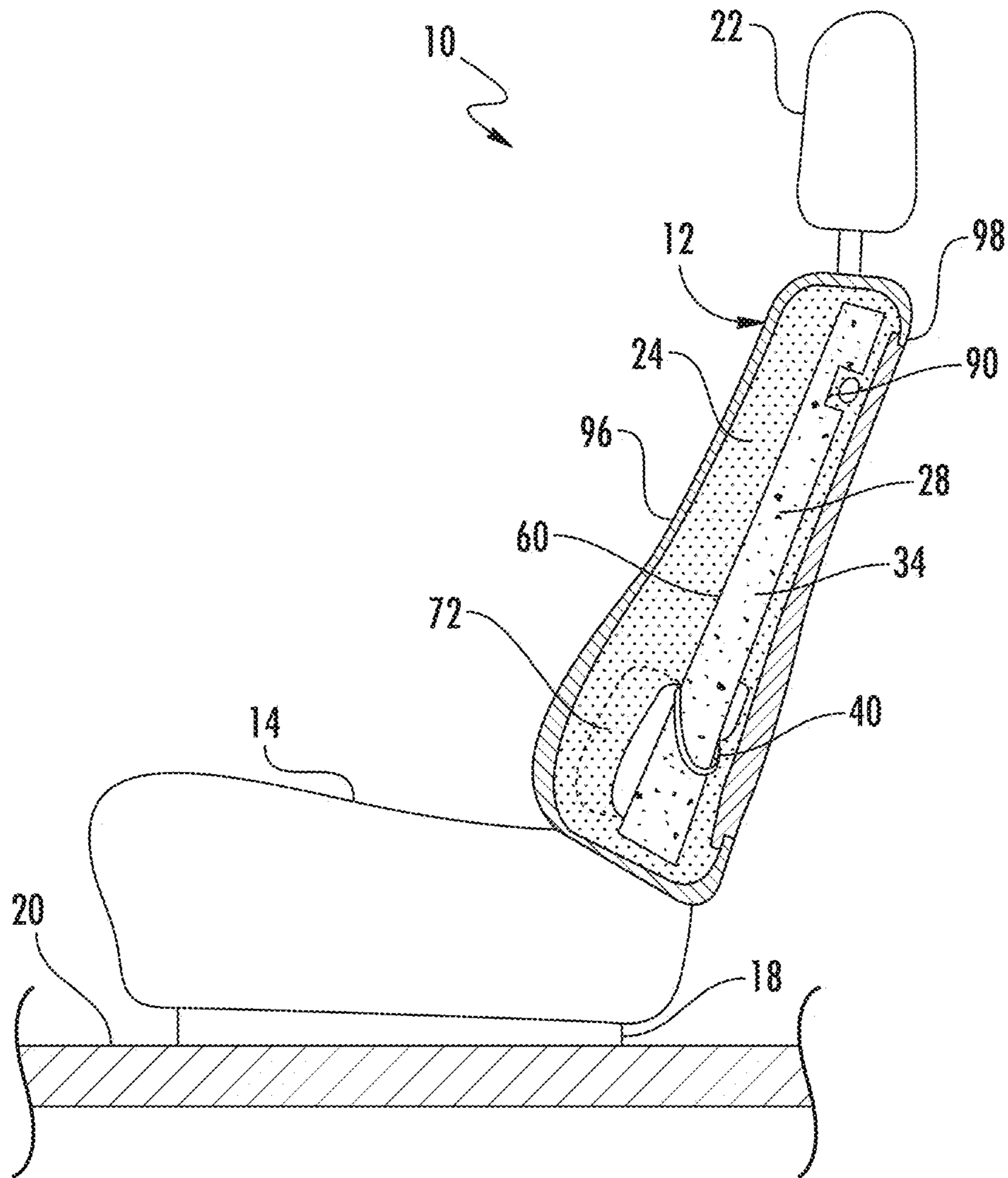

FIG. 1

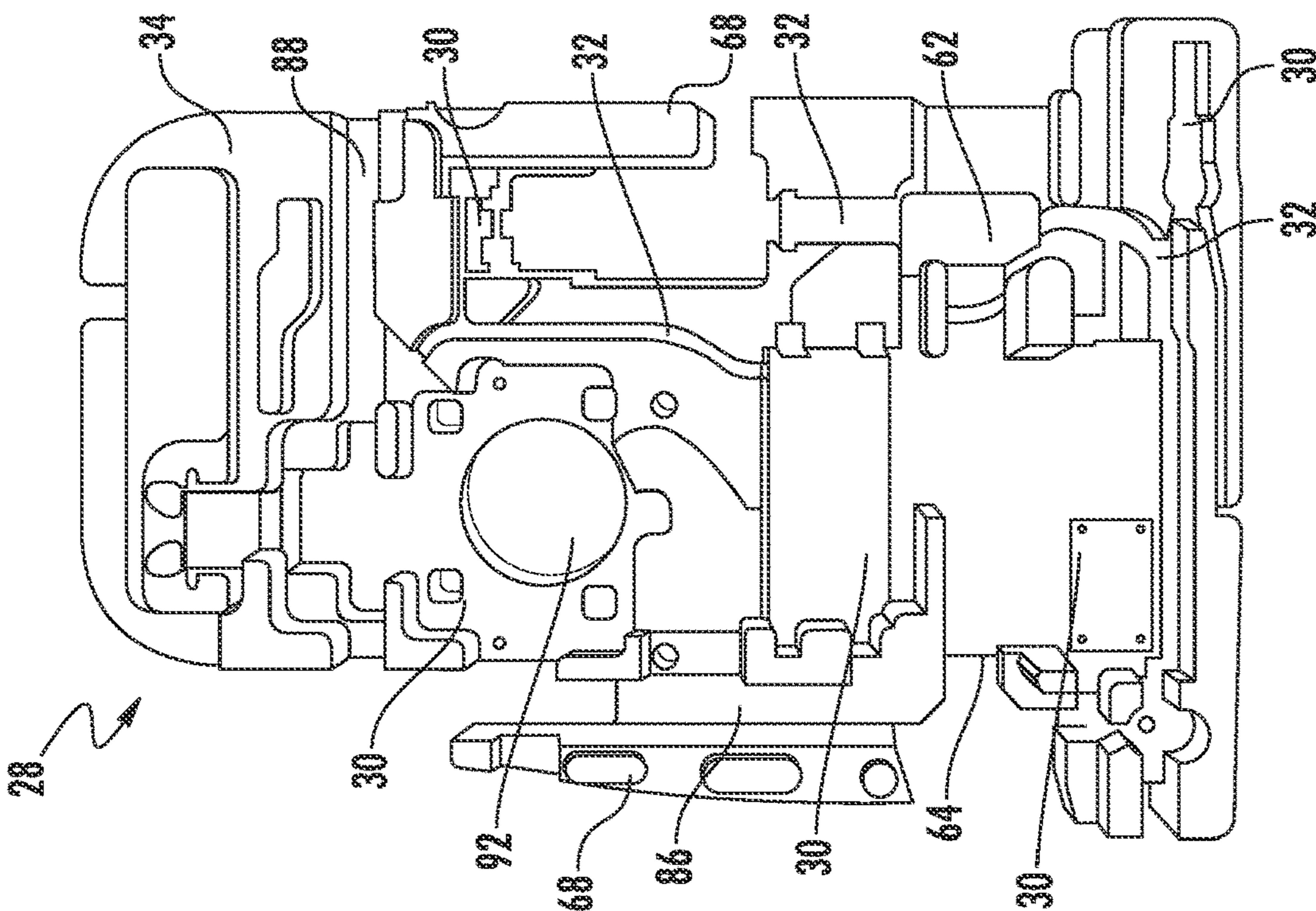

FIG. 2

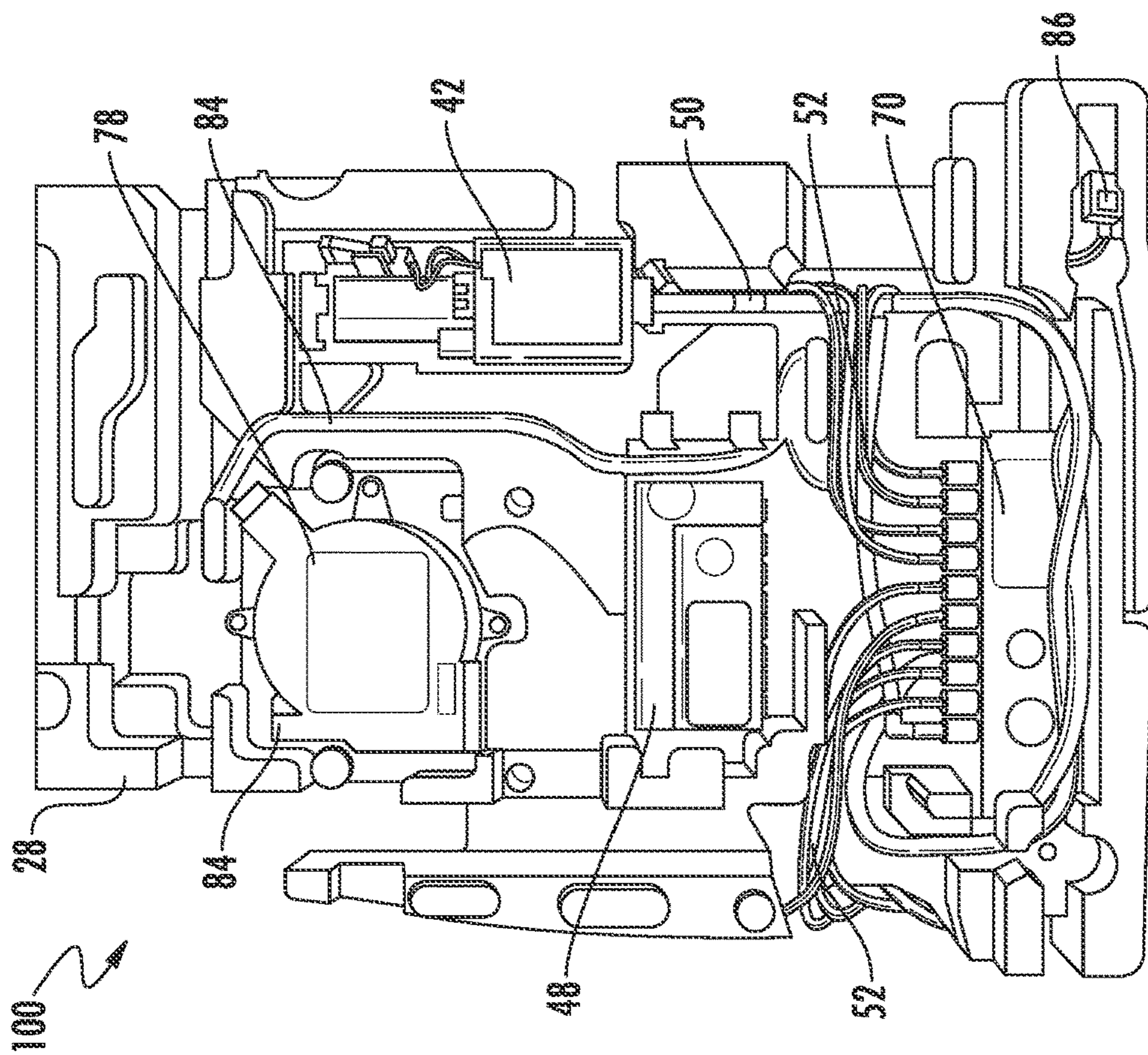

FIG. 3

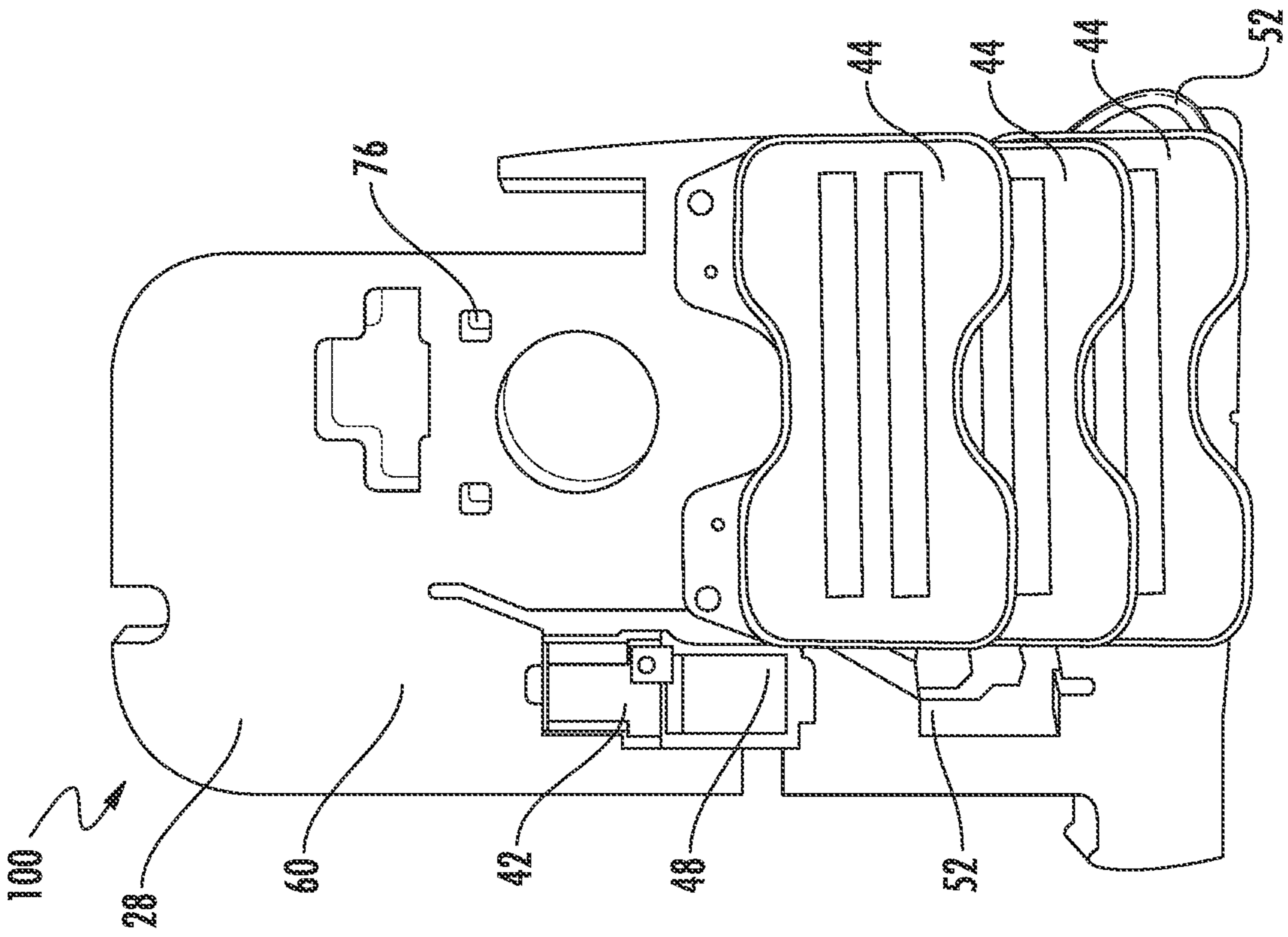

FIG. 5

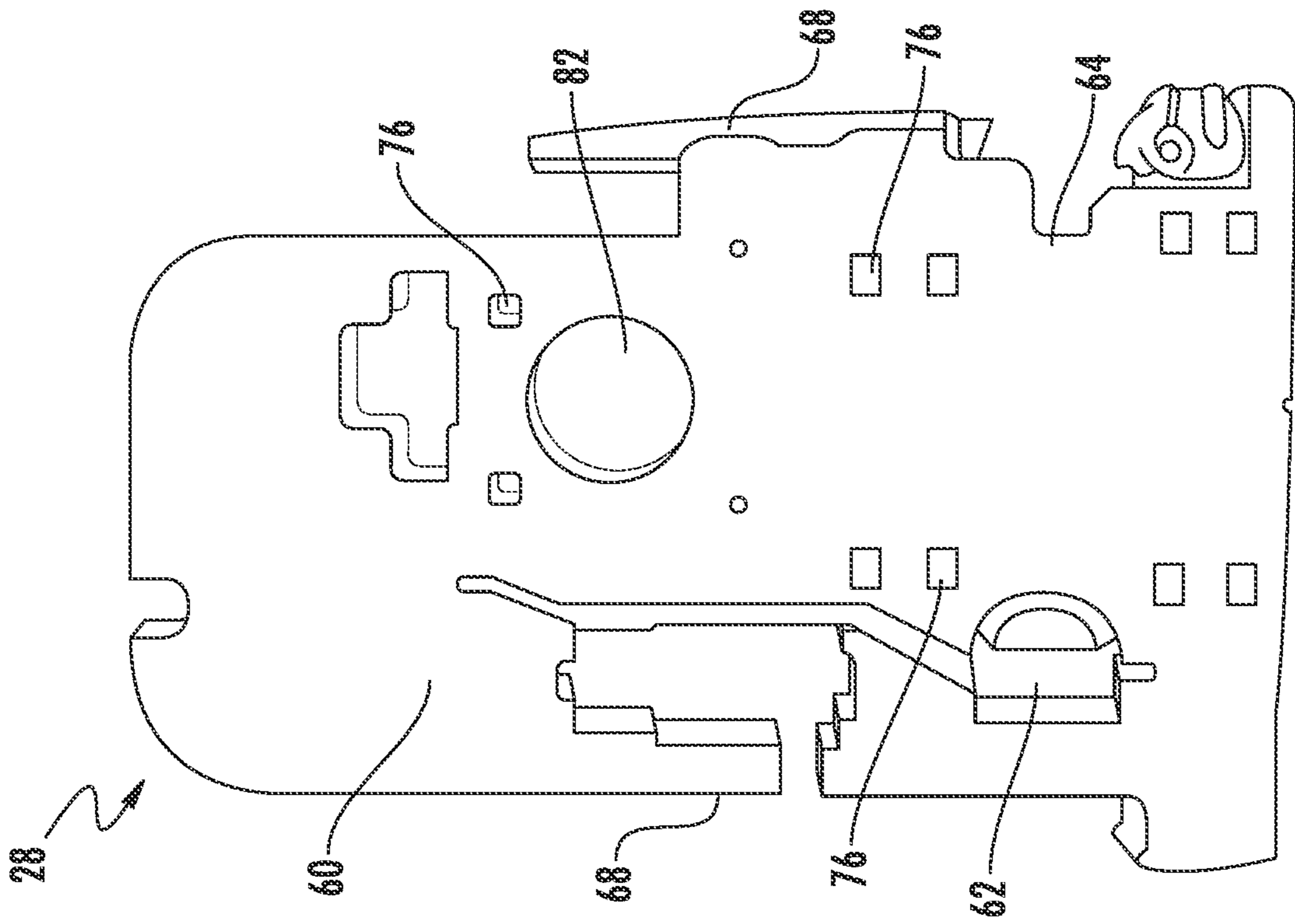

FIG. 4

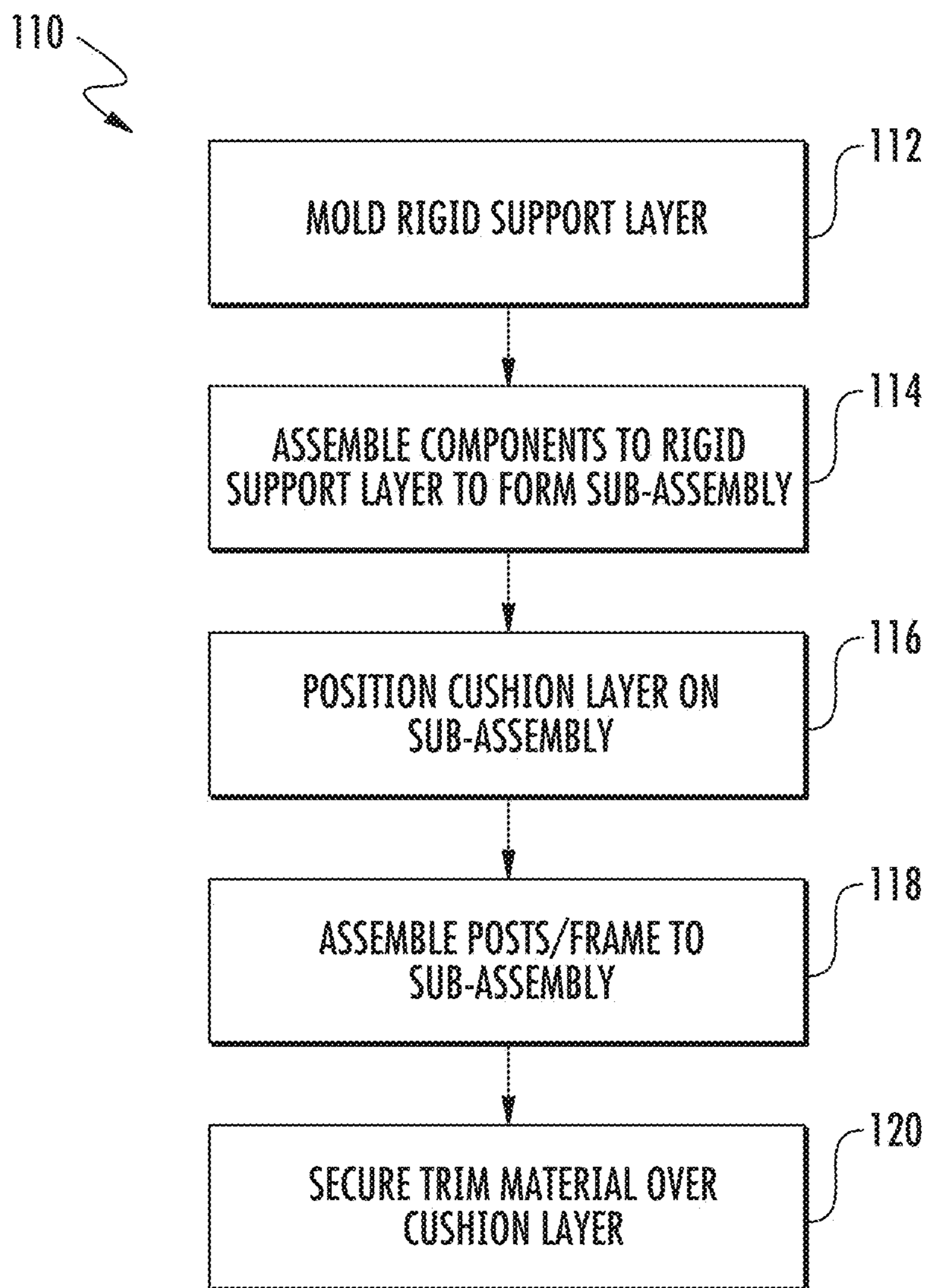

FIG. 6

SEAT SUPPORT LAYER ASSEMBLY**CROSS-REFERENCE TO RELATED APPLICATIONS**

This application is a continuation of 15/404,604 filed on Jan. 12, 2017, which claims foreign priority benefits under 35 U.S.C. § 119(a)-(d) to DE 10 2016 209 218.9, filed May 27, 2016, and DE 10 2016 212 387.4, filed Jul. 7, 2016, the disclosures of which are hereby incorporated by reference in their entirety.

TECHNICAL FIELD

Various embodiments relate to a vehicle seat assembly having a support layer.

BACKGROUND

A seat assembly having a support layer is illustrated and described in U.S. Pat. No. 8,282,164 which issued on Oct. 9, 2012 to Lear Corporation.

SUMMARY

In one embodiment, a seat back assembly is provided. The seat back includes a foam cushion layer and a support sub-assembly. The support sub-assembly includes a rigid support layer having a plurality of cavities and channels defined on a rear surface for receiving components and a generally smooth front surface. At least one component is retained in one of the cavities. A second component is secured on the front surface. A trim material covers the cushion layer and secures the sub-assembly to the seat back.

In another embodiment, the rigid support layer is formed of expanded polypropylene (EPP) material.

In another embodiment, an air pump and a controller are mounted in the cavities along the rear surface and an air bladder is secured to the front surface. The air pump, controller and air bladder provide a lumbar support system in the seat back.

In another embodiment, the air pump and controller are retained on the support layer without any fasteners.

In another embodiment, the air pump and controller are retained in the cavity with an interference fit.

In another embodiment, the sub-assembly includes a wiring harness retained in a channel defined along the rear surface.

In another embodiment, the sub-assembly is retained in the seat back without any fasteners attached to the support layer.

In one further embodiment, a vehicle seat assembly is provided. The seat assembly includes a seat back configured for attachment to a vehicle and having a foam cushion layer defining a seating surface. A rigid expanded polymer layer is disposed adjacent the foam layer. The expanded polymer layer defines at least one cavity on a rear surface and a front surface that abuts the cushion layer. A lumbar support system includes an air pump retained in the at least one cavity along the rear surface of the expanded polymer layer and at least one air bladder mounted to the front surface expanded polymer layer. A trim material covers the cushion layer and secures the rigid expanded polymer layer to the seat back.

In another embodiment, at least one air tube routed from the rear surface to the front surface via at least one of a side cut-out and a through hole defined in the support layer.

In another embodiment, the support layer is retained in the seat back without any fasteners attached to the support layer.

In one other embodiment, a method of manufacturing a seat back is provided. The method includes providing a rigid support layer having a plurality of cavities defined on a rear surface. A sub-assembly is formed by mounting at least one component on the rear surface so the component is retained in one of the cavities without any fasteners. A cushion layer is positioned on the sub-assembly so that the cushion layer covers at least the front surface of the support layer. A trim material is secured over the cushion layer such that the sub-assembly is retained in the seat back without any fasteners attached to the support layer.

In another embodiment, the method includes mounting a lumbar support system on the support layer. An air pump and a controller are mounted in the cavities along the rear surface and an air bladder is secured to the front surface.

BRIEF DESCRIPTION OF THE DRAWINGS

FIG. 1 is a schematic section view of a vehicle seat assembly having a support layer that forms a support sub-assembly.

FIG. 2 is a rear perspective view of the support layer shown in FIG. 1.

FIG. 3 is a rear perspective view of the support layer in FIG. 2 including assembled components that forms the sub-assembly.

FIG. 4 is a front perspective view of the support layer shown in FIG. 2.

FIG. 5 is a front perspective view of the support layer in FIG. 4 including assembled components that forms the sub-assembly.

FIG. 6 is a flow chart illustrating a method of assembling the vehicle seat of FIG. 1.

DETAILED DESCRIPTION

As required, detailed embodiments of the present invention are disclosed herein; however, it is to be understood that the disclosed embodiments are merely exemplary of the invention that may be embodied in various and alternative forms. The figures are not necessarily to scale; some features may be exaggerated or minimized to show details of particular components. Therefore, specific structural and functional details disclosed herein are not to be interpreted as limiting, but merely as a representative basis for teaching one skilled in the art to variously employ the present invention.

FIG. 1 illustrates a schematic view of a vehicle seat assembly 10. The vehicle seat assembly 10 may be adapted for use in an automobile vehicle or may be used in with other seat assemblies including in aircraft, theater seats or any suitable seat assemblies.

The seat assembly 10 includes a seat back 12 pivotally mounted and a seat bottom 14. The seat bottom 14 is mounted on a seat frame 18 which is secured to the floor 20, such as the vehicle floor. In some embodiments, the seat back 12 may include a head restraint 22

The seat back 12 and includes a cushion layer 24. The cushion layer 24 may be made of any suitable comfort foam material, such as a suitable resilient polymer. For example, the cushion layer may be formed of conventional polyurethane foam, soy-based foam, silicone, thermoplastic olefins, thermoplastic urethanes, and/or natural oil-based expanded polyurethanes, soy-based polyurethane, polymer fibers, non-woven polyester pads, and latex foams. The cushion layer 24

is formed of any suitable comfort material that provides soft resilience as the seat assembly is deflected during use when an occupant is in a seated position.

The seat back **12** also includes a support layer **28** disposed rearward of the cushion layer **24**. The support layer **28** is more rigid than the cushion layer **24**, and has a hardness greater than the cushion layer **24** in order to provide structural support for the seat back **12**.

The support layer **28** is formed of a structural foam material such as an expanded polymer including expanded polypropylene (EPP). In another embodiment, the support layer **28** may be formed of other expanded polyolefins, expanded polystyrenes, expanded polyethylene, expanded polybutylene or other suitable expandable polymers known to a person of ordinary skill in the art. The expanded polymer such as EPP may be prepared by a bead polymerization process in which relatively small uniform beads of polymer are produced, containing a gas which is later utilized to effect blowing during the molding process. The most commonly used gas is air although other gases including low boiling point liquids which produce gases at the molding temperatures may be used.

While the structural layer **28** can have any suitable size and configuration the structural foam material that has a rigidity, density and/or hardness that is greater than conventional polyurethane foam used in the cushion layer **24**. The structural layer **28** may be formed of Vestocell® brand EPP foam having low density and high strength and elasticity. In at least one embodiment, the structural layer **28** has a density of at least 30 grams per liter (g/L) and less than 180 g/L. In at least one embodiment, the structural layer **28** has a type-C hardness between 35 and 95. In another embodiment, the structure layer foam has a density between 30 g/L and 60 g/L. In one other embodiment, the structural layer foam has a tension between 150 kPa and 370 kPa at 25% compression. In at least one further embodiment, the structural foam has a density of 40 g/L and a tension between 210 kPa and 230 kPa at 25% compression embodiment.

As illustrated in FIG. 1, the support layer **28** provides structural support for the seat back **12** and may replace a seat back frame that would typically support cushion layer **24** and components mounted in the seat back, as further illustrated in FIGS. 2-5. As shown in FIG. 2, the support layer **28** includes a plurality of cavities **30** and channels **32** formed in a rear surface **34** of the support layer **28**. Each cavity **30** is formed with a shape to receive a component required within the seat back **12**.

As shown in FIG. 3, numerous components can be mounted to the rear surface **34** of the support layer **28**. For example, the components for a lumbar support system **40** are mounted to the support layer **28**. The lumbar support system **40** includes an air pump **42** that is connected to a plurality of air bladders **44** and an air valve controller **48**.

The air pump **42** is mounted in a cavity **30** and held in the cavity without the need for additional fixtures or fasteners. The properties of the expanded polymer used in support layer **28** allow the walls of the cavities to flex or deform as the electrical component is pressed into position. The cavities **30** may be molded such that the walls forming cavities **30** have a negative draft angle or the cavity **30** may be dimensioned such that when the component is positioned within the cavity, there is an interference fit, such as a press fit between the component and the walls of the cavity **30**.

Alternatively, the walls of the cavity may define projections extending inwardly into the cavity to define a snap-fit.

An air supply tube **50** extends from the air pump **42** to the air valve controller **48** along one of the channels **32** formed

in the rear surface **34** of the support layer **28**. A plurality of air tubes **52** extend from the controller **48** to the bladders **44** that are mounted on a front surface **60** of the support layer **28**. The bladder air tubes **52** are routed from the rear surface **34** to a front surface **60** via a through-hole **62** and a cut-out **64** formed in the support layer **28**. The through-hole **62** extends a from the rear surface **34** to the front surface **60**. The cut-out **64** forms an indentation on a side surface **68** of the support layer **28**.

The lumbar support system **40** may also include a massage control module **70** that controls air valve actuation to provide varying pressures to the air bladders **44** in a predetermined pattern. The lumbar support controller **48** and the massage air valve controller **70** are both mounted with a press-fit in cavities **30** along the rear surface **34** of the support layer **28**.

As shown in FIG. 4, the front surface **60** of the support layer **28** is generally planar and provides a smooth comfort surface to the seated occupant. However, the front surface **60** may also have a contour. The lumbar support system **40** includes a plurality of air bladders **44** mounted along the front surface **60** of the support layer **28**. As shown in FIG. 5, the air bladders **44** are arranged in a vertical array in along a lower lumbar region **72** of the seat. However, the air bladders **44** may be arranged in any suitable pattern or location along the front surface of support layer.

The air bladders **44** are mounted onto a felt-carrier **46**. The felt-carrier **46** with the air bladders **44** is then mounted to mounting apertures **76** formed along the front surface **60** of the support layer **28**. The felt-carrier **46** may be mounted to the mounting apertures **76** with a push-pin or fir-tree clip, for example. The mounting apertures **76** extend from the front surface **60** through to the rear surface **34** and are generally small being 5 mm to 20 mm, for example. In another embodiment, the air bladders **44** may be attached directly to the front surface with fasteners or protrusions formed on the air bladder **44** that may be press-fit into mounting apertures.

As shown in the front view of the support layer in FIG. 5, the air pump **42** is mounted to a cavity **30** that extends through the support layer **28**. However, the air pump **42** does not extend beyond the generally smooth front surface **60** so that a protrusion is not felt through the cushion layer **24** by a seated occupant.

A fan **78** may also be mounted in a cavity **30** formed along the rear surface **34** of the support layer **28**. The cavity **30** may include a through-opening **82** that extends from the rear surface **34** to the front surface **60** so in order provide air circulation to a front surface **60** of the support layer and provide cooling to the seated occupant. The fan **78** may be mounted to the support layer **28** using a bracket **80** that mates with the cavity **30**. The bracket **80** may be secured to the support layer with protrusions or fir-tree clips that cooperate with mounting apertures **76**.

A wire harness **84** is connected to the fan **78** and the controllers **48**, **70** and the air pump **42**. The wire harness **84** is routed along a channel **32** along the rear surface **34** of the support layer **28**. The wire harness **84** may also include the wiring for seat heating components. The wire harness **84** may be connected at an electrical connector **86**. The electrical connector **86** may also be secured to the support layer **28** at a molded cavity **30**.

The rear surface **34** also has trench **88** that extends laterally across the support layer **28**. The trench **88** receives a lateral post **90** (FIG. 1) that forms part of the seat back frame **18**. Cooperation of the lateral post **90** with the trench **88** allows the support layer **28** to be aligned and positioned correctly. A vertical trench **92** may also be formed on the rear

5

surface 34 and may also receive a vertical post of the frame 18 in order to further position the support layer 28. The lateral post 90 may connect a pair of vertical posts along the frame 18 of the seat back 12. The rear surface 34 may have any configuration of trenches that form the negative space of the seat frame.

The support layer 28 is not secured by any fasteners. Instead, the support layer 28 is secured in place by the trim material 96 that surrounds the cushion layer 24. Since the cushion layer 24 and covers the support layer 28, the trim material 96 acts to constrain the cushion layer 24 and thereby the support layer 28. In one embodiment, the trim material 96 may include a backboard 98 that covers the rear surface 34 of the support layer 28. In another embodiment, the trim material 96 may cover the rear surface 34 of the support layer 28. In one other embodiment, the rigid backboard 98 may be formed as part of the frame 18.

The support layer 28 may help reduce noise, vibration, and harshness that is associated with the operation of the components such as the air pump, for example. The support layer 28 also reduces the weight of the seat 10 while still providing structural support. In addition, the continuous support layer 28 provides force distribution from the seat structure to the seated occupant.

The support layer 28 that allows easy mounting of components also streamlines the manufacturing process of the seat back 12. FIG. 6 illustrates a method of manufacturing a seat back 12 that utilizes the support layer 28 to form a complete sub-assembly 100.

As shown in FIG. 6, a method 110 of assembling a seat back is provided. First, the rigid support layer 28 is molded at step 112. The support layer 28 is molded with predefined cavities, channels, trenches, cut-outs, through-holes, along the rear surface, as shown in FIG. 2 and described in detail above. The support layer 28 may be formed of expanded polymer such as EPP may be molded in a mold cavity by a bead polymerization process to form a rigid support. For example, foam beads may be injected into a mold tool and superheated with steam and sintered together. After cooling and stabilizing the formed and molded parts can be removed from the mold tool. However, any suitable mold process known to a person of ordinary skill in the art may be utilized to form the rigid support.

In step 114, the components are assembled to the support layer 28 to form the sub-assembly 100. The sub-assembly 100 includes all of the components for the lumbar support system 40, as discussed above. The sub-assembly 100 may also include other seat back components such as the fan and wire-harness, shown in FIG. 3 and FIG. 5. However any components required to be provided in the seat back may be mounted on the support layer 28 to form the sub-assembly 100.

The cushion layer 24 is positioned on the sub-assembly 100 in step 116. The cushion layer 24 is positioned to cover the front surface 60, including the lumbar assembly 40. The cushion layer 24 may also cover the side surfaces 68 and a top surface of the support layer 28. The cushion layer 24 may have cavities formed or molded on the B-surface to receive the sub-assembly 100 and align the cushion layer 24 with the sub-assembly 100. In one embodiment, the cushion layer 24 may include an air connector to be mounted to the fan 78. The air connector may be passed through hole 92 and then attached to the fan 78. The fan 78 may be mounted to the support layer 28 after the cushion layer 24 is pre-assembled to the sub-assembly 100. The air connector mounted on the cushion layer 24 also helps align and position the cushion layer 24 with the sub-assembly 100.

6

In step 118, the sub-assembly 100 and cushion layer 24 are assembled to the lateral post 90 and vertical post. The lateral and vertical posts may be part of the seat back frame 18. The frame 18 is assembled to the sub-assembly 100 in the lateral trench 86 and vertical trench 88.

In step 120, the trim material 96 is secured over the cushion layer 24. In one embodiment, the trim material 96 secures the sub-assembly 100 in the seat back without any fasteners being connected to the support layer 28. The trim material 96 may be secured to the cushion layer 24 or the back board 98 with clips of any other suitable securement device. In another embodiment, the trim material 96 is attached to the cushion layer 24 by hog rings, clips, fasteners or any other trim attachment known to a person of ordinary skill in the art. The trim material 96 is then wrapped around the sub-assembly 100 and attached to a trim trench formed on the frame 18 or on the backboard 98. The trim material 96 may be attached to the frame or the backboard 98 by any suitable method or trim attachment. The seat back wire harness 84 is connected to a main wiring harness via the electrical clip 86 in order to supply power to the components in the seat back, such as the pump

While exemplary embodiments are described above, it is not intended that these embodiments describe all possible forms of the invention. Rather, the words used in the specification are words of description rather than limitation, and it is understood that various changes may be made without departing from the spirit and scope of the invention. Additionally, the features of various implementing embodiments may be combined to form further embodiments of the invention.

What is claimed is:

1. A seat back assembly comprising:

a seat back adapted to be mounted to a seat bottom, the seat back comprising:

a foam cushion layer;

a support sub-assembly comprising:

a rigid support layer formed of structural foam, providing structural support for the seat back assembly; and

at least one component retained on the rigid support layer,

wherein the support sub-assembly is retained in the seat back assembly without any fasteners attached to the rigid support layer.

2. The seat back assembly of claim 1, wherein the rigid support layer is formed of expanded polypropylene (EPP) material.

3. The seat back assembly of claim 1, wherein the at least one component is retained on the rigid support layer without any fasteners.

4. The seat back assembly of claim 1, wherein the rigid support layer has a plurality of cavities defined on a rear surface, wherein the at least one component is retained in at least one of the cavities.

5. The seat back assembly of claim 4, wherein the at least one component is retained in at least one of the plurality of cavities with an interference fit.

6. The seat back assembly of claim 4 wherein a second component is secured to an aperture on a front surface.

7. The seat back assembly of claim 6, wherein the at least one component comprises an air pump and a controller being mounted in the cavities along the rear surface and the second component comprises an air bladder secured to the front surface, the air pump, controller and air bladder providing a lumbar support system in the seat back assembly.

7

8. The seat back assembly of claim **1**, further comprising a trim material covering the foam cushion layer and securing the support sub-assembly.

9. A vehicle seat assembly comprising:

a seat back configured for attachment to a vehicle and having a foam cushion layer defining a seating surface;

a rigid expanded polymer layer disposed adjacent the foam cushion layer and providing structural support for the seat back;

an inflatable support system retained on the rigid expanded polymer layer, wherein the inflatable support system comprises:

an air pump retained in at least one cavity defined along a rear surface of the rigid expanded polymer layer with an interference fit; and

at least one air bladder mounted to a front surface of the rigid expanded polymer layer; and

a trim material covering the foam cushion layer and securing the rigid expanded polymer layer to the seat back,

wherein the rigid expanded polymer layer is retained in the seat back without any fasteners attached to the rigid expanded polymer layer.

10. The vehicle seat assembly of claim **9**, further comprising at least one air tube routed from the rear surface to the front surface via at least one of a side cut-out and a through hole defined in the rigid expanded polymer layer.

11. The vehicle seat assembly of claim **9**, further comprising a second component retained in a second cavity defined on the rear surface.

8

12. The vehicle seat assembly of claim **11**, further comprising a wiring harness retained in a channel defined along the rear surface along and connecting the air pump and the second component.

13. A method of manufacturing a seat back:

molding a rigid support layer of structural foam for providing structural support for a seat back;

forming a sub-assembly by retaining at least one component on the rigid support layer without any fasteners;

positioning a cushion layer on the sub-assembly so that that the cushion layer covers at least a front surface of the rigid support layer;

securing a trim material over the cushion layer such that the sub-assembly is retained in the seat back without any fasteners attached to the rigid support layer.

14. The method of claim **13**, wherein the rigid support layer is molded to define a plurality of cavities defined on a rear surface.

15. The method of claim **13**, further comprising molding the rigid support layer of an expanded polypropylene (EPP) material.

16. The method of claim **14**, further comprising retaining the at least one component in one of the plurality of cavities with an interference fit.

17. The method of claim **16**, further comprising retaining the at least one component in one plurality of cavities with a press-fit.

18. The method of claim **14**, further comprising mounting a lumbar support system on the rigid support layer, wherein an air pump and a controller are mounted in the cavities along the rear surface and an air bladder is secured to the front surface.

* * * * *