

US010967339B2

(12) **United States Patent**
Seal et al.

(10) **Patent No.:** **US 10,967,339 B2**
(45) **Date of Patent:** **Apr. 6, 2021**

(54) **STATIC MIXER**

(71) Applicant: **VME Process Inc.**, Tyler, TX (US)

(72) Inventors: **Justin M. Seal**, Tyler, TX (US);
Michael Thomas, Tyler, TX (US);
Maurice Michael Laperriere, III,
Tyler, TX (US)

(73) Assignee: **VME PROCESS, INC.**, Tyler, TX
(US)

(*) Notice: Subject to any disclaimer, the term of this
patent is extended or adjusted under 35
U.S.C. 154(b) by 171 days.

(21) Appl. No.: **16/095,694**

(22) PCT Filed: **Jun. 19, 2018**

(86) PCT No.: **PCT/US2018/038326**

§ 371 (c)(1),

(2) Date: **Oct. 23, 2018**

(87) PCT Pub. No.: **WO2019/245538**

PCT Pub. Date: **Dec. 26, 2019**

(65) **Prior Publication Data**

US 2020/0206700 A1 Jul. 2, 2020

(51) **Int. Cl.**

B01F 5/04 (2006.01)

B01D 17/04 (2006.01)

(Continued)

(52) **U.S. Cl.**

CPC **B01F 5/0451** (2013.01); **B01D 17/047**
(2013.01); **B01F 3/0865** (2013.01); **B01F**
5/0405 (2013.01); **B01F 5/0458** (2013.01);
B01F 5/0618 (2013.01); **B01F 5/0653**
(2013.01); **C10G 31/08** (2013.01);
(Continued)

(58) **Field of Classification Search**

CPC **B01F 5/0451**; **B01F 3/0865**; **B01F 5/0405**;
B01F 5/0458; **B01F 5/0618**; **B01F**
5/0653; **B01F 2005/0639**; **B01F**
2215/0081; **B01F 5/0614**; **B01F 5/0652**;
B01D 17/047; **C10G 31/08**; **E21B 43/36**;
E21B 41/02

See application file for complete search history.

(56) **References Cited**

U.S. PATENT DOCUMENTS

6,348,657 B1 2/2002 Haslock et al.

6,623,154 B1 9/2003 Garcia

(Continued)

FOREIGN PATENT DOCUMENTS

CN 203002233 U 6/2013

CN 104014263 B 4/2016

GB 2500845 B 6/2015

OTHER PUBLICATIONS

Foreign Communication from a Related Counterpart Application,
International Search Report and Written Opinion dated Sep. 18,
2018, International Application No. PCT/US2018/038326 filed on
Jun. 19, 2018.

Primary Examiner — Randy Boyer

Assistant Examiner — Juan C Valencia

(57) **ABSTRACT**

A static mixer for desalting a fluid is disclosed. A static mixer can include a housing, a reduction cone disposed concentrically within the housing; and an expansion cone disposed concentrically within the housing; wherein the static mixer is configured to direct fluid flow through the reduction cone onto the expansion cone, thereby mixing the fluid.

20 Claims, 6 Drawing Sheets

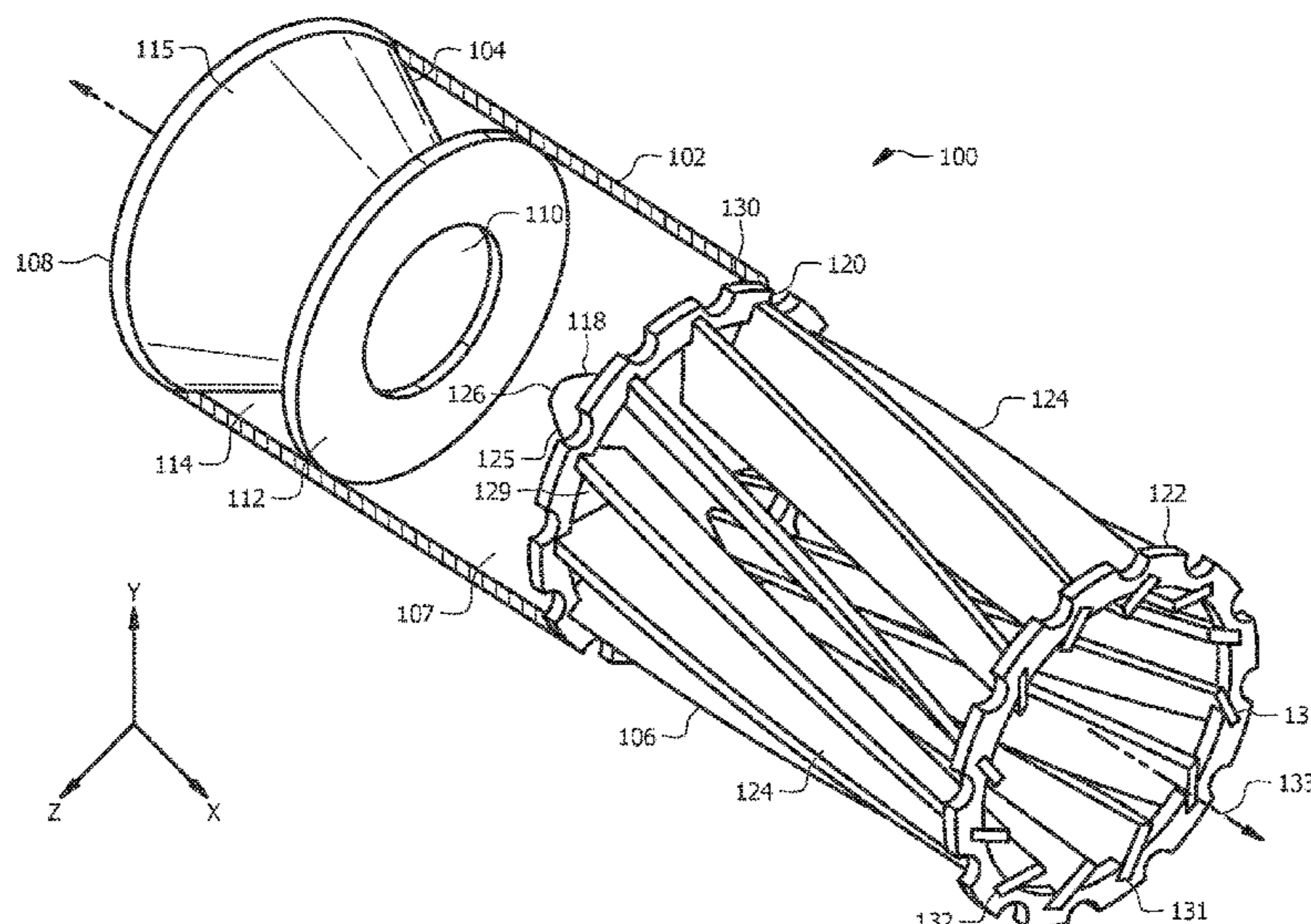

- (51) **Int. Cl.**
B01F 3/08 (2006.01)
B01F 5/06 (2006.01)
C10G 31/08 (2006.01)
E21B 43/36 (2006.01)

- (52) **U.S. Cl.**
CPC *E21B 43/36* (2013.01); *B01F 2005/0639*
(2013.01); *B01F 2215/0081* (2013.01)

(56) **References Cited**

U.S. PATENT DOCUMENTS

7,878,705 B2* 2/2011 Schauerte B01F 5/0688
366/337
8,409,334 B2 4/2013 Audunson et al.
9,067,183 B2 6/2015 Glanville
9,416,604 B2 8/2016 Cobb
10,471,640 B2* 11/2019 Heusser B29C 48/32
2004/0251566 A1 12/2004 Kozyuk
2010/0276340 A1 11/2010 Norling
2014/0301157 A1* 10/2014 Glanville B01F 5/0652
366/337
2015/0071028 A1* 3/2015 Glanville B01F 5/0605
366/337
2017/0291151 A1* 10/2017 Berglund B01F 15/063

* cited by examiner

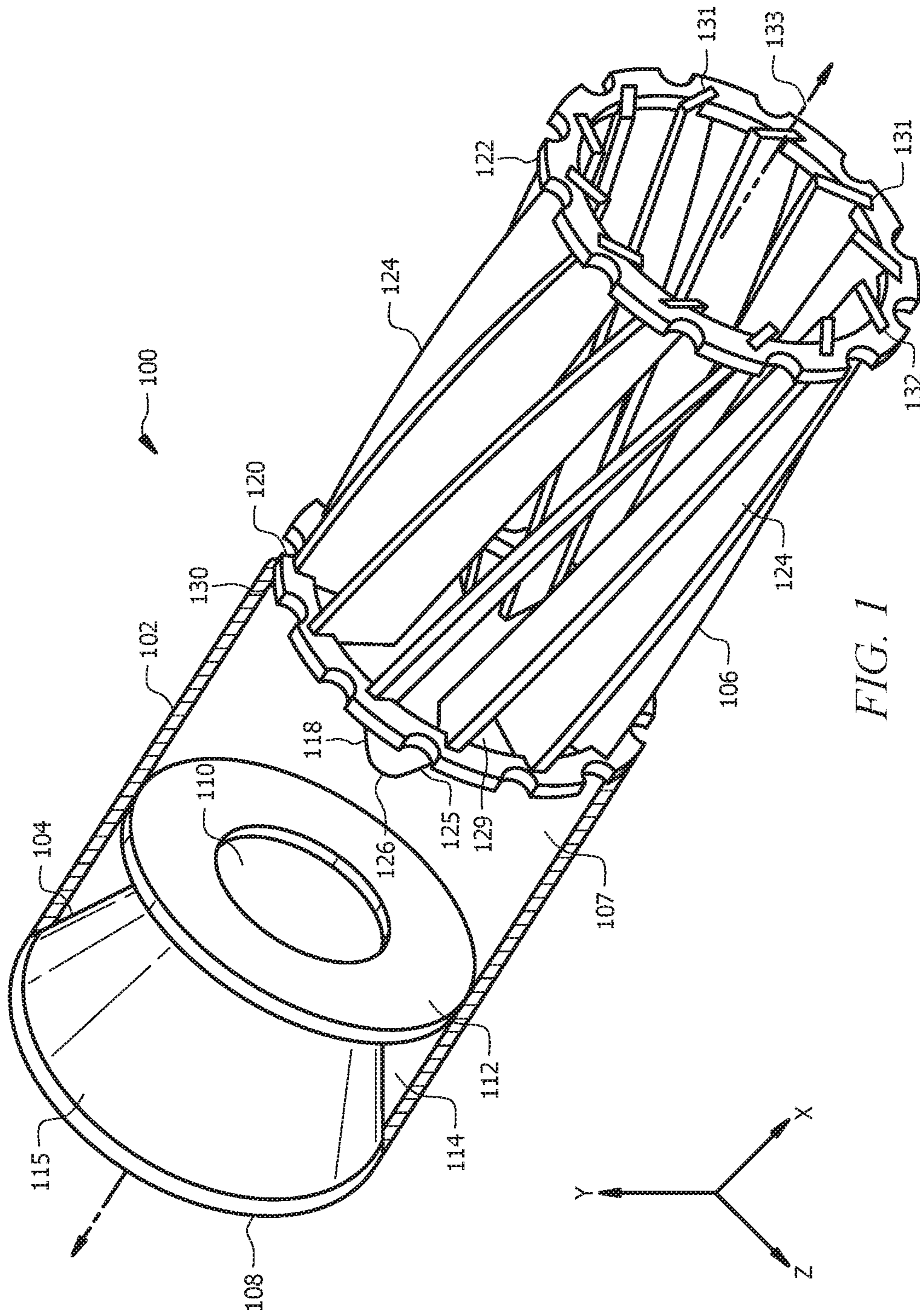

FIG. 1

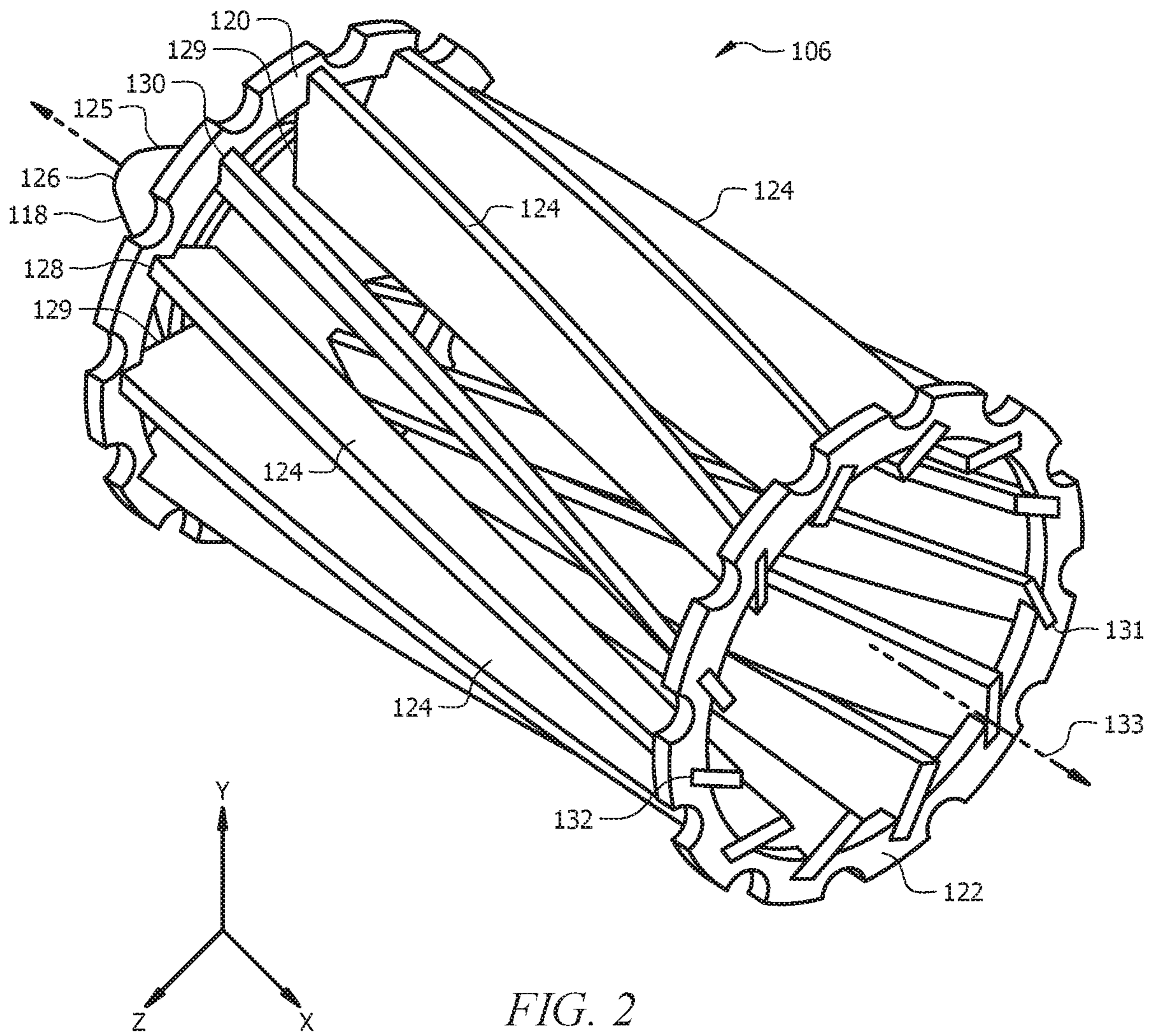

FIG. 2

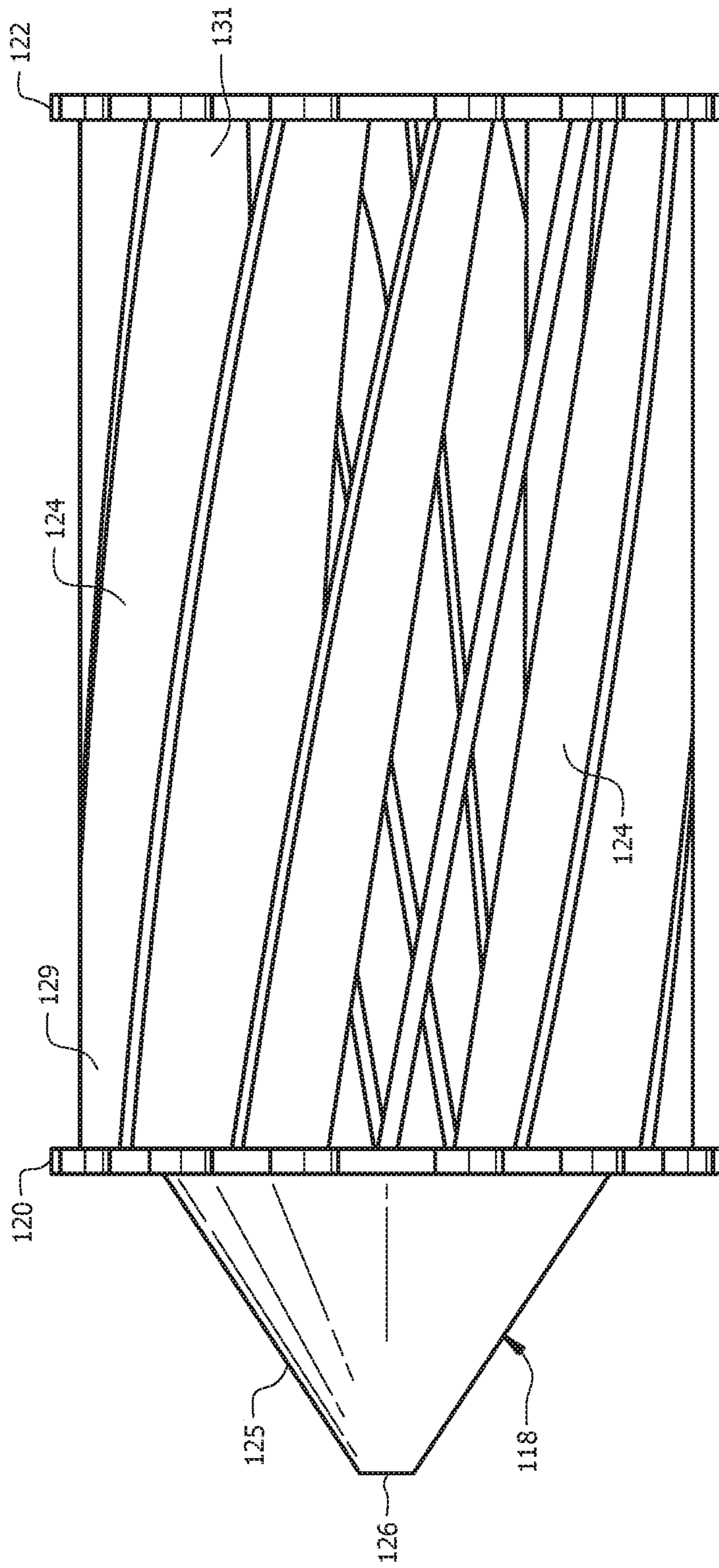
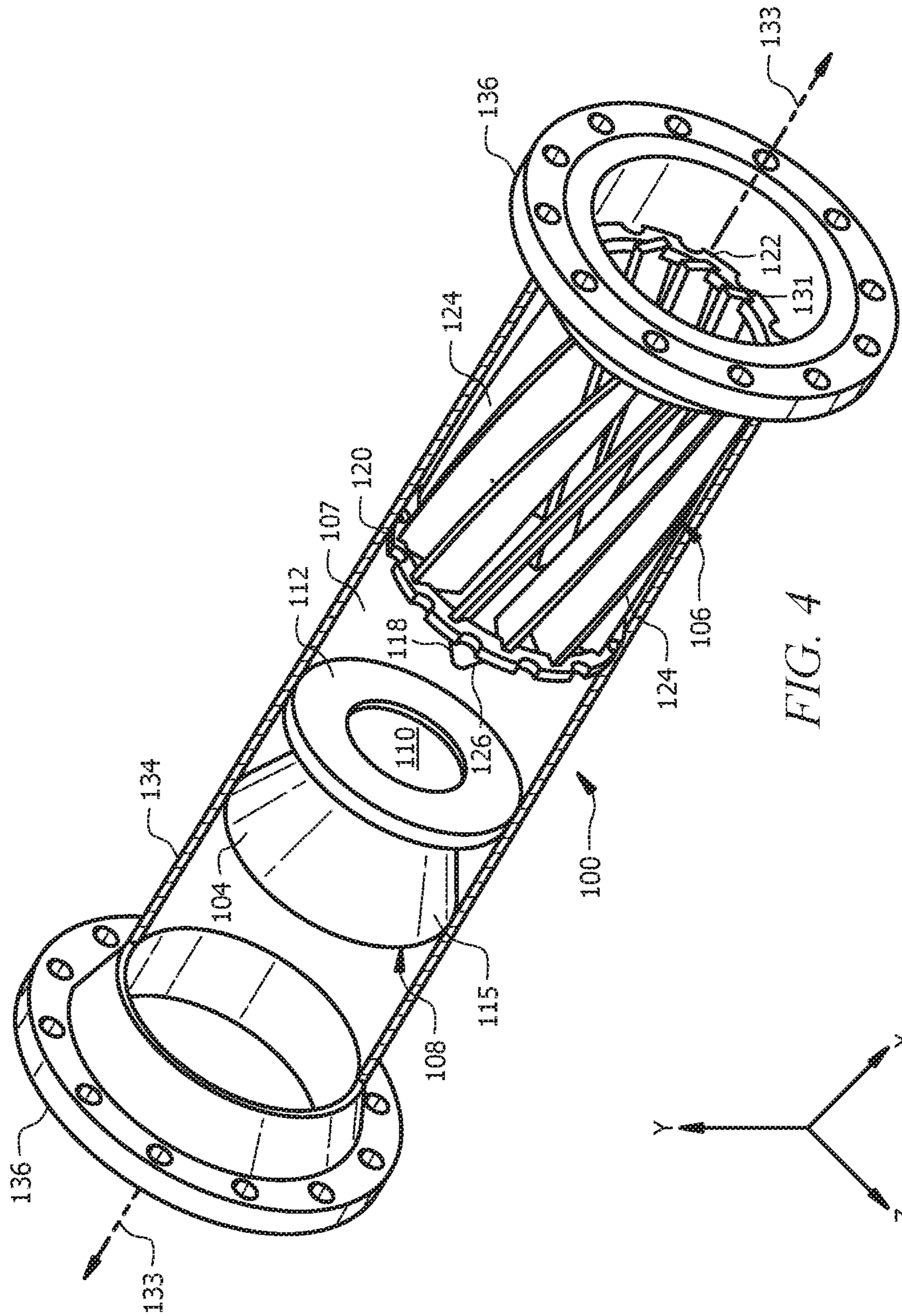
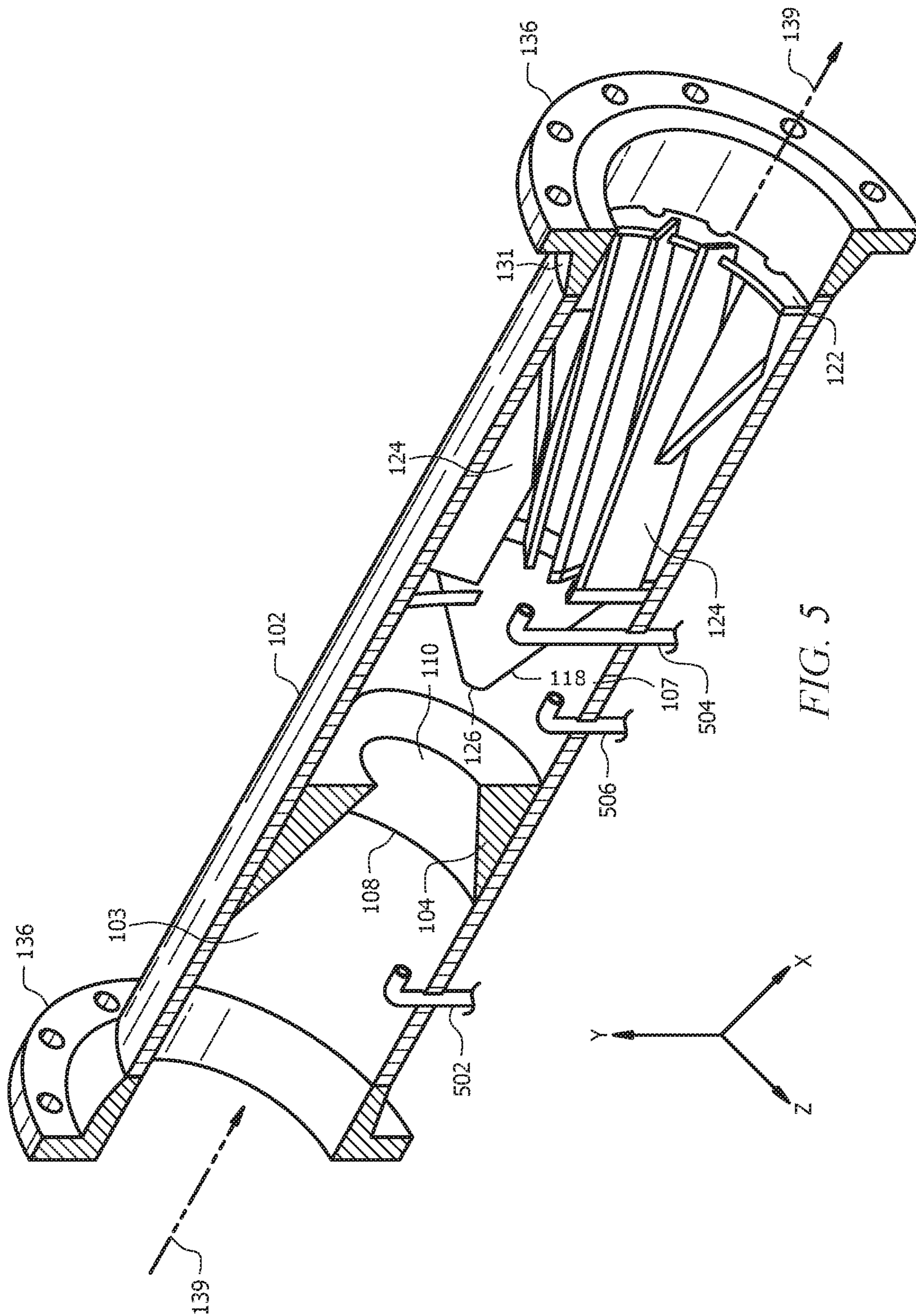
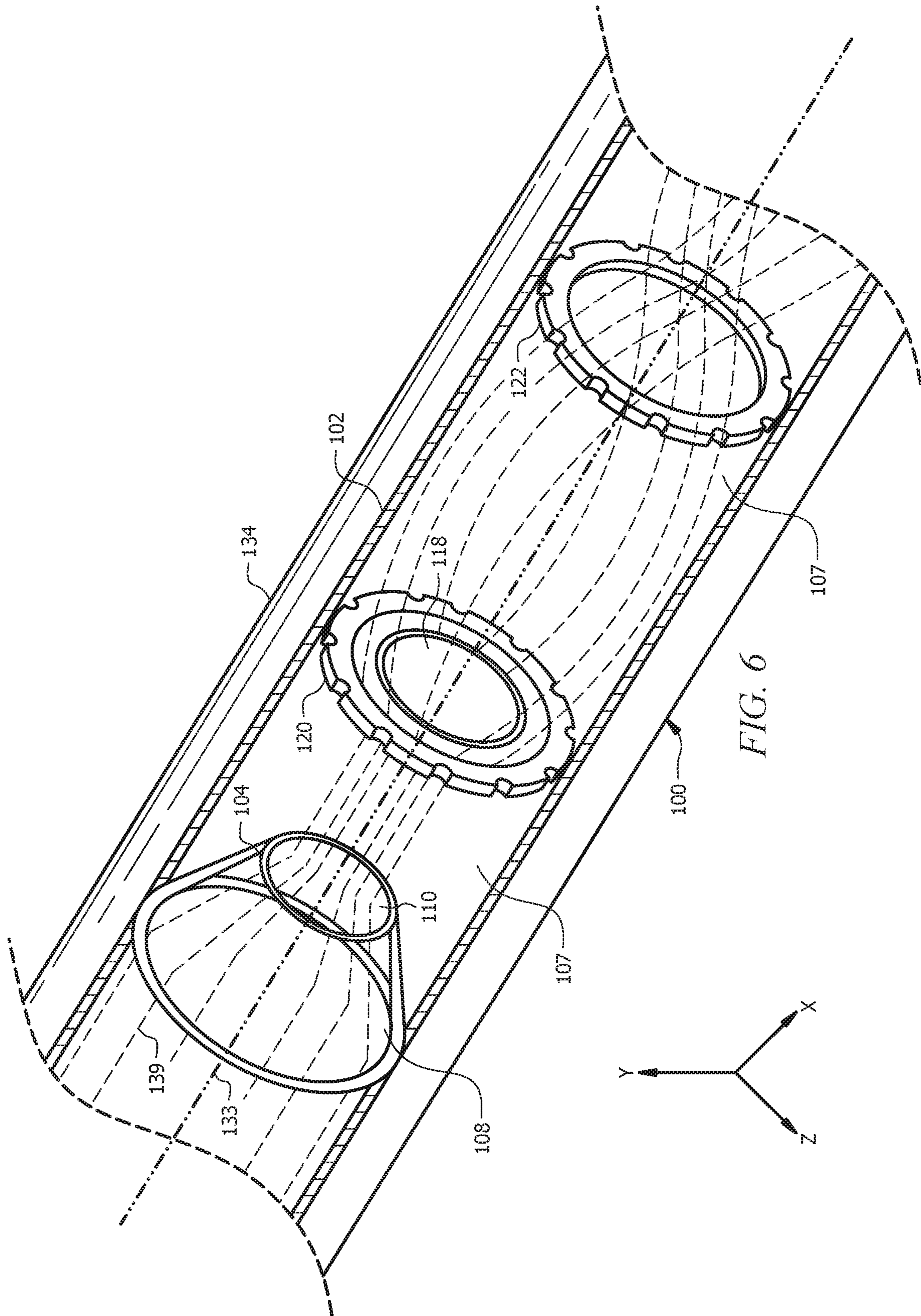

FIG. 3







1

STATIC MIXER**CROSS-REFERENCE TO RELATED APPLICATIONS**

The present application is a filing under 35 U.S.C. 371 as the National Stage of International Application No. PCT/US2018/038326, filed Jun. 19, 2018, entitled "STATIC MIXER," which is incorporated herein by reference in its entirety for all purposes.

BACKGROUND

In some geographical areas, fluid produced from a well may yield crude oil having substantial quantities of water and undesired substances, such as salt. In some instances, the salt and water content may be so high as to interfere with subsequent transportation, storage, and refining of the crude. Salt and water in the crude may be highly deleterious to some metal equipment and piping, and therefore it may be desirable that at least some of the water and undesired substances be separated and removed from the crude.

SUMMARY

In an embodiment, a static mixer for desalting a fluid is disclosed. A static mixer can include a housing; a reduction cone disposed concentrically within the housing; and an expansion cone disposed concentrically within the housing adjacent to the reduction cone; wherein the static mixer is configured to direct fluid flow through the reduction cone onto the expansion cone, thereby mixing the fluid.

A static mixer for desalting a fluid is disclosed, according to another embodiment. A static mixer can include a housing; a reduction cone disposed concentrically within the housing; an expansion cone disposed concentrically within the housing adjacent to the reduction cone; and a plurality of blades disposed within the housing; wherein the static mixer is configured to increase a velocity of a fluid with the reduction cone, distribute the fluid with the expansion cone, and rotate the fluid with the plurality of blades, thereby mixing the fluid.

A static mixer for desalting a fluid is disclosed, according to another embodiment. A static mixer can include a housing; an expansion cone disposed concentrically within the housing; and a plurality of blades disposed within the housing; wherein the static mixer is configured to direct fluid flow onto the expansion cone and through the plurality of blades, thereby mixing the fluid.

A method for static mixing to desalt a fluid is disclosed, according to another embodiment. The method can comprise allowing the fluid to flow through a reduction cone; increasing a velocity of the fluid with the reduction cone; directing the fluid onto an expansion cone; maintaining an increased velocity with the expansion cone; and distributing the fluid over the expansion cone, thereby mixing the fluid.

A method for static mixing to desalt a fluid is disclosed, according to another embodiment. The method can include allowing the fluid to flow through a reduction cone; increasing a velocity of the fluid with the reduction cone; directing the fluid onto an expansion cone; maintaining an increased velocity with the expansion cone; distributing the fluid over the expansion cone, thereby mixing the fluid; allowing the fluid to flow through a plurality of blades, wherein each blade is inclined with respect to a longitudinal axis passing

2

through a center of the reduction cone and expansion cone; and rotating the fluid with the plurality of blades, thereby mixing the fluid.

A method for static mixing to desalt a fluid is disclosed, according to another embodiment. The method can include directing the fluid onto an expansion cone; distributing the fluid over the expansion cone; allowing the fluid to flow through a plurality of blades, wherein each blade is inclined with respect to a longitudinal axis passing through a center of the reduction cone and expansion cone; and rotating the fluid with the plurality of blades, thereby mixing the fluid.

These and other features will be more clearly understood from the following detailed description taken in conjunction with the accompanying drawings and claims.

BRIEF DESCRIPTION OF THE DRAWINGS

For a more complete understanding of the present disclosure, reference is now made to the following brief description, taken in connection with the accompanying drawings and detailed description, wherein like reference numerals represent like parts.

FIG. 1 illustrates a static mixer in accordance with embodiments of the disclosure.

FIG. 2 illustrates an expansion cone assembly in accordance with embodiments of the disclosure.

FIG. 3 illustrates a side view of an expansion cone assembly in accordance with embodiments of the disclosure.

FIG. 4 illustrates a static mixer disposed within a pipe in accordance with embodiments of the disclosure.

FIG. 5 illustrates a cross sectional view of the static mixer of FIG. 4, in accordance with embodiments of the disclosure.

FIG. 6 illustrates a fluid flow path for a static mixer in accordance with embodiments of the disclosure.

DETAILED DESCRIPTION

It should be understood at the outset that although illustrative implementations of one or more embodiments are illustrated below, the disclosed systems and methods may be implemented using any number of techniques, whether currently known or not yet in existence. The disclosure should in no way be limited to the illustrative implementations, drawings, and techniques illustrated below, but may be modified within the scope of the appended claims along with their full scope of equivalents.

Embodiments of the disclosure are directed to a static mixer for contacting two immiscible liquids such as fresh water with an oil/water mixture to provide for desalting of the oil phase. Typically, when oil is produced from a well, it may contain oil, water, and salt, where the salt may be present not only in the water, but also in the oil. In order to remove the salt from the produced fluid that includes oil, water, and salt, a desalter may be used to first separate the water and then contact the oil with fresh water to extract any salt into the water. Part of the desalting process may involve a specific mixing in a mixer prior to further separation of the water that has removed the salt from the oil.

A number of mixer designs exist, all of which have drawbacks. As noted above, a function of the mixer may be to provide contact between the oil and the introduced fresh water. There may be a balance in the amount of mixing that is to be achieved. On one hand, increased mixing may help to provide better transfer of the salts into the water based on an increased contact area between the two liquid phases, while on the other hand, increased mixing may make it

difficult to separate the two phases downstream of the mixer. The static mixer proposed herein may strike a balance that may provide improved contact and salt removal without creating a two phase mixture that is difficult to separate (e.g., such as an emulsion). Additionally, the static mixer proposed herein may allow for close contact between fluids to produce a large interfacial area to improve mass transfer (e.g., salt) from the oil to the water.

As described herein, the mixer comprises a static mixer such that the mixer has no moving parts. The mixer can have several sections that aid in creating the mixing including a reduction cone, an expansion cone, and rotational section comprising a plurality of blades. The reduction cone can serve to increase a fluid velocity. An expansion cone can then be placed downstream of the reduction cone. The expansion cone can be configured to direct the fluid flow outwards while maintaining an increased velocity. While the overall flow cross-sectional area past the reduction cone and the expansion cone can be similar, the expansion cone can serve to change the direction of the fluid flow, and thereby create a mixing of the two-phase fluid. In order to further improve mixing, a rotation inducing section comprising a plurality of blades can be used downstream of the expansion cone. The expansion cone can then direct the fluid into the blades which can cause the fluid to rotate, thereby further increasing mixing and contact between the two phases. While the combination of all three sections may provide the desired mixing, only one or two of the sections may be needed in any particular application. Further, the use of the various sections serves to provide the desired contact between a multi-phase liquid solution while avoiding the creation of an emulsion that is difficult to separate. Thus, the present mixer design serves to provide mixing between a multi-phase fluid in a compact design while having no moving parts.

FIG. 1 illustrates a static mixer 100. Static mixer 100 may include tubular housing 102, a reduction cone 104, an expansion cone assembly 106, and a mixing chamber 107. The static mixer 100 may not include moving components. In some embodiments, the static mixer 100 may be utilized as an insert, and may be positioned into an existing pipe or pipes (pipe string), such as, for example, on a production platform, within a pipeline, or in a subsea assembly, or the like. In certain embodiments, the static mixer 100 may be positioned in a separate pipe (shown on FIG. 4), and then the separate pipe may be integrated into a pipe string. It should be noted that dimensions and/or spacing of each component of static mixer 100 can affect the functionality of the static mixer 100, as described in more detail herein.

The housing 102 may include an internal bore 103 (shown on FIG. 5) with a diameter that may be less than an internal diameter of a pipe (e.g., pipe 134 shown on FIG. 4) that the static mixer 100 may be positioned concentrically. The housing 102 may include a length from about 2 to about 8 diameters of the pipe, though the exact length can vary. The housing 102 may include any suitable material, such as, for example, metal.

The reduction cone 104 may be disposed concentrically within housing 102. In general, the reduction cone 104 may be formed as a frusto-conical cone section configured to direct fluid passing through the interior of the housing through a reduced flow area, thus increasing the flow velocity. The reduction cone 104 may be retained within housing 102 (e.g., against the internal bore 103) using any suitable connections such as welding, etc. The reduction cone 104 can include a flow-in opening 108, a flow-out opening 110, and optionally a flashing or grommet 112. An internal

diameter of reduction cone 104 may decrease from the flow-in opening 108 to the flow-out opening 110, thereby increasing a velocity of a fluid passing through it. That is, the reduction cone 104 can be configured to increase a velocity of a fluid passing through it. A height of the reduction cone 104 may be between about one quarter to about three quarters, or about one half of the diameter of the internal bore 103. The height may be measured from the flow-in opening 108 to the flow-out opening 110 (i.e., a length in the axial direction).

The flow-in opening 108 may have a diameter that is less than the diameter of the internal bore 103 to account for the connection of the reduction cone 104 within the housing 102, though the diameter may be approximately that of the internal bore of the housing 102. The flow-out opening 110 may include a diameter that may be between about one quarter to about three quarters, or about one half of the diameter of internal bore 103. That is, flow-in opening 108 may include a larger diameter than flow-out opening 110. In some embodiments, the flow-out opening 110 can have a diameter of between about 5 inches and about 9 inches, though the diameter can vary depending on the selection of the size of the housing 102.

The optional grommet 112 may be positioned at a circumference of the flow-out opening 110. When used, the grommet 112 may be positioned to prevent fluid from flowing back into volume 114, which is a position in the upstream direction of the flow-out opening 110. The grommet 112 can contact or be connected to both the internal bore 103 and the reduction cone 104 at or near the flow-out opening 110 to provide a seal. In some embodiments, the grommet 112 may only connect to one of the reduction cone 104 or the internal bore 103, but not necessarily both as the grommet 112 serves to prevent backflow around the reduction cone 104 and a perfect seal may not necessarily be required. The volume 114 defined between the exterior 115 of the reduction cone 104, the internal bore 103 of the housing 102 and the upstream surface of the grommet 112 may exist within housing 102 due to a tapering of the reduction cone 104 from the flow-in opening 108 to flow-out opening 110. The volume 114 can contain air in some instances, though the volume 114 can also contain the fluid passing through the mixer 100, where the grommet 112 serves to substantially prevent any backflow such that any fluid in the volume 114 may be stagnant during use.

The expansion cone assembly 106 may be positioned downstream from the reduction cone 104 within the housing 102. With additional reference to FIG. 2 and FIG. 3, the expansion cone assembly 106 may include an expansion cone 118. The expansion cone assembly 106 can serve to redirect flow of the fluid from a central region within the housing 102 towards and outside of the flow path. In general, the reduction cone 104 serves to accelerate the fluid by directing the fluid through a flow area having a reduced cross section. The reduced cross sectional area also serves to direct the flow of fluid through the housing 102 into a central portion of the flow path. The expansion cone assembly 106 can then serve to redirect this flow outwards without slowing the fluid. At least a portion of the mixing occurring within the mixer 100 can occur based on the combination of the flow through the reduction cone 104 and the expansion cone assembly 106. The expansion cone assembly 106 may be formed from any suitable material, such as, for example, metal.

The expansion cone 118 may be positioned concentrically within the housing 102 and may include an exterior surface 125, a lead end or apex 126, and a base 128. In general, the

5

expansion cone **118** can be hollow. The apex **126** of the expansion cone **118** can have a point or be a flat section with a diameter of between about 5% to about 25% of the internal diameter of the housing **102**, or about 10% to about 20% of the internal diameter of the housing **102**. In some embodiments in which the apex **126** of the expansion cone **118** has a flat section, the diameter of the flat section can be between about 0.5 inches to about 2 inches. The apex **126** may not contain an opening, and as a result, fluid may not flow through it. However, fluid may contact the apex **126** and be redirected to flow along an exterior surface **125** toward the base **128**. That is, the static mixer **100** may be configured to direct fluid flow through reduction cone **104** and onto and around the apex **126** and the exterior surface **125**. The conical profile of the expansion cone **118** may maintain an increased velocity of a fluid that contacts it relative to the fluid upstream of the reduction cone **104**. That is, the reduction cone **104** may increase a velocity of a fluid and expansion cone may maintain this increased velocity of the fluid and distribute the fluid over exterior surface **125**, thereby mixing the two phase fluid. The apex **126** may align with a center of the flow-out opening **110** and may face the flow-out opening **110**. A height of the expansion cone **118** may be between about one quarter to three quarters of the diameter of the internal bore **103**, or between about one half of the diameter of internal bore **103**. The height of the cone **118** may be measured from the apex **126** to the base **128**.

The base **128** can be maintained in position within the housing **102** using any suitable configurations. In some embodiments, the base **128** can be coupled (e.g., via welds) to the proximal ends **129** of the blades **124**. That is, the blades **124** may be positioned downstream from the base **128**. In order to allow fluid flow around the base **128**, the base **128** may not directly contact the housing **102**, but may be retained in position within the center of the housing **102**. A diameter of the base **128** may be between about one quarter to three quarters of the internal diameter of the housing **102**, or about one half of the diameter of internal bore **103**.

The blades **124** may extend from the first ring **120** to a second ring **122** about the longitudinal axis **133** of the housing **102**. The second ring **122** may be positioned downstream from the first ring **120**. The blades **124** may be straight flat blades of a rectangular shape, and may include any suitable material, such as, for example, metal (e.g., sheet metal). The blades **124** may have a length that may be between about 1 to about 2 times (e.g., 1.5) the diameter of internal bore **103**. In some embodiments, the blades **124** are not curved or bent within the mixer **100**.

The first ring **120** and the second ring **122** may each be positioned concentrically within the housing **102** at axially spaced positions and attached to the internal bore **103** by any suitable means, such as, for example, welds. A distance between the first ring **120** and the second ring **122** may be about 1 to about 2 times (e.g., about 1.5) the diameter of the internal bore **103**. The first ring **120** and the second ring **122** may be positioned to allow fluid to flow through a central portion of the first ring **120** and a central portion of the second ring **122**. One or more openings or recesses may be disposed in an outer diameter of the first ring **120** and/or the second ring **122**. The openings may allow for fluid flow between the outer portion of the first ring **120** and/or the second ring **122** and an interior surface of the housing **102** during use as well as to allow fluid to drain out of mixer after use. The fluid flow between the first ring **120** and/or the

6

second ring **122** and the interior surface of the housing **102** may provide additional fluid flow through the rings during use of the mixer **100**.

The first ring **120** may include slots **130** (first ring slots), and the second ring **122** may include slots **132** (second ring slots). The blades **124** may be disposed between the first ring **120** and the second ring **122** due to the proximal ends **129** of the blades **124** being positioned into the slots **130** and the distal ends **131** of the blades **124** being positioned into the slots **132**. The blades **124** may be welded into the slots **130** and **132**. The blades **124** may extend longitudinally along longitudinal axis **133** and also may extend from the slots **130** laterally towards the centers of first ring **120**. This positioning of the blades **124** may allow for contact between a fluid and the blades **124**, as the multiphase fluid flows along the exterior surface **125** of the expansion cone **118** and through and along the blades **124** to allow efficient contact and mixing of the fluid.

The first ring **120** and the second ring **122** may include an outer diameter that may be about the diameter of the internal bore **103**. The first ring slots **130** and the second ring slots **132** may be offset from each other (e.g., offset angle of about 25° to about 45° relative to longitudinal axis **133** of housing **102**), thereby causing the blades **124** to be inclined relative to the longitudinal axis. For example, the blades may collectively include a twist/bend about the longitudinal axis while the individual blades are not individually bent or twisted, as the blades **124** extend longitudinally from the first ring **120** to the second ring **122**. The twist/bend about the longitudinal axis may allow for an efficient mixing of the fluid (e.g., the fluid may flow along the blades **124** defining the twist/bend about the longitudinal axis). That is, the blades **124** may be configured to rotate the fluid passing through them, thereby mixing the fluid. A distance between the apex **126** and the flow-out opening **110** may be between about one quarter and three quarters or about one half of the diameter of internal bore **103** (e.g., 6 inches). A distance from apex **126** to second ring **122** may be between about 1.5 to 2.5 times, or about twice the diameter of internal bore **103** (e.g., 24 inches).

The slots **130** in the first ring **120** can be aligned radially such that the blades **124** are arranged with a radial alignment at the first ring **120**. In other words, the flat sides of the blades **124** can be aligned with planes passing radially outwards from the center of the housing **102** at the first ring **120**. The second ring **122** can contain a corresponding number of slots **132** to hold the second end of the blades **124** extending from the first ring **120**. While the blades **124** can be radially aligned at the first ring **120**, the longitudinal alignment of the blades **124** may be angled with respect to the longitudinal axis of the housing **102** such that the blades **124** are not longitudinally parallel with the longitudinal axis of the housing **102**. Rather, by having straight blades disposed at a non-parallel angle with respect to the longitudinal axis of the housing **102**, the blades **124** are not radially aligned at the second ring **122**. Rather, the blades **124** can be non-radially aligned, or aligned at an angle with respect to the center of the housing **102** at the second ring **122**. The resulting flow path between the first ring **120** and the second ring **122** between the blades **124** can induce a spin or circulation in the fluid flowing through the blades **124**. In this embodiment, the blades **124** are straight but form the collective twist about the longitudinal axis.

As shown in FIGS. 2 and 3, the alignment of the blades **124** in the mixing section can result in an open section defined by an interior surface of each of the blades **124**. The open section can have a frusto-conical shape starting at a

first end of the blades adjacent the expansion cone **118** having a diameter approximately equal to the internal diameter of the housing **102** minus the radial length of two of the blades on either side of the ring and any radial distance contributed by the ring. At the second ring **122**, the open section can have an expanded diameter due to the non-radial alignment of the blades at the second ring **122** (where the interior diameter of the housing and any spacing of the ring are approximately the same at the second ring **122**). Thus, the radial distance of the extent of the blades **124** can decrease from the first ring **120** to the second ring **122**.

A mixing chamber **107** may include a volume within housing **102** from the flow-out opening **110** to the second ring **122**. The mixing chamber **107** may allow for mixing of the multi-phase fluid due to the reduction cone **104** and the expansion cone assembly **106**. A combination of the reduction cone **104** and the expansion cone **118** of the expansion cone assembly **106** may provide an initial mixing and contact between the two phases, and then the blades **124** of the expansion cone assembly **106** may provide a subsequent mixing and contact between the two phases, due to rotation of the fluid, as noted above.

FIG. **4** illustrates the static mixer **100** disposed within a pipe **134**. The flanges **136** may be included on each end of the pipe **134**, where the pipe **134** can be integrated into an existing pipe string and connected to the pipe string via the flanges **136**. As noted above, the static mixer **100** may be utilized as an insert (shown on FIG. **1**) or fabricated within separate pipe **134**, as depicted in FIG. **4**.

FIG. **5** further illustrates optional mixing injection points within the mixer **100**. In some embodiments, various fluids such as specific chemicals or mixtures of chemicals can be injected directly into the mixer at one or more points. As shown in FIG. **5**, the injection points can include the use of one or more tubes or nozzles located upstream, downstream, or within the mixer **100**. In an embodiment, one or more injection points **502**, **504**, or **506** can be used to inject fluids into the stream passing through the mixer. The injection points **502**, **504**, **506** can comprise a tube passing through the housing **102** and providing one or more terminal points at which a fluid can be injected into the fluid stream. As shown an injection point **502** can be disposed upstream of the reduction cone **104**, an injection point **506** can be disposed within the mixing chamber **107**, and/or a mixing point **504** can be disposed downstream of the expansion cone **118**. When the optional fluid injection point **504** is present downstream of the expansion cone **118**, the injection point **504** can inject fluid within the downstream side of the expansion cone **118** and/or at one or more points within the volume enclosed by the blades **124**. While shown as a single tube, each injection point can comprise one or more inlet tubes to provide a desired volume of injected fluid. In addition, each injection point **502**, **504**, **506** can comprise one or more opening to release the injected fluid at a point or over an area or line along the flowpath.

Various fluids can be injected at the one or more injection points **502**, **504**, **506**. For example, fresh water, demulsifiers, surfactants, treatment chemicals, or other such fluids can be injected at the injection points. The injection points **502**, **504**, **506** may then allow for precise treatment of the fluid flowing through the mixer at various stages of mixing. For example, a demulsifier may be injected downstream of the expansion cone **118** in order to first allow a two phase fluid to mix and contact upstream of the expansion cone **118** while then providing the demulsifier once the two phase fluid has mixed to prevent an emulsion from forming in the mixing section as well as downstream of the mixer **100**. In some

embodiments, the one or more injection points **502**, **504**, **506** or an upstream or downstream injection point can be used to inject water (e.g., fresh water, an aqueous mixture, etc.). The ability to inject water may allow the ratio of each phase in a multiphase fluid to be controlled as well as providing an aqueous fluid having the desired properties at particular point along the flowpath.

FIGS. **5** and **6** illustrate a travel path of a multiphase fluid **139** (e.g., a multiphase mixture of oil, salt, and water, wherein salt may be distributed in the oil and the water), as the fluid **139** travels through the static mixer **100**. The fluid **139** may flow into the housing **102** and through the flow-in opening **108**, enter the mixing chamber **107**, contact the apex **126** and flow along the exterior surface **125** of the expansion cone **118** through the first ring **120** and through and along the blades **124**, and exit through the second ring **122**. This travel path may allow for efficient mixing of the fluid **139**, thereby drawing out salt from the oil and transferring the salt into the water.

With reference to FIGS. **1-6**, operation of the static mixer **100** may be described as follows. Water or an aqueous fluid may be introduced into an oil containing stream upstream of the static mixer **100**, thereby allowing a two phase liquid-liquid mixture (e.g., the fluid **139**) to enter the static mixer **100** via the flow-in opening **108**. The fluid **139** may first enter the reduction cone **104** that may cause a velocity of the fluid **139** to increase. As noted above, the reduction cone **104** may be configured to increase a velocity of the fluid **139** passing through it. The fluid may then enter the mixing chamber **107** and contact the apex **126** and the exterior surface **125** of the expansion cone **118** to maintain the increased velocity, while forcing the fluid **139** to flow outwards along the exterior surface **125** of the expansion cone **118**, and through and along the blades **124** and through the second ring **122**, thereafter exiting housing **102**. The combination of the reduction cone **104** and the expansion cone **118** may provide a first portion of the mixing and contact between the two phases, thereby drawing out a portion of salt from the oil and transferring the salt into the water.

As noted above, the blades **124** may be positioned at offset angles with respect to the longitudinal axis **133** of the housing **102**. The offset angles of the blades **124** may cause the fluid **139** to rotate and provide further contact and mixing between the two phases due to centrifugal forces. The blades **124** may provide a second portion of the mixing and contact between the two phases, thereby drawing out a portion of salt from the oil and transferring the salt into the water. The resulting contact may not be sufficient to over-mix the two phases (which may make further separation difficult), but may provide improved contact and mixing between the two phases over other static mixer designs.

In some embodiments, only a portion of the mixer **100** may be present while still achieving contact between the fluids. For example, a mixer **100** may comprise only the reduction cone **104** and the expansion cone **118**, which may be sufficient to provide contact between the phases of the multi-phase fluid **139**. In some embodiments, only the expansion cone **118** and the blades **124** may be present and may provide sufficient mixing to provide contact between the phases of the multi-phase fluid **139**.

The mixer **100** as described herein can be used in a number of environments. In general, the mixer **100** can be used to provide mixing and contacting between multiple phases in a multiphase fluid **139**. Exemplary uses include contacting oil and water phases in a desalting apparatus, contacting immiscible phases in a pipe or pipeline. In

general, the mixer can be used in a variety of locations, and in some embodiments, the mixer 100 can be used as a standalone device or within a pipeline in a subsea pipeline or assembly, on a platform, or as part of an onshore facility. In some embodiments, the mixer 100 can be used in a hydrocarbon production and/or treatment facility.

While described herein in the context of contacting a multi-phase fluid 139 comprising an aqueous phase and an oil phase, the mixer 100 may also be useful in contacting other multi-phase fluid streams to allow for contact between the two phases without creating an emulsion. Suitable examples can include an aqueous phase in contact with an organic phase, two immiscible organic phases, or other multiphase fluids comprising one or more liquid phases such as a molten salt phase, a supercritical fluid phase, and the like. Thus, the present disclosure is not limited to use of the mixer with a desalter.

Having described various devices, systems, and methods, some embodiments can include, but are not limited to:

In a first embodiment, a static mixer for desalting a fluid can include a housing; a reduction cone disposed concentrically within the housing; and an expansion cone disposed concentrically within the housing adjacent to the reduction cone; wherein the static mixer is configured to direct fluid flow through the reduction cone onto the expansion cone, thereby mixing the fluid.

A second embodiment can include the static mixer of the first embodiment, further comprising a plurality of blades disposed within the housing between a first ring and a second ring, wherein the plurality of blades extends from the first ring to the second ring along a longitudinal axis of the housing.

A third embodiment can include the static mixer of the first or second embodiment, wherein the first ring comprises first ring slots, and the second ring comprises second ring slots, wherein the first ring slots are offset from the second ring slots.

A fourth embodiment can include the static mixer of any of the first through third embodiments, wherein a proximal end of each blade is positioned into a first ring slot and a distal end of each blade is positioned into a second ring slot.

A fifth embodiment can include the static mixer of any of the first through fourth embodiments, wherein each first ring slot and each second ring slot, due to an offset, is configured to incline each blade with respect to a longitudinal axis passing through a center of the reduction cone and expansion cone as each blade extends from the first ring to the second ring.

A sixth embodiment can include the static mixer of any of the first through fifth embodiments, wherein the static mixer is also configured to direct flow through the plurality of blades, thereby mixing the fluid.

A seventh embodiment can include the static mixer of any of the first through sixth embodiments, wherein the reduction cone further comprises a grommet positioned at a circumference of the flow-out opening, wherein the grommet is configured to prevent backflow along an exterior surface of the reduction cone.

An eighth embodiment can include the static mixer of any of the first to seventh embodiments, further comprising: one or more fluid injection points, wherein the one or more fluid injection points are configured to provide a fluid pathway from outside of the static mixer to within the housing

In a ninth embodiment, a static mixer for desalting a fluid can include a housing; a reduction cone disposed concentrically within the housing; an expansion cone disposed concentrically within the housing; and a plurality of blades

disposed within the housing; wherein the static mixer is configured to increase a velocity of a fluid with the reduction cone, distribute the fluid with the expansion cone, and rotate the fluid with the plurality of blades, thereby mixing the fluid.

A tenth embodiment can include the static mixer of the ninth embodiment, wherein the reduction cone comprises a flow-in opening and a flow-out opening.

A eleventh embodiment can include the static mixer of the ninth or tenth embodiment, wherein the expansion cone is positioned downstream from the reduction cone.

An twelfth embodiment can include the static mixer of any of the ninth through eleventh embodiments, wherein the plurality of blades are positioned downstream from the expansion cone.

A thirteenth embodiment can include the static mixer of any of the ninth through twelfth embodiments, wherein the plurality of blades comprises straight flat blades of a rectangular shape.

A fourteenth embodiment can include the static mixer of any of the ninth through thirteenth embodiments, wherein each blade is inclined with respect to a longitudinal axis passing through a center of the reduction cone and the expansion cone.

A fifteenth embodiment can include the static mixer of any of the ninth to fourteenth embodiments, further comprising: one or more fluid injection points, wherein the one or more fluid injection points are configured to provide a fluid pathway from outside of the static mixer to within the housing.

A sixteenth embodiment can include the static mixer of the fifteenth embodiment, wherein at least one fluid injection point of the one or more fluid injection points is disposed within at least one of the expansion cone or the plurality of blades.

In a seventeenth embodiment, a static mixer comprises: a housing; an expansion cone disposed concentrically within the housing; and a plurality of blades disposed within the housing; wherein the static mixer is configured to direct fluid flow onto expansion cone and through the plurality of blades.

An eighteenth embodiment can include the static mixer of the seventeenth embodiment, further comprising the fluid disposed within the housing, wherein the fluid comprises a multiphase fluid comprising oil, water, and salt, wherein the salt is distributed in the oil and the water.

A nineteenth embodiment can include the static mixer of the seventeenth or eighteenth embodiment, wherein the plurality of blades are configured to rotate the fluid when the fluid is flowing through the mixer.

A twentieth embodiment can include the static mixer of any of the seventeenth to nineteenth embodiments, wherein the plurality of blades are positioned downstream from the expansion cone.

A twenty first embodiment can include the static mixer of any of the seventeenth to twentieth embodiments, wherein the static mixer is positioned within a pipe.

A twenty second embodiment can include the static mixer of the twenty first embodiment, wherein the pipe is positioned on a production platform.

A twenty third embodiment can include the static mixer of any of the seventeenth to twenty second embodiments, wherein the expansion cone is coupled to the plurality of blades.

In a twenty fourth embodiment, a method for static mixing a fluid comprises: passing the fluid through a reduction cone; increasing a velocity of the fluid as the fluid flow

through the reduction cone; directing the fluid onto an expansion cone downstream of the reduction cone; maintaining an increased velocity with the expansion cone; distributing the fluid over the expansion cone; and mixing the fluid.

A twenty fifth embodiment can include the method of the twenty fourth embodiment, wherein the fluid comprises a multiphase fluid comprising salt, water, and oil, wherein the salt is distributed in the oil and the water.

A twenty sixth embodiment can include the method of the twenty fourth or twenty fifth embodiment, further comprising drawing out the salt from the oil due to the mixing of the fluid with the reduction cone and the expansion cone.

A twenty seventh embodiment can include the method of any of the twenty fourth to twenty sixth embodiments, further comprising transferring the salt into the water due to the mixing of the fluid with the reduction cone and the expansion cone.

A twenty eighth embodiment can include the method of any of the twenty fourth to twenty sixth embodiments, further comprising: passing the fluid through a plurality of blades; and rotating the fluid in response to passing the fluid through the plurality of blades.

A twenty ninth embodiment can include the method of the twenty eighth embodiment, wherein each blade of the plurality of blades is straight.

In a thirtieth embodiment, a method for static mixing of a fluid comprises: passing the fluid through a reduction cone; increasing a velocity of the fluid with the reduction cone; directing the fluid onto an expansion cone; maintaining an increased velocity with the expansion cone; distributing the fluid over the expansion cone; allowing the fluid to flow through a plurality of blades, wherein each blade is straight; rotating the fluid with the plurality of blades; and mixing the fluid.

A thirty first embodiment can include the method of the thirtieth embodiment, wherein the fluid comprises water, salt, and oil, wherein the salt is distributed in the oil and the water.

A thirty second embodiment can include the method of the thirty first embodiment, further comprising: drawing out the salt from the oil due to the mixing of the fluid with the reduction cone and the expansion cone.

A thirty third embodiment can include the method of the thirty first or thirty second embodiment, further comprising: transferring the salt into the water due to the mixing of the fluid with the reduction cone and the expansion cone.

A thirty fourth embodiment can include the method of any of the thirty first to thirty third embodiments, further comprising: drawing out the salt from the oil due to the mixing of the fluid with the plurality of blades.

A thirty fifth embodiment can include the method of any of the thirty first to thirty fourth embodiments, further comprising: transferring the salt into the water due to the mixing of the fluid with the plurality of blades.

A thirty sixth embodiment can include the method of any of the thirtieth to thirty fifth embodiments, further comprising: injecting a fluid composition into the fluid at a point between a first position upstream of the reduction cone and a second point downstream of the plurality of blades.

A thirty seventh embodiment can include the method of the thirty sixth embodiment, wherein the fluid composition comprises a demulsifier.

A thirty eighth embodiment can include the method of the thirty seventh embodiment, wherein the demulsifier is injected within or downstream of the expansion cone.

A thirty ninth embodiment can include the method of any of the thirtieth to thirty eighth embodiments, further comprising: passing the fluid through a subsea pipe, wherein the reduction cone, the expansion cone, and the plurality of blades are disposed within the subsea pipe, and wherein the mixing of the fluid occurs within the subsea pipe.

In a fortieth embodiment, a method for static mixing of a fluid comprises: passing a fluid through an interior of a housing; directing the fluid onto an expansion cone between an exterior surface of the expansion cone and the interior of the housing; distributing the fluid over the expansion cone; allowing the fluid to flow through a plurality of blades, wherein each blade is straight; and rotating the fluid within the housing with the plurality of blades.

A forty first embodiment can include the method of the fortieth embodiment, wherein the fluid comprises water, salt, and oil, wherein the salt is distributed in the oil and the water.

A forty second embodiment can include the method of the forty first embodiment, further comprising drawing out the salt from the oil due to the mixing of the fluid with the plurality of blades.

A forty third embodiment can include the method of the forty first or forty second embodiment, further comprising transferring the salt into the water due to the mixing of the fluid with the plurality of blades.

The following brief definition of terms shall apply throughout the application:

The term “comprising” means including but not limited to, and should be interpreted in the manner it is typically used in the patent context;

The phrases “in one embodiment,” “according to one embodiment,” and the like generally mean that the particular feature, structure, or characteristic following the phrase may be included in at least one embodiment of the present invention, and may be included in more than one embodiment of the present invention (importantly, such phrases do not necessarily refer to the same embodiment);

If the specification describes something as “exemplary” or an “example,” it should be understood that refers to a non-exclusive example;

The terms “about” or “approximately” or the like, when used with a number, may mean that specific number, or alternatively, a range in proximity to the specific number, as understood by persons of skill in the art field; and

If the specification states a component or feature “may,” “can,” “could,” “should,” “would,” “preferably,” “possibly,” “typically,” “optionally,” “for example,” “often,” or “might” (or other such language) be included or have a characteristic, that particular component or feature is not required to be included or to have the characteristic. Such component or feature may be optionally included in some embodiments, or it may be excluded.

While several embodiments have been provided in the present disclosure, it should be understood that the disclosed systems and methods may be embodied in many other specific forms without departing from the spirit or scope of the present disclosure. The present examples are to be considered as illustrative and not restrictive, and the intention is not to be limited to the details given herein. For example, the various elements or components may be combined or integrated in another system or certain features may be omitted or not implemented. The particular naming of the components, capitalization of terms, the attributes, structures, or any other structural aspect is not mandatory or significant, and the mechanisms that implement the disclosure or its features may have different names, formats, or

13

protocols. Also, the particular division of functionality between the various components described herein is merely exemplary, and not mandatory; functions performed by a single system component may instead be performed by multiple components, and functions performed by multiple components instead may be performed by a single component. Finally, it should be noted that the language used in the specification has been principally selected for readability and instructional purposes, and may not have been selected to delineate or circumscribe the subject matter.

Also, techniques, systems, subsystems, and methods described and illustrated in the various embodiments as discrete or separate may be combined or integrated with other systems, modules, techniques, or methods without departing from the scope of the present disclosure. Other items shown or discussed as directly coupled or communicating with each other may be indirectly coupled or communicating through some interface, device, or intermediate component, whether electrically, mechanically, or otherwise. Other examples of changes, substitutions, and alterations are ascertainable by one skilled in the art and could be made without departing from the spirit and scope disclosed herein.

Where numerical ranges or limitations are expressly stated, such express ranges or limitations should be understood to include iterative ranges or limitations of like magnitude falling within the expressly stated ranges or limitations (e.g., from about 1 to about 10 includes, 2, 3, 4, etc.; greater than 0.10 includes 0.11, 0.12, 0.13, etc.). For example, whenever a numerical range with a lower limit, R_l , and an upper limit, R_u , is disclosed, any number falling within the range is specifically disclosed. In particular, the following numbers within the range are specifically disclosed: $R=R_l+k*(R_u-R_l)$, wherein k is a variable ranging from 1 percent to 100 percent with a 1 percent increment, i.e., k is 1 percent, 2 percent, 3 percent, 4 percent, 5 percent, . . . 50 percent, 51 percent, 52 percent, . . . , 95 percent, 96 percent, 97 percent, 98 percent, 99 percent, or 100 percent. Moreover, any numerical range defined by two R numbers as defined in the above is also specifically disclosed. Use of the term "optionally" with respect to any element of a claim means that the element is required, or alternatively, the element is not required, both alternatives being within the scope of the claim. The word "exemplary" is used herein to mean "serving as an example, instance, or illustration." Any implementation described herein as "exemplary" is not necessarily to be construed as preferred or advantageous over other implementations. Use of broader terms such as comprises, includes, and having should be understood to provide support for narrower terms such as consisting of, consisting essentially of, and comprised substantially of. Accordingly, the scope of protection is not limited by the description set out above but is defined by the claims that follow, that scope including all equivalents of the subject matter of the claims. Each and every claim is incorporated as further disclosure into the specification and the claims are embodiment(s) of the present invention.

What is claimed is:

1. A method for static mixing a multiphase fluid, the method comprising:
 passing a fluid through a reduction cone, wherein the fluid comprises a multiphase fluid;
 increasing a velocity of the fluid as the fluid flows through the reduction cone, wherein the fluid has an increased velocity after increasing the velocity of the fluid;
 directing the fluid onto an expansion cone downstream of the reduction cone;

14

maintaining the increased velocity with the expansion cone;
 distributing the fluid over the expansion cone;
 and
 mixing the fluid.

2. The method of claim 1, further comprising:
 allowing the fluid to flow through a plurality of blades downstream of the expansion cone, wherein each blade is straight; and
 rotating the fluid with the plurality of blades.

3. The method of claim 1, wherein the fluid comprises a multiphase fluid comprising salt, water, and oil, wherein the salt is distributed in the oil and the water, wherein the method further comprises:

drawing out the salt from the oil due to the mixing of the fluid.

4. The method of claim 3, further comprising:
 transferring the salt into the water due to the mixing of the fluid with the reduction cone and the expansion cone.

5. The method of claim 1, wherein a plurality of blades are disposed downstream of the expansion cone, and wherein the method further comprises:

injecting a fluid composition into the fluid at a point between a first position upstream of the reduction cone and a second point downstream of the plurality of blades.

6. The method of claim 5, wherein the fluid composition comprises a demulsifier, and wherein the demulsifier is injected within or downstream of the expansion cone.

7. The method of claim 2, further comprising:
 passing the fluid through a subsea pipe, wherein the reduction cone, the expansion cone, and the plurality of blades are disposed within the subsea pipe, and wherein the mixing of the fluid occurs within the subsea pipe.

8. The method of claim 1, wherein the mixing of the fluid occurs within a static mixer, and wherein the static mixer comprises:

a housing;
 the reduction cone disposed concentrically within the housing; and
 the expansion cone disposed concentrically within the housing adjacent to the reduction cone.

9. The method of claim 8, wherein the static mixer further comprises:

a plurality of blades disposed within the housing between a first ring and a second ring, wherein the plurality of blades extends from the first ring to the second ring at a non-parallel angle with respect to a longitudinal axis of the housing.

10. The method of claim 9, wherein the first ring comprises first ring slots, and the second ring comprises second ring slots, wherein the first ring slots are offset from the second ring slots, and wherein each blade of the plurality of blades is inclined with respect to a longitudinal axis passing through a center of the reduction cone and the expansion cone.

11. The method of claim 10, wherein a proximal end of each blade of the plurality of blades is positioned into a first ring slot of the first ring slots and a distal end of each blade is positioned into a second ring slot of the second ring slots.

12. The method of claim 9, wherein the reduction cone comprises a flow-in opening and a flow-out opening, wherein a diameter of the flow-in opening is larger than a diameter of the flow-out opening.

13. The method of claim 12, wherein the reduction cone comprises a grommet positioned at a circumference of the

15

flow-out opening, wherein the grommet is configured to prevent backflow along an exterior surface of the reduction cone.

14. The method of claim **8**, wherein the static mixer further comprises:

one or more fluid injection points, wherein the one or more fluid injection points are configured to provide a fluid pathway from outside of the static mixer to within the housing.

15. The method of claim **1**, wherein the mixing of the fluid occurs within a static mixer, and wherein the static mixer comprises:

a housing;

the reduction cone disposed concentrically within the housing;

the expansion cone disposed concentrically within the housing; and

a plurality of blades disposed within the housing, wherein the expansion cone is disposed between the reduction cone and the plurality of blades in the housing;

16

wherein the expansion cone is configured to distribute the fluid, and wherein the plurality of blades are configured to rotate the fluid.

16. The method of claim **15**, wherein the expansion cone is positioned downstream from the reduction cone.

17. The method of claim **16**, wherein the plurality of blades are positioned downstream from the expansion cone.

18. The method of claim **17**, wherein the plurality of blades comprises straight flat blades of a rectangular shape, and wherein each blade is inclined with respect to a longitudinal axis passing through a center of the reduction cone and the expansion cone.

19. The method of claim **15**, further comprising:

one or more fluid injection points, wherein the one or more fluid injection points are configured to provide a fluid pathway from outside of the static mixer to within the housing.

20. The method of claim **19**, wherein at least one fluid injection point of the one or more fluid injection points is disposed within at least one of the expansion cone or the plurality of blades.

* * * * *