

US010845433B2

(12) **United States Patent**
Werth et al.

(10) **Patent No.:** **US 10,845,433 B2**
(45) **Date of Patent:** ***Nov. 24, 2020**

(54) **MAGNETIC FIELD SENSOR
ARRANGEMENT AND METHOD FOR
PROCESSING A MAGNETIC FIELD SENSOR
OUTPUT SIGNAL**

(58) **Field of Classification Search**
CPC G01R 33/0029; G01R 33/0088; G01R
33/07; G01D 5/2448
See application file for complete search history.

(71) Applicant: **Infineon Technologies AG**, Neubiberg
(DE)

(56) **References Cited**

U.S. PATENT DOCUMENTS

(72) Inventors: **Tobias Werth**, Villach (AT);
Catalina-Petruta Juglan, Bucharest
(RO)

7,492,149 B2 2/2009 Motz et al.
9,500,465 B2 11/2016 Rolew et al.
(Continued)

(73) Assignee: **Infineon Technologies AG** (DE)

FOREIGN PATENT DOCUMENTS

(*) Notice: Subject to any disclaimer, the term of this
patent is extended or adjusted under 35
U.S.C. 154(b) by 0 days.

DE 10223767 A1 12/2003
DE 102010064201 A1 6/2012
(Continued)

This patent is subject to a terminal dis-
claimer.

OTHER PUBLICATIONS

(21) Appl. No.: **16/583,854**

Kusuda, Yoshinori. "Auto Correction Feedback for Ripple Suppres-
sion in a Chopper Amplifier". IEEE Journal of Solid-State Circuits,
vol. 45, No. 8, (2010), pp. 1436-1445.

(22) Filed: **Sep. 26, 2019**

(Continued)

(65) **Prior Publication Data**
US 2020/0025838 A1 Jan. 23, 2020

Primary Examiner — Gregory J Toatley, Jr.

Assistant Examiner — Terence E Stifter, Jr.

(74) *Attorney, Agent, or Firm* — Design IP

Related U.S. Application Data

(63) Continuation of application No. 15/492,577, filed on
Apr. 20, 2017, now Pat. No. 10,466,310.

Foreign Application Priority Data

Apr. 20, 2016 (DE) 10 2016 206 686

(51) **Int. Cl.**
G01R 33/00 (2006.01)
G01R 33/07 (2006.01)
G01D 5/244 (2006.01)

(52) **U.S. Cl.**
CPC **G01R 33/0029** (2013.01); **G01R 33/0041**
(2013.01); **G01R 33/0088** (2013.01); **G01R**
33/07 (2013.01); **G01D 5/2448** (2013.01)

(57) **ABSTRACT**

A magnetic field sensor arrangement includes a magnetic
field sensor element configured to provide a sensor output
signal responsive to a magnetic field, wherein the sensor
output signal is representative of a magnetic field amplitude;
a processing module configured to provide a processed
sensor output signal representative of the sensor output
signal; a switching level calculation module configured to
calculate a switching level, (1) during a power up mode,
based on a default switching level, and (2) during a running
mode, based on the processed sensor output signal; a com-
parator module configured to compare the processed sensor
output signal with the switching level, and to provide a
comparator output signal based on the comparison; and a

(Continued)

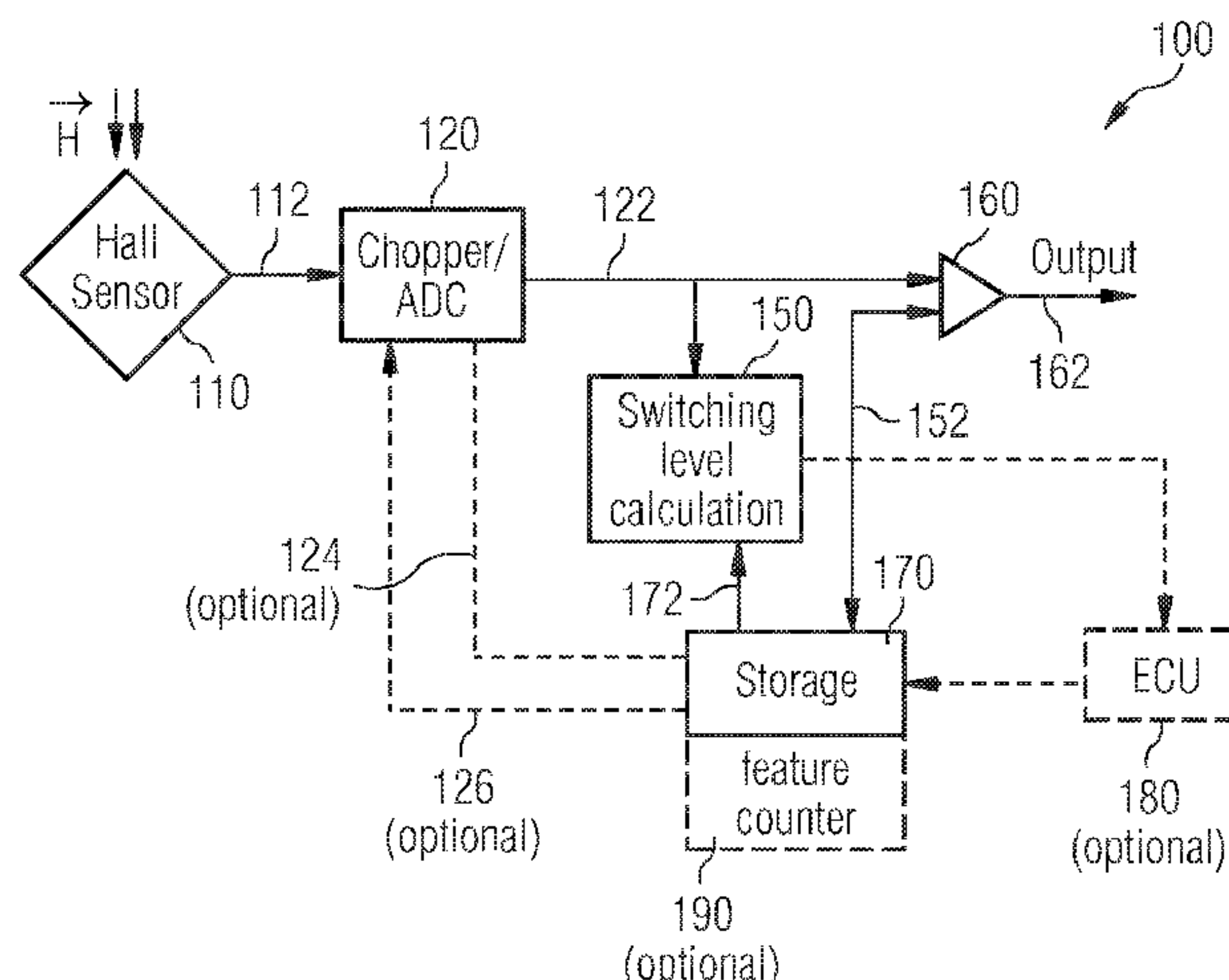

storage module configured to store the default switching level, provide the default switching level during the power up mode, and update the default switching level during the running mode.

25 Claims, 5 Drawing Sheets

(56)

References Cited

U.S. PATENT DOCUMENTS

10,102,992 B2 10/2018 Werth et al.
2003/0225539 A1 12/2003 Motz et al.
2006/0119348 A1* 6/2006 Blossfeld F02D 41/009
324/166
2013/0177040 A1* 7/2013 Foletto G01D 5/142
374/142
2014/0019084 A1* 1/2014 Rolew G01D 5/145
702/150
2014/0077873 A1* 3/2014 Motz H03F 3/387
330/9

2014/0222364 A1 8/2014 Foletto et al.
2014/0266176 A1* 9/2014 Fernandez G01R 1/44
324/244
2015/0061656 A1* 3/2015 Fernandez G01B 7/003
324/207.25
2015/0243461 A1 8/2015 Werth et al.

FOREIGN PATENT DOCUMENTS

DE 102010064203 A1 6/2012
DE 102015102673 A1 8/2015

OTHER PUBLICATIONS

Motz, Mario, et al. "A Chopped Hall Sensor With Small Jitter and Programmable True Power-On Function". IEEE Journal of Solid-State Circuits, vol. 40, No. 7, (2005), pp. 1533-1540.
Allegro MicroSystems, Inc. "Self-Calibrating TPOS Speed Sensor IC Optimized for Automotive Cam Sensing Application". Worcester, Mass., (2013) pp. 1-13.

* cited by examiner

FIG 1

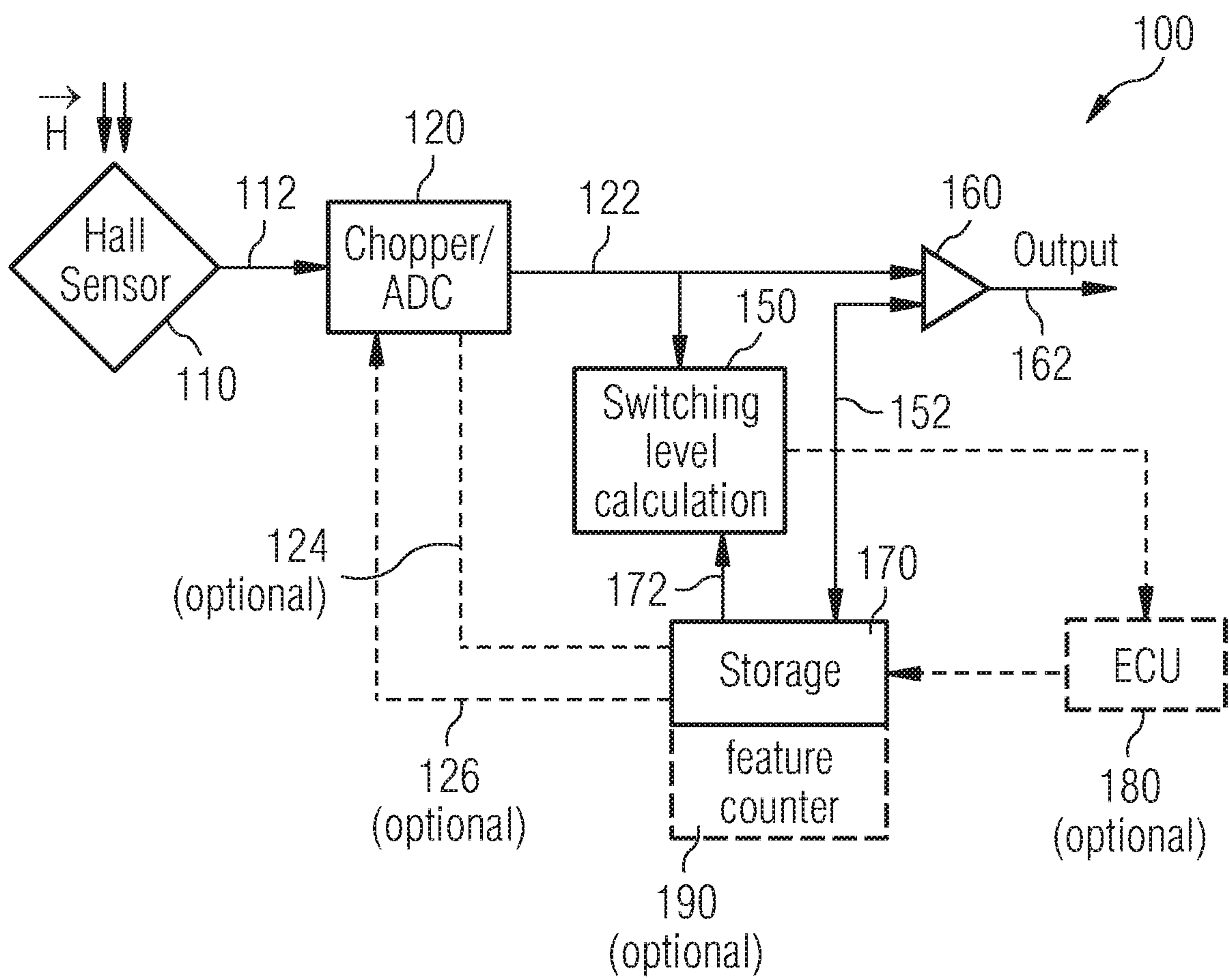

FIG 2

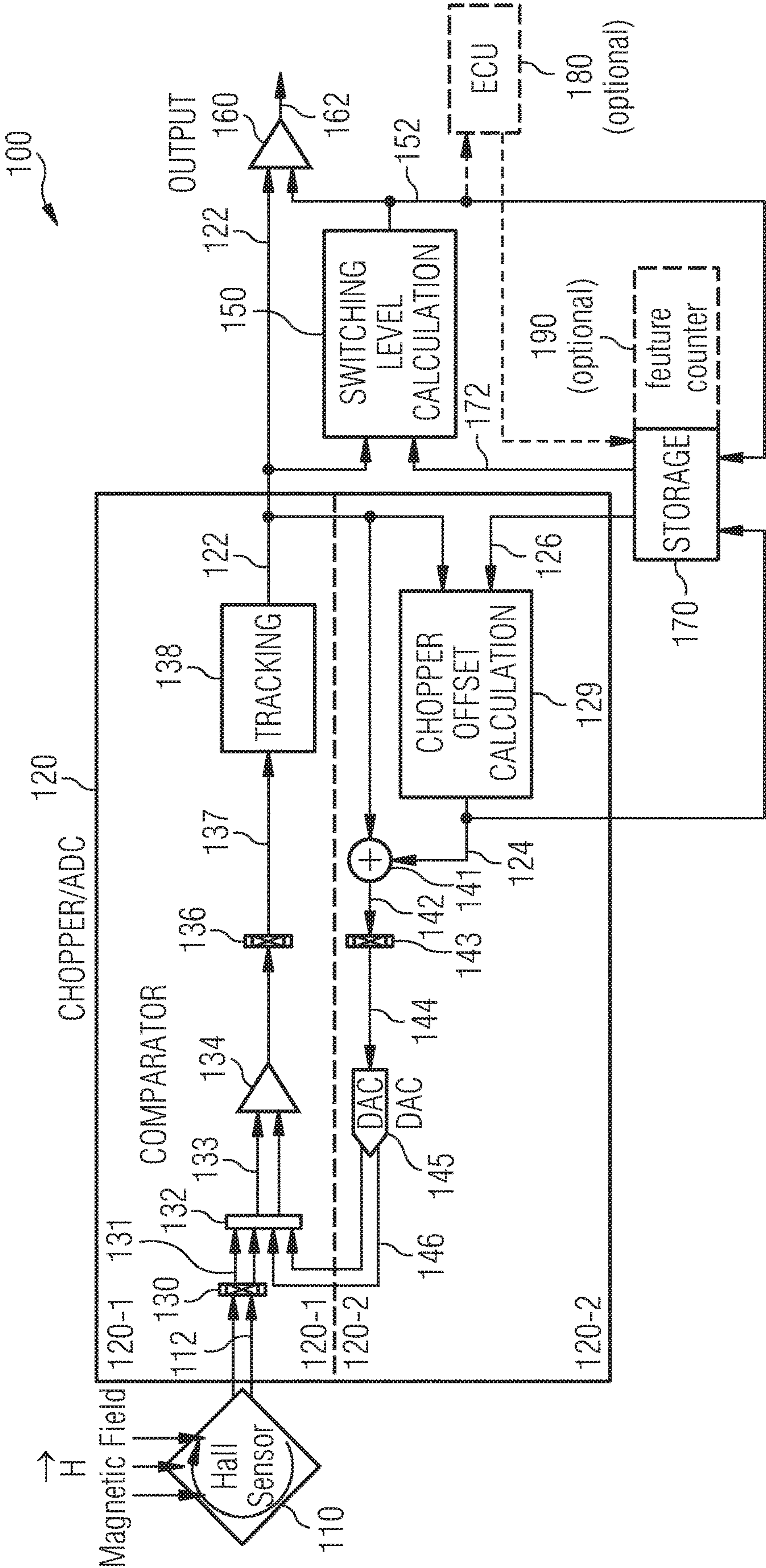

FIG 3A

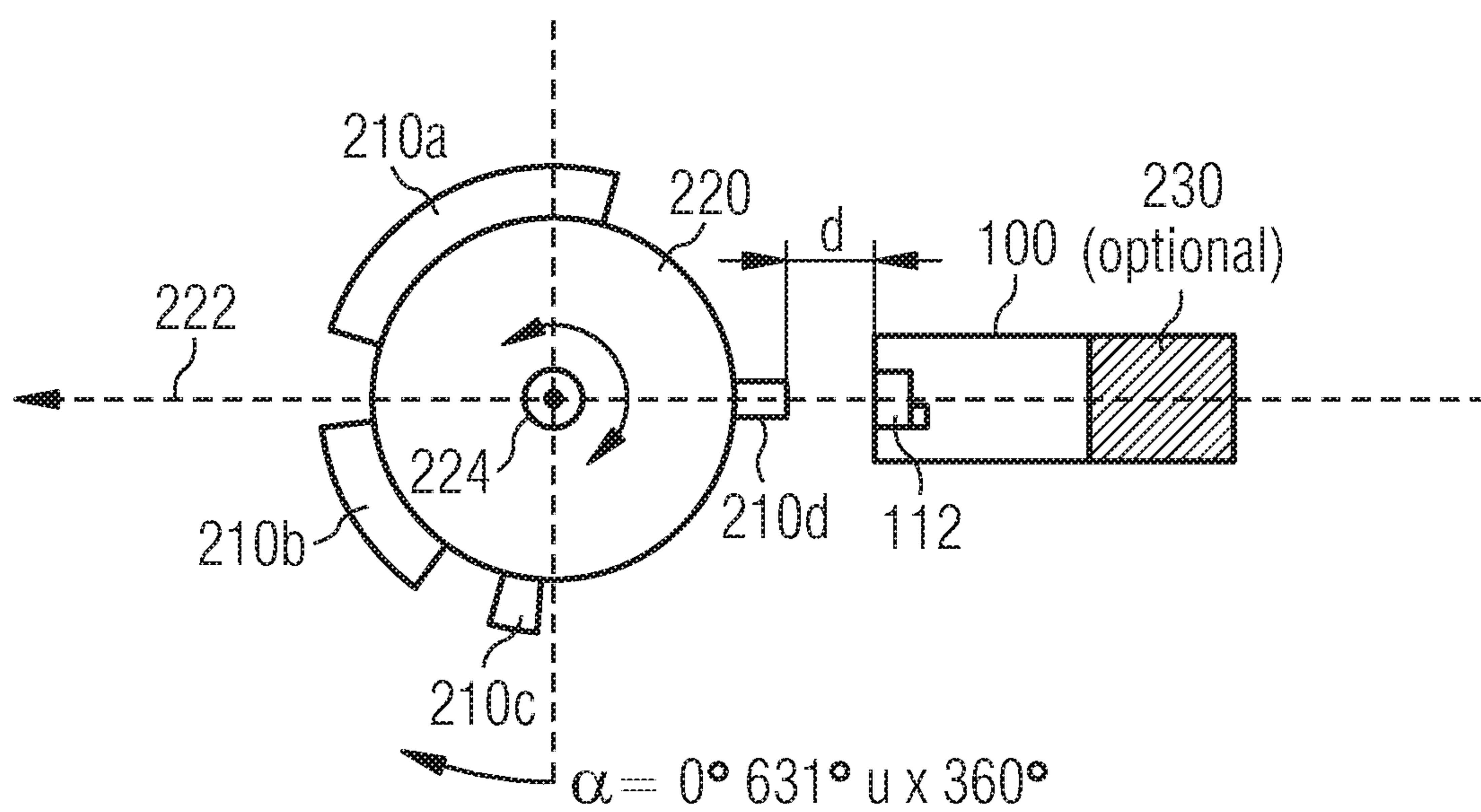

FIG 3B

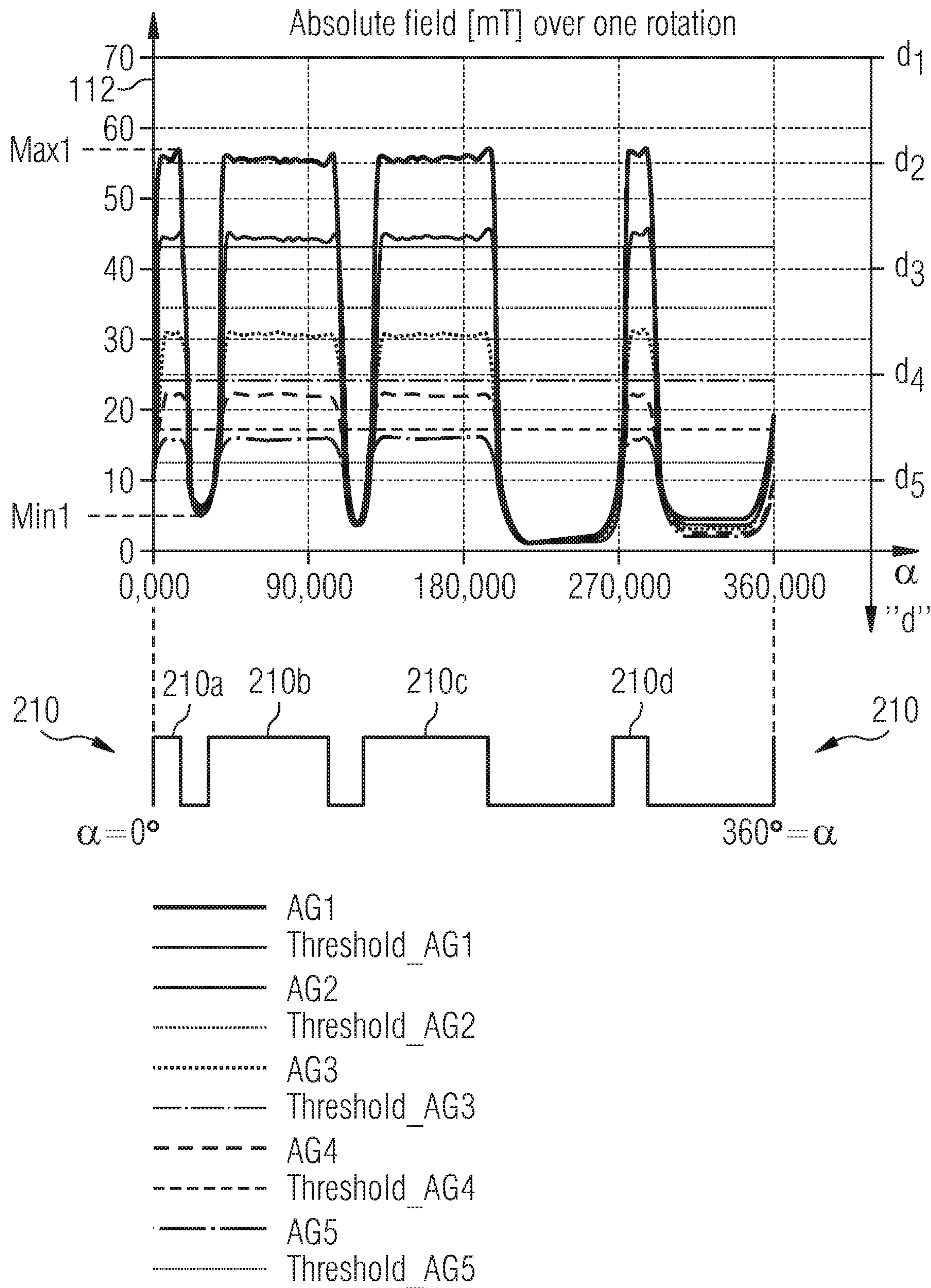
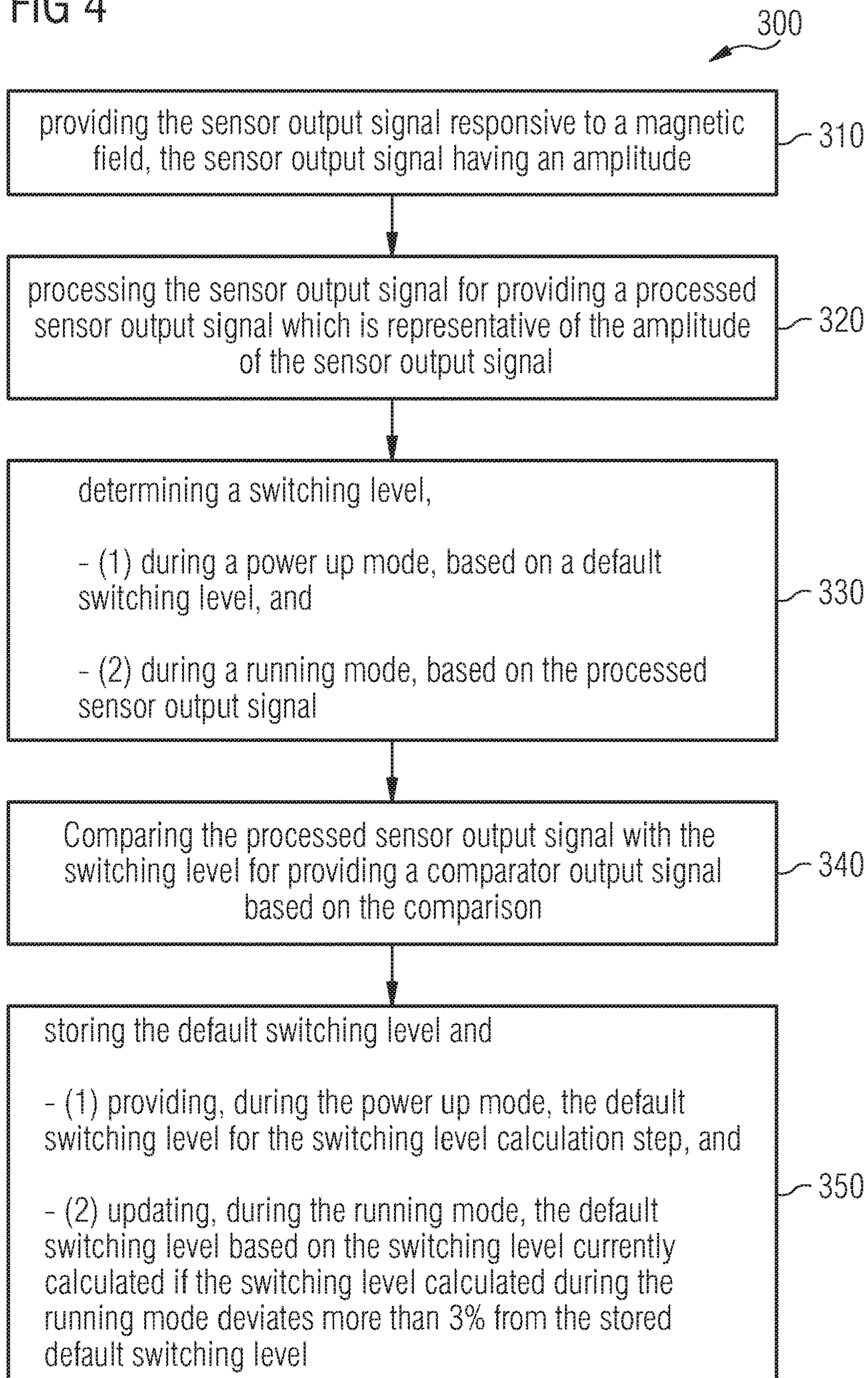

FIG 4



1

MAGNETIC FIELD SENSOR ARRANGEMENT AND METHOD FOR PROCESSING A MAGNETIC FIELD SENSOR OUTPUT SIGNAL

CROSS-REFERENCE TO RELATED APPLICATIONS

This application is a continuation of U.S. patent application Ser. No. 15/492,577, filed Apr. 20, 2017, which claims the benefit of German Patent Application No. 10 2016 206 686.2 filed Apr. 20, 2016, which are incorporated by reference as if fully set forth.

FIELD

Embodiments relate to a magnetic field sensor arrangement and a method for processing a magnetic field sensor output signal.

BACKGROUND

In many sensors, a certain time is required after a sensor system has been taken into operation until the control system acts and the measurement signal relatively accurately reproduces the quantity to be measured. In sensor systems, e.g., magnetic field sensor arrangement, for detecting the position of mechanical elements, such as for example a Hall sensor for camshaft configurations, it is important, after the operating voltage has been switched on, to detect the position of a mechanical element in order to achieve accurate measurements. In the case of a Hall sensor for camshaft configurations, for example, the position of a camshaft should be detected as accurately as possible after the operating voltage has been switched on, i.e. whether it is a tooth gap (notch) or a tooth of the target wheel which is facing the sensor.

Moreover, in order to compensate for offset components which may result from fluctuating influences, e.g., from unstable mechanical stress voltages of the sensor for temperature dependent circuit parameters, chopper principles may be applied. In particular, the chopper principles provide for a so called true power on (TPO) function of the sensor. A TPO function is understood to be the precise measuring operation immediately after the operating voltage of a sensor system has been switched on, which is of importance, for example, for the precise detection of the position of an idle mechanical element, such as a target wheel (tooth wheel). Chopper principles are suitable for a TPO function since they essentially make it possible to eliminate offset components, which impair the measuring accuracy, from the sensor signal shortly after the operating voltage of a sensor system has been switched on.

SUMMARY

Embodiments relate to a magnetic field sensor arrangement and a method for processing a magnetic field sensor output signal. Some embodiments relate to an auto-TPO-nonvolatile storage of calibration value(s) for cam sensors.

An embodiment provides a magnetic field sensor arrangement comprising: a magnetic field sensor element configured to provide a sensor output signal responsive to a magnetic field, wherein the sensor output signal is representative of a magnetic field amplitude; a processing module configured to process the sensor output signal and to provide a processed sensor output signal which is representative of the sensor output signal; switching level calculation module

2

configured to determine/calculating a switching level, (1) during a power up mode, based on a default switching level, and (2) during a running mode, based on the processed sensor output signal; a comparator module configured to compare the processed sensor output signal with the switching level, and to provide a comparator output signal based on the comparison; and a storage module configured to store the default switching level and further configured (1) to provide, during the power up mode, the default switching level to the switching level calculation module, and (2) to update, during the running mode, the default switching level based on the switching level currently calculated by the switching level calculation module, if a difference between the switching level calculated during the running mode and the stored default switching level is higher than a predetermined percentage of the magnetic field amplitude.

According to a further embodiment, the amplitude of the magnetic field is influenced by a target wheel, wherein the default switching level is only updated during the running mode if the target wheel has reached a predetermined rotational speed which is, for example, higher than at least 100 rpm (rpm=revolutions per minute).

A further embodiment provides a method for processing a magnetic field sensor output signal, comprising: providing the sensor output signal responsive to a magnetic field, wherein the sensor output signal is representative of a magnetic field amplitude; processing the sensor output signal for providing a processed sensor output signal which is representative of the sensor output signal; determining/calculating a switching level, (1) during a power up mode, based on a default switching level, and (2) during a running mode, based on the processed sensor output signal; comparing the processed sensor output signal with the default switching level for providing a comparator output signal based on the comparison; and storing the default switching level and providing, during the power up mode, the default switching level for the switching level calculation step, and (2) updating, during the running mode, the default switching level based on the switching level currently calculated if a difference between the switching level calculated during the running mode and the stored default switching level is higher than a predetermined percentage of the magnetic field amplitude.

Thus, the present concept in form of the magnetic field sensor arrangement and the method for processing a magnetic field sensor output signal provide for an improved detection of the phase accuracy of the first switch edges (based on a sensed magnetic field) after power-on of a magnetic sensor, e.g., a mono-cell magnetic cam sensor, when the sensor is mounted in the operating place, e.g., in a vehicle or car. Moreover, the calibrated switching level are stored/updated when the criteria of frequency and, for example, of deviation are met. Additionally, the chopper stores the ripple feedback for a faster startup of the feedback loop.

To be more specific, in accordance with the present concept on the basis the functionality of the magnetic field sensor arrangement and the method for processing a magnetic field sensor output signal, respectively, an updated or calibrated switching level is stored/updated as the (new) default switching level based on the currently calculated switching level (or comparator threshold) when specific criteria of deviation between the default switching level and the currently calculated switching level are met. Moreover, the frequency or rotational speed of the monitored camshaft may be considered as further criterion for storing/updating the default switching level based on the currently calculated

switching level (threshold). To achieve a sufficient accuracy after power on, the sensor arrangement stores the new default switching level, i.e. the newly calibrated switching level, which forms the default switching level during normal operation mode, if the currently stored switching level deviates more than 3% (e.g., more than 5% or 10%) from the ideal (i.e. the currently stored default) switching level compared to the detected peak-to-peak amplitude of the rendered or processed sensor output signal. Moreover, the calibrated switching level may optionally be stored/updated during the running mode only if the target wheel has a higher rotational speed than at least 100 rpm. Updating the default switching level only if the target wheel has achieved a minimum rotational speed is conducted to suppress the possibility to store wrong calibration values (default switching levels) generated by a high target wheel vibration (as the higher the rotational speed of the target wheel is the lower the effect to the calculated switching level is).

The number of self-programming operations (updates of the default switching level) can be stored incrementally and can be limited to a maximum number of, e.g., 10. Additionally, the chopper circuit may store the ripple feedback for a faster startup of the feedback of the feedback loop. To be more specific, as the chopper offset is stored, a more stable and faster restart of the ripple feedback suppression may be achieved.

Further, a “watchdog” (i.e. a device/circuitry that detects faults and initiates corrective actions) for a small signal detection may be implemented to recover for the case that at small signals after remount at a high air gap the sensor does not switch anymore. This may occur when the complete processed sensor signal is below the default switching level. At a wrong/missing switching detection, a fallback TPO implementation can be activated. Another option may be to activate the calibration storage by a digital command applied with the supply modulation when the sensor is mounted.

Furthermore, the number of teeth of the target wheel can also be learned at the first power on. This makes the device more universal and the customer does not program anything. Alternatively, a fixed number of, e.g., 12, teeth can be assumed as this covers target wheels with 1, 2, 3, 4, 6 and 12 teeth which are the most common.

BRIEF DESCRIPTION OF THE DRAWINGS

Various embodiments are described herein making reference to the appended drawings and figures.

FIG. 1 shows a schematic block diagram illustrating a magnetic field sensor arrangement according to one or more embodiments;

FIG. 2 shows a schematic block diagram illustrating a magnetic field sensor arrangement according to one or more embodiments;

FIG. 3A shows schematic circuit diagram of a magnetic field sensor arrangement according to one or more embodiments;

FIG. 3B shows an example graph showing different example sensor output signals responsive to a magnetic field influenced by a target wheel having four teeth according to one or more embodiments; and

FIG. 4 shows a flow diagram of a method for processing a magnetic field sensor output signal according to a further embodiment.

DETAILED DESCRIPTION

Before discussing the embodiments in further detail using the drawings and figures, it is pointed out that in the figures

and the specification identical elements and elements having the same functionality and/or same technical or physical effect are usually provided with the same reference number or identified with the same name/term, so that the description of these elements and of the functionality thereof as illustrated in the different embodiments are mutually exchangeable and may be applied to one another in the different embodiments.

In the following description, embodiments are discussed in detail, however, it should be appreciated that the different embodiments provide many applicable concepts that can be embodied in a wide variety of magnetic field sensor arrangements. The specific embodiments discussed are merely illustrative of specific ways to make and use the present concept, and do not limit the scope of the claims. In the following description of embodiments, the same or similar elements having the same function have associated therewith the same reference signs or the same name/term, and a description of such elements will not be repeated for every embodiment. Moreover, features of the different embodiments described hereinafter may be combined with each other, unless specifically noted otherwise.

FIG. 1 shows a schematic block diagram illustrating a magnetic field sensor arrangement **100** according to an embodiment. The magnetic field sensor arrangement **100** is configured to be operated in at least two different modes or operation modes, wherein a first or initial operation mode after power up will be referred to as “power up mode” or as “initial mode” (e.g., true power on state (TPOS)). The operation following the initialization will be referred to as “running mode”, i.e. a normal operation with a running target wheel. In this connection, it is pointed to the fact that further “intermediate operation modes” between the power up mode and the running mode may be provided for providing a smooth transition between the initial power up mode and the running mode (normal operation mode).

The magnetic field sensor arrangement **100** comprises a magnetic field sensor element **110** which is configured to provide a sensor output signal **112** responsive to a (external) magnetic field \vec{H} , the sensor output signal **112** having an amplitude based on the strength of the magnetic field component to which the magnetic field sensor element is responsive and which passes through the magnetic field sensor element **110**. The sensor output signal **112** is illustrative or representative of the magnetic field amplitude and/or magnetic field absolute value, but may also contain overlaid signal path offset ripple. Thus, the sensor output signal **112** may provide an analog representation of the (sensed) magnetic field amplitude. The magnetic field amplitude may be the peak-to-peak amplitude of the sensed (absolute) magnetic field or an amplitude signal derived therefrom. Thus, the peak-to-peak amplitude is the change between peak (highest amplitude value) and trough (lowest amplitude value). Thus, the magnetic field amplitude is computed as the difference between these maxima and minima of the magnetic field. Thus, the sensor arrangement **100** is able to follow the variations of the magnetic field and is able to detect local minima and local maxima value.

The magnetic field sensor element **110** may comprise, but it is not limited to, a Hall effect element, a magneto-resistance element, or a magneto-transistor. A Hall effect element may comprise, for example, a planar Hall element, a vertical Hall element or a circular Hall element. Magneto-resistive (XMR) sensor elements may comprise any magneto-resistive structures such as AMR (anisotropic magneto-resistance) structures, GMR (giant magneto-resistance)

5

structures or TMR (tunnel magneto-resistance) structures or magnetic tunnel junction (MTJ) structures. To summarize, the term “magnetic field sensor element” is used to describe a variety of electronic elements that can sense a magnetic field for a magnetic field component. Thus, the magnetic field sensor element may be suited for camshaft applications, so that its basic function may be to map either a tooth or a notch into a unique electrical output state, i.e. an amplitude or an amplitude information.

The magnetic field sensor arrangement further comprises a processing module 120 which is configured to receive and process the sensor output signal 112, and further to provide a processed sensor output signal 122 which is representative of the sensor output signal 112. The processed sensor output signal 122 is an amplified and/or digitized (digital) representation of the (e.g., analog) sensor output signal 112. To be more specific, the sensor output signal 112 is representative of the magnetic field amplitude and/or magnetic field absolute value, but may also contain overlaid signal path offset ripple, whereas the processed sensor output signal 122 maintains or provides the magnetic field amplitude and offset information, but the signal path offset ripple component is reduced. Thus, the processed sensor output signal 122 may provide a digital representation of the magnetic field amplitude.

As shown in FIG. 1, the processed sensor output signal 122 is provided to a switching level calculation module 150 and to a comparator module 160. The switching level calculation module is configured to calculate a switching level 152 (e.g., in the form of a switching level signal 152) based on the (sensed) magnetic field amplitude, and to provide the currently calculated switching level 152 to the comparator module 160 and to a storage module 170. During the power up mode (TPOS) the switching level calculation module 150 is configured to calculate the current switching level based on a default switching level 172 provided (e.g., as a default switching level signal 172) by the storage module 170 to the switching level calculation module 150. The switching level calculation module 150 is further configured to calculate the switching level 152 during the running mode (normal operation mode of the magnetic field sensor arrangement 100) based on the processed sensor output signal 122.

The comparator module 160 which receives the processed signal output signal 122 as a first input signal and the switching level 152 as a second input signal is configured to compare the processed sensor output signal 122 with the default switching level 152, and to provide a comparator output signal 162 (as the output signal of the sensor arrangement 100) based on the comparison between the first and second input signals 122 and 152. The comparator output signal 162 may form the output signal of the magnetic field sensor arrangement 100. The comparator module 160 can be configured to provide a comparison result (e.g., as the comparator output signal 162) according to a switching algorithm that includes a hysteresis concept. A visible or hidden hysteresis concept can be applied. The hidden hysteresis concept can be also half hidden, wherein the sensor continues to switch even if one of the hidden thresholds is not crossed.

As already indicated above, the storage module 170 is configured to store the default switching level and is further configured (1) to provide, during the power up mode, the default switching level 172 to the switching level calculation module 150, and (2) to update, during the running mode, the default switching level 172 based on the switching level 152 currently calculated by the switching level calculation mod-

6

ule 150, if a relative difference between the switching level calculated during the running mode and the stored default switching level 172 is larger than 3% (e.g., larger than 5% or 10%), i.e. if a difference between the switching level 152 calculated during the running mode and the stored default switching level 172 is higher than 3% of the magnetic field amplitude.

To be more specific, during the power up mode (initial mode) the magnetic field amplitude information is provided in the form of the processed (e.g., chopped and/or amplified) sensor output signal 122. The threshold information comes during the power up mode as the default switching level 172 from the storage module 170 which may be for example implemented as a nonvolatile PROM-register (PROM=programmable read-only memory) that may be programmed only a limited number of times. The magnetic signal information 122 is compared by means of the comparator module 160 against the default switching level (default threshold) 172, wherein the output state 162 (the comparator output signal 162) is set correspondingly. Some hysteresis may be introduced by the comparator module 160 in order to avoid false switching due to noise in the processed sensor output signal 122.

Furthermore, the switching level calculation module 150 searches for a minimum value (e.g., caused by a notch of a target wheel) and a maximum value (e.g., caused by a tooth of the target wheel) in the processed sensor output signal 122. Once the switching level calculation module 150 has found a pair of min-max values (a peak-to-peak amplitude) the switching level calculation module 150 calculates an associated switching level. After a certain number of switching events, e.g., based on at least one revolution of the target wheel, the accuracy of the calculated switching level 152 is considered to be sufficiently high so that the operation mode of the magnetic field sensor arrangement 100 is switched from the power up mode to the running mode.

In order to provide a high accuracy of the comparator output signal 162 (e.g., preferably immediately) after power on, the storage module 170 is configured to update, during the running mode, the default switching level 172 which is currently stored in the storage module 170 on the basis of the “new” switching level 152 currently calculated by the switching level calculation module 150, if the switching level 152 calculated during the running mode deviates more than 3%, e.g., more than 5% or 10%, (when compared to the currently detected peak-to-peak amplitude) from the currently stored default switching level (or ideal switching level) 172, i.e. from the default switching level which has been provided during the preceding power up mode from the storage module 170 to the switching level calculation module 150.

The magnetic field to which the magnetic field sensor element responds and on the basis thereof provides the sensor output signal 112 may be influenced by a target wheel. The storage module 170 is further configured to update the default switching level during the running mode, only if the target wheel has a higher rotational speed than at least 100 rpm (e.g., 200, or 400 rpm). Thus, the storage module 170 is further configured to update the default switching level during the running mode, only if the target wheel has reached a predetermined rotational speed which is, for example, higher than at least 100 rpm.

To be more specific, the default (calibrated) switching level 172 is only updated and stored if a rotational speed of at least 100 rpm of the target wheel is detected. The updating of the default switching level 172 only during the running mode and when reaching a predetermined rotational speed is

conducted to suppress the possibility to store wrong calibration values generated by target wheel vibration(s), as possible target mean vibrations have a less negative effect on the switching level calculation with an increasing rotational speed of the target wheel. Also, storing/updating (the default switching level **172**) at a higher rotational speed reduces the risk of storing during engine start-stop when the tooth-notch information in the magnetic signal may be corrupted.

The storage module **170** is further configured to conduct only a number of incremental update operations of the default switching level, which is smaller than a preset number **N**, wherein **N** is equal or smaller than 20 (or 15 or 10, for example). Thus, the number of self-programming of the storage module **170** can be stored incrementally and can be limited to a maximal number of, e.g., 20, 15 or 10 etc. A warning signal may be output or a flag may be set by the storage module **170**, if the preset number **N** of update operations is achieved or exceeded. The warning signal may indicate a possible malfunction of the magnetic field sensor arrangement **100**.

The processing module **120** of the magnetic field sensor arrangement **100** may comprise a chopper circuit (not explicitly shown in FIG. **1**) with a chopper offset calculation module in a chopper feedback loop, wherein the chopper-offset calculation module is configured (1) to provide, during the running mode, a correction signal, which is based on an offset signal/component in the processed sensor output signal **122**, and (2) to feed the correction signal into the chopper feedback loop for at least partially suppressing the offset signal/component in the processed sensor output signal **122**.

The storage module **170** may be further optionally configured to store a correction value based on the correction signal **124** and to provide, during the next power up mode(s), the stored correction value **126** to the chopper-offset-calculation module of the processing module **122**. The chopper-offset-calculation module may be further optionally configured to use the stored correction value **126** as a starting value for the correction signal during the next power up mode(s). The chopper-offset-calculation module may be further configured to feed the correction signal **124** into the chopper feedback loop for a ripple feedback suppression in the processed sensor signal **122**. To be more specific, storing the chopper offset (as correction value) in the storage module **170** and providing the stored chopper offset during the (next) power up mode allows for a faster stabilization at a restart of the ripple feedback suppression of the chopper circuit of the processing module **122**.

The storage module **170** may be configured to store the switching level as calculated by the switching level calculation module **150** during the (first) running mode as the (first) default switching level.

The magnetic field sensor arrangement **100** may further optionally comprise an ECU (electronic control unit) **180**, wherein the ECU **180** may instruct the storage module **170** to update, during the running mode, the default switching level **172** based on the switching level **152** calculated by the switching level calculation module **150**. The (optional) ECU **180** may be configured to instruct the storage module **170** during the first power up mode to update the default switching level **172** based on the switching level **152** calculated by the switching level calculation module **150** to the subsequent running mode. Based on this approach, mechanical tolerances with respect to a distance between the magnetic field sensor arrangement **100** and especially the magnetic field sensor element **110** to the target wheel (not shown in FIG. **1**) can be considered, e.g., after installation of the magnetic field sensor arrangement **110** into its operation site.

The optional ECU **180** can also give a trigger command to the storage module **170** without the ECU **180** necessarily knowing the switching level **152** to be programmed as default switching level. The trigger command can be given by the ECU **180** before a programming voltage which might be needed by the storage module **170** is applied externally. Thus, the ECU **180** may be configured to instruct the storage module **170** to update the default switching level **172** when an external programming voltage is applied.

Alternatively, the programming voltage might be provided by internal circuitry, e.g., a charge pump (not shown in FIG. **1**), in the device **100**. Thus, the ECU **180** may be configured to instruct the storage module **170** to update the default switching level **172** when external conditions are considered safe for programming to be done based on an internal programming voltage coming from a charge pump.

The processing module **120** may further optionally comprise a tracking ADC (ADC=analog-digital-converter) which is configured to provide a digital representation in the form of the processed sensor output signal **122** of the sensor output signal **112**, i.e. of the magnetic field amplitude. As indicated above, the magnetic field sensor element **110** may comprise a Hall sensor element, however any sensor elements responsive to a magnetic field component can be used.

Furthermore, the switching level calculation module **150** may be configured to determine a number of teeth or notches e.g., within a range of 1 to 12 (but not limited to 12) of the target wheel during the running mode and to store this information in the storage module **170**.

The storage module **170** can be configured to store an individual switching level **152** for each feature, e.g., tooth, notch or edge, of the target wheel, and to provide the (different) individual switching levels to the switching level calculation module **150** so that the switching level calculation module **150** may be configured to calculate/determine the switching level **152** based on the individual default switching levels for each feature of the target wheel.

The magnetic field sensor arrangement **100** may further optionally comprise a feature counter **190** for determining a current position of the target wheel. A feature of the target wheel may be a tooth, a notch or an edge at the target wheel, wherein the optional feature counter **190** may determine the current position of the target wheel based on the correlation between stored individual switching level and calculated individual switching level.

The switching level calculation module **150** may be further configured to calculate at start up an individual switching level (threshold) of the current feature and to compare the currently calculated individual switching level of the current feature with the stored individual default switching levels (thresholds) in order to match the content of the feature counter **190** with the current position of the target wheel.

Thus, the feature counter **190** may receive information from the switching level calculation module **150** regarding events of detection of minimum and maximum values.

In case, the feature counter **190** is configured to count the teeth on a target wheel, a register (not shown in FIG. **1**) is incremented on each detection of a new maximum and the register is reset when the complete target wheel rotation has finished according to a programmed number of teeth on the target wheel. Alternatively, the feature counter **190** can increment a register at each maximum detection event and each minimum detection event. Alternatively, the feature counter **190** can receive information from the comparator module **160** regarding output switching events. The feature counter **190** can be configured to increment a register each

time a switching event is observed in the comparator module by associating a switching event with a magnetic edge.

The reset of the register in the feature counter can be configured to occur at the end of each target wheel rotation. The feature counter **190** may determine the rotational speed of the target wheel. Alternatively, the feature counter **190** may provide information for an rpm counter (not shown in FIG. **1**) which determines the rotational speed of the target wheel.

In case the different, individual switching levels are used on each feature of the target wheel, the storage module **170** may be further configured to store all default switching levels, i.e. the respective default switching levels for each feature, e.g., tooth, edge or notch, and may be further configured (1) to provide, during the power up mode, the default switching levels **170** to the switching level calculation module **150**, and (2) to update, during the running mode, the default individual switching levels **172** based on the switching level currently calculated by the switching level calculation module **150**, if a difference between the switching level currently calculated during the running mode and the stored default switching level for the (determined) feature of the target wheel is higher than 3% of the magnetic field amplitude (in the sensor output signal). The storage module **170** may be further configured to update the stored default switching level only after a defined number of target wheel rotations, e.g., of at least 10, 100 or 500 rotations, in order to prevent a writing of wrong values in functional testing scenarios. Thus, the storage module **170** may be configured to update of the stored default switching level **172** only when the calculated switching level **152** has remained (essentially) unchanged for a defined number of target wheel rotations. Furthermore, the storage module **170** may be configured to provide a flag or a programmed validity field in the storage unit **170** which indicates if the update of the default switching level (threshold) in the storage module **170** occurred in a "safe supply condition".

When the self-triggered programming occurs in a non-controlled environment (e.g., in field programming inside the engine) it is possible that the engine is stopped and the device is powered down before the programming procedure is finished. It is also possible that a short voltage drop occurs on the supply line during programming procedure even if the engine is not stopped (micro-break). In case supply is lost during programming procedure, the programmed value could be corrupted. In order to avoid using corrupted data as valid information, the data is stored twice and a stored validity field is associated to each instance of the stored data.

In order to ensure that the entire programming procedure occurred in "safe supply conditions" (without supply interruptions) the programming procedure may contain the following steps:

The validity field for the first instance of stored data is programmed as invalid.

The first instance of the storage data is programmed with the new value.

The validity field for the first instance of stored data is programmed as valid. The validity field for the second instance of stored data is programmed as invalid.

The second instance of the storage data is programmed with the new value.

The validity field for the second instance of stored data is programmed as valid.

In case a supply interruption occurs during programming, the two validity fields would contain different information. In order to improve robustness, the validity field can be considered programmed valid when it contains a pattern for

which the probability in case of interrupted programming is reduced. When the device is powered up it uses the instance of the programmed data for which the validity field is programmed as valid.

The storage module **170** may be further configured (during an update of the default switching level) to move the old or discarded default switching level (default threshold value) to a "different" (dedicated) location of the storage module **170** allowing to provide a history or table of the default switching level updates. Thus, the flags or programmed validity fields in the storage module **170** may indicate which of multiple instances of stored default switching level **172** in the storage module **170** can be used as default switching level at start-up.

The storage module **170** can be further configured to receive a temperature information for the junction temperature of the storage device **170** and to allow programming only within a temperature range that is considered safe for the storage device **170**. A safe temperature range may depend on the storage device **170**, as for some EEPROMs programming is not guaranteed at temperatures above 150 C or below 0 C, for example. Thus, the storage module **170** may be configured to update of the stored default switching level **172** only when the measured temperature is considered safe for the programming of the storage device.

The storage module **170** can be further configured to only allow programming of the default switching level **172** when the currently calculated switching level **152** has been stable for multiple consecutive target wheel rotations (for example, at least 2, 4, 6, 8 . . . rotations). This ensures robustness against programming of a wrong default switching level **172** due to a disturbance on the processed sensor output signal **122**. This disturbance can be caused for example by an EMC event (EMC=Electromagnetic Compatibility), by stray field disturbance or by the passing of a metal particle through the air-gap between the device and the target wheel.

Referring now to FIG. **2**, showing a schematic circuit or block diagram of the magnetic field sensor arrangement **100**, wherein a possible implementation of the processing module **120** is illustrated in more detail. The remaining circuit elements, such as the magnetic field sensor element **110**, the switching level calculation module **150**, the comparator module **160**, the storage module **170**, the optional ECU **180** and the optional feature counter **190** correspond to the elements as described with respect to the magnetic field sensor arrangement **100** of FIG. **1** and having (essentially) the same functionality and/or the same technical or physical effect so that the description of these elements and of the functionality thereof as illustrated in the embodiment of FIG. **1** are mutually exchangeable and may be applied to the elements of the magnetic field sensor arrangement of FIG. **2**.

As shown in FIG. **2**, the magnetic field sensor arrangement **100** may comprise a Hall sensor as the magnetic field sensor element **110** to provide a sensor output signal **112** responsive to a magnetic field **H**. The Hall sensor element **110** may be implemented as a Hall plate having $n \times 4$ terminals, for example. An excitation current for the Hall plate **110** is impressed into two opposite terminals. At the other two opposite terminals, the Hall voltage is picked up or sensed. The Hall plate is operated in accordance with the spinning Hall principle (Spinning Current principle) as shown by the arrow in the Hall plate **110**. According to this principle, the connections of the Hall plate are cyclically exchanged at a predetermined clock rate, i.e. the excitation current is impressed at a first pair of terminals during one clock period and a second pair of terminals, arranged at an angle of about $90^\circ/n$ with respect to the first pair of termi-

11

nals, in a subsequent clock period. The connections for picking up the Hall voltage are correspondingly exchanged. Offset components in the signal of the Hall plate, particularly alternating-voltage error signals, can be reduced, in particular by adding the Hall voltages sensed in successive clock periods.

The sensor output signal **112** is provided to the processing module **120**. As shown in FIG. 2, the processing module **120** comprises a main signal path **120-1** and a (auto-correction) feedback loop **121** e.g., for a ripple feedback suppression.

The sensor output signal **112** is provided to a first chopping circuit **130** (input chopping circuit), wherein the chopping circuit **130** chops the sensor output signal **112** in response to a chopping clock signal, wherein the resulting chopped signal **131** is provided to a modulator **132**. The modulator **132** is used for rotating the connections of the Hall plate **110** in accordance with the spinning Hall principle. For this purpose, the modulator **132** is operated with the chopper cycle. The chopper cycle determines the frequency with which the connections of the Hall plate are exchanged.

The modulator output signal **133** is provided to a comparator (or differential amplifier) **134**. The output signal **135** of the comparator **134** is provided to a second chopping circuit **136** which converts the output signal **135** of the comparator **134** back to a DC signal **137**. The DC signal **137** is provided to a tracking ADC **138** which is configured to provide a digital representation of the DC signal **137**, and thus of the sensor output signal **122**. The output signal **122** of the tracking ADC **138** (which is also the output signal of the processing module **120**) is also fed to the chopper feedback loop **120-2**. The chopper feedback loop **120-2** comprises a chopper offset calculation module **139** for providing a correction signal **124** at a combination point **141** into the feedback loop. In the combination point **141**, the processed sensor output signal **122** and the correction signal **124** are combined, e.g., added. The resulting feedback signal **142** is provided to a further chopping circuit **143** which chops the feedback signal **143** in response to the chopping clock, wherein the resulting chopped signal **144** is provided to a DAC **145** (DAC—digital-analog-converter). The DAC **145** provides a DAC output signal **146** as an analog version of the feedback signal **144** to the modulator **134**.

The processing module **120** of the magnetic field sensor arrangement **100** comprises the chopper offset calculation module **139** in the chopper feedback loop **120-2**, wherein the chopper-offset calculation module **139** is configured (1) to provide, during the running mode, a correction signal **124**, which is based on an offset signal or offset component in the processed sensor output signal **122**, and (2) to feed the correction signal **124** into the chopper feedback loop for at least partially suppressing the offset signal or offset component in the processed sensor output signal **122**.

The storage module **170** may be further configured to store a correction value **126** based on the correction signal **124** and to provide, during the next power up mode(s), the stored correction value **126** to the chopper-offset-calculation module **139** of the processing module **122**. The chopper-offset-calculation module **139** may be further configured to use the stored correction value **126** as a starting value for the correction signal during the next power up mode(s). The chopper-offset-calculation module **139** may be further configured to feed the correction signal **124** into the chopper feedback loop **120-2** for a ripple feedback suppression in the processed sensor signal **122**. To be more specific, storing the chopper offset (as correction value) in the storage module **170** and providing the stored chopper offset during the (next)

12

power up mode allows for a more stable restart of the ripple feedback suppression of the chopper circuit of the processing module **122**.

The processing module **120** may further comprise the tracking ADC **138** (ADC=analog-digital-converter) which is configured to provide a digital representation in the form of the processed sensor output signal **122** of the sensor output signal **112**. As indicated above, the magnetic field sensor element **110** may comprise a Hall sensor element, however any sensor elements responsive to a magnetic field component can be used.

Referring to FIG. 3A, a schematic block diagram shows the magnetic feed sensor arrangement **100** according to FIGS. 1 and 2, respectively, together with an associated target wheel **220** to be monitored, wherein FIG. 3B shows an example graph illustrating different example sensor output signals responsive to a magnetic field influenced by a target wheel having four teeth, for example.

As shown in FIG. 3A, the magnetic feed sensor arrangement **100** having the magnetic feed sensor element **112** is arranged next to the target wheel **220** to be monitored. The distance *d* between the magnetic field sensor element **112** and the target wheel **220** may differ due to mechanical installation tolerances so that an increased distance *d* between the magnetic field sensor element **112** of the magnetic field sensor arrangement **110** may result in a decreased magnetic field strength to be sensed by the magnetic field sensor element **110**. Correspondingly, the amplitude of the sensor output signal **112** decreases with a reduced magnetic field component at the magnetic field sensor element **110**. This is indicated by the different courses of the sensor output signal **112** and indicated in FIG. 3B with respect to different and increasing distances *d*.

FIG. 3B shows five different courses AG 1, AG 2, AG 3, AG 4, AG 5 of the sensor output signal **112** with the five associated switching levels Threshold_AG 1, Threshold_AG 2, Threshold_AG 3, Threshold_AG 4, Threshold_AG 5, corresponding to five air-gaps *d*₁ (e.g., 0.5 mm), *d*₂ (e.g., 1.0 mm), *d*₃ (e.g., 1.5 mm), *d*₄ (e.g., 2.0 mm), *d*₅ (e.g., 2.5 mm). The respective switching level “Threshold_AG 1-5” depends on the detected level of minimum field (e.g., Max 1 for AG 1) and maximum field (e.g., Min1 for AG 1) corresponding to the target wheel magnetic pattern **210** at each air-gap *d*₁₋₅ (e.g., *d*₁). The magnetic field amplitude may be the peak-to-peak amplitude of the sensed (absolute) magnetic field or an amplitude signal derived therefrom. Thus, the peak-to-peak amplitude is the change between peak (highest amplitude value, e.g., Max # for AG #, with #=1 . . . 5) and trough (lowest amplitude value e.g., Min # for AG #, with #=1 . . . 5).

The device **100** can be configured to calculate a switching level at a fixed or variable percentage of the distance between minima and maxima of the detected field which is indicated by the sensor output signal **112**. The maximum value taken into consideration for switching level calculation can be an absolute maximum over one target wheel rotation or a function of all the local maxima seen over one target wheel rotation. Similarly, the minimum value taken into consideration for switching level calculation can be an absolute minimum over one target wheel rotation or a function of all the local minima seen over one target wheel rotation.

As shown in FIG. 3A, the magnetic field sensor arrangement **100** comprising the magnetic field sensor element **110** and the associated evaluation circuit **3** may also comprise an optional back-bias magnet **230**. Alternatively or additionally, the different features of the target wheel **220** may be

magnetic, i.e. may provide an sensible magnetic field component. The magnet **230** may be configured to generate a magnetic field directed along a connection axis **222** to the center of the target wheel **220**. The target wheel **220** may comprise a camshaft having at least one feature, the camshaft can be rotatably disposed, for example, upon a rotational axis **224**. As illustrated in FIG. 3A, the target wheel **220** comprises four features or cams **210a-d**. In operation, as the target wheel (cam wheel) **220** rotates, the features **210a-d** determine variations of the magnetic field generated by the back-bias magnet **230**. Variations of the magnetic field are sensed by the magnetic field sensor element **112** and result in amplitude changes (state transitions) in the sensor output signal **112**.

With respect to the target wheel of FIG. 3A, it should be noted that the provision of four cam features is only an example as any number of features can be arranged on the target wheel **220**. As shown in FIG. 3B, the cam features **210a-d** result in the amplitude changes of the signal courses of the sense magnetic field component over one rotation, i.e. from $\alpha=0^\circ$ - 360° .

In the following, a method **300** for processing a magnetic field sensor output signal shall now be described below with reference to FIG. 4. The method for processing a magnetic field sensor output signal, comprises the step **310** of providing the sensor output signal responsive to a magnetic field, the sensor output signal being representative or illustrative of a magnetic field amplitude; the step **320** of processing the sensor output signal for providing a processed sensor output signal which is representative of the sensor output signal, and, thus, of the magnetic field amplitude; the step **330** of determining/calculating a switching level, (1) during a power up mode, based on a default switching level, and (2) during a running mode, based on the processed sensor output signal; the step **340** of comparing the processed sensor output signal with the default switching level for providing a comparator output signal based on the comparison; and the step **350** of storing the default switching level and providing, during the power up mode, the default switching level for the switching level calculation step, and (2) updating, during the running mode, the default switching level based on the switching level currently calculated, if a difference between the switching level calculated during the running mode and the stored default switching level is higher than 3% of the magnetic field amplitude.

The amplitude of the magnetic field is influenced by a target wheel, wherein the default switching level is only updated during the running mode if the target wheel has a higher rotational speed than at least 100 rpm (200, . . . , 400 rpm). The step of updating may comprise the step of conducting a number of incremental update operations of the default switching level which is smaller than a pre-set number N, wherein $N \leq 20$ (15, 10 . . .).

Moreover, a warning signal may be outputted, if the preset number N of update operations is achieved or exceeded. The warning signal may indicate a possible malfunction of the magnetic field sensor arrangement.

The method may comprise the further steps of (1) providing, during the running mode, a correction signal, which is based on an offset signal in the processed sensor output signal, and (2) feeding the correction signal into a chopper feedback loop for at least partially suppressing the offset signal in the processed sensor output signal, which can be conducted by a chopper offset calculation module in a chopper feedback loop **120-2**, for example. The method may comprise the further steps of storing a correction value based on the correction signal, and providing, during the power up

mode, the stored correction value as a starting value for correction signal during the power up mode. The method may comprise the further steps of feeding the correction signal into the chopper feedback loop for a ripple feedback suppression in the processed sensor output signal.

Moreover, the switching level calculated by a switching level calculation module during the running mode may be stored as the default switching level, wherein, during the running mode, the default switching level may be updated based on the calculated switching level. During the first power up mode, the default switching level may be updated based on the switching level calculated during the subsequent running mode.

The method may comprise the further steps of determining a number of teeth within the range of 1-12, for example, of the target wheel during running mode, and of storing this information in a storage module, wherein a different individual switching level may be used on each feature of the target wheel. It should be noted that the number of teeth may be also higher than 12.

The method may comprise the further steps of determining a current position of the target wheel, and of calculating at start-up an individual switching level (threshold) of the current edge/tooth for comparing it with the stored individual switching levels (thresholds).

The method may comprise the further steps of (1) providing, during the power up mode, the default individual switching levels to the switching level calculation module, and (2) updating, during the running mode, the default individual switching levels based on the currently calculated switching level, if the switching level calculated during the running mode deviates more than 3% from the stored default switching level for that determined feature of the target wheel compared to the detected peak-to-peak amplitude of the rendered or processed sensor output signal, i.e. if a difference between the switching level calculated during the running mode and the stored default switching level is higher than 3% of the amplitude of the sensor output signal.

The method may comprise the further steps of updating of the stored default switching level only after a defined number of target wheel rotations in order to prevent writing of wrong values in functional testing scenarios.

The method may comprise the further steps of updating of the stored default switching level only when the calculated switching level **152** has remained unchanged for a defined number of target wheel rotations. The method may comprise the further steps of updating of the stored default switching level only when the measured temperature is considered safe for the programming of the storage device.

A flag in a storage unit may indicate if the update of the default threshold in the storage unit occurred in safe supply conditions, wherein the old default threshold value may be stored for allowing a history of default threshold updates. The wherein flags or programmed validity fields in the storage module **170** may indicate which of multiple instances of stored default switching level **172** in the storage module **170** is usable as default switching level at start-up.

Thus, the present concept in form of the magnetic field sensor arrangement and the method for processing a magnetic field sensor output signal provide for an improved detection the phase accuracy of the first switch edges (based on a sensed magnetic field) after power-on of a magnetic sensor, e.g., a mono-cell magnetic cam sensor, when the sensor is mounted in the operating place, e.g., in a vehicle or car. Moreover, the calibrated switching level is stored/updated when the criteria of frequency and, for example, of

15

deviation are met. Additionally the chopper stores the ripple feedback for a faster startup of the feedback loop.

To be more specific, in accordance with the present concept on the basis the functionality of the magnetic field sensor arrangement and the method for processing a magnetic field sensor output signal, respectively, an updated or calibrated switching level is stored/updated as the (new) default switching level based on the currently calculated switching level (or comparator threshold) when specific criteria of deviation between the default switching level and the currently calculated switching level are met. Moreover, the frequency or rotational speed of the monitored camshaft may be considered as further criterion for storing/updating the default switching level based on the currently calculated switching level (threshold). To achieve a sufficient accuracy after power on, the sensor arrangement stores the new default switching level, i.e. the newly calibrated switching level, which forms the default switching level during normal operation mode, if the currently stored switching level deviates more than 3% (e.g., more than 5% or 10%) from the ideal (i.e. the currently stored default) switching level compared to the detected peak-to-peak amplitude of the rendered or processed sensor output signal. Moreover, the calibrated switching level may optionally be stored/updated during the running mode only if the target wheel has a higher rotational speed than at least 100 rpm. Updating the default switching level only if the target wheel has achieved a minimum rotational speed is conducted to suppress the possibility to store wrong calibration values (default switching levels) generated by a high target wheel vibration (as the higher the rotational speed of the target wheel is the lower the effect to the calculated switching level is).

The number of self-programming operations (updates of the default switching level) can be stored incrementally and can be limited to a maximum number of, e.g., 10. Additionally, the chopper circuit may store the ripple feedback for a faster startup of the feedback of the feedback loop. To be more specific, as the chopper offset is stored, a more stable and faster restart of the ripple feedback suppression may be achieved.

Further, a "watchdog" (i.e. a device/circuitry that detects faults and initiates corrective actions) for a small signal detection may be implemented to recover for the case that at small signals after remount at a high air gap the sensor does not switch anymore. This may occur when the complete processed sensor signal is below the default switching level. At a wrong/missing switching detection, a fallback true power on (TPO) implementation can be activated. Another option may be to activate the calibration storage by a digital command applied with the supply modulation when the sensor is mounted.

Furthermore, the number of teeth of the target wheel can also be learned at the first power on. This makes the device more universal and the customer does not program anything. Alternatively, a fixed number of, e.g., 12, teeth can be assumed as this covers target wheels with 1, 2, 3, 4, 6 and 12 teeth which are the most common.

Moreover, the method may comprise the further step of outputting a warning signal, if the pre-set number N of update operations is achieved or exceeded. The method may comprise the further step of storing a correction value based on the correction signal, and providing, during the power up mode, the stored correction value as a starting value for correction signal during the power up mode.

The method may comprise the further step of feeding the correction signal into the chopper feedback loop for a ripple feedback suppression in the processed sensor output signal.

16

The method may comprise the further step of determining a number of features of the target wheel during running mode, and storing the determined number of features in a storage module.

The method may comprise the further step of using a different individual switching level on each feature of the target wheel. The method may comprise the further step of determining a current position of the target wheel, and calculating at start-up an individual switching level of the current feature for comparing it with the stored individual switching levels.

The method may comprise the further steps of (1) providing, during the power up mode, the default individual switching levels, and (2) updating, during the running mode, the default individual switching levels based on the currently calculated switching level, if the switching level calculated during the running mode deviates more than 3% of the magnetic field amplitude from the stored default switching level for the respective feature.

The method may comprise the further step of updating of the stored default switching level only after a defined number of target wheel rotations. The method may comprise the further step of updating of the stored default switching level only when the calculated switching level (152) has remained unchanged for a defined number of target wheel rotations. The method may comprise the further step of updating of the stored default switching level only when the measured temperature is considered safe for the programming of the storage device.

According to the method, the further step of setting a flag or a programmed validity field in a storage unit is conducted if the update of the default threshold in the storage unit occurred in a safe supply condition. According to the method, flags or programmed validity fields in the storage module (170) indicate which of multiple instances of stored default switching level (172) in the storage module (170) is usable as default switching level at start-up.

The method may comprise the further step storing the default threshold value for allowing a history of default threshold updates.

Although some aspects have been described in the context of an apparatus, it is clear that these aspects also represent a description of the corresponding method, where a block or device corresponds to a method step or a feature of a method step. Analogously, aspects described in the context of a method step also represent a description of a corresponding block or item or feature of a corresponding apparatus. Some or all of the method steps may be executed by (or using) a hardware apparatus, like for example, a microprocessor, a programmable computer or an electronic circuit. In some embodiments, one or more of the most important method steps may be executed by such an apparatus.

Depending on certain implementation requirements, embodiments can be implemented in hardware or in software or at least partially in hardware or at least partially in software. The implementation can be performed using a digital storage medium, for example a floppy disk, a DVD, a Blu-Ray, a CD, a ROM, a PROM, an EPROM, an EEPROM or a FLASH memory, having electronically readable control signals stored thereon, which cooperate (or are capable of cooperating) with a programmable computer system such that the respective method is performed. Therefore, the digital storage medium may be computer readable.

Some embodiments comprise a data carrier having electronically readable control signals, which are capable of cooperating with a programmable computer system, such that one of the methods described herein is performed.

17

Generally, embodiments can be implemented as a computer program product with a program code, the program code being operative for performing one of the methods when the computer program product runs on a computer. The program code may for example be stored on a machine readable carrier.

Other embodiments comprise the computer program for performing one of the methods described herein, stored on a machine readable carrier.

In other words, an embodiment of the method is, therefore, a computer program having a program code for performing one of the methods described herein, when the computer program runs on a computer.

A further embodiment of the methods is, therefore, a data carrier (or a digital storage medium, or a computer-readable medium) comprising, recorded thereon, the computer program for performing one of the methods described herein. The data carrier, the digital storage medium or the recorded medium are typically tangible and/or non-transitory.

A further embodiment of the method is, therefore, a data stream or a sequence of signals representing the computer program for performing one of the methods described herein. The data stream or the sequence of signals may for example be configured to be transferred via a data communication connection, for example via the Internet.

A further embodiment comprises a processing means, for example a computer, or a programmable logic device, configured to or adapted to perform one of the methods described herein.

A further embodiment comprises a computer having installed thereon the computer program for performing one of the methods described herein.

A further embodiment according to the comprises an apparatus or a system configured to transfer (for example, electronically or optically) a computer program for performing one of the methods described herein to a receiver. The receiver may, for example, be a computer, a mobile device, a memory device or the like. The apparatus or system may, for example, comprise a file server for transferring the computer program to the receiver.

In some embodiments, a programmable logic device (for example a field programmable gate array) may be used to perform some or all of the functionalities of the methods described herein. In some embodiments, a field programmable gate array may cooperate with a microprocessor in order to perform one of the methods described herein. Generally, the methods may be performed by any hardware apparatus.

The apparatus described herein may be implemented using a hardware apparatus, or using a computer, or using a combination of a hardware apparatus and a computer.

The methods described herein may be performed using a hardware apparatus, or using a computer, or using a combination of a hardware apparatus and a computer.

The above described embodiments are merely illustrative for the principles of the present concept. It is understood that modifications and variations of the arrangements and the details described herein will be apparent to others skilled in the art. It is the intent, therefore, to be limited only by the scope of the impending patent claims and not by the specific details presented by way of description and explanation of the embodiments herein.

18

What is claimed is:

1. A magnetic field sensor arrangement, comprising:

a magnetic field sensor element configured to provide a sensor output signal responsive to a magnetic field, wherein the sensor output signal is representative of a magnetic field amplitude,

a processing module configured to process the sensor output signal and to provide a processed sensor output signal which is representative of the sensor output signal,

a switching level calculation module configured to determine a first switching level, during a power up mode, based on a default switching level, and determine, during a running mode, a second switching level based on the processed sensor output signal;

a comparator module configured to receive the first switching level and the second switching level, compare the processed sensor output signal with the first switching level during the power up mode, compare the processed sensor output signal with the second switching level during the running mode, and to provide a comparator output signal based on each comparison; and

a storage module configured to:

store the default switching level;

provide, during the power up mode, the default switching level to the switching level calculation module;

update, during the running mode, the default switching level based on the second switching level currently calculated by the switching level calculation module, if a difference between the second switching level calculated during the running mode and the stored default switching level is greater than a predetermined percentage of the magnetic field amplitude; and

maintain, during the running mode, the default switching level as unchanged if the difference between the second switching level calculated during the running mode and the stored default switching level is equal to or less than the predetermined percentage of the magnetic field amplitude.

2. The magnetic field sensor arrangement according to claim 1, wherein the magnetic field is influenced by a target wheel, wherein the default switching level is updated during the running mode only if the target wheel has a rotational speed greater than at least 100 rpm.

3. The magnetic field sensor arrangement according to claim 2, wherein the switching level calculation module is also configured to determine a number of features of the target wheel during the running mode and to store the number of features in the storage module.

4. The magnetic field sensor arrangement according to claim 3, further comprising:

a feature counter for determining a current position of the target wheel,

wherein the switching level calculation module is configured to calculate, at startup, an individual switching level of a current feature and to compare the individual switching level with stored individual switching levels in order to match the feature counter with the current position of the target wheel.

5. The magnetic field sensor arrangement according to claim 4, wherein a different individual switching level is used on each feature, in the form of a tooth, an edge, or a notch of the target wheel.

6. The magnetic field sensor arrangement according to claim 5, wherein the storage module is configured to store all individual default switching levels and is further configured to provide, during the power up mode, the individual default

19

switching levels to the switching level calculation module, and to update, during the running mode, the individual default switching levels based on the second switching level currently calculated by the switching level calculation module, if a difference between the second switching level calculated during the running mode and the stored default switching level is greater than the predetermined percentage of the magnetic field amplitude.

7. The magnetic field sensor arrangement according to claim 1, wherein the storage module is configured to conduct a number of incremental update operations of the default switching level which is smaller than a pre-set number N, wherein $N \leq 20$.

8. The magnetic field sensor arrangement according to claim 7, wherein a warning signal is output, if the pre-set number N of update operations is achieved or exceeded.

9. The magnetic field sensor arrangement according to claim 1, wherein the processing module comprises a chopper circuit with a chopper-offset-calculation module in a chopper feedback loop, wherein the chopper-offset-calculation module is configured to provide, during the running mode, a correction signal, which is based on an offset component in the processed sensor output signal, and to feed the correction signal into the chopper feedback loop for at least partially suppressing the offset component in the processed sensor output signal.

10. The magnetic field sensor arrangement according to claim 9, wherein the storage module is further configured to store a correction value based on the correction signal and to provide, during the power up mode, the stored correction value to the chopper-offset-calculation module.

11. The magnetic field sensor arrangement according to claim 10, wherein the chopper-offset-calculation module is configured to use the stored correction value as a starting value for a correction signal during the power up mode.

12. The magnetic field sensor arrangement according to claim 9, wherein the chopper-offset-calculation module is configured to feed the correction signal into the chopper feedback loop for a ripple feedback suppression in the processed sensor output signal.

13. The magnetic field sensor arrangement according to claim 1, wherein the second switching level calculated by the switching level calculation module during the running mode is stored as the default switching level.

14. The magnetic field sensor arrangement according to claim 1, further comprising:

an electronic control unit (ECU), wherein the ECU is configured to instruct the storage module to update, during the running mode, the default switching level based on the second switching level calculated by the switching level calculation module.

20

15. The magnetic field sensor arrangement according to claim 14, wherein the ECU is configured to instruct the storage module during the power up mode, to update the default switching level based on the second switching level during the running mode.

16. The magnetic field sensor arrangement according to claim 14, wherein the ECU is configured to instruct the storage module to update the default switching level when an external programming voltage is applied.

17. The magnetic field sensor arrangement according to claim 14, wherein the ECU is configured to instruct the storage module to update the default switching level when external conditions are considered safe for programming to be done based on an internal programming voltage coming from a charge pump.

18. The magnetic field sensor arrangement according to claim 1, wherein the processing module comprises a tracking ADC configured to provide a digital representation of the sensor output signal.

19. The magnetic field sensor arrangement according to claim 1, wherein the magnetic field sensor element comprises a Hall sensor element.

20. The magnetic field sensor arrangement according to claim 1, wherein the storage module is configured to update of the stored default switching level only after a defined number of target wheel rotations.

21. The magnetic field sensor arrangement according to claim 20, wherein the storage module is configured to update of the stored default switching level only when the calculated switching level has remained unchanged for a defined number of target wheel rotations.

22. The magnetic field sensor arrangement according to claim 1, wherein the storage module is configured to update of the stored default switching level only when a measured temperature is considered safe for programming.

23. The magnetic field sensor arrangement according to claim 1, wherein a flag or a programmed validity field in the storage module indicates whether the update of the default switching level in the storage module occurred in a safe supply condition.

24. The magnetic field sensor arrangement according to claim 1, wherein flags or programmed validity fields in the storage module indicate which of multiple instances of stored default switching levels in the storage module is usable as the default switching level at start-up.

25. The magnetic field sensor arrangement according to claim 1, wherein a discarded default threshold value is moved to a dedicated storage location of the storage module allowing to provide a history of the updated default switching levels.

* * * * *