

US010411746B2

(12) **United States Patent**
Pederson

(10) **Patent No.:** **US 10,411,746 B2**
(45) **Date of Patent:** ***Sep. 10, 2019**

(54) **VISIBLE LIGHT COMMUNICATION
TRANSCIVER GLASSES**

(58) **Field of Classification Search**
None
See application file for complete search history.

(71) Applicant: **Federal Law Enforcement
Development Services, Inc.**, St. Cloud,
MN (US)

(56) **References Cited**

(72) Inventor: **John C. Pederson**, Merritt Island, FL
(US)

U.S. PATENT DOCUMENTS

(73) Assignee: **Federal Law Enforcement
Development Services, Inc.**, St. Cloud,
MN (US)

700,678 A 5/1902 Downie
2,082,279 A 6/1937 Fore
(Continued)

(*) Notice: Subject to any disclaimer, the term of this
patent is extended or adjusted under 35
U.S.C. 154(b) by 196 days.

FOREIGN PATENT DOCUMENTS

This patent is subject to a terminal dis-
claimer.

AU 2006201345 10/2007
AU 2007202909 2/2008
(Continued)

OTHER PUBLICATIONS

(21) Appl. No.: **15/596,194**

Komine T. et al., "Integrated System of White LED Visible-Light
Communication and Power-Line Communication," Sep. 15, 2002;
Sep. 15, 2002-Sep. 18, 2002, vol. 4, Sep. 15, 2002, pp. 1762-1766.
(Continued)

(22) Filed: **May 16, 2017**

(65) **Prior Publication Data**
US 2018/0097536 A1 Apr. 5, 2018

Primary Examiner — Kenneth B Lee, Jr.
(74) *Attorney, Agent, or Firm* — Vidas, Arrett &
Steinkraus, P.A.

Related U.S. Application Data

(57) **ABSTRACT**

(63) Continuation of application No. 14/546,218, filed on
Nov. 18, 2014, now Pat. No. 9,654,163, which is a
(Continued)

An LED light and communication system includes Visible
Light Communication Transceiver Glasses having at least
one projector, lens(es), and optical transceiver, the optical
transceiver including a light support and a processor. The
light support has at least one light emitting diode and at least
one photodetector attached. The processor is in communi-
cation with the at least one light emitting diode and the at
least one photodetector. The processor is capable of illumi-
nating the at least one light emitting diode to create at least
one light signal which is not observable to the unaided eyes
of an individual. The second light signal includes at least one
data packet. The processor may generate a signal for the
projector to display information on the lens(es).

(51) **Int. Cl.**
H04B 1/3827 (2015.01)
G09G 3/00 (2006.01)
(Continued)

(52) **U.S. Cl.**
CPC **H04B 1/385** (2013.01); **G09G 3/003**
(2013.01); **H04B 10/116** (2013.01); **H04B**
10/40 (2013.01);
(Continued)

15 Claims, 4 Drawing Sheets

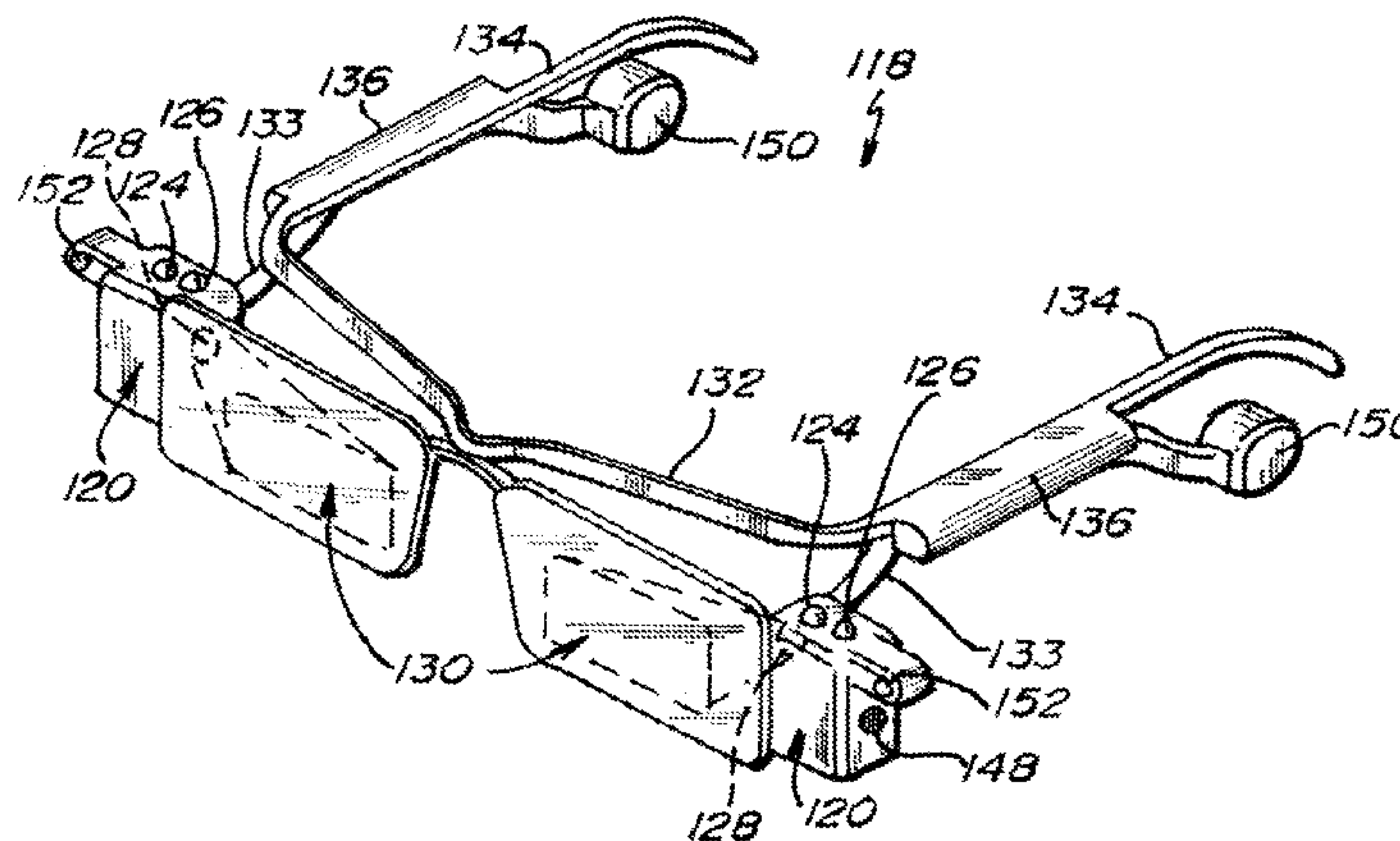

Related U.S. Application Data

- continuation of application No. 12/750,796, filed on Mar. 31, 2010, now Pat. No. 8,890,773.
- (60) Provisional application No. 61/165,546, filed on Apr. 1, 2009.
- (51) **Int. Cl.**
H04B 10/116 (2013.01)
H04B 10/40 (2013.01)
- (52) **U.S. Cl.**
 CPC *G09G 2370/10* (2013.01); *G09G 2380/10* (2013.01); *H04B 2001/3866* (2013.01)

(56) **References Cited**

U.S. PATENT DOCUMENTS

3,469,686	A	9/1969	Gutsche et al.	5,041,947	A	8/1991	Yuen
3,696,384	A	10/1972	Lester	5,045,767	A	9/1991	Wakatake
3,701,043	A	10/1972	Zuleeg et al.	5,050,055	A	9/1991	Lindsay
3,705,316	A	12/1972	Burrous et al.	5,057,828	A	10/1991	Rousseau
3,863,075	A	1/1975	Ironmonger et al.	5,060,303	A	10/1991	Wilmoth
3,867,718	A	2/1975	Moe	5,062,152	A	10/1991	Faulkner
3,889,147	A	6/1975	Groves	5,067,788	A	11/1991	Jannson
3,911,430	A	10/1975	Jankowski et al.	5,091,828	A	2/1992	Jincks
4,149,111	A	4/1979	Coates, Jr.	D324,921	S	3/1992	Stanuch
4,243,985	A	1/1981	Quayle	5,093,768	A	3/1992	Ohe
4,254,453	A	3/1981	Mouyard	5,097,397	A	3/1992	Stanuch
4,271,408	A	6/1981	Teshima	5,097,612	A	3/1992	Williams
4,298,806	A	11/1981	Herold	5,099,346	A	3/1992	Lee
4,301,461	A	11/1981	Asano	5,101,326	A	3/1992	Roney
4,319,306	A	3/1982	Stanuch	5,122,943	A	6/1992	Pugh
4,336,580	A	6/1982	Mouyard	5,136,287	A	8/1992	Borenstein
4,342,944	A	8/1982	SpringThorpe	5,159,486	A	10/1992	Webb
4,368,979	A	1/1983	Ruell	5,164,992	A	11/1992	Turk
4,390,931	A	6/1983	Gorick	5,172,113	A	12/1992	Hamer
4,434,510	A	2/1984	Lemelson	5,182,647	A	1/1993	Chang
4,445,132	A	4/1984	Ichikawa	5,187,547	A	2/1993	Niina
4,556,862	A	12/1985	Meinershagen	5,193,201	A	3/1993	Tymes
4,595,904	A	6/1986	Gosswiller	5,198,746	A	3/1993	Gyugyi
4,598,198	A	7/1986	Fayfield	5,198,756	A	3/1993	Jenkins
4,614,866	A	9/1986	Liss	5,220,235	A	6/1993	Wakimizu
4,615,131	A	10/1986	Wakatake	5,224,773	A	7/1993	Arimura
4,616,225	A	10/1986	Woudenberg	5,233,204	A	8/1993	Fletcher
4,630,180	A	12/1986	Muraki	5,235,498	A	8/1993	VanDulmen
4,630,183	A	12/1986	Fujita	5,247,380	A	9/1993	Lee
4,633,280	A	12/1986	Takasu	5,283,425	A	2/1994	Imamura
4,654,629	A	3/1987	Bezos	5,291,196	A	3/1994	Defour
4,703,219	A	10/1987	Mesquida	5,296,840	A	3/1994	Gieffers
4,710,977	A	12/1987	Lemelson	5,298,738	A	3/1994	Gebert
4,716,296	A	12/1987	Bussiere	5,302,965	A	4/1994	Belcher
4,720,835	A	1/1988	Akiba	5,313,187	A	5/1994	Choi
4,724,312	A	2/1988	Snaper	5,321,593	A	6/1994	Moates
4,742,432	A	5/1988	Thillays	5,357,123	A	10/1994	Sugawara
4,799,135	A	1/1989	Inukai	5,357,409	A	10/1994	Glatt
4,821,118	A	4/1989	Lafreniere	5,359,255	A	10/1994	Kawai
4,821,338	A	4/1989	Naruse	5,359,669	A	10/1994	Shanley
4,848,923	A	7/1989	Ziegler	5,361,190	A	11/1994	Roberts
4,868,719	A	9/1989	Kouchi	5,362,971	A	11/1994	McMahon
4,900,970	A	2/1990	Ando	5,381,155	A	1/1995	Gerber
4,918,497	A	4/1990	Edmond	5,400,140	A	3/1995	Johnston
4,928,084	A	5/1990	Reiser	5,401,328	A	3/1995	Schmitz
4,929,866	A	5/1990	Murata	5,403,916	A	4/1995	Watanabe
4,935,665	A	6/1990	Murata	5,406,095	A	4/1995	Koyama
4,949,866	A	8/1990	Sanders	5,410,328	A	4/1995	Yoksza
4,954,822	A	9/1990	Borenstein	5,410,453	A	4/1995	Ruskouski
4,965,644	A	10/1990	Kawabata	5,416,627	A	5/1995	Wilmoth
4,966,862	A	10/1990	Edmond	5,419,065	A	5/1995	Lin
4,975,644	A	12/1990	Fox	5,420,444	A	5/1995	Sawase
4,975,814	A	12/1990	Schairer	5,422,623	A	6/1995	Bader
4,990,970	A	2/1991	Fuller	5,426,417	A	6/1995	Stanuch
5,000,569	A	3/1991	Nylund	5,434,693	A	7/1995	Tanaka
5,027,168	A	6/1991	Edmond	5,436,809	A	7/1995	Brassier
5,035,055	A	7/1991	McCullough	5,450,301	A	9/1995	Waltz
5,038,406	A	8/1991	Titterton	5,453,729	A	9/1995	Chu
				5,465,142	A	11/1995	Krumes
				5,471,371	A	11/1995	Koppolu
				5,475,241	A	12/1995	Harrah
				5,482,896	A	1/1996	Tang
				5,490,048	A	2/1996	Brassier
				5,490,049	A	2/1996	Montalan
				5,491,350	A	2/1996	Unno
				5,495,358	A	2/1996	Bartig
				5,498,883	A	3/1996	Lebby
				5,514,627	A	5/1996	Lowery
				5,516,727	A	5/1996	Broom
				5,519,720	A	5/1996	Hirano
				5,526,237	A	6/1996	Davenport
				5,528,474	A	6/1996	Roney
				5,532,472	A	7/1996	Furuta
				5,546,219	A	8/1996	Iida
				5,546,496	A	8/1996	Kimoto
				5,552,780	A	9/1996	Knockcart
				5,557,257	A	9/1996	Gieffers
				5,566,022	A	10/1996	Segev
				5,567,036	A	10/1996	Theobald

(56)

References Cited

U.S. PATENT DOCUMENTS

5,568,406 A	10/1996	Gerber	5,875,261 A	2/1999	Fitzpatrick
5,569,939 A	10/1996	Choi	5,884,997 A	3/1999	Stanuch
5,575,459 A	11/1996	Anderson	5,898,381 A	4/1999	Gartner
5,580,156 A	12/1996	Suzuki	5,900,850 A	5/1999	Bailey
5,585,783 A	12/1996	Hall	5,917,637 A	6/1999	Ishikawa
5,593,223 A	1/1997	Koizumi	5,929,788 A	7/1999	Vukosic
5,593,459 A	1/1997	Gamblin	5,931,562 A	8/1999	Arato
5,594,415 A	1/1997	Ishikawa	5,931,570 A	8/1999	Yamuro
5,598,290 A	1/1997	Tanaka	5,932,860 A	8/1999	Plesko
5,604,480 A	2/1997	Lamparter	5,934,694 A	8/1999	Schugt
5,606,444 A	2/1997	Johnson	5,936,417 A	8/1999	Nagata
5,607,788 A	3/1997	Tomazic	5,939,996 A	8/1999	Kniveton
5,612,201 A	3/1997	DePlaen	5,948,038 A	9/1999	Daly
5,612,231 A	3/1997	Holm	5,959,752 A	9/1999	Ota
5,625,201 A	4/1997	Holm	5,960,135 A	9/1999	Ozawa
5,627,851 A	5/1997	Takahashi	5,965,879 A	10/1999	Leviton
5,631,474 A	5/1997	Saitoh	5,966,073 A	10/1999	Walton
5,632,551 A	5/1997	Roney	5,975,714 A	11/1999	Vetorino
5,633,629 A	5/1997	Hochstein	5,990,802 A	11/1999	Maskeny
5,634,287 A	6/1997	Lamparter	5,991,085 A	11/1999	Rallison
5,634,357 A	6/1997	Nutter	6,009,650 A	1/2000	Lamparter
5,634,711 A	6/1997	Kennedy	6,014,237 A	1/2000	Abeles
5,635,902 A	6/1997	Hochstein	6,018,899 A	2/2000	Hanitz
5,635,981 A	6/1997	Ribacoff	6,028,694 A	2/2000	Schmidt
5,636,916 A	6/1997	Sokolowski	6,035,053 A	3/2000	Yoshioka
5,643,357 A	7/1997	Breton	6,035,055 A	3/2000	Wang
5,644,291 A	7/1997	Jozwik	6,035,074 A	3/2000	Fujimoto
5,656,829 A	8/1997	Sakaguchi	6,067,010 A	5/2000	Wang
5,660,461 A	8/1997	Ignatius	6,067,011 A	5/2000	Leslie
5,661,645 A	8/1997	Hochstein	6,067,018 A	5/2000	Skelton
5,661,742 A	8/1997	Huang	6,072,893 A	6/2000	Luo
5,664,448 A	9/1997	Swan	6,081,206 A	6/2000	Kielland
5,674,000 A	10/1997	Kalley	6,081,304 A	6/2000	Kuriyama
5,694,112 A	12/1997	VannRox	6,086,229 A	7/2000	Pastrick
5,696,500 A	12/1997	Diem	6,091,025 A	7/2000	Cotter
5,697,175 A	12/1997	Schwartz	6,094,148 A	7/2000	Henry
5,705,047 A	1/1998	Lee	6,095,661 A	8/2000	Lebens
5,707,891 A	1/1998	Izumi	6,095,663 A	8/2000	Pond
5,708,428 A	1/1998	Phillips	6,102,696 A	8/2000	Osterwalder
5,722,760 A	3/1998	Chien	6,106,137 A	8/2000	Adams
5,726,535 A	3/1998	Yan	6,111,671 A	8/2000	Bahuguna
5,726,786 A	3/1998	Heflinger	6,118,388 A	9/2000	Morrison
5,734,337 A	3/1998	Kupersmit	6,121,898 A	9/2000	Moetteli
5,734,343 A	3/1998	Urbish	6,126,087 A	10/2000	Hedger
5,736,925 A	4/1998	Knauff	6,159,005 A	12/2000	Herold
5,739,552 A	4/1998	Kimura	6,166,496 A	12/2000	Lys
5,739,592 A	4/1998	Rigsby	6,177,678 B1	1/2001	Brass
5,758,947 A	6/1998	Glatt	6,183,100 B1	2/2001	Suckow
5,760,531 A	6/1998	Pederson	6,188,738 B1	2/2001	Sakamoto
5,781,105 A	7/1998	Bitar	6,243,492 B1	6/2001	Kamei
5,783,909 A	7/1998	Hochstein	6,249,340 B1	6/2001	Jung
5,785,418 A	7/1998	Hochstein	6,268,788 B1	7/2001	Gray
5,786,918 A	7/1998	Suzuki	6,271,814 B1	8/2001	Kaoh
5,789,768 A	8/1998	Lee	6,271,815 B1	8/2001	Yang
5,793,062 A	8/1998	Kish, Jr.	6,271,913 B1	8/2001	Jung
5,796,376 A	8/1998	Banks	6,292,575 B1	9/2001	Bortolussi
5,804,822 A	9/1998	Brass	6,293,904 B1	9/2001	Blazey
5,805,081 A	9/1998	Fikacek	6,318,886 B1	11/2001	Stopa
5,805,209 A	9/1998	Yuge	6,352,358 B1	3/2002	Lieberman
5,806,965 A	9/1998	Deese	6,367,949 B1	4/2002	Pederson
5,808,592 A	9/1998	Mizutani	6,369,849 B1	4/2002	Rzyski
5,809,161 A	9/1998	Auty	6,377,558 B1	4/2002	Dent
5,809,681 A	9/1998	Miyamoto	6,380,865 B1	4/2002	Pederson
5,810,833 A	9/1998	Brady	6,389,115 B1	5/2002	Swistock
5,818,421 A	10/1998	Ogino	6,389,155 B2	5/2002	Funayama
5,826,965 A	10/1998	Lyons	6,396,954 B1	5/2002	Kondo
5,828,055 A	10/1998	Jebens	6,400,828 B2	6/2002	Covell
5,831,155 A	11/1998	Hewitt	6,411,022 B1	6/2002	MacHida
5,838,024 A	11/1998	Masuda	6,424,269 B1	7/2002	Pederson
5,838,116 A	11/1998	Katyl	6,426,599 B1	7/2002	Leeb
5,838,247 A	11/1998	Bladowski	6,461,008 B1	10/2002	Pederson
5,838,259 A	11/1998	Tonkin	6,462,669 B1	10/2002	Pederson
5,848,837 A	12/1998	Gustafson	6,469,631 B1	10/2002	Pederson
5,860,135 A	1/1999	Sugita	6,472,996 B1	10/2002	Pederson
5,872,646 A	2/1999	Alderman	6,476,726 B1	11/2002	Pederson
			6,504,487 B1	1/2003	Pederson
			6,504,646 B1	1/2003	Amoruso
			6,532,212 B1	3/2003	Soloway
			6,547,410 B1	4/2003	Pederson

(56)

References Cited

U.S. PATENT DOCUMENTS

6,548,967	B1	4/2003	Dowling	2003/0185340	A1	10/2003	Frantz
6,590,343	B2	7/2003	Pederson	2003/0212996	A1	11/2003	Wolzien
6,590,502	B1	7/2003	Pederson	2003/0222587	A1	12/2003	Dowling
6,600,274	B1	7/2003	Hughes	2004/0028349	A1	2/2004	Nagasaka
6,600,899	B1	7/2003	Radomsky	2004/0044709	A1	3/2004	Cabrera
6,614,359	B2	9/2003	Pederson	2004/0101312	A1	5/2004	Cabrera
6,623,151	B2	9/2003	Pederson	2004/0151344	A1	8/2004	Farmer
6,683,590	B1	1/2004	Pang	2004/0153229	A1	8/2004	Gokturk
6,690,294	B1	2/2004	Zierden	2004/0208599	A1	10/2004	Swartz
6,693,551	B2	2/2004	Pederson	2005/0002673	A1	1/2005	Okano
6,705,745	B1	3/2004	Pederson	2005/0005794	A1	1/2005	Inukai
6,707,389	B2	3/2004	Pederson	2005/0057941	A1	3/2005	Pederson
6,788,217	B2	9/2004	Pederson	2005/0111533	A1	5/2005	Berkman
6,814,459	B2	11/2004	Pederson	2005/0111700	A1	5/2005	Oboyle
6,819,654	B2	11/2004	Soloway	2005/0128751	A1	6/2005	Roberge
6,819,677	B1	11/2004	Nouzovsky	2005/0169643	A1	8/2005	Franklin
6,822,578	B2	11/2004	Pederson	2005/0231128	A1	10/2005	Franklin
6,844,824	B2	1/2005	Vukosic	2006/0012315	A1	1/2006	McDonough
6,879,263	B2	4/2005	Pederson	2006/0039698	A1	2/2006	Pautler
6,892,942	B1	5/2005	Widl	2006/0056855	A1	3/2006	Nakagawa
7,006,768	B1	2/2006	Franklin	2006/0132382	A1	6/2006	Jannard
7,023,469	B1	4/2006	Olson	2006/0149813	A1	7/2006	Janik
7,046,160	B2	5/2006	Pederson	2006/0192672	A1	8/2006	Gidge
7,102,665	B1	9/2006	Chandler	2006/0193634	A1	8/2006	Wang
7,103,614	B1	9/2006	Kucik	2006/0213731	A1	9/2006	Lesesky
7,178,941	B2	2/2007	Roberge	2006/0238368	A1	10/2006	Pederson
7,183,895	B2	2/2007	Bazakos	2006/0253598	A1	11/2006	Nakamura
7,230,884	B2	6/2007	Shemesh	2006/0262545	A1	11/2006	Piepgras
7,289,731	B2	10/2007	Thinguldstad	2006/0275040	A1	12/2006	Franklin
7,309,965	B2	12/2007	Dowling	2007/0041732	A1	2/2007	Oki
7,321,757	B2	1/2008	Yamashita	2007/0104239	A1	5/2007	Koga
7,323,991	B1	1/2008	Eckert	2007/0110446	A1	5/2007	Hong
7,324,757	B2	1/2008	Wilson	2007/0145915	A1	6/2007	Roberge
7,333,735	B1	2/2008	Goorjian	2007/0147843	A1	6/2007	Fujiwara
7,352,972	B2	4/2008	Franklin	2007/0160373	A1	7/2007	Biegelsen
7,439,847	B2	10/2008	Pederson	2007/0165244	A1	7/2007	Yukhin
7,439,874	B2	10/2008	Sotiriou	2007/0195263	A1	8/2007	Shimizu
7,529,488	B2	5/2009	Burdick	2007/0258718	A1	11/2007	Furlong
7,548,698	B2	6/2009	Yamamoto	2007/0269219	A1	11/2007	Teller
7,557,521	B2	7/2009	Lys	2007/0285026	A1	12/2007	Johler
7,583,901	B2	9/2009	Nakagawa	2007/0294029	A1	12/2007	DAndrea
7,689,130	B2	3/2010	Ashdown	2008/0044188	A1	2/2008	Kagawa
7,715,723	B2	5/2010	Kagawa	2008/0063404	A1	3/2008	Broyde
7,912,377	B2	3/2011	Koga	2008/0128505	A1	6/2008	Challa
7,940,191	B2	5/2011	Hierzer	2008/0138077	A1	6/2008	Stretton
8,126,554	B2	2/2012	Kane	2008/0154101	A1	6/2008	Jain
8,175,799	B1	5/2012	Woehler	2008/0170536	A1	7/2008	Marshack
8,188,878	B2	5/2012	Pederson	2008/0214219	A1	9/2008	Matsushima
8,188,879	B2	5/2012	Pederson	2008/0227463	A1	9/2008	Hizume
8,207,821	B2	6/2012	Roberge	2008/0292320	A1	11/2008	Pederson
8,421,588	B1	4/2013	Ross	2009/0002265	A1	1/2009	Kitaoka
8,538,692	B2	9/2013	Wurman	2009/0102396	A1	4/2009	Petrucci
8,547,036	B2	10/2013	Tran	2009/0129782	A1	5/2009	Pederson
8,571,411	B2	10/2013	Pederson	2009/0157545	A1	6/2009	Mobley
8,593,299	B2	11/2013	Pederson	2009/0262760	A1	10/2009	Krupkin
8,687,965	B2	4/2014	Pederson	2009/0315481	A1	12/2009	Zhao
8,729,833	B2	5/2014	Chemel	2009/0315485	A1	12/2009	Verfuert
8,744,267	B2	6/2014	Pederson	2010/0060194	A1	3/2010	Furry
8,836,922	B1	9/2014	Pennecot	2010/0111538	A1	5/2010	Arita
8,886,045	B2	11/2014	Pederson	2010/0142965	A1	6/2010	Breyer
8,890,773	B1	11/2014	Pederson	2010/0209105	A1	8/2010	Shin
8,891,962	B2	11/2014	Du	2011/0006898	A1	1/2011	Kruent
8,902,076	B2	12/2014	Pederson	2011/0128384	A1	6/2011	Tiscareno
8,965,460	B1	2/2015	Rao	2011/0140612	A1	6/2011	Mohan
9,413,469	B2	8/2016	Eden	2011/0208963	A1	8/2011	Soffer
9,461,748	B2	10/2016	Pederson	2011/0225611	A1	9/2011	Shintani
9,654,163	B2*	5/2017	Pederson	2011/0294465	A1	12/2011	Inselberg
2002/0054411	A1	5/2002	Heminger	2011/0305460	A1	12/2011	Snyder
2002/0109892	A1	8/2002	Seto	2012/0183301	A1	7/2012	Pederson
2002/0168958	A1	11/2002	Ford	2012/0202520	A1	8/2012	George
2002/0181044	A1	12/2002	Kuykendall, Jr.	2012/0230696	A1	9/2012	Pederson
2003/0025608	A1	2/2003	Pederson	2012/0240196	A1	9/2012	Bhagwat
2003/0118216	A1	6/2003	Goldberg	2012/0251100	A1	10/2012	Rope
2003/0156037	A1	8/2003	Pederson	2013/0015785	A1	1/2013	Kamada
2003/0169164	A1	9/2003	Lau	2013/0094863	A1	4/2013	Pederson
				2013/0201316	A1	8/2013	Binder
				2013/0221848	A1	8/2013	Miesak
				2013/0229346	A1	9/2013	Jungbauer
				2013/0229492	A1	9/2013	Ose

H04B 1/385

(56)

References Cited

U.S. PATENT DOCUMENTS

2013/0341062 A1 12/2013 Paquin
 2014/0153923 A1 6/2014 Casaccia
 2014/0247907 A1 9/2014 McCune
 2014/0286644 A1 9/2014 Oshima
 2014/0341588 A1 11/2014 Pederson
 2015/0078743 A1 3/2015 Yang
 2016/0190807 A1 6/2016 Wendt
 2017/0367164 A1 12/2017 Engelen

FOREIGN PATENT DOCUMENTS

CA 2164920 6/1996
 DE 4304216 8/1994
 DE 19502735 8/1996
 DE 19548639 6/1997
 DE 19721673 11/1997
 DE 29712281 1/1998
 EP 0326668 8/1989
 EP 0468822 1/1992
 EP 0531184 3/1993
 EP 0531185 3/1993
 EP 0596782 5/1994
 EP 0633163 1/1995
 EP 0688696 12/1995
 EP 0709818 5/1996
 EP 0793403 9/1997
 EP 0887783 12/1998
 EP 0890894 1/1999
 EP 0896898 2/1999
 EP 0967590 12/1999
 EP 1043189 10/2000
 EP 1205763 5/2002
 EP 1564914 8/2005
 FR 2658024 8/1991
 FR 2680861 3/1993
 FR 2707222 1/1995
 FR 2800500 5/2001
 GB 1241369 8/1971
 GB 2069257 8/1981
 GB 2139340 11/1984
 GB 2175428 11/1986
 GB 2240650 2/1990
 GB 2111270 6/1993
 GB 2272791 5/1994
 GB 2292450 2/1996
 GB 2311401 9/1997
 GB 2323618 9/1998
 GB 2330679 4/1999

GB 2359179 8/2001
 GB 2359180 8/2001
 JP 60143150 7/1985
 JP 63153166 6/1988
 JP 6333403 12/1994
 JP 8002341 1/1996
 JP 10098778 4/1998
 WO 9750070 12/1997
 WO 9935634 7/1999
 WO 9942985 8/1999
 WO 9949435 9/1999
 WO 9949446 9/1999
 WO 0074975 12/2000
 WO 0101675 1/2001
 WO 0110674 2/2001
 WO 0110675 2/2001
 WO 0110676 2/2001
 WO 0225842 3/2002
 WO 02073836 9/2002
 WO 2007003037 11/2007

OTHER PUBLICATIONS

Akhavan et al., "High-Speed Power-Efficient Indoor Wireless Infrared Communication Using Code Combining-Part I," IEEE Transactions on Communications, vol. 50, No. 7, Jul. 2002, pp. 1098-1109.
 Djahani et al., "Analysis of Infrared Wireless Links Employing Multibeam Transmitters and Imaging Diversity Receivers," IEEE Transactions on Communications, vol. 48, No. 12, Dec. 2000, pp. 2077-2088.
 Hawaiian Electric Company, Inc.: Powerlines—Energy Efficiency Takes-off at Honolulu International Airport, Spring 2008, pp. 1-13.
 Jeffrey B. Carruthers, "Wireless Infrared Communications," Wiley Encyclopedia of Telecommunications, 2002.
 Kahn et al., "Wireless Infrared Communications," Proceedings of the IEEE, vol. 85, No. 2, Feb. 1997, pp. 265-298.
 Pacific Northwest National Laboratory: Demonstration Assessment of Light-Emitting Diode (LED) Parking Lot Lighting, Phase 1, Jun. 2010, pp. 1-37.
 Van Wicklen, Garrett L.: Using LED Lights Can Reduce Your Electricity Costs, Dec. 2005, Cooperative Extension Service, Applied Poultry Engineering News, vol. 3, No. 1, pp. 1-4.
 T. Komine and M. Nakagawa, Integrated System of White LED Visible-Light Communication and Power-Line Communication Integrated System of White LED Visible-Light Communication and Power-Line Communication, Toshihiko Komine, Student Member, IEEE and Masao Nakagawa, Member, IEEE Date 1, Feb. 2003 pp. 71-79.

* cited by examiner

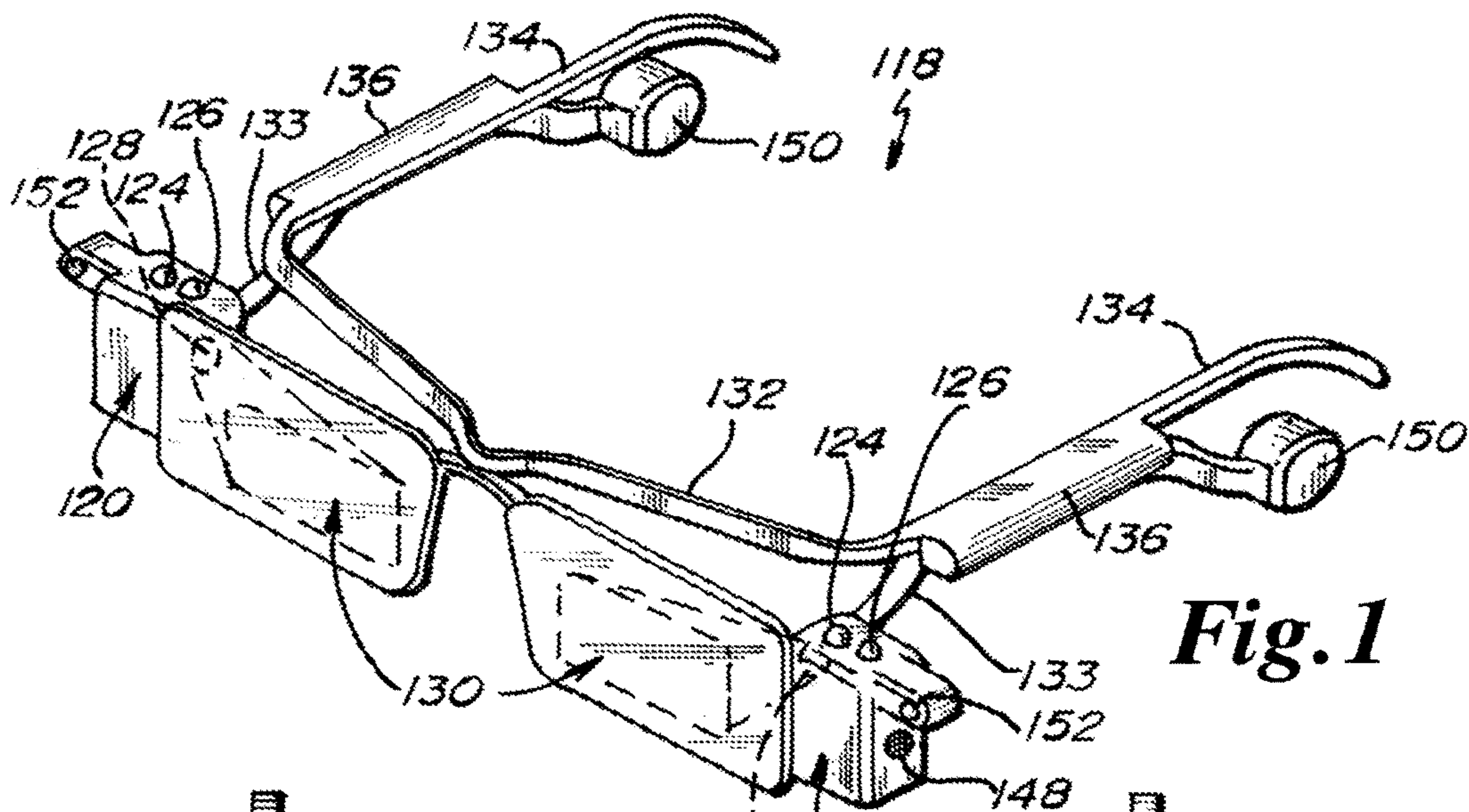

Fig. 1

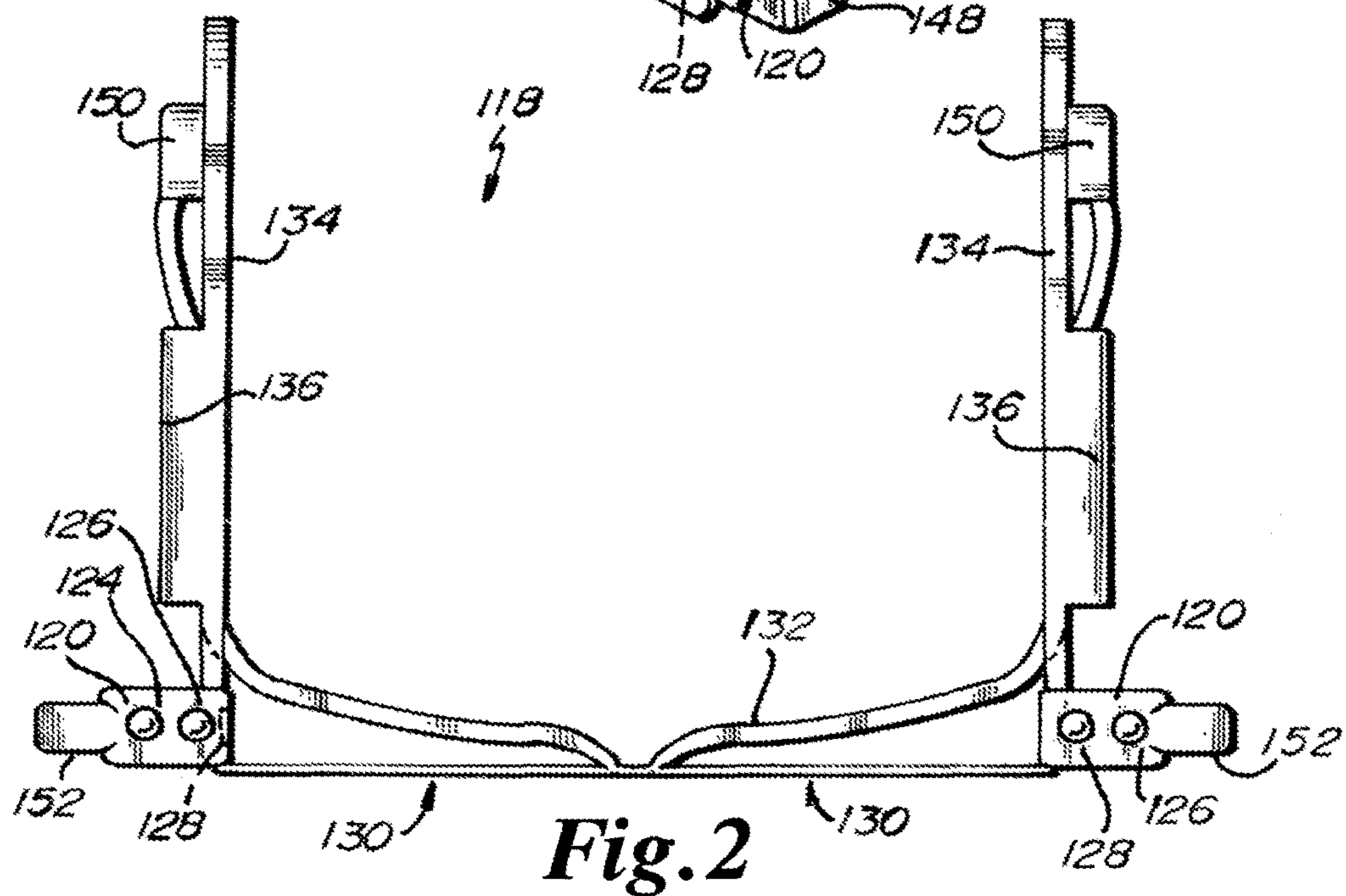

Fig. 2

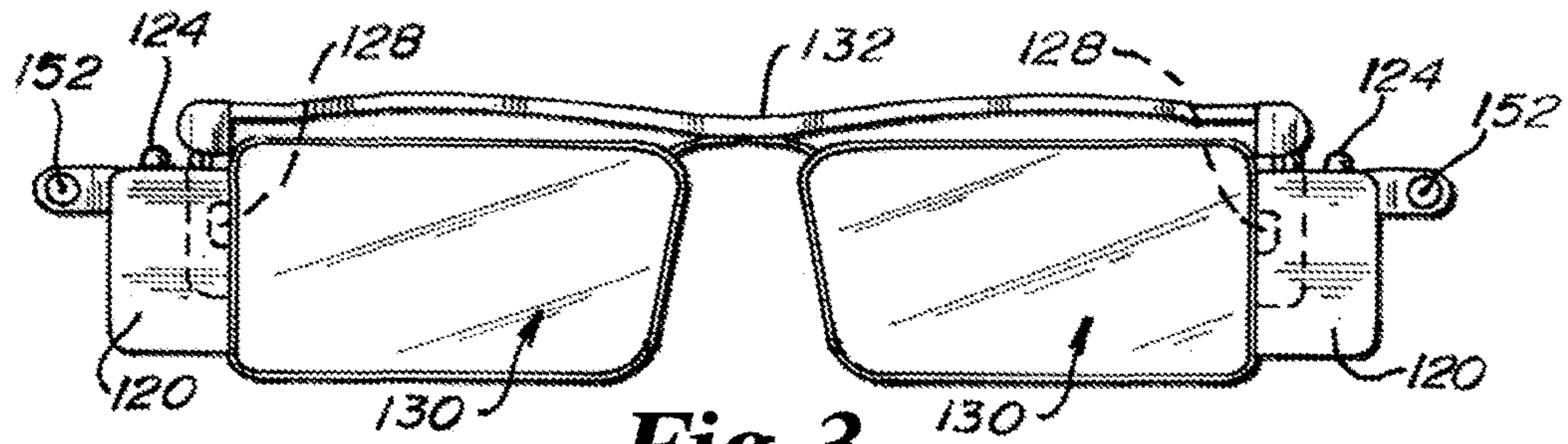

Fig. 3

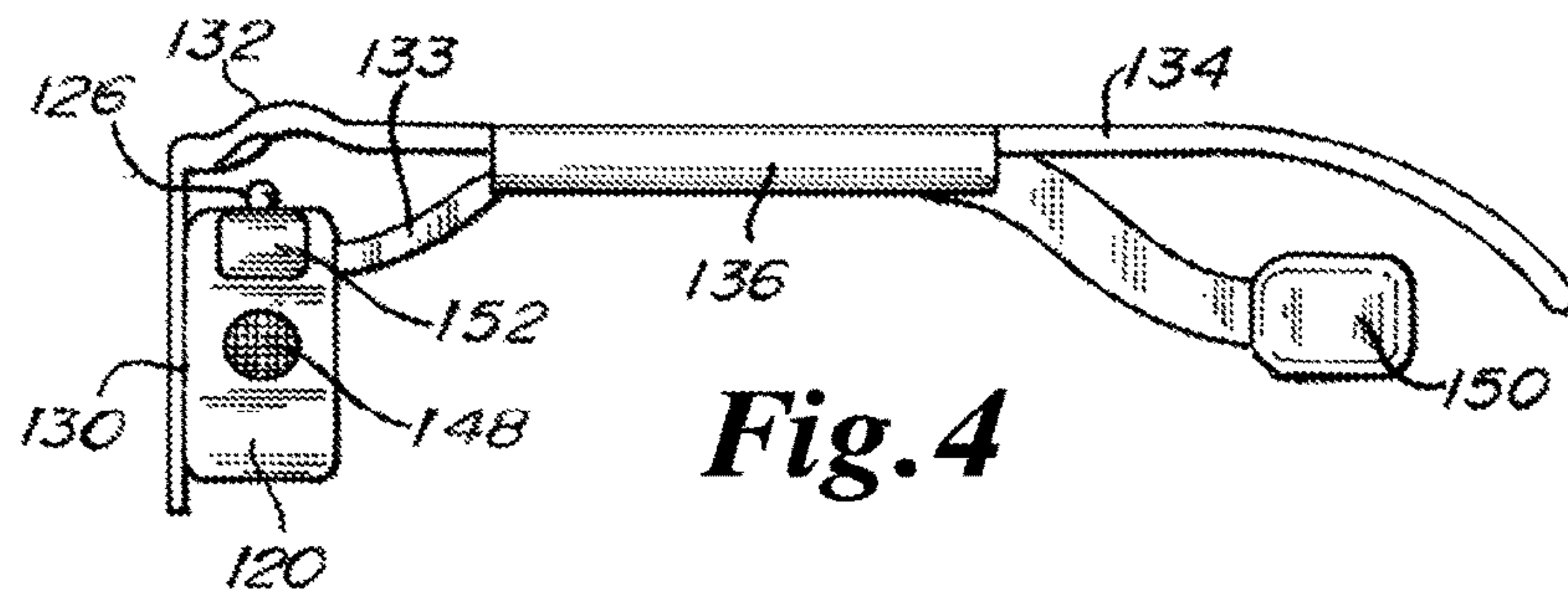

Fig. 4

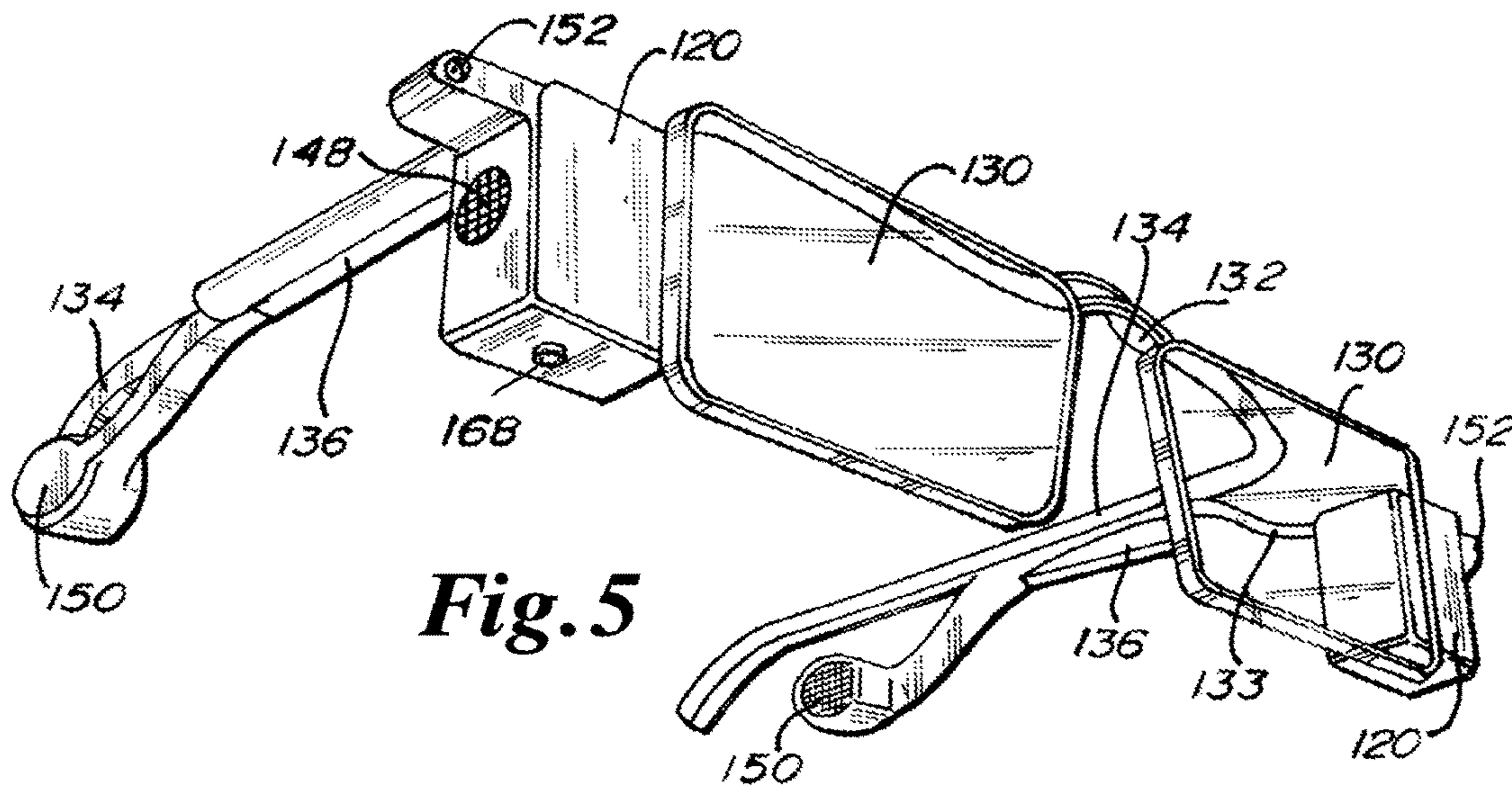

Fig. 5

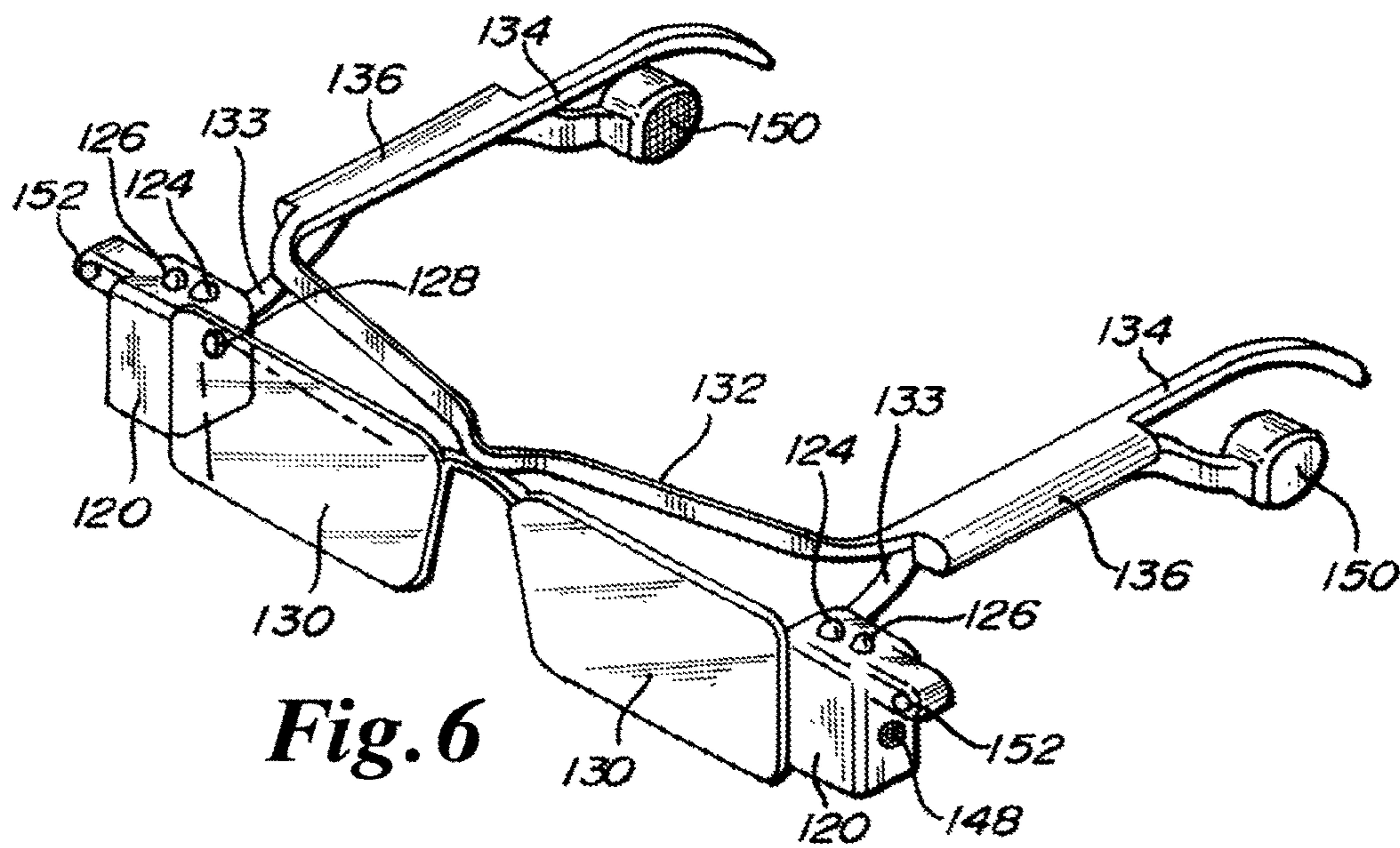

Fig. 6

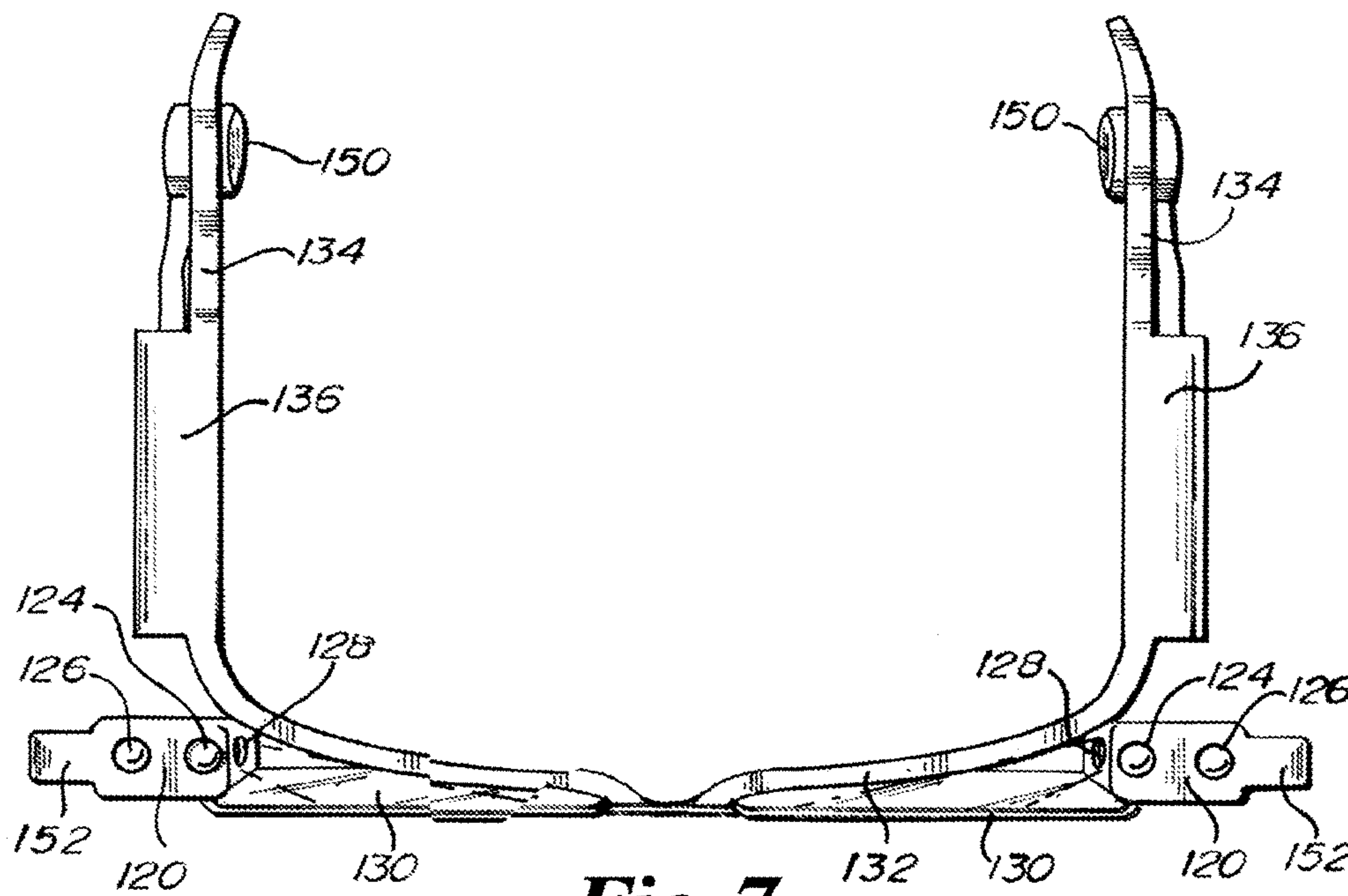

Fig. 7

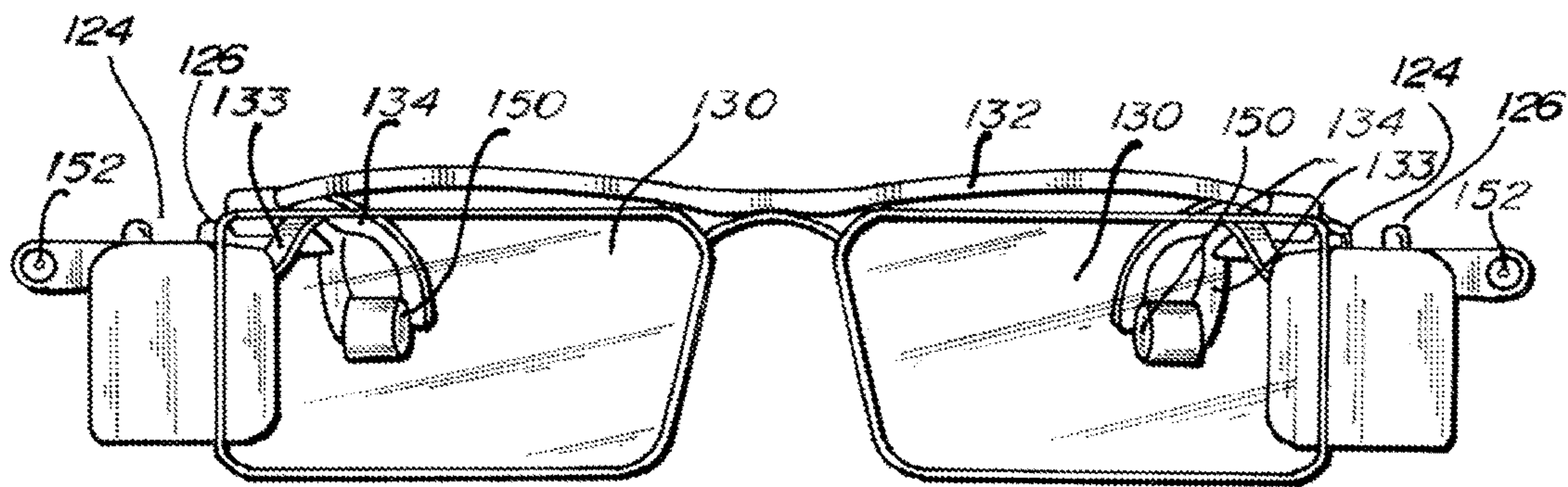

Fig. 8

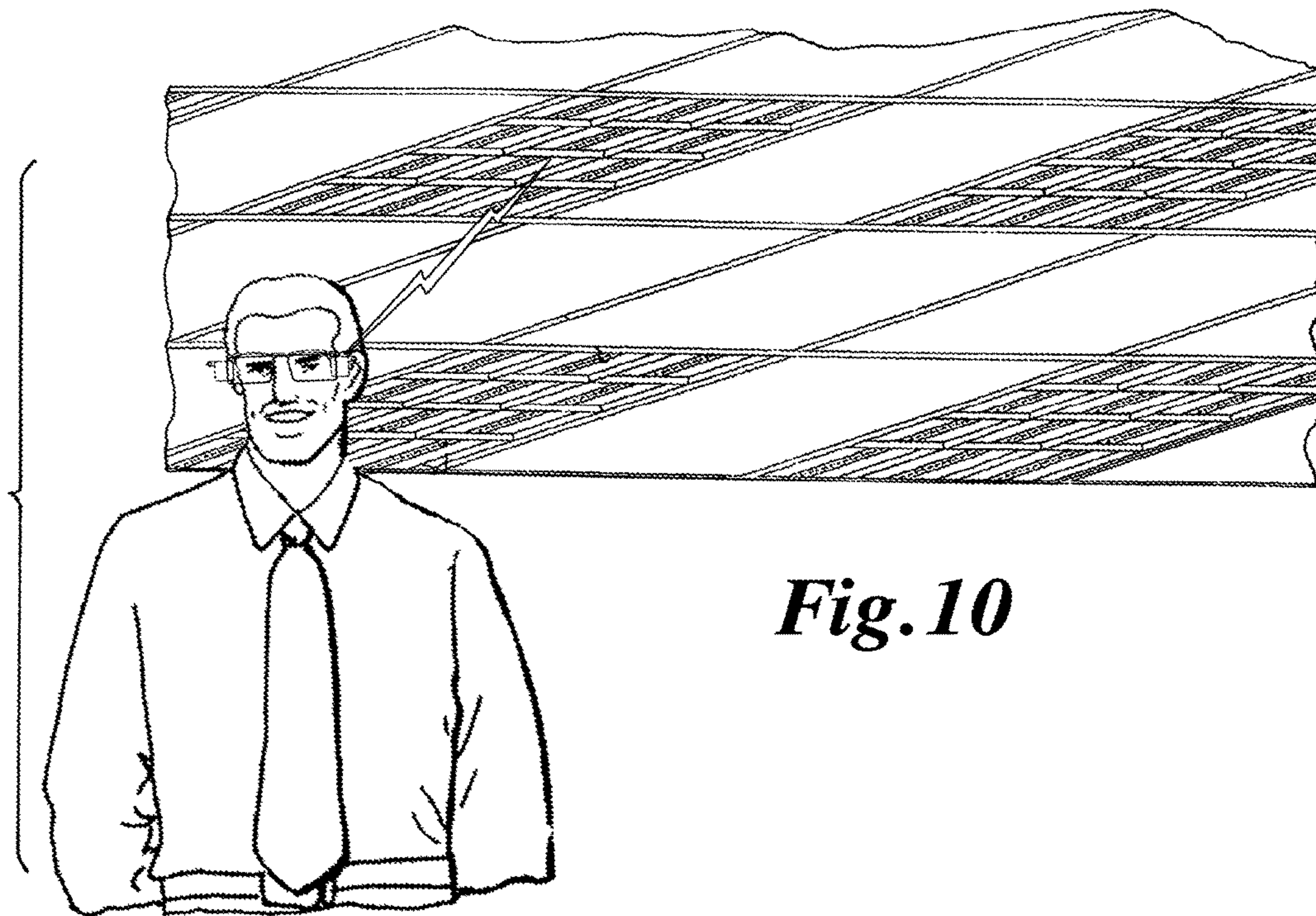
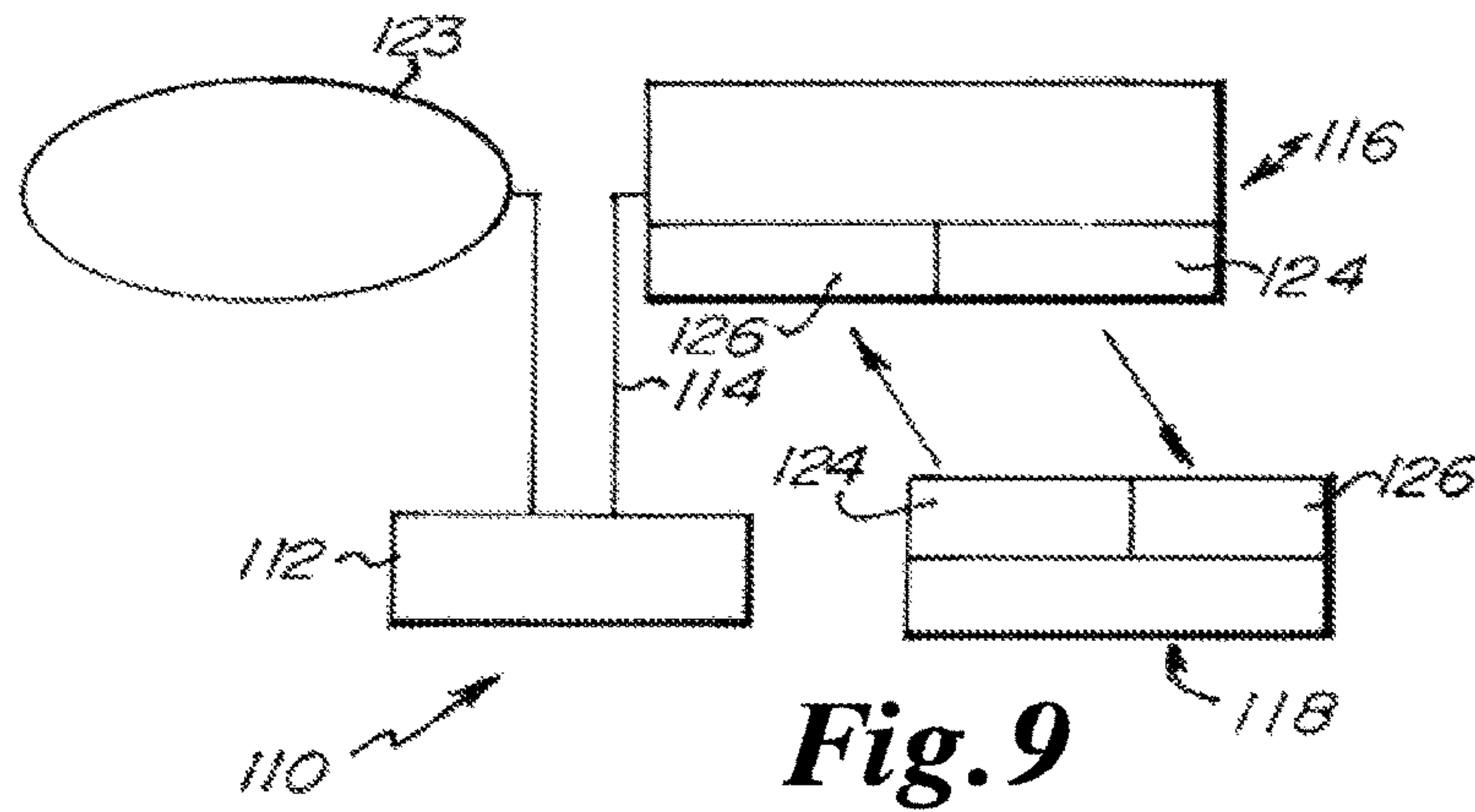
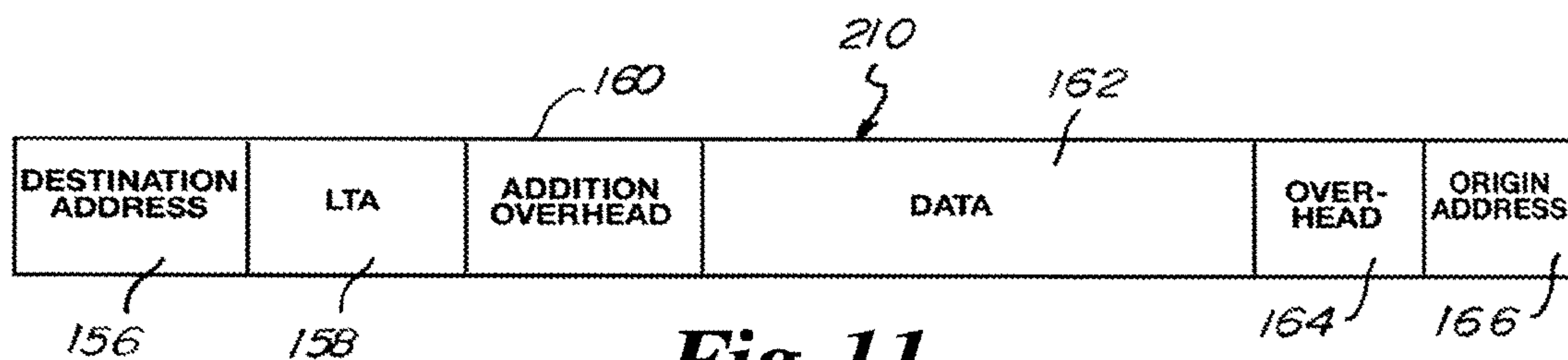

Fig. 10



VISIBLE LIGHT COMMUNICATION TRANSCEIVER GLASSES

In some embodiments the Visible Light Communication Transceiver Glasses utilize pulsed light communication as disclosed in U.S. patent application Ser. No. 14/546,218, filed Nov. 18, 2014, issued as U.S. Pat. No. 9,654,163; U.S. patent application Ser. No. 12/750,796, filed Mar. 31, 2010, issued as U.S. Pat. No. 8,890,773; U.S. Provisional Patent Application No. 61/165,546, filed Apr. 1, 2009; U.S. patent application Ser. No. 12/126,529, filed May 23, 2008, issued as U.S. Pat. No. 8,188,878; U.S. Provisional Application Ser. No. 60/931,611, filed May 24, 2007; U.S. patent application Ser. No. 12/126,227, filed May 23, 2008, issued as U.S. Pat. No. 8,687,965; U.S. patent application Ser. No. 12/126,342, filed May 23, 2008, now abandoned; U.S. patent application Ser. No. 12/126,647, filed May 23, 2008, now abandoned; U.S. patent application Ser. No. 12/126,469, filed May 23, 2008, now abandoned; U.S. patent application Ser. No. 12/126,589, filed May 23, 2008, issued as U.S. Pat. No. 8,188,879; U.S. patent application Ser. No. 12/032,908, filed Feb. 18, 2008; U.S. patent application Ser. No. 11/433,979, filed May 15, 2006; U.S. Pat. No. 7,046,160, issued May 16, 2006; U.S. Pat. No. 6,879,263, issued Apr. 12, 2005; U.S. patent application Ser. No. 12/254,587, filed Oct. 20, 2008, issued as U.S. Pat. No. 7,902,978; U.S. Provisional Patent application No. 60/405,379, filed Aug. 23, 2002; and U.S. Provisional Patent Application Ser. No. 60/405,592, filed Aug. 23, 2002, the entire contents of which are all expressly incorporated herein by reference. Applicant also incorporates by reference herein patent application Ser. No. 10/646,853, filed Aug. 22, 2003, issued as U.S. Pat. No. 7,439,847 and Provisional Patent Application No. 60/248,894, filed Nov. 15, 2000, the entire contents of each being expressly incorporated herein by reference.

This application is a continuation of U.S. patent application Ser. No. 14/546,218 filed Nov. 18, 2014, issued as U.S. Pat. No. 9,654,163, which is a continuation application of U.S. patent application Ser. No. 12/750,796, filed Mar. 31, 2010, issued as U.S. Pat. No. 8,890,773 which claims the benefit of the filing date of U.S. Provisional Patent Application No. 61/165,546, filed Apr. 1, 2009.

In some embodiments the Visible Light Communication Transceiver glasses 10 are related to display or virtual reality glasses, examples of which may be identified in U.S. Pat. Nos. 7,224,326 B2; 7,062,797 B2; 6,816,132 B2; 6,452,572 B1; 6,160,666; 6,097,543; 6,084,555; 5,737,060; 5,619,373; and 5,347,400 the entire contents of which are all incorporated by reference herein in their entireties.

BACKGROUND OF THE INVENTION

Present communication techniques using wireless communication, including radiofrequency transmissions, (RF) raise security concerns because transmissions using RF can be easily intercepted, in part because of the fact that RF signals are designed to radiate signals in all directions. Also, radiofrequency transmissions may be regulated by the Federal Communications Commission (FCC) which may control the frequencies that may be used for RF transmission. Further, RF by its very nature is susceptible to interference and produces noise.

In contrast to RF communications, light sources used for communication are extremely secure due to the fact that the transmissions of light are of practical limited distance. Also, because the visible spectrum is not regulated by the FCC, light sources can be used for communications purposes

without the need of a license. Light sources are also not susceptible to interference, nor do they produce noise that can interfere with other devices.

Light emitting diodes (LEDs) may be used as light sources for data transmission, as described in U.S. Pat. Nos. 6,879,263 and 7,046,160. LEDs have a quick response to "ON" and "OFF" signals, as compared to the longer warm-up and response times associated with fluorescent lighting, for example. LEDs are efficient in the production of light, as measured in lumens per watt. Recent developments in LED technology, such as high brightness blue LEDs, have paved the way for white LEDs, which have made LEDs a practical alternative to conventional light sources. This combination of lighting and communication allows ubiquitous light sources such as street lights, home lighting, and office building lighting, for example, to be converted to, or supplemented with, LED technology to provide for communications while simultaneously producing light for illumination purposes.

In addition to use as general lighting, LEDs may be used in networking applications. In any network, a variety of client devices may communicate with one or more host devices. The host may provide connection to a Local Area Network (LAN), sometimes referred to as an Intranet, owing to the common use of such a network entirely within an office space, building, or business. The host may additionally or alternatively provide connection to a Wide Area Network (WAN), commonly describing a network coupling widely separated physical locations which are connected together through any suitable connection, including for exemplary purposes, but not solely limited thereto such means as fiber optic links, T1 lines, Radio Frequency (RF) links including cellular telecommunications links, satellite connections, DSL connections, or even Internet connections. Generally, where more public means such as the Internet are used, secured access will commonly separate the WAN from general Internet traffic. The host may further provide access to the Internet.

A variety of client devices may be enabled to connect to host devices. Such client devices may commonly include computing devices of all sorts, ranging from hand-held devices such as Personal Digital Assistants (PDAs) to massive mainframe computers, and including Personal Computers (PCs). However, over time many more devices have been enabled for connection to network hosts, including for exemplary purposes printers, network storage devices, cameras, other security and safety devices, appliances, HVAC systems, manufacturing machinery, and so forth.

In the past, digital images and information have been displayed on LCD, Plasma or LED computer screens or Cathode Ray Tubes (CRT's) in various sizes and colors. In addition, information has been transmitted to larger audiences through the projection of information and images onto larger screens. These types of communications have also utilized audio capabilities by attaching speakers to the viewing devices, in order to enhance the presentation of information similar to watching Television screens of today.

In the past the automotive industry has attempted the use of Heads-up display technology to improve reaction time for the driver and reduce distraction, by projecting digital information onto the front windshield of the automobile. Information containing speed and turning indicator direction was typical for the types of information communicated in a Heads-up display. Upon initial deployment of the automotive Heads-up display technology, the information projected upon the windshield could not be altered, and therefore was perceived as limited in scope.

In the past the military developed what is termed as a “heads-up display” or (HUD) for pilots of Military planes and helicopters. The HUD reduced pilot distraction, thus improving the safety of flying or operating aircraft. The HUD projected vital flight information and images proximate to the windshield of the aircraft and was visible to the pilot’s and co-pilot during flight. Information such as speed, altitude and fuel levels were among the information displayed in a HUD. The information projected onto a pilot’s heads-up display screen originated from the output of equipment located internal to the aircraft via communication cables. Nearly all Heads-up Display devices were encumbered with electrical and communication cables that connected physically to remote devices offering broadcast information or images in close proximity to the person using the equipment.

Limited consumer grade equipment has also become available in the occluded version of vision glasses which is primarily utilized in gaming or Television. This equipment may be worn in similar fashion to glasses, but without the benefits of transparency.

True interactive, transparent, Mobile Heads-up Display, Wearable Glasses, or Virtual Retina Display Glasses are not yet available and the present devices fail to offer transparent viewing with clear information enhancements.

Some mobile wearable head gear apparatus designed to provide interaction with the user have been linked to a host server by Radio Frequency mediums, usually supplied by a wireless carrier or within a mesh network of unlicensed RF medium networks. These RF medium networks may be connected to much more powerful host data infrastructures, but given the current nature of RF Technology of today, the networks are not well suited for multiple clients using multiple high bandwidth consuming devices in close proximity of each other. Channel selection for individual use is typically unlicensed and unstructured there-by limiting use or capability.

In addition to being potentially unlicensed and unstructured, RF technology is not able to support the necessary bandwidth requirements in a safe manner to human tissue: to drive content rich information for the viewer.

Heads-up Display, Wearable Glasses, or Virtual Retina Display glasses obscure the normal vision of the person wearing the device. Many challenges are created as the user attempts to stabilize the movement which may create a safety concern during use of known Heads-up Display, Wearable Glasses, or Virtual Retina Display glasses.

Law Enforcement personnel have utilized portable computers mounted in a patrol car to one side of the officer. While the officer was checking information regarding a suspicious vehicle, he or she would be required to take their eyes off the vehicle in question and or the person(s) occupying or adjacent the vehicle, in order to observe the data displayed on the portable computer monitor or screen. This action reduces the effectiveness of the officer’s reaction time to erratic movement or behavior and creates a potential hazard for the officer’s safety.

No known forms of transparent Heads-up Display, Wearable Glasses, or Virtual Retina Display glasses are available to hospitals. As a patient is being attended to during a medical procedure, the doctor or nurse is required to review a patient’s medical information at a portable computer stand located somewhere in close proximity of the doctors or nurses. Time sensitive information, such as x-rays or biological test results may direct the medical doctor or nurse away from the patient potentially reducing the effectiveness of the medical treatment.

The known Heads-up Display, Wearable Glasses, or Virtual Retina Display Glasses, communicate in a single direction, which is considered as a download to the user. This can be accomplished by augmented data overlaid onto a reflective material.

RF Linked Devices are not currently able to support the necessary bandwidth requirements in a safe manner; to drive content rich information for the viewer.

BRIEF DESCRIPTION OF THE DRAWINGS

FIG. 1 is an isometric view of one embodiment of the visible light communication transceiver glasses.

FIG. 2 is a top view of one embodiment of the visible light communication transceiver Glasses.

FIG. 3 is a front view of one embodiment of the visible light communication transceiver Glasses.

FIG. 4 is a side view of one embodiment of the visible light communication transceiver Glasses.

FIG. 5 is an alternative environmental perspective view of one embodiment of the visible light communication transceiver Glasses.

FIG. 6 is an alternative environmental perspective view of one embodiment of the visible light communication transceiver Glasses.

FIG. 7 is an alternative top detail view of one embodiment of the visible light communication transceiver Glasses.

FIG. 8 is an alternative front detail view of one embodiment of the visible light communication transceiver Glasses.

FIG. 9 is a block diagram of one embodiment of the Visible Light Communication Glasses System.

FIG. 10 is an environmental view of one embodiment of the Visible Light Communication Transceiver Glasses System.

FIG. 11 is a block diagram of one embodiment of a data packet.

BRIEF DESCRIPTION OF THE INVENTION

RF Linked Devices do not offer all of the necessary levels of security compared to Visible Light Embedded Communications (VLEC) link of information traversing between the device and the host plexus.

In addition to being unlicensed and unstructured, RF technology is not able to support the necessary bandwidth requirements in a safe manner: to drive content rich information for the viewer. Still, regarding RF Linked Devices: the security levels of the content of information compared to a Visible Light Embedded Communications link of information, traversing between the device and the host plexus are at great risk. Heads-up Display, Wearable Glasses, or Virtual Retina Display glasses obscure the normal vision of the person wearing the device. This limits the movement and creates a safety concern.

In some embodiments it is desirable to provide a set of Visible Light Communication Transceiver Glasses (VLCTG’s) in which a user may view real-world surroundings or over animated simulation, thus reducing potential motion sickness or vertigo.

In some embodiments, on the host VLEC network or plexus, having back-end presence awareness, servers may be fully integrated into a complete IT plexus, without the constraints and bottlenecking limitations of RF enable infrastructures, and the tethering of a wire line infrastructure to perform multiple forms of communication for the Client user to share and interact with other client VLCTG’s in a plexus configuration.

In some embodiments as in Mobile Educational Classrooms, Professors may provide virtual classrooms while enhancing the experience for the student, by providing the student with a closer interaction ability in part due to the flow of information through the use of VLCTG's.

In at least one embodiment, the integration of VLCTG's with a Visible Light Embedded Communications Transceiver Host consisting of LED's transmitting, and a Photo Diode receiving, embedded light communication packets, permit communication and interaction into a Local area network or Wide area network, forming an Intranet or extranet, and coupled with a presence awareness server, and some predetermined legacy equipment, where upon a user may issue verbal commands or brainwave or other activities that act as commands to an intelligent presence awareness server. The Intelligent presence awareness server may include a vast database of information pertinent or personal to the specific user. A command string of information may be received by the "Visible Light Communication Display Glasses Client" and through a digitally computed process, the output of the chip couples the information immediately to the Visible Light Communication Display Glasses, which is then passed on electrically to the projector or Visible Light Communication Transceiver client interface located at some predetermined point on the Visible Light Communication Display Glasses.

In at least one embodiment the communication of information by Visible Light Embedded Communications, will traverse the Visible Light Communication link to a Visible Light Communication Transceiver Host. This host will continue to pass on the Visible Light Embedded Communication packets through a predetermined high capacity high bandwidth plexus or network. With regards to plexus or network connectivity, A Serial, USB, 1+N-base RJ-45 or Fiber optic connection may be in communication with a host Visible Light Embedded Communications fixture system, which is in communication with a host network processor. The host Visible Light Embedded Communications fixture replaces conventional stationary lighting fixtures to provide optical communication between the host and the client or user device through the Serial, USB, 1+N base RJ-45 or Fiber optic connection. The host Visible Light Embedded Communications fixture is preferably constructed an arranged to communicate data through pulsed light transmissions.

In some embodiments, the Visible Light Communication Transceiver Glasses provide internet access and communication capability between an individual and residential and commercial locations.

In some embodiments, the VLCTG's may be electrically coupled to a processor/controller which is used to process the light received from a Visible Light Embedded Communication source, to provide for display of various types of images and/or messages. The processor/controller may be, or include features of, a field programmable gate array and/or a direct logic circuit.

Individual light sources as a portion of the Visible Light Communication Transceiver Glasses system may be in electrical communication with other Visible Light Communication Transceiver Glasses through the use of suitable pulsed light communications network.

In some embodiments, the LED light sources on a set of Visible Light Communication Transceiver Glasses may be electrically coupled in either a parallel or series manner to a processor/controller. The processor/controller may also be in electrical communication with the power supply and the LEDs, to regulate or modulate the light intensity or signal

for the LED light sources. In some embodiments, the processor/controller may be, or include features of, a field programmable gate array or direct logic circuit.

The Visible Light Communication Transceiver Glasses may also include photodetector receiver diodes coupled to the processor/controller, where the photodetector receiver diodes are constructed and arranged for receipt of pulsed LED light signals for conversion to digital information, and for transfer of the digital information to the processor/controller for analysis and interpretation. The processor/controller may then issue a transmission to a projector for display of an image on the lense(s), or may issue other communication signals to an individual, in order to communicate the content of received information transmitted via a pulsed LED light carrier.

The art referred to and/or described herein is not intended to constitute an admission that any patent, publication or other information referred to is "prior art" with respect to this invention. In addition, this section should not be construed to mean that a search has been made or that no other pertinent information as defined in 37 C.F.R. § 1.56(a) exists.

All U.S. patents and applications and all other published documents mentioned anywhere in this application are incorporated herein by reference in their entireties.

Without limiting the scope of the invention, a brief summary of some of the claimed embodiments of the invention is set forth below. Additional details of the summarized embodiments of the invention and/or additional embodiments of the invention may be found in the Detailed Description of the Invention below.

A brief abstract of the technical disclosure in the specification is provided for the purposes of complying with 37 C.F.R. § 1.72.

DETAIL DESCRIPTION

For the purposes of this disclosure, like reference numerals in the figures shall refer to like features unless otherwise indicated.

In one embodiment as depicted in FIGS. 1 through 8 the Visible Light Communication Transceiver Glasses are referred to generally by reference numeral **118**. In this description the Visible Light Communication Transceiver Glasses **118** may also be referred to as VLCTG or VLCTG's **118**.

The VLCTG's **118** may in some embodiments be formed of two lenses **130**. In other embodiments the VLCTG's **118** may be formed of a single lens **130**. In some embodiments the lenses **130** are engaged to and supported by a frame **132** which may include side supports **134** which may engage in individual's ears.

In some embodiments, on each side support **134**, a battery **136** may be provided. The battery **136** may in some embodiments be rechargeable, and in other embodiments be replaceable. The battery **136** may also be integral with, or releasably attached to, side supports **134**.

In some embodiments, ear speakers **150** may be engaged to frame **132** on each side support **134**. Ear speakers **150** are also in electric communication with the respective battery **136** and controller/processor **120**. Controller/processor **120** processes received pulsed/encrypted visible light signals into digital signals to be generated by projector **128** onto lenses **130**. Controller/processor **120** also processes received pulsed/encrypted visible light signals into digital signals to be generated as audible communications from speakers **150**. Ear speakers **150** may be constructed and arranged for

positioning proximate to, or for insertion within, an individual's ear. Ear speakers **150** may also, in certain embodiments, include electrical connectors to facilitate replacement with other types of speakers **150**, which may have different audible specifications and/or dimensions.

In some embodiments, frame **132** may include lower frame elements **133** which may support controller/processor **120** on frame **132**. Controller/processor **120** is positioned to the outside of, and proximate to, each lens **130** of VLCTG's **118**. Each controller/processor **120** is in communication with projector **128**. Each projector **128** includes a light source which generates a signal as communicated by controller/processor **120**, for display of an image, text, symbol, or other communication or information on inside of lenses **130**.

In some embodiments, lenses **130** are transparent permitting display images generated by controller/processor **120** to appear on lenses **130** as see-through images in a manner similar to a heads up display or HUD.

In some embodiments, lenses **130** may include desired optical coatings in order to facilitate display of images thereupon.

In some embodiments, each controller/processor **120** includes a microphone **148**. Microphone **148** detects audible signals generated by an individual for processing within controller/processor **120**. Controller/processor **120** may include voice recognition programming software in order to receive and execute voice commands as generated by an individual during use of the VLCTG's **118**. In some embodiments, an individual may issue a voice command as detected by microphone **148**, to direct controller/processor **120** to change software applications, to search for information, to generate communications for transmission to a server optical transceiver (XCVR) as a pulsed/encrypted light signal, or to change channels or power down the VLCTG's **118**. It should be noted that the above identified voice commands are provided as examples of the types of commands which controller/processor **120** may recognize for execution, and that the above identified examples are not exhaustive and/or are not limiting with respect to the types of commands and/or actions which may be taken by controller/processor **120** during use of VLCTG's **118**.

In some embodiments, at least one LED transmitter **124** and at least one photodetector receiver diode **126** are disposed proximate to, and/or on top of, controller/processor **120**. Each of the LED transmitters **124** are in electrical communication with the controller/processor **120** in order to generate pulsed/encrypted light signals for transmission of information to an XCVR **116** as integral to a network plexus. The controller/processor **120** creates and regulates the duty cycle and pulsation of the LED transmitters **124**, in order to transmit information which may be in the form of data packets for detection by photodetector receiver diodes **126** integral to XCVR's **116**. Communication of information and/or signals may thereby be generated by controller/processor **120** integral to VLCTG's **118** for transfer through the network plexus for receipt at a desired location.

In some embodiments, each of the photodetector receiver diodes **126** are in electrical communication with the controller/processor **120** in order to detect and receive pulsed/encrypted light signals as generated by an XCVR **116** from a network plexus. The photodetector receiver diodes **126** receive the transmissions of information via pulsed light signals from the network plexus, and electrically transfer the signals or information to the controller/processor **120** of the VLCTG's **118**, for processing. The controller/processor **120**

then generates electrical signals to the projector **128** for display of images and/or information on the interior or exterior of lenses **130**.

In some embodiments, a camera **152** is disposed on, engaged to, or in contact with, each controller/processor **120**. Camera **152** is in electrical communication with controller/processor **120** to record images and/or video as digital signals. Images and/or video as recorded by camera **152** may be stored in memory integral to controller/processor **120**, and/or may be processed for transmission as pulsed light communications by LED transmitters **124** to XCVR **116** for communication to a desired location within the network plexus.

In some embodiments, camera **152** continuously records images, and in other embodiments, recording of images by camera **152** may be initiated by voice activation commands. In some embodiments, camera **152** may be similar in specifications and operation to cameras provided and available on cellular telephones.

In some embodiments, VLCTG's **118** may include an on/off button and/or a switch **168** which may be disposed on the bottom of one of the controller/processor **120**.

In some embodiments, controller/processor **120** may include a port which is constructed and arranged for receipt of an electrical wire which is used to interface with a handheld device. The handheld device may be used to implement commands into controller/processor **120** to provide a user with the ability to switch applications, channels, and/or functions to be performed by the VLCTG's **118**. In some embodiments, the handheld device may include a keypad and may be in the form of a personal digital assistant or PDA type of device.

In some embodiments, the elements of the LED transmitters **124** and/or the photodetector receiver diodes **126** may be disposed at other locations about the controller/processor **120**. In some embodiments, the handheld device or PDA may include LED transmitters **124** and/or photodetector receiver diodes **126** where upon the handheld device and the VLCTG's **118** may communicate through the transmission and receipt of pulsed/encrypted light signals. Commands as related to applications, channels, and/or functions may thereby be transmitted by handheld device to controller/processor **120** for operation of VLCTG's **118**.

In at least one embodiment, the projector **128** will utilize liquid crystal displays (LCD's) or organic light emitting diodes. A lens may also be used to magnify the displays to enlarge the image on the lenses **130** of the VLCTG's **118**. In some embodiments, the projector **128** may display two images simultaneously, one for each eye of the user of the VLCTG's **118**. The correct alignment of the images on the lenses **130** of the VLCTG's **118** assist a user's brain to form a composite image from the two images, providing a sense of depth in the formation of a 3D image. This is known as stereoopsis.

In some embodiments, the VLCTG's **118** are binocular or biocular. In some embodiments binocular display on the VLCTG's **118** will create two slightly different images one to each eye, where biocular displays project one image that is visualized simultaneously by both eyes. At least one embodiment, a combination of binocular and biocular images may be used in association with the VLCTG's **118**. In some embodiments, the VLCTG's **118** may also display images so that a user feels immersed into the display. In at least one embodiment, the VLCTG's **118** are non-immersion enabling a user to at least partially see adjacent surroundings.

In some embodiments, the VLCTG's **118** relieve eye stress and/or cyber stress during use. In other embodiments, a user of the VLCTG's **118** may adjust the interpupillary distance between the lenses **130**.

In some embodiments the camera **152** may capture 752× 480 images at 60 FPS to deliver a single 1504×480 side-by-side image for viewing in 3D stereoscopic video. In some embodiments the camera **152** provides for increased resolution or decreased resolution of an image compared to the image described above.

In some embodiments the VLCTG's **118** may permit diopter adjustment of +3.5 D to -3.5 D. for each eye which may be separately and continuously adjustable. In some embodiments, the camera **152** may record, and the projector **128** may project, images having areas of resolution greater or less than 640×480 pixel's per eye. In some embodiments the VLCTG's **118** provide a field of view of 32° which may be equivalent to a screen size of 45-inch and 2 m (6.5 feet) distance.

FIG. **9** depicts a block diagram for an embodiment 110 of an LED light and communication system including Visible Light Communication Transceiver Glasses **118**. FIG. **9** shows a server PC **112** connected via a USB cable **114** to a server optical transceiver (XCVR) **116**, and a set of Visible Light Communication Transceiver Glasses **118** having an optical transceiver. The server PC **112** may be in communication with a network **123** via a CAT-5 cable, for example. An exemplary optical XCVR (or, simply, "XCVR") circuit includes one or more LEDs **124** for transmission of light and one or more photodetectors **126** for receiving transmitted light. The term "photodetector" includes "photodiodes" and all other devices capable of converting light into current or voltage. The terms photodetector and photodiode are used interchangeably herein. The use of the term photodiode is not intended to restrict embodiments of the invention from using alternative photodetectors that are not specifically mentioned herein.

In at least one embodiment, the XCVR circuit may include an RS232 to USB conversion module. The transmit pin on the USB conversion module may drive the driver electronics for the LEDs. In some embodiments, the XCVR circuit includes high intensity LEDs. In some embodiments it may be desirable to use high intensity LEDs to enhance lighting, to improve data transmission, or both. In at least one embodiment, a 12 volt DC 3 amp power supply is sufficient for powering one or more high intensity LEDs.

In some embodiments, the XCVR circuit further includes an amplifier for amplifying the optical signal received by the photodiodes. The output of the amplifier may be fed into level shifting circuitry to raise the signal to TTL levels, for example. The signal may be fed into the receive pin of the RS232 to USB module.

In some embodiments, a 9V battery can be used to power the amplifier circuitry. Significant noise is generated by switching high brightness LEDs on and off at 200 mA and 500 kbps, for example. Powering the amplifier with a battery may reduce these noise problems by reducing or removing transients.

It should be noted that in some embodiments, the LED can both emit and receive light. In such an embodiment, the LED may act both as a transmitter or receiver. More information on such bi-directional LEDs can be found in U.S. Pat. No. 7,072,587, the entire contents of which are expressly incorporated herein by reference.

The use of pulsed light as the communications channel between a set of Visible Light Communication Transceiver Glasses **118** and host, offers an advantage in security,

reliability, system testing and configuration, bandwidth, infrastructure, and in other ways. Security is greatly increased because pulsed light signals do not go through walls, in contrast to radio communications, and steps can be taken to obstruct visible transmissions with a much greater certainty than with high frequency radio waves. Furthermore, the visible pulsed light may additionally be limited or directed by known optical components such as lenses and reflectors to selectively form beams, as opposed to omnidirectional transmissions.

Set-up, testing, troubleshooting and the like are also vastly simplified. When the light communication system is working, the user may actually visualize the illumination and the communication as projected by the projector **128** on one or more lense(s) **130**. If an object interferes with light transmission, the user will again immediately recognize the same. Thus, the ease and convenience of this Visible Light Communication Transceiver Glasses System adds up to greater mobility and less cost. In addition, relatively high energy outputs may be provided where desired, using the preferred visible light communications channel, since the human eye is adapted and well-protected against damage from light. In contrast, many invisible transmission techniques such as Ultraviolet (UV) or Infra-Red (IR) systems have much potential for harm.

In at least one embodiment a host lamp fixture system or a stationary (mounted in a particular place) lighting fixture may be used in order to communicate data. Inside of LED lights there may be one or many diodes; these may pulsate on slightly different frequencies from a single light to communicate. Each may be looking for changes by way of Multiple Channel Access or other suitable technique.

When a client using a set of Visible Light Communication Transceiver Glasses **118** inputs or initiates a request for channels, the host **112** may respond with the location of the channels. LED lights **124** in a ceiling, for example, will communicate with any capable transceiver. One suitable method may use BPL (Broadband over Power Lines) for network connection, taking data and embedding the data into a carrier frequency or group like radio, but instead using power lines or wave guides for transmission throughout an existing set of power lines within a building. Thus, a building may be wired only for lights, saving a huge infrastructure of other wires and fixtures, saving a great deal of money.

In at least one embodiment, the optical XCVRs **116**, or circuitry attached thereto, include modulation circuitry for modulating a carrier signal with the optical signal. Modulation can be used to eliminate bias conditions caused by sunlight or other interfering light sources. Digital modulation may be accomplished by using phase-shift keying, amplitude-shift keying, frequency-shift keying, quadrature modulation, digital coding, code spreading modulation, orthogonal frequency division multiplexing, digital coding, code spreading modulation, orthogonal frequency division multiplexing, or any other digital modulation technique known by those of ordinary skill. Similarly, such XCVRs **116** can include demodulation circuitry that extracts the data from any received signals. Modulation and demodulation techniques are described in U.S. Pat. Nos. 4,732,310, 5,245,681, and 6,137,613, the entire contents of each being expressly incorporated herein by reference.

It may be desirable in some embodiments to further include filters or filter circuitry to prevent unwanted light from being amplified. For example, the optical baseband signal may be modulated at 100 kHz and then transmitted. The XCVR **116** that receives the 100 kHz modulated signal

may include a filter stage centered at 100 kHz. The filtered 100 kHz signal may then be input into the amplifier circuitry, thereby preventing amplification of unwanted signals. In some embodiments, it may be desirable to amplify the transmitted signal first, and then filter out the baseband signal.

In one embodiment, an Internet Provider, connected to the Internet, provides Internet Access via fiber optic cable, or other transmission medium, to a power substation (4 kV-30 kV, for example). In order to inject the signals onto the power lines, a power line bridge may be provided that may modulate, alter, or otherwise adapt the Internet signals (not shown) for transmission over the power lines. As mentioned above, this is a simplification. More information may be found in U.S. Pat. No. 7,349,325, the entire disclosure of which is expressly incorporated herein by reference. As used herein, the term "power line bridge" is used to denote any device that is capable of injecting Internet signals onto power lines, whether it is located at a substation or power line, home, business, etc., or any device that can extract an Internet signal from the power lines in a home, business, etc.

In at least one embodiment, data signals may exit the distribution substation on the distribution bus (not shown) which may then be injected onto the power lines (either overhead or, preferably, underground). In at least one embodiment, the power lines may be fed to street lights. Each street light may be adapted to use an optical XCVR **116**, such as those described above. Although it is envisioned that current street lamp light sources would be replaced with optical XCVRs **116**. In some embodiments, the optical XCVRs **116** may be used in conjunction with current street lamp light sources. Prior to broadcasting the data via a light signal from the LED street light, the data must be extracted via demodulation techniques from the power supplied to the street light (not shown).

Using street lamps and/or other light LED sources as an Internet connection point, takes advantage of the ubiquity of street lighting for transmission of communications to and from the Visible Light Communication Transceiver Glasses **118**. Generally, electricity is supplied to street lamps or LED lighting fixtures via underground cables and through internal wiring. This design significantly reduces the amount of RF noise radiated during transmission of the signals. And, when finally broadcast, the signal is in the form of light, and is thus not a source of RF noise.

In at least one embodiment, the street lights and/or LED lighting form an optical link with customers which may be using a pair of Visible Light Communication Transceiver Glasses **118**. The optical XCVRs **116** in the street lights or LED lighting transmit light to and receive light from the optical XCVRs that are used by an individual.

In at least one embodiment, a set of Visible Light Communication Transceiver Glasses **118** provides Internet access to a customer. The customer's VLCTG's **118** may be in operative communication with a power line bridge. The power line bridge may modulate the signal sent via the street light or other LED light source and injects the modulated signal onto electrical wiring, usually at 120-240 VAC for transmission from an LED light source **124** for reception by the photodetectors **126** integral to the Visible Light Communication Transceiver Glasses **118**. In at least one embodiment, the modulated signal is injected onto the electrical wiring at the electrical mains feed at the circuit breaker panel. This embodiment may inject the signal to all electrical circuits at a designated location, providing access to the signal on each electrical circuit in the location. In some embodiments, rather than injecting onto the electrical wiring

at the electrical mains feed at the circuit breaker panel, the modulated signal can be injected onto specific electrical circuits, if desired.

In at least one embodiment, after signals are injected onto the electrical wiring, a number of methods may be available for transmitting the data to the end user. In some embodiments, another power line bridge is used to demodulate the signal from the electrical power. For example, a power line bridge similar to a BellSouth® Powerline USB Adapter may be used. Of course, a power line bridge may also be Ethernet compatible. The power line bridge may plug into an electrical outlet, demodulate the signal from the electrical power, and transmit the signal to electronic equipment providing Internet access.

In at least one embodiment, the signal is in operative communication with the electronic equipment via cables, such as Ethernet cables.

In other embodiments, the power line bridge plugged into the electrical outlet includes an optical XCVR **116**, and instead of cables, an optical link provides the transmission medium to the electronic equipment which may be a set of Visible Light Communication Transceiver Glasses **118**. Of course, in such an embodiment, another optical photodetector receiver in communication with the Visible Light Communication Transceiver Glasses **118** which receives and transmits data.

In some embodiments, an optical XCVR **116** provides lighting for one or more rooms on the customer premises. In operative communication with the optical XCVR **116** may be a power line bridge that demodulates the signal from the electrical power that supplies power to AC/DC converter that supplies power to the LED array of the XCVR **116**. The power line bridge sends the demodulated signal to the optical XCVR **116** for transmission.

It can be desirable, however, to modulate the light signal prior to transmission to reduce the effects of external lighting. The light sent via the optical XCVR **116** over the optical link may be received by another optical XCVR in communication with the Visible Light Communication Transceiver Glasses **118** and may be demodulated, as described above. Such an embodiment may be desirable because each room at a customer premise may be either designed for, or retrofitted with, optical XCVRs **116** in the ceiling, for example, for lighting. As such, the main light source in the room doubles as an optical link for the Visible Light Communication Transceiver Glasses **118**. Because the optical XCVRs **116** are located in the ceiling, there are few items that can block the light signal to the VLCTG's **118**.

Injecting the signal onto the electrical wiring and providing an optical link through LED lighting is advantageous over wireless DSL modems. Often times, metal shelving or other structures on the premises interfere with or even block RF signals, thereby requiring multiple access points. However, providing an optical link through LED lighting in each room, for example, inherently provides multiple access points.

In an alternative embodiment, Internet access is provided to a customer's electrical wiring by standard Broadband over power line techniques, without the use of LED lighting in street lights, for example, such as described in U.S. Pat. No. 7,349,325 incorporated by reference herein in its entirety. However, once the signal is on the customer's electrical wiring, it can be extracted and broadcast over an optical link using optical XCVRs, as described above.

In another embodiment of the invention, Visible Light Communication Transceiver Glasses **118** (VLCTG) and/or user interface devices may include optical XCVRs **116**, as

shown in FIG. 10. The photodetector receiver, and LED transmitters of a set of VLCTG 118 communicates with the optical XCVRs 116 that are also acting as room lighting, hall lighting, or other lighting in a customer's facility. Of course, the optical XCVRs 116 can be placed in numerous other locations as lighting sources. Using the XCVRs 116 as light sources can reduce energy consumption and simplify communications by reducing the filtering or modulation complexities necessary to distinguish data signals from extraneous lighting sources. An individual may use a set of VLCTG 118 in order to broadcast and receive data over an optical link using the XCVR 116 to a ceiling mounted fixture.

Visible Light Communication Transceiver Glasses 118 may also include features commonly found in standard security identification badges, including but not limited to such attributes as anti-counterfeiting features for an assigned indicia such as employee identification number, or name. An embedded non-alterable electronic, visible, sonic or other identification codes may also be provided in Visible Light Communication Transceiver Glasses 118.

In at least one embodiment a projector 128 and photodetector receiver diodes 126 are provided and enable communication over an optical communications channel. A microphone 148, and ear speakers 150 may be provided to integrate an auditory communication channel between communication VLCTG 118 and the network plexus. A camera, or video camera 152 may be incorporated to capture video or still pictures. In at least one embodiment, images may be displayed by projector 128 on lenses 130 incorporated into VLCTG 118, permitting information to be displayed thereon, which for exemplary purposes could comprise either text, images or graphics as well as other types of communications.

Depending upon the intended application for which VLCTGs 118 are being designed, the VLCTG's 118 may include various video resolution and/or display specifications, and the camera 152 may include various resolution specifications. Information may also be communicated continuously to the VLCTG's 118 or upon request or by polling.

Visible Light Communication Transceiver Glasses 118 communicate with XCVR 116 through use of LED light sources 124. LED light sources 124 may include at least one, and preferably a plurality of LEDs, which may also be in communication with photodetector receiver diodes 126. The one or more photodetector receiver diodes 126 may be broad spectrum detectors or alternatively color-filtered or sensitive to only a single color. The types of detectors utilized will be determined by well-known considerations such as sensitivity, reliability, availability, cost and the like.

A variety of physical and electrical configurations are contemplated herein for LED light source 124. An LED light source 124 may replace a standard fluorescent tube light fixture. This can be accomplished by replacing the entire fixture such that ballasts and other devices specific to fluorescent lighting are replaced. In many cases, this will be the preferred approach. The fixture may then be wired for any suitable or desired voltage, and where a voltage or current different from standard line voltage is used, transformers or power converters or power supplies may be provided. When a building is either initially being constructed, or so thoroughly remodeled to provide adequate replacement of wires, the voltage may be generated in transformers that may be provided outside of the occupied space, such as on the roof, in a utility room, basement or attic. In addition to other benefits, placement in these locations will further reduce requirements for air conditioning.

As efficiencies of light generation by LEDs are now beginning to surpass fluorescent tubes, such entire replacement is more economical. However, total replacement of such fixtures is not the only means contemplated herein. Any lesser degree of replacement is also considered in alternative embodiments. For exemplary purposes, the physical reflectors commonly associated with fluorescent fixtures may be preserved, and the fixture simply rewired to bypass any ballasts or starter circuitry that might be present. In this case, line voltage, such as 120 VAC at 60 Hertz in the United States, may pass through the electrical connector pins. In at least one embodiment, a base of an LED light source 124 may be designed to insert directly into a standard fluorescent socket, such as, for exemplary purposes only, and not limited thereto, the standard T8 and T12 sockets used in the United States. In such case, either red, green, or blue LEDs may be arranged and wired to directly operate from line voltage, or appropriate electronics will need to be provided directly in LED base to provide necessary power conversion. In yet another conceived alternative embodiment, power conversion may be provided through switching-type or other power conversion circuitry to alleviate the need for any rewiring, though in these instances the power conversion circuitry will need to accommodate the particular type of ballast already in place.

Where other types of fixtures already exist, such as standard incandescent Edison screw bases, LED bulbs may similarly accommodate the fixture. For incandescent replacement, no rewiring or removal of ballasts is required, since line voltage is applied directly to incandescent fixtures. Consequently, appropriate conversion may in one conceived alternative embodiment simply involve the replacement of a bulb with no fixture or wiring alterations.

For LED light source 124 to replace an existing bulb, regardless of type, and benefit from the many features enabled in the preferred embodiment, communications circuitry must also be provided. This communications circuitry is necessary to properly illuminate each of the red, green and blue LEDs to desired color, to transport data through an optical communications channel.

In accord with at least one embodiment of the invention, LEDs are used to transmit through optical communication channel several kinds of data, including identity, location, audio and video information. The use of an optical communications link provides large available bandwidth, which in turn permits multiple feeds of personal communication between LED light sources 124 and VLCTG's 118 similar to or in excess of that of cell phones. The optical data is transferred at rates far in excess of those detectable by the human eye, and so a person is not able to detect any visible changes as the data is being transferred. Additionally, because optical illumination is constrained by opaque objects such as walls, the location of a set of VLCTG's and associated person can be discerned to a particular room, hallway or other similar space.

Some embodiments of the VLCTG's 118 include any or all or any combination of the following devices: a microphone 148, ear speaker 150, a rechargeable battery 154, and a video camera 152. In at least one embodiment, the microphone 148 is in communication with an analog-to-digital converter (ADC)(not shown) for converting the analog speech input to a digital signal. An amplifier circuit can be used to boost the microphone signal. The signal can be amplified prior to or after the ADC. In some embodiments, the speakers 150 are in communication with a digital-to-analog converter (DAC)(not shown) for converting the received digital signal to an analog output. An amplifier

circuit can be used to boost the speaker signal. The signal can be amplified prior to or after the DAC. The processor **112** may convert the digital signals from the microphone/amplifier to data packets that can be used for transmission by the optical XCVR **116**. Similarly, the processor **112** may convert the data packets received by the optical XCVR **116** to audio out signals directed to the VLCTG's **118** and speakers **150**. The processor **112** can convert data packets received from or directed to the video camera **152**. The term "processor" as used herein refers to a processor, controller, microprocessor, microcontroller, or any other device that can execute instructions, perform arithmetic and logic functions, access and write to memory, interface with peripheral devices, etc. The processor/controller also may be, or include features of, a field programmable gate array or direct logic circuit.

In such an embodiment, the user can use the VLCTG's **118** as a communication and/or recording device. Alternatively, the user may use the VLCTG's **118** to stream music, or video. Furthermore, the optical XCVR **116** and/or the VLCTG's **118** may also include non-volatile memory (FLASHRAM, EEPROM, and EPROM, for example) that can store firmware, as well as text information, audio signals, video signals, contact information for other users, etc., as is common with current cell phones.

The optical XCVR **116** and VLCTG's **118** may each include one or more photodetector receiver diodes **126** for receiving transmitted LED or other light signals, and one or more LEDs **124** for transmitting LED signals. In some embodiments, an optical signal amplifier is in communication with the photodetector receiver diodes **126** to increase the signal strength of the received light signals. In at least one embodiment, the LEDs **124** are in operative communication with an LED power driver, ensuring a constant current source for the LEDs.

In some embodiments, the VLCTG's **118** may include circuitry that performs modulation, demodulation, data compression, data decompression, up converting, down converting, coding, interleaving, pulse shaping, digital coding, code spreading modulation, orthogonal frequency division multiplexing, and other communication and signal processing techniques.

In at least one embodiment, the VLCTG's **118** are embedded with a unique code, similar in principle to the MAC address of a computer, for example. Thus, every VLCTG **118** has a unique identifier. The VLCTG **118** broadcasts the unique code at regular intervals, or irregular intervals if desired. Optical XCVRs **116** located within the user's building and near the user can then receive the unique code transmitted by the VLCTG **118**.

There are numerous applications of such a design. For example, in some embodiments, an optical XCVR **116** may be engaged to a door lock. When a user with a set of VLCTG **118** approaches a locked door, the VLCTG's **118** broadcasts a unique code, and an optical XCVR **116** in communication with the door lock receives the code, and if acceptable, unlocks or opens the door. A table of acceptable codes may be stored in a memory device that is in communication with, and accessible by, the door's optical XCVR **116**. Alternatively, the door's optical XCVR may transmit a code to a central station that compares the user's code against a table of approved codes and then sends a response either allowing or denying access.

In some embodiments a person walking down a hallway may receive a phone call on their VLCTG's **118** from a person on the other side of the world, as long as the other person was using the Internet to communicate, and knew the

unique code of the VLCTG's **118**. Such communication is possible because the Internet is based upon transmission of packetized data, a form ideally suited for use with an optical XCVR **116**.

In at least one embodiment, the VLCTG's **118** may be used in conjunction with the LED lighting in hallways, rooms, etc. to reduce energy consumption. For example, all the lights in a hallway may have a standby setting such that they are relatively dim or even off. As a person with a set of VLCTG's **118** proceeds down a hallway, the lights in front of the person turn on in response to a transmitted signal (e.g. the unique code of the VLCTG **118**). As the person moves beyond a light, the light returns to its standby setting of dim/off brightness through a signal communicated from a XCVR **116** at a sufficiently remote location to indicate that the individual has passed, and is no longer present at this particular location. The presence of an individual proximate to an XCVR **116** may be determined by either recognition of a signal, or through the failure to continue to recognize a signal, or by a proximity calculation as based on a controller receiving a signal from a remote location, which indicates recognition of a VLCTG **118**. A proximity may then be calculated where initial or previous XCVR light sources are extinguished as an individual passes a particular location. In other embodiments, the lights can gradually become brighter, as a percentage of full brightness, as a person approaches, and then gradually dim, as a percentage of full brightness, as a person moves away based on proximity calculation as earlier described.

The XCVR's **116**, in accordance with an embodiment of the invention, may have AC wiring with data carriers such as S-BPL, and static locations encoded into the system. Thus a person entering a hallway with a set of VLCTG's **118** could use only those lights needed for his travel. As the person progresses toward a destination, the lights behind the person may be no longer needed and so may be programmed to turn off. These lights could function variably from 10 to 100% brightness as needed, for example. In at least one embodiment when a person has traveled, lights may be extinguished, in effect providing a moving "bubble" of illumination surrounding person wearing a set of VLCTG's **118**.

In at least one embodiment of the present invention, extent of human interaction required to control various functions such as light switches and thermostats, is reduced while simultaneously increasing the capabilities of such controls. Individual or selected groups of lights may be selectively configured for optimal physiological and psychological effects and benefits for one or more applications, and then may be readily reconfigured without changes to physical structures for diverse applications having different requirements for optimal physiological and/or psychological effects and benefits. Such embodiments are an improvement over conventional motion detectors, due to the "smart" nature of the optical XCVRs **116** as integrated for communication with VLCTG's **118**. Rather than waiting for a time delay, as is the case with motion detectors, the optical XCVRs **116** (and in some embodiments the optical XCVRs **116** in conjunction with software) in the lighting fixture, recognize immediately that the person has moved beyond a particular light, allowing that particular light to be dimmed or turned off. Also, this smart technology may be used to turn lights on only for people with the correct code embedded in their VLCTG's **118**. In such an embodiment, the user can walk into a restricted area, and if not authorized to be there, the lights would remain off, and if authorized the lights would turn on.

In some embodiments, the VLCTG **118** may be used to assist emergency personnel. For example, if a person with a VLCTG **118** had an incapacitating emergency condition while walking along a hallway in a building with optical XCVRs **116**, as in the embodiments described above, the hallway lighting can be modified to direct emergency workers directly to the injured person. The lights can be made to flash, change color, or form directional arrows, or sequential directional indicators, or otherwise signify to the emergency personnel the quickest path to the person.

In at least one embodiment a building employing an encoded light network/plexus may incorporate multiple safety features. Instead of relying on several security guards at several stations to read badges and monitor each station, a proximity detector may first detect whether a VLCTG **118** is passing through the entrance. If so, the adjacent LED light source will query for an appropriate or legitimate communications code or signal. Even if detected, if a VLCTG **118** has been duplicated, preferred logging and verification through software will instantly identify that the first person is already in the building. Consequently, the presently entering person and the person already in the building can both be located, and the intruder identified.

In at least one embodiment, if audio and/or video is additionally enabled by a user, video of the VLCTG's **118** can be used to capture the last-known conditions of a user or an area. This can be important during medical treatment or diagnosis or in the event a disaster strikes that results in significant destruction of property or life.

In at least one embodiment, the VLCTG's **118** may be in communication with an intelligent audio/visual observation and identification database system which may be coupled to sensors as disposed about a building. The combined system may then build a database with respect to temperature sensors within specific locations, pressure sensors, motion detectors, communications between and locations of VLCTG **118**, phone number identifiers, sound transducers, and/or smoke or fire detectors. Recorded data as received from various sensors may be used to build a database for normal parameters and environmental conditions for specific zones of a structure for individual periods of time and dates. A computer may continuously receive readings/data from remote sensors and/or VLCTG's **118** for comparison to the pre-stored or learned data, to identify discrepancies therebetween. In addition, filtering, flagging and threshold procedures may be implemented to indicate a threshold discrepancy to signal initiation of an investigation. The reassignment of priorities and the storage and recognition of the assigned priorities occurs at the computer to automatically recalibrate the assignment of points or flags for further comparison to a profile prior to the triggering of a signal representative of a threshold discrepancy.

In at least one embodiment of the present invention, the VLCTG's **118** may incorporate guidance and communications systems. For exemplary purposes, consider the situation where a visitor wishes to meet with a regular building occupant. The visitor may be guided through the use any suitable color or intensity indicator pattern displayed on the VLCTG's **118** such as but not limited to flashing patterns, color changes or the like on an observed map, or other similar direction indicator in a heads-up display to the location or person they seek. Further, once within the same building space, the person being sought out may further be made conspicuous by similar changes in color intensity pattern or indicator within the sought-person's VLCTG **118**. Once again, such system control using the LEDs of the present invention is simply a matter of software control.

In those embodiments where audio signaling or communications are enabled for the VLCTG's **118**, and owing to the exact room position detection afforded by the present invention, location specific access intelligence may also be incorporated. As but one example, if a doctor is in a surgical room, a pager feature of the VLCTG's **118** may remain silent. Once the doctor exits surgery, then the pager may be reactivated. This control may be automatic, simply incorporated into the programming of the system. As another example, students may use the preferred VLCTG **118** for communications similar to cellular telephones, including text messaging, voice communications, web access, and so forth. This communication may occur through the use of voice recognition over microphone **148** or as a result of an interface with a supplemental electronic device such as a PDA by keys. However, upon entering a classroom, communications might in one embodiment then be disabled, ensuring the students are not distracted with unauthorized activities. In addition to the foregoing, audio and video communications are possible in accord with light communications in locations and environments where cellular or radio communications may be impossible, forbidden, or unreliable, extending existing communications systems.

Another embodiment of the present invention incorporates Global Positioning System (GPS) information into the data packet to be sent via network to a pair of VLCTG's. The Global Positioning System is described in U.S. Pat. No. 4,785,463, the entire contents of which are expressly incorporated herein by reference. GPS positioning uses one or more coordinate systems, such as World Geodetic System 1984 (WGS84), to provide a reference frame, allowing every point on earth to be coded with a unique GPS location.

GPS systems and cell phone triangulation techniques are typically only accurate to one or several hundred feet. Horizontally, this prior art precision is adequate for many applications. However, vertically several hundred feet could encompass twenty floors in an office or apartment building. In at least one embodiment the VLCTG's **118** are in communication with the plexus and are capable of GPS precision to a room or light fixture, improving GPS accuracy. The use of the VLCTG's **118** in association with the network plexus can locate a person immediately, even in a large area and/or among a large crowd, and can keep track of a large population simultaneously. As noted, the large bandwidth permits video signals to be integrated with VLCTG's **118** location and movement, providing the opportunity to create audio-video records that are fixed in time and location.

Since location may be relatively precisely discerned, optical transmitter or LEDs may in one embodiment be integrated with projector **128** to display colors, flash, or otherwise generate a visible or audible signal to assist with directional guidance, personnel or intruder identification, energy management, or to facilitate the meeting and connection of individuals. To achieve these objectives, a building needs to be wired only for lights, saving a huge infrastructure of other wires and fixtures.

In some embodiments a data packet **210** may include GPS location header bits that include the packet's destination address **156** in GPS coordinates. The data packet may further include GPS location trailer bits that include the packet's origin address **166** in GPS coordinates. The data packet may further include the address in GPS coordinates of the overhead optical XCVR that most recently transmitted the packet **158** (the last known transmission address, or LTA), as will be described in more detail below. The data packet further includes the data **162** to be transmitted, and

may include any other bits of information determined to be necessary for successful transmission of data, such as error detection bits.

Routing data packets from one location to another location can be accomplished using GPS location information tags data packets having a geographic location instead of a cyber location. Such an embodiment eliminates the need for any later geographic location translation because a data packet starts with geographic source and destination information. This simplifies locating the destination of the data packet.

In some embodiments, each data packet is assigned a GPS origin/destination address as it passes through the network infrastructure. The data packet is always searching for the next closest GPS address location. Each stationary (or static) optical XCVR **116**, and some dynamic optical XCVRs, within a network will be designated with a GPS location number. As a data packet passes through the network, it is routed by the optical XCVRs, with their internal processors, to the next physically closer optical XCVR within the network. If another optical XCVR is within receiving range, or is connected with another form of communication medium, that optical XCVR receives the data packet. The optical XCVR's internal processor compares its internal GPS location address (ILA) to the data packet's GPS destination address and the optical XCVR's last known transmission address (LTA) stored within the data packet as originating from the individual VLCTG's. If the ILA code is closer to the data packet destination address than the LTA code stored within the data packet, the optical XCVR's processor inserts its ILA code into the data packet as the new LTA code and then repeats transmission of the entire data packet with the updated LTA code.

The network continues this process until the data packet reaches the destination optical XCVR **116** which then transmits the data packet to a pair of VLCTG's **118**, at which point the data packet is projected or otherwise communicated to an individual. If a piece of the infrastructure is missing, the packet will be rerouted to the next nearest optical XCVR **116** and continue until it finds the shortest pathway through the network to the destination address.

Furthermore, the data may be communicated in a mesh-fashion, where each XCVR lamp directly communicates with adjacent XCVR lamps and does not require central communications or processing. As a result, with little if any infrastructure required, other than visible light encapsulated communication illumination and appropriate processors and programming for each XCVR lamp, signals may be quickly and directly routed from origin to destination.

This means that each user on the network may declare one or more static positions and also may have a dynamic position. A static address may be a home, an office, etc. When a user leaves their static address location to move through the network infrastructure, the user then becomes dynamic. The network may track the user as the user passes optical XCVRs **116**, similar to that of cell phones in relation to cell phone towers, and provide a dynamic address location. If a data packet begins with a destination address that is the user's static address, the network may update the packet with the user's new dynamic address and reroute the packet accordingly, in a scheme similar to that of cellular phones.

In some embodiments, the memory of a user's optical XCVR as integrated or engaged to a VLCTG **118** stores the unique code, the static GPS location address, or both, of another user's optical XCVR in its "phone book", like a cell phone. In at least one embodiment, the optical VLCTG's

include a display, also like a cell phone, that allows a first user to find a second user's information and initiate communication with the second user.

In some embodiments, a channel access method like time division multiple access (TDMA) may be used to generate and/or receive pulsed light signals. TDMA splits a signal into timeslots, with each user transmitting only in their allotted time slot. One of ordinary skill will recognize that frequency division multiple access (FDMA), code division multiple access (CDMA), or other channel access method may be used to allow multiple VLCTG's **118** to transmit to a single optical XCVR **116**.

In one embodiment the system controller/processor **120** will continuously record and store in real time the received pulsed light communication signals for individual VLCTG's **118** in one or more system databases, one or more subsystem databases, or individuals specific databases, in order to assist in the establishment of normal routine parameters for designated locations or areas within a facility.

Depending upon the communications channel, in some embodiments a variety of client connection devices such as a VLCTG's **118** may be in communication with other VLCTG's **118** utilizing PCMCIA or PC cards, serial ports, parallel ports, SIMM cards, USB connectors, Ethernet cards or connectors, firewire interfaces, Bluetooth compatible devices, infrared/IrDA devices, and other known or similar components.

Driver circuitry and LEDs may pass any signals to the optical link for other devices designed to communicate with VLCTG's **118**. Driver circuitry may, in some embodiments, provide appropriate buffering, isolation, modulation or amplification, which will provide appropriate voltage and power to adequately drive LED emitter into producing a visible light transmission. Exemplary of common driver circuits may be operational amplifiers (Op-amps) and transistor amplifiers, though those skilled in the art of signal conditioning will recognize many optional circuits and components which might optionally be used in conjunction with the present invention.

In some embodiments, Visible Light Embedded Communication, or VLEC, as taught herein in association with use of a set of VLCTG's **118** is a secure last mile solution to many diverse communications needs. Last mile refers to the final portion of any communications system, and it is commonly known that the last mile normally demands the vast majority of expense and difficulty in establishing and maintaining a system. Light Emitting Diodes, or LEDs, provide with a set of VLCTG's provide a communications channel while simultaneously affording flexible illumination. Using LEDs to provide visible lighting and to embed communications therein enables the present invention to improve security and provide higher capacity over that known in the prior art. The LED link is untethered and enables a communication link with nomadic devices. The link is untethered in that the user is independent of any one host, and may get the same information at other optical hosts.

In some embodiments, access to a BPL or Broadband over power line system, data is carried as a signal through existing mediums like fiber-optic cable, radio waves, conventional telephone lines, or through the Visible Light Embedded Communications (VLEC) around high-voltage lines. It is then injected into the power grid downstream, onto medium or low voltage wires to businesses and homes. Through advanced electronic equipment, the signal makes its way to Industrial parks and neighborhoods. Customers may then gain access via a VLEC source and ferry the data

back and forth to their VLCTG's through computers or through a Client VLEC Dongle or other appropriate adapter.

In at least one embodiment, communication through the use of VLCTG's **118** can further be shared with optically-enabled name tags, telephones, TV and music, Internet, public address, computing devices of all sorts, ranging from hand-held devices such as Personal Digital Assistants (PDAs) to massive mainframe computers, and including Personal Computers (PCs) printers, network storage devices, building maintenance wiring such as thermostats, HVAC systems, fire alarms, motion detectors, cell phones, and any other electrical or electronic apparatus existing or appearing within the room or space, other security and safety devices, appliances, manufacturing machinery, and so forth. Essentially, any device which incorporates or can be made to incorporate sufficient electronic circuitry may communicate with a set of VLCTG's to exchange information at any time. Advantageously, many different conditions or devices may be simultaneously monitored and/or controlled when they are broadcasting information through the preferred network, because they are operating on a wide-bandwidth optical link. This information can be used anywhere on the network, which includes the other rooms or a central server.

The host fixtures may be configured to manage the relationship of VLCTG's **118** associated with this technology. They can also manage peer to peer relationships to provide redundancy or act as part of an infrastructure void of multiple transport medium interconnects. The host may provide intelligent packet analysis whereby false or inadvertent light photons can be discarded. The means of recognition or validation can be provided by multiple checks and verifications. The host fixtures and clients may each be assigned a unique Machine Access Code and Electronic Serial Number. The Machine Access Codes and Electronic Serial Numbers may be assigned by the certified manufacturer's plant and matched against a unique relationship table residing on various certified servers. The VLCTG's may then move about a LAN, an entire office building, a WAN or other network and achieve maximum throughput rates similar to that of the location they originated. An added benefit of the preferred visible light embedded communications comprised by optical communications channel is that, with increased bandwidth, back end software for synchronizing data on PDAs and other mobile devices may be improved by almost 5 fold over RF applications as the transport mediums, avoiding the communications channel bottleneck from RF.

In at least one embodiment, the VLCTG's **118** may be used with many different types of exemplary communications that may be provided incorporating the VLEC technology. Access to the World Wide Web will be enabled through network access to allow users the benefit of web surfing. VLEC technology allows this access to be untethered and nomadic, even though beyond a building or space the network access may be further coupled using conventional cable, Internet Service Provider (ISP) links such as satellite or dial-up, DSL, or other suitable link. AV communications may include various device interface applications such as appliance communications or manipulation and automated manufacturing. HDTV is further contemplated, including mobile HDTV, mobile gaming and interactive TV, but other types of video are additionally contemplated herein, including Slow-Scan TV (SSTV) or other known systems for capturing video information. Telecommunications and personal communications may further be enabled, for exemplary purposes using Voice Over Internet Protocol (VOIP) and mobile voice recognition. While communications are conceived as occurring between a plurality of hosts

and individual VLCTG's simultaneously, in many instances one set of VLCTG's **118** will only be coupling one data stream at a time with a host.

In at least one embodiment, location based services may be provided as a use of the Visible Light Communication Transceiver Glasses which may have the added advantage of improved and secure content. One example is a consumer shopping mall where general consumers can walk around and discover the exact location of the goods or services they need. This is accomplished by simply providing a portal for any business to place information about their goods and services within the pulsed light plexus for receipt by a set of VLCTG's. The information may also be incorporated into the BPL infrastructure by means of application controlling devices which link to the overall office or place of business to the VLCTG's

In at least one embodiment, the Visible Light Communication Transceiver Glasses are a lens screen-based device which is worn similar to eyewear. In one embodiment, the invention may include a Visible Light Ebedded Communication (VLEC) Transceiver Glasses Interface; for use in association with Visual heads-up Display or Virtual Retinal Display glasses technology in both occluded and transparent models. The Visible Light Communication Transceiver Glasses are preferably safe and include improved information flow, enhanced visual perspective, and communication in daily human activities. The VLCTG's will provide real-time information and two way audio and video communications to the user and offering a greater sense of improved integration to the flow of information.

In some embodiments a single pair of VLCTG's may act as a media center for one person, or a plurality of people. In some embodiments the invention will be integrated with a host network/plexus in Visible Light Embedded Communication (VLEC) technology, and when in use may act as a simple pair of reading glasses, or in some cases a pair of prescription glasses for individuals with corrective lenses.

In some embodiments, the Visible Light Communication Transceiver Glasses (VLCTG) may function as an ocular enhanced Heads-up Display, Wearable Glasses, or Virtual Retina Display glasses.

In some embodiments the VLCTG will provide mobile social networking. In some embodiments the VLCTG will integrate Visible Light Embedded Communications technology. The integration of the Visible Light Embedded Communications with the VLCTG may act as a client device on a host network or IT network/plexus, without the constraints and bottlenecking limitations of RF medium enabled infrastructures. In some embodiments, the VLCTG will eliminate any need for tethering of a wire line Infrastructure to perform multiple duties and having full duplex communication capabilities for the Client. In some embodiments, the VLCTG will provide a user with the ability to share and interact with other client devices in a network/plexus configuration. Sharing and interacting with other client devices may be achieved by providing a higher thru-put path of information back and forth to and from the VLCTG, thus reducing the amount of computing power needed on the local client device itself. In some embodiments the VLCTG are of reduced weight which allows more advanced optical display technology to be incorporated into the design of the device.

In some embodiments the VLCTG may be used in association with Mobile Educational classrooms; Schools and Universities may provide virtual classroom enhancements while optimizing the experience for the student by providing the student with closer interaction ability which in part may

be due to the flow of information, and presentation of educational material, as a result of higher bandwidth and greater security.

In some embodiments the VLCTG may be used in Law Enforcement activities. In at least one embodiment, an officer may process live investigation of a suspect without loss of observation of the suspect through use of a pair of Transparent Visible Light Communication Transceiver Glasses. In at least one embodiment an officer may issue audible information requests through voice command technology which is integrated into the overall design of the VLCTG. The Visible Light Communication Transceiver Glasses will transmit the request to the officers' car or as part of a Visible Light Communication Transceiver network/plexus, through another XCVR light within proximity of the officer. During this time the officer may maintain focus on the suspect. Because of the high data bandwidth available through the Visible Light Communication Transceiver network/plexus the requested information is immediately returned to the officer for follow-up. Images and audio content with certain alert features may be communicated to the officer, and provide the officer with necessary time to react accordingly.

In at least one embodiment, fleet management, asset management, and/or personal locator services may be provided through use of a set of VLCTG's, providing greater accuracy, as updates to inventory or asset databases are no longer limited by the computing power of a remote device. In at least one embodiment, the VLCTG improves and expands a users' ability to access and collaborate on increased volume of information about their surroundings. By using the VLCTG in its transparent mode, a user may stay alert to the location of an asset, or keep track of inventory and people, as they move product through out a building. In at least one embodiment, the VLCTG will enable a user to issue search commands to a database, to access business information while moving throughout the facility safely. In at least one embodiment, the use of VLCTG reduces accidents and improves an employee's efficiency by eliminating un-necessary travel of the employee about or extension to a structure.

In at least one embodiment the VLCTG are integrated with a Visible Light Embedded Communications Transceiver Host consisting of LED's transmitting, and Photo Diodes receiving pulsed light communication into and out of, the Local area network/plexus or Wide area network/plexus, forming an Intranet or Extranet. In at least one embodiment, each individual set of VLCTG will have a unique identification symbol, number, letter or character permanently mated to the device, and recorded in an archived database.

An image such as a face or other object may be recorded digitally by a camera **152** in communication with the VLCTG which then converts the image into a Visible Light Embedded Communication packet for transmission through a network/plexus for processing by a server. The processor in turn will communicate the identity and information about an image or object back down stream through the network/plexus for communication by Visible Light Embedded Communication packets for receipt by the optical receptors integrated to VLCTG for receipt of information as transmitted through a projector **128** upon the lense of the VLCTG.

In at least one embodiment cameras **152** may be attached to the VLCTG to aid in the facial or object recognition. In some embodiments, a plurality of cameras may be oriented on a specially designed pair of Visible Light Embedded Communication Transceiver Glasses to provide a separate

controlled viewing advantage. In at least one embodiment, this would enhance the mobile peer- to peer- to peer collaboration technology. In some embodiments users of the VLCTG may view scenes or objects from various remote locations through the light-weight cameras **152** as attached to the VLCTG which may provide a high definition video and high definition audio information.

In some embodiments, use of the VLCTG improves mobility, user safety, user response time and enhances the capacity for multiple tasks by multiple users which may be completed across a Visible Light Embedded Communications link. In some embodiments use of the VLCTG will significantly improve activity in a condensed proximity environment like a Classroom setting or business conventions.

In at least one embodiment, with regards to a plexus or network connectivity, a Serial, USB and 1+N-base ethernet, or Fiber optic connection may be in communication with a host Visible Light Embedded Communications fixture system, which in turn may be in communication with a host network processor. In some embodiments the host Visible Light Embedded Communications fixture may replace conventional stationary lighting fixtures to provide optical communication between the host and VLCTG's. In some embodiments, the host Visible Light Embedded Communications fixture may be preferably constructed and arranged to communicate data through pulsed light transmissions.

In at least one embodiment, an LED light and communication device is provided comprising:

Visible light communication transceiver glasses comprising:

a frame comprising at least one lens, at least one light emitting diode, and at least one photodetector, the at least one light emitting diode receiving power from a power source, the frame further comprising at least one processor in communication with the at least one light emitting diode and the at least one photodetector, the processor being constructed and arranged to illuminate the at least one light emitting diode to simultaneously create at least one first light signal, and at least one second light signal, the first light signal being observable to the unaided eyes of an individual and the second light signal not being observable to the unaided eyes of the individual, wherein the second light signal comprises at least one data packet; and

at least one projector on said frame, said at least one projector being in communication with said at least one processor for display of at least one image on said at least one lens; a microphone proximate to said frame, said microphone being in communication with said processor; a speaker proximate to said frame, said speaker being in communication with said processor; said processor comprising memory; said processor further comprising voice recognition software; said processor further comprising voice activation software; a camera; the at least one data packet comprising global positioning system (GPS) location information; a switching device in communication with said at least one processor; said switching device is a remote unit which is in communication with said processor through use of another of said second light signals; the Visible Light Communication Transceiver Glasses include a unique identifier; and the unique identifier is stored in non-volatile memory.

This completes the description of the embodiments of the invention. Those skilled in the art may recognize other equivalents to the specific embodiment described herein which equivalents are intended to be encompassed by the claims attached hereto.

What is claimed is:

1. An LED light and communication device comprising: visible light communication transceiver glasses comprising:
 - a frame comprising at least one lens, at least one light emitting diode, and at least one photodetector, said at least one photodetector constructed and arranged for receipt of at least one pulsed light communication signal, said at least one pulsed light communication signal comprising light in a visible spectrum, said frame further comprising at least one processor in communication with said at least one light emitting diode and said at least one photodetector, said processor being constructed and arranged to activate said at least one light emitting diode to generate at least one light communication signal comprising light in said visible spectrum, said at least one pulsed light communication signal or said at least one light communication signal comprising encryption; and
 - at least one projector on said frame, said at least one projector being in communication with said at least one processor for display of said at least one pulsed light communication signal on said at least one lens.
2. The LED light and communication device of claim 1, said at least one pulsed light communication signal comprising at least one of an embedded image, information, and data.
3. The LED light and communication device of claim 1, said at least one light communication signal comprising at least one of an embedded data packet, image, and information packet.
4. The LED light and communication device of claim 1, further comprising an identifier.
5. The LED light and communication device of claim 4, said at least one identifier comprising global positioning system (GPS) location information.
6. The LED light and communication device of claim 4, further comprising non-volatile memory, wherein said identifier is stored in non-volatile memory.

7. The LED light and communication device of claim 4, said frame further comprising at least one speaker, said at least one speaker being in communication with said at least one processor.
8. The LED light and communication device of claim 7, further comprising a microphone proximate to said frame, said microphone being in communication with said processor.
9. The LED light and communication device of claim 8, said processor further comprising voice recognition software or voice activation software.
10. The LED light and communication device of claim 8, further comprising a camera.
11. The LED light and communication device of claim 4, further comprising a switching device in communication with said at least one processor.
12. The LED light and communication device of claim 11, further comprising a visible light communication transceiver host network processor, said visible light communication transceiver host network processor being in communication with a local area network or wide area network.
13. The LED light and communication device of claim 11, said visible light communication transceiver host network processor comprising intelligent presence awareness software or specific user information.
14. The LED light and communication device of claim 1, wherein said at least one pulsed light communication signal is projected onto said at least one lens as a semi-transparent communication or as a heads up display.
15. The LED light and communication device of claim 1, said frame further comprising at least one port, said at least one port being in communication with said at least one processor, said at least one port being constructed and arranged for receipt of an electrical wire interfacing said at least one processor to a handheld electronic device.

* * * * *