

US010253916B2

(12) **United States Patent**
Tjader

(10) **Patent No.:** **US 10,253,916 B2**

(45) **Date of Patent:** **Apr. 9, 2019**

(54) **PIPE REPLACEMENT SYSTEM**

USPC 405/184.1, 184.2, 184.3
See application file for complete search history.

(71) Applicant: **TT Technologies, Inc.**, Aurora, IL (US)

(72) Inventor: **Michael Tjader**, New Richmond, WI (US)

(56) **References Cited**

(73) Assignee: **TT Technologies, Inc.**, Aurora, IL (US)

U.S. PATENT DOCUMENTS

(*) Notice: Subject to any disclaimer, the term of this patent is extended or adjusted under 35 U.S.C. 154(b) by 0 days.

3,934,647	A *	1/1976	Bokenkamp	E21B 43/013 166/347
4,309,128	A *	1/1982	Williams	E03F 3/06 138/97
4,340,322	A *	7/1982	Springett	F16L 1/203 405/154.1
4,674,914	A	6/1987	Wayman et al.	
4,719,991	A *	1/1988	Diehn	B65H 75/38 137/355.26
4,738,565	A	4/1988	Streatfield et al.	
4,745,879	A *	5/1988	Shishkin	B28B 19/0023 118/105

(21) Appl. No.: **15/859,120**

(22) Filed: **Dec. 29, 2017**

(65) **Prior Publication Data**

US 2018/0119867 A1 May 3, 2018

(Continued)

Related U.S. Application Data

OTHER PUBLICATIONS

(63) Continuation of application No. 14/679,384, filed on Apr. 6, 2015, now Pat. No. 9,885,441, which is a continuation of application No. 13/722,004, filed on Dec. 20, 2012, now Pat. No. 8,998,538.

“U.S. Appl. No. 13/722,004, Advisory Action dated Sep. 4, 2014”, 3 pgs.

(Continued)

(60) Provisional application No. 61/577,951, filed on Dec. 20, 2011.

Primary Examiner — Frederick L Lagman

(74) *Attorney, Agent, or Firm* — Schwegman Lundberg & Woessner, P.A.

(51) **Int. Cl.**

F16L 55/18	(2006.01)
F16L 1/032	(2006.01)
B65H 75/40	(2006.01)
F16L 55/165	(2006.01)
F16L 1/028	(2006.01)

(57) **ABSTRACT**

Pipe replacement devices, and systems are shown. Devices and systems may include jointed cutters and floating cutters to navigate difficult pipe replacement conditions. Devices and systems may also include replacement pipe with pre-installed supply hoses, such as lubricant supply and/or pneumatic supply hoses. Methods of pipe replacement are also described, including splitting old pipe and pulling in new pipe behind the equipment as splitting progresses.

(52) **U.S. Cl.**

CPC **F16L 55/18** (2013.01); **B65H 75/40** (2013.01); **F16L 1/028** (2013.01); **F16L 1/032** (2013.01); **F16L 55/165** (2013.01)

10 Claims, 6 Drawing Sheets

(58) **Field of Classification Search**

CPC . F16L 1/024; F16L 1/028; F16L 1/032; F16L 55/18; B65H 75/40; B65H 75/4418; B65H 75/4457; B65H 75/4478; B65H 2701/33

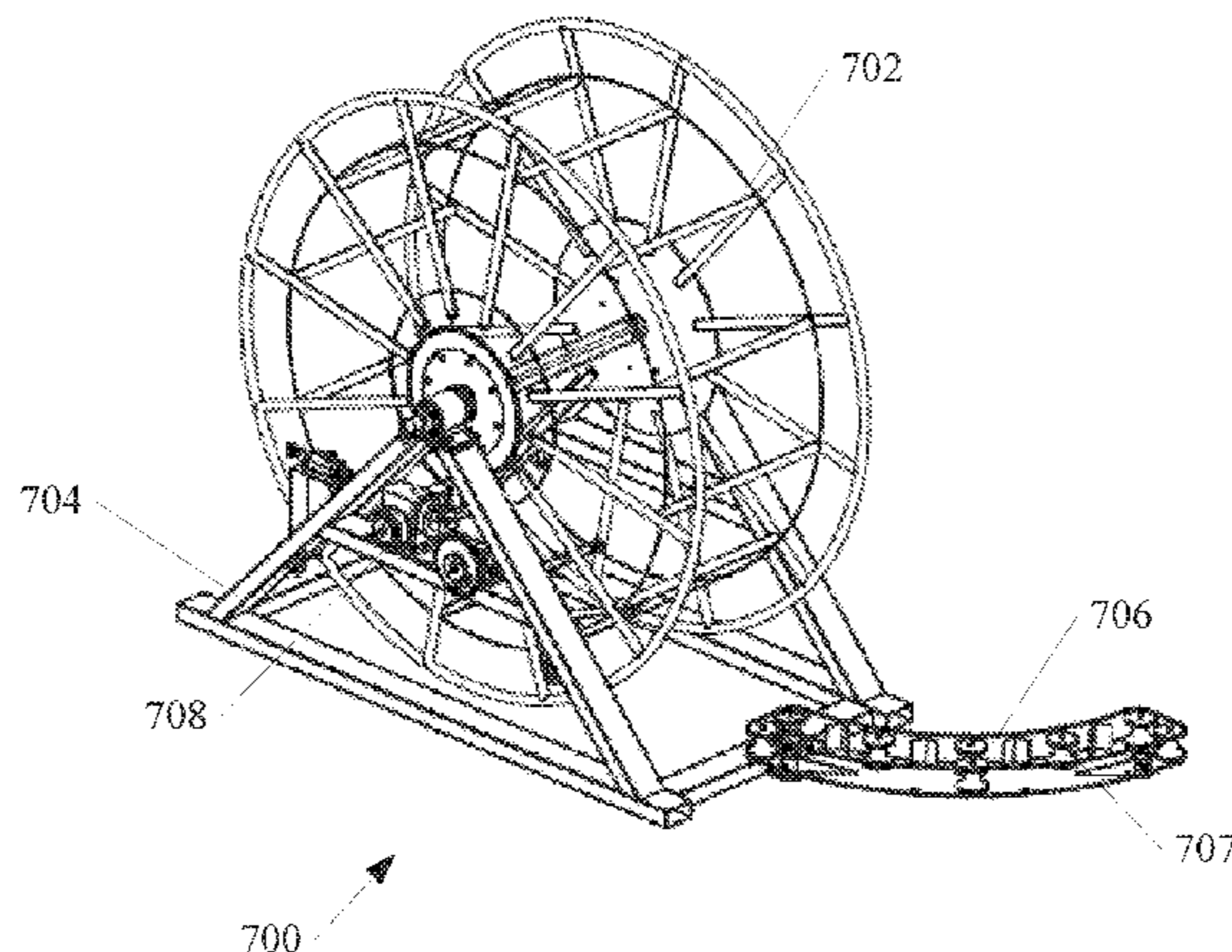

(56)

References Cited

U.S. PATENT DOCUMENTS

4,776,370 A * 10/1988 Long, Jr. F16L 55/1651
138/109

4,930,542 A 6/1990 Winkle et al.

4,983,071 A 1/1991 Fisk et al.

5,076,731 A 12/1991 Luksch

5,078,546 A 1/1992 Fisk et al.

5,112,158 A 5/1992 Mcconnell

5,482,404 A 1/1996 Tenbusch, II et al.

5,544,977 A 8/1996 Cravy et al.

5,628,585 A 5/1997 Parish, II et al.

5,636,648 A * 6/1997 O'Brien B08B 9/04
134/107

5,782,311 A 7/1998 Wentworth

5,876,152 A 3/1999 Hesse

5,984,582 A * 11/1999 Schwert E21B 23/00
138/97

6,039,505 A 3/2000 Tenbusch, II

6,092,553 A 7/2000 Hodgson

6,357,967 B1 3/2002 Putnam

6,382,877 B1 5/2002 Hodgson

6,588,983 B1 7/2003 Tenbusch, II

6,969,216 B2 * 11/2005 Driver F16L 55/1651
138/97

6,969,427 B1 * 11/2005 Noles, Jr. B05C 7/08
118/317

7,086,808 B2 8/2006 Wentworth et al.

7,384,214 B2 6/2008 Tjader

7,398,797 B2 * 7/2008 Kamiyama F16L 55/179
138/97

7,578,636 B2 8/2009 Tjader

7,624,817 B2 12/2009 Putnam

7,641,756 B2 * 1/2010 Schwert B29C 63/36
118/306

8,328,468 B2 12/2012 Tjader

8,403,250 B1 * 3/2013 Callahan B65H 75/403
137/355.26

8,414,225 B2 4/2013 Tjader

8,596,918 B2 12/2013 Tjader

8,998,538 B2 4/2015 Tjader

9,885,441 B2 2/2018 Tjader

2002/0102136 A1 * 8/2002 Holland B08B 9/049
405/184.1

2003/0178520 A1 * 9/2003 Wivagg B65H 75/4449
242/378.2

2004/0228691 A1 11/2004 Tjader

2004/0238675 A1 * 12/2004 Banaszkiwicz .. B65H 75/4402
242/377

2005/0051344 A1 * 3/2005 Goss F16L 55/165
166/384

2006/0088384 A1 * 4/2006 Putnam F16L 55/1658
405/184.1

2007/0036613 A1 2/2007 Tjader

2007/0048091 A1 3/2007 Tjader

2009/0285635 A1 11/2009 Tjader

2010/0150659 A1 * 6/2010 Kamiyama B29C 63/36
405/184.2

2010/0178113 A1 7/2010 Tjader

2011/0081205 A1 4/2011 Tjader

2011/0081206 A1 4/2011 Tjader

2013/0156507 A1 6/2013 Tjader

2015/0211672 A1 7/2015 Tjader

2015/0337895 A1 * 11/2015 Bauck B65H 75/4478
137/355.26

OTHER PUBLICATIONS

“U.S. Appl. No. 13/722,004, Advisory Action dated Sep. 30, 2014”,
3 pgs.

“U.S. Appl. No. 13/722,004, Final Office Action dated Jun. 18,
2014”, 6 pgs.

“U.S. Appl. No. 13/722,004, Non Final Office Action dated Jan. 15,
2014”, 7 pgs.

“U.S. Appl. No. 13/722,004, Notice of Allowance dated Dec. 4,
2014”, 5 pgs.

“U.S. Appl. No. 13/722,004, Response filed Apr. 15, 2014 to Non
Final Office Action dated Jan. 15, 2014”, 8 pgs.

“U.S. Appl. No. 13/722,004, Response filed Aug. 18, 2014 to Final
Office Action dated Jun. 18, 2014”, 9 pgs.

“U.S. Appl. No. 13/722,004, Response filed Sep. 18, 2014 to Final
Office Action dated Jun. 18, 2014”, 8 pgs.

“U.S. Appl. No. 14/679,384, Advisory Action dated Jul. 10, 2017”,
3 pgs.

“U.S. Appl. No. 14/679,384, Final Office Action dated Apr. 19,
2017”, 8 pgs.

“U.S. Appl. No. 14/679,384, Final Office Action dated May 31,
2016”, 9 pgs.

“U.S. Appl. No. 14/679,384, Non Final Office Action dated Oct. 21,
2016”, 8 pgs.

“U.S. Appl. No. 14/679,384, Non Final Office Action dated Dec. 14,
2015”, 11 pgs.

“U.S. Appl. No. 14/679,384, Notice of Allowance dated Sep. 25,
2017”, 5 pgs.

“U.S. Appl. No. 14/679,384, Response filed Jan. 23, 2017 to
Non-Final Office Action dated Oct. 21, 2016”, 6 pgs.

“U.S. Appl. No. 14/679,384, Response filed Jun. 19, 2017 to Final
Office Action dated Apr. 19, 2017”, 7 pgs.

“U.S. Appl. No. 14/679,384, Response filed Mar. 14, 2016 to
Non-Final Office Action dated Dec. 14, 2015”, 9 pgs.

“U.S. Appl. No. 14/679,384, Response filed Sep. 30, 2016 to Final
Office Action dated May 31, 2016”, 8 pgs.

* cited by examiner

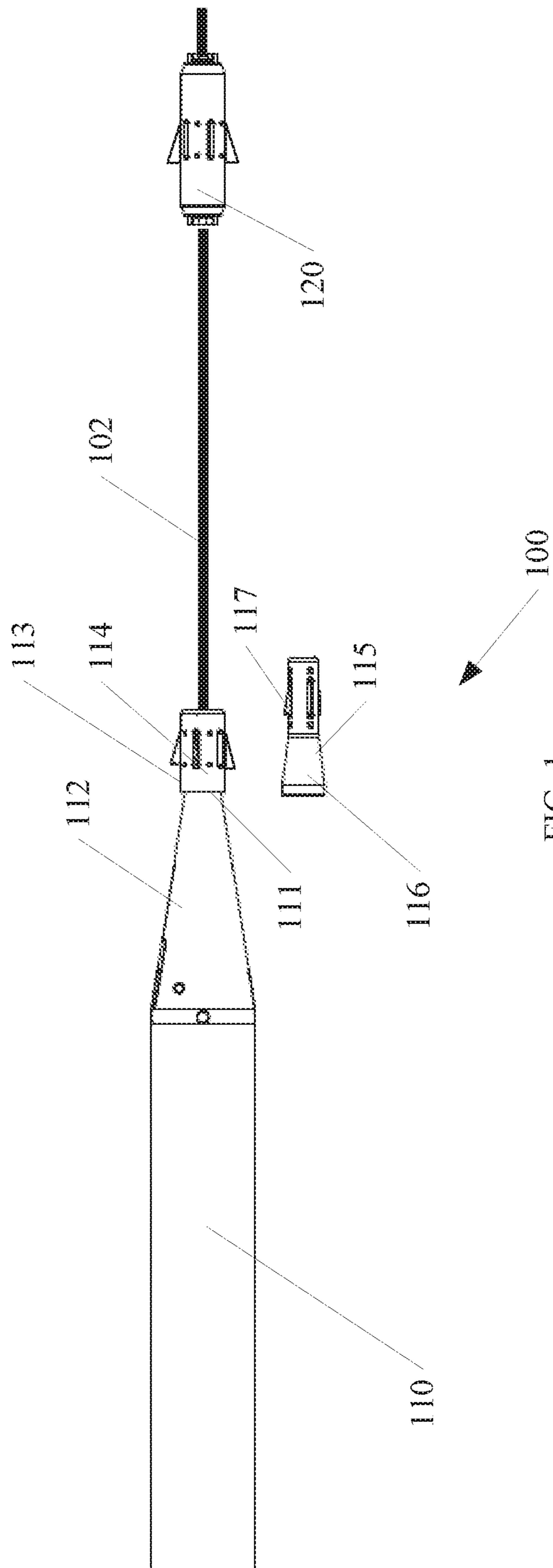
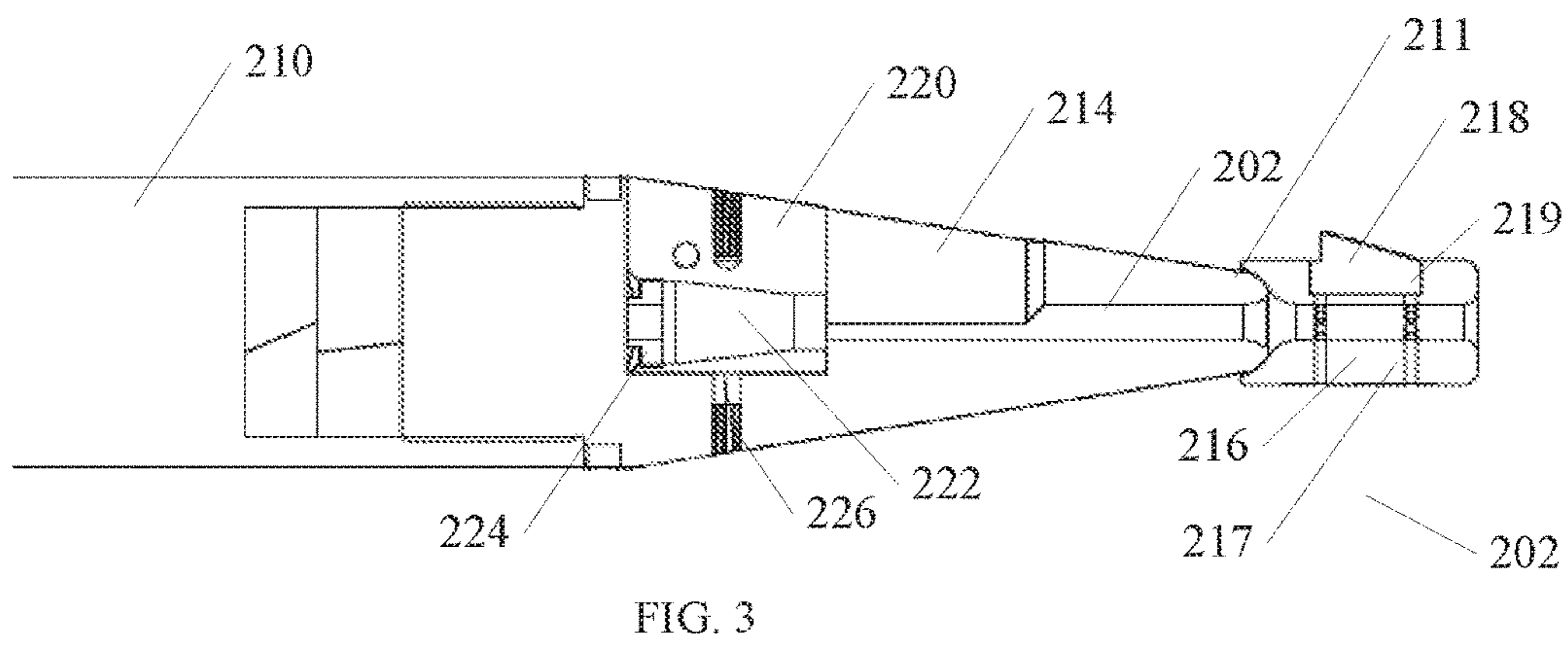
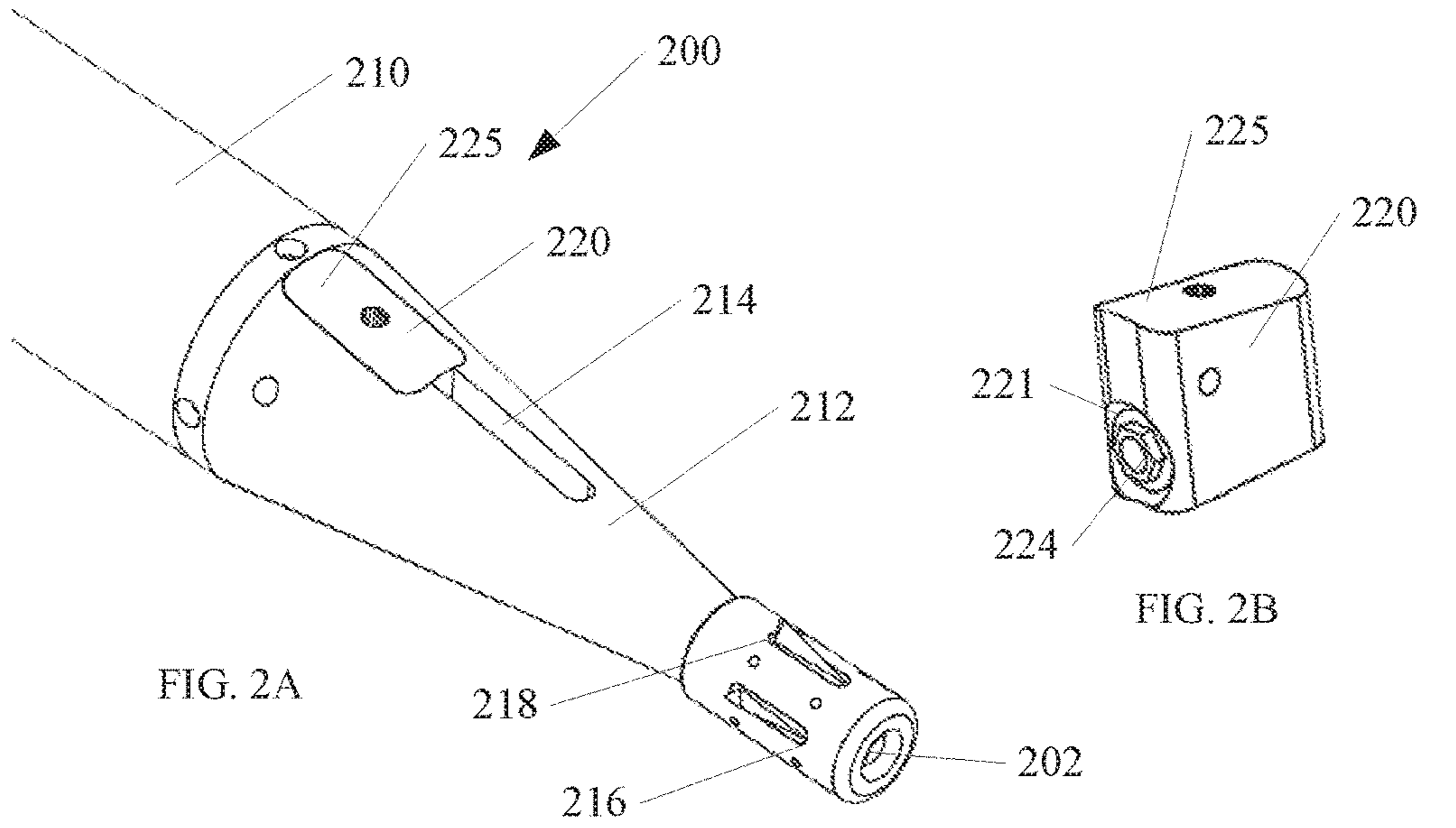
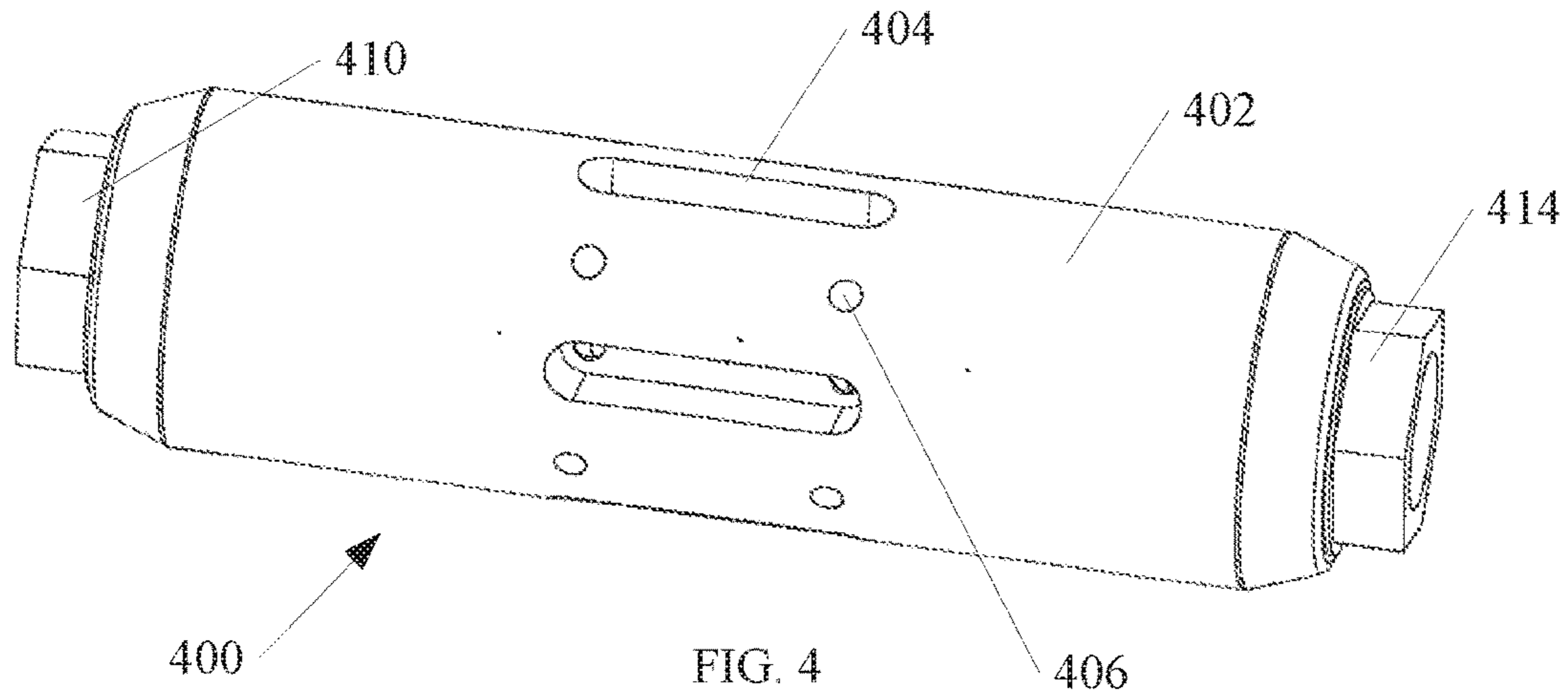

FIG. 1





400

FIG. 4

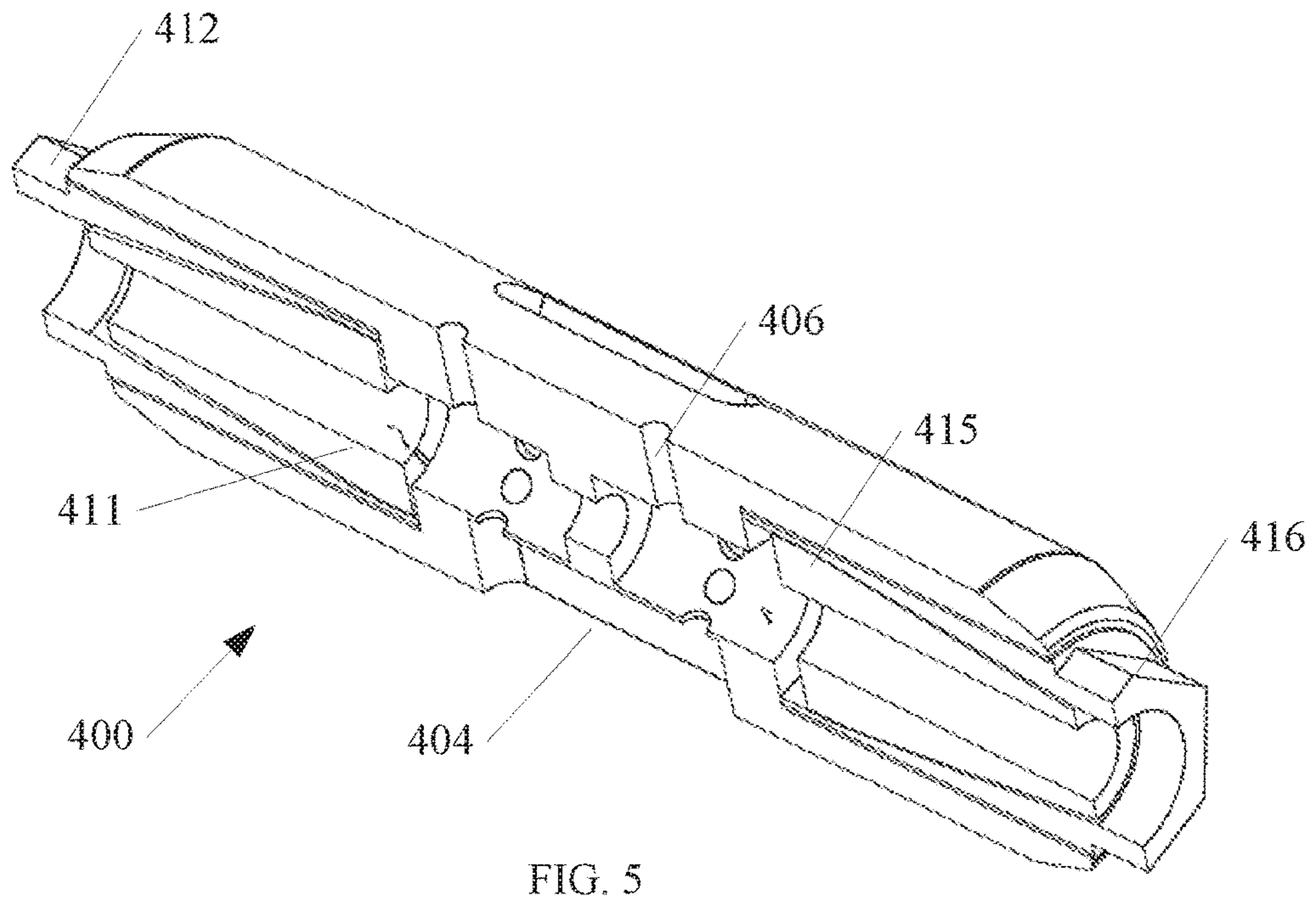

400

FIG. 5

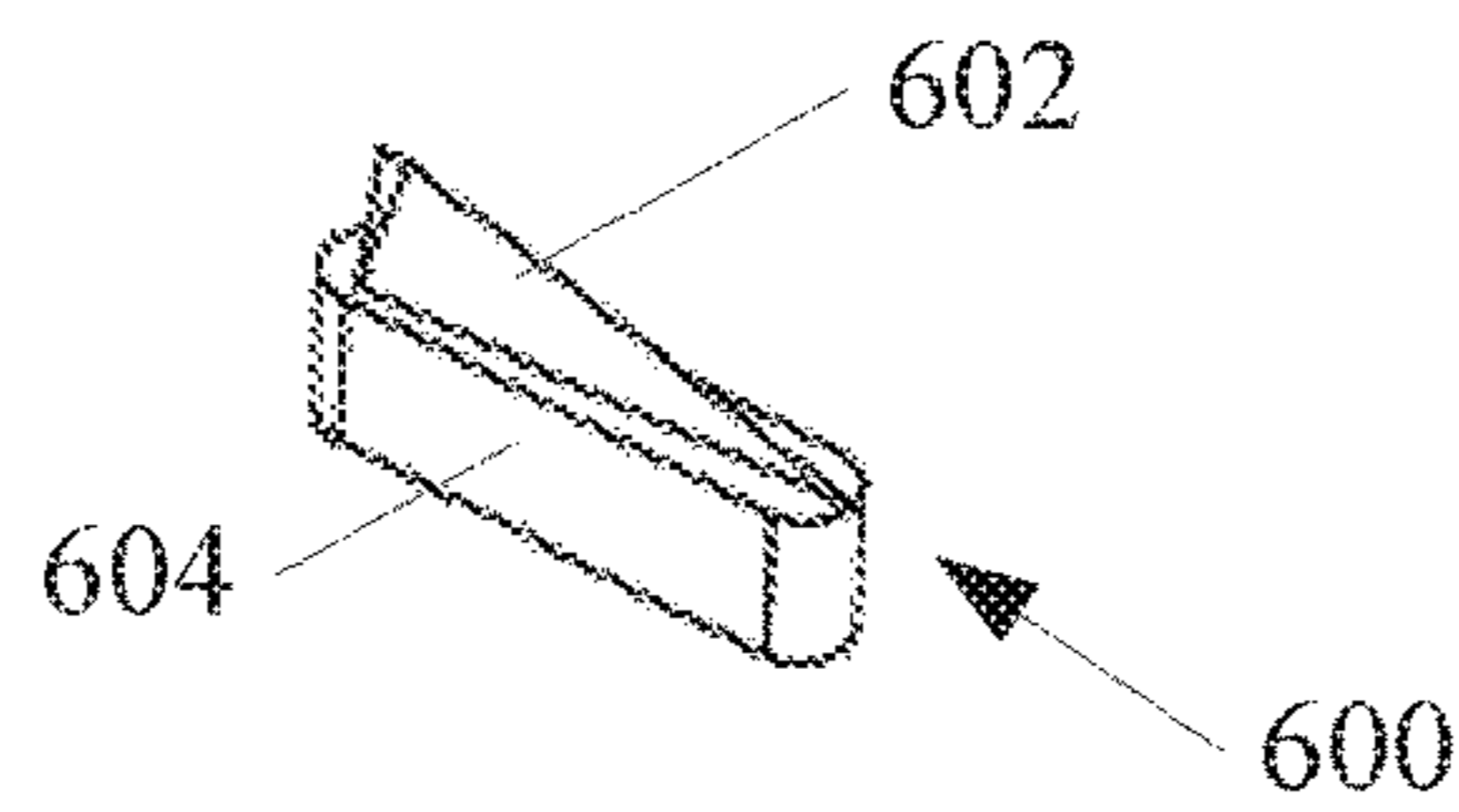

FIG. 6

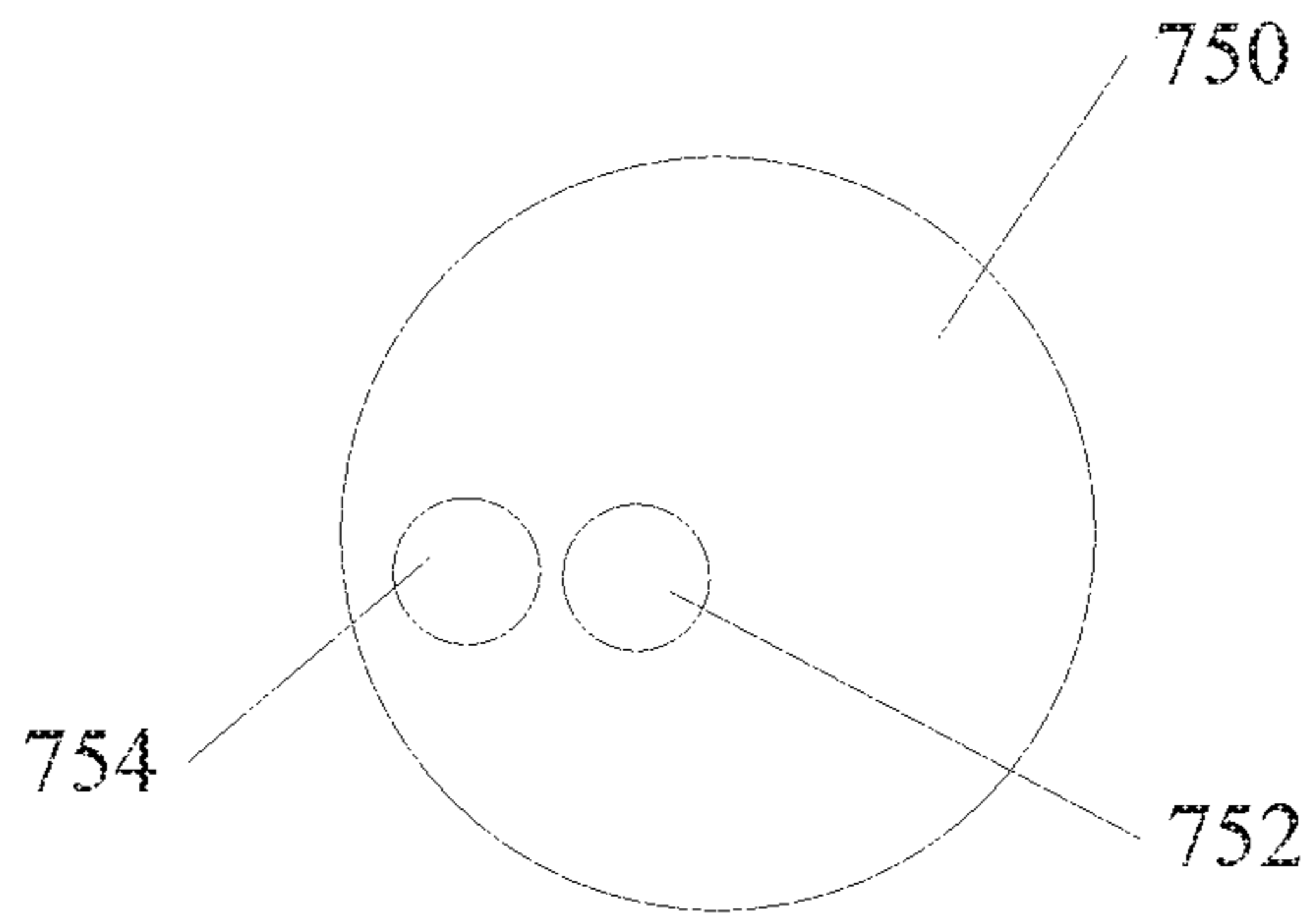

FIG. 7A

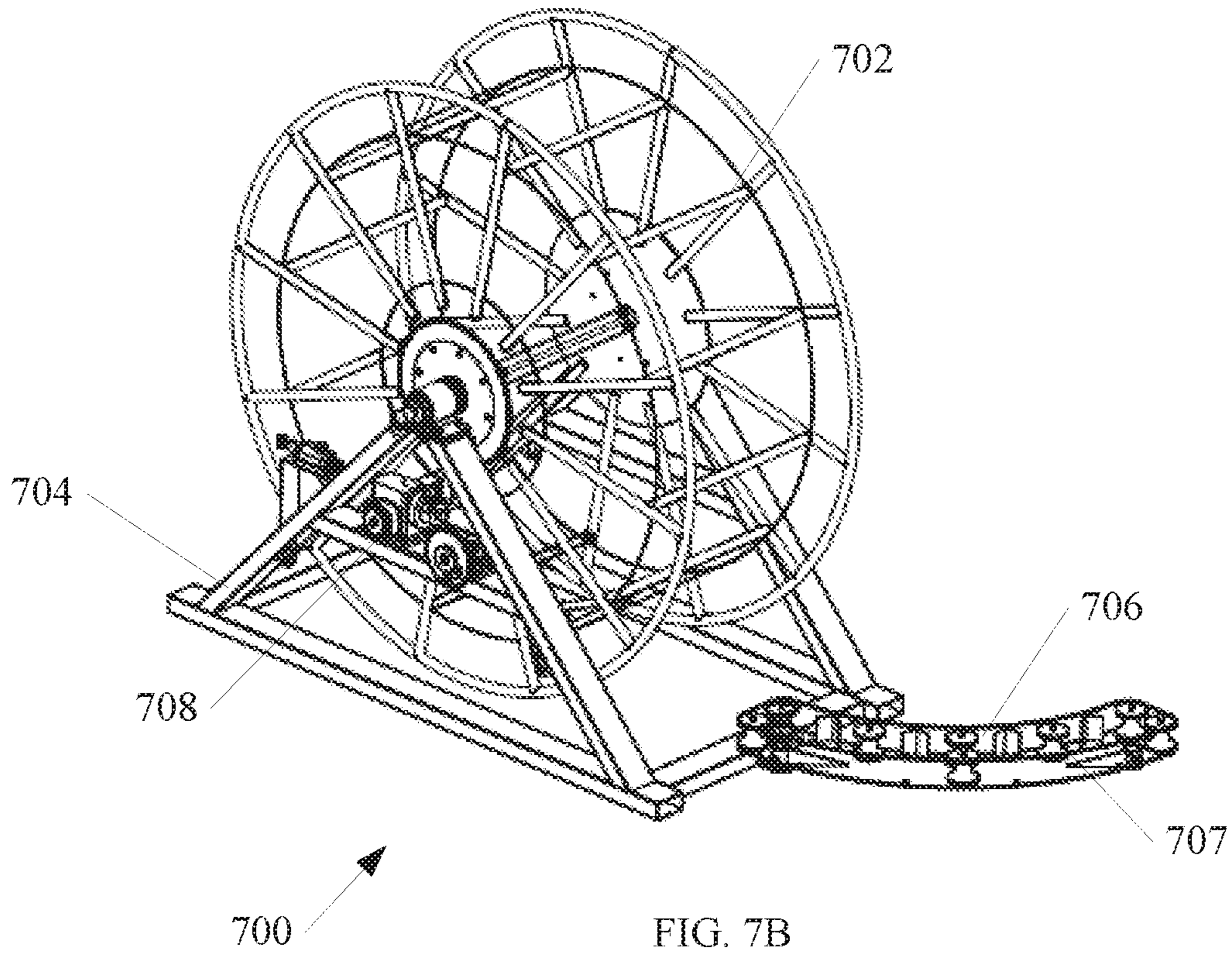

FIG. 7B

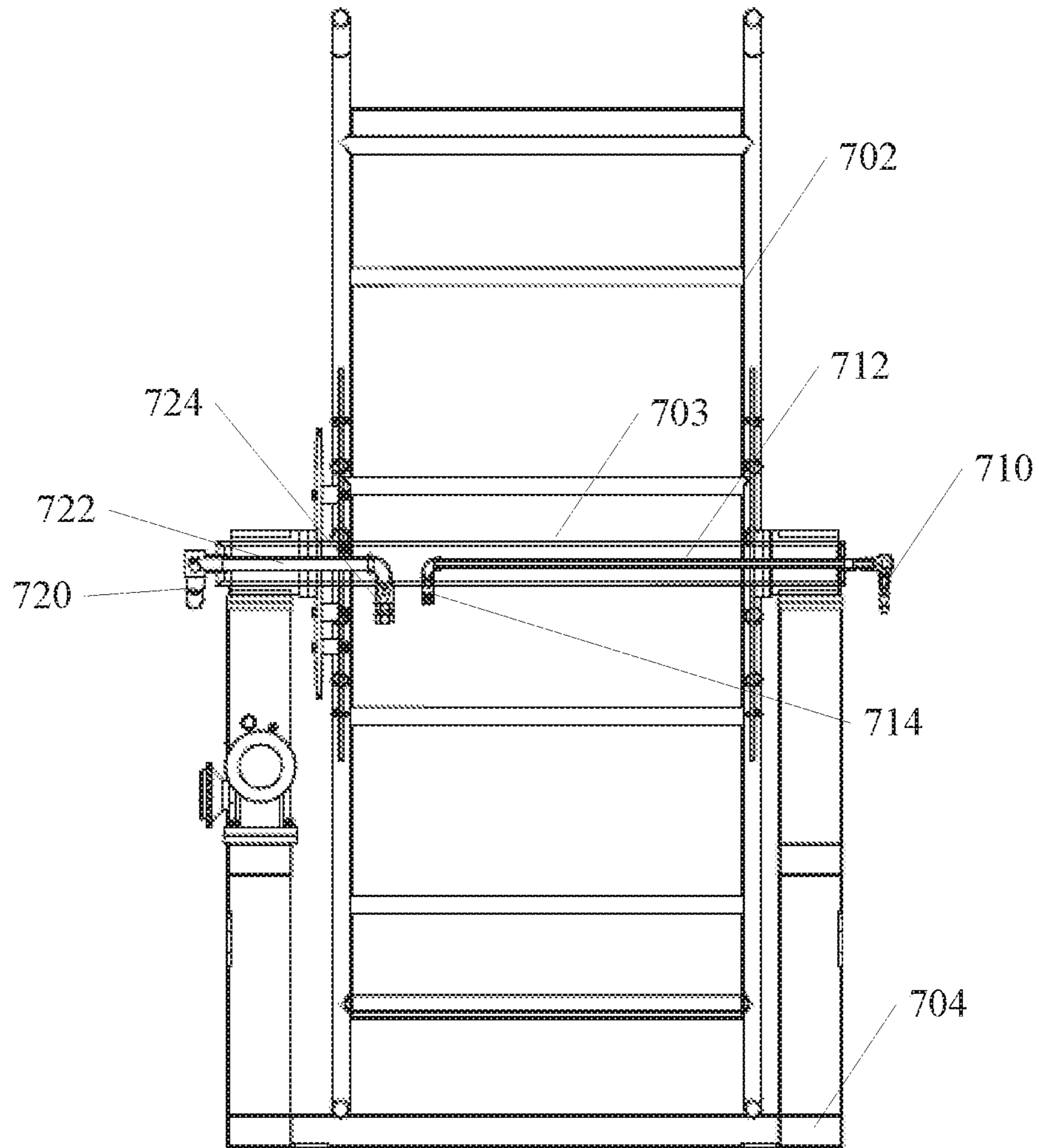

FIG. 8

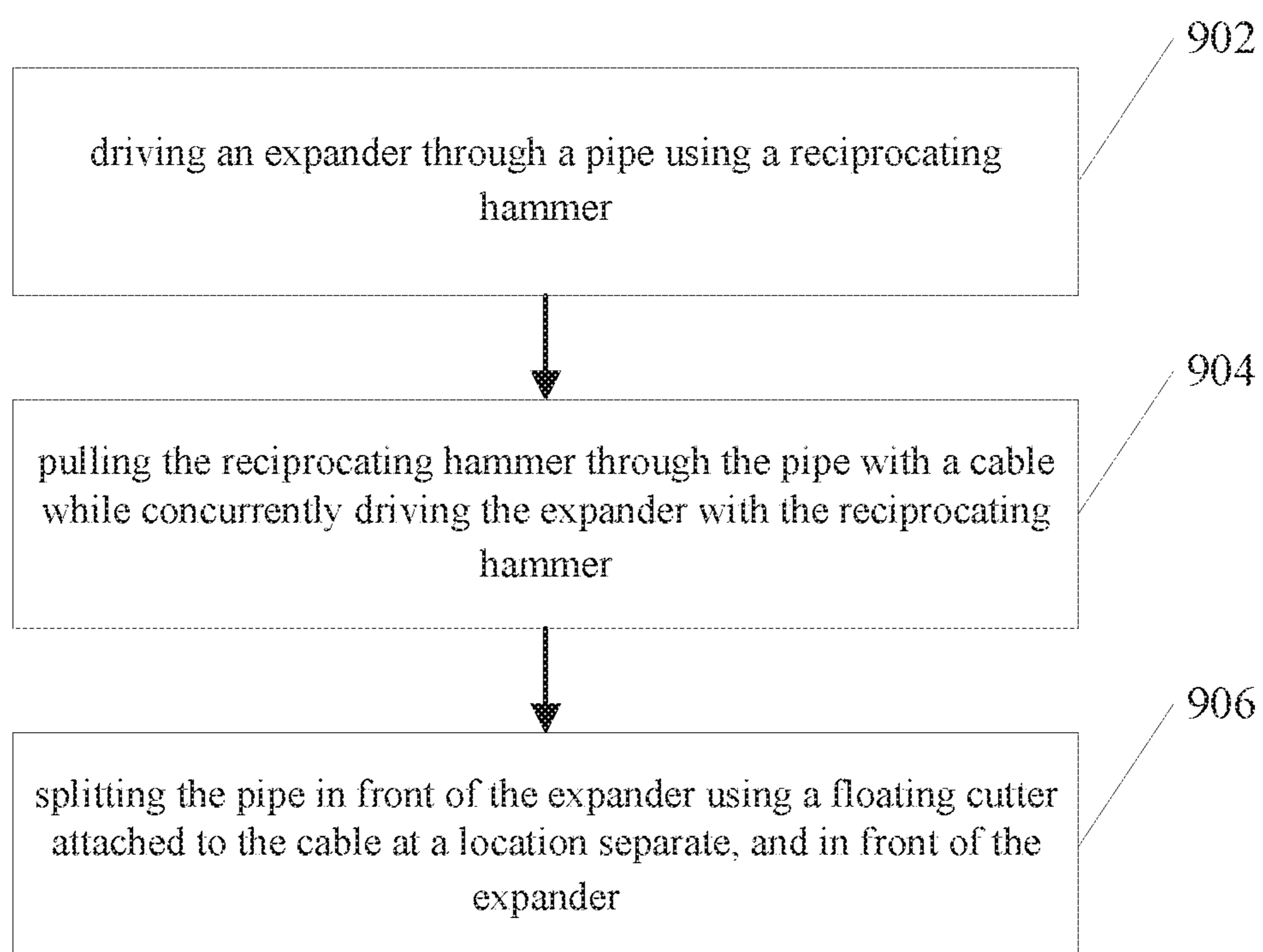

FIG. 9

PIPE REPLACEMENT SYSTEM

PRIORITY

This application is Continuation of U.S. patent applica-
 tion Ser. No. 14/679,384, filed Apr. 6, 2015, which is a
 Continuation of U.S. patent application Ser. No. 13/722,004,
 filed Dec. 20, 2012, which is a Non Provisional of and
 claims the benefit of priority under 35 U.S.C. Section 119(e),
 to U.S. Provisional Patent Application Ser. No. 61/577,951,
 filed on Dec. 20, 2011, which is hereby incorporated by
 reference herein in its entirety.

BACKGROUND

Trenchless pipe replacement is useful for replacement of
 pipes without the need to excavate the length of the pipe to
 be replaced. An example of trenchless pipe replacement
 includes pulling a cutting blade with an expander through
 the pipe to be replaced, and attaching a new pipe behind the
 cutting blade. The pipe to be replaced is split, and pushed
 into the surrounding soil, and the new pipe, of equal or larger
 diameter, is pulled into the new space within the split pipe.
 Splitter are commonly used for small diameter pipes, and for
 pipes of a material that lends itself to splitting. Another
 example of trenchless pipe replacement includes pipe burst-
 ing.

Gas lines are one example of pipes where splitting is
 useful in pipe replacement. An example includes high den-
 sity polyethylene (HDPE) gas pipe. Large quantities of 2
 inch diameter HDPE gas pipes are currently in need of
 replacement. 300 miles of gas pipe in a single city in need
 of replacement is not uncommon. Given the desirability of
 minimizing trenches, it is also desirable to minimize the size
 of entry and exit pits for operating trenchless equipment.
 Cutting pipes in small entry and exit pits can be a challenge
 due to the small amount of available space to operate cutting
 tooling.

BRIEF DESCRIPTION OF THE DRAWINGS

FIG. 1 shows a pipe replacement device according to an
 embodiment of the invention.

FIG. 2A shows a pipe replacement device according to an
 embodiment of the invention.

FIG. 2B shows an anchor block from FIG. 2A according
 to an embodiment of the invention.

FIG. 3 shows a cross section of the pipe replacement
 device from FIG. 2A according to an embodiment of the
 invention.

FIG. 4 shows a cutter according to an embodiment of the
 invention.

FIG. 5 shows a cross section of the cutter from FIG. 4,
 according to an embodiment of the invention.

FIG. 6 shows a blade from a pipe replacement device
 according to an embodiment of the invention.

FIG. 7A shows a replacement pipe according to an
 embodiment of the invention.

FIG. 7B shows a supply device according to an embodi-
 ment of the invention.

FIG. 8 shows a cross section of the supply device from
 FIG. 7, according to an embodiment of the invention.

FIG. 9 shows a flow diagram of a method according to an
 embodiment of the invention.

DETAILED DESCRIPTION

In the following detailed description, reference is made to
 the accompanying drawings which form a part hereof, and

in which is shown, by way of illustration, specific embodi-
 ments in which the invention may be practiced. In the
 drawings, like numerals describe substantially similar com-
 ponents throughout the several views. These embodiments
 are described in sufficient detail to enable those skilled in the
 art to practice the invention. Other embodiments may be
 utilized and mechanical, structural, or logical changes, etc.
 may be made without departing from the scope of the
 present invention.

FIG. 1 shows a pipe replacement device **100** according to
 an embodiment of the invention. The pipe replacement
 device **100** includes an expander **112** located at a front
 portion of a reciprocating hammer **110**. A towing cable **102**
 is also shown coupled to a front end **113** of the expander **112**.

In one example, a combination of pushing forces from
 behind, provided by the reciprocating hammer **110**, and
 pulling forces provided by the towing cable **102** are used to
 split the pipe to be replaced, and to pull in a new pipe in a
 trenchless replacement operation. Although a conical
 expander **112** is shown, other expanders may include offset,
 non concentric expanders. The term towing cable **102**
 includes any of a variety of towing structures, such as wire
 rope, or other flexible lines of sufficient strength.

A cutter **114** is shown coupled to the front end **113** of the
 expander **112**. In one example, the cutter **114** includes a
 jointed cutter that is allowed to pivot at the front end **113**
 of the expander **112**. In one example, a ball joint **111** is included
 between the cutter **114** and the expander **112** to better
 navigate the pipe replacement device **100** through a pipe to
 be replaced. One particularly useful example is in trenchless
 replacement of polymeric pipe, such as buried natural gas
 lines.

In selected operations, such as splitting some types of
 polymeric pipe, a jointed cutter is advantageous. For
 example, selected polymeric pipe was placed in the ground
 by unrolling the pipe off a spool and loosely laying the pipe
 in a trench. When the pipe is later covered with dirt, a
 number of small curves may remain in the pipe as a result
 of shape memory from the spool which the pipe was
 unrolled from. These small curves can be difficult to navi-
 gate in a subsequent splitting operation of a trenchless
 replacement operation.

In one example, the ball joint **111** between the cutter **114**
 and the expander **112** is held together by pressure, and
 aligned by the towing cable **102**. This configuration also
 makes modular substitution of components of the pipe
 replacement device **100**. For example, a second cutter **116**
 is shown as an optional component for use with smaller
 diameter pipe. In one example, the second cutter **116**
 includes a tapered portion **115** that bridges a taper dimension
 between the cutter blades **117** and the starting diameter of
 the expander **112**.

In one example, a floating cutter **120** is included in the
 pipe replacement device **100**. FIG. 1 shows the floating
 cutter **120** in an embodiment that also includes a ball joint
111 and a cutter **114**. Other configurations may include only
 a ball joint **111** and a cutter **114**, or only a floating cutter **120**.

The floating cutter **120** allows great flexibility to split
 and/or weaken the pipe to be replaced ahead of the expander
112 and reciprocating hammer **110**. Because the floating
 cutter is only constrained by the flexible towing cable **102**,
 the floating cutter **120** more easily navigates curves in the
 pipe to be replaced, such as an uncoiled polymeric pipe as
 described above. Further, the floating cutter **120** is not
 constrained at the front of the expander **112** in the way that
 the cutter **114** is constrained. Because the floating cutter **120**
 is not coupled to a ball joint, or other joint, the only

3

constraint on the floating cutter **120** is its connection to the towing cable **102**. One technical challenge with trenchless replacement in curvy pipes is the length of the reciprocating hammer **110** which tends to direct the expander in a straight line. The addition of the floating cutter **120** in front of the expander **112** and reciprocating hammer **110** overcomes this challenge.

FIG. **2A** shows a pipe replacement device **200** similar to the pipe replacement device **100** of FIG. **1**. The pipe replacement device **200** includes an expander **212** coupled to a front end of a reciprocating hammer **210**. Similar to the pipe replacement device **100** of FIG. **1**, a cutter **216** is shown with a number of cutting blades **218** attached. An opening **202** to accept a towing cable is shown that passes through the cutter **216**, and into the expander **212**.

A lateral insertion pocket **214** is shown coupled to the opening **202**. The lateral insertion pocket **214** is adapted to accept a removable anchor block **220** illustrated in place in FIG. **2A**, and separate from the pipe replacement device **200** in FIG. **2B**. In operation, the towing cable is inserted through the opening **202** into the lateral insertion pocket **214** and the towing cable is guided laterally outward from the expander **212**. The removable anchor block **220** is then attached to the end of the towing cable. Once attached, the removable anchor block **220** is seated back into the expander **212**, where it fits within the lateral insertion pocket **214**.

Due to high pulling forces during a trenchless replacement operation, it can be difficult to remove a cable from the pipe replacement device **200** once the replacement is complete. Using configurations shown in the present disclosure, after a replacement operation, the removable anchor block **220** can be removed from the lateral insertion pocket **214** and disengaged from the cable with ease.

An attachment device **221** is shown within the removable anchor block **220**. In one example, the attachment device **221** includes a tapered wedge tightener. In one example, the attachment device **221** is an active tapered wedge tightener, in contrast to a passive tapered wedge tightener that is tightened by pulling on the cable with friction to move the wedge segments. An actuator, such as the threaded fitting **224** is shown in FIG. **2B** and FIG. **3**. The threaded fitting **224** can be tightened down to press against wedge segments **222** to tighten against the cable.

In one example, the lateral insertion pocket **214** is located within a taper region of the expander **212**. In the example shown, the removable anchor block **220** includes a surface **225** that aligns with a taper of the expander **212**. In this configuration, expansion of the pipe to be replaced is more consistent due to the surface **225**, and debris is substantially prevented from falling into the lateral insertion pocket **214**.

FIG. **3** shows a cross section of the pipe replacement device **200** from FIG. **2A**. In one example, illustrated in FIG. **3**, a jack screw **226** is included. After a replacement operation, the jack screw **226** can be actuated to press against the removable anchor block **220** to drive it out of the lateral insertion pocket **214**, if necessary.

FIG. **3** also shows additional detail of the cutter **216**. Similar to examples described above, the cutter **216** is coupled to the expander **212** at a ball joint **211**. As shown in the Figure, the ball joint **211** is held together by pressure along a towing cable (not shown), and the cutter **216** is removable/interchangeable by pulling the ball joint **211** apart.

FIG. **3** further shows a cutting blade **218** located in a pocket **219** of the cutter **216**. The cutting blade **218** is removable for optional replacement, should the cutting blade become dull or damaged. FIG. **3** illustrates a hole **217**

4

located opposite the cutting blade **218**. In one example, the cutting blades **218** are attached within the pockets **219** using an adhesive such as epoxy. In practice, if a cutting blade is to be replaced, a punch or other small tool is inserted within one or more holes **217** opposite the cutting blade **218**. The bond between the cutting blade **218** and the pocket **219** can then be broken by hammering or otherwise driving the cutting blade **218** out of the pocket **219** from the back side. Although one cutting blade **218** is shown, embodiments of cutters **216** including multiple cutting blades **218** are also within the scope of the invention.

FIG. **4** shows a floating cutter **400** similar to the floating cutter **120** described above. The floating cutter **400** includes a body **402** having one or more pockets **404** adapted to accept cutting blades such as cutting blade **600** shown in FIG. **6**. The cutting blade **600** includes an edge portion **602**, and a mating portion **604** to closely fit within the pockets **404**.

Also shown in FIG. **4** are a number of holes **406**. In one example at least one hole is associated with a pocket **404** for removal of a worn or damages cutting blade **600** similar to the process described for cutter **216** described above. In the example of FIG. **4**, two holes **406** are associated with each pocket **404** to more effectively drive a cutting blade **600** out for replacement.

In one example, the cutting blades **600** are attached within the pockets **404** using an adhesive such as epoxy. In practice, if a cutting blade is to be replaced, a punch or other small tool is inserted within one or more holes **406** opposite the cutting blade **600**. The bond between the cutting blade **600** and the pocket **404** can then be broken by hammering or otherwise driving the cutting blade **600** out of the pocket **404** from the back side.

FIG. **4** shows a first attachment device **410** and a second attachment device **414** coupled to ends of the floating cutter **400**. In one example the first attachment device **410** and the second attachment device **414** both include tapered wedge couplers. FIG. **5** illustrates at least one tapered wedge segment **411** of the first attachment device **410**, and at least one tapered wedge segment **415** of the second attachment device **414**. As shown in FIG. **5**, in one example, the first attachment device **410** and the second attachment device **414** are opposing in operational direction. Opposing attachment devices **410**, **414** provide secure location of the floating cutter **400** at a chosen location along a towing cable. As a result of opposing attachment devices **410**, **414**, the floating cutter **400** cannot be slid axially along the towing cable in either direction when the attachment devices **410**, **414** are actuated. Also shown in FIG. **5** is a first threaded fitting **412** to actuate the tapered wedge segment **411** of the first attachment device **410**. Additionally, a second threaded fitting **416** is shown to actuate the tapered wedge segment **415** of the second attachment device **414**.

As discussed above, splitting curved pipes such as polymeric natural gas lines can be problematic, and present a number of technical challenges. Curves in the pipe to be replaced cause increases in friction within the pipe and surrounding soil, and may require large pulling forces to advance a pipe replacement device such as described in embodiments above. Features such as a reciprocating hammer, a towing cable, jointed cutters, and floating cutters all provide enhancements to more effectively split old pipe, and advance new pipe into place as pulled behind the reciprocating hammer.

In selected embodiments, the reciprocating hammer is a pneumatically driven hammer, with a supply of compressed air being supplied from a pneumatic supply hose located

5

within the pipe to be replaced. In selected embodiments, a lubricant is also supplied from a lubricant supply hose routed alongside the pneumatic supply hose. FIG. 7A shows a cross section of a replacement pipe 750 including a pneumatic supply hose 752 and a lubricant supply hose 754. In one example the replacement pipe 750 includes polyethylene pipe. Other flexible polymeric pipes may also be used.

As illustrated in FIG. 7A, in one example, both supply hoses 752, 754 are located within the replacement pipe 750. In one example, the replacement pipe 750 is stored, ready for a job site, with the pneumatic supply hose 752 and lubricant supply hose 754 pre-installed within the replacement pipe 750.

FIG. 7B shows a supply device 700 to hold an amount of replacement pipe such as replacement pipe 750. The supply device 700 includes a reel 702 and a frame 704 to hold the reel 702. In configurations where one or more supply hoses such as pneumatic supply hose 752 or lubricant supply hose 754 are pre-installed within the replacement pipe 750 a job site is much easier to navigate, and much less space is needed. The replacement pipe 750 does not need to be laid out to feed in hoses such as pneumatic supply hose 752 or lubricant supply hose 754 on site.

In one example, a motor 708 is located on the frame 704 of the supply device 700 to drive the reel 702 as needed. In one example, the motor 708 includes a hydraulic motor. A hydraulic motor is useful because other equipment located at the job site may also use hydraulic fluid for power. For example, a winch used to pull the towing cable may also use hydraulic drive.

In one example, a guide 706 is coupled to the frame 704 to direct the replacement pipe 750 from off of the reel 702 into an entry pit where the splitting and replacement operation begins. The guide 706 may include one or more rollers 707 to lower friction as the replacement pipe 750 is moved off the reel 702.

FIG. 8 shows a cross section of the supply device 700 from FIG. 7B. A pneumatic supply line 712 and a lubricant supply line 722 are shown located within a hub 703 of the reel 702. A first pneumatic supply fitting 714 is shown in a location adapted for connection to the pneumatic supply hose 752 within the replacement pipe 750. A second pneumatic supply fitting 710 is shown in a location outside the hub 703, adapted for connection to a source of compressed air. A first lubricant supply fitting 724 is shown in a location adapted for connection to the lubricant supply hose 754 within the replacement pipe 750. A second lubricant supply fitting 720 is shown in a location outside the hub 703, adapted for connection to a source of lubricant. In one example, the lubricant includes a bentonite slurry, although other lubricants are also within the scope of the invention.

Because the pneumatic supply line 712 and the lubricant supply line 722 are located within the hub 703 of the reel 702, compressed air and lubricant can be delivered as needed, while replacement pipe is spooled off the reel, to pipe replacement devices such as examples 100, 200 described above.

FIG. 9 illustrates a flow diagram of an example method of trenchless pipe replacement according to an embodiment of the invention. Operation 902 recites driving an expander through a pipe using a reciprocating hammer. Operation 904 recites pulling the reciprocating hammer through the pipe with a cable while concurrently driving the expander with the reciprocating hammer. Operation 906 recites splitting the pipe in front of the expander using a floating cutter attached to the cable at a location separate, and in front of the expander. Other example methods further include splitting

6

the pipe at a location adjacent to the expander, such as with a jointed cutter. Other example methods further include supplying lubricant and compressed air while splitting, wherein the lubricant and compressed air are supplied through supply lines stored within a replacement pipe. As described above, in one example, the replacement pipe is spooled off a reel, and the lubricant and compressed air are provided through fittings in a hub of the reel.

Although a particularly useful example of splitting old curved polymeric natural gas lines is used as an example in selected descriptions above, the invention is not so limited. Other trenchless replacement operations with other pipe materials such as copper, lead, or other metals are also possible.

While a number of advantages of embodiments of the invention are described, any lists of above mentioned advantages are not intended to be exhaustive. Although specific embodiments have been illustrated and described herein, it will be appreciated by those of ordinary skill in the art that any arrangement which is calculated to achieve the same purpose may be substituted for the specific embodiment shown. This application is intended to cover any adaptations or variations of the present invention. It is to be understood that the above description is intended to be illustrative, and not restrictive. Combinations of the above embodiments, and other embodiments will be apparent to those of skill in the art upon reviewing the above description. The scope of the invention includes any other applications in which the above structures and methods are used. The scope of the invention should be determined with reference to the appended claims, along with the full scope of equivalents to which such claims are entitled.

I claim:

1. A replacement pipe supply device, comprising:
 - a reel coupled to a reel frame;
 - a length of replacement pipe wound around the reel;
 - a pneumatic hose pre-installed within the length of replacement pipe; and
 - a pneumatic supply line located within a hub of the reel.
2. The replacement pipe supply device of claim 1, further including a lubricant supply line located within the hub.
3. The replacement pipe supply device of claim 1, further including a guide coupled to the frame to direct replacement pipe off the reel.
4. The replacement pipe supply device of claim 3, wherein the guide includes one or more rollers.
5. The replacement pipe supply device of claim 1, further including a hydraulic motor coupled to the hub to rotate the reel.
6. The replacement pipe supply device of claim 1, further including a lubricant supply hose pre-installed within the length of replacement pipe.
7. A replacement pipe supply device, comprising:
 - a reel coupled to a reel frame;
 - a length of replacement pipe wound around the reel;
 - a lubricant supply hose pre-installed within the length of replacement pipe; and
 - a lubricant supply line located within a hub of the reel.
8. The replacement pipe supply device of claim 7, further including a guide coupled to the frame to direct replacement pipe off the reel.
9. The replacement pipe supply device of claim 7, wherein the guide includes one or more rollers.

10. The replacement pipe supply device of claim 7, further including a hydraulic motor coupled to the hub to rotate the reel.

* * * * *