

A. ROOP.
WHIFFLETREE HOOK AND TRACE FASTENER.
APPLICATION FILED MAR. 29, 1911.

995,908.

Patented June 20, 1911.

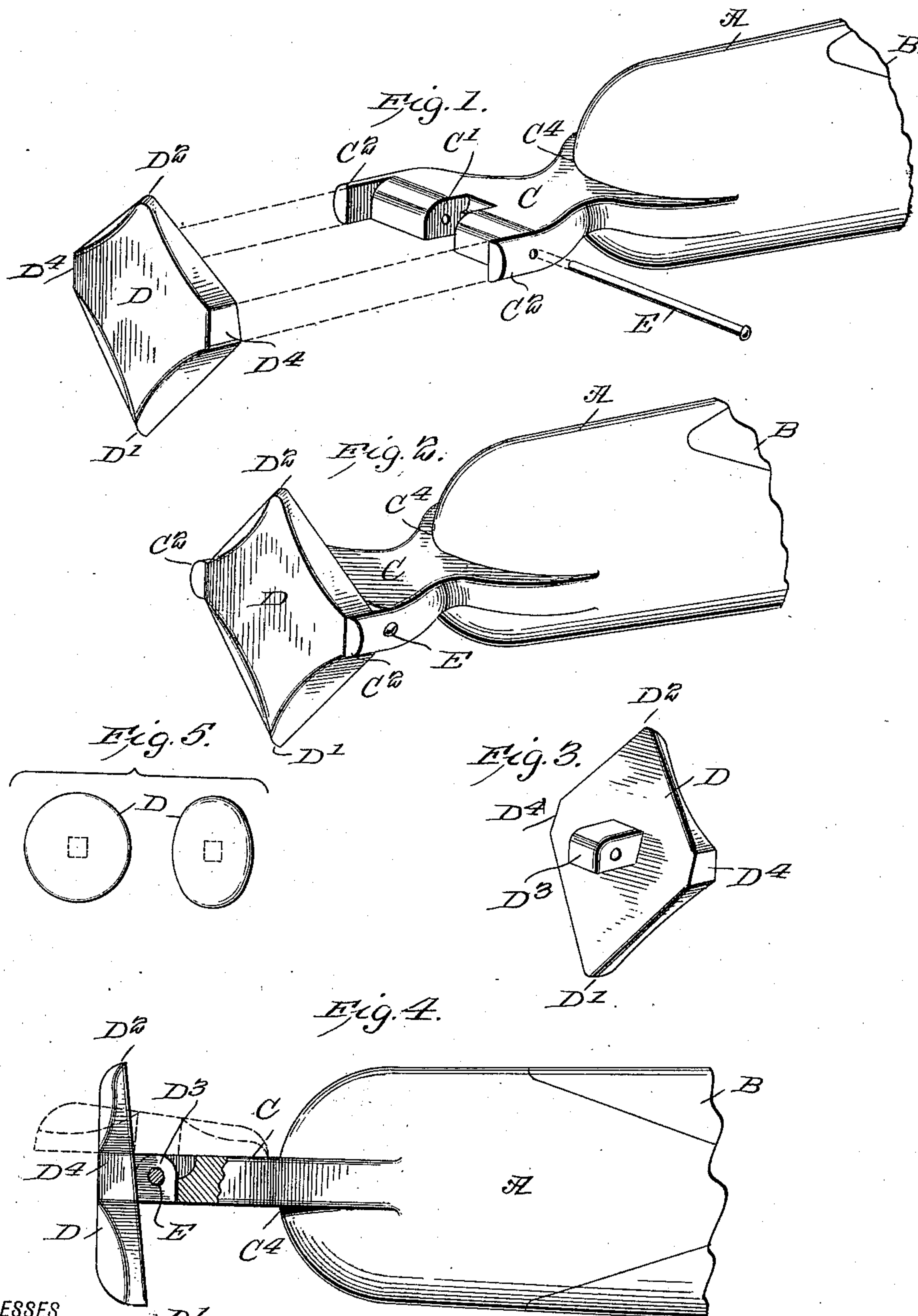

WITNESSES
E. J. Callaghan
Perry B. Surpin

INVENTOR
ALLEY ROOP
BY *Wm. T. Co.*

ATTORNEYS

UNITED STATES PATENT OFFICE.

ALLEY ROOP, OF RAYMOND, WASHINGTON, ASSIGNOR OF ONE-THIRD TO JOSEPH T. MORRIS AND ONE-THIRD TO CHARLES S. B. HENRY, BOTH OF RAYMOND, WASHINGTON.

WHIFFLETREE-HOOK AND TRACE-FASTENER.

995,908.

Specification of Letters Patent. Patented June 20, 1911.

Application filed March 29, 1911. Serial No. 617,562.

To all whom it may concern:

Be it known that I, ALLEY ROOP, a citizen of the United States, and a resident of Raymond, in the county of Pacific and State of Washington, have invented certain new and useful Improvements in Whiffletree-Hooks and Trace-Fasteners, of which the following is a specification.

This invention is an improvement in whiffletree hooks and trace fasteners, and consists in certain novel features of construction and combinations of parts as will be hereinafter described and claimed.

In the drawing Figure 1 is a perspective view showing the parts detached. Fig. 2 is a detail perspective view showing the ferrule and the head connected therewith. Fig. 3 is a detail perspective view of the fastening button. Fig. 4 is an elevation partly in section of the fastening complete. Fig. 5 is a detail view.

In carrying out the invention, I provide a ferrule A which fits upon the body B of the whiffletree and may be secured thereto in any suitable manner. At its outer end, the ferrule A has a flattened head C which is arranged in a horizontal plane and provided midway between its ends with a notch or recess C' extending inwardly from its outer end and has at the front and rear edges of its outer end outwardly extending lugs C² which form guard lips on opposite sides of the button D when the latter is in fastened position. This button D is preferably made angular in form, approximating a diamond-shape, with the points D' and D² at its upper and lower edges and the button is flattened and is provided slightly above its middle on its inner side with a projecting lug D³ which fits within the recess C' of the head C and is pivoted by the cross pin E arranged as best shown in Fig. 4 of the drawing.

In operation, it will be noticed that the flattened sides D⁴ of the button lie snugly between the projecting ears C² and the latter prevent anything from catching upon the button in the use of the invention. The button is so formed and pivoted that it may be turned from its upright position in which it secures the trace to a horizontal position

to permit the ready application of the trace to and its removal from its engagement at C⁴ with the head of the ferrule.

The invention is simple, easily constructed, and efficiently serves the purpose for which it is designed.

The button may be round or oval as shown in Fig. 5. It will be noticed that the button is thicker and heavier at its lower end.

It will be noticed that the fitting of the button snugly between the forwardly projecting ears C² of the head C is important in that it protects and shields the front and rear edges of the button and prevents any stress being exerted against the button either in front or rear of the head, the button when in operative position as shown in Fig. 2, being, so far as its front and rear edges are concerned, housed between the lugs C².

I claim:

1. A whiffletree attachment having at its outer end a flattened head disposed in a horizontal plane and provided mid-way between its edges with a notch or recess and having at its edges outwardly projecting lugs and a button made in approximately diamond form with its points at its upper and lower ends and having its sides flattened and fitting with its flat sides snugly within the outwardly projecting lugs of the flattened head, the said button having on its inner side at a point slightly above its center a lug which projects into the notch or recess of the head, and a pin pivoting said lug to the head, substantially as set forth.

2. An attachment, substantially as described, comprising a head having in its outer end a central notch and provided at the opposite side edges of said head with outwardly projecting lugs and a button operating snugly between the lugs of the head and housed at its front and rear edges by said lugs, the button being provided with a lug projecting into and pivoted within the end notch of the head, substantially as set forth.

ALLEY ROOP.

Witnesses:

CLAUDE HOUSE,
J. T. MORRIS.