

C. F. STONER & F. B. TROUT.

FLY PAPER HOLDER.

APPLICATION FILED APR. 29, 1909.

959,898.

Patented May 31, 1910.

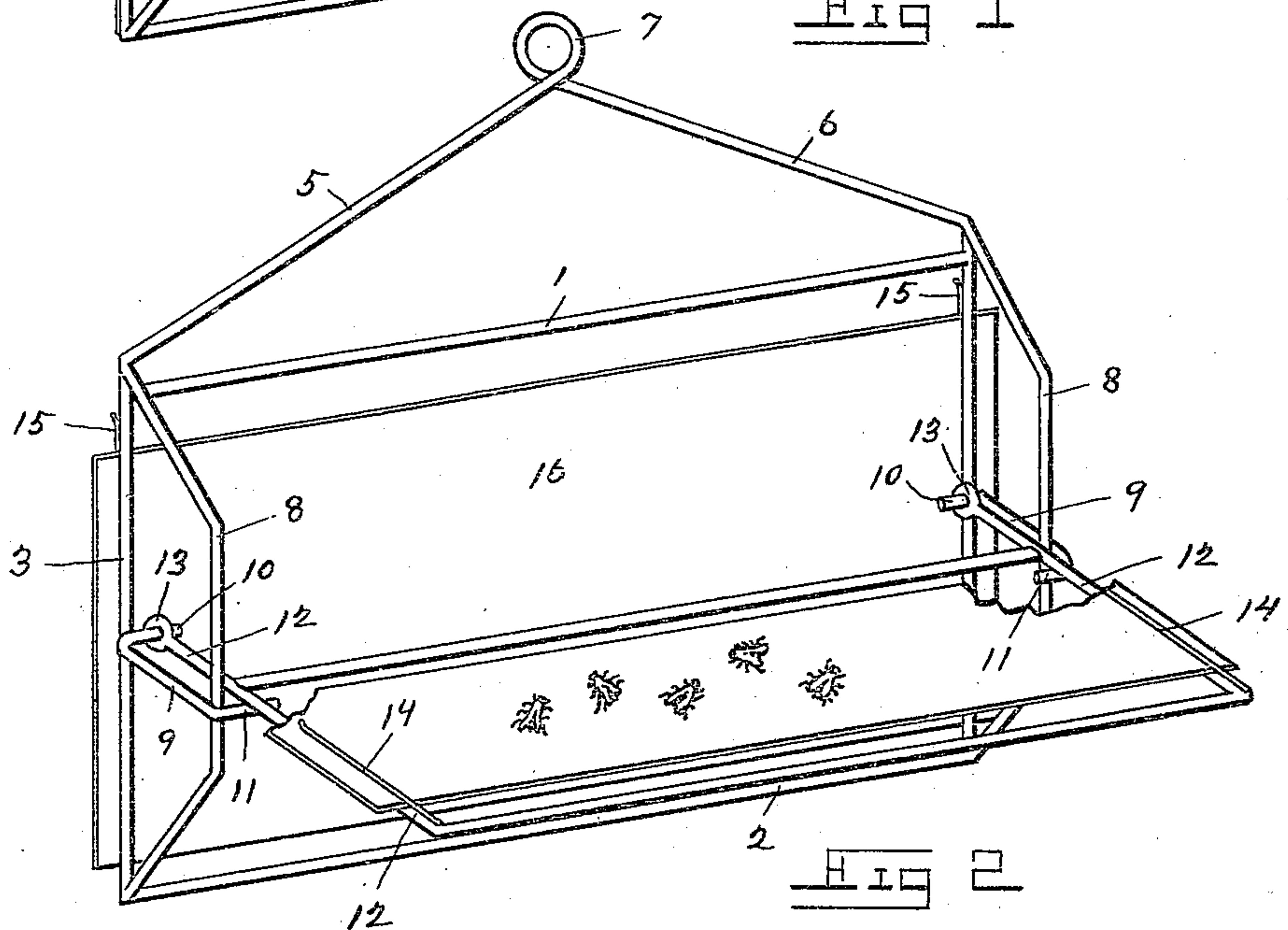
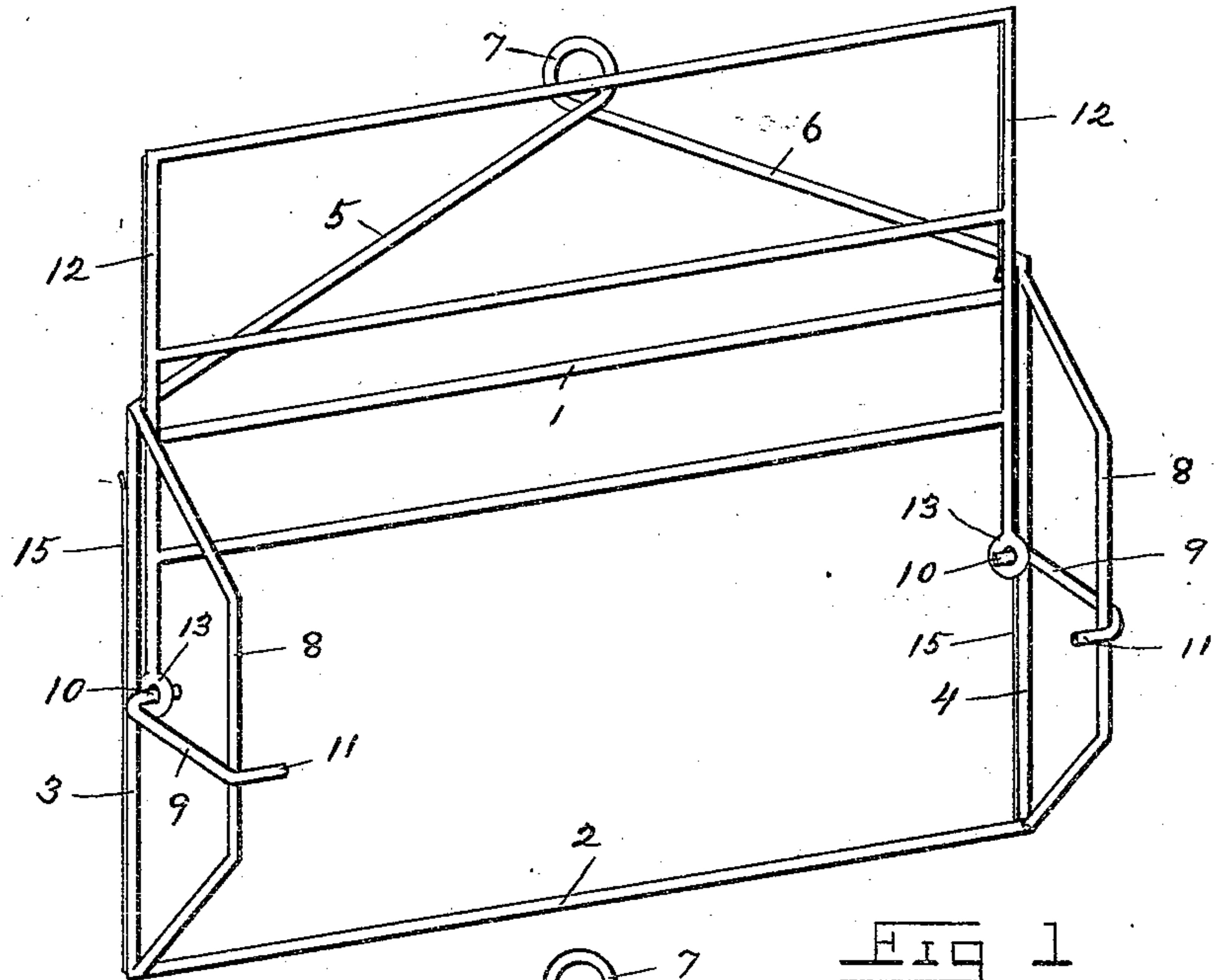

WITNESSES:

J. V. Thompson
M. L. Lefevre

INVENTORS.

Christian F. Stoner.

Frank B. Trout.

BY

John J. Thompson
ATTORNEY

UNITED STATES PATENT OFFICE.

CHRISTIAN F. STONER AND FRANK B. TROUT, OF LANCASTER, PENNSYLVANIA.

FLY-PAPER HOLDER.

959,898.

Specification of Letters Patent.

Patented May 31, 1910.

Application filed April 29, 1909. Serial No. 492,831.

To all whom it may concern:

Be it known that we, CHRISTIAN F. STONER and FRANK B. TROUT, citizens of the United States, residing at Lancaster, in the county of Lancaster and State of Pennsylvania, have invented certain new and useful Improvements in Fly-Paper Holders, of which the following is a specification, reference being had therein to the accompanying drawings.

Our invention relates to a combined holder for fly-paper, and has for its object to provide a cheap, handy and reliable holder for fly-paper, which may be hung upon the wall and which is provided with a folding and detachable shelf, upon which is retained the fly-paper (upon which the flies become entangled) out of sight, and also obviating all danger of other objects coming into contact with the paper.

While another object of our invention is to provide a novelty of this class in which the back is provided with a suitable clamp for retaining a card, upon which may be displayed appropriate advertising matter.

With these and other objects in view our invention consists in certain construction and combination of parts as will hereinafter be fully described and illustrated in the accompanying drawings, which form a part of this application, and in which like figures of reference refer to corresponding parts in all of the views, but it is fully understood that while we have described our invention as shown in the accompanying drawings, that we do not confine ourselves to the exact design as shown, as slight changes may be made in the arrangement of the parts without departing from the spirit of the invention.

In the drawings:—Figure 1, is a perspective view of the device with the shelf closed. Fig. 2, is a perspective view of the device with the shelf open and the paper partly cut away to show the method of attaching the shelf.

Referring to the drawings of our device which we have here illustrated as being made of resilient wire, but which may be made of any suitable material, the same consists of a rectangular frame composed of the top bar 1, the bottom bar 2, and the side bars 3, and

4, all joined together at their ends, and forming the frame. The top bar 1, being also provided with the rods 5, and 6, terminating at their upper ends in the ring 7.

While the side bars 3, and 4, are provided with the brace rods 8, which form extending sides and to which and to the side bars 3 and 4 are secured the bracket arms 9; said bracket arms 9, being formed at their ends with the studs 10, and 11, projecting at right angles to the body of said bracket arms.

The shelf is formed of a rectangular frame, the side rods 12, of which are extended and provided with the eyes 13, which are extended to engage the studs 10, thereby hinging the shelf to the frame, and the side rods 12, are supported with the shelf in a horizontal manner by the studs 11, upon which they rest; while when not in use the shelf may be folded back against the frame, as shown in Fig. 1, of the drawings, or by springing the eyes 13, out of engagement with the studs 10, the shelf may be removed for cleaning, etc.

To retain the fly-paper in place upon the shelf we provide said shelf with the spring clamps 14, which securely retain the paper between themselves and the rods 12. And we further provide the frame sides 3, and 4, with similar spring clamps 15, upon their rear sides for the purpose of holding the card 16, upon which may be displayed suitable advertising matter as desired.

Having thus described our invention what we claim as new and desire to secure by Letters Patent is:—

In a fly-paper holder, in combination with a supporting frame, of hinge studs and bracket arms carried by said frame, a paper-holding shelf formed with rearwardly projecting ends, eyes formed in said projecting ends and adapted to engage said studs, the forward ends of said bracket arms formed with hooked ends for the purpose of supporting said shelf.

In testimony whereof we affix our signatures in presence of two witnesses.

CHRISTIAN F. STONER.
FRANK B. TROUT.

Witnesses:

CHAS. I. BOWMAN,
MABEL L. LEFEVRE.