

A. SCHNEELOCH.
 TYPE BAR FOR TYPE WRITING MACHINES.
 APPLICATION FILED OCT. 9, 1902.

950,543.

Patented Mar. 1, 1910.

2 SHEETS—SHEET 1.

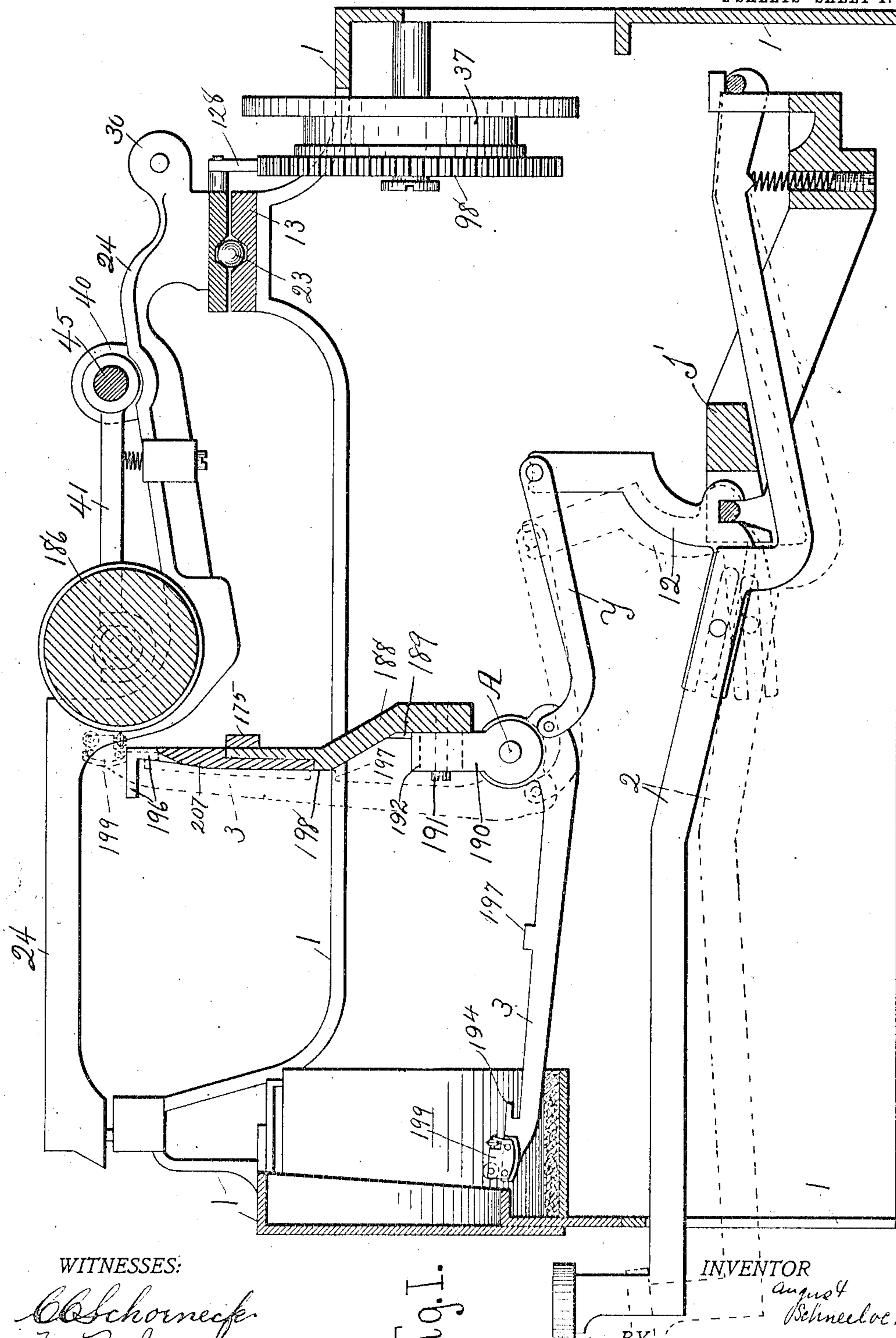

WITNESSES:

A. Schornecker
M. B. Smith

Fig. 1.

INVENTOR

August

Schneeloch

BY

Alfred Wilkerson
 ATTORNEY.

A. SCHNEELOCH.
 TYPE BAR FOR TYPE WRITING MACHINES.
 APPLICATION FILED OCT. 9, 1902.

950,543.

Patented Mar. 1, 1910.

2 SHEETS—SHEET 2.

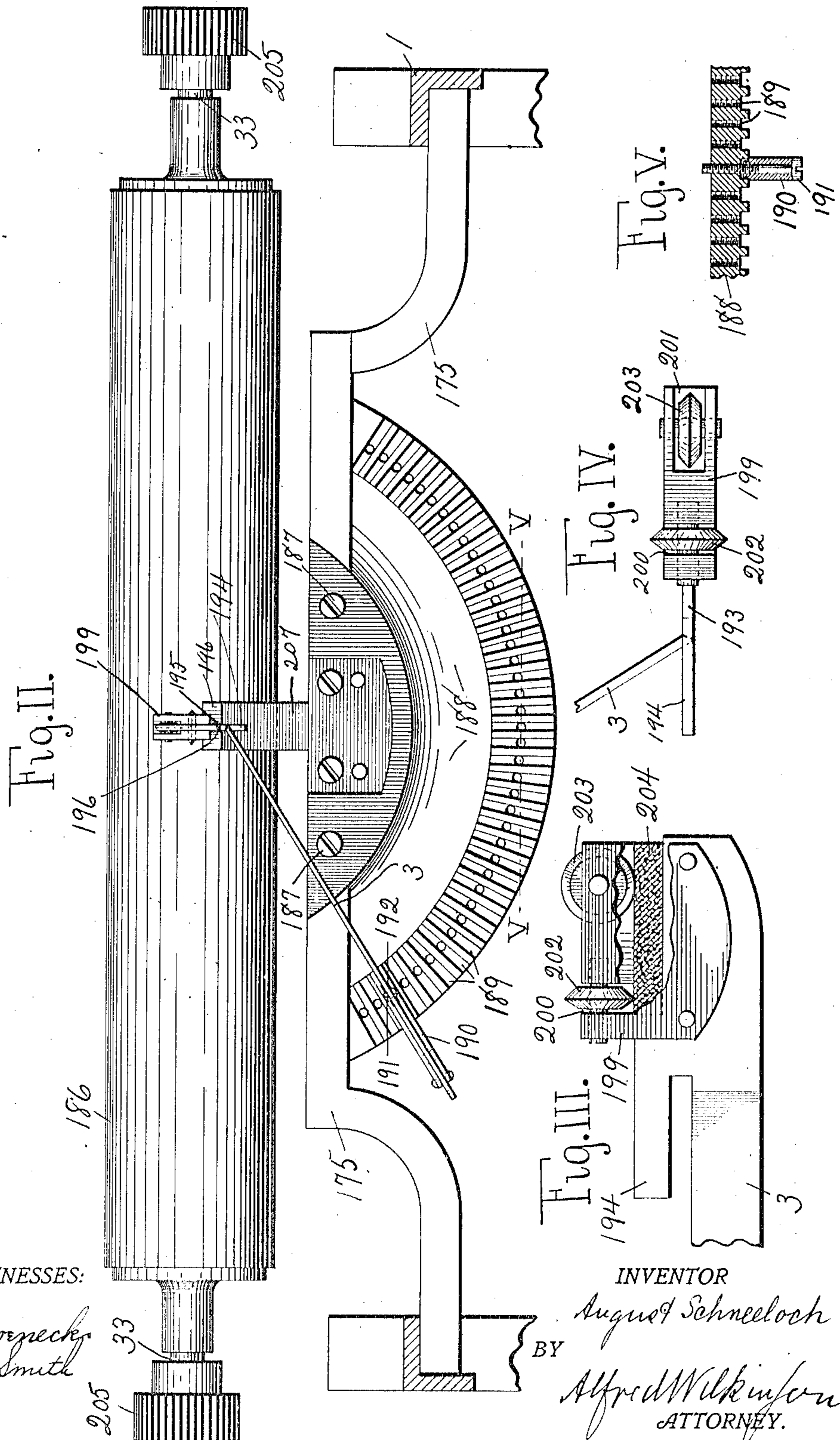

WITNESSES:

Chas. Schorpeck
W. B. Smith

INVENTOR

August Schneeloch

BY

Alfred Wilkinson
 ATTORNEY.

UNITED STATES PATENT OFFICE.

AUGUST SCHNEELOCH, OF SYRACUSE, NEW YORK, ASSIGNOR TO E. C. STEARNS & CO.,
OF SYRACUSE, NEW YORK, A CORPORATION OF NEW YORK.

TYPE-BAR FOR TYPE-WRITING MACHINES.

950,543.

Specification of Letters Patent.

Patented Mar. 1, 1910.

Application filed October 9, 1902. Serial No. 126,603.

To all whom it may concern

Be it known that I, AUGUST SCHNEELOCH, a citizen of the United States, residing at Syracuse, in the county of Onondaga and State of New York, have invented certain new and useful Improvements in Type-Bars for Type-Writing Machines; and I do hereby declare the following to be a full, clear, and exact description of the invention, such as will enable others skilled in the art to which it appertains to make and use the same.

My invention relates to the type-bars of a typewriting machine, means for supporting the bars, and a line ruling mechanism arranged thereon.

My invention is shown in the drawing herewith, in which—

Figure I is a vertical longitudinal section of a typewriting machine, showing the construction and arrangement of parts of my invention. Fig. II is a front elevation of a portion of the machine showing the segment and means for supporting the type-bars thereon. Figs. III and IV are respectively side elevation and top plan of the line ruling mechanism. Fig. V is a horizontal cross section on line V—V of Fig. II, showing one of the hangers arranged in one of the radial grooves.

In the figures, 1 indicates the main frame, 2 a key lever supported on bracket *j*, carrying link 12 connected by link *y* to the tail of type-bar 3, pivoted at A to the type-bar hanger 190 whereby it is swung into printing position as clearly shown in dotted lines Fig. I. The type-bar is provided with integral stop 197 arranged to engage with segment face 198 immediately after the type strikes the platen to prevent making too heavy an impression.

13 is the rear bar grooved for balls 23.

24 are the carriage side pieces having rear brackets 30 and platen rod brackets 40, in which is journaled the platen rod 45, carrying the swinging arms 41, supporting platen 186 having bushings 33.

37 is the spring barrel carrying gear 98 engaging with carriage rack 128. To segment bracket 175, by screws 187, is secured the segment 188, having radial guiding grooves 189, to which are fitted the type-bar hangers 190, adjustably secured in position, each by its screw 191, engaging with its slot 192; the alinement of each type-bar is ad-

justed by loosening the screw and moving the hanger up and down in the groove. The type-bar ends 193 are arranged at an angle to their type-bars, so that when the type-bar is in printing position, as shown in Fig. II, its type will be in a vertical position and maintained positively therein by the engagement of the type-bar end with recess in the guide 196 at the top of vertical arm 207—the radial grooves being centered on point 195. The type-bar end is extended forming the elongation or tail 194, so that when it engages with the slotted guide there is a long guiding bearing extending below the center 195 toward the fulcrum of the type-bar, insuring a positive guide and a steady impression on the platen.

To the end of any suitable type-bar is secured the specially formed type-bar end or block 199, having the cross slots 200 and 201, in which are journaled the ruling rollers 202 and 203; 204 is an inking pad therefor. Evidently the edges of these rollers can be notched regularly or irregularly to make a dotted or spaced line. When the key lever is depressed and the type-bar thrown forward against the platen, the roller 202 will stand in a horizontal position, so that it will rule a horizontal line when the operator slides the carriage to the right or the left. This horizontal roller 202 prints on the lower case and the vertical roller 203 on the upper case, so that when the latter is held against the platen it will print a vertical line by turning the platen backward or forward by its knobs 205.

Having thus described my invention, what I claim as new and desire to secure by Letters Patent, is—

1. In a typewriting machine, the combination with a type-bar suitably hung, of a block secured on the type-bar end having two slots arranged at right angle in its outer face and a recess below the slots, inking rollers journaled in the respective slots, an inking pad arranged on the block in the recess in contact with the inner edges of the rollers, a key-lever and connections between the type-bar and the key-lever whereby the type-bar is operated and one of the rollers brought into contact with the paper respectively in upper and lower case position.

2. In a typewriting machine, means for sustaining and guiding the type-bars, having in combination a vertical segment se-

cured to the front of the machine and formed with radial grooves, a series of hangers secured in the grooves, type-bars journaled on the hangers, type-bar ends having continuous extensions and arranged at an angle to the type-bar, a vertical guide recessed on its top to receive said ends and extensions and an integral stop on the type-bar to engage with the front vertical face of the segment immediately after the type has made an impression to prevent too heavy an impression.

3. In a typewriting machine, the combination with a type-bar suitably hung of a

block secured on the type-bar end, said block being slotted and having a recess below the slot, an inking roller journaled in the slot, an ink pad arranged in the recess in contact with the roller edge, a key-lever and connections between the type-bar and key-lever whereby the type-bar is operated to bring the rollers into operative position.

In testimony whereof I affix my signature in presence of two witnesses.

AUGUST SCHNEELOCH.

Witnesses:

C. C. SCHOENECK,

M. B. SMITH.