

W. M. BURKLE.

NUTCRACKER.

APPLICATION FILED JAN. 26, 1909.

931,562.

Patented Aug. 17, 1909.

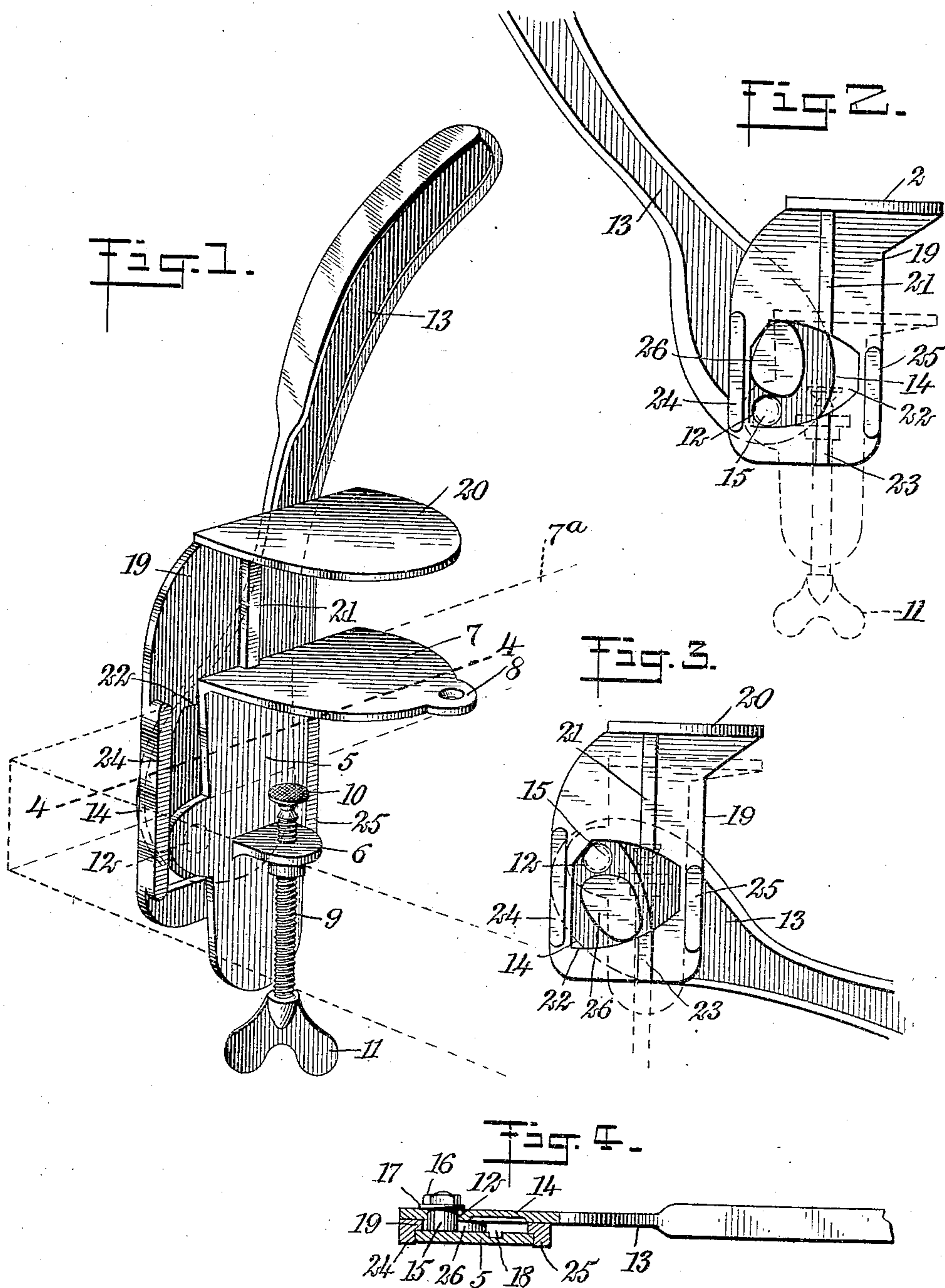

WITNESSES

Walton Harrison

INVENTOR

William Moritz Burkle

BY *Munn & Co.*

ATTORNEYS

UNITED STATES PATENT OFFICE.

WILLIAM MORITZ BURKLE, OF NEW HAVEN, CONNECTICUT.

NUT-CRACKER.

No. 931,562.

Specification of Letters Patent.

Patented Aug. 17, 1909.

Application filed January 26, 1909. Serial No. 474,228.

To all whom it may concern:

Be it known that I, WILLIAM MORITZ BURKLE, a citizen of the United States, and a resident of New Haven, in the county of New Haven and State of Connecticut, have invented a new and Improved Nut-Cracker, of which the following is a full, clear, and exact description.

My invention relates to nut crackers, my more particular purpose being to provide a neat, compact and strong nut cracker adapted to be secured upon the edge of a table and operated by aid of a hand lever.

Reference is to be had to the accompanying drawings forming a part of this specification, in which similar characters of reference indicate corresponding parts in all the views.

Figure 1 is a perspective showing my improved nut cracker ready for use; Fig. 2 is a front elevation showing, in dotted lines, a stationary jaw, and in full lines a movable jaw and hand lever for actuating the same; Fig. 3 is a view somewhat similar to Fig. 2, with the exception that in Fig. 3 the lever is depressed so as to lower the movable jaw; and Fig. 4 is a section on the line 4-4 of Fig. 1, the hand lever, however, being depressed.

A plate 5 is provided with a jaw 7, this jaw having an eye 8, through which a screw may be passed in order to hold the jaw 7 firmly upon a table. This table is shown in dotted lines at 7^a. The plate 5 is further provided with a threaded lug 6 integral with it, and extending through this threaded lug is a threaded bolt 9. The upper end of this bolt carries a milled head 10 for engaging the under surface of the table. The lower end of the threaded bolt 9 is provided with thumb wings 11 whereby it may be turned. A hand lever 13 is provided with a rounded portion 14, and extending through this rounded portion is a hole 12. Mounted upon the plate 5 and extending through the hole 12 is a pin 15, and mounted upon the outer end of the latter is a nut 16. A spring washer 17 is disposed intermediate this nut and the rounded portion 14 of the hand lever 13, as will be understood from Fig. 4. The plate 5 is provided with a groove 18. A movable plate 19 is provided with tongues 21 and 23, which fit into the groove 18. The plate 19 is further provided with an opening 22, and extending into this opening is a

cam 26 integral with the portion 14 of the hand lever. The plate 19 is further provided with lugs 24 and 25 disposed upon opposite sides of the plate 5 and serving as guides for the latter. The plate 19, carrying a jaw 20, is free to move up and down, but has no other motion. The guides 24 and 25 (see Figs. 1 and 2) prevent it from moving sidewise, and the tongues 21 and 23 fitting into the groove 18, prevent it from rocking or turning. When, however, the outer or free end of the hand lever is raised, as indicated in Fig. 1, the plate 19 is raised, and when this lever is depressed, as indicated in Fig. 3, the plate 19 and jaw 20 are carried downwardly. This is because the cam 26, while having a limited play within the opening 22, soon lodges against the wall of this opening and forces the plate 19 upwardly or downwardly, according to the direction in which the hand lever is turned.

The operation of my device is as follows: The handle 13 being raised, as indicated in Fig. 2, a nut is placed upon the stationary jaw 7, and the lever 13 is moved angularly downward, as indicated in Fig. 3. The movable jaw 20 thereupon approaches the stationary jaw 7, thus effectively cracking the nut. The free end of the handle 13 being again raised, the movable jaw 20 is raised accordingly, and the device is ready to receive another nut to be cracked.

Having thus described my invention, I claim as new and desire to secure by Letters Patent:

The combination of a pair of plates provided with jaws one movable relatively to the other, one of said plates being further provided with an opening, a pin mounted upon the other plate and extending into said opening, a hand lever journaled upon said pin and provided with a lug, supported independently of said pin and extending into said opening, said lug being revoluble bodily around said pin as a center serving as a cam for actuating one of said plates relatively to the other, and means for securing one of said plates upon a fixture.

In testimony whereof I have signed my name to this specification in the presence of two subscribing witnesses.

WILLIAM MORITZ BURKLE.

Witnesses:

OWEN C. WRINN,
WILLIAM H. MELIA.