

D. A. BENJAMIN.
EASEL.
APPLICATION FILED DEC. 5, 1908.

930,338.

Patented Aug. 10, 1909.

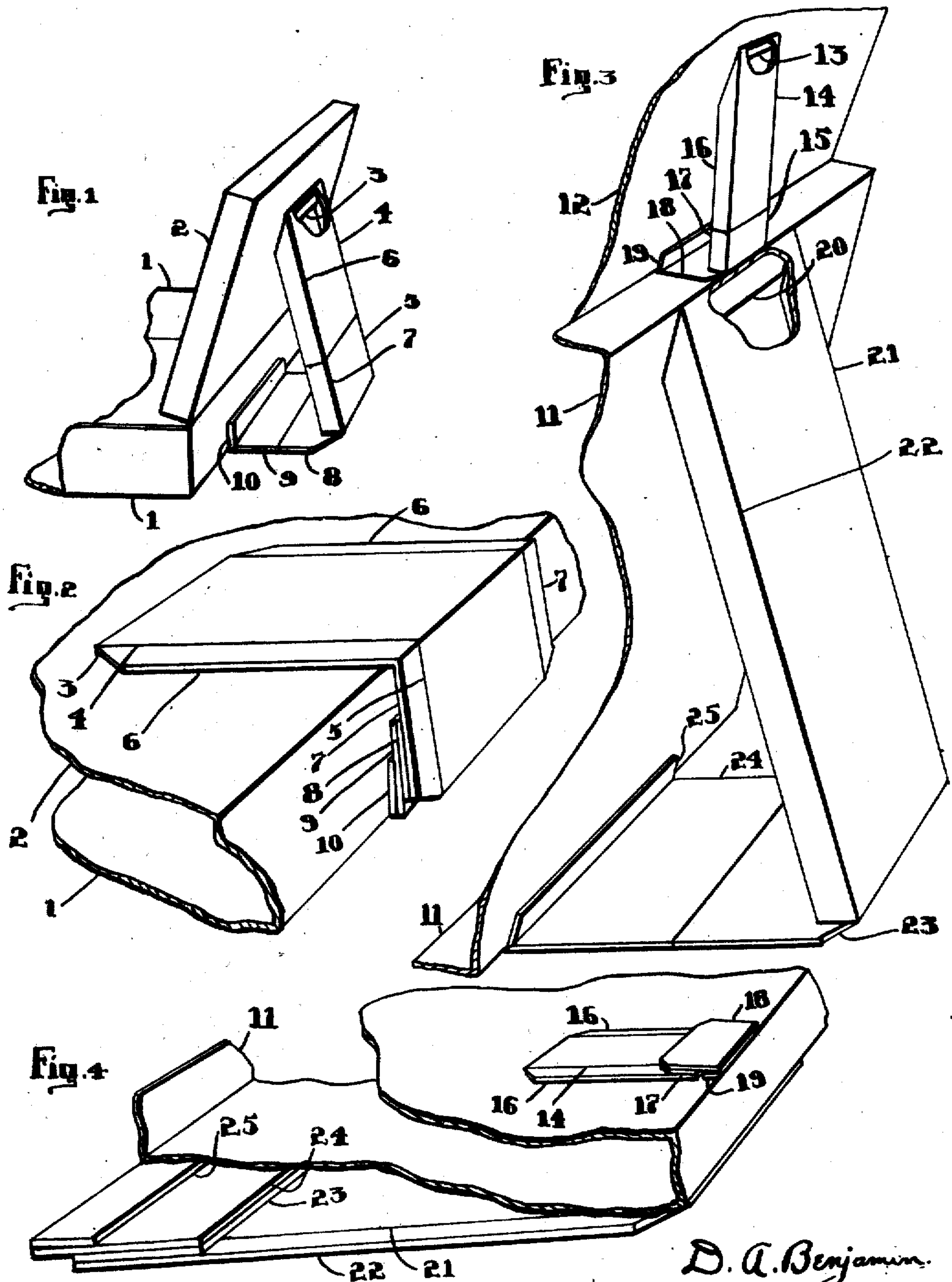

WITNESSES
M. E. Kirk
Hazel Kirk

D. A. Benjamin.
INVENTOR
By Geo. E. Kirk
ATTORNEY

UNITED STATES PATENT OFFICE.

DELSEY A. BENJAMIN, OF TOLEDO, OHIO, ASSIGNOR TO THE STUDIO PRINTING & BOX COMPANY, OF TOLEDO, OHIO, A CORPORATION OF OHIO.

EASEL.

No. 930,338.

Specification of Letters Patent.

Patented Aug. 10, 1909.

Application filed December 5, 1908. Serial No. 466,173.

To all whom it may concern:

Be it known that I, DELSEY A. BENJAMIN, a citizen of the United States, residing at Toledo, Lucas county, Ohio, have invented a new and useful Easel, of which the following is a specification.

This invention relates to a rigid supporting device.

This invention has utility when embodied for display purposes in an easel.

Referring to the drawings: Figure 1 is a perspective view, with parts broken away, of an embodiment of the invention in a display device to positively hold the lid of a box open; Fig. 2 is a perspective view on a larger scale, with parts broken away, of the easel shown in Fig. 1, collapsed or folded over the closed box; Fig. 3 is a perspective view, with parts broken away, of the invention adapted to support the box for display as well as the cover; and Fig. 4 is a perspective view, with parts broken away, of the invention shown in Fig. 3, collapsed or folded up against the closed box.

The box body 1 is provided with the hinged cover 2, to which cover 2 is attached the flap 3 connected to the brace section 4 of the support or easel. This upper portion 4 of the brace section has hinged connection with the lower portion 5 of the brace section. These brace sections are provided on each side with laterally hinged flanges 6, 7 respectively, additionally hinged to each other in the line of the hinge between sections 4, 5. At the upper extremities, flanges 6 are of such form to fit well against the object to be supported or cover 2 to further strengthen the structure as well as make rigid the brace section, while for similar reasons the lower extremities of flanges 7 fit on tie section 8. Tie section 8 is hinged to tie section 9, which latter is hinged to flap 10 attached to box body 1.

For shipment or packing, this support or easel, connected to the box body and to the cover, has its flexible or laterally hinged brace flanges flexed outwardly into the plane of the brace sections. The hinge between the tie sections 8, 9, permits them to be folded against one side of the box body, while in continuing the collapsing, the hinge between brace sections 4, 5, and between flanges 6, 7, permits folding of the brace sec-

tions against one side of the box body and against the cover as the cover is closed.

To place the box in position for display of contents, it is opened, the tie sections unfolded to straight or alined position, and the brace sections alined and their flanges turned inward to thereby lock the support or easel to hold the cover in the fixed display position against movement in either direction. The display box body 11 is provided with the cover 12 to which hinged cover 12 there is attached the flap 13 having hinged connection with brace section 14. Hinged to this brace section 14, is brace section 15, so that there is a hinge intermediate the length of the brace portion 14, 15, permitting folding thereof. These brace sections 14, 15, have laterally flexible portions forming the flanges 16, 17 respectively. The brace portion is held in position by the tie section 18 connected by flap 19 to the cover 12. This support or easel portion serves to maintain the display cover 12 in fixed position as to the box body, while the box body is tilted up for support by a flanged brace section having a tie section. The flap 20, attached to the box body 11, is connected to the brace section 21, having lateral flanges 22. Tie sections 23, 24, hinged to each other, connect the brace section 21 to the flap 25 attached to the box body 11.

In collapsed or folded position, the cover 12 closes the box and has the support lie flat thereagainst by spreading the flanges 16, 17 into the plane of the brace sections 14, 15, and then moving tie section 18 to fold the brace sections against each other and the cover. While against the bottom side of the box body, hinged tie sections 24, 25 fold up against each other, after the flexible flanges 22 have been bent into the plane of brace section 21, to bring the entire easel into most compact shape.

For display, tie sections 24, 25, are unfolded to bring them into a common plane, and the flanges 22 of the brace section 21, are flexed inwardly to lock the easel in position. The tie section 18 is moved to straighten out the brace sections 14, 15, and the flanges 16, 17 are flexed inwardly to lock the cover in display position. The flexible flange feature, or the flanging of the brace section, insures that such brace section shall

act as a brace and not buckle or warp notwithstanding built of paper board. Accordingly when set up for display, it is effective to continue in such position. Besides stiffening the brace against possible buckling, the extremities of the flanges snugly abutting the object supported and the tie section, add materially to the general stability of the structure. To such great features of advantage in display, the easel has also exceptional value in packing or knock-down handling. In such shape, it occupies a minimum of space and is not exposed to be subject to ready breakage. The flexible flange features, while possessing value as indicated, permit hinging or folding of brace sections without detracting from their strength, thereby allowing the knock-down forms to possess exceptional values in the way of general compactness, even to the extent of holding a cover open with the easel at another point connected to the side of the box body, and foldable to permit closing of such cover.

What is claimed and it is desired to secure by Letters Patent is:

1. A collapsible easel comprising a tie section and a flanged brace section intermediately foldable.
2. The combination with a box body and a cover therefor, of an easel having a brace section foldable over the cover and a side of the box.
3. The combination with a box body and a cover hinged thereto, of an easel attached to the box body and to the cover in addition to

the hinging of the cover to the body, said easel having a brace section foldable from the cover over a box side.

4. A collapsible easel having a foldable section provided with a hinged flange movable to lock the section in unfolded position.

5. The combination with a box body and a cover hinged thereto, of a foldable support fixedly hinged to the body and to the cover, said support comprising a brace section having a foldable flange and a tie section, said sections having a hinge connection and foldable against each other.

6. The combination with an object to be supported of a foldable easel comprising a brace section hinged to said support, and a tie section hinged to the brace section, said brace section being provided with a flange movable to lock the sections in unfolded position.

7. A foldable easel comprising a brace section and a tie section, said sections having a hinged connection, and one of said sections having a hinged flange, the line of the hinging of the flange on the section extending away from the connection between the sections, said flange being movable to lock the easel in unfolded position.

In testimony whereof I affix my signature in the presence of two witnesses.

DELSEY A. BENJAMIN.

Witnesses:

C. H. RAUCH,
GEO. E. KIRK.