

J. WISE.
LANTERN.

APPLICATION FILED DEC. 15, 1908.

930,011.

Patented Aug. 3, 1909.

2 SHEETS—SHEET 1.

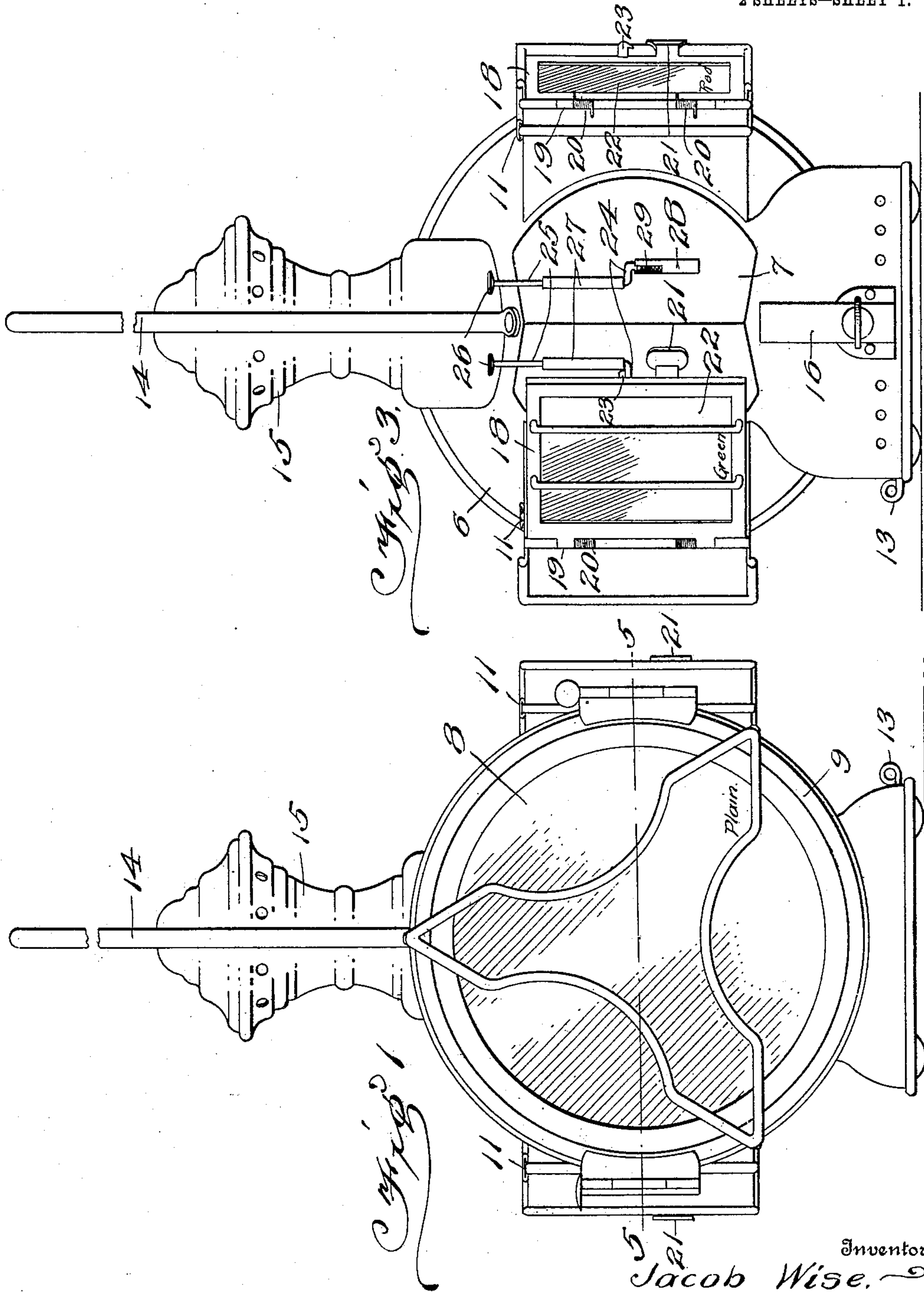

Inventor

Jacob Wise.

Witnesses
Geo L. Thomas
Arthur Masley

By

W. E. Tew

Attorney

J. WISE.
LANTERN.

APPLICATION FILED DEC. 15, 1908.

930,011.

Patented Aug. 3, 1909.

2 SHEETS—SHEET 2.

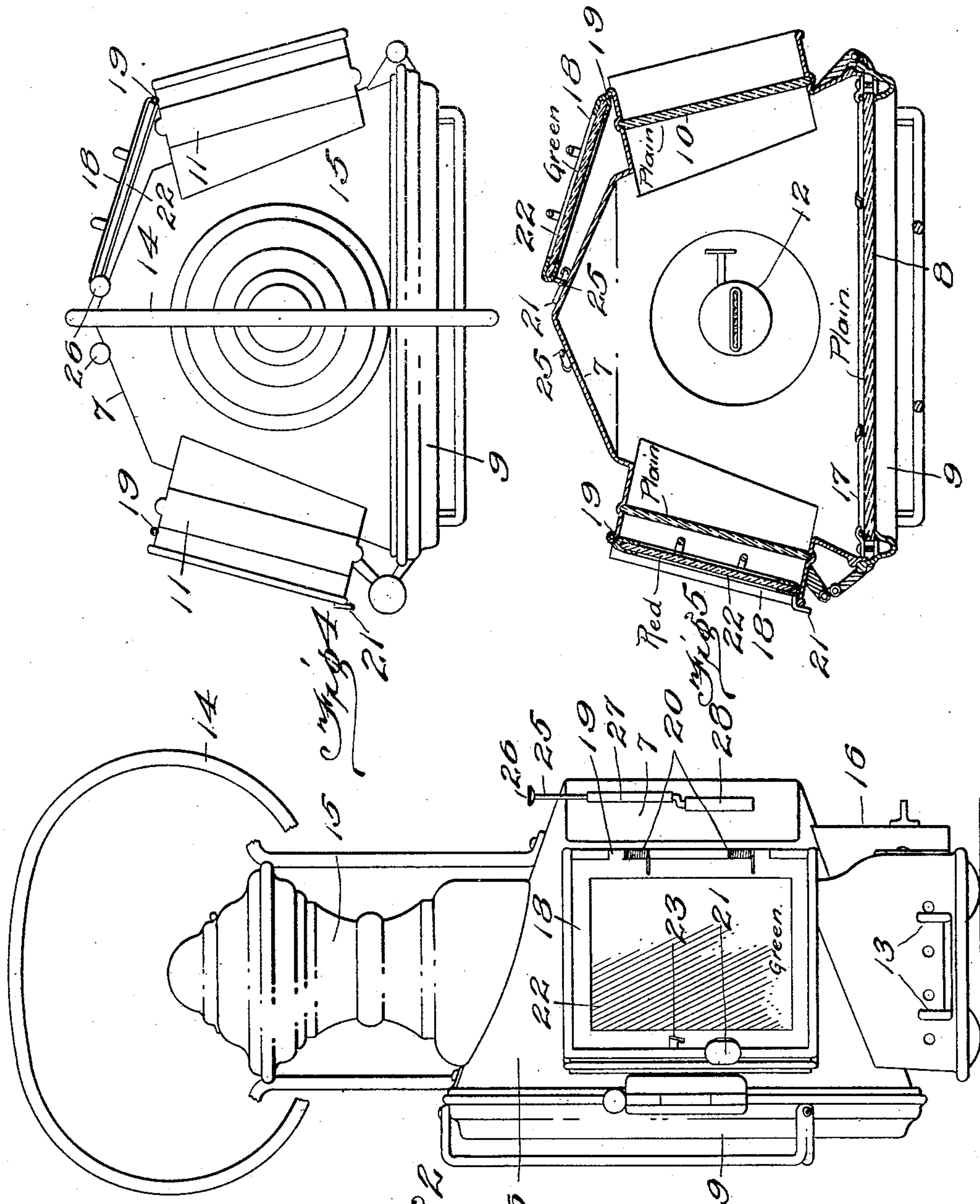

Witnesses

Geo L. Thomas
Arthur M. May

By

By

Inventor
Jacob Wise.

W. E. Tew

Attorney

UNITED STATES PATENT OFFICE.

JACOB WISE, OF CHICAGO, ILLINOIS.

LANTERN.

No. 930,011.

Specification of Letters Patent.

Patented Aug. 3, 1909.

Application filed December 15, 1908. Serial No. 467,604.

To all whom it may concern:

Be it known that I, JACOB WISE, a subject of the Czar of Russia, residing at Chicago, in the county of Cook and State of Illinois, have invented certain new and useful Improvements in Lanterns, of which the following is a specification.

This invention relates to lanterns, and particularly to signal lanterns such as are used by railroad men. It is also capable of use on automobiles, or in any other places where it is desirable to exhibit different colored lights.

As hereinafter described and illustrated the invention is embodied in a lantern which has three openings or windows for the display of the light, and two of the windows are provided with means whereby they can be readily changed from one color to another, as for example from a white light to a green light on one side and from a white light to a red light on the other side. The colored glasses are carried by swinging frames which can be instantly swung over in front of the window or windows desired.

The invention is illustrated in the accompanying drawings in which—

Figure 1 is a front elevation of the lantern; Fig. 2 is a side elevation thereof; Fig. 3 is a rear elevation thereof, one of the colored glasses being shown in inoperative position; Fig. 4 is a top plan view in the position shown in Fig. 3; Fig. 5 is a horizontal section on the line 5—5 of Fig. 1, one of the colored glasses being swung back as in Fig. 3.

The body 6 of the lantern is provided with openings at the front and at each side thereof and at the rear is shaped to form a reflector as indicated at 7. The glass 8 of the front opening is mounted in a ring 9 which is hinged to open and close in any suitable manner. Each of the side openings is provided with a white glass 10 which is held in grooves at the sides of the opening and which may be removed or inserted through an opening covered by a slide 11. The lamp is indicated at 12 and is inserted through an opening in the bottom of the lantern body and is removably held in place by a spring catch 13, these parts not being of special importance or significance in the structure of the lantern. It is provided with a handle 14 at the top, and with a vent head 15. At the back it has a socket 16 whereby it may be mounted on a bracket if desired.

The front glass is protected by wires 17 fixed to the rim.

In addition to the glass above described, each of the side openings is provided with a swinging window consisting of a frame 18 hinged as at 19 to the rear edge of the case, the hinges being provided with springs 20 which tend to close the window over the openings. Each window has a finger piece 21 whereby it may be taken hold of to open the same. The glass 22 of the window is colored, on one side preferably green and on the other side preferably red. As shown in Fig. 4, the side windows are set somewhat obliquely so that they are not visible from the front. The frame of each window is provided with a hooked projection 23 adapted to be engaged by a catch 24 comprising a bend or offset formed in a push rod 25, which has a finger piece 26 at the top. This push rod works through an upper tubular guide 27 and into a lower tubular guide 28, which latter contains a spring 29 bearing upon the catch.

When the window is swung open the hooked piece 23 will snap over and engage the catch 24, and said window will be thereby held in open position, against the rear part or back of the lantern body. When both windows are so swung open, the lantern will show white in all three directions. To show a color, it is simply necessary to press the finger piece 26 on the desired side, or on both sides, and one or both of the windows will, in consequence of the spring hinges, fly closed, and the side lights will then show the colors of the windows, the front light remaining white.

The lantern will be found very useful as a signal lantern for railway men, and will commonly have the three colors used for signaling, white, green and red. White can be displayed by holding the lantern with the front visible, and either of the other colors can be used by holding the lantern accordingly. When there is no occasion to use the colored lights, all three lights can be set white by swinging open the colored windows, but one or both of said colored windows can be instantly closed by the means above described whenever it becomes necessary to show colored lights. When used on an automobile or the like the front light will show white, and the colored windows will ordinarily be closed to show green on one side and red on the other. It is common for

5 railroad men to have separate lanterns of
different colors, but this is objectionable, as
it is often necessary to display a colored
light without delay, and when different lan-
terns are used there is apt to be more or less
delay in obtaining a lantern of the desired
color. By the present invention, only one
lantern is needed, and it is changeable, as
described, from one color to another, and
10 will therefore be found very convenient and
serviceable.

I claim:

15 1. A lantern having front and side open-
ings with glasses of one color, colored win-
dows hinged beside the side openings and
provided with spring hinges tending to close
the same over said openings, and catches en-
gageable with the windows when they are

open, to hold the same in open position when
desired.

20 2. A lantern having front and side light
openings, colored windows hinged at the rear
edges of the side openings in position to
swing open against the back of the lantern,
the hinges having springs tending to close 25
the windows over said openings, and spring
catches on the back of the lantern, engage-
able with said windows to hold them in open
position when desired.

In testimony whereof, I affix my signature 30
in presence of two witnesses.

JACOB WISE.

Witnesses:

NELLIE FELTSKOG,
WM. J. ROBINSON.