

P. DRINKAUS, SR.
CURTAIN FIXTURE.
APPLICATION FILED FEB. 8, 1909.

929,923.

Patented Aug. 3, 1909.

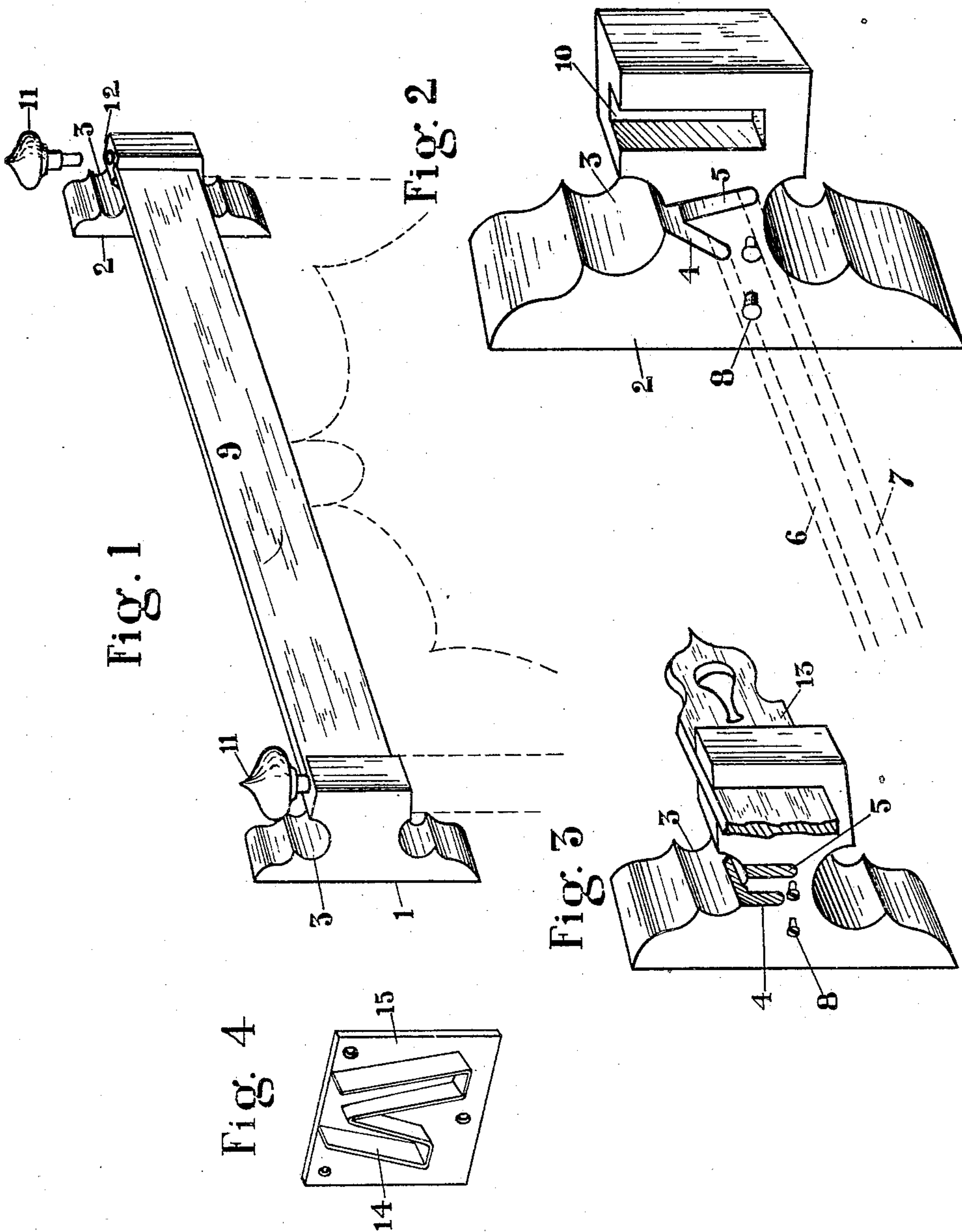

WITNESSES:

E. L. von Ueber.
A. M. Dorr.

INVENTOR

PHILIPP DRINKAUS SR.

BY

[Signature]
ATTORNEYS.

UNITED STATES PATENT OFFICE.

PHILLIPP DRINKAUS, SR., OF DETROIT, MICHIGAN.

CURTAIN-FIXTURE.

No. 929,923.

Specification of Letters Patent.

Patented Aug. 3, 1909.

Application filed February 8, 1909. Serial No. 476,635.

To all whom it may concern:

Be it known that I, PHILLIPP DRINKAUS, Sr., a citizen of the United States of America, residing at Detroit, in the county of Wayne and State of Michigan, have invented certain new and useful Improvements in Curtain-Fixtures, of which the following is a specification, reference being had therein to the accompanying drawings.

10 This invention relates to a curtain fixture, and more especially to one combining the features of a lambrequin, curtain holder or window cornice with curtain poles or rods for use with inner and outer curtains.

15 The invention consists in the matters hereinafter set forth, and more particularly pointed out in the appended claims.

In the drawings, Figure 1 is a view in perspective of a fixture embodying features of the invention. Fig. 2 is a view in detail of one bracket thereof. Fig. 3 is a similar view in detail, of a modification of the bracket suitable for a middle support. Fig. 4 is a view of a separate rod guide plate.

25 Referring to the drawings, 1, 2 indicate brackets of wood, metal, or the like, adapted to be secured on each side of a window casing. The brackets have corresponding concave upper faces 3 at the bottom of which are a pair of downwardly extending grooves 4 and 5, the inner one 4 of which terminates above the outer one 5 both forming guides and sockets for an inner rod 6 and outer rod 7 respectively, the concave faces 3 being so disposed that the rods, when placed on them roll down and drop into the gains. The latter preferably run into one opening having the width of a single gain, as shown in Fig. 2, or they may be disposed in parallel relation as indicated in Fig. 3. In both instances the inner rod grooves 4 terminate above the outer rod groove 5 so that a horizontal row of buttons 8 or the like on the inner face of each bracket extends in from the lower ends of the outer groove beneath the inner groove, allowing a curtain or drape on the outer rod to be turned in and hooked thereon beneath the inner rod, without conflicting with a curtain on the latter.

50 A cornice front or shield 9 is detachably secured at the ends in gains 10 in the brackets so as to conceal the rods 6 and 7, ornamental caps or heads 11 being afterward inserted in suitable dowel pin holes 12 or the ends 13 of the shield may be extended through transverse slots in the brackets as in Fig. 3 to

make a suitable finish. The latter form of bracket is also available for use in the center of a double window across which it is desired to carry a single cornice. In such construction the rod grooves or gains 4 and 5 are either extended entirely through the body of the bracket or else a pair is formed on each of the bracket sides to accommodate the rods of each window. Instead of forming the groove, gains or guides in the body of the brackets, they may be made as indicated in Fig. 4 in suitable ribs 14 on a plate 15 which is attached to the side of the bracket.

By this construction a suitable combined lambrequin and curtain holder and cornice is obtained which may be readily taken down or remounted without the use of tools, and which is ornamental and easily made. Furthermore, the inner rod being used for the inner curtain and the outer rod being intended for the lambrequin, drop curtain or outer drapery to slip over, there is no need of buttons or hooks on the cornice front or shield, and this enables the lambrequin or drop curtain to be placed on the rod and the latter then raised up into place.

Obviously, changes in the details of construction may be made without departing from the spirit of the invention and I do not care to limit myself to any particular form or arrangement of parts.

What I claim as my invention is:—

1. A curtain fixture comprising brackets having concave upper guide surfaces terminating in gains extending partly down the inner faces of the brackets, a horizontal row of curtain supporters extending from the lower end of each outer gain below the inner gain, rods removably seated in the said gains, a horizontal row of curtain supporters in the inner face of each bracket and a front shield detachably interlocking at its ends with the brackets.

2. A curtain fixture comprising brackets having recesses in the outer ends and having concave upper guide surfaces terminating in gains extending partly down the inner faces of the brackets, a horizontal row of curtain supporters extending from the lower end of each outer gain below the inner gain, rods removably seated in the said gains, and a front shield removably secured at its ends in the recesses in the brackets.

3. A curtain fixture comprising brackets adapted to be secured to a window casing,

the proximate faces of the bracket having gains extending from their upper edges partially across the faces toward the lower edges, and the upper faces having concave guide surfaces from whose lowest points the gains open, a horizontal row of curtain supporters extending from the lower end of each outer gain below the inner gain, rods detachably seated in the gains, and a shield strip removably secured at its ends to the brackets in front of the rods.

4. A curtain fixture comprising brackets having recesses in their outer ends and adapted to be secured to a window casing, the proximate faces of the bracket having gains extending from their upper edges partially across the faces toward the lower edges, and the upper faces having concave guide surfaces from whose lowest points the gains open, a horizontal row of curtain supporters extending from the lower end of each outer

gain below the inner gain, rods detachably seated in the gains, and a shield strip whose ends are removably seated in the recesses in the brackets in front of the rods.

5. A curtain fixture comprising brackets having upper concave surfaces with a pair of gains extending down the inner faces of the brackets from the lowest part of the concave surfaces, the inner gains terminating above the outer gains, a horizontal row of curtain supporters extending from the lower end of each outer gain below the inner gain, rods removably seated in the said gains, and a front shield detachably interlocking at its ends with the brackets.

In testimony whereof I affix my signature in presence of two witnesses.

PHILLIPP DRINKAUS, SR.

Witnesses:

OTTO F. BARTHEL,
C. R. STICKNEY.