

O. O. STORLIE.  
SLOTTING DEVICE.  
APPLICATION FILED JUNE 16, 1908.

914,613.

Patented Mar. 9, 1909.

2 SHEETS—SHEET 1.

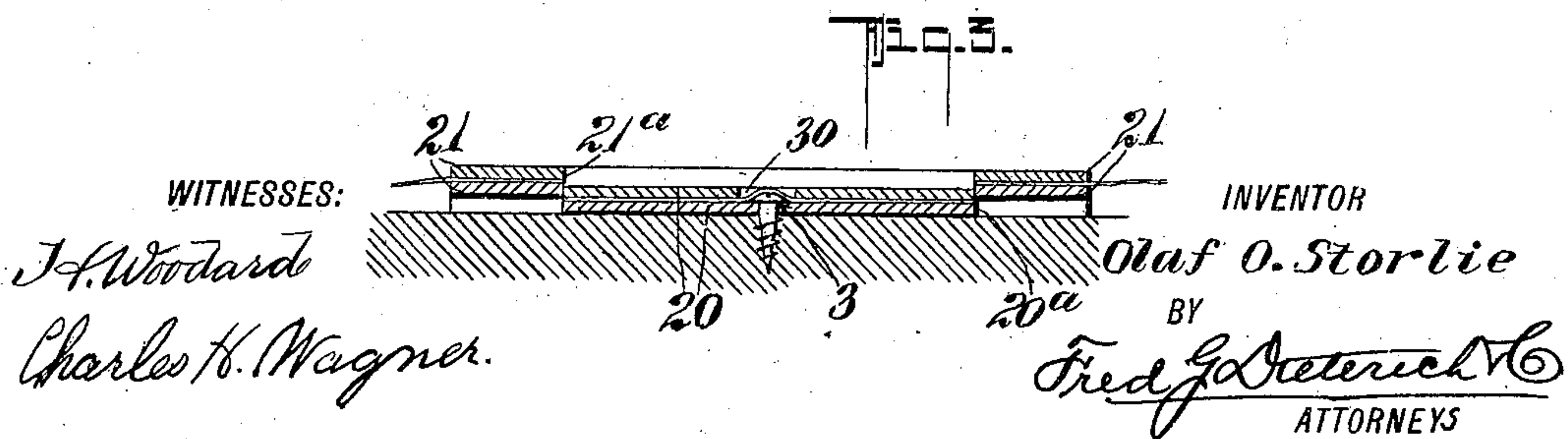
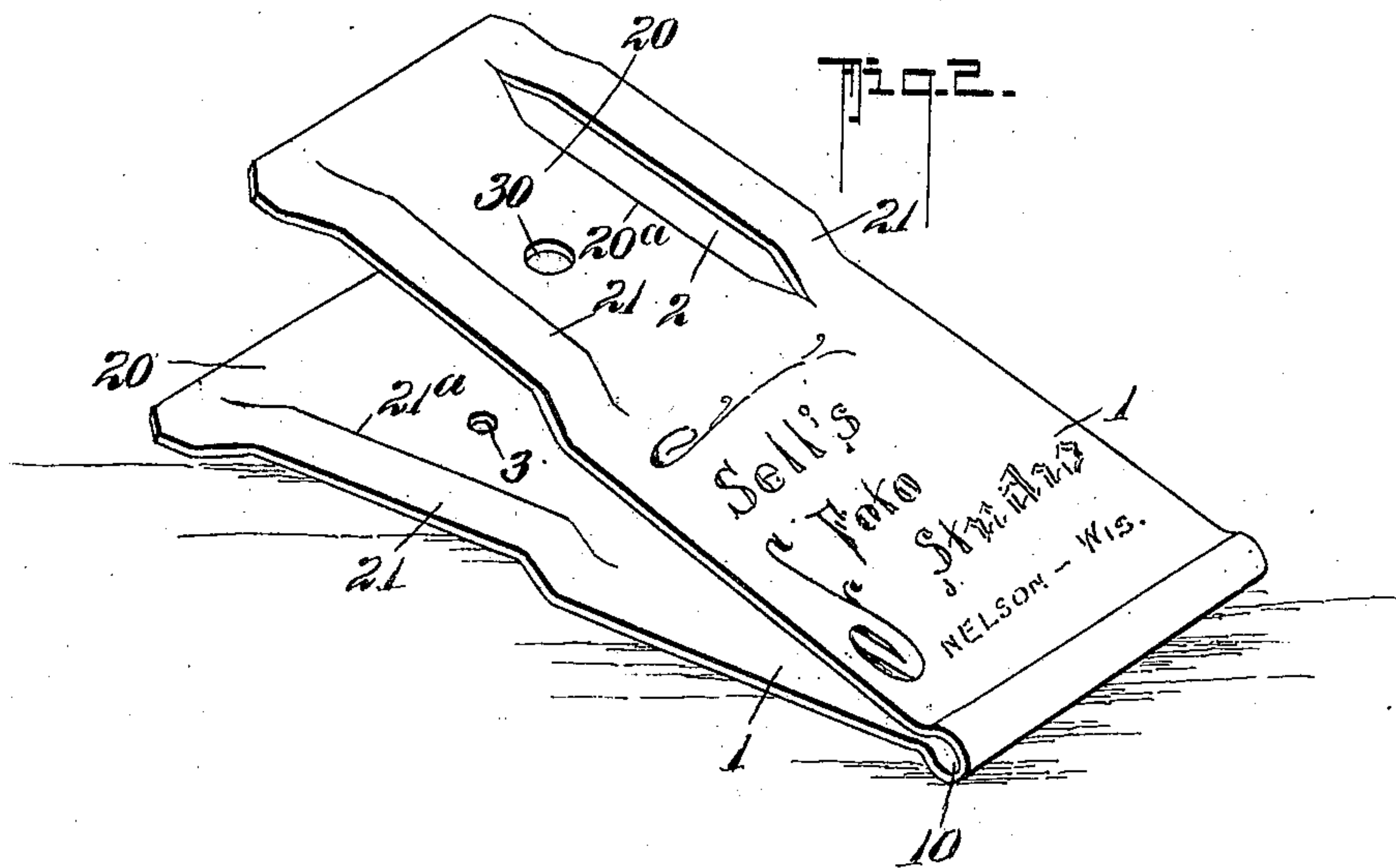
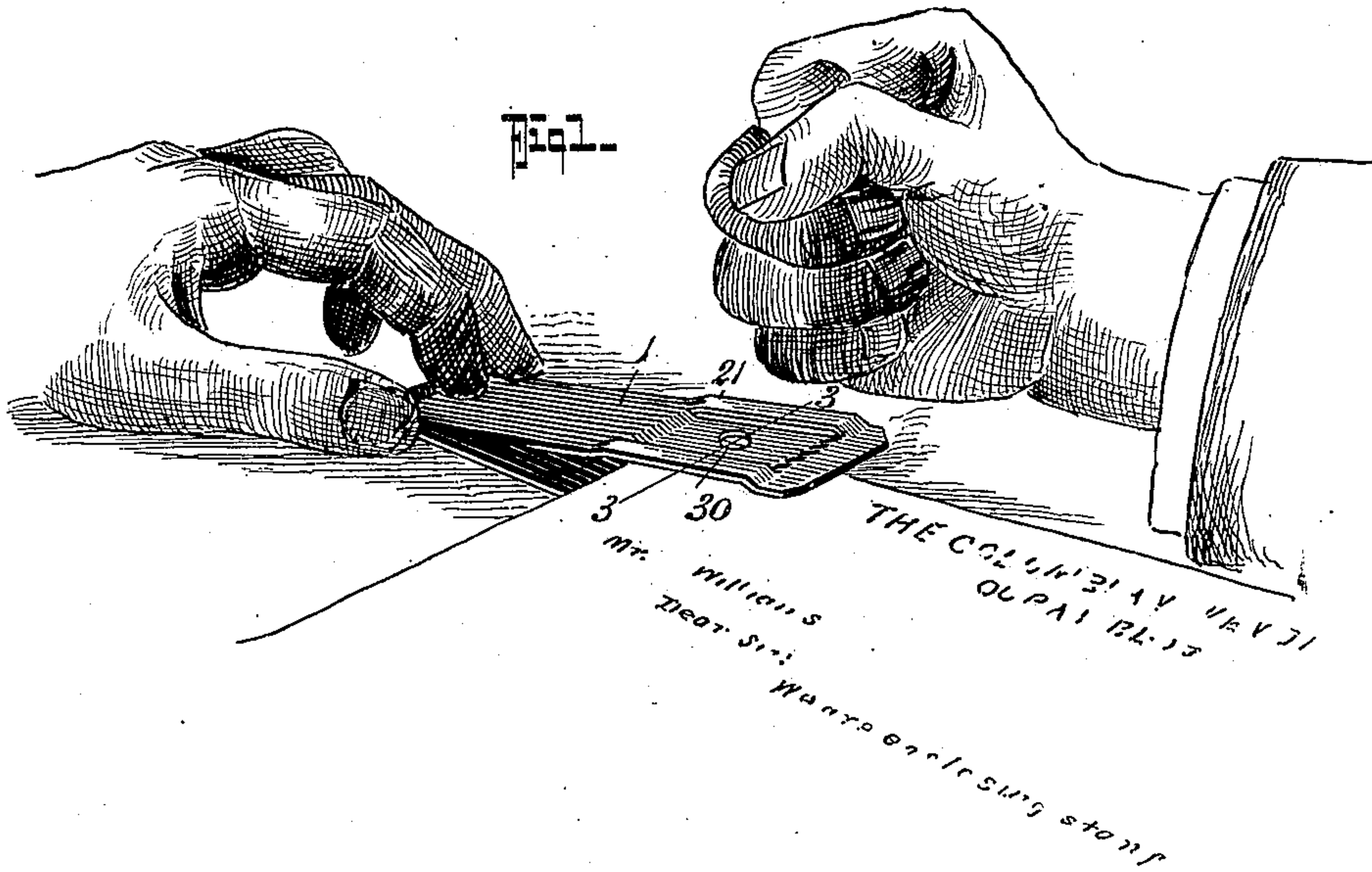

O. O. STORLIE.  
SLOTTING DEVICE.  
APPLICATION FILED JUNE 16, 1908.

914,613.

Patented Mar. 9, 1909.

2 SHEETS—SHEET 2.

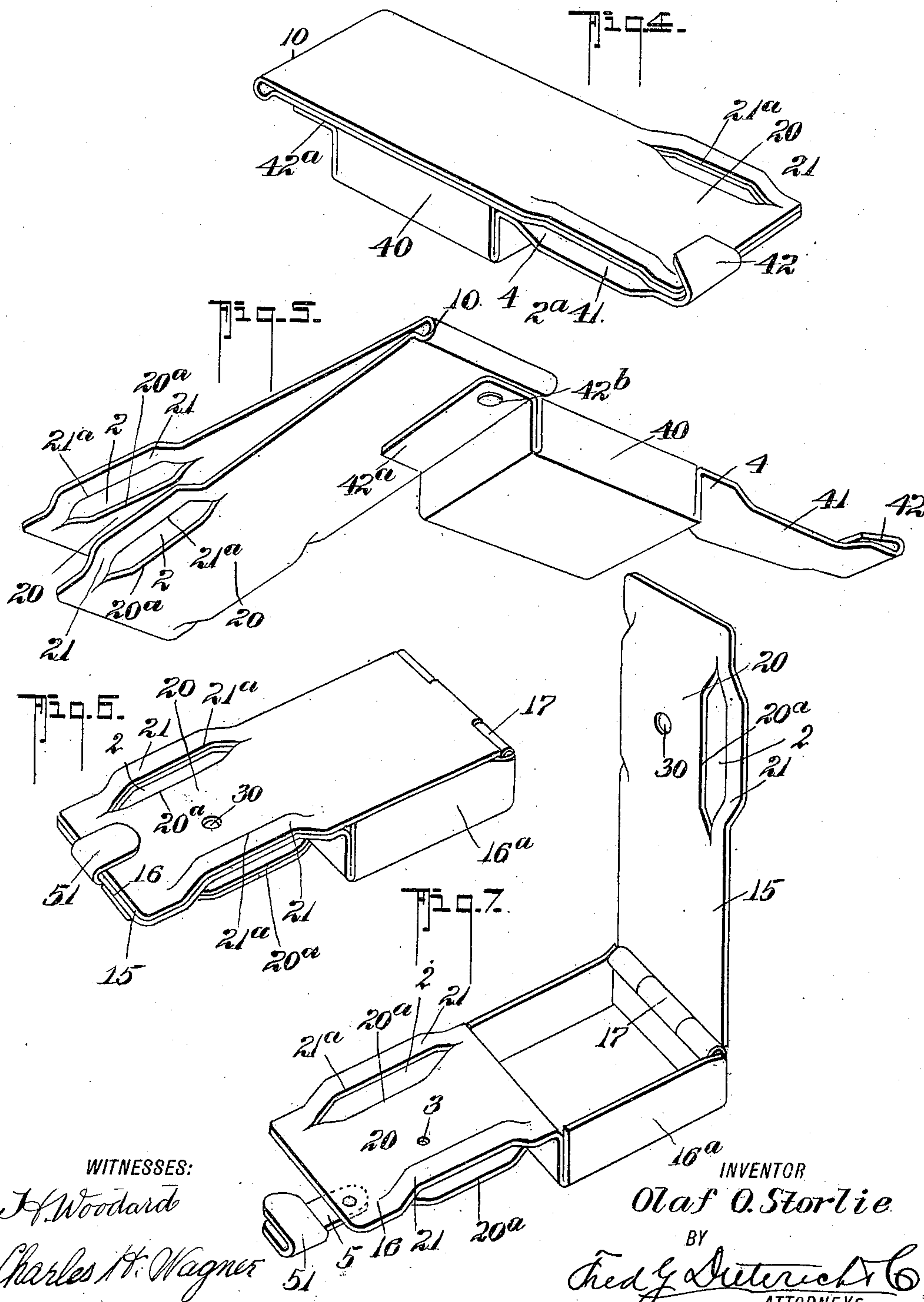

WITNESSES:

*J. Woodard*

*Charles H. Wagner*

INVENTOR

*Olaf O. Storlie*

BY

*Fred G. Suterich & Co.*  
ATTORNEYS



# UNITED STATES PATENT OFFICE.

OLAF O. STORLIE, OF NELSONVILLE, WISCONSIN, ASSIGNOR OF ONE-HALF TO CARL O. DOXRUD, OF NELSONVILLE, WISCONSIN.

## SLOTING DEVICE.

No. 914,613.

Specification of Letters Patent.

Patented March 9, 1909.

Application filed June 16, 1908. Serial No. 438,708.

*To all whom it may concern:*

Be it known that I, OLAF O. STORLIE, residing at Nelsonville, in the county of Portage and State of Wisconsin, have invented a new and Improved Slotting Device, of which the following is a specification.

This invention has for its object to provide a simple, neat and inexpensive device for conveniently cutting slots in letter heads or other papers, into which postage stamps and the like can be conveniently inserted and held when it is desired to inclose a stamp or other like article within a letter.

Another object is to provide a simple and cheap slot cutting device for the purposes stated in which means are also provided for conveniently holding stamps, and a still further object is to provide a device of the character stated that can be conveniently utilized as an advertising novelty.

With the above and other objects in view that will be hereinafter explained, this invention comprehends an implement or device embodying the general and specific structural features hereinafter fully described, specifically pointed out in the appended claims and illustrated in the accompanying drawing, in which:—

Figure 1, is a perspective view of the simplest form of my invention and illustrating the manner in which it is used. Fig. 2, is a perspective view of the same, the slotting members being at their open or normal position. Fig. 3, is a transverse section thereof on the line 3—3 on Fig. 1. Fig. 4, is a perspective view of a modified form of my invention, the same being shown with a stamp holder having means for holding the several parts to a closed or interlocked position. Fig. 5, is a perspective view of the form shown in Fig. 4 with the parts released, and the stamp holder swung outwardly to permit of using the slotting members. Figs. 6 and 7, are perspective views of a further modification of my invention that will be hereinafter specifically referred to.

In the simplest form, my invention consists of a single elongated body formed of spring sheet metal, that is bent upon itself to form a pair of opposing clamping jaws 1—1, and for applying tension to the two jaws so they will normally open sufficiently so that they can be slipped over the letter or other sheet. That part where the blank or member is bent

upon itself, is transversely strengthened by a spring loop 10, as shown.

The outer ends of the two jaws each have a pair of longitudinally extended parallel slots 2—2 and the portions of the jaws between the slots are bent out in one direction as at 20—20 while the portions of the jaws between the slots and the outer edges are bent out in the opposite direction as at 21—21, the bent portions of the two jaws being relatively such that when they are closed down upon each other, the slot edges 20<sup>a</sup>—20<sup>a</sup> of one member and the edges 21<sup>a</sup>—21<sup>a</sup> of the other member form shearing edges that cut the parallel slots in the sheet, such operation being facilitated and rendered positive since in bringing the two jaws together the cooperating shearing edges 20<sup>a</sup> and 21<sup>a</sup> pass each other and entirely through the sheet as it is securely held between the front and side clamping faces of the two jaws, as clearly shown in Fig. 3.

For firmly mounting the device on a desk, one of the jaws has a small aperture 3 for a fastening screw or nail and the other jaw has a larger aperture 30 so that in closing down against its mate, it will pass over the head of the nail or screw and not interfere with the proper closure of the two parts.

If desired, the device may be readily utilized as an advertising novelty by printing, stamping or otherwise affixing the advertisement on the outer faces of the jaws as shown in Fig. 2.

In Figs. 4 and 5 I have shown a modified form of my invention and in this form another sheet metal member 4 is attached to the slotting member and the said other sheet metal member is stamped or otherwise bent up to form a shallow pocket 40 adapted for receiving postage stamps, and with an extending arm 41, the end of which is turned up to form a locking lip 42 adapted for sliding over the outer ends of the two slotting jaws when they are closed together, the said member 4 also having a short rearwardly extending portion 42<sup>a</sup> that is pivotally connected at one edge 42<sup>b</sup> to the under side of the lower slotting jaw, the pivotal connection being such that the member 4 can be swung laterally so its lip 42 will close over the outer ends of the two slotting jaws as shown.

Instead of making the holder as a separate member from the slotting jaws, the device may be made as shown in Figs. 6 and 7, from



which it will be noticed that the two slotting jaws, instead of being bent up from a single blank, are two distinct members 15—16, whose outer or slotting ends are constructed the same as shown in the other forms, but whose other ends have a hinged joint connection 17, and in this last form one of the jaws 16 has a stamp holding pocket 16<sup>a</sup>—integral therewith, that is closed by the other jaw, and for holding the said other jaw to normally close the stamp pocket and prevent loss of stamps therefrom, a latch piece 5 is pivotally secured on the outer end of one of the jaws and has a lip 51 for locking over both of the said outer jaw ends, as shown.

While I have described the pocket portion as especially adapted for holding postage stamps, it is obvious the entire device may be made sufficiently large that the pocket can be used for matches or other small sundries, and further, while I have shown but three forms of my invention, it will be readily apparent that other modifications or variations of the several forms of my invention as shown and described, may be made without departing from the scope of the appended claims.

Having thus described my invention, what I claim and desire to secure by Letters Patent, is:—

1. A device for the purposes stated, comprising a pair of attached opposing jaws, said jaws each having a pair of parallel slots at their outer ends with the portions between the slots bent in one direction and the portions between the slots and the outer edges bent out in the opposite direction.

2. A device for the purposes stated, comprising a pair of attached opposing jaws, said jaws each having a pair of parallel slots at their outer ends with the portions between

the slots bent in one direction and the portions between the slots and the outer edges bent out in the opposite direction one of the jaws having a small aperture for receiving a fastening screw or nail and the other having an aperture large enough to pass over the head of the said screw or nail.

3. A sheet metal device of the character stated comprising a pair of opposing plates having cooperating means stamped in their outer ends for cutting parallel slots in a sheet when closed down thereon, one of said plates having an integral pocket and the other plate forming the closure member for said pocket.

4. A device of the character described, comprising a pair of jaws formed of a single piece of spring metal bent upon itself and of such tension whereby the jaws are normally held open, the said jaws having cooperating means at their outer end for cutting parallel slots in a sheet when closed down thereon, and a pocket secured upon one of the jaws and having means for holding the jaws closed against each other.

5. A device of the character stated, comprising a pair of opposing sheet metal plates having provisions at their outer ends for simultaneously cutting parallel slots in a sheet or the like when closed upon each other, another sheet metal member bent to form a pocket, means for securing said pocket member to one of said first mentioned sheet metal plates, and means carried by said pocket member for holding the first mentioned sheet metal plates in their contacting position.

OLAF O. STORLIE.

Witnesses:

L. H. JOHNSON,  
CARL NOGSLARD.