

R. H. HALL.
STOVE LIFTER.
APPLICATION FILED FEB. 18, 1908.

910,810.

Patented Jan. 26, 1909.

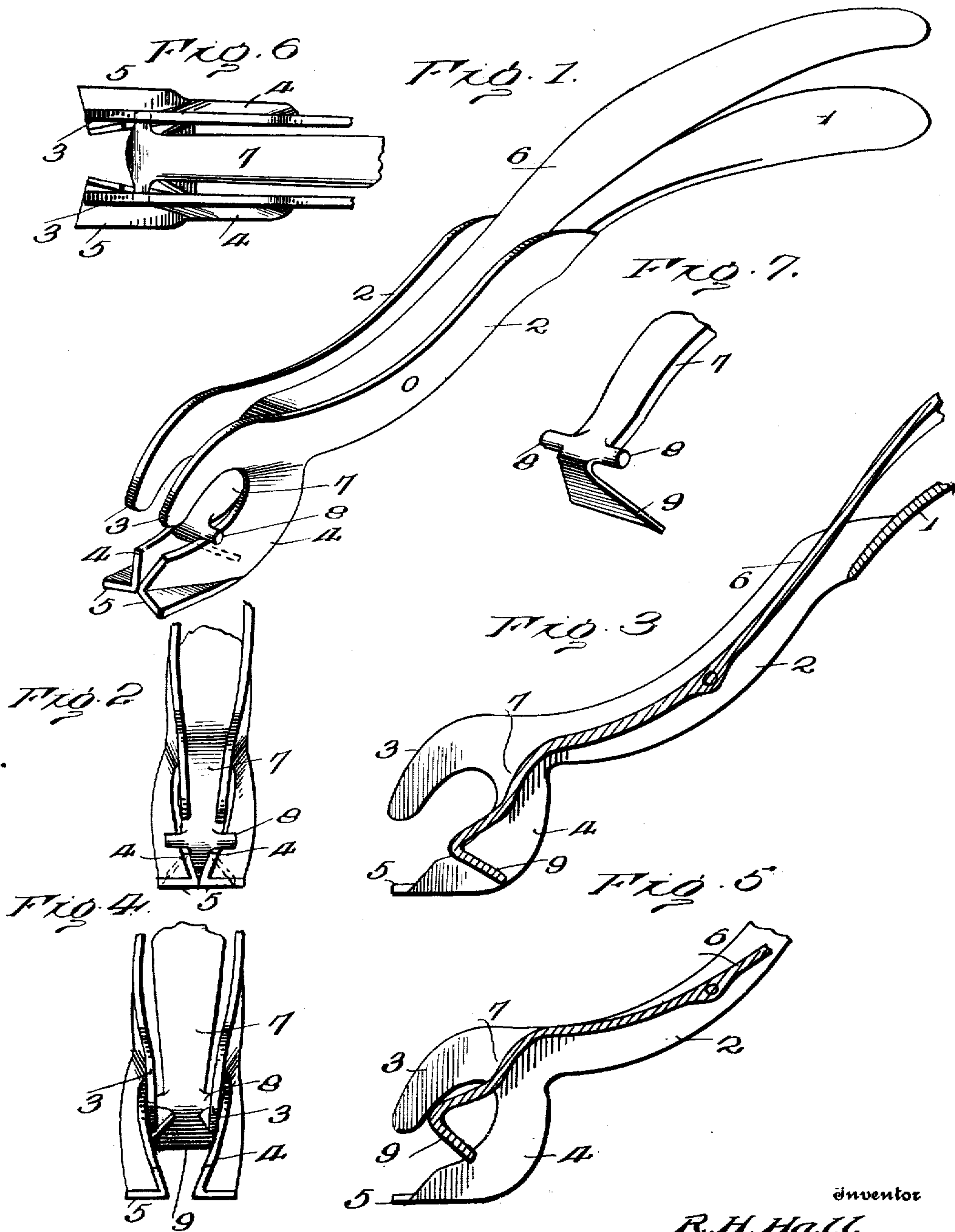

Witnesses

James W. Woodson

By

W. H. Roney, Attorneys.

Inventor

R. H. Hall

UNITED STATES PATENT OFFICE.

ROBERT H. HALL, OF DEL RIO, TEXAS.

STOVE-LIFTER.

No. 910,810.

Specification of Letters Patent.

Patented Jan. 26, 1909.

Application filed February 18, 1908. Serial No. 416,535.

To all whom it may concern:

Be it known that I, ROBERT H. HALL, citizen of the United States, residing at Del Rio, in the county of Valverde and State of Texas, have invented certain new and useful Improvements in Stove-Lifters, of which the following is a specification.

The object of this invention is an improved lifter which is designed particularly to be employed to adjust or remove stove lids and which is arranged to securely grip the lid and thus prevent the latter from slipping off the lifter, as is liable to occur with the lifters ordinarily used for this purpose.

A further object of the invention is an improved lifter which is adapted to be used as a pair of kitchen tongs, and which when applied to a vessel is arranged to firmly grasp the latter so as to permit the vessel to be conveniently and safely moved from place to place.

With these and other objects in view, as will more fully appear as the description proceeds, the invention consists in certain constructions and arrangements of the parts that I shall hereinafter fully describe and claim.

For a full understanding of the invention and the merits thereof, reference is to be had to the following description and the accompanying drawing, in which:

Figure 1 is a perspective view of my improved lifter. Fig. 2 is an end elevation, partly broken away. Fig. 3 is a longitudinal section of the lifter. Fig. 4 is an end elevation, partly broken away, showing the legs spread apart. Fig. 5 is a longitudinal section showing the actuating lever in a rocked position. Fig. 6 is a top plan view, partly broken away. Fig. 7 is a detail view, in perspective, of the front end of the lever.

Corresponding and like parts are referred to in the following description and indicated in all the views of the drawing by the same reference characters.

Referring to the drawing, the numeral 1 designates the handle of my improved lifter which is provided at one end with two transversely spaced side members 2, the front ends of which are curved forwardly and downwardly to form arms 3. Spring legs 4 are secured to or formed integral with the side members back of the arms 3 and are curved forwardly and downwardly in spaced relation to the latter, said legs converging forwardly and having their extremities oppositely and laterally disposed to form feet 5.

An actuating lever 6 is fulcrumed intermediate of its ends between the side members 2 by means of a pin passing therethrough, the rear arm of said lever being normally spaced from the handle 1, as shown. The front arm 7 of the lever normally extends between the legs 4, and its end is preferably crimped upwardly as shown, and is formed with two laterally disposed lugs 8 which constitute stops arranged to abut against the opposing edges of the arms 3 and legs 4 to limit the movement of the lever. The forward extremity of the lever is disposed downwardly and flared rearwardly, and forms a wedge which fits between and bears against the inner faces of the converging spring legs 4.

In the practical use of my improved lifter, the feet 5 are inserted in the socket of a stove lid, and the rear arm of the actuating lever is depressed. This obviously rocks the lever and moves the flared extremity or wedge thereof in a direction to spread apart the legs 4 and the feet 5 attached thereto. The feet 5 are thus spread apart within the socket of the stove lid, and are held securely therein until the actuating lever is returned to its original position which thus removes the wedging force and permits the legs 4 to spring into their normal positions. In another use of this improved lifter, the latter is applied to a vessel so that the upper edge thereof is received in the space between the arms 3 and the legs 4, the lever being then rocked so that the crimped end thereof bears against the vessel, and thus causes the latter to be securely gripped by the device, so that the vessel may be conveniently and safely moved from place to place as desired.

Having thus described the invention, what I claim is:

1. A lifter comprising a handle, legs secured to the handle, a wedge interposed between the legs, and means for operating the wedge to spread the legs apart.

2. A lifter comprising a handle, legs secured to the handle, and an actuating lever fulcrumed on the handle with its forward extremity fitting between the legs and constituting a wedge to spread the same apart.

3. A lifter comprising a handle, legs secured to the handle and converging forwardly, feet formed at the extremity of said legs, an actuating lever fulcrumed on said handle, and a backwardly flared wedge formed at the forward end of the actuating lever and adapted to spread the legs apart.

4. A lifter comprising a handle, spaced
members secured at one end to the handle,
legs secured to the respective members and
converging forwardly, and an actuating le-
5 ver fulcrumed intermediate of its ends be-
tween the members, the forward end of said
lever extending between the legs with its ex-
tremity rearwardly disposed therebetween
and constituting a wedge.
10 5. A lifter comprising a handle, legs se-
cured to the handle and converging for-
wardly, feet formed at the extremity of said
legs, an actuating lever fulcrumed on said
handle, and a backwardly flared wedge formed
15 at the forward end of the actuating lever and
adapted to spread the legs apart, the for-
ward end of the lever being formed with lat-
erally disposed lugs.

6. A lifter comprising a handle, spaced
20 side members secured at one end to the han-
dle and formed at their other ends with arms,
legs secured to the respective side members
and spaced from the arms, and an actuating
lever fulcrumed intermediate of its ends be-

tween the side members, the forward end of 25
said lever normally extending between the
legs and being arranged to be swung toward
the arms.

7. A lifter comprising a handle, spaced
side members secured at one end to the han- 30
dle and formed at their other ends with arms,
legs secured to the respective side members
and spaced from the arms, and an actuating
lever fulcrumed intermediate of its ends be-
tween the side members, the forward end of 35
said lever normally extending between the
legs and being arranged to be moved toward
the arms, said end of the lever being formed
with laterally disposed stops adapted to abut
against the corresponding edges of the arms 40
and legs to limit the movement of the lever.

In testimony whereof I affix my signature
in presence of two witnesses.

ROBERT H. HALL. [L. S.]

Witnesses:

F. M. ROSE,
E. W. SMITH.