

No. 892,564.

PATENTED JULY 7, 1908.

A. G. STEELE.
STANDARD FENDER FOR PLOWS.
APPLICATION FILED OCT. 19, 1907.

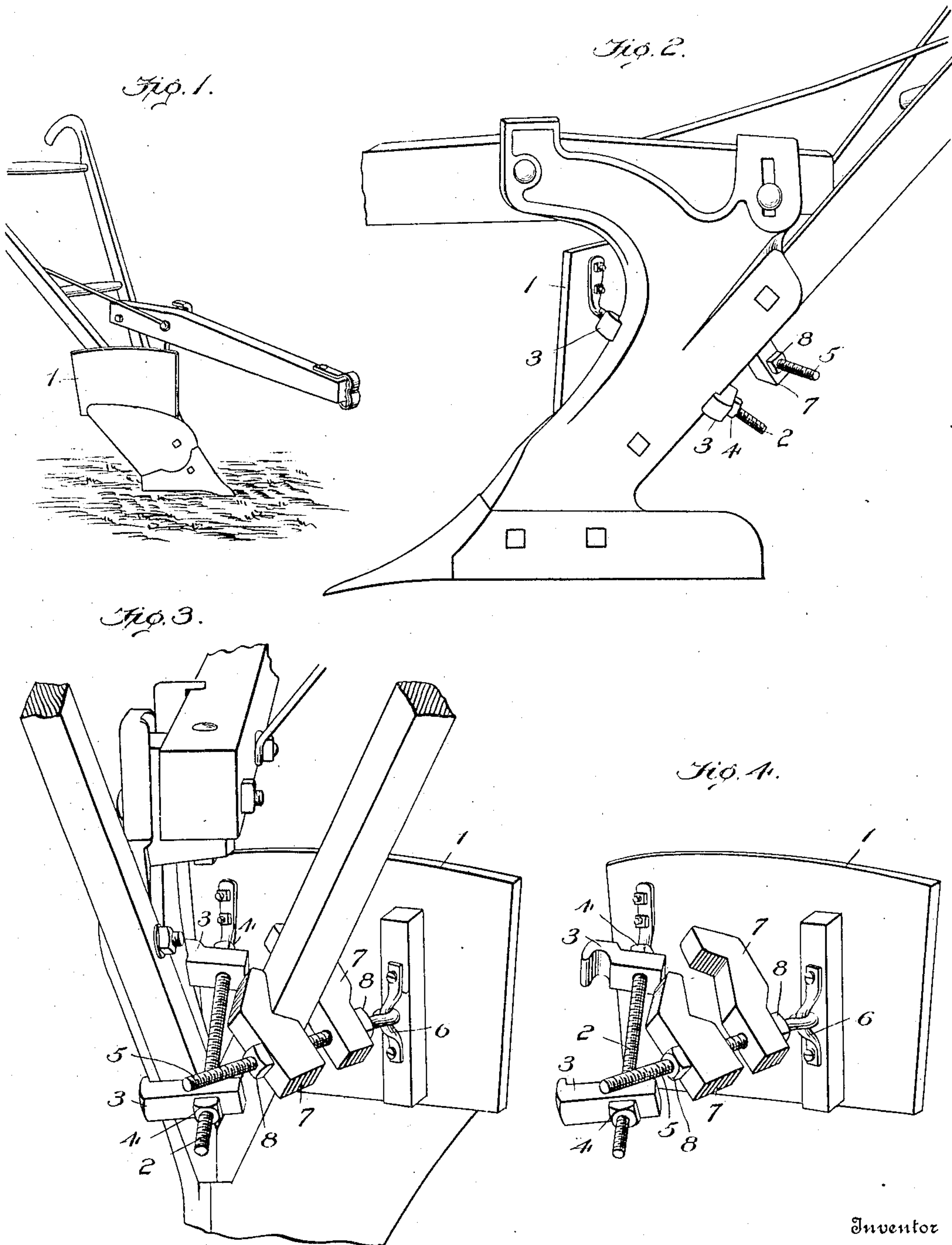

Witnesses

Edwin L. Bradford
Anne B. Johnson

Inventor

A. G. Steele
By *Johnson & Johnson*
Attorneys

UNITED STATES PATENT OFFICE.

ALVA G. STEELE, OF DIXIE, GEORGIA.

STANDARD-FENDER FOR PLOWS.

No. 892,564.

Specification of Letters Patent.

Patented July 7, 1908.

Application filed October 19, 1907. Serial No. 398,144.

To all whom it may concern:

Be it known that I, ALVA G. STEELE, a citizen of the United States, residing at Dixie, in the county of Brooks and State of Georgia, have invented certain new and useful Improvements in Standard-Fenders for Plows; and I do hereby declare the following to be a full, clear, and exact description of the invention, such as will enable others skilled in the art to which it appertains to make and use the same.

The object of my improvement in plows is to prevent choking at the standard which often occurs in plows having a land-side and a turning mold-board by the accumulation of grass and weeds between the standard and the top edge of the mold-board so as to overhang the latter and obstruct the free turning of the earth from the mold-board, causing the plowman to stop and remove the obstruction and the loss of time in doing so. By the provision of a standard fender-plate mounted at the top edge of the mold-board, forming a vertical extension thereof in front of the standard, the turning capacity of the mold-board is greatly increased and the choking at the standard prevented.

In the accompanying drawings which illustrate my improvement Figure 1 shows a turning plow with a standard-fender plate applied thereto. Fig. 2 shows the landside of the plow with the standard fender-plate. Fig. 3 shows a rear view of the plow and the standard-fender and the means for supporting the standard-fender in rear of and at the top edge of the mold-board. Fig. 4 shows the fender-device as an article of manufacture including the means secured to its rear side for attaching it to the plow-standard and to the right plow-handle.

The standard-fender 1, is a plate having an unbroken surface and adapted for attachment to any plow having a turning mold-board and a landside, and it may be constructed of hard wood or steel, the latter preferable. It is mounted so as to extend from the top of the mold-board at the rear side of and just below its top edge, in front of the standard and from the upper rear point of the mold-board, so that it stands beneath the beam about at the same inclination with the moldboard and forms by its flat surface an extension thereof as a backing to prevent the grass and weeds from collecting at the junction of the standard with the top edge of

the moldboard and between it and the standard and from overhanging the top edge of the moldboard, and maintaining thereby a clear turning surface of the latter.

Any suitable means may be provided for firmly supporting the fender at the upper edge of the moldboard, and for this purpose the fender may be clamped by suitable devices to the standard and to the right plow handle. Both clamps are fastened to the rear side of the fender and consists of a pair of jaws adjustably fitted upon a screw 2, one end of which is rigidly secured by an angle-foot to the back of the fender so as to project therefrom crossing the inner side of the standard and having a pair of metal jaws 3—3, adapted to be adjusted and clamped upon the standard, the screw for that purpose having a clamp nut 4—4 for each jaw. The other screw 5, is fastened by a swivel-joint 6, to the back of the fender so as to project therefrom crossing the outer side of the right plow-handle and having a pair of metal jaws 7—7, adapted to be adjusted and clamped upon the handle the screw for that purpose having a clamp nut 8—8, for each jaw. This supports the fender at each end and by reason of the swivel function of the screw-joint of the handle-clamp allows the fender to be secured to plows in which the handles may be nearer together or further apart and adapts the fender device for attachment to any moldboard turning plow.

While it is not necessary to the proper function of the fender that its flat surface shall conform to the curves of the moldboard, it is preferable that the fender be clamped about the middle of its length against the moldboard. Nor is it necessary that the fender conform to the curves of the moldboard, but may have a flat surface as its essential feature resides in such relation to the moldboard as to increase its turning capacity and thereby prevent the choking of the plow.

The fender with its adjustable clamping devices, is made complete as an article of manufacture and may be applied to any plow where the standard and handles have the usual construction of turn moldboard plows and its relation thereto presents a broad flat surface to receive the earth in the direction in which it is turned from the moldboard and keep it from the standard or from falling over the top edge of the moldboard.

I claim:

1. In a plow, the combination with the moldboard including the standard, of a fender for the standard consisting of a plate arranged with its smooth surface forming a vertical extension of the moldboard and in front of the standard, and means for supporting the plate in position to prevent the choking of the plow at the standard.
2. In a plow, and in combination, a moldboard including the standard, a fender-plate having a plain surface mounted in front of the standard at the rear side of the top edge of the moldboard and forming a vertical extension thereof, a screw rigidly secured to the rear side of the fender-plate at one end thereof, a pair of clamps adjustable upon said screw adapted to be clamped upon the standard, a screw having a universal joint connection with the other end of the fender-plate at the rear side thereof, and a pair of clamps adjustable upon said screw adapted to be clamped upon the plow-handle.

3. In a plow, the moldboard including the standard, a fender-plate having a plain surface mounted in front of the standard at the rear side of the top edge of the moldboard and forming a vertical extension thereof for preventing the choking of the standard, and adjustable means secured to the rear side of the fender, whereby it is secured at one end to the standard and at the other end to the plow handle.

4. As a new article of manufacture a fender-plate having a plain surface, and means fastened to its rear side whereby it is adapted to be secured to the standard and to the handle of a plow in front of the standard.

In testimony whereof I have signed my name to this specification in the presence of two subscribing witnesses.

ALVA G. STEELE.

Witnesses:

H. B. AUSTIN,
G. W. AUSTIN.